

California Department of Transportation, District 4
Office of Environmental Engineering

Telecopier (FAX) No: (510) 286-5728

Date: 01/18/2000

Time: 8:25

To: Name: DON HWANG
Agency: ALAMEDA CO.
Attention: SAME
Telephone: 510 567-6746

From: Name: TERESA
Telephone: 510 286-5701

Number of pages being sent (including this page): 02

Message:

ATTACH is a site map indicating
the locations of the wells installed.
Please review and response w/ comments.
Thanks.

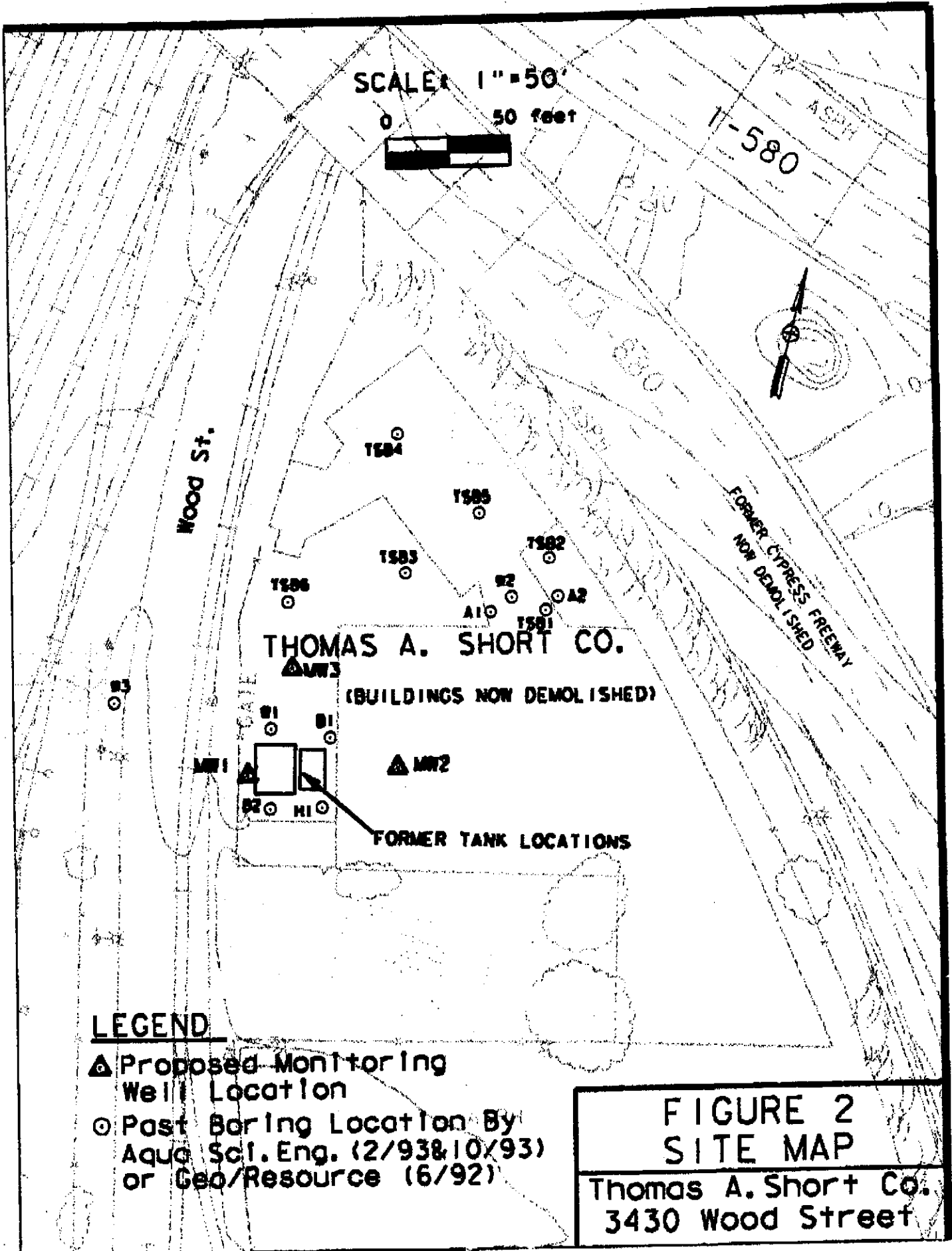

SCALE: 1" = 50'



THOMAS A. SHORT CO.
(BUILDINGS NOW DEMOLISHED)

MW1, MW2, MW3
FORMER TANK LOCATIONS

LEGEND

- ▲ Proposed Monitoring Well Location
- Past Boring Location By:
Aqua Sci. Eng. (2/93&10/93)
or Geo/Resource (6/92)

**FIGURE 2
SITE MAP**
Thomas A. Short Co.
3430 Wood Street