

E AND G CONSTRUCTION
6433 OBERLIN WAY
SAN JOSE CA 95123

RE: FIELD SAMPLING AT

NAME: FREEWAY ARCO
ADDRESS: 2740 98th AVE

DATE: 7-1, 7-2, 93

SAMPLING REPORT

Field sampling was undertaken in accordance with state and local enforcement agency standards and requirements for objective analytical information on the levels of residual contaminants found outside the primary containment structure.

Sampling was performed in accordance with approved methodology at the locations shown on the accompanying site diagram. Numbers on the site diagram are identification numbers which reference the analytical results which will be found in the separate laboratory report.

Sample material was collected in special containers appropriate to the type of analysis intended. Sample containers were sealed, chilled, and transported to a state certified hazardous waste testing laboratory with standard chain of custody records maintained at each transmittal.

Soil samples were taken by:

Company Name: E + G Construction

Address: 6433 Oberlin Way

SAN JOSE CA 95123

Representitive on site: MARK D. EAST / MARK LARSON

signature of rep.: Mark D East / Mark Larson

SAMPLE COLLECTION

Date Collected 7-2-93 Collected By Mark Jenson
 Time Collected 11:50 am Sample Identification No. C-1
 Date Shipped 7-2-93 Sample Container Boots Tube
 Type Of Sample Soil Sample Analysis Needed TPH-X BTX+E
 Sample Source Corner of Island #1 Sample Preservation N/A
 Observations _____

WATER

GROUNDWATER

Well Number _____
 Purge Method _____
 Collection Method _____
 Sample Equipment _____
 Total Well Depth _____ ft. Well Diameter _____ ft.
 Depth to Water _____ ft.
 Borehole Purge Volume _____ ft³
 Screened Interval _____ ft to _____ ft.
 Depth Sample Collected _____ ft.
 Pump Rate _____ gpm Total Pump. Time _____ min.

Pumping time Elapsed (min.)	Borehole Vol. Purged	Temp. (°C)	pH	E.C.

SURFACE WATER:

Collection Location _____
 Collection Method _____
 Observations _____

SOIL

SOIL BORING:
 Boring No. N/A
 Collection Method: Hand Digger Bucket
 (Follow stem, mud rotary, hand driven, etc.)
 Depth Collected 12'
 Observations: _____

BOREHOLE LOCATION

EXCAVATION:

SAMPLE LOCATION: Northwall Southwall

Floor East Wall West Wall

Collection Method: Backhoe & Rubber Mallet

SAMPLE COLLECTION

Date Collected 7-1-93 Collected By Mark Inou
 Time Collected 5:30 PM Sample Identification No. B-1
 Date Shipped 7-2-93 Sample Container Brass Tube
 Type Of Sample Soil Sample Analysis Needed TPH-M BTX+E
 Sample Source Soil below Island #2 Sample Preservation N/A
 Observations _____

WATER

GROUNDWATER
 Well Number _____
 Purge Method _____
 Collection Method _____
 Sample Equipment _____
 Total Well Depth _____ ft. Well Diameter _____ ft.
 Depth to Water _____ ft.
 Borehole Purge Volume _____ ft³
 Screened Interval _____ ft to _____ ft
 Depth Sample Collected _____ ft.
 Pump Rate _____ gpm Total Pump Time _____ min

Pumping time Elapsed (min.)	Borehole Vol. Purged	Temp. (°C)	pH	E.C.

SURFACE WATER:
 Collection Location _____
 Collection Method _____
 Observations _____

SOIL

SOIL BORING:
 Boring No. N/A
 Collection Method: Back Hoe Hand Driven
 (Hollow stem, mud rotary, hand driven, etc.)
 Depth Collected 12'
 Observations: SToned Soil until 12'

BOREHOLE LOCATION

EXCAVATION:

SAMPLE LOCATION: Northwall Southwall

East Wall West Wall

(Flag)

Collection Method: Backhoe & Rubber Mallet

SAMPLE COLLECTION

Date Collected 7-1-93 Collected By Mark East
 Time Collected 3:20 PM Sample Identification No. A-1
 Date Shipped 7-2-93 Sample Container BRASS TUBE
 Type Of Sample Soil Sample Analysis Needed TPH-21 RTX+S
 Sample Source Soil Below Island Sample Preservation N/A
 Observations _____

WATER

GROUNDWATER

Well Number _____
 Purge Method _____
 Collection Method _____
 Sample Equipment _____
 Total Well Depth _____ ft Well Diameter _____ ft.
 Depth to Water _____ ft
 Borehole Purge Volume _____ ft³
 Screened Interval _____ ft to _____ ft
 Depth Sample Collected _____ ft
 Pump Rate _____ gpm Total Pump Time _____ min.

Pumping time Elapsed (min.)	Borehole Vol. Purged	Temp. (°C)	pH	E.C.

SURFACE WATER:

Collection Location _____
 Collection Method _____

SOIL

SOIL BORING:

Boring No. N/A
 Collection Method: Back Hoe
 (Hollow stem, mud rotary, hand driven, etc.)
 Depth Collected 13'
 Observations: Stained Soil until
13'

BOREHOLE LOCATION

EXCAVATION:

SAMPLE LOCATION: Northwest Southwest

 East Wall West Wall

⊙ Floor

Collection Method: Backhoe & Rubber
Mallet

Trace Analysis Laboratory, Inc.

3423 Investment Boulevard, #8 • Hayward, California 94546

Telephone (510) 783-7511
Facsimile (510) 783-7511

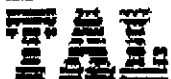

562-4505
Arco Station

CHAIN OF CUSTODY RECORD

Proj. No.		Project Name		No. of Containers	Analyses:	REMARKS
		3-Way Arco ^{2740 98th Avenue}				
Company Name and Address:		E & G Construction 4433 Oberly Way San Jose, CA 95123				
Project Manager: Mark East						
Sample ID	Date	Time	Site Location			
A-1	7/1	3:30	#1 Island at corner of Arco	1-BT	✓	
B-1	7/1	5:30	Island #2	1-BT	✓	
C-1	7/2	11:50	Island #1 Corner of AT	1-BT	✓	
Sampled by: (signature)		Date/Time	Relinquished by: (signature)		Date/Time	
<i>Mark East</i>		3:15 7-2-93	<i>Mark East</i>		3:15 7-2-93	
Received by: (signature)		Date/Time	Relinquished by: (signature)		Date/Time	
Received for Laboratory by: (signature)			Date/Time	TURNAROUND TIME		
<i>Maureen Nequette for TAL</i>			7/2/93 3:15 PM	1-day ASAP TAT		
REMARKS						
TTP, 3 BT, 1-day, Y-Copy						

Freeway ARCO
2740 98TH AVE
OAKLAND CA

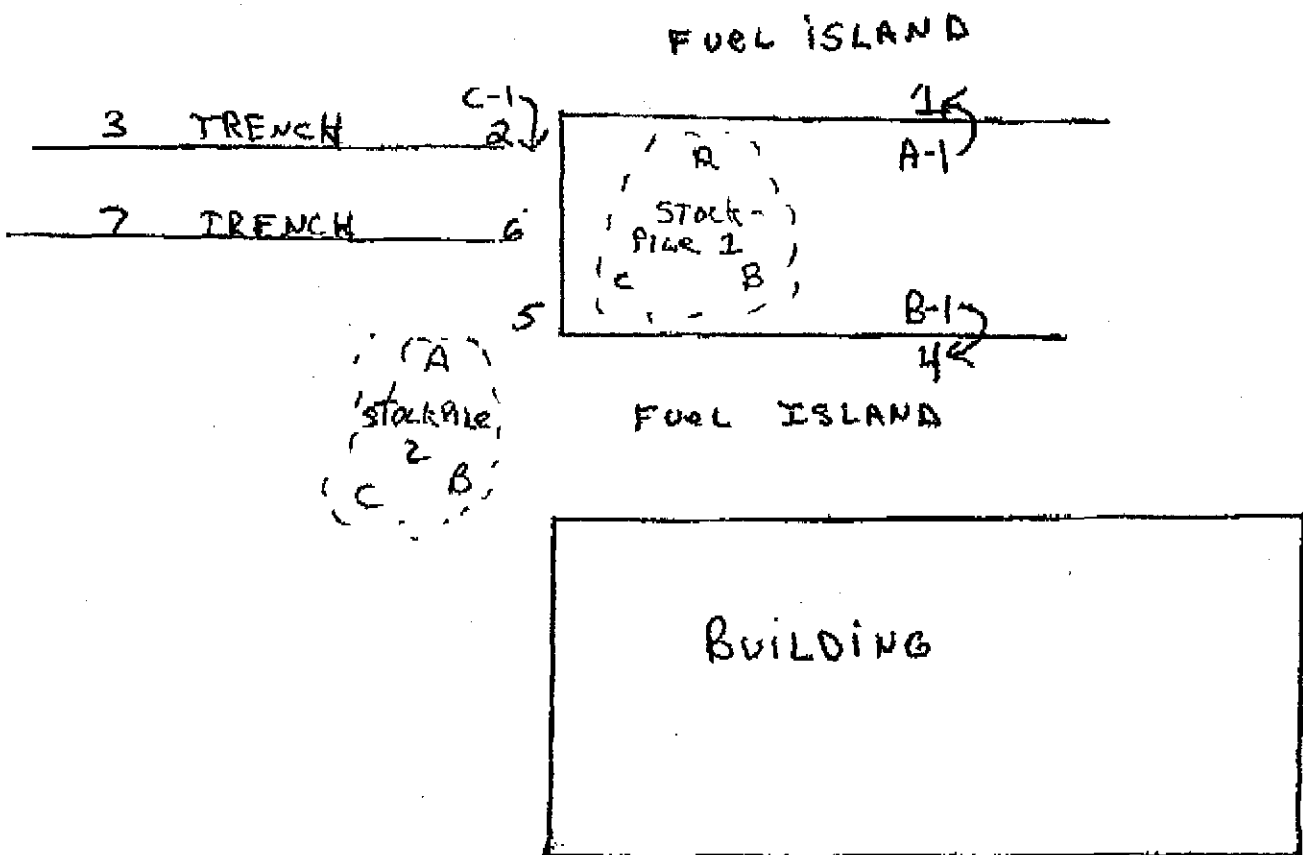
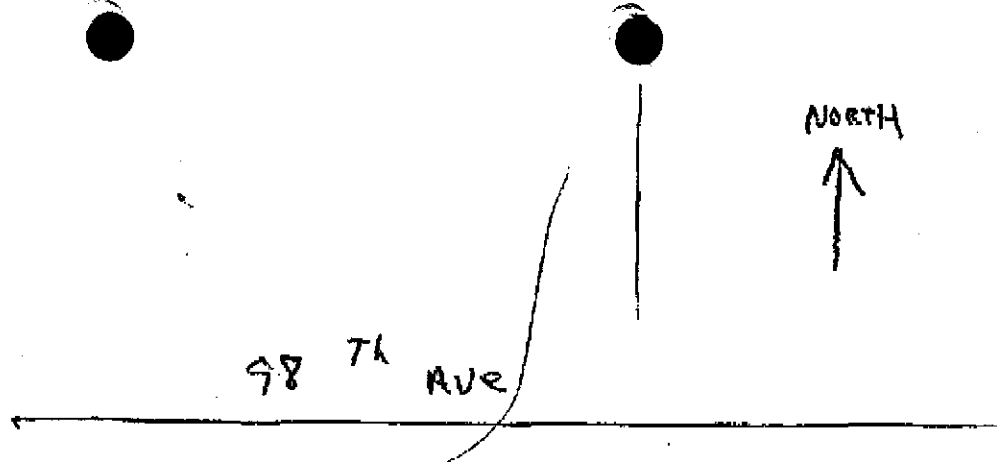

Date Sampled: 7-1, 7-2, /1993

LOG # 3386