

**SOIL SAMPLING, TREATMENT & DISPOSAL
OF CONTAMINATED STOCKPILED SOIL
FROM THE PROPERTY
LOCATED AT 2740 98th AVENUE
OAKLAND, CALIFORNIA
APRIL 14, 2000**

**PREPARED FOR:
MS. MALIHEH FARAJI
2000 STRATTON ROAD
WALNUT CREEK, CALIFORNIA 94598**

**BY:
ENVIRO SOIL TECH CONSULTANTS
131 TULLY ROAD
SAN JOSE, CALIFORNIA 95111**

ENVIRO SOIL TECH CONSULTANTS

LIST OF TABLES

TABLE 1 ... Summary of Stockpiled Soil Samples Analytical Results
Prior to Bio-Treatment

TABLE 2 ... Summary of Stockpiled Soil Samples Analytical Results
After Bio-Treatment

LIST OF FIGURES

FIGURE 1 ... Site Vicinity Map Showing 2740 98th Avenue, Oakland,
California

FIGURE 2 ... Site Plan Showing Location of Buildings, Former UST
Areas, Island & Canopy Areas, Monitoring Wells and
Stockpiled Soil Samples Prior to Treatment

FIGURE 3 ... Site Plan Showing Location of Buildings, Former UST
Areas, Island & Canopy Areas, Monitoring Wells and
Stockpiled Soil Samples After Treatment

LIST OF APPENDICES

APPENDIX "A" ... Table 1 and Table 2

APPENDIX "B" ... Figure 1, Figure 2 and Figure 3

APPENDIX "C" ... Laboratory Reports and Chain-of-Custody
Documentation

APPENDIX "D" ... Request Letter to BFI Landfill for Contaminated
Soil Disposal

APPENDIX "E" ... Stockpiled Soil Disposal Documentation

TABLE OF CONTENTS

Page Number

LETTER OF TRANSMITTAL

1-3

APPENDIX "A"

TABLE 1 - SUMMARY OF STOCKPILED SOIL SAMPLES
ANALYTICAL RESULTS PRIOR TO BIO-TREATMENT T1

TABLE 2 - SUMMARY OF STOCKPILED SOIL SAMPLES
ANALYTICAL RESULTS AFTER BIO-TREATMENT T2

APPENDIX "B"

FIGURE 1 - VICINITY MAP M1

FIGURE 2 - SITE MAP SHOWING SOIL SAMPLES
LOCATIONS PRIOR BIO-TREATMENT M2

FIGURE 3 - SITE MAP SHOWING SOIL SAMPLES
LOCATIONS AFTER BIO-TREATMENT M3

APPENDIX "C"

PRIORITY ENVIRONMENTAL LABS REPORT & CHAIN-OF-CUSTODY (11/25/98)
PRIORITY ENVIRONMENTAL LABS REPORT & CHAIN-OF-CUSTODY (1/17/00)

APPENDIX "D"

ESTC'S REQUEST LETTER TO BFI LANDFILL FOR SOIL DISPOSAL (1/17/2000)

APPENDIX "E"

STOCKPILED SOIL DISPOSAL TO BFI LANDFILL DOCUMENTATION

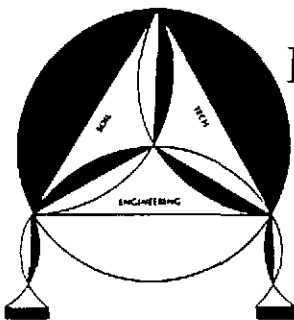

ENVIRO SOIL TECH CONSULTANTS

Environmental & Geotechnical Consultants

131 TULLY ROAD, SAN JOSE, CALIFORNIA 95111

Tel: (408) 297-1500

Fax: (408) 292-2116

April 14, 2000

File No. 7-93-556-SI

Ms. Maliheh Faraji
2000 Stratton Road
Walnut Creek, California 94598

**SUBJECT: SOIL SAMPLING , TREATMENT & DISPOSAL
OF CONTAMINATED STOCKPILED SOIL
FROM THE PROPERTY**

Located at 2740 98th Avenue, in
Oakland, California

Dear Ms. Faraji:

This report summarizes the results of our on-site treatment of approximately 100 yards of contaminated soil excavated from former underground tank area at 2740 98th Avenue, in Oakland, California (Figure 1)

The excavated contaminated soil was stockpiled on a plastic liner at east side of the property (Figure 2). The stockpiled soil was sampled to characterize the soil prior to on-site bio-treatment. Three discrete soil samples were collected from the stockpile on

November 19, 1998. The soil samples were taken randomly at various depths in the stockpile and were labeled as SP-1, SP-2 and SP-3. The stockpiled soil samples were composited in the laboratory into one composite sample that was analyzed for Total Petroleum Hydrocarbons as gasoline and diesel (TPHg and TPHd); Benzene Toluene, Ethylbenzene, Total Xylenes (BTEX); Total Oil & Grease (TOG); Methyl Tertiary Butyl Ether (MTBE); Cadmium, Chromium, Lead, Nickel and Zinc (Cd, Cr, Pb, Ni, Zn). A summary of the analytical results prior to bio-treatment is presented in Table 1.

The stockpiled soil was mixed thoroughly with horse manure and spread. A dilute mixture of nutrient elements (Nitrogen and Phosphorous) was sprayed on the soil surface in order to maintain soil moisture and to stimulate bacterial growth. The stockpiled was covered with plastic except during mixing, fertilizer application and sampling.

On January 11, 2000, the stockpile was resampled to determine the level of the contamination. The verification samples and analysis showed that the treatment was successful in reducing the elevated level of hydrocarbons in the stockpile. The location of samples are shown on Figure 3. Table 2 summarizes the analytical results after bio-treatment.

The BFI Sanitary Landfill, Inc. was provided with results of the analyses of prior bio-treatment and after bio-treatment soil. BFI authorized disposal of the stockpiled soil at their landfill at 4001 north Vasco Road, Livermore, California. Accordingly, the treated soil was disposed at the landfill on January 29, 2000 and March 11, 2000.

File No. 7-93-556-SI

Copies of the laboratory testing during characterization, treatment, over-excavation, request for disposal of contaminated soil and receipts from the landfill where the soil was disposed of are attached.

If you have any questions or require additional information, please feel free to contact our office at (408) 297-1500.

Sincerely,

ENVIRO SOIL TECH CONSULTANTS



LAWRENCE KOO, P. E.

C. E. #34928

FRANK HAMEDI-FARD
GENERAL MANAGER

A P P E N D I X "A"

ENVIRO SOIL TECH CONSULTANTS

TABLE 1
SUMMARY OF STOCKPILED SOIL
SAMPLES ANALYTICAL RESULTS
PRIOR TO BIO-TREATMENT
IN MILLIGRAM PER KILOGRAM (mg/Kg)

Date	Sample No.	TPHg	TPHd	B	T	E	X	MTBE	TOG	Cd	Cr	Pb	Ni	Zn
11/19/98	SP-1,2,3	ND<1	57	ND<0.005	ND<0.005	ND<0.005	ND<0.005	ND<0.005	680	1.2	3.1	2.9	22	17

TPHg - Total Petroleum Hydrocarbons as gasoline

BTEX - Benzene, Toluene, Ethylbenzene, Total Xylenes

TOG - Total Oil & Grease

Cr - Chromium

Ni - Nickel

ND - Not Detected (Below Laboratory Detection Limit)

TPHd - Total Petroleum Hydrocarbons as diesel

MTBE - Methyl Tertiary Butyl Ether

Cd - Cadmium

Pb - Lead

Zn - Zinc

TABLE 2
SUMMARY OF STOCKPILE SOIL
SAMPLES ANALYTICAL RESULTS
AFTER BIO-TREATMENT
IN MILLIGRAM PER KILOGRAM (mg/Kg)

A. MOTOR OIL, BTEX, EPA 8260 AND EPA 8270 RESULTS:

Date	Sample No.	Motor Oil	B	T	E	X	8260	8270
1/11/2000	S-5,6,7,8	16	ND<0.005	ND<0.005	ND<0.005	ND<0.005	ND<0.005	ND<0.3

B. CAM 17 RESULTS:

Date	Sample Number	Reporting Metals	Concentration Detected
1/11/2000	S-5,6,7,8	Antimony	ND<0.1
		Arsenic	ND<0.01
		Barium	1.8
		Beryllium	ND<0.01
		Cadmium	1.4
		Chromium	3.2
		Cobalt	ND<0.05
		Copper	1.8
		Lead	3.3
		Mercury	ND<0.002
		Molybdenum	ND<0.05
		Nickel	16
		Selenium	ND<0.01
		Silver	ND<0.05
		Thallium	ND<0.2
		Vanadium	ND<0.05
		Zinc	17

A P P E N D I X "B"

ENVIRO SOIL TECH CONSULTANTS

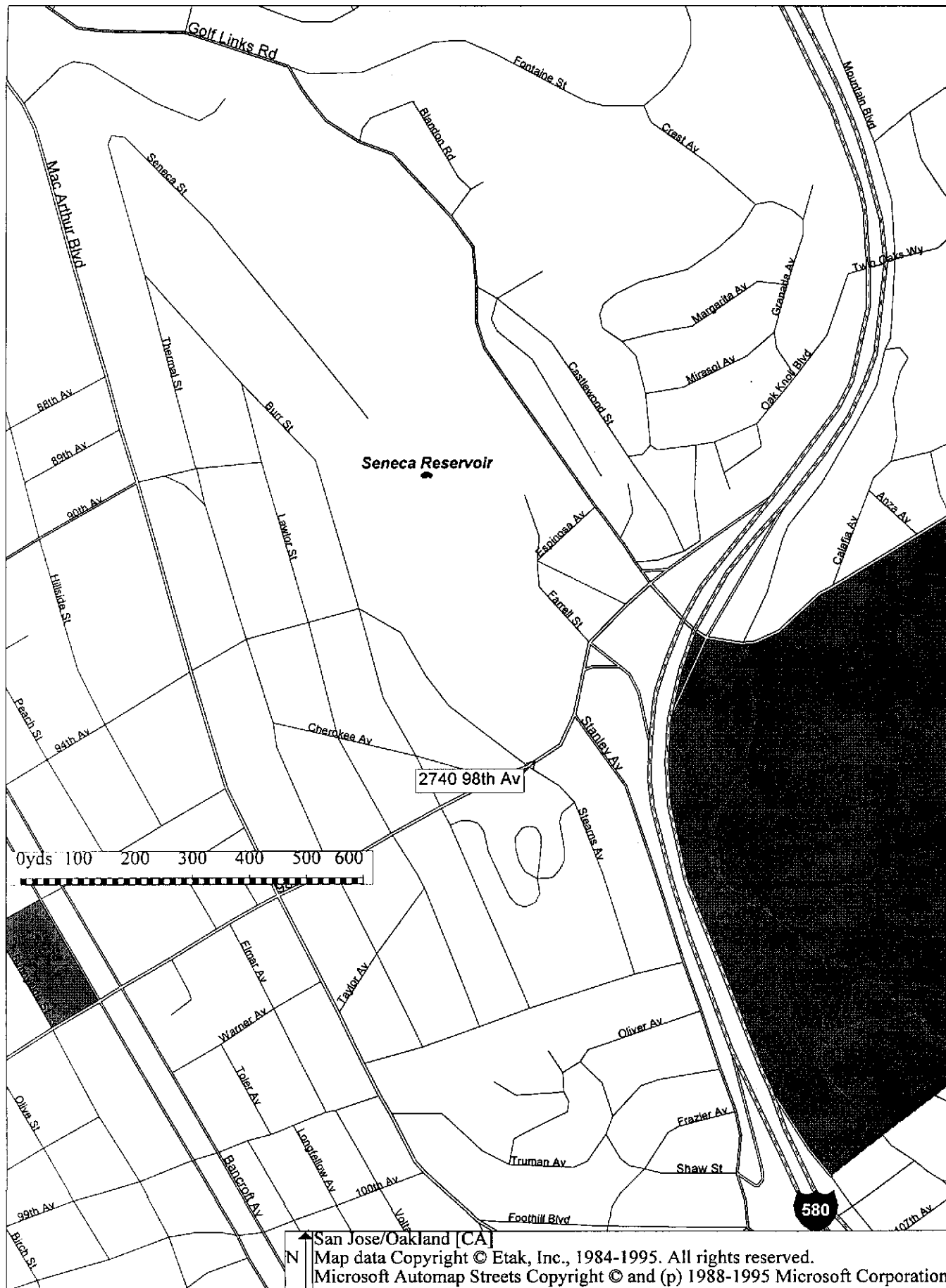

ENVIRO SOIL TECH CONSULTANTS

Figure 1

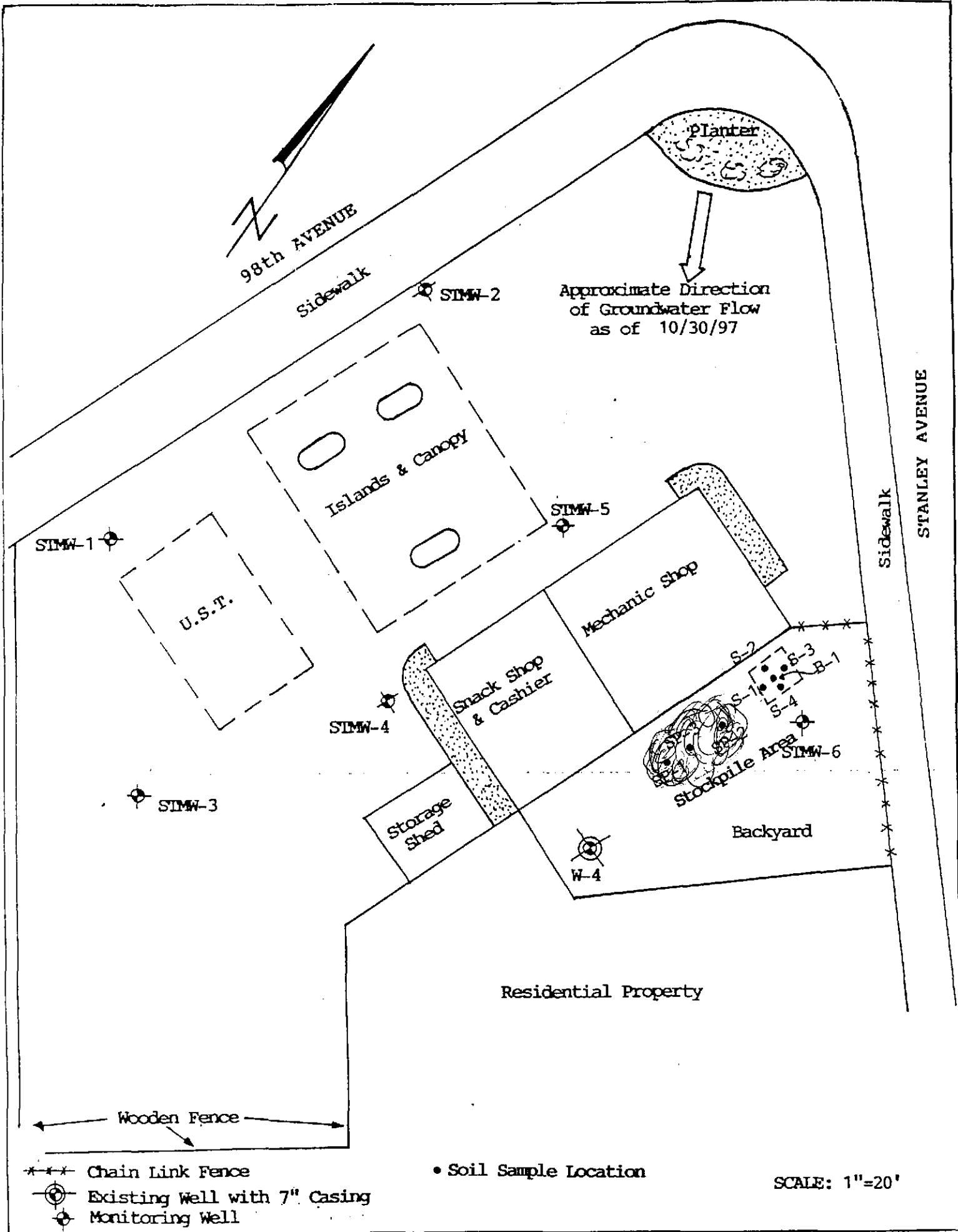

Figure 2

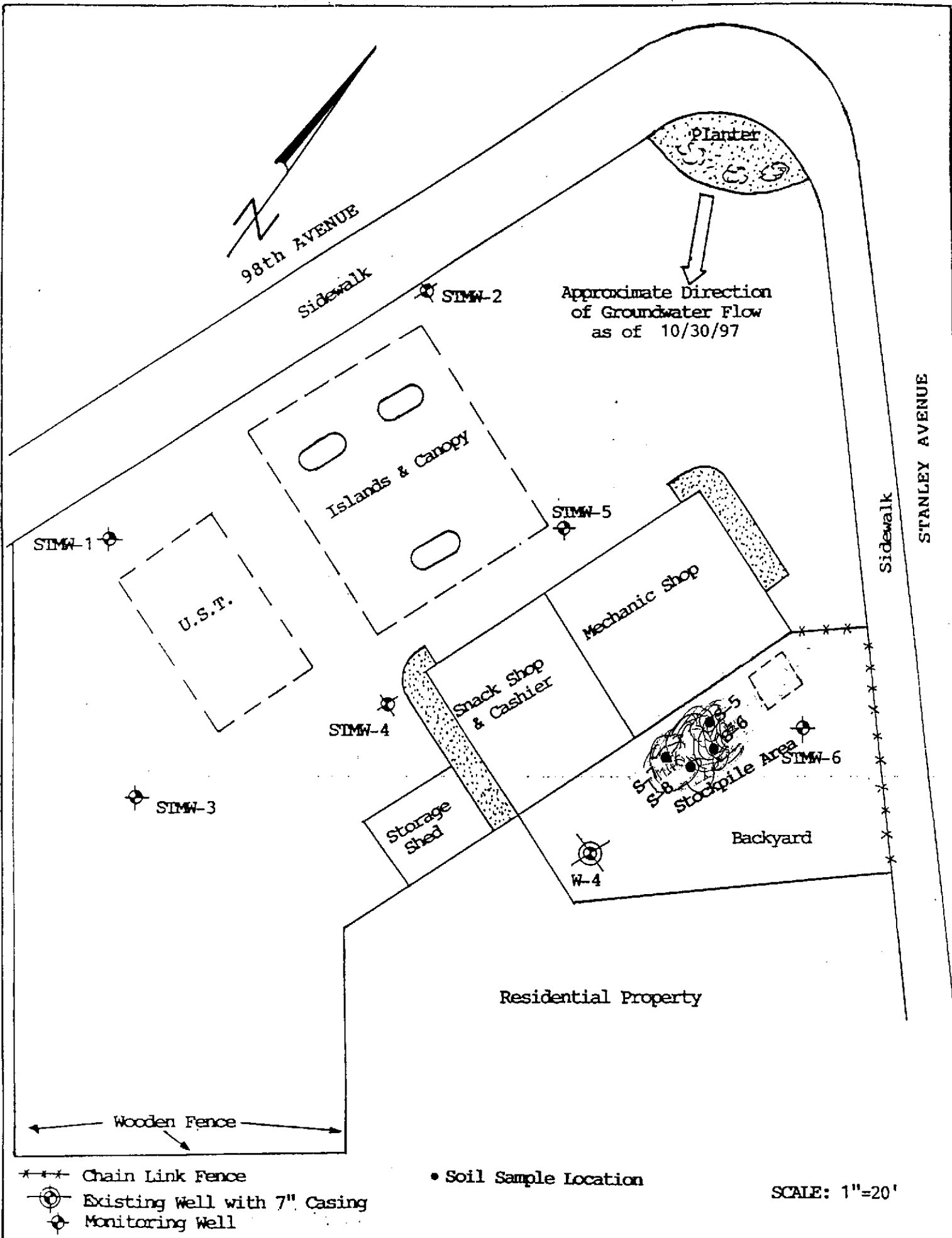
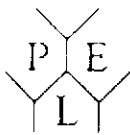

Figure 3

A P P E N D I X "C"

ENVIRO SOIL TECH CONSULTANTS



PRIORITY ENVIRONMENTAL LABS

Precision Environmental Analytical Laboratory

November 25, 1998

PEL # 9811023

SOIL TECH ENGINEERING

Attn: Frank Hamedi

Re: Six soil samples for Gasoline/BTEX with MTBE, Diesel, and Oil & Grease analyses.

Project name: 2740 98th Ave., Oakland.

Project number: 7-93-556-ST

Date sampled: Nov 19, 1998

Date submitted: Nov 20, 1998

Date extracted: Nov 21-24, 1998

Date analyzed: Nov 21-24, 1998

RESULTS:

SAMPLE I.D.	MTBE (ug/Kg)	Gasoline (mg/Kg)	Diesel (mg/Kg)	Benzene (ug/Kg)	Toluene (ug/Kg)	Ethyl Benzene (ug/Kg)	Total Xylene (ug/Kg)	Oil & Grease (mg/Kg)
B-1	N.D.	N.D.	N.D.	N.D.	N.D.	N.D.	N.D.	N.D.
S-1	N.D.	N.D.	34	N.D.	N.D.	N.D.	N.D.	360
S-2	N.D.	N.D.	61	N.D.	N.D.	N.D.	N.D.	780
S-3	N.D.	N.D.	11	N.D.	N.D.	N.D.	N.D.	150
S-4	N.D.	N.D.	39	N.D.	N.D.	N.D.	N.D.	590
SP-1,2,3*	N.D.	N.D.	57	N.D.	N.D.	N.D.	N.D.	680
Blank	N.D.	N.D.	N.D.	N.D.	N.D.	N.D.	N.D.	N.D.
Spiked Recovery	---	91.1%	86.7%	100.9%	91.4%	83.5%	101.1%	---
Detection limit	5.0	1.0	1.0	5.0	5.0	5.0	5.0	10
Method of Analysis	8020	5030/ 8015	3550/ 8015	8020	8020	8020	8020	5520 D & F

*composited soil sample.

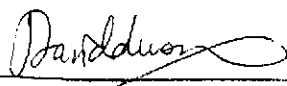
 David Duong
 Laboratory Director



PRIORITY ENVIRONMENTAL LABS

Precision Environmental Analytical Laboratory

November 27, 1998

PEL # 9811023

SOIL TECH ENGINEERING.

Attn: Frank Hamedi

Re: Six soil samples for Cadmium, Chromium, Lead, Nickel, and Zinc analyses.

Project name: 2740 98th Ave., Oakland.

Project number: 7-93-556-ST

Date sampled: Nov 19, 1998

Date submitted: Nov 20, 1998

Date extracted: Nov 20-24, 1998

Date analyzed: Nov 20-24, 1998

RESULTS:

SAMPLE I.D.	Cadmium (mg/Kg)	Chromium (mg/Kg)	Lead (mg/Kg)	Nickel (mg/Kg)	Zinc (mg/Kg)
B-1	1.1	2.7	3.3	12	19
S-1	0.9	1.8	2.4	14	21
S-2	1.3	2.4	3.1	9.9	18
S-3	1.5	2.9	2.7	15	19
S-4	1.0	3.6	3.2	17	16
SP-1,2,3*	1.2	3.1	2.9	22	17
Blank	N.D.	N.D.	N.D.	N.D.	N.D.
Detection limit	0.50	1.0	1.0	1.0	1.0
Method of Analysis	7130	7190	7420	7520	7950

*composited soil sample.

David Duong
Laboratory Director

PROJ NO. 7-93-555-SI NAME 2740 98th Avenue, Oakland

SAMPLERS: (Signature) *Richard Mandy*

NO.	DATE	TIME	SOIL	WATER	LOCATION	CON-TAINER
1	11/19/98		✓		S-1	1
2			✓		S-2	1
3			✓		S-3	1
4			✓		S-4	1
5			✓		B-1	1
6			✓		SP-1	1
7			✓		SP-2	1
8			✓		SP-3	1

ANALYSES REQUESTED:
 TPH, BTEX, TOG, MTBE, Cd, Cr, Pb, Ni, Zn

DEMAND # PEL # 9811023
 INV # 28634

} COMP

Relinquished by: (Signature) <i>Richard Mandy</i>	Date / Time 11/20/98 13:55	Received by: (Signature)	Relinquished by: (Signature)	Date / Time	Received by: (Signature)
Relinquished by: (Signature)	Date / Time	Received by: (Signature)	Relinquished by: (Signature)	Date / Time	Received by: (Signature)
Relinquished by: (Signature)	Date / Time	Received for Laboratory by: (Signature) <i>Richard Mandy</i>	Date / Time 11-20-98 1:56 PM	Remarks P.E.C	

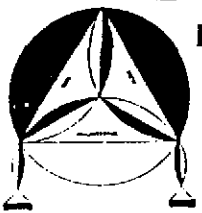

ENVIRO SOIL TECH CONSULTANTS
 Environmental & Geotechnical Consultants
 131 TULLY ROAD, SAN JOSE, CALIFORNIA 95111
 Tel: (408) 297-1500 Fax: (408) 292-2116



PRIORITY ENVIRONMENTAL LABS

Precision Environmental Analytical Laboratory

January 17, 2000

PEL # 0001009

ENVIRO SOIL TECH CONSULTANTS

Attn: Frank Hamedi

Re: One composited soil sample for Motor Oil and BTEX analyses.

Project name: 2740 98th Ave., Oakland. Project number: 7-93-556-SI

Date sampled: Jan 11, 2000

Date submitted: Jan 13, 2000

Date extracted: Jan 13-14, 2000

Date analyzed: Jan 13-14, 2000

RESULTS:

SAMPLE I.D.	Motor Oil (mg/Kg)	Benzene (ug/Kg)	Toluene (ug/Kg)	Ethyl Benzene (ug/Kg)	Total Xylenes (ug/Kg)
S-5,6,7,8	16	N.D.	N.D.	N.D.	N.D.
Blank	N.D.	N.D.	N.D.	N.D.	N.D.
Spiked Recovery	---	86.7%	91.2%	80.9%	97.8%
Detection limit	10	5.0	5.0	5.0	5.0
Method of Analysis	5520 D & F	8020	8020	8020	8020

David Duong
David Duong
Laboratory Director



PRIORITY ENVIRONMENTAL LABS

Precision Environmental Analytical Laboratory

January 17, 2000

PEL # 0001009

ENVIRO SOIL TECH CONSULTANTS

Attn: Frank Hamedi

Project name: 2740 98th Ave., Oakland.
Project number: 7-93-556-SI

Analysis : TTLC CAM 17 metals

Sample I.D.: S-5,6,7,8*

Date Sampled: Jan 11, 2000
Date Analyzed: Jan 13-15, 2000

Date Submitted: Jan 13, 2000

Method of Analysis: EPA 6010

CODE	METAL	CONCENTRATION (mg/Kg)	DETECTION LIMIT (mg/Kg)
Ag	Silver	N.D.	0.05
As	Arsenic	N.D.	0.01
Ba	Barium	1.8	0.05
Be	Beryllium	N.D.	0.01
Cd	Cadmium	1.4	0.01
Co	Cobalt	N.D.	0.05
Cr	Chromium	3.2	0.05
Cu	Copper	1.8	0.05
Hg	Mercury	N.D.	0.002
Mo	Molybdenum	N.D.	0.05
Ni	Nickel	16	0.05
Pb	Lead	3.3	0.10
Sb	Antimony	N.D.	0.10
Se	Selenium	N.D.	0.01
Tl	Thallium	N.D.	0.20
V	Vanadium	N.D.	0.05
Zn	Zinc	17	0.05

*Composited soil sample.

David Duong
Laboratory Director



PRIORITY ENVIRONMENTAL LABS

Precision Environmental Analytical Laboratory

January 17, 2000

PEL # 0001009

Page 01 of 02

ENVIRO SOIL TECH CONSULTANTS

Attn: Frank Hamedi

Project name: 2740 98th Ave., Oakland. Project number: 7-93-556-SI

Sample I.D.: S-5,6,7,8*

Date Sampled: Jan 11, 2000

Date Submitted: Jan 13, 2000

Date Analyzed: Jan 13-16, 2000

Method of Analysis: EPA 8260 Detection limit: 5.0 ug/Kg

COMPOUND NAME	CONCENTRATION (ug/Kg)	C.A.S. no.
---------------	---------------------------	---------------

Benzene	N.D.	71-43-2
Bromobenzene	N.D.	108-86-1
Bromochloromethane	N.D.	74-97-5
Bromodichloromethane	N.D.	75-27-4
Bromoform	N.D.	75-25-2
Bromomethane	N.D.	74-83-9
n-Butylbenzene	N.D.	104-51-8
sec-Butylbenzene	N.D.	135-98-8
tert-Butylbenzene	N.D.	98-06-6
Carbon tetrachloride	N.D.	56-23-5
Chlorobenzene	N.D.	108-90-7
Chloroethane	N.D.	75-00-3
Chloroform	N.D.	67-66-3
Chloromethane	N.D.	74-87-3
2-Chlorotoluene	N.D.	95-49-8
4-Chlorotoluene	N.D.	106-43-4
Dibromochloromethane	N.D.	124-38-1
1,2-Dibromo-3-chloropropane	N.D.	96-12-8
1,2-Dibromoethane	N.D.	106-93-4
Dibromoethane	N.D.	74-95-3
1,2-Dichlorobenzene	N.D.	95-50-1
1,3-Dichlorobenzene	N.D.	541-73-1
1,4-Dichlorobenzene	N.D.	106-46-7
Dichlorodifluoromethane	N.D.	75-71-8
1,1-Dichloroethane	N.D.	75-34-3
1,2-Dichloroethane	N.D.	107-06-2
1,1-Dichloroethene	N.D.	75-35-4
cis-1,2-Dichloroethene	N.D.	156-69-4
trans-1,2-Dichloroethene	N.D.	156-60-5
1,2-Dichloropropane	N.D.	78-87-5
1,3-Dichloropropane	N.D.	142-28-9
2,2-Dichloropropane	N.D.	594-20-7
1,1-Dichloropropene	N.D.	563-58-6



PRIORITY ENVIRONMENTAL LABS

Precision Environmental Analytical Laboratory

PEL # 0001009
Page 2 of 2

SAMPLE I.D. S-5,6,7,8*

COMPOUND NAME	CONCENTRATION (ug/Kg)	C.A.S. no.
Ethylbenzene	N.D.	100-41-1
Hexachlorobutadiene	N.D.	87-68-3
MTBE	N.D.	-----
Isopropyltoluene	N.D.	98-82-8
p-Isopropyltoluene	N.D.	99-87-6
Methylene chloride	N.D.	75-09-2
Naphthalene	N.D.	91-20-3
n-Propylbenzene	N.D.	103-65-1
Styrene	N.D.	100-42-5
1,1,1,2-Tetrachloroethane	N.D.	630-20-6
1,1,2,2-Tetrachloroethane	N.D.	79-34-5
Tetrachloroethene	N.D.	127-18-4
Toluene	N.D.	108-88-3
1,2,3-Trichlorobenzene	N.D.	87-61-6
1,2,4-Trichlorobenzene	N.D.	120-82-1
1,1,1-Trichloroethane	N.D.	71-55-6
1,1,2-Trichloroethane	N.D.	79-00-5
Trichloroethene	N.D.	79-01-6
Trichlorofluoromethane	N.D.	75-69-4
1,2,3-Trichloropropane	N.D.	96-18-4
1,2,4-Trimethylbenzene	N.D.	95-63-6
1,3,5-Trimethylbenzene	N.D.	108-67-8
Vinyl chloride	N.D.	75-01-4
o-Xylene	N.D.	95-47-6
m-Xylene	N.D.	108-38-3
p-Xylene	N.D.	106-42-3

*composited soil sample.

David Duong
Laboratory Director



PRIORITY ENVIRONMENTAL LABS

Precision Environmental Analytical Laboratory

January 17, 2000

PEL # 0001009
Page 01 of 02

ENVIRO SOIL TECH CONSULTANTS

Attn: Frank Hamedi

Project name: 2740 98th Ave., Oakland. Project number: 7-93-556-SI

Sample I.D.: S-5,6,7,8*

Date Sampled: Jan 11, 2000
Date Analyzed: Jan 13-16, 2000

Date Submitted: Jan 13, 2000

Method of Analysis: EPA 8270

Detection limit: 300 ug/Kg

COMPOUND NAME	CONCENTRATION (ug/Kg)
---------------	---------------------------

bis(2-chloroethyl)ether	N.D.
aniline	N.D.
phenol	N.D.
2-chlorophenol	N.D.
1,3-dichlorobenzene	N.D.
1,4-dichlorobenzene	N.D.
1,2-dichlorobenzene	N.D.
benzyl alcohol	N.D.
bis-(2-chloroisopropyl)	N.D.
2-methylphenol	N.D.
hexachloroethane	N.D.
n-nitroso-di-n-propylamine	N.D.
4-methylphenol	N.D.
nitrobenzene	N.D.
isophorone	N.D.
2-nitrophenol	N.D.
2,4-dimethylphenol	N.D.
bis(2-chloroethoxy)methane	N.D.
2,4-dichlorophenol	N.D.
1,2,4-trichlorobenzene	N.D.
naphthalene	N.D.
benzoic acid	N.D.
4-chloroaniline	N.D.
hexachlorobutadiene	N.D.
4-chloro-3-methylphenol	N.D.
2-methyl-naphthalene	N.D.
hexachlorocyclopentadiene	N.D.
2,4,6-trichlorophenol	N.D.
2,4,5-trichlorophenol	N.D.
2-chloronaphthalene	N.D.
2-nitroaniline	N.D.
acenaphthylene	N.D.
dimethylphthlate	N.D.
2,6-dinitrotoluene	N.D.



PRIORITY ENVIRONMENTAL LABS

Precision Environmental Analytical Laboratory

PEL # 0001009

Page 02 of 02

SAMPLE I.D. S-5,6,7,8*

COMPOUND NAME CONCENTRATION
(ug/Kg)

acenaphthylene	N.D.
3-nitroaniline	N.D.
2,4-dinitrophenol	N.D.
dibenzofuran	N.D.
2,4-dinitrotoluene	N.D.
4-nitrophenol	N.D.
fluorene	N.D.
4-chlorophenyl-phenyl ether	N.D.
diethylphthlate	N.D.
4-nitroaniline	N.D.
4,6-dinitro-2-methylphenol	N.D.
n-nitrosodiphenylamine	N.D.
1,2-diphenylhydrazine	N.D.
4-bromo-phenyl-phenyl ether	N.D.
hexachlorobenzene	N.D.
pentachlorophenol	N.D.
phenanthrene	N.D.
anthracene	N.D.
di-n-butylphthalate	N.D.
fluoranthene	N.D.
benzidine	N.D.
pyrene	N.D.
butylbenzylphthalate	N.D.
3,3'-dichlorobenzidine	N.D.
benzo[a]anthracene	N.D.
chrysene	N.D.
bis(2-ethylhexyl)phthalate	N.D.
di-n-octylphthalate	N.D.
benzo(b,k)fluoranthene	N.D.
benzo[a]pyrene	N.D.
indeno[1,2,3-cd]pyrene	N.D.
dibenzo[a,h]anthracene	N.D.
benzo[g,h,i]perylene	N.D.

*composited soil sample.

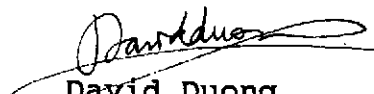
David Duong
Laboratory Director

CHAIN OF CUSTODY RECORD

PEL

PROJ NO. 7-93-556-SI		NAME 2740 98th Avenue, Oakland			CON-TAINER	ANALYSES REQUESTED (2) MOTOR OIL BTEX CAMP 82100 82700	REMARKS
SAMPLERS: (Signature) <i>[Signature]</i>							
NO.	DATE	TIME	SOIL	WATER	LOCATION		
1	1/11/00	11:00	✓		S-5	}	Composited
2	1	11:15	✓		S-6		
3	1	11:30	✓		S-7		
4	1	11:45	✓		S-8		
Relinquished by: (Signature) <i>[Signature]</i>					Date / Time 1/13/2000 14:28	Received by: (Signature)	
Relinquished by: (Signature)					Date / Time	Received by: (Signature)	
Relinquished by: (Signature)					Date / Time	Date / Time 1/13/2000 14:28	Received for Laboratory by: (Signature) <i>[Signature]</i>
						Remarks	

PEL # 0001009

INV # 30000

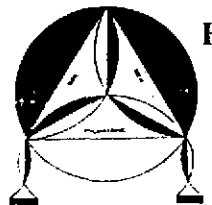

ENVIRO SOIL TECH CONSULTANTS
 Environmental & Geotechnical Consultants
 131 TULLY ROAD, SAN JOSE, CALIFORNIA 95111
 Tel: (408) 297-1500 Fax: (408) 292-2116

A P P E N D I X "D"

ENVIRO SOIL TECH CONSULTANTS

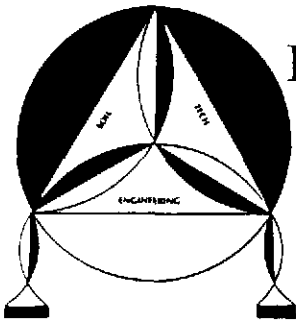

ENVIRO SOIL TECH CONSULTANTS

Environmental & Geotechnical Consultants

131 TULLY ROAD, SAN JOSE, CALIFORNIA 95111

Tel: (408) 297-1500

Fax: (408) 292-2116

January 17, 2000

File No. 7-93-556-SI

Ms. Judy Erlandson

BFI - Vasco Road Landfill
4001 North Vasco Road
Livermore, California 94550

**SUBJECT; REQUEST FOR DISPOSAL OF CONTAMINATED
SOIL FROM THE PROPERTY**

Located at 2740 98th Avenue, in
Oakland, California

Dear Ms. Erlandson:

Enclosed is information regarding motor oil contaminated soil that we wish to dispose of at BFI landfill.

The soil stockpile is a results of the removal of underground waste oil storage tank from the property located at 2740 98th Avenue, in Oakland, California.

The soil stockpiled is approximately 100 yards, and it is currently stored on-site and treated by bio-remediation.

The stockpiled soil was mixed thoroughly and spread. A dilute mixture of nutrient elements (Nitrogen and Phosphorous) were sprayed to the soil surface on a weekly basis in order to maintain soil moisture and to stimulate bacterial growth. The pile was covered with plastic except during mixing, fertilizer application and sampling.

After treatment of the stockpiled soil, samples were dug out from within the stockpile, with the aide of a hand sampler, in a brass tube. Four discrete soil samples were taken from the stockpiled on January 13, 2000, which were composited into one sample by the laboratory. The ends of the tube were capped and sealed, and the tube was labeled and placed in an ice chest for delivery to Priority Environmental Labs, in Milpitas, accompanied by the proper chain-of-custody documentation.

Per BFI sampling protocol, the composite soil sample was analyzed for Motor Oil, BTEX, CAM 17, EPA Methods 8260 and 8270.

Please review this information as soon as possible. We would like to start transporting the soil as soon as possible.

Thank you for prompt response. Should you have any questions or require additional information, please feel free to contact our office at (408) 297-1500.

Sincerely,

ENVIRO SOIL TECH CONSULTANTS

FRANK HAMEDI-FARD
GENERAL MANAGER



BFI WASTE CODE

WASTE APPROVAL REQUEST

BFI to complete this area.

BFI Initiator:
Location:
Company Number:
Telephone:
Fax:
Date:

Action Requested:
Up-Date Approval - Previous Number:
Disposal Site Requested:
Company Number:
Management Method Requested:
Other:

WASTE CHARACTERIZATION DATA
SPECIAL WASTE

IMPORTANT: INFORMATION FOR PHYSICAL COMPLETION OF THIS FORM MUST BE OBTAINED FROM AN AUTHORIZED REPRESENTATIVE OF THE WASTE GENERATOR. PLEASE READ THE INSTRUCTIONS BEFORE COMPLETING THIS FORM. THIS FORM IS TO BE USED ONLY ONE TIME, AND MUST BE TYPEWRITTEN OR LEGIBLY PRINTED IN INK, AND SIGNED.

1. GENERATOR INFORMATION

a) Generator's Name: Manijeh Farajji
b) Generating Facility's Address: 2740 98th Avenue
City: Oakland State: CA Zip: 94605
c) Generator's Representative: Enviro Soil Tech Consultants
Title: Consultant
Telephone: (408) 297-1500
Fax: (408) 293-2116
d) Emergency/Information Contact: Frank Hamed
Title: General Manager
Telephone: (408) 297-1500
e) State/Provincial/Local Registration No.: N/A
Generator's EPA Id. No.: CAL 000019843
Industry Description/SIC Code: N/A
f) Customer's Name: Enviro Soil Tech Consultants
g) Customer's Mailing Address: 131 Tully Road
City: San Jose State: CA Zip: 95111
h) Billing Contact: Frank Hamed
Telephone: (408) 297-1500
Fax: (408) 293-2116

2. GENERAL WASTE STREAM INFORMATION

a) Name/Description of the Waste: Soil Stockpile from the removal of 550 gallon underground waste oil storage tank.
b) Process Generating the Waste: Removal of 550 gallon of underground waste oil storage tank.
c) Is this waste a characteristically hazardous waste as per 40 CFR 261.21-24? Yes No [X] N/D
d) Is this waste an F,K,P, or U listed hazardous waste as per 40 CFR 261.32-33? Yes No [X] N/D
e) Is this waste a treatment residue of a waste which was previously a characteristically hazardous waste? Yes No [X] N/D
If yes, describe the waste, applicable code(s), and the process generating the waste prior to treatment.
f) Is this a "Hazardous Waste" as defined by State, Provincial, or Local Regulations? Yes No [X] N/D
If yes, enter the Waste Identification Number if one has been assigned:
g) Recommended personal protection equipment and special handling procedures: None

3. WASTE PROPERTIES AT 72°F

- a) Physical State: Solid Semi-solid Powder Free Liquid Combination
- b) Reactivity: Water Reactive Acid Reactive Alkaline Reactive Oxidizer Autopolymerizable
 Pyrophoric Explosive Thermally Sensitive Shock Sensitive None of the above
- c) Flash Point, °F:
 ≤ 72 73-100 101-140 141-200 ≥ 201 N/A N/D
- d) pH:
 ≤ 2 2.1 - 5.0 5.1 - 9.0 9.1 - 12.4 ≥ 12.5 N/A N/D
- e) Odor - describe _____
 None Mild Strong

4. WASTE COMPOSITION

Please provide a breakdown of the waste stream based upon generator knowledge of the waste and the process(s) generating the waste stream.

Does this waste contain any of the following:

- Free Cyanide
- Free Sulfide
- Organic Solvents
- OSHA Substances
- Radioactive Materials
- Virgin Oils
- Used Oils
- Etiological Agents
- PCB'S not regulated by TSCA 40 CFR 761
- None of the Above

Components/Contaminants

Range (%)

Components/Contaminants	Range (%)
100% Soil	

If any of the above are marked, please specify in waste breakdown at right

5. TRANSPORTATION INFORMATION

If the waste is a DOT Hazardous Material, complete the following:

Proper USDOT Shipping Name: _____

USDOT Hazard Class: _____ UN or NA Number: _____ CERCLA Reportable Quantity: _____

6. GENERATOR'S CERTIFICATION

I hereby certify that the above and attached description is complete and accurate to the best of my knowledge and ability to determine, that no deliberate or willful omissions of composition or properties exist, that all known or suspected hazards have been disclosed, analytical results submitted are accurate and representative of the waste (per SW846), and that the waste is not a regulated hazardous waste by the USEPA, by an applicable State or Provincial authority, or by any applicable local authority, and does not contain PCBs regulated by TSCA (i.e., 40 CFR 761) or any Provincial authority.

GENERATOR'S AUTHORIZED SIGNATORY:

DATE: 1/17/2000

PRINT NAME: Frank Homedi SIGNATURE: [Signature] TITLE: General Manager

TELEPHONE: (408) 297-1500 FAX: (408) 292-2116

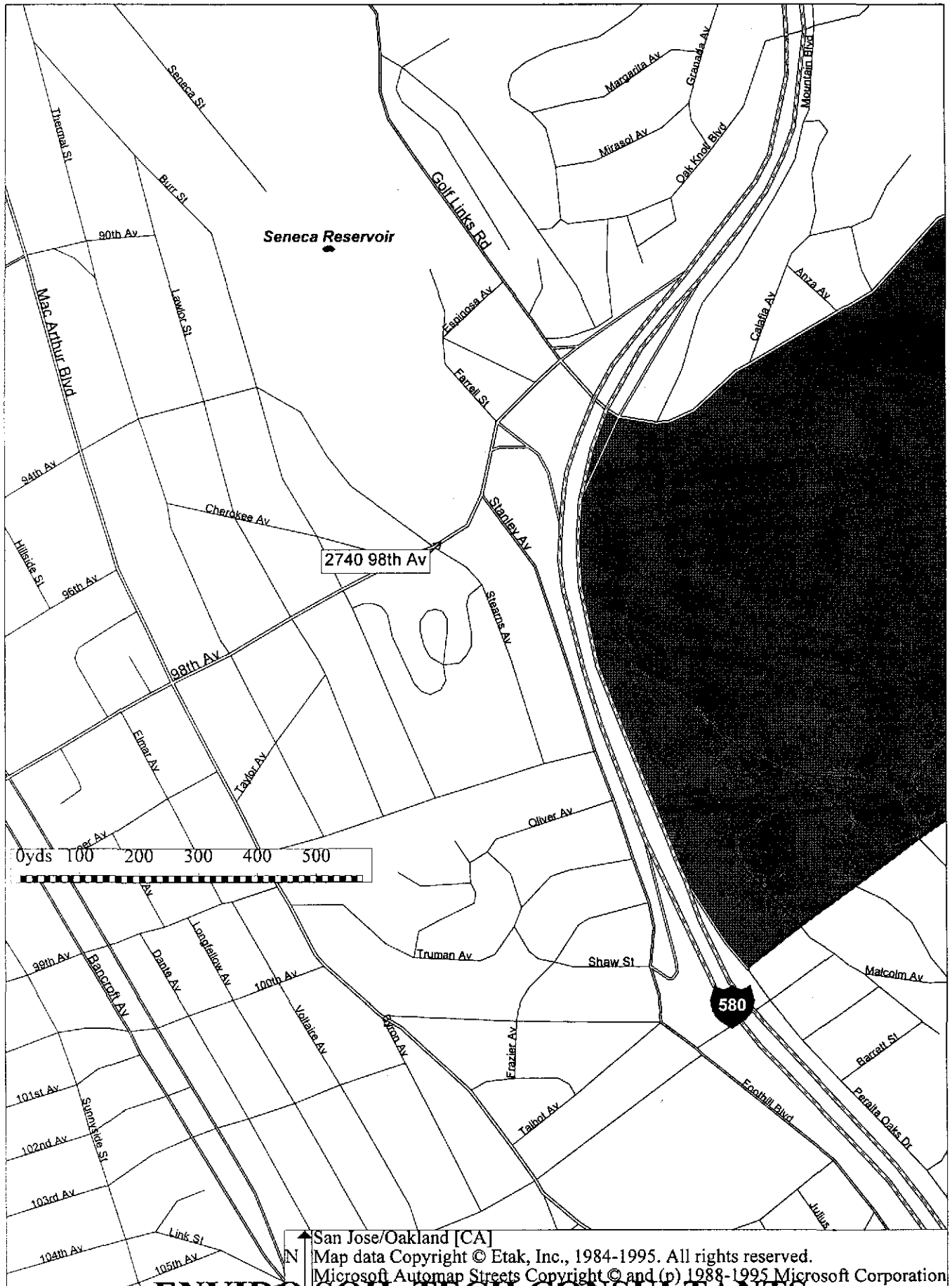

ENVIRO SOIL TECH CONSULTANTS

Figure 1

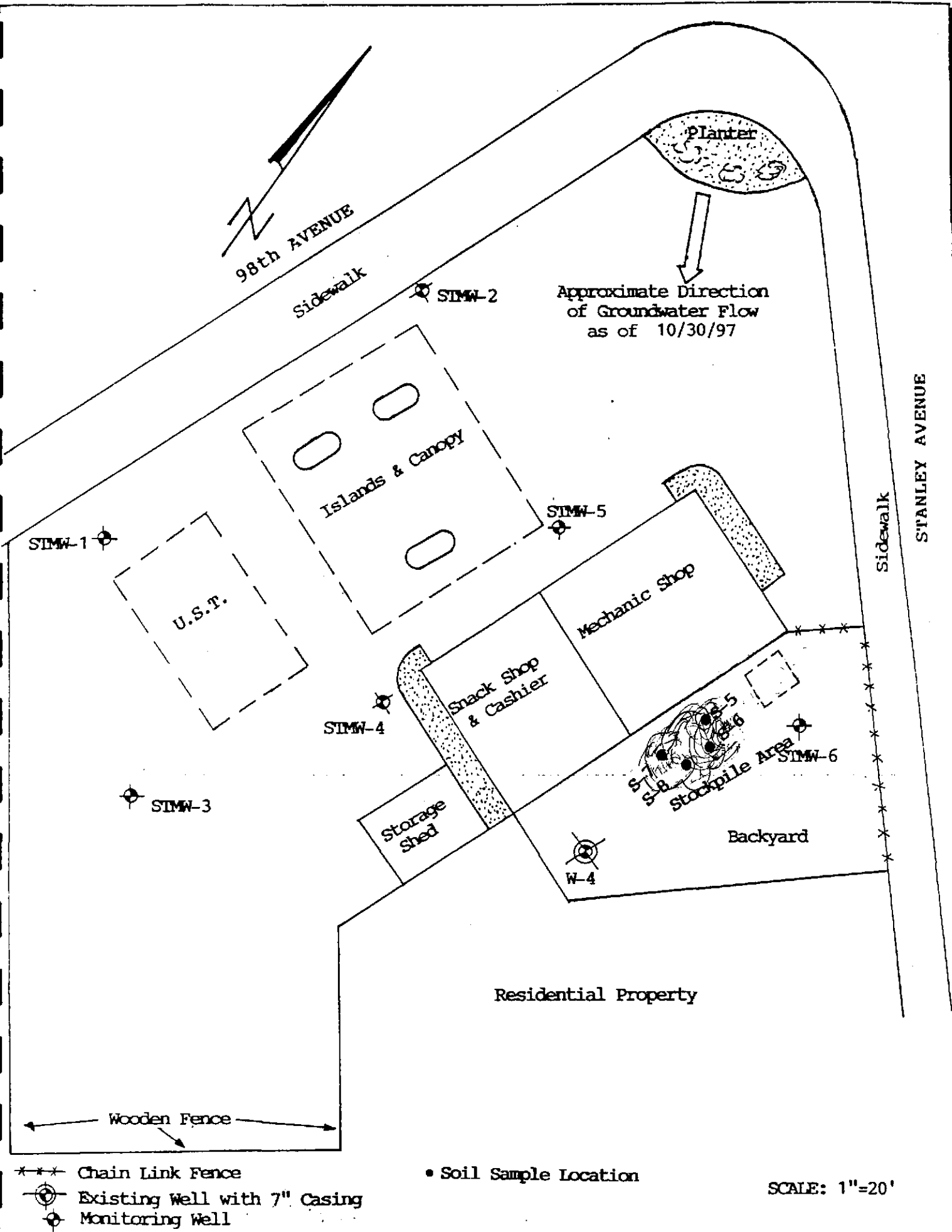

- *** Chain Link Fence
- ⊕ Existing Well with 7" Casing
- ⊙ Monitoring Well

• Soil Sample Location

SCALE: 1"=20'

Figure 2



PRIORITY ENVIRONMENTAL LABS

Precision Environmental Analytical Laboratory

January 17, 2000

PEL # 0001009

ENVIRO SOIL TECH CONSULTANTS

Attn: Frank Hamedi

Re: One composited soil sample for Motor Oil and BTEX analyses.

Project name: 2740 98th Ave., Oakland. Project number: 7-93-556-SI

Date sampled: Jan 11, 2000

Date submitted: Jan 13, 2000

Date extracted: Jan 13-14, 2000

Date analyzed: Jan 13-14, 2000

RESULTS:

SAMPLE I.D.	Motor Oil (mg/Kg)	Benzene (ug/Kg)	Toluene (ug/Kg)	Ethyl Benzene (ug/Kg)	Total Xylenes (ug/Kg)
S-5,6,7,8	16	N.D.	N.D.	N.D.	N.D.
Blank	N.D.	N.D.	N.D.	N.D.	N.D.
Spiked Recovery	---	86.7%	91.2%	80.9%	97.8%
Detection limit	10	5.0	5.0	5.0	5.0
Method of Analysis	5520 D & F	8020	8020	8020	8020

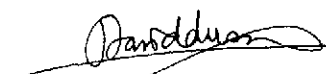
David Duong
Laboratory Director



PRIORITY ENVIRONMENTAL LABS

Precision Environmental Analytical Laboratory

January 17, 2000

PEL # 0001009

ENVIRO SOIL TECH CONSULTANTS

Attn: Frank Hamedi

Project name: 2740 98th Ave., Oakland.

Project number: 7-93-556-SI

Analysis : TTLC CAM 17 metals

Sample I.D.: S-5,6,7,8*

Date Sampled: Jan 11, 2000

Date Submitted: Jan 13, 2000

Date Analyzed: Jan 13-15, 2000

Method of Analysis: EPA 6010

CODE	METAL	CONCENTRATION (mg/Kg)	DETECTION LIMIT (mg/Kg)
Ag	Silver	N.D.	0.05
As	Arsenic	N.D.	0.01
Ba	Barium	1.8	0.05
Be	Beryllium	N.D.	0.01
Cd	Cadmium	1.4	0.01
Co	Cobalt	N.D.	0.05
Cr	Chromium	3.2	0.05
Cu	Copper	1.8	0.05
Hg	Mercury	N.D.	0.002
Mo	Molybdenum	N.D.	0.05
Ni	Nickel	16	0.05
Pb	Lead	3.3	0.10
Sb	Antimony	N.D.	0.10
Se	Selenium	N.D.	0.01
Tl	Thallium	N.D.	0.20
V	Vanadium	N.D.	0.05
Zn	Zinc	17	0.05

*Composited soil sample.

David Duong
Laboratory Director



PRIORITY ENVIRONMENTAL LABS

Precision Environmental Analytical Laboratory

January 17, 2000

PEL # 0001009

Page 01 of 02

ENVIRO SOIL TECH CONSULTANTS

Attn: Frank Hamedi

Project name: 2740 98th Ave., Oakland. Project number: 7-93-556-SI

Sample I.D.: S-5,6,7,8*

Date Sampled: Jan 11, 2000

Date Submitted: Jan 13, 2000

Date Analyzed: Jan 13-16, 2000

Method of Analysis: EPA 8260 Detection limit: 5.0 ug/Kg

COMPOUND NAME	CONCENTRATION (ug/Kg)	C.A.S. no.
---------------	---------------------------	---------------

Benzene	N.D.	71-43-2
Bromobenzene	N.D.	108-86-1
Bromochloromethane	N.D.	74-97-5
Bromodichloromethane	N.D.	75-27-4
Bromoform	N.D.	75-25-2
Bromomethane	N.D.	74-83-9
n-Butylbenzene	N.D.	104-51-8
sec-Butylbenzene	N.D.	135-98-8
tert-Butylbenzene	N.D.	98-06-6
Carbon tetrachloride	N.D.	56-23-5
Chlorobenzene	N.D.	108-90-7
Chloroethane	N.D.	75-00-3
Chloroform	N.D.	67-66-3
Chloromethane	N.D.	74-87-3
2-Chlorotoluene	N.D.	95-49-8
4-Chlorotoluene	N.D.	106-43-4
Dibromochloromethane	N.D.	124-38-1
1,2-Dibromo-3-chloropropane	N.D.	96-12-8
1,2-Dibromoethane	N.D.	106-93-4
Dibromoethane	N.D.	74-95-3
1,2-Dichlorobenzene	N.D.	95-50-1
1,3-Dichlorobenzene	N.D.	541-73-1
1,4-Dichlorobenzene	N.D.	106-46-7
Dichlorodifluoromethane	N.D.	75-71-8
1,1-Dichloroethane	N.D.	75-34-3
1,2-Dichloroethane	N.D.	107-06-2
1,1-Dichloroethene	N.D.	75-35-4
cis-1,2-Dichloroethene	N.D.	156-69-4
trans-1,2-Dichloroethene	N.D.	156-60-5
1,2-Dichloropropane	N.D.	78-87-5
1,3-Dichloropropane	N.D.	142-28-9
2,2-Dichloropropane	N.D.	594-20-7
1,1-Dichloropropene	N.D.	563-58-6



PRIORITY ENVIRONMENTAL LABS

Precision Environmental Analytical Laboratory

SAMPLE I.D. S-5,6,7,8*

PEL # 0001009
Page 2 of 2

COMPOUND NAME	CONCENTRATION (ug/Kg)	C.A.S. no.
Ethylbenzene	N.D.	100-41-1
Hexachlorobutadiene	N.D.	87-68-3
MTBE	N.D.	-----
Isopropyltoluene	N.D.	98-82-8
p-Isopropyltoluene	N.D.	99-87-6
Methylene chloride	N.D.	75-09-2
Naphthalene	N.D.	91-20-3
n-Propylbenzene	N.D.	103-65-1
Styrene	N.D.	100-42-5
1,1,1,2-Tetrachloroethane	N.D.	630-20-6
1,1,2,2-Tetrachloroethane	N.D.	79-34-5
Tetrachloroethene	N.D.	127-18-4
Toluene	N.D.	108-88-3
1,2,3-Trichlorobenzene	N.D.	87-61-6
1,2,4-Trichlorobenzene	N.D.	120-82-1
1,1,1-Trichloroethane	N.D.	71-55-6
1,1,2-Trichloroethane	N.D.	79-00-5
Trichloroethene	N.D.	79-01-6
Trichlorofluoromethane	N.D.	75-69-4
1,2,3-Trichloropropane	N.D.	96-18-4
1,2,4-Trimethylbenzene	N.D.	95-63-6
1,3,5-Trimethylbenzene	N.D.	108-67-8
Vinyl chloride	N.D.	75-01-4
o-Xylene	N.D.	95-47-6
m-Xylene	N.D.	108-38-3
p-Xylene	N.D.	106-42-3

*composited soil sample.

David Duong
Laboratory Director



PRIORITY ENVIRONMENTAL LABS

Precision Environmental Analytical Laboratory

January 17, 2000

PEL # 0001009
Page 01 of 02

ENVIRO SOIL TECH CONSULTANTS

Attn: Frank Hamedi

Project name: 2740 98th Ave., Oakland. Project number: 7-93-556-SI

Sample I.D.: S-5,6,7,8*

Date Sampled: Jan 11, 2000
Date Analyzed: Jan 13-16, 2000

Date Submitted: Jan 13, 2000

Method of Analysis: EPA 8270

Detection limit: 300 ug/Kg

COMPOUND NAME	CONCENTRATION (ug/Kg)
---------------	---------------------------

bis(2-chloroethyl)ether	N.D.
aniline	N.D.
phenol	N.D.
2-chlorophenol	N.D.
1,3-dichlorobenzene	N.D.
1,4-dichlorobenzene	N.D.
1,2-dichlorobenzene	N.D.
benzyl alcohol	N.D.
bis-(2-chloroisopropyl)	N.D.
2-methylphenol	N.D.
hexachloroethane	N.D.
n-nitroso-di-n-propylamine	N.D.
4-methylphenol	N.D.
nitrobenzene	N.D.
isophorone	N.D.
2-nitrophenol	N.D.
2,4-dimethylphenol	N.D.
bis(2-chloroethoxy)methane	N.D.
2,4-dichlorophenol	N.D.
1,2,4-trichlorobenzene	N.D.
naphthalene	N.D.
benzoic acid	N.D.
4-chloroaniline	N.D.
hexachlorobutadiene	N.D.
4-chloro-3-methylphenol	N.D.
2-methyl-naphthalene	N.D.
hexachlorocyclopentadiene	N.D.
2,4,6-trichlorophenol	N.D.
2,4,5-trichlorophenol	N.D.
2-chloronaphthalene	N.D.
2-nitroaniline	N.D.
acenaphthylene	N.D.
dimethylphthlate	N.D.
2,6-dinitrotoluene	N.D.



PRIORITY ENVIRONMENTAL LABS

Precision Environmental Analytical Laboratory

SAMPLE I.D. S-5,6,7,8*

PEL # 0001009
Page 02 of 02

COMPOUND NAME	CONCENTRATION (ug/Kg)
---------------	--------------------------

acenaphthylene	N.D.
3-nitroaniline	N.D.
2,4-dinitrophenol	N.D.
dibenzofuran	N.D.
2,4-dinitrotoluene	N.D.
4-nitrophenol	N.D.
fluorene	N.D.
4-chlorophenyl-phenyl ether	N.D.
diethylphthlate	N.D.
4-nitroaniline	N.D.
4,6-dinitro-2-methylphenol	N.D.
n-nitrosodiphenylamine	N.D.
1,2-diphenylhydrazine	N.D.
4-bromo-phenyl-phenyl ether	N.D.
hexachlorobenzene	N.D.
pentachlorophenol	N.D.
phenanthrene	N.D.
anthracene	N.D.
di-n-butylphthalate	N.D.
fluoranthene	N.D.
benzidine	N.D.
pyrene	N.D.
butylbenzylphthalate	N.D.
3,3'-dichlorobenzidine	N.D.
benzo[a]anthracene	N.D.
chrysene	N.D.
bis(2-ethylhexyl)phthalate	N.D.
di-n-octylphthalate	N.D.
benzo(b,k)fluoranthene	N.D.
benzo[a]pyrene	N.D.
indeno[1,2,3-cd]pyrene	N.D.
dibenzo[a,h]anthracene	N.D.
benzo[g,h,i]perylene	N.D.

*composited soil sample.

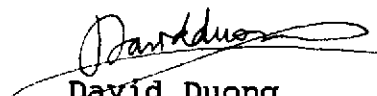
David Duong
Laboratory Director

CHAIN OF CUSTODY RECORD

PEL

PROJ NO. 7-93-556-SI		NAME 2740 98th Avenue, Oakland				CON-TAINER	ANALYSES REQUESTED MOTOR OIL BTEX CAMP 82160 82170	REMARKS	
SAMPLERS: (Signature) <i>[Signature]</i>									
NO.	DATE	TIME	SOIL	WATER	LOCATION				
1	1/11/00	11:00	✓		S-5			Composited	
2		11:15	✓		S-6				
3		11:30	✓		S-7				
4	✓	11:45	✓		S-8				
							PEL # 0001009		
							INV # 30000		
Relinquished by: (Signature) <i>[Signature]</i>		Date / Time 1/13/2000 14:28		Received by: (Signature)		Relinquished by: (Signature)		Date / Time	Received by: (Signature)
Relinquished by: (Signature)		Date / Time		Received by: (Signature)		Relinquished by: (Signature)		Date / Time	Received by: (Signature)
Relinquished by: (Signature)		Date / Time		Received for Laboratory by: (Signature) <i>[Signature]</i>		Date / Time 1/13/2000 14:28		Remarks	

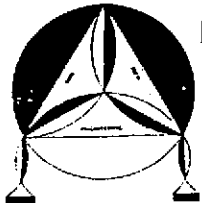

ENVIRO SOIL TECH CONSULTANTS

Environmental & Geotechnical Consultants
 131 TULLY ROAD, SAN JOSE, CALIFORNIA 95111
 Tel: (408) 297-1500 Fax: (408) 292-2116

A P P E N D I X "E"

ENVIRO SOIL TECH CONSULTANTS

VASCO ROAD LANDFILL CO.

No: 1204355

4001 VASCO ROAD
LIVERMORE, CA 94550
(510) 447-0491

Date : 01-29-00 Time In: 09:32:36 Time Out: 10:45:19
 Ticket # : A33962 CMS # : 1009539 LMS # : 0000999
 Customer : CASH
 Vehicle # : E10 Lic Plate:
 CO WALNUT CREEK
 Manifest # : 613405 PO #: Transporter:
 Source Cd : Generator : AMA ALAMEDA
 Disposal : Operator: MARK
 Capacity : 26.00 yd Scale In # : 3 Scale Out #: 2
 Gross Wt : 35.25 Tare Wt: 16.49 Net Wt: 18.56 t

WARNING: Transporting any unauthorized hazardous waste to this facility for disposal is prohibited by law. Persons violating this prohibition are subject to civil and criminal prosecution.

Item	Descr	Actual	Bill Qty	\$/Unit	Extended
02429	SOIL	14.00	18.56 t	18.00000	334.08
Sub Total..... \$					334.08
Total..... \$					334.08
Check Tendered.. \$					334.08
Change Due.... \$.00

All children must remain in vehicles. Absolutely no salvaging allowed.

Niños deben de permanecer en los carros a todas horas.

No se permite llevar cosas del dompe absolutamente.

THANK YOU FOR YOUR BUSINESS!!!
HAVE A GREAT DAY!!!

DRIVER

DRIVER

VASCO ROAD LANDFILL CO.

No: 1204357

4001 VASCO ROAD
LIVERMORE, CA 94550
(510) 447-0491

Date : 01-29-00 Time In: 10:18:06 Time Out: 10:48:29
 Ticket # : A33999 CMS # : 1009539 LMS # : 0000999
 Customer : CASH
 Vehicle # : 000078 Lic Plate:
 CO WALNUT CREEK
 Manifest # : 613404 PO #: Transporter:
 Source Cd : Generator : AMA ALAMEDA
 Disposal : Operator: MARK
 Capacity : 26.00 yd Scale In # : 3 Scale Out #: 2
 Gross Wt : 32.35 Tare Wt: 15.76 Net Wt: 16.59 t

WARNING: Transporting any unauthorized hazardous waste to this facility for disposal is prohibited by law. Persons violating this prohibition are subject to civil and criminal prosecution.

Item	Descr	Actual	Bill Qty	\$/Unit	Extended
02429	SOIL	12.00	16.59 t	18.00000	298.62
Sub Total..... \$					298.62
Total..... \$					298.62
Check Tendered.. \$					298.62
Change Due.... \$.00

All children must remain in vehicles. Absolutely no salvaging allowed.

Niños deben de permanecer en los carros a todas horas.

No se permite llevar cosas del dompe absolutamente.

THANK YOU FOR YOUR BUSINESS!!!
HAVE A GREAT DAY!!!

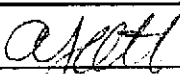
DRIVER

DRIVER

VASCO ROAD LANDFILL CO.

No: 1204486

4001 VASCO ROAD
LIVERMORE, CA 94550
(510) 447-0491

Date : 01-29-00 Time In: 13:53:53 Time Out: 14:17:39
 Ticket # : A34129 OHS # : 1009539 LMS #: 0000999
 Customer : CASH
 Vehicle # : 000078 Lic Plate:
 CC WALNUT CREEK
 Manifest # : 613403 PO #:
 Source Cd : Generator : AMA ALAMEDA Transporter:
 Comment : Operator: MARK
 Capacity : 20.00 yd Scale In # : 3 Scale Out #: 2
 Gross Wt : 31.76 Tare Wt: 15.70 Net Wt: 16.06 t

WARNING: Transporting any unauthorized hazardous waste to this facility for disposal is prohibited by law. Persons violating this prohibition are subject to civil and criminal prosecution.

Item	Descr	Actual	Bill Qty	\$/Unit	Extended
02429	SOIL	12.00	16.06 t	18.00000	289.08
	Sub Total..... \$				289.08
	Total..... \$				289.08
	Check Tended.. \$				289.08
	Change Due.... \$.00

All children must remain in vehicles. Absolutely no salvaging allowed.

Niños deben de permanecer en los carros a todas horas.

No se permite llevar cosas del dompe absolutamente.

THANK YOU FOR YOUR BUSINESS!!!
HAVE A GREAT DAY!!!

DRIVER

jele

DRIVER

VASCO ROAD LANDFILL CO.

No: 1216959

4001 VASCO ROAD
LIVERMORE, CA 94550
(510) 447-0491

TICKET: 1409
CUSTOMER: CASH / Cash Customer
PROFILE #: 02429

DATE: 03/11/2000

GENERATOR: MAS / MASNIJEH FARAHI
ORIGIN: 0008 / OAKLAND
TRUCK: 202 P.O.:
LICENSE:
COMMENT:

GROSS:
TARE:
NET:

WARNING: Transporting any hazardous waste to this facility for disposal is prohibited by law. Persons violating this prohibition are subject to civil and criminal prosecution.

WASTE	QUANTITY	UNIT	RATE	AMOUNT
SOIL / SOIL - ADC	17.81	T		320.58

All children must remain in vehicles. Absolutely no salvaging allowed.
Niños deben de permanecer en los carros a todas horas.
No se permite llevar cosas del dompe absolutamente.

Mandatory Fees	17.81	T	\$ 0.00	\$ 0.00
----------------	-------	---	---------	---------

CASH IN: \$ 320.58 CHANGE: \$ 0.00

Total: \$ 320.58

I certify that I have not disposed of any liquid or hazardous waste

Weighmaster:

IN: MARK P
DRIVER

OUT: MARK P
DRIVER

VASCO ROAD LANDFILL CO.

No: 1217098

4001 VASCO ROAD
LIVERMORE, CA 94550
(510) 447-0491

TICKET: 1563
CUSTOMER: CASH / Cash Customer
PROFILE #: 02429

DATE: 03/11/2000

GENERATOR: MAS / MASNIJEH FARAHI
ORIGIN: 0008 / OAKLAND
TRUCK: 202 P.O.:
LICENSE:
COMMENT:

GROSS:
TARE:
NET:

WARNING: Transporting any unauthorized hazardous waste to this facility for disposal is prohibited by law. Persons violating this prohibition are subject to civil and criminal prosecution.

WASTE	QUANTITY	UNIT	RATE	AMOUNT
SOIL / SOIL - ADC	16.78	T	\$ 18.00	\$ 302.04

All children must remain in vehicles. Absolutely no salvaging allowed.

Niños deben de permanecer en los carros a todas horas.

No se permite llevar cosas del dompe absolutamente.

Mandatory Fees	16.78	T	\$ 0.00	\$ 0.00
----------------	-------	---	---------	---------

CASH IN: \$ 302.04 CHANGE: \$ 0.00

Total: \$ 302.04

I certify that I have not disposed of any liquid or hazardous waste

Weighmaster:

IN: MARK P
DRIVER

OUT: MARK P
DRIVER



NON-HAZARDOUS SPECIAL WASTE & ASBESTOS MANIFEST

If waste is asbestos waste, complete Sections I, II, III and IV.
If waste is NOT asbestos waste, complete only Sections I, II and III.

No. 613403

Section I GENERATOR (Generator completes all of Section I)

a. Generator Name: Manijeh Faraji b. Generating Location: Freeway Station and Service
 c. Address: 2000 Stratton Road d. Address: 2740 98th Avenue
Walnut Creek, CA 94598 Oakland, CA 94605
 e. Phone No.: 925-256-1039 f. Phone No.: 510-562-7384

If owner of the generating facility differs from the generator, provide:

g. Owner's Name: _____ h. Owner's Phone No.: _____

i. BFI WASTE CODE:

C	4	4	0	5	0	1	1	9	0	0
---	---	---	---	---	---	---	---	---	---	---

0	2	4	2	9
---	---	---	---	---

 Containers: _____
 j. Description of Waste: 100% Soil k. Quantity:

--	--	--	--	--	--

 Units:

--

 No.:

--	--	--

 TYPE:

	T
--	---

- TYPE**
- DM - METAL DRUM
 - DP - PLASTIC DRUM
 - B - BAG
 - BA - 8 MIL. PLASTIC BAG or WRAP
 - T - TRUCK
 - O - OTHER
- UNITS**
- P - POUNDS
 - Y - YARDS
 - M³ - CUBIC METERS
 - Y³ - CUBIC YARDS
 - O - OTHER

GENERATOR'S CERTIFICATION: I hereby certify that the above named material is not a hazardous waste as defined by 40 CFR Part 261 or any applicable state law, has been properly described, classified and packaged, and is in proper condition for transportation according to applicable regulations; AND, if the waste is a treatment residue of a previously restricted hazardous waste subject to the Land Disposal Restrictions, I certify and warrant that the waste has been treated in accordance with the requirements of 40 CFR Part 268 and is no longer a hazardous waste as defined by 40 CFR Part 261.

Generator Authorized Agent Name: _____ Signature: _____ Shipment Date:

0	1	2	9	0	0
---	---	---	---	---	---

Section II TRANSPORTER (Generator complete a-d; Transporter I complete e-g; Transporter II complete h-n)

TRANSPORTER I	TRANSPORTER II												
a. Name: <u>E. J. Pires Trucking, Inc.</u>	h. Name: <u>E. J. Pires Trucking, Inc.</u>												
b. Address: <u>731 Renz Lane</u> <u>Gilroy, CA 95020</u>	i. Address: <u>731 Renz Lane</u> <u>Gilroy, CA 95020</u>												
c. Driver Name/Title: _____	j. Driver Name/Title: _____												
d. Phone No.: <u>408-846-3557</u> e. Truck No.: <u>78</u>	k. Phone No.: <u>408-846-3557</u> l. Truck No.: _____												
f. Vehicle License No./State: _____	m. Vehicle License No./State: _____												
Acknowledgement of Receipt of Materials: _____	Acknowledgement of Receipt of Materials: _____												
g. Driver Signature: _____ Shipment Date: <table border="1"><tr><td> </td><td> </td><td> </td><td> </td><td> </td><td> </td></tr></table>							n. Driver Signature: _____ Shipment Date: <table border="1"><tr><td> </td><td> </td><td> </td><td> </td><td> </td><td> </td></tr></table>						

Section III DESTINATION (Generator completes a-d, destination site completes e-f)

a. Site Name: Vasco Road Landfill c. Phone No.: 925-447-0491
 b. Physical Address: 4001 N. Vasco Road d. Mailing Address: 4001 N. Vasco Road
Livermore, CA 94565 Livermore, CA 94565
 e. Discrepancy Indication Space: _____
 I hereby certify that the above named material has been accepted and to the best of my knowledge the foregoing is true and accurate.
 f. Name of Authorized Agent: Bm Signature: _____ Receipt Date:

0	1	2	9	0	0
---	---	---	---	---	---

Section IV ASBESTOS (Generator complete a-d, f, g; Shipper* completes e)

a. Shippers's* Name: _____ b. Shippers's* Phone No.: _____
 c. Shippers's* Address: _____
 d. Shippers's Special Handling Instructions and additional information: _____

CERTIFICATION: I hereby declare that the contents of this consignment are fully and accurately described above by proper shipping name and are classified, packaged, marked, and labeled/placarded, and are in all respects in proper condition for transport according to applicable international and national governmental regulations.

e. Shippers's* Name & Title: _____ Print/Type: _____ Shipper's Signature: _____ Date:

--	--	--	--	--	--

 f. Name and Address of Responsible Agency: _____
 g. Friable; Non-friable; Both _____ % friable _____ % nonfriable

* Shipper refers to the company which owns, leases, operates, controls, or supervises the facility being demolished or renovated, or the demolition or renovation operation, or both.



NON-HAZARDOUS SPECIAL WASTE & ASBESTOS MANIFEST

If waste is asbestos waste, complete Sections I, II, III and IV.
If waste is NOT asbestos waste, complete only Sections I, II and III.

No. 613404

Section I GENERATOR (Generator completes all of Section I)

a. Generator Name: Manijeh Faraji b. Generating Location: Freeway Station and Service
 c. Address: 2000 Stratton Road d. Address: 2740 98th Avenue
Walnut Creek, CA 94598 Oakland, CA 94605
 e. Phone No.: 925-256-1039 f. Phone No.: 510-562-7374

If owner of the generating facility differs from the generator, provide:

g. Owner's Name: _____ h. Owner's Phone No.: _____

i. BFI WASTE CODE:

C	A	4	0	5	0	1	1	9	0	0
---	---	---	---	---	---	---	---	---	---	---

0	2	4	2	9
---	---	---	---	---

 Containers: _____

j. Description of Waste: 100# Soil k. Quantity: _____ Units: _____ No.: _____ TYPE: _____

TYPE	
DM	- METAL DRUM
DP	- PLASTIC DRUM
B	- BAG
BA	- 6 MIL PLASTIC BAG or WRAP
T	- TRUCK
O	- OTHER

UNITS	
P	- POUNDS
Y	- YARDS
M ³	- CUBIC METERS
Y ³	- CUBIC YARDS
O	- OTHER

GENERATOR'S CERTIFICATION: I hereby certify that the above named material is not a hazardous waste as defined by 40 CFR Part 261 or any applicable state law, has been properly described, classified and packaged, and is in proper condition for transportation according to applicable regulations; AND, if the waste is a treatment residue of a previously restricted hazardous waste subject to the Land Disposal Restrictions, I certify and warrant that the waste has been treated in accordance with the requirements of 40 CFR Part 268 and is no longer a hazardous waste as defined by 40 CFR Part 261.

Generator Authorized Agent Name: _____ Signature: _____ Shipment Date:

0	1	2	9	0	0
---	---	---	---	---	---

Section II TRANSPORTER (Generator completes a-d; Transporter I completes e-g; Transporter II completes h-n)

TRANSPORTER I

a. Name: E. J. Pires Trucking, Inc.
 b. Address: 731 Renz Lane
Gilroy, CA 95020
 c. Driver Name/Title: AJEETA
 d. Phone No.: 408-846-8557 e. Truck No.: E-78
 f. Vehicle License No./State: 9A 83617
 Acknowledgement of Receipt of Materials.
 g. Driver Signature: _____ Shipment Date:

0	1	2	9	0	0
---	---	---	---	---	---

TRANSPORTER II

h. Name: E. J. Pires Trucking, Inc.
 i. Address: 731 Renz Lane
Gilroy, CA 95020
 j. Driver Name/Title: _____
 k. Phone No.: 408-846-8557 l. Truck No.: _____
 m. Vehicle License No./State: _____
 Acknowledgement of Receipt of Materials.
 n. Driver Signature: _____ Shipment Date: _____

Section III DESTINATION (Generator completes a-d; Destination site completes e-f)

a. Site Name: Vasco Road Landfill c. Phone No.: 925-447-0491
 b. Physical Address: 4001 N. Vasco Road d. Mailing Address: 4001 N. Vasco Road
Livermore, CA 94565 Livermore, CA 94565
 e. Discrepancy Indication Space: _____
 I hereby certify that the above named material has been accepted and to the best of my knowledge the foregoing is true and accurate.
 f. Name of Authorized Agent: _____ Signature: B.M Receipt Date:

0	1	2	9	0	0
---	---	---	---	---	---

Section IV ASBESTOS (Generator completes a-d; f, g; Shipper* completes e)

a. Shippers'* Name: _____ b. Shippers'* Phone No.: _____
 c. Shippers'* Address: _____
 d. Shippers's Special Handling Instructions and additional information: _____

CERTIFICATION: I hereby declare that the contents of this consignment are fully and accurately described above by proper shipping name and are classified, packaged, marked, and labeled/placarded, and are in all respects in proper condition for transport according to applicable international and national governmental regulations.

e. Shippers'* Name & Title: _____ Print/Type: _____ Shippers's Signature: _____ Date: _____
 f. Name and Address of Responsible Agency: _____
 g. Friable; Non-friable; Both _____ % friable _____ % nonfriable

* Shipper refers to the company which owns, leases, operates, controls, or supervises the facility being demolished or renovated, or the demolition or renovation operation, or both.



NON-HAZARDOUS SPECIAL WASTE & ASBESTOS MANIFEST

If waste is asbestos waste, complete Sections I, II, III and IV.
If waste is NOT asbestos waste, complete only Sections I, II and III.

No. 613405

Section I GENERATOR (Generator completes all of Section I)

a. Generator Name: Manijeh Faraji b. Generating Location: Freeway Station and Service
 c. Address: 2000 Stratton Road d. Address: 2740 98th Avenue
Walnut Creek, CA 94598 Oakland, CA 94605
 e. Phone No.: 925-256-1039 f. Phone No.: 510-562-7374

If owner of the generating facility differs from the generator, provide:

g. Owner's Name: _____ h. Owner's Phone No.: _____
 i. BFI WASTE CODE:

C	A	4	0	5	0	1	1	9	0	0
---	---	---	---	---	---	---	---	---	---	---

0	2	4	2	9
---	---	---	---	---

 Containers: _____
 j. Description of Waste: 100% Soil k. Quantity: _____ Units: _____ No.: _____ TYPE: _____

TYPE	
DM	- METAL DRUM
DP	- PLASTIC DRUM
B	- BAG
BA	- 6 MIL. PLASTIC BAG or WRAP
T	- TRUCK
O	- OTHER
UNITS	
P	- POUNDS
Y	- YARDS
M ³	- CUBIC METERS
Y ³	- CUBIC YARDS
O	- OTHER

GENERATOR'S CERTIFICATION: I hereby certify that the above named material is not a hazardous waste as defined by 40 CFR Part 261 or any applicable state law, has been properly described, classified and packaged, and is in proper condition for transportation according to applicable regulations; AND, if the waste is a treatment residue of a previously restricted hazardous waste subject to the Land Disposal Restrictions, I certify and warrant that the waste has been treated in accordance with the requirements of 40 CFR Part 268 and is no longer a hazardous waste as defined by 40 CFR Part 261.

Generator Authorized Agent Name: _____ Signature: _____ Shipment Date:

0	1	2	9	0	0
---	---	---	---	---	---

Section II TRANSPORTER (Generator complete a-d; Transporter I complete e-g; Transporter II complete h-n)

TRANSPORTER I		TRANSPORTER II							
a. Name: <u>E. J. Pinos Trucking, Inc.</u>	h. Name: <u>E. J. Pinos Trucking, Inc.</u>	i. Address: <u>731 Renz Lane</u>	j. Address: <u>731 Renz Lane</u>						
b. Address: <u>731 Renz Lane</u>	i. Address: <u>731 Renz Lane</u>	k. Driver Name/Title: _____	l. Driver Name/Title: _____						
c. Driver Name/Title: <u>Sean</u>	j. Driver Name/Title: _____	m. Phone No.: <u>408-346-3557</u>	n. Phone No.: <u>408-346-3557</u>						
d. Phone No.: <u>408-346-3557</u>	k. Phone No.: <u>408-346-3557</u>	o. Vehicle License No./State: <u>9A12401</u>	p. Vehicle License No./State: _____						
e. Truck No.: <u>0-14</u>	l. Truck No.: _____	Acknowledgement of Receipt of Materials: _____							
f. Vehicle License No./State: <u>9A12401</u>	m. Vehicle License No./State: _____	g. Driver Signature: <u>[Signature]</u> Shipment Date: <table border="1"><tr><td>0</td><td>1</td><td>2</td><td>9</td><td>0</td><td>0</td></tr></table>		0	1	2	9	0	0
0	1	2	9	0	0				
g. Driver Signature: _____	n. Driver Signature: _____	Shipment Date: _____							

Section III DESTINATION (Generator completes a-d, destination site completes e-l)

a. Site Name: Vasco Road Landfill c. Phone No.: 925-447-0491
 b. Physical Address: 4001 N. Vasco Road d. Mailing Address: 4001 N. Vasco Road
Livermore, CA 94565 Livermore, CA 94565
 e. Discrepancy Indication Space: _____
 I hereby certify that the above named material has been accepted and to the best of my knowledge the foregoing is true and accurate.
 f. Name of Authorized Agent: _____ Signature: [Signature] Receipt Date:

0	1	2	9	0	0
---	---	---	---	---	---

Section IV ASBESTOS (Generator complete a-d, f, g, Shipper* completes e.)

a. Shippers's* Name: _____ b. Shippers's* Phone No.: _____
 c. Shippers's* Address: _____
 d. Shippers's Special Handling Instructions and additional information: _____

CERTIFICATION: I hereby declare that the contents of this consignment are fully and accurately described above by proper shipping name and are classified, packaged, marked, and labeled/placarded, and are in all respects in proper condition for transport according to applicable international and national governmental regulations.

e. Shippers's* Name & Title: _____ Print/Type: _____ Shippers's Signature: _____ Date: _____
 f. Name and Address of Responsible Agency: _____
 g. Friable; Non-friable; Both _____ % friable _____ % nonfriable

* Shipper refers to the company which owns, leases, operates, controls, or supervises the facility being demolished or renovated, or the demolition or renovation operation, or both.



NON-HAZARDOUS SPECIAL WASTE & ASBESTOS MANIFEST

If waste is asbestos waste, complete Sections I, II, III and IV.
If waste is NOT asbestos waste, complete only Sections I, II and III.

No. 613401

Section I GENERATOR (Generator completes a-f; Section II)

a. Generator Name: Manijeh Faraji b. Generating Location: Freeway Station and Service
 c. Address: 2000 Stratton Road d. Address: 2740 98th Avenue
Walnut Creek, CA 94598 Oakland, CA 94605
 e. Phone No.: 510-562-7374 f. Phone No.: 925-256-1039

If owner of the generating facility differs from the generator, provide:
 g. Owner's Name: Manijeh Faraji h. Owner's Phone No.: 925-256-1039

i. BFI WASTE CODE:

C	A	4	0	5	0	1	1	9	0	0
---	---	---	---	---	---	---	---	---	---	---

 Containers:

0	2	4	2	9
---	---	---	---	---

 TYPE:

DM - METAL DRUM
DP - PLASTIC DRUM
B - BAG
BA - 6 MIL. PLASTIC BAG or WRAP
T - TRUCK
O - OTHER

 j. Description of Waste: 100% Soil k. Quantity:

--	--	--	--	--

 Units:

--

 No.:

--	--	--

 TYPE:

T

GENERATOR'S CERTIFICATION: I hereby certify that the above named material is not a hazardous waste as defined by 40 CFR Part 261 or any applicable state law, has been properly described, classified and packaged, and is in proper condition for transportation according to applicable regulations; AND, if the waste is a treatment residue of a previously restricted hazardous waste subject to the Land Disposal Restrictions, I certify and warrant that the waste has been treated in accordance with the requirements of 40 CFR Part 268 and is no longer a hazardous waste as defined by 40 CFR Part 261.

Generator Authorized Agent Name: [Signature] Signature: [Signature] Shipment Date:

0	3	1	1	0	0
---	---	---	---	---	---

Section II TRANSPORTER (Generator completes a-d; Transporter I completes e-g; Transporter II completes h-n)

CHARLES GAL TRANSPORTER I
 a. Name: J. Pires Trucking, Inc.
 b. Address: 731 Benz Lane
415 ALDO AVE
Citroy, CA 95020
SANTA CLARA
CA 95054
 c. Driver Name/Title: [Signature]
 d. Phone No.: 408-346-8557 PRINT/TYPE: 202
 e. Truck No.: 202
 f. Vehicle License No./State: 9A44425
 Acknowledgement of Receipt of Materials.
 g. [Signature] Shipment Date:

0	3	1	1	0	0
---	---	---	---	---	---

TRANSPORTER II
 h. Name: E. J. Pires Trucking, Inc.
 i. Address: Renz Lane
Citroy, CA 95020
 j. Driver Name/Title: [Signature]
 k. Phone No.: 408-346-8557 PRINT/TYPE: [Signature]
 l. Truck No.: [Signature]
 m. Vehicle License No./State: [Signature]
 Acknowledgement of Receipt of Materials.
 n. [Signature] Shipment Date:

--	--	--	--	--	--

Section III DESTINATION (Generator completes a-d; destination site completes e-f)

a. Site Name: Vasco Road Landfill c. Phone No.: 925-447-0491
 b. Physical Address: 4001 N. Vasco Road d. Mailing Address: 4001 N. Vasco Road
Livermore, CA 94565 Livermore, CA 94565
 e. Discrepancy Indication Space: _____
 I hereby certify that the above named material has been accepted and to the best of my knowledge the foregoing is true and accurate.
 f. [Signature] Name of Authorized Agent: _____ Signature: _____ Receipt Date:

0	3	1	1	0	0
---	---	---	---	---	---

Section IV ASBESTOS (Generator completes a-d; f, g; Shipper* completes e.)

a. Shippers* Name: _____ b. Shippers* Phone No.: _____
 c. Shippers* Address: _____
 d. Shippers* Special Handling Instructions and additional information: _____
 CERTIFICATION: I hereby declare that the contents of this consignment are fully and accurately described above by proper shipping name and are classified, packaged, marked, and labeled/placarded, and are in all respects in proper condition for transport according to applicable international and national governmental regulations.
 e. Shippers* Name & Title: _____ Print/Type: _____ Shippers* Signature: _____ Date: _____
 f. Name and Address of Responsible Agency: _____
 g. Friable; Non-friable; Both _____ % friable _____ % nonfriable



NON-HAZARDOUS SPECIAL WASTE & ASBESTOS MANIFEST

If waste is asbestos waste, complete Sections I, II, III and IV.
If waste is NOT asbestos waste, complete only Sections I, II and III.

No. 613896

Section I GENERATOR (Generator completes all of Section I)

a. Generator Name: Manijeh Faraji b. Generating Location: Freeway Station and Sewer
 c. Address: 2000 Strahan Road d. Address: 2740 98th Avenue
Walnut Creek, CA 94598 Oakland, CA 94605
 e. Phone No.: 925-256-7374 f. Phone No.: 925-256-1039

If owner of the generating facility differs from the generator, provide:
 g. Owner's Name: Manijeh Faraji h. Owner's Phone No.: 925-256-1039

i. BFI WASTE CODE:

LA	405	011900	02429
----	-----	--------	-------

 Containers:

DM	DP	B	BA	T	O
----	----	---	----	---	---

 j. Description of Waste: 100% Soil k. Quantity:

--	--	--	--	--	--

 Units:

--	--	--	--

 No.:

--	--	--	--

 TYPE:

T

GENERATOR'S CERTIFICATION: I hereby certify that the above named material is not a hazardous waste as defined by 40 CFR Part 261 or any applicable state law, has been properly described, classified and packaged, and is in proper condition for transportation according to applicable regulations; AND, if the waste is a treatment residue of a previously restricted hazardous waste subject to the Land Disposal Restrictions, I certify and warrant that the waste has been treated in accordance with the requirements of 40 CFR Part 268 and is no longer a hazardous waste as defined by 40 CFR Part 261.

Frank Generator Authorized Agent Name Signature

031100

 Shipment Date

- TYPE
 DM - METAL DRUM
 DP - PLASTIC DRUM
 B - BAG
 BA - 6 MIL. PLASTIC BAG or WRAP
 T - TRUCK
 O - OTHER
- UNITS
 P - POUNDS
 Y - YARDS
 M³ - CUBIC METERS
 Y³ - CUBIC YARDS
 O - OTHER

Section II TRANSPORTER (Generator complete a-d; Transporter I complete e-g; Transporter II complete h-n)

TRANSPORTER I
 a. Name: Cirujos Galasso
 b. Address: 415 Aliso Ave
Santa Clara, CA 95054
 c. Driver Name/Title: _____
 d. Phone No.: 408-988-4071 e. Truck No.: 202
 f. Vehicle License No./State: 9A44425
 Acknowledgement of Receipt of Materials.
 g. Hindoz Driver Signature

031100

 Shipment Date

TRANSPORTER II
 h. Name: _____
 i. Address: _____
 j. Driver Name/Title: _____
 k. Phone No.: _____ l. Truck No.: _____
 m. Vehicle License No./State: _____
 Acknowledgement of Receipt of Materials.
 n. _____ Driver Signature

--	--	--	--	--	--

 Shipment Date

Section III DESTINATION (Generator completes a-d, destination site completes e-f)

a. Site Name: Yosco Road Linnville c. Phone No.: 925-447-0491
 b. Physical Address: 4001 W. Yosco Rd d. Mailing Address: 4001 W. Yosco Rd
Linnmore, CA 94565 Linnmore, CA 94565

e. Discrepancy Indication Space: _____
 I hereby certify that the above named material has been accepted and to the best of my knowledge the foregoing is true and accurate.

f. _____ Name of Authorized Agent Signature

031100

 Receipt Date

Section IV ASBESTOS (Generator complete a-d, f, g; Shipper* completes e)

a. Shippers* Name: _____ b. Shippers* Phone No.: _____
 c. Shippers* Address: _____
 d. Shippers* Special Handling Instructions and additional information: _____

CERTIFICATION: I hereby declare that the contents of this consignment are fully and accurately described above by proper shipping name and are classified, packaged, marked, and labeled/placarded, and are in all respects in proper condition for transport according to applicable international and national governmental regulations.

e. Shippers* Name & Title: _____ Print/Type Shippers' Signature Date
 f. Name and Address of Responsible Agency: _____
 g. Friable; Non-friable; Both _____ % friable _____ % nonfriable

* Shipper refers to the company which owns, leases, operates, controls, or supervises the facility being demolished or renovated, or the demolition or renovation operation, or both.