

C A M B R I A

February 25, 2005

Mr. Don Hwang
ACHSA
1131 Harbor Bay Pkwy.
Oakland, CA 94502-6577

RE: 5910 Macarthur Blvd, Oakland
ACHSCA RO#: ~~0000124~~ 7

Alameda County
MAR 7 1 2005
BUSINESS SERVICES CENTER

Dear Mr. Hwang:



This letter is to inform you of a change in management for the above-referenced site.

Effective immediately, the new ChevronTexaco project manager will be:

Mr. Mark Inglis
ChevronTexaco
6001 Bollinger Canyon Rd., K-2256
San Ramon, CA 94583
Phone: 925-842-1589

Please contact either Mr. Mark Inglis or Cambria if you have any questions.

Regards,

Cambria Environmental Technology, Inc.

cc: Mark Inglis, Chevron Texaco

**Cambria
Environmental
Technology, Inc.**

5900 Hollis Street
Suite A
Emeryville, CA 94608
Tel (510) 420-0700
Fax (510) 420-9170
Site #: 99708

20124



Winston H. Hickox
Secretary for
Environmental
Protection

State Water Resources Control Board

Division of Financial Assistance

1001 I Street • Sacramento, California 95814
P.O. Box 944212 • Sacramento, California • 94244-2120
(916) 341-5714 • FAX (916) 341-5806 • www.swrcb.ca.gov/cwphome/ustef



Gray Davis
Governor

The energy challenge facing California is real. Every Californian needs to take immediate action to reduce energy consumption. For a list of simple ways you can reduce demand and cut your energy costs, see our website at www.swrcb.ca.gov.

October 15, 2003

Chevron Products Company
Robert Cochran
P O Box 6004
San Ramon, CA 94583-0904

UNDERGROUND STORAGE TANK CLEANUP FUND (FUND), NOTICE OF ELIGIBILITY DETERMINATION: CLAIM NUMBER 017878; FOR SITE ADDRESS: 5910 MACARTHUR BLVD, OAKLAND

Your claim has been accepted for placement on the Priority List in Priority Class "D" with a deductible of \$10,000.

We have completed our initial review. The next step in the claim review process is to conduct a compliance review.

Compliance Review: Staff reviews, verifies, and processes claims based on the priority and rank within a priority class. After the Board adopts the Priority List, your claim will remain on the Priority List until your Priority Class and rank are reached. At that time, staff will conduct an extensive Compliance Review at the local regulatory agency or Regional Water Quality Control Board. During this Compliance Review, staff may request additional information needed to verify eligibility. Once the Compliance Review is completed, staff will determine if the claim is valid or must be rejected. If the claim is valid, a Letter of Commitment will be issued obligating funds toward the cleanup. If staff determine that you have not complied with regulations governing site cleanup, you have not supplied necessary information or documentation, or your claim application contains a material error, the claim will be rejected. In such event, you will be issued a Notice of Intended Removal from the Priority List, informed of the basis for the proposed removal of your claim, and provided an opportunity to correct the condition that is the basis for the proposed removal. Your claim will be barred from further participation in the Fund, if the claim application contains a material error resulting from fraud or intentional or negligent misrepresentation.

Record keeping: During your cleanup project you should keep complete and well organized records of all corrective action activity and payment transactions. If you are eventually issued a Letter of Commitment, you will be required to submit: (1) copies of detailed invoices for all corrective action activity performed (including subcontractor invoices), (2) copies of canceled checks used to pay for work shown on the invoices, (3) copies of technical documents (bids, narrative work description, reports), and (4) evidence that the claimant paid for the work performed (not paid by another party). These documents are necessary for reimbursement and failure to submit them could impact the amount of reimbursement made by the Fund. ***It is not necessary to submit these documents at this time; however, they will definitely be required prior to reimbursement.***

Compliance with Corrective Action Requirements: In order to be reimbursed for your eligible costs of cleanup incurred after December 2, 1991, you must have complied with corrective action requirements of Article 11, Chapter 16, Division 3, Title 23, California Code of Regulations. Article 11 categorized the corrective action process into **phases**. In addition, Article 11 requires the responsible party to submit an

California Environmental Protection Agency



investigative workplan/Corrective Action Plan (CAP) before performing any work. This phasing process and the workplan/CAP requirements were intended to:

1. help the responsible party undertake the necessary corrective action in a cost-effective, efficient and timely manner;
2. enable the regulatory agency to review and approve the proposed cost-effective corrective action alternative before any corrective action work was performed; and
3. ensure the Fund will only reimburse the most cost-effective corrective action alternative required by the regulatory agency to achieve the minimum cleanup necessary to protect human health, safety and the environment.

In some limited situations *interim cleanup* will be necessary to mitigate a demonstrated immediate hazard to public health, or the environment. Program regulations allow the responsible party to undertake interim remedial action after: (1) notifying the regulatory agency of the proposed action, and; (2) complying with any requirements that the regulatory agency may set. Interim remedial action should only be proposed when necessary to mitigate an immediate demonstrated hazard. ***Implementing interim remedial action does not eliminate the requirement for a CAP and an evaluation of the most cost-effective corrective action alternative.***

Three bids and Cost Preapproval: Only corrective action costs required by the regulatory agency to protect human health, safety and the environment can be claimed for reimbursement. You must comply with all regulatory agency time schedules and requirements and you must obtain three bids for any required corrective action. Unless waived in writing, you are required to obtain preapproval of costs for all future corrective action work. ***If you do not obtain three bids or a waiver of the three bid requirement, reimbursement is not assured and costs may be rejected as ineligible.***

If you have any questions, please contact me at (916) 341-5714.

Sincerely,

Shari Knieriem
Claims Review Unit
Underground Storage Tank Cleanup Fund

cc: Mr. Chuck Headlee
RWQCB, Region 2
1515 Clay Street, Ste. 1400
Oakland, CA 94612

Ms. Donna Drogos
Alameda County EHD
1131 Harbor Bay Pkway, 2nd Fl.
Alameda, CA 94502-6577

ALAMEDA COUNTY
HEALTH CARE SERVICES

AGENCY

DAVID J. KEARS, Agency Director



ENVIRONMENTAL HEALTH SERVICES
ENVIRONMENTAL PROTECTION
1131 Harbor Bay Parkway, Suite 250
Alameda, CA 94502-6577
(510) 567-6700
FAX (510) 337-9335

January 22, 2002

Tom Bauhs, Project Manager
Chevron USA, Inc.
Site Assessment & Remediation
6001 Bollinger Canyon Rd., V1132
PO Box 6004
San Ramon, CA 94583-0904

Dear Mr. Bauhs:

Subject: Former Chevron Service Station #9-9708, 5910 MacArthur Blvd., Oakland, CA;
RO0000124

"Interim Corrective Action (ICA) Evaluation" dated January 2, 2002 by Delta Environmental Consultants, Inc., and "2nd Quarter Event of June 19, 2001" dated July 19, 2001 by Gettler-Ryan, Inc., for the facility referenced were reviewed. The ICA evaluation determined that no significant benefit was realized from this activity and recommended discontinuation of ICA activities. We concur. Groundwater monitoring results from September 18, 2001 samples from wells MW-1, MW-2, MW-3, and MW-4, were also reported. All wells were sampled for total petroleum hydrocarbons as gasoline (TPH-G), benzene, toluene, ethyl benzene, xylene (BTEX), and methyl tertiary-butyl ether (MTBE). MW-3 was additionally sampled for TPH as diesel (TPH-D) and volatile organic compounds (VOC). Results were consistent with recent samples with the following exceptions: MW-3 had the highest TPH-D concentration, 4,800 ug/l, since sampling was initiated in 1997. MW-3 was below the detection limit for all other analytes. The 1,2-dichloroethane (1,2-DCA) concentration from MW-3 was below the detection limit, <2 ug/l. However, the detection limit exceeds the maximum contaminant level (MCL) of 0.5 ug/l. MW-4 was below the detection limit for all analytes. MW-1's concentrations for TPH-G, BTEX, and MTBE, were 200, 32, 0.55, 3, <1.5, and 1,600 ug/l. The MTBE concentration was much higher than the previous quarter's 110 ug/l, which was also much lower than other recent quarters. MW-2's concentrations were 1,700, 42, 1.9, 2, 2.9, and 280 ug/l, respectively.

"2nd Quarter Event of June 19, 2001" dated July 19, 2001 by Gettler-Ryan, Inc., reported the sampling of MW-1, MW-2, MW-3, and MW-4, on June 19, 2001 for TPH-G, BTEX, and MTBE. MW-3 was additionally sampled for TPH-D and VOC. Constituent concentrations were low or nondetectable for all wells. Constituent concentrations were consistent with recent

Mr. Bauhs
January 22, 2002
Page 2 of 2

samples with the following exceptions: MW-1's MTBE concentrations decreased to 110 ug/l from 1,570 to 6,030 ug/l found since 1999. The 1,2-DCA concentration from MW-3 was below the detection limit, <1.6 ug/l. However, the detection limit exceeds the MCL of 0.5 ug/l. MW-3's TPH-D of 120 ug/l was less than the 690 to 2,700 found since sampling started in 1997. MW-4 exhibited detectable concentrations of 210 ug/l TPH-G, 7.6 ug/l benzene, 1.4 ug/l toluene, and 10 ug/l MTBE, whereas the previous 4 samples collected in 2000 were nondetectable for all constituents.

Future analyses of 1,2-DCA need detection limits at or below 0.5 ug/l, the MCL. The two additional downgradient wells proposed in the ICA dated June 30, 2000 still have not been installed but installation is anticipated during the first quarter of 2002. The sanitary sewer and storm drain were identified as possible pathways for dissolved and vapor phase petroleum hydrocarbons. Again, you may consider using EPA Method 8260 to confirm the presence of MTBE and other oxygenates for groundwater samples from monitoring well MW-1. If you have any questions, call me at (510) 567-6746.

Sincerely,

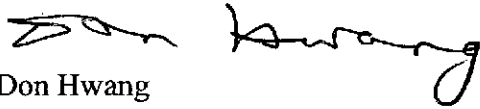

Don Hwang
Hazardous Materials Specialist

cc
C: Todd Del Frate, Delta Environmental Consultants, Inc., 3164 Gold Camp Dr., Suite 200,
Rancho Cordova, CA 95670-6021

✓ File

ALAMEDA COUNTY
HEALTH CARE SERVICES

AGENCY

DAVID J. KEARS, Agency Director



ENVIRONMENTAL HEALTH SERVICES
ENVIRONMENTAL PROTECTION
1131 Harbor Bay Parkway, Suite 250
Alameda, CA 94502-6577
(510) 567-6700
FAX (510) 337-9335

November 26, 2001

Tom Bauhs, Project Manager
Chevron USA, Inc.
Site Assessment & Remediation
6001 Bollinger Canyon Rd., V1132
PO Box 6004
San Ramon, CA 94583-0904

Dear Mr. Bauhs:

Subject: Former Chevron Service Station #9-9708, 5910 MacArthur Blvd., Oakland, CA;
RO0000124

"Sensitive Receptor Survey Report" dated August 1, 2001 and "Interim Corrective Action" dated August 6, 2001 by Gettler-Ryan, Inc., were reviewed. These reports documented the implementation of some of the items proposed in the Interim Corrective Action Plan (ICAP) dated June 30, 2000. The sanitary sewer and storm drain were identified as possible pathways for dissolved and vapor phase petroleum hydrocarbons. Hydrocarbon impacted groundwater was extracted from monitoring wells MW-1 and MW-2. An evaluation of the extraction activities will be included with the next quarterly groundwater monitoring results.

The two additional downgradient wells were not installed. Indicate when they will be installed. If you have any questions, please call me at (510) 567-6746.

Sincerely,

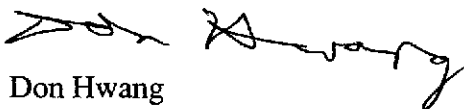
Don Hwang
Hazardous Materials Specialist

u
C: Todd Del Frate, Steven Meeks, Brett Bardsley, Gettler-Ryan, Inc., 3164 Gold Camp Dr.,
Suite 200, Rancho Cordova, CA 95670-6021

File



Delta
Environmental
Consultants, Inc.

August 6, 2001

Mr. Don Hwang
Alameda County Health Care Services
1131 Harbor Bay Parkway
Alameda, CA 94502-6577

Subject: *Interim Corrective Action*
Former Chevron Station #9-9708
5910 MacArthur Boulevard
Oakland, California

Dear Mr. Hwang,

Delta Environmental Consultants, Inc. (Delta), has been authorized by Chevron Products Company (Chevron) to perform interim corrective action (ICA) at the above referenced site. This activity was conducted as part of the implementation of *Delta's Interim Corrective Action Plan*, dated June 30, 2000. This letter documents field activities associated with interim corrective action at the subject site. The location of the site and surrounding properties are shown on Figure 2.

On August 2, 2001, a Delta representative was onsite to oversee Integrated Wastestream Management (IWM) conduct extraction of groundwater from wells MW-1 and MW-2. Prior to extraction of groundwater, depth to water (DTW) was measured in wells MW-1 through MW-4. The DTW ranged between 12.15 to 12.96 feet below surface grade (bsg). Following DTW measurements, groundwater extraction activities were performed on well MW-1 and MW-2. Approximately 50 gallons of hydrocarbon impacted groundwater was extracted during this activity. Well MW-2 was included in the extraction activities due to low groundwater yield from well MW-1. Upon completion of ICA, DTW in all site wells were measured ranging between 12.19 and 19.5 feet bsg. Groundwater extracted was transported by IWM to McKittrick WTS in McKittrick, California.

Following receipt of the next quarterly groundwater sampling results, Delta will evaluate current data and assess the effects of the extraction activities on dissolved concentrations of petroleum hydrocarbons. If you have questions or comments regarding this letter, please contact Todd Del Frate at (916) 536-2612.

Sincerely,

DELTA ENVIRONMENTAL CONSULTANTS, INC.

Brett Bardsley

Brett A. Bardsley
Staff Geologist
BAB (CL002.99708.doc)

cc: Tom Bauhs – Chevron Products Company
Saidian Zekser – Station Owner

Providing a Competitive Edge

3164 Gold Camp Drive
Suite 200
Rancho Cordova, CA 95670-6021
U.S.A.
916/638-2085
FAX: 916/638-8385

AUG 14 2001

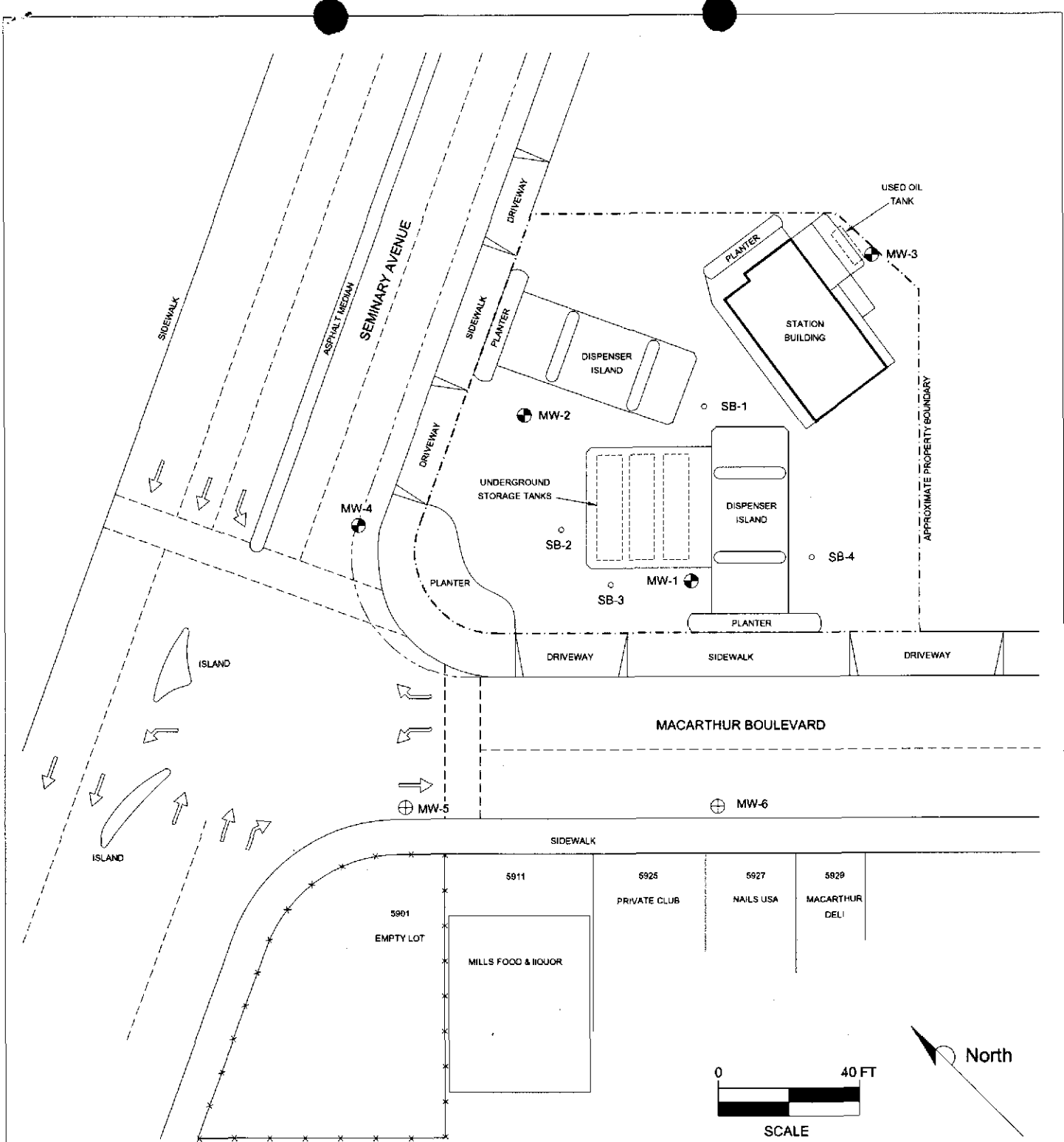

LEGEND:

- MW-1 MONITORING WELL LOCATION
- ⊕ MW-5 PROPOSED MONITORING WELL LOCATION
- SB-1 PROPOSED SOIL BORING LOCATIONS

FIGURE 2
SITE VICINITY MAP
CHEVRON SERVICE STATION NO. 9-9708
5910 MACARTHUR BOULEVARD
OAKLAND, CA.

PROJECT NO. DG99-708	DRAWN BY TLA 6/15/01
FILE NO. 9-9708-2	PREPARED BY TAD
REVISION NO. 3	REVIEWED BY

Delta
Environmental
Consultants, Inc.

Hwang, Don, Env. Health

From: tdelfrate@deltaenv.com[SMTP:tdelfrate@deltaenv.com]
Sent: Wednesday, August 01, 2001 1:46 PM
To: dhwang@co.alameda.ca.us
Cc: tkba@chevron.com; jbrownell@deltaenv.com; bbardsley@deltaenv.com
Subject: Overpurge of well MW-1 at Chevron 9-9708, 5910 MacArthur Boulevard, Oakland, Ca

Hello Don, Delta Environmental will be on-site tomorrow to conduct overpurging of well MW-1 as proposed in the Interim Corrective Action Plan dated June 30, 2000. Staff professional Brett Bardsley will be onsite to oversee IWM. Start time will be approximately 0900. The sensitive receptor survey has been completed and is being reviewed for final. Chevron/Delta has prepared an encroachment permit package for the City of Oakland. If you have any questions please call me at the number listed below.

Todd Del Frate
Project Manager
Delta Environmental Consultants, Inc.
Phone: 916-536-2612 Fax: 916-854-8385
email: tdelfrate@deltaenv.com

ALAMEDA COUNTY
HEALTH CARE SERVICES

July 13, 2001

AGENCY
DAVID J. KEARS, Agency Director



Tom Bauhs, Project Manager
Chevron USA, Inc.
Site Assessment & Remediation
6001 Bollinger Canyon Rd., V1132
PO Box 6004
San Ramon, CA 94583-0904

ENVIRONMENTAL HEALTH SERVICES
ENVIRONMENTAL PROTECTION
1131 Harbor Bay Parkway, Suite 250
Alameda, CA 94502-6577
(510) 567-6700
FAX (510) 337-9335

Dear Mr. Bauhs:

Subject: Former Chevron Service Station #9-9708, 5910 MacArthur Blvd., Oakland, CA;
RO0000124

"1st Quarter Event of March 1, 2001" dated April 18, 2001 by Gettler-Ryan, Inc., for the facility referenced was reviewed. Monitoring wells MW-1, MW-2, and MW-3, were sampled on March 1, 2001 for total petroleum hydrocarbons as gasoline (TPH-G), benzene, toluene, ethyl benzene, xylene (BTEX), and methyl tertiary-butyl ether (MTBE). Monitoring well MW-3 was additionally sampled for TPH as diesel (TPH-D) and volatile organic compounds (VOC). Monitoring well MW-4 was inaccessible for sampling. Constituent concentrations were consistent with recent samples. The MTBE concentration in monitoring well MW-1 was 3,360 ug/l. Monitoring well MW-2's MTBE concentration was 245 ug/l. The concentrations for the other constituents found in monitoring wells MW-1 and MW-2 were low or nondetectable. Monitoring well MW-3's TPH-D was 1,060 ug/l. The 1,2-dichloroethane (1,2-DCA) concentration of 0.528 ug/l for monitoring well MW-3 exceeded the maximum contaminant level (MCL) of 0.5 ug/l. The concentrations for the other constituents found in monitoring well MW-3 were low or nondetectable.

The Interim Corrective Action Plan (ICAP) dated June 30, 2000 which proposed 2 additional wells further downgradient, a sensitive receptor survey, and over-purging of monitoring well MW-1, has not been implemented. To delineate the extent of the contamination for TPH-D and VOC, these contaminants need to be included for monitoring wells MW-1, MW-2, and MW-4, as well as the proposed wells. Again, you may consider using EPA Method 8260 to confirm the presence of MTBE and other oxygenates for groundwater samples from monitoring well MW-1. If you have any questions, call me at (510) 567-6746.

Sincerely,

Don Hwang
Hazardous Materials Specialist

C: Deanna Harding, Gettler-Ryan, Inc., 6747 Sierra Court, Suite J, Dublin, CA 94568
File

ALAMEDA COUNTY
HEALTH CARE SERVICES

AGENCY

DAVID J. KEARS, Agency Director



ENVIRONMENTAL HEALTH SERVICES
ENVIRONMENTAL PROTECTION
1131 Harbor Bay Parkway, Suite 250
Alameda, CA 94502-6577
(510) 567-6700
FAX (510) 337-9335

September 15, 2000

Tom Bauhs, Project Manager
Chevron USA, Inc.
Site Assessment & Remediation
6001 Bollinger Canyon Rd., Bldg. L
P.O. Box 6004
San Ramon, CA 94583-0904

Dear Mr. Bauhs:

Subject: Former Chevron Service Station #9-9708, 5910 MacArthur Blvd., Oakland, CA;
StId 871

"Interim Corrective Action Plan (ICAP)" dated June 30, 2000 by Delta Environmental Consultants was reviewed. ICAP proposed 2 additional wells further downgradient, a sensitive receptor survey, and over-purging of monitoring well MW-1. ICAP is acceptable.

You may consider using EPA Method 8260 for Methyl Tertiary-Butyl Ether (MTBE) and other oxygenates for groundwater samples from monitoring well MW-1.

If you have any questions, call me at (510) 567-6746.

Sincerely,

Don Hwang
Hazardous Materials Specialist

u
C: Will Speth, Delta Environmental Consultants, Inc., 3164 Gold Camp Dr., Suite 200,
Rancho Cordova, CA 95670

✓ file

ALAMEDA COUNTY
HEALTH CARE SERVICES

AGENCY

DAVID J. KEARS, Agency Director



ENVIRONMENTAL HEALTH SERVICES
ENVIRONMENTAL PROTECTION
1131 Harbor Bay Parkway, Suite 250
Alameda, CA 94502-6577
(510) 567-6700
FAX (510) 337-9335

June 2, 2000

Tom Bauhs, Project Manager
Chevron USA, Inc.
Site Assessment & Remediation
6001 Bollinger Canyon Rd., Bldg. L
P.O. Box 6004
San Ramon, CA 94583-0904

Re: Former Chevron Service Station #9-9708, 5910 MacArthur Blvd., Oakland, CA;
StId 871

Dear Mr. Bauhs:

This office has reviewed the 4th quarter 1999 groundwater monitoring report dated March 13, 2000 and the 1st quarter 2000 groundwater monitoring report dated April 24, 2000 by Blaine Tech Services, Inc., for the above noted facility. The March 1, 2000 sample from MW-1 was significantly higher for all constituents compared to the December 8, 1999 sample and prior samples. Total petroleum hydrocarbons as gasoline (TPH-G), benzene, toluene, ethyl benzene, xylene (BTEX), and methyl tertiary-butyl ether (MTBE) were 2580 ug/l, 481 ug/l, 6.84 ug/l, 86.6 ug/l, 41.9 ug/l, and 5460 ug/l, respectively. The March 1, 2000 and December 8, 1999 samples from MW-2 were nondetectable (ND) except for MTBE on March 1, 2000 at 254 ug/l, benzene on March 1, 2000 and December 8, 1999 at 6.92 and 2.74 ug/l, respectively, and TPH-G at 96.8 ug/l. The March 1, 2000 and December 8, 1999 samples from MW-3 and MW-4 were ND for all constituents.

Your request for an extension until July 1, 2000 to submit a Corrective Action Plan, which includes an assessment of impacts, a feasibility study, and applicable cleanup levels, is accepted.

If you have any questions, call me at (510) 567-6746.

Sincerely,

Don Hwang
Hazardous Materials Specialist

 C: file



GETTLER-RYAN INC.

ENVIRONMENTAL
PROTECTION

00 APR 28 PM 3:39

April 25, 2000

Mr. Don Hwang
Alameda County Environmental Health Services
1131 Harbor Bay Parkway
Alameda, CA 94502-6577

Subject: Chevron Station #9-9708, 5910 McArthur Boulevard, Oakland, CA

Mr. Hwang:

We have prepared this letter at the request of Chevron Products Company in response to your letter of December 17, 1999. Chevron has recently re-assigned oversight of this site within their Site Remediation and Assessment group. The new Project Manager is Mr. Tom Bauhs (925.842.8898). In addition, Chevron is also redistributing site assignments among its consultants; the consultant for this site may change. Because of these changes, on behalf of Chevron we request an extension until July 1, 2000, to review the files and prepare the work plan.

Please call us at 916.631.1300 if you have questions.

Sincerely,
Gettler-Ryan Inc.

Stephen J. Carter, R.G.
Senior Geologist

cc: Mr. Tom Bauhs, Chevron Products Company

346395.04

ALAMEDA COUNTY
HEALTH CARE SERVICES

AGENCY
DAVID J. KEARS, Agency Director



COPY

ENVIRONMENTAL HEALTH SERVICES
ENVIRONMENTAL PROTECTION
1131 Harbor Bay Parkway
Alameda, CA 94502-6577
(510) 567-6700
(510) 337-9432

December 17, 1999

Brett Hunter, Project Manager
Chevron USA, Inc.
Site Assessment & Remediation
6001 Bollinger Canyon Rd., Bldg. L
P.O. Box 6004
San Ramon, CA 94583-0904

Re: Former Chevron Service Station #9-9708, 5910 MacArthur
Blvd., Oakland, CA; STID 871

Dear Mr. Hunter:

This office has reviewed the 3rd quarter 1999 groundwater monitoring report dated December 1, 1999 by Blaine Tech Services, Inc., for the above noted facility. The September 29, 1999 sample from MW-1 contained 647 PPB total petroleum hydrocarbons as gasoline (TPH-G), 167 PPB benzene, <2.5 PPB toluene, 58.6 PPB ethyl benzene, 14.8 PPB xylene (BTEX), and 1570 PPB methyl tertiary-butyl ether (MTBE). The September 29, 1999 sample from MW-2 contained 2000 PPB total petroleum hydrocarbons as gasoline (TPH-G), 320 PPB benzene, 10.4 PPB toluene, 16.5 PPB ethyl benzene, 20.3 PPB xylene (BTEX), and 642 PPB MTBE. The results were within the range of previous samples from these wells.

You indicated that you did not plan to use ORC and instead would submit an alternative proposal. A Corrective Action Plan, which includes an assessment of impacts, a feasibility study, and applicable cleanup levels, is required. Submit a Corrective Action Plan, which incorporates your findings within 30 days.

If you have any questions, call me at (510) 567-6746.

Sincerely,

Don Hwang
Hazardous Materials Specialist

C: file

15.



5710 871
Chevron

June 23, 1999

Chevron Products Company
6001 Bollinger Canyon Road
Building L, Room 1080
PO Box 6004
San Ramon, CA 94583-0904

Mr. Thomas Peacock
Alameda County Health Care Services
Department of Environmental Health
1131 Harbor Bay Parkway, Suite 250
Alameda, CA 94502-6577

Philip R. Briggs
Project Manager
Site Assessment & Remediation
Phone 925 842-9136
Fax 925 842-8370

Subject: Certified List of Record Fee Title Owners
For: Chevron Service Station # 9-9708
5910 MacArthur Blvd., Oakland, California

Dear Mr. Peacock:

In accordance with section 25297.15(a) of Chapter 6.7 of the Health & Safety Code, Chevron Products Company, certify that the following is a complete list of current record fee title owners and their mailing addresses for the above site:

Mr. Nisson Saidion
5910 MacArthur Blvd.
Oakland, CA 94605

Sincerely,

CHEVRON PRODUCTS COMPANY

Philip R. Briggs
Site Assessment and Remediation Project Manger

CC Mr. Bill Scudder, Chevron

99 JUN 28 PM 3:38

ENVIRONMENTAL
PROTECTION

ALAMEDA COUNTY
HEALTH CARE SERVICES
HEALTH CARE SERVICES
AGENCY



DAVID J. KEARS, Agency Director
DAVID J. KEARS, Agency Director

RAFAT A. SHAHID, Director

June 15, 1999

STID 871

Philip R. Briggs
Chevron products Company
6001 Bollinger Canyon Rd.
San Ramon, CA 94583

RE: 5910 MacArthur Blvd., Oakland, CA 94605

DEPARTMENT OF ENVIRONMENTAL HEALTH
ENVIRONMENTAL HEALTH SERVICES
Environmental Protection Division
1131 Harbor Bay Parkway, Suite 250
Alameda, CA 94502-6577
(510) 567-6760
(510) 367-6700

LANDOWNER NOTIFICATION AND PARTICIPATION REQUIREMENTS

Dear Mr. Briggs:

This letter is to inform you of new legislative requirements pertaining to cleanup and closure of sites where an unauthorized release of hazardous substance, including petroleum, has occurred from an underground storage tank (UST). Section 25297.15(a) of Ch. 6.7 of the Health & Safety Code requires the primary or active responsible party to notify all current record owners of fee title to the site of: 1) a site cleanup proposal, 2) a site closure proposal, 3) a local agency intention to make a determination that no further action is required, and 4) a local agency intention to issue a closure letter. Section 25297.15(b) requires the local agency to take all reasonable steps to accommodate responsible landowners' participation in the cleanup or site closure process and to consider their input and recommendations.

For purposes of implementing these sections, you have been identified as the primary or active responsible party. Please provide to this agency, within twenty (20) calendar days of receipt of this notice, a complete mailing list of all current record owners of fee title to the site. You may use the enclosed "list of landowners" form (sample letter 2) as a template to comply with this requirement. If the list of current record owners of fee title to the site changes, you must notify the local agency of the change within 20 calendar days from when you are notified of the change.

If you are the sole landowner, please indicate that on the landowner list form. The following notice requirements do not apply to responsible parties who are the sole landowner for the site.

In accordance with Section 25297.15(a) of Ch. 6.7 of the Health & Safety Code, you must certify to the local agency that all current record owners of fee title to the site have been informed of the proposed action before the local agency may do any of the following:

LANDOWNER NOTIFICATION

Re: 5910 MacArthur Blvd., Oakland, CA 94605

June 15, 1999

Page 2 of 2

- 1) consider a cleanup proposal (corrective action plan)
- 2) consider a site closure proposal
- 3) make a determination that no further action is required
- 4) issue a closure letter

You may use the enclosed "notice of proposed action" form (sample letter 3) as a template to comply with this requirement. Before approving a cleanup proposal or site closure proposal, determining that no further action is required, or issuing a closure letter, the local agency will take all reasonable steps necessary to accommodate responsible landowner participation in the cleanup and site closure process and will consider all input and recommendations from any responsible landowner.

Please call me at (510) 567-6782 should you have any questions about the content of this letter.

Sincerely,

Thomas Peacock, Manager
Environmental Protection Division

Attachments

c: Chuck Headlee, RWQCB

LOP - CHANGE RECORD REQUEST FORM

printed:
06/04/99

Mark Out What Needs Changing and Hand to LOP Data Entry
(Name/Address changes go to Annual Programs Data Entry)

Insp:

AGENCY # : 10000 SOURCE OF FUNDS: F
 StID : 871 LOC: -0-
 SITE NAME: Chevron Products Co.
 ADDRESS : 5910 MacArthur Blvd
 CITY/ZIP : Oakland 94605

SUBSTANCE: 8006619
 DATE REPORTED : 06/18/97
 DATE CONFIRMED: 06/12/97
 MULTIPLE RPs : Y

SITE STATUS

CASE TYPE: W CONTRACT STATUS: 4 PRIOR CODE:1 EMERGENCY RESP: -0-
 RP SEARCH: S DATE COMPLETED: 06/25/97
 PRELIMINARY ASMNT: U DATE UNDERWAY: 05/21/97 DATE COMPLETED: 05/23/97
 REM INVESTIGATION: U DATE UNDERWAY: -0- DATE COMPLETED: -0-
 REMEDIAL ACTION: U DATE UNDERWAY: -0- DATE COMPLETED: -0-
 POST REMED ACT MON:- DATE UNDERWAY: -0- DATE COMPLETED: -0-

ENFORCEMENT ACTION TYPE: 1 DATE ENFORCEMENT ACTION TAKEN: 10/17/97
 LUFT FIELD MANUAL CONSID: 3
 CASE CLOSED: - DATE CASE CLOSED: -0-
 DATE EXCAVATION STARTED : -0- REMEDIAL ACTIONS TAKEN: -0-

RESPONSIBLE PARTY INFORMATION

RP#1-CONTACT NAME: Philip R. Briggs
 COMPANY NAME: Chevron Products Company
 ADDRESS: 6001 Bollinger Canyon Rd.
 CITY/STATE: San Ramon Ca 94583

RP#--CONTACT NAME: Nissan, Car. Saidian
 COMPANY NAME: Na-
 ADDRESS: 5733 Medallion Ct.
 CITY/STATE: Castro Valley, Ca 94552

INSPECTOR VERIFICATION:

NAME _____ SIGNATURE _____ DATE _____

DATA ENTRY INPUT:

Name/Address Changes Only

Case Progress Changes

ANNPGRMS _____ LOP _____ DATE _____

LOP _____ DATE _____

ALAMEDA COUNTY
HEALTH CARE SERVICES

AGENCY
DAVID J. KEARS, Agency Director



ENVIRONMENTAL HEALTH SERVICES
1131 Harbor Bay Parkway, Suite 250
Alameda, CA 94502-6577
(510) 567-6700
(510) 337-9335 (FAX)

January 15, 1999

STID 871

Phil Briggs
Chevron U S A Inc.
P. O. Box 5004
San Ramon, CA 94583-0904

re: Chevron Station, 5910 MacArthur Blvd., Oakland, CA 94605

Dear Mr. Briggs:

This office has received and reviewed a Quarterly Groundwater Monitoring Report dated October 15, 1998 by Gettler-Ryan Inc, with your cover letter dated October 30, 1998. The following comments concern this report:

1. The level of contamination in MW-2 is still very high, with MTBE levels of 1,300 ppb when tested using EPA 8260. Although the level declined from the previous quarter, this is not significant in relationship to the levels since 06/04/97 when it was at 2,100 ppb. Without a down gradient well it is not known what is happening to this contamination. Where is it going?
2. The workplan is acceptable. You say that implementation will begin upon regulatory approval. This should be within at least 60 days. Please call this office at least 3 days prior to implementation of the field portion of the workplan. I guess the previous approval crossed in the mail.

You may contact me at (510) 567-6782 if you have any questions regarding this letter.

Sincerely,

Thomas Peacock, Manager
Environmental Protection Division

c: Dick Pantages, Chief – Files-Tom
LeRoy Griffin, City Of Oakland Hazardous Materials

ALAMEDA COUNTY
HEALTH CARE SERVICES

AGENCY
DAVID J. KEARS, Agency Director



ENVIRONMENTAL HEALTH SERVICES

1131 Harbor Bay Parkway, Suite 250
Alameda, CA 94502-6577
(510) 567-6700
(510) 337-9335 (FAX)

November 12, 1998

STID 871

Phil Briggs
Chevron U S A Inc.
P. O. Box 5004
San Ramon, CA 94583-0904

re: Chevron Station, 5910 MacArthur Blvd., Oakland, CA 94605

Dear Mr. Briggs:

This office has received and reviewed a Quarterly Groundwater Monitoring Report dated July 31, 1998 by Gettler-Ryan Inc, with your cover letter, and a work plan dated August 25, 1998, also by Gettler-Ryan Inc. The following comments concern this report and the workplan:

1. The level of contamination in MW-2 is still very high, with MTBE levels of 4,000 ppb when tested using EPA 8260. Although the level declined from the previous quarter, this is not significant in relationship to the levels since 06/04/97 when it was at 2,100 ppb.
2. The workplan is acceptable. You say that implementation will begin upon regulatory approval. This should be within at least 60 days. Please call this office at least 3 days prior to implementation of the field portion of the workplan.

You may contact me at (510) 567-6782 if you have any questions regarding this letter.

Sincerely,

Thomas Peacock, Manager
Environmental Protection Division

c: **Dick Pantages, Chief - Files-Tom**
LeRoy Griffin, City Of Oakland Hazardous Materials

ENVIRONMENTAL
PROTECTION

98 NOV -4 PH12-18



Chevron

Chevron Products Company
6001 Bollinger Canyon Road
Building L, Room 1110
PO Box 6004
San Ramon, CA 94583-0904

Philip R. Briggs
Project Manager
Site Assessment & Remediation
Phone 925 842-9136
Fax 925 842-8370

October 30, 1998

Mr. Thomas Peacock, Manager
Alameda County Health Care Services
Division of Environmental Protection
1131 Harbor Bay Parkway, Suite 250
Alameda, CA 94502-6577

**Re: Chevron Service Station #9-9708
5910 MacArthur Blvd.
Oakland, California**

Dear Mr. Peacock:

Enclosed is the Third Quarter Groundwater Monitoring and Sampling Report for 1998 that was prepared by our consultant Gettler-Ryan Inc. for the above noted facility. The groundwater samples were analyzed for the presence of TPH-g, BTEX, MtBE and for TPH-d in monitoring well MW-3. All wells are sampled quarterly.

The benzene constituent increased in monitoring well MW-1 from the previous sampling event, while it decreased in well MW-2. In well MW-3 the TPH-g, BTEX and MtBE constituents were below method detection limits while the TPH-d (indicated as an unidentified hydrocarbon), was the same from the previous sampling event.

Depth to ground water varied from 12.22 feet to 14.29 feet below grade with a direction of flow southwesterly.

A work plan was recently submitted for the installation of an additional groundwater monitoring well to further delineate the lateral extent of MtBE in the groundwater beneath the site. Chevron is awaiting your concurrence to the work plan or if you have any questions, please contact me.

October 30, 1998
Mr. Thomas Peacock
Chevron Service Station #9-9708
Page 2

Chevron will continue monitor the site as noted above. If you have any questions call me at (925) 842-9136.

Sincerely,
CHEVRON PRODUCTS COMPANY



Philip R. Briggs
Site Assessment and Remediation Project Manager

Enclosure

Cc. Mr. Bill Scudder, Chevron

Mr. Yoginder Sethi
5910 MacArthur Blvd.
Oakland, CA 94605



GETTLER-RYAN INC.

ST10871
CTEJ
ENVIRONMENTAL
PROTECTION

98 AUG 25 PM 11:02

TRANSMITTAL

TO: Mr. Phil Briggs
Chevron Products Company
P. O. Box 6004
San Ramon, California 94583

DATE: August 25, 1998
PROJ. #: 346395.02
SUBJECT: Work Plan
Chevron Station #9-9708
5910 Mac Author Boulevard
Oakland, California

FROM:

Rick L. Fears, R.G.
Senior Geologist
Gettler-Ryan Inc.
3164 Gold Camp Drive, Suite 240
Rancho Cordova, California 95670

WE ARE SENDING YOU:

COPIES	DATED	DESCRIPTION
1	August 25, 1998	Work Plan For Well Installation

THESE ARE TRANSMITTED as checked below:

- For review and comment Approved as submitted Resubmit __ copies for approval
- As requested Approved as noted Submit __ copies for distribution
- For approval Return for corrections Return __ corrected prints
- For Your Files

COMMENTS:

At Chevron's request, Gettler-Ryan is sending you one copy of the above referenced Work Plan for your files. If you have any questions, please call me in our Sacramento office at (916) 631-1300.

cc: Thomas F. Peacock, Manager, Alameda County Health Care Services, Environmental Health Services, Environmental Protection Division, 1131 Harbor Bay Parkway, Suite 250, Alameda, California 94502

ENVIRONMENTAL
PROTECTION
AGENCY
EPC MS 10 AN 12-01



August 10, 1998

Chevron Products Company
6001 Bollinger Canyon Road
Building L, Room 1110
PO Box 6004
San Ramon, CA 94583-0904

Philip R. Briggs
Project Manager
Site Assessment & Remediation
Phone 925 842-9136
Fax 925 842-8370

Mr. Thomas Peacock, Manager
Alameda County Health Care Services
Division of Environmental Protection
1131 Harbor Bay Parkway, Suite 250
Alameda, CA 94502-6577

STC 871

Re: Chevron Service Station #9-9708
5910 MacArthur Blvd.
Oakland, California

Dear Mr. Peacock:

Enclosed is the Second Quarter Groundwater Monitoring and Sampling Report for 1998 that was prepared by our consultant Gettler-Ryan Inc. for the above noted facility. The groundwater samples were analyzed for the presence of TPH-g, BTEX, MtBE and for TPH-d in monitoring well MW-3. All wells are sampled quarterly.

The TPH-g and BTEX constituents were below method detection limits in monitoring well MW-1 while the MtBE constituent declined from the previous sampling event. In well MW-2 the MtBE concentration declined to 4,000 ppb (by EPA Method 8260) from the previous sampling concentration of 7,100 ppb. In well MW-3 the TPH-g, BTEX and MtBE constituents were below method detection limits while the TPH-d (indicated as an unidentified hydrocarbon), increased from the previous sampling event.

Depth to ground water varied from 11.60 feet to 12.93 feet below grade with a direction of flow westerly.

In response to your letter of June 26, 1998, Chevron will submit a work plan to define the lateral extent of the petroleum hydrocarbon plume downgradient of well MW-2. This work plan is expected to be submitted within the time frame given in your letter.



August 10, 1998
Mr. Thomas Peacock
Chevron Service Station #9-9708
Page 2

Chevron will continue monitor the site as noted above. If you have any questions call me at (925) 842-9136.

Sincerely,
CHEVRON PRODUCTS COMPANY



Philip R. Briggs
Site Assessment and Remediation Project Manager

Enclosure

Cc. Mr. Bill Scudder, Chevron

Mr. Yoginder Sethi
5910 MacArthur Blvd.
Oakland, CA 94605

ALAMEDA COUNTY
HEALTH CARE SERVICES

AGENCY
DAVID J. KEARS, Agency Director



ENVIRONMENTAL HEALTH SERVICES

1131 Harbor Bay Parkway, Suite 250
Alameda, CA 94502-6577
(510) 567-6700
(510) 337-9335 (FAX)

June 26, 1998

STID 871

Phil Briggs
Chevron U S A Inc.
P. O. Box 5004
San Ramon, CA 94583-0904

re: Chevron Station, 5910 MacArthur Blvd., Oakland, CA 94605

Dear Mr. Briggs:

This office has received and reviewed a Quarterly Groundwater Monitoring Report dated April 22, 1998 by Gettler-Ryan Inc. The following comments concern this report:

1. The level of contamination in MW-2 is very high, with MTBE levels of 7,100 ppb when tested using EPA 8260. This well is downgradient of the dispenser islands and also is the downgradient well on the site.
2. This situation requires further investigation in the downgradient direction to assess the lateral extent of contamination. You are required to submit a workplan for further investigation within 60 days

You may contact me at (510) 567-6782 if you have any questions regarding this letter.

Sincerely,

Thomas Peacock, Manager
Environmental Protection Division

c: Dick Pantages, Chief → ~~Files-Tom~~
LeRoy Griffin, City Of Oakland Hazardous Materials

ENVIRONMENTAL
PROTECTION

98 MAY -5 PM 2:35



*ST10 871
PE*
Chevron

May 1, 1998

Mr. Thomas Peacock, Manager
Alameda County Health Care Services
Division of Environmental Protection
1131 Harbor Bay Parkway, Suite 250
Alameda, CA 94502-6577

Chevron Products Company
6001 Bollinger Canyon Road
Building L
San Ramon, CA 94583
P.O. Box 6004
San Ramon, CA 94583-0904

Marketing - Sales West
Phone 510 842-9500

**Re: Chevron Service Station #9-9708
5910 MacArthur Blvd.
Oakland, California**

Dear Mr. Peacock:

Enclosed is the First Quarter Groundwater Monitoring and Sampling Report for 1998 that was prepared by our consultant Gettler-Ryan Inc. for the above noted facility. The groundwater samples were analyzed for the presence of TPH-g, BTEX, MtBE and for TPH-d in monitoring well MW-3. All wells are sampled quarterly.

The benzene constituent decreased in monitoring well MW-2 while slightly increasing in well MW-1 from the previous sampling event. In well MW-3 the TPH-g, BTEX and MtBE constituents were below the method detection limits while the unidentified hydrocarbons (by TPH-d), decreased from the previous sampling event.

Depth to ground water varied from 10.88 feet to 12.70 feet below grade with a direction of flow northwesterly.

Chevron will continue monitor the site as noted above. If you have any questions call me at (510) 842-9136.

Sincerely,
CHEVRON PRODUCTS COMPANY

A handwritten signature in dark ink, appearing to read "Philip R. Briggs".

Philip R. Briggs
Site Assessment and Remediation Project Manager

May 1, 1998
Mr. Thomas Peacock
Chevron Service Station #9-8431
Page 2

Enclosure

Cc. Mr. Bill Scudder, Chevron

Mr. Yoginder Sethi
5910 MacArthur Blvd.
Oakland, CA 94605



Chevron

PE
STP
821

98 FEB -3 AM 9: 61

Chevron Products Company
P.O. Box 6004
San Ramon, CA 94583

January 30, 1998

Mr. Thomas Peacock
Alameda County Health Care Services
Department of Environmental Health
1131 Harbor Bay Parkway, Suite 250
Alameda, CA 94502-6577

Re: Chevron Service Station #9-9708
5910 MacArthur Blvd.
Oakland, California 94609

Dear Mr. Peacock:

Enclosed is the Fourth Quarter Groundwater Monitoring and Sampling Report for 1997 that was prepared by our consultant Gettler-Ryan Inc. for the above noted facility. The groundwater samples were analyzed for the presence of TPH-g, BTEX, MtBE and for TPH-d in monitoring well MW-3. All wells will be sampled quarterly.

Monitoring well MW-1 showed a decrease in the benzene constituent from the previous sampling event while well MW-2 showed an increase. Well MW-3 showed a slight presence of the benzene and toluene constituents and the presence of unidentified hydrocarbons when sampling for TPH-d.

Depth to ground water varied from 10.80 feet to 12.18 feet below grade with a direction of flow northwesterly.

Chevron will continue monitor the site quarterly. If you have any questions call me at (510) 842-9136.

Sincerely,
CHEVRON PRODUCTS COMPANY

Philip R. Briggs
Site Assessment and Remediation Project Manager

Enclosure

cc. Mr. Bill Scudder, Chevron

Mr. Yoginder Sethi
5910 MacArthur Blvd.
Oakland, CA 94605 (Report sent separately)



ST10 871
PE

ENVIRONMENTAL
PROTECTION



Chevron

97 OCT 28 PM 3: 35

October 24, 1997

Mr. Thomas Peacock
Manager, Environmental Protection Division
Alameda County Health Care Services
Department of Environmental Health
1131 Harbor Bay Parkway, Suite 250
Alameda, CA 94502-6577

Chevron Products Company
6001 Bollinger Canyon Road
Building L
San Ramon, CA 94583
P.O. Box 6004
San Ramon, CA 94583-0904

Marketing - Sales West
Phone 510 842-9500

**Re: Chevron Service Station #9-9708
5910 MacArthur Blvd.
Oakland, California**

Dear Mr. Peacock:

Enclosed is the Third Quarter Groundwater Monitoring and Sampling Report for 1997 that was prepared by our consultant Gettler-Ryan Inc. for the above noted facility. The groundwater samples were analyzed for the presence of TPH-g, BTEX, MtBE and for TPH-d in monitoring well MW-3. All wells will be sampled quarterly.

This is the first sampling event after groundwater monitoring wells were installed to determine if the site had been impacted petroleum hydrocarbons. This investigation was initiated due to the proposed sale of the property and the facilities. Refer to the report of this investigation under Chevron's cover letter dated July 1, 1997, addressed to Juliet Shin of your office.

Monitoring well MW-1 showed an increase in the benzene constituent while well MW-2 showed a decrease from the initial investigation. No TPH-g, BTEX and MtBE constituents were detected in monitoring well MW-3. Well MW-3 did detect the presence of the TPH-d constituent but accordingly to the chromatographic data, it indicates the presence of material which is heavier than diesel fuel.

Depth to ground water varied from 12.19 feet to 12.99 feet below grade with a direction of flow westerly.

Chevron will continue monitor the site quarterly. If you have any questions call me at (510) 842-9136.

Sincerely,
CHEVRON PRODUCTS COMPANY

Philip R. Briggs
Site Assessment and Remediation Project Manager

Enclosure

October 24, 1997
Mr. Thomas Peacock
Chevron Service Station # 9-9708
Page 2

cc. Mr. Bill Scudder, Chevron

Mr. Kevin Graves
RWQCB-San Francisco Bay Region
2101 Webster Street, Suite 500
Oakland, CA 94612

Mr. Yoginder Sethi
5910 MacArthur Blvd.
Oakland, CA 94605



Chevron

July 1, 1997

Ms. Juliet Shin
Alameda County Health Care Services
Department of Environmental Health
1131 Harbor Bay Parkway, Suite 250
Alameda, CA 94502-6577

Chevron Products Company
6001 Bollinger Canyon Road
Building L
San Ramon, CA 94583
P.O. Box 6004
San Ramon, CA 94583-0904

Marketing - Sales West
Phone 510 842 9500

Re: **Chevron Service Station #9-9708**
5910 MacArthur Blvd.
Oakland, California

Dear Ms. Shin:

Enclosed is the Subsurface Investigation Report that was prepared by our consultant Gettler-Ryan Inc. for the above noted facility. This work was initiated due to the proposed sale of the property/facilities and to evaluate whether the soil and ground water beneath the site had been impacted by petroleum hydrocarbons.

To determine this evaluation, three borings were installed at the site and were drilled to a final depth of 41.5 with soil samples collected every 5 feet. Two moist sandy gravel lenses were detected but no free ground water was encountered. The borings were left open for 24 hours but no ground water accumulated. The wells were then backfilled with bentonite to 20 feet and a 2 inch monitoring well was installed in each boring. There were other wells located near this site that indicated the presence of ground water at a shallow depth. After a period of six days ground water was observed in all wells.

The wells were developed and ground water samples were collected and analyzed for TPH-g, BTEX and MtBE constituents. In addition, well MW-3 that was drilled next to the former waste oil tank was also analyzed for TPH-d, TOG, VOs and SVOs. The soil samples were analyzed for TPH-g, BTEX and MtBE constituents, while MW-3 was also analyzed for TPH-d, TOG, VOs, SVOs and selected metals.

Soil samples from 21 feet to 41 feet were analyzed only for TPH-g, BTEX and MtBE constituents and the results were below method detection limits for all constituents. The highest concentration of benzene detected in the soil was 0.0270 ppm in well MW-1 at the 15.5 foot level. The soil sample from well MW-3 only detected concentrations of TOG, VOs, and selected metals.

The TPH-g, BTEX and MtBE constituents were only detected in monitoring wells MW-1 and MW-2. Well MW-3 only detected the presence of TPH-d and one analyte of VOs. The highest benzene concentration was detected in MW-2 at 120 ppb.

It appears that the soil beneath the site has been minimally impacted from petroleum hydrocarbons only at depths between 11 feet to 16 feet below grade. The ground water has also been minimally impacted from dissolved hydrocarbons. Therefore, Chevron proposes to perform quarterly ground water monitoring for at least one year to determine water gradient and the concentration of the constituents in this time frame. Note that the tank and piping systems were tested in April 1997 and they tested tight.

97 JUL -2 PM 2:18
C:\PAC\1105\AL



July 1, 1997
Ms. Juliet Shin
Chevron Service Station # 9-9708
Page 2

Sincerely,
CHEVRON PRODUCTS COMPANY



Philip R. Briggs
Site Assessment and Remediation Project Manager

Enclosure

cc. Mr. Bill Scudder, Chevron

Mr. Kevin Graves
RWQCB-San Francisco Bay Region
2101 Webster Street, Suite 500
Oakland, CA 94612

Mr. Yoginder Sethi
5910 MacArthur Blvd.
Oakland, CA 94605 (Report sent separately)

UNDERGROUND STORAGE TANK UNAUTHORIZED RELEASE (LEAK) / CONTAMINATION SITE REPORT

EMERGENCY <input type="checkbox"/> YES <input checked="" type="checkbox"/> NO	HAS STATE OFFICE OF EMERGENCY SERVICES REPORT BEEN FILED? <input type="checkbox"/> YES <input type="checkbox"/> NO	FOR LOCAL AGENCY USE ONLY I HEREBY CERTIFY THAT I HAVE DISTRIBUTED THIS INFORMATION ACCORDING TO THE DISTRIBUTION SHOWN ON THE INSTRUCTION SHEET ON THE BACK PAGE OF THIS FORM. Signed: <u>Camela J Evans</u> DATE: <u>9-17-97</u>
REPORT DATE: <u>06/18/97</u>	CASE #	

REPORTED BY	NAME OF INDIVIDUAL FILING REPORT <u>PHILIP R BRIGGS</u>	PHONE <u>(510) 842-9136</u>	SIGNATURE <u>Philip R Briggs</u>	
	REPRESENTING <input type="checkbox"/> LOCAL AGENCY <input checked="" type="checkbox"/> OWNER/OPERATOR <input type="checkbox"/> REGIONAL BOARD <input type="checkbox"/> OTHER	COMPANY OR AGENCY NAME <u>CHEVRON PRODUCTS COMPANY</u>		
	ADDRESS <u>6001 POLLINGER CANYON ROAD SAN RAMON CA 94583</u>			

RESPONSIBLE PARTY	NAME <u>CHEVRON PRODUCTS CO</u> <input type="checkbox"/> UNKNOWN	CONTACT PERSON <u>PHILIP R BRIGGS</u>	PHONE <u>(510) 842-9136</u>
	ADDRESS <u>6001 POLLINGER CANYON RD SAN RAMON CA 94583</u>		

SITE LOCATION	FACILITY NAME (IF APPLICABLE) <u>CHEVRON SERVICE STATION</u>	OPERATOR <u>YOGI SETHI</u>	PHONE <u>(510) 569-0237</u>	
	ADDRESS <u>5910 MAC ARTHUR BLVD OAKLAND CA 94605</u>			
	CROSS STREET <u>SEMINARY AVENUE</u>			

IMPLEMENTING AGENCIES	LOCAL AGENCY AGENCY NAME <u>ALAMEDA COUNTY HEALTH CARE SERVICES</u>	CONTACT PERSON <u>EVA GANJULIET SHIN</u>	PHONE <u>(510) 567-6763</u>
	REGIONAL BOARD <u>RWQCB - SAN FRANCISCO</u>		PHONE <u>(510) 286-0435</u>

SUBSTANCES INVOLVED	(1) NAME <u>GASOLINE</u>	QUANTITY LOST (GALLONS) <input checked="" type="checkbox"/> UNKNOWN
	(2)	<input type="checkbox"/> UNKNOWN

DISCOVERY/ABATEMENT	DATE DISCOVERED <u>06/18/97</u>	HOW DISCOVERED <input type="checkbox"/> INVENTORY CONTROL <input checked="" type="checkbox"/> SUBSURFACE MONITORING <input type="checkbox"/> TANK TEST <input type="checkbox"/> TANK REMOVAL <input type="checkbox"/> NUISANCE CONDITIONS <input type="checkbox"/> OTHER
	DATE DISCHARGE BEGAN <input checked="" type="checkbox"/> UNKNOWN	METHOD USED TO STOP DISCHARGE (CHECK ALL THAT APPLY) <input type="checkbox"/> REMOVE CONTENTS <input type="checkbox"/> CLOSE TANK & REMOVE <input type="checkbox"/> REPAIR PIPING <input type="checkbox"/> REPAIR TANK <input type="checkbox"/> CLOSE TANK & FILL IN PLACE <input type="checkbox"/> CHANGE PROCEDURE <input type="checkbox"/> REPLACE TANK <input checked="" type="checkbox"/> OTHER <u>UNKNOWN WHERE LEAK HAS OCCURRED</u>
	HAS DISCHARGE BEEN STOPPED? <input type="checkbox"/> YES <input type="checkbox"/> NO IF YES, DATE <u>UNKNOWN (SEE COMMENTS)</u>	

SOURCE/CAUSE	SOURCE OF DISCHARGE <input type="checkbox"/> TANK LEAK <input checked="" type="checkbox"/> UNKNOWN <input type="checkbox"/> PIPING LEAK <input type="checkbox"/> OTHER	CAUSE(S) <input type="checkbox"/> OVERFILL <input type="checkbox"/> RUPTURE/FAILURE <input type="checkbox"/> SPILL <input type="checkbox"/> CORROSION <input checked="" type="checkbox"/> UNKNOWN <input type="checkbox"/> OTHER
--------------	---	--

CASE TYPE	CHECK ONE ONLY <input type="checkbox"/> UNDETERMINED <input type="checkbox"/> SOIL ONLY <input checked="" type="checkbox"/> GROUNDWATER <input type="checkbox"/> DRINKING WATER - (CHECK ONLY IF WATER WELLS HAVE ACTUALLY BEEN AFFECTED)
-----------	--

CURRENT STATUS	CHECK ONE ONLY <input type="checkbox"/> NO ACTION TAKEN <input checked="" type="checkbox"/> PRELIMINARY SITE ASSESSMENT WORKPLAN SUBMITTED <input checked="" type="checkbox"/> POLLUTION CHARACTERIZATION <input type="checkbox"/> LEAK BEING CONFIRMED <input checked="" type="checkbox"/> PRELIMINARY SITE ASSESSMENT UNDERWAY <input type="checkbox"/> POST CLEANUP MONITORING IN PROGRESS <input type="checkbox"/> REMEDIATION PLAN <input type="checkbox"/> CASE CLOSED (CLEANUP COMPLETED OR UNNECESSARY) <input type="checkbox"/> CLEANUP UNDERWAY
----------------	--

REMEDIAL ACTION	CHECK APPROPRIATE ACTION(S) (SEE BACK FOR DETAILS) <input type="checkbox"/> EXCAVATE & DISPOSE (ED) <input type="checkbox"/> REMOVE FREE PRODUCT (FP) <input type="checkbox"/> ENHANCED BIO DEGRADATION (IT) <input type="checkbox"/> CAP SITE (CD) <input type="checkbox"/> EXCAVATE & TREAT (ET) <input type="checkbox"/> PUMP & TREAT GROUNDWATER (GT) <input type="checkbox"/> REPLACE SUPPLY (RS) <input type="checkbox"/> CONTAINMENT BARRIER (CB) <input type="checkbox"/> NO ACTION REQUIRED (NA) <input type="checkbox"/> TREATMENT AT HOOKUP (HU) <input type="checkbox"/> VENT SOIL (VS) <input type="checkbox"/> VACUUM EXTRACT (VE) <input checked="" type="checkbox"/> OTHER (OT) <u>MONITOR QUARTERLY - NEW DUMPER TO INSTALL OVERSPILL PROTECTION IN 1998</u>
-----------------	---

COMMENTS: AS REPORTED TO EVA ON 6-18-97, CHEVRON IS PROPOSING TO SALE FACILITIES AND PERFORMED A BASELINE INVESTIGATION OF THE SITE TO DETERMINE ANY ENVIRONMENTAL PROBLEMS. GROUNDWATER MONITORING WELLS WERE INSTALLED AND DISSOLVED PETROLEUM HYDROCARBONS WERE DETECTED. CHEVRON WILL SUBMIT ASSESSMENT REPORT AND INSTITUTE QUARTERLY GROUNDWATER MONITORING. TANKS/PIPING HAVE BEEN TESTED AND TESTED TIGHT.

P 368 729 408
STID #'S 871 & 3961
US Postal Service

Receipt for Certified Mail

No Insurance Coverage Provided.
Do not use for International Mail (See reverse)

Sent to	
Phillip Briggs	
Street & Number	
Chevron Products	
6000 Holsinger Canyon Rd	
San Ramon, CA 94583	
Postage	\$
Certified Fee	
Special Delivery Fee	
Restricted Delivery Fee	
Return Receipt Showing to Whom & Date Delivered	
Return Receipt Showing to Whom, Date, & Addressee's Address	
TOTAL Postage & Fees	\$
Postmark or Date	

PS Form 3800 April 1995