



**CONESTOGA-ROVERS
& ASSOCIATES**

5900 Hollis Street, Suite A
Emeryville, California 94608
Telephone: (510) 420-0700 Fax: (510) 420-9170
www.CRAworld.com

TRANSMITTAL

DATE: July 9, 2014 REFERENCE NO.: 240366

PROJECT NAME: 999 San Pablo Avenue, Albany

TO: Jerry Wickham
Alameda County Environmental Health
1131 Harbor Bay Parkway, Suite 250
Alameda, California 94502-6577

RECEIVED

By Alameda County Environmental Health at 9:51 am, Jul 11, 2014

Please find enclosed: Draft Final
 Originals Other
 Prints

Sent via: Mail Same Day Courier
 Overnight Courier Other GeoTracker and Alameda County FTP

QUANTITY	DESCRIPTION
1	Well Destruction Report

As Requested For Review and Comment
 For Your Use _____

COMMENTS:

If you have any questions regarding the content of this document, please call the CRA project manager Peter Schaefer at (510) 420-3319 or the Shell program manager Perry Pineda at (425) 413-1164.

Copy to: Perry Pineda, Shell Oil Products US (electronic copy)
Betty Patton Trust and Mary Biggs Trust (property owner), Douglas Patton, 5314 Proctor Avenue, Oakland, CA 94618-2732
Betty Patton Trust and Mary Biggs Trust (property owner), Gregg Biggs, 3640 Valley Road, Casper, WY 82604-4982

Completed by: Peter Schaefer Signed: *Peter Schaefer*

Filing: Correspondence File



Mr. Jerry Wickham
Alameda County Environmental Health
1131 Harbor Bay Parkway, Suite 250
Alameda, California 94502-6577

Shell Oil Products US
Soil and Groundwater Focus Delivery Group
20945 S. Wilmington Avenue
Carson, CA 90810
Tel (425) 413 1164
Fax (425) 413 0988
Email perry.pineda@shell.com
Internet <http://www.shell.com>

Re: 999 San Pablo Avenue
Albany, California
SAP Code 135037
Incident No. 98995143
ACEH Case No. RO0000121

Dear Mr. Wickham:

The attached document is provided for your review and comment. Upon information and belief, I declare, under penalty of perjury, that the information contained in the attached document is true and correct.

As always, please feel free to contact me directly at (425) 413-1164 with any questions or concerns.

Sincerely,
Shell Oil Products US

A handwritten signature in black ink, appearing to read "Perry Pineda", is located below the typed name.

Perry Pineda
Senior Environmental Program Manager



WELL DESTRUCTION REPORT

**SHELL-BRANDED SERVICE STATION
999 SAN PABLO AVENUE
ALBANY, CALIFORNIA**

**SAP CODE 135037
INCIDENT NO. 98995143
AGENCY NO. RO0000121**

JULY 9, 2014
REF. NO. 240366 (17)
This report is printed on recycled paper.

**Prepared by:
Conestoga-Rovers
& Associates**

5900 Hollis Street, Suite A
Emeryville, California
U.S.A. 94608

Office: (510) 420-0700
Fax: (510) 420-9170

web: <http://www.CRAworld.com>

TABLE OF CONTENTS

	<u>Page</u>
1.0 INTRODUCTION	1
2.0 WELL DESTRUCTIONS	1
2.1 FIELD DATES	1
2.2 PERSONNEL PRESENT	1
2.3 DESTRUCTION METHOD	1
2.4 WASTE DISPOSAL	1

LIST OF FIGURES
(Following Text)

FIGURE 1 VICINITY MAP

FIGURE 2 SITE PLAN

LIST OF APPENDICES

APPENDIX A PERMITS

APPENDIX B WASTE MANIFEST

1.0 INTRODUCTION

Conestoga-Rovers & Associates (CRA) prepared this report on behalf of Equilon Enterprises LLC dba Shell Oil Products US (Shell) to document the recent well destructions at the referenced site.

The wells were properly destroyed to facilitate case closure as requested by Alameda County Environmental Health in their March 13, 2014 letter.

2.0 WELL DESTRUCTIONS

2.1 FIELD DATES

May 20 and 21, 2014.

2.2 PERSONNEL PRESENT

Geologist Katherine Ward directed the well destructions under the supervision of California Professional Geologist Peter Schaefer.

2.3 DESTRUCTION METHOD

After removing the well boxes, wells S-1 through S-4, S-6 through S-9, and RW-1 through RW-3 were destroyed by pressure grouting. Copies of the Alameda County Public Works Agency well destruction permit and City of Albany and Caltrans encroachment permits are included in Appendix A.

2.4 WASTE DISPOSAL

A separate-phase hydrocarbon absorbent sock was removed from well S-8 prior to well destruction. The sock was temporarily stored on site in a 55-gallon drum and profiled for disposal. On May 27, 2014, the drum was transported to Clean Harbors Aragonite, LLC Service Granville, Utah facility for disposal as hazardous waste. The waste manifest is included in Appendix B.

All of Which is Respectfully Submitted,
CONESTOGA-ROVERS & ASSOCIATES



Peter Schaefer, CEG, CHG



Aubrey K. Cool, PG



FIGURES

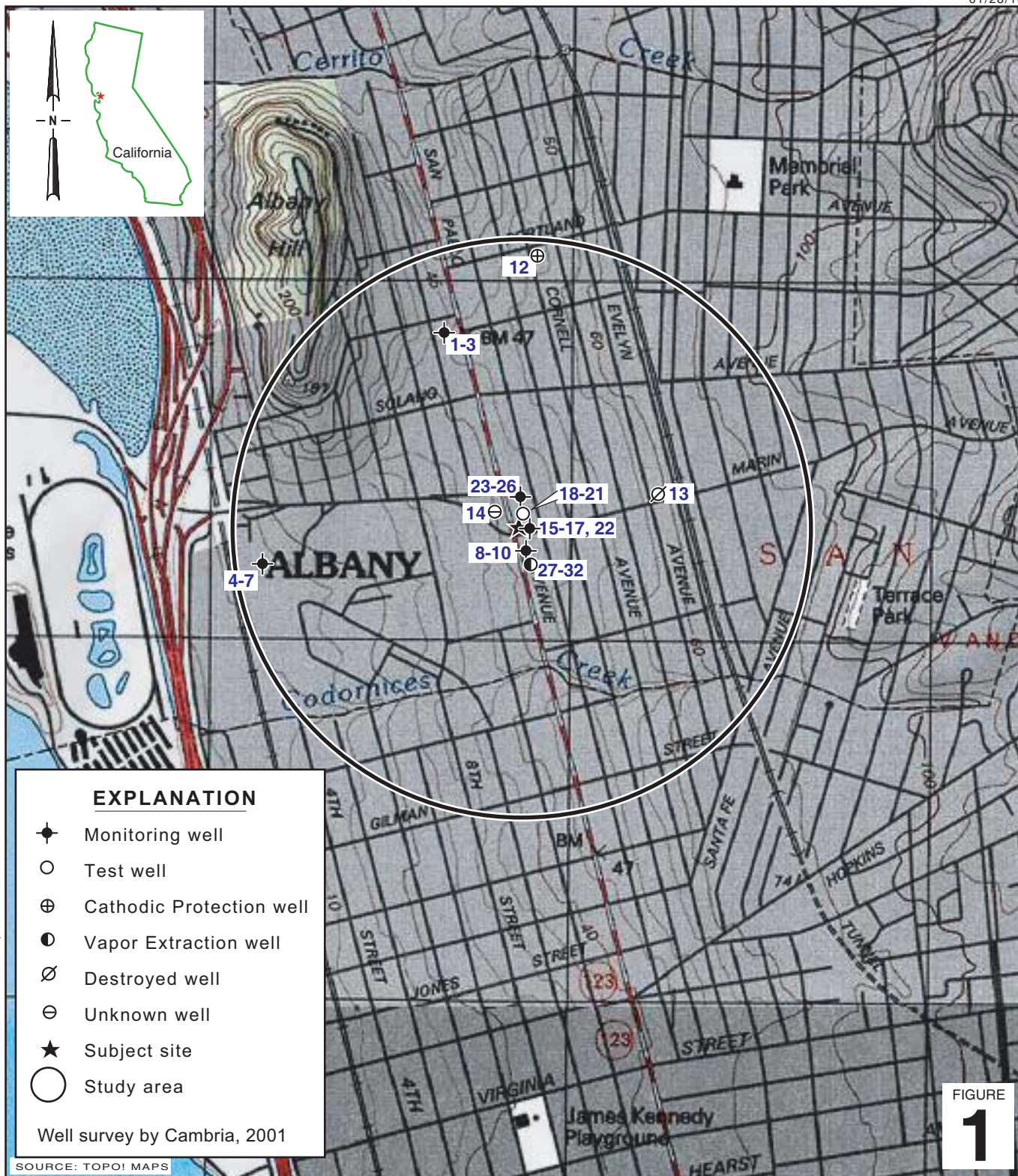

I:\Shell\6-chars\2403--\240366-Albany_999 San Pablo Ave\240366-FIGURES\240366 VICINITY.A1

FIGURE 1

Shell-branded Service Station
999 San Pablo Avenue
Albany, California



CONESTOGA-ROVERS & ASSOCIATES

Vicinity Map



EXPLANATION

- S-1 ☒ Destroyed monitoring well location (Shell)
- RW-1 ◆ Destroyed recovery well location (Shell)
- SB-1 ● Soil boring location (1990)
- D-1 • Dispenser soil sample location (2007)
- P-1 ○ Pipeline soil sample location (1996)
- D-1 ▲ Dispenser soil sample location (1996)
- V-1 ◆ Ventline soil sample location (1996)
- E-1 ■ Excavation soil sample location (1996)
- NE ▲ Trench soil sample location (1996)

I:\Shell\6-chars\2403-240366-Albany 999 San Pablo Ave\240366-FIGURES\240366 SITE PLAN (ON-SITE).DWG

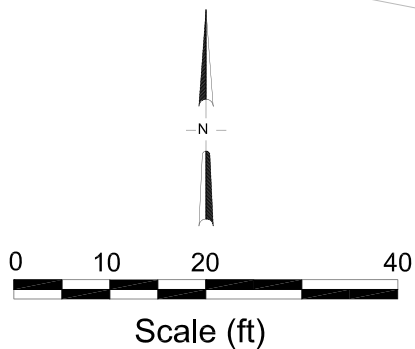
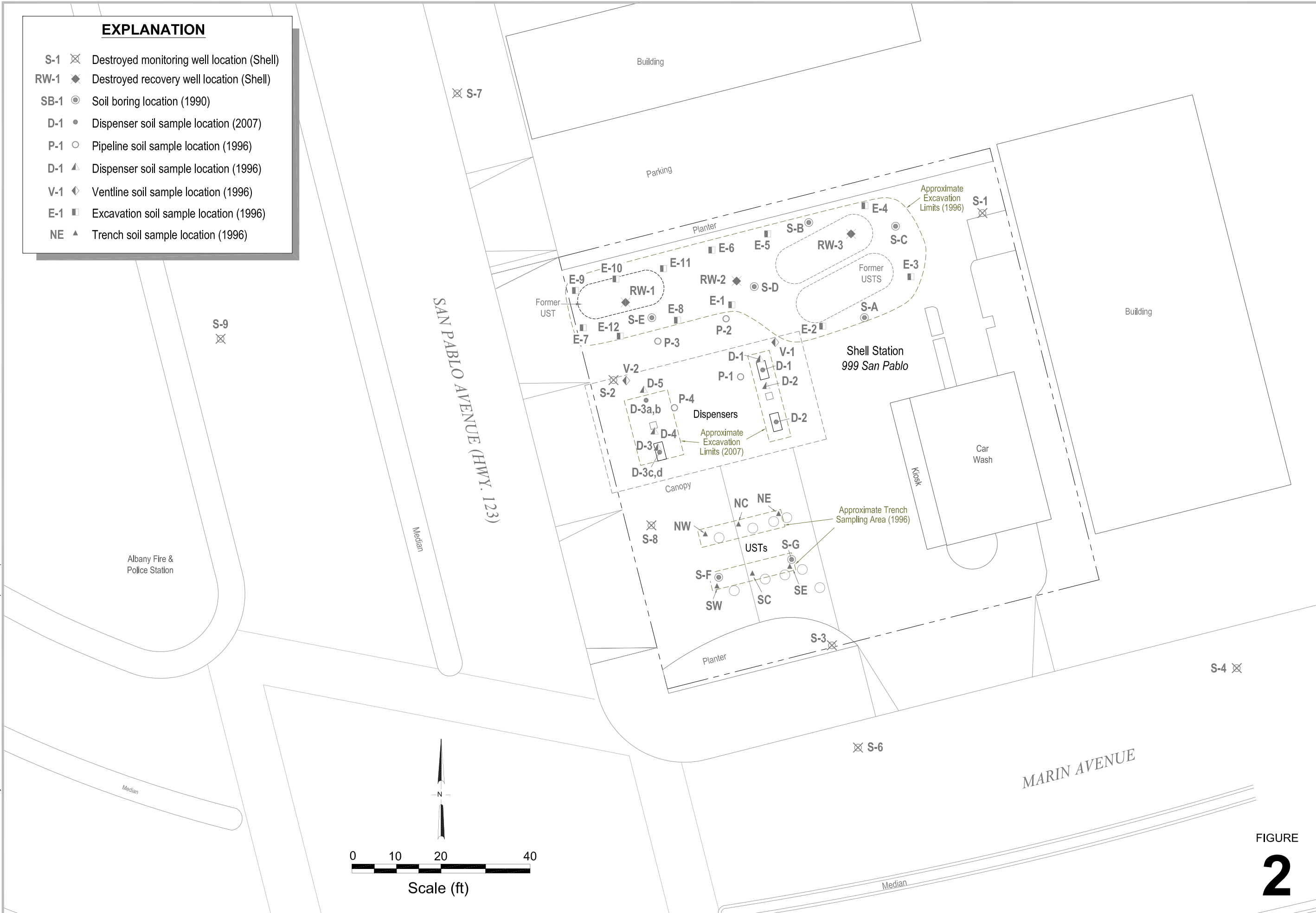

FIGURE
2

APPENDIX A

PERMITS

STATE OF CALIFORNIA • DEPARTMENT OF TRANSPORTATION
ENCROACHMENT PERMIT

TR-0120 (REV 6/2012)

Permit No. 0414-6MW 0739	
Dist/Co/Rte/PM 04-ALA-123 4.459/4.464	
DATE May 5, 2014	
Fee Paid \$ 492.00	Deposit \$
Performance Bond Amount \$	Payment Bond Amount \$
Bond Company	
Bond Number (1)	Bond Number (2)

In compliance with (Check one):

- Your application of April 16, 2014
- Utility Notice No. _____ of _____
- Agreement No. _____ of _____
- R/W Contract No. _____ of _____

TO: Shell Oil Products, LLC
 c/o Conestoga-Rovers & Associate
 5900 Hollis Street, Suite A
 Emeryville, CA 94608

Attn: Patrick O'Connell
 Phone: (510) 681-6142

PERMITTEE

and subject to the following, PERMISSION IS HEREBY GRANTED to:

Perform the following work for "Shell Oil Product, LLC," to decommission monitoring wells, S-7 and S-9, as required by the Alameda County Environmental Health Agency; located on San Pablo Avenue, north of Marin Avenue, on State Highway 04-ALA-123, Post Mile 4.459/4.464, in the City of Albany.

A minimum of one week prior to start of work under this permit, notice shall be given to, and approval of construction details, operations, public safety, and traffic control shall be obtained from State representative Sunny Mantravadi, Telephone number (510) 715-9573, between 7:30 AM and 4:00 PM. Monday- Friday.

All permitted work requires the permittee to apply for and obtain a work authorization number prior to start of work. See the attached "Encroachment Permit Project Work Scheduling Procedures" and the attached "Permit Project Work Scheduling Request Form". Additional time beyond the minimum seven days advanced notice required in the above paragraph may be required for obtaining the traffic control approval.

THIS PERMIT IS NOT A PROPERTY RIGHT AND DOES NOT TRANSFER WITH THE PROPERTY TO A NEW OWNER.

The following attachments are also included as part of this permit (Check applicable): <input checked="" type="checkbox"/> Yes <input type="checkbox"/> No General Provisions (TR-0045) <input type="checkbox"/> Yes <input checked="" type="checkbox"/> No Utility & Tree Trimming Provisions (03/2013) <input checked="" type="checkbox"/> Yes <input type="checkbox"/> No Storm Water Special Provisions (TR-0400) <input type="checkbox"/> Yes <input checked="" type="checkbox"/> No A Cal-OSHA permit, if required: Permit No. <input type="checkbox"/> Yes <input checked="" type="checkbox"/> No As-Built Plans Submittal Route Slip for Locally Advertised Projects <input type="checkbox"/> Yes <input checked="" type="checkbox"/> No Storm Water Pollution Prevention Plan	In addition to fee, the permittee will be billed actual costs for: <input type="checkbox"/> Yes <input checked="" type="checkbox"/> No Review <input checked="" type="checkbox"/> Yes <input type="checkbox"/> No Inspection <input checked="" type="checkbox"/> Yes ----- Field Work <i>(If any Caltrans effort expended)</i>
--	--

Yes No The information in the environmental documentation has been reviewed and considered prior to approval of this permit.

This permit is void unless the work is completed before April 30, 2015

This permit is to be strictly construed and no other work other than specifically mentioned is hereby authorized. No project work shall be commenced until all other necessary permits and environmental clearances have been obtained.

DC
 CC: Permit: S. Mantravadi
 Maint: B. Kimball
 DTM: S. Torchia
 TMC: J. Richardson, D4TMC/D04/Caltrans/CAGov
 Local: City of Albany;
 ACHCSA: Jerry Wickham, jerry.wickham@acgov.org
 File:

APPROVED:
BIJAN SARTIPI, District Director, District 4
 BY: 
DAVID SALLADAY, District Permit Engineer

ADA Notice For individuals with sensory disabilities, this document is available in alternate formats. For information call (916) 654-6410 or TDD (916) 654-3880 or write Records and Forms Management, 1120 N Street, MS-89, Sacramento, CA 95814.

ADDITIONAL GENERAL SPECIAL PROVISIONS:

All personnel shall wear appropriate personal protective equipment, including hard hats and bright colored vest, shirts, or jackets with retro-reflective material while on State Right-of-Way.

Caltrans is not subscribed to Underground Services Alert (USA). Caltrans may have existing electrical, signal and communication facilities within 9" from the surface. Permittee shall identify all existing underground facilities prior to perform trenching or boring and also repair/replace any damaged Caltrans facility due to their operation.

The Permittee shall make appropriate arrangement with a licensed vendor and California Highway Patrol (CHP) or a local Traffic Control Officers for traffic control and management, at Permittee's expense, in accordance with the approved traffic control plan.

The Permittee or the Contractor shall notify the State representative and submit an Encroachment Permit Work Scheduling Request Form 7days prior to the scheduled work activities.

Before any work is begun which will interrupt the normal flow of public traffic, approval shall be obtained from State representative.

No vehicle or equipment shall be stored overnight within the right-of-way; it shall be removed immediately at the completion of the project.

Permittee shall be responsible for the collection and removal of trash or garbage generated by these construction activities.

All debris shall be removed from the right of way and the area left in a safe and presentable condition at the end of each presentable day.

Any damage to existing State's facilities shall be repaired or replaced in kind by the Permittee at Permittee's expense.

Suitable barricades, signs and lights, as approved by State representative, to warn and protect traffic effectively shall enclose the site of the work.

Permittee shall provide safe pedestrian and bicycle passage around construction area.

All traffic signs to comply with 2012 MUTCD Section, 6F.01 through Section 6F.04. The signs shall have orange background. The Link: http://www.dot.ca.gov/hq/traffops/signtech/mutcdsupp/ca_mutcd2012.htm

Provide one 12' minimum width thru traffic lane in each direction of travel within State Right-of-Way, to accommodate all traffic movements, Monday-Friday between 9:00 AM – 3:00 PM. No lane closure permitted any other time. Holidays excluded.

Shoulder and /or parking (if applicable) may be closed while work is actively in progress.

When approved, the traffic control performed under this permit shall be in accordance the appropriate State Standard 2010, Plans RSP T11. Where required by the plan, the use of flashing arrow board is MANDATORY. Use of flagman is required.

Provide access to and from Ramps at all times. No ramp closure necessary or permitted.

No ingress or egress from the freeway to the worksite is permitted. Access to the work site for construction and any future maintenance activities shall be performed on local road.

Permittee and the Contractor shall check with the City of Albany within their jurisdiction for conflict in closure schedule, and cooperate and coordinate with all other construction work activities in that vicinity.

If an accident or other incident (related to or not related to the permitted activity) occurs within, or close to the permitted activity, the Permittee shall immediately stop work and remove traffic controls from the highway unless public health, welfare and safety is endangered by unfinished work. Only traffic control to protect open excavations may remain in place. After free traffic flow is restored, work in accordance with the conditions of the permit may be returned.

Any damage to existing facilities, landscaping or irrigation within the State Right-of-Way shall be replaced in kind by the Permittee at Permittee's expense. Any damaged concrete sidewalk shall be replaced from score-line to score-line and shall be ADA Compliant.

No excavation shall be left open overnight without written permission from the Caltrans representative or unless otherwise specified herein.

Residue from saw cutting, coring and grinding operation shall be picked up by vacuum device. Residue shall not be allowed to flow across the pavement and shall not be left on the surface of the pavement.

Vacuumed slurry residue shall be disposed in accordance with, "Solid Waste Management" and "Storm Water Special Provisions for Minimal or No Impact."

Permittee shall remove and dispose of all spoils outside of State Right-of-Way. Permittee shall provide records of all the sites of disposal facilities to State representative.

Curbs and gutters shall be installed over 6" of Class II Aggregate Base. Sidewalks shall be placed over 4" of Class II Aggregate Base.

Where there are potential Caltrans electrical facilities (lighting, signal, metering, etc) exist on the project site and not shown on the plans, the Permittee shall be responsible to resolve any conflicts and changes during construction. The Permittee shall incur any additional cost when there are changes to the original plans.

Permitter reserves the right to impose any additional requirements or conditions, including considerations, for the use of its right of way, if such requirements or conditions are allowed by future legislation, administrative determination, and/or court decisions.

The Permittee is responsible for any contaminated material and/or groundwater, which are generated due to excavation under this permit. The Permittee shall also adhere to all current rules and regulations which may apply for the containment, disposal and/or clean-up of any contaminated material and/or groundwater which is excavated.

RESPONSIBILITY FOR DAMAGE: Permittee shall indemnify and save harmless the State of California, all officers, employees, and State's contractors, thereof, including but not limited to the Director of Transportation and the Chief Deputy Director, from all claims, suits or actions of every name, kind and description (" **Claims** ") brought for or on account of injuries to or death of any person, or damage to property resulting from the (1) performance of work or other activity under the permit; or (2) arising out of Permittee's failure to perform its obligations under any permit, or (3) resulting from defects or obstructions, or from any cause whatsoever during the progress of the work, or at any subsequent time, work or other activity is being performed under the obligations provided by and contemplated by the permit, except to the extent any such Claims result from State's negligence or willful misconduct or as otherwise provided by statute. Permittee's duty to indemnify and save harmless includes the duties to defend as set forth in Section 2778 of the Civil Code."

In addition to the above conditions, Permittee understand and acknowledges that the conditions, limitations, restrictions and reservation for access to state-owned highway right of way for telecommunications and information technologies, including consideration and means of access, are subject to current and ongoing Department and/or legislative review, and this permit may be revoked, made subject to different conditions, limitations, restrictions and reservations, or converted to license, lease or other form of agreement, upon reasonable notice.

This Encroachment Permit herewith, for the work authorized to Shell Oil Products, c/o Conestoga-Rovers & Associate. Other Contractors shall apply for separate permit.

A copy of this permit and local permits, complete with all attachments, shall be kept by Permittee/Contractor working under this permit and must be shown to the State representatives, or Law Enforcement Officer, on demand.

Permittee understands and agrees that it will comply with the obligations of Titles II and III of the Americans with Disabilities Act of 1990 in the conduct of the event, and further agrees to indemnify and save harmless the State of California, all officers and employees thereof, including but not limited to the Director of Transportation, from any claims or liability arising out of or by virtue of said act.

The Contractor for the Permittee shall apply for an Encroachment Permit for the work authorized therein, and the application shall be accompanied by a check in the amount of \$328.00 to cover the permit fee. Permittee shall be billed for any additional inspection cost at the current Caltrans standard hourly rate of \$82.00 per hour.

Permittee shall be responsible for full compliance with the Caltrans Storm Water Program and the Caltrans NPDES permit requirements. Please see the Storm Water Special Provisions attached to this Permit.

The Permittee shall provide signed and sealed construction detail plans for the State representative for review and approval a week before construction.

Permittee shall refer to State's 2010 Standard Specifications and 2010 Standard Plans.

Permittee shall be responsible for any liability issue due to the proposed improvements within State Right-of-Way.

Permittee shall make an effort in controlling construction noise pollution within the local City ordinance.

California Endangered Species Act must be adhered to the law, regulations and policies in the provisions, <http://www.dfg.ca.gov/habcon/cesa/>.

Migratory Bird Treaty Act must be adhered to the law, regulations and policies in the provisions, <http://www.fws.gov/migratorybirds/RegulationsandPolicies.html> ; no work shall be allowed during bird nesting and the nesting area must not be disturbed and shall be protected.

Abandoning water well shall be per requirement and regulation of the State Water Quality Board.

Changes to the Plans, Specifications, and Permit Provisions are not allowed without prior approval from the State representative.

Immediately following completion of the work permitted herein, the Permittee shall fill out and mail the Notice of Completion attached to this permit.

PERMIT NUMBER
 0414 - 6MW0739

Dear Customer,

Our goal is to provide the best service possible to our customers. Please take a few minutes to complete this questionnaire. Your comments will enable us to see how we are doing overall and any areas which may need improvement.

PLEASE TELL US HOW WE'RE DOING

INSIDE THE OFFICE	EXCELLENT	VERY GOOD	GOOD	POOR
Staff courteous and helpful	<input type="checkbox"/>	<input type="checkbox"/>	<input type="checkbox"/>	<input type="checkbox"/>
Staff quick and efficient	<input type="checkbox"/>	<input type="checkbox"/>	<input type="checkbox"/>	<input type="checkbox"/>
Explanations and instructions clear	<input type="checkbox"/>	<input type="checkbox"/>	<input type="checkbox"/>	<input type="checkbox"/>
TELEPHONE ANSWERING				
Timely response	<input type="checkbox"/>	<input type="checkbox"/>	<input type="checkbox"/>	<input type="checkbox"/>
Receiving information or answers	<input type="checkbox"/>	<input type="checkbox"/>	<input type="checkbox"/>	<input type="checkbox"/>
INSPECTION				
Inspector courteous and helpful	<input type="checkbox"/>	<input type="checkbox"/>	<input type="checkbox"/>	<input type="checkbox"/>
Pre-construction meeting set and held in a timely manner	<input type="checkbox"/>	<input type="checkbox"/>	<input type="checkbox"/>	<input type="checkbox"/>
Inspector at job site frequently	<input type="checkbox"/>	<input type="checkbox"/>	<input type="checkbox"/>	<input type="checkbox"/>
Inspector able to answer questions and deal with problems	<input type="checkbox"/>	<input type="checkbox"/>	<input type="checkbox"/>	<input type="checkbox"/>
OVERALL PERFORMANCE				
What would you say is our overall performance?	<input type="checkbox"/>	<input type="checkbox"/>	<input type="checkbox"/>	<input type="checkbox"/>
Is there a staff person you would like to commend?	STAFF'S NAME:			

COMMENTS:

NAME (Optional)	BUSINESS PHONE NUMBER	DATE
-----------------	-----------------------	------

Alameda County Public Works Agency - Water Resources Well Permit

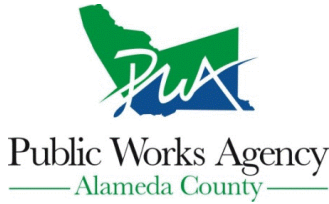

399 Elmhurst Street
Hayward, CA 94544-1395
Telephone: (510)670-6633 Fax:(510)782-1939

Application Approved on: 04/02/2014 By jamesy

Permit Numbers: W2014-0309 to W2014-0317
Permits Valid from 05/19/2014 to 05/23/2014

Application Id: 1396374476721
Site Location: 999 San Pablo Avenue
Project Start Date: 05/19/2014
Assigned Inspector: Contact Steve Miller at (510) 670-5517 or stevem@acpwa.org

City of Project Site: Albany

Completion Date: 05/23/2014

Applicant: Conestoga-Rovers & Associates, Inc. (CRA) - **Phone:** 510-681-6142
Patrick O'Connell
5900 Hollis Street, Suite A, Emeryville, CA 94608

Property Owner: Anabi Oil Corporation **Phone:** --
1040 N Benson Avenue, Upland, CA 91786

Client: Shell Oil Products US **Phone:** --
20945 S Wilmington Avenue, Carson, CA 90810

Contact: Patrick O'Connell **Phone:** 510-681-6142
Cell: 510-681-6142

Total Due: \$3441.00
Total Amount Paid: \$3441.00
Payer Name : PATRICK J OCONNELL Paid By: VISA **PAID IN FULL**

Works Requesting Permits:

Remediation Well Destruction-Extraction - 3 Wells
Driller: Cascade Drilling, L.P. - Lic #: 938110 - Method: press

Work Total: \$265.00

Specifications

Permit #	Issued Date	Expire Date	Owner Well Id	Hole Diam.	Casing Diam.	Seal Depth	Max. Depth	State Well #	Orig. Permit #	DWR #
W2014-0309	04/02/2014	08/17/2014	RW-1	10.00 in.	4.00 in.	5.00 ft	14.00 ft	NO RECORDS	NO RECORDS	NO RECORDS
W2014-0309	04/02/2014	08/17/2014	RW-2	10.00 in.	4.00 in.	5.00 ft	14.00 ft	NO RECORDS	NO RECORDS	NO RECORDS
W2014-0309	04/02/2014	08/17/2014	RW-3	10.00 in.	4.00 in.	5.00 ft	14.00 ft	NO RECORDS	NO RECORDS	NO RECORDS

Specific Work Permit Conditions

1. Drilling Permit(s) can be voided/ cancelled only in writing. It is the applicant's responsibility to notify Alameda County Public Works Agency, Water Resources Section in writing for an extension or to cancel the drilling permit application. No drilling permit application(s) shall be extended beyond ninety (90) days from the original start date. Applicants may not cancel a drilling permit application after the completion date of the permit issued has passed.
2. Compliance with the well-sealing specifications shall not exempt the well-sealing contractor from complying with appropriate State reporting-requirements related to well construction or destruction (Sections 13750 through 13755 (Division 7, Chapter 10, Article 3) of the California Water Code). Contractor must complete State DWR Form 188 and mail original to the Alameda County Public Works Agency, Water Resources Section, within 60 days. Include permit number and site map.
3. Applicant shall submit the copies of the approved encroachment permit to this office within 60 days.
4. Applicant shall contact Steve Miller for an inspection time at (510) 670-5517 or email to stevem@acpwa.org at least five (5) working days prior to starting, once the permit has been approved. Confirm the scheduled date(s) at least 24 hours prior to drilling.

Alameda County Public Works Agency - Water Resources Well Permit

5. Remove the Christy box or similar structure. Pressure Grout with Cement (Less than 30 ft in depth). After the seal has set, backfill the remaining hole with concrete or compacted material to match existing.

6. Copy of approved drilling permit must be on site at all times. Failure to present or show proof of the approved permit application on site shall result in a fine of \$500.00.

7. Remove the Christy box or similar structure. Tremie Grout with Cement (More than 30 ft in depth). After the seal has set, backfill the remaining hole with concrete or compacted material to match existing.

Well Destruction-Monitoring - 8 Wells

Driller: Cascade Drilling, L.P. - Lic #: 938110 - Method: press

Work Total: \$3176.00

Specifications

Permit #	Issued Date	Expire Date	Owner Well Id	Hole Diam.	Casing Diam.	Seal Depth	Max. Depth	State Well #	Orig. Permit #	DWR #
W2014-0310	04/02/2014	08/17/2014	S-1	8.00 in.	3.00 in.	4.00 ft	14.00 ft	NO RECORDS	1990 ?	NO RECORDS
W2014-0311	04/02/2014	08/17/2014	S-2	8.00 in.	3.00 in.	4.00 ft	15.00 ft	NO RECORDS	1990 ?	NO RECORDS
W2014-0312	04/02/2014	08/17/2014	S-3	8.00 in.	3.00 in.	4.00 ft	20.50 ft	NO RECORDS	1990 ?	NO RECORDS
W2014-0313	04/02/2014	08/17/2014	S-4	8.00 in.	3.00 in.	3.00 ft	20.50 ft	NO RECORDS	1990 ?	NO RECORDS
W2014-0314	04/02/2014	08/17/2014	S-6	8.00 in.	3.00 in.	3.50 ft	19.50 ft	NO RECORDS	1990 ?	NO RECORDS
W2014-0315	04/02/2014	08/17/2014	S-7	8.00 in.	3.00 in.	3.50 ft	19.50 ft	NO RECORDS	1990 ?	NO RECORDS
W2014-0316	04/02/2014	08/17/2014	S-8	10.00 in.	4.00 in.	3.00 ft	16.00 ft	NO RECORDS	1990 ?	NO RECORDS
W2014-0317	04/02/2014	08/17/2014	S-9	8.00 in.	2.00 in.	3.00 ft	16.00 ft	NO RECORDS	1990 ?	NO RECORDS

Specific Work Permit Conditions

1. Drilling Permit(s) can be voided/ cancelled only in writing. It is the applicant's responsibility to notify Alameda County Public Works Agency, Water Resources Section in writing for an extension or to cancel the drilling permit application. No drilling permit application(s) shall be extended beyond ninety (90) days from the original start date. Applicants may not cancel a drilling permit application after the completion date of the permit issued has passed.

2. Prior to any drilling activities, it shall be the applicant's responsibility to contact and coordinate an Underground Service Alert (USA), obtain encroachment permit(s), excavation permit(s) or any other permits or agreements required for that Federal, State, County or City, and follow all City or County Ordinances. No work shall begin until all the permits and requirements have been approved or obtained. It shall also be the applicants responsibilities to provide to the Cities or to Alameda County an Traffic Safety Plan for any lane closures or detours planned. No work shall begin until all the permits and requirements have been approved or obtained.

3. Compliance with the well-sealing specifications shall not exempt the well-sealing contractor from complying with appropriate State reporting-requirements related to well construction or destruction (Sections 13750 through 13755 (Division 7, Chapter 10, Article 3) of the California Water Code). Contractor must complete State DWR Form 188 and mail original to the Alameda County Public Works Agency, Water Resources Section, within 60 days. Include permit number and site map.

Alameda County Public Works Agency - Water Resources Well Permit

4. Applicant shall submit the copies of the approved encroachment permit to this office within 60 days.
 5. Permittee shall assume entire responsibility for all activities and uses under this permit and shall indemnify, defend and save the Alameda County Public Works Agency, its officers, agents, and employees free and harmless from any and all expense, cost and liability in connection with or resulting from the exercise of this Permit including, but not limited to, property damage, personal injury and wrongful death.
 6. Applicant shall contact Steve Miller for an inspection time at (510) 670-5517 or email to stevem@acpwa.org at least five (5) working days prior to starting, once the permit has been approved. Confirm the scheduled date(s) at least 24 hours prior to drilling.
 7. Permittee, permittee's contractors, consultants or agents shall be responsible to assure that all material or waters generated during drilling, boring destruction, and/or other activities associated with this Permit will be safely handled, properly managed, and disposed of according to all applicable federal, state, and local statutes regulating such. In no case shall these materials and/or waters be allowed to enter, or potentially enter, on or off-site storm sewers, dry wells, or waterways or be allowed to move off the property where work is being completed.
 8. Remove the Christy box or similar structure. Destroy wells S-4, S-5, S-6 and S-9 by overdrilling the upper 5ft. bgs & Tremie Grouting with Cement. After the seal has set, backfill the remaining hole with concrete or compacted material to match existing or follow City Encroachment Permit conditions.
 9. Remove the Christy box or similar structure. Destroy all other wells by grouting neat cement with a tremie pipe or pressure grouting (25 psi for 5min.) to the bottom of the well and by filling with neat cement to three (3-5) feet below surface grade. Allow the sealing material to spill over the top of the casing to fill any annular space between casing and soil. After the seal has set, backfill the remaining hole with concrete or compacted material to match existing conditions.
 10. Copy of approved drilling permit must be on site at all times. Failure to present or show proof of the approved permit application on site shall result in a fine of \$500.00.
-



City of Albany



ENCROACHMENT PERMIT

PERMANENT OR TEMPORARY CONSTRUCTION WITHIN CITY RIGHT OF WAY

LOCATION: (Client) 999 SAN PABLO AVENUE, ALBANY, CA (2 sites on Marin, 2 on San Pablo)

PERMIT NO. 14-130

NAME	ADDRESS	Phone No. Normal/Emergency	Business Lic. No. Workers Comp. No.
Applicant <u>PATRICK O'CONNEL</u>	<u>5900 HOLLIS STREET, SUITE A EMERYVILLE, CA 94608</u>	<u>510.681.6142</u>	<u>7592</u> <u>01WEOH1021</u>
Owner: <u>SHELL OIL PRODUCTS US</u> <u>dba EQUILON ENTERPRISES LLC</u>	<u>20945 S WILMINGTON AVENUE CARSON, CA 90810</u>	<u>310.834.1297</u>	
Engineer / Architect <u>CAGE CONESTOGA-ROBERTS & ASSOCIATES INC.</u>	<u>5900 HOLLIS STREET, SUITE A EMERYVILLE, CA 94608</u>	<u>510.681.6142</u>	<u>7592</u> <u>01WEOH1021</u>
Contractor <u>CASCADE DRILLING, L.P.</u>	<u>120 S. 23RD STREET RICHMOND, CA 94804</u>	<u>510.478.0858</u>	

TYPE OF WORK

- Sidewalk Curb & Gutter Sewer Street Tree
 Utility Co. Permanent Structure Other: STREET (ASPHALT PAVEMENT)

DESCRIPTION OF WORK

GRANDWATER
ABANDON 2 MONITORING WELLS (W-4, -6) PER IN ACCORDANCE WITH
LAMEOA COUNTY PUBLIC WORKS AGENCY (LCPWA) AND CITY OF ALBANY REQUIREMENTS ON MARIN AVE
ABANDON 2 WELLS ON SAN PABLO AVE REQUIRED CONDITIONS (S-7, -9) WITH CALTRANS ENCROACHMENT
PERMIT.

- All work shall be in accordance with the attached standard conditions.
- No refund after 120 days or work begins, 70% of fee refundable within 120 days provided no work has begun.
- Permanent structures require City Council approval (City Code 14-2).
- CALL USA 1-800-227-2600 before excavating.
- Call for Final Inspection and Sign-Off 48 hr. in advance at (510) 528-5760 (510) 524-9543.
- Special Conditions may be imposed following City review and prior to issuance of this permit.

Applicant's Signature: Patrick O'Connell Date: 4/10/2014

STAFF USE ONLY	
Permit Fee Computation	
Total construction cost subject to fee	
New construction at 8% of construction cost	
In-Lieu storm water fee (when Street is cut)	
Minimum fee per schedule (if greater than 2% fee)	
Total Fee due (transfer to fee schedule from 1500 fee to 600 fee)	<u>\$3463</u>
Special Conditions: <u>See attached Engineer's Condition</u>	
Issued by: <u>[Signature]</u>	Date: <u>5/16/14</u>
Permit Expiration Date: <u>11/16/14</u>	(not to exceed 180 days for date issued)
Final Sign Off by: _____	Date: _____

City of Albany

SPECIAL PROVISIONS FOR ENCROACHMENT PERMIT FOR PERMANENT IMPROVEMENT IN CITY RIGHT-OF-WAY

Permit # 14-130

Location: 999 SAN PABLO AVENUE, ALBANY, CA

This APPLICATION MUST BE ACCOMPANIED by the DATA and PLANS indicated below:

- Description of Job
- APPROVED Construction Plans and/or Documents (~\$1,000)
- An Engineer's Estimate of the value of all public improvements and utility services within the public right-of-way
- A Soils Report prepared by a Registered Civil Engineer.
- Others: Specify SITE PLAN & TCEPs

ALL FEES SHALL BE PAID AND DEPOSITS MADE PRIOR TO THE ISSUANCE OF THIS PERMIT: except Utility Companies. Utility Companies will be invoiced.

STANDARDS/SPECIFICATION:

The following conditions and provisions of the Albany Municipal Code apply to this permit. All work shall be in accordance with City Standard Specifications and Drawings.

COMMENCEMENT OF WORK

The permittee shall begin the work or use authorized by a permit issued pursuant to this chapter within ninety (90) days from the date of issuance unless a different period is stated in the permit, or an extension of time is granted by the Director of Community Development & Environmental Resources. If the work or use is not begun accordingly the permit shall become void.

INSPECTION

In general, inspection producers and requirements shall be as established by the Director of Community Development & Environmental Resources. Unless specifically exempted by the City Code, no encroachment work shall take place without inspection by the Director of Community Development & Environmental Resources or his/her authorized agent. Inspections by the City must be requested at least TWENTY-FOUR (24) HOURS (excluding weekends) IN ADVANCE of the work to be performed. No work shall be performed on weekends without PRIOR AUTHORIZATION of the Director of Community Development & Environmental Resources.

DISPLAY OF PERMIT

The permittee shall keep a copy of this permit at the site of the work, or in the cab of a vehicle when movement on a public street is involved. The permit shall be shown to any authorized representative of the Director of Community Development & Environmental Resources or Law Enforcement Officer on demand.

ACCEPTANCE OF PERMIT BY APPLICANT

Acceptance by the applicant of the permit shall be conclusive evidence of the reasonableness of the terms imposed and shall constitute a waiver of any right to legislative determination thereof.

NON-ASSIGNMENT OF PERMIT

Permits shall be issued only to the person making application and may not be assigned to another person by the permittee. If any permittee assigns his permit to another, the permit will be revoked.

CHANGES IN PERMIT AND WORK

No changes may be made in the location, dimensions, character, or duration of the encroachment or use as granted by the permit except upon written authorization of the Director of Community Development & Environmental Resources.

City of Albany

Date: May 13, 2014

APPLICANT COPY

Special Conditions Encroachment Permit for

Conestoga-Rovers & Associates (CRA) to decommission 4 wells at San Pablo Avenue and at the Marin Avenue side.

1. Working hours on the City of Albany shall be from 8:00AM to 6:00PM Monday through Saturday; and 10:00AM to 5:00PM Sunday and Holidays. No startup of heavy equipment is allowed prior to 8:00 AM. Written permission must be obtained from the City Engineer prior to any weekend and holiday work.
2. **Temporary closure of lanes on Marin Avenue and San Pablo Avenue shall be between the hours of 9:00 AM to 3:00 PM only.**
3. If driveways will be temporarily blocked, arrange with property owners and occupants a minimum of seventy two (72) hours in advance so they can move vehicles.
4. The applicant shall take all necessary precautions to allow emergency vehicles to pass through the construction zones without delays.
5. **Contact the City Albany Police and Fire Dispatch at 510-525-7300 to inform the City of any street or lane closures a minimum of 72 hours in advance of work.**
6. Abandonment of exploratory wells under this permit is subject to the Alameda County Public Works Agency Guidelines, Policies & Procedures, the State Water Well Standards, and any instruction by the Health Department. (Applicant has submitted a copy of the Alameda County Permit).
7. Permittee and permittee's contractor shall be responsible to assure that all material or waters generated during well destruction, and/or other activities associated with this permit will be safely handled, properly managed, and disposed of according to all applicable Federal, State and local statutes regulating such. In no case shall these materials and/or waters be allowed to enter, or potentially enter, on or off-site storm and/or sewer drain system, or waterways, or are allowed to move off the property where work is being completed.
8. All wells must be completely filled with cement grout mixture. The top 12" of the well shall reconstruct the original surface material per the City's standards. The applicant shall be responsible for the replacement of any and all obliterated or removed pavement markings or striping.
9. Conform to City Standard Details for Curb, Gutter and Sidewalk Repairs. Concrete repairs shall be removed to the nearest joint and have dowels installed between existing and new materials. See Standard Details ST-1 to ST-7 at the City of Albany Website <http://www.albanyca.org/index.aspx?page=989>
10. Restoration of pavement and base shall conform to the City's Standard Detail ST-9 (<http://www.albanyca.org/index.aspx?page=989>). Asphalt Concrete shall be Caltrans Type A, ½" maximum aggregate saw cut existing pavement after trenching as shown on the Standard Detail and as Directed by the City Engineer.
11. Provide for traffic control and pedestrian safety and lane closures per the General Provisions of the City and Caltrans Standard Specifications.

EXPLANATION

- S-1 ● Monitoring well location
- RW-1 ■ Recovery well location
- S-7 ∅ Paved-over well location
- SB-1 ⊙ Soil boring location (1990)
- D-1 ● Dispenser soil sample location (2007)
- P-1 ○ Pipeline soil sample location (1996)
- D-1 ▲ Dispenser soil sample location (1996)
- V-1 ◆ Ventline soil sample location (1996)
- E-1 ■ Excavation soil sample location (1996)
- NE ▲ Trench soil sample location (1996)

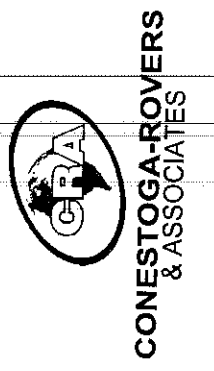
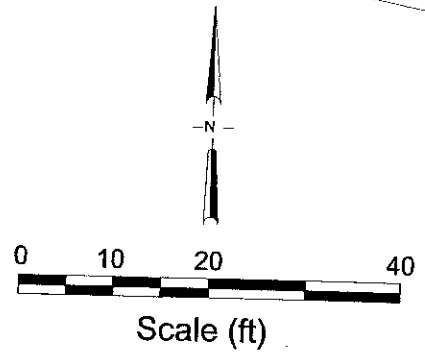
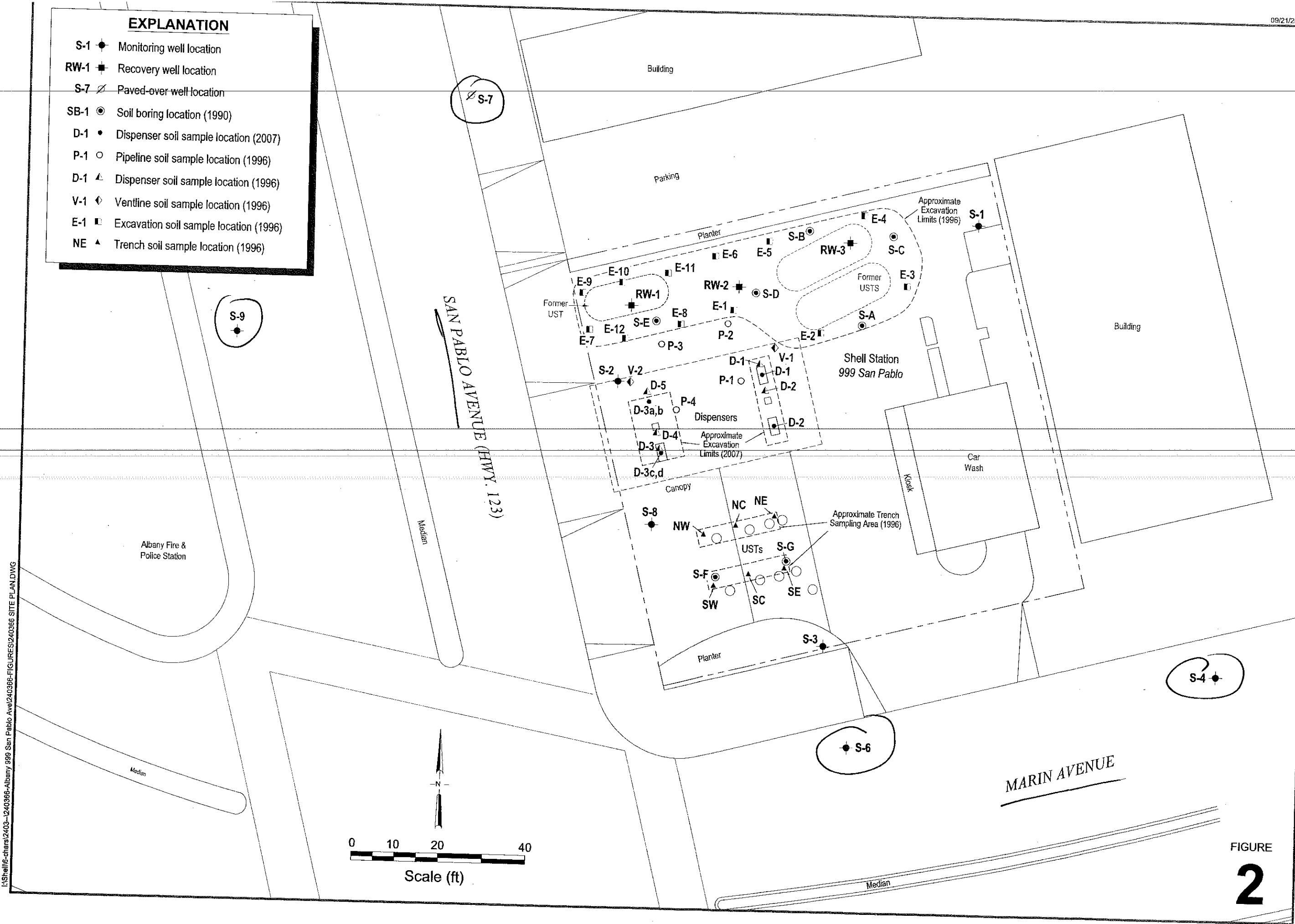

Shell-branded Service Station
 999 San Pablo Avenue
 Albany, California

FIGURE
2

I:\Shell\6-chara\2403-1240366-Albany 999 San Pablo Ave\240366-FIGURES\240366 SITE PLAN.DWG

EXPLANATION

- S-1 ◆ Monitoring well location
- RW-1 ■ Recovery well location
- S-7 ✗ Paved-over well location
- SB-1 ● Soil boring location (1990)
- D-1 • Dispenser soil sample location (2007)
- P-1 ○ Pipeline soil sample location (1996)
- D-1 ▲ Dispenser soil sample location (1996)
- V-1 ◆ Ventline soil sample location (1996)
- E-1 ■ Excavation soil sample location (1996)
- NE ▲ Trench soil sample location (1996)

(2 NO PARKING SPOTS)
 5/19 - 09:00 - 17:00
 TBD - 09:00 - 17:00

Sunny Mantravadi (CACTHANS)
 Wants S-9 repaired:
 1) 1.5' diameter well box and concrete pad removed to 1' depth
 2) Grind down 2 3/4", 6" out in all directions AND INSTALL NEW CONCRETE PATCH.
 3) 3 PARKING SPOTS:
 - 5/19 - 09:00 - 12:00
 - TBD - 09:00 - 17:00 (1 day)
 Albany Fire & Police Station

I:\Shell6-chars\2403-1240366-Albany 999 San Pablo Ave\240366-FIGURES\240366 SITE PLAN.DWG

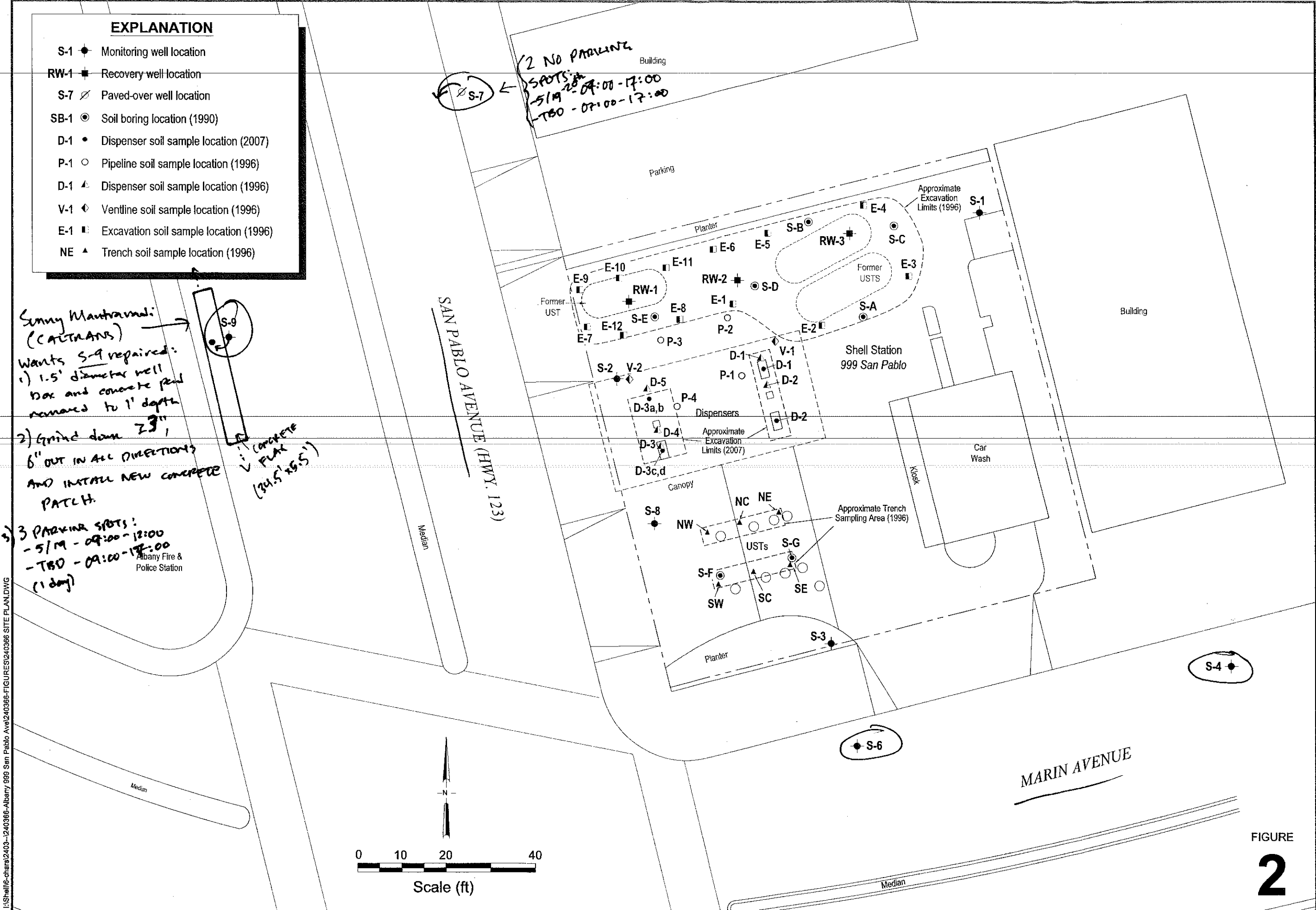

Site Plan

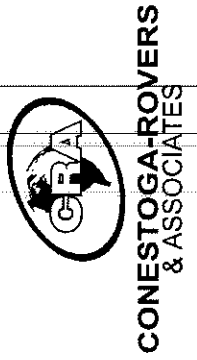

Shell-branded Service Station
 999 San Pablo Avenue
 Albany, California

FIGURE
2

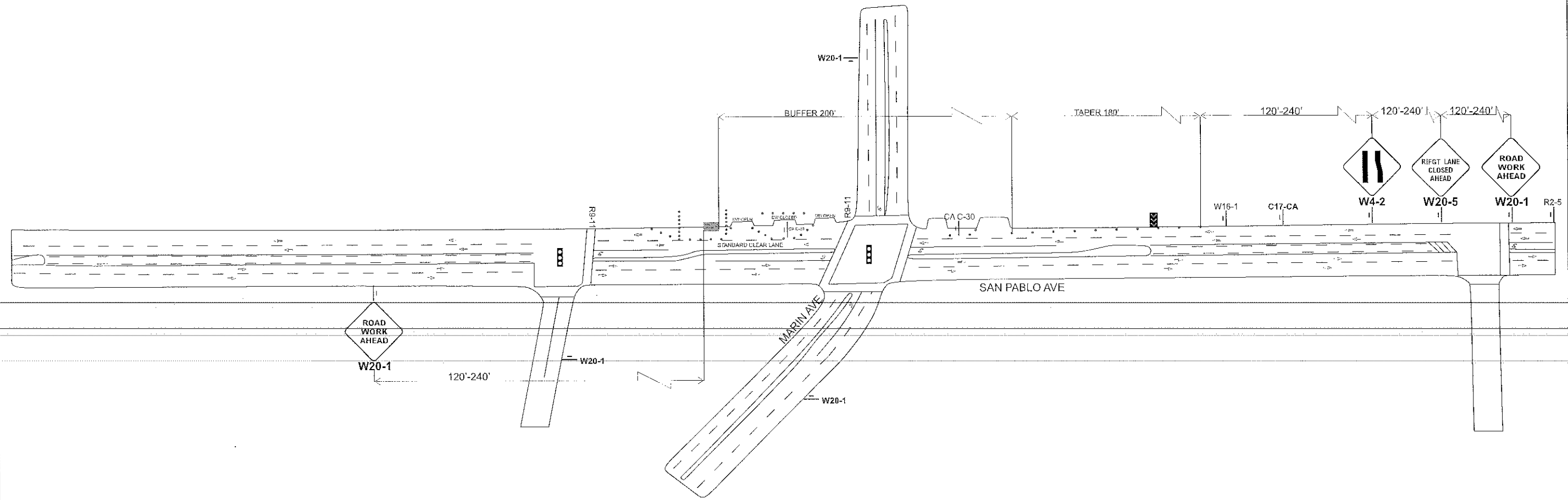

POSTED SPEED: 30 MPH | TAPER LENGTH: 180' | CONE SPACING: 30' | SIGN SPACING: 120-240' | BUFFER ZONE: 200'



30 MPH
 10' OFFSET = 150'
 11' OFFSET = 165'
 12' OFFSET = 180'

	W16-1		C17-CA		R2-5
	WORK ZONE		CA C-30		W4-2
	REFLECTIVE CONE		W20-5		W20-1
	TEMPORARY C.A.S.		R9-11		
	TRAFFIC FLOW				
	ARROW BOARD				
	TYPE I BARRICADE				

Owner: STATE OF CALIFORNIA
 Project Name: 999 SAN PABLO AVE JOB#240366
 Prime Contractor: CRA
 Phone Number: 510-681-6142
 Date Prepared: 4/3/2014
 Prepared By: STATEWIDE TRAFFIC SAFETY & SIGNS
 Project Sheet #: # 2489

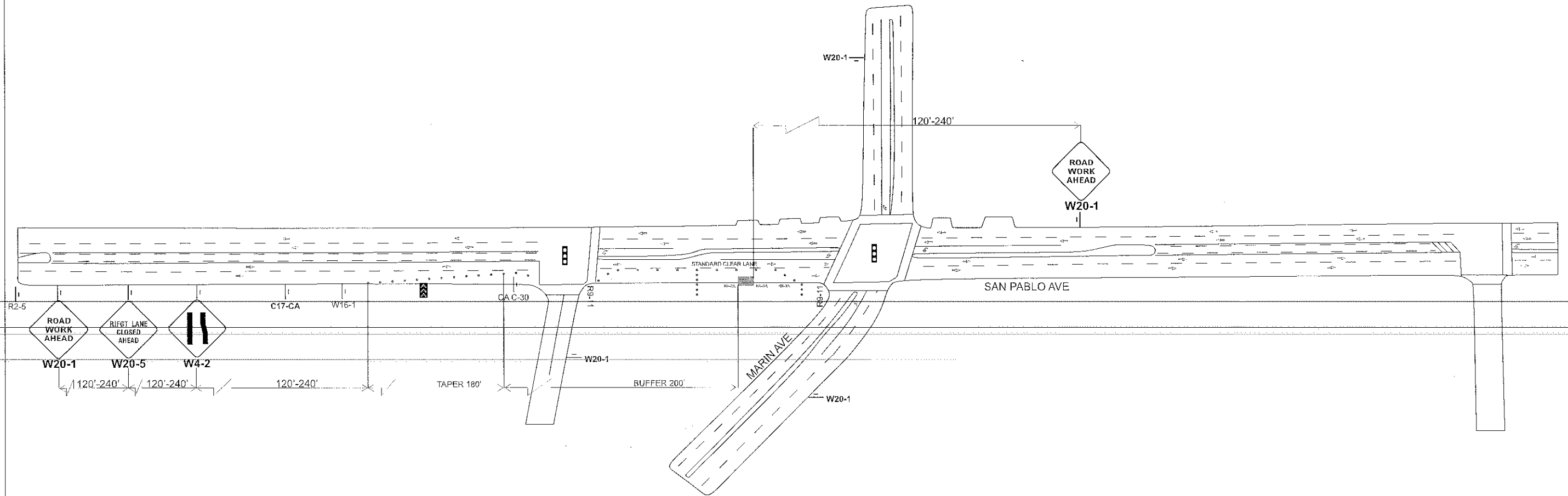

POSTED SPEED: 30 MPH | TAPER LENGTH: 180' | CONE SPACING: 30' | SIGN SPACING: 120-240' | BUFFER ZONE: 200'



30 MPH
 10' OFFSET = 150'
 11' OFFSET = 165'
 12' OFFSET = 180'

	W16-1		C17-CA		R2-5
	WORK ZONE		CA C-30		W4-2
	REFLECTIVE CONE		W20-5		W20-1
	TEMPORARY C.A.S.		R9-11		R8-3A
	TRAFFIC FLOW				
	ARROW BOARD				
	TYPE I BARRICADE				

Owner: STATE OF CALIFORNIA
 Project Name: 999 SAN PABLO AVE JOB#240366
 Prime Contractor: CRA
 Phone Number: 510-681-6142
 Date Prepared: 4/3/2014
 Prepared By: STATEWIDE TRAFFIC SAFETY & SIGNS
 Project Sheet #: # 2490

STATEWIDE

TRAFFIC SAFETY & SIGNS

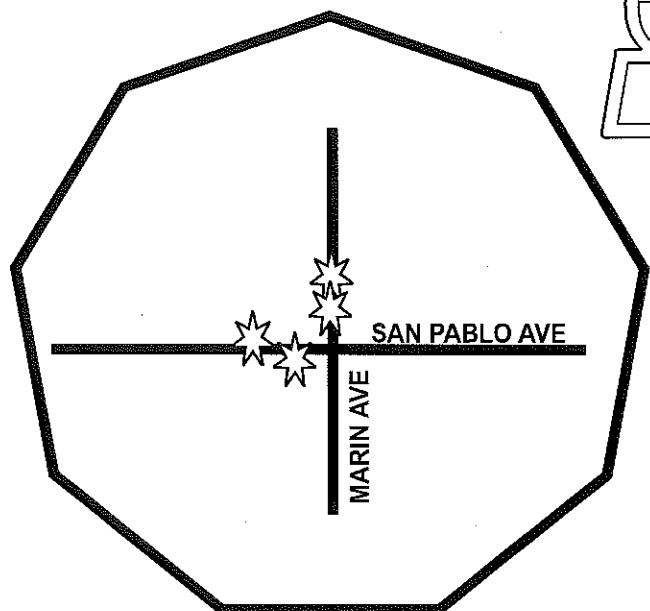

PROJECT LOCATION

THIS PROJECT IS LOCATED ON SAN PABLO AVE & MARIN AVE IN ALBANY, CA. THESE PLANS WILL BE USED TO WORK IN THE SIDEWALK/STREET TO DESTROY WELLS. WORK HOURS WILL BE 9AM TO 4PM MONDAY THRU FRIDAY. CONTRACTOR WILL COMPLY WITH THE CITY OF ALBANY STANDARD SPECIFICATIONS.

CONTRACTOR WILL COMPLY WITH THE STATE OF CALIFORNIA STANDARD SPECIFICATIONS (ARTICLE 10), CONTRACT SPECIAL SPECIFICATIONS, TRAFFIC CONTROL PLAN SUPPLEMENT AND CALTRANS SPECIFICATIONS, M.U.T.C.D 2012 EDITION. THIS PLAN MAY BE MODIFIED BY THE ENGINEER AT ANY TIME TO ELIMINATE OR AVOID TRAFFIC CONDITIONS THAT ARE HAZARDOUS TO THE SAFETY OF THE PUBLIC.

CONTINUAL MONITORING AND MAINTENANCE OF THE TRAFFIC CONTROL ZONE, EMERGENCY ACCESS, ACCOMMODATION FOR PEDESTRIANS, BICYCLE TRAFFIC AND THE DISABLED, PROPER TRAINING OF FLAGGERS, PROPER DEVICES AND DEVICE USAGE AND APPROPRIATE NOTIFICATIONS SHALL BE USED ON THIS PROJECT.



TRAFFIC CONTROL PLANS
CRA
999 SAN PABLO AVE, ALBANY, CA
JOB#240336

CONTRACTOR:
CRA
CONTACT:
PATRICK O'CONNELL 510-681-6142

Statewide Traffic Safety and Signs ("Statewide") shall not be responsible for, and [CRA, CITY OF ALBANY & CAL TRANS] shall indemnify, defend and hold harmless Statewide and its agents, representatives and employees from and against, any claims, costs, damages, liabilities, expenses, demands and losses (including attorney's fees and costs and expenses) arising out of or relating to the failure of any Traffic Control Plan applicable to Statewide's work or services to comply with any local, state or federal rule, regulation, ordinance, or statute. [CRA, CITY OF ALBANY & CAL TRANS] agrees that the Statewide is entitled to and will rely on the written Traffic Control Plan(s) provided to Statewide by [CRA, CITY OF ALBANY & CAL TRANS] and its agents, representatives and employees in the performance of Statewide's work or services.

NOTES:

- SIGN SPACING VARIANCE IS ALLOWED AS PER 2012 CA M.U.T.C.D 6C.04.
- THE LOCATION OF THE SIGNS AS SHOWN ON THE PLANS ARE GUIDELINES AND ACTUAL LOCATIONS WILL DEPEND UPON ALIGNMENT, GRADE, LOCATION OF STREET INTERSECTIONS, POSTED SPEED LIMITS, AND 85TH % TILE.
- ALL HIGH LEVEL WARNING DEVICES WILL BE EQUIPPED WITH FLAGS FOR DAY CLOSURES.
- IF THE WORK AREA ENCLOSES UPON A SIDEWALK OR WALKWAY, "SIDEWALK CLOSED, USE OTHER SIDE" SIGNS WILL BE USED TO GUIDE PEDESTRIANS TO CROSS TO ANOTHER MARKER CROSSWALK. PEDESTRIANS MAY NOT BE GUIDED ONTO PRIVATE PROPERTY OR THE TRAVELED WAY.
- TRAFFIC LANES SHALL BE A MINIMUM OF TEN FEET IN WIDTH MIN CLR.
- WHENEVER FEASIBLE AN ADDITIONAL 5 FEET SHALL BE PROVIDED FOR A BICYCLE LANE. IF IT IS NOT FEASIBLE TO PROVIDE A SEPARATE BICYCLE LANE, THE CONTRACTOR SHALL POST SIGNAGE BEFORE THE CONSTRUCTION AREA STATING: "SHARE the Road with Bicyclists". WHEN THE LANE IS SHARED, THE CONTRACTOR SHALL POST SIGNAGE FOR A MAXIMUM SPEED LIMIT OF 25 MPH IN THE SHARED LANE.
- MONITOR AND MAINTAIN TRAFFIC CONTROL ZONE AT ALL TIMES.
- MAINTAIN ACCESS FOR EMERGENCY VEHICLES.
- ASSURE SAFE PASSAGE OF PEDESTRIANS & BICYCLISTS INCLUDING PERSONS WITH DISABILITIES IN ACCORDANCE WITH THE AMERICANS WITH DISABILITIES ACT OF 1990 (ADA), TITLE II, PARAGRAPH 35.130.
- ALL DEVICES TO CONFORM TO CALTRAN'S STANDARDS/ CA M.U.T.C.D.
- DEVICE PLACEMENT TO CONFORM TO CALTRAN'S GUIDELINES/CONSTRUCTION SPECS.
- FLAGGERS TO BE TRAINED PER TITLE 8 CCR.

NOTE:

- CONTRACTOR WILL ASSIST ALL ADA, PED FOOT TRAFFIC AS NEEDED THROUGH WORK AREA. (MIN 5')
- MAINTAIN ACCESS TO BUSINESS & RESIDENTS AT ALL TIMES.
- NOTIFY AND COORDINATE WITH REGIONAL TRANSIT RELOCATION, CLOSURE OR MAINTAIN ACCESS TO BUS STOPS.
- ANY RESIDENT OR BUSINESS PARKING AFFECTED SHALL BE COORDINATED A MIN OF 48HRS IN ADVANCE OF PARKING RESTRICTION PLACEMENT.
- SIGNS SHALL BE 48X48".

BOTH ARE BASED ON.

- 85TH % TILE OR IF NOT AVAILABLE, THEN USE
 - POSTED SPEED LIMIT (PSL)
- L = TAPER LENGTH
S = SPEED
W = WIDTH (OFFST FROM PATH OF TRAVEL)

*CONES SHOWN ON THIS PLAN ARE ILLUSTRATION PURPOSE ONLY. EXACT NUMBER OF CONES REQUIRED SHALL BE BASED ON CONE SPACING, TAPER LENGTHS, ACTUAL FIELD, ACTUAL FIELD CONDITIONS, ECT....

POSTED SPEED	FORMULAS	BUFFER SPACE	MINIMUM TAPER LENGTH									MAX CONE SPACING	SIGN SPACING
			10' OFFSET			11' OFFSET			12' OFFSET				
			L MERGE	1/2 L SHIFT	1/3 L SHOULDER	L MERGE	1/2 L SHIFT	1/3 L SHOULDER	L MERGE	1/2 L SHIFT	1/3 L SHOULDER		
25		155'	104'	52'	35'	115'	57'	38'	125'	63'	42'	25'	100-200'
30	L=	200'	150'	75'	50'	165'	83'	55'	180'	90'	60'	30'	120-240'
35	(WS)(WS)	250'	204'	102'	68'	225'	112'	75'	245'	123'	82'	35'	140-280'
40	60	305'	267'	133'	89'	293'	147'	98'	320'	160'	107'	40'	160-320'
45		360'	450'	225'	150'	495'	248'	165'	540'	270'	180'	45'	350-500'
50		425'	50'	250'	167'	550'	275'	183'	600'	300'	200'	50'	525' MIN
55	L= (WS)	495'	550'	275'	183'	605'	303'	202'	660'	330'	220'	50'	550' MIN
60		570'	600'	300'	200'	660'	330'	220'	720'	360'	240'	50'	575' MIN
65		645'	650'	325'	217'	715'	358'	227'	780'	390'	260'	50'	600' MIN
70		730'	700'	350'	233'	770'	385'	240'	840'	420'	280'	50'	650' MIN

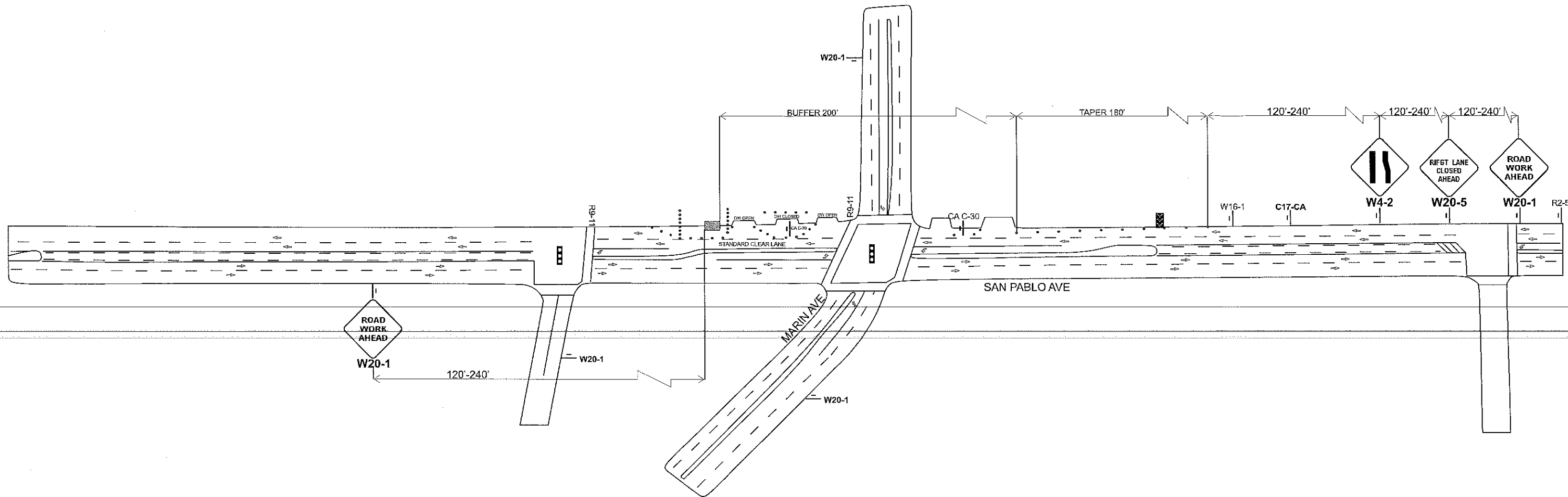

POSTED SPEED: 30 MPH | TAPER LENGTH: 180' | CONE SPACING: 30' | SIGN SPACING: 120-240' | BUFFER ZONE: 200'



30 MPH
 10' OFFSET = 150'
 11' OFFSET = 165'
 12' OFFSET = 180'

	W16-1		CA C-30		R2-5	Owner:	STATE OF CALIFORNIA
	REFLECTIVE CONE		TEMPORARY C.A.S.		W4-2	Project Name:	999 SAN PABLO AVE JOB#240366
	TRAFFIC FLOW		ARROW BOARD		W20-5	Prime Contractor:	CRA
	TYPE I BARRICADE		TRAFFIC FLOW		W20-1	Phone Number:	510-681-6142
			ARROW BOARD		R9-11	Date Prepared:	4/3/2014
						Prepared By:	STATEWIDE TRAFFIC SAFETY & SIGNS
						Project Sheet #:	# 2489

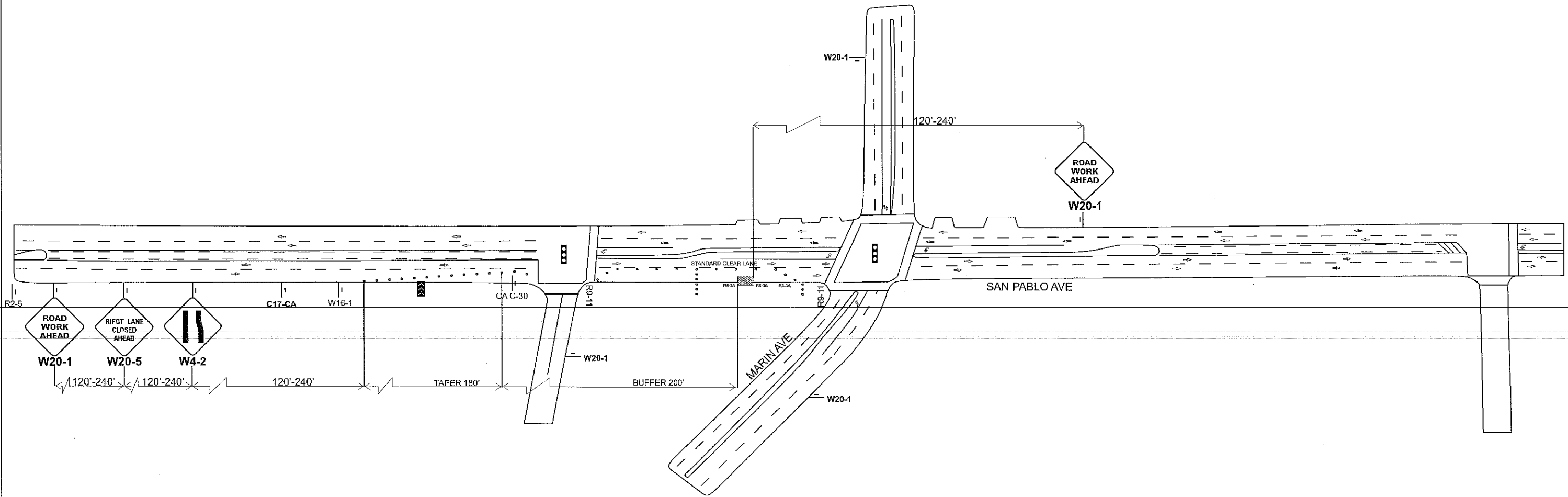

POSTED SPEED: 30 MPH | TAPER LENGTH: 180' | CONE SPACING: 30' | SIGN SPACING: 120-240' | BUFFER ZONE: 200'

	W16-1		C17-CA		R2-5
	WORK ZONE		CA C-30		W4-2
	REFLECTIVE CONE		W20-5		W20-1
	TEMPORARY C.A.S.		R9-11		R8-3A
	TRAFFIC FLOW				
	ARROW BOARD				
	TYPE I BARRICADE				

Owner: STATE OF CALIFORNIA
 Project Name: 999 SAN PABLO AVE JOB#240366
 Prime Contractor: CRA
 Phone Number: 510-681-6142 | Date Prepared: 4/3/2014
 Prepared By: STATEWIDE TRAFFIC SAFETY & SIGNS | Project Sheet #: # 2490

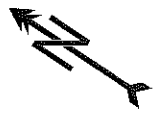

30 MPH
 10' OFFSET = 150'
 11' OFFSET = 165'
 12' OFFSET = 180'



City of Albany
1000 San Pablo Ave
Albany, CA
94706

Receipt Number: R84396

Cashier Name: NICOLE

Terminal Number: 1

Receipt Date: 5/16/2014 9:00:50 AM

Transaction Code: 1.00000 - Finance \$324.63

Product: Encroachment fee Units: 0.00 Amount: 324.63
Encroachment fee
CONESTOGA-ROVERS ASSOC/BL7592/X7.10.14/999 SAN PABLO/\$N/A

Total Balance Due: \$324.63



Payment Method: Check Reference: 5575

Amount: \$324.63

Total Payment Received: \$324.63

Change: \$0.00

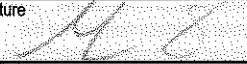
APPENDIX B
WASTE MANIFEST

UNIFORM HAZARDOUS WASTE MANIFEST		1. Generator ID Number CAR000183103	2. Page 1 of	3. Emergency Response Phone 303-227-3333	4. Manifest Tracking Number 008875357 JJK		
5. Generator's Name and Mailing Address Shell Oil Products US via CRA Attn: Derek Eisman 6520 Corporate Drive, Indianapolis, IN 46276				Generator's Site Address (if different than mailing address) 990 San Pablo Avenue Albany, CA 94706			
Generator's Phone: 317-291-7007							
6. Transporter 1 Company Name American Integrated Services, Inc.				U.S. EPA ID Number CAR000148338			
7. Transporter 2 Company Name				U.S. EPA ID Number			
8. Designated Facility Name and Site Address Clean Harbors Aragonia, LLC Service 11600 North Apios Road, Gransville, UT 84083 USA				U.S. EPA ID Number UTS951552177			
Facility's Phone: 435-884-8100							
9a. HM	9b. U.S. DOT Description (including Proper Shipping Name, Hazard Class, ID Number, and Packing Group (if any))	10. Containers		11. Total Quantity	12. Unit Wt./Vol.	13. Waste Codes	
		No.	Type				
	1. UN3175, Waste Solids Containing Flammable Liquid, N.O.S., (Gasoline, Benzene), 4.1, PGI (D001) (D015) ERG# 133	25	DM	25	P	352	D001 D015
	2.						
	3.						
	4.						
14. Special Handling Instructions and Additional Information Wear protective equipment while handling. Weights or volumes are approximate. 24 hour emergency number (800) 424-9300 Chemtrec. Absorbents contaminated with gasoline				Project #: 74006-2-45 CRA#240369 RIPR#: 102101 SAP#135037 LxSS Profile #: CH378336 SO#1400514428			
15. GENERATOR'S/OFFEROR'S CERTIFICATION: I hereby declare that the contents of this consignment are fully and accurately described above by the proper shipping name, and are classified, packaged, marked and labeled/placarded, and are in all respects in proper condition for transport according to applicable international and national governmental regulations. If export shipment and I am the Primary Exporter, I certify that the contents of this consignment conform to the terms of the attached EPA Acknowledgment of Consent. I certify that the waste minimization statement identified in 40 CFR 262.27(a) (if I am a large quantity generator) or (b) (if I am a small quantity generator) is true.							
Generator's/Offoror's Printed/Typed Name AIS on behalf of SOPUS - J Sherman				Signature 		Month Day Year 5 27 14	
16. International Shipments <input type="checkbox"/> Import to U.S. <input type="checkbox"/> Export from U.S. Port of entry/exit: _____ Date leaving U.S.: _____							
17. Transporter Acknowledgment of Receipt of Materials							
Transporter 1 Printed/Typed Name MARCO MARTELLI				Signature 		Month Day Year 5 27 14	
Transporter 2 Printed/Typed Name MARCO MARTELLI				Signature		Month Day Year	
18. Discrepancy							
18a. Discrepancy Indication Space <input type="checkbox"/> Quantity <input type="checkbox"/> Type <input type="checkbox"/> Residue <input type="checkbox"/> Partial Rejection <input type="checkbox"/> Full Rejection							
Manifest Reference Number: _____							
18b. Alternate Facility (or Generator)				U.S. EPA ID Number			
Facility's Phone:							
18c. Signature of Alternate Facility (or Generator)						Month Day Year	
19. Hazardous Waste Report Management Method Codes (i.e., codes for hazardous waste treatment, disposal, and recycling systems)							
1.		2.		3.		4.	
20. Designated Facility Owner or Operator: Certification of receipt of hazardous materials covered by the manifest except as noted in Item 18a							
Printed/Typed Name				Signature		Month Day Year	

GENERATOR

TRANSPORTER INTL

DESIGNATED FACILITY