

C A M B R I A

February 9, 1999

~~Susan Hugo~~ *Don A.*
Alameda County Health Care Services Agency
1131 Harbor Bay Parkway, Suite 250
Alameda, California 94502-6577

Re: **Fourth Quarter 1998 Monitoring Report**
Shell-branded Service Station
999 San Pablo Avenue
Albany, California
Incident # 98995143
Cambria Project# 24-314-498



Dear Ms. Hugo:

On behalf of Equiva Services LLC, Cambria Environmental Technology, Inc. (Cambria) is submitting this ground water monitoring report in accordance with the reporting requirements of 23 CCR 2652d.

FOURTH QUARTER 1998 ACTIVITIES

Blaine Tech Services, Inc. (Blaine) of San Jose, California gauged the site wells and sampled well S-7. Blaine calculated ground water elevations and compiled the analytical data (Table 1). Cambria prepared a ground water elevation contour map (Figure 1). The Blaine report, presenting the laboratory report, is included as Attachment A.

ANTICIPATED FIRST QUARTER 1999 ACTIVITIES

Blaine will gauge and sample selected site wells and tabulate the data. Cambria will prepare a monitoring report.

Oakland, CA
Sonoma, CA
Portland, OR
Seattle, WA

**Cambria
Environmental
Technology, Inc.**

1144 65th Street
Suite B
Oakland, CA 94608
Tel (510) 420-0700
Fax (510) 420-9170



DISCUSSION

Cambria discontinued monitoring of well S-5 as it is apparent that the separate-phase hydrocarbons (SPH) detected in well S-5 originates from the Arco station immediately adjacent to well S-5, and not the Shell-branded station. We request your permission to transfer ownership of well S-5 to Arco or to remove the well.

CLOSING



We appreciate the opportunity to work with you on this project. Please call Daryk Ataide at (510) 420-3339 if you have any questions or comments.

Sincerely,
Cambria Environmental Technology, Inc

Darryk Ataide
Project Environmental Scientist

Diane M. Lundquist, P.E.
Principal Engineer



Attachment: A - Blaine Ground Water Monitoring Report

cc: Karen Petryna, Equiva Services LLC, P.O. Box 6249, Carson, California 90749

g:\albany 999\qm\4q98qm.doc



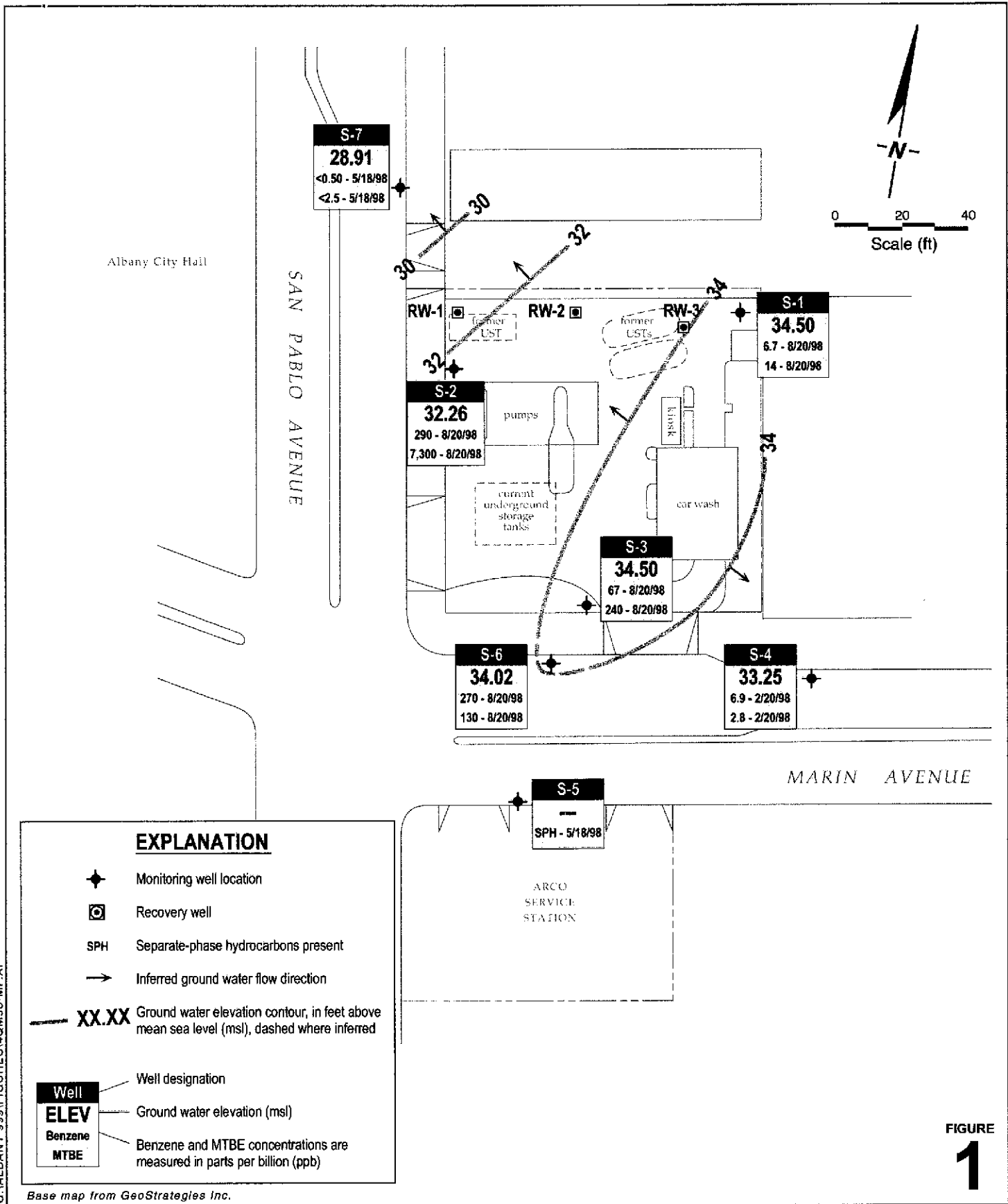

FIGURE 1

Shell-branded Service Station
 999 San Pablo Avenue
 Albany, California
 WIC #204-0079-0109



CAMBRIA

Ground Water Elevation Contour Map

November 6, 1998

G:\ALBANY_999\FIGURES\4QM98-MP.AI



ATTACHMENT A

Blaine Ground Water Monitoring Report

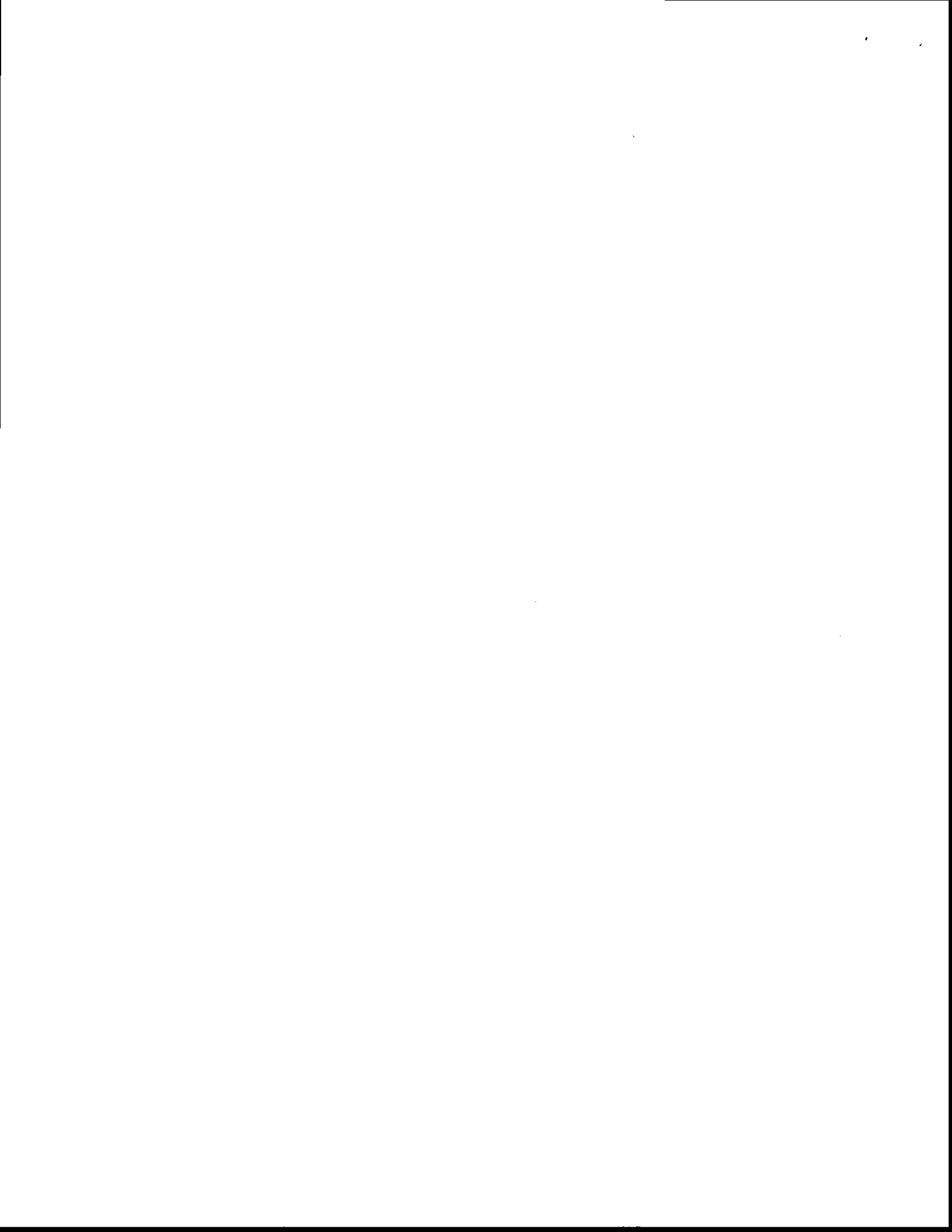

BLAINE
TECH SERVICES INC.



1680 ROGERS AVENUE
SAN JOSE, CA 95112-1105
(408) 573-7771 FAX
(408) 573-0555 PHONE

January 12, 1999

Equiva Services, L.L.C.
P.O. Box 6249
Carson, CA 90749-6249

Attn: Karen Petryna

Shell WIC #204-0079-0109
999 San Pablo Avenue
Albany, California

4th Quarter 1998

Groundwater Monitoring Report 981106-Z-2

Blaine Tech Services, Inc. performs environmental monitoring and documentation as an independent third party. Copies of our Monitoring Report along with the laboratory's Certified Analytical Report are forwarded to the consultant overseeing work at this site. Submission of the assembled documents to interested regulatory agencies will be made by the designated consultant.

Groundwater monitoring at this site was performed in accordance with Standard Operating Procedures provided to the interested regulatory agencies. If you have any questions about the work performed at this site please call me at (408) 573-0555 ext. 201.

Yours truly,



Francis Thie

attachments: Table of Well Gauging Data
Chain of Custody
Field Data Sheets
Certified Analytical Report

cc: Cambria Environmental Technology, Inc.
1144 65th Street, Suite C
Oakland, CA 94608-2411
Attn: Aubrey Cool

(Any professional evaluations or recommendations will be made by the consultant under separate cover.)



Ground Water Chemical Analytical Concentrations
Shell-branded Service Station
 999 San Pablo Ave.
 Albany, California
 Wic #204-0079-0109

Well ID	Sample Date	TOC Elev. (ft)	Measured GW Depth (ft)	Corrected GW Elevation (ft)	SP	Depth to SPH (ft)	TPHg (ug/L)	B (ug/L)	T (ug/L)	E (ug/L)	X (ug/L)	MTBE 8020 (ug/L)	MTBE 8260 (ug/L)	DO (mg/L)
S-1	05/13/1991	42.73	8.24	34.49	0.00	NA	1,500	20	2.6	86	74	NA	NA	NA
S-1	08/23/1991	42.73	8.37	34.36	0.00	NA	2,900	27	<2.5	75	18	NA	NA	NA
S-1	11/07/1991	42.73	8.30	34.43	0.00	NA	2,900	8	2.5	46	26	NA	NA	NA
S-1	01/28/1992	42.73	7.84	34.89	0.00	NA	2,000	11	<2.5	60	20	NA	NA	NA
S-1	05/06/1992	42.73	7.95	34.78	0.00	NA	1,200	5.5	<2.5	80	36	NA	NA	NA
S-1	08/26/1992	42.73	8.24	34.49	0.00	NA	2,000	9.4	<2.5	130	<2.5	NA	NA	NA
S-1	10/28/1992	42.73	8.52	34.21	0.00	NA	1,300	27	3.2	72	13	NA	NA	NA
S-1	01/19/1993	42.73	6.54	36.19	0.00	NA	1,500	13	3	29	31	NA	NA	NA
S-1	04/29/1993	42.73	7.93	34.80	0.00	NA	2,000	15	<2.5	82	<65	NA	NA	NA
S-1	07/22/1993	42.73	8.09	34.64	0.00	NA	620	1.1	4.2	3.5	13	NA	NA	NA
S-1	10/21/1993	42.73	9.43	33.30	0.00	NA	1,200	34	25	15	9.5	NA	NA	NA
S-1	01/04/1994	42.73	8.25	34.48	0.00	NA	860	<2.5	<2.5	5.7	5.3	NA	NA	NA
S-1	04/13/1994	42.73	8.02	34.71	0.00	NA	NA	NA	NA	NA	NA	NA	NA	NA
S-1	07/25/1994	42.73	8.22	34.51	0.00	NA	1,200	8.3	7.4	15	20	NA	NA	NA
S-1	10/10/1994	42.73	8.29	34.44	0.00	NA	NA	NA	NA	NA	NA	NA	NA	NA
S-1	01/26/1995	42.73	6.88	35.85	0.00	NA	1,000	12	0.6	12	420	NA	NA	NA
S-1	04/21/1995	42.73	7.65	35.08	0.00	NA	NA	NA	NA	NA	NA	NA	NA	NA
S-1	07/28/1995	42.73	7.90	34.83	0.00	NA	660	7.2	1	11	8.9	NA	NA	4
S-1	10/31/1995	42.73	7.72	35.01	0.00	NA	NA	NA	NA	NA	NA	NA	NA	NA
S-1	01/10/1996	42.73	8.24	34.49	0.00	NA	1,100	3.5	7	5.1	9.4	NA	NA	7.4
S-1	04/25/1996	42.73	7.74	34.99	0.00	NA	NA	NA	NA	NA	NA	NA	NA	NA
S-1	07/23/1996	42.73	7.92	34.81	0.00	NA	<50	<0.5	<0.5	<0.5	<0.5	<2.5	NA	2.7
S-1	12/10/1996	42.73	7.56	35.17	0.00	NA	NA	NA	NA	NA	NA	NA	NA	0.6
S-1	02/20/1997	42.73	7.95	34.78	0.00	NA	<50	<0.50	<0.50	<0.50	<0.50	<2.5	NA	3
S-1	05/22/1997	42.73	8.11	34.62	0.00	NA	NA	NA	NA	NA	NA	NA	NA	0.5
S-1	08/22/1997	42.73	7.86	34.87	0.00	NA	810	18	<2.0	5.1	4.4	18	NA	3
S-1	11/03/1997	42.73	8.35	34.38	0.00	NA	NA	NA	NA	NA	NA	NA	NA	1.1
S-1	02/20/1998	42.73	6.09	36.64	0.00	NA	<50	<0.50	<0.50	<0.50	<0.50	<2.5	NA	2.9
S-1	05/18/1998	42.73	7.69	35.04	0.00	NA	NA	NA	NA	NA	NA	NA	NA	1.1

Ground Water Chemical Analytical Concentrations
Shell-branded Service Station
 999 San Pablo Ave.
 Albany, California
 Wic #204-0079-0109

Well ID	Sample Date	TOC Elev. (ft)	Measured GW Depth (ft)	Corrected GW Elevation (ft)	SP	Depth to SPH (ft)	TPHg (ug/L)	B (ug/L)	T (ug/L)	E (ug/L)	X (ug/L)	MTBE 8020 (ug/L)	MTBE 8260 (ug/L)	DO (mg/L)
---------	-------------	----------------	------------------------	-----------------------------	----	-------------------	-------------	----------	----------	----------	----------	------------------	------------------	-----------

S-1	08/20/1998	42.73	8.20	34.53	0.00	NA	390	6.7	<0.50	0.64	<0.50	14	NA	1.9
S-1	11/06/1998	42.73	8.10	34.53	0.00	NA	NA	NA	NA	NA	NA	NA	NA	NA
S-2	05/13/1991	40.73	8.50	32.23	0.00	NA	23,000	3,900	230	1,100	3,200	NA	NA	NA
S-2	08/23/1991	40.73	8.80	31.93	0.00	NA	23,000	4,400	260	1,900	2,400	NA	NA	NA
S-2	11/07/1991	40.73	8.61	32.12	0.00	NA	40,000	4,000	160	1,020	3,400	NA	NA	NA
S-2	01/28/1992	40.73	7.80	32.93	0.00	NA	22,000	1,600	70	420	1,700	NA	NA	NA
S-2	05/06/1992	40.73	8.10	32.63	0.00	NA	20,000	2,600	110	860	1,900	NA	NA	NA
S-2	08/26/1992	40.73	8.37	32.36	0.00	NA	42,000	5,000	160	1,100	3,500	NA	NA	NA
S-2	10/28/1992	40.73	8.64	32.09	0.00	NA	34,000	4,800	330	1,600	2,900	NA	NA	NA
S-2	01/19/1993	40.73	5.82	34.91	0.00	NA	20,000	2,300	370	660	1,300	NA	NA	NA
S-2	04/29/1993	40.73	7.70	33.03	0.00	NA	40,000	2,000	67	900	1,900	NA	NA	NA
S-2	07/22/1993	40.73	8.38	32.35	0.00	NA	22,000	3,000	120	1,000	1,600	NA	NA	NA
S-2	10/21/1993	40.73	8.58	32.15	0.00	NA	14,000	2,800	74	870	1,100	NA	NA	NA
S-2	01/04/1994	40.73	7.70	33.03	0.00	NA	21,000	2,100	67	990	770	NA	NA	NA
S-2	04/13/1994	40.73	7.62	33.11	0.00	NA	NA	NA	NA	NA	NA	NA	NA	NA
S-2	07/25/1994	40.73	7.86	32.87	0.00	NA	43,000	2,600	490	990	1,300	NA	NA	NA
S-2	10/10/1994	40.73	8.12	32.61	0.00	NA	NA	NA	NA	NA	NA	NA	NA	NA
S-2	01/26/1995	40.73	6.38	34.35	0.00	NA	21,000	790	12	290	570	NA	NA	5.5
S-2	04/21/1995	40.73	7.01	33.72	0.00	NA	NA	NA	NA	NA	NA	NA	NA	NA
S-2	07/28/1995	40.73	7.82	32.91	0.00	NA	14,000	2,400	360	960	370	NA	NA	4
S-2	10/31/1995	40.73	7.57	33.16	0.00	NA	NA	NA	NA	NA	NA	NA	NA	NA
S-2	01/10/1996	40.73	8.13	32.60	0.00	NA	17,000	1,400	<50	480	170	NA	NA	7.2
S-2	04/25/1996	40.73	7.72	33.01	0.00	NA	NA	NA	NA	NA	NA	NA	NA	NA
S-2	07/23/1996	40.73	8.10	32.63	0.00	NA	16,000	2,700	69	1,100	110	9,500	NA	2.2
S-2	12/10/1996	40.73	8.57	32.16	0.00	NA	NA	NA	NA	NA	NA	NA	NA	0.5
S-2	02/20/1997	40.73	8.15	32.58	0.00	NA	10,000	500	<10	90	130	6,400	NA	4
S-2	05/22/1997	40.73	8.79	31.94	0.00	NA	NA	NA	NA	NA	NA	NA	NA	1.1
S-2	08/22/1997	40.73	8.05	32.68	0.00	NA	23,000	1,300	65	740	290	4,500	NA	3.2

Ground Water Chemical Analytical Concentrations
Shell-branded Service Station
999 San Pablo Ave.
Albany, California
Wic #204-0079-0109

Well ID	Sample Date	TOC Elev. (ft)	Measured		Corrected GW Elevation (ft)	SP	Depth to SPH (ft)	TPHg (ug/L)	B (ug/L)	T (ug/L)	E (ug/L)	X (ug/L)	MTBE 8020 (ug/L)	MTBE 8260 (ug/L)	DO (mg/L)
			GW Depth (ft)	Depth to SPH (ft)											

S-2	11/03/1997	40.73	8.75	31.98	0.00	NA	NA	NA	NA	NA	NA	NA	NA	NA	1.2
S-2	02/20/1998	40.73	6.34	34.39	0.00	NA	450	28	7.4	1.3	7.4	12	35	NA	0.4
S-2	05/18/1998	40.73	7.95	32.78	0.00	NA	NA	NA	NA	NA	NA	NA	NA	NA	0.8
S-2	08/20/1998	40.73	7.73	33.00	0.00	NA	22,000	290	44	44	420	410	7,300	NA	1.9
S-2	11/06/1998	40.73	7.26	32.26	0.00	NA	NA	NA	NA	NA	NA	NA	NA	NA	2.2

S-3	05/13/1991	41.46	7.90	33.56	0.00	NA	3,300	30	3.6	3.6	26	13	NA	NA	NA
S-3	08/23/1991	41.46	8.14	33.32	0.00	NA	2,000	25	4	4	9.3	4.5	NA	NA	NA
S-3	11/07/1991	41.46	7.91	33.55	0.00	NA	4,000	20	3.9	3.9	5	4.9	NA	NA	NA
S-3	01/28/1992	41.46	7.53	33.93	0.00	NA	2,100	21	7.6	7.6	6.7	15	NA	NA	NA
S-3	05/06/1992	41.46	7.55	33.91	0.00	NA	6,600	38	51	51	45	65	NA	NA	NA
S-3	08/26/1992	41.46	7.53	33.93	0.00	NA	5,800	18	12	12	29	60	NA	NA	NA
S-3	10/28/1992	41.46	7.95	33.51	0.00	NA	3,000	55	11	11	16	32	NA	NA	NA
S-3	01/19/1993	41.46	6.12	35.34	0.00	NA	3,100	<5	5.1	5.1	11	16	NA	NA	NA
S-3	04/29/1993	41.46	7.27	34.19	0.00	NA	3,000	31	22	22	<5	14	NA	NA	NA
S-3	07/22/1993	41.46	7.62	33.84	0.00	NA	2,600	3.1	43	43	23	53	NA	NA	NA
S-3	10/21/1993	41.46	7.81	33.65	0.00	NA	2,500	73	14	14	16	32	NA	NA	NA
S-3	01/04/1994	41.46	7.49	33.97	0.00	NA	4,800	13	21	21	<12.5	33	NA	NA	NA
S-3	04/13/1994	41.46	7.32	34.14	0.00	NA	NA	NA	NA	NA	NA	NA	NA	NA	NA
S-3	07/25/1994	41.46	7.66	33.80	0.00	NA	2,600	6.1	4	4	3.8	12	NA	NA	NA
S-3	10/10/1994	41.46	7.49	33.97	0.00	NA	NA	NA	NA	NA	NA	NA	NA	NA	NA
S-3	01/26/1995	41.46	6.50	34.96	0.00	NA	3,600	30	6.8	6.8	5.6	19	NA	NA	NA
S-3	04/21/1995	41.46	6.79	34.67	0.00	NA	NA	NA	NA	NA	NA	NA	NA	NA	NA
S-3	07/28/1995	41.46	7.28	34.18	0.00	NA	3,700	27	9.3	9.3	20	34	NA	NA	4
S-3	10/31/1995	41.46	6.74	34.72	0.00	NA	NA	NA	NA	NA	NA	NA	NA	NA	NA
S-3	01/10/1996	41.46	7.48	33.98	0.00	NA	4,000	10	<0.5	<0.5	13	28	NA	NA	6.1
S-3	04/25/1996	41.46	6.90	34.56	0.00	NA	NA	NA	NA	NA	NA	NA	NA	NA	NA
S-3	07/23/1996	41.46	7.04	34.42	0.00	NA	2,100	20	<0.5	<0.5	<0.5	<0.5	<25	NA	2.1
S-3	12/10/1996	41.46	7.96	33.50	0.00	NA	NA	NA	NA	NA	NA	NA	NA	NA	0.7

Ground Water Chemical Analytical Concentrations
Shell-branded Service Station
999 San Pablo Ave.
Albany, California
Wic #204-0079-0109

Well ID	Sample Date	TOC Elev. (ft)	Measured GW Depth (ft)	Corrected GW Elevation (ft)	SP	Depth to SPH (ft)	TPHg (ug/L)	B (ug/L)	T (ug/L)	E (ug/L)	X (ug/L)	MTBE 8020 (ug/L)	MTBE 8260 (ug/L)	DO (mg/L)
S-3	02/20/1997	41.46	7.44	34.02	0.00	NA	3,500	83	<5.0	18	16	130	NA	3
S-3	05/22/1997	41.46	7.13	34.33	0.00	NA	NA	NA	NA	NA	NA	NA	NA	0.6
S-3	08/22/1997	41.46	6.81	34.65	0.00	NA	4,700	60	12	19	21	40	NA	2.9
S-3	11/03/1997	41.46	7.40	34.06	0.00	NA	NA	NA	NA	NA	NA	NA	NA	0.9
S-3	02/20/1998	41.46	6.55	34.91	0.00	NA	3,400	<10	<10	14	18	85	NA	0.8
S-3	05/18/1998	41.46	6.81	34.65	0.00	NA	NA	NA	NA	NA	NA	NA	NA	0.7
S-3	08/20/1998	41.46	6.98	34.48	0.00	NA	4,400	67	23	9.8	22	240	NA	2.2
S-3	10/06/1998	41.46	5.96	34.90	0.00	NA	NA	NA	NA	NA	NA	NA	NA	NA

S-4	05/13/1991	41.10	7.44	33.66	0.00	NA	<50	<0.5	<0.5	<0.5	<0.5	NA	NA	NA
S-4	08/23/1991	41.10	8.32	32.78	0.00	NA	<50	<0.5	<0.5	<0.5	<0.5	NA	NA	NA
S-4	11/07/1991	41.10	8.32	32.78	0.00	NA	260	<0.5	<0.5	<0.5	<0.5	NA	NA	NA
S-4	01/28/1992	41.10	7.40	33.70	0.00	NA	110	<0.5	<0.5	<0.5	<0.5	NA	NA	NA
S-4	05/06/1992	41.10	7.21	33.89	0.00	NA	54	<0.5	<0.5	<0.5	<0.5	NA	NA	NA
S-4	08/26/1992	41.10	8.13	32.97	0.00	NA	67	<0.5	<0.5	<0.5	<0.5	NA	NA	NA
S-4	10/28/1992	41.10	8.73	32.37	0.00	NA	<50	<0.5	<0.5	<0.5	<0.5	NA	NA	NA
S-4	01/19/1993	41.10	5.86	35.24	0.00	NA	86	1.2	0.7	2.7	15	NA	NA	NA
S-4	04/29/1993	41.10	7.02	34.08	0.00	NA	<50	<0.5	<0.5	<0.5	<0.5	NA	NA	NA
S-4	07/22/1993	41.10	7.76	33.34	0.00	NA	<50	<0.5	<0.5	<0.5	<0.5	NA	NA	NA
S-4	10/21/1993	41.10	8.53	32.57	0.00	NA	<50	<0.5	<0.5	<0.5	<0.5	NA	NA	NA
S-4	01/04/1994	41.10	7.92	33.18	0.00	NA	<50	<0.5	<0.5	<0.5	<0.5	NA	NA	NA
S-4	04/13/1994	41.10	7.71	33.39	0.00	NA	NA	NA	NA	NA	NA	NA	NA	NA
S-4	07/25/1994	41.10	7.82	33.28	0.00	NA	NA	NA	NA	NA	NA	NA	NA	NA
S-4	10/10/1994	41.10	8.15	32.95	0.00	NA	NA	NA	NA	NA	NA	NA	NA	NA
S-4	01/26/1995	41.10	5.73	35.37	0.00	NA	<50	<0.5	<0.5	<0.5	<0.5	NA	NA	NA
S-4	04/21/1995	41.10	6.26	34.84	0.00	NA	NA	NA	NA	NA	NA	NA	NA	NA
S-4	07/28/1995	41.10	7.80	33.30	0.00	NA	NA	NA	NA	NA	NA	NA	NA	NA
S-4	10/31/1995	41.10	8.45	32.65	0.00	NA	NA	NA	NA	NA	NA	NA	NA	NA
S-4	01/10/1996	41.10	8.26	32.84	0.00	NA	<50	1	2.8	<0.5	2.1	NA	NA	2.8

S-4	05/13/1991	41.10	7.44	33.66	0.00	NA	<50	<0.5	<0.5	<0.5	<0.5	NA	NA	NA
S-4	08/23/1991	41.10	8.32	32.78	0.00	NA	<50	<0.5	<0.5	<0.5	<0.5	NA	NA	NA
S-4	11/07/1991	41.10	8.32	32.78	0.00	NA	260	<0.5	<0.5	<0.5	<0.5	NA	NA	NA
S-4	01/28/1992	41.10	7.40	33.70	0.00	NA	110	<0.5	<0.5	<0.5	<0.5	NA	NA	NA
S-4	05/06/1992	41.10	7.21	33.89	0.00	NA	54	<0.5	<0.5	<0.5	<0.5	NA	NA	NA
S-4	08/26/1992	41.10	8.13	32.97	0.00	NA	67	<0.5	<0.5	<0.5	<0.5	NA	NA	NA
S-4	10/28/1992	41.10	8.73	32.37	0.00	NA	<50	<0.5	<0.5	<0.5	<0.5	NA	NA	NA
S-4	01/19/1993	41.10	5.86	35.24	0.00	NA	86	1.2	0.7	2.7	15	NA	NA	NA
S-4	04/29/1993	41.10	7.02	34.08	0.00	NA	<50	<0.5	<0.5	<0.5	<0.5	NA	NA	NA
S-4	07/22/1993	41.10	7.76	33.34	0.00	NA	<50	<0.5	<0.5	<0.5	<0.5	NA	NA	NA
S-4	10/21/1993	41.10	8.53	32.57	0.00	NA	<50	<0.5	<0.5	<0.5	<0.5	NA	NA	NA
S-4	01/04/1994	41.10	7.92	33.18	0.00	NA	<50	<0.5	<0.5	<0.5	<0.5	NA	NA	NA
S-4	04/13/1994	41.10	7.71	33.39	0.00	NA	NA	NA	NA	NA	NA	NA	NA	NA
S-4	07/25/1994	41.10	7.82	33.28	0.00	NA	NA	NA	NA	NA	NA	NA	NA	NA
S-4	10/10/1994	41.10	8.15	32.95	0.00	NA	NA	NA	NA	NA	NA	NA	NA	NA
S-4	01/26/1995	41.10	5.73	35.37	0.00	NA	<50	<0.5	<0.5	<0.5	<0.5	NA	NA	NA
S-4	04/21/1995	41.10	6.26	34.84	0.00	NA	NA	NA	NA	NA	NA	NA	NA	NA
S-4	07/28/1995	41.10	7.80	33.30	0.00	NA	NA	NA	NA	NA	NA	NA	NA	NA
S-4	10/31/1995	41.10	8.45	32.65	0.00	NA	NA	NA	NA	NA	NA	NA	NA	NA
S-4	01/10/1996	41.10	8.26	32.84	0.00	NA	<50	1	2.8	<0.5	2.1	NA	NA	2.8

Ground Water Chemical Analytical Concentrations
Shell-branded Service Station
999 San Pablo Ave.
Albany, California
Wic #204-0079-0109

Well ID	Sample Date	TOC Elev. (ft)	Measured GW Depth (ft)	Corrected GW Elevation (ft)	SP	Depth to SPH (ft)	TPHg (ug/L)	B (ug/L)	T (ug/L)	E (ug/L)	X (ug/L)	MTBE 8020 (ug/L)	MTBE 8260 (ug/L)	DO (mg/L)
---------	-------------	----------------	------------------------	-----------------------------	----	-------------------	-------------	----------	----------	----------	----------	------------------	------------------	-----------

S-4	04/25/1996	41.10	7.14	33.96	0.00	NA	NA	NA	NA	NA	NA	NA	NA	NA
S-4	07/23/1996	41.10	8.18	32.92	0.00	NA	<50	<0.5	<0.5	<0.5	<0.5	<2.5	NA	3.8
S-4	12/10/1996	41.10	7.04	34.06	0.00	NA	NA	NA	NA	NA	NA	NA	NA	3.9
S-4	02/20/1997	41.10	7.07	34.03	0.00	NA	<50	<0.50	<0.50	<0.50	<0.50	6.7	NA	5
S-4	05/22/1997	41.10	6.63	34.47	0.00	NA	NA	NA	NA	NA	NA	NA	NA	0.8
S-4	08/22/1997	41.10	7.69	33.41	0.00	NA	NA	NA	NA	NA	NA	NA	NA	3.7
S-4	11/03/1997	41.10	8.26	32.84	0.00	NA	NA	NA	NA	NA	NA	NA	NA	1.3
S-4	02/20/1998	41.10	5.57	35.53	0.00	NA	130	6.9	4.6	5.2	17	2.8	NA	1.8
S-4	05/18/1998	41.10	7.13	33.97	0.00	NA	NA	NA	NA	NA	NA	NA	NA	1.4
S-4	08/20/1998	41.10	7.77	33.33	0.00	NA	NA	NA	NA	NA	NA	NA	NA	4
S-4	11/06/1998	41.10	7.35	33.75	0.06	NA	NA	NA	NA	NA	NA	NA	NA	9

S-5	05/13/1991	39.99	14.60	30.57	6.48	NA	NA	NA	NA	NA	NA	NA	NA	NA
S-5	08/23/1991	39.99	15.14	29.25	5.50	NA	NA	NA	NA	NA	NA	NA	NA	NA
S-5	11/07/1991	39.99	15.10	29.17	5.35	NA	NA	NA	NA	NA	NA	NA	NA	NA
S-5	01/28/1992	39.99	14.05	29.86	4.90	NA	NA	NA	NA	NA	NA	NA	NA	NA
S-5	05/06/1992	39.99	14.31	30.21	5.66	NA	NA	NA	NA	NA	NA	NA	NA	NA
S-5	08/26/1992	39.99	14.26	28.77	3.80	NA	NA	NA	NA	NA	NA	NA	NA	NA
S-5	10/28/1992	39.99	14.22	28.82	3.81	NA	NA	NA	NA	NA	NA	NA	NA	NA
S-5	01/19/1993	39.99	12.36	30.80	3.96	NA	NA	NA	NA	NA	NA	NA	NA	NA
S-5	04/29/1993	39.99	9.64	31.07	0.90	NA	NA	NA	NA	NA	NA	NA	NA	NA
S-5	07/22/1993	39.99	9.55	31.16	0.90	NA	NA	NA	NA	NA	NA	NA	NA	NA
S-5	10/21/1993	39.99	11.23	29.34	0.73	NA	NA	NA	NA	NA	NA	NA	NA	NA
S-5	01/04/1994	39.99	11.69	29.82	1.90	NA	NA	NA	NA	NA	NA	NA	NA	NA
S-5	04/13/1994	39.99	11.42	29.87	1.62	NA	NA	NA	NA	NA	NA	NA	NA	NA
S-5	07/25/1994	39.99	12.01	29.41	1.79	NA	NA	NA	NA	NA	NA	NA	NA	NA
S-5	10/10/1994	39.99	12.05	29.38	1.80	NA	NA	NA	NA	NA	NA	NA	NA	NA
S-5	01/26/1995	39.99	8.42	32.95	1.72	NA	NA	NA	NA	NA	NA	NA	NA	NA
S-5	04/21/1995	39.99	10.03	30.90	1.17	NA	NA	NA	NA	NA	NA	NA	NA	NA

Ground Water Chemical Analytical Concentrations
Shell-branded Service Station
999 San Pablo Ave.
Albany, California
Wic #204-0079-0109

Well ID	Sample Date	TOC Elev. (ft)	Measured GW Depth (ft)	Corrected GW Elevation (ft)	SP	Depth to SPH (ft)	TPHg (ug/L)	B (ug/L)	T (ug/L)	E (ug/L)	X (ug/L)	MTBE 8020 (ug/L)	MTBE 8260 (ug/L)	DO (mg/L)
---------	-------------	----------------	------------------------	-----------------------------	----	-------------------	-------------	----------	----------	----------	----------	------------------	------------------	-----------

S-5	07/28/1995	39.99	11.42	30.07	1.87	NA	NA	NA	NA	NA	NA	NA	NA	NA
S-5	10/31/1995	39.99	13.21	27.21	0.54	NA	NA	NA	NA	NA	NA	NA	NA	NA
S-5	01/10/1996	39.99	12.05	28.04	0.13	NA	NA	NA	NA	NA	NA	NA	NA	NA
S-5	04/25/1996	39.99	9.68	30.33	0.03	NA	NA	NA	NA	NA	NA	NA	NA	NA
S-5	07/23/1996	39.99	9.82	30.20	0.04	NA	NA	NA	NA	NA	NA	NA	NA	NA
S-5	12/10/1996	39.99	9.10	30.91	0.03	NA	270,000	8,800	29,000	5,200	37,000	<2,500	NA	NA
S-5	02/20/1997	39.99	8.93	31.06	0.00	NA	NA	NA	NA	NA	NA	NA	NA	NA
S-5	05/22/1997	39.99	10.07	29.94	0.02	NA	88,000	2,000	11,000	1,600	19,000	<500	NA	5
S-5	08/22/1997	39.99	10.24	29.77	0.02	NA	NA	NA	NA	NA	NA	NA	NA	NA
S-5	11/03/1997	39.99	10.91	29.10	0.02	NA	NA	NA	NA	NA	NA	NA	NA	NA
S-5	02/20/1998	39.99	7.81	32.20	0.03	NA	NA	NA	NA	NA	NA	NA	NA	NA
S-5	05/18/1998	39.99	9.64	30.37	0.02	NA	NA	NA	NA	NA	NA	NA	NA	NA

S-6	05/13/1991	40.12	7.82	32.30	0.00	NA	13,000	600	140	210	310	NA	NA	NA
S-6	08/23/1991	40.12	9.58	30.54	0.00	NA	9,800	480	80	120	150	NA	NA	NA
S-6	11/07/1991	40.12	10.86	29.26	0.00	NA	6,200	240	23	25	27	NA	NA	NA
S-6	01/28/1992	40.12	8.97	31.15	0.00	NA	5,600	250	15	41	36	NA	NA	NA
S-6	05/06/1992	40.12	8.27	31.85	0.00	NA	7,100	330	29	110	210	NA	NA	NA
S-6	08/26/1992	40.12	9.57	31.55	0.00	NA	13,000	240	<50	56	780	NA	NA	NA
S-6	10/28/1992	40.12	8.90	32.22	0.00	NA	10,000	470	210	67	170	NA	NA	NA
S-6	01/19/1993	40.12	4.84	35.28	0.00	NA	4,800	100	26	27	45	NA	NA	NA
S-6	04/29/1993	40.12	5.61	34.51	0.00	NA	7,000	430	20	<12.5	42	NA	NA	NA
S-6	07/22/1993	40.12	6.56	33.56	0.00	NA	5,800	260	120	65	150	NA	NA	NA
S-6	10/21/1993	40.12	8.73	31.39	0.00	NA	5,500	270	69	120	140	NA	NA	NA
S-6	01/04/1994	40.12	7.14	32.98	0.00	NA	7,100	180	58	63	62	NA	NA	NA
S-6	04/13/1994	40.12	7.21	32.91	0.00	NA	NA	NA	NA	NA	NA	NA	NA	NA
S-6	07/25/1994	40.12	6.85	33.27	0.00	NA	12,000	190	52	30	39	NA	NA	NA
S-6	10/10/1994	40.12	6.20	33.92	0.00	NA	NA	NA	NA	NA	NA	NA	NA	NA
S-6	01/26/1995	40.12	4.89	35.23	0.00	NA	5,800	120	23	24	44	NA	NA	NA

Ground Water Chemical Analytical Concentrations
Shell-branded Service Station
 999 San Pablo Ave.
 Albany, California
 Wic #204-0079-0109

Well ID	Sample Date	TOC Elev. (ft)	Measured GW Depth (ft)	Corrected GW Elevation (ft)	SP	Depth to SPH (ft)	TPHg (ug/L)	B (ug/L)	T (ug/L)	E (ug/L)	X (ug/L)	MTBE 8020 (ug/L)	MTBE 8260 (ug/L)	DO (mg/L)
---------	-------------	----------------	------------------------	-----------------------------	----	-------------------	-------------	----------	----------	----------	----------	------------------	------------------	-----------

S-6	04/21/1995	40.12	5.61	34.51	0.00	NA	NA	NA	NA	NA	NA	NA	NA	NA
S-6	07/28/1995	40.12	5.30	34.82	0.00	NA	4,400	210	23	34	60	NA	NA	3
S-6	10/31/1995	40.12	4.98	35.14	0.00	NA	NA	NA	NA	NA	NA	NA	NA	NA
S-6	01/10/1996	40.12	5.67	34.45	0.00	NA	6,800	170	87	35	105	NA	NA	2.2
S-6	04/25/1996	40.12	5.23	34.89	0.00	NA	NA	NA	NA	NA	NA	NA	NA	NA
S-6	07/23/1996	40.12	5.40	34.72	0.00	NA	2,600	170	<0.5	<0.5	8.5	<25	NA	1.4
S-6	12/10/1996	40.12	6.68	33.44	0.00	NA	NA	NA	NA	NA	NA	NA	NA	0.7
S-6	02/20/1997	40.12	5.70	34.42	0.00	NA	6,300	160	7.7	14	31	77	NA	2
S-6	05/22/1997	40.12	5.49	34.63	0.00	NA	NA	NA	NA	NA	NA	NA	NA	0.9
S-6	08/22/1997	40.12	5.71	34.41	0.00	NA	6,200	160	26	15	27	49	NA	2.8
S-6	11/03/1997	40.12	6.15	33.97	0.00	NA	NA	NA	NA	NA	NA	NA	NA	1.4
S-6	02/20/1998	40.12	5.25	34.87	0.00	NA	4,100	150	<10	<10	15	55	NA	0.4
S-6	05/18/1998	40.12	5.69	34.43	0.00	NA	NA	NA	NA	NA	NA	NA	NA	0.4
S-6	08/20/1998	40.12	6.04	34.08	0.00	NA	7,800	240	38	16	39	110	NA	1.5
S-6	08/20/1998	40.12	6.04	34.08	0.00	NA	8,400	270	30	19	31	130	NA	NA
S-6	11/06/1998	40.12	6.10	34.02	0.00	NA	NA	NA	NA	NA	NA	NA	NA	0.9

S-7	05/13/1991	40.10	10.56	29.54	0.00	NA	<50	<0.5	<0.5	<0.5	<0.5	NA	NA	NA
S-7	08/23/1991	40.10	11.16	28.94	0.00	NA	<50	<0.5	<0.5	<0.5	<0.5	NA	NA	NA
S-7	11/07/1991	40.10	11.48	28.62	0.00	NA	<50	<0.5	<0.5	<0.5	<0.5	NA	NA	NA
S-7	01/28/1992	40.10	10.72	29.38	0.00	NA	<50	<0.5	<0.5	<0.5	<0.5	NA	NA	NA
S-7	05/06/1992	40.10	10.34	29.76	0.00	NA	<50	<0.5	<0.5	<0.5	<0.5	NA	NA	NA
S-7	08/26/1992	40.10	11.13	28.97	0.00	NA	160	<0.5	<0.5	<0.5	<0.5	NA	NA	NA
S-7	10/28/1992	40.10	11.52	28.58	0.00	NA	<50	<0.5	<0.5	<0.5	<0.5	NA	NA	NA
S-7	01/19/1993	40.10	8.68	31.42	0.00	NA	50	1.1	0.6	1.9	9.2	NA	NA	NA
S-7	04/29/1993	40.10	9.90	30.20	0.00	NA	<50	<0.5	<0.5	<0.5	<0.5	NA	NA	NA
S-7	07/22/1993	40.10	NA	NA	0.00	NA	NA	NA	NA	NA	NA	NA	NA	NA
S-7	10/21/1993	40.10	11.10	29.00	0.00	NA	<50	<0.5	<0.5	<0.5	<0.5	NA	NA	NA
S-7	01/04/1994	40.10	10.40	29.70	0.00	NA	<50	<0.5	<0.5	<0.5	<0.5	NA	NA	NA

Ground Water Chemical Analytical Concentrations
Shell-branded Service Station
 999 San Pablo Ave.
 Albany, California
 Wic #204-0079-0109

Well ID	Sample Date	TOC Elev. (ft)	Measured GW Depth (ft)	Corrected GW Elevation (ft)	SP	Depth to SPH (ft)	TPHg (ug/L)	B (ug/L)	T (ug/L)	E (ug/L)	X (ug/L)	MTBE 8020 (ug/L)	MTBE 8260 (ug/L)	DO (mg/L)
S-7	04/13/1994	40.10	10.20	29.90	0.00	NA	<50	1.4	0.61	<0.5	0.64	NA	NA	NA
S-7	07/25/1994	40.10	10.48	29.62	0.00	NA	<50	<0.5	<0.5	<0.5	<0.5	NA	NA	NA
S-7	10/10/1994	40.10	10.64	29.46	0.00	NA	<50	<0.5	<0.5	<0.5	<0.5	NA	NA	NA
S-7	01/26/1995	40.10	7.75	32.35	0.00	NA	<50	<0.5	<0.5	<0.5	<0.5	NA	NA	4.6
S-7	04/21/1995	40.10	8.51	31.59	0.00	NA	<50	<0.5	<0.5	<0.5	<0.5	NA	NA	NA
S-7	07/28/1995	40.10	10.20	29.90	0.00	NA	<50	<0.5	<0.5	<0.5	<0.5	NA	NA	3
S-7	10/31/1995	40.10	10.86	29.24	0.00	NA	<50	<0.5	<0.5	<0.5	<0.5	NA	NA	4.9
S-7	01/10/1996	40.10	10.33	29.77	0.00	NA	<50	<0.5	2	<0.5	2.6	NA	NA	7.6
S-7	04/25/1996	40.10	9.13	30.97	0.00	NA	<50	<0.5	<0.5	<0.5	<0.5	<2.5	NA	6.2
S-7	07/23/1996	40.10	10.18	29.92	0.00	NA	<50	<0.5	<0.5	<0.5	<0.5	14	NA	3.7
S-7	12/10/1996	40.10	9.04	31.06	0.00	NA	<50	<0.5	<0.5	<0.5	<0.5	<2.5	NA	4.6
S-7	02/20/1997	40.10	9.60	30.50	0.00	NA	<50	<0.50	<0.50	<0.50	<0.50	<2.5	NA	5
S-7	05/22/1997	40.10	10.63	29.47	0.00	NA	<50	1.3	<0.50	<0.50	<0.50	5.5	NA	0.8
S-7	08/22/1997	40.10	10.95	29.15	0.00	NA	<50	<0.50	<0.50	<0.50	<0.50	<2.5	NA	2.6
S-7	11/03/1997	40.10	11.29	28.81	0.00	NA	<50	2.2	1.7	0.58	3.4	<2.5	NA	2.6
S-7	02/20/1998	40.10	7.73	32.37	0.00	NA	350	23	13	14	42	3.8	NA	4.6
S-7	05/18/1998	40.10	10.29	29.81	0.00	NA	<50	<0.50	<0.50	<0.50	<0.50	<2.5	NA	4.4
S-7	08/20/1998	40.10	11.00	29.10	0.00	NA	NA	NA	NA	NA	NA	NA	NA	5.4
S-7	11/06/1998	40.10	11.19	28.91	0.00	NA	<50	<0.50	<0.50	<0.50	<0.50	<2.5	NA	5.2

Abbreviations:
 TPHg = Total petroleum hydrocarbons as gasoline by modified EPA Method 8015
 BTEX = benzene, toluene, ethylbenzene, xylenes by EPA Method 8020
 MTBE = methyl-tertiary-butyl ether by EPA Method 8020
 DO = Dissolved Oxygen Readings
 <x = Not detected at detection limit of x
 NA = Not analyzed or not available



Sequoia
Analytical

680 Chesapeake Drive
404 N. Wiget Lane
819 Striker Avenue, Suite 8
1455 McDowell Blvd. North, Ste. D

Redwood City, CA 94063
Walnut Creek, CA 94598
Sacramento, CA 95834
Petaluma, CA 94954

(650) 364-9600
(925) 988-9600
(916) 921-9600
(707) 792-1865

FAX (650) 364-9233
FAX (925) 988-9673
FAX (916) 921-0100
FAX (707) 792-0342

Blaine Tech Services
1680 Rogers Avenue
San Jose, CA 95112
Attention: Fran Thie

Project: Shell 999 San Pablo Ave.

Enclosed are the results from samples received at Sequoia Analytical on November 9, 1998.
The requested analyses are listed below:

<u>SAMPLE #</u>	<u>SAMPLE DESCRIPTION</u>	<u>DATE COLLECTED</u>	<u>TEST METHOD</u>
9811542 -01	LIQUID, S-7	11/06/98	Purgeable TPH/BTEX/MTBE

Please contact me if you have any questions. In the meantime, thank you for the opportunity to work with you on this project.

Very truly yours,

SEQUOIA ANALYTICAL

Peggy Penner
Project Manager





Sequoia
Analytical

680 Chesapeake Drive
404 N. Wiget Lane
819 Striker Avenue, Suite 8
1455 McDowell Blvd. North, Ste. D

Redwood City, CA 94063
Walnut Creek, CA 94598
Sacramento, CA 95834
Petaluma, CA 94954

(650) 364-9600
(925) 988-9600
(916) 921-9600
(707) 792-1865

FAX (650) 364-9233
FAX (925) 988-9673
FAX (916) 921-0100
FAX (707) 792-0342

Blaine Tech Services 1680 Rogers Avenue San Jose, CA 95112	Client Proj. ID: Shell 999 San Pablo Ave. Sample Descript: S-7 Matrix: LIQUID Analysis Method: 8015Mod/8020 Lab Number: 9811542-01	Sampled: 11/06/98 Received: 11/09/98 Analyzed: 11/14/98 Reported: 11/21/98
Attention: Fran Thie		

Total Purgeable Petroleum Hydrocarbons (TPPH) with BTEX and MTBE

Analyte	Detection Limit ug/L	Sample Results ug/L
TPPH as Gas	50	N.D.
Methyl t-Butyl Ether	2.5	N.D.
Benzene	0.50	N.D.
Toluene	0.50	N.D.
Ethyl Benzene	0.50	N.D.
Xylenes (Total)	0.50	N.D.
Chromatogram Pattern:		
Surrogates	Control Limits %	% Recovery
Trifluorotoluene	70 130	110

Analyses reported as N.D. were not present above the stated limit of detection.

SEQUOIA ANALYTICAL - ELAP #1210

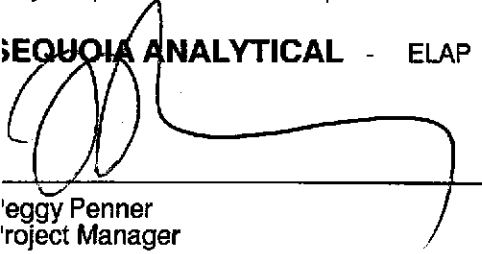
Peggy Penner
Project Manager





Sequoia
Analytical

680 Chesapeake Drive
404 N. Wiget Lane
819 Striker Avenue, Suite 8
1455 McDowell Blvd. North, Ste. D

Redwood City, CA 94063
Walnut Creek, CA 94598
Sacramento, CA 95834
Petaluma, CA 94954

(650) 364-9600
(925) 988-9600
(916) 921-9600
(707) 792-1865

FAX (650) 364-9233
FAX (925) 988-9673
FAX (916) 921-0100
FAX (707) 792-0342

Blaine Tech Services, Inc.
1680 Rogers Ave.
San Jose, CA 95112
Attention: Fran Thie

Client Project ID: Shell 999 San Pablo Ave.
Matrix: Liquid

Work Order #: 9811542 -01

Reported: Dec 3, 1998

QUALITY CONTROL DATA REPORT

Analyte: Gasoline

QC Batch#: 8110236
Analy. Method: EPA 8015M/8020M
Prep. Method: EPA 5030

Analyst: -
MS/MSD #: P811136-01
Sample Conc.: N.D.
Prepared Date: 11/14/98
Analyzed Date: 11/14/98
Instrument I.D.#: -
Conc. Spiked: 1000 µg/L

Result: 1580
MS % Recovery: 96.4

Dup. Result: 1560
MSD % Recov.: 94.4

RPD: 1.27
RPD Limit: 0-12

LCS #: LCS111498

Prepared Date: 11/14/98
Analyzed Date: 11/14/98
Instrument I.D.#: -
Conc. Spiked: 1000 µg/L

LCS Result: 1010
LCS % Recov.: 101

MS/MSD 53-146
LCS 79-127
Control Limits

SEQUOIA ANALYTICAL
Elap #2245

Peggy Penner
Project Manager

Please Note:

The LCS is a control sample of known, interferent-free matrix that is analyzed using the same reagents, preparation, and analytical methods employed for the samples. The matrix spike is an aliquot of sample fortified with known quantities of specific compounds and subjected to the entire analytical procedure. If the recovery of analytes from the matrix spike does not fall within specified control limits due to matrix interference, the LCS recovery is to be used to validate the batch.

** MS=Matrix Spike, MSD=MS Duplicate, RPD=Relative % Difference

9811542.BLA <1>





Sequoia
Analytical

680 Chesapeake Drive
404 N. Wiget Lane
819 Striker Avenue, Suite 8
1455 McDowell Blvd. North, Ste. D

Redwood City, CA 94063
Walnut Creek, CA 94598
Sacramento, CA 95834
Petaluma, CA 94954

(650) 364-9600
(925) 988-9600
(916) 921-9600
(707) 792-1865

FAX (650) 364-9233
FAX (925) 988-9673
FAX (916) 921-0100
FAX (707) 792-0342

Blaine Tech Services 1680 Rogers Avenue San Jose, CA 95112 Attention: Fran Thie	Client Proj. ID: Shell 999 San Pablo Ave. Lab Proj. ID: 9811542	Received: 11/09/98 Reported: 11/21/98
--	--	--

LABORATORY NARRATIVE

In order to properly interpret this report, it must be reproduced in its entirety. This report contains a total of 4 pages including the laboratory narrative, sample results, quality control, and related documents as required (cover page, COC, raw data, etc.).

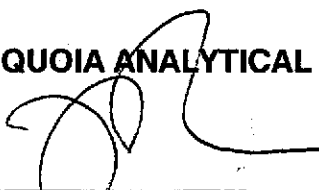
SEQUOIA ANALYTICAL

Peggy Penner
Project Manager





**SHELL OIL COMPANY
RETAIL ENVIRONMENTAL ENGINEERING - WEST**

CHAIN OF CUSTODY RECORD

Serial No: **981106-22** Page 1 of 1

Site Address: 999 San Pablo Ave., Albany, CA
 WIC#: 204-0079-0109
 Shell Engineer: Alex Perez Phone No: (510) 675-6168 Fax #: 675-6172
 Consultant Name & Address:
 Blaine Tech Services, Inc.
 1680 Rogers Ave., San Jose, CA 95112
 Consultant Contact: Fran Thie Phone No: (408) 573-0555 Fax #: 573-7771
 Comments: **981106-22**
 Sampled by: **Sereny**
 Printed Name: **Sereny**

Analysis Required

TPH (EPA 8015 Mod. Gas)	TPH (EPA 8015 Mod. Diesel)	BTEX (EPA 8020/602)	Volatile Organics (EPA 8240)	Test for Disposal	Combination TPH 8015 & BTEX 8020	Asbestos	Container Size	Preparation Used	Composite Y/N
					X				

LAB: Sereny's	TURN AROUND TIME
<input checked="" type="checkbox"/> G.W. Monitoring (441) <input type="checkbox"/> Site Investigation (441) <input type="checkbox"/> Soil Classy/Disposal (442) (Normal) <input type="checkbox"/> Water Classy/Disposal (443) <input type="checkbox"/> Soil/Air Rem. or Spt. O & M (443) <input type="checkbox"/> Water Rem. or Spt. O & M (445) <input type="checkbox"/> Other	24 hours <input type="checkbox"/> 48 hours <input type="checkbox"/> 15 days <input checked="" type="checkbox"/> Other <input type="checkbox"/>

NOTE: Notify Lab as soon as Possible of 24/48 hrs. TAT.

UST AGENCY: BTS	MATERIAL DESCRIPTION	SAMPLE CONDITION/COMMENTS

Relinquished By (signature):	Printed Name:	Date: 11/19/98	Received (signature):	Printed Name:	Date: 11-19-98
<i>[Signature]</i>	Sereny		<i>[Signature]</i>	LAWRENCE A. ANDERSON	
Relinquished By (signature):	Printed Name:	Date:	Received (signature):	Printed Name:	Date:
<i>[Signature]</i>	LAWRENCE A. ANDERSON		<i>[Signature]</i>		
Relinquished By (signature):	Printed Name:	Date:	Received (signature):	Printed Name:	Date:
<i>[Signature]</i>	Sereny		<i>[Signature]</i>		

THE LABORATORY MUST PROVIDE A COPY OF THIS CHAIN-OF-CUSTODY WITH INVOICE AND RESULTS

