

SCALE 1:24,000

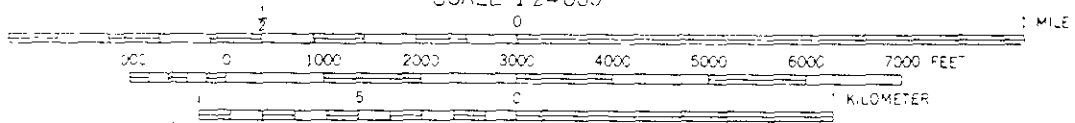

Figure 1.
Site Location Map.

TIRE CENTER



FORMER
TANK
LOCATION

BRIGHTON AVENUE

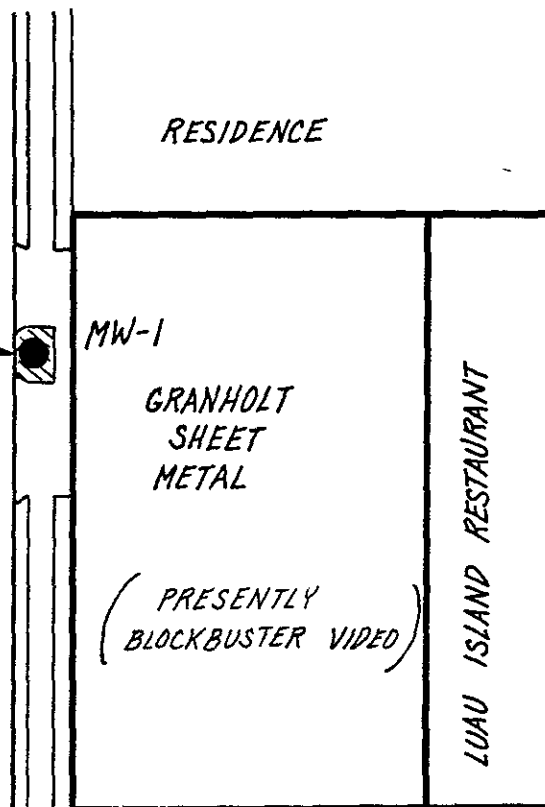

SAN PABLO AVENUE

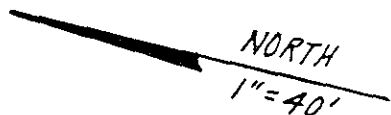

FIGURE 2.
Site Map.

water level in the well had attained 80% or more of the original static water level, a groundwater sample was collected using a clean teflon bailer. The water sample was placed inside appropriate 40 mL VOA vials free of any headspace. The samples were immediately placed on ice, then transported under chain-of-custody to the laboratory at the end of the work day.

At the time the monitoring well was sampled, the following information was recorded in the field: 1) depth-to-water prior to purging, using an electrical well sounding tape, 2) identification of any floating product, sheen, or odor prior to purging, using a clear teflon bailer, 3) sample pH, 4) sample temperature, and 5) specific conductance of the sample. A copy of the well sampling log is included as Attachment A.

All analyses were conducted by a California State DOHS certified laboratory in accordance with EPA recommended procedures. All groundwater samples were analyzed for Total Petroleum Hydrocarbons as Gasoline, and Benzene, Toluene, Ethylbenzene, and Total Xylenes (BTEX).

Water Level Measurement.

The shallow groundwater elevation in MW-1 was measured as 1.36 feet below ground surface on December 7, 1992.

Laboratory Results.

Table 1 presents the results of the laboratory analysis for TPH and BTXE of the groundwater samples collected from monitoring well MW-1.

For this round of sampling, dissolved Gasoline was detected in the one shallow groundwater sample at a concentration of 4,900 $\mu\text{g/L}$ (ppb). In addition, dissolved Benzene, Toluene, Ethylbenzene, and Total Xylenes were detected at concentrations of 12 $\mu\text{g/L}$ (ppb), 16 $\mu\text{g/L}$ (ppb), 35 $\mu\text{g/L}$ (ppb) and 130 $\mu\text{g/L}$ (ppb), respectively.

A copy of the laboratory certificate for the water sample analyses is included as Attachment B.

Table 1.
Groundwater Sampling Results

Well	Date	TPH as Gasoline (ug/L)	Benzene (ug/L)	Toluene (ug/L)	Ethyl-benzene (ug/L)	Total Xylenes (ug/L)
MW-1	06-12-90	770	3.0	ND	3.0	4.0
	02-01-91	740	92	7.0	2.7	3.2
	06-03-91	ND	ND	ND	ND	ND
	12-17-91	560	8.3	11	8.1	61
	03-06-92	700	6.0	9.9	22	40
	05-28-92	1,000	4.2	5.1	15	30
	08-31-92	1,600	13	12	27	57
	12-07-92	4,900	12	16	35	130
Detection Limit		50	0.5	0.5	0.5	0.5

ND = not detected

REPORT OF QUARTERLY GROUNDWATER SAMPLING
GRANHOLT SHEET METAL
501 San Pablo Avenue, Albany, CA

December 21, 1992



EXP. 9-30-95

Gary Aguiar

RCE 34262

Bruce Hageman
Bruce Hageman

ATTACHMENT A

WELL SAMPLING LOG

WELL SAMPLING LOG

Project/No. GRANTHOLT

Page 1 of 1

Site Location RICHMOND, CA

Date 12/7/92

Well No. MW 1

Time Began 1123

Weather WET / 55° F

Completed 1155

EVACUATION DATA

Description of Measuring Point (MP) WELL BOX AT GRADE

Total Sounded Depth of Well Below MP 11.92

- Depth to Water Below MP 1.36

Diameter of Casing 2"

= Water Column in Well 10.56

Gallons in Casing 1.7 + Annular Space 6.5 = Total Gallons 8.2
(30% porosity) (x4 = 32.8)

Gallons Pumped Prior to Sampling 33

Evacuation Method TEFLON BAILER

SAMPLING DATA / FIELD PARAMETERS

Inspection for Free Product: NONE DETECTED
(thickness to 0.1 inch, if any)

Time	<u>1123</u>	<u>1132</u>	<u>1140</u>	<u>1148</u>
Gals Removed	<u>0</u>	<u>11</u>	<u>22</u>	<u>33</u>
Temperature	<u>17.3</u>	<u>17.6</u>	<u>17.4</u>	<u>17.5</u>
Conductivity	<u>800</u>	<u>700</u>	<u>700</u>	<u>700</u>
pH	<u>7.3</u>	<u>7.4</u>	<u>7.5</u>	<u>7.5</u>
Color / Odor	<u>CLR/ORG</u>	<u>LT. GRN/ORG</u>	<u>LT. GRN/ORG</u>	<u>LT. GRN/ORG</u>
Turbidity	<u>LOW</u>	<u>MED</u>	<u>MED</u>	<u>MED</u>

Comments: NONE

ATTACHMENT B

ANALYTICAL RESULTS: GROUNDWATER



PRIORITY ENVIRONMENTAL LABS

Precision Environmental Analytical Laboratory

December 08, 1992

PEL # 9212017

HAGEMAN - AGUIAR, INC.

Attn: Jeffrey Roth

Re: One water sample for Gasoline/BTEX analysis.

Project name: Granholt

Project location: San Pablo Ave., -Berkeley

Date sampled: Dec 07, 1992

Date submitted: Dec 07, 1992

Date extracted: Dec 07, 1992

Date analyzed: Dec 07, 1992

RESULTS:

SAMPLE I.D.	Gasoline (ug/L)	Benzene (ug/L)	Toluene (ug/L)	Ethyl Benzene (ug/L)	Total Xylenes (ug/L)
MW 1	4900	12	16	35	130
Blank	N.D.	N.D.	N.D.	N.D.	N.D.
Spiked Recovery	102.3%	100.7%	98.4%	97.9%	103.1%
Detection limit	50	0.5	0.5	0.5	0.5
Method of Analysis	5030 / 8015	602	602	602	602

David Duong
Laboratory Director

PEL # 9212017

INV # 23251

CHAIN OF CUSTODY RECORD

PROJECT NAME AND ADDRESS: <i>GEANTHOLT</i> <i>SAN PABLO AVE.</i> <i>BERKELEY</i>					SAMPLER: (Signature) <i>[Signature]</i>		ANALYSIS REQUESTED <i>TPH GAS</i> <i>BTEX</i>					
					HAGEMAN - AGUIAR, INC. 3732 Mt. Diablo Blvd., Suite 372 Lafayette, CA 94549 (415)284-1661 (415)284-1664 (FAX)							
CROSS REFERENCE NUMBER	DATE	TIME	SOIL	WATER	STATION LOCATION						REMARKS	
<i>AW 1</i>	<i>12/7/92</i>	<i>11:55</i>		<i>X</i>	<i>MONITORING WELL</i>	<i>X</i>	<i>X</i>					<i>Norm TAT</i>
RELINQUISHED BY: (Signature) <i>[Signature]</i>					DATE <i>12/3/92</i>	RECEIVED BY: (Signature)					DATE	
					TIME <i>1:30</i>						TIME	
RELINQUISHED BY: (Signature)					DATE	RECEIVED BY: (Signature)					DATE	
					TIME						TIME	
RELINQUISHED BY: (Signature)					DATE	RECEIVED BY: (Signature)					DATE	
					TIME						TIME	
RELINQUISHED BY: (Signature)					DATE	RECEIVED FOR LABORATORY BY: (Signature) <i>[Signature]</i>					DATE <i>12/7/92</i>	
					TIME						TIME <i>15:20</i>	