

Rogers Environmental Services

3682

August 29, 1996

REF: 1004-3Q.RPT

Mr. Barney Chan
Environmental Health
Alameda County
1131 Harbor Bay Pkwy
Alameda, CA 94502-6577

**SUBJECT: REPORT OF QUARTERLY MONITORING AT 1234 40TH AVE.,
OAKLAND, CA**

Dear Barney:

I have enclosed a copy of the Quarterly Monitoring report prepared for the Motor Partners site, 1234 40th Ave., Oakland, California. The groundwater sampling results are presented for the third quarterly monitoring period in 1996.

If you have any questions or comments regarding the report, please give me a call.

Sincerely,



Gary Rogers, Ph.D.

cc: Bill Owens

510-791-7153
7/25/96 11:11

QUARTERLY MONITORING REPORT
3rd Quarter, 1996

PROJECT SITE:

MOTOR PARTNERS
1234 40TH AVE., OAKLAND, CALIFORNIA
StID #3682

PREPARED FOR:

Mr. Bill Owens
2221 Olympic Blvd.
Walnut Creek, CA 94595
510-935-3840

SUBMITTED TO:

Mr. Barney Chan
Environmental Health
Alameda County
1131 Harbor Bay Pkwy
Alameda, CA 94502-6577

PREPARED BY:

Gary Rogers, Ph.D.
2657 Bailey Ct.
Fremont, CA 94536
(510) 791-7157

PROJECT NO. 1004.95

August 29, 1996

96 SEP 12 11 23 AM
ENVIRONMENTAL
HEALTH DEPARTMENT

TABLE OF CONTENTS

INTRODUCTION 1

 Project Description 1

 Site Location and Description 1

 Previous Subsurface Investigation 1

GEOLOGY AND HYDROGEOLOGY 5

GROUNDWATER MONITORING 8

 Groundwater Elevation Measurement 8

 Monitoring Well Sampling 8

ANALYTICAL RESULTS 9

SUMMARY AND RECOMMENDATIONS 13

LIMITATIONS 14

APPENDICES 15

 Appendix A - Analytical Data A-1

 Appendix B - Quarterly Monitoring Data Sheets B-1

LIST OF FIGURES

Figure 1. Site Location Map 2
Figure 2. Site Layout Map 3
Figure 3. Groundwater Gradient 6

LIST OF TABLES

Table 1. Well Construction Data 7
Table 2. Static Water Level & Groundwater Elevation Data 10
Table 3. Quarterly Monitoring Analytical Results 11

INTRODUCTION

PROJECT DESCRIPTION

This report discusses the results of quarterly sampling for the third quarter in 1996 at the Motor Partners site, 1234 40th Ave., Oakland, California.

SITE LOCATION AND DESCRIPTION

The project site is known as Motor Partners, 1234 40th Avenue, Oakland, California (Figure 1), located in a commercial/light industrial area. The elevation of the site is approximately 25 feet above mean sea level.

Motor Partners is located at 1234 40th Avenue near Nimitz Highway (880) in the Fruitvale District of Oakland, California (Figure 1). The BART rail tracks are about 500 feet west of the site and San Leandro Bay is less than one mile to the southwest.

Motor Partners utilized the site for auto repair shops. Two underground storage tanks were maintained outside the 1234 40th Avenue building. A 1,000-gallon underground gasoline tank and a 500-gallon underground waste oil tank were located below the sidewalk (Figure 2). No reliable records exist to determine if inventory was lost.

Previous Subsurface Investigations

On Oct. 12, 1990, Semco, Inc. of Modesto, California removed both the 1,000-gallon gasoline tank and the 500-gallon waste oil tank. The concentration of total petroleum hydrocarbons in the gasoline range (TPH-G) below the 1,000-gallon tank was 1,600 mg/Kg. The TPH-G and TPH-D concentrations below the 500-gallon tank were 570 mg/Kg and 650 mg/Kg, respectively. There was no record of groundwater in the excavations. The excavations were backfilled to grade with original spoils.

In January, 1994, SEMCO re-excavated the area to remove contaminated soil, and dispose of the contaminated backfill. During the course of over excavation, it was noted that contamination extended beneath the building and into the street. Utilities prevented further excavation. The over excavation was halted and samples taken from the sidewalls of each excavation. An extraction well casing was installed in each excavation. Clean imported soil was used to backfill the two areas and the sidewalk was resurfaced with Christy boxes housing the two extraction casings.

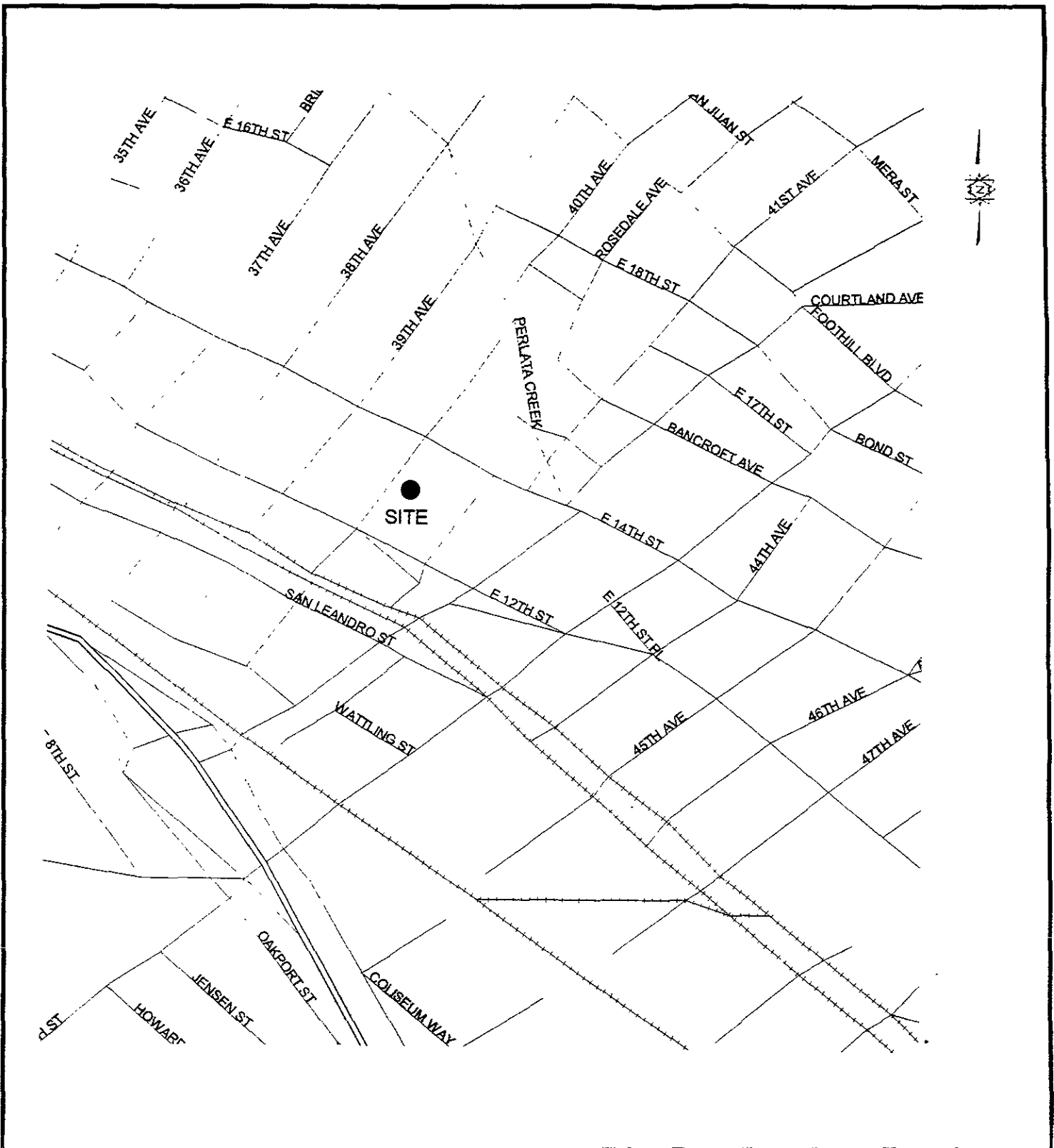

GARY ROGERS, PH.D. ENVIRONMENTAL CONSULTANT 2557 BAILEY CT FREMONT, CA 94536 (510) 79-7157	DESCRIPTION Site Location	FIGURE 1		
	PROJECT LOCATION Motor Partners 1234 40th Ave., Oakland CA			
DRAWN BY [Blank]	DRAWING DATE 8-29-96	PROJECT NUMBER 1004	FILE NAME 1004-7Q.DWG	PROJECT MANAGER [Blank]

Motor Partners 1234 40th Ave. Oakland CA

3

Project No. 1004
Fig. 1004-301

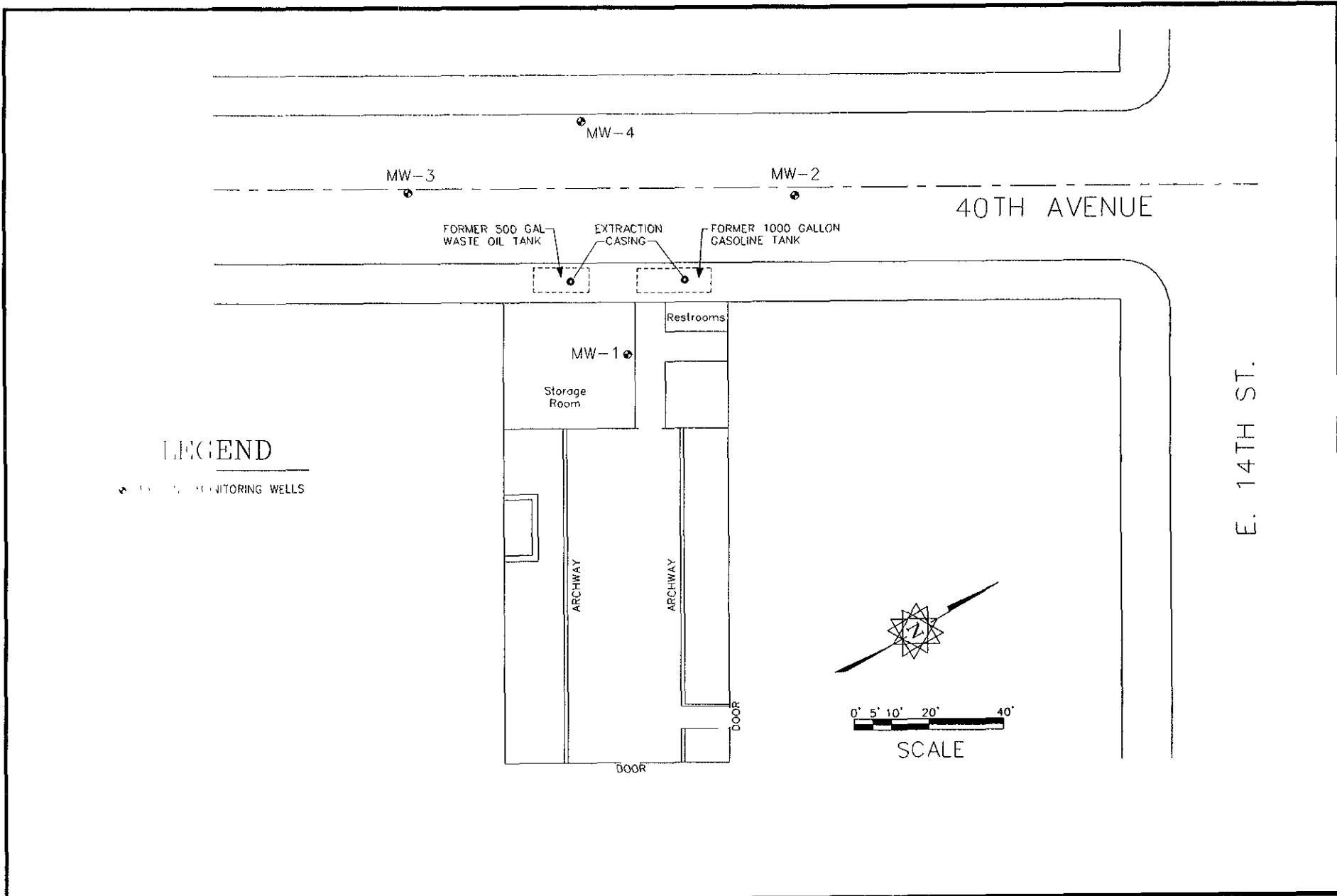

GARY ROGERS, PH.D. ENVIRONMENTAL CONSULTANT 2857 BAILEY C. "OPEMON" CA 94636 (510) 791-7157	DRAWN BY GLR	PROJECT NUMBER 1004	DESCRIPTION <p style="text-align: center;">Site Layout</p>	FIGURE <p style="text-align: center;">2</p>	
	DRAWING DATE 8/29/96	FILE NAME 1004-3Q DWG			
	REVISION BY	PROJECT MANAGER GLR	PROJECT/LOCATION Motor Partners 1234 40th Ave., Oakland		
	REVISION BY	CHECKED BY			

Sampling conducted on January 11, 1994 indicated levels of TPH-gasoline for the former waste oil tank area between 100 and 700 ppm. Levels of TPH-gasoline for the former gasoline tank area ranged from 150 to 1,200 ppm.

GROWTH Environmental completed soil borings at the property between May and June of 1994. Eleven borings were drilled and three monitoring wells were installed. Both soil and groundwater samples were collected from the borings. Soil and groundwater contamination was found in nearly every boring. Levels of TPH-D up to 2,700 ppm were observed on the west side of the building. A sample from inside the building had a TPH-D level of 520 ppm.

Groundwater samples had highest concentrations near the former tank excavations. The highest level of TPH-G was 64,000 ppb. BTEX compounds were found in groundwater samples from all the borings.

The monitoring wells were sampled on June 17, 1994 and December 7, 1994. Contamination was reported in all three wells. Levels of TPH-G were up to 17,000 ppb and Benzene levels were up to 1,200 ppb in MW-1.

A quarterly monitoring sampling event was completed on November 29, 1995. All of the wells showed increased TPH-G and BTEX levels when compared to the previous sampling event. TPH-G levels were up to 67,000 ppb in MW-1. The groundwater gradient was calculated to be in a southwesterly direction.

Additional geoprobe borings were completed along 40th Avenue between November, 1995 and February, 1996 to determine the extent of contamination.

On February 1, 1996, Bay Area Exploration drilled a soil boring across the street from the former underground storage tank excavations at the Motor Partners site (location shown in Figure 3). A two-inch groundwater monitoring well (MW-4) was installed in the boring. The monitoring well was installed according to State of California Water Resource Control Board standards to a depth of 25 feet below grade surface (bgs) and screened from 5 to 25 feet bgs.

GEOLOGY AND HYDROGEOLOGY

Regional Geology.

The site is located on the East Bay Plain about 1.0 mile west of the Oakland Hills, about 1.0 mile east of the San Francisco Bay, and about 0.5 miles north of San Leandro Bay. The property is bounded on the northeast by 14th Street.

The site rests on Quaternary Deposits of various physical and compositional properties. The predominant formation is the Temescal Formation consisting of contemporaneous alluvial units of different origin, lithology, and physical properties. The material ranges from irregularly bedded clay, silt, sand and gravel to lenses of clay, silt, sand, and gravel with Claremont Chert.

The Hayward Fault is approximately 1.5 miles East of the site and is an active historic Fault. The Hayward Fault is the only active fault in the Oakland East Quadrangle.

Regional Hydrogeology.

The site is located within the East Bay Plain which makes up the ground water reservoir in the area. The water bearing capacity varies within the area due to the juxtaposed positions of the various types of soils and strata encountered underneath the East Bay Plain.

In General the water bearing capacities of the Younger Alluvium range from moderately permeable to low permeable soils. Below the Younger Alluvium at a depth of approximately 70 feet lies the Older Alluvium, which yields large to small quantities of well water.

Site Geology. The site soils were characterized using the United Soil Classification System (USCS). During on-site subsurface drilling, CEC (GROWTH) encountered up to two feet of baserock (fill) followed by a 4 to 5 foot layer of dark sandy clay (CL). Below the dark clay to a depth between 7 and 15 feet, a grey sandy gravel was found. Below the sandy gravel the soil varied between a clayey sand to a sandy silty clay (SC). The gravels are poorly sorted, angular to rounded clasts ranging in size from 0.2 cm to 3.0 cm.

Site Hydrogeology. The depth of first water ranged from 8 to 10 feet below the ground surface (bgs) in the borings. Groundwater was encountered within the grey clayey sandy gravel layers.

Motor Partners 1234 40th Ave. Oakland, CA
 Groundwater Monitoring Report

08/29/96

Motor Partners 1234 40th Ave. Oakland, CA
 Groundwater Monitoring Report

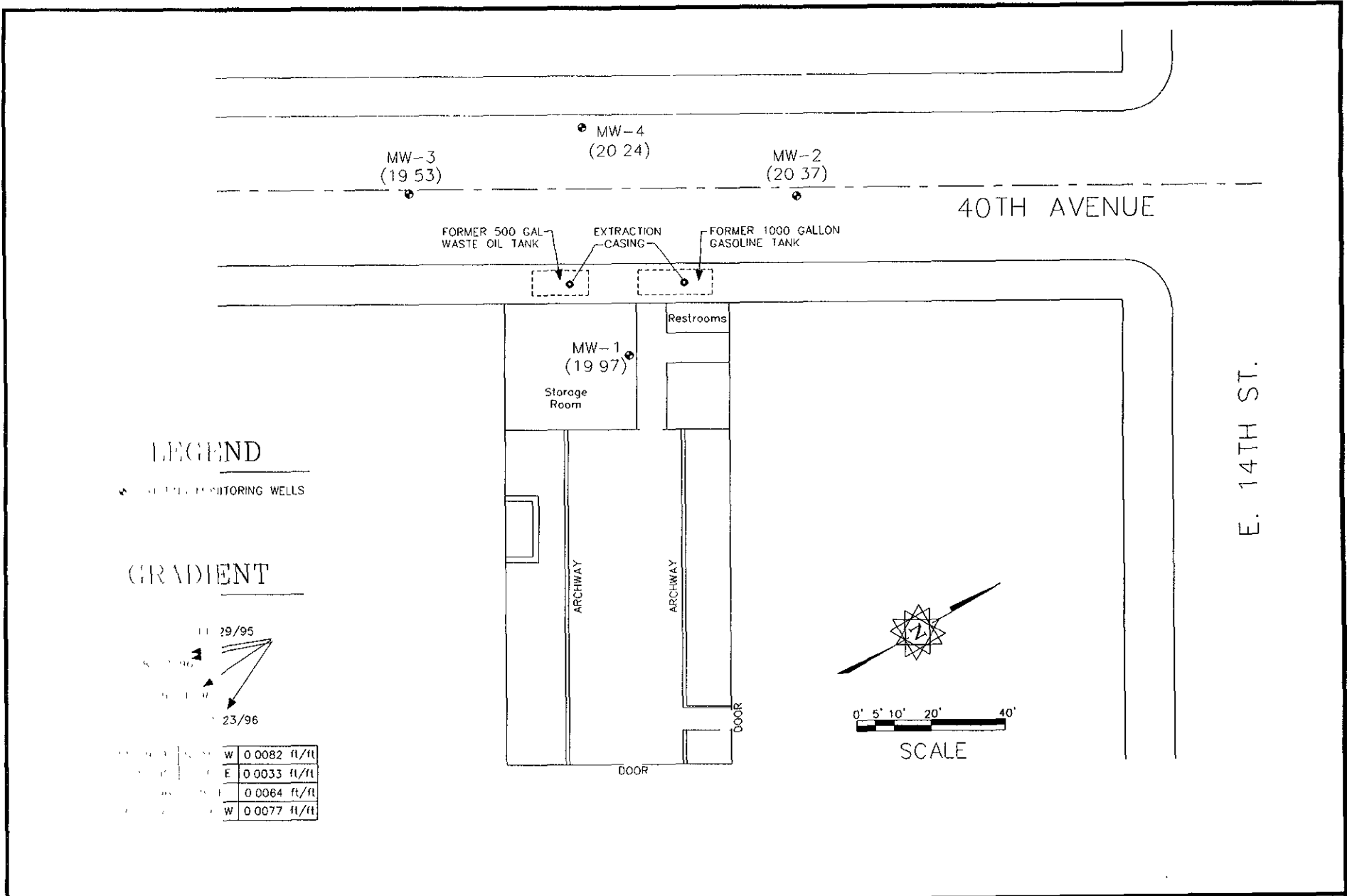

GARY ROGERS, P.E. ENVIRONMENTAL CONSULTANT 2350 HAYLEY CT. BERKELEY, CA 94705 (510) 861-7157	DRAWN BY GLR	PROJECT NUMBER 1004	DESCRIPTION Groundwater Gradient	FIGURE 3	
	DRAWING DATE 8/29/96	FILE NAME 1004-3Q DWG			
	REVISION BY	PROJECT MANAGER GLR	PROJECT LOCATION Motor Partners 1234 40th Ave., Oakland		
	REVISION BY	CHECKED BY			

Table 1
Monitoring Well Construction Data for Motor Partners Site
1234 40th Ave., Oakland, California

	MW-1	MW-2	MW-3	MW-4
Date Drilled	6/15/94	6/14/94	6/14/94	2/1/96
Total Depth	22.5 ft.	22.0 ft.	23.0 ft.	23.0 ft.
Bore Diameter	10 inches	10 inches	10 inches	10 inches
Casing Diameter	2 inch	2 inch	2 inch	2 inch
Well Seal Type	Bentonite Pellets	Bentonite Pellets	Bentonite Pellets	Bentonite Pellets
Well Seal Interval	5.0 - 6.0 bgs	5.0 - 6.0 bgs	5.0 - 6.0 bgs	3.0 - 4.0 bgs
Filter Pack Material	2/14 Lonestar Sand	2/14 Lonestar Sand	2/14 Lonestar Sand	2/14 Lonestar Sand
Filter Pack Interval	6.0 - 17.0 bgs	9.0 - 20.0 bgs	6.5 - 20.0 bgs	4.0 - 25.0 bgs
Screen Slot Size	0.020 in.	0.020 in.	0.020 in.	0.010 in.
Screened Interval	7.0 - 17.0 bgs	10.0 - 20.0 bgs	7.0 - 20.0 bgs	5.0 - 25.0 bgs
Well Elevation ¹	28.43 ft.	28.03 ft.	27.41 ft.	27.34 ft.

¹TOC -Top of Casing Elevations for MW-1, MW-2, and MW-3 were surveyed on 11/17/95 to a City of Oakland benchmark at the northwest corner of the block using an elevation of 29.07 feet above mean sea level. The Top of Casing Elevation for MW-4 was surveyed on 2/14/96 to the TOC Elevations for MW-2 and MW-3.

GROUNDWATER MONITORING

GROUNDWATER ELEVATION MEASUREMENTS

The static water level was measured in all four monitoring wells (MW-1, MW-2, MW-3, and MW-4) on August 22, 1996 and the depths were recorded to the nearest 0.01 foot using an electronic water level sounder. All of the results were recorded on Quarterly Monitoring Data Sheets presented in Appendix B.

MONITORING WELL SAMPLING

The monitoring wells were purged by withdrawing a minimum of three casing volumes from each well using a 2" submersible pump. The purging continued until the turbidity was less than 100 NTU and the temperature, electric conductivity, and pH were relatively stable. Samples were collected when the water levels recovered to at least 80% of the original static level.

A groundwater sample was collected with a disposable Teflon bailer and placed in two 40-ml VOA's and one one-liter amber bottle. The samples were labeled and stored on ice until delivered under a chain of custody to the state certified laboratory. Samples from all four wells (MW-1, MW-2, MW-3, and MW-4) were analyzed for total petroleum hydrocarbons as diesel (TPH-D), using EPA methods modified 8015; as gasoline (TPH-G) using EPA methods 8015/5030; and benzene, toluene, ethylbenzene, and xylenes (BTEX) using EPA methods 8020.

ANALYTICAL RESULTS

GROUNDWATER HYDRAULIC CONDITIONS

Groundwater Elevation. The groundwater elevation data for the monitoring wells is presented in Table 2. Based on groundwater level measurements collected on August 22, 1996, the depth to groundwater in the wells ranged from 7.1 to 8.5 feet below the top of the casing. The groundwater elevations for the wells were as follows; MW-1 was 19.97 feet above mean sea level (msl), MW-2 was 20.37 feet above msl, MW-3 was 19.53 feet above msl, and MW-4 was 20.24 feet above msl.

Groundwater Flow Direction and Gradient. Groundwater flow direction was calculated using three wells (MW-1, MW-2, and MW-3). Groundwater flow direction trended to the southwest (S 19°W) at a gradient of 0.0077 ft/ft. The flow direction and gradient are shown in Figure 3.

LABORATORY DATA

A summary of the analytical results for the monitoring well sampling is presented in Table 3. Copies of all the analytical data sheets from ChromaLab, Inc. are presented in Appendix A.

Table 2
Groundwater Elevation Results at Motor Partners Site
1234 40th Ave., Oakland, California

	DATE	MW-1	MW-2	MW-3	MW-4	GRADIENT
TOC		28.43 ft	28.03 ft	27.41 ft.	27.34	
SWL	11/29/95	10.13	9.31	9.53		S 21° W
GSE		18.3	18.72	17.88		0.0082 ft/ft
SWL	2/23/96	4.59	3.77	3.56	3.17	S 26° E
GSE		23.84	24.26	23.85	24.17	0.0033 ft/ft
SWL	5/21/96	6.04	5.24	5.29	4.68	S 5° E
GSE		22.39	22.79	22.12	22.66	0.0064 ft/ft
SWL	8/22/96	8.46	7.66	7.88	7.10	S 19° W
GSE		19.97	20.37	19.53	20.24	0.0077 ft/ft

TOC - Top of Casing Elevations for MW-1, MW-2, and MW-3 were surveyed on 11/17/95 to City of Oakland benchmark at northwest corner of block, using an elevation of 29.07 feet above mean sea level. The Top of Casing Elevation for MW-4 was surveyed on 2/14/96 to MW-2 and MW-3.

SWL - Static Water Level (ft)

GSE - Groundwater Surface Elevation (feet relative to mean sea level)

Table 3
Quarterly Groundwater Sampling Results at Motor Partners
1234 40th Ave., Oakland, California

Sample I.D. Number	Date Collected	TPH-D ($\mu\text{g/L}$)	TPH-G ($\mu\text{g/L}$)	Benzene ($\mu\text{g/L}$)	Toluene ($\mu\text{g/L}$)	Ethyl Benzene ($\mu\text{g/L}$)	Total Xylenes ($\mu\text{g/L}$)
MW-1	6/17/94	2,400	17,000	1,200	220	1,000	2,600
	11/29/95	53,000	67,000	860	180	1,300	3,100
	2/23/96	25,000	16,000	360	ND	370	740
	5/21/96	650	11,000	290	37	600	1,300
	8/22/96	ND	13,000	270	51	540	1,400
MW-2	6/17/94	370	990	ND	1.3	2.3	4.4
	12/07/94	ND	170	2.1	0.70	0.60	1.7
	11/29/95	200	400	ND	ND	ND	3
	2/23/96	ND	500	ND	ND	ND	ND
	5/21/96	ND	62	ND	ND	ND	1
	8/22/96	ND	120	0.58	0.62	ND	0.62
California Drinking Water MCL		None Listed	None Listed	1.0	1,000	680	1,750
Reporting Limit		50	50	0.5	0.5	0.5	1.0

Notes: All results in $\mu\text{g/l}$ (ppb)
 ND = Not Detected
 NA = Not Analyzed

Table 3 Continued
Quarterly Groundwater Sampling Results at Motor Partners
1234 40th Ave., Oakland, California

Sample I.D. Number	Date Collected	TPH-D ($\mu\text{g/L}$)	TPH-G ($\mu\text{g/L}$)	Benzene ($\mu\text{g/L}$)	Toluene ($\mu\text{g/L}$)	Ethyl Benzene ($\mu\text{g/L}$)	Total Xylenes ($\mu\text{g/L}$)
MW-3	6/17/95	2,200	9,500	330	40	100	74
	12/07/94	1,700	7,500	380	42	130	72
	11/29/95	14,000	9,000	300	49	300	16
	2/23/96	14,000	13,000	270	83	260	67
	5/21/96	350	6,600	220	48	160	66
	8/22/96	ND	4,800	120	34	44	44
MW-4	2/23/96	3,000	6,000	58	36	6	28
	5/21/96	78	1,200	18	2.5	6.2	12
	8/22/96	ND	400	8.6	3.4	1.8	2.6
California Drinking Water MCL		None Listed	None Listed	1.0	1,000	680	1,750
Reporting Limit		50	50	0.5	0.5	0.5	1.0

Notes: All results in $\mu\text{g/l}$ (ppb)
 ND = Not Detected
 NA = Not Analyzed

SUMMARY AND RECOMMENDATIONS

The four monitoring wells at the Motor Partners site were sampled for the third quarter, 1996. The results of the sampling indicate that hydrocarbon contamination is present in groundwater samples from each of the wells. Levels appear to be diminishing in MW-3 and MW-4. Concentrations of hydrocarbons in samples from MW-1 and MW-2 appear to be at similar levels to the previous monitoring period.

TPH-Gasoline and Benzene contamination exists on the property. The highest concentrations reported from the four wells were from the groundwater sample collected at MW-1 (inside the building). Groundwater flow direction for this sampling period was shown to be in a southwesterly direction.

Phase II investigation activities are on-going at the site. It is recommended that quarterly groundwater sampling be continued.

LIMITATIONS

This report has been prepared in accordance with generally accepted environmental, geological and engineering practices. No warranty, either expressed or implied is made as to the professional advice presented herein. The analysis, conclusions, and recommendations contained in this report are based upon site conditions as they existed at the time of the investigation and they are subject to change.

The conclusions presented in this report are professional opinions based solely upon visual observations of the site and vicinity, and interpretation of available information as described in this report. The scope of services performed in execution of this investigation may not be appropriate to satisfy the needs of other users and any use or reuse of this document or its findings, conclusions or recommendations presented herein is at the sole risk of the said user.

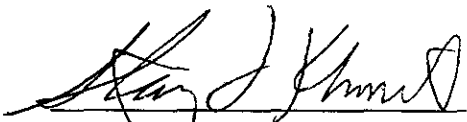

Stanley L. Klemetson Ph.D., P.E.
P.E No. 40087



APPENDIX A

Analytical Results

CHROMALAB, INC.

SUBM #: 9608303 REP: MD
 CLIENT: ROGERSENV
 DUE: 08/29/96
 REF #: 29366

29366
Chain of Custody

Environmental Services (SDB) (DOHS 1094)

DATE 8-22-96 PAGE 1 OF 1

PROJ MGR <u>Gary Rogers</u> COMPANY <u>Rogers Environmental Services</u> ADDRESS <u>2657 Bailey Ct</u> <u>Fremont CA 94536</u>				ANALYSIS REPORT																		NUMBER OF CONTAINERS			
				TPH - Gasoline (EPA 5030, 8015)	TPH - Gasoline (5030, 8015) w/BTEX (EPA 602, 8020)	TPH - Diesel, TEPH (EPA 3510/3550, 8015)	PURGEABLE AROMATICS BTEX (EPA 602, 8020)	PURGEABLE HALOCARBONS (EPA 601, 8010)	VOLATILE ORGANICS (EPA 624, 8240, 524.2)	BASE/NEUTRALS, ACIDS (EPA 625/627, 8270, 525)	TOTAL OIL & GREASE (EPA 5520, B+F, E+F)	PCB (EPA 608, 8080)	PESTICIDES (EPA 608, 8080)	TOTAL RECOVERABLE HYDROCARBONS (EPA 418.1)	LUFT METALS: Cd, Cr, Pb, Zn, Ni	CAM METALS (17)	PRIORITY POLLUTANT METALS (13)	TOTAL LEAD	EXTRACTION (TCLP, STLC)						
SAMPLERS (SIGNATURE) <u>Gary Rogers</u> (PHONE NO.) <u>510-791-7157</u> (FAX NO.) <u>510-742-1552</u>																									
SAMPLE ID	DATE	TIME	MATRIX	PRESERV.																					
MW-2	8-22	12:45	W		X	X																	3		
MW-3	8-22	12:55	W		X	X																	3		
MW-4	8-22	1:05	W		X	X																	3		
MW-1	8-22	1:20	W		X	X																	3		
PROJECT INFORMATION				SAMPLE RECEIPT				RELINQUISHED BY 1						RELINQUISHED BY 2						RELINQUISHED BY 3					
PROJECT NAME <u>Motor Partners</u>				TOTAL NO OF CONTAINERS <u>12</u>				SIGNATURE <u>Gary Rogers</u> 2:50 (TIME)						SIGNATURE <u>Jeff Lindberg</u> 1725 (TIME)						SIGNATURE <u>[Signature]</u> (TIME)					
PROJECT NUMBER <u>1004.95</u>				HEAD SPACE				PRINTED NAME <u>Gary Rogers</u> 8-22-96 (DATE)						PRINTED NAME <u>Jeff Lindberg</u> 8-22-96 (DATE)						PRINTED NAME (DATE)					
P.O. #				REC'D GOOD CONDITION/COLD				COMPANY <u>Rogers Env. Services</u>						COMPANY <u>Chromalab</u>						COMPANY					
TAT <u>STANDARD 5-DAY</u>				CONFORMS TO RECORD				RECEIVED BY <u>Jeff Lindberg</u> 1450 (TIME)						RECEIVED BY						RECEIVED BY (LABORATORY) <u>Chris Rowley</u> 1723 (TIME)					
SPECIAL INSTRUCTIONS/COMMENTS								PRINTED NAME <u>Jeff Lindberg</u> 8-22-96 (DATE)						PRINTED NAME (DATE)						PRINTED NAME <u>Chris Rowley</u> 8-22-96 (DATE)					
								COMPANY <u>Chromalab</u>						COMPANY						COMPANY <u>Chromalab</u> (LAB)					

CHROMALAB, INC.

Environmental Services (SDB)

August 29, 1996

Submission #: 9608303

ROGERS ENVIRONMENTAL SERVICES

Atten: Gary Rogers

Project: MOTOR PARTNERS
Received: August 22, 1996

Project#: 1004.95

re: 4 samples for TPH - Diesel analysis.
Method: EPA 3510/8015M

Matrix: WATER
Run#: 2891
Extracted: August 28, 1996
Analyzed: August 28, 1996

Sampled: August 22, 1996

Spl#	CLIENT SPL ID	DIESEL (ug/L)	REPORTING LIMIT (ug/L)	BLANK RESULT (ug/L)	BLANK SPIKE (%)	DILUTION FACTOR
97131	MW-2	N.D.	50	N.D.	89.0	1
97132	MW-3	N.D.	50	N.D.	89.0	1
97133	MW-4	N.D.	50	N.D.	89.0	1
97134	MW-1	N.D.	50	N.D.	89.0	1

Bruce Havlik
Chemist

Alex Tam
Semivolatiles Supervisor

CHROMALAB, INC.

Environmental Services (SDB)

August 29, 1996

Submission #: 9608303

ROGERS ENVIRONMENTAL SERVICES

Atten: Gary Rogers

Project: MOTOR PARTNERS
Received: August 22, 1996

Project#: 1004.95

re: 1 sample for Gasoline and BTEX compounds analysis.
Method: EPA 5030/8015M/8020

Matrix: WATER

Sampled: August 22, 1996

Run#: 2806

Analyzed: August 24, 1996

Spl#	CLIENT SPL ID	Gasoline (ug/L)	Benzene (ug/L)	Toluene (ug/L)	Ethyl Benzene (ug/L)	Total Xylenes (ug/L)
97134	MW-1	13000	270	51	540	1400
Reporting Limits		2500	25	25	25	25
Blank Result		N.D.	N.D.	N.D.	N.D.	N.D.
Blank Spike Result (%)		86.0	85.6	85.2	88.5	89.8

June Zhao
Chemist

Marianne Alexander
Gas/BTEX Supervisor

CHROMALAB, INC.

Environmental Services (SDB)

August 29, 1996

Submission #: 9608303

ROGERS ENVIRONMENTAL SERVICES

Atten: Gary Rogers

Project: MOTOR PARTNERS
Received: August 22, 1996

Project#: 1004.95

re: 1 sample for Gasoline and BTEX compounds analysis.
Method: EPA 5030/8015M/8020

Matrix: WATER

Sampled: August 22, 1996

Run#: 2806

Analyzed: August 23, 1996

Spl#	CLIENT SPL ID	Gasoline (ug/L)	Benzene (ug/L)	Toluene (ug/L)	Ethyl Benzene (ug/L)	Total Xylenes (ug/L)
97131	MW-2	120	0.58	0.62	N.D.	0.62
Reporting Limits		50	0.50	0.50	0.50	0.50
Blank Result		N.D.	N.D.	N.D.	N.D.	N.D.
Blank Spike Result (%)		86.0	85.6	85.2	88.5	89.8

June Zhao
Chemist

Marianne Alexander
Gas/BTEX Supervisor

CHROMALAB, INC.

Environmental Services (SDB)

August 29, 1996

Submission #: 9608303

ROGERS ENVIRONMENTAL SERVICES

Atten: Gary Rogers

Project: MOTOR PARTNERS
Received: August 22, 1996

Project#: 1004.95

re: 1 sample for Gasoline and BTEX compounds analysis.
Method: EPA 5030/8015M/8020

Matrix: WATER

Sampled: August 22, 1996

Run#: 2806

Analyzed: August 24, 1996

Spl#	CLIENT SPL ID	Gasoline (ug/L)	Benzene (ug/L)	Toluene (ug/L)	Ethyl Benzene (ug/L)	Total Xylenes (ug/L)
97132	MW-3	4800	120	34	44	44
Reporting Limits		500	5.0	5.0	5.0	5.0
Blank Result		N.D.	N.D.	N.D.	N.D.	N.D.
Blank Spike Result (%)		86.0	85.6	85.2	88.5	89.8

June Zhao
Chemist

Marianne Alexander
Gas/BTEX Supervisor

CHROMALAB, INC.

Environmental Services (SDB)

August 29, 1996

Submission #: 9608303

ROGERS ENVIRONMENTAL SERVICES

Atten: Gary Rogers

Project: MOTOR PARTNERS
Received: August 22, 1996

Project#: 1004.95

re: 1 sample for Gasoline and BTEX compounds analysis.
Method: EPA 5030/8015M/8020

Matrix: WATER

Sampled: August 22, 1996

Run#: 2806

Analyzed: August 23, 1996

Spl#	CLIENT SPL ID	Gasoline (ug/L)	Benzene (ug/L)	Toluene (ug/L)	Ethyl Benzene (ug/L)	Total Xylenes (ug/L)
97133	MW-4	400	8.6	3.4	1.8	2.6
Reporting Limits		50	0.50	0.50	0.50	0.50
Blank Result		N.D.	N.D.	N.D.	N.D.	N.D.
Blank Spike Result (%)		86.0	85.6	85.2	88.5	89.8

June Zhao
Chemist

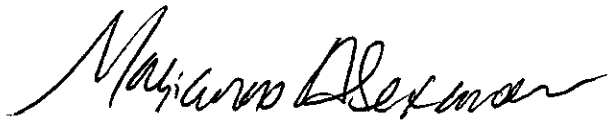
Marianne Alexander
Gas/BTEX Supervisor

APPENDIX B

Quarterly Monitoring Data Sheets

Quarterly Monitoring Data Sheet

Date: 8/22/96
 Project Location: Motor Partners Site
1234 40th Ave., Oakland
 Sampler: G. Rogers

Well Diameter: 2 Inches Well ID: MW-1
 Well Type: Monitoring Well
 Total Depth as Built: 19 ft
 Screened Interval: 7 ft to 17 ft

Water Level Data

Time Depth Sounded: 11:54 AM
 Measured Depth to Water: 8.46 ft
 Measured Total Depth: 18.0 ft

Purge Calculation (Min 3 Casing Volumes)

gal/ft X ft = gal X 3 = gal
0.163 X 9.5 = 1.6 X 3 = 4.7

Purge Data

Time	Flowrate (gpm)	Volume (gal)	Temp (°F)	EC (μs/cm)	pH	Turbidity (NTU)
12:01		0	70.2	643	7.37	>200
12:05		2	69.5	624	6.63	>200
12:08		4	69.2	618	6.61	73
12:14		6	69.0	625	6.60	20

Observations/Comments:

Inside Building

Laboratory Analysis:

Sample at 1:20 PM
 Water depth - 8.49 ft.
 Analyze for TPH-D, TPH-G and BTEX

Data for Volume Calculation:

1 cu ft. = 7.48 gal = 62.4 lbs (approx)	1 gal = 0.134 cu. ft. = 8.34 lbs (approx)
2" well = 0.163 gal/linear ft	3" well = 0.367 gal/linear ft.
4" well = 0.653 gal/linear ft	6" well = 1.469 gal/linear ft

Quarterly Monitoring Data Sheet

Date: <u>8/22/96</u> Project Location: <u>Motor Partners Site</u> <u>1234 40th Ave., Oakland</u> Sampler: <u>G. Rogers</u>	Well Diameter: <u>2 Inches</u> Well ID: <u>MW-2</u> Well Type: <u>Monitoring Well</u> Total Depth as Built: <u>22 ft</u> Screened Interval: <u>10 ft to 20 ft</u>
---	--

Water Level Data	Purge Calculation (Min 3 Casing Volumes)
Time Depth Sounded: <u>9:50 AM</u> Measured Depth to Water: <u>7.66 ft</u> Measured Total Depth: <u>19.2 ft</u>	$\text{gal/ft} \times \text{ft} = \text{gal} \times 3 = \text{gal}$ $0.163 \times 11.5 = 1.9 \times 3 = 5.6$

Purge Data

Time	Flowrate (gpm)	Volume (gal)	Temp (°F)	EC (μs/cm)	pH	Turbidity (NTU)
9:56		0	71.5	725	8.04	>200
10:00		2	72.4	639	7.69	>200
10:05		4	72.4	632	7.43	159
10:09		6	71.8	631	7.44	107
10:14		8	71.4	629	7.40	63

Observations/Comments:

Clear and Sunny

Laboratory Analysis:

Sample at 12:45 PM
 Water depth - 7.69 ft.
 Analyze for TPH-D, TPH-G and BTEX

Data for Volume Calculation:

1 cu. ft. = 7.48 gal = 62.4 lbs (approx)	1 gal = 0.134 cu. ft. = 8.34 lbs (approx)
2" well = 0.163 gal/linear ft	3" well = 0.367 gal/linear ft
4" well = 0.653 gal/linear ft	6" well = 1.469 gal/linear ft

Quarterly Monitoring Data Sheet

Date: <u>8/22/96</u> Project Location: <u>Motor Partners Site</u> <u>1234 40th Ave., Oakland</u> Sampler: <u>G. Rogers</u>	Well Diameter: <u>2 Inches</u> Well ID: <u>MW-3</u> Well Type: <u>Monitoring Well</u> Total Depth as Built: <u>23 ft</u> Screened Interval: <u>7 ft to 20 ft</u>
---	---

Water Level Data	Purge Calculation (Min 3 Casing Volumes)
Time Depth Sounded: <u>10:49 AM</u> Measured Depth to Water: <u>7.88 ft</u> Measured Total Depth: <u>21.5 ft</u>	gal/ft X ft = gal X 3 = gal 0.163 X 13.7 = 2.2 X 3 = 6.7

Purge Data

Time	Flowrate (gpm)	Volume (gal)	Temp (°F)	EC (μs/cm)	pH	Turbidity (NTU)
10:54		0	74.7	647	7.96	126
10:58		2	74.4	657	7.03	96
11:01		4	74.0	661	6.84	21
11:04		6	73.8	664	6.75	9
11:08		8	74.0	669	6.74	7

Observations/Comments:

Clear and Sunny

Laboratory Analysis:

Sample at 12:55 PM
 Water depth - 7.94 ft.
 Analyze for TPH-D, TPH-G and BTEX

Data for Volume Calculation:

1 cu. ft. = 7.48 gal = 62.4 lbs (approx)	1 gal = 0.134 cu. ft. = 8.34 lbs (approx)
2" well = 0.163 gal/linear ft.	3" well = 0.367 gal/linear ft.
4" well = 0.653 gal/linear ft.	6" well = 1.469 gal/linear ft.

Quarterly Monitoring Data Sheet

Date: <u>8/22/96</u> Project Location: <u>Motor Partners Site</u> <u>1234 40th Ave., Oakland</u> Sampler: <u>G. Rogers</u>	Well Diameter: <u>2 Inches</u> Well ID: <u>MW-4</u> Well Type: <u>Monitoring Well</u> Total Depth as Built: <u>25 ft</u> Screened Interval: <u>5 ft to 25 ft</u>
---	---

Water Level Data	Purge Calculation (Min 3 Casing Volumes)
Time Depth Sounded: <u>11:19 AM</u> Measured Depth to Water: <u>7.10 ft</u> Measured Total Depth: <u>24.4 ft</u>	gal/ft X ft = gal X 3 = gal 0.163 X 17.3 = 2.8 X 3 = 8.5

Purge Data

Time	Flowrate (gpm)	Volume (gal)	Temp (°F)	EC (μs/cm)	pH	Turbidity (NTU)
11:25		0	74.1	683	7.83	>200
11:28		2	74.9	682	7.28	>200
11:31		4	74.0	641	7.33	>200
11:34		6	73.9	639	7.34	>200
11:38		8	73.5	615	7.24	>200
11:41		10	73.6	627	7.24	189

Observations/Comments:

Clear and Sunny

Laboratory Analysis:

Sample at 1:05 PM
 Water depth - 7.24 ft.
 Analyze for TPH-D, TPH-G and BTEX

Data for Volume Calculation:

1 cu. ft. = 7.48 gal = 62.4 lbs (approx)	1 gal = 0.134 cu. ft. = 8.34 lbs (approx)
2" well = 0.163 gal/linear ft	3" well = 0.367 gal/linear ft
4" well = 0.653 gal/linear ft.	6" well = 1.469 gal/linear ft.