

**RECEIVED**

By Alameda County Environmental Health at 3:50 pm, May 20, 2014

## Atlantic Richfield Company

**Chuck Carmel**  
Remediation Management Project Manager

PO Box 1257  
San Ramon, CA 94583  
Phone: (925) 275-3804  
Fax: (925) 275-3815  
E-Mail: chuck.carmel@bp.com

May 19, 2014

Re: Well Destruction Report  
Atlantic Richfield Company Station No. 2035  
1001 San Pablo Avenue, Albany, California  
ACEH Case #RO0000100

I declare that to the best of my knowledge at the present time, that the information and/or recommendations contained in the attached document are true and correct.

Submitted by,



**Chuck Carmel**  
Remediation Management Project Manager

Attachment



**WELL DESTRUCTION REPORT**  
**Atlantic Richfield Company Station No. 2035**  
**1001 San Pablo Avenue**  
**Albany, Alameda County, California**

**Prepared for:**

Mr. Chuck Carmel  
Atlantic Richfield Company  
P.O. Box 1257  
San Ramon, CA 94583

**Prepared by:**

Broadbent & Associates, Inc.  
875 Cotting Lane, Suite G  
Vacaville, California 95688  
(530) 566-1400

May 19, 2014

Project No. 06-88-610



**BROADBENT**

875 Cotting Ln., Suite G, Vacaville, CA 95688

[T] 707-455-7290 [F] 707-455-7295

broadbentinc.com

**CREATING SOLUTIONS. BUILDING TRUST.**

May 19, 2014

Project No. 06-88-610

Atlantic Richfield Company  
P.O. Box 1257  
San Ramon, CA 94583  
Submitted via ENFOS

Attn.: Mr. Chuck Carmel

Re: Well Destruction Report, Atlantic Richfield Company Station No. 2035  
1001 San Pablo Avenue, Albany, Alameda County, California  
ACEH Case #RO0000100

Dear Mr. Carmel:

Broadbent & Associates, Inc. (Broadbent) is pleased to submit this *Well Destruction Report* for Atlantic Richfield Company Station No. 2035 located at 1001 San Pablo Avenue, Albany, California (Site). This report documents the permanent decommissioning of nine groundwater monitor wells, one remediation well, four air-sparge wells and nine vapor extraction wells, as recommended in the Alameda County Environmental Health (Appendix A) letter requesting to complete the case closure activities for the Site.

Should you have questions or require additional information, please do not hesitate to contact us at (707) 455-7290.

Sincerely,

BROADBENT & ASSOCIATES, INC.

Lu Damerell, P.G.  
Project Geologist

Kristene Tidwell, P.G., C.Hg.  
Senior Geologist

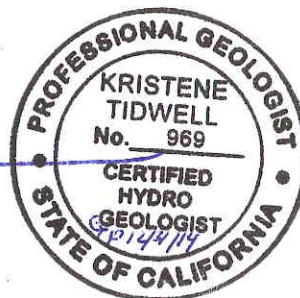

Enclosures

cc: Mr. Jerry Wickham, Alameda County Environmental Health (Submitted via ACEH ftp Site)  
Electronic copy uploaded to GeoTracker

## TABLE OF CONTENTS

<u>No.</u>	<u>Section</u>	<u>Page</u>
1.0	Introduction .....	1
2.0	Site Background .....	1
3.0	Field Activities Performed .....	1
3.1	Preliminary Field Activities .....	1
3.2	Well Destruction Activities .....	2
3.3	Excess Soil Produced .....	2
4.0	Conclusions & Recommendations.....	2
5.0	Limitations.....	2

### **DRAWINGS**

- Drawing 1     Site Location Map
- Drawing 2     Well Destruction Location Map

### **APPENDICES**

- Appendix A    Regulatory Correspondence
- Appendix B    Permits
- Appendix C    Utility Clearance Survey

## WELL DESTRUCTION REPORT

Atlantic Richfield Company Station No. 2035  
1001 San Pablo Avenue, Albany, California  
ACEH Case #RO0000393

### 1.0 INTRODUCTION

On behalf of the Atlantic Richfield Company, RM (a BP affiliated company) Broadbent & Associates, Inc. (Broadbent) has prepared this *Well Destruction Report* (Report) documenting case closure activities at Atlantic Richfield Company Station No. 2035, located at 1001 San Pablo Avenue, Albany, California (Site). Case Closure was recommended by Alameda County Environmental Health (ACEH) in their January 28, 2013 *Well Decommissioning Letter* (Appendix A). This Report presents details of the field activities performed.

### 2.0 SITE BACKGROUND

The Site is an active ARCO-brand gasoline retail station that consists of an AM/PM station building, four underground storage tanks (USTs), and four dispenser islands with a total of eight dispensers. The Site is located on the southeastern corner of San Pablo Avenue and Marin Avenue in Albany, California (Drawing 1). The land use in the immediate vicinity of the Site is mixed commercial and residential. The Site surface area is predominantly covered with concrete and asphalt.

### 3.0 FIELD ACTIVITIES PERFORMED

During March 24 through 28, Broadbent oversaw Gregg Drilling & Testing (Gregg), pressure grout monitor wells MW-1 through MW-9; remediation well RW-1; air-sparge wells AS-1 and AS-2; and vapor wells VW-1 through VW-9. The top two feet of well casing was also removed from each well following completion of pressure grouting. A Site map depicting abandoned well locations is provided as Drawing 2.

#### 3.1 Preliminary Field Activities

Necessary permits from Alameda County Public Works Agency (ACPWA) and an encroachment permit (for MW-6 along San Pablo Avenue – see Drawing 2) from the California Department of Transportation were secured prior to performing the field investigation. Copies of these permits are included in Appendix B. All borings were marked and areas were outlined with white spray paint, and an Underground Service Alert (USA) ticket was secured to notify all member utility companies of the planned field activities. Additionally, all boring locations were cleared for underground utilities by NORCAL Geophysical Consultants, Inc. (NORCAL) on March 14, 2014. NORCAL's survey report is included in Appendix C.

Upon completion of access, notifications, and utility clearance activities, Gregg mobilized to the Site on March 24 through 28, 2014 to clear well locations to 6.5 feet below ground surface (bgs) using air-knife technology.

#### 3.2 Well Destruction Activities

During March 24 through 28, 2014, monitor wells MW-1 through MW-9; remediation well RW-1; air sparge wells AS-1 S, AS-1 V, AS-2 S and AS-2 V; and vapor wells VW-1 through VW-9 were destroyed by pressure grouting. Following completion of pressure grouting, the top two feet of each well casing was

removed from each well. On April 28 through 30, 2014, Cornerstone Environmental Contractors, Inc. removed all well boxes/vaults and completed surfaces to match existing. The MW-6 well box, however, was left in-place due to the complex connection between the vault and the public sidewalk pavement. Each well was destroyed in accordance with ACPWA requirements. California Department of Water Resources Well Completion Reports have been completed, but are not published in this Report due to confidentiality of the records.

### **3.3 EXCESS SOIL PRODUCED**

Excess soil produced during investigation activities is temporarily being stored onsite in Department of Transportation-approved 55-gallon drums until June 2014, when they will be removed and transported to appropriate California-regulated facilities by Belshire Environmental Services, Inc. of Foothill Ranch, CA.

### **4.0 CONCLUSIONS & RECOMMENDATIONS**

Monitor, remediation, air-sparge and vapor extraction wells were abandoned in general accordance ACPWA monitor well destruction requirements. Well abandonment work activities complete the Site case closure process. No further actions are recommended. We anticipate that following submittal of this report, Atlantic Richfield Company will be issued a "Remedial Action Completion Certificate." Atlantic Richfield Company is eagerly awaiting receipt of this documentation.

### **5.0 LIMITATIONS**

This document has been prepared for the exclusive use of Atlantic Richfield Company. The findings presented in this report are based upon the observations of Broadbent field personnel. Services were performed in accordance with the generally accepted standard of practice at the time this report was written. No warranty, expressed or implied, is intended.

#### **ATTACHMENTS:**

- Drawing 1: Site Location Map
- Drawing 2: Well Abandonment Map
  
- Appendix A Regulatory Correspondence
- Appendix B Permits
- Appendix C Utility Clearance Survey

## **DRAWINGS**

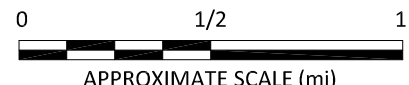
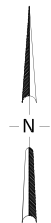
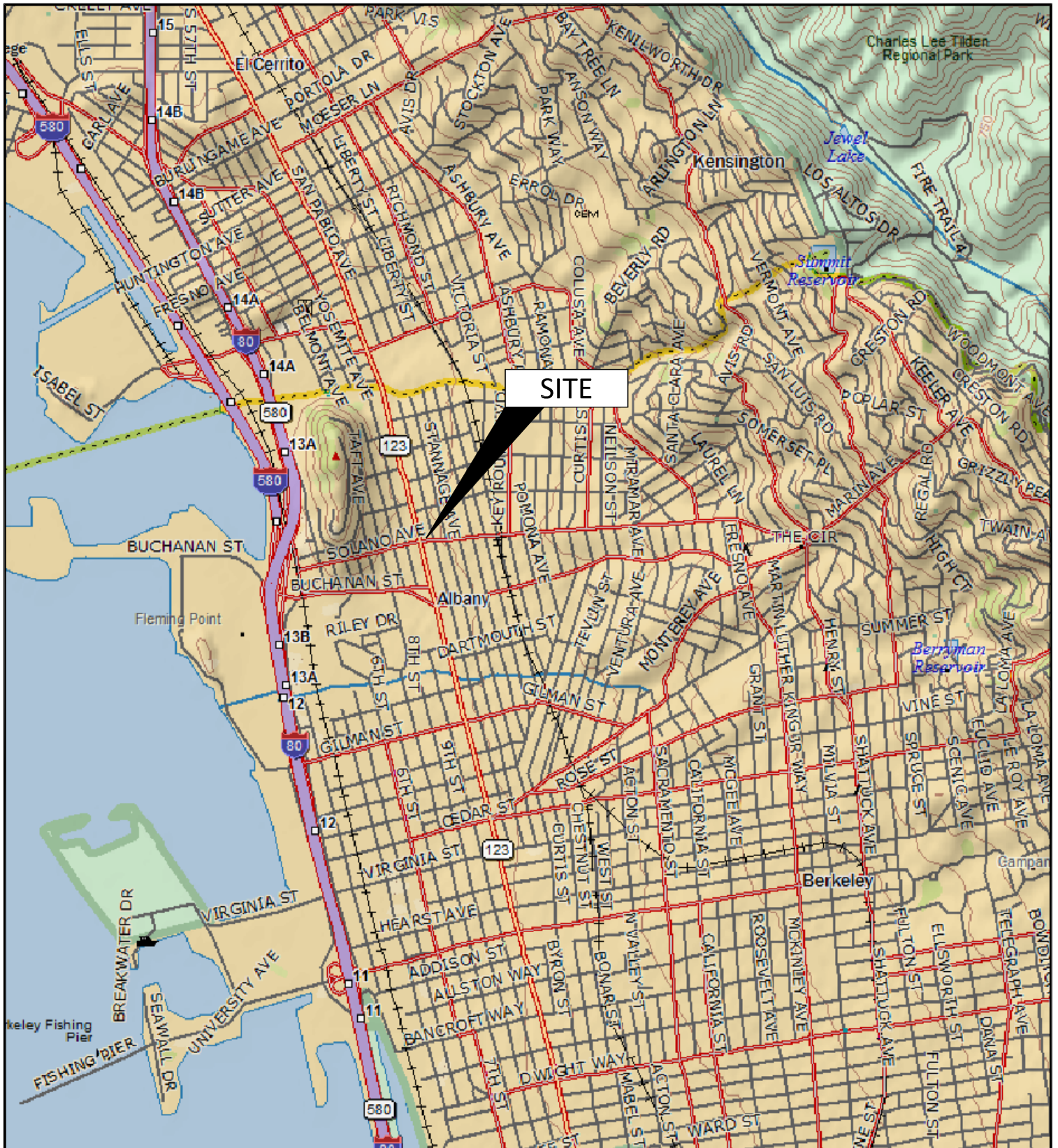

IMAGE SOURCE: DeLorme USA Topo 7.0



1370 Ridgewood Dr., Suite 5  
Chico, California 95973

Project No.: 06-88-610 Date: 4/9/2013

ARCO Service Station #2035  
1001 San Pablo Avenue  
Albany, California

Site Location Map

Drawing

1



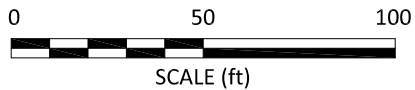
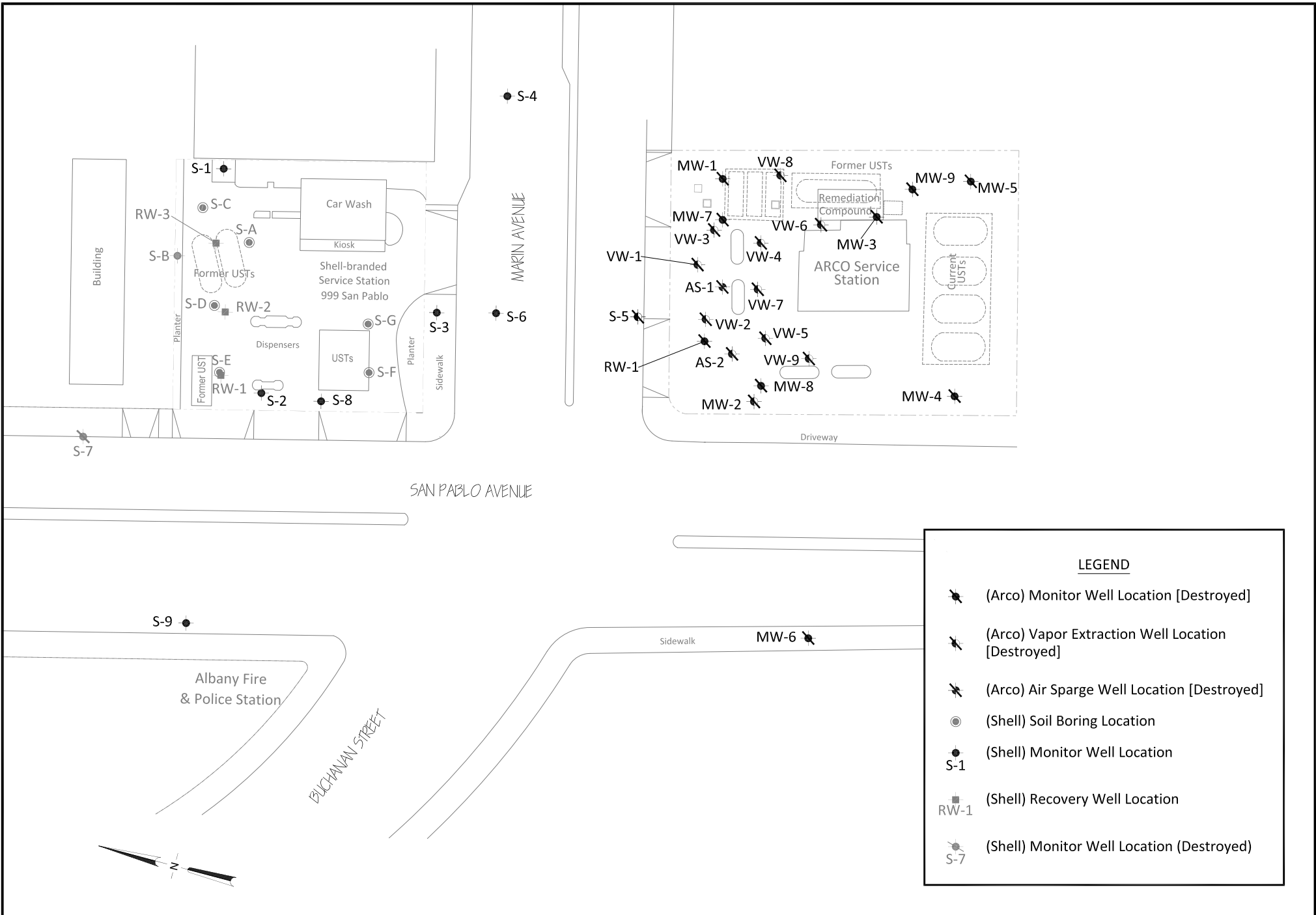

**BROADBENT**  
875 Cotting Lane, Suite G  
Vacaville, California 95688  
Project No.: 06-88-610 Date: 5/45/2014

ARCO Service Station #2035  
1001 San Pablo Avenue  
Albany, California

Well Destruction Location Map

Drawing

2

**APPENDIX A**

REGULATORY CORRESPONDENCE



ENVIRONMENTAL HEALTH SERVICES  
ENVIRONMENTAL PROTECTION  
1131 Harbor Bay Parkway, Suite 250  
Alameda, CA 94502-6577  
(510) 567-6700  
FAX (510) 337-9335

January 28, 2014

Charles Carmel  
Atlantic Richfield Company  
PO Box 1257  
San Ramon, CA 94583  
(Sent via E-mail to: [charles.carmel@bp.com](mailto:charles.carmel@bp.com))

Lawrence and Lynne Freeman Trust and John LeStrange Trust  
Attn: John LeStrange  
1340 Country Commons  
Lake Oswego, OR 97034-2168

Subject: Well Decommissioning for Fuel Leak Case No. RO0000100 and GeoTracker Global ID T0600100081, ARCO #02035, 1001 San Pablo Avenue, Albany, CA 94706

Dear Mr. Carmel:

Alameda County Environmental Health (ACEH) have reviewed the fuel leak case file and case closure summary for the above-referenced site and concur that no further action related to the underground storage tank fuel release is required at this time. No comments were received on the proposed case closure during a public comment period conducted between November 25, 2013 and January 27, 2014. Prior to issuance of remedial action completion certification and case closure, we request that the monitoring wells at the site be properly decommissioned, should the monitoring wells have no further use at the site. Please decommission the monitoring wells and provide documentation of the well decommissioning and waste disposal documentation to this office no later than May 23, 2014. Remedial action completion certification will be issued following receipt of the documentation.

Well destruction permits may be obtained from the Alameda County Public Works Agency (<http://www.acgov.org/pwa/wells/index.shtml>). If you have any questions, please call me at (510) 567-6791 or send me an electronic mail message at [jerry.wickham@acgov.org](mailto:jerry.wickham@acgov.org).

### **TECHNICAL REPORT REQUEST**

Please upload technical reports to the ACEH ftp site (Attention: Jerry Wickham), and to the State Water Resources Control Board's GeoTracker website according to the following schedule and file-naming convention:

- **May 23, 2014** – Well Decommissioning Report  
File to be named: WELL\_DCM\_R\_yyyy-mm-dd RO100

These reports are being requested pursuant to California Health and Safety Code Section 25296.10. 23 CCR Sections 2652 through 2654, and 2721 through 2728 outline the responsibilities of a responsible party in response to an unauthorized release from a petroleum UST system, and require your compliance with this request.

Responsible Parties  
RO0000100  
January 28, 2014  
Page 2

If you have any questions, please call me at (510) 567-6791 or send me an electronic mail message at [jerry.wickham@acgov.org](mailto:jerry.wickham@acgov.org). Case files can be reviewed online at the following website: <http://www.acgov.org/aceh/index.htm>. As your email address does not appear on the cover page of this notification ACEH is requesting you provide your email address so that we can correspond with you quickly and efficiently regarding your case.

Sincerely,

Jerry Wickham, California PG 3766, CEG 1177, and CHG 297  
Senior Hazardous Materials Specialist

Attachment: Responsible Party(ies) Legal Requirements/Obligations

Enclosure: ACEH Electronic Report Upload (ftp) Instructions

cc: Kristene Tidwell, Broadbent, 875 Cotting Lane, Suite G, Vacaville, CA 95688 (*Sent via E-mail to:* [ktidwell@broadbentinc.com](mailto:ktidwell@broadbentinc.com))

Jerry Wickham, ACEH (*Sent via E-mail to:* [jerry.wickham@acgov.org](mailto:jerry.wickham@acgov.org))  
GeoTracker, eFile

## Attachment 1

### Responsible Party(ies) Legal Requirements/Obligations

#### REPORT/DATA REQUESTS

These reports/data are being requested pursuant to Division 7 of the California Water Code (Water Quality), Chapter 6.7 of Division 20 of the California Health and Safety Code (Underground Storage of Hazardous Substances), and Chapter 16 of Division 3 of Title 23 of the California Code of Regulations (Underground Storage Tank Regulations).

#### ELECTRONIC SUBMITTAL OF REPORTS

ACEH's Environmental Cleanup Oversight Programs (Local Oversight Program [LOP] for unauthorized releases from petroleum Underground Storage Tanks [USTs], and Site Cleanup Program [SCP] for unauthorized releases of non-petroleum hazardous substances) require submission of reports in electronic format pursuant to Chapter 3 of Division 7, Sections 13195 and 13197.5 of the California Water Code, and Chapter 30, Articles 1 and 2, Sections 3890 to 3895 of Division 3 of Title 23 of the California Code of Regulations (23 CCR). Instructions for submission of electronic documents to the ACEH FTP site are provided on the attached "Electronic Report Upload Instructions."

Submission of reports to the ACEH FTP site is in addition to requirements for electronic submittal of information (ESI) to the State Water Resources Control Board's (SWRCB) Geotracker website. In April 2001, the SWRCB adopted 23 CCR, Division 3, Chapter 16, Article 12, Sections 2729 and 2729.1 (Electronic Submission of Laboratory Data for UST Reports). Article 12 required electronic submittal of analytical laboratory data submitted in a report to a regulatory agency (effective September 1, 2001), and surveyed locations (latitude, longitude and elevation) of groundwater monitoring wells (effective January 1, 2002) in Electronic Deliverable Format (EDF) to Geotracker. Article 12 was subsequently repealed in 2004 and replaced with Article 30 (Electronic Submittal of Information) which expanded the ESI requirements to include electronic submittal of any report or data required by a regulatory agency from a cleanup site. The expanded ESI submittal requirements for petroleum UST sites subject to the requirements of 23 CCR, Division, 3, Chapter 16, Article 11, became effective December 16, 2004. All other electronic submittals required pursuant to Chapter 30 became effective January 1, 2005. Please visit the SWRCB website for more information on these requirements. ([http://www.waterboards.ca.gov/water\\_issues/programs/ust/electronic\\_submittal/](http://www.waterboards.ca.gov/water_issues/programs/ust/electronic_submittal/))

#### PERJURY STATEMENT

All work plans, technical reports, or technical documents submitted to ACEH must be accompanied by a cover letter from the responsible party that states, at a minimum, the following: "I declare, under penalty of perjury, that the information and/or recommendations contained in the attached document or report is true and correct to the best of my knowledge." This letter must be signed by an officer or legally authorized representative of your company. Please include a cover letter satisfying these requirements with all future reports and technical documents submitted for this fuel leak case.

#### PROFESSIONAL CERTIFICATION & CONCLUSIONS/RECOMMENDATIONS

The California Business and Professions Code (Sections 6735, 7835, and 7835.1) requires that work plans and technical or implementation reports containing geologic or engineering evaluations and/or judgments be performed under the direction of an appropriately registered or certified professional. For your submittal to be considered a valid technical report, you are to present site specific data, data interpretations, and recommendations prepared by an appropriately licensed professional and include the professional registration stamp, signature, and statement of professional certification. Please ensure all that all technical reports submitted for this fuel leak case meet this requirement.

#### UNDERGROUND STORAGE TANK CLEANUP FUND

Please note that delays in investigation, late reports, or enforcement actions may result in your becoming ineligible to receive grant money from the state's Underground Storage Tank Cleanup Fund (Senate Bill 2004) to reimburse you for the cost of cleanup.

#### AGENCY OVERSIGHT

If it appears as though significant delays are occurring or reports are not submitted as requested, we will consider referring your case to the Regional Board or other appropriate agency, including the County District Attorney, for possible enforcement actions. California Health and Safety Code, Section 25299.76 authorizes enforcement including administrative action or monetary penalties of up to \$10,000 per day for each day of violation.

<b>Alameda County Environmental Cleanup Oversight Programs (LOP and SCP)</b>	<b>REVISION DATE:</b> July 25, 2012
	<b>ISSUE DATE:</b> July 5, 2005
	<b>PREVIOUS REVISIONS:</b> October 31, 2005; December 16, 2005; March 27, 2009; July 8, 2010
<b>SECTION:</b> Miscellaneous Administrative Topics & Procedures	<b>SUBJECT:</b> Electronic Report Upload (ftp) Instructions

The Alameda County Environmental Cleanup Oversight Programs (petroleum UST and SCP) require submission of all reports in electronic form to the county's FTP site. Paper copies of reports will no longer be accepted. The electronic copy replaces the paper copy and will be used for all public information requests, regulatory review, and compliance/enforcement activities.

## REQUIREMENTS

- **Please do not submit reports as attachments to electronic mail.**
- Entire report including cover letter must be submitted to the ftp site as a **single Portable Document Format (PDF) with no password protection.**
- It is **preferable** that reports be converted to PDF format from their original format, (e.g., Microsoft Word) rather than scanned.
- **Signature pages and perjury statements must be included and have either original or electronic signature.**
- **Do not password protect the document.** Once indexed and inserted into the correct electronic case file, the document will be secured in compliance with the County's current security standards and a password. **Documents with password protection will not be accepted.**
- Each page in the PDF document should be rotated in the direction that will make it easiest to read on a computer monitor.
- Reports must be named and saved using the following naming convention:

RO#\_Report Name\_Year-Month-Date (e.g., RO#5555\_WorkPlan\_2005-06-14)

## Submission Instructions

- 1) Obtain User Name and Password
  - a) Contact the Alameda County Environmental Health Department to obtain a User Name and Password to upload files to the ftp site.
    - i) Send an e-mail to [.loptoxic@acgov.org](mailto:.loptoxic@acgov.org)
  - b) In the subject line of your request, be sure to include **"ftp PASSWORD REQUEST"** and in the body of your request, include the **Contact Information, Site Addresses,** and the **Case Numbers (RO# available in Geotracker) you will be posting for.**
- 2) Upload Files to the ftp Site
  - a) Using Internet Explorer (IE4+), go to <://alcoftp1.acgov.org>
    - (i) Note: Netscape, Safari, and Firefox browsers will not open the FTP site as they are NOT being supported at this time.
  - b) Click on Page located on the Command bar on upper right side of window, and then scroll down to Open FTP Site in Windows Explorer.
  - c) Enter your User Name and Password. (Note: Both are Case Sensitive.)
  - d) Open "My Computer" on your computer and navigate to the file(s) you wish to upload to the ftp site.
  - e) With both "My Computer" and the ftp site open in separate windows, drag and drop the file(s) from "My Computer" to the ftp window.
- 3) Send E-mail Notifications to the Environmental Cleanup Oversight Programs
  - a) Send email to [.loptoxic@acgov.org](mailto:.loptoxic@acgov.org) notify us that you have placed a report on our ftp site.
  - b) Copy your Caseworker on the e-mail. Your Caseworker's e-mail address is the entire first name then a period and entire last name @acgov.org. (e.g., firstname.lastname@acgov.org)
  - c) The subject line of the e-mail must start with the RO# followed by **Report Upload.** (e.g., Subject: RO1234 Report Upload) If site is a new case without an RO#, use the street address instead.
  - d) If your document meets the above requirements and you follow the submission instructions, you will receive a notification by email indicating that your document was successfully uploaded to the ftp site.

**APPENDIX B**

PERMITS

# STANDARD ENCROACHMENT PERMIT APPLICATION

TR-0100 (REV. 07/2007)

Permission is requested to encroach on the State Highway right-of-way as follows:  
 (Complete all **BOXES** [write N/A if not applicable])  
 This application is not complete until all requirements have been approved.

FOR CALTRANS USE	
PERMIT NO.	
DIST/CO/RTE/PM	
SIMPLEX STAMP	
DATE OF SIMPLEX STAMP	

1. COUNTY	2. ROUTE	3. POSTMILE
-----------	----------	-------------

4. ADDRESS OR STREET NAME	5. CITY
---------------------------	---------

6. CROSS STREET (Distance and direction from site)	7. PORTION OF RIGHT-OF-WAY
--	----------------------------

8. WORK TO BE PERFORMED BY <input type="checkbox"/> OWN FORCES <input type="checkbox"/> CONTRACTOR	9. EST. START DATE	10. EST. COMPLETION DATE
---	--------------------	--------------------------

11. EXCAVATION	MAX. DEPTH	AVG. DEPTH	AVG. WIDTH	LENGTH	SURFACE TYPE
----------------	------------	------------	------------	--------	--------------

12. EST. COST IN STATE HIGHWAY RIGHT-OF-WAY	FUNDING SOURCE(S) <input type="checkbox"/> FEDERAL <input type="checkbox"/> STATE <input type="checkbox"/> LOCAL <input type="checkbox"/> PRIVATE
---	--

13. PIPES	PRODUCT TYPE	DIAMETER	VOLTAGE / PSIG	14. CALTRANS PROJECT E.A. NUMBER
-----------	--------------	----------	----------------	----------------------------------

15.  Double Permit   Parent Permit Number \_\_\_\_\_  
 Applicant's Reference Number / Utility Work Order Number \_\_\_\_\_

16. Have your plans been reviewed by another Caltrans branch?    NO    YES (If "YES")   Who? \_\_\_\_\_

17. Completely describe work to be done within STATE highway right-of-way :  
 Attach 6 complete sets of **FOLDED** plans (folded 8.5" x 11"), and any applicable specifications, calculations, maps, etc.  
 All dimensions shall be in U.S. Customary (English) Units.

18. Is a city, county, or other agency involved in the approval of this project?

YES (If "YES", check type of project and attach environmental documentation and conditions of approval.)

COMMERCIAL DEVELOPMENT    BUILDING    GRADING    OTHER \_\_\_\_\_

CATEGORICALLY EXEMPT    NEGATIVE DECLARATION    ENVIRONMENTAL IMPACT REPORT    OTHER \_\_\_\_\_

NO (If "NO", please check the category below which best describes the project, and complete page 4 of this application.)

DRIVEWAY OR ROAD APPROACH, RECONSTRUCTION, MAINTENANCE, OR RESURFACING    FENCE

PUBLIC UTILITY MODIFICATIONS, EXTENSIONS, HOOKUPS    MAILBOX

FLAGS, SIGNS, BANNERS, DECORATIONS, PARADES AND CELEBRATIONS    EROSION CONTROL

OTHER \_\_\_\_\_    LANDSCAPING

19. Will this project cause a substantial change in the significance of a historical resource (45 years or older), or cultural resource?    YES    NO  
 (If "YES", provide a description)

20. Is this project on an existing highway or street where the activity involves removal of a scenic resource including a significant tree or stand of trees, a rock outcropping or a historic building?    YES    NO (If "YES", provide a description)

21. Is work being done on applicant's property?    YES    NO (If "YES", attach site and grading plans.)



**STANDARD ENCROACHMENT PERMIT APPLICATION**

TR-0100 (REV. 07/2007)

PERMIT NO. \_\_\_\_\_

22. Will this proposed project require the disturbance of soil?  YES  NO

If "YES", estimate the area within State Highway right-of-way in square feet AND acres: \_\_\_\_\_ (ft<sup>2</sup>) AND \_\_\_\_\_ (acres)  
 estimate the area outside of State Highway right-of-way in square feet AND acres: \_\_\_\_\_ (ft<sup>2</sup>) AND \_\_\_\_\_ (acres)

23. Will this proposed project require dewatering?  YES  NO

If "YES", estimate total gallons AND gallons/month. \_\_\_\_\_ (gallons) AND \_\_\_\_\_ (gallons/month)

SOURCE\*:  STORMWATER  NON-STORMWATER(\*See Caltrans SWMP for definitions of non-storm water discharge: <http://www.dot.ca.gov/hq/env/stormwater/index.htm> )

24. How will any storm water or ground water be disposed of from within or near the limits of this proposed project?

 Storm Drain System  Combined Sewer / Storm System  Storm Water Retention Basin Other (explain): \_\_\_\_\_PLEASE READ THE FOLLOWING CLAUSES PRIOR TO SIGNING THIS ENCROACHMENT PERMIT APPLICATION.

**The applicant, understands and herein agrees to that an encroachment permit can be denied, and/or a bond required for non-payment of prior or present encroachment permit fees. Encroachment Permit fees may still be due when an application is withdrawn or denied, and that a denial may be appealed, in accordance with the California Streets and Highways Code, Section 671.5. All work shall be done in accordance with Caltrans rules and regulations subject to inspection and approval.**

**The applicant, understands and herein agrees to the general provisions, special provisions and conditions of the encroachment permit, and to indemnify and hold harmless the State, its officers, directors, agents, employees and each of them (Indemnitees) from and against any and all claims, demands, causes of action, damages, costs, expenses, actual attorneys' fees, judgments, losses and liabilities of every kind and nature whatsoever (Claims) arising out of or in connection with the issuance and/or use of this encroachment permit and the placement and subsequent operation and maintenance of said encroachment for: 1) bodily injury and/or death to persons including but not limited to the Applicant, the State and its officers, directors, agents and employees, the Indemnitees, and the public; and 2) damage to property of anyone. Except as provided by law, the indemnification provisions stated above shall apply regardless of the existence or degree of fault of Indemnitees. The Applicant, however, shall not be obligated to indemnify Indemnitees for Claims arising from the sole negligence and willful misconduct of State, its officers, directors, agents or employees.**

**DISCHARGES OF STORM WATER AND NON-STORM WATER: Work within State Highway right-of-way shall be conducted in compliance with all applicable requirements of the National Pollutant Discharge Elimination System (NPDES) permit issued to the Department of Transportation (Department), to govern the discharge of storm water and non-storm water from its properties. Work shall also be in compliance with all other applicable Federal, State and Local laws and regulations, and with the Department's Encroachment Permits Manual and encroachment permit. Compliance with the Department's NPDES permit requires amongst other things, the preparation and submission of a Storm Water Pollution Protection Plan (SWPPP), or a Water Pollution Control Program (WPCP), and the approval of same by the appropriate reviewing authority prior to the start of any work. Information on the requirements may also be reviewed on the Department's Construction Website at:**

<http://www.dot.ca.gov/hq/construc/stormwater1.htm>

25. NAME of APPLICANT or ORGANIZATION (Print or Type)

E-MAIL ADDRESS

ADDRESS of APPLICANT or ORGANIZATION WHERE PERMIT IS TO BE MAILED (Include City and Zip Code)

PHONE NUMBER

FAX NUMBER

26. NAME of AUTHORIZED AGENT / ENGINEER (Print or Type)

IS LETTER OF AUTHORIZATION ATTACHED?

E-MAIL ADDRESS

 YES  NO

ADDRESS of AUTHORIZED AGENT / ENGINEER (Include City and Zip Code)

PHONE NUMBER

FAX NUMBER

27. SIGNATURE of APPLICANT or AUTHORIZED AGENT

28. PRINT OR TYPE NAME

29. TITLE

30. DATE

PERMIT NO.
WORK ORDER/REFERENCE NUMBER

FEE CALCULATION -- FOR CALTRANS USE					
<input type="checkbox"/> CASH <input type="checkbox"/> CREDITCARD    NAME ON CARD _____    PHONE NUMBER _____					
<input type="checkbox"/> CHECK    NUMBER _____    NAME ON CHECK _____    PHONE NUMBER _____					
<input type="checkbox"/> EXEMPT <input type="checkbox"/> PROJECT EA _____ <input type="checkbox"/> DEFERREDBILLING (Utility)					
CALCULATED BY	(1)		(2)		
<b>REVIEW</b>	1. FEE / DEPOSIT	DATE	2. FEE / DEPOSIT	DATE	TOTAL FEE / DEPOSIT
1. _____ HOURS @ \$ _____ *	\$ _____		\$ _____		\$ _____
2. _____ HOURS @ \$ _____ *			\$ _____		\$ _____
<b>INSPECTION</b>	1. FEE / DEPOSIT	DATE	2. FEE / DEPOSIT	DATE	TOTAL FEE / DEPOSIT
1. _____ HOURS @ \$ _____ *	\$ _____		\$ _____		\$ _____
2. _____ HOURS @ \$ _____ *			\$ _____		\$ _____
<b>FIELDWORK</b>					
_____ HOURS @ \$ _____ *	\$ _____		\$ _____		\$ _____
<b>EQUIPMENT &amp; MATERIALS</b>	DEPOSIT	DATE	DEPOSIT	DATE	DEPOSIT
	\$ _____		\$ _____		\$ _____
<b>CASH DEPOSIT IN LIEU OF BOND</b>	\$ _____		\$ _____		\$ _____
<b>TOTAL COLLECTED</b>	\$ _____		\$ _____		
<b>CASHIER'S INITIALS</b>	_____		_____		\$ _____
* The current hourly rate is set annually by Headquarters Accounting. District Office staff do not have authority to modify this rate.					
<b>PERFORMANCE BOND</b>	<input type="checkbox"/>	DATE			AMOUNT \$
<b>PAYMENT BOND</b>	<input type="checkbox"/>	DATE			AMOUNT \$
<b>LIABILITY INSURANCE REQUIRED?</b>		<input type="checkbox"/> YES <input type="checkbox"/> NO			AMOUNT \$

**STANDARD ENCROACHMENT PERMIT APPLICATION**

TR-0100 (REV. 07/2007)

PERMIT NO. \_\_\_\_\_

**INSTRUCTIONS**  
for completing page 4

This page needs to be completed when the proposed project **DOES NOT** involve a City, County or other public agency.

Your answers to these questions will assist departmental staff in identifying any physical, biological, social or economic resources that may be affected by your proposed project within the State highway right-of-way. And, to determine which type of environmental studies may be required to approve your application for an encroachment permit.

It is the applicant's responsibility for the production of all required environmental documentation and supporting studies, in some cases this may be costly and time-consuming. If possible, attach photographs of the location of the proposed project.

Please answer these questions to the best of your ability. Provide a description of any "YES" answers (type, name, number, etc.)

1. Will any existing vegetation and/or landscaping within the highway right-of-way be disturbed?
2. Are there waterways (e.g. river, creek, pond, natural pool or dry streambed) adjacent to or within the limits of the project or highway right-of-way?
3. Is the proposed project located within five miles of the coast line?
4. Will the proposed project generate construction noise levels greater than 86 dBA (e.g. jack-hammering, pile driving)?
5. Will the proposed project incorporate land from a public park, recreation area or wildlife refuge open to the public?
6. Are there any recreational trails or paths within the limits of the proposed project or highway right-of-way?
7. Will the proposed project impact any structures, buildings, rail lines, or bridges within highway right-of-way?
8. Will the proposed project impact access to any businesses or residences?
9. Will the proposed project impact any existing public utilities or public services?
10. Will the proposed project impact existing pedestrian facilities, such as sidewalks, crosswalks, or overcrossings?
11. Will new lighting be constructed within or adjacent to highway right-of-way?

**APPENDIX C**

UTILITY CLEARANCE SURVEY

PERSONNEL: DTH AGH

CLIENT: Broadbent & Associates

JOB: 14-1034.23

DATE: 3/14/14

LOCATION: ARCO 2035, 1001 San Pablo Avenue, Albany

BORING: MW-6

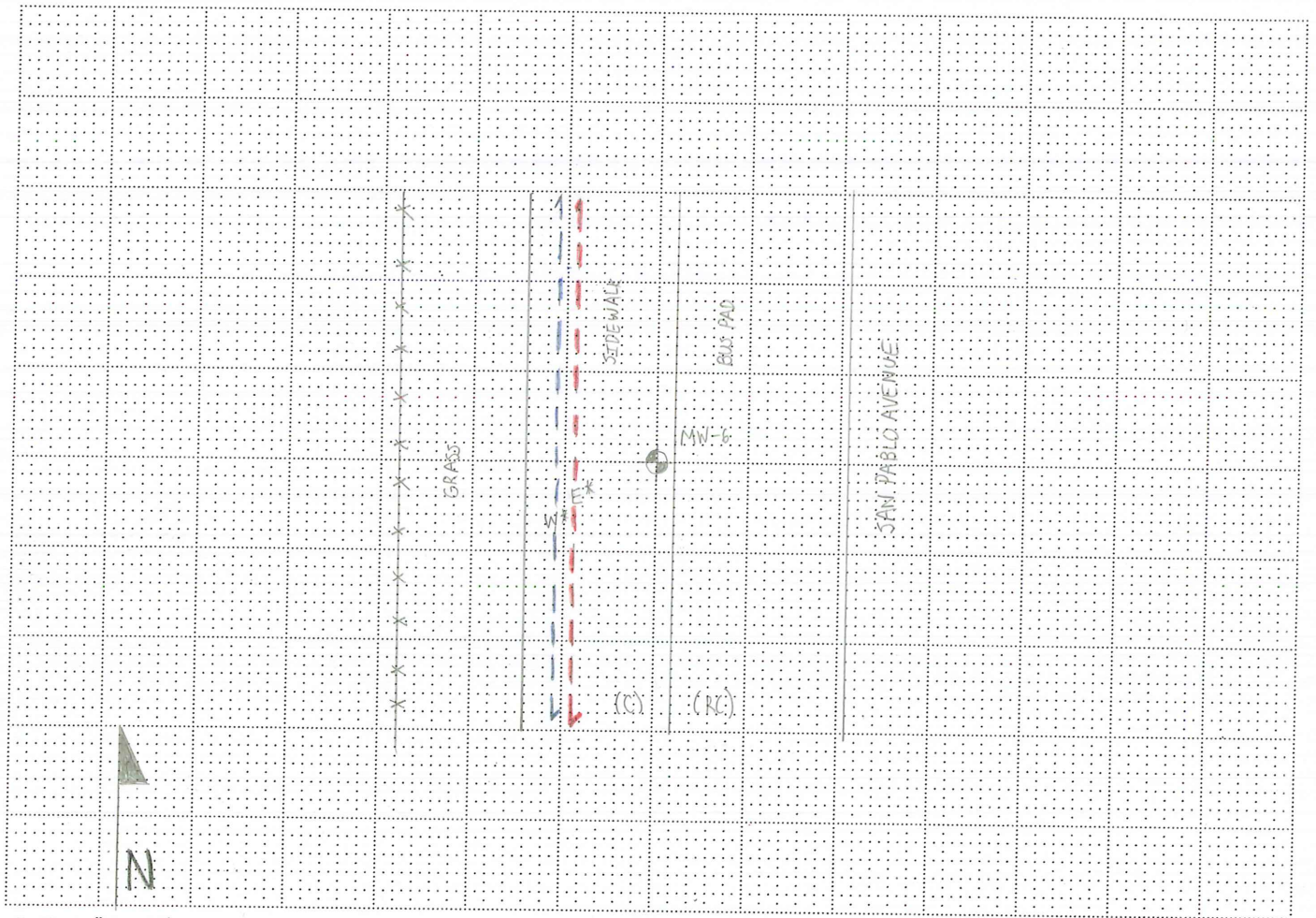

Scale: 1" = 10'

### EXPLANATION

- Original Boring Location
- Final Boring Location
- Existing Well Location
- GPR Traverse
- Localized GPR Anomaly
- Utility Alignment

#### Utilities

- T (Telephone, Comm.)
- ✓ E (Electric)
- NG (Natural Gas)
- CA (Compressed Air)
- STM (Steam)
- SS (Sanitary Sewer)
- SD (Storm Drain)
- ✓ W (Water)
- FS (Fire Supression)
- UU (Undifferentiated Utility)

#### Surface

- ✓ RC (Reinforced Concrete)
- AC (Asphalt)
- ✓ C (Concrete)
- Soil
- Gravel
- other

### NOTES

- |                   |                    |                            |
|-------------------|--------------------|----------------------------|
| <b>Equipment:</b> | <b>Procedure:</b>  | <b>Surface Conditions:</b> |
| ✓ GPR (Radar)     | - EMC (Conduction) | - Wet                      |
| ✓ RD 4000         | - EMI (Induction)  | ✓ Dry                      |
| ✓ M Scope         | ✓ Ambient          | - other                    |
| - other           | ✓ GPR              |                            |

### REMARKS

LIGHT STANDARD POLE #89 30FT SOUTH, 2.5FT WEST OF CURB

E\* } AS DETECTED BY OTHERS AND DETECTED BY NORCAL  
W\* }

PERSONNEL: DTH AGH

CLIENT: Broadbent & Associates

JOB: 14-1034.23

DATE: 3/14/14

LOCATION: ARCO 2035, 1001 San Pablo Avenue, Albany

BORING: VW-8, VAULT 2

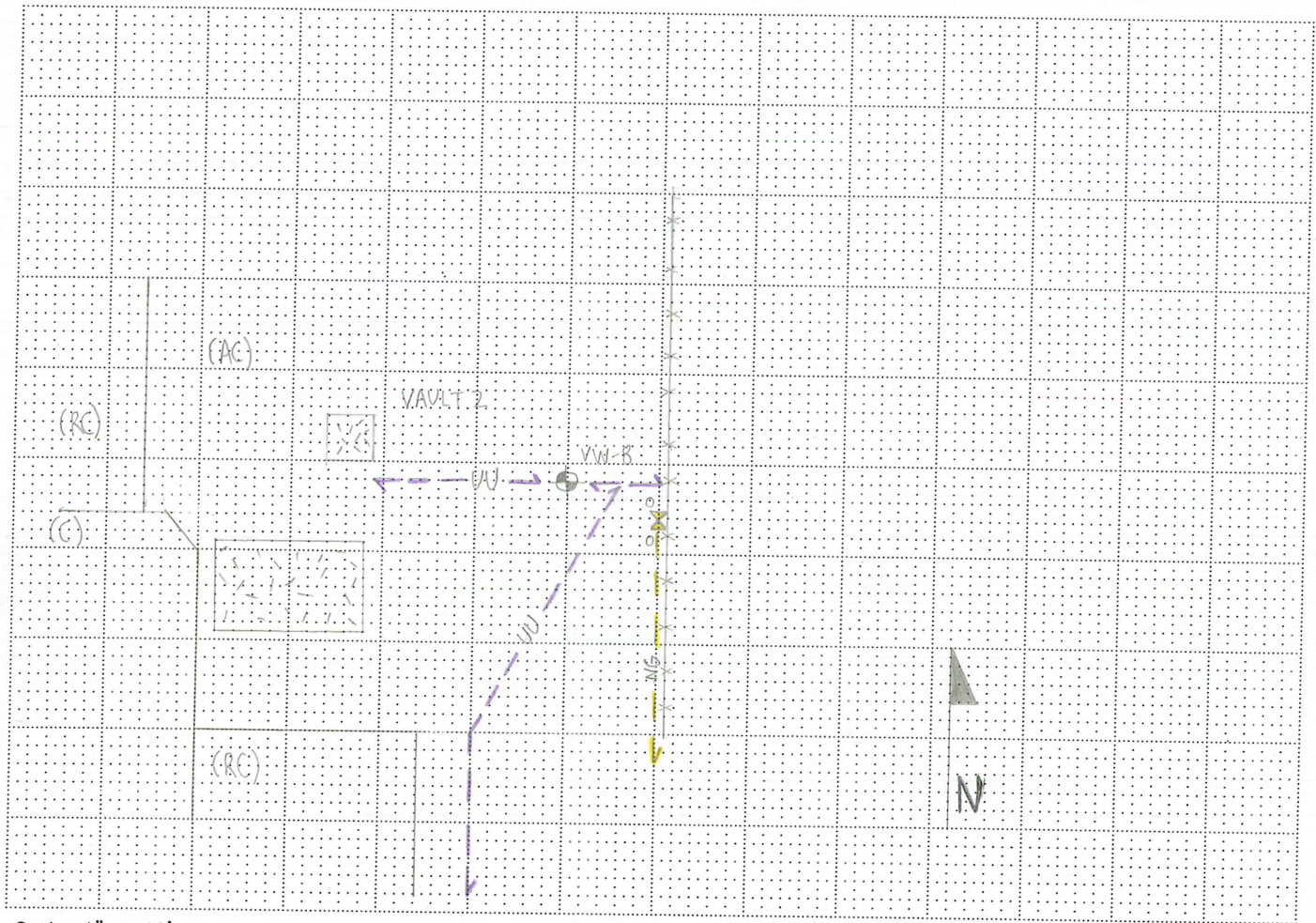

Scale: 1" = 10'

### EXPLANATION

- Original Boring Location
- Final Boring Location
- Existing Well Location
- GPR Traverse
- Localized GPR Anomaly
- Utility Alignment

#### Utilities

- T (Telephone, Comm.)
- E (Electric)
- ✓ NG (Natural Gas)
- CA (Compressed Air)
- STM (Steam)
- SS (Sanitary Sewer)
- SD (Storm Drain)
- W (Water)
- FS (Fire Supression)
- ✓ UU (Undifferentiated Utility)

#### Surface

- ✓ RC (Reinforced Concrete)
- ✓ AC (Asphalt)
- ✓ C (Concrete)
- Soil
- Gravel
- other

### NOTES

- |               |                    |                     |
|---------------|--------------------|---------------------|
| Equipment:    | Procedure:         | Surface Conditions: |
| ✓ GPR (Radar) | - EMC (Conduction) | - Wet               |
| ✓ RD 4000     | - EMI (Induction)  | ✓ Dry               |
| ✓ M Scope     | ✓ Ambient          | - other             |
| - other       | ✓ GPR              |                     |

### REMARKS

- o BOLLARD
- ✚ NATURAL GAS VALVE

PERSONNEL: DTH AGH

CLIENT: Broadbent & Associates

JOB: 14-1034.23

DATE: 3/14/14

LOCATION: ARCO 2035, 1001 San Pablo Avenue, Albany

BORING: MW-5



Scale: 1" = 10'

### EXPLANATION

- Original Boring Location
- Final Boring Location
- Existing Well Location
- GPR Traverse
- Localized GPR Anomaly
- Utility Alignment

#### Utilities

- T (Telephone, Comm.)
- E (Electric)
- NG (Natural Gas)
- CA (Compressed Air)
- STM (Steam)
- SS (Sanitary Sewer)
- SD (Storm Drain)
- W (Water)
- FS (Fire Supression)
- UU (Undifferentiated Utility)

#### Surface

- RC (Reinforced Concrete)
- ✓ AC (Asphalt)
- ✓ C (Concrete)
- Soil
- Gravel
- other

### NOTES

- |               |                    |                     |
|---------------|--------------------|---------------------|
| Equipment:    | Procedure:         | Surface Conditions: |
| ✓ GPR (Radar) | - EMC (Conduction) | - Wet               |
| ✓ RD 4000     | - EMI (Induction)  | ✓ Dry               |
| ✓ M Scope     | ✓ Ambient          | - other             |
| - other       | ✓ GPR              |                     |

### REMARKS

o BOLLARD

PERSONNEL: DTH AGH

CLIENT: Broadbent & Associates

JOB: 14-1034.23

DATE:

LOCATION: ARCO 2035, 1001 San Pablo Avenue, Albany

BORING: VW-9

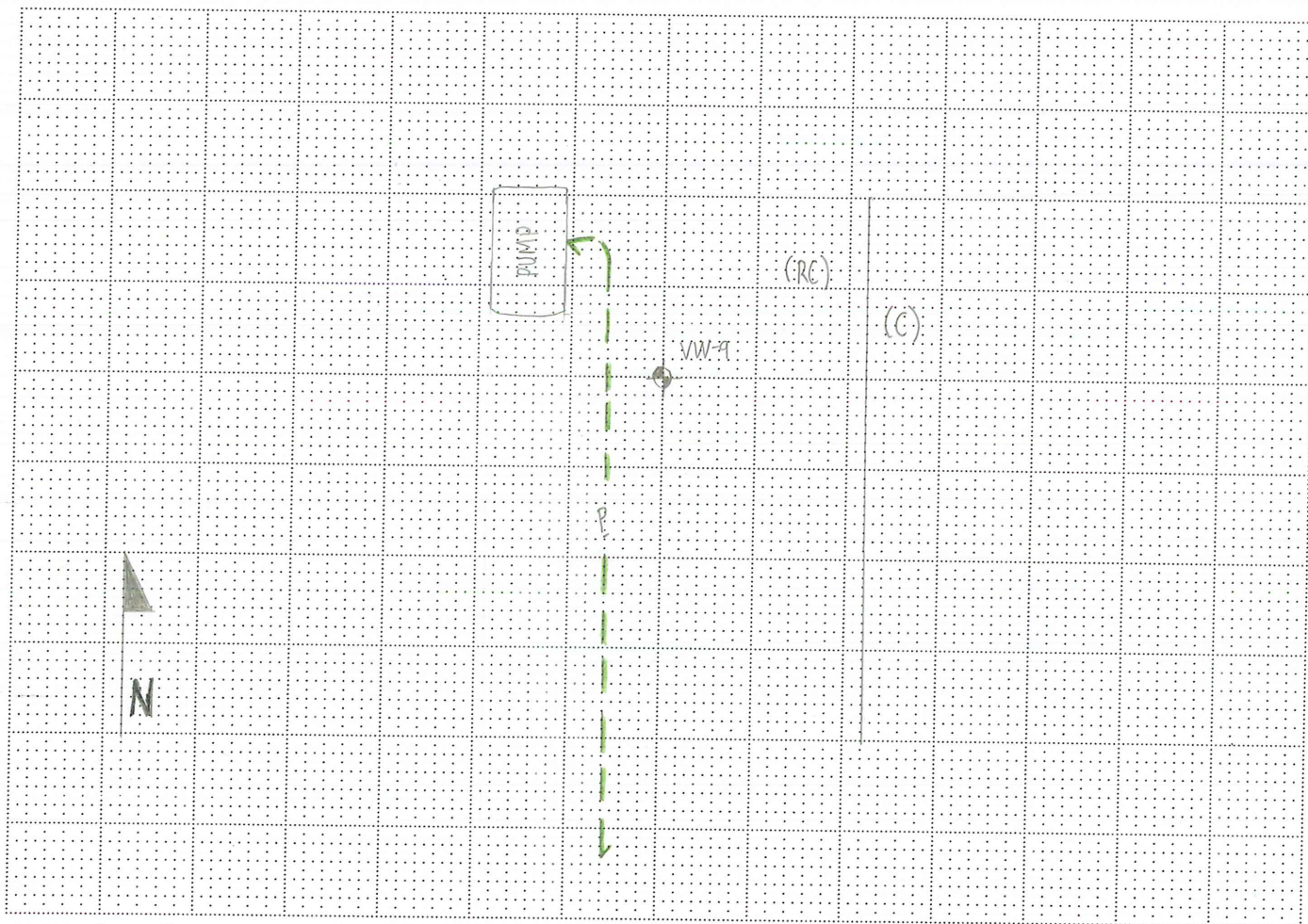

Scale: 1" = 10'

**EXPLANATION**

**NOTES**

- Original Boring Location
- Final Boring Location
- Existing Well Location
- GPR Traverse
- Localized GPR Anomaly
- Utility Alignment

- |   |   |   |
|---|---|---|
| <b>Equipment:</b>                               | <b>Procedure:</b>                           | <b>Surface Conditions:</b>              |
| <input checked="" type="checkbox"/> GPR (Radar) | <input type="checkbox"/> EMC (Conduction)   | <input type="checkbox"/> Wet            |
| <input checked="" type="checkbox"/> RD 4000     | <input type="checkbox"/> EMI (Induction)    | <input checked="" type="checkbox"/> Dry |
| <input checked="" type="checkbox"/> M Scope     | <input checked="" type="checkbox"/> Ambient | <input type="checkbox"/> other          |
| <input type="checkbox"/> other                  | <input checked="" type="checkbox"/> GPR     |   |

Utilities

- |   |  |
|---|--|
| <input type="checkbox"/> T (Telephone, Comm.) | <input type="checkbox"/> SS (Sanitary Sewer)           |
| <input type="checkbox"/> E (Electric)         | <input type="checkbox"/> SD (Storm Drain)              |
| <input type="checkbox"/> NG (Natural Gas)     | <input type="checkbox"/> W (Water)                     |
| <input type="checkbox"/> CA (Compressed Air)  | <input type="checkbox"/> FS (Fire Supression)          |
| <input type="checkbox"/> STM (Steam)          | <input type="checkbox"/> UU (Undifferentiated Utility) |

Surface

- |  |                                 |
|--|---------------------------------|
| <input checked="" type="checkbox"/> RC (Reinforced Concrete) | <input type="checkbox"/> Soil   |
| <input type="checkbox"/> AC (Asphalt)                        | <input type="checkbox"/> Gravel |
| <input checked="" type="checkbox"/> C (Concrete)             | <input type="checkbox"/> other  |

**REMARKS**

--- P --- PRODUCT LINE



PERSONNEL: DTH AGH

CLIENT: Broadbent & Associates

JOB: 14-1034.23

DATE: 3/14/14

LOCATION: ARCO 2035, 1001 San Pablo Avenue, Albany

BORING: VW-4, VW-7, VW-5, VW-2, AS-2, RW-1

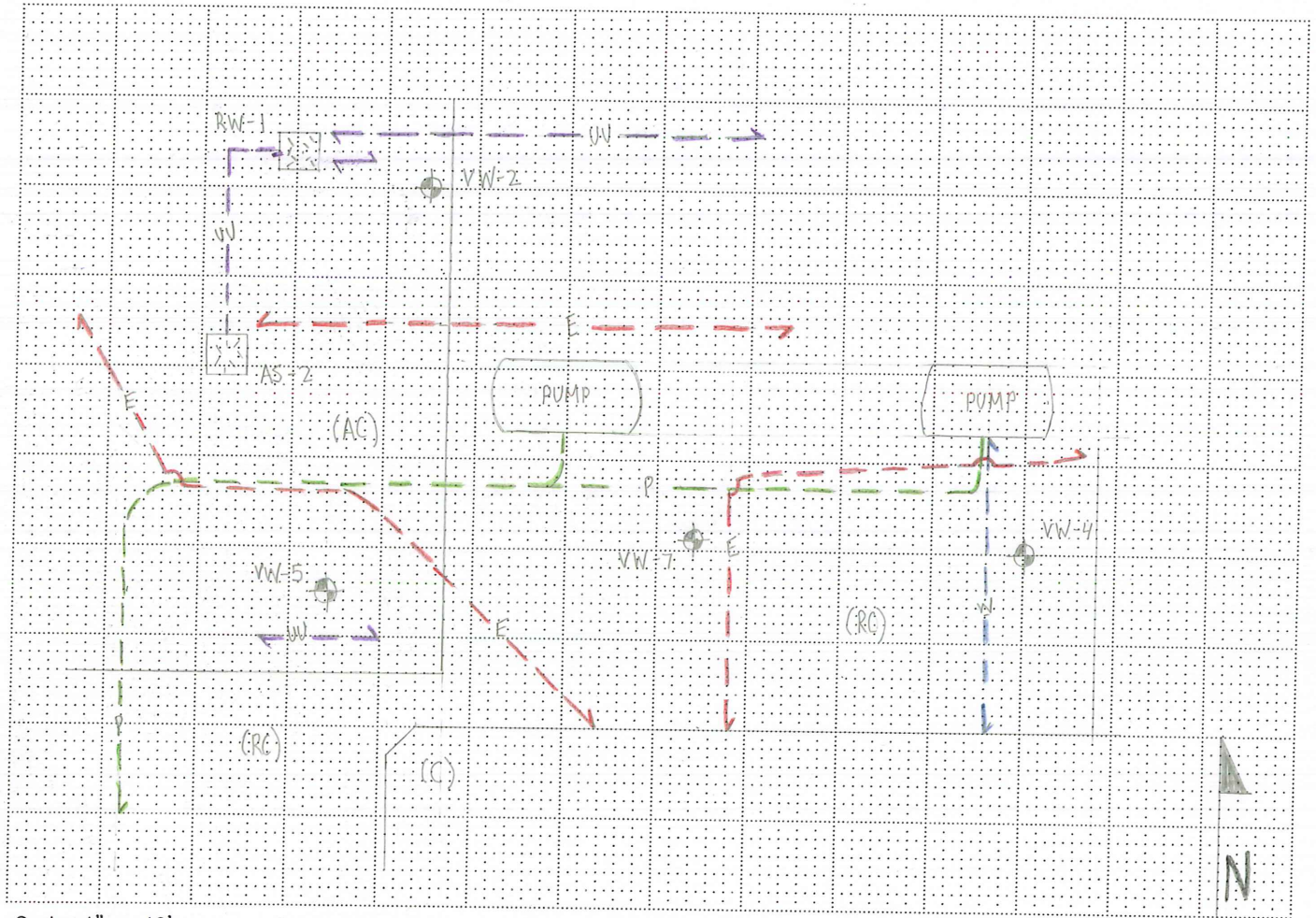

Scale: 1" = 10'

### EXPLANATION

- Original Boring Location
- Final Boring Location
- Existing Well Location
- GPR Traverse
- Localized GPR Anomaly
- Utility Alignment

#### Utilities

- T (Telephone, Comm.)
- ✓ E (Electric)
- NG (Natural Gas)
- CA (Compressed Air)
- STM (Steam)
- SS (Sanitary Sewer)
- SD (Storm Drain)
- ✓ W (Water)
- FS (Fire Supression)
- ✓ UU (Undifferentiated Utility)

#### Surface

- ✓ RC (Reinforced Concrete)
- ✓ AC (Asphalt)
- ✓ C (Concrete)
- Soil
- Gravel
- other

### NOTES

- |                   |                    |                            |
|-------------------|--------------------|----------------------------|
| <b>Equipment:</b> | <b>Procedure:</b>  | <b>Surface Conditions:</b> |
| ✓ GPR (Radar)     | - EMC (Conduction) | - Wet                      |
| ✓ RD 4000         | - EMI (Induction)  | ✓ Dry                      |
| ✓ M Scope         | ✓ Ambient          | - other                    |
| - other           | ✓ GPR              |                            |

### REMARKS

PRODUCT LINE

PERSONNEL: DTH AGH

JOB: 14-1034.23

DATE: 3/13/14

CLIENT: Broadbent & Associates

LOCATION: ARCO 2035, 1001 San Pablo Avenue, Albany

BORING: MW-1, VAULT 1, MW-7, VW-3, VW-1, AS-1

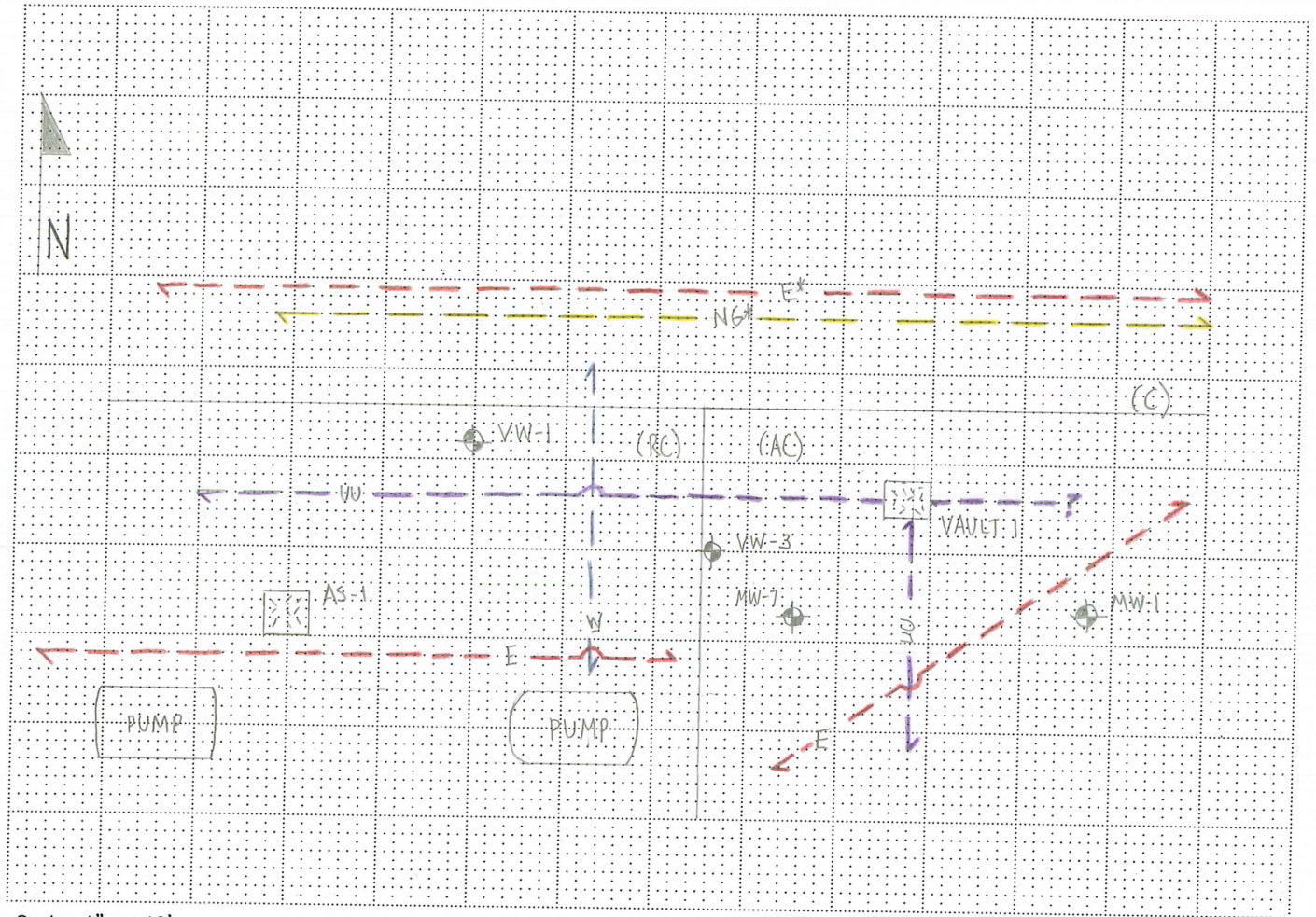

Scale: 1" = 10'

### EXPLANATION

- Original Boring Location
- Final Boring Location
- Existing Well Location
- GPR Traverse
- Localized GPR Anomaly
- Utility Alignment

#### Utilities

- T (Telephone, Comm.)
- ✓ E (Electric)
- ✓ NG (Natural Gas)
- CA (Compressed Air)
- STM (Steam)
- SS (Sanitary Sewer)
- SD (Storm Drain)
- ✓ W (Water)
- FS (Fire Supression)
- ✓ UU (Undifferentiated Utility)

#### Surface

- ✓ RC (Reinforced Concrete)
- ✓ AC (Asphalt)
- ✓ C (Concrete)
- Soil
- Gravel
- other

### NOTES

- |                   |                    |                            |
|-------------------|--------------------|----------------------------|
| <b>Equipment:</b> | <b>Procedure:</b>  | <b>Surface Conditions:</b> |
| ✓ GPR (Radar)     | - EMC (Conduction) | - Wet                      |
| ✓ RD 4000         | - EMI (Induction)  | ✓ Dry                      |
| ✓ M Scope         | ✓ Ambient          | - other                    |
| - other           | ✓ GPR              |                            |

### REMARKS

E\* } AS MARKED BY OTHERS AND DETECTED BY NORCAL  
 NG\* }

PERSONNEL: DTH AGH

CLIENT: Broadbent & Associates

JOB: 14-1034.23

DATE: 3/13/14

LOCATION: ARCO 2035, 1001 San Pablo Avenue, Albany

BORING: MW-4

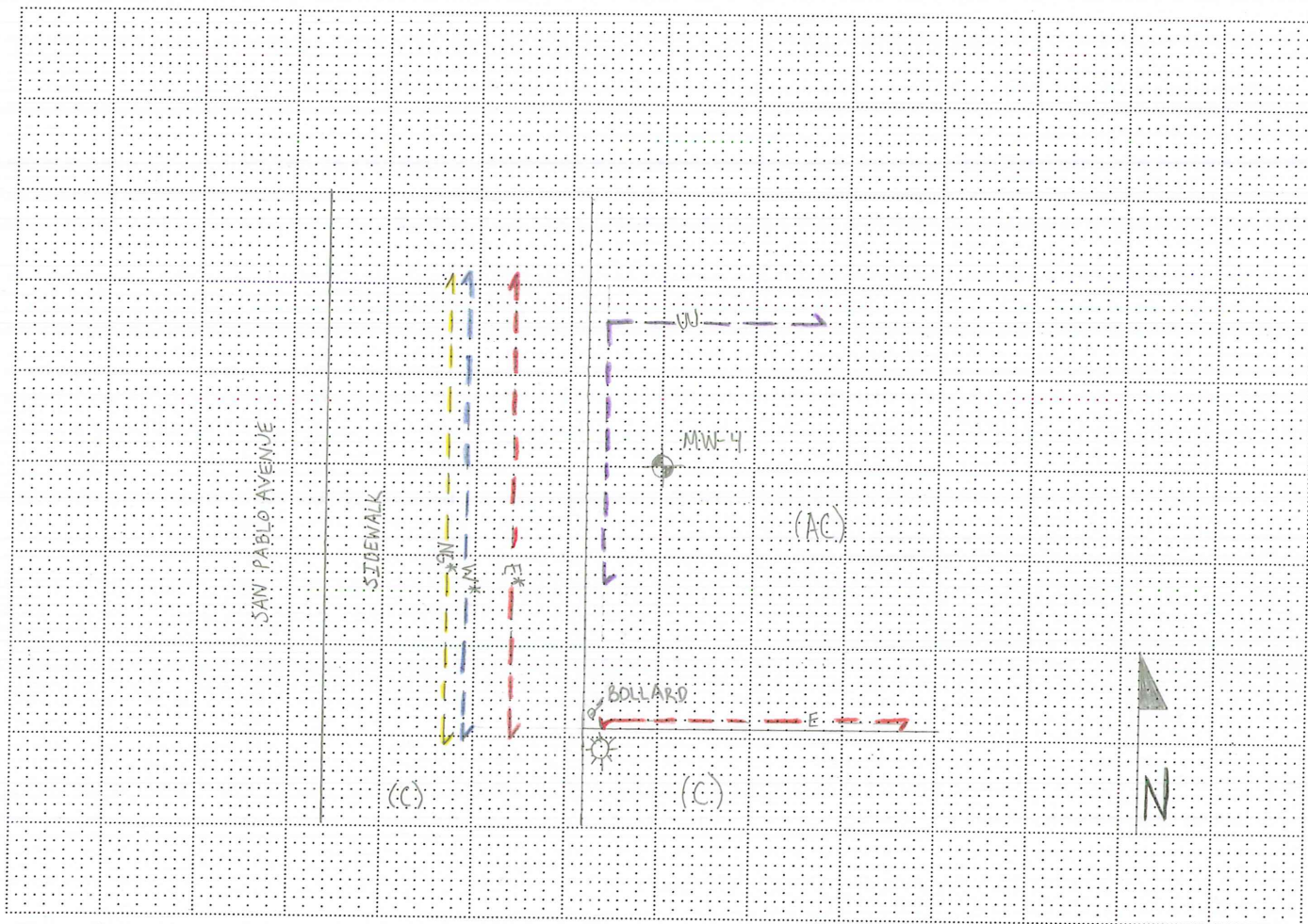

Scale: 1" = 10'

EXPLANATION

NOTES

- Original Boring Location
- Final Boring Location
- Existing Well Location
- GPR Traverse
- Localized GPR Anomaly
- Utility Alignment

- |   |   |   |
|---|---|---|
| <b>Equipment:</b>                               | <b>Procedure:</b>                           | <b>Surface Conditions:</b>              |
| <input checked="" type="checkbox"/> GPR (Radar) | <input type="checkbox"/> EMC (Conduction)   | <input type="checkbox"/> Wet            |
| <input checked="" type="checkbox"/> RD 4000     | <input type="checkbox"/> EMI (Induction)    | <input checked="" type="checkbox"/> Dry |
| <input checked="" type="checkbox"/> M Scope     | <input checked="" type="checkbox"/> Ambient | <input type="checkbox"/> other          |
| <input type="checkbox"/> other                  | <input checked="" type="checkbox"/> GPR     |   |

Utilities

- |  |   |
|--|---|
| <input type="checkbox"/> T (Telephone, Comm.)        | <input type="checkbox"/> SS (Sanitary Sewer)                      |
| <input checked="" type="checkbox"/> E (Electric)     | <input type="checkbox"/> SD (Storm Drain)                         |
| <input checked="" type="checkbox"/> NG (Natural Gas) | <input checked="" type="checkbox"/> W (Water)                     |
| <input type="checkbox"/> CA (Compressed Air)         | <input type="checkbox"/> FS (Fire Suppression)                    |
| <input type="checkbox"/> STM (Steam)                 | <input checked="" type="checkbox"/> UU (Undifferentiated Utility) |

Surface

- |   |                                 |
|---|---------------------------------|
| <input type="checkbox"/> RC (Reinforced Concrete) | <input type="checkbox"/> Soil   |
| <input checked="" type="checkbox"/> AC (Asphalt)  | <input type="checkbox"/> Gravel |
| <input checked="" type="checkbox"/> C (Concrete)  | <input type="checkbox"/> other  |

REMARKS

E\* } AS MARKED BY OTHERS AND DETECTED BY NORCAL  
 W\* }  
 NG\* }

PERSONNEL: DTH AGH

CLIENT: Broadbent & Associates

JOB: 14-1034.23

DATE: 3/14/14

LOCATION: ARCO 2035, 1001 San Pablo Avenue, Albany



BORING: MW-2, MW-8

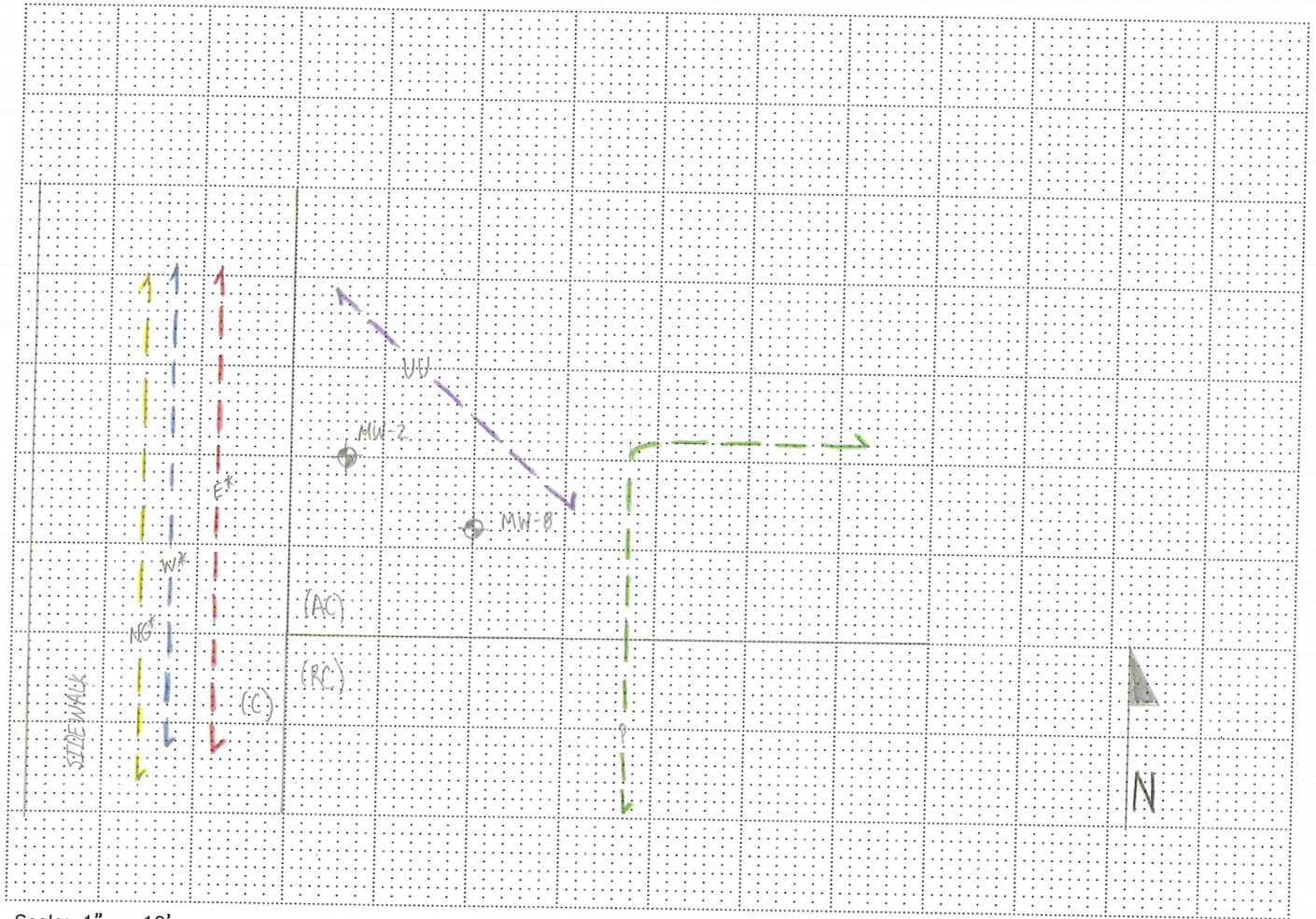

Scale: 1" = 10'

### EXPLANATION

### NOTES

- Original Boring Location
  - Final Boring Location
  - Existing Well Location
  - GPR Traverse
  - Localized GPR Anomaly
  - Utility Alignment
- Utilities
- T (Telephone, Comm.)
  - E (Electric)
  - NG (Natural Gas)
  - CA (Compressed Air)
  - STM (Steam)
  - SS (Sanitary Sewer)
  - SD (Storm Drain)
  - W (Water)
  - FS (Fire Supression)
  - UU (Undifferentiated Utility)
- Surface
- RC (Reinforced Concrete)
  - AC (Asphalt)
  - C (Concrete)
  - Soil
  - Gravel
  - other

- |   |   |   |
|---|---|---|
| <b>Equipment:</b>                               | <b>Procedure:</b>                           | <b>Surface Conditions:</b>              |
| <input checked="" type="checkbox"/> GPR (Radar) | - EMC (Conduction)                          | <input type="checkbox"/> Wet            |
| <input checked="" type="checkbox"/> RD 4000     | - EMI (Induction)                           | <input checked="" type="checkbox"/> Dry |
| <input checked="" type="checkbox"/> M Scope     | <input checked="" type="checkbox"/> Ambient | - other                                 |
| - other   | <input checked="" type="checkbox"/> GPR     |   |

### REMARKS

P PRODUCT LINE

E\* }  
W\* } AS MARKED BY OTHERS AND DETECTED BY NORCAL  
NG\* }

PERSONNEL: DTH AGH

CLIENT: Broadbent & Associates

JOB: 14-1034.23

DATE: 3/13/14

LOCATION: ARCO 2035, 1001 San Pablo Avenue, Albany

BORING: MW-3, MW-9, VW-6

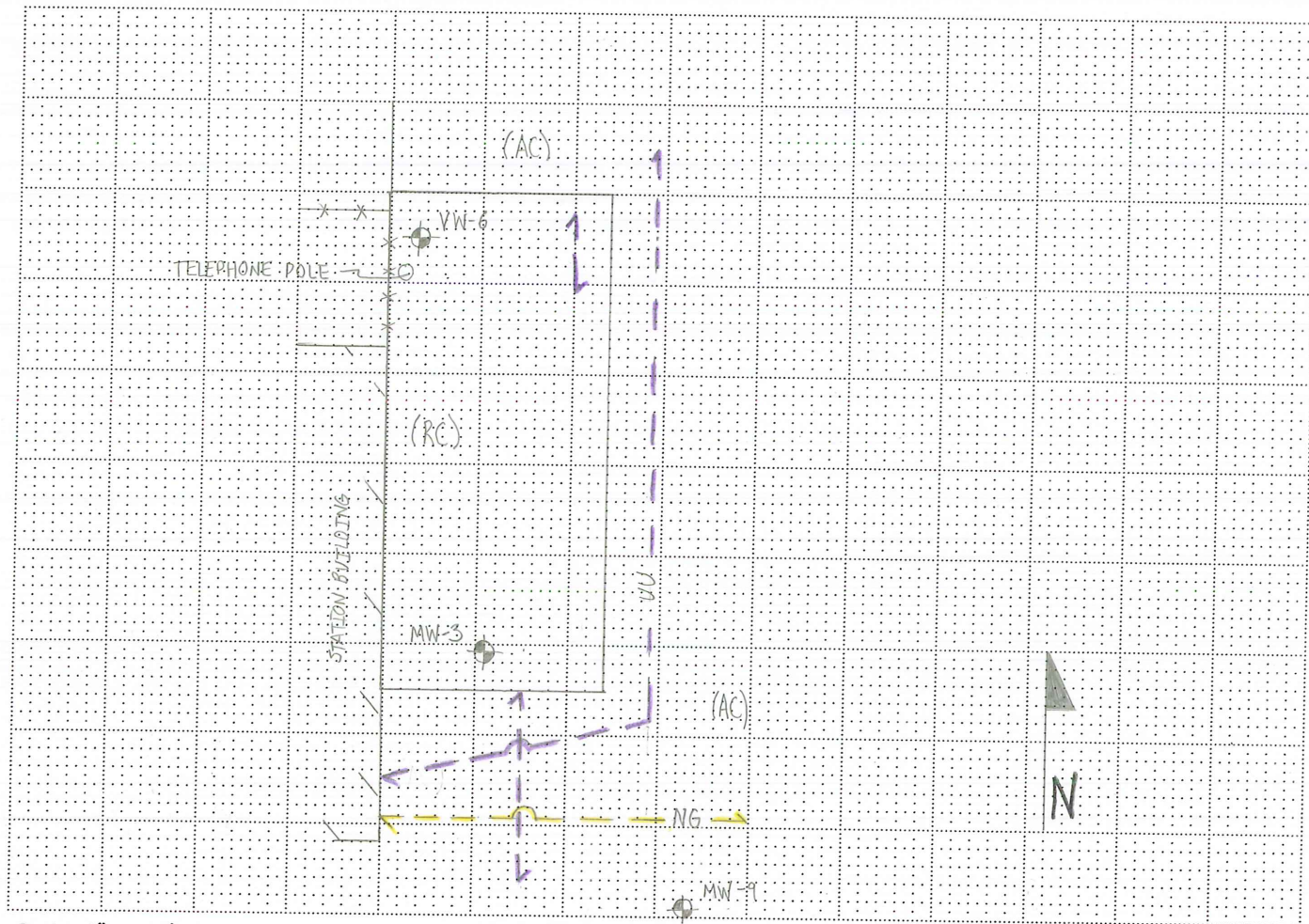

Scale: 1" = 10'

### EXPLANATION

- Original Boring Location
- Final Boring Location
- Existing Well Location
- GPR Traverse
- Localized GPR Anomaly
- Utility Alignment

#### Utilities

- T (Telephone, Comm.)
- E (Electric)
- ✓ NG (Natural Gas)
- CA (Compressed Air)
- STM (Steam)
- SS (Sanitary Sewer)
- SD (Storm Drain)
- W (Water)
- FS (Fire Supression)
- ✓ UU (Undifferentiated Utility)

#### Surface

- ✓ RC (Reinforced Concrete)
- ✓ AC (Asphalt)
- C (Concrete)
- Soil
- Gravel
- other

### NOTES

- |                   |                    |                            |
|-------------------|--------------------|----------------------------|
| <b>Equipment:</b> | <b>Procedure:</b>  | <b>Surface Conditions:</b> |
| ✓ GPR (Radar)     | - EMC (Conduction) | - Wet                      |
| ✓ RD 4000         | - EMI (Induction)  | ✓ Dry                      |
| ✓ M Scope         | ✓ Ambient          | - other                    |
| - other           | ✓ GPR              |                            |

### REMARKS