

Atlantic Richfield Company

Shannon Couch
Operations Project Manager

PO Box 1257
San Ramon, CA 94583
Phone: (925) 275-3804
Fax: (925) 275-3815
E-Mail: shannon.couch@bp.com

April 15, 2013

RECEIVED

By Alameda County Environmental Health at 9:32 am, Apr 17, 2013

Re: First Quarter 2013 Status Report
Atlantic Richfield Company Station #2035
1001 San Pablo Avenue, Albany, California
ACEH Case #RO0000100

I declare that to the best of my knowledge at the present time, that the information and/or recommendations contained in the attached document are true and correct.

Submitted by,

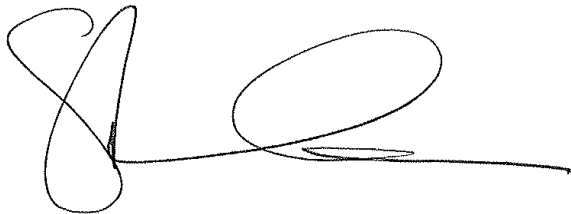

Shannon Couch
Operations Project Manager

Attachment



BROADBENT

875 Cotting Ln., Suite G, Vacaville, CA 95688

[T] 707-455-7290 [F] 707-455-7295

broadbentinc.com

CREATING SOLUTIONS. BUILDING TRUST.

April 15, 2013

Project No. 06-88-610

Atlantic Richfield Company
P.O. Box 1257
San Ramon, CA 94583
Submitted via ENFOS

Attn.: Ms. Shannon Couch

Re: First Quarter 2013 Status Report, Atlantic Richfield Company Station #2035,
1001 San Pablo Avenue, Albany, California; ACEH Case #RO0000100

Dear Ms. Couch:

Attached is the First Quarter 2013 Status Report for Atlantic Richfield Company Station #2035 located at 1001 San Pablo Avenue, Albany, California. This report presents a summary of current developments at the Site through the First Quarter of 2013.

Should you have questions regarding this submittal, please do not hesitate to contact me at (707) 455-7290.

Sincerely,

BROADBENT & ASSOCIATES, INC.

Alexander J. Martinez
Senior Staff Geologist

Kristene Tidwell, PG, CHG
Senior Geologist

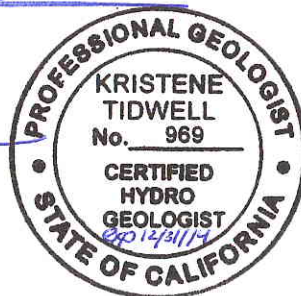

Enclosures

cc: Ms. Dilan Roe, P.E., Alameda County Environmental Health (submitted via ACEH ftp site)
Mr. John LeStrange, 17851 State Highway 128, Calistoga, California 94515
Electronic copy uploaded to GeoTracker

**FIRST QUARTER 2013
STATUS REPORT
ARCO STATION #2035, ALBANY, CALIFORNIA**

Broadbent & Associates, Inc. (Broadbent) is pleased to present this *First Quarter 2012 Status Report* on behalf of Atlantic Richfield Company (a BP affiliated company) for ARCO Station #2035 located in Albany, Alameda County, California. Quarterly reporting is being submitted to the Alameda County Environmental Health Services Agency (ACEH) consistent with their requirements under the legal authority of the California Regional Water Quality Control Board as codified by California Code of Regulations Title 23, Section 2652(d). A summary description of current developments regarding the Site is provided below.

Facility Name / Address:	ARCO Station #2035 / 1001 San Pablo Avenue, Albany
Client Project Manager / Title:	Ms. Shannon Couch / RM Operations Project Manager
Broadbent Contact:	Ms. Kristene Tidwell, PG, CHG / 707-455-7290
Broadbent Project No.:	06-88-610
Primary Regulatory Agency / ID No.:	ACEH, Case #RO0000100
Current phase of project:	Monitoring
List of Acronyms / Abbreviations:	See end of report text for list of acronyms/abbreviations used in report.

WORK PERFORMED THIS QUARTER (First Quarter 2013):

1. Submitted *Fourth Quarter 2012 Semi-Annual Monitoring Report* on January 31, 2013.
2. No environmental field work was conducted at Station #2035 during the First Quarter 2013.

WORK SCHEDULED FOR NEXT QUARTER (Second Quarter 2013):

1. Prepared and submitted *First Quarter 2013 Status Report* (contained herein).
2. Conduct semi-annual groundwater monitoring/sampling for Second Quarter 2013, coordinated with consultant for nearby Shell Station.
3. Submit Conceptual Site Model for the Site.

DISCUSSION:

Groundwater monitoring and sampling is scheduled to be conducted at ARCO Station #2035 during the Second Quarter 2013, consistent with the current monitoring program. Currently, a Conceptual Site Model is being prepared.

ATTACHMENTS:

- Drawing 1: Site Location Map
Drawing 2: Groundwater Elevation and Contour and Analytical Summary Map, December 6, 2012

LIST OF COMMONLY USED ACCRONYMS/ABBREVIATIONS:

ACEH:	Alameda County Environmental Health	ft/ft:	feet per foot
ACPWA:	Alameda County Public Works Agency	gal:	Gallons
BTEX:	Benzene, Toluene, Ethylbenzene, Total Xylenes	GRO:	Gasoline-Range Organics
1,2-DCA:	1,2-Dichloroethane	LNAPL:	Light Non-Aqueous Phase Liquid
DIPE:	Di-Isopropyl Ether	MTBE:	Methyl Tertiary Butyl Ether
DO:	Dissolved Oxygen	NO ₃ :	Nitrate as Nitrogen
DRO:	Diesel-Range Organics	ppb:	parts per billion
EDB:	1,2-Dibromomethane	SO ₄ :	Sulfate

Eh: Oxidation Reduction Potential
EPA: Environmental Protection Agency
ETBE: Ethyl Tertiary Butyl Ether
Fe²⁺: Ferrous Iron

TAME: Tert-Amyl Methyl Ether
TBA: Tertiary Butyl Ether
TOC: Top of Casing
µg/L: micrograms per liter

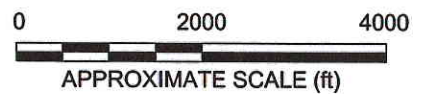
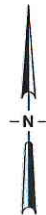
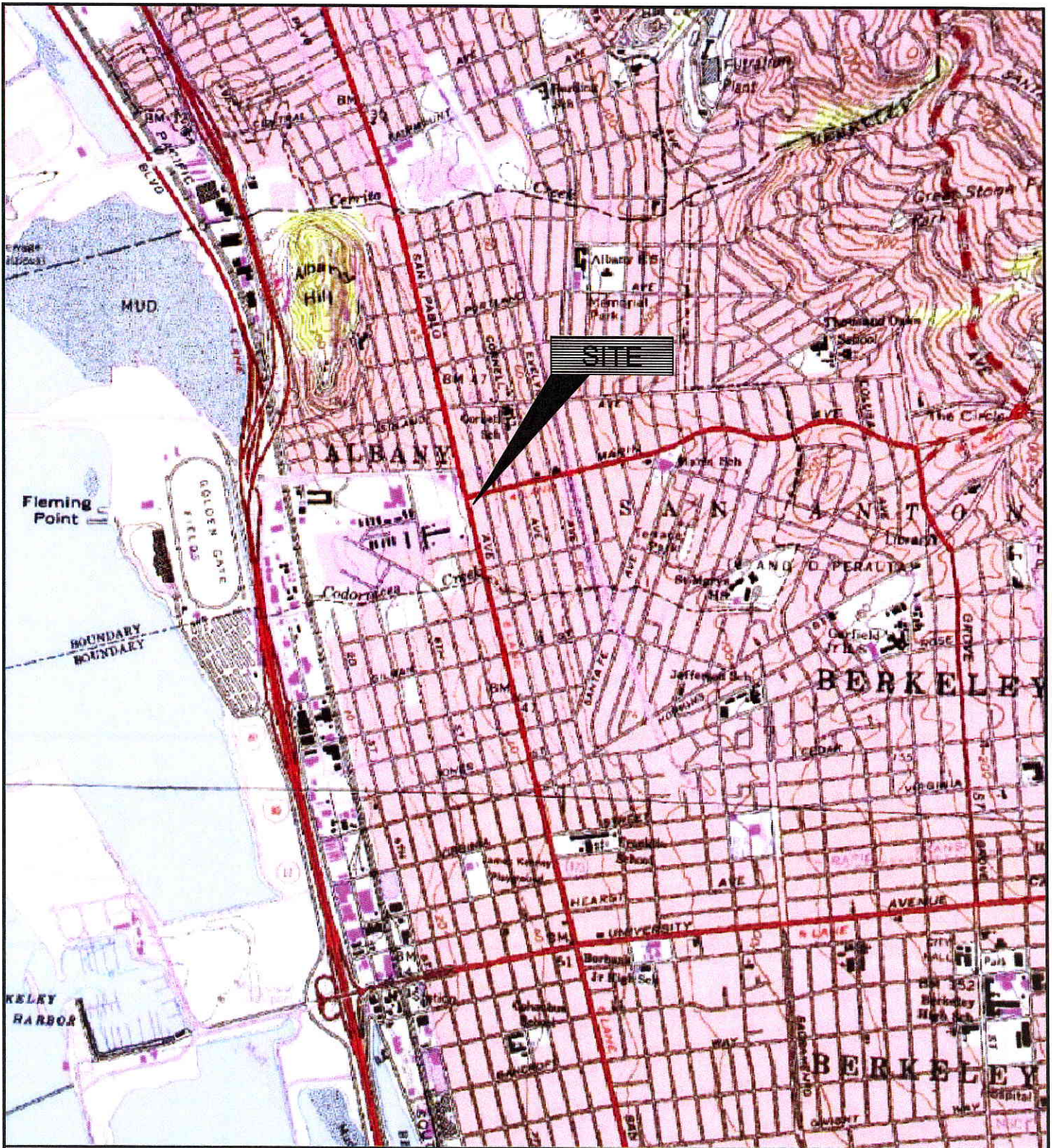

IMAGE SOURCE: USGS

BROADBENT & ASSOCIATES, INC.
 ENGINEERING, WATER RESOURCES & ENVIRONMENTAL
 1324 Mangrove Ave. Suite 212, Chico, CA 95926
 Project No.: 06-88-610 Date: 08/7/09

ARCO Service Station #2035
 1001 San Pablo Avenue
 Albany, California

Site Location Map

Drawing

1

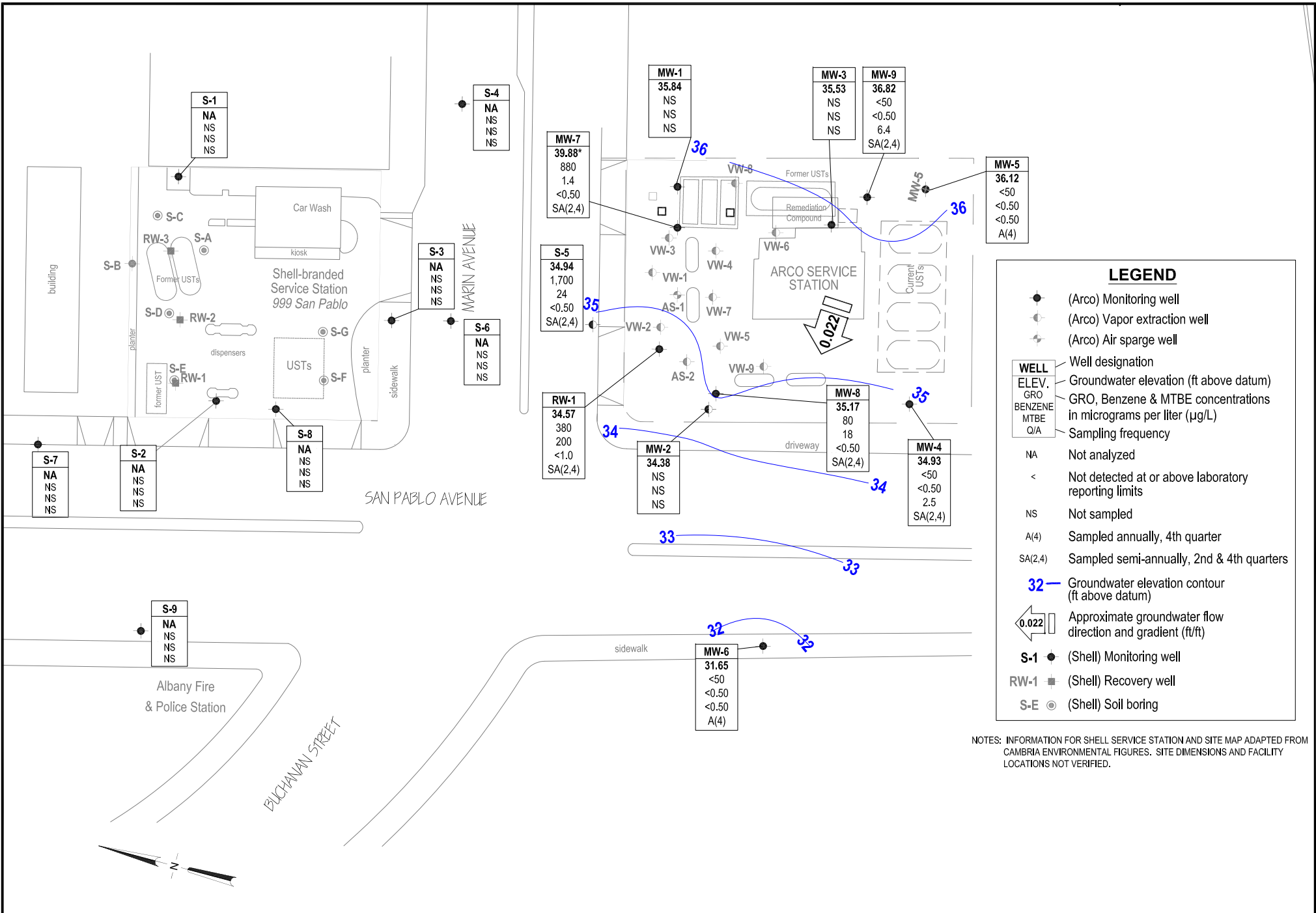

LEGEND

- (Arco) Monitoring well
- (Arco) Vapor extraction well
- (Arco) Air sparge well

WELL	ELEV.	GRO	BENZENE	MTBE	Q/A
		GRO, Benzene & MTBE concentrations in micrograms per liter (µg/L)			
					Sampling frequency
NA					Not analyzed
<					Not detected at or above laboratory reporting limits
NS					Not sampled
A(4)					Sampled annually, 4th quarter
SA(2,4)					Sampled semi-annually, 2nd & 4th quarters

- 32 — Groundwater elevation contour (ft above datum)
- 0.022 Approximate groundwater flow direction and gradient (ft/ft)
- S-1 ● (Shell) Monitoring well
- RW-1 ■ (Shell) Recovery well
- S-E ○ (Shell) Soil boring

NOTES: INFORMATION FOR SHELL SERVICE STATION AND SITE MAP ADAPTED FROM CAMBRIA ENVIRONMENTAL FIGURES. SITE DIMENSIONS AND FACILITY LOCATIONS NOT VERIFIED.

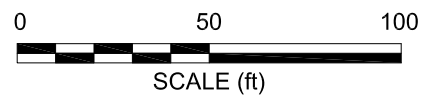

BROADBENT
 1324 Mangrove Ave. Suite 212
 Chico, California 95926
 Project No.: 06-88-610 Date: 1/22/2013

ARCO Service Station #2035
 1001 San Pablo Avenue
 Albany, California

Groundwater Elevation Contour
 and Analytical Summary Map
 December 6, 2012

Drawing
2