

Atlantic Richfield Company

Chuck Carmel
Environmental Business Manager

RECEIVED

8:51 am, Apr 01, 2010

Alameda County
Environmental Health

PO Box 1257
San Ramon, CA 94583
Phone: (925) 275-3803
Fax: (925) 275-3815
E-Mail: charles.carmel@bp.com

5 April 2010

Re: First Quarter 2010 Status Report
Atlantic Richfield Company Station #2035
1001 San Pablo Avenue, Albany, California
ACEH Case #RO0000100

"I declare, that to the best of my knowledge at the present time, that the information and/or recommendations contained in the attached document are true and correct.

Submitted by,



Chuck Carmel
Environmental Business Manager

Attachment

5 April 2010

Project No. 06-88-610

Atlantic Richfield Company
P.O. Box 1257
San Ramon, CA 94583
Submitted via ENFOS

Attn.: Mr. Chuck Carmel

Re: First Quarter 2010 Status Report, Atlantic Richfield Company Station #2035
1001 San Pablo Avenue, Albany, California; ACEH Case #RO0000100

Dear Mr. Carmel:

Attached is the *First Quarter 2010 Status Report* for Atlantic Richfield Company (a BP affiliated company) Station #2035 located at 1001 San Pablo Avenue, Albany, Alameda County, California. This report presents a summary of current developments at the Site through the First Quarter 2010.

Should you have questions regarding this submittal, please do not hesitate to contact me at (530) 566-1400.

Sincerely,
BROADBENT & ASSOCIATES, INC.



Thomas A. Venus, P.E.
Senior Engineer



Enclosures

cc: Mr. Paresh Khatri, Alameda County Environmental Health (Submitted via ACEH ftp site)
Mr. John Lestrangle, 17851 State Highway 128, Calistoga, California 94515
Mr. Robert Cave, Bay Area Air Quality Management District (Submitted via GeoTracker)
Electronic copy uploaded to GeoTracker

STATION # 2035 QUARTERLY STATUS REPORT

Facility: #2035	Address: 1001 San Pablo Avenue, Albany, California
Environmental Business Manager:	Mr. Chuck Carmel
Consulting Co./Contact Person:	Broadbent & Associates, Inc.(BAI)/Mr. Tom Venus, PE (530) 566-1400
Consultant Project No.:	06-02-610
Primary Agency/Regulatory ID No.:	Alameda County Environmental Health (ACEH) ACEH Case # RO0000100

WORK PERFORMED THIS QUARTER (First Quarter 2010):

1. Prepared and submitted the *Fourth Quarter 2009 Semi-Annual Ground-Water Monitoring Report* (BAI, 01/29/2010).
2. Submitted *Facility Update Information* form to Bay Area Air Quality Management District on 19 February 2010, formally closing Permit to Operate for treatment system shutdown since February 2004.
3. Implemented *Revised Vapor Intrusion Assessment Work Plan* (BAI, 9/25/2009). Installed five shallow soil gas monitoring points on 9-10 March 2010.

WORK PROPOSED FOR NEXT QUARTER (Second Quarter 2010):

1. Prepared and submitted the *First Quarter 2010 Status Report* (contained herein).
2. Prepare and submit *Vapor Intrusion Assessment Report* to ACEH by 30 April 2010.
3. Conduct semi-annual ground-water monitoring/sampling for Second Quarter 2010. Work to be performed by BAI.

SITE SUMMARY:

Current phase of project:	Ground-Water Monitoring/Sampling, Vapor Intrusion Assessment
Frequency of ground-water monitoring:	Semi-Annually (2Q and 4Q): Wells MW-1, MW-2, MW-3, MW-4, MW-5, MW-6, MW-7, MW-8, MW-9, RW-1, S-5
Frequency of ground-water sampling:	Semi-Annually (2Q and 4Q): Wells MW-4, MW-7, MW-8, MW-9, RW-1, and S-5 Annually (4Q): Wells MW-5 and MW-6
Is free product (FP) present on-site:	No
Depth to ground water (below TOC):	8.31 ft (MW-7) to 12.90 ft (MW-6) (November 2009)
General ground-water flow direction:	West (November 2009)
Approximate hydraulic gradient:	0.03 ft/ft (November 2009)

DISCUSSION:

A *Vapor Intrusion Assessment Work Plan* for environmental work at Station #2035 was prepared and submitted on 10 August 2009 to ACEH in response to a directive letter received from Mr. Paresh Khatri, dated 11 June 2009. Mr. Khatri responded to the submittal with technical comments within a letter from ACEH dated 3 September 2009. The technical comments focused on the number and locations of proposed soil vapor sampling implants. In response, a *Revised Vapor Intrusion Assessment Work Plan* was prepared and submitted on 25 September 2009. Following approval of the workplan, BAI supervised the installation of five soil vapor sampling wells on 9-10 March 2010. For reference, a Site Location Map is provided as Drawing 1. A Ground-Water Elevation Contour and Analytical Summary Map from the Fourth Quarter of 2009 is provided as Drawing 2. The soil gas boring/temporary vapor well sampling locations are presented in Drawing 3.

ATTACHMENTS:

- Drawing 1. Site Location Map, ARCO Service Station #2035, 1001 San Pablo Avenue, Albany, California
- Drawing 2. Ground-Water Elevation Contour and Analytical Summary Map, 24 November 2009, ARCO Service Station #2035, 1001 San Pablo Avenue, Albany, California
- Drawing 3. Site Plan with Proposed Soil Gas Boring Locations, ARCO Service Station #2035, 1001 San Pablo Avenue, Albany, California

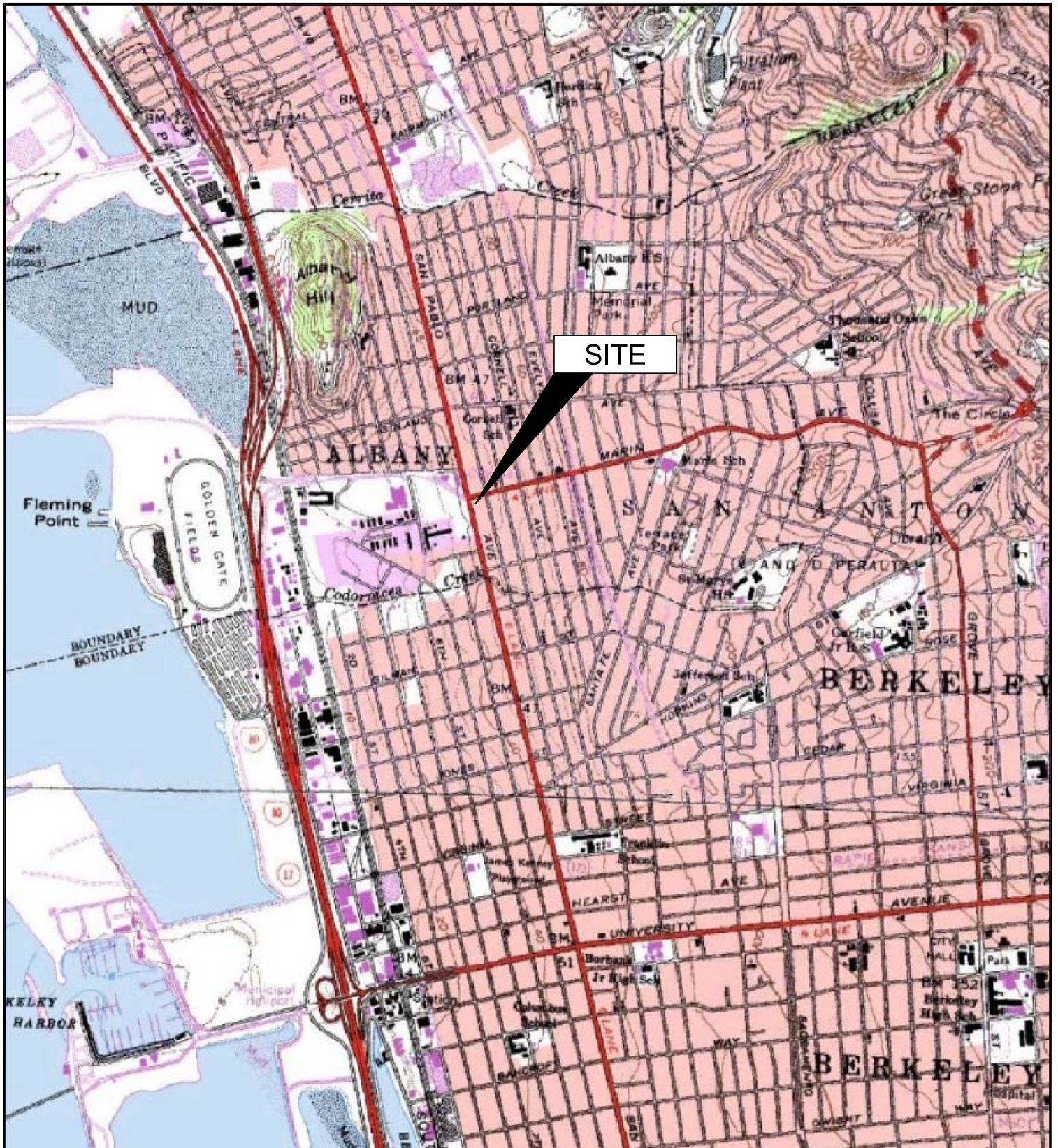
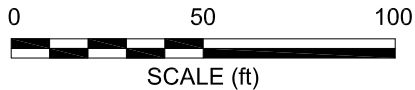
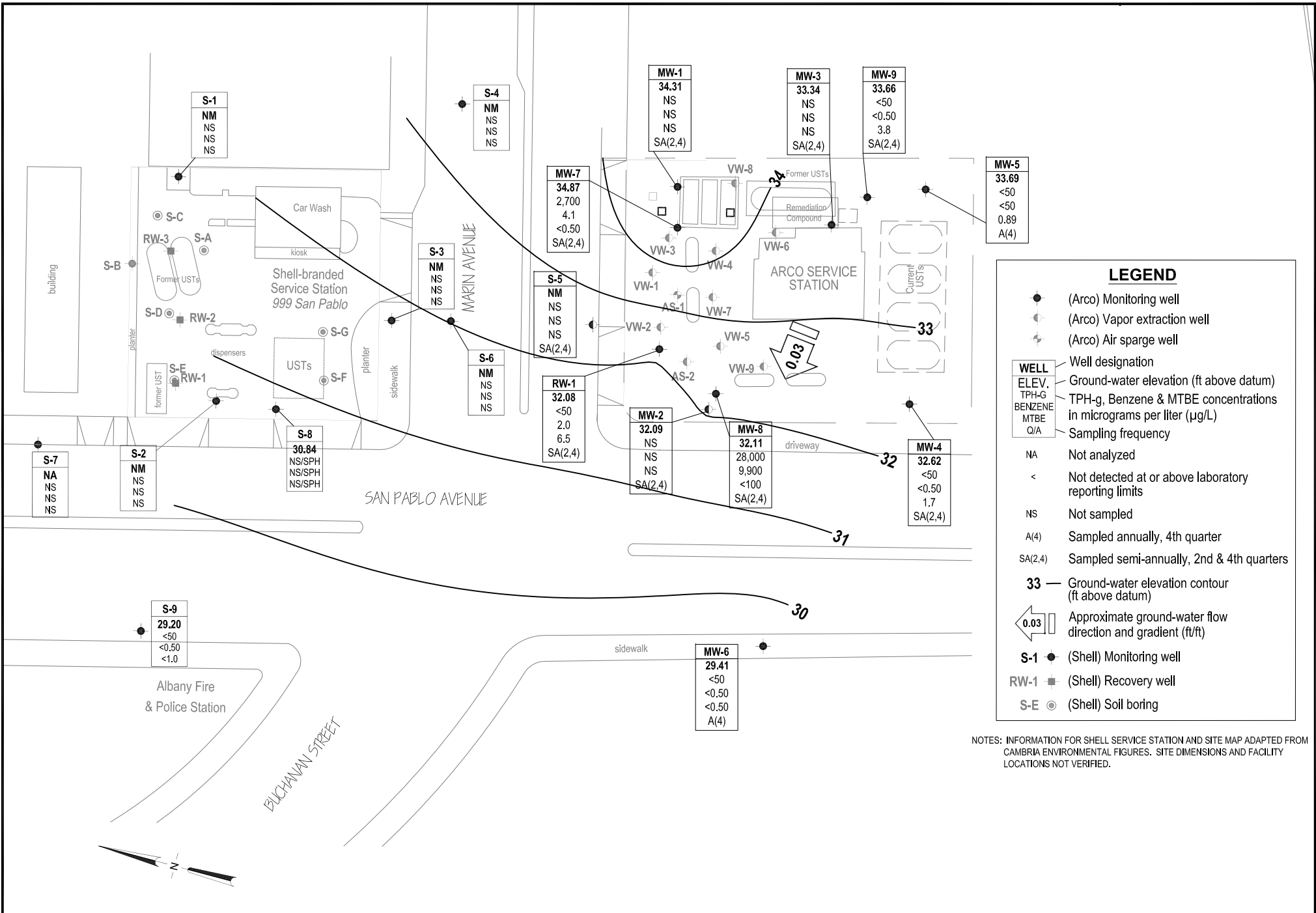

IMAGE SOURCE: USGS



BROADBENT & ASSOCIATES, INC.
ENGINEERING, WATER RESOURCES & ENVIRONMENTAL
1324 Mangrove Ave. Suite 212 Chico 95926
Project No.: 06-88-610 Date: 1/14/10

ARCO Service Station #2035
1001 San Pablo Avenue
Albany, California

Ground-Water Elevation Contour
and Analytical Summary Map
24 November 2009

Drawing

2

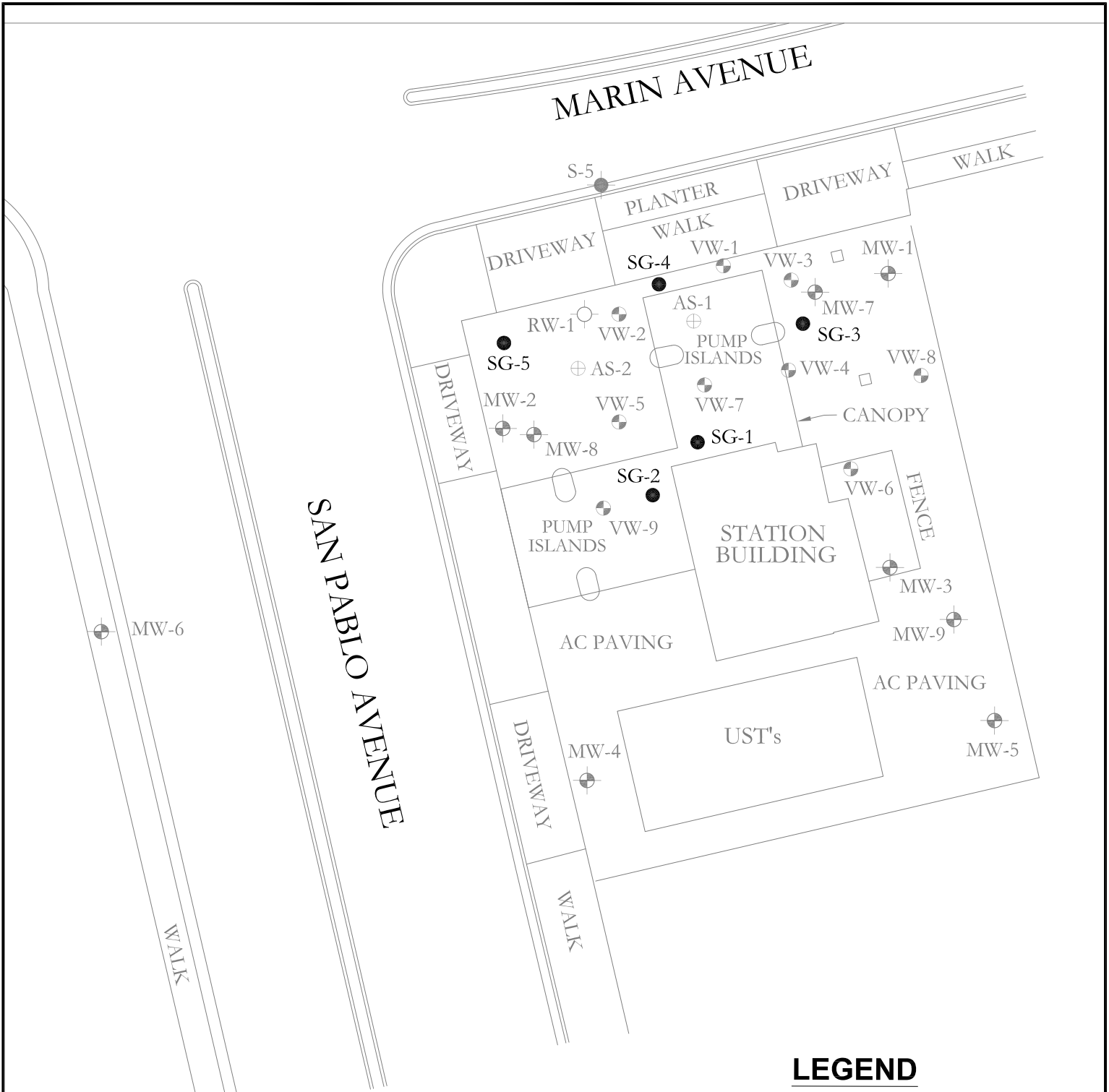

LEGEND

- Soil Gas Boring/ Temporary Vapor well
- ⊕ (ARCO) Monitoring well
- ⊕ (ARCO) Vapor extraction well
- ⊕ (ARCO) Air sparge well
- S-5 ● (Shell) Monitoring well

NOTES: SITE MAP ADAPTED FROM WOOD RODGERS FIGURE. SITE DIMENSIONS AND FACILITY LOCATIONS NOT VERIFIED.

