

Atlantic Richfield Company

Chuck Carmel
Environmental Business Manager

RECEIVED

10:32 am, Oct 19, 2009

**Alameda County
Environmental Health**

PO Box 1257
San Ramon, CA 94583
Phone: (925) 275-3803
Fax: (925) 275-3815
E-Mail: charles.carmel@bp.com

16 October 2009

Re: Third Quarter 2009 Status Report
Atlantic Richfield Company Station #2035
1001 San Pablo Avenue, Albany, California
ACEH Case #RO0000100

"I declare, that to the best of my knowledge at the present time, that the information and/or recommendations contained in the attached document are true and correct.

Submitted by,



Chuck Carmel
Environmental Business Manager

Attachment

16 October 2009

Project No. 06-88-610

Atlantic Richfield Company
P.O. Box 1257
San Ramon, CA 94583
Submitted via ENFOS

Attn.: Mr. Chuck Carmel

Re: Third Quarter 2009 Status Report, Atlantic Richfield Company Station #2035
1001 San Pablo Avenue, Albany, California; ACEH Case #RO0000100

Dear Mr. Carmel:

Attached is the *Third Quarter 2009 Status Report* for Atlantic Richfield Company (a BP affiliated company) Station #2035 located at 1001 San Pablo Avenue, Albany, Alameda County, California. This report presents a summary of current developments at the Site through the Third Quarter 2009. Atlantic Richfield Company is presently awaiting comments or approval to the *Revised Vapor Intrusion Assessment Work Plan* submitted on 25 September 2009.

Should you have questions regarding this submittal, please do not hesitate to contact me at (530) 566-1400.

Sincerely,
BROADBENT & ASSOCIATES, INC.



Thomas A. Venus, P.E.
Senior Engineer

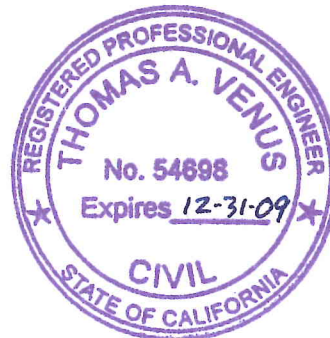

Enclosures

cc: Mr. Paresh Khatri, Alameda County Environmental Health (Submitted via ACEH ftp site)
Mr. John Lestrangle, 17851 State Highway 128, Calistoga, California 94515
Mr. Robert Cave, Bay Area Air Quality Management District (Submitted via GeoTracker)
Electronic copy uploaded to GeoTracker

STATION # 2035 QUARTERLY STATUS REPORT

Facility: #2035	Address: 1001 San Pablo Avenue, Albany, California
Environmental Business Manager:	Mr. Chuck Carmel
Consulting Co./Contact Person:	Broadbent & Associates, Inc.(BAI)/Mr. Tom Venus, PE (530) 566-1400
Consultant Project No.:	06-02-610
Primary Agency/Regulatory ID No.:	Alameda County Environmental Health (ACEH) ACEH Case # RO0000100
Permitting Agency/Facility Permits:	Bay Area Air Quality Management District (BAAQMD) BAAQMD Permit # 8694

WORK PERFORMED THIS QUARTER (Third Quarter 2009):

1. Prepared and submitted the *Second Quarter 2009 Semi-Annual Ground-Water Monitoring Report* (BAI, 7/15/2009).
2. Prepared and submitted *Vapor Intrusion Assessment Work Plan* (BAI, 8/10/2009) in response to directive letter from ACEH dated 11 June 2009.
3. Prepared and submitted *Revised Vapor Intrusion Assessment Work Plan* (BAI, 9/25/2009) in response to technical comments within directive letter from ACEH dated 3 September 2009.

WORK PROPOSED FOR NEXT QUARTER (Fourth Quarter 2009):

1. Prepared and submitted the *Third Quarter 2009 Status Report* (contained herein).
2. Conduct semi-annual ground-water monitoring/sampling for Fourth Quarter 2009. Work to be performed by BAI.
3. Implement *Revised Vapor Intrusion Assessment Work Plan* (BAI, 9/25/2009) pending approval from ACEH. Work to be performed by BAI.
4. Prepare and submit resultant soil and water investigation report as requested within directive letter by ACEH dated 3 September 2009.

SITE SUMMARY:

Current phase of project:	Ground-Water Monitoring/Sampling, Vapor Intrusion Assessment
Frequency of ground-water monitoring:	Semi-Annually (2Q and 4Q): Wells MW-1, MW-2, MW-3, MW-4, MW-5, MW-6, MW-7, MW-8, MW-9, RW-1, S-5
Frequency of ground-water sampling:	Semi-Annually (2Q and 4Q): Wells MW-4, MW-7, MW-8, MW-9, RW-1, and S-5 Annually (4Q): Wells MW-5 and MW-6
Is free product (FP) present on-site:	No
Depth to ground water (below TOC):	6.73 ft (MW-7) to 12.52 ft (MW-6) (4/9/2009)
General ground-water flow direction:	West (4/9/2009)
Approximate hydraulic gradient:	0.02 ft/ft (4/9/2009)

DISCUSSION:

A *Vapor Intrusion Assessment Work Plan* for environmental work at Station #2035 was prepared and submitted on 10 August 2009 to ACEH in response to a directive letter received from Mr. Paresh Khatri, dated 11 June 2009. Mr. Khatri responded to the submittal with technical comments within a letter from ACEH dated 3 September 2009. The technical comments focused on the number and locations of proposed soil vapor sampling implants. In response, a *Revised Vapor Intrusion Assessment Work Plan* was prepared and submitted on 25 September 2009. Atlantic Richfield Company has not received approval or comments to the most recent revised work plan submittal. Due to the modification

of the scope of work and work plan, an extension request from the due date of 23 December 2009 stipulated in the last ACEH letter appears justified and may be needed. For Reference, a Site Location Map is provided as Drawing 1. A Ground-Water Elevation Contour and Analytical Summary Map from the Second Quarter of 2009 is provided as Drawing 2. The proposed soil gas boring/temporary vapor well sampling locations are presented in Drawing 3.

ATTACHMENTS:

- Drawing 1. Site Location Map, ARCO Service Station #2035, 1001 San Pablo Avenue, Albany, California
- Drawing 2. Ground-Water Elevation Contour and Analytical Summary Map, 9 April 2009, ARCO Service Station #2035, 1001 San Pablo Avenue, Albany, California
- Drawing 3. Site Plan with Proposed Soil Gas Boring Locations, ARCO Service Station #2035, 1001 San Pablo Avenue, Albany, California

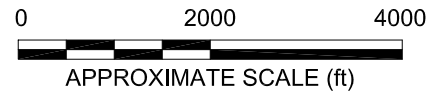
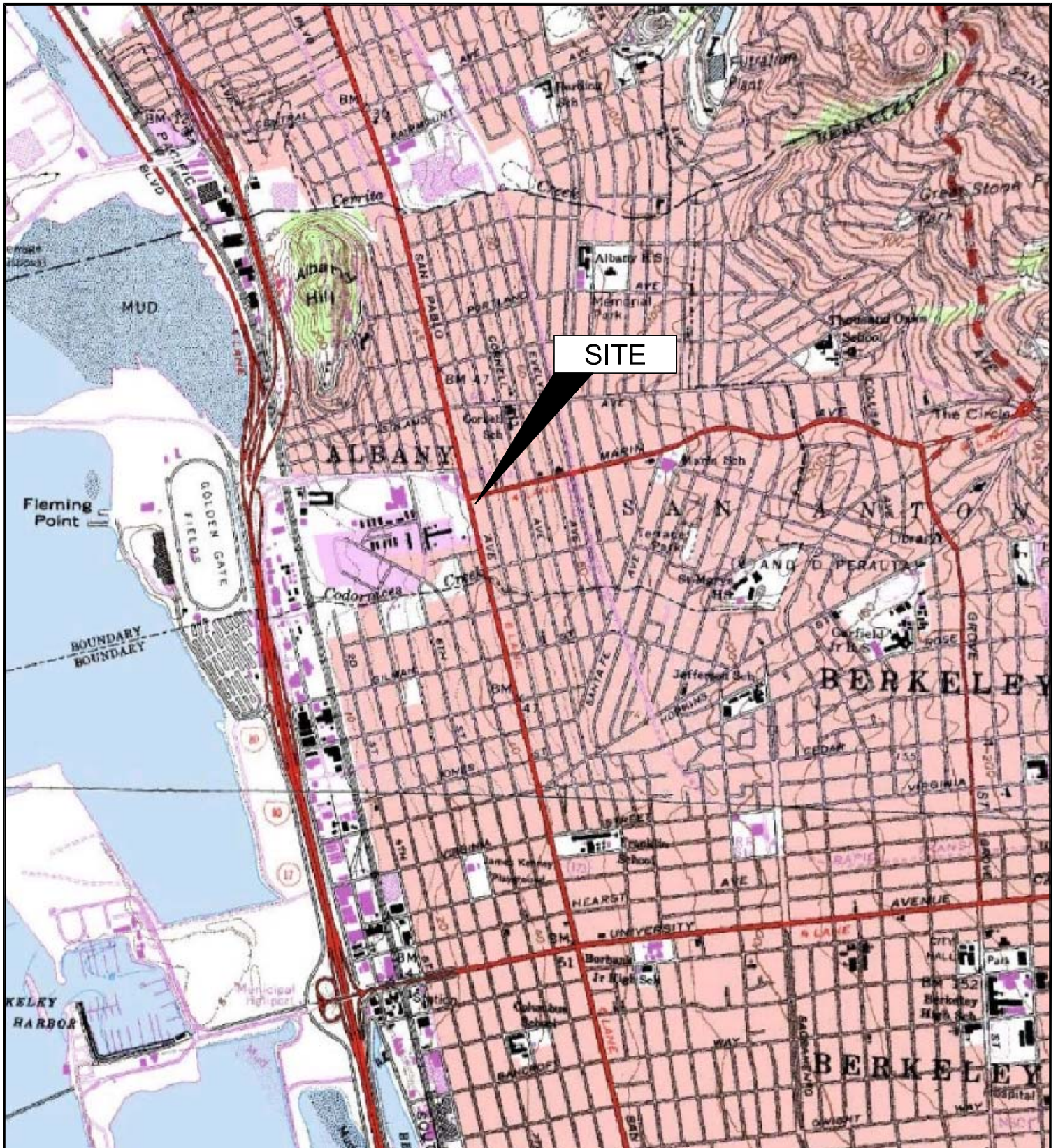
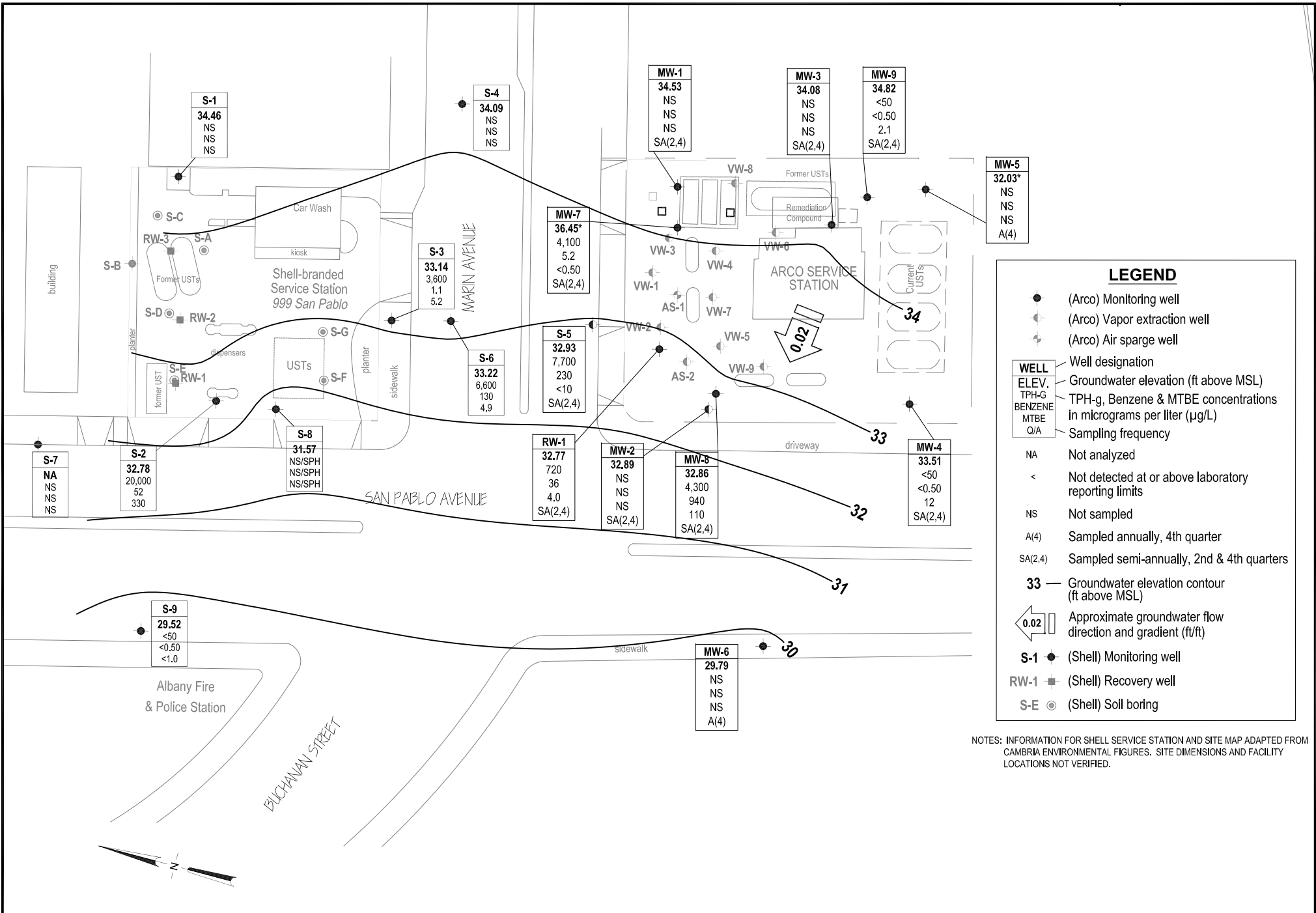

IMAGE SOURCE: USGS



NOTES: INFORMATION FOR SHELL SERVICE STATION AND SITE MAP ADAPTED FROM CAMBRIA ENVIRONMENTAL FIGURES. SITE DIMENSIONS AND FACILITY LOCATIONS NOT VERIFIED.



BROADBENT & ASSOCIATES, INC.
 ENGINEERING, WATER RESOURCES & ENVIRONMENTAL
 1324 Mangrove Ave. Suite 212 Chico 95926
 Project No.: 06-88-610 Date: 6/16/08

ARCO Service Station #2035
 1001 San Pablo Avenue
 Albany, California

Ground-Water Elevation Contour
 and Analytical Summary Map
 9 April 2009

Drawing
2

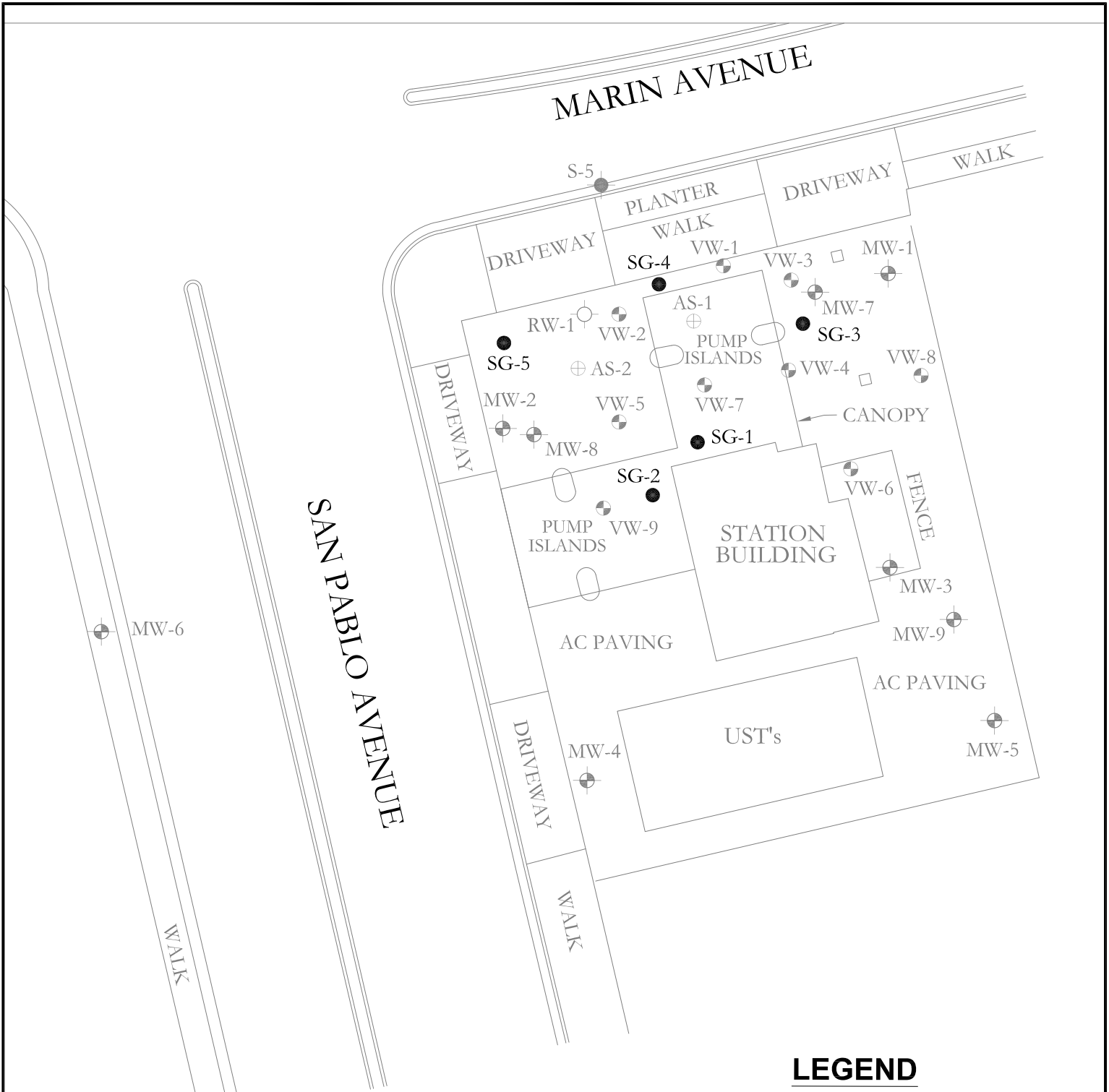

LEGEND

- Soil Gas Boring/ Temporary Vapor well
- ⊕ (ARCO) Monitoring well
- ⊙ (ARCO) Vapor extraction well
- ⊕ (ARCO) Air sparge well
- S-5 ● (Shell) Monitoring well

NOTES: SITE MAP ADAPTED FROM WOOD RODGERS FIGURE. SITE DIMENSIONS AND FACILITY LOCATIONS NOT VERIFIED.

