



Atlantic Richfield Company
(a BP affiliated company)

P.O. Box 1257
San Ramon, CA 94583
Phone: (925) 275-3801
Fax: (925) 275-3815

30 April 2009

Re: First Quarter 2009 Status Report
Atlantic Richfield Company Station #2035
1001 San Pablo Avenue
Albany, California
ACEH Case # RO0000100

“I declare, that to the best of my knowledge at the present time, that the information and/or recommendations contained in the attached document are true and correct.”

Submitted by:

Paul Supple
Environmental Business Manger

RECEIVED

10:09 am, May 01, 2009

Alameda County
Environmental Health



30 April 2009

Project No. 06-08-610

Atlantic Richfield Company
P.O. Box 1257
San Ramon, CA 94583
Submitted via ENFOS

Attn.: Mr. Paul Supple

Re: First Quarter 2009 Status Report, Atlantic Richfield Company (a BP affiliated company)
Station #2035, 1001 San Pablo Avenue, Albany, California; ACEH Case #RO0000100

Dear Mr. Supple:

Attached is the *First Quarter 2009 Status Report* for Atlantic Richfield Company Station #2035 located at 1001 San Pablo Avenue, Albany, Alameda County, California. This report presents a summary of current developments at the Site through the First Quarter 2009.

Should you have questions regarding this submittal, please do not hesitate to contact us at (530) 566-1400.

Sincerely,
BROADBENT & ASSOCIATES, INC.



Thomas A. Venus, P.E.
Senior Engineer



Robert H. Miller, P.G., C.HG.
Principal Hydrogeologist



Enclosures

cc: Mr. Paresh Khatri, Alameda County Environmental Health (Submitted via ACEH ftp site)
Mr. John Lestrangle, 17851 State Highway 128, Calistoga, California 94515
Mr. Robert Cave, Bay Area Air Quality Management District - Permit Division, 939 Ellis Street, San Francisco, California 94109
Electronic copy uploaded to GeoTracker

STATION # 2035 QUARTERLY GROUND-WATER STATUS REPORT

Facility: #2035	Address: 1001 San Pablo Avenue, Albany, California
Environmental Business Manager:	Mr. Paul Supple
Consulting Co./Contact Persons:	Broadbent & Associates, Inc.(BAI)/Rob Miller & Tom Venus (530) 566-1400
Consultant Project No.:	06-02-610
Primary Agency/Regulatory ID No.:	Alameda County Environmental Health (ACEH) ACEH Case # RO0000100
Permitting Agency/Facility Permits:	Bay Area Air Quality Management District (BAAQMD) BAAQMD Permit # 8694

WORK PERFORMED THIS QUARTER (First Quarter 2009):

1. Prepared and submitted the Fourth Quarter 2008 Semi-Annual Ground-Water Monitoring Report.
2. Conducted a soil and ground-water investigation which included monitoring well installation activities on-site between 25-27 March 2009. Work performed by Stratus Environmental, Inc. (Stratus)

WORK PROPOSED FOR NEXT QUARTER (Second Quarter 2009):

1. Prepared and submitted the First Quarter 2009 Status Report (contained herein).
2. Conduct semi-annual ground-water monitoring/sampling for Second Quarter 2009. Work to be performed by Stratus.
3. Prepare and submit a soil and ground-water investigation report by 20 May 2009 as requested by ACEH.

SITE SUMMARY:

Current phase of project:	Remediation/Natural Attenuation/Ground-water monitoring/sampling
Frequency of ground-water sampling:	Semi-Annually (2Q and 4Q): Wells MW-1, MW-2, MW-3, MW-4, RW-1, S-5 Annually (4Q): Wells MW-5 and MW-6
Frequency of ground-water monitoring:	Semi-Annually (2Q and 4Q)
Is free product (FP) present on-site:	No
Depth to ground water (below TOC):	10.00 ft (RW-1) to 13.2 ft (MW-6) (11/7/2008)
General ground-water flow direction:	West (11/7/2008)
Approximate hydraulic gradient:	0.02 ft/ft (11/7/2008)

DISCUSSION:

A soil and ground-water investigation was conducted on-site between 25-27 March 2009, as approved in the ACEH letter to Atlantic Richfield Company dated 19 February 2009. A Soil and Ground-Water Investigation Report will be submitted to ACEH by 20 May 2009. A Ground-Water Elevation Contour and Analytical Summary Map from Fourth Quarter 2008 is provided as Drawing 1.

ATTACHMENTS:

- Drawing 1. Ground-Water Elevation Contour and Analytical Summary Map, 7 November 2008, ARCO Service Station #2035, 1001 San Pablo Avenue, Albany, California

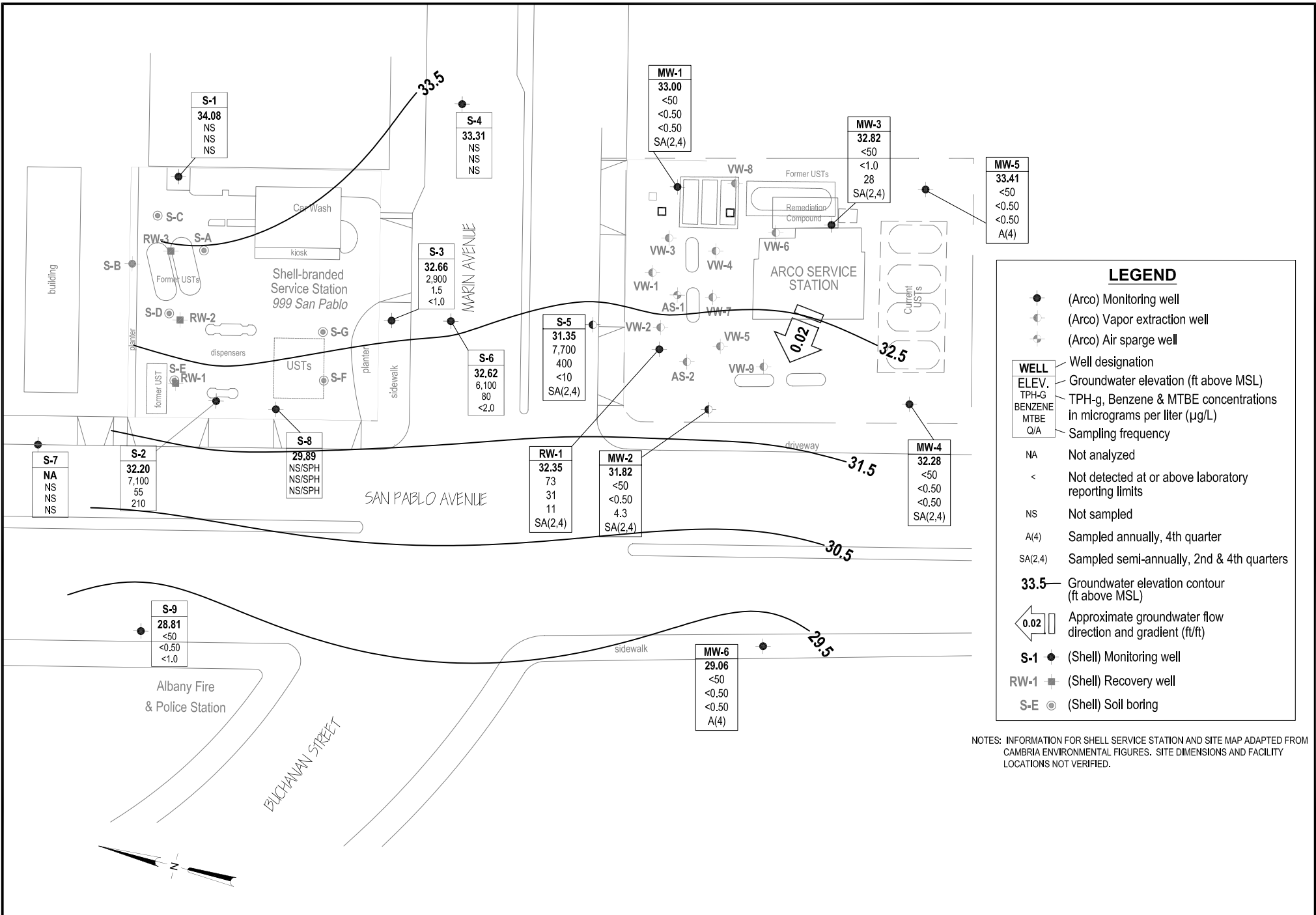

LEGEND

- (Arco) Monitoring well
- ◐ (Arco) Vapor extraction well
- ⚡ (Arco) Air sparge well

WELL	ELEV.	TPH-G	BENZENE	MTBE	Q/A
	Well designation				
	Groundwater elevation (ft above MSL)				
	TPH-g, Benzene & MTBE concentrations in micrograms per liter (µg/L)				
	Sampling frequency				
NA	Not analyzed				
<	Not detected at or above laboratory reporting limits				
NS	Not sampled				
A(4)	Sampled annually, 4th quarter				
SA(2,4)	Sampled semi-annually, 2nd & 4th quarters				

- 33.5 — Groundwater elevation contour (ft above MSL)
- ◁ 0.02 ▷ Approximate groundwater flow direction and gradient (ft/ft)
- S-1 ● (Shell) Monitoring well
- RW-1 ◐ (Shell) Recovery well
- S-E ○ (Shell) Soil boring

NOTES: INFORMATION FOR SHELL SERVICE STATION AND SITE MAP ADAPTED FROM CAMBRIA ENVIRONMENTAL FIGURES. SITE DIMENSIONS AND FACILITY LOCATIONS NOT VERIFIED.

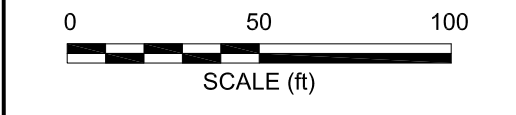

BROADBENT & ASSOCIATES, INC.
ENGINEERING, WATER RESOURCES & ENVIRONMENTAL
1324 Mangrove Ave. Suite 212 Chico 95926
Project No.: 06-08-610 Date: 12/18/08

ARCO Service Station #2035
1001 San Pablo Avenue
Albany, California

Ground-Water Elevation Contour
and Analytical Summary Map
24 November 2008