

**RECEIVED**

By Alameda County Environmental Health at 2:42 pm, Jan 27, 2014

## Atlantic Richfield Company

**Chuck Carmel**  
Remediation Management Project Manager

PO Box 1257  
San Ramon, CA 94583  
Phone: (925) 275-3804  
Fax: (925) 275-3815  
E-Mail: chuck.carmel@bp.com

January 24, 2014

Re: Fourth Quarter 2013 Status Report  
Atlantic Richfield Company Station No. 2035  
1001 San Pablo Avenue, Albany, California  
ACEH Case #RO0000100

I declare that to the best of my knowledge at the present time, that the information and/or recommendations contained in the attached document are true and correct.

Submitted by,



**Chuck Carmel**  
Remediation Management Project Manager

Attachment



**BROADBENT**

875 Cotting Ln., Suite G, Vacaville, CA 95688

[T] 707-455-7290 [F] 707-455-7295

broadbentinc.com

**CREATING SOLUTIONS. BUILDING TRUST.**

January 24, 2014

Project No. 06-88-610

Atlantic Richfield Company  
P.O. Box 1257  
San Ramon, CA 94583  
Submitted via ENFOS

Attn.: Mr. Chuck Carmel

Re: Fourth Quarter 2013 Status Report, Atlantic Richfield Company Station No. 2035,  
1001 San Pablo Avenue, Albany, California; ACEH Case #RO0000100

Dear Mr. Carmel:

Attached is the Fourth Quarter 2013 Status Report for Atlantic Richfield Company Station No. 2035 located at 1001 San Pablo Avenue in Albany, California. This report presents a summary of current developments at the Site through the Fourth Quarter 2013.

Should you have questions regarding this submittal, please do not hesitate to contact us at (707) 455-7290.

Sincerely,

BROADBENT & ASSOCIATES, INC.

Kristene Tidwell, P.G., C.Hg.  
Senior Geologist

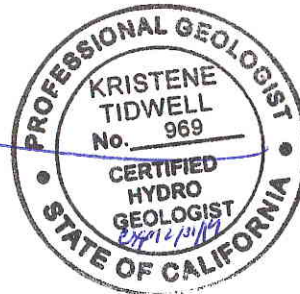

Enclosures

cc: Mr. Jerry Wickham, Alameda County Environmental Health (submitted via ACEH ftp site)  
Mr. John LeStrange, 17851 State Highway 128, Calistoga, California 94515  
Electronic copy uploaded to GeoTracker

**FOURTH QUARTER 2013  
STATUS REPORT  
ARCO STATION No. 2035, ALBANY, CALIFORNIA**

Broadbent & Associates, Inc. (Broadbent) is pleased to present this *Fourth Quarter 2013 Status Report* on behalf of Atlantic Richfield Company (a BP affiliated company) for ARCO Station No. 2035 located on 1001 San Pablo Avenue in Albany, Alameda County, California (the Site). Quarterly reporting is being submitted to the Alameda County Environmental Health Services Agency (ACEH) consistent with their requirements under the legal authority of the California Regional Water Quality Control Board as codified by California Code of Regulations Title 23, Section 2652(d). A summary description of current developments regarding the Site is provided below.

Facility Name / Address:	ARCO Station No. 2035 / 1001 San Pablo Avenue, Albany
Client Project Manager / Title:	Mr. Chuck Carmel / Remediation Management Project Manager
Broadbent Contact:	Ms. Kristene Tidwell, P.G., C.Hg. / 707-455-7290
Broadbent Project No.:	06-88-610
Primary Regulatory Agency / ID No.:	ACEH, Case #RO0000100
Current phase of project:	Monitoring
List of Acronyms / Abbreviations:	ACEH: Alameda County Environmental Health ARCO: Atlantic Richfield Company

**WORK PERFORMED THIS QUARTER (Fourth Quarter 2013):**

1. Submitted *Third Quarter 2013 Monitoring Report* on October 15, 2013.
2. Received a *Landowner and Public Notification* letter from the ACEH dated November 25, 2013, indicating the Site is eligible for Case Closure.
3. No environmental field work was conducted at Station No. 2035 during the Third Quarter 2013.

**WORK SCHEDULED FOR NEXT QUARTER (First Quarter 2014):**

1. Prepared and submitted *Fourth Quarter 2013 Status Report* (contained herein).
2. Conduct well decommissioning/other closure activities once the public review period has expired on January 26, 2014.

**DISCUSSION:**

The most recent groundwater monitoring and sampling event occurred during the Second Quarter 2013. The results of this sampling are outlined in the Second Quarter Groundwater Monitoring Report submitted July 29, 2013. Sampling has currently been suspended at the Site pending final case closure. The case is currently in the Public Comment period preceding case closure. It is anticipated that well decommissioning/closure activities will take place shortly after the comment period expires on January 26, 2014.

A Site Location Map is included as Drawing 1. The most recent groundwater elevation contour map is included as Drawing 2.

**ATTACHMENTS:**

- Drawing 1: Site Location Map  
Drawing 2: Groundwater Elevation Contour Map, June 4, 2013

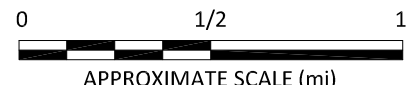
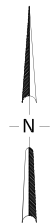
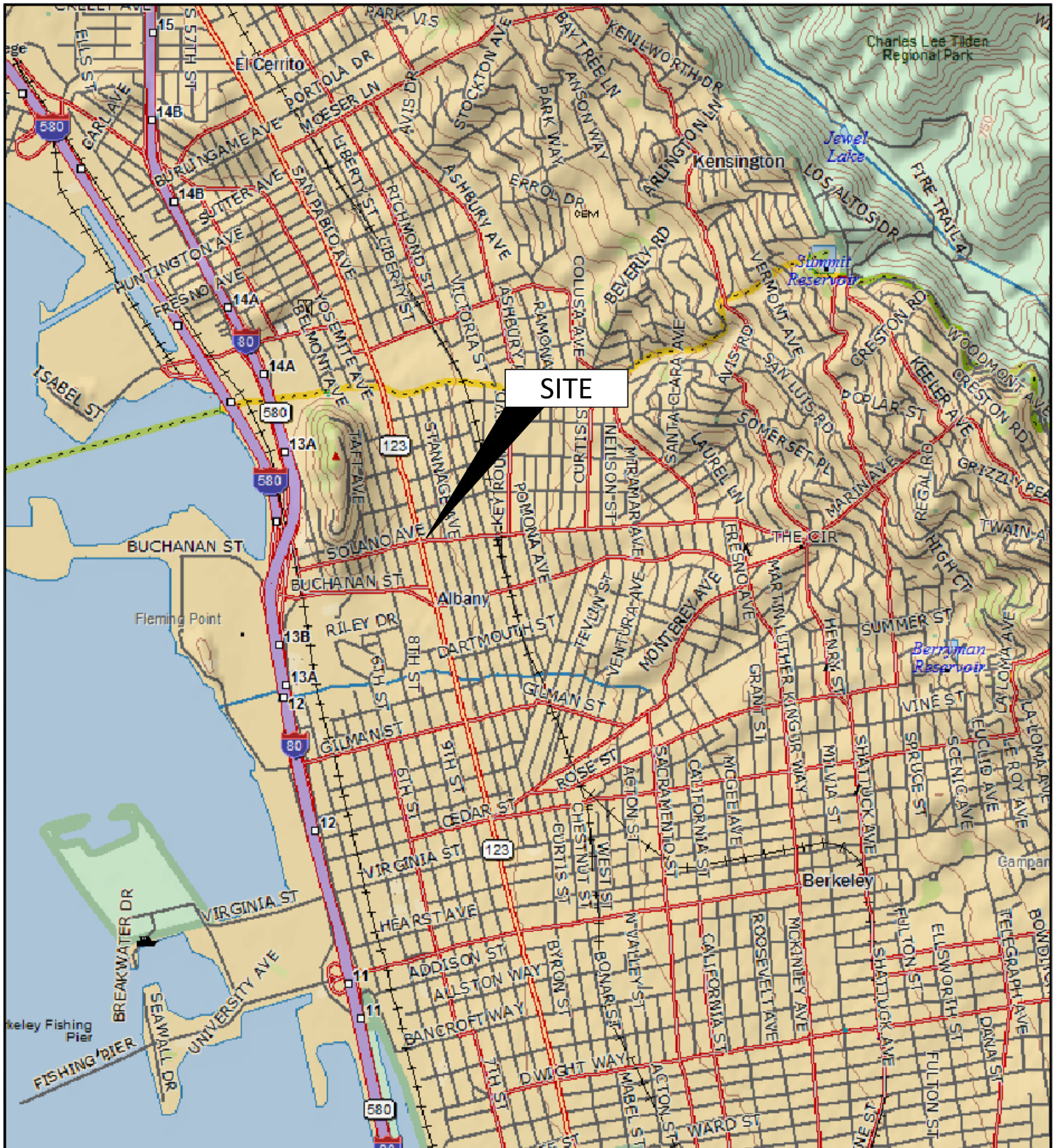

APPROXIMATE SCALE (mi)

IMAGE SOURCE: DeLorme USA Topo 7.0

**BROADBENT**  
 1370 Ridgewood Dr., Suite 5  
 Chico, California 95973  
 Project No.: 06-88-610 Date: 4/9/2013

ARCO Service Station #2035  
 1001 San Pablo Avenue  
 Albany, California

Site Location Map

Drawing

1



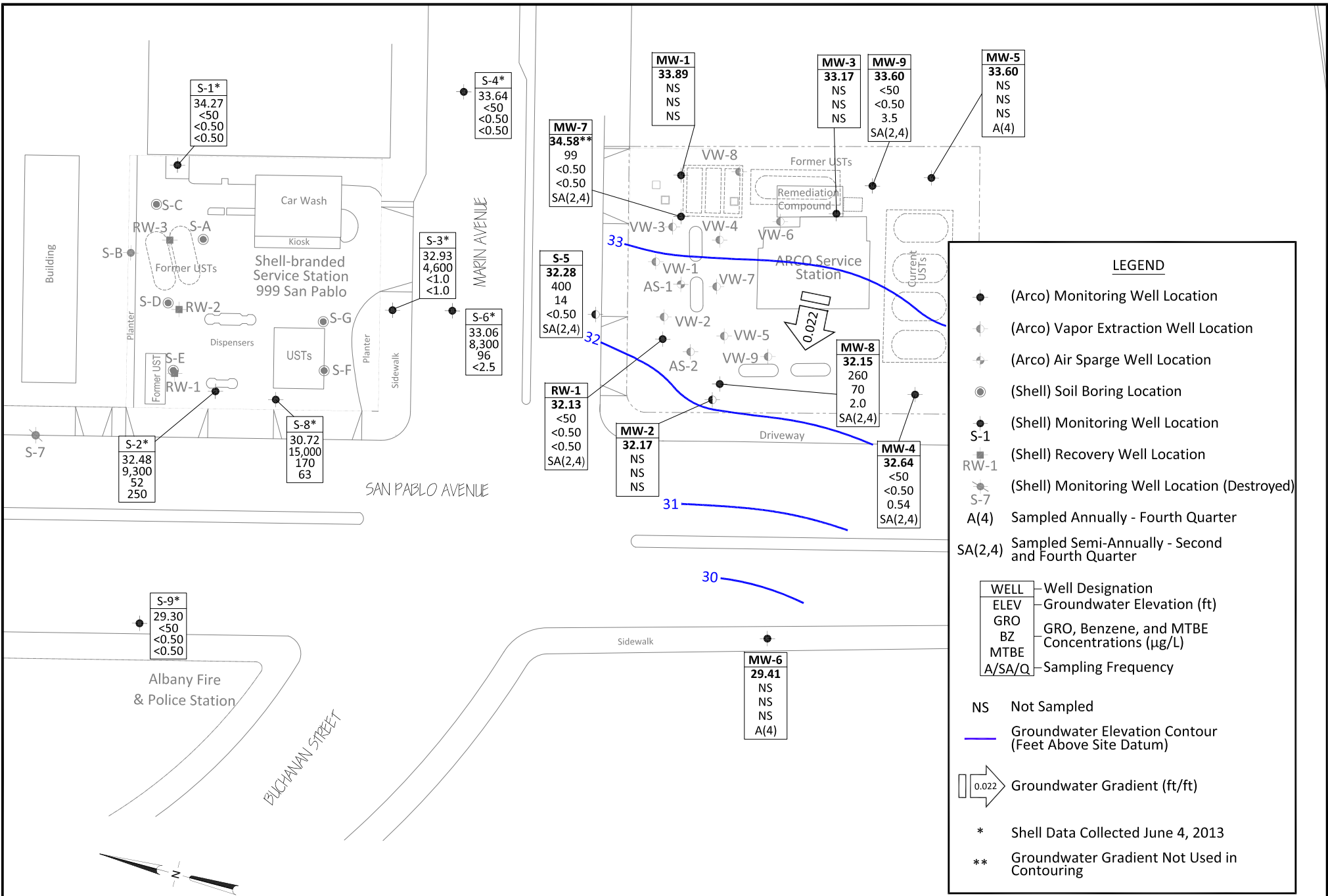

NOTE: INFORMATION FOR SHELL SERVICE STATION AND SITE MAP ADAPTED FROM CABRIA ENVIRONMENTAL FIGURE. SITE DIMENSIONS AND FACILITY LOCATIONS NOT VERIFIED.

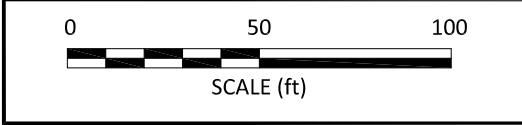

**BROADBENT**  
 1370 Ridgewood Dr., Suite 5  
 Chico, California 95973  
 Project No.: 06-88-610 Date: 7/11/2013

ARCO Service Station #2035  
 1001 San Pablo Avenue  
 Albany, California

Groundwater Elevation Contour Map  
 June 4, 2013