

**RECEIVED**

By Alameda County Environmental Health at 4:17 pm, Jul 31, 2013

## Atlantic Richfield Company

**Shannon Couch**  
Operations Project Manager

PO Box 1257  
San Ramon, CA 94583  
Phone: (925) 275-3804  
Fax: (925) 275-3815  
E-Mail: shannon.couch@bp.com

July 29, 2013

Re: Second Quarter 2013 Monitoring Report  
Atlantic Richfield Company Station #2035  
1001 San Pablo Avenue, Albany, California  
ACEH Case #RO0000100

I declare that to the best of my knowledge at the present time, that the information and/or recommendations contained in the attached document are true and correct.

Submitted by,

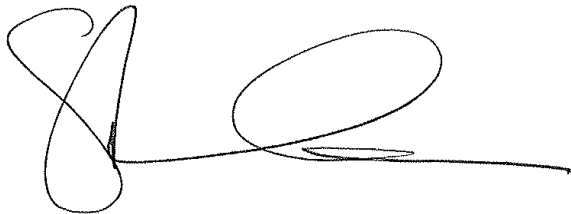
A handwritten signature in black ink, consisting of a large, stylized 'S' followed by a horizontal line that ends in a small loop.

Shannon Couch  
Operations Project Manager

Attachment

July 29, 2013

Project No. 06-88-610

Atlantic Richfield Company  
P.O. Box 1257  
San Ramon, California 94583  
Submitted via ENFOS

Attn.: Ms. Shannon Couch

Re: Second Quarter 2013 Monitoring Report, Atlantic Richfield Company Station No. 2035,  
1001 San Pablo Avenue, Albany, Alameda County, California; ACEH Case #RO0000100

Dear Ms. Couch:

Provided herein is the *Second Quarter 2013 Monitoring Report* for Atlantic Richfield Company Station No. 2035 located at 1001 San Pablo Avenue in Albany, Alameda County, California. Should you have questions regarding the work performed or results obtained, please do not hesitate to contact me at (707) 455-7290.

Sincerely,

BROADBENT & ASSOCIATES, INC.

  
Alejandra Hernandez  
Project Geologist

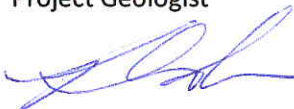
  
Kristene Tidwell, PG, CHG  
Senior Geologist

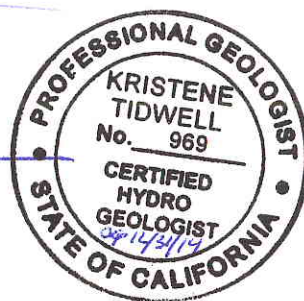

Enclosures

cc: Ms. Dilan Roe, Alameda County Environmental Health (Submitted via ACEH ftp site)  
Electronic copy uploaded to GeoTracker

**SECOND QUARTER 2013  
MONITORING REPORT  
ARCO STATION No. 2035, ALBANY, CALIFORNIA**

Broadbent & Associates, Inc. (Broadbent) is pleased to present this *Second Quarter 2013 Monitoring Report* on behalf of Atlantic Richfield Company (ARCO) – a BP affiliated company, for ARCO Station No. 2035 (herein referred to as Station No. 2035) located at 1001 San Pablo Avenue in Albany, Alameda County, California (Site). Monitoring activities at the Site were performed in accordance with an agency directive issued by the Alameda County Environmental Health (ACEH). Details of work performed, discussion of results, and recommendations are provided below.

|                                     |   |
|-------------------------------------|---|
| Facility Name / Address:            | ARCO Station No.2035 / 1001 San Pablo Avenue, Albany, CA                  |
| Client Project Manager / Title:     | Ms. Shannon Couch / Operations Project Manager                            |
| Broadbent Contact:                  | Ms. Kristene Tidwell, PG, CHG / 707-455-7290                              |
| Broadbent Project No.:              | 06-88-610   |
| Primary Regulatory Agency / ID No.: | ACEH / Case #RO00001000   |
| Current phase of project:           | Monitoring  |
| List of Acronyms / Abbreviations:   | See end of report text for list of acronyms/abbreviations used in report. |

**WORK PERFORMED THIS QUARTER (Second Quarter 2013):**

1. Broadbent submitted a *First Quarter 2013 Status Report* on April 15, 2013.
2. Broadbent conducted groundwater monitoring/sampling on June 4, 2013 for Second Quarter 2013.

**WORK SCHEDULED FOR NEXT QUARTER (Third Quarter 2013):**

1. Submit *Second Quarter 2013 Monitoring Report* (contained herein).
2. No environmental work activities are scheduled to be conducted at the Site during the Third Quarter 2013.
3. Submit Conceptual Site Model and Case Closure Request.

**QUARTERLY MONITORING PLAN SUMMARY:**

|  |                                      |                          |
|--|--------------------------------------|--------------------------|
| Groundwater level gauging:                     | MW-1 through MW-9, RW-1, S-5         | (Semi-Annually: 2Q & 4Q) |
| Groundwater sample collection:                 | MW-4, MW-7, MW-8, MW-9,<br>RW-1, S-5 | (Semi-Annually: 2Q & 4Q) |
|  | MW-5, MW-6                           | (Annually: 1Q)           |
| Biodegradation indicator parameter monitoring: | None                                 |                          |

**QUARTERLY RESULTS SUMMARY:**

**LNAPL**

|                               |      |          |
|-------------------------------|------|----------|
| LNAPL observed this quarter:  | No   | (yes\no) |
| LNAPL recovered this quarter: | None | (gal)    |
| Cumulative LNAPL recovered:   | None | (gal)    |

**Groundwater Elevation and Gradient:**

|                              |                                   |                             |
|------------------------------|-----------------------------------|-----------------------------|
| Depth to groundwater:        | 8.60 ft (MW-7) to 12.90 ft (MW-6) | (ft below TOC)              |
| Gradient direction:          | West                              | (compass direction)         |
| Gradient magnitude:          | 0.022 ft/ft                       | (ft/ft)                     |
| Average change in elevation: | -2.77                             | (ft since last measurement) |

## Laboratory Analytical Data

### Summary:

- GRO was detected in three wells at concentrations ranging between 99 µg/L in well MW-7 and 400 µg/L in well S-5
  - Benzene was detected in two wells at concentrations of 14 µg/L in well S-5 and 70 µg/L in well MW-8
  - Toluene was detected in two wells at concentrations of 1.1 µg/L in well MW-8 and 1.8 µg/L in well S-5
  - Ethylbenzene was detected in two wells at concentrations of 3.1 µg/L in well S-5 and 34 µg/L in well MW-8
  - Total Xylenes were detected in two wells at concentrations of 1.6 µg/L in well MW-8 and 2.3 µg/L in well S-5
  - MTBE was detected in three wells at concentrations ranging between 0.54 µg/L in well MW-4 and 3.5 µg/L in well MW-9
  - TBA was detected in well MW-8 at a concentration of 26 µg/L
  - The remaining petroleum hydrocarbon constituents were below laboratory detection limits.
- 

## ACTIVITIES CONDUCTED & RESULTS:

On June 4, 2013, Broadbent conducted the Second Quarter 2013 groundwater monitoring and sampling event at Station No. 2035 in accordance with the quarterly monitoring plan summary detailed above. Conestoga-Rovers & Associates (CRA) conducted groundwater monitoring at the adjacent Shell Station on June 4, 2013. No irregularities were noted during water level gauging activities. Water levels were gauged in all wells associated with the Site. Light non-aqueous phase liquid (LNAPL) was not observed in any Site wells; LNAPL had been observed in well RW-1 dating back to 1995 monitoring/sampling event. Depth to water measurements at the Site ranged from 8.60 ft in well MW-7 to 12.90 ft in well MW-6. Resulting groundwater surface elevations at the Site ranged from 29.41 ft at well MW-6 to 34.58 ft at well MW-7. Water level elevations yielded a potentiometric groundwater gradient direction and magnitude to the west at 0.022 ft/ft. Field methods used during groundwater monitoring are provided in Appendix A. Field data sheets are included in Appendix B. Measured depths to groundwater and respective groundwater elevations are summarized in Table 1. Current and historic groundwater analytical data are summarized in Table 1 and Table 2. Current and historic groundwater gradient directions and magnitudes are provided within Table 3. A Site location map is provided as Drawing 1. A groundwater elevation contour and analytical summary map for June 4, 2013 is provided as Drawing 2.

Consistent with the current groundwater sampling schedule, all wells were gauged and water samples were collected from wells MW-4, MW-7 through MW-9, RW-1, and S-5. No irregularities were encountered during sampling at the Site. Collected groundwater samples were submitted to TestAmerica Environmental Laboratories, Inc. (TestAmerica) of Irvine, California for analysis of GRO by EPA Method 8015B; BTEX, MTBE, ETBE, TAME, DIPE, TBA, EDB, 1,2-DCA, and Ethanol by EPA Method 8260B. No significant irregularities were reported during analysis of the samples.

Laboratory analytical report and chain of custody record for are provided in Appendix C. Groundwater monitoring data (GEO\_WELL) and laboratory analytical results (EDF) were uploaded to the GeoTracker AB2886 database. Upload confirmation receipts are provided in Appendix D.

## **DISCUSSION:**

Groundwater levels and gradient data indicate that the gradient measured during Second Quarter 2013 monitoring is consistent with predominant measurements observed historic minimum and maximum elevations at the Site. During Second Quarter 2013, groundwater elevations decreased an average of 2.77 ft across the Site relative to measurements collected during Fourth Quarter 2012.

Results of the second quarter groundwater data indicate that the highest residual hydrocarbon concentrations are present in wells MW-8 and S-5. However, detected analytical concentrations were within historic minimum and maximum ranges recorded for each well. Groundwater samples in well S-5 had a historic low for GRO and benzene concentrations.

## **RECOMMENDATIONS:**

No environmental work activities are scheduled to be conducted at the Site during the Third Quarter 2013. The next quarterly monitoring event is scheduled for the Fourth Quarter 2013. Unless directed by ACEH, no change to the monitoring program at Station No. 2035 is presently deemed warranted or recommended. The Site is currently being evaluated for Case Closure under the Low threat UST Policy. A Conceptual Site Model and Case Closure Request will be submitted during the third quarter 2013.

## **LIMITATIONS:**

The findings presented in this report are based upon observations of field personnel, points investigated, results of laboratory tests performed by TestAmerica and our understanding of ACEH guidelines. Our services were performed in accordance with the generally accepted standard of practice at the time this report was written. No other warranty, expressed or implied was made. This report has been prepared for the exclusive use of ARC. It is possible that variations in soil or groundwater conditions could exist beyond points explored in this investigation. Also, changes in site conditions could occur in the future due to variations in rainfall, temperature, regional water usage, or other factors.

**ATTACHMENTS:**

- Drawing 1: Site Location Map
- Drawing 2: Groundwater Elevation Contour Map June 4, 2013
  
- Table 1: Summary of Groundwater Monitoring Data: Relative Water Elevations and Laboratory Analyses
- Table 2: Summary of Fuel Additive Analytical Data
- Table 3: Historic Groundwater Gradient Information
  
- Appendix A: Field Methods
- Appendix B: Field Data Sheet
- Appendix C: Laboratory Report and Chain-of-Custody Documentation
- Appendix D: GeoTracker Upload Confirmation Receipts

**LIST OF COMMONLY USED ACRONYMS/ABBREVIATIONS:**

|            |   |        |  |
|------------|---|--------|--|
| ACEH       | Alameda County Environmental Health                     | ft/ft: | foot per foot  |
| ARCO:      | Atlantic Richfield Company                              | gal:   | gallons  |
| Broadbent: | Broadbent & Associates, Inc.                            | GRO:   | gasoline range organics (C6-12)  |
| BTEX:      | benzene, toluene, ethylbenzene, total xylenes           | LNAPL: | light non-aqueous phase liquid   |
| 1,2-DCA:   | 1,2-dichloroethane                                      | MTBE:  | methyl tertiary butyl ether  |
| DIPE:      | di-isopropyl ether                                      | Q:     | Quarter  |
| DO:        | dissolved oxygen  | RWQCB: | California Regional Water Quality Control Board-San Francisco Bay Region |
| EDB:       | 1,2-dibromomethane                                      | TAME:  | tert-amyl methyl ether   |
| ESLs:      | RWQCB Environmental Screening Levels (revised May 2008) | TBA:   | tert-butyl alcohol   |
| ETBE:      | Ethyl tert-butyl ether                                  | TOC:   | top of casing  |
| ft:        | foot  | µg/L:  | micrograms per liter   |



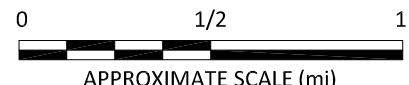
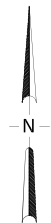
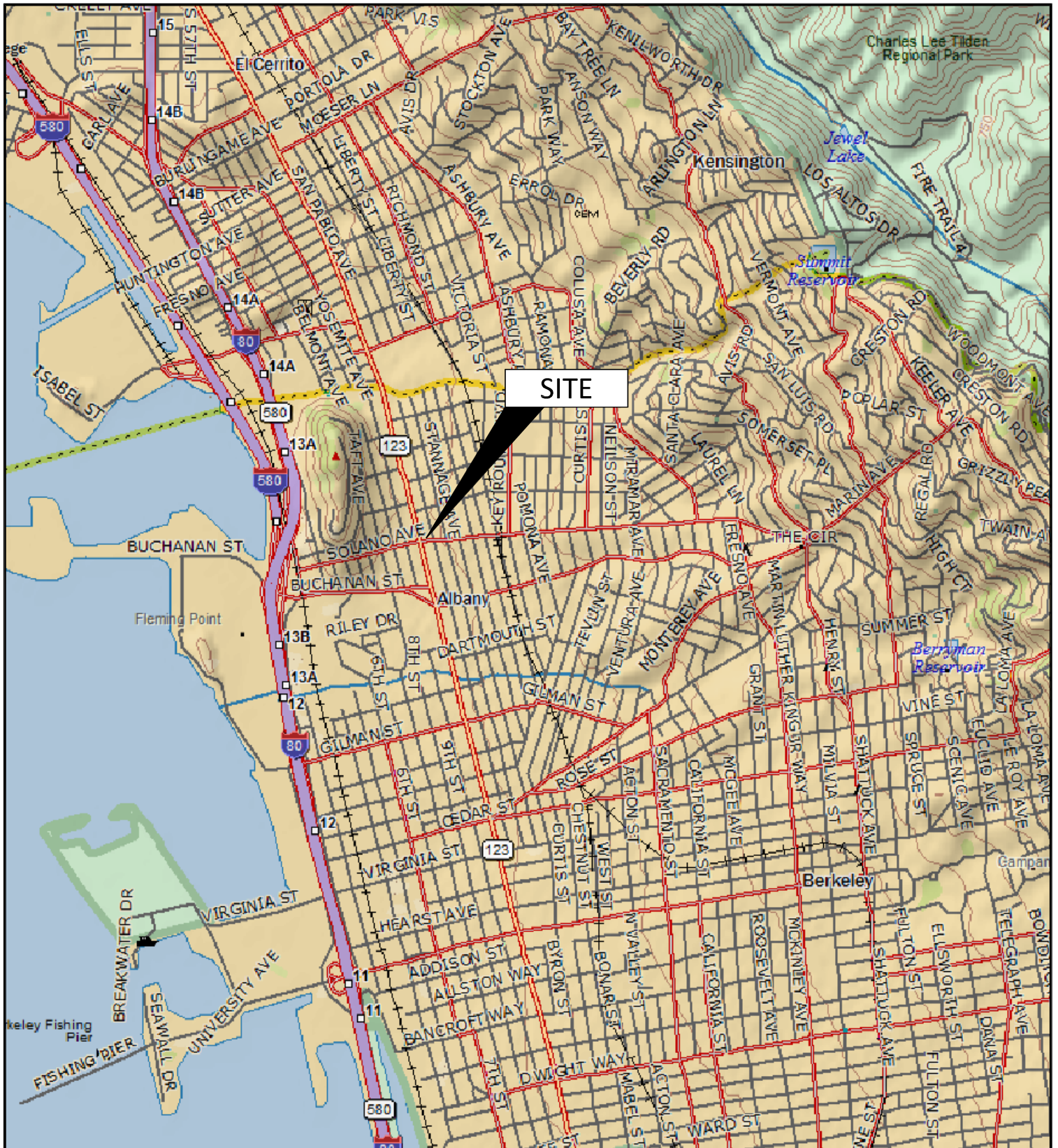

IMAGE SOURCE: DeLorme USA Topo 7.0



1370 Ridgewood Dr., Suite 5  
Chico, California 95973

Project No.: 06-88-610 Date: 4/9/2013

ARCO Service Station #2035  
1001 San Pablo Avenue  
Albany, California

Site Location Map

Drawing

1

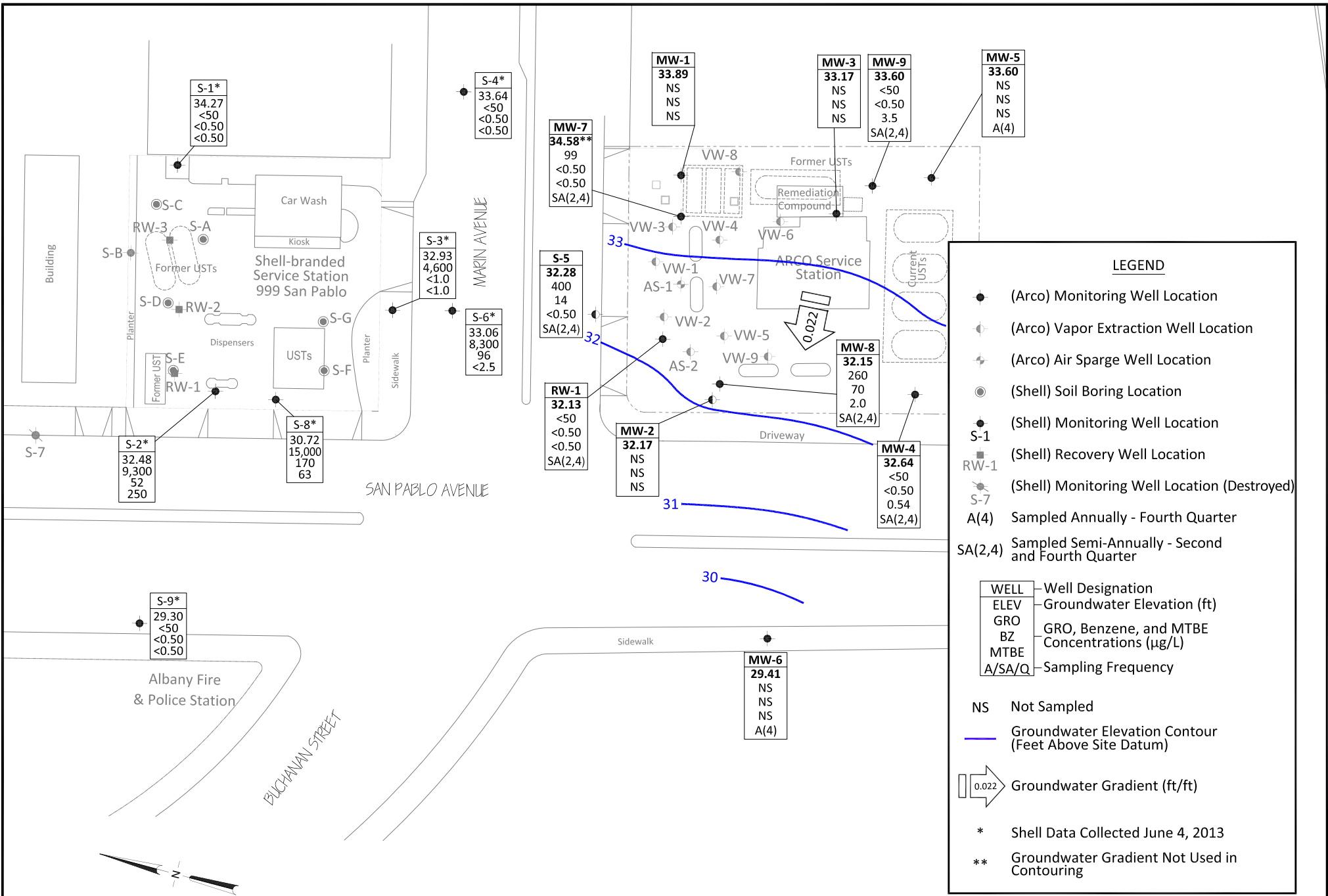

**LEGEND**

- (Arco) Monitoring Well Location
- (Arco) Vapor Extraction Well Location
- (Arco) Air Sparge Well Location
- (Shell) Soil Boring Location
- (Shell) Monitoring Well Location
- (Shell) Recovery Well Location
- (Shell) Monitoring Well Location (Destroyed)
- A(4) Sampled Annually - Fourth Quarter
- SA(2,4) Sampled Semi-Annually - Second and Fourth Quarter

| WELL   | Well Designation                             |
|--------|--|
| ELEV   | Groundwater Elevation (ft)                   |
| GRO    | GRO, Benzene, and MTBE Concentrations (µg/L) |
| BZ     |  |
| MTBE   |  |
| A/SA/Q | Sampling Frequency                           |

- NS Not Sampled
- Groundwater Elevation Contour (Feet Above Site Datum)
- 0.022 Groundwater Gradient (ft/ft)

\* Shell Data Collected June 4, 2013  
\*\* Groundwater Gradient Not Used in Contouring

NOTE: INFORMATION FOR SHELL SERVICE STATION AND SITE MAP ADAPTED FROM CABRIA ENVIRONMENTAL FIGURE. SITE DIMENSIONS AND FACILITY LOCATIONS NOT VERIFIED.

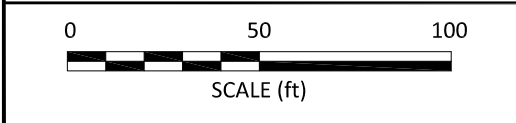

**BROADBENT**  
1370 Ridgewood Dr., Suite 5  
Chico, California 95973  
Project No.: 06-88-610 Date: 7/11/2013

ARCO Service Station #2035  
1001 San Pablo Avenue  
Albany, California

Groundwater Elevation Contour Map  
June 4, 2013

Drawing  
**2**



Table 1. Summary of Groundwater Monitoring Data: Relative Water Elevations and Laboratory Analyses

ARCO Service Station #2035, 1001 San Pablo Ave., Albany, CA

| Well ID and Date Monitored | P/NP      | TOC (feet) | Top of Screen (ft bgs) | Bottom of Screen (ft bgs) | DTW (feet)  | Product Thickness (feet) | Water Level Elevation (feet) | Concentrations in µg/L |           |           |               |               |           | DO (mg/L) | pH        | Footnote |
|----------------------------|-----------|------------|------------------------|---------------------------|-------------|--------------------------|------------------------------|------------------------|-----------|-----------|---------------|---------------|-----------|-----------|-----------|----------|
|                            |           |            |                        |                           |             |                          |                              | GRO/TPHg               | Benzene   | Toluene   | Ethyl-Benzene | Total Xylenes | MTBE      |           |           |          |
| <b>MW-1</b>                |           |            |                        |                           |             |                          |                              |                        |           |           |               |               |           |           |           |          |
| 4/11/2002                  | P         | 41.41      | 15.00                  | 30.00                     | 10.73       | 0.00                     | 30.68                        | 800                    | 360       | <5.0      | <5.0          | <5.0          | <50       | --        | --        |          |
| 11/27/2002                 | P         |            | 15.00                  | 30.00                     | 10.22       | 0.00                     | 31.19                        | <50                    | <0.50     | <0.50     | <0.50         | <0.50         | 1.7       | 1.1       | --        |          |
| 6/3/2003                   | --        |            | 15.00                  | 30.00                     | 9.14        | 0.00                     | 32.27                        | 1,700                  | 430       | <5.0      | 24            | 11            | 8.6       | 1.7       | --        |          |
| 11/13/2003                 | P         | 43.55      | 15.00                  | 30.00                     | 10.17       | 0.00                     | 33.38                        | <50                    | <0.50     | <0.50     | <0.50         | <0.50         | 0.95      | 2.3       | 6.5       | a        |
| 05/12/2004                 | P         |            | 15.00                  | 30.00                     | 9.28        | 0.00                     | 34.27                        | 120                    | 7.2       | <0.50     | <0.50         | <0.50         | 3.0       | 1.6       | 6.0       |          |
| 12/01/2004                 | P         |            | 15.00                  | 30.00                     | 9.16        | 0.00                     | 34.39                        | <50                    | 0.94      | <0.50     | <0.50         | 1.1           | 2.4       | 5.2       | 6.6       |          |
| 05/02/2005                 | P         |            | 15.00                  | 30.00                     | 8.58        | 0.00                     | 34.97                        | 1,300                  | 390       | <5.0      | 12            | 6.4           | 8.8       | 2.8       | 6.5       |          |
| 11/16/2005                 | P         |            | 15.00                  | 30.00                     | 9.50        | 0.00                     | 34.05                        | <50                    | <0.50     | <0.50     | <0.50         | 0.54          | 0.92      | 1.7       | 6.4       |          |
| 5/31/2006                  | P         |            | 15.00                  | 30.00                     | 7.36        | 0.00                     | 36.19                        | 850                    | 200       | <2.5      | 5.4           | <2.5          | 4.0       | 2.4       | 6.5       |          |
| 12/6/2006                  | P         |            | 15.00                  | 30.00                     | 9.91        | 0.00                     | 33.64                        | <50                    | 0.52      | <0.50     | <0.50         | <0.50         | 0.72      | 4.50      | 6.99      |          |
| 5/15/2007                  | P         |            | 15.00                  | 30.00                     | 9.65        | 0.00                     | 33.90                        | 67                     | 6.6       | <0.50     | <0.50         | <0.50         | 1.8       | 2.43      | 6.96      |          |
| 11/29/2007                 | P         |            | 15.00                  | 30.00                     | 9.11        | 0.00                     | 34.44                        | <50                    | <0.50     | <0.50     | <0.50         | <0.50         | 0.98      | 4.51      | 6.81      |          |
| 5/6/2008                   | P         |            | 15.00                  | 30.00                     | 8.25        | 0.00                     | 35.30                        | 890                    | 140       | 0.53      | 5.4           | 5.8           | <0.50     | 1.89      | 6.61      |          |
| 11/24/2008                 | P         |            | 15.00                  | 30.00                     | 10.55       | 0.00                     | 33.00                        | <50                    | <0.50     | <0.50     | <0.50         | <0.50         | <0.50     | 1.83      | 6.67      |          |
| 4/9/2009                   | --        |            | 15.00                  | 30.00                     | 9.02        | 0.00                     | 34.53                        | --                     | --        | --        | --            | --            | --        | --        | --        | d        |
| 11/24/2009                 | --        |            | 15.00                  | 30.00                     | 9.24        | 0.00                     | 34.31                        | --                     | --        | --        | --            | --            | --        | --        | --        |          |
| 5/26/2010                  | --        |            | 15.00                  | 30.00                     | 8.47        | 0.00                     | 35.08                        | --                     | --        | --        | --            | --            | --        | --        | --        |          |
| 11/30/2010                 | --        |            | 15.00                  | 30.00                     | 8.62        | 0.00                     | 34.93                        | --                     | --        | --        | --            | --            | --        | --        | --        |          |
| 2/16/2011                  | P         |            | 15.00                  | 30.00                     | 8.64        | 0.00                     | 34.91                        | --                     | --        | --        | --            | --            | --        | --        | --        |          |
| 5/11/2011                  | --        |            | 15.00                  | 30.00                     | 8.24        | 0.00                     | 35.31                        | --                     | --        | --        | --            | --            | --        | --        | --        |          |
| 11/28/2011                 | --        |            | 15.00                  | 30.00                     | 9.48        | 0.00                     | 34.07                        | --                     | --        | --        | --            | --            | --        | --        | --        |          |
| 6/5/2012                   | --        |            | 15.00                  | 30.00                     | 8.62        | 0.00                     | 34.93                        | --                     | --        | --        | --            | --            | --        | --        | --        |          |
| 12/6/2012                  | --        |            | 15.00                  | 30.00                     | 7.71        | 0.00                     | 35.84                        | --                     | --        | --        | --            | --            | --        | --        | --        |          |
| <b>6/4/2013</b>            | <b>--</b> |            | <b>15.00</b>           | <b>30.00</b>              | <b>9.66</b> | <b>0.00</b>              | <b>33.89</b>                 | <b>--</b>              | <b>--</b> | <b>--</b> | <b>--</b>     | <b>--</b>     | <b>--</b> | <b>--</b> | <b>--</b> |          |
| <b>MW-2</b>                |           |            |                        |                           |             |                          |                              |                        |           |           |               |               |           |           |           |          |
| 4/11/2002                  | P         | 40.38      | 20.00                  | 29.00                     | 11.05       | 0.00                     | 29.33                        | <50                    | <0.50     | <0.50     | <0.50         | <0.50         | 24        | --        | --        |          |
| 11/27/2002                 | P         |            | 20.00                  | 29.00                     | 10.51       | 0.00                     | 29.87                        | <50                    | <0.50     | <0.50     | <0.50         | <0.50         | 5.4       | 2.6       | --        |          |
| 6/3/2003                   | --        |            | 20.00                  | 29.00                     | 9.78        | 0.00                     | 30.60                        | <50                    | <0.50     | <0.50     | <0.50         | <0.50         | 23        | 1.7       | --        |          |
| 11/13/2003                 | P         | 42.52      | 20.00                  | 29.00                     | 10.69       | 0.00                     | 31.83                        | <50                    | <0.50     | <0.50     | <0.50         | <0.50         | 9.5       | 2.3       | 6.5       | a        |
| 05/12/2004                 | P         |            | 20.00                  | 29.00                     | 10.34       | 0.00                     | 32.18                        | <250                   | <2.5      | <2.5      | <2.5          | <2.5          | 27        | 2.2       | 6.6       |          |

**Table 1. Summary of Groundwater Monitoring Data: Relative Water Elevations and Laboratory Analyses**

**ARCO Service Station #2035, 1001 San Pablo Ave., Albany, CA**

| Well ID and Date Monitored | P/NP | TOC (feet) | Top of Screen (ft bgs) | Bottom of Screen (ft bgs) | DTW (feet)   | Product Thickness (feet) | Water Level Elevation (feet) | Concentrations in µg/L |         |         |               |               |      | DO (mg/L) | pH   | Footnote |
|----------------------------|------|------------|------------------------|---------------------------|--------------|--------------------------|------------------------------|------------------------|---------|---------|---------------|---------------|------|-----------|------|----------|
|                            |      |            |                        |                           |              |                          |                              | GRO/TPHg               | Benzene | Toluene | Ethyl-Benzene | Total Xylenes | MTBE |           |      |          |
| <b>MW-2 Cont.</b>          |      |            |                        |                           |              |                          |                              |                        |         |         |               |               |      |           |      |          |
| 12/01/2004                 | P    | 42.52      | 20.00                  | 29.00                     | 10.28        | 0.00                     | 32.24                        | <50                    | <0.50   | <0.50   | <0.50         | 0.70          | 17   | 3.9       | 6.6  |          |
| 05/02/2005                 | P    |            | 20.00                  | 29.00                     | 9.50         | 0.00                     | 33.02                        | <50                    | <0.50   | <0.50   | <0.50         | <0.50         | 25   | 3.1       | 6.6  |          |
| 11/16/2005                 | P    |            | 20.00                  | 29.00                     | 10.50        | 0.00                     | 32.02                        | <50                    | <0.50   | <0.50   | <0.50         | 0.50          | 7.6  | 2.8       | 6.4  |          |
| 5/31/2006                  | P    |            | 20.00                  | 29.00                     | 10.03        | 0.00                     | 32.49                        | <50                    | <0.50   | <0.50   | <0.50         | <0.50         | 24   | 2.0       | 6.6  |          |
| 12/6/2006                  | P    |            | 20.00                  | 29.00                     | 10.28        | 0.00                     | 32.24                        | <50                    | <0.50   | <0.50   | <0.50         | <0.50         | 1.6  | 3.72      | 6.91 |          |
| 5/15/2007                  | P    |            | 20.00                  | 29.00                     | 10.00        | 0.00                     | 32.52                        | <50                    | <0.50   | <0.50   | <0.50         | <0.50         | 44   | 2.90      | 6.69 |          |
| 11/29/2007                 | P    |            | 20.00                  | 29.00                     | 10.13        | 0.00                     | 32.39                        | <50                    | <0.50   | <0.50   | <0.50         | <0.50         | 1.9  | 4.83      | 6.89 |          |
| 5/6/2008                   | P    |            | 20.00                  | 29.00                     | 9.55         | 0.00                     | 32.97                        | <50                    | <0.50   | <0.50   | <0.50         | <0.50         | 35   | 1.88      | 6.62 |          |
| 11/24/2008                 | P    |            | 20.00                  | 29.00                     | 10.70        | 0.00                     | 31.82                        | <50                    | <0.50   | <0.50   | <0.50         | <0.50         | 4.3  | 1.83      | 6.74 |          |
| 4/9/2009                   | --   | 42.57      | 20.00                  | 29.00                     | 9.68         | 0.00                     | 32.89                        | --                     | --      | --      | --            | --            | --   | --        | --   | d        |
| 11/24/2009                 | --   |            | 20.00                  | 29.00                     | 10.48        | 0.00                     | 32.09                        | --                     | --      | --      | --            | --            | --   | --        | --   |          |
| 5/26/2010                  | --   |            | 20.00                  | 29.00                     | 9.65         | 0.00                     | 32.92                        | --                     | --      | --      | --            | --            | --   | --        | --   |          |
| 11/30/2010                 | --   |            | 20.00                  | 29.00                     | 9.84         | 0.00                     | 32.73                        | --                     | --      | --      | --            | --            | --   | --        | --   |          |
| 2/16/2011                  | P    |            | 20.00                  | 29.00                     | 9.39         | 0.00                     | 33.18                        | --                     | --      | --      | --            | --            | --   | --        | --   |          |
| 5/11/2011                  | --   |            | 20.00                  | 29.00                     | 9.68         | 0.00                     | 32.89                        | --                     | --      | --      | --            | --            | --   | --        | --   |          |
| 11/28/2011                 | --   |            | 20.00                  | 29.00                     | 10.12        | 0.00                     | 32.45                        | --                     | --      | --      | --            | --            | --   | --        | --   |          |
| 6/5/2012                   | --   |            | 20.00                  | 29.00                     | 10.20        | 0.00                     | 32.37                        | --                     | --      | --      | --            | --            | --   | --        | --   |          |
| 12/6/2012                  | --   |            | 20.00                  | 29.00                     | 8.19         | 0.00                     | 34.38                        | --                     | --      | --      | --            | --            | --   | --        | --   |          |
| <b>6/4/2013</b>            | --   |            | <b>20.00</b>           | <b>29.00</b>              | <b>10.40</b> | <b>0.00</b>              | <b>32.17</b>                 | --                     | --      | --      | --            | --            | --   | --        | --   |          |
| <b>MW-3</b>                |      |            |                        |                           |              |                          |                              |                        |         |         |               |               |      |           |      |          |
| 4/11/2002                  | P    | 41.44      | 13.00                  | 33.00                     | 11.05        | 0.00                     | 30.39                        | 250                    | 9.4     | <0.50   | <0.50         | <0.50         | 120  | --        | --   |          |
| 11/27/2002                 | P    |            | 13.00                  | 33.00                     | 10.49        | 0.00                     | 30.95                        | <100                   | <1.0    | <1.0    | <1.0          | 2.5           | 56   | 2.2       | --   |          |
| 6/3/2003                   | --   |            | 13.00                  | 33.00                     | 9.44         | 0.00                     | 32.00                        | 130                    | <0.50   | <0.50   | <0.50         | <0.50         | 47   | 4.1       | --   |          |
| 11/13/2003                 | P    | 43.62      | 13.00                  | 33.00                     | 10.68        | 0.00                     | 32.94                        | 53                     | <0.50   | <0.50   | <0.50         | <0.50         | 36   | 3.8       | 6.8  | a        |
| 05/12/2004                 | P    |            | 13.00                  | 33.00                     | 9.95         | 0.00                     | 33.67                        | 65                     | <0.50   | <0.50   | <0.50         | <0.50         | 39   | 4.2       | 6.9  |          |
| 12/01/2004                 | P    |            | 13.00                  | 33.00                     | 10.32        | 0.00                     | 33.30                        | 140                    | <0.50   | <0.50   | <0.50         | <0.50         | 37   | 4.3       | 6.9  |          |
| 05/02/2005                 | P    |            | 13.00                  | 33.00                     | 9.12         | 0.00                     | 34.50                        | 140                    | <0.50   | <0.50   | <0.50         | <0.50         | 23   | 3.1       | 6.7  |          |
| 11/16/2005                 | P    |            | 13.00                  | 33.00                     | 10.58        | 0.00                     | 33.04                        | <50                    | <0.50   | <0.50   | <0.50         | <0.50         | 32   | 4.1       | 6.5  |          |
| 5/31/2006                  | P    |            | 13.00                  | 33.00                     | 9.41         | 0.00                     | 34.21                        | <50                    | <0.50   | <0.50   | <0.50         | <0.50         | 20   | 4.3       | 6.8  |          |
| 12/6/2006                  | P    |            | 13.00                  | 33.00                     | 10.25        | 0.00                     | 33.37                        | <50                    | <0.50   | <0.50   | <0.50         | <0.50         | 20   | 2.71      | 7.00 |          |

Table 1. Summary of Groundwater Monitoring Data: Relative Water Elevations and Laboratory Analyses

ARCO Service Station #2035, 1001 San Pablo Ave., Albany, CA

| Well ID and Date Monitored | P/NP      | TOC (feet) | Top of Screen (ft bgs) | Bottom of Screen (ft bgs) | DTW (feet)   | Product Thickness (feet) | Water Level Elevation (feet) | Concentrations in µg/L |           |           |               |               |           | DO (mg/L) | pH        | Footnote |
|----------------------------|-----------|------------|------------------------|---------------------------|--------------|--------------------------|------------------------------|------------------------|-----------|-----------|---------------|---------------|-----------|-----------|-----------|----------|
|                            |           |            |                        |                           |              |                          |                              | GRO/TPHg               | Benzene   | Toluene   | Ethyl-Benzene | Total Xylenes | MTBE      |           |           |          |
| <b>MW-3 Cont.</b>          |           |            |                        |                           |              |                          |                              |                        |           |           |               |               |           |           |           |          |
| 5/15/2007                  | P         | 43.62      | 13.00                  | 33.00                     | 9.70         | 0.00                     | 33.92                        | <50                    | <0.50     | <0.50     | <0.50         | <0.50         | 40        | 5.89      | 7.07      |          |
| 11/29/2007                 | P         |            | 13.00                  | 33.00                     | 10.08        | 0.00                     | 33.54                        | 90                     | <0.50     | <0.50     | <0.50         | <0.50         | 35        | 4.74      | 6.61      |          |
| 5/6/2008                   | P         |            | 13.00                  | 33.00                     | 10.02        | 0.00                     | 33.60                        | <50                    | <0.50     | <0.50     | <0.50         | <0.50         | 14        | 2.05      | 6.61      |          |
| 11/24/2008                 | P         |            | 13.00                  | 33.00                     | 10.80        | 0.00                     | 32.82                        | <50                    | <1.0      | <1.0      | <1.0          | <1.0          | 28        | 1.98      | 6.77      |          |
| 4/9/2009                   | --        | 43.63      | 13.00                  | 33.00                     | 9.55         | 0.00                     | 34.08                        | --                     | --        | --        | --            | --            | --        | --        | --        | d        |
| 11/24/2009                 | --        |            | 13.00                  | 33.00                     | 10.29        | 0.00                     | 33.34                        | --                     | --        | --        | --            | --            | --        | --        | --        |          |
| 5/26/2010                  | --        |            | 13.00                  | 33.00                     | 9.76         | 0.00                     | 33.87                        | --                     | --        | --        | --            | --            | --        | --        | --        |          |
| 11/30/2010                 | --        |            | 13.00                  | 33.00                     | 10.15        | 0.00                     | 33.48                        | --                     | --        | --        | --            | --            | --        | --        | --        |          |
| 2/16/2011                  | P         |            | 13.00                  | 33.00                     | 9.22         | 0.00                     | 34.41                        | --                     | --        | --        | --            | --            | --        | --        | --        |          |
| 5/11/2011                  | --        |            | 13.00                  | 33.00                     | 9.55         | 0.00                     | 34.08                        | --                     | --        | --        | --            | --            | --        | --        | --        |          |
| 11/28/2011                 | --        |            | 13.00                  | 33.00                     | 10.06        | 0.00                     | 33.57                        | --                     | --        | --        | --            | --            | --        | --        | --        |          |
| 6/5/2012                   | --        |            | 13.00                  | 33.00                     | 9.92         | 0.00                     | 33.71                        | --                     | --        | --        | --            | --            | --        | --        | --        |          |
| 12/6/2012                  | --        |            | 13.00                  | 33.00                     | 8.10         | 0.00                     | 35.53                        | --                     | --        | --        | --            | --            | --        | --        | --        |          |
| <b>6/4/2013</b>            | <b>--</b> |            | <b>13.00</b>           | <b>33.00</b>              | <b>10.46</b> | <b>0.00</b>              | <b>33.17</b>                 | <b>--</b>              | <b>--</b> | <b>--</b> | <b>--</b>     | <b>--</b>     | <b>--</b> | <b>--</b> | <b>--</b> |          |
| <b>MW-4</b>                |           |            |                        |                           |              |                          |                              |                        |           |           |               |               |           |           |           |          |
| 4/11/2002                  | NP        | 40.33      | 9.00                   | 26.00                     | 10.81        | 0.00                     | 29.52                        | <50                    | <0.50     | <0.50     | <0.50         | <0.50         | 11        | --        | --        |          |
| 11/27/2002                 | NP        |            | 9.00                   | 26.00                     | 10.09        | 0.00                     | 30.24                        | <50                    | <0.50     | <0.50     | <0.50         | <0.50         | 6.5       | 1.8       | --        |          |
| 6/3/2003                   | --        |            | 9.00                   | 26.00                     | 8.62         | 0.00                     | 31.71                        | <250                   | <2.5      | <2.5      | <2.5          | <2.5          | 120       | 1.1       | --        |          |
| 11/13/2003                 | NP        | 42.48      | 9.00                   | 26.00                     | 9.98         | 0.00                     | 32.50                        | <50                    | <0.50     | <0.50     | <0.50         | <0.50         | 20        | 1.3       | 6.2       | a        |
| 05/12/2004                 | P         |            | 9.00                   | 26.00                     | 9.48         | 0.00                     | 33.00                        | <250                   | <2.5      | <2.5      | <2.5          | <2.5          | 79        | 2.9       | 6.6       |          |
| 12/01/2004                 | NP        |            | 9.00                   | 26.00                     | 9.60         | 0.00                     | 32.88                        | <50                    | <0.50     | <0.50     | <0.50         | <0.50         | 1.8       | 1.9       | 6.7       |          |
| 05/02/2005                 | NP        |            | 9.00                   | 26.00                     | 8.67         | 0.00                     | 33.81                        | <50                    | <0.50     | <0.50     | <0.50         | <0.50         | 11        | 2.8       | 6.6       |          |
| 11/16/2005                 | NP        |            | 9.00                   | 26.00                     | 10.00        | 0.00                     | 32.48                        | <50                    | <0.50     | <0.50     | <0.50         | <0.50         | 0.93      | 1.7       | 6.3       |          |
| 5/31/2006                  | NP        |            | 9.00                   | 26.00                     | 8.52         | 0.00                     | 33.96                        | <50                    | <0.50     | <0.50     | <0.50         | <0.50         | 2.4       | 1.0       | 7.0       |          |
| 12/6/2006                  | NP        |            | 9.00                   | 26.00                     | 9.90         | 0.00                     | 32.58                        | <50                    | <0.50     | <0.50     | <0.50         | <0.50         | 7.8       | 0.85      | 7.10      |          |
| 5/15/2007                  | NP        |            | 9.00                   | 26.00                     | 9.18         | 0.00                     | 33.30                        | <50                    | <0.50     | <0.50     | <0.50         | <0.50         | 2.2       | 1.37      | 6.85      |          |
| 11/29/2007                 | NP        |            | 9.00                   | 26.00                     | 9.10         | 0.00                     | 33.38                        | <50                    | <0.50     | <0.50     | <0.50         | <0.50         | 9.1       | 1.81      | 7.14      |          |
| 5/6/2008                   | P         |            | 9.00                   | 26.00                     | 9.40         | 0.00                     | 33.08                        | <50                    | <0.50     | <0.50     | <0.50         | <0.50         | 10        | 2.61      | 6.91      |          |
| 11/24/2008                 | NP        |            | 9.00                   | 26.00                     | 10.20        | 0.00                     | 32.28                        | <50                    | <0.50     | <0.50     | <0.50         | <0.50         | <0.50     | 2.67      | 6.88      |          |
| 4/9/2009                   | P         | 42.51      | 9.00                   | 26.00                     | 9.00         | 0.00                     | 33.51                        | <50                    | <0.50     | <0.50     | <0.50         | <0.50         | 12        | 2.51      | 7.11      | d        |

Table 1. Summary of Groundwater Monitoring Data: Relative Water Elevations and Laboratory Analyses

ARCO Service Station #2035, 1001 San Pablo Ave., Albany, CA

| Well ID and Date Monitored | P/NP     | TOC (feet) | Top of Screen (ft bgs) | Bottom of Screen (ft bgs) | DTW (feet)  | Product Thickness (feet) | Water Level Elevation (feet) | Concentrations in µg/L |                 |                 |                 |                | DO (mg/L)   | pH          | Footnote    |      |
|----------------------------|----------|------------|------------------------|---------------------------|-------------|--------------------------|------------------------------|------------------------|-----------------|-----------------|-----------------|----------------|-------------|-------------|-------------|------|
|                            |          |            |                        |                           |             |                          |                              | GRO/TPHg               | Benzene         | Toluene         | Ethyl-Benzene   | Total Xylenes  |             |             |             | MTBE |
| <b>MW-4 Cont.</b>          |          |            |                        |                           |             |                          |                              |                        |                 |                 |                 |                |             |             |             |      |
| 11/24/2009                 | P        | 42.51      | 9.00                   | 26.00                     | 9.89        | 0.00                     | 32.62                        | <50                    | <0.50           | <0.50           | <0.50           | <0.50          | 1.7         | 0.80        | 6.58        |      |
| 5/26/2010                  | P        |            | 9.00                   | 26.00                     | 8.79        | 0.00                     | 33.72                        | <50                    | <0.50           | <0.50           | <0.50           | <0.50          | 1.4         | 0.98        | 6.0         |      |
| 11/30/2010                 | P        |            | 9.00                   | 26.00                     | 9.31        | 0.00                     | 33.20                        | --                     | --              | --              | --              | --             | --          | 1.40        | 6.4         | f    |
| 2/16/2011                  | P        |            | 9.00                   | 26.00                     | 8.50        | 0.00                     | 34.01                        | <50                    | <0.50           | <0.50           | <0.50           | <0.50          | 2.1         | 0.91        | 7.1         |      |
| 5/11/2011                  | P        |            | 9.00                   | 26.00                     | 8.80        | 0.00                     | 33.71                        | <50                    | <0.50           | <0.50           | <0.50           | <0.50          | 0.75        | 1.43        | 6.8         |      |
| 11/28/2011                 | P        |            | 9.00                   | 26.00                     | 9.53        | 0.00                     | 32.98                        | <50                    | <0.50           | 0.61            | <0.50           | 0.69           | 0.67        | 0.75        | 6.8         |      |
| 6/5/2012                   | P        |            | 9.00                   | 26.00                     | 9.40        | 0.00                     | 33.11                        | <50                    | <0.50           | <0.50           | <0.50           | <0.50          | 1.2         | 1.66        | 6.67        |      |
| 12/6/2012                  | P        |            | 9.00                   | 26.00                     | 7.58        | 0.00                     | 34.93                        | <50                    | <0.50           | <0.50           | <0.50           | <1.0           | 2.5         | 4.27        | 7.50        |      |
| <b>6/4/2013</b>            | <b>P</b> |            | <b>9.00</b>            | <b>26.00</b>              | <b>9.87</b> | <b>0.00</b>              | <b>32.64</b>                 | <b>&lt;50</b>          | <b>&lt;0.50</b> | <b>&lt;0.50</b> | <b>&lt;0.50</b> | <b>&lt;1.0</b> | <b>0.54</b> | <b>1.49</b> | <b>5.95</b> |      |
| <b>MW-5</b>                |          |            |                        |                           |             |                          |                              |                        |                 |                 |                 |                |             |             |             |      |
| 4/11/2002                  | NP       | 41.84      | 8.00                   | 25.00                     | 10.63       | 0.00                     | 31.21                        | <50                    | <0.50           | <0.50           | <0.50           | <0.50          | <5.0        | --          | --          |      |
| 11/27/2002                 | NP       |            | 8.00                   | 25.00                     | 10.65       | 0.00                     | 31.19                        | --                     | --              | --              | --              | --             | --          | --          | --          |      |
| 6/3/2003                   | --       |            | 8.00                   | 25.00                     | 8.92        | 0.00                     | 32.92                        | <50                    | <0.50           | <0.50           | <0.50           | <0.50          | <0.50       | 1.8         | --          |      |
| 11/13/2003                 | NP       | 44.03      | 8.00                   | 25.00                     | 10.58       | 0.00                     | 33.45                        | <50                    | <0.50           | <0.50           | <0.50           | <0.50          | 0.79        | 1.4         | 5.7         | a    |
| 05/12/2004                 | --       |            | 8.00                   | 25.00                     | 9.95        | 0.00                     | 34.08                        | --                     | --              | --              | --              | --             | --          | --          | --          |      |
| 12/01/2004                 | NP       |            | 8.00                   | 25.00                     | 10.05       | 0.00                     | 33.98                        | <50                    | <0.50           | <0.50           | <0.50           | <0.50          | 0.55        | 1.8         | 6.3         |      |
| 05/02/2005                 | --       |            | 8.00                   | 25.00                     | 8.75        | 0.00                     | 35.28                        | --                     | --              | --              | --              | --             | --          | --          | --          |      |
| 11/16/2005                 | NP       |            | 8.00                   | 25.00                     | 10.37       | 0.00                     | 33.66                        | <50                    | <0.50           | <0.50           | <0.50           | <0.50          | <0.50       | 1.3         | 6.2         |      |
| 5/31/2006                  | --       |            | 8.00                   | 25.00                     | 9.07        | 0.00                     | 34.96                        | --                     | --              | --              | --              | --             | --          | --          | --          |      |
| 12/6/2006                  | NP       |            | 8.00                   | 25.00                     | 10.25       | 0.00                     | 33.78                        | <50                    | <0.50           | <0.50           | <0.50           | <0.50          | 0.99        | 1.24        | 6.88        |      |
| 5/15/2007                  | --       |            | 8.00                   | 25.00                     | 9.51        | 0.00                     | 34.52                        | --                     | --              | --              | --              | --             | --          | --          | --          |      |
| 11/29/2007                 | NP       |            | 8.00                   | 25.00                     | 9.95        | 0.00                     | 34.08                        | <50                    | <0.50           | <0.50           | <0.50           | <0.50          | <0.50       | 1.93        | 6.98        |      |
| 5/6/2008                   | --       |            | 8.00                   | 25.00                     | 9.67        | 0.00                     | 34.36                        | --                     | --              | --              | --              | --             | --          | --          | --          |      |
| 11/24/2008                 | NP       |            | 8.00                   | 25.00                     | 10.62       | 0.00                     | 33.41                        | <50                    | <0.50           | <0.50           | <0.50           | <0.50          | <0.50       | 2.43        | 6.52        |      |
| 4/9/2009                   | --       |            | 8.00                   | 25.00                     | 12.00       | 0.00                     | 32.03                        | --                     | --              | --              | --              | --             | --          | --          | --          | d    |
| 11/24/2009                 | P        |            | 8.00                   | 25.00                     | 10.34       | 0.00                     | 33.69                        | <50                    | <0.50           | 1.4             | <0.50           | <0.50          | 0.89        | 0.94        | 6.1         |      |
| 5/26/2010                  | --       |            | 8.00                   | 25.00                     | 9.21        | 0.00                     | 34.82                        | --                     | --              | --              | --              | --             | --          | --          | --          |      |
| 11/30/2010                 | P        |            | 8.00                   | 25.00                     | 9.85        | 0.00                     | 34.18                        | --                     | --              | --              | --              | --             | --          | --          | 6.17        | f    |
| 2/16/2011                  | P        |            | 8.00                   | 25.00                     | 9.01        | 0.00                     | 35.02                        | <50                    | <0.50           | <0.50           | <0.50           | <0.50          | <0.50       | 1.23        | 6.9         |      |
| 5/11/2011                  | --       |            | 8.00                   | 25.00                     | 9.44        | 0.00                     | 34.59                        | --                     | --              | --              | --              | --             | --          | --          | --          |      |

Table 1. Summary of Groundwater Monitoring Data: Relative Water Elevations and Laboratory Analyses

ARCO Service Station #2035, 1001 San Pablo Ave., Albany, CA

| Well ID and Date Monitored | P/NP      | TOC (feet) | Top of Screen (ft bgs) | Bottom of Screen (ft bgs) | DTW (feet)   | Product Thickness (feet) | Water Level Elevation (feet) | Concentrations in µg/L |           |           |               |               |           | DO (mg/L) | pH        | Footnote |
|----------------------------|-----------|------------|------------------------|---------------------------|--------------|--------------------------|------------------------------|------------------------|-----------|-----------|---------------|---------------|-----------|-----------|-----------|----------|
|                            |           |            |                        |                           |              |                          |                              | GRO/TPHg               | Benzene   | Toluene   | Ethyl-Benzene | Total Xylenes | MTBE      |           |           |          |
| <b>MW-5 Cont.</b>          |           |            |                        |                           |              |                          |                              |                        |           |           |               |               |           |           |           |          |
| 11/28/2011                 | P         | 44.03      | 8.00                   | 25.00                     | 10.06        | 0.00                     | 33.97                        | <50                    | <0.50     | <0.50     | <0.50         | <0.50         | <0.50     | 2.10      | 6.5       |          |
| 6/5/2012                   | --        |            | 8.00                   | 25.00                     | 9.88         | 0.00                     | 34.15                        | --                     | --        | --        | --            | --            | --        | --        | --        |          |
| 12/6/2012                  | P         |            | 8.00                   | 25.00                     | 7.91         | 0.00                     | 36.12                        | <50                    | <0.50     | <0.50     | <0.50         | <1.0          | <0.50     | 4.44      | 7.26      |          |
| <b>6/4/2013</b>            | <b>--</b> |            | <b>8.00</b>            | <b>25.00</b>              | <b>10.43</b> | <b>0.00</b>              | <b>33.60</b>                 | <b>--</b>              | <b>--</b> | <b>--</b> | <b>--</b>     | <b>--</b>     | <b>--</b> | <b>--</b> | <b>--</b> |          |
| <b>MW-6</b>                |           |            |                        |                           |              |                          |                              |                        |           |           |               |               |           |           |           |          |
| 4/11/2002                  | NP        | 40.13      | 8.00                   | 25.00                     | 11.42        | 0.00                     | 28.71                        | <50                    | <0.50     | <0.50     | <0.50         | <0.50         | <5.0      | --        | --        |          |
| 11/27/2002                 | NP        |            | 8.00                   | 25.00                     | 13.11        | 0.00                     | 27.02                        | <50                    | <0.50     | <0.50     | <0.50         | <0.50         | <0.50     | 1.3       | --        |          |
| 6/3/2003                   | --        |            | 8.00                   | 25.00                     | 12.48        | 0.00                     | 27.65                        | <50                    | <0.50     | <0.50     | <0.50         | <0.50         | <0.50     | 1.1       | --        |          |
| 11/13/2003                 | NP        | 42.26      | 8.00                   | 25.00                     | 13.11        | 0.00                     | 29.15                        | <50                    | <0.50     | <0.50     | <0.50         | <0.50         | <0.50     | 1.2       | 6.8       | a        |
| 05/12/2004                 | --        |            | 8.00                   | 25.00                     | 12.68        | 0.00                     | 29.58                        | --                     | --        | --        | --            | --            | --        | --        | --        |          |
| 12/01/2004                 | NP        |            | 8.00                   | 25.00                     | 12.68        | 0.00                     | 29.58                        | <50                    | <0.50     | <0.50     | <0.50         | <0.50         | <0.50     | 1.7       | 7.3       |          |
| 05/02/2005                 | --        |            | 8.00                   | 25.00                     | 12.25        | 0.00                     | 30.01                        | --                     | --        | --        | --            | --            | --        | --        | --        |          |
| 11/16/2005                 | NP        |            | 8.00                   | 25.00                     | 12.98        | 0.00                     | 29.28                        | <50                    | <0.50     | <0.50     | <0.50         | <0.50         | <0.50     | 1.2       | 6.7       |          |
| 5/31/2006                  | --        |            | 8.00                   | 25.00                     | 12.35        | 0.00                     | 29.91                        | --                     | --        | --        | --            | --            | --        | --        | --        |          |
| 12/6/2006                  | NP        |            | 8.00                   | 25.00                     | 12.98        | 0.00                     | 29.28                        | <50                    | <0.50     | <0.50     | <0.50         | <0.50         | <0.50     | 1.24      | 6.86      |          |
| 5/15/2007                  | --        |            | 8.00                   | 25.00                     | 12.55        | 0.00                     | 29.71                        | --                     | --        | --        | --            | --            | --        | --        | --        |          |
| 11/29/2007                 | NP        |            | 8.00                   | 25.00                     | 12.75        | 0.00                     | 29.51                        | <50                    | <0.50     | <0.50     | <0.50         | <0.50         | <0.50     | --        | 6.93      |          |
| 5/6/2008                   | --        |            | 8.00                   | 25.00                     | 12.91        | 0.00                     | 29.35                        | --                     | --        | --        | --            | --            | --        | --        | --        |          |
| 11/24/2008                 | NP        |            | 8.00                   | 25.00                     | 13.20        | 0.00                     | 29.06                        | <50                    | <0.50     | <0.50     | <0.50         | <0.50         | <0.50     | 2.28      | 7.25      |          |
| 4/9/2009                   | --        | 42.31      | 8.00                   | 25.00                     | 12.52        | 0.00                     | 29.79                        | --                     | --        | --        | --            | --            | --        | --        | --        | d        |
| 11/24/2009                 | P         |            | 8.00                   | 25.00                     | 12.90        | 0.00                     | 29.41                        | <50                    | <0.50     | <0.50     | <0.50         | <0.50         | <0.50     | 0.83      | 6.59      |          |
| 5/26/2010                  | --        |            | 8.00                   | 25.00                     | 12.17        | 0.00                     | 30.14                        | --                     | --        | --        | --            | --            | --        | --        | --        |          |
| 11/30/2010                 | P         |            | 8.00                   | 25.00                     | 12.45        | 0.00                     | 29.86                        | --                     | --        | --        | --            | --            | --        | 1.20      | 7.2       | f        |
| 2/16/2011                  | P         |            | 8.00                   | 25.00                     | 11.95        | 0.00                     | 30.36                        | <50                    | <0.50     | <0.50     | <0.50         | <0.50         | <0.50     | 1.02      | 6.9       |          |
| 5/11/2011                  | --        |            | 8.00                   | 25.00                     | 12.35        | 0.00                     | 29.96                        | --                     | --        | --        | --            | --            | --        | --        | --        |          |
| 11/28/2011                 | P         |            | 8.00                   | 25.00                     | 12.62        | 0.00                     | 29.69                        | <50                    | <0.50     | 0.74      | <0.50         | 0.64          | <0.50     | 0.91      | 7.2       |          |
| 6/5/2012                   | --        |            | 8.00                   | 25.00                     | 12.60        | 0.00                     | 29.71                        | --                     | --        | --        | --            | --            | --        | --        | --        |          |
| 12/6/2012                  | P         |            | 8.00                   | 25.00                     | 10.66        | 0.00                     | 31.65                        | <50                    | <0.50     | <0.50     | <0.50         | <1.0          | <0.50     | 3.33      | 7.85      |          |
| <b>6/4/2013</b>            | <b>--</b> |            | <b>8.00</b>            | <b>25.00</b>              | <b>12.90</b> | <b>0.00</b>              | <b>29.41</b>                 | <b>--</b>              | <b>--</b> | <b>--</b> | <b>--</b>     | <b>--</b>     | <b>--</b> | <b>--</b> | <b>--</b> |          |

Table 1. Summary of Groundwater Monitoring Data: Relative Water Elevations and Laboratory Analyses

ARCO Service Station #2035, 1001 San Pablo Ave., Albany, CA

| Well ID and Date Monitored | P/NP     | TOC (feet) | Top of Screen (ft bgs) | Bottom of Screen (ft bgs) | DTW (feet)   | Product Thickness (feet) | Water Level Elevation (feet) | Concentrations in µg/L |                 |                 |                 |                |                 | DO (mg/L)   | pH          | Footnote |
|----------------------------|----------|------------|------------------------|---------------------------|--------------|--------------------------|------------------------------|------------------------|-----------------|-----------------|-----------------|----------------|-----------------|-------------|-------------|----------|
|                            |          |            |                        |                           |              |                          |                              | GRO/TPHg               | Benzene         | Toluene         | Ethyl-Benzene   | Total Xylenes  | MTBE            |             |             |          |
| <b>MW-7</b>                |          |            |                        |                           |              |                          |                              |                        |                 |                 |                 |                |                 |             |             |          |
| 4/9/2009                   | P        | 43.18      | 6.00                   | 16.00                     | 6.73         | 0.00                     | 36.45                        | 4,100                  | 5.2             | 1.7             | 21              | 21             | <0.50           | 8.41        | 7.79        | d        |
| 11/24/2009                 | P        |            | 6.00                   | 16.00                     | 8.31         | 0.00                     | 34.87                        | 2,700                  | 4.1             | 1.1             | 3.3             | 3.0            | <0.50           | 0.60        | 6.8         | c        |
| 5/26/2010                  | P        |            | 6.00                   | 16.00                     | 6.62         | 0.00                     | 36.56                        | 1,800                  | 1.2             | 0.53            | 2.2             | 0.84           | <0.50           | 0.71        | 6.6         |          |
| 11/30/2010                 | P        |            | 6.00                   | 16.00                     | 6.84         | 0.00                     | 36.34                        | --                     | --              | --              | --              | --             | --              | 0.79        | 6.7         | f        |
| 2/16/2011                  | P        |            | 6.00                   | 16.00                     | 5.44         | 0.00                     | 37.74                        | 2,000                  | 1.4             | 0.84            | 8.0             | 1.4            | <0.50           | 0.56        | 7.0         | g        |
| 5/11/2011                  | P        |            | 6.00                   | 16.00                     | 6.98         | 0.00                     | 36.20                        | 84                     | <0.50           | <0.50           | <0.50           | <0.50          | <0.50           | 1.76        | 7.1         | lw       |
| 11/28/2011                 | P        |            | 6.00                   | 16.00                     | 7.13         | 0.00                     | 36.05                        | 850                    | 0.55            | 1.3             | <0.50           | 2.5            | <0.50           | 0.38        | 7.3         | lw       |
| 6/5/2012                   | P        |            | 6.00                   | 16.00                     | 7.65         | 0.00                     | 35.53                        | 1,300                  | 0.97            | 0.59            | 0.95            | 0.64           | <0.50           | 1.95        | 7.04        |          |
| 12/6/2012                  | P        |            | 6.00                   | 16.00                     | 3.30         | 0.00                     | 39.88                        | 880                    | 1.4             | 0.57            | 1.4             | <1.0           | <0.50           | 4.90        | 7.78        |          |
| <b>6/4/2013</b>            | <b>P</b> |            | <b>6.00</b>            | <b>16.00</b>              | <b>8.60</b>  | <b>0.00</b>              | <b>34.58</b>                 | <b>99</b>              | <b>&lt;0.50</b> | <b>&lt;0.50</b> | <b>&lt;0.50</b> | <b>&lt;1.0</b> | <b>&lt;0.50</b> | <b>1.31</b> | <b>6.51</b> |          |
| <b>MW-8</b>                |          |            |                        |                           |              |                          |                              |                        |                 |                 |                 |                |                 |             |             |          |
| 4/9/2009                   | P        | 42.36      | 6.00                   | 19.00                     | 9.50         | 0.00                     | 32.86                        | 4,300                  | 940             | 260             | 150             | 590            | 110             | 2.09        | 7.62        | d        |
| 11/24/2009                 | P        |            | 6.00                   | 19.00                     | 10.25        | 0.00                     | 32.11                        | 28,000                 | 9,900           | 670             | 1,300           | 2,200          | <100            | 0.64        | 6.48        | c        |
| 5/26/2010                  | P        |            | 6.00                   | 19.00                     | 9.25         | 0.00                     | 33.11                        | 1,400                  | 420             | <10             | 21              | <10            | <10             | 0.78        | 6.6         |          |
| 11/30/2010                 | P        |            | 6.00                   | 19.00                     | 9.68         | 0.00                     | 32.68                        | --                     | --              | --              | --              | --             | --              | 2.26        | 6.6         | f        |
| 2/16/2011                  | P        |            | 6.00                   | 19.00                     | 8.95         | 0.00                     | 33.41                        | 960                    | 270             | <5.0            | 50              | <5.0           | <5.0            | 3.35        | 6.9         | g        |
| 5/11/2011                  | P        |            | 6.00                   | 19.00                     | 9.43         | 0.00                     | 32.93                        | 1,200                  | 290             | <4.0            | 57              | 4.5            | <4.0            | 0.94        | 7.2         | lw       |
| 11/28/2011                 | P        |            | 6.00                   | 19.00                     | 9.85         | 0.00                     | 32.51                        | <50                    | <0.50           | 0.59            | <0.50           | 0.53           | <0.50           | 3.64        | 7.2         |          |
| 6/5/2012                   | P        |            | 6.00                   | 19.00                     | 9.72         | 0.00                     | 32.64                        | 890                    | 170             | 1.9             | 92              | 16             | 2.1             | 1.31        | 6.99        |          |
| 12/6/2012                  | P        |            | 6.00                   | 19.00                     | 7.19         | 0.00                     | 35.17                        | 80                     | 18              | <0.50           | 6.8             | 1.2            | <0.50           | 6.59        | 8.01        |          |
| <b>6/4/2013</b>            | <b>P</b> |            | <b>6.00</b>            | <b>19.00</b>              | <b>10.21</b> | <b>0.00</b>              | <b>32.15</b>                 | <b>260</b>             | <b>70</b>       | <b>1.1</b>      | <b>34</b>       | <b>1.6</b>     | <b>2.0</b>      | <b>1.50</b> | <b>6.21</b> |          |
| <b>MW-9</b>                |          |            |                        |                           |              |                          |                              |                        |                 |                 |                 |                |                 |             |             |          |
| 4/9/2009                   | P        | 43.77      | 6.00                   | 16.00                     | 8.95         | 0.00                     | 34.82                        | <50                    | <0.50           | <0.50           | <0.50           | <0.50          | 2.1             | 2.81        | 7.58        | d        |
| 11/24/2009                 | P        |            | 6.00                   | 16.00                     | 10.11        | 0.00                     | 33.66                        | <50                    | <0.50           | <0.50           | <0.50           | <0.50          | 3.8             | --          | 6.3         |          |
| 5/26/2010                  | P        |            | 6.00                   | 16.00                     | 8.88         | 0.00                     | 34.89                        | <50                    | <0.50           | <0.50           | <0.50           | <0.50          | 1.9             | 0.66        | 5.7         |          |
| 11/30/2010                 | P        |            | 6.00                   | 16.00                     | 9.56         | 0.00                     | 34.21                        | --                     | --              | --              | --              | --             | --              | 0.64        | 6.3         | f        |
| 2/16/2011                  | P        |            | 6.00                   | 16.00                     | 8.65         | 0.00                     | 35.12                        | <50                    | <0.50           | <0.50           | <0.50           | <0.50          | 3.8             | 0.55        | 6.6         |          |
| 5/11/2011                  | P        |            | 6.00                   | 16.00                     | 9.06         | 0.00                     | 34.71                        | <50                    | <0.50           | <0.50           | <0.50           | <0.50          | 1.2             | 1.22        | 6.6         |          |
| 11/28/2011                 | P        |            | 6.00                   | 16.00                     | 9.75         | 0.00                     | 34.02                        | <50                    | <0.50           | 0.70            | <0.50           | 0.72           | 9.1             | 0.50        | 6.8         |          |



**Table 1. Summary of Groundwater Monitoring Data: Relative Water Elevations and Laboratory Analyses**

**ARCO Service Station #2035, 1001 San Pablo Ave., Albany, CA**

| Well ID and Date Monitored | P/NP     | TOC (feet) | Top of Screen (ft bgs) | Bottom of Screen (ft bgs) | DTW (feet)   | Product Thickness (feet) | Water Level Elevation (feet) | Concentrations in µg/L |                 |                 |                 |                |            | DO (mg/L)   | pH          | Footnote |
|----------------------------|----------|------------|------------------------|---------------------------|--------------|--------------------------|------------------------------|------------------------|-----------------|-----------------|-----------------|----------------|------------|-------------|-------------|----------|
|                            |          |            |                        |                           |              |                          |                              | GRO/TPHg               | Benzene         | Toluene         | Ethyl-Benzene   | Total Xylenes  | MTBE       |             |             |          |
| <b>MW-9 Cont.</b>          |          |            |                        |                           |              |                          |                              |                        |                 |                 |                 |                |            |             |             |          |
| 6/5/2012                   | P        | 43.77      | 6.00                   | 16.00                     | 9.57         | 0.00                     | 34.20                        | <50                    | <0.50           | <0.50           | <0.50           | <0.50          | 4.8        | 1.45        | 6.32        |          |
| 12/6/2012                  | P        |            | 6.00                   | 16.00                     | 6.95         | 0.00                     | 36.82                        | <50                    | <0.50           | <0.50           | <0.50           | <1.0           | 6.4        | 2.25        | 7.23        |          |
| <b>6/4/2013</b>            | <b>P</b> |            | <b>6.00</b>            | <b>16.00</b>              | <b>10.17</b> | <b>0.00</b>              | <b>33.60</b>                 | <b>&lt;50</b>          | <b>&lt;0.50</b> | <b>&lt;0.50</b> | <b>&lt;0.50</b> | <b>&lt;1.0</b> | <b>3.5</b> | <b>1.58</b> | <b>5.40</b> |          |
| <b>RW-1</b>                |          |            |                        |                           |              |                          |                              |                        |                 |                 |                 |                |            |             |             |          |
| 4/11/2002                  | P        | 40.33      | 11.00                  | 26.00                     | 9.20         | 0.00                     | 31.13                        | 15,000                 | 750             | 2,000           | 380             | 2,000          | 1,500      | --          | --          |          |
| 11/27/2002                 | P        |            | 11.00                  | 26.00                     | 10.31        | 0.00                     | 30.02                        | <2,500                 | 720             | <25             | <25             | <25            | <25        | 1.8         | --          |          |
| 6/3/2003                   | --       |            | 11.00                  | 26.00                     | 9.54         | 0.00                     | 30.79                        | 470                    | 78              | 0.97            | 4.3             | 9              | 48         | 1.4         | --          |          |
| 11/13/2003                 | P        | 42.35      | 11.00                  | 26.00                     | 10.35        | 0.00                     | 32.00                        | 130                    | 29              | <0.50           | <0.50           | <0.50          | 44         | 1.3         | 6.6         | a        |
| 05/12/2004                 | P        |            | 11.00                  | 26.00                     | 9.80         | 0.00                     | 32.55                        | <250                   | 66              | <2.5            | <2.5            | <2.5           | <2.5       | 1.9         | 6.9         |          |
| 09/02/2004                 | --       |            | 11.00                  | 26.00                     | 10.42        | 0.00                     | 31.93                        | --                     | --              | --              | --              | --             | --         | --          | --          |          |
| 10/07/2004                 | --       |            | 11.00                  | 26.00                     | 10.36        | 0.00                     | 31.99                        | --                     | --              | --              | --              | --             | --         | --          | --          |          |
| 11/04/2004                 | --       |            | 11.00                  | 26.00                     | 9.93         | 0.00                     | 32.42                        | --                     | --              | --              | --              | --             | --         | --          | --          |          |
| 12/01/2004                 | P        |            | 11.00                  | 26.00                     | 10.02        | 0.00                     | 32.33                        | <250                   | 96              | <2.5            | <2.5            | <2.5           | 16         | 1.8         | 6.7         |          |
| 05/02/2005                 | P        |            | 11.00                  | 26.00                     | 9.20         | 0.00                     | 33.15                        | 230                    | 100             | <1.0            | <1.0            | <1.0           | 50         | 2.5         | 6.6         |          |
| 11/16/2005                 | P        |            | 11.00                  | 26.00                     | 10.96        | 0.00                     | 31.39                        | <100                   | 28              | <1.0            | <1.0            | <1.0           | 32         | 1.0         | 6.5         |          |
| 5/31/2006                  | P        |            | 11.00                  | 26.00                     | 9.34         | 0.00                     | 33.01                        | 320                    | 32              | <0.50           | <0.50           | <0.50          | 28         | 1.3         | 6.8         |          |
| 12/6/2006                  | P        |            | 11.00                  | 26.00                     | 10.10        | 0.00                     | 32.25                        | 50                     | 27              | <0.50           | <0.50           | <0.50          | 19         | 1.49        | 7.54        |          |
| 5/15/2007                  | P        |            | 11.00                  | 26.00                     | 9.42         | 0.00                     | 32.93                        | 280                    | 32              | <0.50           | <0.50           | <0.50          | 18         | 2.61        | 7.10        |          |
| 11/29/2007                 | P        |            | 11.00                  | 26.00                     | 9.75         | 0.00                     | 32.60                        | <50                    | 14              | <0.50           | <0.50           | <0.50          | 18         | 4.86        | 8.14        |          |
| 5/6/2008                   | P        |            | 11.00                  | 26.00                     | 9.71         | 0.00                     | 32.64                        | 610                    | 110             | <2.5            | <2.5            | <2.5           | 2.6        | 2.48        | 6.95        |          |
| 11/24/2008                 | P        |            | 11.00                  | 26.00                     | 10.48        | 0.00                     | 31.87                        | 73                     | 31              | <0.50           | <0.50           | <0.50          | 11         | 2.53        | 6.88        |          |
| 4/9/2009                   | P        | 42.23      | 11.00                  | 26.00                     | 9.46         | 0.00                     | 32.77                        | 720                    | 36              | <0.50           | 1.0             | 1.2            | 4.0        | 2.58        | 7.73        | d        |
| 11/24/2009                 | P        |            | 11.00                  | 26.00                     | 10.15        | 0.00                     | 32.08                        | <50                    | 2.0             | <0.50           | <0.50           | <0.50          | 6.5        | 0.85        | 6.6         |          |
| 5/26/2010                  | P        |            | 11.00                  | 26.00                     | 9.12         | 0.00                     | 33.11                        | 90                     | 11              | <0.50           | <0.50           | <0.50          | 0.94       | 1.46        | 6.4         |          |
| 11/30/2010                 | P        |            | 11.00                  | 26.00                     | 9.38         | 0.00                     | 32.85                        | --                     | --              | --              | --              | --             | --         | 2.10        | 7.2         | f        |
| 2/16/2011                  | P        |            | 11.00                  | 26.00                     | 9.15         | 0.00                     | 33.08                        | 1,600                  | 370             | 2.9             | 2.6             | 2.9            | 1.3        | 0.76        | 7.0         |          |
| 5/11/2011                  | P        |            | 11.00                  | 26.00                     | 9.56         | 0.00                     | 32.67                        | 1,600                  | 79              | <2.0            | <2.0            | 2.0            | <2.0       | 0.91        | 7.4         | lw       |
| 11/28/2011                 | P        |            | 11.00                  | 26.00                     | 9.69         | 0.00                     | 32.54                        | <50                    | <0.50           | 0.54            | <0.50           | <0.50          | <0.50      | 3.05        | 7.3         |          |
| 6/5/2012                   | P        |            | 11.00                  | 26.00                     | 9.63         | 0.00                     | 32.60                        | 1,000                  | 49              | 1.3             | <0.50           | 0.86           | <0.50      | 1.43        | 6.75        |          |
| 12/6/2012                  | P        |            | 11.00                  | 26.00                     | 7.66         | 0.00                     | 34.57                        | 380                    | 200             | 1.5             | <1.0            | <2.0           | <1.0       | 1.52        | 7.34        |          |

**Table 1. Summary of Groundwater Monitoring Data: Relative Water Elevations and Laboratory Analyses**

**ARCO Service Station #2035, 1001 San Pablo Ave., Albany, CA**

| Well ID and Date Monitored | P/NP     | TOC (feet)   | Top of Screen (ft bgs) | Bottom of Screen (ft bgs) | DTW (feet)   | Product Thickness (feet) | Water Level Elevation (feet) | Concentrations in µg/L |                 |                 |                 |                |                 | DO (mg/L)   | pH          | Footnote    |
|----------------------------|----------|--------------|------------------------|---------------------------|--------------|--------------------------|------------------------------|------------------------|-----------------|-----------------|-----------------|----------------|-----------------|-------------|-------------|-------------|
|                            |          |              |                        |                           |              |                          |                              | GRO/TPHg               | Benzene         | Toluene         | Ethyl-Benzene   | Total Xylenes  | MTBE            |             |             |             |
| <b>RW-1 Cont.</b>          |          |              |                        |                           |              |                          |                              |                        |                 |                 |                 |                |                 |             |             |             |
| <b>6/4/2013</b>            | <b>P</b> | <b>42.23</b> | <b>11.00</b>           | <b>26.00</b>              | <b>10.10</b> | <b>0.00</b>              | <b>32.13</b>                 | <b>&lt;50</b>          | <b>&lt;0.50</b> | <b>&lt;0.50</b> | <b>&lt;0.50</b> | <b>&lt;1.0</b> | <b>&lt;0.50</b> | <b>1.31</b> | <b>6.16</b> |             |
| <b>S-5</b>                 |          |              |                        |                           |              |                          |                              |                        |                 |                 |                 |                |                 |             |             |             |
| 4/11/2002                  | P        | 40.33        | 6.00                   | 16.00                     | 10.17        | 0.00                     | 30.16                        | 30,000                 | 390             | 1,400           | 410             | 7,400          | <500            | --          | --          |             |
| 11/27/2002                 | P        |              | 6.00                   | 16.00                     | 9.77         | 0.00                     | 30.56                        | 55,000                 | 1,300           | 450             | 1,400           | 13,000         | <50             | 4.3         | --          |             |
| 6/3/2003                   | --       |              | 6.00                   | 16.00                     | 9.03         | 0.00                     | 31.30                        | 44,000                 | 680             | 260             | 1,100           | 9,900          | <25             | 1.9         | --          |             |
| 6/3/2003                   | --       |              | 6.00                   | 16.00                     | 9.12         | 0.00                     | 31.21                        | 44,000                 | 680             | 260             | 1,100           | 9,900          | <25             | 1.9         | --          |             |
| 6/3/2003                   | --       |              | 6.00                   | 16.00                     | 9.03         | 0.00                     | 31.30                        | --                     | --              | --              | --              | --             | <25             | 1.4         | --          |             |
| 6/3/2003                   | --       |              | 6.00                   | 16.00                     | 9.12         | 0.00                     | 31.21                        | --                     | --              | --              | --              | --             | <25             | 1.4         | --          |             |
| 11/13/2003                 | P        | 41.83        | 6.00                   | 16.00                     | 9.12         | 0.00                     | 32.71                        | 31,000                 | 520             | 120             | 690             | 5,900          | <50             | 1.4         | 6.5         | a           |
| 05/12/2004                 | P        |              | 6.00                   | 16.00                     | 9.95         | 0.00                     | 31.88                        | 28,000                 | 760             | 79              | 910             | 5,000          | <50             | 1.9         | 6.6         |             |
| 12/01/2004                 | P        |              | 6.00                   | 16.00                     | 9.61         | 0.00                     | 32.22                        | 26,000                 | 1,500           | 64              | 1,400           | 4,000          | <25             | --          | 6.5         | b           |
| 05/02/2005                 | P        |              | 6.00                   | 16.00                     | 8.80         | 0.00                     | 33.03                        | 13,000                 | 700             | 18              | 260             | 1,300          | <5.0            | 1.8         | 6.4         |             |
| 11/16/2005                 | P        |              | 6.00                   | 16.00                     | 9.80         | 0.00                     | 32.03                        | 15,000                 | 1,400           | 25              | 570             | 850            | <5.0            | 1.1         | 6.3         |             |
| 5/31/2006                  | P        |              | 6.00                   | 16.00                     | 8.89         | 0.00                     | 32.94                        | 9,800                  | 170             | <5.0            | 490             | 390            | <5.0            | 1.4         | 6.6         |             |
| 12/6/2006                  | P        |              | 6.00                   | 16.00                     | 9.65         | 0.00                     | 32.18                        | 16,000                 | 1,100           | <25             | 1,700           | 970            | <25             | 1.23        | 6.95        |             |
| 5/15/2007                  | P        |              | 6.00                   | 16.00                     | 8.89         | 0.00                     | 32.94                        | 10,000                 | 140             | <5.0            | 340             | 310            | <5.0            | 3.63        | 7.10        |             |
| 11/29/2007                 | P        |              | 6.00                   | 16.00                     | 9.48         | 0.00                     | 32.35                        | 13,000                 | 770             | 8.6             | 500             | 360            | <2.5            | 5.42        | 7.28        | c (Benzene) |
| 5/6/2008                   | P        |              | 6.00                   | 16.00                     | 9.30         | 0.00                     | 32.53                        | 7,400                  | 320             | 2.8             | 580             | 130            | <0.50           | 3.37        | 6.88        |             |
| 11/24/2008                 | P        |              | 6.00                   | 16.00                     | 10.00        | 0.00                     | 31.83                        | 7,700                  | 400             | <10             | 390             | 14             | <10             | 3.22        | 6.43        |             |
| 4/9/2009                   | P        |              | 6.00                   | 16.00                     | 8.90         | 0.00                     | 32.93                        | 7,700                  | 230             | <10             | 370             | 35             | <10             | 3.14        | 7.77        |             |
| 11/24/2009                 | --       |              | 6.00                   | 16.00                     | --           | --                       | --                           | --                     | --              | --              | --              | --             | --              | --          | --          | e           |
| 5/26/2010                  | --       |              | 6.00                   | 16.00                     | --           | --                       | --                           | --                     | --              | --              | --              | --             | --              | --          | --          | e           |
| 11/30/2010                 | P        |              | 6.00                   | 16.00                     | 8.92         | 0.00                     | 32.91                        | --                     | --              | --              | --              | --             | --              | 0.62        | 6.6         | f           |
| 2/16/2011                  | P        |              | 6.00                   | 16.00                     | 8.57         | 0.00                     | 33.26                        | 2,700                  | 26              | <0.50           | 11              | 3.2            | <0.50           | 1.34        | 7.5         |             |
| 5/11/2011                  | P        |              | 6.00                   | 16.00                     | 8.85         | 0.00                     | 32.98                        | 1,500                  | 19              | 0.58            | 9.7             | 2.2            | <0.50           | 0.72        | 6.8         | lw          |
| 11/28/2011                 | --       |              | 6.00                   | 16.00                     | --           | --                       | --                           | --                     | --              | --              | --              | --             | --              | --          | --          | e           |
| 6/5/2012                   | P        |              | 6.00                   | 16.00                     | 9.00         | 0.00                     | 32.83                        | 1,700                  | 29              | 0.99            | 2.1             | 0.60           | <0.50           | 1.44        | 6.68        |             |
| 12/6/2012                  | P        |              | 6.00                   | 16.00                     | 6.89         | 0.00                     | 34.94                        | 1,700                  | 24              | 1.7             | 3.3             | 2.0            | <0.50           | 2.95        | 7.51        |             |
| <b>6/4/2013</b>            | <b>P</b> |              | <b>6.00</b>            | <b>16.00</b>              | <b>9.55</b>  | <b>0.00</b>              | <b>32.28</b>                 | <b>400</b>             | <b>14</b>       | <b>1.8</b>      | <b>3.1</b>      | <b>2.3</b>     | <b>&lt;0.50</b> | <b>1.41</b> | <b>5.98</b> |             |

Symbols & Abbreviations:

-- = Not analyzed/applicable/measured/available  
< = Not detected at or above laboratory reporting limit  
ft bgs = Feet below ground surface  
BTEX = Benzene, toluene, ethylbenzene and xylenes  
DO = Dissolved oxygen  
DTW = Depth to water in ft bgs  
GRO = Gasoline range organics, range C4-C12  
GWE = Groundwater elevation measured in ft  
mg/L = Milligrams per liter  
MTBE = Methyl tert butyl ether  
NP = Not purged before sampling  
P = Purged before sampling  
TOC = Top of casing measured in ft  
TPH-g = Total petroleum hydrocarbons as gasoline, analyzed using EPA Method 8015, Modified  
µg/L = Micrograms per liter  
SEQ/SEQM = Sequoia Analytical/Sequoia Morgan Hill Laboratories

Footnotes:

a = Site resurveyed by URS on 10/15/03 to NAVD '88  
b = Sheen in well  
c = Sample taken from VOA vial with air bubble >6mm  
d = Well surveyed on 4/20/09  
e = Well not monitored or sampled due to traffic control safety concerns  
f = Samples were collected on 11/30/2010 but not able to be analyzed (frozen). Subsequent re-sampling could not occur in 4Q 2010  
g = Quantitation of unknown hydrocarbon(s) in sample based on gasoline  
lw = Quantitated against gasoline

Notes:

No sampling occurs at this site during the first and third quarters of each calendar year

TPH-g analyzed using EPA Method 8015, Modified and BTEX and MTBE by EPA method 8260B

Beginning in the fourth quarter 2003, the laboratory modified the reported analyte list. TPH-g was changed to GRO. The resulting data may be impacted by the potential of non-TPH-g analytes within the requested fuel range resulting in a higher concentration being reported

Beginning in the second quarter 2004, the carbon range for GRO was changed from C6-C10 to C4-C12

Values for DO and pH were obtained through field measurements

GRO analysis was completed by EPA method 8260B (C4-C12) for samples collected from the time period April 2006 through February 4, 2008. The analysis for GRO was changed to EPA method 8015B (C6-C12) for samples collected from the time period February 5, 2008 through the present

The data within this table collected prior to April 2006 was provided to Broadbent & Associates, Inc. by Atlantic Richfield Company and their previous consultants. Broadbent & Associates, Inc. has not verified the accuracy of this information

**Table 2. Summary of Fuel Additives Analytical Data**  
**ARCO Service Station #2035, 1001 San Pablo Ave., Albany, CA**

| Well ID and<br>Date Monitored | Concentrations in µg/L |      |       |       |       |       |         |       | Footnote |
|-------------------------------|------------------------|------|-------|-------|-------|-------|---------|-------|----------|
|                               | Ethanol                | TBA  | MTBE  | DIPE  | ETBE  | TAME  | 1,2-DCA | EDB   |          |
| <b>MW-1</b>                   |                        |      |       |       |       |       |         |       |          |
| 4/11/2002                     | --                     | --   | <50   | --    | --    | --    | --      | --    |          |
| 11/27/2002                    | --                     | --   | 1.7   | --    | --    | --    | --      | --    |          |
| 6/3/2003                      | <1000                  | <200 | 8.6   | <5.0  | <5.0  | <5.0  | <5.0    | <5.0  |          |
| 11/13/2003                    | <100                   | <20  | 0.95  | <0.50 | <0.50 | <0.50 | --      | --    |          |
| 05/12/2004                    | <100                   | <20  | 3.0   | <0.50 | <0.50 | <0.50 | <0.50   | <0.50 |          |
| 12/01/2004                    | <100                   | <20  | 2.4   | <0.50 | <0.50 | <0.50 | <0.50   | <0.50 |          |
| 05/02/2005                    | <1,000                 | 220  | 8.8   | <5.0  | <5.0  | <5.0  | <5.0    | <5.0  |          |
| 11/16/2005                    | <100                   | <20  | 0.92  | <0.50 | <0.50 | <0.50 | <0.50   | <0.50 | a        |
| 5/31/2006                     | <1,500                 | <100 | 4.0   | <2.5  | <2.5  | <2.5  | <2.5    | <2.5  | a        |
| 12/6/2006                     | <300                   | <20  | 0.72  | <0.50 | <0.50 | <0.50 | <0.50   | <0.50 |          |
| 5/15/2007                     | <300                   | <20  | 1.8   | <0.50 | <0.50 | <0.50 | <0.50   | <0.50 |          |
| 11/29/2007                    | <300                   | <20  | 0.98  | <0.50 | <0.50 | <0.50 | <0.50   | <0.50 |          |
| 5/6/2008                      | <300                   | <10  | <0.50 | <0.50 | <0.50 | <0.50 | <0.50   | <0.50 |          |
| 11/24/2008                    | <300                   | <10  | <0.50 | <0.50 | <0.50 | <0.50 | <0.50   | <0.50 |          |
| <b>MW-2</b>                   |                        |      |       |       |       |       |         |       |          |
| 4/11/2002                     | --                     | --   | 24    | --    | --    | --    | --      | --    |          |
| 11/27/2002                    | --                     | --   | 5.4   | --    | --    | --    | --      | --    |          |
| 6/3/2003                      | <100                   | <20  | 23    | <0.50 | <0.50 | <0.50 | 0.94    | <0.50 |          |
| 11/13/2003                    | <100                   | <20  | 9.5   | <0.50 | <0.50 | <0.50 | --      | --    |          |
| 05/12/2004                    | <500                   | <100 | 27    | <2.5  | <2.5  | <2.5  | <2.5    | <2.5  |          |
| 12/01/2004                    | <100                   | <20  | 17    | <0.50 | <0.50 | <0.50 | 0.74    | <0.50 |          |
| 05/02/2005                    | <100                   | 75   | 25    | <0.50 | <0.50 | <0.50 | <0.50   | <0.50 |          |
| 11/16/2005                    | <100                   | <20  | 7.6   | <0.50 | <0.50 | <0.50 | 0.79    | <0.50 | a        |
| 5/31/2006                     | <300                   | <20  | 24    | <0.50 | <0.50 | <0.50 | 0.66    | <0.50 | a        |
| 12/6/2006                     | <300                   | <20  | 1.6   | <0.50 | <0.50 | <0.50 | <0.50   | <0.50 | a        |
| 5/15/2007                     | <300                   | <20  | 44    | <0.50 | <0.50 | <0.50 | 1.2     | <0.50 |          |
| 11/29/2007                    | <300                   | <20  | 1.9   | <0.50 | <0.50 | <0.50 | <0.50   | <0.50 |          |
| 5/6/2008                      | <300                   | <10  | 35    | <0.50 | <0.50 | <0.50 | 0.93    | <0.50 |          |
| 11/24/2008                    | <300                   | <10  | 4.3   | <0.50 | <0.50 | <0.50 | <0.50   | <0.50 |          |
| <b>MW-3</b>                   |                        |      |       |       |       |       |         |       |          |

**Table 2. Summary of Fuel Additives Analytical Data**  
**ARCO Service Station #2035, 1001 San Pablo Ave., Albany, CA**

| Well ID and<br>Date Monitored | Concentrations in µg/L |      |       |       |       |       |         |       | Footnote |
|-------------------------------|------------------------|------|-------|-------|-------|-------|---------|-------|----------|
|                               | Ethanol                | TBA  | MTBE  | DIPE  | ETBE  | TAME  | 1,2-DCA | EDB   |          |
| <b>MW-3 Cont.</b>             |                        |      |       |       |       |       |         |       |          |
| 4/11/2002                     | --                     | --   | 120   | --    | --    | --    | --      | --    |          |
| 11/27/2002                    | --                     | --   | 56    | --    | --    | --    | --      | --    |          |
| 6/3/2003                      | <100                   | <20  | 47    | <0.50 | <0.50 | <0.50 | <0.50   | <0.50 |          |
| 11/13/2003                    | <100                   | <20  | 36    | <0.50 | <0.50 | <0.50 | --      | --    |          |
| 05/12/2004                    | <100                   | <20  | 39    | <0.50 | <0.50 | <0.50 | <0.50   | <0.50 |          |
| 12/01/2004                    | <100                   | <20  | 37    | <0.50 | <0.50 | <0.50 | <0.50   | <0.50 |          |
| 05/02/2005                    | <100                   | <20  | 23    | <0.50 | <0.50 | <0.50 | <0.50   | <0.50 |          |
| 11/16/2005                    | <100                   | <20  | 32    | <0.50 | <0.50 | <0.50 | <0.50   | <0.50 | a        |
| 5/31/2006                     | <300                   | <20  | 20    | <0.50 | <0.50 | <0.50 | <0.50   | <0.50 | a        |
| 12/6/2006                     | <300                   | <20  | 20    | <0.50 | <0.50 | <0.50 | <0.50   | <0.50 | a        |
| 5/15/2007                     | <300                   | <20  | 40    | <0.50 | <0.50 | <0.50 | <0.50   | <0.50 |          |
| 11/29/2007                    | <300                   | <20  | 35    | <0.50 | <0.50 | <0.50 | <0.50   | <0.50 |          |
| 5/6/2008                      | <300                   | <10  | 14    | <0.50 | <0.50 | <0.50 | <0.50   | <0.50 |          |
| 11/24/2008                    | <600                   | <20  | 28    | <1.0  | <1.0  | <1.0  | <1.0    | <1.0  |          |
| <b>MW-4</b>                   |                        |      |       |       |       |       |         |       |          |
| 4/11/2002                     | --                     | --   | 11    | --    | --    | --    | --      | --    |          |
| 11/27/2002                    | --                     | --   | 6.5   | --    | --    | --    | --      | --    |          |
| 6/3/2003                      | <500                   | <100 | 120   | <2.5  | <2.5  | <2.5  | <2.5    | <2.5  |          |
| 11/13/2003                    | <100                   | <20  | 20    | <0.50 | <0.50 | <0.50 | --      | --    |          |
| 05/12/2004                    | <500                   | <100 | 79    | <2.5  | <2.5  | <2.5  | <2.5    | <2.5  |          |
| 12/01/2004                    | <100                   | <20  | 1.8   | <0.50 | <0.50 | <0.50 | <0.50   | <0.50 |          |
| 05/02/2005                    | <100                   | 75   | 11    | <0.50 | <0.50 | <0.50 | <0.50   | <0.50 |          |
| 11/16/2005                    | <100                   | <20  | 0.93  | <0.50 | <0.50 | <0.50 | <0.50   | <0.50 | a        |
| 5/31/2006                     | <300                   | <20  | 2.4   | <0.50 | <0.50 | <0.50 | <0.50   | <0.50 | a        |
| 12/6/2006                     | <300                   | <20  | 7.8   | <0.50 | <0.50 | <0.50 | <0.50   | <0.50 | a        |
| 5/15/2007                     | <300                   | <20  | 2.2   | <0.50 | <0.50 | <0.50 | <0.50   | <0.50 |          |
| 11/29/2007                    | <300                   | <20  | 9.1   | <0.50 | <0.50 | <0.50 | <0.50   | <0.50 |          |
| 5/6/2008                      | <300                   | <10  | 10    | <0.50 | <0.50 | <0.50 | <0.50   | <0.50 |          |
| 11/24/2008                    | <300                   | <10  | <0.50 | <0.50 | <0.50 | <0.50 | <0.50   | <0.50 |          |
| 4/9/2009                      | <300                   | <10  | 12    | <0.50 | <0.50 | <0.50 | <0.50   | <0.50 |          |
| 11/24/2009                    | <300                   | <10  | 1.7   | <0.50 | <0.50 | <0.50 | <0.50   | <0.50 |          |

**Table 2. Summary of Fuel Additives Analytical Data**  
**ARCO Service Station #2035, 1001 San Pablo Ave., Albany, CA**

| Well ID and<br>Date Monitored | Concentrations in µg/L |               |             |                 |                 |                 |                 |                 | Footnote |
|-------------------------------|------------------------|---------------|-------------|-----------------|-----------------|-----------------|-----------------|-----------------|----------|
|                               | Ethanol                | TBA           | MTBE        | DIPE            | ETBE            | TAME            | 1,2-DCA         | EDB             |          |
| <b>MW-4 Cont.</b>             |                        |               |             |                 |                 |                 |                 |                 |          |
| 5/26/2010                     | <300                   | <10           | 1.4         | <0.50           | <0.50           | <0.50           | <0.50           | <0.50           |          |
| 2/16/2011                     | <300                   | <10           | 2.1         | <0.50           | <0.50           | <0.50           | <0.50           | <0.50           |          |
| 5/11/2011                     | <300                   | <10           | 0.75        | <0.50           | <0.50           | <0.50           | <0.50           | <0.50           |          |
| 11/28/2011                    | <300                   | <10           | 0.67        | <0.50           | <0.50           | <0.50           | <0.50           | <0.50           |          |
| 6/5/2012                      | <300                   | <10           | 1.2         | <0.50           | <0.50           | <0.50           | <0.50           | <0.50           |          |
| 12/6/2012                     | <150                   | <10           | 2.5         | <0.50           | <0.50           | <0.50           | <0.50           | <0.50           |          |
| <b>6/4/2013</b>               | <b>&lt;150</b>         | <b>&lt;10</b> | <b>0.54</b> | <b>&lt;0.50</b> | <b>&lt;0.50</b> | <b>&lt;0.50</b> | <b>&lt;0.50</b> | <b>&lt;0.50</b> |          |
| <b>MW-5</b>                   |                        |               |             |                 |                 |                 |                 |                 |          |
| 4/11/2002                     | --                     | --            | <5.0        | --              | --              | --              | --              | --              |          |
| 6/3/2003                      | <100                   | <20           | <0.50       | <0.50           | <0.50           | <0.50           | <0.50           | <0.50           |          |
| 11/13/2003                    | <100                   | <20           | 0.79        | <0.50           | <0.50           | <0.50           | --              | --              |          |
| 12/01/2004                    | <100                   | <20           | 0.55        | <0.50           | <0.50           | <0.50           | <0.50           | <0.50           |          |
| 11/16/2005                    | <100                   | <20           | <0.50       | <0.50           | <0.50           | <0.50           | <0.50           | <0.50           | a        |
| 12/6/2006                     | <300                   | <20           | 0.99        | <0.50           | <0.50           | <0.50           | <0.50           | <0.50           | a        |
| 11/29/2007                    | <300                   | <20           | <0.50       | <0.50           | <0.50           | <0.50           | <0.50           | <0.50           |          |
| 11/24/2008                    | <300                   | <10           | <0.50       | <0.50           | <0.50           | <0.50           | <0.50           | <0.50           |          |
| 11/24/2009                    | <300                   | <10           | 0.89        | <0.50           | <0.50           | <0.50           | <0.50           | <0.50           |          |
| 2/16/2011                     | <300                   | <10           | <0.50       | <0.50           | <0.50           | <0.50           | <0.50           | <0.50           |          |
| 11/28/2011                    | <300                   | <10           | <0.50       | <0.50           | <0.50           | <0.50           | <0.50           | <0.50           |          |
| 12/6/2012                     | <150                   | <10           | <0.50       | <0.50           | <0.50           | <0.50           | <0.50           | <0.50           |          |
| <b>MW-6</b>                   |                        |               |             |                 |                 |                 |                 |                 |          |
| 4/11/2002                     | --                     | --            | <5.0        | --              | --              | --              | --              | --              |          |
| 11/27/2002                    | --                     | --            | <0.50       | --              | --              | --              | --              | --              |          |
| 6/3/2003                      | <100                   | <20           | <0.50       | <0.50           | <0.50           | <0.50           | <0.50           | <0.50           |          |
| 11/13/2003                    | <100                   | <20           | <0.50       | <0.50           | <0.50           | <0.50           | --              | --              |          |
| 12/01/2004                    | <100                   | <20           | <0.50       | <0.50           | <0.50           | <0.50           | <0.50           | <0.50           |          |
| 11/16/2005                    | <100                   | <20           | <0.50       | <0.50           | <0.50           | <0.50           | <0.50           | <0.50           | a        |
| 12/6/2006                     | <300                   | <20           | <0.50       | <0.50           | <0.50           | <0.50           | <0.50           | <0.50           | a        |
| 11/29/2007                    | <300                   | <20           | <0.50       | <0.50           | <0.50           | <0.50           | <0.50           | <0.50           |          |
| 11/24/2008                    | <300                   | <10           | <0.50       | <0.50           | <0.50           | <0.50           | <0.50           | <0.50           |          |



**Table 2. Summary of Fuel Additives Analytical Data**  
**ARCO Service Station #2035, 1001 San Pablo Ave., Albany, CA**

| Well ID and<br>Date Monitored | Concentrations in µg/L |        |       |       |       |       |         |       | Footnote |
|-------------------------------|------------------------|--------|-------|-------|-------|-------|---------|-------|----------|
|                               | Ethanol                | TBA    | MTBE  | DIPE  | ETBE  | TAME  | 1,2-DCA | EDB   |          |
| <b>MW-6 Cont.</b>             |                        |        |       |       |       |       |         |       |          |
| 11/24/2009                    | <300                   | <10    | <0.50 | <0.50 | <0.50 | <0.50 | <0.50   | <0.50 |          |
| 2/16/2011                     | <300                   | <10    | <0.50 | <0.50 | <0.50 | <0.50 | <0.50   | <0.50 |          |
| 11/28/2011                    | <300                   | <10    | <0.50 | <0.50 | <0.50 | <0.50 | <0.50   | <0.50 |          |
| 12/6/2012                     | <150                   | <10    | <0.50 | <0.50 | <0.50 | <0.50 | <0.50   | <0.50 |          |
| <b>MW-7</b>                   |                        |        |       |       |       |       |         |       |          |
| 4/9/2009                      | <300                   | <10    | <0.50 | <0.50 | <0.50 | <0.50 | <0.50   | <0.50 |          |
| 11/24/2009                    | <300                   | <10    | <0.50 | <0.50 | <0.50 | <0.50 | <0.50   | <0.50 | b        |
| 5/26/2010                     | <300                   | <10    | <0.50 | <0.50 | <0.50 | <0.50 | <0.50   | <0.50 |          |
| 2/16/2011                     | <300                   | <10    | <0.50 | <0.50 | <0.50 | <0.50 | <0.50   | <0.50 |          |
| 5/11/2011                     | <300                   | <10    | <0.50 | <0.50 | <0.50 | <0.50 | <0.50   | <0.50 |          |
| 11/28/2011                    | <300                   | <10    | <0.50 | <0.50 | <0.50 | <0.50 | <0.50   | <0.50 |          |
| 6/5/2012                      | <300                   | <10    | <0.50 | <0.50 | <0.50 | <0.50 | <0.50   | <0.50 |          |
| 12/6/2012                     | <150                   | <10    | <0.50 | <0.50 | <0.50 | <0.50 | <0.50   | <0.50 |          |
| 6/4/2013                      | <150                   | <10    | <0.50 | <0.50 | <0.50 | <0.50 | <0.50   | <0.50 |          |
| <b>MW-8</b>                   |                        |        |       |       |       |       |         |       |          |
| 4/9/2009                      | <300                   | 330    | 110   | 5.5   | <0.50 | <0.50 | 34      | <0.50 |          |
| 11/24/2009                    | <60,000                | <2,000 | <100  | <100  | <100  | <100  | <100    | <100  | b        |
| 5/26/2010                     | <6,000                 | <200   | <10   | <10   | <10   | <10   | <10     | <10   |          |
| 2/16/2011                     | <3,000                 | <100   | <5.0  | <5.0  | <5.0  | <5.0  | <5.0    | <5.0  |          |
| 5/11/2011                     | <2,400                 | <80    | <4.0  | <4.0  | <4.0  | <4.0  | <4.0    | <4.0  |          |
| 11/28/2011                    | <300                   | <10    | <0.50 | <0.50 | <0.50 | <0.50 | <0.50   | <0.50 |          |
| 6/5/2012                      | <300                   | 38     | 2.1   | <0.50 | <0.50 | <0.50 | <0.50   | <0.50 |          |
| 12/6/2012                     | <150                   | <10    | <0.50 | <0.50 | <0.50 | <0.50 | <0.50   | <0.50 |          |
| 6/4/2013                      | <150                   | 26     | 2.0   | <0.50 | <0.50 | <0.50 | <0.50   | <0.50 |          |
| <b>MW-9</b>                   |                        |        |       |       |       |       |         |       |          |
| 4/9/2009                      | <300                   | <10    | 2.1   | <0.50 | <0.50 | <0.50 | <0.50   | <0.50 |          |
| 11/24/2009                    | <300                   | <10    | 3.8   | <0.50 | <0.50 | <0.50 | <0.50   | <0.50 |          |
| 5/26/2010                     | <300                   | <10    | 1.9   | <0.50 | <0.50 | <0.50 | <0.50   | <0.50 |          |
| 2/16/2011                     | <300                   | <10    | 3.8   | <0.50 | <0.50 | <0.50 | <0.50   | <0.50 |          |
| 5/11/2011                     | <300                   | <10    | 1.2   | <0.50 | <0.50 | <0.50 | <0.50   | <0.50 |          |

**Table 2. Summary of Fuel Additives Analytical Data**  
**ARCO Service Station #2035, 1001 San Pablo Ave., Albany, CA**

| Well ID and<br>Date Monitored | Concentrations in µg/L |               |                 |                 |                 |                 |                 |                 | Footnote |
|-------------------------------|------------------------|---------------|-----------------|-----------------|-----------------|-----------------|-----------------|-----------------|----------|
|                               | Ethanol                | TBA           | MTBE            | DIPE            | ETBE            | TAME            | 1,2-DCA         | EDB             |          |
| <b>MW-9 Cont.</b>             |                        |               |                 |                 |                 |                 |                 |                 |          |
| 11/28/2011                    | <300                   | <10           | 9.1             | <0.50           | <0.50           | <0.50           | <0.50           | <0.50           |          |
| 6/5/2012                      | <300                   | <10           | 4.8             | <0.50           | <0.50           | <0.50           | <0.50           | <0.50           |          |
| 12/6/2012                     | <150                   | <10           | 6.4             | <0.50           | <0.50           | <0.50           | <0.50           | <0.50           |          |
| <b>6/4/2013</b>               | <b>&lt;150</b>         | <b>&lt;10</b> | <b>3.5</b>      | <b>&lt;0.50</b> | <b>&lt;0.50</b> | <b>&lt;0.50</b> | <b>&lt;0.50</b> | <b>&lt;0.50</b> |          |
| <b>RW-1</b>                   |                        |               |                 |                 |                 |                 |                 |                 |          |
| 4/11/2002                     | --                     | --            | 1,500           | --              | --              | --              | --              | --              |          |
| 11/27/2002                    | --                     | --            | <25             | --              | --              | --              | --              | --              |          |
| 6/3/2003                      | <100                   | 22            | 48              | <0.50           | <0.50           | <0.50           | <0.50           | <0.50           |          |
| 11/13/2003                    | <100                   | <20           | 44              | <0.50           | <0.50           | <0.50           | --              | --              |          |
| 05/12/2004                    | <500                   | <100          | <2.5            | <2.5            | <2.5            | <2.5            | <2.5            | <2.5            |          |
| 12/01/2004                    | <500                   | <100          | 16              | <2.5            | <2.5            | <2.5            | <2.5            | <2.5            |          |
| 05/02/2005                    | <200                   | <40           | 50              | <1.0            | <1.0            | <1.0            | <1.0            | <1.0            |          |
| 11/16/2005                    | <200                   | <40           | 32              | <1.0            | <1.0            | <1.0            | <1.0            | <1.0            | a        |
| 5/31/2006                     | <300                   | <20           | 28              | <0.50           | <0.50           | <0.50           | <0.50           | <0.50           | a        |
| 12/6/2006                     | <300                   | <20           | 19              | <0.50           | <0.50           | <0.50           | <0.50           | <0.50           | a        |
| 5/15/2007                     | <300                   | <20           | 18              | <0.50           | <0.50           | <0.50           | <0.50           | <0.50           |          |
| 11/29/2007                    | <300                   | <20           | 18              | <0.50           | <0.50           | <0.50           | <0.50           | <0.50           |          |
| 5/6/2008                      | <1,500                 | <50           | 2.6             | <2.5            | <2.5            | <2.5            | <2.5            | <2.5            |          |
| 11/24/2008                    | <300                   | <10           | 11              | <0.50           | <0.50           | <0.50           | <0.50           | <0.50           |          |
| 4/9/2009                      | <300                   | <10           | 4.0             | <0.50           | <0.50           | <0.50           | <0.50           | <0.50           |          |
| 11/24/2009                    | <300                   | <10           | 6.5             | <0.50           | <0.50           | <0.50           | <0.50           | <0.50           |          |
| 5/26/2010                     | <300                   | <10           | 0.94            | <0.50           | <0.50           | <0.50           | <0.50           | <0.50           |          |
| 2/16/2011                     | <300                   | <10           | 1.3             | <0.50           | <0.50           | <0.50           | <0.50           | <0.50           |          |
| 5/11/2011                     | <1,200                 | <40           | <2.0            | <2.0            | <2.0            | <2.0            | <2.0            | <2.0            |          |
| 11/28/2011                    | <300                   | <10           | <0.50           | <0.50           | <0.50           | <0.50           | <0.50           | <0.50           |          |
| 6/5/2012                      | <300                   | <10           | <0.50           | <0.50           | <0.50           | <0.50           | <0.50           | <0.50           |          |
| 12/6/2012                     | <300                   | <20           | <1.0            | <1.0            | <1.0            | <1.0            | <1.0            | <1.0            |          |
| <b>6/4/2013</b>               | <b>&lt;150</b>         | <b>&lt;10</b> | <b>&lt;0.50</b> | <b>&lt;0.50</b> | <b>&lt;0.50</b> | <b>&lt;0.50</b> | <b>&lt;0.50</b> | <b>&lt;0.50</b> |          |
| <b>S-5</b>                    |                        |               |                 |                 |                 |                 |                 |                 |          |
| 4/11/2002                     | --                     | --            | <500            | --              | --              | --              | --              | --              |          |

**Table 2. Summary of Fuel Additives Analytical Data**  
**ARCO Service Station #2035, 1001 San Pablo Ave., Albany, CA**

| Well ID and<br>Date Monitored | Concentrations in µg/L |               |                 |                 |                 |                 |                 |                 | Footnote |
|-------------------------------|------------------------|---------------|-----------------|-----------------|-----------------|-----------------|-----------------|-----------------|----------|
|                               | Ethanol                | TBA           | MTBE            | DIPE            | ETBE            | TAME            | 1,2-DCA         | EDB             |          |
| <b>S-5 Cont.</b>              |                        |               |                 |                 |                 |                 |                 |                 |          |
| 11/27/2002                    | --                     | --            | <50             | --              | --              | --              | --              | --              |          |
| 6/3/2003                      | <5,000                 | <1,000        | <25             | <25             | <25             | <25             | <25             | <25             |          |
| 6/3/2003                      | <5,000                 | <1,000        | <25             | <25             | <25             | <25             | <25             | <25             |          |
| 6/3/2003                      | <5,000                 | <1,000        | <25             | <25             | <25             | <25             | <25             | <25             |          |
| 6/3/2003                      | <5,000                 | <1,000        | <25             | <25             | <25             | <25             | <25             | <25             |          |
| 11/13/2003                    | <10,000                | <2,000        | <50             | <50             | <50             | <50             | --              | --              |          |
| 05/12/2004                    | <10,000                | <2,000        | <50             | <50             | <50             | <50             | <50             | <50             |          |
| 12/01/2004                    | <5,000                 | <1,000        | <25             | <25             | <25             | <25             | <25             | <25             |          |
| 05/02/2005                    | <1,000                 | <200          | <5.0            | <5.0            | <5.0            | <5.0            | <5.0            | <5.0            |          |
| 11/16/2005                    | <1,000                 | <200          | <5.0            | <5.0            | <5.0            | <5.0            | <5.0            | <5.0            | a        |
| 5/31/2006                     | <3,000                 | <200          | <5.0            | <5.0            | <5.0            | <5.0            | <5.0            | <5.0            | a        |
| 12/6/2006                     | <15,000                | <1,000        | <25             | <25             | <25             | <25             | <25             | <25             | a        |
| 5/15/2007                     | <3,000                 | <200          | <5.0            | <5.0            | <5.0            | <5.0            | <5.0            | <5.0            |          |
| 11/29/2007                    | <1,500                 | <100          | <2.5            | <2.5            | <2.5            | <2.5            | <2.5            | <2.5            |          |
| 5/6/2008                      | <300                   | <10           | <0.50           | <0.50           | <0.50           | <0.50           | <0.50           | <0.50           |          |
| 11/24/2008                    | <6,000                 | <200          | <10             | <10             | <10             | <10             | <10             | <10             |          |
| 4/9/2009                      | <6,000                 | <200          | <10             | <10             | <10             | <10             | <10             | <10             |          |
| 2/16/2011                     | <300                   | <10           | <0.50           | <0.50           | <0.50           | <0.50           | <0.50           | <0.50           |          |
| 5/11/2011                     | <300                   | <10           | <0.50           | <0.50           | <0.50           | <0.50           | <0.50           | <0.50           |          |
| 6/5/2012                      | <300                   | <10           | <0.50           | <0.50           | <0.50           | <0.50           | <0.50           | <0.50           |          |
| 12/6/2012                     | <150                   | <10           | <0.50           | <0.50           | <0.50           | <0.50           | <0.50           | <0.50           |          |
| <b>6/4/2013</b>               | <b>&lt;150</b>         | <b>&lt;10</b> | <b>&lt;0.50</b> | <b>&lt;0.50</b> | <b>&lt;0.50</b> | <b>&lt;0.50</b> | <b>&lt;0.50</b> | <b>&lt;0.50</b> |          |

Symbols & Abbreviations:

-- = Not analyzed/applicable/measured/available

< = Not detected at or above the laboratory reporting limit

1,2-DCA = 1,2-Dichloroethane

DIPE = Di-isopropyl ether

EDB = 1,2-Dibromoethane

ETBE = Ethyl tert-butyl ether

MTBE = Methyl tert-butyl ether

TAME = tert-Amyl methyl ether

TBA = tert-Butyl alcohol

µg/L = Micrograms per Liter

Footnote:

a = Calibration verification for ethanol was within method limits but outside contract limits

b = Sample taken from VOA vial with air bubble > 6mm diameter

c = LW Quantitated against gasoline

Notes:

All volatile organic compounds analyzed using EPA Method 8260B

The data within this table collected prior to April 2006 was provided to Broadbent & Associates, Inc. by Atlantic Richfield Company and their previous consultants. Broadbent & Associates, Inc. has not verified the accuracy of this information

**Table 3. Historical Groundwater Gradient - Direction and Magnitude****ARCO Service Station #2035, 1001 San Pablo Ave., Albany, CA**

| <b>Date Measured</b> | <b>Approximate Gradient Direction</b> | <b>Approximate Gradient Magnitude (ft/ft)</b> |
|----------------------|---------------------------------------|---|
| 4/11/2002            | Southwest                             | 0.012   |
| 11/27/2002           | West                                  | 0.021   |
| 6/3/2003             | West                                  | 0.024   |
| 11/13/2003           | West (offsite Northwest)              | 0.015   |
| 5/12/2004            | West                                  | 0.020   |
| 12/1/2004            | West                                  | 0.030   |
| 5/2/2005             | West                                  | 0.02  |
| 11/16/2005           | West                                  | 0.03  |
| 5/31/2006            | West                                  | 0.04  |
| 12/6/2006            | West                                  | 0.01  |
| 5/15/2007            | West                                  | 0.02  |
| 11/29/2007           | West                                  | 0.02  |
| 5/6/2008             | West                                  | 0.007   |
| 11/24/2008           | West                                  | 0.02  |
| 4/9/2009             | West                                  | 0.02  |
| 11/24/2009           | West                                  | 0.03  |
| 5/26/2010            | West                                  | 0.02  |
| 11/30/2010           | West-Southwest                        | 0.02  |
| 2/16/2011            | West                                  | 0.03  |
| 5/11/2011            | West-Southwest                        | 0.03  |
| 11/28/2011           | West-Southwest                        | 0.02  |
| 6/5/2012             | West                                  | 0.02  |
| 12/6/2012            | West                                  | 0.022   |
| <b>6/4/2013</b>      | <b>West</b>                           | <b>0.022</b>                                  |

## Notes:

Site resurveyed by URS on 10/15/03 by datum NAVD '88

The data within this table collected prior to April 2006 was provided to Broadbent & Associates, Inc. by Atlantic Richfield Company and their previous consultants. Broadbent & Associates, Inc. has not verified the accuracy of this information

**APPENDIX A**

FIELD METHODS



## **QUALITY ASSURANCE/QUALITY CONTROL FIELD METHODS**

Field methods discussed herein were implemented to provide for accuracy and reliability of field activities, data collection, sample collection, and handling. Discussion of these methods is provided below.

### **1.0 Equipment Calibration**

Equipment calibration was performed per equipment manufacturer specifications before use.

### **2.0 Depth to Groundwater and Light Non-Aqueous Phase Liquid Measurement**

Depth to groundwater was measured in wells identified for gauging in the scope of work using a decontaminated water level indicator. The depth to water measurement was taken from a cut notch or permanent mark at the top of the well casing to which the well head elevation was originally surveyed.

Once depth to water was measured, an oil/water interface meter or a new disposable bailer was utilized to evaluate the presence and, if present, to measure the “apparent” thickness of light non-aqueous phase liquid (LNAPL) in the well. If LNAPL was present in the well, groundwater purging and sampling were not performed, unless sampling procedures in the scope of work specified collection of samples in the presence of LNAPL. Otherwise, time allowing, LNAPL was bailed from the well using either a new disposable bailer, or the disposal bailer previously used for initial LNAPL assessment. Bailing of LNAPL continued until the thickness of LNAPL (or volume) stabilized in each bailer pulled from the well, or LNAPL was no longer present. After LNAPL thickness either stabilized or was eliminated, periodic depth to water and depth to LNAPL measurements were collected as product came back into the well to evaluate product recovery rate and to aid in further assessment of LNAPL in the subsurface. LNAPL thickness measurements were recorded as “apparent.” If a bailer was used for LNAPL thickness measurement, the field sampler noted the bailer entry diameter and chamber diameter to enable correction of thickness measurements. Recovered LNAPL was stored on-site in a labeled steel drum(s) or other appropriate container(s) prior to disposal.

### **3.0 Well Purging and Groundwater Sample Collection**

Well purging and groundwater sampling were performed in wells specified in the scope of work after measuring depth to groundwater and evaluating the presence of LNAPL. Purging and sampling were performed using one of the methods detailed below. The method used was noted in the field records. Purge water was stored on-site in labeled steel drum(s) or other appropriate container(s) prior to disposal or on-site treatment (in cases where treatment using an on-site system is authorized).

### 3.1 Purging a Predetermined Well Volume

Purging a predetermined well volume is performed per ASTM International (ASTM) D4448-01. This purging method has the objective of removing a predetermined volume of stagnant water from the well prior to sampling. The volume of stagnant water is defined as either the volume of water contained within the well casing, or the volume within the well casing and sand/gravel in the annulus if natural flow through these is deemed insufficient to keep them flushed out.

This purging method involves removal of a minimum of three stagnant water volumes from the well using a decontaminated pump with new disposable plastic discharge or suction tubing, dedicated well tubing, or using a new disposable or decontaminated reusable bailer. If a new disposable bailer was used for assessment of LNAPL, that bailer may be used for purging. The withdrawal rate used is one that minimizes drawdown while satisfying time constraints.

To evaluate when purging is complete, one or more groundwater stabilization parameters are monitored and recorded during purging activities until stabilization is achieved. Most commonly, stabilization parameters include temperature, conductivity, and pH, but field procedures detailed in the scope of work may also include monitoring of dissolved oxygen concentrations, oxidation reduction potential, and/or turbidity<sup>1</sup>. Parameters are considered stable when two (2) consecutive readings recorded three (3) minutes apart fall within ranges provided below in Table 1. In the event that the parameters have not stabilized and five (5) well casing volumes have been removed, purging activities will cease and be considered complete. Once the well is purged, a groundwater sample(s) is collected from the well using a new disposable bailer. If a new disposable bailer was used for purging, that bailer may be used to collect the sample(s). A sample is not collected if the well is inadvertently purged dry.

Table 1. Criteria for Defining Stabilization of Water-Quality Indicator Parameters

| Parameter                     | Stabilization Criterion                 |
|-------------------------------|---|
| Temperature                   | ± 0.2°C (± 0.36°F)                      |
| pH                            | ± 0.1 standard units                    |
| Conductivity                  | ± 3%                                    |
| Dissolved oxygen              | ± 10%                                   |
| Oxidation reduction potential | ± 10 mV                                 |
| Turbidity <sup>1</sup>        | ± 10% or 1.0 NTU (whichever is greater) |

### 3.2 Low-Flow Purging and Sampling

“Low-Flow”, “Minimal Drawdown”, or “Low-Stress” purging is performed per ASTM D6771-02. It is a method of groundwater removal from within a well’s screened interval that is intended to

<sup>1</sup> As stated in ASTM D6771-02, turbidity is not a chemical parameter and not indicative of when formation-quality water is being purged; however, turbidity may be helpful in evaluating stress on the formation during purging. Turbidity measurements are taken at the same time that stabilization parameter measurements are made, or, at a minimum, once when purging is initiated and again just prior to sample collection, after stabilization parameters have stabilized. To avoid artifacts in sample analysis, turbidity should be as low as possible when samples are collected. If turbidity values are persistently high, the withdrawal rate is lowered until turbidity decreases. If high turbidity persists even after lowering the withdrawal rate, the purging is stopped for a period of time until turbidity settles, and the purging process is then restarted. If this fails to solve the problem, the purging/sampling process for the well is ceased, and well maintenance or redevelopment is considered.

minimize drawdown and mixing of the water column in the well casing. This is accomplished by pumping the well using a decontaminated pump with new disposable plastic discharge or suction tubing or dedicated well tubing at a low flow rate while evaluating the groundwater elevation during pumping.

The low flow pumping rate is well specific and is generally established at a volume that is less than or equal to the natural recovery rate of the well. A pump with adjustable flow rate control is positioned with the intake at or near the mid-point of the submerged well screen. The pumping rate used during low-flow purging is low enough to minimize mobilization of particulate matter and drawdown (stress) of the water column. Low-flow purging rates will vary based on the individual well characteristics; however, the purge rate should not exceed 1.0 Liter per minute (L/min) or 0.25 gallon per minute (gal/min). Low-flow purging should begin at a rate of approximately 0.1 L/min (0.03 gal/min)<sup>2</sup>, or the lowest rate possible, and be adjusted based on an evaluation of drawdown. Water level measurements should be recorded at approximate one (1) to two (2) minute intervals until the low-flow rate has been established, and drawdown is minimized. As a general rule, drawdown should not exceed 25% of the distance between the top of the water column and the pump in-take.

To evaluate when purging is complete, one or more groundwater stabilization parameters are monitored and recorded during purging activities until stabilization is achieved. Most commonly, stabilization parameters include temperature, conductivity, and pH, but field procedures detailed in the scope of work may also include monitoring of dissolved oxygen concentrations, oxidation reduction potential, and/or turbidity<sup>1</sup>. The frequency between measurements will be at an interval of one (1) to three (3) minutes; however, if a flow cell is used, the frequency will be determined based on the time required to evacuate one cell volume. Stabilization is defined as three (3) consecutive readings recorded several minutes apart falling within ranges provided in Table 1. Samples will be collected by filling appropriate containers from the pump discharge tubing at a rate not to exceed the established pumping rate.

### 3.3 Minimal Purge, Discrete Depth, and Passive Sampling

Per ASTM D4448-01, sampling techniques that do not rely on purging, or require only minimal purging, may be used if a particular zone within a screened interval is to be sampled or if a well is not capable of yielding sufficient groundwater for purging. To properly use these sampling techniques, a water sample is collected within the screened interval with little or no mixing of the water column within the casing. These techniques include minimal purge sampling which uses a dedicated sampling pump capable of pumping rates of less than 0.1 L/min (0.03 gal/min)<sup>2</sup>, discrete depth sampling using a bailer that allows groundwater entry at a controlled depth (e.g. differential pressure bailer), or passive (diffusion) sampling. These techniques are based on certain studies referenced in ASTM D4448-01 that indicate that under certain conditions, natural groundwater flow is laminar and horizontal with little or no mixing within the well screen.

---

<sup>2</sup> According to ASTM D4448-01, studies have indicated that at flow rates of 0.1 L/min, low-density polyethylene (LDPE) and plasticized polypropylene tubing materials are prone to sorption. Therefore, TFE-fluorocarbon or other appropriate tubing material is used, particularly when tubing lengths of 50 feet or longer are used.

#### 4.0 Decontamination

Reusable groundwater sampling equipment were cleaned using a solution of Alconox or other acceptable detergent, rinsed with tap water, and finally rinsed with distilled water prior to use in each well. Decontamination water was stored on-site in labeled steel drum(s) or other appropriate container(s) prior to disposal.

#### 5.0 Sample Containers, Labeling, and Storage

Samples were collected in laboratory prepared containers with appropriate preservative (if preservative was required). Samples were properly labeled (site name, sample I.D., sampler initials, date, and time of collection) and stored chilled (refrigerator or ice chest with ice) until delivery to a certified laboratory, under chain of custody procedures.

#### 6.0 Chain of Custody Record and Procedure

The field sampler was personally responsible for care and custody of the samples collected until they were properly transferred to another party. To document custody and transfer of samples, a Chain of Custody Record was prepared. The Chain of Custody Record provided identification of the samples corresponding to sample labels and specified analyses to be performed by the laboratory. The original Chain of Custody Record accompanied the shipment, and a copy of the record was stored in the project file. When the samples were transferred, the individuals relinquishing and receiving them signed, dated, and noted the time of transfer on the record.

#### 7.0 Field Records

Daily Report and data forms were completed by staff personnel to provide daily record of significant events, observations, and measurements. Field records were signed, dated, and stored in the project file.

**APPENDIX B**

FIELD DATA SHEETS



# DAILY REPORT

Page 1 of 1

Project: RD 2035 Project No.: 06-88-610

Field Representative(s): A. Martinez / J. Ramos Day: Tuesday Date: 6/4/13

Time Onsite: From: 0715 To: \_\_\_\_\_; From: \_\_\_\_\_ To: \_\_\_\_\_; From: \_\_\_\_\_ To: \_\_\_\_\_

- Signed HASP
- Safety Glasses
- Hard Hat
- Steel Toe Boots
- Safety Vest
- UST Emergency System Shut-off Switches Located
- Proper Gloves
- Proper Level of Barricading
- \_\_\_\_ Other PPE (describe) \_\_\_\_\_

Weather: Overcast

Equipment In Use: Peristaltic pump, water quality meter, interface, pipe.

Visitors: K. Tidwell

### TIME:

### WORK DESCRIPTION:

|             |  |
|-------------|--|
| <u>0715</u> | <u>Arrived onsite, conducted tailgate</u>                  |
| <u>0810</u> | <u>Set up @ MW-9</u>                                       |
| <u>0845</u> | <u>K. Tidwell &amp; Statewide arrive onsite.</u>           |
|             | <u>Re calibrated US3 due to unusually low pH readings.</u> |
| <u>0915</u> | <u>Set up @ road well S-5</u>                              |
| <u>0945</u> | <u>Set up @ MW-4</u>                                       |
| <u>1020</u> | <u>Set up @ MW-2 &amp; MW-8</u>                            |
| <u>1040</u> | <u>Set up @ RW-1</u>                                       |
| <u>1200</u> | <u>Set up @ MW-7</u>                                       |
| <u>1245</u> | <u>Cleaned up, completed fieldwork &amp; off site.</u>     |
|             |  |
|             |  |
|             |  |
|             |  |
|             |  |
|             |  |
|             |  |
|             |  |
|             |  |

Signature: James Ram























**APPENDIX C**

LABORATORY REPORT  
AND CHAIN-OF-CUSTODY DOCUMENTATION

# TestAmerica

THE LEADER IN ENVIRONMENTAL TESTING

## ANALYTICAL REPORT

TestAmerica Laboratories, Inc.  
TestAmerica Irvine  
17461 Derian Ave  
Suite 100  
Irvine, CA 92614-5817  
Tel: (949)261-1022

TestAmerica Job ID: 440-48384-1  
Client Project/Site: ARCO 2035, Albany

For:  
Broadbent & Associates, Inc.  
875 Cotting Lane  
Suite G  
Vacaville, California 95688

Attn: Kristene Tidwell



---

*Authorized for release by:  
6/18/2013 12:50:51 PM*

Kathleen Robb, Project Manager II  
kathleen.robbs@testamericainc.com

*The test results in this report meet all 2003 NELAC and 2009 TNI requirements for accredited parameters, exceptions are noted in this report. This report may not be reproduced except in full, and with written approval from the laboratory. For questions please contact the Project Manager at the e-mail address or telephone number listed on this page.*

*This report has been electronically signed and authorized by the signatory. Electronic signature is intended to be the legally binding equivalent of a traditionally handwritten signature.*

*Results relate only to the items tested and the sample(s) as received by the laboratory.*

1

2

3

4

5

6

7

8

9

10

11

12

13



# Table of Contents

|                                 |    |
|---------------------------------|----|
| Cover Page . . . . .            | 1  |
| Table of Contents . . . . .     | 2  |
| Sample Summary . . . . .        | 3  |
| Case Narrative . . . . .        | 4  |
| Client Sample Results . . . . . | 5  |
| Method Summary . . . . .        | 11 |
| Chronicle . . . . .             | 12 |
| QC Sample Results . . . . .     | 14 |
| QC Association . . . . .        | 17 |
| Definitions . . . . .           | 18 |
| Certification Summary . . . . . | 19 |
| Chain of Custody . . . . .      | 20 |
| Receipt Checklists . . . . .    | 21 |



# Sample Summary

Client: Broadbent & Associates, Inc.  
Project/Site: ARCO 2035, Albany

TestAmerica Job ID: 440-48384-1

| Lab Sample ID | Client Sample ID | Matrix | Collected      | Received       |
|---------------|------------------|--------|----------------|----------------|
| 440-48384-1   | MW-4             | Water  | 06/04/13 10:12 | 06/05/13 09:30 |
| 440-48384-2   | RW-1             | Water  | 06/04/13 11:00 | 06/05/13 09:30 |
| 440-48384-3   | S-5              | Water  | 06/04/13 09:40 | 06/05/13 09:30 |
| 440-48384-4   | MW-7             | Water  | 06/04/13 12:20 | 06/05/13 09:30 |
| 440-48384-5   | MW-8             | Water  | 06/04/13 10:35 | 06/05/13 09:30 |
| 440-48384-6   | MW-9             | Water  | 06/04/13 08:35 | 06/05/13 09:30 |



# Case Narrative

Client: Broadbent & Associates, Inc.  
Project/Site: ARCO 2035, Albany

TestAmerica Job ID: 440-48384-1

---

**Job ID: 440-48384-1**

---

**Laboratory: TestAmerica Irvine**

**Narrative**

---

**Job Narrative**  
**440-48384-1**

**Comments**

No additional comments.

**Receipt**

The samples were received on 6/5/2013 9:30 AM; the samples arrived in good condition, properly preserved and, where required, on ice. The temperature of the cooler at receipt was 2.2° C.

**GC/MS VOA**

No analytical or quality issues were noted.

**GC VOA**

Method(s) 8015B: Surrogate recovery was outside control limits for the following sample: (CCV 440-110236/14), (CCV 440-110236/24). BFB surrogate coeluted with TPH standard. Data not impacted.

No other analytical or quality issues were noted.

**VOA Prep**

No analytical or quality issues were noted.



# Client Sample Results

Client: Broadbent & Associates, Inc.  
 Project/Site: ARCO 2035, Albany

TestAmerica Job ID: 440-48384-1

**Client Sample ID: MW-4**

**Lab Sample ID: 440-48384-1**

**Date Collected: 06/04/13 10:12**

**Matrix: Water**

**Date Received: 06/05/13 09:30**

**Method: 8260B/5030B - Volatile Organic Compounds (GC/MS)**

| Analyte                            | Result      | Qualifier | RL   | Unit | D | Prepared | Analyzed       | Dil Fac |
|------------------------------------|-------------|-----------|------|------|---|----------|----------------|---------|
| 1,2-Dibromoethane (EDB)            | ND          |           | 0.50 | ug/L |   |          | 06/13/13 11:22 | 1       |
| 1,2-Dichloroethane                 | ND          |           | 0.50 | ug/L |   |          | 06/13/13 11:22 | 1       |
| Benzene                            | ND          |           | 0.50 | ug/L |   |          | 06/13/13 11:22 | 1       |
| Ethanol                            | ND          |           | 150  | ug/L |   |          | 06/13/13 11:22 | 1       |
| Ethylbenzene                       | ND          |           | 0.50 | ug/L |   |          | 06/13/13 11:22 | 1       |
| Ethyl-t-butyl ether (ETBE)         | ND          |           | 0.50 | ug/L |   |          | 06/13/13 11:22 | 1       |
| Isopropyl Ether (DIPE)             | ND          |           | 0.50 | ug/L |   |          | 06/13/13 11:22 | 1       |
| m,p-Xylene                         | ND          |           | 1.0  | ug/L |   |          | 06/13/13 11:22 | 1       |
| <b>Methyl-t-Butyl Ether (MTBE)</b> | <b>0.54</b> |           | 0.50 | ug/L |   |          | 06/13/13 11:22 | 1       |
| o-Xylene                           | ND          |           | 0.50 | ug/L |   |          | 06/13/13 11:22 | 1       |
| Tert-amyl-methyl ether (TAME)      | ND          |           | 0.50 | ug/L |   |          | 06/13/13 11:22 | 1       |
| tert-Butyl alcohol (TBA)           | ND          |           | 10   | ug/L |   |          | 06/13/13 11:22 | 1       |
| Toluene                            | ND          |           | 0.50 | ug/L |   |          | 06/13/13 11:22 | 1       |
| Xylenes, Total                     | ND          |           | 1.0  | ug/L |   |          | 06/13/13 11:22 | 1       |

| Surrogate                   | %Recovery | Qualifier | Limits   | Prepared | Analyzed       | Dil Fac |
|-----------------------------|-----------|-----------|----------|----------|----------------|---------|
| 4-Bromofluorobenzene (Surr) | 110       |           | 80 - 120 |          | 06/13/13 11:22 | 1       |
| Dibromofluoromethane (Surr) | 103       |           | 80 - 120 |          | 06/13/13 11:22 | 1       |
| Toluene-d8 (Surr)           | 112       |           | 80 - 120 |          | 06/13/13 11:22 | 1       |

**Method: 8015B/5030B - Gasoline Range Organics (GC)**

| Analyte      | Result | Qualifier | RL | Unit | D | Prepared | Analyzed       | Dil Fac |
|--------------|--------|-----------|----|------|---|----------|----------------|---------|
| GRO (C6-C12) | ND     |           | 50 | ug/L |   |          | 06/10/13 19:38 | 1       |

| Surrogate                   | %Recovery | Qualifier | Limits   | Prepared | Analyzed       | Dil Fac |
|-----------------------------|-----------|-----------|----------|----------|----------------|---------|
| 4-Bromofluorobenzene (Surr) | 109       |           | 65 - 140 |          | 06/10/13 19:38 | 1       |

# Client Sample Results

Client: Broadbent & Associates, Inc.  
Project/Site: ARCO 2035, Albany

TestAmerica Job ID: 440-48384-1

**Client Sample ID: RW-1**

**Lab Sample ID: 440-48384-2**

**Date Collected: 06/04/13 11:00**

**Matrix: Water**

**Date Received: 06/05/13 09:30**

**Method: 8260B/5030B - Volatile Organic Compounds (GC/MS)**

| Analyte                       | Result | Qualifier | RL   | Unit | D | Prepared | Analyzed       | Dil Fac |
|-------------------------------|--------|-----------|------|------|---|----------|----------------|---------|
| 1,2-Dibromoethane (EDB)       | ND     |           | 0.50 | ug/L |   |          | 06/13/13 12:52 | 1       |
| 1,2-Dichloroethane            | ND     |           | 0.50 | ug/L |   |          | 06/13/13 12:52 | 1       |
| Benzene                       | ND     |           | 0.50 | ug/L |   |          | 06/13/13 12:52 | 1       |
| Ethanol                       | ND     |           | 150  | ug/L |   |          | 06/13/13 12:52 | 1       |
| Ethylbenzene                  | ND     |           | 0.50 | ug/L |   |          | 06/13/13 12:52 | 1       |
| Ethyl-t-butyl ether (ETBE)    | ND     |           | 0.50 | ug/L |   |          | 06/13/13 12:52 | 1       |
| Isopropyl Ether (DIPE)        | ND     |           | 0.50 | ug/L |   |          | 06/13/13 12:52 | 1       |
| m,p-Xylene                    | ND     |           | 1.0  | ug/L |   |          | 06/13/13 12:52 | 1       |
| Methyl-t-Butyl Ether (MTBE)   | ND     |           | 0.50 | ug/L |   |          | 06/13/13 12:52 | 1       |
| o-Xylene                      | ND     |           | 0.50 | ug/L |   |          | 06/13/13 12:52 | 1       |
| Tert-amyl-methyl ether (TAME) | ND     |           | 0.50 | ug/L |   |          | 06/13/13 12:52 | 1       |
| tert-Butyl alcohol (TBA)      | ND     |           | 10   | ug/L |   |          | 06/13/13 12:52 | 1       |
| Toluene                       | ND     |           | 0.50 | ug/L |   |          | 06/13/13 12:52 | 1       |
| Xylenes, Total                | ND     |           | 1.0  | ug/L |   |          | 06/13/13 12:52 | 1       |

| Surrogate                   | %Recovery | Qualifier | Limits   | Prepared | Analyzed       | Dil Fac |
|-----------------------------|-----------|-----------|----------|----------|----------------|---------|
| 4-Bromofluorobenzene (Surr) | 110       |           | 80 - 120 |          | 06/13/13 12:52 | 1       |
| Dibromofluoromethane (Surr) | 105       |           | 80 - 120 |          | 06/13/13 12:52 | 1       |
| Toluene-d8 (Surr)           | 114       |           | 80 - 120 |          | 06/13/13 12:52 | 1       |

**Method: 8015B/5030B - Gasoline Range Organics (GC)**

| Analyte      | Result | Qualifier | RL | Unit | D | Prepared | Analyzed       | Dil Fac |
|--------------|--------|-----------|----|------|---|----------|----------------|---------|
| GRO (C6-C12) | ND     |           | 50 | ug/L |   |          | 06/10/13 20:05 | 1       |

| Surrogate                   | %Recovery | Qualifier | Limits   | Prepared | Analyzed       | Dil Fac |
|-----------------------------|-----------|-----------|----------|----------|----------------|---------|
| 4-Bromofluorobenzene (Surr) | 101       |           | 65 - 140 |          | 06/10/13 20:05 | 1       |

# Client Sample Results

Client: Broadbent & Associates, Inc.  
 Project/Site: ARCO 2035, Albany

TestAmerica Job ID: 440-48384-1

**Client Sample ID: S-5**

**Lab Sample ID: 440-48384-3**

**Date Collected: 06/04/13 09:40**

**Matrix: Water**

**Date Received: 06/05/13 09:30**

**Method: 8260B/5030B - Volatile Organic Compounds (GC/MS)**

| Analyte                       | Result      | Qualifier | RL   | Unit | D | Prepared | Analyzed       | Dil Fac |
|-------------------------------|-------------|-----------|------|------|---|----------|----------------|---------|
| 1,2-Dibromoethane (EDB)       | ND          |           | 0.50 | ug/L |   |          | 06/13/13 13:22 | 1       |
| 1,2-Dichloroethane            | ND          |           | 0.50 | ug/L |   |          | 06/13/13 13:22 | 1       |
| <b>Benzene</b>                | <b>14</b>   |           | 0.50 | ug/L |   |          | 06/13/13 13:22 | 1       |
| Ethanol                       | ND          |           | 150  | ug/L |   |          | 06/13/13 13:22 | 1       |
| <b>Ethylbenzene</b>           | <b>3.1</b>  |           | 0.50 | ug/L |   |          | 06/13/13 13:22 | 1       |
| Ethyl-t-butyl ether (ETBE)    | ND          |           | 0.50 | ug/L |   |          | 06/13/13 13:22 | 1       |
| Isopropyl Ether (DIPE)        | ND          |           | 0.50 | ug/L |   |          | 06/13/13 13:22 | 1       |
| <b>m,p-Xylene</b>             | <b>1.7</b>  |           | 1.0  | ug/L |   |          | 06/13/13 13:22 | 1       |
| Methyl-t-Butyl Ether (MTBE)   | ND          |           | 0.50 | ug/L |   |          | 06/13/13 13:22 | 1       |
| <b>o-Xylene</b>               | <b>0.64</b> |           | 0.50 | ug/L |   |          | 06/13/13 13:22 | 1       |
| Tert-amyl-methyl ether (TAME) | ND          |           | 0.50 | ug/L |   |          | 06/13/13 13:22 | 1       |
| tert-Butyl alcohol (TBA)      | ND          |           | 10   | ug/L |   |          | 06/13/13 13:22 | 1       |
| <b>Toluene</b>                | <b>1.8</b>  |           | 0.50 | ug/L |   |          | 06/13/13 13:22 | 1       |
| <b>Xylenes, Total</b>         | <b>2.3</b>  |           | 1.0  | ug/L |   |          | 06/13/13 13:22 | 1       |

| Surrogate                   | %Recovery | Qualifier | Limits   | Prepared | Analyzed       | Dil Fac |
|-----------------------------|-----------|-----------|----------|----------|----------------|---------|
| 4-Bromofluorobenzene (Surr) | 109       |           | 80 - 120 |          | 06/13/13 13:22 | 1       |
| Dibromofluoromethane (Surr) | 105       |           | 80 - 120 |          | 06/13/13 13:22 | 1       |
| Toluene-d8 (Surr)           | 113       |           | 80 - 120 |          | 06/13/13 13:22 | 1       |

**Method: 8015B/5030B - Gasoline Range Organics (GC)**

| Analyte             | Result     | Qualifier | RL | Unit | D | Prepared | Analyzed       | Dil Fac |
|---------------------|------------|-----------|----|------|---|----------|----------------|---------|
| <b>GRO (C6-C12)</b> | <b>400</b> |           | 50 | ug/L |   |          | 06/10/13 20:33 | 1       |

| Surrogate                   | %Recovery | Qualifier | Limits   | Prepared | Analyzed       | Dil Fac |
|-----------------------------|-----------|-----------|----------|----------|----------------|---------|
| 4-Bromofluorobenzene (Surr) | 93        |           | 65 - 140 |          | 06/10/13 20:33 | 1       |

# Client Sample Results

Client: Broadbent & Associates, Inc.  
 Project/Site: ARCO 2035, Albany

TestAmerica Job ID: 440-48384-1

**Client Sample ID: MW-7**

**Lab Sample ID: 440-48384-4**

**Date Collected: 06/04/13 12:20**

**Matrix: Water**

**Date Received: 06/05/13 09:30**

**Method: 8260B/5030B - Volatile Organic Compounds (GC/MS)**

| Analyte                       | Result | Qualifier | RL   | Unit | D | Prepared | Analyzed       | Dil Fac |
|-------------------------------|--------|-----------|------|------|---|----------|----------------|---------|
| 1,2-Dibromoethane (EDB)       | ND     |           | 0.50 | ug/L |   |          | 06/13/13 13:51 | 1       |
| 1,2-Dichloroethane            | ND     |           | 0.50 | ug/L |   |          | 06/13/13 13:51 | 1       |
| Benzene                       | ND     |           | 0.50 | ug/L |   |          | 06/13/13 13:51 | 1       |
| Ethanol                       | ND     |           | 150  | ug/L |   |          | 06/13/13 13:51 | 1       |
| Ethylbenzene                  | ND     |           | 0.50 | ug/L |   |          | 06/13/13 13:51 | 1       |
| Ethyl-t-butyl ether (ETBE)    | ND     |           | 0.50 | ug/L |   |          | 06/13/13 13:51 | 1       |
| Isopropyl Ether (DIPE)        | ND     |           | 0.50 | ug/L |   |          | 06/13/13 13:51 | 1       |
| m,p-Xylene                    | ND     |           | 1.0  | ug/L |   |          | 06/13/13 13:51 | 1       |
| Methyl-t-Butyl Ether (MTBE)   | ND     |           | 0.50 | ug/L |   |          | 06/13/13 13:51 | 1       |
| o-Xylene                      | ND     |           | 0.50 | ug/L |   |          | 06/13/13 13:51 | 1       |
| Tert-amyl-methyl ether (TAME) | ND     |           | 0.50 | ug/L |   |          | 06/13/13 13:51 | 1       |
| tert-Butyl alcohol (TBA)      | ND     |           | 10   | ug/L |   |          | 06/13/13 13:51 | 1       |
| Toluene                       | ND     |           | 0.50 | ug/L |   |          | 06/13/13 13:51 | 1       |
| Xylenes, Total                | ND     |           | 1.0  | ug/L |   |          | 06/13/13 13:51 | 1       |

| Surrogate                   | %Recovery | Qualifier | Limits   | Prepared | Analyzed       | Dil Fac |
|-----------------------------|-----------|-----------|----------|----------|----------------|---------|
| 4-Bromofluorobenzene (Surr) | 109       |           | 80 - 120 |          | 06/13/13 13:51 | 1       |
| Dibromofluoromethane (Surr) | 108       |           | 80 - 120 |          | 06/13/13 13:51 | 1       |
| Toluene-d8 (Surr)           | 114       |           | 80 - 120 |          | 06/13/13 13:51 | 1       |

**Method: 8015B/5030B - Gasoline Range Organics (GC)**

| Analyte      | Result | Qualifier | RL | Unit | D | Prepared | Analyzed       | Dil Fac |
|--------------|--------|-----------|----|------|---|----------|----------------|---------|
| GRO (C6-C12) | 99     |           | 50 | ug/L |   |          | 06/10/13 21:01 | 1       |

| Surrogate                   | %Recovery | Qualifier | Limits   | Prepared | Analyzed       | Dil Fac |
|-----------------------------|-----------|-----------|----------|----------|----------------|---------|
| 4-Bromofluorobenzene (Surr) | 121       |           | 65 - 140 |          | 06/10/13 21:01 | 1       |

# Client Sample Results

Client: Broadbent & Associates, Inc.  
 Project/Site: ARCO 2035, Albany

TestAmerica Job ID: 440-48384-1

**Client Sample ID: MW-8**

**Lab Sample ID: 440-48384-5**

**Date Collected: 06/04/13 10:35**

**Matrix: Water**

**Date Received: 06/05/13 09:30**

**Method: 8260B/5030B - Volatile Organic Compounds (GC/MS)**

| Analyte                            | Result     | Qualifier | RL   | Unit | D | Prepared | Analyzed       | Dil Fac |
|------------------------------------|------------|-----------|------|------|---|----------|----------------|---------|
| 1,2-Dibromoethane (EDB)            | ND         |           | 0.50 | ug/L |   |          | 06/13/13 14:21 | 1       |
| 1,2-Dichloroethane                 | ND         |           | 0.50 | ug/L |   |          | 06/13/13 14:21 | 1       |
| <b>Benzene</b>                     | <b>70</b>  |           | 0.50 | ug/L |   |          | 06/13/13 14:21 | 1       |
| Ethanol                            | ND         |           | 150  | ug/L |   |          | 06/13/13 14:21 | 1       |
| <b>Ethylbenzene</b>                | <b>34</b>  |           | 0.50 | ug/L |   |          | 06/13/13 14:21 | 1       |
| Ethyl-t-butyl ether (ETBE)         | ND         |           | 0.50 | ug/L |   |          | 06/13/13 14:21 | 1       |
| Isopropyl Ether (DIPE)             | ND         |           | 0.50 | ug/L |   |          | 06/13/13 14:21 | 1       |
| <b>m,p-Xylene</b>                  | <b>1.6</b> |           | 1.0  | ug/L |   |          | 06/13/13 14:21 | 1       |
| <b>Methyl-t-Butyl Ether (MTBE)</b> | <b>2.0</b> |           | 0.50 | ug/L |   |          | 06/13/13 14:21 | 1       |
| o-Xylene                           | ND         |           | 0.50 | ug/L |   |          | 06/13/13 14:21 | 1       |
| Tert-amyl-methyl ether (TAME)      | ND         |           | 0.50 | ug/L |   |          | 06/13/13 14:21 | 1       |
| <b>tert-Butyl alcohol (TBA)</b>    | <b>26</b>  |           | 10   | ug/L |   |          | 06/13/13 14:21 | 1       |
| <b>Toluene</b>                     | <b>1.1</b> |           | 0.50 | ug/L |   |          | 06/13/13 14:21 | 1       |
| <b>Xylenes, Total</b>              | <b>1.6</b> |           | 1.0  | ug/L |   |          | 06/13/13 14:21 | 1       |

| Surrogate                   | %Recovery | Qualifier | Limits   | Prepared | Analyzed       | Dil Fac |
|-----------------------------|-----------|-----------|----------|----------|----------------|---------|
| 4-Bromofluorobenzene (Surr) | 109       |           | 80 - 120 |          | 06/13/13 14:21 | 1       |
| Dibromofluoromethane (Surr) | 105       |           | 80 - 120 |          | 06/13/13 14:21 | 1       |
| Toluene-d8 (Surr)           | 114       |           | 80 - 120 |          | 06/13/13 14:21 | 1       |

**Method: 8015B/5030B - Gasoline Range Organics (GC)**

| Analyte             | Result     | Qualifier | RL | Unit | D | Prepared | Analyzed       | Dil Fac |
|---------------------|------------|-----------|----|------|---|----------|----------------|---------|
| <b>GRO (C6-C12)</b> | <b>260</b> |           | 50 | ug/L |   |          | 06/10/13 21:28 | 1       |

| Surrogate                   | %Recovery | Qualifier | Limits   | Prepared | Analyzed       | Dil Fac |
|-----------------------------|-----------|-----------|----------|----------|----------------|---------|
| 4-Bromofluorobenzene (Surr) | 97        |           | 65 - 140 |          | 06/10/13 21:28 | 1       |

# Client Sample Results

Client: Broadbent & Associates, Inc.  
 Project/Site: ARCO 2035, Albany

TestAmerica Job ID: 440-48384-1

**Client Sample ID: MW-9**

**Lab Sample ID: 440-48384-6**

**Date Collected: 06/04/13 08:35**

**Matrix: Water**

**Date Received: 06/05/13 09:30**

**Method: 8260B/5030B - Volatile Organic Compounds (GC/MS)**

| Analyte                            | Result     | Qualifier | RL   | Unit | D | Prepared | Analyzed       | Dil Fac |
|------------------------------------|------------|-----------|------|------|---|----------|----------------|---------|
| 1,2-Dibromoethane (EDB)            | ND         |           | 0.50 | ug/L |   |          | 06/13/13 14:51 | 1       |
| 1,2-Dichloroethane                 | ND         |           | 0.50 | ug/L |   |          | 06/13/13 14:51 | 1       |
| Benzene                            | ND         |           | 0.50 | ug/L |   |          | 06/13/13 14:51 | 1       |
| Ethanol                            | ND         |           | 150  | ug/L |   |          | 06/13/13 14:51 | 1       |
| Ethylbenzene                       | ND         |           | 0.50 | ug/L |   |          | 06/13/13 14:51 | 1       |
| Ethyl-t-butyl ether (ETBE)         | ND         |           | 0.50 | ug/L |   |          | 06/13/13 14:51 | 1       |
| Isopropyl Ether (DIPE)             | ND         |           | 0.50 | ug/L |   |          | 06/13/13 14:51 | 1       |
| m,p-Xylene                         | ND         |           | 1.0  | ug/L |   |          | 06/13/13 14:51 | 1       |
| <b>Methyl-t-Butyl Ether (MTBE)</b> | <b>3.5</b> |           | 0.50 | ug/L |   |          | 06/13/13 14:51 | 1       |
| o-Xylene                           | ND         |           | 0.50 | ug/L |   |          | 06/13/13 14:51 | 1       |
| Tert-amyl-methyl ether (TAME)      | ND         |           | 0.50 | ug/L |   |          | 06/13/13 14:51 | 1       |
| tert-Butyl alcohol (TBA)           | ND         |           | 10   | ug/L |   |          | 06/13/13 14:51 | 1       |
| Toluene                            | ND         |           | 0.50 | ug/L |   |          | 06/13/13 14:51 | 1       |
| Xylenes, Total                     | ND         |           | 1.0  | ug/L |   |          | 06/13/13 14:51 | 1       |

| Surrogate                   | %Recovery | Qualifier | Limits   | Prepared | Analyzed       | Dil Fac |
|-----------------------------|-----------|-----------|----------|----------|----------------|---------|
| 4-Bromofluorobenzene (Surr) | 107       |           | 80 - 120 |          | 06/13/13 14:51 | 1       |
| Dibromofluoromethane (Surr) | 99        |           | 80 - 120 |          | 06/13/13 14:51 | 1       |
| Toluene-d8 (Surr)           | 111       |           | 80 - 120 |          | 06/13/13 14:51 | 1       |

**Method: 8015B/5030B - Gasoline Range Organics (GC)**

| Analyte      | Result | Qualifier | RL | Unit | D | Prepared | Analyzed       | Dil Fac |
|--------------|--------|-----------|----|------|---|----------|----------------|---------|
| GRO (C6-C12) | ND     |           | 50 | ug/L |   |          | 06/10/13 21:56 | 1       |

| Surrogate                   | %Recovery | Qualifier | Limits   | Prepared | Analyzed       | Dil Fac |
|-----------------------------|-----------|-----------|----------|----------|----------------|---------|
| 4-Bromofluorobenzene (Surr) | 105       |           | 65 - 140 |          | 06/10/13 21:56 | 1       |



# Method Summary

Client: Broadbent & Associates, Inc.  
Project/Site: ARCO 2035, Albany

TestAmerica Job ID: 440-48384-1

| Method      | Method Description                 | Protocol | Laboratory |
|-------------|------------------------------------|----------|------------|
| 8260B/5030B | Volatile Organic Compounds (GC/MS) | SW846    | TAL IRV    |
| 8015B/5030B | Gasoline Range Organics (GC)       | SW846    | TAL IRV    |

**Protocol References:**

SW846 = "Test Methods For Evaluating Solid Waste, Physical/Chemical Methods", Third Edition, November 1986 And Its Updates.

**Laboratory References:**

TAL IRV = TestAmerica Irvine, 17461 Derian Ave, Suite 100, Irvine, CA 92614-5817, TEL (949)261-1022



# Lab Chronicle

Client: Broadbent & Associates, Inc.  
Project/Site: ARCO 2035, Albany

TestAmerica Job ID: 440-48384-1

## Client Sample ID: MW-4

Date Collected: 06/04/13 10:12

Date Received: 06/05/13 09:30

## Lab Sample ID: 440-48384-1

Matrix: Water

| Prep Type | Batch Type | Batch Method | Run | Dil Factor | Initial Amount | Final Amount | Batch Number | Prepared or Analyzed | Analyst | Lab     |
|-----------|------------|--------------|-----|------------|----------------|--------------|--------------|----------------------|---------|---------|
| Total/NA  | Analysis   | 8260B/5030B  |     | 1          | 10 mL          | 10 mL        | 111069       | 06/13/13 11:22       | SS      | TAL IRV |
| Total/NA  | Analysis   | 8015B/5030B  |     | 1          | 10 mL          | 10 mL        | 110236       | 06/10/13 19:38       | IM      | TAL IRV |

## Client Sample ID: RW-1

Date Collected: 06/04/13 11:00

Date Received: 06/05/13 09:30

## Lab Sample ID: 440-48384-2

Matrix: Water

| Prep Type | Batch Type | Batch Method | Run | Dil Factor | Initial Amount | Final Amount | Batch Number | Prepared or Analyzed | Analyst | Lab     |
|-----------|------------|--------------|-----|------------|----------------|--------------|--------------|----------------------|---------|---------|
| Total/NA  | Analysis   | 8260B/5030B  |     | 1          | 10 mL          | 10 mL        | 111069       | 06/13/13 12:52       | SS      | TAL IRV |
| Total/NA  | Analysis   | 8015B/5030B  |     | 1          | 10 mL          | 10 mL        | 110236       | 06/10/13 20:05       | IM      | TAL IRV |

## Client Sample ID: S-5

Date Collected: 06/04/13 09:40

Date Received: 06/05/13 09:30

## Lab Sample ID: 440-48384-3

Matrix: Water

| Prep Type | Batch Type | Batch Method | Run | Dil Factor | Initial Amount | Final Amount | Batch Number | Prepared or Analyzed | Analyst | Lab     |
|-----------|------------|--------------|-----|------------|----------------|--------------|--------------|----------------------|---------|---------|
| Total/NA  | Analysis   | 8260B/5030B  |     | 1          | 10 mL          | 10 mL        | 111069       | 06/13/13 13:22       | SS      | TAL IRV |
| Total/NA  | Analysis   | 8015B/5030B  |     | 1          | 10 mL          | 10 mL        | 110236       | 06/10/13 20:33       | IM      | TAL IRV |

## Client Sample ID: MW-7

Date Collected: 06/04/13 12:20

Date Received: 06/05/13 09:30

## Lab Sample ID: 440-48384-4

Matrix: Water

| Prep Type | Batch Type | Batch Method | Run | Dil Factor | Initial Amount | Final Amount | Batch Number | Prepared or Analyzed | Analyst | Lab     |
|-----------|------------|--------------|-----|------------|----------------|--------------|--------------|----------------------|---------|---------|
| Total/NA  | Analysis   | 8260B/5030B  |     | 1          | 10 mL          | 10 mL        | 111069       | 06/13/13 13:51       | SS      | TAL IRV |
| Total/NA  | Analysis   | 8015B/5030B  |     | 1          | 10 mL          | 10 mL        | 110236       | 06/10/13 21:01       | IM      | TAL IRV |

## Client Sample ID: MW-8

Date Collected: 06/04/13 10:35

Date Received: 06/05/13 09:30

## Lab Sample ID: 440-48384-5

Matrix: Water

| Prep Type | Batch Type | Batch Method | Run | Dil Factor | Initial Amount | Final Amount | Batch Number | Prepared or Analyzed | Analyst | Lab     |
|-----------|------------|--------------|-----|------------|----------------|--------------|--------------|----------------------|---------|---------|
| Total/NA  | Analysis   | 8260B/5030B  |     | 1          | 10 mL          | 10 mL        | 111069       | 06/13/13 14:21       | SS      | TAL IRV |
| Total/NA  | Analysis   | 8015B/5030B  |     | 1          | 10 mL          | 10 mL        | 110236       | 06/10/13 21:28       | IM      | TAL IRV |

## Client Sample ID: MW-9

Date Collected: 06/04/13 08:35

Date Received: 06/05/13 09:30

## Lab Sample ID: 440-48384-6

Matrix: Water

| Prep Type | Batch Type | Batch Method | Run | Dil Factor | Initial Amount | Final Amount | Batch Number | Prepared or Analyzed | Analyst | Lab     |
|-----------|------------|--------------|-----|------------|----------------|--------------|--------------|----------------------|---------|---------|
| Total/NA  | Analysis   | 8260B/5030B  |     | 1          | 10 mL          | 10 mL        | 111069       | 06/13/13 14:51       | SS      | TAL IRV |

TestAmerica Irvine

# Lab Chronicle

Client: Broadbent & Associates, Inc.  
Project/Site: ARCO 2035, Albany

TestAmerica Job ID: 440-48384-1

**Client Sample ID: MW-9**

**Lab Sample ID: 440-48384-6**

**Date Collected: 06/04/13 08:35**

**Matrix: Water**

**Date Received: 06/05/13 09:30**

| Prep Type | Batch Type | Batch Method | Run | Dil Factor | Initial Amount | Final Amount | Batch Number | Prepared or Analyzed | Analyst | Lab     |
|-----------|------------|--------------|-----|------------|----------------|--------------|--------------|----------------------|---------|---------|
| Total/NA  | Analysis   | 8015B/5030B  |     | 1          | 10 mL          | 10 mL        | 110236       | 06/10/13 21:56       | IM      | TAL IRV |

**Laboratory References:**

TAL IRV = TestAmerica Irvine, 17461 Derian Ave, Suite 100, Irvine, CA 92614-5817, TEL (949)261-1022

- 1
- 2
- 3
- 4
- 5
- 6
- 7
- 8
- 9
- 10
- 11
- 12
- 13

# QC Sample Results

Client: Broadbent & Associates, Inc.  
Project/Site: ARCO 2035, Albany

TestAmerica Job ID: 440-48384-1

## Method: 8260B/5030B - Volatile Organic Compounds (GC/MS)

Lab Sample ID: MB 440-111069/4

Matrix: Water

Analysis Batch: 111069

Client Sample ID: Method Blank

Prep Type: Total/NA

| Analyte                       | MB Result | MB Qualifier | RL   | Unit | D | Prepared | Analyzed       | Dil Fac |
|-------------------------------|-----------|--------------|------|------|---|----------|----------------|---------|
| 1,2-Dibromoethane (EDB)       | ND        |              | 0.50 | ug/L |   |          | 06/13/13 09:53 | 1       |
| 1,2-Dichloroethane            | ND        |              | 0.50 | ug/L |   |          | 06/13/13 09:53 | 1       |
| Benzene                       | ND        |              | 0.50 | ug/L |   |          | 06/13/13 09:53 | 1       |
| Ethanol                       | ND        |              | 150  | ug/L |   |          | 06/13/13 09:53 | 1       |
| Ethylbenzene                  | ND        |              | 0.50 | ug/L |   |          | 06/13/13 09:53 | 1       |
| Ethyl-t-butyl ether (ETBE)    | ND        |              | 0.50 | ug/L |   |          | 06/13/13 09:53 | 1       |
| Isopropyl Ether (DIPE)        | ND        |              | 0.50 | ug/L |   |          | 06/13/13 09:53 | 1       |
| m,p-Xylene                    | ND        |              | 1.0  | ug/L |   |          | 06/13/13 09:53 | 1       |
| Methyl-t-Butyl Ether (MTBE)   | ND        |              | 0.50 | ug/L |   |          | 06/13/13 09:53 | 1       |
| o-Xylene                      | ND        |              | 0.50 | ug/L |   |          | 06/13/13 09:53 | 1       |
| Tert-amyl-methyl ether (TAME) | ND        |              | 0.50 | ug/L |   |          | 06/13/13 09:53 | 1       |
| tert-Butyl alcohol (TBA)      | ND        |              | 10   | ug/L |   |          | 06/13/13 09:53 | 1       |
| Toluene                       | ND        |              | 0.50 | ug/L |   |          | 06/13/13 09:53 | 1       |
| Xylenes, Total                | ND        |              | 1.0  | ug/L |   |          | 06/13/13 09:53 | 1       |

| Surrogate                   | MB %Recovery | MB Qualifier | Limits   | Prepared | Analyzed       | Dil Fac |
|-----------------------------|--------------|--------------|----------|----------|----------------|---------|
| 4-Bromofluorobenzene (Surr) | 109          |              | 80 - 120 |          | 06/13/13 09:53 | 1       |
| Dibromofluoromethane (Surr) | 100          |              | 80 - 120 |          | 06/13/13 09:53 | 1       |
| Toluene-d8 (Surr)           | 113          |              | 80 - 120 |          | 06/13/13 09:53 | 1       |

Lab Sample ID: LCS 440-111069/5

Matrix: Water

Analysis Batch: 111069

Client Sample ID: Lab Control Sample

Prep Type: Total/NA

| Analyte                       | Spike Added | LCS Result | LCS Qualifier | Unit | D | %Rec | %Rec. Limits |
|-------------------------------|-------------|------------|---------------|------|---|------|--------------|
| 1,2-Dibromoethane (EDB)       | 25.0        | 25.5       |               | ug/L |   | 102  | 75 - 125     |
| 1,2-Dichloroethane            | 25.0        | 25.1       |               | ug/L |   | 100  | 60 - 140     |
| Benzene                       | 25.0        | 25.0       |               | ug/L |   | 100  | 70 - 120     |
| Ethanol                       | 250         | 278        |               | ug/L |   | 111  | 40 - 155     |
| Ethylbenzene                  | 25.0        | 25.3       |               | ug/L |   | 101  | 75 - 125     |
| Ethyl-t-butyl ether (ETBE)    | 25.0        | 26.9       |               | ug/L |   | 108  | 65 - 135     |
| Isopropyl Ether (DIPE)        | 25.0        | 27.3       |               | ug/L |   | 109  | 60 - 135     |
| m,p-Xylene                    | 50.0        | 53.8       |               | ug/L |   | 108  | 75 - 125     |
| Methyl-t-Butyl Ether (MTBE)   | 25.0        | 26.5       |               | ug/L |   | 106  | 60 - 135     |
| o-Xylene                      | 25.0        | 25.7       |               | ug/L |   | 103  | 75 - 125     |
| Tert-amyl-methyl ether (TAME) | 25.0        | 28.1       |               | ug/L |   | 112  | 60 - 135     |
| tert-Butyl alcohol (TBA)      | 125         | 134        |               | ug/L |   | 107  | 70 - 135     |
| Toluene                       | 25.0        | 26.2       |               | ug/L |   | 105  | 70 - 120     |

| Surrogate                   | LCS %Recovery | LCS Qualifier | Limits   |
|-----------------------------|---------------|---------------|----------|
| 4-Bromofluorobenzene (Surr) | 107           |               | 80 - 120 |
| Dibromofluoromethane (Surr) | 102           |               | 80 - 120 |
| Toluene-d8 (Surr)           | 113           |               | 80 - 120 |

TestAmerica Irvine

# QC Sample Results

Client: Broadbent & Associates, Inc.  
Project/Site: ARCO 2035, Albany

TestAmerica Job ID: 440-48384-1

## Method: 8260B/5030B - Volatile Organic Compounds (GC/MS) (Continued)

Lab Sample ID: 440-48384-1 MS

Matrix: Water

Analysis Batch: 111069

Client Sample ID: MW-4

Prep Type: Total/NA

| Analyte                       | Sample Result | Sample Qualifier | Spike Added | MS Result | MS Qualifier | Unit | D | %Rec | %Rec. Limits |
|-------------------------------|---------------|------------------|-------------|-----------|--------------|------|---|------|--------------|
| 1,2-Dibromoethane (EDB)       | ND            |                  | 25.0        | 26.6      |              | ug/L |   | 107  | 70 - 130     |
| 1,2-Dichloroethane            | ND            |                  | 25.0        | 26.2      |              | ug/L |   | 105  | 60 - 140     |
| Benzene                       | ND            |                  | 25.0        | 25.4      |              | ug/L |   | 102  | 65 - 125     |
| Ethanol                       | ND            |                  | 250         | 250       |              | ug/L |   | 100  | 40 - 155     |
| Ethylbenzene                  | ND            |                  | 25.0        | 24.9      |              | ug/L |   | 100  | 65 - 130     |
| Ethyl-t-butyl ether (ETBE)    | ND            |                  | 25.0        | 27.5      |              | ug/L |   | 110  | 60 - 135     |
| Isopropyl Ether (DIPE)        | ND            |                  | 25.0        | 27.8      |              | ug/L |   | 111  | 60 - 140     |
| m,p-Xylene                    | ND            |                  | 50.0        | 50.9      |              | ug/L |   | 102  | 65 - 130     |
| Methyl-t-Butyl Ether (MTBE)   | 0.54          |                  | 25.0        | 29.2      |              | ug/L |   | 115  | 55 - 145     |
| o-Xylene                      | ND            |                  | 25.0        | 24.8      |              | ug/L |   | 99   | 65 - 125     |
| Tert-amyl-methyl ether (TAME) | ND            |                  | 25.0        | 29.2      |              | ug/L |   | 117  | 60 - 140     |
| tert-Butyl alcohol (TBA)      | ND            |                  | 125         | 122       |              | ug/L |   | 98   | 65 - 140     |
| Toluene                       | ND            |                  | 25.0        | 26.8      |              | ug/L |   | 107  | 70 - 125     |

| Surrogate                   | MS %Recovery | MS Qualifier | Limits   |
|-----------------------------|--------------|--------------|----------|
| 4-Bromofluorobenzene (Surr) | 108          |              | 80 - 120 |
| Dibromofluoromethane (Surr) | 104          |              | 80 - 120 |
| Toluene-d8 (Surr)           | 114          |              | 80 - 120 |

Lab Sample ID: 440-48384-1 MSD

Matrix: Water

Analysis Batch: 111069

Client Sample ID: MW-4

Prep Type: Total/NA

| Analyte                       | Sample Result | Sample Qualifier | Spike Added | MSD Result | MSD Qualifier | Unit | D | %Rec | %Rec. Limits | RPD | RPD Limit |
|-------------------------------|---------------|------------------|-------------|------------|---------------|------|---|------|--------------|-----|-----------|
| 1,2-Dibromoethane (EDB)       | ND            |                  | 25.0        | 27.3       |               | ug/L |   | 109  | 70 - 130     | 2   | 25        |
| 1,2-Dichloroethane            | ND            |                  | 25.0        | 25.8       |               | ug/L |   | 103  | 60 - 140     | 1   | 20        |
| Benzene                       | ND            |                  | 25.0        | 25.3       |               | ug/L |   | 101  | 65 - 125     | 0   | 20        |
| Ethanol                       | ND            |                  | 250         | 266        |               | ug/L |   | 107  | 40 - 155     | 6   | 30        |
| Ethylbenzene                  | ND            |                  | 25.0        | 25.8       |               | ug/L |   | 103  | 65 - 130     | 3   | 20        |
| Ethyl-t-butyl ether (ETBE)    | ND            |                  | 25.0        | 27.8       |               | ug/L |   | 111  | 60 - 135     | 1   | 25        |
| Isopropyl Ether (DIPE)        | ND            |                  | 25.0        | 28.0       |               | ug/L |   | 112  | 60 - 140     | 0   | 25        |
| m,p-Xylene                    | ND            |                  | 50.0        | 52.4       |               | ug/L |   | 105  | 65 - 130     | 3   | 25        |
| Methyl-t-Butyl Ether (MTBE)   | 0.54          |                  | 25.0        | 29.1       |               | ug/L |   | 114  | 55 - 145     | 0   | 25        |
| o-Xylene                      | ND            |                  | 25.0        | 25.8       |               | ug/L |   | 103  | 65 - 125     | 4   | 20        |
| Tert-amyl-methyl ether (TAME) | ND            |                  | 25.0        | 29.3       |               | ug/L |   | 117  | 60 - 140     | 0   | 30        |
| tert-Butyl alcohol (TBA)      | ND            |                  | 125         | 128        |               | ug/L |   | 103  | 65 - 140     | 5   | 25        |
| Toluene                       | ND            |                  | 25.0        | 26.7       |               | ug/L |   | 107  | 70 - 125     | 0   | 20        |

| Surrogate                   | MSD %Recovery | MSD Qualifier | Limits   |
|-----------------------------|---------------|---------------|----------|
| 4-Bromofluorobenzene (Surr) | 106           |               | 80 - 120 |
| Dibromofluoromethane (Surr) | 101           |               | 80 - 120 |
| Toluene-d8 (Surr)           | 111           |               | 80 - 120 |

TestAmerica Irvine

# QC Sample Results

Client: Broadbent & Associates, Inc.  
Project/Site: ARCO 2035, Albany

TestAmerica Job ID: 440-48384-1

## Method: 8015B/5030B - Gasoline Range Organics (GC)

Lab Sample ID: MB 440-110236/3

Matrix: Water

Analysis Batch: 110236

Client Sample ID: Method Blank

Prep Type: Total/NA

| Analyte                     | MB Result    | MB Qualifier | RL       | Unit | D | Prepared | Analyzed       | Dil Fac |
|-----------------------------|--------------|--------------|----------|------|---|----------|----------------|---------|
| GRO (C6-C12)                | ND           |              | 50       | ug/L |   |          | 06/10/13 12:57 | 1       |
| Surrogate                   | MB %Recovery | MB Qualifier | Limits   |      |   | Prepared | Analyzed       | Dil Fac |
| 4-Bromofluorobenzene (Surr) | 93           |              | 65 - 140 |      |   |          | 06/10/13 12:57 | 1       |

Lab Sample ID: LCS 440-110236/2

Matrix: Water

Analysis Batch: 110236

Client Sample ID: Lab Control Sample

Prep Type: Total/NA

| Analyte                     | Spike Added   | LCS Result    | LCS Qualifier | Unit | D | %Rec | %Rec. Limits |
|-----------------------------|---------------|---------------|---------------|------|---|------|--------------|
| GRO (C4-C12)                | 800           | 703           |               | ug/L |   | 88   | 80 - 120     |
| Surrogate                   | LCS %Recovery | LCS Qualifier | Limits        |      |   |      |              |
| 4-Bromofluorobenzene (Surr) | 106           |               | 65 - 140      |      |   |      |              |

Lab Sample ID: 440-48395-A-2 MS

Matrix: Water

Analysis Batch: 110236

Client Sample ID: Matrix Spike

Prep Type: Total/NA

| Analyte                     | Sample Result | Sample Qualifier | Spike Added | MS Result | MS Qualifier | Unit | D | %Rec | %Rec. Limits |
|-----------------------------|---------------|------------------|-------------|-----------|--------------|------|---|------|--------------|
| GRO (C4-C12)                | 340           |                  | 800         | 985       |              | ug/L |   | 81   | 65 - 140     |
| Surrogate                   | MS %Recovery  | MS Qualifier     | Limits      |           |              |      |   |      |              |
| 4-Bromofluorobenzene (Surr) | 87            |                  | 65 - 140    |           |              |      |   |      |              |

Lab Sample ID: 440-48395-A-2 MSD

Matrix: Water

Analysis Batch: 110236

Client Sample ID: Matrix Spike Duplicate

Prep Type: Total/NA

| Analyte                     | Sample Result | Sample Qualifier | Spike Added | MSD Result | MSD Qualifier | Unit | D | %Rec | %Rec. Limits | RPD | RPD Limit |
|-----------------------------|---------------|------------------|-------------|------------|---------------|------|---|------|--------------|-----|-----------|
| GRO (C4-C12)                | 340           |                  | 800         | 955        |               | ug/L |   | 77   | 65 - 140     | 3   | 20        |
| Surrogate                   | MSD %Recovery | MSD Qualifier    | Limits      |            |               |      |   |      |              |     |           |
| 4-Bromofluorobenzene (Surr) | 81            |                  | 65 - 140    |            |               |      |   |      |              |     |           |

TestAmerica Irvine

# QC Association Summary

Client: Broadbent & Associates, Inc.  
Project/Site: ARCO 2035, Albany

TestAmerica Job ID: 440-48384-1

## GC/MS VOA

### Analysis Batch: 111069

| Lab Sample ID    | Client Sample ID   | Prep Type | Matrix | Method      | Prep Batch |
|------------------|--------------------|-----------|--------|-------------|------------|
| 440-48384-1      | MW-4               | Total/NA  | Water  | 8260B/5030B |            |
| 440-48384-1 MS   | MW-4               | Total/NA  | Water  | 8260B/5030B |            |
| 440-48384-1 MSD  | MW-4               | Total/NA  | Water  | 8260B/5030B |            |
| 440-48384-2      | RW-1               | Total/NA  | Water  | 8260B/5030B |            |
| 440-48384-3      | S-5                | Total/NA  | Water  | 8260B/5030B |            |
| 440-48384-4      | MW-7               | Total/NA  | Water  | 8260B/5030B |            |
| 440-48384-5      | MW-8               | Total/NA  | Water  | 8260B/5030B |            |
| 440-48384-6      | MW-9               | Total/NA  | Water  | 8260B/5030B |            |
| LCS 440-111069/5 | Lab Control Sample | Total/NA  | Water  | 8260B/5030B |            |
| MB 440-111069/4  | Method Blank       | Total/NA  | Water  | 8260B/5030B |            |

## GC VOA

### Analysis Batch: 110236

| Lab Sample ID     | Client Sample ID       | Prep Type | Matrix | Method      | Prep Batch |
|-------------------|------------------------|-----------|--------|-------------|------------|
| 440-48384-1       | MW-4                   | Total/NA  | Water  | 8015B/5030B |            |
| 440-48384-2       | RW-1                   | Total/NA  | Water  | 8015B/5030B |            |
| 440-48384-3       | S-5                    | Total/NA  | Water  | 8015B/5030B |            |
| 440-48384-4       | MW-7                   | Total/NA  | Water  | 8015B/5030B |            |
| 440-48384-5       | MW-8                   | Total/NA  | Water  | 8015B/5030B |            |
| 440-48384-6       | MW-9                   | Total/NA  | Water  | 8015B/5030B |            |
| 440-48395-A-2 MS  | Matrix Spike           | Total/NA  | Water  | 8015B/5030B |            |
| 440-48395-A-2 MSD | Matrix Spike Duplicate | Total/NA  | Water  | 8015B/5030B |            |
| LCS 440-110236/2  | Lab Control Sample     | Total/NA  | Water  | 8015B/5030B |            |
| MB 440-110236/3   | Method Blank           | Total/NA  | Water  | 8015B/5030B |            |

## Definitions/Glossary

Client: Broadbent & Associates, Inc.  
Project/Site: ARCO 2035, Albany

TestAmerica Job ID: 440-48384-1

### Glossary

| Abbreviation   | These commonly used abbreviations may or may not be present in this report.                                 |
|----------------|---|
| ▫              | Listed under the "D" column to designate that the result is reported on a dry weight basis                  |
| %R             | Percent Recovery  |
| CNF            | Contains no Free Liquid   |
| DER            | Duplicate error ratio (normalized absolute difference)  |
| DL, RA, RE, IN | Indicates a Dilution, Re-analysis, Re-extraction, or additional Initial metals/anion analysis of the sample |
| DLC            | Decision level concentration  |
| MDA            | Minimum detectable activity   |
| EDL            | Estimated Detection Limit   |
| MDC            | Minimum detectable concentration  |
| MDL            | Method Detection Limit  |
| ML             | Minimum Level (Dioxin)  |
| NC             | Not Calculated  |
| ND             | Not detected at the reporting limit (or MDL or EDL if shown)  |
| PQL            | Practical Quantitation Limit  |
| QC             | Quality Control   |
| RER            | Relative error ratio  |
| RL             | Reporting Limit or Requested Limit (Radiochemistry)   |
| RPD            | Relative Percent Difference, a measure of the relative difference between two points                        |
| TEF            | Toxicity Equivalent Factor (Dioxin)   |
| TEQ            | Toxicity Equivalent Quotient (Dioxin)   |



# Certification Summary

Client: Broadbent & Associates, Inc.  
 Project/Site: ARCO 2035, Albany

TestAmerica Job ID: 440-48384-1

## Laboratory: TestAmerica Irvine

All certifications held by this laboratory are listed. Not all certifications are applicable to this report.

| Authority                | Program                     | EPA Region | Certification ID  | Expiration Date |
|--------------------------|-----------------------------|------------|-------------------|-----------------|
| Alaska                   | State Program               | 10         | CA01531           | 06-30-13        |
| Arizona                  | State Program               | 9          | AZ0671            | 10-13-13        |
| California               | LA Cty Sanitation Districts | 9          | 10256             | 01-31-14        |
| California               | NELAP                       | 9          | 1108CA            | 01-31-14        |
| California               | State Program               | 9          | 2706              | 06-30-14        |
| Guam                     | State Program               | 9          | Cert. No. 12.002r | 01-28-14 *      |
| Hawaii                   | State Program               | 9          | N/A               | 01-31-14        |
| Nevada                   | State Program               | 9          | CA015312007A      | 07-31-13        |
| New Mexico               | State Program               | 6          | N/A               | 01-31-14        |
| Northern Mariana Islands | State Program               | 9          | MP0002            | 01-31-14        |
| Oregon                   | NELAP                       | 10         | 4005              | 09-12-13        |
| USDA                     | Federal                     |            | P330-09-00080     | 06-06-14        |
| USEPA UCMR               | Federal                     | 1          | CA01531           | 01-31-15        |

\* Expired certification is currently pending renewal and is considered valid.



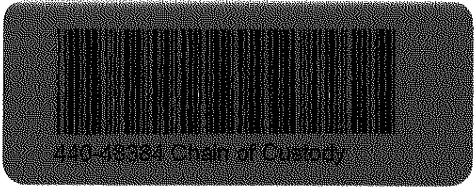

Laboratory Management Program LaMP Chain of Custody Record

Page \_\_\_\_ of \_\_\_\_

BP Site Node Path: 06-88-610

Req Due Date (mm/dd/yy):

Rush TAT: Yes \_\_\_ No \_\_\_

BP Facility No: 2035

Lab Work Order Number: 440-48384

Lab Name: Test America, Facility Address: 1001 San Pablo Ave, Consultant/Contractor: Broadbent and Associates, Inc. Lab Address: 17461 Derian Suite #100, Irvine, CA 92641, City, State, ZIP Code: Albany, CA 95926, Consultant/Contractor Project No: 06-88-610, Lab PM: Kathleen Robb, Lead Regulatory Agency: ACEH, Address: 875 Cotting Lane, Suite G, Vacaville, CA 95688, Lab Phone: 949-261-1022, California Global ID No.: T0600100081, Consultant/Contractor PM: Kristene Tidwell, Lab Shipping Acct: 1103-6633-7, Enfos Proposal No: 005TK-0004 / WR245699, Phone: 707-455-7290, Fax: 707-455-7295, Lab Bottle Order No: Accounting Mode: Provision [X] OOC-BU OOC-UM, Email EDD To: ktidwell@broadbentinc.com and to lab.enfosdoc@bp.com, Other Info: Stage: Execute (40) Activity: Project Spend (80) Invoice To: BP [X] Contractor

Table with columns: Lab No., Sample Description, Date, Time, Matrix, No. Containers / Preservative, Requested Analyses, Report Type & QC Level, Comments. Includes rows for MW-4, RW-1, S-5, MW-7, MW-8, MW-9, and TB-2035-06042013.

Sampler's Name: Alex Martinez & James Ramos, Relinquished By / Affiliation, Date, Time, Accepted By / Affiliation, Date, Time. Includes handwritten signatures and dates.

Special Instructions: THIS LINE - LAB USE ONLY: Custody Seals In Place: [X] No, Temp Blank: Yes / No, Cooler Temp on Receipt: 2.5/2.2 F/C, Trip Blank: Yes / No, MS/MSD Sample Submitted: Yes / No

Page 20 of 24 8/2013



## Login Sample Receipt Checklist

Client: Broadbent & Associates, Inc.

Job Number: 440-48384-1

**Login Number: 48384**

**List Source: TestAmerica Irvine**

**List Number: 1**

**Creator: Escalante, Maria**

| Question   | Answer | Comment                     |
|--|--------|-----------------------------|
| Radioactivity wasn't checked or is <=/ background as measured by a survey meter. | N/A    |                             |
| The cooler's custody seal, if present, is intact.                                | N/A    |                             |
| Sample custody seals, if present, are intact.                                    | N/A    |                             |
| The cooler or samples do not appear to have been compromised or tampered with.   | True   |                             |
| Samples were received on ice.  | True   |                             |
| Cooler Temperature is acceptable.  | True   |                             |
| Cooler Temperature is recorded.  | True   |                             |
| COC is present.  | True   |                             |
| COC is filled out in ink and legible.  | True   |                             |
| COC is filled out with all pertinent information.                                | True   |                             |
| Is the Field Sampler's name present on COC?                                      | True   | ALEX MARTINEZ & JAMES RAMOS |
| There are no discrepancies between the containers received and the COC.          | True   |                             |
| Samples are received within Holding Time.  | True   |                             |
| Sample containers have legible labels.   | True   |                             |
| Containers are not broken or leaking.  | True   |                             |
| Sample collection date/times are provided.                                       | True   |                             |
| Appropriate sample containers are used.  | True   |                             |
| Sample bottles are completely filled.  | True   |                             |
| Sample Preservation Verified.  | N/A    |                             |
| There is sufficient vol. for all requested analyses, incl. any requested MS/MSDs | True   |                             |
| Containers requiring zero headspace have no headspace or bubble is <6mm (1/4").  | True   |                             |
| Multiphasic samples are not present.   | True   |                             |
| Samples do not require splitting or compositing.                                 | True   |                             |
| Residual Chlorine Checked.   | N/A    |                             |



**APPENDIX D**

**GEOTRACKER UPLOAD CONFIRMATION RECEIPTS**

STATE WATER RESOURCES CONTROL BOARD  
**GEOTRACKER ESI**

## UPLOADING A EDF FILE

**SUCCESS**

**Processing is complete. No errors were found!  
Your file has been successfully submitted!**

|                                    |   |
|------------------------------------|---|
| <b><u>Submittal Type:</u></b>      | <b>EDF</b>                                |
| <b><u>Report Title:</u></b>        | <b>2Q13 GW Monitoring</b>                 |
| <b><u>Report Type:</u></b>         | <b>Monitoring Report - Semi-Annually</b>  |
| <b><u>Facility Global ID:</u></b>  | <b>T0600100081</b>                        |
| <b><u>Facility Name:</u></b>       | <b>ARCO #02035</b>                        |
| <b><u>File Name:</u></b>           | <b>440-48384-1_18 Jun 13 1337_EDF.zip</b> |
| <b><u>Organization Name:</u></b>   | <b>Broadbent &amp; Associates, Inc.</b>   |
| <b><u>Username:</u></b>            | <b>BROADBENT-C</b>                        |
| <b><u>IP Address:</u></b>          | <b>216.241.56.58</b>                      |
| <b><u>Submittal Date/Time:</u></b> | <b>7/11/2013 4:25:25 PM</b>               |
| <b><u>Confirmation Number:</u></b> | <b>2977448940</b>                         |

[VIEW QC REPORT](#)

[VIEW DETECTIONS REPORT](#)

Copyright © 2013 State of California