

Atlantic Richfield Company

Chuck Carmel
Environmental Business Manager

PO Box 1257
San Ramon, CA 94583
Phone: (925) 275-3803
Fax: (925) 275-3815
E-Mail: charles.carmel@bp.com

RECEIVED

4:37 pm, Feb 02, 2011

Alameda County
Environmental Health

31 January 2011

Re: Fourth Quarter 2010 Semi-Annual Groundwater Monitoring Report
Atlantic Richfield Company Station #2035
1001 San Pablo Avenue, Albany, California
ACEH Case #RO0000100

"I declare, that to the best of my knowledge at the present time, that the information and/or recommendations contained in the attached document are true and correct.

Submitted by,



Chuck Carmel
Environmental Business Manager

Attachment

**Fourth Quarter 2010 Semi-Annual
Groundwater Monitoring Report**
Atlantic Richfield Company Station #2035
1001 San Pablo Ave., Albany, California
ACEH Case #RO0000100

Prepared for

Mr. Chuck Carmel
Environmental Business Manager
Atlantic Richfield Company
P.O. Box 1257
San Ramon, California 94583

Prepared by



1324 Mangrove Avenue, Suite 212
Chico, California 95926
(530) 566-1400
www.broadbentinc.com

31 January 2011

Project No. 06-88-610

31 January 2011

Project No. 06-88-610

Atlantic Richfield Company
P.O. Box 1257
San Ramon, CA 94583
Submitted via ENFOS

Attn.: Mr. Chuck Carmel

Re: Fourth Quarter 2010 Semi-Annual Groundwater Monitoring Report, Atlantic Richfield Company Station #2035, 1001 San Pablo Avenue, Albany, Alameda County, California; ACEH Case #RO0000100

Dear Mr. Carmel:

Attached is the *Fourth Quarter 2010 Semi-Annual Groundwater Monitoring Report* for Atlantic Richfield Company (a BP affiliated company) Station #2035 located at 1001 San Pablo Avenue, Albany, Alameda County, California (Site). This report presents the results of groundwater monitoring conducted at the Site during the Fourth Quarter of 2010.

Should you have questions regarding the work performed or results obtained, please do not hesitate to contact me at (530) 566-1400.

Sincerely,
BROADBENT & ASSOCIATES, INC.



Thomas A. Venus, P.E.
Senior Engineer



Enclosures

cc: Mr. Paresh Khatri, Alameda County Environmental Health (Submitted via ACEH ftp site)
Mr. John Lestrangle, 17851 State Highway 128, Calistoga, California 94515
Electronic copy uploaded to GeoTracker

STATION # 2035 SEMI-ANNUAL GROUNDWATER MONITORING REPORT

Facility: #2035	Address: 1001 San Pablo Avenue, Albany, California
Environmental Business Manager:	Mr. Chuck Carmel
Consulting Co./Contact Persons:	Broadbent & Associates, Inc.(BAI)/Mr. Tom Venus, PE (530) 566-1400
Consultant Project No.:	06-88-610
Primary Agency/Regulatory ID No.:	Alameda County Environmental Health (ACEH) ACEH Case # RO0000100

WORK PERFORMED THIS QUARTER (Fourth Quarter 2010):

1. Prepared and submitted the *Third Quarter 2010 Status Report* (BAI, 10/05/2010).
2. Conducted semi-annual groundwater monitoring/sampling for Fourth Quarter 2010. Work performed on 30 November 2010 by BAI.
3. Executed service agreement with TEG-North to assist with Vapor Intrusion Assessment field work sampling of existing soil gas implants.

WORK PROPOSED FOR NEXT QUARTER (First Quarter 2011):

1. Prepared and submitted the *Fourth Quarter 2010 Semi-Annual Groundwater Monitoring Report* (contained herein).
2. Resample Site monitoring wells due to problems with preservation of Fourth Quarter 2010 samples.
3. Conduct vapor intrusion assessment sampling of installed soil gas monitoring implants and prepare resultant report.

SITE SUMMARY:

Current phase of project:	Groundwater Monitoring/Sampling, Vapor Intrusion Assessment
Frequency of groundwater monitoring:	Semi-Annually (2Q & 4Q): Wells MW-1 through MW-9, RW-1, S-5
Frequency of groundwater sampling:	Semi-Annually (2Q & 4Q): Wells MW-4, MW-7, MW-8, MW-9, RW-1, and S-5 Annually (4Q): Wells MW-5 and MW-6
Is free product (FP) present on-site:	No
Depth to groundwater (below TOC):	6.84 ft (MW-7) to 12.45 ft (MW-6)
General groundwater flow direction:	West-southwest
Approximate hydraulic gradient:	0.02 ft/ft

DISCUSSION:

Fourth Quarter 2010 groundwater monitoring and sampling was conducted at Station #2035 on 30 November 2010 by BAI. Water levels were gauged in eleven wells associated with the Site. No irregularities were noted during water-level gauging. Depth-to-water measurements ranged from 6.84 ft at MW-7 to 12.45 ft at MW-6. Resulting groundwater surface elevations ranged from 36.34 ft in up-gradient well MW-7 to 29.86 ft at down-gradient well MW-6. Co-monitored water level measurements from 30 November 2010 and resulting elevations from the nearby Shell-branded Service Station at 999 San Pablo Avenue were used to create the groundwater elevation contours. Potentiometric groundwater elevation contours are presented in Drawing 1. Water level elevations yielded a potentiometric groundwater flow direction and gradient to the west-southwest at approximately 0.02 ft/ft (see Table 2). Measured depths to groundwater and respective groundwater elevations are summarized in Table 1.

Groundwater monitoring field data sheets for Station #2035 are provided within Appendix A. Co-monitored data from the nearby Shell-branded Service Station at 999 San Pablo Avenue are provided in Appendix B.

Consistent with the current groundwater sampling schedule, groundwater samples were collected from wells MW-4 through MW-9, RW-1 and S-5. No irregularities were reported during sampling. Samples were submitted under chain-of-custody protocol to Calscience Environmental Laboratories, Inc. (Garden Grove, California), for analysis of Gasoline Range Organics (GRO, C6-C12) by the EPA Method 8015B; for Benzene, Toluene, Ethylbenzene, and Total Xylenes (BTEX) by EPA Method 8260B; and Tert-Amyl Methyl Ether (TAME), Tert-Butyl Alcohol (TBA), Di-Isopropyl Ether (DIPE), 1,2-Dibromomethane (EDB), 1,2-Dichloroethane (1,2-DCA), Ethanol, Ethyl Tert-Butyl Ether (ETBE), and Methyl Tert-Butyl Ether (MTBE) by EPA Method 8260B. Samples were received at the lab frozen, therefore were not analyzed by Calscience. Re-sampling was scheduled for 13 December 2010 but had to be postponed again, this time to 17 December 2010, due to a delay experienced during drilling field work at another site. On 16 December 2010, BAI received a safety stand-down order from BP due to an incident at different site. The safety stand-down prevented field work for the remainder of 2010. When the safety stand-down order is rescinded, BAI will resample Station #2035. Groundwater sampling field data sheets from 30 November 2010 are provided in Appendix A.

Recent laboratory analytical results are summarized in Table 1. The most recent GRO, Benzene, and MTBE concentrations are also presented in Drawing 1. A copy of the Laboratory Analytical Report, including chain-of-custody documentation is provided in Appendix A. The co-monitored elevation and analytical data for the nearby Shell-branded service station at 999 San Pablo Avenue are provided in Appendix B. Groundwater monitoring data (GEO_WELL) and laboratory analytical results (EDF) were uploaded to the GeoTracker AB2886 database. Upload confirmation receipts are provided in Appendix D.

CONCLUSIONS AND RECOMMENDATIONS:

Water level elevations were between historic minimum and maximum ranges for wells MW-1 through MW-6, RW-1, and S-5, as summarized in Table 1. Water level elevations yielded a potentiometric groundwater flow direction and gradient to the west-southwest at approximately 0.02 ft/ft, consistent with historical data (see Table 2). Historic laboratory analytical results are summarized in Table 1 and within Appendix C. Due to unanticipated problems with sample handling, samples collected on 30 November 2010 were unable to be analyzed by the laboratory. Attempts to collect additional samples during the remainder of the Fourth Quarter of 2010 were unsuccessful due to scheduling issues. Therefore, BAI recommends collection and laboratory analysis of another round of samples to be collected in First Quarter 2011 to make up for those missed in the Fourth Quarter of 2010.

CLOSURE:

The findings presented in this report are based upon: observations of BAI field personnel (see Appendix A) and Conestoga-Rover and Associates (see Appendix B), the points investigated, and results of laboratory tests performed by Calscience Environmental Laboratories, Inc. (Garden Grove, California). Our services were performed in accordance with the generally accepted standard of practice at the time this report was written. No other warranty, expressed or implied was made. This report has been prepared for the exclusive use of Atlantic Richfield Company. It is possible that variations in soil or groundwater conditions could exist beyond points explored in this investigation. Also, changes in site conditions could occur in the future due to variations in rainfall, temperature, regional water usage, or other factors.

ATTACHMENTS:

- Drawing 1. Site Location Map, ARCO Service Station #2035, 1001 San Pablo Avenue, Albany, California
- Drawing 2. Groundwater Elevation Contour and Analytical Summary Map, 30 November 2010, ARCO Service Station #2035, 1001 San Pablo Avenue, Albany, California
- Table 1. Summary of Groundwater Monitoring Data: Relative Water Elevations and Laboratory Analyses, ARCO Service Station #2035, 1001 San Pablo Avenue, Albany, California
- Table 2. Historical Groundwater Flow Direction and Gradient Data, ARCO Service Station #2035, 1001 San Pablo Avenue, Albany, California
- Appendix A. BAI Groundwater Sampling Data Package (Includes Field Data Sheets, Chain-of-Custody Documentation, and Field Procedures)
- Appendix B. Joint Monitoring Data
- Appendix C. Historical Groundwater Data Tables
- Appendix D. GeoTracker Upload Confirmation Receipts

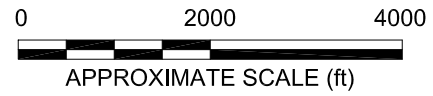
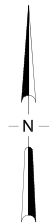
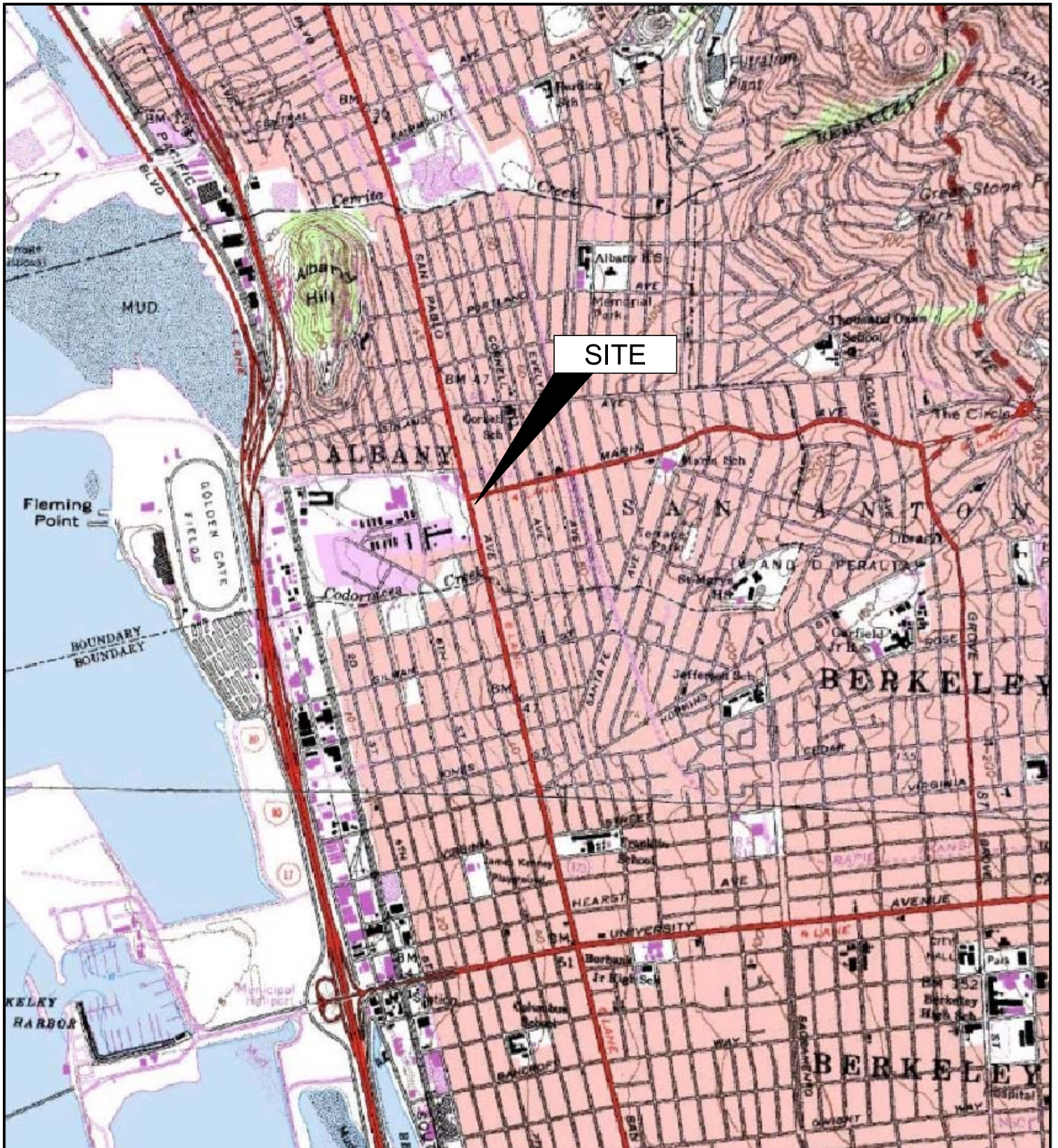
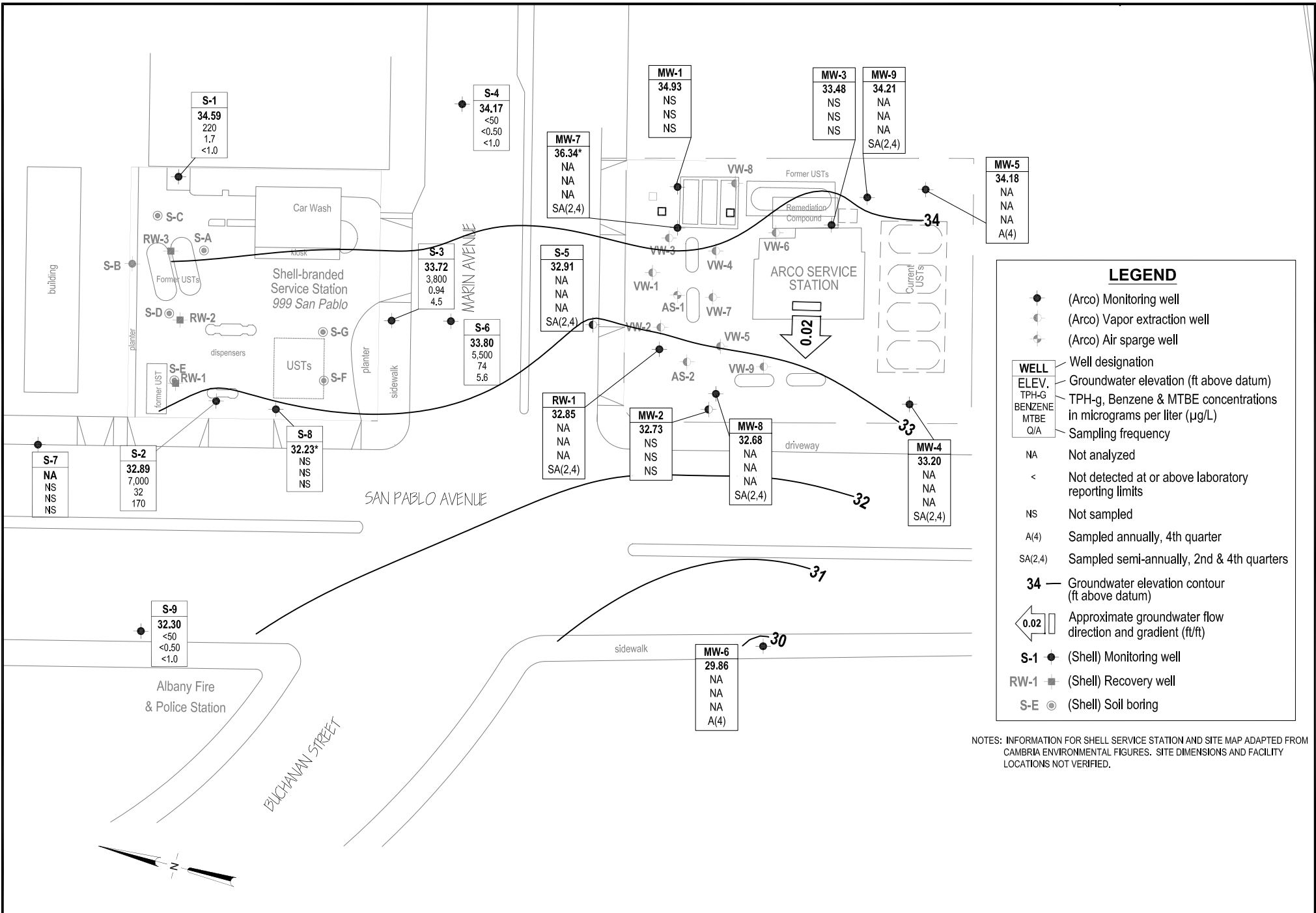

IMAGE SOURCE: USGS



NOTES: INFORMATION FOR SHELL SERVICE STATION AND SITE MAP ADAPTED FROM CAMBRIA ENVIRONMENTAL FIGURES. SITE DIMENSIONS AND FACILITY LOCATIONS NOT VERIFIED.



BROADBENT & ASSOCIATES, INC.
ENGINEERING, WATER RESOURCES & ENVIRONMENTAL
1324 Mangrove Ave. Suite 212 Chico 95926
Project No.: 06-88-610 Date: 01/17/11

ARCO Service Station #2035
1001 San Pablo Avenue
Albany, California

Groundwater Elevation Contour
and Analytical Summary Map
30 November 2010

Drawing
2

Table 1. Summary of Groundwater Monitoring Data: Relative Water Elevations and Laboratory Analyses
ARCO Service Station #2035, 1001 San Pablo Ave., Albany, CA

Well and Sample Date	P/NP	TOC Elevation (feet)	Depth to Water (feet bgs)	Product Thickness (feet)	Water Level Elevation (feet)	Concentrations in (µg/L)						DO (mg/L)	Lab	pH	Comments
						GRO/TPHg	Benzene	Toluene	Ethyl-Benzene	Total Xylenes	MTBE				
MW-1															
4/11/2002	P	41.41	10.73	--	30.68	800	360	<5.0	<5.0	<5.0	<50	--	--	--	
11/27/2002	P	41.41	10.22	--	31.19	<50	<0.50	<0.50	<0.50	<0.50	1.7	1.1	--	--	
6/3/2003	--	41.41	9.14	--	32.27	1,700	430	<5.0	24	11	8.6	1.7	--	--	
11/13/2003	P	43.55	10.17	--	33.38	<50	<0.50	<0.50	<0.50	<0.50	0.95	2.3	SEQM	6.5	a
05/12/2004	P	43.55	9.28	--	34.27	120	7.2	<0.50	<0.50	<0.50	3.0	1.6	SEQM	6.0	
12/01/2004	P	43.55	9.16	--	34.39	<50	0.94	<0.50	<0.50	1.1	2.4	5.2	SEQM	6.6	
05/02/2005	P	43.55	8.58	--	34.97	1,300	390	<5.0	12	6.4	8.8	2.8	SEQM	6.5	
11/16/2005	P	43.55	9.50	--	34.05	<50	<0.50	<0.50	<0.50	0.54	0.92	1.7	SEQM	6.4	
5/31/2006	P	43.55	7.36	--	36.19	850	200	<2.5	5.4	<2.5	4.0	2.4	SEQM	6.5	
12/6/2006	P	43.55	9.91	--	33.64	<50	0.52	<0.50	<0.50	<0.50	0.72	4.50	TAMC	6.99	
5/15/2007	P	43.55	9.65	--	33.90	67	6.6	<0.50	<0.50	<0.50	1.8	2.43	TAMC	6.96	
11/29/2007	P	43.55	9.11	--	34.44	<50	<0.50	<0.50	<0.50	<0.50	0.98	4.51	TAMC	6.81	
5/6/2008	P	43.55	8.25	--	35.30	890	140	0.53	5.4	5.8	<0.50	1.89	CEL	6.61	
11/24/2008	P	43.55	10.55	--	33.00	<50	<0.50	<0.50	<0.50	<0.50	<0.50	1.83	CEL	6.67	
4/9/2009	--	43.55	9.02	--	34.53	--	--	--	--	--	--	--	--	--	d
11/24/2009	--	43.55	9.24	--	34.31	--	--	--	--	--	--	--	--	--	
5/26/2010	--	43.55	8.47	--	35.08	--	--	--	--	--	--	--	--	--	
11/30/2010	--	43.55	8.62	--	34.93	--	--	--	--	--	--	--	--	--	
MW-2															
4/11/2002	P	40.38	11.05	--	29.33	<50	<0.50	<0.50	<0.50	<0.50	24	--	--	--	
11/27/2002	P	40.38	10.51	--	29.87	<50	<0.50	<0.50	<0.50	<0.50	5.4	2.6	--	--	
6/3/2003	--	40.38	9.78	--	30.60	<50	<0.50	<0.50	<0.50	<0.50	23	1.7	--	--	
11/13/2003	P	42.52	10.69	--	31.83	<50	<0.50	<0.50	<0.50	<0.50	9.5	2.3	SEQM	6.5	a
05/12/2004	P	42.52	10.34	--	32.18	<250	<2.5	<2.5	<2.5	<2.5	27	2.2	SEQM	6.6	
12/01/2004	P	42.52	10.28	--	32.24	<50	<0.50	<0.50	<0.50	0.70	17	3.9	SEQM	6.6	
05/02/2005	P	42.52	9.50	--	33.02	<50	<0.50	<0.50	<0.50	<0.50	25	3.1	SEQM	6.6	
11/16/2005	P	42.52	10.50	--	32.02	<50	<0.50	<0.50	<0.50	0.50	7.6	2.8	SEQM	6.4	
5/31/2006	P	42.52	10.03	--	32.49	<50	<0.50	<0.50	<0.50	<0.50	24	2.0	SEQM	6.6	
12/6/2006	P	42.52	10.28	--	32.24	<50	<0.50	<0.50	<0.50	<0.50	1.6	3.72	TAMC	6.91	
5/15/2007	P	42.52	10.00	--	32.52	<50	<0.50	<0.50	<0.50	<0.50	44	2.90	TAMC	6.69	

Table 1. Summary of Groundwater Monitoring Data: Relative Water Elevations and Laboratory Analyses
ARCO Service Station #2035, 1001 San Pablo Ave., Albany, CA

Well and Sample Date	P/NP	TOC Elevation (feet)	Depth to Water (feet bgs)	Product Thickness (feet)	Water Level Elevation (feet)	Concentrations in (µg/L)						DO (mg/L)	Lab	pH	Comments
						GRO/TPHg	Benzene	Toluene	Ethyl-Benzene	Total Xylenes	MTBE				
MW-2 Cont.															
11/29/2007	P	42.52	10.13	--	32.39	<50	<0.50	<0.50	<0.50	<0.50	1.9	4.83	TAMC	6.89	
5/6/2008	P	42.52	9.55	--	32.97	<50	<0.50	<0.50	<0.50	<0.50	35	1.88	CEL	6.62	
11/24/2008	P	42.52	10.70	--	31.82	<50	<0.50	<0.50	<0.50	<0.50	4.3	1.83	CEL	6.74	
4/9/2009	--	42.57	9.68	--	32.89	--	--	--	--	--	--	--	--	--	d
11/24/2009	--	42.57	10.48	--	32.09	--	--	--	--	--	--	--	--	--	
5/26/2010	--	42.57	9.65	--	32.92	--	--	--	--	--	--	--	--	--	
11/30/2010	--	42.57	9.84	--	32.73	--	--	--	--	--	--	--	--	--	
MW-3															
4/11/2002	P	41.44	11.05	--	30.39	250	9.4	<0.50	<0.50	<0.50	120	--	--	--	
11/27/2002	P	41.44	10.49	--	30.95	<100	<1.0	<1.0	<1.0	2.5	56	2.2	--	--	
6/3/2003	--	41.44	9.44	--	32.00	130	<0.50	<0.50	<0.50	<0.50	47	4.1	--	--	
11/13/2003	P	43.62	10.68	--	32.94	53	<0.50	<0.50	<0.50	<0.50	36	3.8	SEQM	6.8	a
05/12/2004	P	43.62	9.95	--	33.67	65	<0.50	<0.50	<0.50	<0.50	39	4.2	SEQM	6.9	
12/01/2004	P	43.62	10.32	--	33.30	140	<0.50	<0.50	<0.50	<0.50	37	4.3	SEQM	6.9	
05/02/2005	P	43.62	9.12	--	34.50	140	<0.50	<0.50	<0.50	<0.50	23	3.1	SEQM	6.7	
11/16/2005	P	43.62	10.58	--	33.04	<50	<0.50	<0.50	<0.50	<0.50	32	4.1	SEQM	6.5	
5/31/2006	P	43.62	9.41	--	34.21	<50	<0.50	<0.50	<0.50	<0.50	20	4.3	SEQM	6.8	
12/6/2006	P	43.62	10.25	--	33.37	<50	<0.50	<0.50	<0.50	<0.50	20	2.71	TAMC	7.00	
5/15/2007	P	43.62	9.70	--	33.92	<50	<0.50	<0.50	<0.50	<0.50	40	5.89	TAMC	7.07	
11/29/2007	P	43.62	10.08	--	33.54	90	<0.50	<0.50	<0.50	<0.50	35	4.74	TAMC	6.61	
5/6/2008	P	43.62	10.02	--	33.60	<50	<0.50	<0.50	<0.50	<0.50	14	2.05	CEL	6.61	
11/24/2008	P	43.62	10.80	--	32.82	<50	<1.0	<1.0	<1.0	<1.0	28	1.98	CEL	6.77	
4/9/2009	--	43.63	9.55	--	34.08	--	--	--	--	--	--	--	--	--	d
11/24/2009	--	43.63	10.29	--	33.34	--	--	--	--	--	--	--	--	--	
5/26/2010	--	43.63	9.76	--	33.87	--	--	--	--	--	--	--	--	--	
11/30/2010	--	43.63	10.15	--	33.48	--	--	--	--	--	--	--	--	--	
MW-4															
4/11/2002	NP	40.33	10.81	--	29.52	<50	<0.50	<0.50	<0.50	<0.50	11	--	--	--	
11/27/2002	NP	40.33	10.09	--	30.24	<50	<0.50	<0.50	<0.50	<0.50	6.5	1.8	--	--	

Table 1. Summary of Groundwater Monitoring Data: Relative Water Elevations and Laboratory Analyses
ARCO Service Station #2035, 1001 San Pablo Ave., Albany, CA

Well and Sample Date	P/NP	TOC Elevation (feet)	Depth to Water (feet bgs)	Product Thickness (feet)	Water Level Elevation (feet)	Concentrations in (µg/L)						DO (mg/L)	Lab	pH	Comments
						GRO/TPHg	Benzene	Toluene	Ethyl-Benzene	Total Xylenes	MTBE				
MW-4 Cont.															
6/3/2003	--	40.33	8.62	--	31.71	<250	<2.5	<2.5	<2.5	<2.5	120	1.1	--	--	
11/13/2003	NP	42.48	9.98	--	32.50	<50	<0.50	<0.50	<0.50	<0.50	20	1.3	SEQM	6.2	a
05/12/2004	P	42.48	9.48	--	33.00	<250	<2.5	<2.5	<2.5	<2.5	79	2.9	SEQM	6.6	
12/01/2004	NP	42.48	9.60	--	32.88	<50	<0.50	<0.50	<0.50	<0.50	1.8	1.9	SEQM	6.7	
05/02/2005	NP	42.48	8.67	--	33.81	<50	<0.50	<0.50	<0.50	<0.50	11	2.8	SEQM	6.6	
11/16/2005	NP	42.48	10.00	--	32.48	<50	<0.50	<0.50	<0.50	<0.50	0.93	1.7	SEQM	6.3	
5/31/2006	NP	42.48	8.52	--	33.96	<50	<0.50	<0.50	<0.50	<0.50	2.4	1.0	SEQM	7.0	
12/6/2006	NP	42.48	9.90	--	32.58	<50	<0.50	<0.50	<0.50	<0.50	7.8	0.85	TAMC	7.10	
5/15/2007	NP	42.48	9.18	--	33.30	<50	<0.50	<0.50	<0.50	<0.50	2.2	1.37	TAMC	6.85	
11/29/2007	NP	42.48	9.10	--	33.38	<50	<0.50	<0.50	<0.50	<0.50	9.1	1.81	TAMC	7.14	
5/6/2008	P	42.48	9.40	--	33.08	<50	<0.50	<0.50	<0.50	<0.50	10	2.61	CEL	6.91	
11/24/2008	NP	42.48	10.20	--	32.28	<50	<0.50	<0.50	<0.50	<0.50	<0.50	2.67	CEL	6.88	
4/9/2009	P	42.51	9.00	--	33.51	<50	<0.50	<0.50	<0.50	<0.50	12	2.51	CEL	7.11	d
11/24/2009	P	42.51	9.89	--	32.62	<50	<0.50	<0.50	<0.50	<0.50	1.7	0.80	CEL	6.58	
5/26/2010	P	42.51	8.79	--	33.72	<50	<0.50	<0.50	<0.50	<0.50	1.4	0.98	CEL	6.0	
11/30/2010	P	42.51	9.31	--	33.20	--	--	--	--	--	--	1.40	--	6.4	f
MW-5															
4/11/2002	NP	41.84	10.63	--	31.21	<50	<0.50	<0.50	<0.50	<0.50	<5.0	--	--	--	
11/27/2002	NP	41.84	10.65	--	31.19	--	--	--	--	--	--	--	--	--	
6/3/2003	--	41.84	8.92	--	32.92	<50	<0.50	<0.50	<0.50	<0.50	<0.50	1.8	--	--	
11/13/2003	NP	44.03	10.58	--	33.45	<50	<0.50	<0.50	<0.50	<0.50	0.79	1.4	SEQM	5.7	a
05/12/2004	--	44.03	9.95	--	34.08	--	--	--	--	--	--	--	--	--	
12/01/2004	NP	44.03	10.05	--	33.98	<50	<0.50	<0.50	<0.50	<0.50	0.55	1.8	SEQM	6.3	
05/02/2005	--	44.03	8.75	--	35.28	--	--	--	--	--	--	--	--	--	
11/16/2005	NP	44.03	10.37	--	33.66	<50	<0.50	<0.50	<0.50	<0.50	<0.50	1.3	SEQM	6.2	
5/31/2006	--	44.03	9.07	--	34.96	--	--	--	--	--	--	--	--	--	
12/6/2006	NP	44.03	10.25	--	33.78	<50	<0.50	<0.50	<0.50	<0.50	0.99	1.24	TAMC	6.88	
5/15/2007	--	44.03	9.51	--	34.52	--	--	--	--	--	--	--	--	--	
11/29/2007	NP	44.03	9.95	--	34.08	<50	<0.50	<0.50	<0.50	<0.50	<0.50	1.93	TAMC	6.98	
5/6/2008	--	44.03	9.67	--	34.36	--	--	--	--	--	--	--	--	--	

Table 1. Summary of Groundwater Monitoring Data: Relative Water Elevations and Laboratory Analyses
ARCO Service Station #2035, 1001 San Pablo Ave., Albany, CA

Well and Sample Date	P/NP	TOC Elevation (feet)	Depth to Water (feet bgs)	Product Thickness (feet)	Water Level Elevation (feet)	Concentrations in (µg/L)						DO (mg/L)	Lab	pH	Comments
						GRO/TPHg	Benzene	Toluene	Ethyl-Benzene	Total Xylenes	MTBE				
MW-5 Cont.															
11/24/2008	NP	44.03	10.62	--	33.41	<50	<0.50	<0.50	<0.50	<0.50	<0.50	2.43	CEL	6.52	
4/9/2009	--	44.03	12.00	--	32.03	--	--	--	--	--	--	--	--	--	d
11/24/2009	P	44.03	10.34	--	33.69	<50	<0.50	1.4	<0.50	<0.50	0.89	0.94	CEL	6.1	
5/26/2010	--	44.03	9.21	--	34.82	--	--	--	--	--	--	--	--	--	
11/30/2010	P	44.03	9.85	--	34.18	--	--	--	--	--	--	--	--	6.17	f
MW-6															
4/11/2002	NP	40.13	11.42	--	28.71	<50	<0.50	<0.50	<0.50	<0.50	<5.0	--	--	--	
11/27/2002	NP	40.13	13.11	--	27.02	<50	<0.50	<0.50	<0.50	<0.50	<0.50	1.3	--	--	
6/3/2003	--	40.13	12.48	--	27.65	<50	<0.50	<0.50	<0.50	<0.50	<0.50	1.1	--	--	
11/13/2003	NP	42.26	13.11	--	29.15	<50	<0.50	<0.50	<0.50	<0.50	<0.50	1.2	SEQM	6.8	a
05/12/2004	--	42.26	12.68	--	29.58	--	--	--	--	--	--	--	--	--	
12/01/2004	NP	42.26	12.68	--	29.58	<50	<0.50	<0.50	<0.50	<0.50	<0.50	1.7	SEQM	7.3	
05/02/2005	--	42.26	12.25	--	30.01	--	--	--	--	--	--	--	--	--	
11/16/2005	NP	42.26	12.98	--	29.28	<50	<0.50	<0.50	<0.50	<0.50	<0.50	1.2	SEQM	6.7	
5/31/2006	--	42.26	12.35	--	29.91	--	--	--	--	--	--	--	--	--	
12/6/2006	NP	42.26	12.98	--	29.28	<50	<0.50	<0.50	<0.50	<0.50	<0.50	1.24	TAMC	6.86	
5/15/2007	--	42.26	12.55	--	29.71	--	--	--	--	--	--	--	--	--	
11/29/2007	NP	42.26	12.75	--	29.51	<50	<0.50	<0.50	<0.50	<0.50	<0.50	--	TAMC	6.93	
5/6/2008	--	42.26	12.91	--	29.35	--	--	--	--	--	--	--	--	--	
11/24/2008	NP	42.26	13.20	--	29.06	<50	<0.50	<0.50	<0.50	<0.50	<0.50	2.28	CEL	7.25	
4/9/2009	--	42.31	12.52	--	29.79	--	--	--	--	--	--	--	--	--	d
11/24/2009	P	42.31	12.90	--	29.41	<50	<0.50	<0.50	<0.50	<0.50	<0.50	0.83	CEL	6.59	
5/26/2010	--	42.31	12.17	--	30.14	--	--	--	--	--	--	--	--	--	
11/30/2010	P	42.31	12.45	--	29.86	--	--	--	--	--	--	1.20	--	7.2	f
MW-7															
4/9/2009	P	43.18	6.73	--	36.45	4,100	5.2	1.7	21	21	<0.50	8.41	CEL	7.79	d
11/24/2009	P	43.18	8.31	--	34.87	2,700	4.1	1.1	3.3	3.0	<0.50	0.60	CEL	6.8	c
5/26/2010	P	43.18	6.62	--	36.56	1,800	1.2	0.53	2.2	0.84	<0.50	0.71	CEL	6.6	
11/30/2010	P	43.18	6.84	--	36.34	--	--	--	--	--	--	0.79	--	6.7	f

Table 1. Summary of Groundwater Monitoring Data: Relative Water Elevations and Laboratory Analyses
ARCO Service Station #2035, 1001 San Pablo Ave., Albany, CA

Well and Sample Date	P/NP	TOC Elevation (feet)	Depth to Water (feet bgs)	Product Thickness (feet)	Water Level Elevation (feet)	Concentrations in (µg/L)						DO (mg/L)	Lab	pH	Comments
						GRO/TPHg	Benzene	Toluene	Ethyl-Benzene	Total Xylenes	MTBE				
MW-8															
4/9/2009	P	42.36	9.50	--	32.86	4,300	940	260	150	590	110	2.09	CEL	7.62	d
11/24/2009	P	42.36	10.25	--	32.11	28,000	9,900	670	1,300	2,200	<100	0.64	CEL	6.48	c
5/26/2010	P	42.36	9.25	--	33.11	1,400	420	<10	21	<10	<10	0.78	CEL	6.6	
11/30/2010	P	42.36	9.68	--	32.68	--	--	--	--	--	--	2.26	--	6.6	f
MW-9															
4/9/2009	P	43.77	8.95	--	34.82	<50	<0.50	<0.50	<0.50	<0.50	2.1	2.81	CEL	7.58	d
11/24/2009	P	43.77	10.11	--	33.66	<50	<0.50	<0.50	<0.50	<0.50	3.8	--	CEL	6.3	
5/26/2010	P	43.77	8.88	--	34.89	<50	<0.50	<0.50	<0.50	<0.50	1.9	0.66	CEL	5.7	
11/30/2010	P	43.77	9.56	--	34.21	--	--	--	--	--	--	0.64	--	6.3	f
RW-1															
4/11/2002	P	40.33	9.20	--	31.13	15,000	750	2,000	380	2,000	1,500	--	--	--	
11/27/2002	P	40.33	10.31	--	30.02	<2,500	720	<25	<25	<25	<25	1.8	--	--	
6/3/2003	--	40.33	9.54	--	30.79	470	78	0.97	4.3	9	48	1.4	--	--	
11/13/2003	P	42.35	10.35	--	32.00	130	29	<0.50	<0.50	<0.50	44	1.3	SEQM	6.6	a
05/12/2004	P	42.35	9.80	--	32.55	<250	66	<2.5	<2.5	<2.5	<2.5	1.9	SEQM	6.9	
09/02/2004	--	42.35	10.42	--	31.93	--	--	--	--	--	--	--	--	--	
10/07/2004	--	42.35	10.36	--	31.99	--	--	--	--	--	--	--	--	--	
11/04/2004	--	42.35	9.93	--	32.42	--	--	--	--	--	--	--	--	--	
12/01/2004	P	42.35	10.02	--	32.33	<250	96	<2.5	<2.5	<2.5	16	1.8	SEQM	6.7	
05/02/2005	P	42.35	9.20	--	33.15	230	100	<1.0	<1.0	<1.0	50	2.5	SEQM	6.6	
11/16/2005	P	42.35	10.96	--	31.39	<100	28	<1.0	<1.0	<1.0	32	1.0	SEQM	6.5	
5/31/2006	P	42.35	9.34	--	33.01	320	32	<0.50	<0.50	<0.50	28	1.3	SEQM	6.8	
12/6/2006	P	42.35	10.10	--	32.25	50	27	<0.50	<0.50	<0.50	19	1.49	TAMC	7.54	
5/15/2007	P	42.35	9.42	--	32.93	280	32	<0.50	<0.50	<0.50	18	2.61	TAMC	7.10	
11/29/2007	P	42.35	9.75	--	32.60	<50	14	<0.50	<0.50	<0.50	18	4.86	TAMC	8.14	
5/6/2008	P	42.35	9.71	--	32.64	610	110	<2.5	<2.5	<2.5	2.6	2.48	CEL	6.95	
11/24/2008	P	42.35	10.48	--	31.87	73	31	<0.50	<0.50	<0.50	11	2.53	CEL	6.88	
4/9/2009	P	42.23	9.46	--	32.77	720	36	<0.50	1.0	1.2	4.0	2.58	CEL	7.73	d
11/24/2009	P	42.23	10.15	--	32.08	<50	2.0	<0.50	<0.50	<0.50	6.5	0.85	CEL	6.6	

Table 1. Summary of Groundwater Monitoring Data: Relative Water Elevations and Laboratory Analyses
ARCO Service Station #2035, 1001 San Pablo Ave., Albany, CA

Well and Sample Date	P/NP	TOC Elevation (feet)	Depth to Water (feet bgs)	Product Thickness (feet)	Water Level Elevation (feet)	Concentrations in (µg/L)						DO (mg/L)	Lab	pH	Comments
						GRO/TPHg	Benzene	Toluene	Ethyl-Benzene	Total Xylenes	MTBE				
RW-1 Cont.															
5/26/2010	P	42.23	9.12	--	33.11	90	11	<0.50	<0.50	<0.50	0.94	1.46	CEL	6.4	
11/30/2010	P	42.23	9.38	--	32.85	--	--	--	--	--	--	2.10	--	7.2	f
S-5															
4/11/2002	P	40.33	10.17	--	30.16	30,000	390	1,400	410	7,400	<500	--	--	--	
11/27/2002	P	40.33	9.77	--	30.56	55,000	1,300	450	1,400	13,000	<50	4.3	--	--	
6/3/2003	--	40.33	9.12	--	31.21	--	--	--	--	--	--	1.4	--	--	
6/3/2003	--	40.33	9.03	--	31.30	44,000	680	260	1,100	9,900	<25	1.9	--	--	
11/13/2003	P	41.83	9.12	--	32.71	31,000	520	120	690	5,900	<50	1.4	SEQM	6.5	a
05/12/2004	P	41.83	9.95	--	31.88	28,000	760	79	910	5,000	<50	1.9	SEQM	6.6	
12/01/2004	P	41.83	9.61	--	32.22	26,000	1,500	64	1,400	4,000	<25	--	SEQM	6.5	b
05/02/2005	P	41.83	8.80	--	33.03	13,000	700	18	260	1,300	<5.0	1.8	SEQM	6.4	
11/16/2005	P	41.83	9.80	--	32.03	15,000	1,400	25	570	850	<5.0	1.1	SEQM	6.3	
5/31/2006	P	41.83	8.89	--	32.94	9,800	170	<5.0	490	390	<5.0	1.4	SEQM	6.6	
12/6/2006	P	41.83	9.65	--	32.18	16,000	1,100	<25	1,700	970	<25	1.23	TAMC	6.95	
5/15/2007	P	41.83	8.89	--	32.94	10,000	140	<5.0	340	310	<5.0	3.63	TAMC	7.10	
11/29/2007	P	41.83	9.48	--	32.35	13,000	770	8.6	500	360	<2.5	5.42	TAMC	7.28	c (Benzene)
5/6/2008	P	41.83	9.30	--	32.53	7,400	320	2.8	580	130	<0.50	3.37	CEL	6.88	
11/24/2008	P	41.83	10.00	--	31.83	7,700	400	<10	390	14	<10	3.22	CEL	6.43	
4/9/2009	P	41.83	8.90	--	32.93	7,700	230	<10	370	35	<10	3.14	CEL	7.77	
11/24/2009	--	41.83	--	--	--	--	--	--	--	--	--	--	--	--	e
5/26/2010	--	41.83	--	--	--	--	--	--	--	--	--	--	--	--	e
11/30/2010	P	41.83	8.92	--	32.91	--	--	--	--	--	--	0.62	--	6.6	f

ABBREVIATIONS & SYMBOLS:

-- = Not analyzed/applicable/measured/available
< = Not detected at or above laboratory reporting limit
ft bgs = Feet below ground surface
BTEX = Benzene, toluene, ethylbenzene and xylenes
DO = Dissolved oxygen
DTW = Depth to water in ft bgs
GRO = Gasoline range organics, range C4-C12
GWE = Groundwater elevation measured in ft
mg/L = Milligrams per liter
MTBE = Methyl tert butyl ether
NP = Not purged before sampling
P = Purged before sampling
TOC = Top of casing measured in ft
TPH-g = Total petroleum hydrocarbons as gasoline, analyzed using EPA Method 8015, Modified
 $\mu\text{g/L}$ = Micrograms per liter
SEQ/SEQM = Sequoia Analytical/Sequoia Morgan Hill Laboratories

FOOTNOTES:

a = Site resurveyed by URS on 10/15/03 to NAVD '88
b = Sheen in well
c = Sample taken from VOA vial with air bubble >6mm
d = Well surveyed on 4/20/09
e = Well not monitored or sampled due to traffic control safety concerns
f = Samples were collected on 11/30/2010 but not able to be analyzed (frozen). Subsequent re-sampling could not occur in 4Q 2010

NOTES:

No sampling occurs at this site during the first and third quarters of each calendar year.

TPH-g analyzed using EPA Method 8015, Modified and BTEX and MTBE by EPA method 8260B.

Beginning in the fourth quarter 2003, the laboratory modified the reported analyte list. TPH-g was changed to GRO. The resulting data may be impacted by the potential of non-TPH-g analytes within the requested fuel range resulting in a higher concentration being reported.

Beginning in the second quarter 2004, the carbon range for GRO was changed from C6-C10 to C4-C12.

Values for DO and pH were obtained through field measurements.

GRO analysis was completed by EPA method 8260B (C4-C12) for samples collected from the time period April 2006 through February 4, 2008. The analysis for GRO was changed to EPA method 8015B (C6-C12) for samples collected from the time period February 5, 2008 through the present.

Note: The data within this table collected prior to April 2006 was provided to Broadbent & Associates, Inc. by Atlantic Richfield Company and their previous consultants. Broadbent & Associates, Inc. has not verified the accuracy of this information.

**Table 2. Historical Groundwater Flow Direction and Gradient
ARCO Service Station #2035, 1001 San Pablo Ave., Albany, CA**

Date Sampled	Approximate Flow Direction	Approximate Hydraulic Gradient
4/11/2002	Southwest	0.012
11/27/2002	West	0.021
6/3/2003	West	0.024
11/13/2003	West (offsite Northwest)	0.015
5/12/2004	West	0.020
12/1/2004	West	0.030
5/2/2005	West	0.02
11/16/2005	West	0.03
5/31/2006	West	0.04
12/6/2006	West	0.01
5/15/2007	West	0.02
11/29/2007	West	0.02
5/6/2008	West	0.007
11/24/2008	West	0.02
4/9/2009	West	0.02
11/24/2009	West	0.03
5/26/2010	West	0.02
11/30/2010	West-Southwest	0.02

NOTES:

Site resurveyed by URS on 10/15/03 by datum NAVD '88.

Note: The data within this table collected prior to April 2006 was provided to Broadbent & Associates, Inc. by Atlantic Richfield Company and their previous consultants. Broadbent & Associates, Inc. has not verified the accuracy of this information.

APPENDIX A

BAI GROUNDWATER SAMPLING DATA PACKAGE

(Includes Field Data Sheets, Laboratory Analytical Report with Chain-Of-Custody Documentation, and Field Procedures)

Groundwater Sampling Data Sheet

Well I.D.: MW-4
 Project Name/Location: BP/ARCO 2035 Project #: 06-88-610
 Sampler's Name: SB & EF Date: 11/30/10
 Purging Equipment: bauler
 Sampling Equipment: bauler

Casing Type: PVC

Casing Diameter: 4 inch

***UNIT CASING VOLUMES**

Total Well Depth: 25.02 feet

2" = 0.16 gal/lin ft.

Depth to Water: - 9.31 feet

3" = 0.37 gal/lin ft.

Water Column Thickness: = 15.71 feet

4" = 0.65 gal/lin ft.

Unit Casing Volume*: x 0.65 gallon / foot

6" = 1.47 gal/lin ft.

Casing Water Volume: = 10.2 gallons

Casing Volume: x 3 each

Estimated Purge Volume: = 30.6 gallons

Free product measurement (if present): _____

Purged (gallons)	Time (24:00)	DO	ORP (mV)	Fe	Conductance (µS)	Temperature (Fahrenheit)	pH	Observations
0	1149	1.40	247	-	363.1	65.0	6.8	
5.0	1155	X	X	X	355.4	66.7	6.5	
10.0	1159	X	X	X	356.5	67.4	6.4	
		X	X	X				
		X	X	X				
		X	X	X				
		X	X	X				
		X	X	X				

Total Water Volume Purged: 10 gallons

Depth to Water at Sample Collection: _____ feet

Sample Collection Time: 1205

Purged Dry? (Y/N) (N)

Comments:

Groundwater Sampling Data Sheet

Well I.D.: MV-5
 Project Name/Location: BP 2055 Project #: 06.886
 Sampler's Name: JB & EP Date: 11/30/10
 Purging Equipment: bailler
 Sampling Equipment: bailler

Casing Type: PVC
 Casing Diameter: 4 inch
 Total Well Depth: 24.54 feet
 Depth to Water: - 9.85 feet
 Water Column Thickness: = 14.49 feet
 Unit Casing Volume*: x 0.65 gallon / foot
 Casing Water Volume: = 9.41 gallons
 Casing Volume: x 3 each
 Estimated Purge Volume: = 28.25 gallons

***UNIT CASING VOLUMES**

2" = 0.16 gal/lin ft.
 3" = 0.37 gal/lin ft.
 4" = 0.65 gal/lin ft.
 6" = 1.47 gal/lin ft.

Free product measurement (if present): _____

Purged (gallons)	Time (24:00)	DO	ORP (mV)	Fe	Conductance (µS)	Temperature (Fahrenheit)	pH	Observations
<u>0</u>	<u>1114</u>		<u>225</u>		<u>586.7</u>	<u>62.7</u>	<u>6.39</u>	
<u>7</u>	<u>1121</u>	X	X	X	<u>581.9</u>	<u>69.6</u>	<u>6.20</u>	
<u>14</u>	<u>1127</u>	X	X	X	<u>610.8</u>	<u>84.4</u>	<u>6.17</u>	
		X	X	X				
		X	X	X				
		X	X	X				
		X	X	X				
		X	X	X				

Total Water Volume Purged: 14 gallons

Depth to Water at Sample Collection: - feet

Sample Collection Time: 1130 Purged Dry? (Y/N)

Comments:



Groundwater Sampling Data Sheet

Well I.D.: MLW-6
 Project Name/Location: RP/AR10 2035 Project #: 06-88-610
 Sampler's Name: S&BP Date: 11/30/10
 Purging Equipment: boiler
 Sampling Equipment: boiler

Casing Type: PVC

Casing Diameter: 2 inch

***UNIT CASING VOLUMES**

Total Well Depth: 24.23 feet

2" = 0.16 gal/lin ft.

Depth to Water: - 12.45 feet

3" = 0.37 gal/lin ft.

Water Column Thickness: = 11.78 feet

4" = 0.65 gal/lin ft.

Unit Casing Volume*: x 0.16 gallon / foot

6" = 1.47 gal/lin ft.

Casing Water Volume: = 1.88 gallons

Casing Volume: x 3 each

Estimated Purge Volume: = 5.5 gallons

Free product measurement (if present): _____

Purged (gallons)	Time (24:00)	DO	ORP (mV)	Fe	Conductance (µS)	Temperature (Fahrenheit)	pH	Observations
0	1325	1.20	162	—	611.2	64.0	7.29	
1	1326	X	X	X	607.5	65.4	7.3	
2	1327	X	X	X	609.4	65.9	7.2	
		X	X	X				
		X	X	X				
		X	X	X				
		X	X	X				
		X	X	X				

Total Water Volume Purged: 2.0 gallons

Depth to Water at Sample Collection: _____ feet

Sample Collection Time: 1335

Purged Dry? (Y/N) (N)

Comments: _____



Groundwater Sampling Data Sheet

Well I.D.: MW-7

Project Name/Location: BP/ARLO 2035 Project #: 06-88-610

Sampler's Name: SB & BP Date: 11/30/10

Purging Equipment: builer

Sampling Equipment: builer

Casing Type: PVC

Casing Diameter: 4 inch

***UNIT CASING VOLUMES**

Total Well Depth: 16.00 feet

2" = 0.16 gal/lin ft.

Depth to Water: - 6.54 feet

3" = 0.37 gal/lin ft.

Water Column Thickness: = 9.16 feet

4" = 0.65 gal/lin ft.

Unit Casing Volume*: x 0.65 gallon / foot

6" = 1.47 gal/lin ft.

Casing Water Volume: = 5.9 gallons

Casing Volume: x 3 each

Estimated Purge Volume: = 17.8 gallons

Free product measurement (if present):

Purged (gallons)	Time (24:00)	DO	ORP (mV)	Fe	Conductance (µS)	Temperature (Fahrenheit)	pH	Observations
0	1257	0.79	268	—	803.4	64.3	6.7	
6	1258	X	X	X	820.7	66.1	6.7	
10	1304	X	X	X	819.6	67.4	6.7	
		X	X	X				
		X	X	X				
		X	X	X				
		X	X	X				
		X	X	X				

Total Water Volume Purged: 10 gallons

Depth to Water at Sample Collection: _____ feet

Sample Collection Time: 1305

Purged Dry? (Y/N) (N)

Comments: _____



Groundwater Sampling Data Sheet

Well I.D.: MW-8
 Project Name/Location: HR/ARCO 2035 Project #: 08-88-610
 Sampler's Name: SB & BP Date: 11/30/10
 Purging Equipment: boiler
 Sampling Equipment: boiler

Casing Type: PVC

Casing Diameter: 4 inch

***UNIT CASING VOLUMES**

Total Well Depth: 1900 feet

2" = 0.16 gal/lin ft.

Depth to Water: - 9.68 feet

3" = 0.37 gal/lin ft.

Water Column Thickness: = 9.32 feet

4" = 0.65 gal/lin ft.

Unit Casing Volume*: x 0.65 gallon / foot

6" = 1.47 gal/lin ft.

Casing Water Volume: = 6.0 gallons

Casing Volume: x 3 each

Estimated Purge Volume: = 18.0 gallons

Free product measurement (if present): _____

Purged (gallons)	Time (24:00)	DO	ORP (mV)	Fe	Conductance (µS)	Temperature (Fahrenheit)	pH	Observations
0	1219	226	279	-	479.6	64.5	6.6	
5	1224	X	X	X	523.2	65.1	6.6	
10	1232	X	X	X	539.5	65.3	6.6	
		X	X	X				
		X	X	X				
		X	X	X				
		X	X	X				
		X	X	X				

Total Water Volume Purged: 10 gallons

Depth to Water at Sample Collection: _____ feet

Sample Collection Time: 1240

Purged Dry? (Y/N) (N)

Comments: _____

Groundwater Sampling Data Sheet

Well I.D.: mw-9
 Project Name/Location: ARCO 2035 Project #: 06-88-610
 Sampler's Name: SBEP Date: 11/30/10
 Purging Equipment: Boiler
 Sampling Equipment: boiler

Casing Type: PVC
 Casing Diameter: 4 inch
 Total Well Depth: 16.00 feet
 Depth to Water: 9.56 feet
 Water Column Thickness: 6.44 feet
 Unit Casing Volume*: 0.65 gallon / foot
 Casing Water Volume: 4.2 gallons
 Casing Volume: 3 each
 Estimated Purge Volume: 12.5 gallons

***UNIT CASING VOLUMES**

2" = 0.16 gal/lin ft.
 3" = 0.37 gal/lin ft.
 4" = 0.65 gal/lin ft.
 6" = 1.47 gal/lin ft.

Free product measurement (if present): _____

Purged (gallons)	Time (24:00)	DO	ORP (mV)	Fe	Conductance (µS)	Temperature (Fahrenheit)	pH	Observations
0	1048	0.64	102	-	556.7	65.0	6.5	
5	1053	X	X	X	555.5	65.8	6.4	
7	1056	X	X	X	554.2	66.5	6.3	
		X	X	X				
		X	X	X				
		X	X	X				
		X	X	X				
		X	X	X				

Total Water Volume Purged: 7.0 gallons
 Depth to Water at Sample Collection: _____ feet
 Sample Collection Time: 1100

Purged Dry? (Y/N) (N)

Comments: _____



BROADBENT & ASSOCIATES, INC.
ENGINEERING, WATER RESOURCES & ENVIRONMENTAL

Groundwater Sampling Data Sheet

Well I.D.: RW-1
 Project Name/Location: BB/ARCO 2035 Project #: 06-88-610
 Sampler's Name: SB DEK Date: 11/30/16
 Purging Equipment: Waterum pump
 Sampling Equipment: bn der

Casing Type: PVC

Casing Diameter: 6 inch

Total Well Depth: 22.56 feet 75 11

Depth to Water: - 9.58 feet

Water Column Thickness: = 13.18 feet

Unit Casing Volume*: x 1.47 gallon / foot

Casing Water Volume: = 18.57 gallons

Casing Volume: x 3 each

Estimated Purge Volume: = 58.12 gallons

***UNIT CASING VOLUMES**

2" = 0.16 gal/lin ft.

3" = 0.37 gal/lin ft.

4" = 0.65 gal/lin ft.

6" = 1.47 gal/lin ft.

Free product measurement (if present):

Purged (gallons)	Time (24:00)	DO	ORP (mV)	Fe	Conductance (µS)	Temperature (Fahrenheit)	pH	Observations
0	0926	2.10	160	✓	644.0	63.2	7.9	
10	0930	X	X	X	611.4	64.2	7.3	
20	0934	X	X	X	616.7	64.1	7.2	
		X	X	X				
		X	X	X				
		X	X	X				
		X	X	X				
		X	X	X				

Total Water Volume Purged: 20 gallons

Depth to Water at Sample Collection: _____ feet

Sample Collection Time: 0945

Purged Dry? (Y/N) (N)

Comments:



BROADBENT & ASSOCIATES, INC.
ENGINEERING, WATER RESOURCES & ENVIRONMENTAL

Groundwater Sampling Data Sheet

Well I.D.: S-5
 Project Name/Location: BP/ARCO 2035 Project #: 06-28-616
 Sampler's Name: SLAEP Date: 11/30/10
 Purging Equipment: Miller
 Sampling Equipment: backer

Casing Type: PVC
 Casing Diameter: 3 inch
 Total Well Depth: 15.67 feet
 Depth to Water: - 8.92 feet
 Water Column Thickness: = 6.75 feet
 Unit Casing Volume*: x 0.37 gallon / foot
 Casing Water Volume: = 2.49 gallons
 Casing Volume: x 3 each
 Estimated Purge Volume: = 7.49 gallons

***UNIT CASING VOLUMES**

2" = 0.16 gal/lin ft.
 3" = 0.37 gal/lin ft.
 4" = 0.65 gal/lin ft.
 6" = 1.47 gal/lin ft.

Free product measurement (if present): _____

Purged (gallons)	Time (24:00)	DO	ORP (mV)	Fe	Conductance (µS)	Temperature (Fahrenheit)	pH	Observations
0	1031	0.62	165	-	676.8	64.6	6.8	
3	1035	X	X	X	702.2	66.6	6.7	
5	1038	X	X	X	746.6	67.5	6.6	
		X	X	X				
		X	X	X				
		X	X	X				
		X	X	X				
		X	X	X				

Total Water Volume Purged: 5.0 gallons

Depth to Water at Sample Collection: _____ feet

Sample Collection Time: 1195

Purged Dry? (Y/N) (N)

Comments: _____



Laboratory Management Program LaMP Chain of Custody Record

0243

BP/ARC Project Name: BP 2035

Req Due Date (mm/dd/yy): Standard Rush TAT: Yes No

BP/ARC Facility No: 2035

Lab Work Order Number: _____

Lab Name: Calscience	BP/ARC Facility Address: 1001 San Pablo Avenue	Consultant/Contractor: Broadbent & Associates, Inc.
Lab Address: 7440 Lincoln Way	City, State, ZIP Code: Albany, CA	Consultant/Contractor Project No: 06-88-610-5-822
Lab PM: Richard Villafania	Lead Regulatory Agency: ACEH	Address: 1324 Mangrove Ave. Ste. 212, Chico, CA 95926
Lab Phone: 714-895-5494	California Global ID No.: T0600100081	Consultant/Contractor PM: Tom Venus
Lab Shipping Acct#: 9225	Enfos Proposal No: 000P9-0006	Phone: 530-566-1400
Lab Bottle Order No:	Accounting Mode: Provision <input checked="" type="checkbox"/> OOC-BU <input type="checkbox"/> OOC-RM <input type="checkbox"/>	Email EDD To: tvenus@broadbentinc.com
Other Info:	Stage: Operate (5) Activity: Monitoring/MNA (22)	Invoice To: BP/ARC <input checked="" type="checkbox"/> Contractor <input type="checkbox"/>

BP/ARC EBM: Chuck Carmel				Matrix			No. Containers / Preservative						Requested Analyses						Report Type & QC Level	
EBM Phone:				Soil / Solid	Water / Liquid	Air / Vapor	Total Number of Containers	Unpreserved	H ₂ SO ₄	HNO ₃	HCl	Methanol	GRO (8015)	BTEX (8260)	5 Oxys (8260)	EDB (8260)	1,2-DCA (8260)	Ethanol (8260)	Standard <input checked="" type="checkbox"/>	
EBM Email:																			Full Data Package <input type="checkbox"/>	
Lab No.	Sample Description	Date	Time																Comments	
1	MW-4	11/30/10	1205	X			6				X	X	X	X	X	X				
2	MW-5	↓	1130	X			6				X	X	X	X	X	X				
3	MW-6		1335	X			6				X	X	X	X	X	X				
4	MW-7		1305	X			6				X	X	X	X	X	X				
5	MW-8		1240	X			6				X	X	X	X	X	X				
6	MW-9		1100	X			6				X	X	X	X	X	X				
7	RW-1		0945	X			6				X	X	X	X	X	X				
8	S-5		1145	X			6				X	X	X	X	X	X				
9	TB - 2035 - 101130		11/30/10	1340	X			2				X								on hold

Sampler's Name: <u>Sam Barkley</u>	Relinquished By / Affiliation: <u>[Signature] / BAI</u>	Date: <u>12/2/10</u>	Time: <u>1600</u>	Accepted By / Affiliation: <u>[Signature]</u>	Date: <u>12/3/10</u>	Time: <u>0930</u>
Sampler's Company: <u>BAI</u>						
Shipment Method: <u>GSO</u>	Ship Date: <u>12/2/10</u>					
Shipment Tracking No: <u>106836691</u>						

Special Instructions: 1

THIS LINE - LAB USE ONLY: Custody Seals In Place: Yes / No Temp Blank: Yes / No Cooler Temp on Receipt: _____ °F/C Trip Blank: Yes / No MS/MSD Sample Submitted: Yes / No

PLEASE PRESS FIRMLY

1	DATE	12/2/10	SHIPPER'S GSO ACCOUNT NO.	9255
	COMPANY	Broadbent & Associates, Inc		
	ADDRESS	875 Cotting Lane		
	ADDRESS	STE/ROOM	G	
	CITY	ZIP CODE	95688	
2	SENDER'S NAME	Sam Barkley		
	PHONE NUMBER	(530) 588-2720		
3	COMPANY	CAL SCIENCE		
	NAME	PHONE NUMBER	714) 895-5494	
	ADDRESS	STE/ROOM	7441 LINCOLN WAY	
	ADDRESS	ZIP CODE	92841	
4	CITY	GARDEN GROVE		
	YOUR INTERNAL BILLING REFERENCE WILL APPEAR ON YOUR INVOICE			
SPECIAL INSTRUCTIONS				

GSO
GOLDEN STATE OVERNIGHT

1-800-322-5555
www.gso.com

SHIPPING AIR BILL

4 PACKAGE INFORMATION

LETTER (MAX 8 OZ)

PACKAGE (WT) _____

DECLARED VALUE \$ _____

COD AMOUNT \$ _____
(CASH NOT ACCEPTED)

5 DELIVERY SERVICE PRIORITY OVERNIGHT BY 10:30 AM

EARLY PRIORITY BY 8:00 AM

SATURDAY DELIVERY

*DELIVERY TIMES MAY BE LATER IN SOME AREAS • CONSULT YOUR SERVICE GUIDE OR CALL GOLDEN STATE OVERNIGHT.

6 RELEASE SIGNATURE _____

SIGN TO AUTHORIZE DELIVERY WITHOUT OBTAINING SIGNATURE

EXP. DATE _____

7 CREDIT CARD

M/C

VISA AM EX

CREDIT CARD NUMBER _____

8 PICK UP INFORMATION

TIME _____ DRIVER # _____

ROUTE # _____

9 GSO TRACKING NUMBER

106836691

← ON PLY 3 LIFT TAB AND REMOVE FOR YOUR RECORD

SHIPPER'S COPY

order from BAY CITIES PRINTING & Graphics (650) 872-1477

BROADBENT & ASSOCIATES INC. FIELD PROCEDURES

A.1 QUALITY ASSURANCE/QUALITY CONTROL FIELD PROTOCOLS

Field protocols have been implemented to enhance the accuracy and reliability of data collection, ground-water sample collection, transportation and laboratory analysis. Discussion of these protocols is provided below.

A.1.1 Water Level & Free-Product Measurement

Prior to ground-water sample collection from each monitoring well, the presence of separate-phase hydrocarbons (SPH or free product, FP) and depth to ground water shall be measured. Depth to ground water will be measured with a standard water level indicator that has been decontaminated prior to its use in accordance with procedures discussed below. Depth to groundwater will be gauged from a saw cut notch at the top of the well casing on each well head. Where FP is suspected, the initial gauging will be done with an oil-water interface probe. Once depth to water has been measured, the first retrieval of a new disposable bailer will be scrutinized for the presence of SPH/FP.

A.1.2 Monitoring Well Purging

Subsequent to measuring depth to ground water and prior to the collection of ground-water samples, purging of standing water within the monitoring well will be performed if called for. Consistent with the American Society for Testing and Materials (ASTM) Standard D6452-99, Section 7.1, the well will be purged of approximately three wetted-casing volumes of water, or until the well is dewatered, or until monitored field parameters indicate stabilization. The well will be purged using a pre-cleaned disposable bailer or submersible pump and disposable plastic tubing dedicated to each individual well. The well will be purged at a low flow rate to minimize the possibility of purging the well dry. So that the sample collected is representative of formation water, several field parameters will be monitored during the purging process. The sample will not be collected until these parameters (i.e. temperature, pH, and conductivity) have stabilized to within 10% of the previously measured value. If a well is purged dry, the sample should not be collected until the well has recovered to a minimum 50% of its initial volume.

A.1.3 Ground-Water Sample Collection

Once the wells are satisfactorily purged, water samples will be collected from each well. Water samples for organic analyses will be collected using a pre-cleaned, new, disposable bailer and transferred into the appropriate, new, laboratory-prepared containers such that no head space or air bubbles are present in the sample container (if appropriate to the analysis). The samples will be properly labeled (i.e. sample identification, sampler initials, date/time of collection, site location, requested analyses), placed in an ice chest with bagged ice or ice substitute, and delivered to the contracted analytical laboratory.

A.1.4 Surface Water Sample Collection

Unless specified otherwise, surface water samples will be collected from mid-depth in the central area of the associated surface water body. Water samples will be collected into appropriate, new, laboratory-prepared containers by dipping the container into the surface water unless the container has a preservative present. If a sample preservative is present, a new, cleaned non-preserved surrogate container will be used to obtain the sample which will then be directly transferred into a new, laboratory-provided, preserved container. Samples will be properly labeled and transported as described above.

A.1.5 Decontamination Protocol

Prior to use in each well, re-usable ground-water sampling equipment (e.g., water level indicator, oil-interface probe, purge pump, etc.) will be decontaminated. Decontamination protocol will include thoroughly cleaning with a solution of Liquinox, rinsing with clean water, and final rinsing with control water (potable water of known quality, distilled, or de-ionized water). Pre-cleaned new disposable bailers and disposable plastic tubing will be dedicated to each individual well.

A.1.6 Chain of Custody Procedures

Sample identification documents will be carefully prepared so identification and chain of custody can be maintained and sample disposition can be controlled. The sample identification documents include Chain-of-Custody (COC) records and Daily Field Report forms. Chain of custody procedures are outlined below.

Field Custody Procedures

The field sampler is individually responsible for the care and custody of the samples collected until they are properly transferred.

Samples will have unique labels. The information on these labels will correspond to the COC which shows the identification of individual samples and the contents of the shipping container. The original COC will accompany the shipment and a copy will be retained by the field sampler.

Transfer of Custody and Shipment

A COC will accompany samples during transfer and shipment. When transferring samples, the individual relinquishing and the individual receiving the samples will each sign, date, and note the time on the COC. This documents the sample custody transfer.

Samples will be packaged properly for shipment and dispatched to the appropriate laboratory for analysis, with a separate COC accompanying each shipment. Shipments will be accompanied by the original COC. Samples will be delivered by BAI personnel to the laboratory, or shipped by responsible courier. When a shipping courier is utilized, the sample shipment number will be identified on the COC.

A.1.7 Field Records

In addition to sample identification numbers and COC records, Daily Field Report records will be maintained by field staff to provide daily records of significant events, observations, and measurements during field investigations. These documents will contain observed information such as: the personnel present, site conditions, sampling procedures, measurement procedures, calibration records, equipment used, supplies used, etc. Field measurements will be recorded on the appropriate forms. Entries on the data forms will be signed and dated. The data forms will be kept as permanent file records.

NO. 857325

NON-HAZARDOUS WASTE DATA FORM

1. BESI #

2. Generator's Name and Mailing Address BP WEST COAST PRODUCTS, LLC P.O. BOX 80249 RANCHO SANTA MARGARITA, CA 92688 Generator's Phone: (949) 460-5200	Generator's Site Address (if different than mailing address) <i>BP 2035</i> 2035 1001 San Pablo ave Albany CA 24-HOUR EMERGENCY PHONE: (949) 699-3706
--	---

3. Transporter 1 Company Name Broadbent & Associates, Inc.	Phone # (530) 566-1400
--	----------------------------------

4. Transporter 2 Company Name Gomes Excavating	Phone # (707) 374-2881
--	----------------------------------

5. Designated Facility Name and Site Address INTRAT, INC. 1105 AIRPORT RD #C RIO VISTA, CA 94571	Phone # (530) 753-1829
--	----------------------------------

6. Waste Shipping Name and Description	7. Containers		8. Total Quantity	9. Unit Wt/Vol	10. Profile No.
	No.	Type			
A. NON-HAZARDOUS WATER	1	TT	78	G	
B.					
C.					
D.					

11. Special Handling Instructions and Additional Information

WEAR ALL APPROPRIATE PROTECTIVE CLOTHING

WELL PURGING / DECON WATER

12. GENERATOR'S CERTIFICATION: I certify the materials described above on this data form are non-hazardous.

Generator's/Officer's Printed/Typed Name <i>BAT</i>	Signature 	Month <i>11</i>	Day <i>30</i>	Year <i>10</i>
--	---	--------------------	------------------	-------------------

13. Transporter Acknowledgment of Receipt of Materials

Transporter 1 Printed/Typed Name <i>BAT</i>	Signature 	Month <i>11</i>	Day <i>30</i>	Year <i>10</i>
Transporter 2 Printed/Typed Name	Signature	Month	Day	Year

14. Designated Facility Owner or Operator: Certification of receipt of materials covered by this data form.

Printed/Typed Name	Signature	Month	Day	Year
--------------------	-----------	-------	-----	------

APPENDIX B

JOINT MONITORING DATA

BLAINE

TECH SERVICES INC.

GROUNDWATER SAMPLING SPECIALISTS
SINCE 1985

December 20, 2010

Denis Brown
Shell Oil Products US
20945 South Wilmington Avenue
Carson, CA 90810

Fourth Quarter 2010 Groundwater Monitoring at
Shell-branded Service Station
999 San Pablo Avenue
Albany, CA

Monitoring performed on November 30, 2010

Groundwater Monitoring Report **101130-BP-1**

This report covers the routine monitoring of groundwater wells at this Shell-branded facility. In accordance with standard procedures that conform to Regional Water Quality Control Board requirements, routine field data collection includes depth to water, total well depth, thickness of any separate immiscible layer, water column volume, calculated purge volume (if applicable), elapsed evacuation time (if applicable), total volume of water removed (if applicable), and standard water parameter instrument readings. Sample material is collected, contained, stored, and transported to the laboratory in conformance with EPA standards. Purge water (if applicable) is, likewise, collected and transported to the Martinez Refining Company.

Basic field information is presented alongside analytical values excerpted from the laboratory report in the cumulative table of **WELL CONCENTRATIONS**. The full analytical report for the most recent samples and the field data sheets are attached to this report.

At a minimum, Blaine Tech Services, Inc. field personnel are certified on completion of a forty-hour Hazardous Materials and Emergency Response training course per 29 CFR 1910.120. Field personnel are also enrolled in annual eight-hour refresher courses.

Blaine Tech Services, Inc. conducts sampling and documentation assignments of this type as an

SAN JOSE SACRAMENTO LOS ANGELES SAN DIEGO SEATTLE
1680 ROGERS AVENUE SAN JOSE, CA (408) 573-0555 FAX (408) 573-7771 LIC. 746684 www.blainetech.com

independent third party. Our activities at this site consisted of objective data and sample collection only. No interpretation of analytical results, defining of hydrological conditions or formulation of recommendations was performed.

Please call if you have any questions.

Yours truly,

A handwritten signature in black ink, appearing to read 'Mike Ninokata', with a long horizontal flourish extending to the right.

Mike Ninokata
Project Manager

MN/np

attachments: Cumulative Table of WELL CONCENTRATIONS
Certified Analytical Report
Field Data Sheets

cc: Anni Kreml
Conestoga-Rovers & Associates
5900 Hollis Street, Suite A
Emeryville, CA 94608

WELL CONCENTRATIONS
Shell-branded Service Station
999 San Pablo Avenue
Albany, CA

Well ID	Date	TPPH (ug/L)	B (ug/L)	T (ug/L)	E (ug/L)	X (ug/L)	MTBE 8020 (ug/L)	MTBE 8260 (ug/L)	DIPE (ug/L)	ETBE (ug/L)	TAME (ug/L)	TBA (ug/L)	TOC (MSL)	Depth to Water (ft.)	GW Elevation (MSL)	SPH Thickness (ft.)	DO Reading (ppm)
S-1	05/13/1991	1,500	20	2.6	86	74	NA	NA	NA	NA	NA	NA	42.73	8.24	34.49	NA	NA
S-1	08/23/1991	2,900	27	<2.5	75	18	NA	NA	NA	NA	NA	NA	42.73	8.37	34.36	NA	NA
S-1	11/07/1991	2,900	8	2.5	46	26	NA	NA	NA	NA	NA	NA	42.73	8.30	34.43	NA	NA
S-1	01/28/1992	2,000	11	<2.5	60	20	NA	NA	NA	NA	NA	NA	42.73	7.84	34.89	NA	NA
S-1	05/06/1992	1,200	5.5	<2.5	80	36	NA	NA	NA	NA	NA	NA	42.73	7.95	34.78	NA	NA
S-1	08/26/1992	2,000	9.4	<2.5	130	<2.5	NA	NA	NA	NA	NA	NA	42.73	8.24	34.49	NA	NA
S-1	10/28/1992	1,300	27	3.2	72	13	NA	NA	NA	NA	NA	NA	42.73	8.52	34.21	NA	NA
S-1	01/19/1993	1,500	13	3	29	31	NA	NA	NA	NA	NA	NA	42.73	6.54	36.19	NA	NA
S-1	04/29/1993	2,000	15	<2.5	82	<65	NA	NA	NA	NA	NA	NA	42.73	7.93	34.80	NA	NA
S-1	07/22/1993	620	1.1	4.2	3.5	13	NA	NA	NA	NA	NA	NA	42.73	8.09	34.64	NA	NA
S-1	10/21/1993	1,200	34	25	15	9.5	NA	NA	NA	NA	NA	NA	42.73	9.43	33.30	NA	NA
S-1	01/04/1994	860	<2.5	<2.5	5.7	5.3	NA	NA	NA	NA	NA	NA	42.73	8.25	34.48	NA	NA
S-1	04/13/1994	NA	NA	NA	NA	NA	NA	NA	NA	NA	NA	NA	42.73	8.02	34.71	NA	NA
S-1	07/25/1994	1,200	8.3	7.4	15	20	NA	NA	NA	NA	NA	NA	42.73	8.22	34.51	NA	NA
S-1	10/10/1994	NA	NA	NA	NA	NA	NA	NA	NA	NA	NA	NA	42.73	8.29	34.44	NA	NA
S-1	01/26/1995	1,000	12	0.6	12	420	NA	NA	NA	NA	NA	NA	42.73	6.88	35.85	NA	NA
S-1	04/21/1995	NA	NA	NA	NA	NA	NA	NA	NA	NA	NA	NA	42.73	7.65	35.08	NA	NA
S-1	07/28/1995	660	7.2	1	11	8.9	NA	NA	NA	NA	NA	NA	42.73	7.90	34.83	NA	4
S-1	10/31/1995	NA	NA	NA	NA	NA	NA	NA	NA	NA	NA	NA	42.73	7.72	35.01	NA	NA
S-1	01/10/1996	1,100	3.5	7	5.1	9.4	NA	NA	NA	NA	NA	NA	42.73	8.24	34.49	NA	7.4
S-1	04/25/1996	NA	NA	NA	NA	NA	NA	NA	NA	NA	NA	NA	42.73	7.74	34.99	NA	NA
S-1	07/23/1996	<50	<0.5	<0.5	<0.5	<0.5	<2.5	NA	NA	NA	NA	NA	42.73	7.92	34.81	NA	2.7
S-1	12/10/1996	NA	NA	NA	NA	NA	NA	NA	NA	NA	NA	NA	42.73	7.56	35.17	NA	0.6
S-1	02/20/1997	<50	<0.50	<0.50	<0.50	<0.50	<2.5	NA	NA	NA	NA	NA	42.73	7.95	34.78	NA	3
S-1	05/22/1997	NA	NA	NA	NA	NA	NA	NA	NA	NA	NA	NA	42.73	8.11	34.62	NA	0.5
S-1	08/22/1997	810	18	<2.0	5.1	4.4	18	NA	NA	NA	NA	NA	42.73	7.86	34.87	NA	3
S-1	11/03/1997	NA	NA	NA	NA	NA	NA	NA	NA	NA	NA	NA	42.73	8.35	34.38	NA	1.1
S-1	02/20/1998	<50	<0.50	<0.50	<0.50	<0.50	<2.5	NA	NA	NA	NA	NA	42.73	6.09	36.64	NA	2.9
S-1	05/18/1998	NA	NA	NA	NA	NA	NA	NA	NA	NA	NA	NA	42.73	7.69	35.04	NA	1.1

WELL CONCENTRATIONS
Shell-branded Service Station
999 San Pablo Avenue
Albany, CA

Well ID	Date	TPPH (ug/L)	B (ug/L)	T (ug/L)	E (ug/L)	X (ug/L)	MTBE 8020 (ug/L)	MTBE 8260 (ug/L)	DIPE (ug/L)	ETBE (ug/L)	TAME (ug/L)	TBA (ug/L)	TOC (MSL)	Depth to Water (ft.)	GW Elevation (MSL)	SPH Thickness (ft.)	DO Reading (ppm)
S-1	08/20/1998	390	6.7	<0.50	0.64	<0.50	14	NA	NA	NA	NA	NA	42.73	8.20	34.53	NA	1.9
S-1	11/06/1998	NA	NA	NA	NA	NA	NA	NA	NA	NA	NA	NA	42.73	8.23	34.50	NA	NA
S-1	02/16/1999	<50	<0.50	<0.50	<0.50	<0.50	<2.5	NA	NA	NA	NA	NA	42.73	7.47	35.26	NA	1.5
S-1	05/28/1999	NA	NA	NA	NA	NA	NA	NA	NA	NA	NA	NA	42.73	7.60	35.13	NA	1.3
S-1	08/24/1999	72.4	<0.500	<0.500	<0.500	<0.500	<2.50	NA	NA	NA	NA	NA	42.73	7.95	34.78	NA	1.4
S-1	11/16/1999	NA	NA	NA	NA	NA	NA	NA	NA	NA	NA	NA	42.73	7.87	34.86	NA	1.3
S-1	02/02/2000	<50.0	<0.500	<0.500	<0.500	<0.500	<5.00	NA	NA	NA	NA	NA	42.73	7.26	35.47	NA	1.4
S-1	05/09/2000	NA	NA	NA	NA	NA	NA	NA	NA	NA	NA	NA	42.73	8.13	34.60	NA	1.0
S-1	08/03/2000	209	6.42	<0.500	<0.500	<0.500	<2.50	NA	NA	NA	NA	NA	42.73	8.12	34.61	NA	1.4
S-1	11/15/2000	NA	NA	NA	NA	NA	NA	NA	NA	NA	NA	NA	42.73	8.06	34.67	NA	1.0
S-1	02/14/2001	179	4.46	<0.500	<0.500	<0.500	8.72	NA	NA	NA	NA	NA	42.73	8.08	34.65	NA	1.1
S-1	05/31/2001	NA	NA	NA	NA	NA	NA	NA	NA	NA	NA	NA	42.73	8.05	34.68	NA	1.0
S-1	08/15/2001	270	<0.50	<0.50	<0.50	<0.50	NA	<5.0	NA	NA	NA	NA	42.73	8.40	34.33	NA	1.3
S-1	12/31/2001	NA	NA	NA	NA	NA	NA	NA	NA	NA	NA	NA	42.73	7.42	35.31	NA	0.4
S-1	02/06/2002	<50	<0.50	<0.50	<0.50	<0.50	NA	<5.0	NA	NA	NA	NA	42.73	7.60	35.13	NA	2.2
S-1	06/04/2002	NA	NA	NA	NA	NA	NA	NA	NA	NA	NA	NA	42.73	8.16	34.57	NA	0.8
S-1	07/25/2002	230	<0.50	<0.50	<0.50	<0.50	NA	<5.0	NA	NA	NA	NA	42.57	7.84	34.73	NA	0.9
S-1	11/27/2002	NA	NA	NA	NA	NA	NA	NA	NA	NA	NA	NA	42.57	8.01	34.56	NA	0.6
S-1	01/30/2003	310	<0.50	<0.50	3.6	1.6	NA	<5.0	NA	NA	NA	NA	42.57	7.56	35.01	NA	1.5
S-1	06/03/2003	NA	NA	NA	NA	NA	NA	NA	NA	NA	NA	NA	42.57	7.87	34.70	NA	1.6
S-1	08/08/2003	730	<0.50	<0.50	12	6.4	NA	<0.50	NA	NA	NA	NA	42.57	7.95	34.62	NA	1.3
S-1	11/13/2003	NA	NA	NA	NA	NA	NA	NA	NA	NA	NA	NA	42.57	7.90	34.67	NA	0.8
S-1	02/04/2004	220	<0.50	<0.50	1.8	1.1	NA	<0.50	NA	NA	NA	NA	42.57	7.37	35.20	NA	1.2
S-1	05/12/2004	NA	NA	NA	NA	NA	NA	NA	NA	NA	NA	NA	42.57	8.05	34.52	NA	1.1
S-1	08/23/2004	110 g	<0.50	<0.50	<0.50	<1.0	NA	<0.50	NA	NA	NA	NA	42.57	8.10	34.47	NA	0.6
S-1	12/01/2004	NA	NA	NA	NA	NA	NA	NA	NA	NA	NA	NA	42.57	7.84	34.73	NA	NA
S-1	02/07/2005	53 h	<0.50	<0.50	<0.50	<1.0	NA	<0.50	NA	NA	NA	NA	42.57	7.48	35.09	NA	0.49
S-1	05/02/2005	NA	NA	NA	NA	NA	NA	NA	NA	NA	NA	NA	42.57	8.05	34.52	NA	NA
S-1	08/04/2005	850	<0.50	<0.50	4.5	1.0	NA	<0.50	NA	NA	NA	NA	42.57	8.05	34.52	NA	0.01

WELL CONCENTRATIONS
Shell-branded Service Station
999 San Pablo Avenue
Albany, CA

Well ID	Date	TPPH (ug/L)	B (ug/L)	T (ug/L)	E (ug/L)	X (ug/L)	MTBE 8020 (ug/L)	MTBE 8260 (ug/L)	DIPE (ug/L)	ETBE (ug/L)	TAME (ug/L)	TBA (ug/L)	TOC (MSL)	Depth to Water (ft.)	GW Elevation (MSL)	SPH Thickness (ft.)	DO Reading (ppm)
---------	------	----------------	-------------	-------------	-------------	-------------	------------------------	------------------------	----------------	----------------	----------------	---------------	--------------	----------------------------	--------------------------	---------------------------	------------------------

S-1	11/16/2005	NA	NA	NA	NA	NA	NA	NA	NA	NA	NA	NA	42.57	8.19	34.38	NA	NA
S-1	03/02/2006	170	<0.50	<0.50	2.4	0.91	NA	<0.50	NA	NA	NA	NA	42.57	7.58	34.99	NA	0.32
S-1	05/31/2006	NA	NA	NA	NA	NA	NA	NA	NA	NA	NA	NA	42.57	8.03	34.54	NA	NA
S-1	08/29/2006	<50.0	<0.500	<0.500	<0.500	<0.500	NA	<0.500	NA	NA	NA	NA	42.57	7.99	34.58	NA	1.05
S-1	12/06/2006	NA	NA	NA	NA	NA	NA	NA	NA	NA	NA	NA	42.57	8.07	34.50	NA	0.4
S-1	01/30/2007	640	<0.50	<0.50	1.9	<1.0	NA	<0.50	NA	NA	NA	NA	42.57	8.32	34.25	NA	1.20
S-1	05/15/2007	NA	NA	NA	NA	NA	NA	NA	NA	NA	NA	NA	42.57	7.85	34.72	NA	0.16
S-1	08/29/2007	980 j	0.37 l	<1.0	3.3	<1.0	NA	<1.0	<2.0	<2.0	<2.0	<10	42.57	7.87	34.70	NA	2.54
S-1	11/29/2007	NA	NA	NA	NA	NA	NA	NA	NA	NA	NA	NA	42.57	8.18	34.39	NA	0.28
S-1	02/21/2008	430 j	<0.50	<1.0	<1.0	<1.0	NA	<1.0	NA	NA	NA	NA	42.57	7.94	34.63	NA	0.27
S-1	05/06/2008	NA	NA	NA	NA	NA	NA	NA	NA	NA	NA	NA	42.57	8.00	34.57	NA	0.1
S-1	08/27/2008	170	<0.50	<1.0	<1.0	<1.0	NA	<1.0	NA	NA	NA	NA	42.57	8.45	34.12	NA	0.21
S-1	11/24/2008	NA	NA	NA	NA	NA	NA	NA	NA	NA	NA	NA	42.57	8.49	34.08	NA	0.06
S-1	01/28/2009	390	<0.50	<1.0	<1.0	<1.0	NA	<1.0	NA	NA	NA	NA	42.57	8.29	34.28	NA	1.70
S-1	05/26/2009	NA	NA	NA	NA	NA	NA	NA	NA	NA	NA	NA	42.57	8.11	34.46	NA	NA
S-1	11/24/2009	230	<0.50	<1.0	<1.0	<1.0	NA	<1.0	NA	NA	NA	NA	42.57	8.34	34.23	NA	1.47
S-1	05/26/2010	490	<0.50	<1.0	1.3	2.1	NA	<1.0	NA	NA	NA	NA	42.57	7.99	34.58	NA	0.38
S-1	11/30/2010	220	1.7	<1.0	<1.0	<1.0	NA	<1.0	NA	NA	NA	NA	42.57	7.98	34.59	NA	0.65

S-2	05/13/1991	23,000	3,900	230	1,100	3,200	NA	NA	NA	NA	NA	NA	40.73	8.50	32.23	NA	NA
S-2	08/23/1991	23,000	4,400	260	1,900	2,400	NA	NA	NA	NA	NA	NA	40.73	8.80	31.93	NA	NA
S-2	11/07/1991	40,000	4,000	160	1,020	3,400	NA	NA	NA	NA	NA	NA	40.73	8.61	32.12	NA	NA
S-2	01/28/1992	22,000	1,600	70	420	1,700	NA	NA	NA	NA	NA	NA	40.73	7.80	32.93	NA	NA
S-2	05/06/1992	20,000	2,600	110	860	1,900	NA	NA	NA	NA	NA	NA	40.73	8.10	32.63	NA	NA
S-2	08/26/1992	42,000	5,000	160	1,100	3,500	NA	NA	NA	NA	NA	NA	40.73	8.37	32.36	NA	NA
S-2	10/28/1992	34,000	4,800	330	1,600	2,900	NA	NA	NA	NA	NA	NA	40.73	8.64	32.09	NA	NA
S-2	01/19/1993	20,000	2,300	370	660	1,300	NA	NA	NA	NA	NA	NA	40.73	5.82	34.91	NA	NA
S-2	04/29/1993	40,000	2,000	67	900	1,900	NA	NA	NA	NA	NA	NA	40.73	7.70	33.03	NA	NA
S-2	07/22/1993	22,000	3,000	120	1,000	1,600	NA	NA	NA	NA	NA	NA	40.73	8.38	32.35	NA	NA
S-2 (D)	07/22/1993	17,000	3,000	110	1,000	1,500	NA	NA	NA	NA	NA	NA	40.73	8.38	32.35	NA	NA

WELL CONCENTRATIONS
Shell-branded Service Station
999 San Pablo Avenue
Albany, CA

Well ID	Date	TPPH (ug/L)	B (ug/L)	T (ug/L)	E (ug/L)	X (ug/L)	MTBE 8020 (ug/L)	MTBE 8260 (ug/L)	DIPE (ug/L)	ETBE (ug/L)	TAME (ug/L)	TBA (ug/L)	TOC (MSL)	Depth to Water (ft.)	GW Elevation (MSL)	SPH Thickness (ft.)	DO Reading (ppm)
S-2	10/21/1993	14,000	2,800	74	870	1,100	NA	NA	NA	NA	NA	NA	40.73	8.58	32.15	NA	NA
S-2 (D)	10/21/1993	13,000	3,200	53	960	820	NA	NA	NA	NA	NA	NA	40.73	8.58	32.15	NA	NA
S-2	01/04/1994	21,000	2,100	67	990	770	NA	NA	NA	NA	NA	NA	40.73	7.70	33.03	NA	NA
S-2 (D)	01/04/1994	22,000	2,000	64	910	750	NA	NA	NA	NA	NA	NA	40.73	7.70	33.03	NA	NA
S-2	04/13/1994	NA	NA	NA	NA	NA	NA	NA	NA	NA	NA	NA	40.73	7.62	33.11	NA	NA
S-2	07/25/1994	43,000	2,600	490	990	1,300	NA	NA	NA	NA	NA	NA	40.73	7.86	32.87	NA	NA
S-2	10/10/1994	NA	NA	NA	NA	NA	NA	NA	NA	NA	NA	NA	40.73	8.12	32.61	NA	NA
S-2	01/26/1995	21,000	790	12	290	570	NA	NA	NA	NA	NA	NA	40.73	6.38	34.35	NA	5.5
S-2	04/21/1995	NA	NA	NA	NA	NA	NA	NA	NA	NA	NA	NA	40.73	7.01	33.72	NA	NA
S-2	07/28/1995	14,000	2,400	360	960	370	NA	NA	NA	NA	NA	NA	40.73	7.82	32.91	NA	4
S-2	10/31/1995	NA	NA	NA	NA	NA	NA	NA	NA	NA	NA	NA	40.73	7.57	33.16	NA	NA
S-2	01/10/1996	17,000	1,400	<50	480	170	NA	NA	NA	NA	NA	NA	40.73	8.13	32.60	NA	7.2
S-2	04/25/1996	NA	NA	NA	NA	NA	NA	NA	NA	NA	NA	NA	40.73	7.72	33.01	NA	NA
S-2	07/23/1996	16,000	2,700	69	1,100	110	9,500	NA	NA	NA	NA	NA	40.73	8.10	32.63	NA	2.2
S-2 (D)	07/23/1996	11,000	2,600	68	1,000	96	10,000	11,000	NA	NA	NA	NA	40.73	8.10	32.63	NA	2.2
S-2	12/10/1996	NA	NA	NA	NA	NA	NA	NA	NA	NA	NA	NA	40.73	8.57	32.16	NA	0.5
S-2	02/20/1997	10,000	500	<10	90	130	6,400	NA	NA	NA	NA	NA	40.73	8.15	32.58	NA	4
S-2	05/22/1997	NA	NA	NA	NA	NA	NA	NA	NA	NA	NA	NA	40.73	8.79	31.94	NA	1.1
S-2	08/22/1997	23,000	1,300	65	740	290	4,500	NA	NA	NA	NA	NA	40.73	8.05	32.68	NA	3.2
S-2 (D)	08/22/1997	20,000	1,200	<100	630	250	3,900	NA	NA	NA	NA	NA	40.73	8.05	32.68	NA	3.2
S-2	11/03/1997	NA	NA	NA	NA	NA	NA	NA	NA	NA	NA	NA	40.73	8.75	31.98	NA	1.2
S-2	02/20/1998	450	28	1.3	7.4	12	35	NA	NA	NA	NA	NA	40.73	6.34	34.39	NA	0.4
S-2	05/18/1998	NA	NA	NA	NA	NA	NA	NA	NA	NA	NA	NA	40.73	7.95	32.78	NA	0.8
S-2	08/20/1998	22,000	290	44	420	410	7,300	NA	NA	NA	NA	NA	40.73	7.73	33.00	NA	1.9
S-2	11/06/1998	NA	NA	NA	NA	NA	NA	NA	NA	NA	NA	NA	40.73	8.47	32.26	NA	NA
S-2	02/16/1999	27,000	200	<200	770	840	5,400	NA	NA	NA	NA	NA	40.73	7.24	33.49	NA	1.4
S-2	05/28/1999	NA	NA	NA	NA	NA	NA	NA	NA	NA	NA	NA	40.73	7.82	32.91	NA	1.3
S-2	08/24/1999	13,400	196	<25.0	439	113	597	NA	NA	NA	NA	NA	40.73	8.61	32.12	NA	1.2
S-2	11/16/1999	NA	NA	NA	NA	NA	NA	NA	NA	NA	NA	NA	40.73	8.17	32.56	NA	1.1

WELL CONCENTRATIONS
Shell-branded Service Station
999 San Pablo Avenue
Albany, CA

Well ID	Date	TPPH (ug/L)	B (ug/L)	T (ug/L)	E (ug/L)	X (ug/L)	MTBE 8020 (ug/L)	MTBE 8260 (ug/L)	DIPE (ug/L)	ETBE (ug/L)	TAME (ug/L)	TBA (ug/L)	TOC (MSL)	Depth to Water (ft.)	GW Elevation (MSL)	SPH Thickness (ft.)	DO Reading (ppm)
S-2	02/02/2000	7,850	176	88.0	134	111	540	NA	NA	NA	NA	NA	40.73	7.57	33.16	NA	1.2
S-2	05/09/2000	NA	NA	NA	NA	NA	NA	NA	NA	NA	NA	NA	40.73	7.94	32.79	NA	1.3
S-2	08/03/2000	35,000	255	122	842	224	905	726e	NA	NA	NA	NA	40.73	8.07	32.66	NA	1.1
S-2	11/15/2000	NA	NA	NA	NA	NA	NA	NA	NA	NA	NA	NA	40.73	8.13	32.60	NA	1.3
S-2	02/14/2001	13,000	147	<25.0	309	54.4	581	NA	NA	NA	NA	NA	40.73	6.39	34.34	NA	1.4
S-2	05/31/2001	NA	NA	NA	NA	NA	NA	NA	NA	NA	NA	NA	40.73	7.21	33.52	NA	1.5
S-2	08/15/2001	15,000	67	4.1	220	33	NA	440	NA	NA	NA	NA	40.73	8.27	32.46	NA	0.6
S-2	12/31/2001	NA	NA	NA	NA	NA	NA	270	NA	NA	NA	NA	40.73	6.07	34.66	NA	0.2
S-2	02/06/2002	15,000	53	2.8	120	31	NA	220	NA	NA	NA	NA	40.73	7.98	32.75	NA	1.8
S-2	06/04/2002	NA	NA	NA	NA	NA	NA	NA	NA	NA	NA	NA	40.73	6.70	34.03	NA	0.2
S-2	07/25/2002	9,000	75	4.0	180	24	NA	460	NA	NA	NA	NA	40.63	7.67	32.96	NA	0.9
S-2	11/27/2002	NA	NA	NA	NA	NA	NA	NA	NA	NA	NA	NA	40.63	7.84	32.79	NA	0.7
S-2	01/30/2003	15,000	26	<2.5	92	22	NA	210	NA	NA	NA	NA	40.63	7.29	33.34	NA	15.6
S-2	06/03/2003	17,000	<25	<25	130	<50	NA	290	NA	NA	NA	NA	40.63	7.87	32.76	NA	5.4
S-2	08/08/2003	4,500	<2.5	<2.5	9.4	<5.0	NA	140	NA	NA	NA	NA	40.63	8.18	32.45	NA	16.2
S-2	11/13/2003	10,000	18	<10	47	21	NA	180	NA	NA	NA	NA	40.63	7.98	32.65	NA	19.5
S-2	02/04/2004	5,700	54	<10	54	<20	NA	270	NA	NA	NA	NA	40.63	7.21	33.42	NA	>15
S-2	05/12/2004	8,200	18	<10	<10	<20	NA	250	NA	NA	NA	NA	40.63	8.07	32.56	NA	3.1
S-2	08/23/2004	4,100	<10	<10	<10	<20	NA	84	<40	<40	<40	<100	40.63	8.52	32.11	NA	10.7
S-2	12/01/2004	2,000	3.4	<2.5	6.2	<5.0	NA	77	NA	NA	NA	NA	40.63	8.70	31.93	NA	11.8
S-2	02/07/2005	7,400	32	1.6	29	3.1	NA	210	NA	NA	NA	NA	40.63	7.58	33.05	NA	0.11
S-2	05/02/2005	8,100	84	4.9	83	5.5	NA	320	NA	NA	NA	NA	40.63	7.45	33.18	NA	0.6
S-2	08/04/2005	4,900	48	2.1	19	2.8	NA	330	<4.0	<4.0	<4.0	55	40.63	7.90	32.73	NA	0.4
S-2	11/16/2005	13,700	43.8	2.79	25.1	5.92	NA	156	NA	NA	NA	NA	40.63	8.33	32.30	NA	0.5
S-2	03/02/2006	5,800	44	3.2	20	5.6	NA	190	NA	NA	NA	NA	40.63	6.74	33.89	NA	0.63
S-2	05/31/2006	11,100	72.0	4.20	22.4	5.36	NA	308	NA	NA	NA	NA	40.63	7.46	33.17	NA	0.6
S-2	08/29/2006	37,400	72.1	5.08	39.6	6.89	NA	377	<0.500	<0.500	<0.500	46.7	40.63	8.02	32.61	NA	0.70
S-2	12/06/2006	5,000	41	3.2	11	5.2	NA	170	NA	NA	NA	NA	40.63	8.04	32.59	NA	0.5
S-2	01/30/2007	4,200	24	1.7	5.9	2.3	NA	140	NA	NA	NA	NA	40.63	8.08	32.55	NA	0.11

WELL CONCENTRATIONS
Shell-branded Service Station
999 San Pablo Avenue
Albany, CA

Well ID	Date	TPPH (ug/L)	B (ug/L)	T (ug/L)	E (ug/L)	X (ug/L)	MTBE 8020 (ug/L)	MTBE 8260 (ug/L)	DIPE (ug/L)	ETBE (ug/L)	TAME (ug/L)	TBA (ug/L)	TOC (MSL)	Depth to Water (ft.)	GW Elevation (MSL)	SPH Thickness (ft.)	DO Reading (ppm)
---------	------	----------------	-------------	-------------	-------------	-------------	------------------------	------------------------	----------------	----------------	----------------	---------------	--------------	----------------------------	--------------------------	---------------------------	------------------------

S-2	05/15/2007	8,100 j	48	3.5	19	6.2 l	NA	180	NA	NA	NA	NA	40.63	8.05	32.58	NA	0.11
S-2	08/29/2007	8,400 j	60	3.8	12	4.68 l	NA	270	<4.0	<4.0	<4.0	64	40.63	8.01	32.62	NA	1.02
S-2	11/29/2007	4,100 j	48	4.8 m	11	12.3	NA	280	NA	NA	NA	NA	40.63	8.25	32.38	NA	0.55
S-2	02/21/2008	7,300 j	57	4.0	13	4.7	NA	250	NA	NA	NA	NA	40.63	7.25	33.38	NA	0.40
S-2	05/06/2008	8,900	42	3.1	9.8	4.1	NA	270	NA	NA	NA	NA	40.63	6.30	34.34	0.01	0.10/2.0
S-2	08/27/2008	9,400	67	<5.0	27	6.0	NA	240	<10	<10	<10	67	40.63	8.33	32.30	NA	0.15
S-2	11/24/2008	7,100	55	<5.0	9.3	<5.0	NA	210	NA	NA	NA	NA	40.63	8.43	32.20	NA	0.7
S-2	01/28/2009	6,000	29	<5.0	6.5	<5.0	NA	130	NA	NA	NA	NA	40.63	8.19	32.44	NA	0.15
S-2	05/26/2009	20,000	52	3.2	13	6.0	NA	330	NA	NA	NA	NA	40.63	7.85	32.78	NA	0.43
S-2	11/24/2009	5,200	19	<2.0	6.8	4.7	NA	120	<4.0	<4.0	<4.0	80	40.63	8.32	32.31	NA	0.18
S-2	05/26/2010	7,500	78	<5.0	11	<5.0	NA	330	NA	NA	NA	NA	40.63	7.62	33.01	NA	0.34
S-2	11/30/2010	7,000	32	2.7	4.5	5.0	NA	170	<4.0	<4.0	<4.0	86	40.63	7.74	32.89	NA	0.65

S-3	05/13/1991	3,300	30	3.6	26	13	NA	NA	NA	NA	NA	NA	41.46	7.90	33.56	NA	NA
S-3	08/23/1991	2,000	25	4	9.3	4.5	NA	NA	NA	NA	NA	NA	41.46	8.14	33.32	NA	NA
S-3	11/07/1991	4,000	20	3.9	5	4.9	NA	NA	NA	NA	NA	NA	41.46	7.91	33.55	NA	NA
S-3	01/28/1992	2,100	21	7.6	6.7	15	NA	NA	NA	NA	NA	NA	41.46	7.53	33.93	NA	NA
S-3 (D)	01/28/1992	2,100	18	6.1	7.1	14	NA	NA	NA	NA	NA	NA	41.46	7.53	33.93	NA	NA
S-3	05/06/1992	6,600	38	51	45	65	NA	NA	NA	NA	NA	NA	41.46	7.55	33.91	NA	NA
S-3	08/26/1992	5,800	18	12	29	60	NA	NA	NA	NA	NA	NA	41.46	7.53	33.93	NA	NA
S-3	10/28/1992	3,000	55	11	16	32	NA	NA	NA	NA	NA	NA	41.46	7.95	33.51	NA	NA
S-3	01/19/1993	3,100	<5	5.1	11	16	NA	NA	NA	NA	NA	NA	41.46	6.12	35.34	NA	NA
S-3	04/29/1993	3,000	31	22	<5	14	NA	NA	NA	NA	NA	NA	41.46	7.27	34.19	NA	NA
S-3	07/22/1993	2,600	3.1	43	23	53	NA	NA	NA	NA	NA	NA	41.46	7.62	33.84	NA	NA
S-3	10/21/1993	2,500	73	14	16	32	NA	NA	NA	NA	NA	NA	41.46	7.81	33.65	NA	NA
S-3	01/04/1994	4,800	13	21	<12.5	33	NA	NA	NA	NA	NA	NA	41.46	7.49	33.97	NA	NA
S-3	04/13/1994	NA	NA	NA	NA	NA	NA	NA	NA	NA	NA	NA	41.46	7.32	34.14	NA	NA
S-3	07/25/1994	2,600	6.1	4	3.8	12	NA	NA	NA	NA	NA	NA	41.46	7.66	33.80	NA	NA
S-3	10/10/1994	NA	NA	NA	NA	NA	NA	NA	NA	NA	NA	NA	41.46	7.49	33.97	NA	NA

WELL CONCENTRATIONS
Shell-branded Service Station
999 San Pablo Avenue
Albany, CA

Well ID	Date	TPPH (ug/L)	B (ug/L)	T (ug/L)	E (ug/L)	X (ug/L)	MTBE 8020 (ug/L)	MTBE 8260 (ug/L)	DIPE (ug/L)	ETBE (ug/L)	TAME (ug/L)	TBA (ug/L)	TOC (MSL)	Depth to Water (ft.)	GW Elevation (MSL)	SPH Thickness (ft.)	DO Reading (ppm)
S-3	01/26/1995	3,600	30	6.8	5.6	19	NA	NA	NA	NA	NA	NA	41.46	6.50	34.96	NA	NA
S-3 (D)	01/26/1995	2,200	9.9	15	14	22	NA	NA	NA	NA	NA	NA	41.46	6.50	34.96	NA	NA
S-3	04/21/1995	NA	NA	NA	NA	NA	NA	NA	NA	NA	NA	NA	41.46	6.79	34.67	NA	NA
S-3	07/28/1995	3,700	27	9.3	20	34	NA	NA	NA	NA	NA	NA	41.46	7.28	34.18	NA	4
S-3	10/31/1995	NA	NA	NA	NA	NA	NA	NA	NA	NA	NA	NA	41.46	6.74	34.72	NA	NA
S-3	01/10/1996	4,000	10	<0.5	13	28	NA	NA	NA	NA	NA	NA	41.46	7.48	33.98	NA	6.1
S-3	04/25/1996	NA	NA	NA	NA	NA	NA	NA	NA	NA	NA	NA	41.46	6.90	34.56	NA	NA
S-3	07/23/1996	2,100	20	<0.5	<0.5	<0.5	<25	NA	NA	NA	NA	NA	41.46	7.04	34.42	NA	2.1
S-3	12/10/1996	NA	NA	NA	NA	NA	NA	NA	NA	NA	NA	NA	41.46	7.96	33.50	NA	0.7
S-3	02/20/1997	3,500	83	<5.0	18	16	130	NA	NA	NA	NA	NA	41.46	7.44	34.02	NA	3
S-3 (D)	02/20/1997	3,000	69	<5.0	14	12	70	NA	NA	NA	NA	NA	41.46	7.44	34.02	NA	3
S-3	05/22/1997	NA	NA	NA	NA	NA	NA	NA	NA	NA	NA	NA	41.46	7.13	34.33	NA	0.6
S-3	08/22/1997	4,700	60	12	19	21	40	NA	NA	NA	NA	NA	41.46	6.81	34.65	NA	2.9
S-3	11/03/1997	NA	NA	NA	NA	NA	NA	NA	NA	NA	NA	NA	41.46	7.40	34.06	NA	0.9
S-3	02/20/1998	3,400	<10	<10	14	18	85	NA	NA	NA	NA	NA	41.46	6.55	34.91	NA	0.8
S-3 (D)	02/20/1998	3,100	8.6	7.8	12	16	57	NA	NA	NA	NA	NA	41.46	6.55	34.91	NA	0.8
S-3	05/18/1998	NA	NA	NA	NA	NA	NA	NA	NA	NA	NA	NA	41.46	6.81	34.65	NA	0.7
S-3	08/20/1998	4,400	67	23	9.8	22	240	NA	NA	NA	NA	NA	41.46	6.98	34.48	NA	2.2
S-3	11/06/1998	NA	NA	NA	NA	NA	NA	NA	NA	NA	NA	NA	41.46	6.96	34.50	NA	NA
S-3	02/16/1999	2,000	6.9	6.2	3.7	4.8	47	NA	NA	NA	NA	NA	41.46	6.93	34.53	NA	2.0
S-3	05/28/1999	NA	NA	NA	NA	NA	NA	NA	NA	NA	NA	NA	41.46	6.74	34.72	NA	1.8
S-3	08/24/1999	4,170	54.8	14.2	6.65	13.7	43.4	NA	NA	NA	NA	NA	41.46	9.05	32.41	NA	1.9
S-3	11/16/1999	NA	NA	NA	NA	NA	NA	NA	NA	NA	NA	NA	41.46	7.09	34.37	NA	1.6
S-3	02/02/2000	2,410	133	112	24.9	104	46.0	NA	NA	NA	NA	NA	41.46	6.59	34.87	NA	1.9
S-3	05/09/2000	NA	NA	NA	NA	NA	NA	NA	NA	NA	NA	NA	41.46	7.13	34.33	NA	1.9
S-3	08/03/2000	3,890	17.2	21.9	<10.0	<10.0	166	NA	NA	NA	NA	NA	41.46	6.82	34.64	NA	1.8
S-3	11/15/2000	NA	NA	NA	NA	NA	NA	NA	NA	NA	NA	NA	41.46	6.98	34.48	NA	1.6
S-3	02/14/2001	2,800	35.8	5.57	3.83	2.94	1,070	1,250	NA	NA	NA	NA	41.46	6.57	34.89	NA	1.1
S-3	05/31/2001	NA	NA	NA	NA	NA	NA	NA	NA	NA	NA	NA	41.46	6.72	34.74	NA	1.6

WELL CONCENTRATIONS
Shell-branded Service Station
999 San Pablo Avenue
Albany, CA

Well ID	Date	TPPH (ug/L)	B (ug/L)	T (ug/L)	E (ug/L)	X (ug/L)	MTBE 8020 (ug/L)	MTBE 8260 (ug/L)	DIPE (ug/L)	ETBE (ug/L)	TAME (ug/L)	TBA (ug/L)	TOC (MSL)	Depth to Water (ft.)	GW Elevation (MSL)	SPH Thickness (ft.)	DO Reading (ppm)
S-3	08/15/2001	2,700	2.0	0.52	<0.50	2.0	NA	140	NA	NA	NA	NA	41.46	7.44	34.02	NA	0.6
S-3	12/31/2001	2,300	<2.0	<2.0	<2.0	<2.0	NA	470	NA	NA	NA	NA	41.46	6.62	34.84	NA	0.6
S-3	02/06/2002	2,000	2.6	1.6	4.3	7.8	NA	170	NA	NA	NA	NA	41.46	7.22	34.24	NA	2.2
S-3	06/04/2002	2,400	1.0	1.1	0.54	4.5	NA	120	NA	NA	NA	NA	41.46	7.34	34.12	NA	0.5
S-3	07/25/2002	3,100	0.86	<0.50	<0.50	2.0	NA	92	NA	NA	NA	NA	41.37	6.98	34.39	NA	1.0
S-3	11/27/2002	2,600	2.0	0.55	<0.50	2.1	NA	44	NA	NA	NA	NA	41.37	7.62	33.75	NA	0.7
S-3	01/30/2003	1,200	2.1	1.3	1.6	3.4	NA	42	NA	NA	NA	NA	41.37	7.14	34.23	NA	13.6
S-3	06/03/2003	2,700	2.9	<0.50	0.50	2.8	NA	43	NA	NA	NA	NA	41.37	7.25	34.12	NA	1.7
S-3	08/08/2003	1,400	2.4	0.71	<0.50	2.2	NA	32	NA	NA	NA	NA	41.37	7.67	33.70	NA	>20
S-3	11/13/2003	5,200	5.1	2.4	<1.0	5.6	NA	69	NA	NA	NA	NA	41.37	7.56	33.81	NA	19.6
S-3	02/04/2004	2,800	1.9	<1.0	1.0	2.6	NA	20	NA	NA	NA	NA	41.37	7.12	34.25	NA	>15
S-3	05/12/2004	1,900	2.8	<1.0	<1.0	2.2	NA	9.7	NA	NA	NA	NA	41.37	7.94	33.43	NA	4.0
S-3	08/23/2004	1,400	7.6	1.1	<1.0	2.9	NA	13	<4.0	<4.0	<4.0	<10	41.37	8.09	33.28	NA	13.3
S-3	12/01/2004	950	1.9	<1.0	<1.0	<2.0	NA	5.6	NA	NA	NA	NA	41.37	8.21	33.16	NA	13.0
S-3	02/07/2005	1,800	1.4	<1.0	<1.0	2.1	NA	9.9	NA	NA	NA	NA	41.37	7.69	33.68	NA	0.25
S-3	05/02/2005	4,000	2.3	1.1	1.6	3.0	NA	9.9	NA	NA	NA	NA	41.37	7.20	34.17	NA	0.5
S-3	08/04/2005	3,600	2.1	<1.0	<2.0	3.6	NA	8.5	<4.0	<4.0	<4.0	33	41.37	8.14	33.23	NA	0.2
S-3	11/16/2005	6,000	2.24	0.800	0.660	3.35	NA	3.83	NA	NA	NA	NA	41.37	8.39	32.98	NA	0.6
S-3	03/02/2006	1,500	1.3	<0.50	0.57	2.0	NA	5.1	NA	NA	NA	NA	41.37	7.09	34.28	NA	0.52
S-3	05/31/2006	5,560	1.71	0.730	1.24	3.89	NA	8.01 i	NA	NA	NA	NA	41.37	7.95	33.42	NA	0.5
S-3	08/29/2006	4,850	1.82	0.680	1.19	2.22	NA	3.16	<0.500	<0.500	<0.500	<10.0	41.37	6.35	35.02	NA	0.88
S-3	12/06/2006	2,900	1.1	<0.50	<0.50	2.2	NA	<0.50	NA	NA	NA	NA	41.37	8.41	32.96	NA	0.3
S-3	01/30/2007	2,100	1.0	<0.50	0.53	1.8	NA	5.7	NA	NA	NA	NA	41.37	8.31	33.06	NA	0.36
S-3	05/15/2007	3,500 j	1.1	0.51 l	0.76 l	2.38 l	NA	8.0	NA	NA	NA	NA	41.37	7.60	33.77	NA	0.11
S-3	08/29/2007	<50 j	1.5	0.48 l	0.50 l	2.81 l	NA	<1.0	<2.0	<2.0	<2.0	<10	41.37	8.64	32.73	NA	0.57
S-3	11/29/2007	3,800 j	1.8	0.80 l,m	0.65 l	3.34 l	NA	5.9	NA	NA	NA	NA	41.37	8.36	33.01	NA	0.22
S-3	02/21/2008	2,900 j	0.60	<1.0	<1.0	1.2	NA	5.0	NA	NA	NA	NA	41.37	7.35	34.02	NA	0.44
S-3	05/06/2008	2,400	1.2	<1.0	<1.0	1.7	NA	<1.0	NA	NA	NA	NA	41.37	8.00	33.37	NA	0.2/1.4
S-3	08/27/2008	3,100	1.5	<1.0	<1.0	2.3	NA	<1.0	<2.0	<2.0	<2.0	<10	41.37	8.56	32.81	NA	0.13

WELL CONCENTRATIONS
Shell-branded Service Station
999 San Pablo Avenue
Albany, CA

Well ID	Date	TPPH (ug/L)	B (ug/L)	T (ug/L)	E (ug/L)	X (ug/L)	MTBE 8020 (ug/L)	MTBE 8260 (ug/L)	DIPE (ug/L)	ETBE (ug/L)	TAME (ug/L)	TBA (ug/L)	TOC (MSL)	Depth to Water (ft.)	GW Elevation (MSL)	SPH Thickness (ft.)	DO Reading (ppm)
---------	------	----------------	-------------	-------------	-------------	-------------	------------------------	------------------------	----------------	----------------	----------------	---------------	--------------	----------------------------	--------------------------	---------------------------	------------------------

S-3	11/24/2008	2,900	1.5	<1.0	<1.0	2.2	NA	<1.0	NA	NA	NA	NA	41.37	8.71	32.66	NA	0.32
S-3	01/28/2009	3,900	1.4	<1.0	<1.0	2.2	NA	<1.0	NA	NA	NA	NA	41.37	8.22	33.15	NA	0.48
S-3	05/26/2009	3,600	1.1	<1.0	<1.0	1.5	NA	5.2	NA	NA	NA	NA	41.37	8.23	33.14	NA	1.54
S-3	11/24/2009	2,200	0.98	<1.0	<1.0	1.7	NA	<1.0	<2.0	<2.0	<2.0	<10	41.37	8.71	32.66	NA	0.42
S-3	05/26/2010	2,800	1.0	<1.0	<1.0	2.4	NA	7.8	NA	NA	NA	NA	41.37	7.80	33.57	NA	0.32
S-3	11/30/2010	3,800	0.94	<1.0	<1.0	1.9	NA	4.5	<2.0	<2.0	<2.0	<10	41.37	7.65	33.72	NA	0.87

S-4	05/13/1991	<50	<0.5	<0.5	<0.5	<0.5	NA	NA	NA	NA	NA	NA	41.10	7.44	33.66	NA	NA
S-4	08/23/1991	<50	<0.5	<0.5	<0.5	<0.5	NA	NA	NA	NA	NA	NA	41.10	8.32	32.78	NA	NA
S-4	11/07/1991	260	<0.5	<0.5	<0.5	<0.5	NA	NA	NA	NA	NA	NA	41.10	8.32	32.78	NA	NA
S-4	01/28/1992	110c	<0.5	<0.5	<0.5	<0.5	NA	NA	NA	NA	NA	NA	41.10	7.40	33.70	NA	NA
S-4	05/06/1992	54	<0.5	<0.5	<0.5	<0.5	NA	NA	NA	NA	NA	NA	41.10	7.21	33.89	NA	NA
S-4	08/26/1992	67	<0.5	<0.5	<0.5	<0.5	NA	NA	NA	NA	NA	NA	41.10	8.13	32.97	NA	NA
S-4	10/28/1992	<50	<0.5	<0.5	<0.5	<0.5	NA	NA	NA	NA	NA	NA	41.10	8.73	32.37	NA	NA
S-4	01/19/1993	86	1.2	0.7	2.7	15	NA	NA	NA	NA	NA	NA	41.10	5.86	35.24	NA	NA
S-4	04/29/1993	<50	<0.5	<0.5	<0.5	<0.5	NA	NA	NA	NA	NA	NA	41.10	7.02	34.08	NA	NA
S-4 (D)	04/29/1993	<50	<0.5	<0.5	<0.5	<0.5	NA	NA	NA	NA	NA	NA	41.10	7.02	34.08	NA	NA
S-4	07/22/1993	<50	<0.5	<0.5	<0.5	<0.5	NA	NA	NA	NA	NA	NA	41.10	7.76	33.34	NA	NA
S-4	10/21/1993	<50	<0.5	<0.5	<0.5	<0.5	NA	NA	NA	NA	NA	NA	41.10	8.53	32.57	NA	NA
S-4	01/04/1994	<50	<0.5	<0.5	<0.5	<0.5	NA	NA	NA	NA	NA	NA	41.10	7.92	33.18	NA	NA
S-4	04/13/1994	NA	NA	NA	NA	NA	NA	NA	NA	NA	NA	NA	41.10	7.71	33.39	NA	NA
S-4	07/25/1994	NA	NA	NA	NA	NA	NA	NA	NA	NA	NA	NA	41.10	7.82	33.28	NA	NA
S-4	10/10/1994	NA	NA	NA	NA	NA	NA	NA	NA	NA	NA	NA	41.10	8.15	32.95	NA	NA
S-4	01/26/1995	<50	<0.5	<0.5	<0.5	<0.5	NA	NA	NA	NA	NA	NA	41.10	5.73	35.37	NA	NA
S-4	04/21/1995	NA	NA	NA	NA	NA	NA	NA	NA	NA	NA	NA	41.10	6.26	34.84	NA	NA
S-4	07/28/1995	NA	NA	NA	NA	NA	NA	NA	NA	NA	NA	NA	41.10	7.80	33.30	NA	NA
S-4	10/31/1995	NA	NA	NA	NA	NA	NA	NA	NA	NA	NA	NA	41.10	8.45	32.65	NA	NA
S-4	01/10/1996	<50	1	2.8	<0.5	2.1	NA	NA	NA	NA	NA	NA	41.10	8.26	32.84	NA	2.8
S-4	04/25/1996	NA	NA	NA	NA	NA	NA	NA	NA	NA	NA	NA	41.10	7.14	33.96	NA	NA

WELL CONCENTRATIONS
Shell-branded Service Station
999 San Pablo Avenue
Albany, CA

Well ID	Date	TPPH (ug/L)	B (ug/L)	T (ug/L)	E (ug/L)	X (ug/L)	MTBE 8020 (ug/L)	MTBE 8260 (ug/L)	DIPE (ug/L)	ETBE (ug/L)	TAME (ug/L)	TBA (ug/L)	TOC (MSL)	Depth to Water (ft.)	GW Elevation (MSL)	SPH Thickness (ft.)	DO Reading (ppm)
S-4	07/23/1996	<50	<0.5	<0.5	<0.5	<0.5	<2.5	NA	NA	NA	NA	NA	41.10	8.18	32.92	NA	3.8
S-4	12/10/1996	NA	NA	NA	NA	NA	NA	NA	NA	NA	NA	NA	41.10	7.04	34.06	NA	3.9
S-4	02/20/1997	<50	<0.50	<0.50	<0.50	<0.50	6.7	NA	NA	NA	NA	NA	41.10	7.07	34.03	NA	5
S-4	05/22/1997	NA	NA	NA	NA	NA	NA	NA	NA	NA	NA	NA	41.10	6.63	34.47	NA	0.8
S-4	08/22/1997	NA	NA	NA	NA	NA	NA	NA	NA	NA	NA	NA	41.10	7.69	33.41	NA	3.7
S-4	11/03/1997	NA	NA	NA	NA	NA	NA	NA	NA	NA	NA	NA	41.10	8.26	32.84	NA	1.3
S-4	02/20/1998	130	6.9	4.6	5.2	17	2.8	NA	NA	NA	NA	NA	41.10	5.57	35.53	NA	1.8
S-4	05/18/1998	NA	NA	NA	NA	NA	NA	NA	NA	NA	NA	NA	41.10	7.13	33.97	NA	1.4
S-4	08/20/1998	NA	NA	NA	NA	NA	NA	NA	NA	NA	NA	NA	41.10	7.77	33.33	NA	4.0
S-4	11/06/1998	NA	NA	NA	NA	NA	NA	NA	NA	NA	NA	NA	41.10	7.85	33.25	NA	NA
S-4	02/16/1999	<50	<0.50	<0.50	<0.50	<0.50	23	NA	NA	NA	NA	NA	41.10	6.51	34.59	NA	3.6
S-4	05/28/1999	NA	NA	NA	NA	NA	NA	NA	NA	NA	NA	NA	41.10	7.00	34.10	NA	3.2
S-4	08/24/1999	NA	NA	NA	NA	NA	NA	NA	NA	NA	NA	NA	41.10	9.13	31.97	NA	1.9
S-4	11/16/1999	NA	NA	NA	NA	NA	NA	NA	NA	NA	NA	NA	41.10	7.79	33.31	NA	1.7
S-4	02/02/2000	<50.0	<0.500	<0.500	<0.500	<0.500	<5.00	NA	NA	NA	NA	NA	41.10	7.19	33.91	NA	1.9
S-4	05/09/2000	NA	NA	NA	NA	NA	NA	NA	NA	NA	NA	NA	41.10	7.51	33.59	NA	1.8
S-4	08/03/2000	NA	NA	NA	NA	NA	NA	NA	NA	NA	NA	NA	41.10	7.83	33.27	NA	1.9
S-4	11/15/2000	NA	NA	NA	NA	NA	NA	NA	NA	NA	NA	NA	41.10	7.69	33.41	NA	1.5
S-4	02/14/2001	<50.0	<0.500	<0.500	<0.500	<0.500	<2.50	NA	NA	NA	NA	NA	41.10	6.20	34.90	NA	1.6
S-4	05/31/2001	NA	NA	NA	NA	NA	NA	NA	NA	NA	NA	NA	41.10	6.56	34.54	NA	1.6
S-4	08/15/2001	NA	NA	NA	NA	NA	NA	NA	NA	NA	NA	NA	41.10	7.90	33.20	NA	0.6
S-4	12/31/2001	NA	NA	NA	NA	NA	NA	NA	NA	NA	NA	NA	41.10	5.62	35.48	NA	2.7
S-4	02/06/2002	<50	<0.50	<0.50	<0.50	<0.50	NA	<5.0	NA	NA	NA	NA	41.10	7.29	33.81	NA	0.2
S-4	06/04/2002	NA	NA	NA	NA	NA	NA	NA	NA	NA	NA	NA	41.10	7.45	33.65	NA	0.6
S-4	07/25/2002	NA	NA	NA	NA	NA	NA	NA	NA	NA	NA	NA	41.04	7.39	33.65	NA	0.8
S-4	11/27/2002	NA	NA	NA	NA	NA	NA	NA	NA	NA	NA	NA	41.04	7.60	33.44	NA	NA
S-4	01/30/2003	<50	<0.50	<0.50	<0.50	<0.50	NA	<5.0	NA	NA	NA	NA	41.04	8.45	32.59	NA	NA
S-4	06/03/2003	NA	NA	NA	NA	NA	NA	NA	NA	NA	NA	NA	41.04	6.82	34.22	NA	NA
S-4	08/08/2003	NA	NA	NA	NA	NA	NA	NA	NA	NA	NA	NA	41.04	7.36	33.68	NA	NA

WELL CONCENTRATIONS
Shell-branded Service Station
999 San Pablo Avenue
Albany, CA

Well ID	Date	TPPH (ug/L)	B (ug/L)	T (ug/L)	E (ug/L)	X (ug/L)	MTBE 8020 (ug/L)	MTBE 8260 (ug/L)	DIPE (ug/L)	ETBE (ug/L)	TAME (ug/L)	TBA (ug/L)	TOC (MSL)	Depth to Water (ft.)	GW Elevation (MSL)	SPH Thickness (ft.)	DO Reading (ppm)
S-4	11/13/2003	NA	NA	NA	NA	NA	NA	NA	NA	NA	NA	NA	41.04	7.56	33.48	NA	NA
S-4	02/04/2004	<50	<0.50	<0.50	<0.50	<1.0	NA	<0.50	NA	NA	NA	NA	41.04	6.47	34.57	NA	NA
S-4	05/12/2004	NA	NA	NA	NA	NA	NA	NA	NA	NA	NA	NA	41.04	7.10	33.94	NA	NA
S-4	08/23/2004	NA	NA	NA	NA	NA	NA	NA	NA	NA	NA	NA	41.04	7.60	33.44	NA	NA
S-4	12/01/2004	NA	NA	NA	NA	NA	NA	NA	NA	NA	NA	NA	41.04	7.23	33.81	NA	NA
S-4	02/07/2005	<50	<0.50	<0.50	<0.50	<1.0	NA	<0.50	NA	NA	NA	NA	41.04	6.12	34.92	NA	NA
S-4	05/02/2005	NA	NA	NA	NA	NA	NA	NA	NA	NA	NA	NA	41.04	6.50	34.54	NA	NA
S-4	08/04/2005	NA	NA	NA	NA	NA	NA	NA	NA	NA	NA	NA	41.04	7.13	33.91	NA	NA
S-4	11/16/2005	NA	NA	NA	NA	NA	NA	NA	NA	NA	NA	NA	41.04	7.43	33.61	NA	NA
S-4	03/02/2006	<50	<0.50	<0.50	<0.50	<0.50	NA	<0.50	NA	NA	NA	NA	41.04	6.05	34.99	NA	NA
S-4	05/31/2006	NA	NA	NA	NA	NA	NA	NA	NA	NA	NA	NA	41.04	6.64	34.40	NA	NA
S-4	08/29/2006	NA	NA	NA	NA	NA	NA	NA	NA	NA	NA	NA	41.04	7.25	33.79	NA	NA
S-4	12/06/2006	NA	NA	NA	NA	NA	NA	NA	NA	NA	NA	NA	41.04	7.39	33.65	NA	NA
S-4	01/30/2007	<50	<0.50	<0.50	<0.50	<1.0	NA	<0.50	NA	NA	NA	NA	41.04	7.24	33.80	NA	NA
S-4	05/15/2007	NA	NA	NA	NA	NA	NA	NA	NA	NA	NA	NA	41.04	6.60	34.44	NA	NA
S-4	08/29/2007	NA	NA	NA	NA	NA	NA	NA	NA	NA	NA	NA	41.04	7.42	33.62	NA	NA
S-4	11/29/2007	NA	NA	NA	NA	NA	NA	NA	NA	NA	NA	NA	41.04	7.22	33.82	NA	NA
S-4	02/21/2008	<50 j	<0.50	<1.0	<1.0	<1.0	NA	<1.0	NA	NA	NA	NA	41.04	6.20	34.84	NA	NA
S-4	05/06/2008	NA	NA	NA	NA	NA	NA	NA	NA	NA	NA	NA	41.04	7.19	33.85	NA	NA
S-4	08/27/2008	NA	NA	NA	NA	NA	NA	NA	NA	NA	NA	NA	41.04	7.52	33.52	NA	NA
S-4	11/24/2008	NA	NA	NA	NA	NA	NA	NA	NA	NA	NA	NA	41.04	7.73	33.31	NA	NA
S-4	01/28/2009	<50	<0.50	<1.0	<1.0	<1.0	NA	<1.0	NA	NA	NA	NA	41.04	7.21	33.83	NA	NA
S-4	05/26/2009	NA	NA	NA	NA	NA	NA	NA	NA	NA	NA	NA	41.04	6.95	34.09	NA	NA
S-4	11/24/2009	<50	<0.50	<1.0	<1.0	<1.0	NA	<1.0	NA	NA	NA	NA	41.04	7.43	33.61	NA	NA
S-4	05/26/2010	NA	NA	NA	NA	NA	NA	NA	NA	NA	NA	NA	41.04	6.68	34.36	NA	NA
S-4	11/30/2010	<50	<0.50	<1.0	<1.0	<1.0	NA	<1.0	NA	NA	NA	NA	41.04	6.87	34.17	NA	NA
S-5	05/13/1991	NA	NA	NA	NA	NA	NA	NA	NA	NA	NA	NA	39.99	14.60	30.57	6.48	NA
S-5	08/23/1991	NA	NA	NA	NA	NA	NA	NA	NA	NA	NA	NA	39.99	15.14	29.25	5.50	NA

WELL CONCENTRATIONS
Shell-branded Service Station
999 San Pablo Avenue
Albany, CA

Well ID	Date	TPPH (ug/L)	B (ug/L)	T (ug/L)	E (ug/L)	X (ug/L)	MTBE 8020 (ug/L)	MTBE 8260 (ug/L)	DIPE (ug/L)	ETBE (ug/L)	TAME (ug/L)	TBA (ug/L)	TOC (MSL)	Depth to Water (ft.)	GW Elevation (MSL)	SPH Thickness (ft.)	DO Reading (ppm)
S-5	11/07/1991	NA	NA	NA	NA	NA	NA	NA	NA	NA	NA	NA	39.99	15.10	29.17	5.35	NA
S-5	01/28/1992	NA	NA	NA	NA	NA	NA	NA	NA	NA	NA	NA	39.99	14.05	29.86	4.90	NA
S-5	05/06/1992	NA	NA	NA	NA	NA	NA	NA	NA	NA	NA	NA	39.99	14.31	30.21	5.66	NA
S-5	08/26/1992	NA	NA	NA	NA	NA	NA	NA	NA	NA	NA	NA	39.99	14.26	28.77	3.80	NA
S-5	10/28/1992	NA	NA	NA	NA	NA	NA	NA	NA	NA	NA	NA	39.99	14.22	28.82	3.81	NA
S-5	01/19/1993	NA	NA	NA	NA	NA	NA	NA	NA	NA	NA	NA	39.99	12.36	30.80	3.96	NA
S-5	04/29/1993	NA	NA	NA	NA	NA	NA	NA	NA	NA	NA	NA	39.99	9.64	31.07	0.90	NA
S-5	07/22/1993	NA	NA	NA	NA	NA	NA	NA	NA	NA	NA	NA	39.99	9.55	31.16	0.90	NA
S-5	10/21/1993	NA	NA	NA	NA	NA	NA	NA	NA	NA	NA	NA	39.99	11.23	29.34	0.73	NA
S-5	01/04/1994	NA	NA	NA	NA	NA	NA	NA	NA	NA	NA	NA	39.99	11.69	29.82	1.90	NA
S-5	04/13/1994	NA	NA	NA	NA	NA	NA	NA	NA	NA	NA	NA	39.99	11.42	29.87	1.62	NA
S-5	07/25/1994	NA	NA	NA	NA	NA	NA	NA	NA	NA	NA	NA	39.99	12.01	29.41	1.79	NA
S-5	10/10/1994	NA	NA	NA	NA	NA	NA	NA	NA	NA	NA	NA	39.99	12.05	29.38	1.80	NA
S-5	01/26/1995	NA	NA	NA	NA	NA	NA	NA	NA	NA	NA	NA	39.99	8.42	32.95	1.72	NA
S-5	04/21/1995	NA	NA	NA	NA	NA	NA	NA	NA	NA	NA	NA	39.99	10.03	30.90	1.17	NA
S-5	07/28/1995	NA	NA	NA	NA	NA	NA	NA	NA	NA	NA	NA	39.99	11.42	30.07	1.87	NA
S-5	10/31/1995	NA	NA	NA	NA	NA	NA	NA	NA	NA	NA	NA	39.99	13.21	27.21	0.54	NA
S-5	01/10/1996	NA	NA	NA	NA	NA	NA	NA	NA	NA	NA	NA	39.99	12.05	28.04	0.13	NA
S-5	04/25/1996	NA	NA	NA	NA	NA	NA	NA	NA	NA	NA	NA	39.99	9.68	30.33	0.03	NA
S-5	07/23/1996	NA	NA	NA	NA	NA	NA	NA	NA	NA	NA	NA	39.99	9.82	30.20	0.04	NA
S-5	12/10/1996	270,000	8,800	29,000	5,200	37,000	<2,500	NA	NA	NA	NA	NA	39.99	9.10	30.91	0.03	NA
S-5 (D)	12/10/1996	400,000	9,200	32,000	7,200	50,000	<2,500	NA	NA	NA	NA	NA	39.99	9.10	30.91	0.03	NA
S-5	02/20/1997	88,000	2,000	11,000	1,600	19,000	<500	NA	NA	NA	NA	NA	39.99	8.93	31.06	NA	5
S-5	05/22/1997	NA	NA	NA	NA	NA	NA	NA	NA	NA	NA	NA	39.99	10.07	29.94	0.02	NA
S-5	08/22/1997	NA	NA	NA	NA	NA	NA	NA	NA	NA	NA	NA	39.99	10.24	29.77	0.02	NA
S-5	11/03/1997	NA	NA	NA	NA	NA	NA	NA	NA	NA	NA	NA	39.99	10.91	29.10	0.02	NA
S-5	02/20/1998	NA	NA	NA	NA	NA	NA	NA	NA	NA	NA	NA	39.99	7.81	32.20	0.03	NA
S-5	05/18/1998	NA	NA	NA	NA	NA	NA	NA	NA	NA	NA	NA	39.99	9.64	30.37	0.02	NA
S-5	05/31/2001	NA	NA	NA	NA	NA	NA	NA	NA	NA	NA	NA	39.99	10.13	29.86	NA	NA

WELL CONCENTRATIONS
Shell-branded Service Station
999 San Pablo Avenue
Albany, CA

Well ID	Date	TPPH (ug/L)	B (ug/L)	T (ug/L)	E (ug/L)	X (ug/L)	MTBE 8020 (ug/L)	MTBE 8260 (ug/L)	DIPE (ug/L)	ETBE (ug/L)	TAME (ug/L)	TBA (ug/L)	TOC (MSL)	Depth to Water (ft.)	GW Elevation (MSL)	SPH Thickness (ft.)	DO Reading (ppm)
S-6	05/13/1991	13,000	600	140	210	310	NA	NA	NA	NA	NA	NA	40.12	7.82	32.30	NA	NA
S-6	08/23/1991	9,800	480	80	120	150	NA	NA	NA	NA	NA	NA	40.12	9.58	30.54	NA	NA
S-6	11/07/1991	6,200	240	23	25	27	NA	NA	NA	NA	NA	NA	40.12	10.86	29.26	NA	NA
S-6	01/28/1992	5,600	250	15	41	36	NA	NA	NA	NA	NA	NA	40.12	8.97	31.15	NA	NA
S-6	05/06/1992	7,100	330	29	110	210	NA	NA	NA	NA	NA	NA	40.12	8.27	31.85	NA	NA
S-6	08/26/1992	13,000	240	<50	56	780	NA	NA	NA	NA	NA	NA	40.12	9.57	31.55	NA	NA
S-6	10/28/1992	10,000	470	210	67	170	NA	NA	NA	NA	NA	NA	40.12	8.90	32.22	NA	NA
S-6	01/19/1993	4,800	100	26	27	45	NA	NA	NA	NA	NA	NA	40.12	4.84	35.28	NA	NA
S-6	04/29/1993	7,000	430	20	<12.5	42	NA	NA	NA	NA	NA	NA	40.12	5.61	34.51	NA	NA
S-6	07/22/1993	5,800	260	120	65	150	NA	NA	NA	NA	NA	NA	40.12	6.56	33.56	NA	NA
S-6	10/21/1993	5,500	270	69	120	140	NA	NA	NA	NA	NA	NA	40.12	8.73	31.39	NA	NA
S-6	01/04/1994	7,100	180	58	63	62	NA	NA	NA	NA	NA	NA	40.12	7.14	32.98	NA	NA
S-6	04/13/1994	NA	NA	NA	NA	NA	NA	NA	NA	NA	NA	NA	40.12	7.21	32.91	NA	NA
S-6	07/25/1994	12,000	190	52	30	39	NA	NA	NA	NA	NA	NA	40.12	6.85	33.27	NA	NA
S-6 (D)	07/25/1994	7,200	170	32	31	34	NA	NA	NA	NA	NA	NA	40.12	6.85	33.27	NA	NA
S-6	10/10/1994	NA	NA	NA	NA	NA	NA	NA	NA	NA	NA	NA	40.12	6.20	33.92	NA	NA
S-6	01/26/1995	5,800	120	23	24	44	NA	NA	NA	NA	NA	NA	40.12	4.89	35.23	NA	NA
S-6	04/21/1995	NA	NA	NA	NA	NA	NA	NA	NA	NA	NA	NA	40.12	5.61	34.51	NA	NA
S-6	07/28/1995	4,400	210	23	34	60	NA	NA	NA	NA	NA	NA	40.12	5.30	34.82	NA	3
S-6 (D)	07/28/1995	6,100	230	20	38	59	NA	NA	NA	NA	NA	NA	40.12	5.30	34.82	NA	3
S-6	10/31/1995	NA	NA	NA	NA	NA	NA	NA	NA	NA	NA	NA	40.12	4.98	35.14	NA	NA
S-6	01/10/1996	6,800	170	87	35	105	NA	NA	NA	NA	NA	NA	40.12	5.67	34.45	NA	2.2
S-6 (D)	01/10/1996	7,800	230	120	50	210	NA	NA	NA	NA	NA	NA	40.12	5.67	34.45	NA	2.2
S-6	04/25/1996	NA	NA	NA	NA	NA	NA	NA	NA	NA	NA	NA	40.12	5.23	34.89	NA	NA
S-6	07/23/1996	2,600	170	<0.5	<0.5	8.5	<25	NA	NA	NA	NA	NA	40.12	5.40	34.72	NA	1.4
S-6	12/10/1996	NA	NA	NA	NA	NA	NA	NA	NA	NA	NA	NA	40.12	6.68	33.44	NA	0.7
S-6	02/20/1997	6,300	160	7.7	14	31	77	NA	NA	NA	NA	NA	40.12	5.70	34.42	NA	2
S-6	05/22/1997	NA	NA	NA	NA	NA	NA	NA	NA	NA	NA	NA	40.12	5.49	34.63	NA	0.9
S-6	08/22/1997	6,200	160	26	15	27	49	NA	NA	NA	NA	NA	40.12	5.71	34.41	NA	2.8

WELL CONCENTRATIONS
Shell-branded Service Station
999 San Pablo Avenue
Albany, CA

Well ID	Date	TPPH (ug/L)	B (ug/L)	T (ug/L)	E (ug/L)	X (ug/L)	MTBE 8020 (ug/L)	MTBE 8260 (ug/L)	DIPE (ug/L)	ETBE (ug/L)	TAME (ug/L)	TBA (ug/L)	TOC (MSL)	Depth to Water (ft.)	GW Elevation (MSL)	SPH Thickness (ft.)	DO Reading (ppm)
S-6	11/03/1997	NA	NA	NA	NA	NA	NA	NA	NA	NA	NA	NA	40.12	6.15	33.97	NA	1.4
S-6	02/20/1998	4,100	150	<10	<10	15	55	NA	NA	NA	NA	NA	40.12	5.25	34.87	NA	0.4
S-6	05/18/1998	NA	NA	NA	NA	NA	NA	NA	NA	NA	NA	NA	40.12	5.69	34.43	NA	0.4
S-6	08/20/1998	7,800	240	38	16	39	110	NA	NA	NA	NA	NA	40.12	6.04	34.08	NA	1.5
S-6 (D) b	08/20/1998	8,400	270	30	19	31	130	NA	NA	NA	NA	NA	40.12	6.04	34.08	NA	1.5
S-6	11/06/1998	NA	NA	NA	NA	NA	NA	NA	NA	NA	NA	NA	40.12	6.10	34.02	NA	NA
S-6	02/16/1999	6,000	190	19	14	20	<2.5	NA	NA	NA	NA	NA	40.12	5.84	34.28	NA	1.7
S-6	05/28/1999	NA	NA	NA	NA	NA	NA	NA	NA	NA	NA	NA	40.12	9.51	30.61	NA	1.9
S-6	08/24/1999	6,870	193	32.1	18.8	36.4	<25.0	NA	NA	NA	NA	NA	40.12	8.29	31.83	NA	2.7
S-6	11/16/1999	NA	NA	NA	NA	NA	NA	NA	NA	NA	NA	NA	40.12	5.93	34.19	NA	2.6
S-6	02/02/2000	2,310	164	122	28.6	133	63.1	NA	NA	NA	NA	NA	40.12	5.33	34.79	NA	2.6
S-6	05/09/2000	NA	NA	NA	NA	NA	NA	NA	NA	NA	NA	NA	40.12	6.41	33.71	NA	2.4
S-6	08/03/2000	5,600	188	27.4	<10.0	25.2	174	NA	NA	NA	NA	NA	40.12	5.84	34.28	NA	2.7
S-6	11/15/2000	NA	NA	NA	NA	NA	NA	NA	NA	NA	NA	NA	40.12	5.58	34.54	NA	2.3
S-6	02/14/2001	6,140	126	13.2	8.01	18.0	205	NA	NA	NA	NA	NA	40.12	5.50	34.62	NA	1.3
S-6	05/31/2001	NA	NA	NA	NA	NA	NA	NA	NA	NA	NA	NA	40.12	5.52	34.60	NA	1.2
S-6	08/15/2001	6,000	160	9.1	5.8	24	NA	51	NA	NA	NA	NA	40.12	6.04	34.08	NA	0.4
S-6	12/31/2001	6,900	120	12	6.6	24	NA	44	NA	NA	NA	NA	40.12	5.52	34.60	NA	0.4
S-6	02/06/2002	4,300	110	7.3	4.8	18	NA	39	NA	NA	NA	NA	40.12	6.34	33.78	NA	0.5
S-6	06/04/2002	4,300	140	8.4	4.9	22	NA	26	NA	NA	NA	NA	40.12	6.19	33.93	NA	0.4
S-6	07/25/2002	3,900	140	9.0	5.5	23	NA	31	NA	NA	NA	NA	39.92	6.05	33.87	NA	0.7
S-6	11/27/2002	5,200	160	9.6	4.9	24	NA	26	NA	NA	NA	NA	39.92	6.26	33.66	NA	NA
S-6	01/30/2003	4,700	200	9.6	5.5	25	NA	30	NA	NA	NA	NA	39.92	5.73	34.19	NA	NA
S-6	06/03/2003	3,900	160	10	<10	25	NA	30	NA	NA	NA	NA	39.92	5.52	34.40	NA	NA
S-6	08/08/2003	2,900	150	8.8	3.6	18	NA	18	NA	NA	NA	NA	39.92	6.14	33.78	NA	NA
S-6	11/13/2003	8,300	220	19	11	35	NA	28	NA	NA	NA	NA	39.92	5.85	34.07	NA	NA
S-6	02/04/2004	7,400	310	17	10	31	NA	30	NA	NA	NA	NA	39.92	5.51	34.41	NA	NA
S-6	05/12/2004	4,000	230	10	5.5	24	NA	21	NA	NA	NA	NA	39.92	6.10	33.82	NA	NA
S-6	08/23/2004	6,000	260	16	9.0	32	NA	19	NA	NA	NA	NA	39.92	6.38	33.54	NA	NA

WELL CONCENTRATIONS
Shell-branded Service Station
999 San Pablo Avenue
Albany, CA

Well ID	Date	TPPH (ug/L)	B (ug/L)	T (ug/L)	E (ug/L)	X (ug/L)	MTBE 8020 (ug/L)	MTBE 8260 (ug/L)	DIPE (ug/L)	ETBE (ug/L)	TAME (ug/L)	TBA (ug/L)	TOC (MSL)	Depth to Water (ft.)	GW Elevation (MSL)	SPH Thickness (ft.)	DO Reading (ppm)
---------	------	----------------	-------------	-------------	-------------	-------------	------------------------	------------------------	----------------	----------------	----------------	---------------	--------------	----------------------------	--------------------------	---------------------------	------------------------

S-6	12/01/2004	9,600	280	23	11	47	NA	24	NA	NA	NA	NA	39.92	6.41	33.51	NA	NA
S-6	02/07/2005	7,100	300	14	8.4	35	NA	21	NA	NA	NA	NA	39.92	5.94	33.98	NA	NA
S-6	05/02/2005	6,100	250	12	8.1	30	NA	16	NA	NA	NA	NA	39.92	5.90	34.02	NA	NA
S-6	08/04/2005	5,200	180	13	8.0	31	NA	15	NA	NA	NA	NA	39.92	6.67	33.25	NA	NA
S-6	11/16/2005	9,950	147	15.3	9.82	32.3	NA	10.8	NA	NA	NA	NA	39.92	6.64	33.28	NA	NA
S-6	03/02/2006	2,400	72	9.2	7.0	21	NA	6.4	NA	NA	NA	NA	39.92	5.92	34.00	NA	NA
S-6	05/31/2006	9,460	182	13.6	8.80	33.5	NA	11.4 i	NA	NA	NA	NA	39.92	6.28	33.64	NA	NA
S-6	08/29/2006	8,840	108	26.6	12.4	37.7	NA	10.1	NA	NA	NA	NA	39.92	7.19	32.73	NA	NA
S-6	12/06/2006	4,900	130	17	8.2	35	NA	9.4	NA	NA	NA	NA	39.92	7.06	32.86	NA	NA
S-6	01/30/2007	4,500	100	22	12	38	NA	8.1	NA	NA	NA	NA	39.92	6.94	32.98	NA	NA
S-6	05/15/2007	6,900 j	120	9.2	6.7	27.6	NA	6.4	NA	NA	NA	NA	39.92	6.30	33.62	NA	NA
S-6	08/29/2007	9,300 j	110	30	14	52	NA	6.4	5.3 l	<10	<10	<50	39.92	7.27	32.65	NA	NA
S-6	11/29/2007	4,300 j	110	19 m	14	53	NA	8.7	NA	NA	NA	NA	39.92	6.87	33.05	NA	NA
S-6	02/21/2008	5,600 j	110	8.6	5.0	28.3	NA	6.4	NA	NA	NA	NA	39.92	5.75	34.17	NA	NA
S-6	05/06/2008	5,900	110	12	7.5	30.1	NA	<1.0	NA	NA	NA	NA	39.92	6.60	33.32	NA	NA
S-6	08/27/2008	6,200	58	15	7.0	27.9	NA	<2.0	NA	NA	NA	NA	39.92	7.40	32.52	NA	NA
S-6	11/24/2008	6,100	80	20	12	40.0	NA	<2.0	NA	NA	NA	NA	39.92	7.30	32.62	NA	NA
S-6	11/24/2008	6,100	80	20	12	40.0	NA	<2.0	NA	NA	NA	NA	39.92	7.30	32.62	NA	NA
S-6	01/28/2009	5,300	80	10	6.3	26	NA	<1.0	NA	NA	NA	NA	39.92	6.61	33.31	NA	NA
S-6	05/26/2009	6,600	130	6.6	4.4	21	NA	4.9	NA	NA	NA	NA	39.92	6.70	33.22	NA	NA
S-6	11/24/2009	6,200	69	13	8.4	32	NA	4.5	NA	NA	NA	NA	39.92	7.03	32.89	NA	NA
S-6	05/26/2010	5,100	130	8.3	4.8	27	NA	6.1	NA	NA	NA	NA	39.92	6.24	33.68	NA	NA
S-6	11/30/2010	5,500	74	10	6.2	32	NA	5.6	NA	NA	NA	NA	39.92	6.12	33.80	NA	NA

S-7	05/13/1991	<50	<0.5	<0.5	<0.5	<0.5	NA	NA	NA	NA	NA	NA	40.10	10.56	29.54	NA	NA
S-7	08/23/1991	<50	<0.5	<0.5	<0.5	<0.5	NA	NA	NA	NA	NA	NA	40.10	11.16	28.94	NA	NA
S-7	11/07/1991	<50	<0.5	<0.5	<0.5	<0.5	NA	NA	NA	NA	NA	NA	40.10	11.48	28.62	NA	NA
S-7	01/28/1992	<50	<0.5	<0.5	<0.5	<0.5	NA	NA	NA	NA	NA	NA	40.10	10.72	29.38	NA	NA
S-7	05/06/1992	<50	<0.5	<0.5	<0.5	<0.5	NA	NA	NA	NA	NA	NA	40.10	10.34	29.76	NA	NA
S-7	08/26/1992	160	<0.5	<0.5	<0.5	<0.5	NA	NA	NA	NA	NA	NA	40.10	11.13	28.97	NA	NA

WELL CONCENTRATIONS
Shell-branded Service Station
999 San Pablo Avenue
Albany, CA

Well ID	Date	TPPH (ug/L)	B (ug/L)	T (ug/L)	E (ug/L)	X (ug/L)	MTBE 8020 (ug/L)	MTBE 8260 (ug/L)	DIPE (ug/L)	ETBE (ug/L)	TAME (ug/L)	TBA (ug/L)	TOC (MSL)	Depth to Water (ft.)	GW Elevation (MSL)	SPH Thickness (ft.)	DO Reading (ppm)
S-7	10/28/1992	<50	<0.5	<0.5	<0.5	<0.5	NA	NA	NA	NA	NA	NA	40.10	11.52	28.58	NA	NA
S-7	01/19/1993	50	1.1	0.6	1.9	9.2	NA	NA	NA	NA	NA	NA	40.10	8.68	31.42	NA	NA
S-7	04/29/1993	<50	<0.5	<0.5	<0.5	<0.5	NA	NA	NA	NA	NA	NA	40.10	9.90	30.20	NA	NA
S-7	07/22/1993	Well inaccessible		NA	NA	NA	NA	NA	NA	NA	NA	NA	40.10	NA	NA	NA	NA
S-7	10/21/1993	<50	<0.5	<0.5	<0.5	<0.5	NA	NA	NA	NA	NA	NA	40.10	11.10	29.00	NA	NA
S-7	01/04/1994	<50	<0.5	<0.5	<0.5	<0.5	NA	NA	NA	NA	NA	NA	40.10	10.40	29.70	NA	NA
S-7	04/13/1994	<50	1.4	0.61	<0.5	0.64	NA	NA	NA	NA	NA	NA	40.10	10.20	29.90	NA	NA
S-7 (D)	04/13/1994	<50	1.4	0.61	<0.5	0.66	NA	NA	NA	NA	NA	NA	40.10	10.20	29.90	NA	NA
S-7	07/25/1994	<50	<0.5	<0.5	<0.5	<0.5	NA	NA	NA	NA	NA	NA	40.10	10.48	29.62	NA	NA
S-7 a	10/10/1994	<50	<0.5	<0.5	<0.5	<0.5	NA	NA	NA	NA	NA	NA	40.10	10.64	29.46	NA	NA
S-7	01/26/1995	<50	<0.5	<0.5	<0.5	<0.5	NA	NA	NA	NA	NA	NA	40.10	7.75	32.35	NA	4.6
S-7	04/21/1995	<50	<0.5	<0.5	<0.5	<0.5	NA	NA	NA	NA	NA	NA	40.10	8.51	31.59	NA	NA
S-7	07/28/1995	<50	<0.5	<0.5	<0.5	<0.5	NA	NA	NA	NA	NA	NA	40.10	10.20	29.90	NA	3
S-7	10/31/1995	<50	<0.5	<0.5	<0.5	<0.5	NA	NA	NA	NA	NA	NA	40.10	10.86	29.24	NA	4.9
S-7	01/10/1996	<50	<0.5	2	<0.5	2.6	NA	NA	NA	NA	NA	NA	40.10	10.33	29.77	NA	7.6
S-7	04/25/1996	<50	<0.5	<0.5	<0.5	<0.5	<2.5	NA	NA	NA	NA	NA	40.10	9.13	30.97	NA	6.2
S-7	07/23/1996	<50	<0.5	<0.5	<0.5	<0.5	14	NA	NA	NA	NA	NA	40.10	10.18	29.92	NA	3.7
S-7	12/10/1996	<50	<0.5	<0.5	<0.5	<0.5	<2.5	NA	NA	NA	NA	NA	40.10	9.04	31.06	NA	4.6
S-7	02/20/1997	<50	<0.50	<0.50	<0.50	<0.50	<2.5	NA	NA	NA	NA	NA	40.10	9.60	30.50	NA	5
S-7	05/22/1997	<50	1.3	<0.50	<0.50	<0.50	5.5	NA	NA	NA	NA	NA	40.10	10.63	29.47	NA	0.8
S-7	08/22/1997	<50	<0.50	<0.50	<0.50	<0.50	<2.5	NA	NA	NA	NA	NA	40.10	10.95	29.15	NA	2.6
S-7	11/03/1997	<50	2.2	1.7	0.58	3.4	<2.5	NA	NA	NA	NA	NA	40.10	11.29	28.81	NA	2.6
S-7	02/20/1998	350	23	13	14	42	3.8	NA	NA	NA	NA	NA	40.10	7.73	32.37	NA	4.6
S-7	05/18/1998	<50	<0.50	<0.50	<0.50	<0.50	<2.5	NA	NA	NA	NA	NA	40.10	10.29	29.81	NA	4.4
S-7	08/20/1998	Well inaccessible		NA	NA	NA	NA	NA	NA	NA	NA	NA	40.10	11.00	29.10	NA	5.4
S-7	11/06/1998	<50	<0.50	<0.50	<0.50	<0.50	<2.5	NA	NA	NA	NA	NA	40.10	11.19	28.91	NA	5.2
S-7	02/16/1999	Well inaccessible		NA	NA	NA	NA	NA	NA	NA	NA	NA	40.10	NA	NA	NA	NA
S-7	05/28/1999	<50.0	<0.500	<0.500	<0.500	<0.500	<5.00	NA	NA	NA	NA	NA	40.10	9.76	30.34	NA	2.7
S-7	08/24/1999	<50.0	<0.500	<0.500	<0.500	<0.500	<2.50	NA	NA	NA	NA	NA	40.10	10.61	29.49	NA	2.1

WELL CONCENTRATIONS
Shell-branded Service Station
999 San Pablo Avenue
Albany, CA

Well ID	Date	TPPH (ug/L)	B (ug/L)	T (ug/L)	E (ug/L)	X (ug/L)	MTBE 8020 (ug/L)	MTBE 8260 (ug/L)	DIPE (ug/L)	ETBE (ug/L)	TAME (ug/L)	TBA (ug/L)	TOC (MSL)	Depth to Water (ft.)	GW Elevation (MSL)	SPH Thickness (ft.)	DO Reading (ppm)
S-7	11/16/1999	<50.0	<0.500	<0.500	<0.500	<0.500	3.68	NA	NA	NA	NA	NA	40.10	10.90	29.20	NA	2.3
S-7	02/02/2000	<50.0	<0.500	<0.500	<0.500	<0.500	<5.00	NA	NA	NA	NA	NA	40.10	10.30	29.80	NA	2.1
S-7	05/09/2000	<50.0	<0.500	<0.500	<0.500	<0.500	<2.50	NA	NA	NA	NA	NA	40.10	10.25	29.85	NA	2.7
S-7	08/03/2000	<50.0	<0.500	<0.500	<0.500	<0.500	<2.50	NA	NA	NA	NA	NA	40.10	10.65	29.45	NA	2.5
S-7	11/15/2000	<50.0	<0.500	<0.500	<0.500	<0.500	<2.50	NA	NA	NA	NA	NA	40.10	10.53	29.57	NA	4.6
S-7	02/14/2001	Well inaccessible		NA	NA	NA	NA	NA	NA	NA	NA	NA	40.10	NA	NA	NA	NA
S-7	05/31/2001	<50	<0.50	<0.50	<0.50	0.77	NA	4.6	NA	NA	NA	NA	40.10	9.46	30.64	NA	2.1
S-7	08/15/2001	<50	<0.50	<0.50	<0.50	<0.50	NA	<5.0	NA	NA	NA	NA	40.10	10.93	29.17	NA	2.0
S-7	12/31/2001	<50	<0.50	<0.50	<0.50	<0.50	NA	6.0	NA	NA	NA	NA	40.10	9.14	30.96	NA	3.0
S-7	02/06/2002	<50	<0.50	<0.50	<0.50	<0.50	NA	<5.0	NA	NA	NA	NA	40.10	8.61	31.49	NA	3.2
S-7	06/04/2002	<50	<0.50	<0.50	<0.50	<0.50	NA	<5.0	NA	NA	NA	NA	40.10	10.41	29.69	NA	0.9
S-7	07/25/2002	<50	<0.50	<0.50	<0.50	<0.50	NA	<5.0	NA	NA	NA	NA	39.91	10.37	29.54	NA	1.1
S-7	11/27/2002	<50	<0.50	<0.50	<0.50	<0.50	NA	<5.0	NA	NA	NA	NA	39.91	10.52	29.39	NA	NA
S-7	01/30/2003	<50	<0.50	<0.50	<0.50	<0.50	NA	<5.0	NA	NA	NA	NA	39.91	9.38	30.53	NA	NA
S-7	06/03/2003	<50	<0.50	<0.50	<0.50	<1.0	NA	0.72	NA	NA	NA	NA	39.91	10.18	29.73	NA	NA
S-7	08/08/2003	<50	<0.50	<0.50	<0.50	<1.0	NA	<0.50	NA	NA	NA	NA	39.91	10.43	29.48	NA	NA
S-7	11/13/2003	<50	<0.50	<0.50	<0.50	<1.0	NA	<0.50	NA	NA	NA	NA	39.91	10.39	29.52	NA	NA
S-7	02/04/2004	<50	<0.50	<0.50	<0.50	<1.0	NA	<0.50	NA	NA	NA	NA	39.91	9.17	30.74	NA	NA
S-7	05/12/2004	<50	<0.50	<0.50	<0.50	<1.0	NA	<0.50	NA	NA	NA	NA	39.91	10.20	29.71	NA	NA
S-7	08/23/2004	<50	<0.50	<0.50	<0.50	<1.0	NA	<0.50	NA	NA	NA	NA	39.72 f	10.53	29.19	NA	NA
S-7	12/01/2004	<50	<0.50	<0.50	<0.50	<1.0	NA	<0.50	NA	NA	NA	NA	39.72	10.36	29.36	NA	NA
S-7	02/07/2005	<50	<0.50	<0.50	<0.50	<1.0	NA	<0.50	NA	NA	NA	NA	39.72	8.78	30.94	NA	NA
S-7	05/02/2005	<50	<0.50	<0.50	<0.50	<1.0	NA	<0.50	NA	NA	NA	NA	39.72	9.46	30.26	NA	NA
S-7	08/04/2005	Well paved over		NA	NA	NA	NA	NA	NA	NA	NA	NA	NA	NA	NA	NA	NA
S-7	11/16/2005	Well paved over		NA	NA	NA	NA	NA	NA	NA	NA	NA	NA	NA	NA	NA	NA
S-7	03/02/2006	Well paved over		NA	NA	NA	NA	NA	NA	NA	NA	NA	NA	NA	NA	NA	NA
S-7	05/31/2006	Well paved over		NA	NA	NA	NA	NA	NA	NA	NA	NA	NA	NA	NA	NA	NA
S-7	08/29/2006	Well paved over		NA	NA	NA	NA	NA	NA	NA	NA	NA	NA	NA	NA	NA	NA
S-7	12/06/2006	Well paved over		NA	NA	NA	NA	NA	NA	NA	NA	NA	NA	NA	NA	NA	NA

WELL CONCENTRATIONS
Shell-branded Service Station
999 San Pablo Avenue
Albany, CA

Well ID	Date	TPPH (ug/L)	B (ug/L)	T (ug/L)	E (ug/L)	X (ug/L)	MTBE 8020 (ug/L)	MTBE 8260 (ug/L)	DIPE (ug/L)	ETBE (ug/L)	TAME (ug/L)	TBA (ug/L)	TOC (MSL)	Depth to Water (ft.)	GW Elevation (MSL)	SPH Thickness (ft.)	DO Reading (ppm)
---------	------	----------------	-------------	-------------	-------------	-------------	------------------------	------------------------	----------------	----------------	----------------	---------------	--------------	----------------------------	--------------------------	---------------------------	------------------------

S-7	01/30/2007	Well paved over	NA	NA	NA	NA	NA	NA	NA	NA	NA	NA	NA	NA	NA	NA	NA
S-7	05/15/2007	Well paved over	NA	NA	NA	NA	NA	NA	NA	NA	NA	NA	NA	NA	NA	NA	NA
S-7	08/29/2007	Well paved over	NA	NA	NA	NA	NA	NA	NA	NA	NA	NA	NA	NA	NA	NA	NA
S-7	11/29/2007	Well paved over	NA	NA	NA	NA	NA	NA	NA	NA	NA	NA	NA	NA	NA	NA	NA
S-7	02/21/2008	Well paved over	NA	NA	NA	NA	NA	NA	NA	NA	NA	NA	NA	NA	NA	NA	NA
S-7	05/06/2008	Well paved over	NA	NA	NA	NA	NA	NA	NA	NA	NA	NA	NA	NA	NA	NA	NA
S-7	08/27/2008	Well paved over	NA	NA	NA	NA	NA	NA	NA	NA	NA	NA	NA	NA	NA	NA	NA
S-7	11/24/2008	Well paved over	NA	NA	NA	NA	NA	NA	NA	NA	NA	NA	NA	NA	NA	NA	NA
S-7	01/28/2009	Well paved over	NA	NA	NA	NA	NA	NA	NA	NA	NA	NA	NA	NA	NA	NA	NA

S-8	05/10/2004	NA	NA	NA	NA	NA	NA	NA	NA	NA	NA	NA	40.52	10.85	29.67	NA	NA
S-8	05/12/2004	<1,300	<13	<13	<13	<25	NA	2,500	NA	NA	NA	NA	40.52	10.95	29.57	NA	NA
S-8	08/23/2004	1,300	15	<13	<13	<25	NA	2,500	<50	<50	<50	570	40.52	11.40	29.12	NA	NA
S-8	12/01/2004	1,400 h	<13	<13	<13	<25	NA	2,700	NA	NA	NA	NA	40.52	11.10	29.42	NA	NA
S-8	02/07/2005	6,400	240	27	290	100	NA	370	NA	NA	NA	NA	40.52	10.22	30.30	NA	NA
S-8	05/02/2005	6,300	160	25	200	74	NA	190	NA	NA	NA	NA	40.52	10.05	30.47	NA	NA
S-8	08/04/2005	2,500	130	7.5	<6.0	14	NA	290	<8.0	<8.0	<8.0	92	40.52	10.88	29.64	NA	NA
S-8	11/16/2005	27,700	43.2	4.36	637	1,200	NA	638	NA	NA	NA	NA	40.52	11.28	29.24	NA	NA
S-8	03/02/2006	9,900	160	13	490	530	NA	110	NA	NA	NA	NA	40.52	8.85	31.67	NA	NA
S-8	05/31/2006	14,300	270	53.1	283	246	NA	102 i	NA	NA	NA	NA	40.52	10.34	30.18	NA	NA
S-8	08/29/2006	14,700	107	9.42	196	195	NA	278	<0.500	<0.500	<0.500	36.1	40.52	11.17	29.35	NA	NA
S-8	12/06/2006	7,800	150	8.6	120	110	NA	200	NA	NA	NA	NA	40.52	11.21	29.31	NA	NA
S-8	01/30/2007	7,500	220	18	180	96	NA	170	NA	NA	NA	NA	40.52	10.72	29.80	NA	NA
S-8	05/15/2007	9,600 j	NA	24	160	112	NA	130	NA	NA	NA	NA	40.52	10.50	30.02	NA	NA
S-8	08/29/2007	NA	NA	NA	NA	NA	NA	NA	NA	NA	NA	NA	40.52	11.44	29.11	0.04	NA
S-8	08/30/2007	6,100 j	35	2.7	140	234	NA	170	<4.0	<4.0	<4.0	820	40.52	11.37	29.25	0.13	NA
S-8	09/25/2007	NA	NA	NA	NA	NA	NA	NA	NA	NA	NA	NA	40.52	11.56	29.22	0.32	NA
S-8	10/29/2007	NA	NA	NA	NA	NA	NA	NA	NA	NA	NA	NA	40.52	11.23	29.50	0.26	NA
S-8	11/29/2007	NA	NA	NA	NA	NA	NA	NA	NA	NA	NA	NA	40.52	11.08	29.60	0.20	NA

WELL CONCENTRATIONS
Shell-branded Service Station
999 San Pablo Avenue
Albany, CA

Well ID	Date	TPPH (ug/L)	B (ug/L)	T (ug/L)	E (ug/L)	X (ug/L)	MTBE 8020 (ug/L)	MTBE 8260 (ug/L)	DIPE (ug/L)	ETBE (ug/L)	TAME (ug/L)	TBA (ug/L)	TOC (MSL)	Depth to Water (ft.)	GW Elevation (MSL)	SPH Thickness (ft.)	DO Reading (ppm)
---------	------	----------------	-------------	-------------	-------------	-------------	------------------------	------------------------	----------------	----------------	----------------	---------------	--------------	----------------------------	--------------------------	---------------------------	------------------------

S-8	12/11/2007	NA	NA	NA	NA	NA	NA	NA	NA	NA	NA	NA	40.52	10.61	30.03	0.15	NA
S-8	01/24/2008	NA	NA	NA	NA	NA	NA	NA	NA	NA	NA	NA	40.52	9.61	30.97	0.08	NA
S-8	02/21/2008	NA	NA	NA	NA	NA	NA	NA	NA	NA	NA	NA	40.52	9.11	31.43	0.03	NA
S-8	03/20/2008	NA	NA	NA	NA	NA	NA	NA	NA	NA	NA	NA	40.52	10.22	30.40	0.12	NA
S-8	04/30/2008	NA	NA	NA	NA	NA	NA	NA	NA	NA	NA	NA	40.52	10.91	29.67	0.07	NA
S-8	05/06/2008	NA	NA	NA	NA	NA	NA	NA	NA	NA	NA	NA	40.52	10.50	30.05	0.04	NA
S-8	06/04/2008	NA	NA	NA	NA	NA	NA	NA	NA	NA	NA	NA	40.52	11.34	29.24	0.07	NA
S-8	07/29/2008	NA	NA	NA	NA	NA	NA	NA	NA	NA	NA	NA	40.52	11.83	28.71	0.03	NA
S-8	08/27/2008	NA	NA	NA	NA	NA	NA	NA	NA	NA	NA	NA	40.52	11.40	29.14	0.03	NA
S-8	09/30/2008	NA	NA	NA	NA	NA	NA	NA	NA	NA	NA	NA	40.52	12.08	28.46	0.03	NA
S-8	10/31/2008	NA	NA	NA	NA	NA	NA	NA	NA	NA	NA	NA	40.52	11.35	29.37	0.25	NA
S-8	11/24/2008	NA	NA	NA	NA	NA	NA	NA	NA	NA	NA	NA	40.52	10.79	29.89	0.20	NA
S-8	12/30/2008	NA	NA	NA	NA	NA	NA	NA	NA	NA	NA	NA	40.52	8.90	31.75	0.16	NA
S-8	01/14/2009	NA	NA	NA	NA	NA	NA	NA	NA	NA	NA	NA	40.52	9.87	30.83	0.22	NA
S-8	01/28/2009	NA	NA	NA	NA	NA	NA	NA	NA	NA	NA	NA	40.52	9.52	31.10	0.13	NA
S-8	03/31/2009	NA	NA	NA	NA	NA	NA	NA	NA	NA	NA	NA	40.52	8.56	32.11	0.19	NA
S-8	04/21/2009	NA	NA	NA	NA	NA	NA	NA	NA	NA	NA	NA	40.52	8.90	31.75	0.16	NA
S-8	05/26/2009	NA	NA	NA	NA	NA	NA	NA	NA	NA	NA	NA	40.52	9.04	31.57	0.11	NA
S-8	06/30/2009	NA	NA	NA	NA	NA	NA	NA	NA	NA	NA	NA	40.52	10.28	30.32	0.10	NA
S-8	07/23/2009	NA	NA	NA	NA	NA	NA	NA	NA	NA	NA	NA	40.52	10.37	30.25	0.13	NA
S-8	08/31/2009	NA	NA	NA	NA	NA	NA	NA	NA	NA	NA	NA	40.52	10.78	29.80	0.08	NA
S-8	11/24/2009	NA	NA	NA	NA	NA	NA	NA	NA	NA	NA	NA	40.52	9.73	30.84	0.06	NA
S-8	05/26/2010	59,000	150	32	2,100	4,400	NA	78	NA	NA	NA	NA	40.52	7.59	32.93	0.00	NA
S-8	11/30/2010	NA	NA	NA	NA	NA	NA	NA	NA	NA	NA	NA	40.52	8.34	32.23	0.06	NA

S-9	05/10/2004	NA	NA	NA	NA	NA	NA	NA	NA	NA	NA	NA	39.72	10.34	29.38	NA	NA
S-9	05/12/2004	<50	<0.50	<0.50	<0.50	<1.0	NA	<0.50	NA	NA	NA	NA	39.72	10.42	29.30	NA	NA
S-9	08/23/2004	<50	<0.50	<0.50	<0.50	<1.0	NA	<0.50	NA	NA	NA	NA	39.72	11.32	28.40	NA	NA
S-9	12/01/2004	Unable to locate		NA	NA	NA	NA	NA	NA	NA	NA	NA	39.72	NA	NA	NA	NA

WELL CONCENTRATIONS
Shell-branded Service Station
999 San Pablo Avenue
Albany, CA

Well ID	Date	TPPH (ug/L)	B (ug/L)	T (ug/L)	E (ug/L)	X (ug/L)	MTBE 8020 (ug/L)	MTBE 8260 (ug/L)	DIPE (ug/L)	ETBE (ug/L)	TAME (ug/L)	TBA (ug/L)	TOC (MSL)	Depth to Water (ft.)	GW Elevation (MSL)	SPH Thickness (ft.)	DO Reading (ppm)
S-9	02/07/2005	<50	<0.50	<0.50	<0.50	<1.0	NA	<0.50	NA	NA	NA	NA	39.72	8.74	30.98	NA	NA
S-9	05/02/2005	Well inaccessible		NA	NA	NA	NA	NA	NA	NA	NA	NA	39.72	NA	NA	NA	NA
S-9	08/04/2005	<50	<0.50	<0.50	<0.50	<1.0	NA	<0.50	NA	NA	NA	NA	39.72	8.79	30.93	NA	NA
S-9	11/16/2005	<50.0	<0.500	<0.500	<0.500	<0.500	NA	<0.500	NA	NA	NA	NA	39.72	10.30	29.42	NA	NA
S-9	03/02/2006	<50	<0.50	<0.50	<0.50	<0.50	NA	<0.50	NA	NA	NA	NA	39.72	5.86	33.86	NA	NA
S-9	05/31/2006	<50.0	<0.500	<0.500	<0.500	0.540	NA	<0.500	NA	NA	NA	NA	39.72	9.85	29.87	NA	NA
S-9	08/29/2006	<50.0	<0.500	<0.500	<0.500	<0.500	NA	<0.500	NA	NA	NA	NA	39.72	10.75	28.97	NA	NA
S-9	12/06/2006	<50	<0.50	<0.50	<0.50	<1.0	NA	<0.50	NA	NA	NA	NA	39.72	10.60	29.12	NA	NA
S-9	01/30/2007	<50	<0.50	<0.50	<0.50	<1.0	NA	<0.50	NA	NA	NA	NA	39.72	10.45	29.27	NA	NA
S-9	05/15/2007	61 j,k	<0.50	<1.0	<1.0	<1.0	NA	<1.0	NA	NA	NA	NA	39.72	10.15	29.57	NA	NA
S-9	08/29/2007	71 j	<0.50	<1.0	1.3	2.1	NA	<1.0	<2.0	<2.0	<2.0	<10	39.72	10.96	28.76	NA	NA
S-9	11/29/2007	Well inaccessible		NA	NA	NA	NA	NA	NA	NA	NA	NA	39.72	NA	NA	NA	NA
S-9	02/21/2008	<50 j	<0.50	<1.0	<1.0	<1.0	NA	<1.0	NA	NA	NA	NA	39.72	7.36	32.36	NA	NA
S-9	05/06/2008	<50	<0.50	<1.0	<1.0	<1.0	NA	<1.0	NA	NA	NA	NA	39.72	10.49	29.23	NA	NA
S-9	08/27/2008	<50	<0.50	<1.0	<1.0	<1.0	NA	<1.0	NA	NA	NA	NA	39.72	11.19	28.53	NA	NA
S-9	11/24/2008	<50	<0.50	<1.0	<1.0	<1.0	NA	<1.0	NA	NA	NA	NA	39.72	10.91	28.81	NA	NA
S-9	01/28/2009	Well inaccessible			NA	NA	NA	NA	NA	NA	NA	NA	39.72	NA	NA	NA	NA
S-9	05/26/2009	<50	<0.50	<1.0	<1.0	<1.0	NA	<1.0	NA	NA	NA	NA	39.72	10.20	29.52	NA	NA
S-9	11/24/2009	<50	<0.50	<1.0	<1.0	<1.0	NA	<1.0	NA	NA	NA	NA	39.72	10.52	29.20	NA	NA
S-9	05/26/2010	<50	<0.50	<1.0	<1.0	<1.0	NA	<1.0	NA	NA	NA	NA	39.72	7.09	32.63	NA	NA
S-9	11/30/2010	<50	<0.50	<1.0	<1.0	<1.0	NA	<1.0	NA	NA	NA	NA	39.72	7.42	32.30	NA	NA

WELL CONCENTRATIONS
Shell-branded Service Station
999 San Pablo Avenue
Albany, CA

Well ID	Date	TPPH (ug/L)	B (ug/L)	T (ug/L)	E (ug/L)	X (ug/L)	MTBE 8020 (ug/L)	MTBE 8260 (ug/L)	DIPE (ug/L)	ETBE (ug/L)	TAME (ug/L)	TBA (ug/L)	TOC (MSL)	Depth to Water (ft.)	GW Elevation (MSL)	SPH Thickness (ft.)	DO Reading (ppm)
---------	------	----------------	-------------	-------------	-------------	-------------	------------------------	------------------------	----------------	----------------	----------------	---------------	--------------	----------------------------	--------------------------	---------------------------	------------------------

Abbreviations:

TPPH = Total petroleum hydrocarbons as gasoline by EPA Method 8260B; prior to May 31, 2001, analyzed by EPA Method 8015.

BTEX = Benzene, toluene, ethylbenzene, xylenes by EPA Method 8260B; prior to May 31, 2001, analyzed by EPA Method 8020.

MTBE = Methyl tertiary butyl ether

DIPE = Di-isopropyl ether, analyzed by EPA Method 8260B

ETBE = Ethyl tertiary butyl ether, analyzed by EPA Method 8260B

TAME = Tertiary amyl methyl ether, analyzed by EPA Method 8260B

TBA = Tertiary butyl alcohol, analyzed by EPA Method 8260B

TOC = Top of Casing Elevation

TOB = Top of Wellbox Elevation

SPH = Separate-Phase Hydrocarbons

GW = Groundwater

DO = Dissolved Oxygen

ug/L = Parts per billion

mg/L = Parts per million

MSL = Mean sea level

ft. = Feet

ppm = Parts per million

<n = Below detection limit

(D) = Duplicate sample

NA = Not applicable

WELL CONCENTRATIONS
Shell-branded Service Station
999 San Pablo Avenue
Albany, CA

Well ID	Date	TPPH (ug/L)	B (ug/L)	T (ug/L)	E (ug/L)	X (ug/L)	MTBE 8020 (ug/L)	MTBE 8260 (ug/L)	DIPE (ug/L)	ETBE (ug/L)	TAME (ug/L)	TBA (ug/L)	TOC (MSL)	Depth to Water (ft.)	GW Elevation (MSL)	SPH Thickness (ft.)	DO Reading (ppm)
---------	------	----------------	-------------	-------------	-------------	-------------	------------------------	------------------------	----------------	----------------	----------------	---------------	--------------	----------------------------	--------------------------	---------------------------	------------------------

Notes:

a = Sample analyzed for total dissolved solids (450 mg/L).

b = Surrogate recovery outside QC limits due to matrix effect.

c = Chromatogram pattern indicated an unidentified hydrocarbon.

d = This sample analyzed outside of EPA recommended hold time.

e = Concentration is an estimate value above the linear quantitation range.

f = Top of casing elevation lowered 0.19 feet on June 22, 2004 due to wellhead maintenance.

g = Hydrocarbon reported does not match the laboratory standard.

h = Quantity of unknown hydrocarbon(s) in sample based on gasoline.

i = Secondary ion abundances were outside method requirements. Identification based on analytical judgement.

j = Analyzed by EPA Method 8015B (M).

k = The sample chromatographic pattern for TPH does not match the chromatographic pattern of the specified standard. Quantitation of the unknown hydrocarbon(s) in the sample was based upon the specified standard.

l = Analyte was detected at a concentration below the reporting limit and above the laboratory method detection limit. Reported value is estimated.

m = Analyte was present in the associated method blank.

When separate-phase hydrocarbons are present, ground water elevation is adjusted using the relation:

Corrected ground water elevation = Top-of-casing elevation - depth to water + (0.8 x hydrocarbon thickness).

Ownership of well S-5 is being transferred to Arco.

Beginning July 25, 2002 depth to waters referenced to Top of Casing.

Site surveyed January 9, 2002 by Virgil Chavez Land Surveying of Vallejo, CA.

Wells S-8 and S-9 surveyed May 11, 2004 by Virgil Chavez Land Surveying of Vallejo, CA.

APPENDIX C

HISTORICAL GROUNDWATER DATA TABLES

**Table 1
Groundwater Monitoring Data**

**ARCO Service Station No. 2035
1001 San Pablo Avenue, Albany, California**

Well Number	TOC Elevation (ft-MSL)	Depth to Water (feet)	FP Thickness (feet)	Groundwater Elevation [1] (ft-MSL)	Date Sampled	TPHg (µg/L)	Benzene (µg/L)	Toluene (µg/L)	Ethyl-benzene (µg/L)	Total Xylenes (µg/L)	MTBE 8021B+ (µg/L)	MTBE 8240/8260 (µg/L)	Dissolved Oxygen (mg/L)	Purged/ Not Purged (P/NP)
MW-1	41.41	6.21	0.00	35.20	03-23-91	8,800	3,600	<50	62	99	--	--	--	--
MW-1	41.41	9.37	0.00	32.04	05-23-91	4,800	2,000	<20	52	<20	--	--	--	--
MW-1	41.41	10.30	0.00	31.11	08-21-91	780	310	<2.5	12	<2.5	14	--	--	--
MW-1	41.41	12.25	0.00	29.16	11-08-91	58	14	<0.5	<0.5	<0.5	--	--	--	--
MW-1	41.41	9.08	0.00	32.33	02-26-92	2,700	930	12	18	32	51	--	--	--
MW-1	41.41	9.11	0.00	32.30	04-21-92	2,700	1,000	<10	22	<10	<60	--	--	--
MW-1	41.41	10.37	0.00	31.04	08-14-92	300	52	<0.5	0.9	<0.5	22	--	--	--
MW-1	41.41	8.79	0.00	32.62	12-09-92	270	63	0.7	<0.5	1	25	--	--	--
MW-1	41.41	9.80	0.00	31.61	03-26-93	1,500	610	<5	15	7	56	--	--	--
MW-1	41.41	9.65	0.00	31.76	05-21-93	110	6	<0.5	<0.5	0.7	10	--	--	--
MW-1	41.41	10.22	0.00	31.19	09-03-93	180	40	<0.5	1.2	0.5	26	--	--	--
MW-1	41.41	10.68	0.00	30.73	11-02-93	83	8	<0.5	<0.5	<0.5	13	--	--	--
MW-1	41.41	6.92	0.00	34.49	02-19-94	1,800	540	7	27	31	46	--	--	--
MW-1	41.41	9.28	0.00	32.13	05-17-94	4,500	1,300	20	57	20	<60	--	--	--
MW-1	41.41	10.05	0.00	31.36	08-20-94	530	110	<5	<5	<5	400	--	--	--
MW-1	41.41	10.42	0.00	30.99	10-19-94	66	9.1	<0.5	<0.5	<0.5	8	--	--	--
MW-1	41.41	8.10	0.00	33.31	02-15-95	1,200	390	<5	<5	6	45	--	--	--
MW-1	41.41	9.53	0.00	31.88	05-23-95	1,300	600	3	13	3	26	--	--	--
MW-1	41.41	10.03	0.00	31.38	08-23-95	100	21	1.3	<0.5	<0.5	8	--	0.55	P
MW-1	41.41	9.80	0.00	31.61	11-15-95	99	10	0.6	<0.5	<1	7	--	2.1	P
MW-1	41.41	8.82	0.00	32.59	02-01-96	400	93	1.6	3.6	3.7	19	--	1.0	P
DUP I	--	--	--	--	06-20-96	416	88.4	<2.50	4.61	1.56	<5.00	--	--	--
MW-1	41.41	9.60	0.00	31.81	06-20-96	444	100	<2.50	4.15	<2.50	15.9	--	1.7	P
MW-1	41.41	9.50	0.00	31.91	11-05-96	73.2	17.8	<0.500	<0.500	<0.500	7.80	--	1.04	P
MW-1	41.41	9.28	0.00	32.13	05-03-97	714	392	<5.00	<5.00	<5.00	26.1	--	--	P
MW-1	41.41	10.50	0.00	30.91	10-02-97	<50	<0.50	<0.50	<0.50	<0.50	<2.5	--	0.59	P
DUP I	--	--	--	--	10-02-97	<50	<0.50	<0.50	<0.50	0.52	<2.5	--	--	--

**Table 1
Groundwater Monitoring Data**

**ARCO Service Station No. 2035
1001 San Pablo Avenue, Albany, California**

Well Number	TOC Elevation (ft-MSL)	Depth to Water (feet)	FP Thickness (feet)	Groundwater Elevation [1] (ft-MSL)	Date Sampled	TPHg (µg/L)	Benzene (µg/L)	Toluene (µg/L)	Ethyl-benzenc (µg/L)	Total Xylenes (µg/L)	MTBE 8021B* (µg/L)	MTBE 8240/8260 (µg/L)	Dissolved Oxygen (mg/L)	Purged/ Not Purged (P/NP)
MW-2	40.38	6.96	0.00	33.42	03-23-91	<50	<0.5	<0.5	<0.5	<0.5	--	--	--	--
MW-2	40.38	10.02	0.00	30.36	05-23-91	Not sampled: well sampled semi-annually, during the first and third quarters								
MW-2	40.38	10.87	0.00	29.51	08-21-91	<50	<0.5	<0.5	<0.5	<0.5	<3	--	--	--
MW-2	40.38	13.12	0.00	27.26	11-08-91	Not sampled: well sampled semi-annually, during the first and third quarters								
MW-2	40.38	10.25	0.00	30.13	02-26-92	<50	<0.5	<0.5	<0.5	<0.5	<3	--	--	--
MW-2	40.38	9.98	0.00	30.40	04-21-92	Not sampled: well sampled semi-annually, during the first and third quarters								
MW-2	40.38	11.10	0.00	29.28	08-14-92	<50	<0.5	<0.5	<0.5	<0.5	4	--	--	--
MW-2	40.38	10.00	0.00	30.38	12-09-92	Not sampled: well sampled semi-annually, during the first and third quarters								
MW-2	40.38	10.38	0.00	30.00	03-26-93	<50	<0.5	<0.5	<0.5	<0.5	12	--	--	--
MW-2	40.38	10.65	0.00	29.73	05-21-93	Not sampled: well sampled semi-annually, during the first and third quarters								
MW-2	40.38	10.87	0.00	29.51	09-03-93	<50	<0.5	<0.5	<0.5	<0.5	19	--	--	--
MW-2	40.38	11.25	0.00	29.13	11-02-93	<50	<0.5	<0.5	<0.5	<0.5	18	--	--	--
MW-2	40.38	7.69	0.00	32.69	02-19-94	<50	0.5	<0.5	<0.5	<0.5	12	--	--	--
MW-2	40.38	9.88	0.00	30.50	05-17-94	<50	<0.5	<0.5	<0.5	<0.5	10	--	--	--
MW-2	40.38	10.62	0.00	29.76	08-20-94	<50	<0.5	<0.5	<0.5	<0.5	3	--	--	--
MW-2	40.38	11.00	0.00	29.38	10-19-94	<50	<0.5	<0.5	<0.5	<0.5	31	--	--	--
MW-2	40.38	9.04	0.00	31.34	02-15-95	<50	<0.5	<0.5	<0.5	<0.5	13	--	--	--
MW-2	40.38	9.90	0.00	30.48	05-23-95	<50	0.6	<0.5	<0.5	<0.5	47	--	--	--
MW-2	40.38	10.60	0.00	29.78	08-23-95	<50	<0.5	<0.5	<0.5	<0.5	20	--	0.88	P
MW-2	40.38	10.45	0.00	29.93	11-15-95	<50	<0.5	<0.5	<0.5	<1	<3	--	2.5	P
MW-2	40.38	9.49	0.00	30.89	02-01-96	<50	<0.5	<0.5	<0.5	<1	59	--	1.0	P
MW-2	40.38	10.30	0.00	30.08	06-20-96	<50.0	<0.500	<0.500	<0.500	<0.500	4.17	--	1.5	P
MW-2	40.38	10.19	0.00	30.19	11-05-96	<50.0	<0.500	<0.500	<0.500	<0.500	30.6	--	1.27	P
MW-2	40.38	10.15	0.00	30.23	05-03-97	<50.0	<0.500	<0.500	<0.500	<0.500	32.7	--	--	P
DUP	--	--	--	--	05-03-97	<50.0	<0.500	<0.500	<0.500	<0.500	31.5	--	--	--
MW-2	40.38	10.97	0.00	29.41	10-02-97	<50	<0.50	<0.50	<0.50	<0.50	<2.5	--	0.63	P

**Table 1
Groundwater Monitoring Data**

**ARCO Service Station No. 2035
1001 San Pablo Avenue, Albany, California**

Well Number	TOC Elevation (ft-MSL)	Depth to Water (feet)	FP Thickness (feet)	Groundwater Elevation [1] (ft-MSL)	Date Sampled	TPHg (µg/L)	Benzene (µg/L)	Toluene (µg/L)	Ethyl- benzene (µg/L)	Total Xylenes (µg/L)	MTBE 8021B* (µg/L)	MTBE 8240/8260 (µg/L)	Dissolved Oxygen (mg/L)	Purged/ Not Purged (P/NP)
MW-3	41.44	7.29	0.00	34.15	03-23-91	51	0.8	<0.5	2.4	<0.5	--	--	--	--
MW-3	41.44	9.53	0.00	31.91	05-23-91	<50	<0.5	<0.5	<0.5	<0.5	--	--	--	--
MW-3	41.44	11.19	0.00	30.25	08-21-91	<50	<0.5	<0.5	<0.5	<0.5	79	--	--	--
MW-3	41.44	12.77	0.00	28.67	11-08-91	<50	<0.5	<0.5	<0.5	<0.5	--	--	--	--
MW-3	41.44	9.41	0.00	32.03	02-26-92	120	3.6	<0.5	2.2	3.7	90	--	--	--
MW-3	41.44	9.63	0.00	31.81	04-21-92	<50	<0.5	<0.5	<0.5	<0.5	90	--	--	--
MW-3	41.44	11.12	0.00	30.32	08-14-92	<50	<0.5	<0.5	<0.5	<0.5	54	--	--	--
MW-3	41.44	10.34	0.00	31.10	12-09-92	71	<0.5	<0.5	<0.5	<0.5	130	--	--	--
MW-3	41.44	10.28	0.00	31.16	03-26-93	<100	<1	<1	<1	<1	170	--	--	--
MW-3	41.44	10.40	0.00	31.04	05-21-93	<100	<1	<1	<1	<1	95	--	--	--
MW-3	41.44	10.75	0.00	30.69	09-03-93	<50	<0.5	<0.5	<0.5	<0.5	37	--	--	--
MW-3	41.44	11.44	0.00	30.00	11-02-93	<200	<2	<2	<2	<2	130	--	--	--
MW-3	41.44	7.48	0.00	33.96	02-19-94	<200	<2	5	<2	8	140	--	--	--
MW-3	41.44	9.87	0.00	31.57	05-17-94	<100	<1	<1	<1	<1	150	--	--	--
MW-3	41.44	10.72	0.00	30.72	08-20-94	<200	<2	<2	<2	<2	210	--	--	--
MW-3	41.44	11.30	0.00	30.14	10-19-94	<200	<2	<2	<2	<2	270	--	--	--
MW-3	41.44	8.60	0.00	32.84	02-15-95	<500	<5	<5	<5	<5	700	--	--	--
MW-3	41.44	9.87	0.00	31.57	05-23-95	<50	<0.5	<0.5	<0.5	<0.5	150	140	--	--
MW-3	41.44	10.83	0.00	30.61	08-23-95	<50	<0.5	<0.5	<0.5	<0.5	54	71	0.41	P
MW-3	41.44	10.54	0.00	30.90	11-15-95	100	<0.5	3.3	<0.5	<1	500	--	6.2	P
MW-3	41.44	5.69	0.00	35.75	02-01-96	18,000	1,000	45	1,500	940	100	--	2.12	P
MW-3	41.44	9.99	0.00	31.45	06-20-96	90.9	1.52	<0.500	<0.500	<0.500	187	--	2.6	P
MW-3	41.44	10.15	0.00	31.29	11-05-96	138	2.37	<0.500	<0.500	<0.500	216	--	0.47	P
MW-3	41.44	10.17	0.00	31.27	05-03-97	316	15.7	1.14	<0.500	<0.500	178	--	--	P
MW-3	41.44	10.99	0.00	30.45	10-02-97	120	<0.50	<0.50	<0.50	<0.50	120	--	0.47	P

**Table 1
Groundwater Monitoring Data**

**ARCO Service Station No. 2035
1001 San Pablo Avenue, Albany, California**

Well Number	TOC Elevation (ft-MSL)	Depth to Water (feet)	FP Thickness (feet)	Groundwater Elevation [1] (ft-MSL)	Date Sampled	TPHg (µg/L)	Benzene (µg/L)	Toluene (µg/L)	Ethyl-benzene (µg/L)	Total Xylenes (µg/L)	MTBE 8021B* (µg/L)	MTBE 8240/8260 (µg/L)	Dissolved Oxygen (mg/L)	Purged/Not Purged (P/NP)
MW-4	40.33	5.92	0.00	34.41	03-23-91	<50	<0.5	<0.5	<0.5	<0.5	--	--	--	--
MW-4	40.33	9.23	0.00	31.10	05-23-91	<50	<0.5	<0.5	<0.5	<0.5	--	--	--	--
MW-4	40.33	10.61	0.00	29.72	08-21-91	<50	<0.5	<0.5	<0.5	<0.5	99	--	--	--
MW-4	40.33	11.97	0.00	28.36	11-08-91	<50	<0.5	<0.5	<0.5	<0.5	--	89	--	--
MW-4	40.33	8.84	0.00	31.49	02-26-92	<50	0.8	<0.5	<0.5	<0.5	<3	--	--	--
MW-4	40.33	9.15	0.00	31.18	04-21-92	Not sampled: well sampled annually, during the first quarter							--	--
MW-4	40.33	10.35	0.00	29.98	08-14-92	Not sampled: well sampled annually, during the first quarter							--	--
MW-4	40.33	8.70	0.00	31.63	12-09-92	Not sampled: well sampled annually, during the first quarter							--	--
MW-4	40.33	9.75	0.00	30.58	03-26-93	<5,000	<50	<50	<50	<50	4,200	--	--	--
MW-4	40.33	9.91	0.00	30.42	05-21-93	Not sampled: well sampled annually, during the first quarter							--	--
MW-4	40.33	10.25	0.00	30.08	09-03-93	Not sampled: well sampled annually, during the first quarter							--	--
MW-4	40.33	10.79	0.00	29.54	11-02-93	<50	<0.5	<0.5	<0.5	<0.5	<3	--	--	--
MW-4	40.33	6.78	0.00	33.55	02-19-94	<2,000	<20	<20	<20	<20	3,300	--	--	--
MW-4	40.33	9.26	0.00	31.07	05-17-94	<50	<0.5	<0.5	<0.5	<0.5	<3	--	--	--
MW-4	40.33	10.10	0.00	30.23	08-20-94	<50	<0.5	<0.5	<0.5	<0.5	9	--	--	--
MW-4	40.33	10.43	0.00	29.90	10-19-94	<50	<0.5	<0.5	<0.5	<0.5	17	--	--	--
MW-4	40.33	8.56	0.00	31.77	02-15-95	<500	<5	<5	<5	<5	400	--	--	--
MW-4	40.33	9.52	0.00	30.81	05-23-95	<50	<0.5	<0.5	<0.5	<0.5	10	7.6	--	--
MW-4	40.33	9.99	0.00	30.34	08-23-95	<2,500	<25	<25	<25	<25	1,200	1,300	0.84	NP
MW-4	40.33	9.80	0.00	30.53	11-15-95	<50	<0.5	<0.5	<0.5	<1	<3	--	0.0	NP
MW-4	40.33	9.11	0.00	31.22	02-01-96	<50	<0.5	<0.5	<0.5	<1	1,200	--	1.0	NP
MW-4	40.33	9.60	0.00	30.73	06-20-96	<50.0	<0.500	<0.500	<0.500	<0.500	60.5	--	1.3	NP
MW-4	40.33	9.53	0.00	30.80	11-05-96	<50.0	<0.500	<0.500	<0.500	<0.500	14.0	--	0.71	NP
MW-4	40.33	9.21	0.00	31.12	05-03-97	<50.0	<0.500	<0.500	<0.500	<0.500	83.6	--	--	NP
MW-4	40.33	10.74	0.00	29.59	10-02-97	<50	<0.50	<0.50	<0.50	<0.50	260	--	0.59	NP

**Table 1
Groundwater Monitoring Data**

**ARCO Service Station No. 2035
1001 San Pablo Avenue, Albany, California**

Well Number	TOC Elevation (ft-MSL)	Depth to Water (feet)	FP Thickness (feet)	Groundwater Elevation [1] (ft-MSL)	Date Sampled	TPHg (µg/L)	Benzene (µg/L)	Toluene (µg/L)	Ethyl-benzene (µg/L)	Total Xylenes (µg/L)	MTBE 8021B* (µg/L)	MTBE 8240/8260 (µg/L)	Dissolved Oxygen (mg/L)	Purged/ Not Purged (P/NP)		
MW-5	41.84	6.23	0.00	35.61	03-23-91	<50	<0.5	<0.5	<0.5	<0.5	--	--	--	--		
MW-5	41.84	9.61	0.00	32.23	05-23-91	Not sampled: well sampled annually, during the first quarter									--	--
MW-5	41.84	11.12	0.00	30.72	08-21-91	Not sampled: well sampled annually, during the first quarter									--	--
MW-5	41.84	12.52	0.00	29.32	11-08-91	Not sampled: well sampled annually, during the first quarter									--	--
MW-5	41.84	9.52	0.00	32.32	02-26-92	<50	<0.5	<0.5	<0.5	<0.5	<3	--	--	--		
MW-5	41.84	9.44	0.00	32.40	04-21-92	Not sampled: well sampled annually, during the first quarter									--	--
MW-5	41.84	10.83	0.00	31.01	08-14-92	Not sampled: well sampled annually, during the first quarter									--	--
MW-5	41.84	9.20	0.00	32.64	12-09-92	Not sampled: well sampled annually, during the first quarter									--	--
MW-5	41.84	10.10	0.00	31.74	03-26-93	<50	<0.5	<0.5	<0.5	<0.5	<3	--	--	--		
MW-5	41.84	10.28	0.00	31.56	05-21-93	Not sampled: well sampled annually, during the first quarter									--	--
MW-5	41.84	10.73	0.00	31.11	09-03-93	Not sampled: well sampled annually, during the first quarter									--	--
MW-5	41.84	11.23	0.00	30.61	11-02-93	Not sampled: well sampled annually, during the first quarter									--	--
MW-5	41.84	6.67	0.00	35.17	02-19-94	<50	<0.5	<0.5	<0.5	<0.5	<3	--	--	--		
MW-5	41.84	9.61	0.00	32.23	05-17-94	Not sampled: well sampled annually, during the first quarter									--	--
MW-5	41.84	10.58	0.00	31.26	08-20-94	Not sampled: well sampled annually, during the first quarter									--	--
MW-5	41.84	10.66	0.00	31.18	10-19-94	Not sampled: well sampled annually, during the first quarter									--	--
MW-5	41.84	8.35	0.00	33.49	02-15-95	Not sampled									--	--
MW-5	41.84	9.95	0.00	31.89	05-23-95	<50	<0.5	<0.5	<0.5	<0.5	<3	--	--	--		
MW-5	41.84	10.51	0.00	31.33	08-23-95	<50	<0.5	<0.5	<0.5	<0.5	<3	--	0.79	NP		
MW-5	41.84	10.37	0.00	31.47	11-15-95	Not sampled: well sampled annually, during the second quarter									--	--
MW-5	41.84	9.35	0.00	32.49	02-01-96	<50	<0.5	<0.5	<0.5	<1	<3	--	1.0	NP		
MW-5	41.84	10.03	0.00	31.81	06-20-96	<50.0	<0.500	<0.500	<0.500	<0.500	<2.50	--	3.1	NP		
MW-5	41.84	9.89	0.00	31.95	11-05-96	Not sampled: well sampled annually, during the second quarter									--	--
MW-5	41.84	9.42	0.00	32.42	05-03-97	<50.0	<0.500	<0.500	<0.500	<0.500	<2.50	--	--	NP		
MW-5	41.84	10.55	0.00	31.29	10-02-97	Not sampled: well sampled annually, during the second quarter									--	--

**Table 1
Groundwater Monitoring Data**

**ARCO Service Station No. 2035
1001 San Pablo Avenue, Albany, California**

Well Number	TOC Elevation (ft.-MSL)	Depth to Water (feet)	FP Thickness (feet)	Groundwater Elevation [1] (ft.-MSL)	Date Sampled	TPHg (µg/L)	Benzene (µg/L)	Toluene (µg/L)	Ethyl-benzene (µg/L)	Total Xylenes (µg/L)	MTBE 8021B* (µg/L)	MTBE 8240/8260 (µg/L)	Dissolved Oxygen (mg/L)	Purged/ Not Purged (P/NP)	
MW-6	40.13	9.03	0.00	31.10	03-23-91	<50	<0.5	<0.5	<0.5	<0.5	--	--	--	--	
MW-6	40.13	12.45	0.00	27.68	05-23-91	Not sampled: well sampled annually, during the first quarter								--	--
MW-6	40.13	13.32	0.00	26.81	08-21-91	Not sampled: well sampled annually, during the first quarter								--	--
MW-6	40.13	14.13	0.00	26.00	11-08-91	Not sampled: well sampled annually, during the first quarter								--	--
MW-6	40.13	11.86	0.00	28.27	02-26-92	<50	<0.5	<0.5	<0.5	<0.5	<3	--	--	--	
MW-6	40.13	12.35	0.00	27.78	04-21-92	Not sampled: well sampled annually, during the first quarter								--	--
MW-6	40.13	13.18	0.00	26.95	08-14-92	Not sampled: well sampled annually, during the first quarter								--	--
MW-6	40.13	11.94	0.00	28.19	12-09-92	Not sampled: well sampled annually, during the first quarter								--	--
MW-6	40.13	13.10	0.00	27.03	03-26-93	<50	<0.5	<0.5	<0.5	<0.5	<3	--	--	--	
MW-6	40.13	13.00	0.00	27.13	05-21-93	Not sampled: well sampled annually, during the first quarter								--	--
MW-6	40.13	13.30	0.00	26.83	09-03-93	Not sampled: well sampled annually, during the first quarter								--	--
MW-6	40.13	13.42	0.00	26.71	11-02-93	<50	<0.5	<0.5	<0.5	<0.5	19	--	--	--	
MW-6	40.13	10.57	0.00	29.56	02-19-94	<100	<1	<1	<1	<1	95	--	--	--	
MW-6	40.13	12.64	0.00	27.49	05-17-94	<100	<1	<1	<1	<1	180	--	--	--	
MW-6	40.13	13.13	0.00	27.00	08-20-94	<100	<1	<1	<1	<1	180	--	--	--	
MW-6	40.13	13.48	0.00	26.65	10-19-94	<100	<1	<1	<1	<1	180	--	--	--	
MW-6	40.13	11.92	0.00	28.21	02-15-95	<200	<2	<2	<2	<2	200	--	--	--	
MW-6	40.13	12.80	0.00	27.33	05-23-95	<50	<0.5	<0.5	<0.5	<0.5	120	--	--	--	
MW-6	40.13	13.03	0.00	27.10	08-23-95	<50	<0.5	<0.5	<0.5	<0.5	44	--	0.46	NP	
MW-6	40.13	12.70	0.00	27.43	11-15-95	<50	<0.5	<0.5	<0.5	<1	17	17	0.0	NP	
MW-6	40.13	8.61	0.00	31.52	02-01-96	<50	<0.5	<0.5	<0.5	<1	6	--	1.0	NP	
MW-6	40.13	12.88	0.00	27.25	06-20-96	<50.0	<0.500	<0.500	<0.500	<0.500	2.57	--	2.8	NP	
MW-6	40.13	12.74	0.00	27.39	11-05-96	<50.0	<0.500	<0.500	<0.500	<0.500	3.77	--	1.51	NP	
DUP	--	--	--	--	11-05-96	<50.0	<0.500	<0.500	<0.500	<0.500	4.03	--	--	--	
MW-6	40.13	11.29	0.00	28.84	05-03-97	<50.0	<0.500	<0.500	<0.500	<0.500	10.5	12.3	--	NP	
MW-6	40.13	11.35	0.00	28.78	10-02-97	<50	<0.50	<0.50	<0.50	<0.50	5.8	4.8	0.61	NP	

**Table 1
Groundwater Monitoring Data**

**ARCO Service Station No. 2035
1001 San Pablo Avenue, Albany, California**

Well Number	TOC Elevation (ft-MSL)	Depth to Water (feet)	FP Thickness (feet)	Groundwater Elevation [1] (ft-MSL)	Date Sampled	TPHg ($\mu\text{g/L}$)	Benzene ($\mu\text{g/L}$)	Toluene ($\mu\text{g/L}$)	Ethyl-benzene ($\mu\text{g/L}$)	Total Xylenes ($\mu\text{g/L}$)	MTBE 8021B* ($\mu\text{g/L}$)	MTBE 8240/8260 ($\mu\text{g/L}$)	Dissolved Oxygen (mg/L)	Purged/Not Purged (P/NP)
RW-1	40.33	9.32	0.01	31.02	03-23-91	11,000	560	660	150	1,700	--	--	--	--
RW-1	40.33	9.75	0.03	30.60	05-23-91	Not sampled: well contained floating product							--	--
RW-1	40.33	10.86	0.02	29.48	08-21-91	Not sampled: well contained floating product							--	--
RW-1	40.33	20.61	0.00	19.72	11-08-91	1,600	79	46	13	240	--	--	--	--
RW-1	40.33	16.56	0.00	23.77	02-26-92	210	44	7.5	2.5	24	29	--	--	--
RW-1	40.33	9.65	0.00	30.68	04-21-92	36,000	7,400	3,700	580	3,400	<300	--	--	--
RW-1	40.33	10.60	0.00	29.73	08-14-92	1,800	31	38	15	150	<30	--	--	--
RW-1	40.33	8.72	0.00	31.61	12-09-92	25,000	1,900	1,000	330	3,200	<100	--	--	--
RW-1	40.33	10.33	0.00	30.00	03-26-93	7,200	1,900	59	95	240	480	--	--	--
RW-1	40.33	10.10	0.00	30.23	05-21-93	3,000	630	84	45	340	<60	--	--	--
RW-1	40.33	10.42	0.00	29.91	09-03-93	7,100	120	55	14	160	<60	--	--	--
RW-1	40.33	9.10	0.00	31.23	11-02-93	<200	14	19	3	19	140	--	--	--
RW-1	40.33	7.49	0.00	32.84	02-19-94	3,800	1,000	85	64	220	950	--	--	--
RW-1	40.33	8.90	0.00	31.43	05-17-94	<200	45	<2	2	4	220	--	--	--
RW-1	40.33	11.06	0.00	29.27	08-20-94	480	200	<2	<2	30	180	--	--	--
RW-1	40.33	11.12	0.00	29.21	10-19-94	110	36	2.9	<0.5	4.1	5	--	--	--
RW-1	40.33	7.70	0.00	32.63	02-16-95	250	61	2	2	19	94	--	--	--
RW-1	40.33	11.12	0.00	29.21	05-23-95	4,500	2,000	7	<2	180	35	--	--	--
RW-1	40.33	10.15	0.00	30.18	08-23-95	2,600	1,100	6.3	2.3	17	39	--	0.52	NP
RW-1	40.33	9.95	0.00	30.38	11-15-95	1,200	2,600	16	86	41	140	--	1.4	P
RW-1	40.33	11.88	0.00	28.45	02-01-96	11,000	980	230	200	1,400	38	--	1.0	NP
RW-1	40.33	9.83	0.00	30.50	06-20-96	899	278	<2.50	8.70	8.46	61.1	--	1.3	NP
RW-1	40.33	8.45	0.00	31.88	11-05-96	156,000	3,260	28,800	4,570	25,700	26,200	--	0.63	P
RW-1	40.33	8.57	0.00	31.76	05-03-97	244,000	8,420	56,000	5,660	36,200	23,400	11,000	--	P
RW-1	40.33	9.13	0.00	31.20	10-02-97	120,000	2,500	33,000	3,800	21,000	3,300	--	0.38	P

**Table 1
Groundwater Monitoring Data**

**ARCO Service Station No. 2035
1001 San Pablo Avenue, Albany, California**

Well Number	TOC Elevation (ft-MSL)	Depth to Water (feet)	FP Thickness (feet)	Groundwater Elevation [1] (ft-MSL)	Date Sampled	TPHg ($\mu\text{g/L}$)	Benzene ($\mu\text{g/L}$)	Toluene ($\mu\text{g/L}$)	Ethylbenzene ($\mu\text{g/L}$)	Total Xylenes ($\mu\text{g/L}$)	MTBE 8021B* ($\mu\text{g/L}$)	MTBE 8240/8260 ($\mu\text{g/L}$)	Dissolved Oxygen (mg/L)	Purged/Not Purged (P/NP)
S-5	--	--	--	--	05-30-97	310,000	3,000	11,000	4,000	34,000	<2,500	--	--	--
S-5	--	10.00	--	--	10-02-97	70,000	1,800	7,800	1,400	20,000	<120	--	0.25	NP

TOC: top of casing

ft-MSL: elevation in feet, relative to mean sea level

TPH: total petroleum hydrocarbons as gasoline, California DHS LUFT Method

BTEX: benzene, toluene, ethylbenzene, total xylenes by EPA method 8021B. (EPA method 8020 prior to 11/16/99).

MTBE: Methyl tert-butyl ether

$\mu\text{g/L}$: micrograms per liter

mg/L: milligrams per liter

--: not analyzed or not applicable

<: denotes concentration not present at or above laboratory detection limit stated to the right.

[1] = Computed by adding correction factor to groundwater elevation. Correction factor = free product thickness times 0.73 (approximate specific gravity of gasoline).

*: EPA method 8020 prior to 11/16/99

** : For previous historical groundwater elevation and analytical data please refer to *Fourth Quarter 1995 Groundwater Monitoring Program Results and Remediation System Performance Evaluation Report, ARCO Service Station 2035, Albany, California*, (EMCON, March 25, 1996).

DUP: duplicate sample

Table 3
 Historical Groundwater Analytical Data
 Petroleum Hydrocarbons and Their Constituents
 1994 - Present*

ARCO Service Station 2035
 1001 San Pablo Avenue, Albany, California

Date: 12-22-03

Well Designation	Water Sample Field Date	TPHC	Benzene	Toluene	Ethylbenzene	Total Xylenes	MIBC	MTBE	Oil and Grease SM 5520B&F	Oil and Grease SM 5520C	Oil and Grease SM 5520F	TPH	PHD
		LUFT Method µg/L	EPA 8020 µg/L	EPA 8020 µg/L	EPA 8020 µg/L	EPA 8020 µg/L	EPA 8020 µg/L	EPA 8240 µg/L	µg/L	µg/L	µg/L	EPA 418.1 µg/L	LUFT Method µg/L
MW-1	01-31-90	<50	13	<0.5	0.5	0.6	--	--	--	--	--	--	--
MW-1	04-25-90	990	290	3.5	18	14	--	--	--	--	--	--	--
MW-1	07-28-90	760	280	<2.5	7.1	<2.5	--	--	--	--	--	--	--
MW-1	11-14-90	570	150	7.3	<2.5	30	--	--	--	--	--	--	--
MW-1	03-23-91	8800	3600	<50	62	99	--	--	--	--	--	--	--
MW-1	05-23-91	4800	2000	<20	52	<20	--	--	--	--	--	--	--
MW-1	08-21-91	780	310	<2.5	12	<2.5	14	--	--	--	--	--	--
MW-1	11-08-91	58	14	<0.5	<0.5	<0.5	--	--	--	--	--	--	--
MW-1	02-26-92	2700	930	12	18	32	51	--	--	--	--	--	--
MW-1	04-21-92	2700	1000	<10	22	<10	<60	--	--	--	--	--	--
MW-2	01-31-90	<50	<0.5	<0.5	<0.5	<0.5	--	--	--	--	--	--	--
MW-2	04-25-90	<50	<0.5	<0.5	<0.5	<0.5	--	--	--	--	--	--	--
MW-2	07-28-90	<50	<0.5	<0.5	<0.5	<0.5	--	--	--	--	--	--	--
MW-2	11-14-90	<50	<0.5	<0.5	<0.5	<0.5	--	--	--	--	--	--	--
MW-2	03-23-91	<50	<0.5	<0.5	<0.5	<0.5	--	--	--	--	--	--	--
MW-2	05-23-91	Not sampled: not scheduled for chemical analysis											
MW-2	08-21-91	<50	<0.5	<0.5	<0.5	<0.5	<3	--	--	--	--	--	--
MW-2	11-08-91	Not sampled: not scheduled for chemical analysis											
MW-2	02-26-92	<50	<0.5	<0.5	<0.5	<0.5	<3	--	--	--	--	--	--
MW-2	04-21-92	Not sampled: not scheduled for chemical analysis											
MW-3	01-31-90	<50	1.9	<0.5	2.1	<0.5	--	--	--	<500	<500	--	--
MW-3	04-25-90	<50	1.1	<0.5	2.4	0.9	--	--	--	--	--	<600	--
MW-3	07-28-90	<50	<0.5	<0.5	<0.5	<0.5	--	--	--	--	--	600	--
MW-3	11-14-90	<50	<0.5	<0.5	<0.5	<0.5	--	--	--	--	--	<500	--
MW-3	03-23-91	51	0.8	<0.5	2.4	<0.5	--	--	--	--	--	<500	--
MW-3	05-23-91	<50	<0.5	<0.5	<0.5	<0.5	--	--	--	--	--	<500	--
MW-3	08-21-91	<50	<0.5	<0.5	<0.5	<0.5	79	--	--	--	--	<500	--
MW-3	11-08-91	<50	<0.5	<0.5	<0.5	<0.5	--	--	--	--	--	600	--
MW-3	02-26-92	120	3.6	<0.5	2.2	3.7	90	--	--	--	--	<0.5	--
MW-3	04-21-92	<50	<0.5	<0.5	<0.5	<0.5	90	--	--	--	--	--	--
MW-4	01-31-90	<50	<0.5	<0.5	<0.5	<0.5	--	--	--	--	--	--	--
MW-4	04-25-90	<50	<0.5	<0.5	<0.5	<0.5	--	--	--	--	--	--	--
MW-4	07-28-90	<50	<0.5	<0.5	<0.5	<0.5	--	--	--	--	--	--	--
MW-4	11-14-90	220	12	19	0.9	39	--	--	--	--	--	--	--
MW-4	03-23-91	<50	<0.5	<0.5	<0.5	<0.5	--	--	--	--	--	--	--
MW-4	05-23-91	<50	<0.5	<0.5	<0.5	<0.5	--	--	--	--	--	--	--
MW-4	08-21-91	<50	<0.5	<0.5	<0.5	<0.5	99	--	--	--	--	--	--
MW-4	11-08-91	<50	<0.5	<0.5	<0.5	<0.5	--	89	--	--	--	--	--
MW-4	02-26-92	<50	0.8	<0.5	<0.5	<0.5	<3	--	--	--	--	--	--
MW-4	04-21-92	Not sampled: not scheduled for chemical analysis											

Table 3
 Historical Groundwater Analytical Data
 Petroleum Hydrocarbons and Their Constituents
 1994 - Present*

ARCO Service Station 2035

1001 San Pablo Avenue, Albany, California

Date: 12-22-03

Well Designation	Water Sample Field Date	TPHG LUFT Method	Benzene	Toluene	Ethylbenzene	Total Xylenes	MTBE	MTBE	Oil and Grease SM 5520C&F	Oil and Grease SM 5520C	Oil and Grease SM 5520F	TPHH EPA 418.1	TPHD LUFT Method
			EPA 8070	EPA 8070	EPA 8070	EPA 8070							
MW-5	01-31-90	<50	<0.5	<0.5	<0.5	<0.5	--	--	--	--	--	--	--
MW-5	04-25-90	<50	<0.5	<0.5	<0.5	<0.5	--	--	--	--	--	--	--
MW-5	07-28-90	<50	<0.5	<0.5	<0.5	<0.5	--	--	--	--	--	--	--
MW-5	11-14-90	<50	<0.5	<0.5	<0.5	<0.5	--	--	--	--	--	--	--
MW-5	03-23-91	<50	<0.5	<0.5	<0.5	<0.5	--	--	--	--	--	--	--
MW-5	05-23-91	Not sampled; not scheduled for chemical analysis											
MW-5	08-21-91	Not sampled; not scheduled for chemical analysis											
MW-5	11-08-91	Not sampled; not scheduled for chemical analysis											
MW-5	02-26-92	<50	<0.5	<0.5	<0.5	<0.5	<3	--	--	--	--	--	--
MW-5	04-21-92	Not sampled; not scheduled for chemical analysis											
MW-6	01-31-90	<50	<0.5	<0.5	<0.5	<0.5	--	--	--	--	--	--	--
MW-6	04-25-90	<50	<0.5	<0.5	<0.5	<0.5	--	--	--	--	--	--	--
MW-6	07-28-90	<50	<0.5	<0.5	<0.5	<0.5	--	--	--	--	--	--	--
MW-6	11-14-90	<50	<0.5	<0.5	<0.5	<0.5	--	--	--	--	--	--	--
MW-6	03-23-91	<50	<0.5	<0.5	<0.5	<0.5	--	--	--	--	--	--	--
MW-6	05-23-91	Not sampled; not scheduled for chemical analysis											
MW-6	08-21-91	Not sampled; not scheduled for chemical analysis											
MW-6	11-08-91	Not sampled; not scheduled for chemical analysis											
MW-6	02-26-92	<50	<0.5	<0.5	<0.5	<0.5	<3	--	--	--	--	--	--
MW-6	04-21-92	Not sampled; not scheduled for chemical analysis											
RW-1	01-31-90	Not sampled; well connected to the remediation system											
RW-1	04-25-90	Not sampled; well contained floating product											
RW-1	07-28-90	Not sampled; well contained floating product											
RW-1	11-14-90	Not sampled; well contained floating product											
RW-1	03-23-91	11000	560	660	150	1700	--	--	--	--	--	--	--
RW-1	05-23-91	Not sampled; well contained floating product											
RW-1	08-21-91	Not sampled; well contained floating product											
RW-1	11-08-91	1600	79	46	13	240	--	--	--	--	--	--	--
RW-1	02-26-92	210	44	7.5	2.5	24	29	--	--	--	--	--	--
RW-1	04-21-92	36000	7400	3700	580	3400	<300	--	--	--	--	--	--

TPHG: Total petroleum hydrocarbons as gasoline, California DHS LUFT Method

µg/L: micrograms per liter

EPA: United States Environmental Protection Agency

MTBE: Methyl-tert-butyl ether

SM: standard method

TPHH: Total recoverable petroleum hydrocarbons

TPHD: Total petroleum hydrocarbons as diesel, California DHS LUFT Method

-- : not analyzed

* For previous historical analytical data please refer to *Golden Water 1990 Groundwater Monitoring Program Results and Remediation Performance Evaluation Report, ARCO Service Station 2035, Albany, California*, (EMLUL, March 23, 1996).

APPENDIX D

GEOTRACKER UPLOAD CONFIRMATION RECEIPTS

STATE WATER RESOURCES CONTROL BOARD
GEOTRACKER ESI

UPLOADING A GEO_WELL FILE

SUCCESS

Processing is complete. No errors were found!
Your file has been successfully submitted!

<u>Submittal Type:</u>	GEO_WELL
<u>Submittal Title:</u>	4Q10 GEO_WELL 2035
<u>Facility Global ID:</u>	T0600100081
<u>Facility Name:</u>	ARCO #02035
<u>File Name:</u>	GEO_WELL.zip
<u>Organization Name:</u>	Broadbent & Associates, Inc.
<u>Username:</u>	BROADBENT-C
<u>IP Address:</u>	67.118.40.90
<u>Submittal Date/Time:</u>	1/20/2011 12:02:31 PM
<u>Confirmation Number:</u>	4128991544