

0 80
SCALE

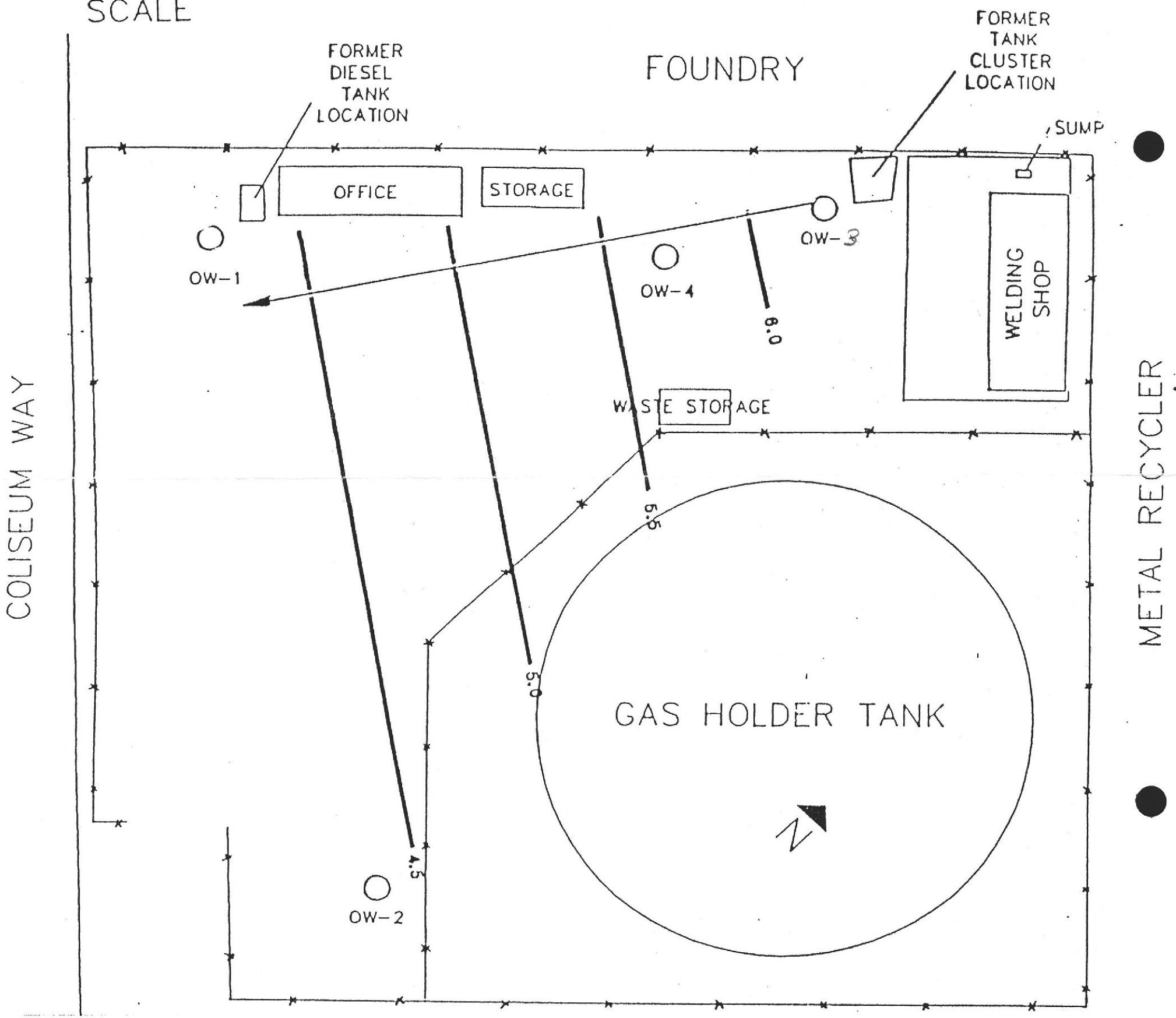

COLISEUM WAY

METAL RECYCLER

FOUNDRY

FORMER DIESEL TANK LOCATION

FORMER TANK CLUSTER LOCATION

SUMP

OFFICE

STORAGE

WELDING SHOP

WASTE STORAGE

GAS HOLDER TANK

OW-1

OW-2

OW-4

OW-3



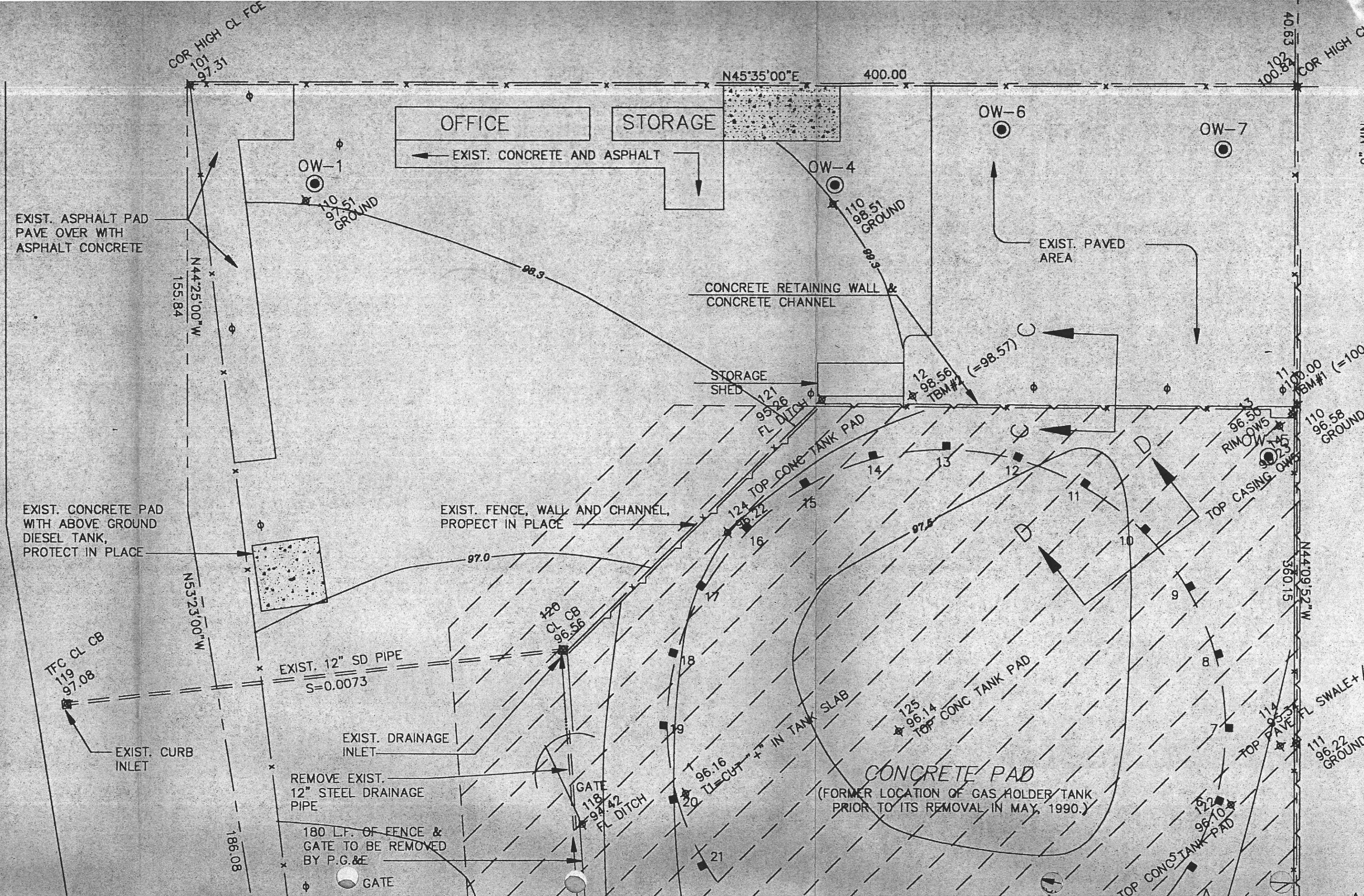

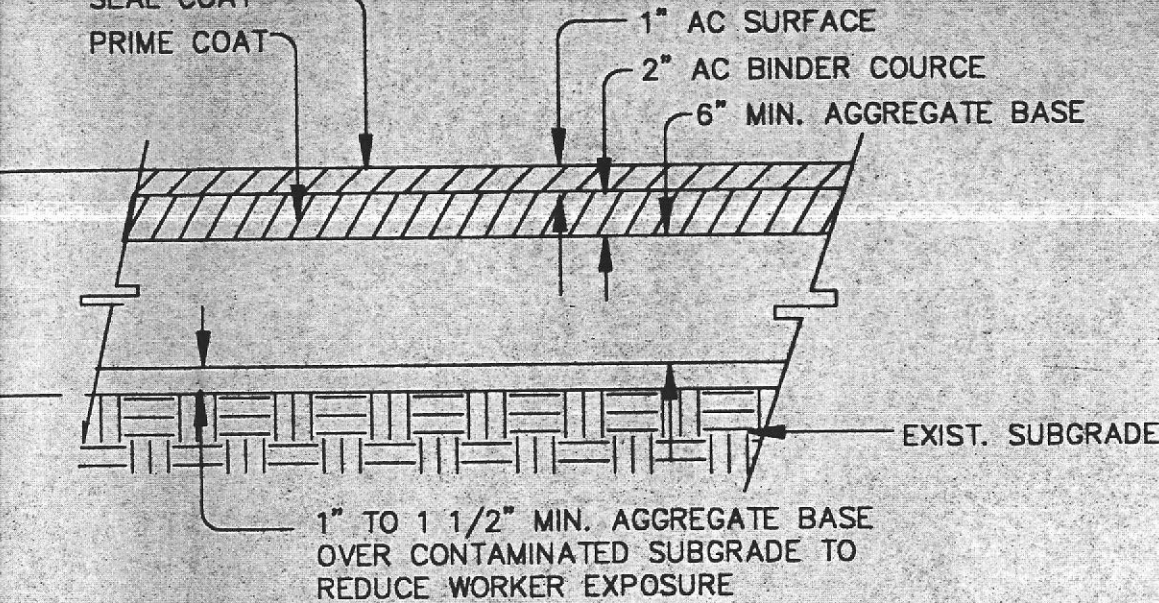

MINIMUM PAVEMENT SECTION

N.T.S.

GENERAL NOTES

1. Prior to performing any work, the contractor shall review the Health and Safety Plan for Additional Investigation and Remediation. The provisions of this plan shall be adhered to throughout the duration of the project.
2. The finished grades may be adjusted in the field as directed by the engineer.
3. The area shown as being contaminated shall not have the subgrade graded unless directed by the engineer. Prior to compacting the subgrade, these areas shall receive 1 1/2" of the total aggregate base thickness to prevent dust nuisance.
4. When the finished grade requires a thicker pavement section than provided by the MINIMUM PAVEMENT SECTION, increase the thickness of the aggregate base course.
5. The application of water during compacting shall be kept to a minimum. Under no circumstances shall applied water be allowed to pond or run off from the site.
6. All existing vehicles, equipment, and supplies stored at the site will be removed by PG&E prior to the grading and paving. The contractor shall be responsible for removing any vegetation or other objectionable organic material from the area to be paved.
7. Aggregate base shall conform to Section 26, 3/4-inch maximum of Caltrans Standard Specifications for Class 2 Aggregate Base.
8. Asphalts and asphalt concrete shall conform to Caltrans Standard Specifications for Asphalt Concrete (Section 39) and Asphalts (Section 92). Aggregate shall be Type B, 1/2" maximum, medium as specified in Section 39. Steam-refined asphalt shall be AR4000 as specified in Section 92.
9. Seal coat shall conform to Section 37-1 of the Caltrans Standard Specifications for Bituminous Seals, and a fine type seal coat shall be used.
10. The contractor shall pump or otherwise remove any residual oil from each tie-down prior to filling the tie downs with concrete. The contractor shall be responsible for disposing of any oil removed.

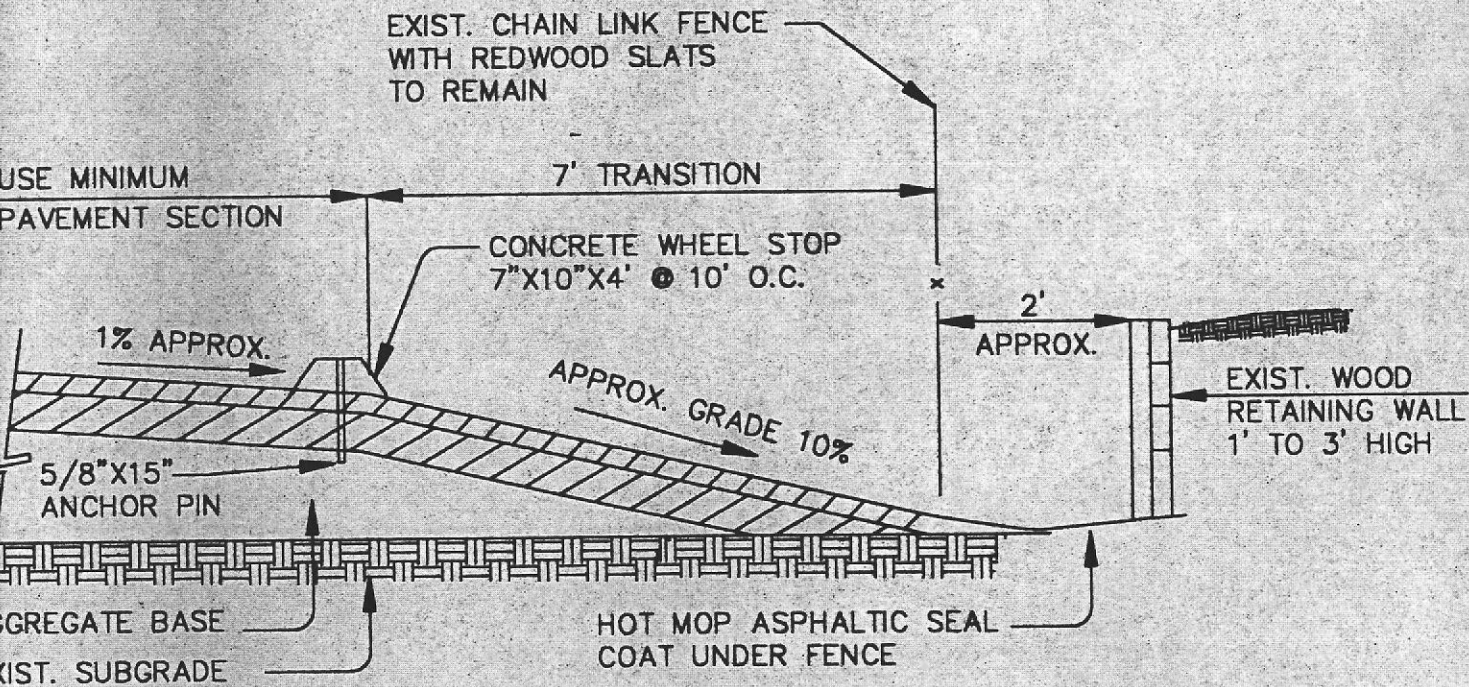

SECTION A-A

N.T.S.

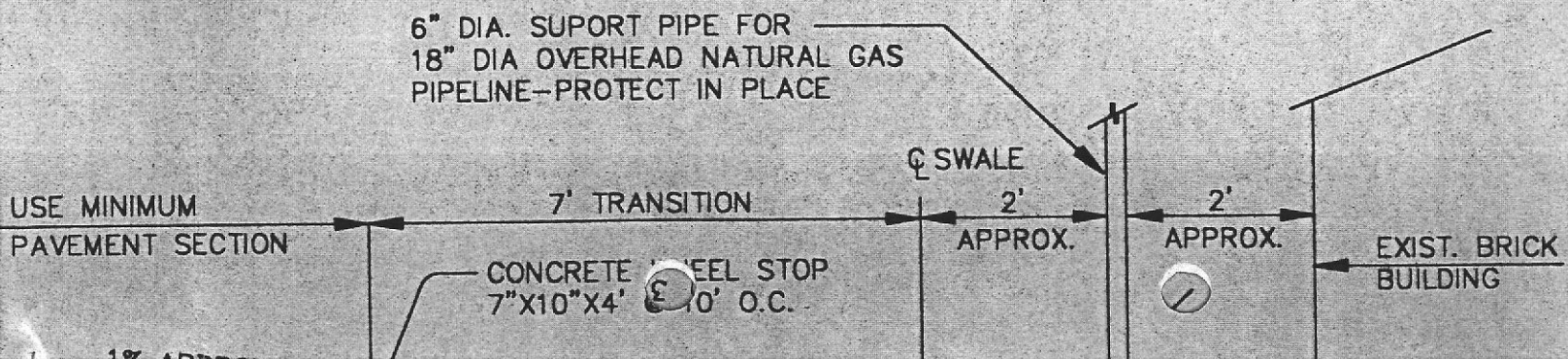











AQUA RESOURCES, INC

BERKELEY, CALIFORNIA

SECTION YARD

CALIFORNIA

LEGEND:

-  OW-2
 EXISTING MONITORING WELL
- 
 EXISTING CHAIN LINK FENCE
- 
 PROPERTY LINE
- 
 EXISTING RETAINING WALL
- 
 EXISTING UTILITY POLE
-  24
 EXISTING TIE DOWN
-  95.60
 EXISTING ELEVATION
- 
 FLOW DIRECTION
-  97.0
 FINISHED CONTOUR
- 
 EXTENT OF SOIL WITH AN ELEVATED LEAD CONCENTRATION REQUIRING CAPPING

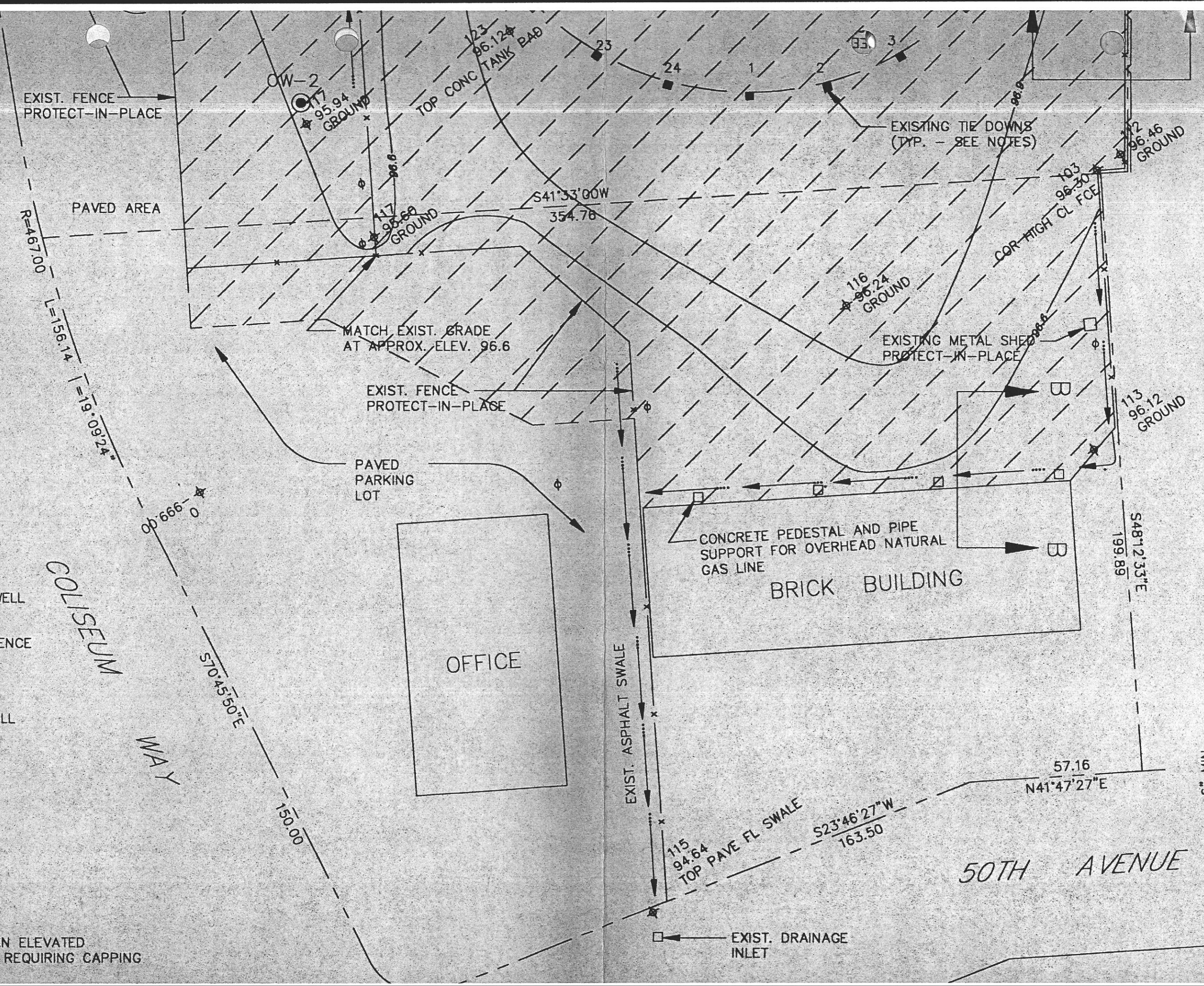

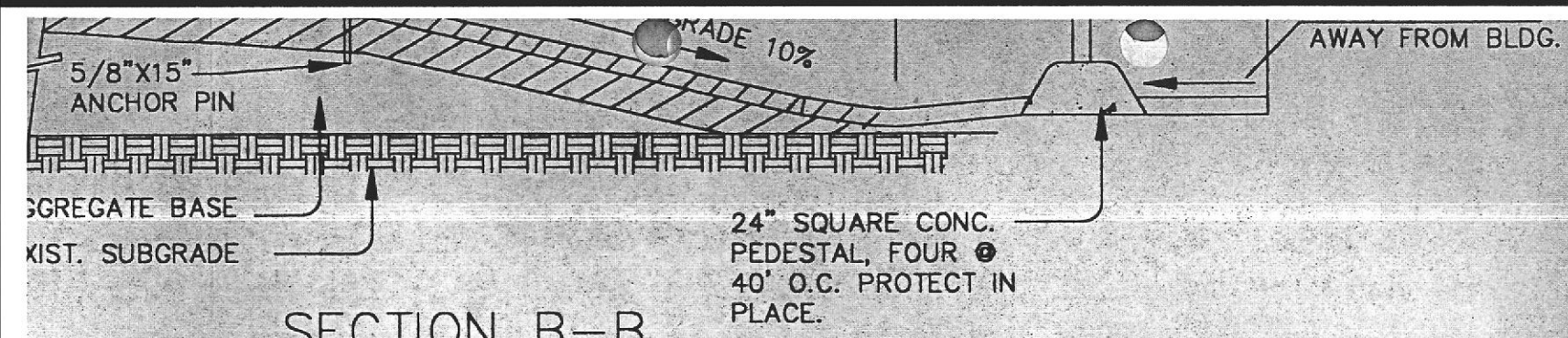

SECTION B-B

N.T.S.

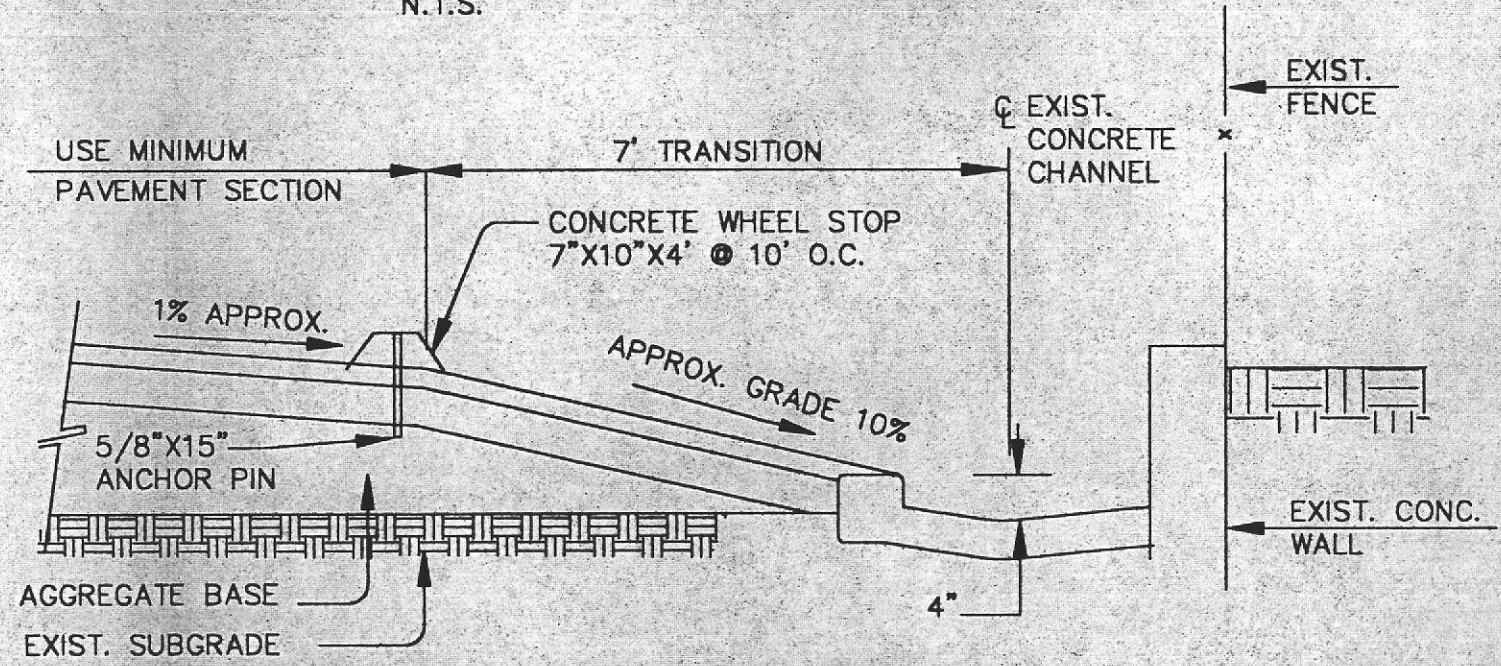

SECTION C-C

N.T.S.

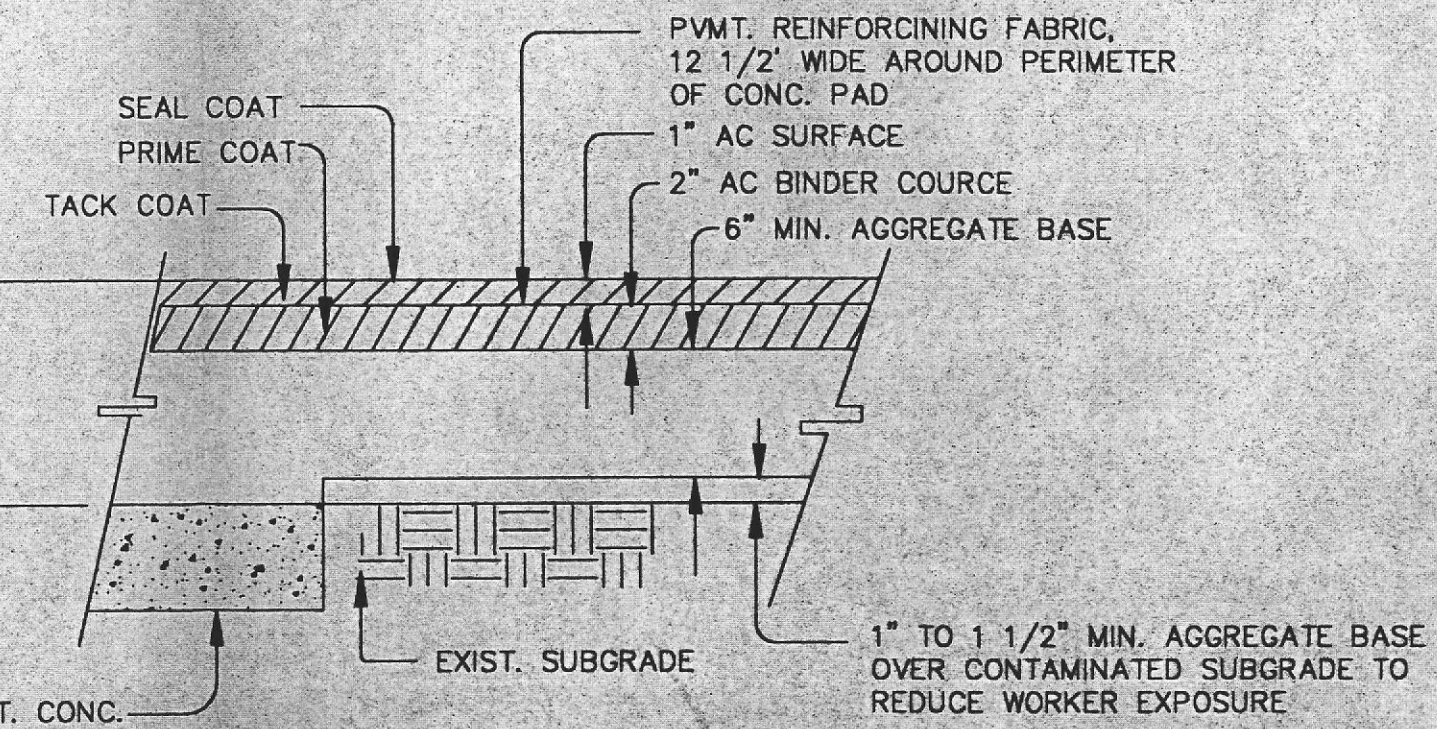

SECTION D-D

N.T.S.

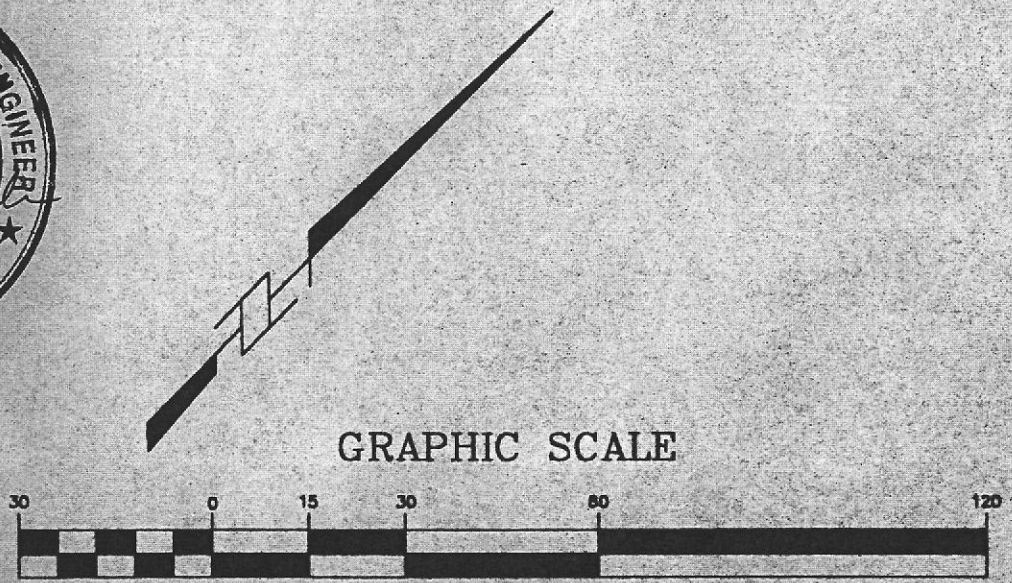

92 SEP 30 PM 2:59

PAVING PLAN
 P.G. & E ENCON-GAS T & D CONSTE
 4930 COLISEUM WAY
 ALAMEDA COUNTY
 CITY OF OAKLAND

Date	Revisions	No.
JUNE, 1992		
Scale 1" = 30'		
Design D.H.		
Drawn E.M.		
Approved		
Job No 90262-04		

Drawing Number:

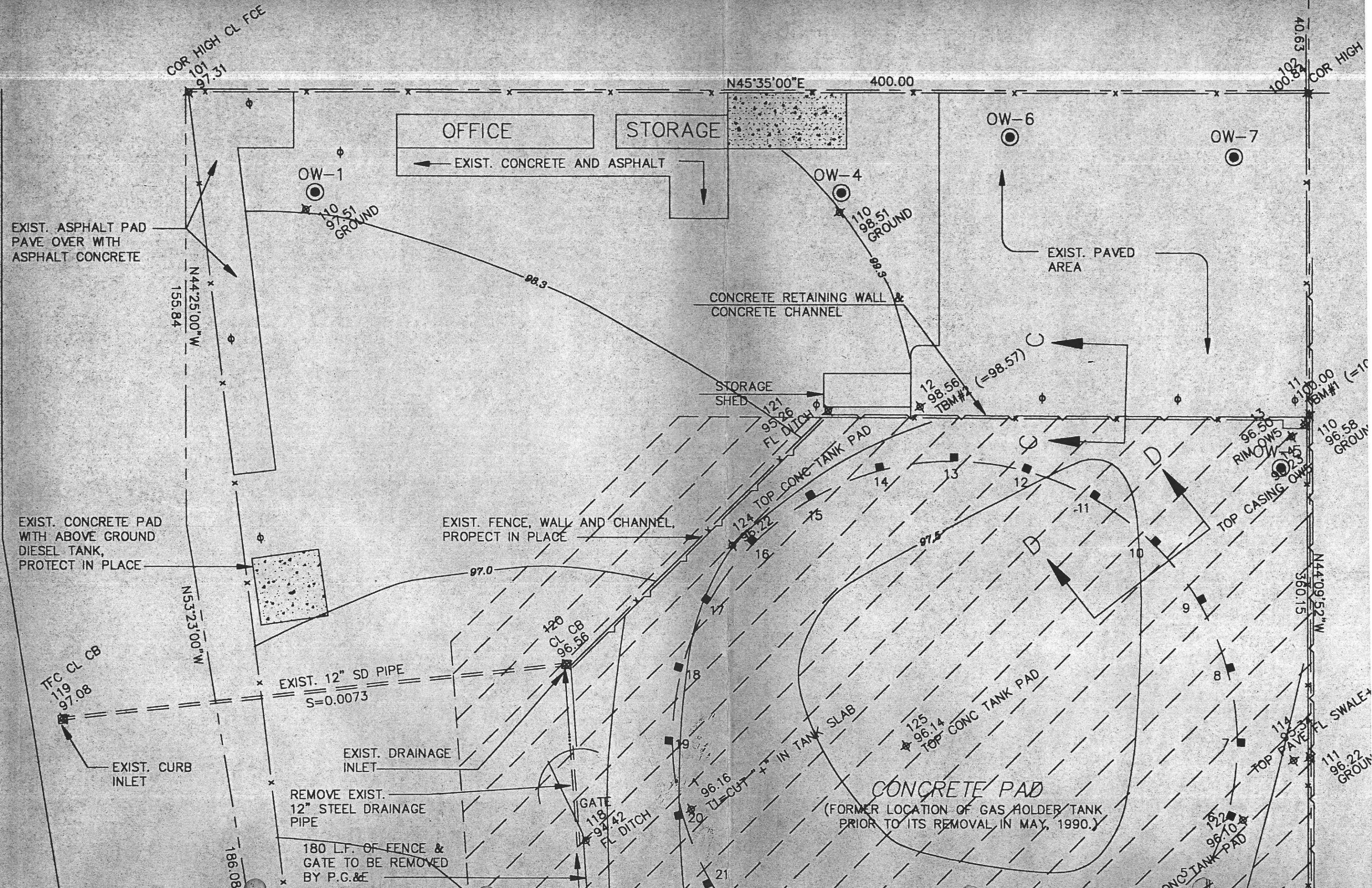

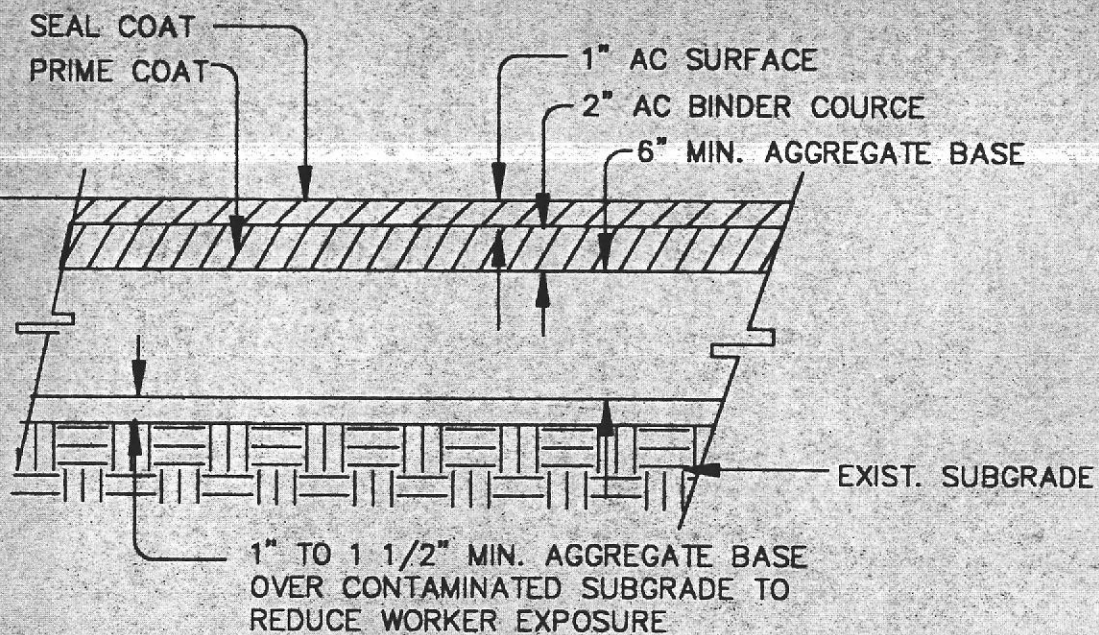

MINIMUM PAVEMENT SECTION

N.T.S.

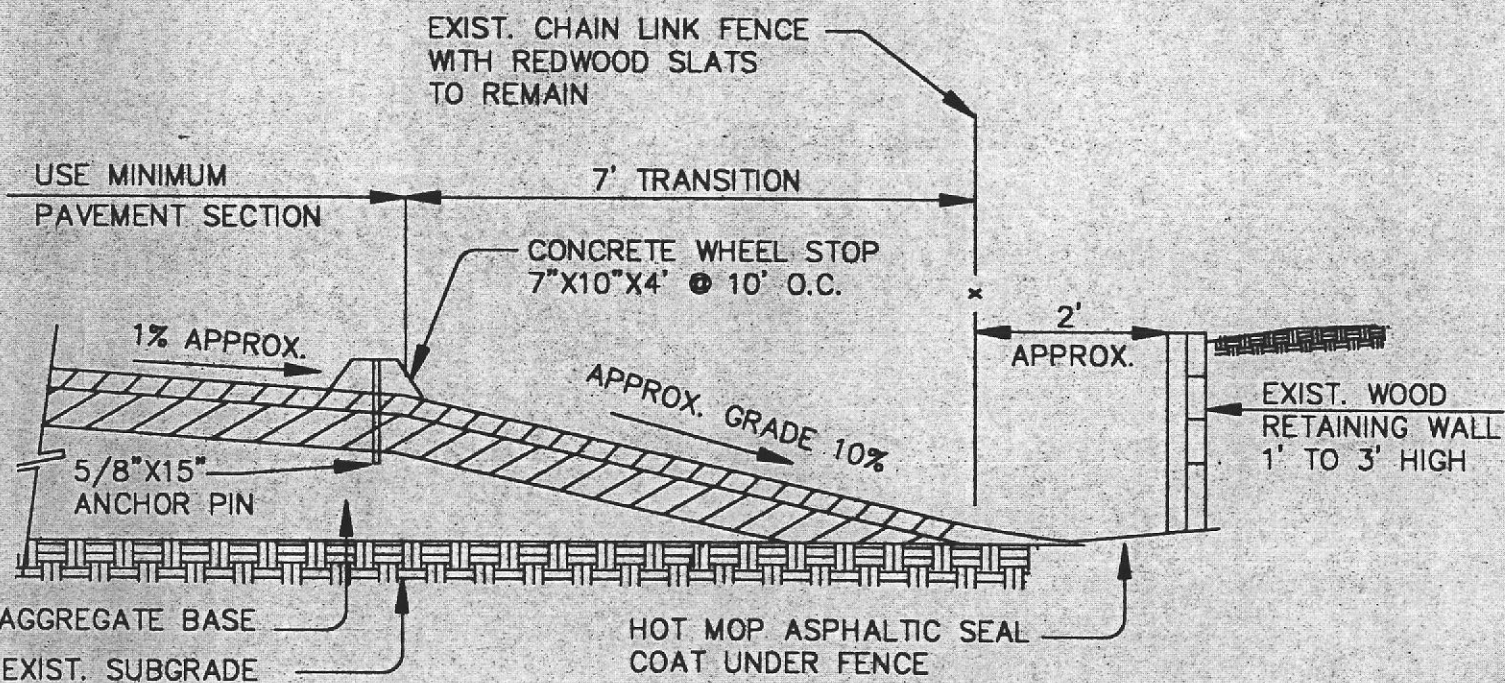

SECTION A-A

N.T.S.

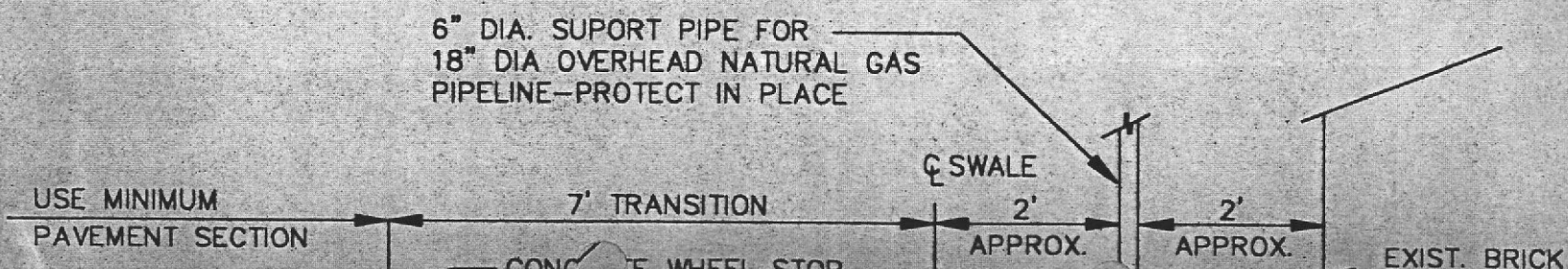

GENERAL NOTES

1. Prior to performing any work, the contractor shall review the Health and Safety Plan for Additional Investigation and Remediation. The provisions of this plan shall be adhered to throughout the duration of the project.
2. The finished grades may be adjusted in the field as directed by the engineer.
3. The area shown as being contaminated shall not have the subgrade graded unless directed by the engineer. Prior to compacting the subgrade, these areas shall receive 1 1/2" of the total aggregate base thickness to prevent dust nuisance.
4. When the finished grade requires a thicker pavement section than provided by the MINIMUM PAVEMENT SECTION, increase the thickness of the aggregate base course.
5. The application of water during compacting shall be kept to a minimum. Under no circumstances shall applied water be allowed to pond or run off from the site.
6. All existing vehicles, equipment, and supplies stored at the site will be removed by PG&E prior to the grading and paving. The contractor shall be responsible for removing any vegetation or other objectionable organic material from the area to be paved.
7. Aggregate base shall conform to Section 26, 3/4-inch maximum of Caltrans Standard Specifications for Class 2 Aggregate Base.
8. Asphalts and asphalt concrete shall conform to Caltrans Standard Specifications for Asphalt Concrete (Section 39) and Asphalts (Section 92). Aggregate shall be Type B, 1/2" maximum, medium as specified in Section 39. Steam-refined asphalt shall be AR4000 as specified in Section 92.
9. Seal coat shall conform to Section 37-1 of the Caltrans Standard Specifications for Bituminous Seals, and a fine type seal coat shall be used.
10. The contractor shall pump or otherwise remove any residual oil from each tie-down prior to filling the tie downs with concrete. The contractor shall be responsible for disposing of any oil removed.









AQUA RESOURCES, INC.

BERKELEY, CALIFORNIA

ON YARD

CALIFORNIA

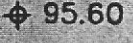
LEGEND:

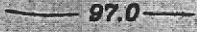
- 
OW-2
EXISTING MONITORING WELL
- 
EXISTING CHAIN LINK FENCE
- 
PROPERTY LINE
- 
EXISTING RETAINING WALL
- 
EXISTING UTILITY POLE
- 
24
EXISTING TIE DOWN
- 
95.60
EXISTING ELEVATION
- 
FLOW DIRECTION
- 
97.0
FINISHED CONTOUR

 EXTENT OF SOIL WITH AN ELEVATED LEAD CONCENTRATION REQUIRING CAPPING

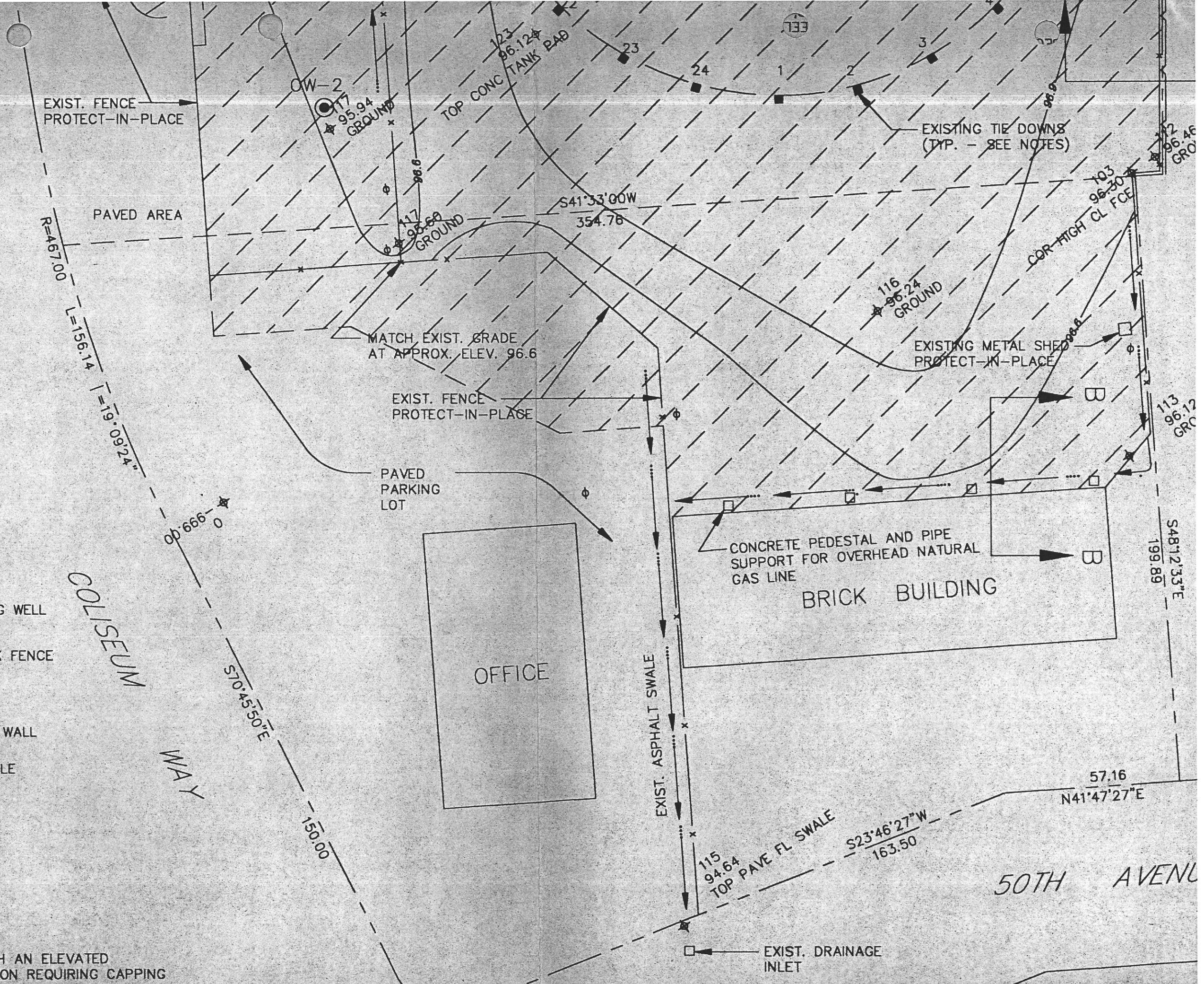

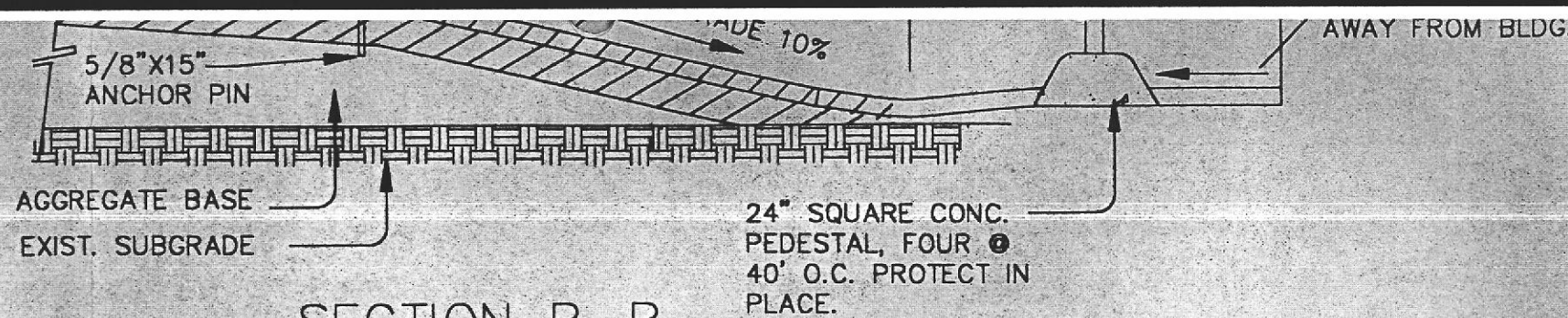

SECTION B-B

N.T.S.

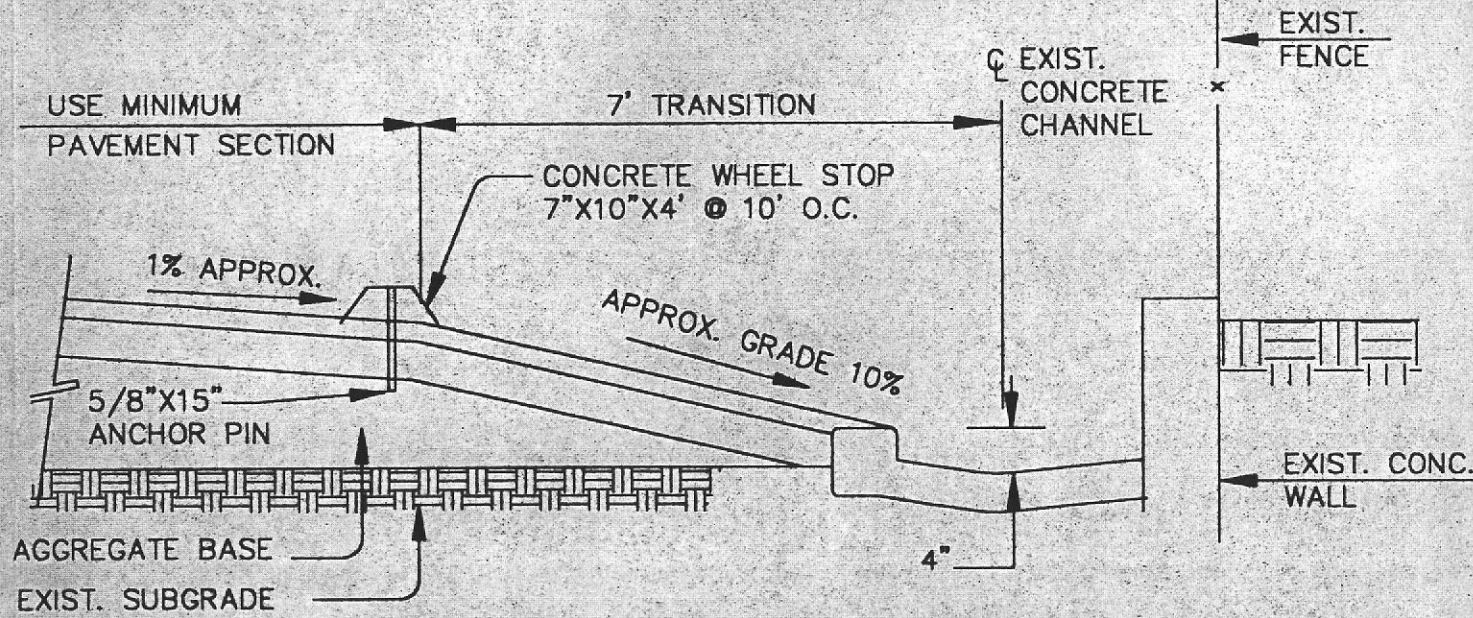

SECTION C-C

N.T.S.

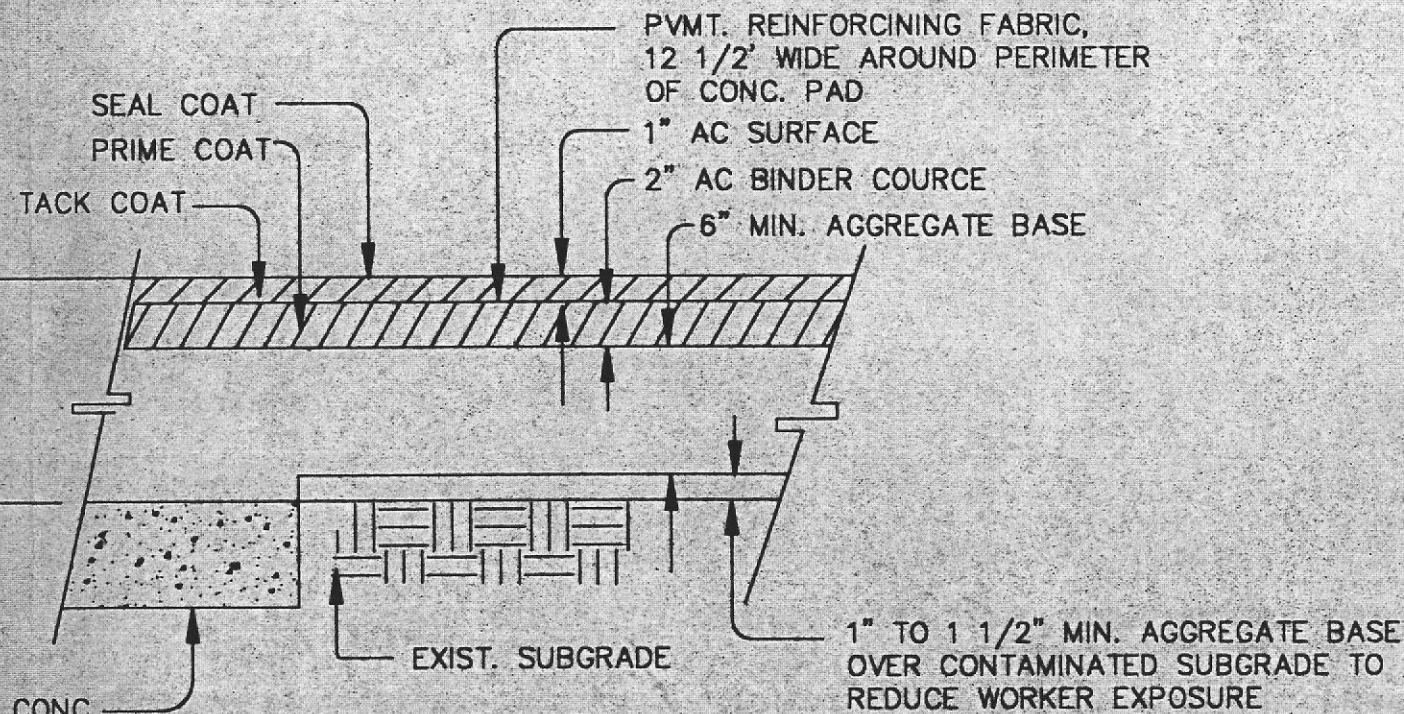

SECTION D-D

N.T.S.

92 SEP 30 PM 2:59

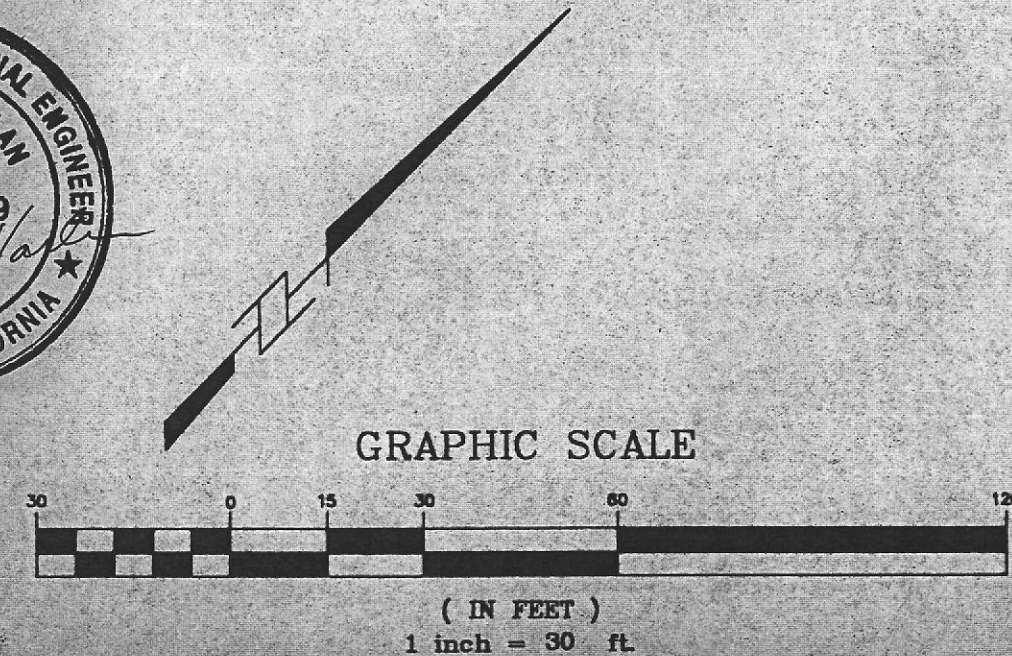

PAVING PLAN
 P.G. & E ENCON-GAS T & D CONSTI
 4930 COLISEUM WAY

Date	Revisions	No.
JUNE, 1992		
Scale 1" = 30'		
Design	D.H.	
Drawn	E.M.	

Drawing Number