

ARTESIAN ENVIRONMENTAL

General Engineering Contracting License 622461: A, B, C-57, Haz., Asb.

229 Tewksbury Ave., Pt. Richmond, CA 94801

Telephone (510) 307-9943 • Facsimile (510) 232-2823 • e-mail: augerpro@aol.com

Phase I Environmental Assessments • Limited Access Drilling • Asbestos and Lead Inspections
Remediations Tank Removals • Potentially Responsible Party Studies • Subsurface Investigations • EIRs

FACSIMILE TRANSMISSION

TO: Ms. Annie Beal FAX: (805) 588-4163

DATE: 5/4/99 JOB #: 413-001-01

FROM: Paul Jones^{X230} TOTAL SHEETS: 11

MESSAGE: Analytical for Eagle Gas.
Sorry I did not get you this sooner -
The lab didn't send it until after
I left yesterday.

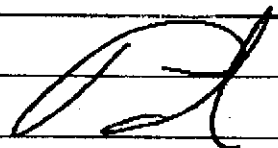
CC: Oakland Fire Services (510) 238-7761
Inspector Hernan Gomez

NOTES: If you did not receive the complete transmission, please call. This fax is privileged and confidential. If you are not an intended recipient, you are notified that any disclosure, dissemination or duplication of this fax is not authorized, and no waiver of any privilege or confidentiality is intended by your receipt of this transmission.

 MCCAMPBELL ANALYTICAL INC.	110 2nd Avenue South, #D7, Pacheco, CA 94553-5560 Telephone: 925-798-1620 Fax: 925-798-1622 http://www.mccampbell.com E-mail: main@mccampbell.com

Artesian Environmental 229 Tewksbury Avenue Point Richmond, CA 94801	Client Project ID: #413-001-01; RPC/Oakland	Date Sampled: 04/21-04/022/99
	Client Contact Paul Jones	Date Received: 04/23/99
	Client P.O:	Date Extracted: 04/23/99
		Date Analyzed: 04/23-04/26/99

Volatile Organics By GC/MS			
EPA method 624 or 8240			
Lab ID	09723		
Client ID	CS5-6.5		
Matrix	S		
Compound	Concentration*	Compound	Concentration*
Acetone ^(b)	ND<1400	cis-1,3-Dichloropropene	ND<250
Benzene	ND<250	trans-1,3-Dichloropropene	ND<250
Bromodichloromethane	ND<250	Bihylbenzene	ND<250
Bromoform	ND<250	Methyl butyl ketone ^(d)	ND<250
Bromomethane	ND<250	Methylene Chloride ^(d)	ND<250
Carbon Disulfide	ND<250	Methyl ethyl ketone ^(d)	ND<250
Carbon Tetrachloride	ND<250	Methyl isobutyl ketone ^(d)	ND<250
Chlorobenzene	ND<250	Styrene ^(f)	ND<250
Chloroethane	ND<250	1,1,2,2-Tetrachloroethane	ND<250
2-Chloroethyl Vinyl Ether ^(c)	ND<250	Tetrachloroethene	ND<250
Chloroform	ND<250	Toluene ^(f)	610
Chloromethane	ND<250	1,1,1-Trichloroethane	ND<250
Dibromochloromethane	ND<250	1,1,2-Trichloroethane	ND<250
1,2-Dichlorobenzene	ND<250	Trichloroethene	ND<250
1,3-Dichlorobenzene	ND<250	Trichlorofluoromethane	ND<250
1,4-Dichlorobenzene	ND<250	Vinyl Acetate ^(m)	ND<250
1,1-Dichloroethane	ND<250	Vinyl Chloride ⁽ⁿ⁾	ND<250
1,2-Dichloroethane	ND<250	Xylenes, total ^(o)	1500
1,1-Dichloroethene	ND<250	Surrogate Recoveries (%)	
cis-1,2-Dichloroethene	ND<250	Dibromofluoromethane	93
trans-1,2-Dichloroethene	ND<250	Toluene-d8	96
1,2-Dichloropropane	ND<250	4-Bromofluorobenzene	125

Comments: p

*water and vapor samples are reported in ug/L, soil and sludge samples in ug/kg, wipes in ug/wipe and all TCLP / SPLP extracts in ug/L

Reporting limits unless otherwise stated: water samples 1 ug/L; vapor samples 0.5 ug/L; solid and sludge samples 5 ug/kg; wipes 0.2ug/wipe

ND means not detected above the reporting limit; N/A means analyte not applicable to this analysis

(b) 2-propanone or dimethyl ketone; (c) (2-chloroethoxy) ethene; (d) 2-hexanone; (e) dichloromethane; (f) 2-butanone; (g) 4-methyl-2-pentanone or isopropylacetone; (h) lighter than water immiscible when is present; (i) liquid sample that contains greater than -5 vol. % sediment; (j) sample diluted due to high organic content; (k) ethylbenzene; (l) methylbenzene; (m) acetic acid ethenyl ester; (n) chloroethene; (o) dimethylbenzenes; (p) sample dilute due to high organics content.

DHS Certification No. 1644

 Edward Hamilton, Lab Director

 McCAMPBELL ANALYTICAL INC.	110 2nd Avenue South, #D7, Pacheco, CA 94553-5560 Telephone : 925-798-1620 Fax : 925-798-1622 http://www.mccampbell.com E-mail: main@mccampbell.com

Artesian Environmental 229 Tewksbury Avenue Point Richmond, CA 94801	Client Project ID: #413-001-01; RPC/Oakland	Date Sampled: 04/21-04/22/99
	Client Contact Paul Jones	Date Received: 04/23/99
	Client P.O:	Date Extracted: 04/23/99
		Date Analyzed: 04/23/99

Semi-Volatile Organics By GC/MS with PCP & Creosote							
EPA method 625 and 3510 or 4270 and 3550							
Lab ID	09723						
Client ID	CS5-6.5						
Matrix	S						
Compound	Concentration*	Reporting Limit		Compound	Concentration*	Reporting Limit	
		W	S			W	S
Acenaphthene	ND	10	0.33	Di-n-octyl Phthalate	ND	10	0.33
Acenaphthylene	ND	10	0.33	1,2-Diphenylhydrazine	ND	10	0.33
Anthracene	ND	10	0.33	Fluoranthene	ND	10	0.33
Benzidine	ND	30	1.0	Fluorene	ND	10	0.33
Benzoic Acid	ND	50	1.6	Hexachlorobenzene	ND	10	0.33
Benzo(a)anthracene	ND	10	0.33	Hexachlorobutadiene	ND	10	0.33
Benzo(b)fluoranthene	ND	10	0.33	Hexachlorocyclopentadiene	ND	20	0.66
Benzo(k)fluoranthene	ND	10	0.33	Hexachloroethane	ND	10	0.33
Benzo(g,h,i)perylene	ND	10	0.33	Indeno(1,2,3-cd)pyrene	ND	10	0.33
Benzo(a)pyrene	ND	10	0.33	Isophorone	ND	10	0.33
Benzyl Alcohol	ND	10	0.66	2-Methylnaphthalene	ND	10	0.33
Bis(2-chloroethoxy)methane	ND	10	0.33	2-Methylphenol (o-Cresol)	ND	10	0.33
Bis(2-chloroethyl) Ether	ND	10	0.33	4-Methylphenol (p-Cresol)	ND	10	0.33
Bis(2-chloroisopropyl) Ether	ND	10	0.33	Naphthalene	ND	10	0.33
Bis(2-ethylhexyl) Phthalate	ND	10	0.33	2-Nitroaniline	ND	20	0.66
4-Bromophenyl Phenyl Ether	ND	10	0.33	3-Nitroaniline	ND	20	0.66
Butylbenzyl Phthalate	ND	10	0.33	4-Nitroaniline	ND	20	0.66
4-Chloroaniline	ND	10	0.33	2-Nitrophenol	ND	50	1.6
4-Chloro-3-methylphenol	ND	10	0.33	4-Nitrophenol	ND	50	1.6
2-Chloronaphthalene	ND	10	0.33	Nitrobenzene	ND	10	0.33
2-Chlorophenol	ND	10	0.33	N-Nitrosodimethylamine	ND	10	0.33
4-Chlorophenyl Phenyl Ether	ND	10	0.33	N-Nitrosodibethylamine	ND	10	0.33
Chrysene	ND	10	0.33	N-Nitrosodi-n-propylamine	ND	10	0.33
Dibenzo(a,h)anthracene	ND	10	0.33	Parachlorophenol	ND	30	1.0
Dibenzofuran	ND	10	0.33	Phenanthrene	ND	10	0.33
Di-n-butyl Phthalate	ND	10	0.33	Phenol	ND	10	0.33
1,2-Dichlorobenzene	ND	10	0.33	Pyrene	ND	10	0.33
1,3-Dichlorobenzene	ND	10	0.33	1,2,4-Trichlorobenzene	ND	10	0.33
1,4-Dichlorobenzene	ND	10	0.33	2,4,5-Trichlorophenol	ND	10	0.33
3,3-Dichlorobenzidine	ND	20	0.66	2,4,6-Trichlorophenol	ND	10	0.33
2,4-Dichlorophenol	ND	10	0.33	Creosote	ND	10	0.33
Diethyl Phthalate	ND	10	0.33	Comments:			
2,4-Dimethylphenol	ND	10	0.33				
Dimethyl Phthalate	ND	10	0.33	Surrogate Recoveries (%)			
4,6-Dinitro-2-methylphenol	ND	50	1.6	2-Fluorobiphenyl			107
2,4-Dinitrophenol	ND	50	1.6	2-Nitrophenol			115
2,4-Dinitrotoluene	ND	10	0.33	Nitrobenzene-d5			99
2,6-Dinitrotoluene	ND	10	0.33	Phenol-d5			98
PCP	ND	10	0.33	2,4,6-Tribromophenol			121
				p-Terphenyl-d14			106

*water samples are reported in ug/L, soil and sludge samples in mg/kg, wipes in ug/wipe and all TCLP / STLC / SPLP extracts in ug/L

ND means not detected above the reporting limit; N/A means analysis not applicable to this analysis.

h) lighter than water immiscible sludge is present; i) liquid sample that contains greater than ~3 vol. % sediment; j) sample diluted due to high organic content

DHS Certification No. 1644

Edward Hamilton Edward Hamilton, Lab Director

 McCAMPBELL ANALYTICAL INC.	110 2nd Avenue South, #D7, Pacheco, CA 94553-5560 Telephone: 925-798-1620 Fax: 925-798-1622 http://www.mccampbell.com E-mail: main@mccampbell.com	
	(Additional contact information or address details)	

Artesian Environmental 229 Tewksbury Avenue Point Richmond, CA 94801	Client Project ID: #413-001-01; RPC/Oakland	Date Sampled: 04/21-04/02/99
	Client Contact Paul Jones	Date Received: 04/23/99
	Client P.O:	Date Analyzed: 04/23-05/03/99
	Date Extracted: 04/23/99	(Empty)

Polynuclear Aromatic Hydrocarbons (PAH / PNA) by GC-MS

EPA methods 625 (modified 610) and 3510 or 8270 (modified 8100) and 3550

Lab ID	09721	09723					Reporting Limit	
	Client ID	GW-3	CS5-6.5					S
Matrix	W	S						
Compound	Concentration*						mg/kg	ug/L
Acenaphthene	ND	ND					0.33	10
Acenaphthylene	ND	ND					0.33	10
Anthracene	37	ND					0.33	10
Benzo(a)anthracene	98	ND					0.33	10
Benzo(b)fluoranthene	47	ND					0.33	10
Benzo(k)fluoranthene	ND	ND					0.33	10
Benzo(g,h,i)perylene	ND	ND					0.33	10
Benzo(a)pyrene	38	ND					0.33	10
Chrysene	10	ND					0.33	10
Dibenz(a,h)anthracene	ND	ND					0.33	10
Fluoranthene	ND	ND					0.33	10
Fluorene	90	ND					0.33	10
Indeno(1,2,3-cd)pyrene	ND	ND					0.33	10
Naphthalene	55	ND					0.33	10
Phenanthrene	190	ND					0.33	10
Pyrene	110	ND					0.33	10
% Recovery Surrogate 1	84	107						
% Recovery Surrogate 2	90	115						
Comments	h							

* water and vapor samples are reported in ug/L, soil and sludge samples in mg/kg, wipes in ug/wipe and all TCLP / STLC / SPLP extracts in ug/l.

ND means not detected above the reporting limit; N/A means analyte not applicable to this analysis

* surrogate diluted out of range or surrogate coelutes with another peak

(h) a lighter than water immiscible sheen is present; (i) liquid sample that contains >=5 vol. % sediment; (j) sample diluted due to high organic content.

HIGH STREET (43rd AVE.)

(1-10
1-15 baffled)

- ⊗ Soil Sample Locations (Sample Depth as Suffix)
- ⊙ Groundwater Sample Locations

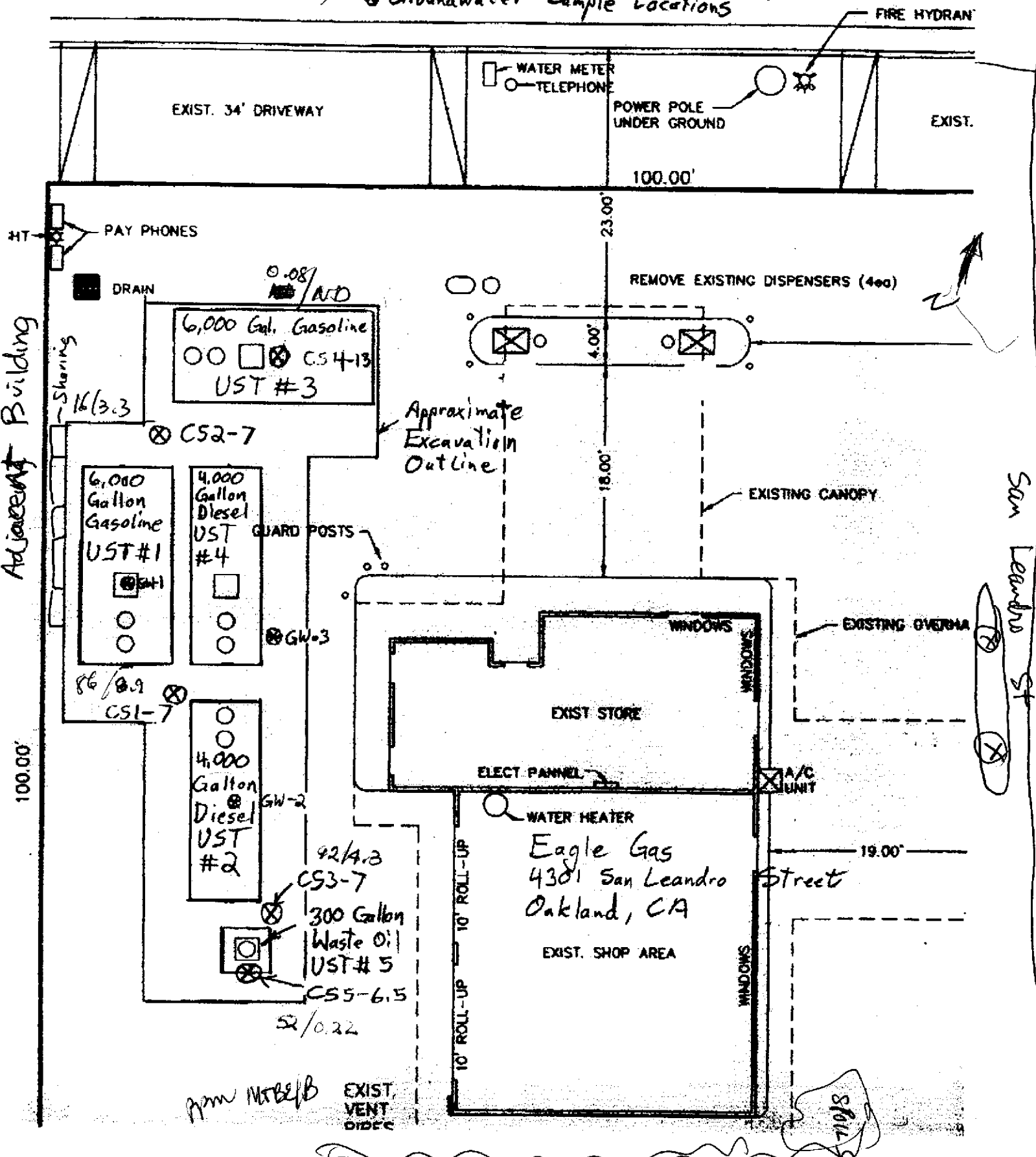

from MBE/B

Scale 1/8" = 1'-0"