



## Environmental Services, Inc.

2111 Jennings Street, San Francisco, CA 94124-3224, Phone (415) 822-4555 FAX (415) 822-5290

91 SEP -6 11:17

August 22, 1991  
Project 2102A

Mr. Manuel G. Jardin  
P. O. Box 20817  
Castro Valley, CA 94556

### FINAL REPORT/TANK REMOVAL

RE: Jardin Pipeline, Inc.  
2315 Dunn Road  
Hayward, California

Dear Mr. Jardin:

We are pleased to forward this report to you and the Alameda County Health Care Services Agency.

#### GENERAL

One 2000-gallon diesel underground storage tanks was removed from the above site on August 14, 1991. In accordance with the Underground Tank Closure Permit issued by the Alameda County Health Care Services Agency we are presenting this report. A copy of the approved first page of the Underground Tank Closure Permit is attached.

Jardin Pipeline, Inc. is located on the north side of Dunn Street, at 2315 Dunn Road in Hayward, California. Figure 1, Vicinity Map shows the site location with respect to the surrounding area. Figure 2, the Site Plan, shows the approximate location of the tank with respect to the property line and buildings located at the site.

#### TANK PREPARATION AND REMOVAL

Prior to removal, the tank was inspected for remaining product. The tank was purged of explosive vapors by the insertion of approximately 100 pounds of dry ice. Ms. Pamela Evans, Hazardous Materials Specialist with the Alameda County Environmental Health Department was on site to observe the procedures and direct the soil sampling.

When the tanks were lifted from the excavation, an inspection was made of the tank integrity. The tank appeared in good condition. After scraping and probing, no holes were observed in the tank.

*inlay w/ BS  
soil (for reanalysis?)  
before sampling?*

The tank bottom was measured to be about 8.5 feet deep. Soil was excavated from the tank pit to a depth of 12 feet below ground surface. Some water accumulation was noted in the 12 foot deep excavation during removal. No sheen was observed on the water. Water from the 12 foot deep excavation was sampled and submitted for analysis.

The empty, rinsed, and purged tanks were then immediately placed on a truck from Erickson Trucking and was delivered to Erickson Trucking in Richmond under Uniform Hazardous Waste Manifest procedures. A copy of the Uniform Hazardous Waste Manifest number 90392204 is attached.

### SOIL SAMPLING

Ms. Pam Evans designated four soil sample locations. Samples 2102-S1-12 and 2102-N1-12 were from the "in situ" soil below the tank backfill at a depth of about 12 feet below ground surface at the south and north ends of the tank excavation respectively. A backhoe was used to obtain the soil from the excavation for sampling. Samples 2102-G1 and 2102-G2 were from the soil removed during excavation and was taken from about 1 foot below the top of the 3 foot high pile. Figure 3, the Sample Location Plan, shows the location of samples at the site.

The soil samples were collected by driving 2 inch diameter, 6 inch long brass tubes into the designated soil. The tubes were capped, sealed, labeled and stored in a cooled ice chest. The samples were then transported to Precision Analytical Laboratory under chain of custody protocol for analysis.

### LABORATORY ANALYSIS AND PROCEDURES

#### SOIL

The four samples were analyzed for Total Petroleum Hydrocarbons as Diesel (TPH-D) by the DHS extraction method; Total Oil and Grease by Standard Method, 16th Edition, 503D; and Benzene, Toluene, Ethylbenzene, and Xylenes (BTEX) by EPA Method 8020. The laboratory results are tabulated below.

Sample	TPH-D (ppm)	TOG (ppm)	B (ppm)	T (ppm)	E (ppm)	X (ppm)
<i>Pit</i>   2102-S1-12	16	80	ND	0.008	0.009	0.062
2102-N1-12	ND	ND	ND	ND	ND	ND
<i>stack pile</i>   2102-G1	ND	ND	ND	ND	ND	0.027
2102-G2	ND	80	ND	0.018	ND	ND

**WATER**

The water sample was analyzed for Total Petroleum Hydrocarbons as Diesel (TPH-D) by the DHS extraction method; Total Oil and Grease (TOG) by Standard Method, 16th Edition, 503A; and BTEX by EPA Method 602. The laboratory results are tabulated below.

Sample	TPH-D (ppm)	TOG (ppm)	B (ppb)	T (ppb)	E (ppb)	X (ppb)
2102-W1	ND	ND	ND	ND	ND	ND

Notes: ppm parts per million  
ppb parts per billion  
ND Non-Detected at or above the Method Detection Limit.

Original signed laboratory certificates from Precision Analytical Laboratory for each analysis are attached.

**SOIL HANDLING**

As the soil was removed from the tank excavation it was stored on plastic sheeting approximately 10 feet from the tank area. The excavation was left open pending analytical results of soil samples from the excavated soil. A decision regarding the disposition of the excavated soil.

If there are any questions please call.

Sincerely,

George Wilson  
Vice President

  
John Carver  
Civil Engineer 23772



  
cc Alameda County Health Care Services Agency  
Department of Environmental Health  
ATTN: Ms Pam Evans

**ATTACHMENTS**

PHASE I ENVIRONMENTAL ASSESSMENT  
2315 DUNN ROAD  
HAYWARD, CALIFORNIA

L&W Project 2102  
August 22, 1991

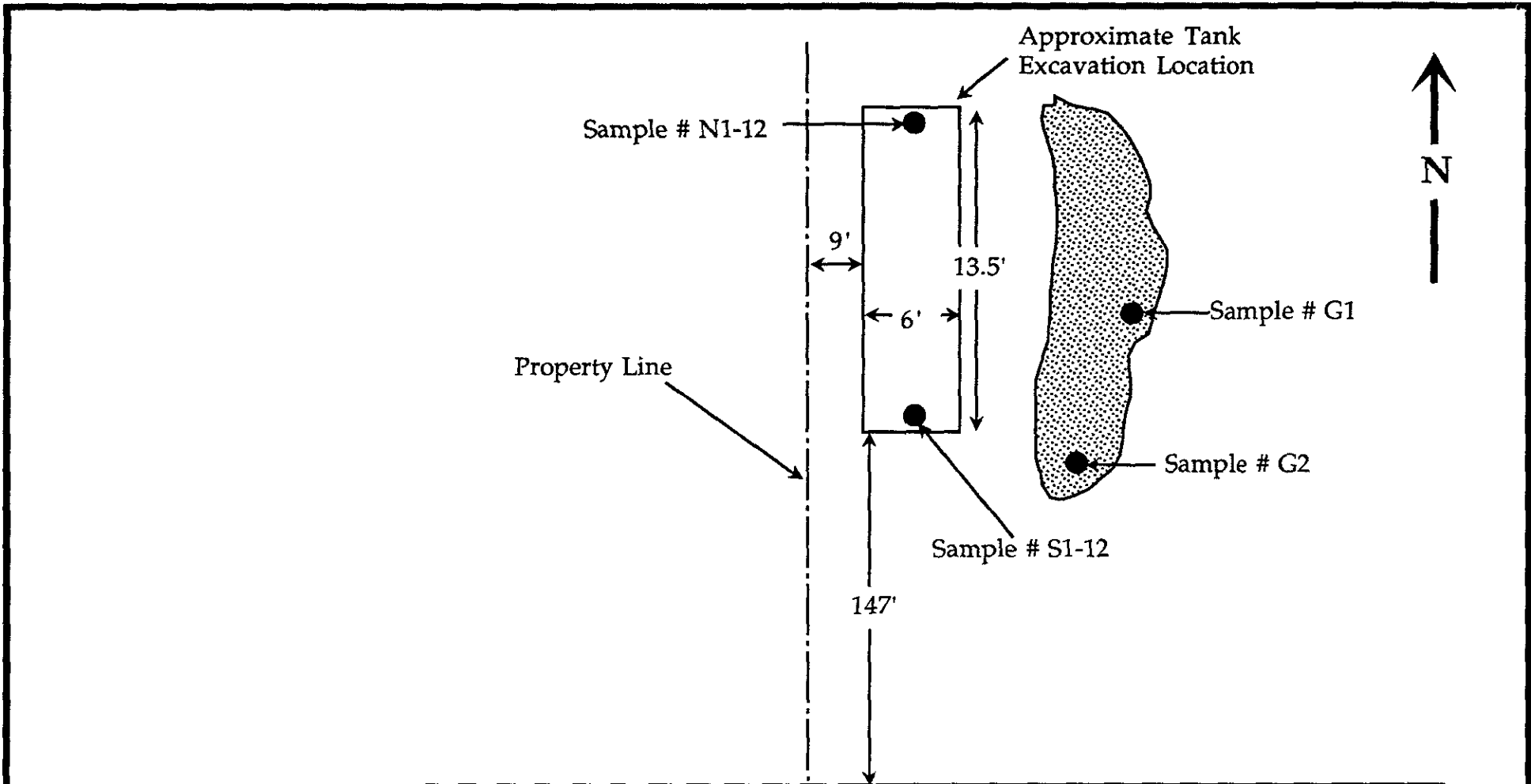

<b>L &amp; W Environmental Services, Inc.</b> 2111 Jennings Street San Francisco, California		<b>Sample Location Plan</b> Jardin Pipeline 2315 Dunn Road Hayward, California		
Project Number: 2102	Drawn by: MJK	Not to Scale	August, 1991	Figure Number: 3

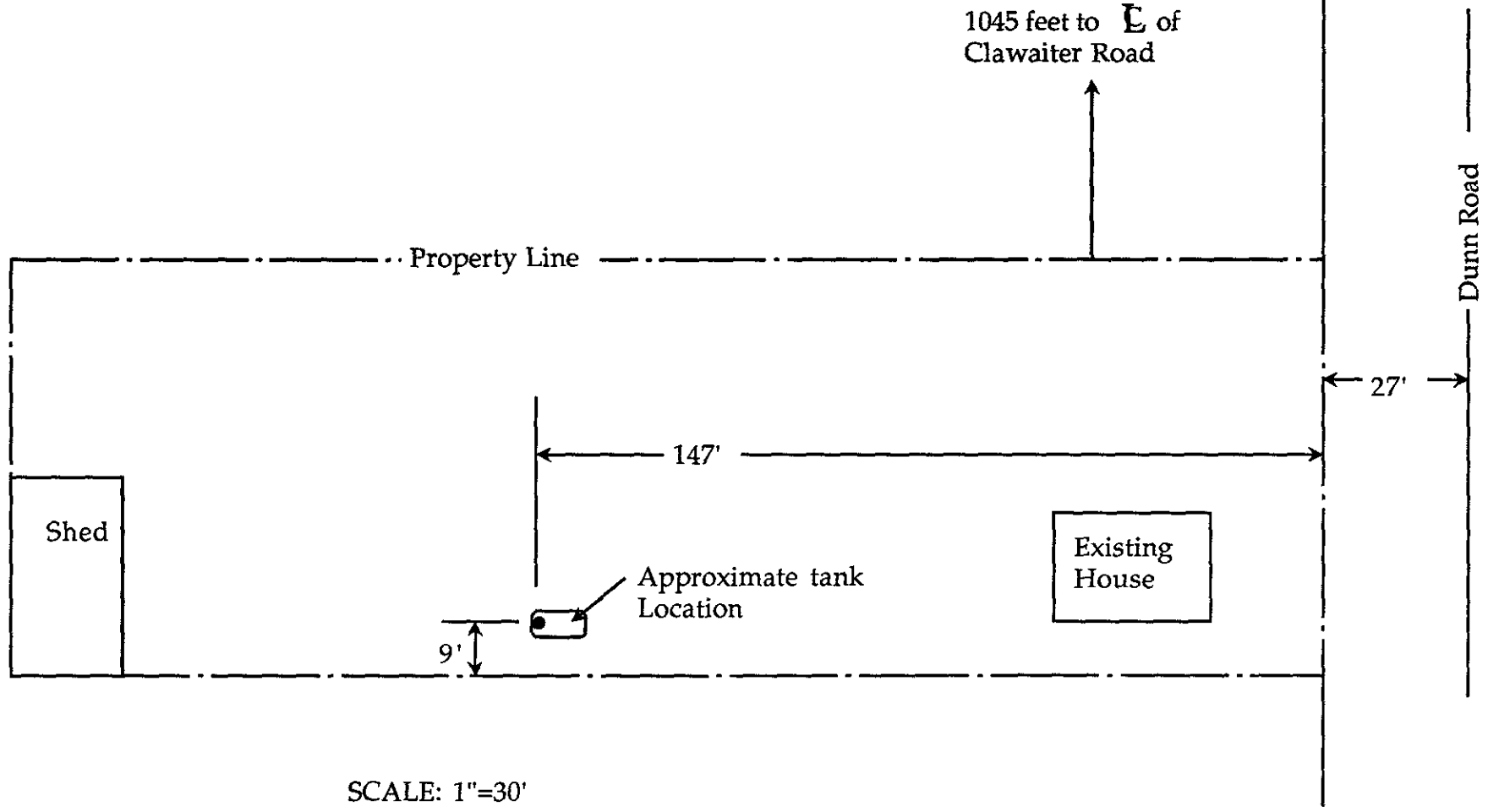

SCALE: 1"=30'

<b>L &amp; W Environmental Services, Inc.</b>		<b>Site Plan</b>	
2111 Jennings Street San Francisco, California		Jardin Pipeline 2315 Dunn Road Hayward, California	
Project Number: 2102	Drawn by: JNC	Date: August, 1991	Figure Number: 2

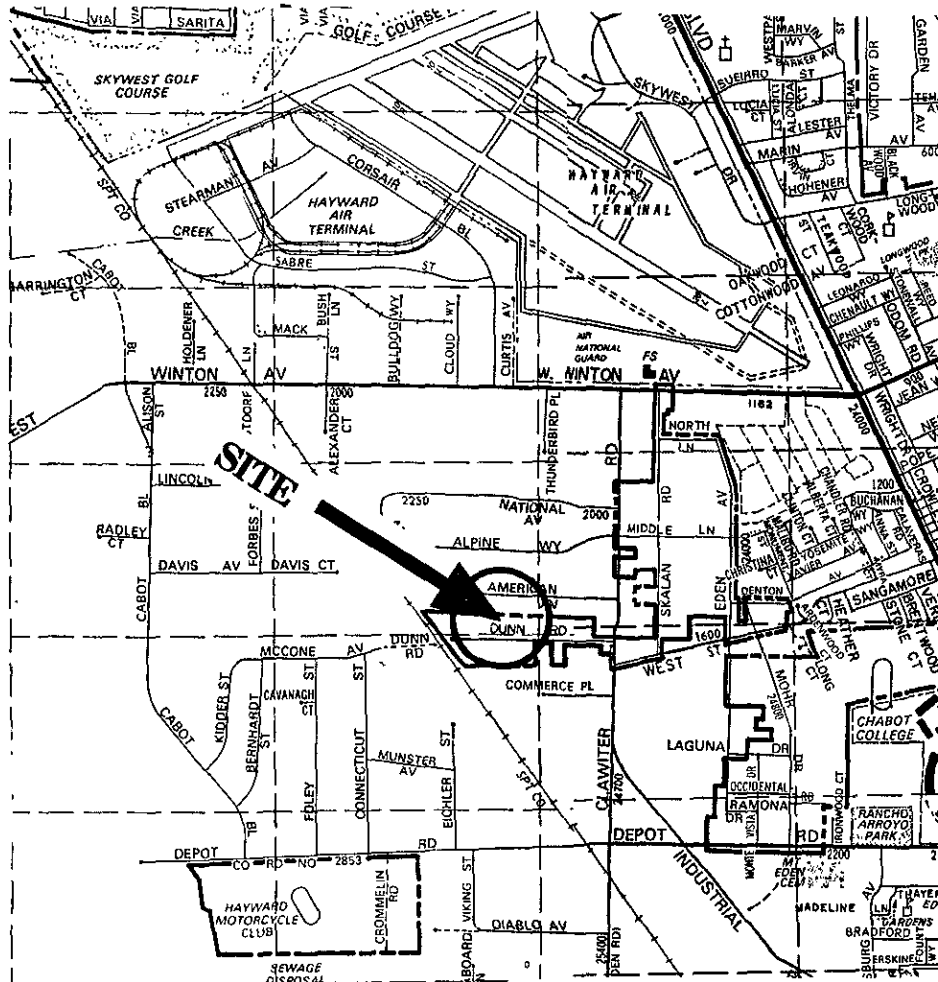

0 1/4 mile



Scale

Source: Thomas Bros. 1990

**L & W Environmental Services, Inc.**

2111 Jennings Street  
San Francisco, California

**Vicinity Map**

2315 Dunn Road  
Hayward, California

Project Number: 2102

Drawn by: MJK

Date: August, 1991

Figure Number: 1

ALAMEDA COUNTY HEALTH CARE SERVICES AGENCY  
DEPARTMENT OF ENVIRONMENTAL HEALTH  
HAZARDOUS MATERIALS DIVISION  
80 SWAN WAY, ROOM 200  
OAKLAND, CA 94621  
PHONE NO. 415/271-4320

Project Specialist (print)

UNDERGROUND TANK CLOSURE PLAN

\* \* \* Complete according to attached instructions \* \* \*

1. Business Name JARDIN PIPELINE, INC.  
Business Owner Manuel G. Jardin
2. Site Address 2315 Dunn Road  
City Hayward Zip 94544 Phone 782-5335
3. Mailing Address P.O. Box 20817  
City Castro Valley Zip 94546 Phone 782-5335
4. Land Owner Manuel G. Jardin  
Address P.O. Box 20817, Castro Valley, State CA Zip 94546
5. Generator name under which tank will be manifested JARDIN PIPELINE, INC.  
EPA I.D. No. under which tank will be manifested CAC.000624344



Please print or type. Form designed for use on elite (12-pitch typewriter).

<b>UNIFORM HAZARDOUS WASTE MANIFEST</b>		1. Generator's US EPA ID No. CAL10666KR41344		Manifest Document No. 912204		2. Page 1 of _____		Information in the shaded areas is not required by Federal law.			
3. Generator's Name and Mailing Address MANUEL G JARDIN PO BOX 20617 CASTRO VALLEY CA 94556						A. State Manifest Document Number 90392204					
4. Generator's Phone ( ) _____						B. State Generator's ID _____					
6. Transporter 1 Company Name TRIDENT TRUCK LINE, INC.			8. US EPA ID Number CAL10666KR41344			C. State Transporter's ID 2034		D. Transporter's Phone _____			
7. Transporter 2 Company Name _____						8. US EPA ID Number _____		E. State Transporter's ID 204352			
9. Designated Facility Name and Site Address WILSON INCORPORATED 453 PARK BLVD. RICHMOND, CA. 94801						10. US EPA ID Number _____		G. State Facility's ID _____			
						H. Facility's Phone _____					
11. US DOT Description (Including Proper Shipping Name, Hazard Class, and ID Number) EMPTY TANK NON-HAZARDOUS WASTE SOLID						12. Containers No. Type 001 55		13. Total Quantity 12000		14. Unit Wt/Vol LBS	
J. Additional Descriptions for Materials Listed Above QUANTITY 1 EMPTY STORAGE TANK(S) 6862 HAVE BEEN CRYOTED WITH 15 LBS. DRY ICE PER 1000 GAL. CAPACITY.						K. Handling Codes for Wastes Listed Above a. _____ b. _____ c. _____ d. _____					
15. Special Handling Instructions and Additional Information KEEP AWAY FROM SOURCES OF IGNITION. ALWAYS WEAR HARDSHATS AND GASSES WHEN WORKING AROUND UNDERGROUND STORAGE TANKS. 24 HR. CONTACT NAME: GEORGE WILSON PHONE: 415 822-4555											
16. GENERATOR'S CERTIFICATION: I hereby declare that the contents of this consignment are fully and accurately described above by proper shipping name and are classified, packed, marked, and labeled, and are in all respects in proper condition for transport by highway according to applicable international and national government regulations. If I am a large quantity generator, I certify that I have a program in place to reduce the volume and toxicity of waste generated to the degree I have determined to be economically practicable and that I have selected the practicable method of treatment, storage, or disposal currently available to me which minimizes the present and future threat to human health and the environment; OR, if I am a small quantity generator, I have made a good faith effort to minimize my waste generation and select the best waste management method that is available to me and that I can afford.											
Printed/Typed Name MANUEL G JARDIN				Signature <i>Manuel Jardin</i>				Month Day Year 10 21 91			
17. Transporter 1 Acknowledgement of Receipt of Materials						Printed/Typed Name Edward Hayward		Signature <i>Edward Hayward</i>		Month Day Year 08 14 91	
18. Transporter 2 Acknowledgement of Receipt of Materials						Printed/Typed Name _____		Signature _____		Month Day Year _____	
19. Discrepancy Indication Space											
20. Facility Owner or Operator Certification of receipt of hazardous materials covered by this manifest except as noted in item 19.											
Printed/Typed Name _____				Signature _____				Month Day Year _____			

IN CASE OF AN EMERGENCY OR SPILL, CALL THE NATIONAL RESPONSE CENTER 1-800-424-8802; WITHIN CALIFORNIA CALL 1-800-852-7550  
 90392204  
 GENERATOR  
 TRANSPORTER  
 FACILITY

# CHAIN OF CUSTODY MK

# RUSH

SAMPLES: (Signature) <i>Edward Jones</i>						ANALYSIS REQUESTED <i>(checked)</i>							
PROJECT NAME: (Print) <u>JARDINE PIPELINE</u> JOB NUMBER: <u>2102</u>													
DESCRIPTION: <u>TANK PULL (SAMPLING)</u>													
ADDRESS: <u>2315 Dunn Rd, Hayward, CA</u>													
CROSS REFERENCE NUMBER	DATE	TIME	SOIL	WATER	SAMPLE LOCATION	TOTAL PETROLEUM HYDROCARBONS	BTEX	VOC - EPA 8240	TOTAL OIL AND GREASE	TETRAETHYL LEAD	EPA - 8270	METALS	REMARKS
2102-S1-12	8-14-91	10:45	X		12' INTO HOLE SOUTH END TANK	X	X						1x2" TUBE
2102-N1-12	8-14-91	11:00	X		12' INTO HOLE NORTH END TANK	X	X	X					1x2" TUBE
2102-G1	8-14-91	10:30	X		GRAB SAMPLE EAST PILE 1' DOWN	X	X	X					1x2" TUBE
2102-G2	8-14-91	10:40	X		GRAB SAMPLE SOUTH PILE 1' DOWN	X	X	X					1x2" TUBE
2102-W1	8-14-91	11:15		X	11" INTO EXCAVATION NORTH END	X	X	X					4 Noa 2 Lit

RELINQUISHED BY: (Signature) <i>Edward Jones</i>	DATE <u>8-14-91</u>	RECEIVED BY: (Signature) <i>Raj Pandher</i>	DATE <u>8-14-91</u>
	TIME <u>5:45</u>		TIME <u>5:45</u>
RELINQUISHED BY: (Signature)	DATE	RECEIVED BY: (Signature)	DATE
	TIME		TIME
RELINQUISHED BY: (Signature)	DATE	RECEIVED BY: (Signature)	DATE
	TIME		TIME
RELINQUISHED BY: (Signature)	DATE	RECEIVED BY: (Signature)	DATE
	TIME		TIME
RELINQUISHED BY: (Signature)	DATE	RECEIVED BY: (Signature)	DATE
	TIME		TIME

Precision Analytical Laboratory, Inc.

4136 LAKESIDE DRIVE, RICHMOND, CA 94806      PHONE (415) 222-3002      FAX (415) 222-1251

**CERTIFICATE OF ANALYSIS**

STATE LICENSE NO. E 750

Received: 8/14/91  
Reported: 8/19/91  
Job #: 72707

Attn: George Wilson  
L & W Environmental  
2111 Jennings Street  
San Francisco, CA 94124

Project: Jardine Pipeline  
2315 Dunn Road, Hayward, CA  
Matrix: Soil

Total Petroleum Hydrocarbon Analysis  
DHS Extraction Method (LUFT)  
mg/Kg

<u>Lab ID</u>	<u>Client ID</u>	<u>Diesel</u>	<u>MDL</u>
72707-1	2102-S1-12	16	1
72707-2	2102-N1-12	ND<1	1
72707-3	2102-G1	ND<1	1
72707-4	2102-G2	ND<1	1

QA/QC: Spike Recovery for Diesel: 97%

MDL: Method Detection Limit. Compound below this level would not be detected.

Surinder Sidhu  
Surinder Sidhu  
Senior Organic Chemist

SS/td

Precision Analytical Laboratory, Inc.

4136 LAKESIDE DRIVE, RICHMOND, CA 94806 PHONE (415) 222-3002 FAX (415) 222-1251

CERTIFICATE OF ANALYSIS

STATE LICENSE NO. E 750

Received: 8/14/91  
Reported: 8/19/91  
Job #: 72707

Attn: George Wilson  
L & W Environmental  
2111 Jennings Street  
San Francisco, CA 94124

Project: Jardine Pipeline  
2315 Dunn Road, Hayward, CA  
Matrix: Water

Total Petroleum Hydrocarbon Analysis  
DHS Extraction Method (LUFT)  
mg/L

<u>Lab ID</u>	<u>Client ID</u>	<u>Diesel</u>	<u>MDL</u>
72707-5	2102-W1	ND<0.05	0.05

QA/QC: Spike Recovery for Diesel: 98%

MDL: Method Detection Limit. Compound below this level would not be detected.

Surinder Sidhu  
Surinder Sidhu  
Senior Organic Chemist

SS/td

Precision Analytical Laboratory, Inc.

4136 LAKESIDE DRIVE, RICHMOND, CA 94806 PHONE (415) 222-3002 FAX (415) 222-1251

CERTIFICATE OF ANALYSIS

STATE LICENSE NO. E 750

Received: 8/14/91  
Reported: 8/19/91  
Job #: 72707

Attn: George Wilson  
L & W Environmental  
2111 Jennings Street  
San Francisco, CA 94124

Project: Jardine Pipeline  
2315 Dunn Road, Hayward, CA  
Matrix: Soil

Aromatic Volatile Hydrocarbon Analysis  
EPA Method 8020  
mg/Kg

<u>Lab ID</u>	<u>Client ID</u>	<u>Benzene</u>	<u>MDL</u>	<u>Toluene</u>	<u>MDL</u>
72707-1	2102-S1-12	ND<0.005	0.005	0.008	0.005
72707-2	2102-N1-12	ND<0.005	0.005	ND<0.005	0.005
72707-3	2102-G1	ND<0.005	0.005	ND<0.005	0.005
72707-4	2102-G2	ND<0.005	0.005	0.018	0.005

<u>Lab ID</u>	<u>Client ID</u>	<u>Ethyl- benzene</u>	<u>MDL</u>	<u>Xylenes</u>	<u>MDL</u>
72707-1	2102-S1-12	0.009	0.005	0.062	0.005
72707-2	2102-N1-12	ND<0.005	0.005	ND<0.005	0.005
72707-3	2102-G1	ND<0.005	0.005	0.027	0.005
72707-4	2102-G2	ND<0.005	0.005	ND<0.005	0.005

QA/QC: Spike Recovery for Benzene: 84%  
Spike Recovery for Toluene: 88%  
Spike Recovery for Xylene: 90%

MDL: Method Detection Limit. Compound below this level would not be detected.

Surinder Sidhu  
Surinder Sidhu  
Senior Organic Chemist

OUTSTANDING QUALITY AND SERVICE  
CALIFORNIA STATE CERTIFIED LABORATORY

SS/td

Precision Analytical Laboratory, Inc.

4136 LAKESIDE DRIVE, RICHMOND, CA 94806      PHONE (415) 222-3002      FAX (415) 222-1251

**CERTIFICATE OF ANALYSIS**

STATE LICENSE NO. E 750

Received: 8/14/91  
Reported: 8/19/91  
Job #: 72707

Attn: George Wilson  
L & W Environmental  
2111 Jennings Street  
San Francisco, CA 94124

Project: Jardine Pipeline  
2315 Dunn Road, Hayward, CA  
Matrix: Water

Aromatic Volatile Hydrocarbon Analysis  
EPA Method 602  
µg/L

<u>Lab ID</u>	<u>Client ID</u>	<u>Benzene</u>	<u>MDL</u>	<u>Toluene</u>	<u>MDL</u>
72707-5	2102-W1	ND<0.3	0.3	ND<0.3	0.3

<u>Lab ID</u>	<u>Client ID</u>	<u>Ethyl- benzene</u>	<u>MDL</u>	<u>Xylenes</u>	<u>MDL</u>
72707-5	2102-W1	ND<0.3	0.3	ND<0.6	0.6

QA/QC: Spike Recovery for Benzene: 102%  
Spike Recovery for Toluene: 110%  
Spike Recovery for Xylene: 112%

MDL: Method Detection Limit. Compound below this level would not be detected.

Surinder Sidhu  
Surinder Sidhu  
Senior Organic Chemist

SS/td

Precision Analytical Laboratory, Inc.

4136 LAKESIDE DRIVE, RICHMOND, CA 94806      PHONE (415) 222-3002      FAX (415) 222-1251

**CERTIFICATE OF ANALYSIS**

STATE LICENSE NO. E 750

Received: 8/14/91  
Reported: 8/19/91  
Job #: 72707

Attn: George Wilson  
L & W Environmental  
2111 Jennings Street  
San Francisco, CA 94124

Project: Jardine Pipeline  
2315 Dunn Road, Hayward, CA  
Matrix: Soil

Total Oil and Grease  
Standard Method, 16th Edition, 503-D  
mg/Kg

<u>Lab ID</u>	<u>Client ID</u>	<u>Oil and Grease</u>	<u>MDL</u>
72707-1	2102-S1-12	80	50
72707-2	2102-N1-12	ND<50	50
72707-3	2102-G1	ND<50	50
72707-4	2102-G2	80	50

QA/QC: Spike Recovery: 92%

MDL: Method Detection Limit. Compound below this level would not be detected.

*Surinder Sidhu*

Surinder Sidhu  
Senior Organic Chemist

SS/td

Precision Analytical Laboratory, Inc.

4136 LAKESIDE DRIVE, RICHMOND, CA 94806      PHONE (415) 222-3002      FAX (415) 222-1251

**CERTIFICATE OF ANALYSIS**

STATE LICENSE NO. E 750

Received: 8/14/91  
Reported: 8/19/91  
Job #: 72707

Attn: George Wilson  
L & W Environmental  
2111 Jennings Street  
San Francisco, CA 94124

Project: Jardine Pipeline  
2315 Dunn Road, Hayward, CA  
Matrix: Water

Total Oil and Grease  
Standard Method, 16th Edition, 503-A  
mg/L

<u>Lab ID</u>	<u>Client ID</u>	<u>Oil and Grease</u>	<u>MDL</u>
72707-5	2102-W1	ND<5	5

QA/QC: Spike Recovery: 92%

MDL: Method Detection Limit. Compound below this level would not be detected.

Surinder Sidhu  
Surinder Sidhu  
Senior Organic Chemist

SS/td