



Foundry/Corporate Office

Los Angeles Service Center

7825 San Leandro Street  
Oakland, CA 94621-2598  
510/632-3467  
510/632-8035 Fax

15006 Nelson Avenue  
City of Industry, CA 91744-4331  
626/333-4882  
626/333-8681 Fax

November 22, 2011

Mr. Jerry Wickham  
Hazardous Materials Specialist  
Alameda County Environmental Health  
1131 Harbor Bay Parkway, Suite 250  
Alameda, CA 94502-6577

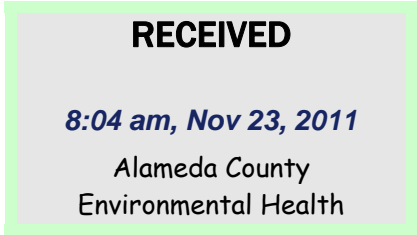

**Subject: Fuel Leak Case No. RO0000092 and Geotracker Global ID T0600100065 Well Decommissioning Report, AB&I Foundry, 7825 San Leandro Street, Oakland California 94621**

Dear Mr. Wickham:

AB&I respectfully submits the attached Well Decommissioning Report for the AB&I Foundry Site located at 7825 San Leandro Street, Oakland, California.

I declare, under penalty of perjury, that the information and/or recommendations contained in the attached document are true and correct to the best of my knowledge.

Sincerely,

Dave Robinson  
Engineering Manager

Attachment: Well Decommissioning Report, AB&I Foundry, 7825 San Leandro Street, Oakland, California

November 21, 2011

Mr. Dave Robinson  
Engineering Manager  
AB&I Foundry  
7825 San Leandro Street  
Oakland, CA 94621

**Subject: Report on Well Decommissioning,  
AB&I Facility Site,  
Oakland, California  
Fuel Leak Case No. RO0000092 and GeoTracker Global ID T0600100065**

Dear Mr. Robinson:

This report is a summary of the groundwater monitoring well destruction conducted at the AB&I Foundry facility located at 7825 San Leandro Blvd (the Site) in Oakland, California (Figure 1). The well destructions were conducted by The Source Group, Inc. (SGI) on behalf of the AB&I in accordance with the Alameda County Public Works Agency (ACPWA) permit requirements and the ACEH letter titled, "Request for Well Decommissioning for Fuel Leak Case No. RO0000092 and GeoTracker Global ID T0600100065, American Brass & Iron Foundry, 7825 San Leandro Street, Oakland, CA 94621," dated September 22, 2011.

The Site is located in a light industrial area of Oakland (Figures 1 and 2). Elmhurst Creek is located along the southeast corner of the property (Figure 2). The monitoring wells discussed in this closure report were formerly used to assess groundwater quality associated with seven underground storage tanks (USTs). The locations of the subject monitoring wells are shown on Figure 2. Available monitoring well survey and construction information are summarized in Table 1.

All nine monitoring wells located on the Site were destroyed on October 11, 2011 in accordance with the requirements of ACPWA. The following activities were implemented for the destruction of the nine monitoring wells:

- SGI obtained well destruction permits from the ACPWA and arranged for the appropriate inspections by the ACPWA. Copies of the ACPWA well permits are attached to this letter.

Mr. Dave Robinson  
November 21, 2011  
Page 2 of 2

- All well destruction activities were performed by Vironex, Inc of Concord, California, with SGI supervision and ACPWA inspection.
- The ACPWA approved tremmie grouting as the appropriate method for closure of the well casings.
- Wellhead boxes were removed and recycled onsite..
- The wells were grouted from the bottom of the well to the surface using a tremmie pipe and the surfaces were restored.

As required by the California Department of Water Resources, well destruction reports were completed following the destruction of the monitoring wells and are attached to this letter.

There were no significant deviations from the above procedures during the work.

If you have any questions regarding this report, please contact the undersigned at (925) 944-2856.

Sincerely,

**The Source Group, Inc.**



Nathan Colton  
Project Scientist



Kent R. Reynolds  
Project Manager



Kristene Tidwell, P.G.  
Project Geologist

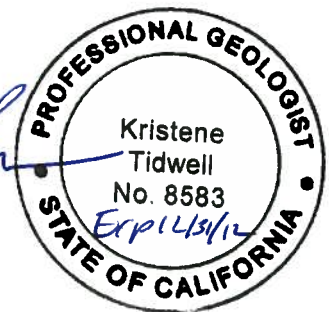

Attachments: Figure 1 Site location Map  
Figure 2 Site Plan  
Table 1 Well Construction Summary  
ACPWA Permits and DWR Forms

**The Source Group, Inc.**

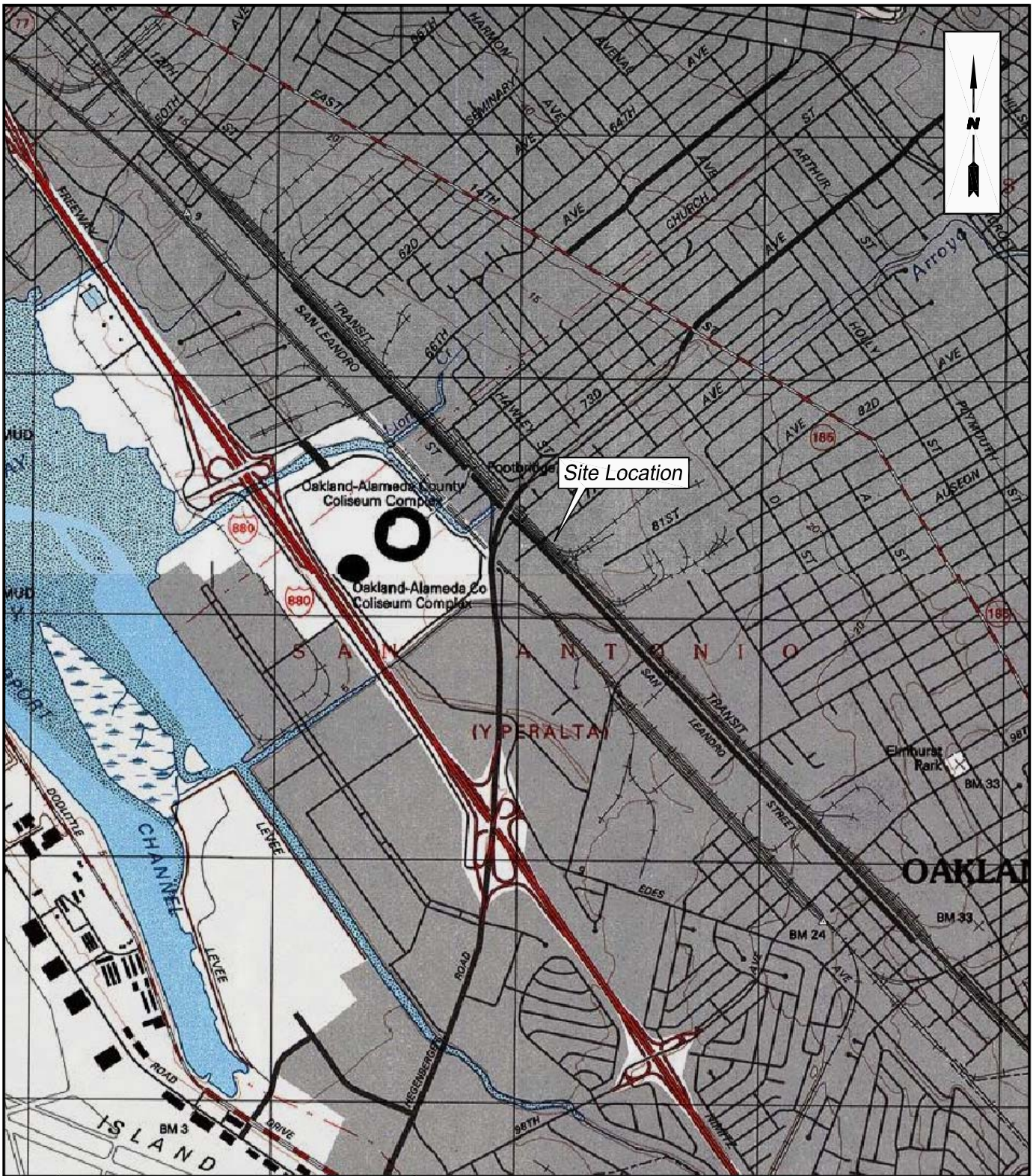

**SGI** THE SOURCE GROUP, INC.  
environmental

3451-C VINCENT ROAD  
 PLEASANT HILL, CA 94523

SOURCE: U.S.G.S. 7.5' QUAD SHEET  
 OAKLAND EAST, CALIFORNIA  
 PHOTOREVISED 1997

SCALE:



**SITE LOCATION MAP**

CLIENT:

AB&I FOUNDRY

DATE:

6/27/07

LOCATION:

7825 San Leandro Street  
 Oakland, California

FIGURE:

**1**

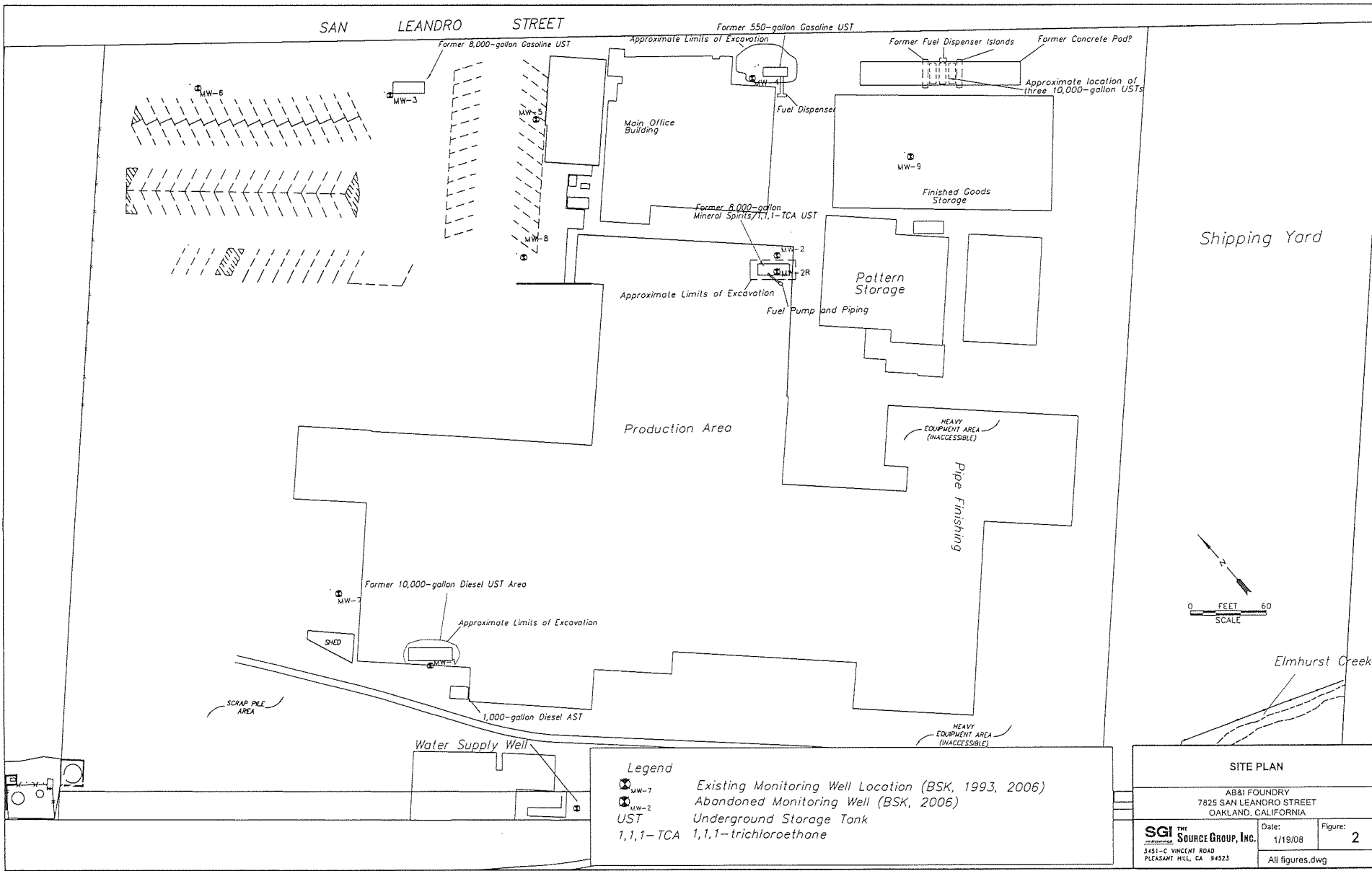

**Legend**

- Existing Monitoring Well Location (BSK, 1993, 2006)
- Abandoned Monitoring Well (BSK, 2006)
- UST** Underground Storage Tank
- 1,1,1-TCA 1,1,1-trichloroethane

**SITE PLAN**

AB&I FOUNDRY  
7825 SAN LEANDRO STREET  
OAKLAND, CALIFORNIA

|   |                  |              |
|---|------------------|--------------|
| <b>SGI</b> THE SOURCE GROUP, Inc.<br>3451-C VINCENT ROAD<br>PLEASANT HILL, CA 94523 | Date:<br>1/19/08 | Figure:<br>2 |
|   | All figures.dwg  |              |

**Table 1**  
**Well Construction Details and Groundwater Elevation - December 2010**

AB&I Foundry  
7825 San Leandro Street  
Oakland, California

| <b>Well Number</b> | <b>Total Depth<sup>1</sup></b><br><i>(feet, bgs<sup>1</sup>)</i> | <b>Solid Casing<sup>2</sup></b><br><i>(feet, bgs<sup>1</sup>)</i> | <b>Screened Interval<sup>3</sup></b><br><i>(feet, bgs<sup>1</sup>)</i> | <b>Top of Casing</b><br><i>(feet, msl<sup>4</sup>)</i> | <b>Depth to Water</b><br><i>(feet, btoc<sup>5</sup>)</i> | <b>Groundwater Elevation</b><br><i>(feet, msl<sup>6</sup>)</i> |
|--------------------|--|---|--|--|--|--|
| MW-1               | 23   | 0-10  | 10-20  | 9.60   | 4.92   | 4.68   |
| MW-2               | 17   | 0-8   | 8-17   | NM   | NM   | Destroyed  |
| MW-2R              | 20.5   | 0-5   | 5-20   | 7.49   | NM   | NM   |
| MW-3               | 19.5   | 0-9   | 9-19   | 9.90   | 5.60   | 4.30   |
| MW-4               | 26.5   | 0-10  | 10-25  | 10.49  | 6.42   | 4.07   |
| MW-5               | 20.5   | 0-5   | 5-20   | 10.92  | 6.70   | 4.22   |
| MW-6               | 20.5   | 0-5   | 5-20   | 10.19  | 6.86   | 3.33   |
| MW-7               | 20.5   | 0-5   | 5-20   | 10.61  | 5.64   | 4.97   |
| MW-8               | 20.5   | 0-5   | 5-20   | 11.19  | 7.09   | 4.10   |
| MW-9               | 20.5   | 0-5   | 5-20   | 7.95   | 3.52   | 4.43   |

**Notes:**

- 1) feet, bgs = feet below ground surface
- 2) All monitoring wells constructed with 2" I.D. schedule 40 PVC; monitoring well MW-2 constructed with 4" I.D. schedule 40 PVC
- 3) All well casing includes .02" slotted screen
- 4) Top of casing elevation in feet above mean sea level (msl)
- 5) Depth to water below top of casing (btoc) measured on December 22, 2010
- 6) Groundwater elevation in feet above mean sea level (msl)

**ACPWA Permits and DWR Forms**

# Alameda County Public Works Agency - Water Resources Well Permit



399 Elmhurst Street  
Hayward, CA 94544-1395  
Telephone: (510)670-6633 Fax:(510)782-1939

**Application Approved on: 10/11/2011 By jamesy**

**Permit Numbers: W2011-0628 to W2011-0636**  
**Permits Valid from 10/11/2011 to 10/11/2011**

**Application Id:** 1317421522247  
**Site Location:** 7825 San Leandro Street,

**City of Project Site:**Alameda

Oakland, CA 94621

**Project Start Date:** 10/11/2011

**Completion Date:**10/11/2011

**Assigned Inspector:** Contact Vicky Hamlin at (510) 670-5443 or vickyh@acpwa.org

**Applicant:** AB&I Foundry - Dave Robinson  
7825 San Leandro Street, Oakland, CA 94621

**Phone:** 510-632-3467

**Property Owner:** AB&I Foundry  
7825 San Leandro Street, Oakland, CA 94621

**Phone:** 510-632-3467

**Client:** Dave Robinson  
7825 San Leandro Street, Oakland, CA 94621

**Phone:** 510-632-3467

**Contact:** Kent Reynolds

**Phone:** 925-944-2856 x326  
**Cell:** 925-207-2257

|                                    |                                     |                     |
|------------------------------------|-------------------------------------|---------------------|
| <b>Receipt Number: WR2011-0298</b> | <b>Total Due:</b> \$3573.00         |                     |
| <b>Payer Name : AB&amp;I</b>       | <b>Total Amount Paid:</b> \$3573.00 |                     |
|                                    | <b>Paid By: CHECK</b>               | <b>PAID IN FULL</b> |

**Works Requesting Permits:**

Well Destruction-Monitoring - 9 Wells

Driller: Vironex - Lic #: 705927 - Method: press

**Work Total: \$3573.00**

**Specifications**

| Permit #   | Issued Date | Expire Date | Owner Well Id | Hole Diam. | Casing Diam. | Seal Depth | Max. Depth | State Well # | Orig. Permit # | DWR #      |
|------------|-------------|-------------|---------------|------------|--------------|------------|------------|--------------|----------------|------------|
| W2011-0628 | 10/11/2011  | 01/09/2012  | MW-1          | 8.00 in.   | 2.00 in.     | 8.00 ft    | 23.00 ft   | 2S/3W16R     | NO RECORDS     | NO RECORDS |
| W2011-0629 | 10/11/2011  | 01/09/2012  | MW-2R         | 8.00 in.   | 2.00 in.     | 4.00 ft    | 20.00 ft   | 2S/3W16R     | W2006-0706     | NO RECORDS |
| W2011-0630 | 10/11/2011  | 01/09/2012  | MW-3          | 8.00 in.   | 2.00 in.     | 7.00 ft    | 19.50 ft   | 2S/3W16R     | NO RECORDS     | NO RECORDS |
| W2011-0631 | 10/11/2011  | 01/09/2012  | MW-4          | 8.00 in.   | 2.00 in.     | 8.00 ft    | 26.50 ft   | 2S/3W16R     | NO RECORDS     | NO RECORDS |
| W2011-0632 | 10/11/2011  | 01/09/2012  | MW-5          | 8.00 in.   | 2.00 in.     | 4.00 ft    | 20.00 ft   | 2S/3W16R     | W2006-0707     | NO RECORDS |
| W2011-0633 | 10/11/2011  | 01/09/2012  | MW-6          | 8.00 in.   | 2.00 in.     | 4.00 ft    | 20.00 ft   | 2S/3W16R     | W2006-0708     | NO RECORDS |
| W2011-0634 | 10/11/2011  | 01/09/2012  | MW-7          | 8.00 in.   | 2.00 in.     | 4.00 ft    | 20.00 ft   | 2S/3W16R     | W2006-0709     | NO RECORDS |
| W2011-0635 | 10/11/2011  | 01/09/2012  | MW-8          | 8.00 in.   | 2.00 in.     | 4.00 ft    | 20.00 ft   | 2S/3W16R     | W2006-0710     | NO RECORDS |
| W2011-0636 | 10/11/2011  | 01/09/2012  | MW-9          | 8.00 in.   | 2.00 in.     | 4.00 ft    | 20.00 ft   | 2S/3W16R     | W2006-0711     | NO RECORDS |

**Specific Work Permit Conditions**

1. Drilling Permit(s) can be voided/ cancelled only in writing. It is the applicant's responsibility to notify Alameda County Public Works Agency, Water Resources Section in writing for an extension or to cancel the drilling permit application. No drilling permit application(s) shall be extended beyond ninety (90) days from the original start date. Applicants may not cancel a drilling permit application after the completion date of the permit issued has passed.
2. Prior to any drilling activities, it shall be the applicant's responsibility to contact and coordinate an Underground



## Alameda County Public Works Agency - Water Resources Well Permit

Service Alert (USA), obtain encroachment permit(s), excavation permit(s) or any other permits or agreements required for that Federal, State, County or City, and follow all City or County Ordinances. No work shall begin until all the permits and requirements have been approved or obtained. It shall also be the applicants responsibilities to provide to the Cities or to Alameda County an Traffic Safety Plan for any lane closures or detours planned. No work shall begin until all the permits and requirements have been approved or obtained.

3. Compliance with the well-sealing specifications shall not exempt the well-sealing contractor from complying with appropriate State reporting-requirements related to well construction or destruction (Sections 13750 through 13755 (Division 7, Chapter 10, Article 3) of the California Water Code). Contractor must complete State DWR Form 188 and mail original to the Alameda County Public Works Agency, Water Resources Section, within 60 days. Including permit number and site map.

4. Applicant shall submit the copies of the approved encroachment permit to this office within 60 days.

5. Permittee shall assume entire responsibility for all activities and uses under this permit and shall indemnify, defend and save the Alameda County Public Works Agency, its officers, agents, and employees free and harmless from any and all expense, cost and liability in connection with or resulting from the exercise of this Permit including, but not limited to, property damage, personal injury and wrongful death.

6. Applicant shall contact Vicky Hamlin for an inspection time at 510-670-5443 or email to vickyh@acpwa.org at least five (5) working days prior to starting, once the permit has been approved. Confirm the scheduled date(s) at least 24 hours prior to drilling.

7. Permittee, permittee's contractors, consultants or agents shall be responsible to assure that all material or waters generated during drilling, boring destruction, and/or other activities associated with this Permit will be safely handled, properly managed, and disposed of according to all applicable federal, state, and local statutes regulating such. In no case shall these materials and/or waters be allowed to enter, or potentially enter, on or off-site storm sewers, dry wells, or waterways or be allowed to move off the property where work is being completed.

8. Remove the Christy box or similar structure.

Destroy well by grouting neat cement with a tremie pipe or pressure grouting (25 psi for 5min.) to the bottom of the well and by filling with neat cement to three (3-5) feet below surface grade. Allow the sealing material to spill over the top of the casing to fill any annular space between casing and soil.

After the seal has set, backfill the remaining hole with concrete or compacted material to match existing conditions.

9. Copy of approved drilling permit must be on site at all times. Failure to present or show proof of the approved permit application on site shall result in a fine of \$500.00.

---

**CONFIDENTIAL**

STATE OF CALIFORNIA DWR  
WELL COMPLETION REPORT  
(WELL LOGS)

**REMOVED**

WELL NO. MW-1  
 PROJECT NO. P92270.3  
 DATE INSTALLED 3/10/93

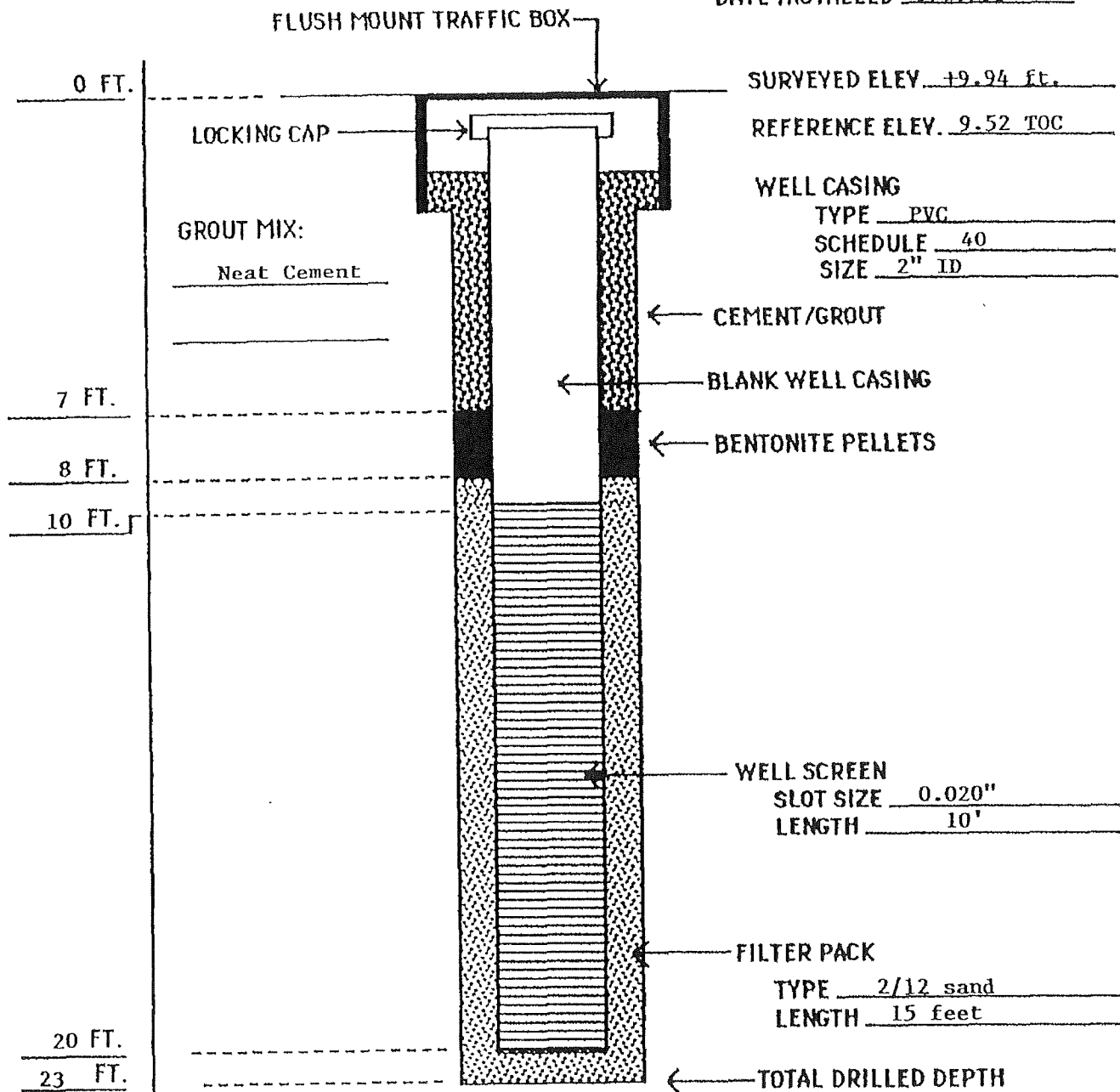

REMARKS : \_\_\_\_\_  
 \_\_\_\_\_

|                             |   |                            |
|-----------------------------|---|----------------------------|
| PROJECT NO. <u>P92270.3</u> | MONITORING WELL<br>INSTALLATION DIAGRAM | <b>BSK</b><br>& ASSOCIATES |
| FIGURE: <u>3</u>            |   |                            |

**CONFIDENTIAL**

STATE OF CALIFORNIA DWR  
WELL COMPLETION REPORT  
(WELL LOGS)

**REMOVED**

| DEPTH (Feet bgs) | FIELD DATA                         |                 |                       |            |           | BORING LOG: <u>MW-2R</u>   |  | WELL CONSTRUCTION |
|------------------|------------------------------------|-----------------|-----------------------|------------|-----------|--|--|-------------------|
|                  | SAMPLER TYPE/<br>SAMPLE NO.        | SAMPLE INTERVAL | TIME OF<br>COLLECTION | BLOWS/FOOT | PID (ppm) | USCS   | DESCRIPTION  |                   |
| 5                | Drilled with mast down no sampling |                 |                       |            |           | CL/CH  | 4" Concrete<br>Silty Sandy Clay: Olive brown/gray, moist, medium grained sand, very soft<br>2" PVC 0-5'<br>Cement 0-3'<br>Bentonite 3-4' |                   |
| 10               |                                    |                 |                       |            | SC        | Clayey Sand: Dark gray, loose medium grained sand<br>2/12 Sand 20-4' |  |                   |
| 15               |                                    |                 |                       |            | CL        | Sandy Clay: Dark olive gray, wet, very soft<br>Slotted PVC 20-5'     |  |                   |
| 20               |                                    |                 |                       |            | CL/CH     | Clayey Sand: Olive brown, wet, loose, medium grained sand            |  |                   |
| 25               |                                    |                 |                       |            | CL        | Sandy Clay: Olive brown, wet, fine grained sand                      |  |                   |
| 30               |                                    |                 |                       |            |           |  | Total Depth Well 20'   |                   |
| 35               |                                    |                 |                       |            |           |  |  |                   |

**CONFIDENTIAL**

STATE OF CALIFORNIA DWR  
WELL COMPLETION REPORT  
(WELL LOGS)

**REMOVED**

WELL NO. MW-3  
 PROJECT NO. P92270.3  
 DATE INSTALLED 3/10/93

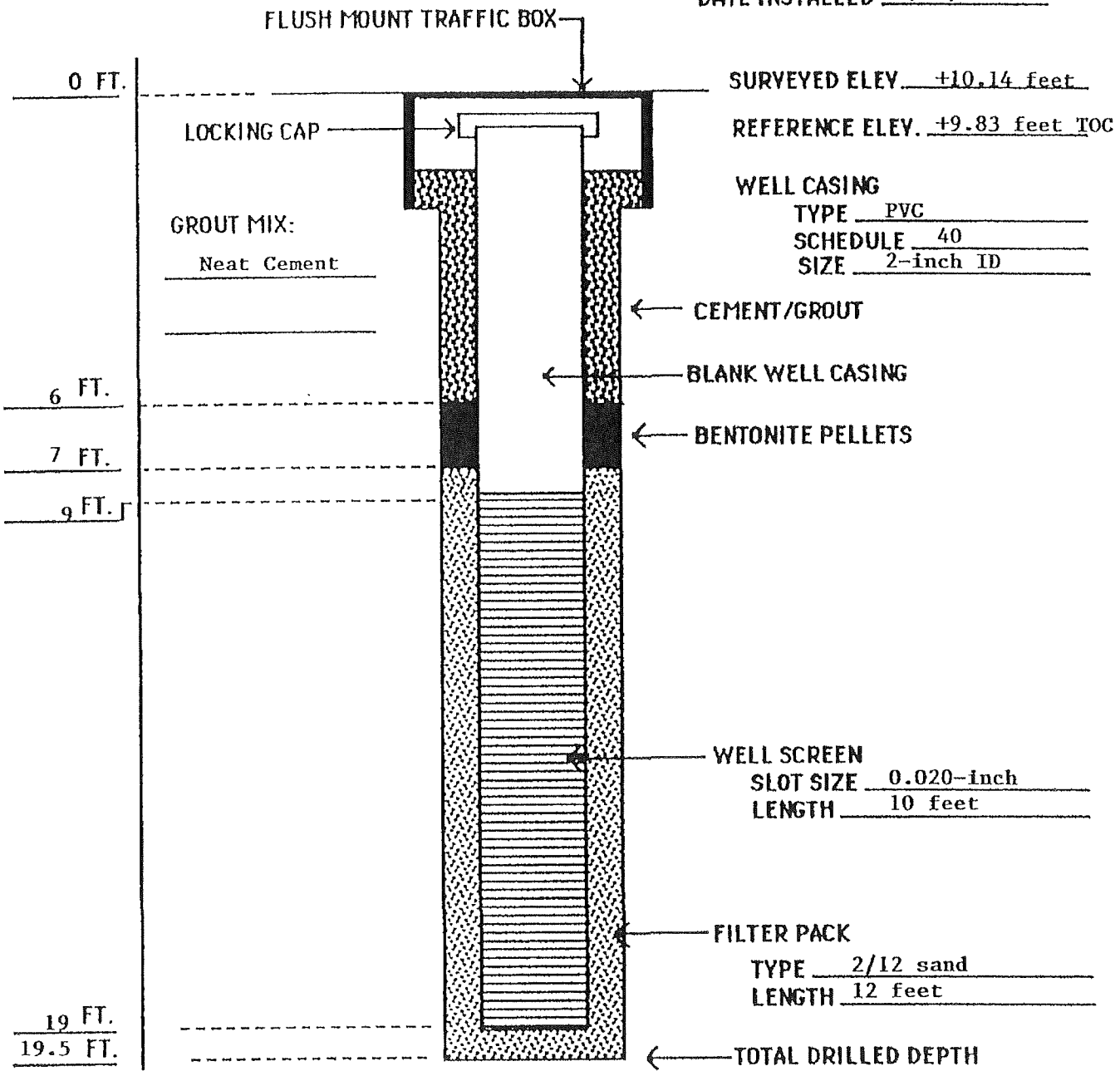

REMARKS : \_\_\_\_\_  
 \_\_\_\_\_

|                      |   |                            |
|----------------------|---|----------------------------|
| PROJECT NO. P92270.3 | MONITORING WELL<br>INSTALLATION DIAGRAM | <b>BSK</b><br>& ASSOCIATES |
| FIGURE: 5            |   |                            |

**CONFIDENTIAL**

STATE OF CALIFORNIA DWR  
WELL COMPLETION REPORT  
(WELL LOGS)

**REMOVED**



WELL NO. MW-4  
 PROJECT NO. P92270.3  
 DATE INSTALLED 3/10/93

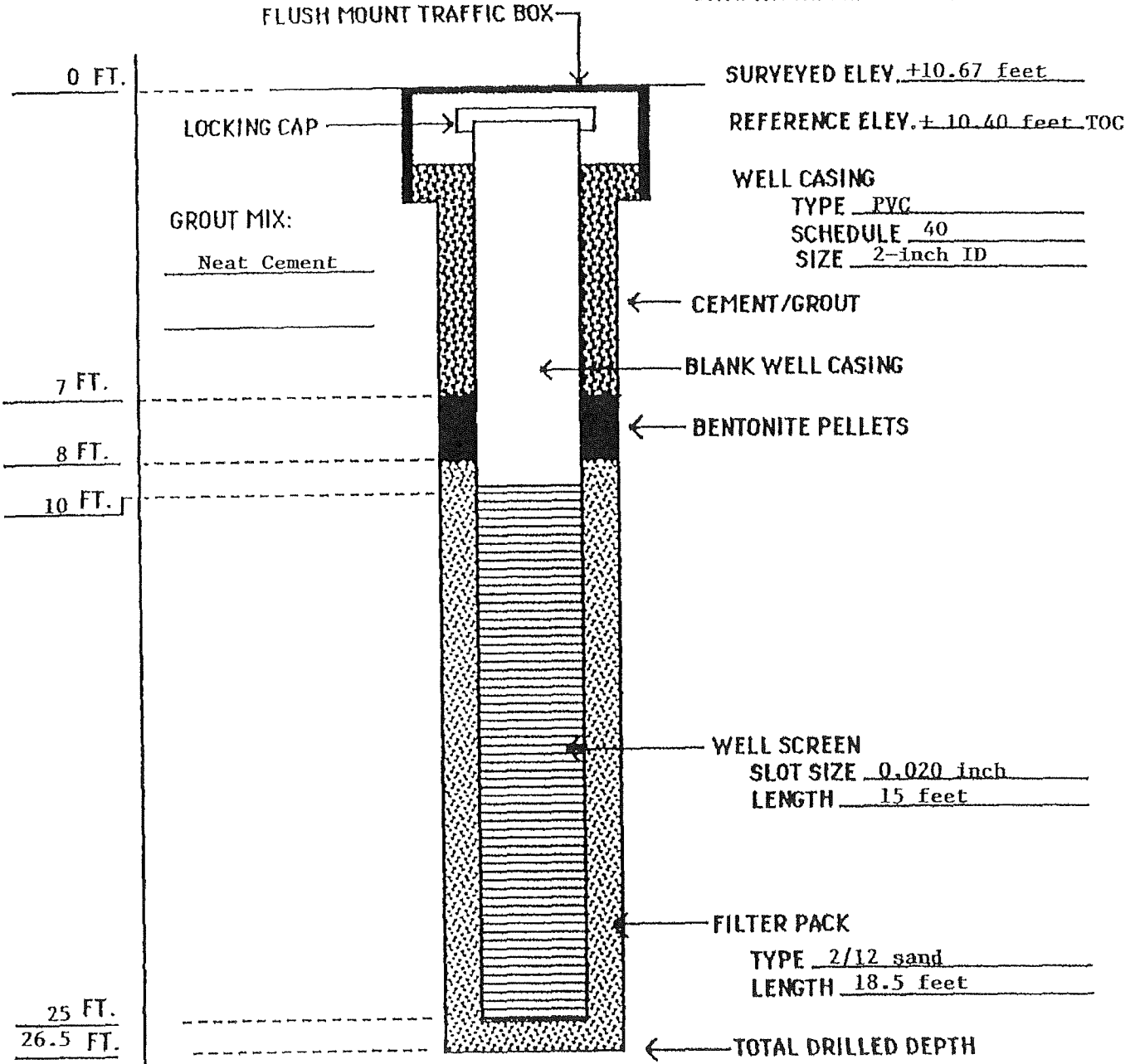

REMARKS : \_\_\_\_\_  
 \_\_\_\_\_

|                             |   |                            |
|-----------------------------|---|----------------------------|
| PROJECT NO. <u>P92270.3</u> | MONITORING WELL<br>INSTALLATION DIAGRAM | <b>BSK</b><br>& ASSOCIATES |
| FIGURE: <u>6</u>            |   |                            |

**CONFIDENTIAL**

STATE OF CALIFORNIA DWR  
WELL COMPLETION REPORT  
(WELL LOGS)

**REMOVED**

| DEPTH (Feet bgs) | FIELD DATA                  |                 |                       |            |           | BORING LOG: <u>MW-5</u>  |   | WELL CONSTRUCTION |
|------------------|-----------------------------|-----------------|-----------------------|------------|-----------|--|---|-------------------|
|                  | SAMPLER TYPE/<br>SAMPLE NO. | SAMPLE INTERVAL | TIME OF<br>COLLECTION | BLOWS/FOOT | PID (ppm) | DATE(S): <u>8/12/06</u><br>LOGGED BY: <u>E. Studley</u><br>WATER LEVEL: <u>13 feet at time of drilling</u><br>EQUIPMENT: <u>CME-75, 8" HSA</u> |   |                   |
|                  |                             |                 |                       |            |           | USCS   | DESCRIPTION   |                   |
| 5                | CS-1                        | █               | 11:05                 | 32         |           | Fill   | 3" Asphalt Concrete<br>Silty Sandy Gravel: Yellow brown, damp, (Fill) 2" PVC 0-5'                             |                   |
|                  |                             |                 |                       |            |           | CL/CH  | Sandy Silty Clay: Dark gray, damp to moist, fine grained sand<br>Cement 0-3'<br>Bentonite 3-4'                |                   |
|                  | CS-2                        | █               | 11:08                 | 11         |           | CH   | Silty Clay: Dark gray, moist, soft, trace organics<br>2/12 Sand 20-4'   |                   |
|                  | CS-3                        | █               | 11:12                 | 12         |           |  | Slotted PVC 20-5'   |                   |
| 10               | CS-4                        | █               | 11:15                 | 11         |           |  | Silty Clay: Brown mottled olive gray, moist, soft   |                   |
| 15               | CS-5                        | █               | 11:18                 | 4          |           | CL/CH  | Silty Sandy Clay: Olive brown, wet, soft medium grained sand  |                   |
| 20               | CS-6                        | █               | 11:24                 | 21         |           | SC   | grades mottled olive brown/gray<br>Clayey Silty Sand: Gray brown, medium grained sand<br>Total Depth Well 20' |                   |
| 25               |                             |                 |                       |            |           |  |   |                   |
| 30               |                             |                 |                       |            |           |  |   |                   |
| 35               |                             |                 |                       |            |           |  |   |                   |

**CONFIDENTIAL**

STATE OF CALIFORNIA DWR  
WELL COMPLETION REPORT  
(WELL LOGS)

**REMOVED**

| DEPTH (Feet bgs) | FIELD DATA                  |                 |                       |            |           | BORING LOG: <u>MW-6</u> |   | WELL CONSTRUCTION |
|------------------|-----------------------------|-----------------|-----------------------|------------|-----------|-------------------------|---|-------------------|
|                  | SAMPLER TYPE/<br>SAMPLE NO. | SAMPLE INTERVAL | TIME OF<br>COLLECTION | BLOWS/FOOT | PID (ppm) | USCS                    | DESCRIPTION   |                   |
|                  |                             |                 |                       |            |           | Fill                    | 3" Asphalt Concrete<br>Silty Sandy Gravel: Brown, damp, (Fill) 2" PVC 0-5'                                  |                   |
| 5                | CS-1                        |                 | 9:10                  | 10         |           | CL/CH<br>Fill           | Sandy Silty Clay: Dark gray brown, moist,<br>trace gravel, wood, brick (Fill) Cement 0-3'<br>Bentonite 3-4' |                   |
|                  | CS-2                        |                 | 9:15                  | 12         |           | CH                      | Silty Clay: Dark gray, moist, soft,<br>trace organics 2/12 Sand 20-4'                                       |                   |
|                  | CS-3                        |                 | 9:18                  | 14         |           |                         | grades dark gray to olive gray, very moist<br>Slotted PVC 20-5'   |                   |
| 10               | CS-4                        |                 | 9:21                  | 15         |           |                         | Silty Clay: Brown mottled olive gray,<br>very moist to wet in pores, some carbonates                        |                   |
| 15               | CS-5                        |                 | 9:25                  | 10         |           | CL/SC                   | Silty Clay/Clayey Sand: Brown to light olive<br>brown, wet  |                   |
| 20               | CS-6                        |                 | 9:38                  | 6          |           | CL/CH                   | Silty Clay: Brown to light olive brown, wet<br>Total Depth Well 20'   |                   |
| 25               |                             |                 |                       |            |           |                         |   |                   |
| 30               |                             |                 |                       |            |           |                         |   |                   |
| 35               |                             |                 |                       |            |           |                         |   |                   |

**CONFIDENTIAL**

STATE OF CALIFORNIA DWR  
WELL COMPLETION REPORT  
(WELL LOGS)

**REMOVED**

| DEPTH (Feet bgs) | FIELD DATA                  |                 |                       |            |           | BORING LOG: <u>MW-7</u> |  | WELL CONSTRUCTION |
|------------------|-----------------------------|-----------------|-----------------------|------------|-----------|-------------------------|--|-------------------|
|                  | SAMPLER TYPE/<br>SAMPLE NO. | SAMPLE INTERVAL | TIME OF<br>COLLECTION | BLOWS/FOOT | PID (ppm) | USCS                    | DESCRIPTION  |                   |
|                  |                             |                 |                       |            |           | Fill                    | 4" Concrete<br>Silty Sandy Gravel: Yellow brown, damp, (Fill) 2" PVC 0-5'                                  |                   |
| 5                | CS-1                        |                 | 15:26                 | 29         |           | CL/CH<br>Fill           | Silty Clay: Dark gray, damp, gravels to 1.5" glass, slag, concrete (Fill)<br>Cement 0-3'<br>Bentonite 3-4' |                   |
|                  | NR                          |                 | 15:30                 | 18         |           |                         | 2/12 Sand 20-4'  |                   |
| 10               | CS-2                        |                 | 15:34                 | 11         |           | CH                      | Silty Clay: Dark gray, wet, strong hydrocarbon odor<br>Slotted PVC 20-5'                                   |                   |
|                  | CS-3                        |                 | 15:45                 | 4          |           |                         | grades to dark gay mottled light gray wet, slight odor, roots/wood fragments                               |                   |
| 15               | CS-4                        |                 | 15:50                 | 7          |           | CL/CH                   | Sandy Silty Clay: Olive brown/gray, wet, soft, medium grained sand, faint odor                             |                   |
| 20               | CS-5                        |                 | 16:01                 | 9          |           |                         | grades to olive gray<br>Total Depth Well 20'   |                   |
| 25               |                             |                 |                       |            |           |                         |  |                   |
| 30               |                             |                 |                       |            |           |                         |  |                   |
| 35               |                             |                 |                       |            |           |                         |  |                   |

**CONFIDENTIAL**

STATE OF CALIFORNIA DWR  
WELL COMPLETION REPORT  
(WELL LOGS)

**REMOVED**



| DEPTH (Feet bgs) | FIELD DATA                  |                 |                       |            |           | BORING LOG: <u>MW-8</u>                         |  | WELL CONSTRUCTION |
|------------------|-----------------------------|-----------------|-----------------------|------------|-----------|---|--|-------------------|
|                  | SAMPLER TYPE/<br>SAMPLE NO. | SAMPLE INTERVAL | TIME OF<br>COLLECTION | BLOWS/FOOT | PID (ppm) | DATE(S): <u>8/12/06</u>                         |  |                   |
|                  |                             |                 |                       |            |           | LOGGED BY: <u>E. Studley</u>                    |  |                   |
|                  |                             |                 |                       |            |           | WATER LEVEL: <u>13 feet at time of drilling</u> |  |                   |
|                  |                             |                 |                       |            |           | EQUIPMENT: <u>CME-75, 8" HSA</u>                |  |                   |
|                  |                             |                 |                       |            |           | USCS  | DESCRIPTION  |                   |
|                  | CS-1                        |                 | 13:00                 | 20         |           | Fill  | 3" Asphalt Concrete<br>Silty Sandy Gravel: Yellow brown, moist, (Fill) 2" PVC 0-5'             |                   |
| 5                |                             |                 |                       |            |           | CL/CH<br>Fill                                   | Silty Clay: Dark olive brown, damp, gravels, Cement 0-3'<br>wire, debris (Fill) Bentonite 3-4' |                   |
|                  | CS-2                        |                 | 13:02                 | 6          |           | CL/CH   | Silty Clay: Dark olive brown, moist to wet 2/12 Sand 20-4'<br>medium grained sand lenses       |                   |
|                  | CS-3                        |                 | 13:08                 | 12         |           |   | Slotted PVC 20-5'  |                   |
| 10               | NR                          |                 |                       | 13         |           | CH  | grades to olive brown mottled gray   |                   |
| 15               | CS-4                        |                 | 13:29                 | 5          |           | CL/CH   | Silty Sandy Clay: Olive brown, wet,<br>soft, medium grained sand                               |                   |
| 20               | CS-5                        |                 | 13:36                 | 15         |           |   | trace carbonates<br>Total Depth Well 20'   |                   |
| 25               |                             |                 |                       |            |           |   |  |                   |
| 30               |                             |                 |                       |            |           |   |  |                   |
| 35               |                             |                 |                       |            |           |   |  |                   |

**CONFIDENTIAL**

STATE OF CALIFORNIA DWR  
WELL COMPLETION REPORT  
(WELL LOGS)

**REMOVED**

| DEPTH (Feet bgs) | FIELD DATA                  |                 |                       |            |           | BORING LOG: <u>MW-9</u> |  | WELL CONSTRUCTION |
|------------------|-----------------------------|-----------------|-----------------------|------------|-----------|-------------------------|--|-------------------|
|                  | SAMPLER TYPE/<br>SAMPLE NO. | SAMPLE INTERVAL | TIME OF<br>COLLECTION | BLOWS/FOOT | PID (ppm) | USCS                    | DESCRIPTION  |                   |
|                  | DP-1                        |                 | 10:57                 |            |           | Fill                    | 6" Concrete<br>Silty Clay: Dark gray, some concrete debris |                   |
| 5                | DP-2                        |                 | 11:03                 |            |           | CH                      | Silty Clay: Dark gray, hydrocarbon odor                    |                   |
|                  | DP-3                        |                 | 11:10                 |            |           |                         | 2" PVC 0-5'<br>Cement 0-3'<br>Bentonite 3-4'               |                   |
| 10               | DP-4                        |                 | 11:29                 |            |           | CH                      | Silty Clay: Olive brown/brown, no odor                     |                   |
| 15               | DP-5                        |                 | 11:36                 |            |           |                         | Slotted PVC 20-5'  |                   |
| 20               | DP-6                        |                 | 11:40                 |            |           |                         | grades wet, slight odor<br><br>some fine sand, odor        |                   |
|                  |                             |                 |                       |            |           |                         | Total Depth Well 20'                                       |                   |
| 25               |                             |                 |                       |            |           |                         |  |                   |
| 30               |                             |                 |                       |            |           |                         |  |                   |
| 35               |                             |                 |                       |            |           |                         |  |                   |