

1089

April 30, 2003

Mr. Kelly Engineer
1791 Pine Street
Concord, California 94520

Alameda County
MAY 06 2003
Environmental Health

RE: Groundwater Sampling Letter Report
3820 San Leandro Street, Oakland, California
ACC Project Number 6651-001.00

Dear Mr. Engineer:

ACC Environmental Consultants, Inc., (ACC) has prepared this letter report to document results of groundwater sampling at 3820 San Leandro Street, Oakland, California. The project objectives were to obtain groundwater samples from three onsite monitoring wells, analyze the water samples for constituents of concern, and report the findings.

On your behalf, ACC will forward a copy of this report to Mr. Barney Chan of the Alameda County Health Care Services Agency (ACHCSA) for review.

BACKGROUND

The site consists of a gasoline and diesel fueling station (Guy's Diesel) located at 3820 San Leandro Street in Oakland, California (Figure 1). In his letter dated June 12, 2000, Mr. Chan of the ACHCSA requested that groundwater monitoring and sampling be performed at the site, and that the groundwater samples be analyzed for total petroleum hydrocarbons as gasoline (TPHg) and diesel (TPHd), benzene, toluene, ethylbenzene and total xylenes (BTEX), and methyl tertiary butyl ether (MTBE). In addition, one groundwater sample was analyzed for all fuel oxygenates in accordance with regulations recently enacted by the Regional Water Quality Control Board (RWQCB).

In January 2003, ACC obtained and reviewed a copy of the August 10, 1998 Soil and Groundwater Investigation Report, prepared by Brunsing Associates, Inc. (Brunsing) for Mr. Kelly Engineer. According to Brunsing, two diesel fuel and two gasoline fuel underground storage tanks (USTs) were removed by American Consulting Remediation and Construction (ACRC) in January 1998. UST removal activities were summarized in ACRC's Tank Closure Report. Excavated soil removed during the UST removal was profiled and disposed at Forward Landfill. Brunsing advanced six exploratory soil borings (B1, B2, B5, B6, and B7) and installed three groundwater monitoring wells. The monitoring wells were subsequently developed and sampled on July 6, 1998. The six exploratory soil borings were completed to depths of 7.0 to 16.5 feet below ground surface (bgs) and the three groundwater monitoring wells were completed to depths of 21.0 to 21.5 feet bgs. The three groundwater monitoring wells are screened from 5 to 20 feet bgs.

FIELD PROCEDURES

Groundwater Sampling

ACC performed groundwater sampling at the site on April 17, 2003. The locations of the three monitoring wells are illustrated on Figure 2. Prior to groundwater sampling, the depth to the surface of the water table in each well was measured from the top of the well casing using an electronic water level meter. The water level measurements were recorded to the nearest 0.01 foot. The wells were constructed of 2-inch diameter polyvinyl chloride (PVC) with locked well caps, and appeared to be in good condition. The total depth of each of the wells was approximately 20 feet below ground surface (bgs), and the depth to groundwater was measured to be approximately 11 feet below the top of the well casing.

TABLE 1 - GROUNDWATER DEPTH INFORMATION

Well No.	Well Elevation* (above MSL)	Date Measured	Depth to Groundwater	Groundwater Elevation
MW-1	27.54	07/06/98**	7.77	19.77
		09/10/00	N/A	N/A
		04/10/01	7.34	20.20
		07/17/01	9.00	18.54
		01/15/03	6.94	20.60
		04/17/03	7.01	20.53
MW-2	25.97	07/06/98**	8.15	17.82
		09/10/00	N/A	N/A
		04/10/01	7.32	18.65
		07/17/01	8.96	17.01
		01/15/03	7.25	18.72
		04/17/03	7.43	18.54
MW-3	26.52	07/06/98**	8.42	18.10
		09/10/00	N/A	N/A
		04/10/01	7.73	18.79
		07/17/01	8.42	18.10
		01/15/03	7.60	18.92
		04/17/03	8.07	18.45

Notes: All measurements in feet
 *Well elevation measured to top of casing
 **Groundwater elevations recorded by BACE Environmental

Groundwater Gradient

Groundwater elevations were calculated from data collected from the wells on April 17, 2003. The calculated groundwater flow direction and gradient values are south at 0.050 feet per feet. Historic values are summarized in Table 2.

TABLE 2 - GROUNDWATER GRADIENT AND FLOW DIRECTION

Date Monitored	Gradient (foot/foot)	Direction
07/06/98	0.04	South
09/10/00	N/A	N/A
04/10/01	0.038	South
07/17/01	0.020	East
01/15/03	0.038	South
04/17/03	0.050	South

After water level measurements were collected, wells MW-1, MW-2 and MW-3 were purged by hand using a designated disposable polyethylene bailer for each well. The wells were considered to be purged when approximately four volumes were removed from each well. The removed purge water was stored onsite in a steel 55-gallon drum.

After the groundwater level had recovered to a minimum of approximately 80 percent of its static level in wells MW-1 and MW-2 and 60 percent in well MW-3, water samples were obtained using designated disposable polyethylene bailers. Three 40-milliliter VOA vials and one amber glass liter were filled to overflowing with the water collected from the three wells. The samples were preserved in a pre-chilled, insulated container and submitted to STL San Francisco (STL-SF), a state-certified analytical laboratory, following chain of custody protocol.

Analytical Results

Groundwater samples from wells MW-1, MW-2 and MW-3 were submitted to STL-SF for analysis of TPHg, TPHd, BTEX, and MTBE by EPA Method 8260B. Relatively minor concentrations were reported in monitoring wells MW-1 and MW-2 and elevated TPHg, BTEX, and MTBE were reported in monitoring well MW-3.

Analytical results from the groundwater samples are summarized in Table 3. Copies of the analytical results and chain of custody record are attached.

**TABLE 3 - GROUNDWATER SAMPLE ANALYTICAL RESULTS
 PETROLEUM HYDROCARBONS**

Sample ID	Date	TPHg (µg/L)	TPHd (µg/L)	Benzene (µg/L)	Toluene (µg/L)	Ethylbenzene (µg/L)	Total Xylenes (µg/L)	MTBE (µg/L)
MW-1	07/06/98	4,100	< 100	36	53	< 5.0	20	80
	09/10/00	1,000 ^g	1,800 ^{ndp}	4.8	< 0.50	6.2	1.2	< 5.0
	04/10/01	1,100	N/A	12	7.7	< 2.5	< 2.5	73
	07/17/01	920	320 ^{ndp}	6.2	1.1	< 0.50	< 0.50	49
	01/15/03	360 ^g	86 ^{ndp}	5.5	< 0.50	4.3	1.3	19
	04/17/03	< 50	< 50	< 0.50	< 0.50	< 0.50	< 1.0	11
MW-2	07/06/98	6,400	< 100	190	14	13	12	210
	09/10/00	760 ^g	270 ^{edr}	19	< 0.50	< 0.50	< 0.50	110
	04/10/01	320	N/A	3.6	1.1	1.2	0.79	< 5.0
	07/17/01	440 ^g	68 ^{ndp}	6.0	< 0.50	6.2	< 0.50	< 5.0
	01/15/03	750 ^g	250 ^{ndp}	13	< 0.50	< 0.50	< 0.50	78
	04/17/03	180	120	< 0.50	< 0.50	< 0.50	< 1.0	8.1
MW-3	07/06/98	36,000	< 100	6,700	72	6.2	530	13,000
	09/10/00	20,000 ^g	4,200 ^{ndp}	9,200	70	710	79	6,400
	04/10/01	15,000	N/A	4,500	27	320	140	8,800
	07/17/01	28,000 ^g	8,000 ^{ndp}	7,000	< 50	270	75	15,000
	01/15/03	40,000 ^g	11,000 ^{ndp}	10,000	110	680	210	20,000
	04/17/03	39,000	3,200 ^{ndp}	11,000	< 100	870	< 200	34,000

Notes: µg/L = micrograms per liter (approximately equivalent to parts per billion)
 < Indicates the sample tested below the indicated laboratory reporting limit
 g = hydrocarbon reported does not match the laboratory's gasoline standard
 edr = hydrocarbon is in the early diesel range and does not match the laboratory's diesel standard
 ndp = hydrocarbon reported does not match the laboratory diesel standard
 N/A = sample not analyzed for this constituent

DISCUSSION

This sampling event was performed to document trends in groundwater flow direction, gradient, and concentrations of constituents of concern at the Site. Previous site investigation and groundwater monitoring results have demonstrated that soil and groundwater have been impacted by a release from the former onsite USTs and/or fuel delivery system.

Similar to previous groundwater monitoring events, the groundwater sample from well MW-3 reported the highest concentrations of petroleum hydrocarbons and related constituents. Well MW-3 reported 39,000 parts per billion (ppb) TPHg, 3,200 ppb TPHd, 11,000 ppb benzene, 34,000 ppb MTBE, and lesser concentrations of toluene, ethylbenzene, and xylenes. Concentrations of constituents of concern were significantly less in wells MW-1 and MW-2, indicating that the release(s) may be localized in the vicinity of well MW-3.

As requested by the Alameda County Health Care Services Agency, downgradient subsurface investigation is warranted to determine the horizontal extent of impact in groundwater and help evaluate the necessity for groundwater remediation and/or additional groundwater monitoring wells.

CONCLUSIONS

Based on groundwater sample analytical results, ACC has made the following conclusions:

- Groundwater at the site is being impacted by releases of petroleum hydrocarbons as TPHg, TPHd, BTEX, and MTBE;
- Groundwater flow direction and gradient are consistent with historical trends and approximate surface topography;
- The majority of impacted groundwater appears to be located in the vicinity of well MW-3 (closest to San Leandro Street); and
- No fuel oxygenates other than MTBE were detected above laboratory reporting limits in well MW-1.

RECOMMENDATIONS

Based on conclusions of groundwater monitoring performed to date, ACC recommends the following:

- Perform additional downgradient investigation according to a Work Plan approved by the ACHCSA;
- Evaluate groundwater extraction in well MW-3 as an interim remedial option and to help minimize offsite migration; and
- Analyze future water samples from well MW-3 for TPHg, BTEX, and all fuel oxygenates by EPA Method 8260B.

A Work Plan for a proposed downgradient groundwater investigation will be submitted under separate cover in early May 2003.

Mr. Kelly Engineer

April 30, 2003

Page 6

If you have any questions regarding this report or the findings of the work, please contact me at (510) 638-8400, extension 109.

Sincerely,

A handwritten signature in black ink that reads "D. DeMent". The signature is written in a cursive style with a large initial "D" and a stylized "DeMent".

David R. DeMent, RG, REA II
Environmental Division Manager

cc: Mr. Barney Chan, ACHCSA
Mr. Paul Rosenstein, Esq.

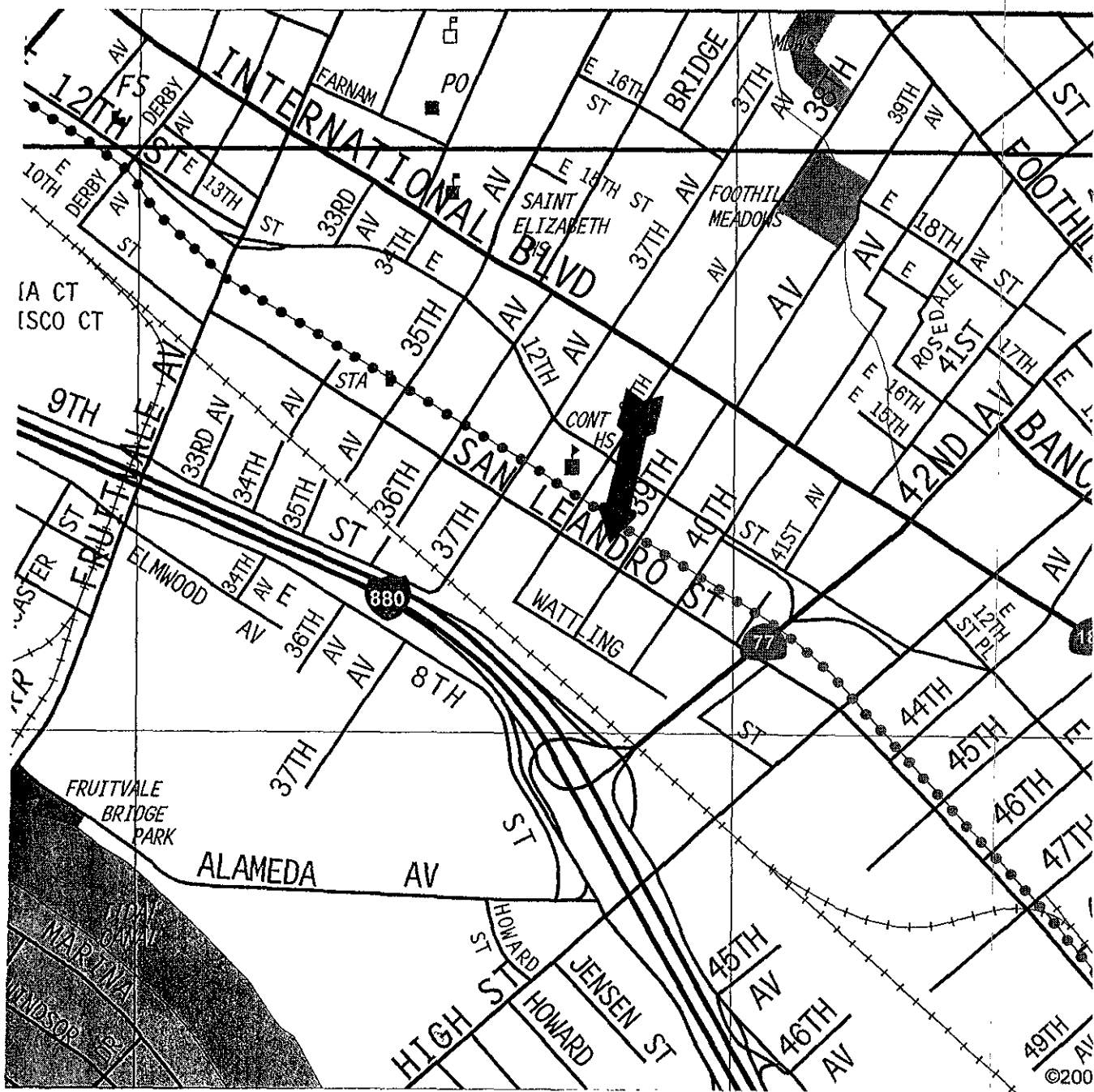

IA CT
ISCO CT

Source: Thomas Guide Digital Edition 2002

Title: Location Map 3820 San Leandro Street Oakland, California	
Figure Number: 1	Scale: None
Project No:6651-001.00	Drawn By: TRB
A • C • C ENVIRONMENTAL CONSULTANTS	Date: 5/1/03
7977 Capwell Drive, Suite 100 Oakland, California 94621 (510) 638-8400 Fax: (510) 638-8404	

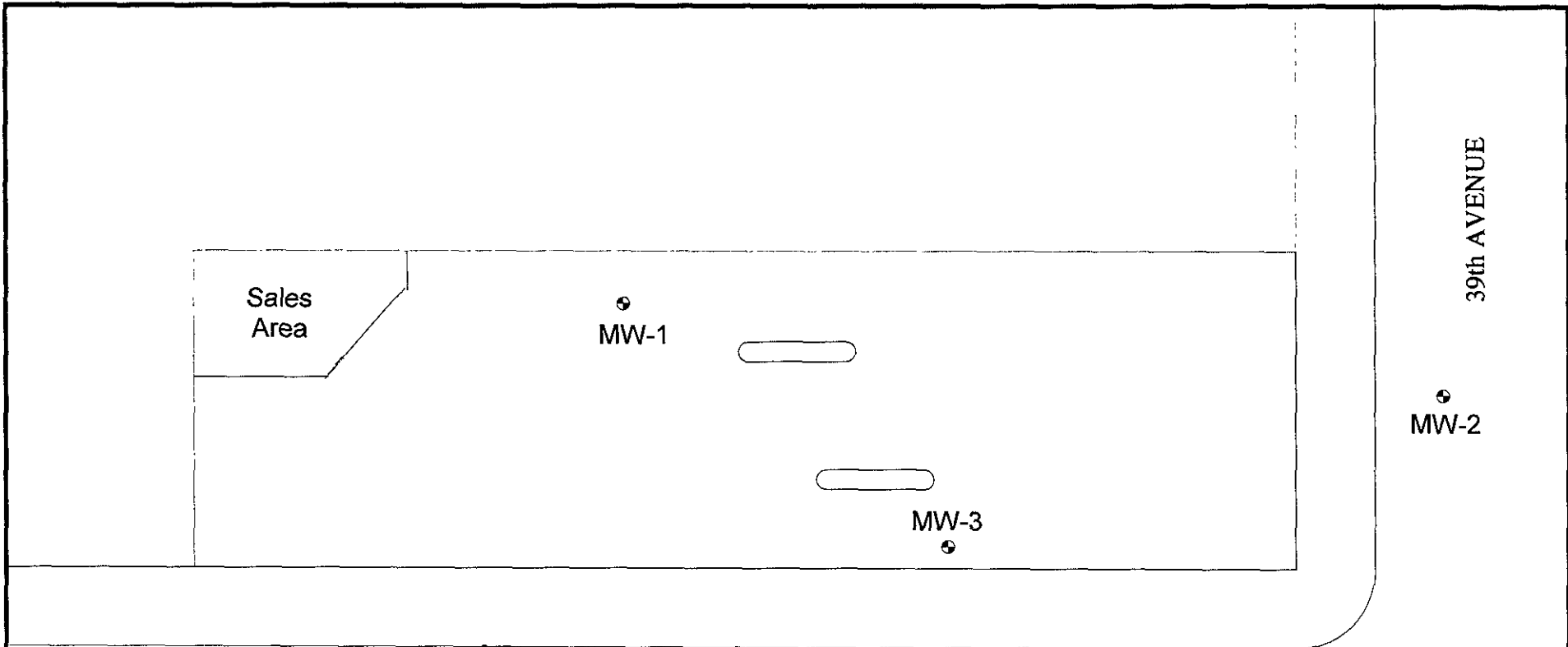

SAN LEANDRO STREET

39th AVENUE

Sales Area

MW-1

MW-2

MW-3

LEGEND

 - Groundwater Monitoring Well
MW-3

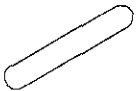

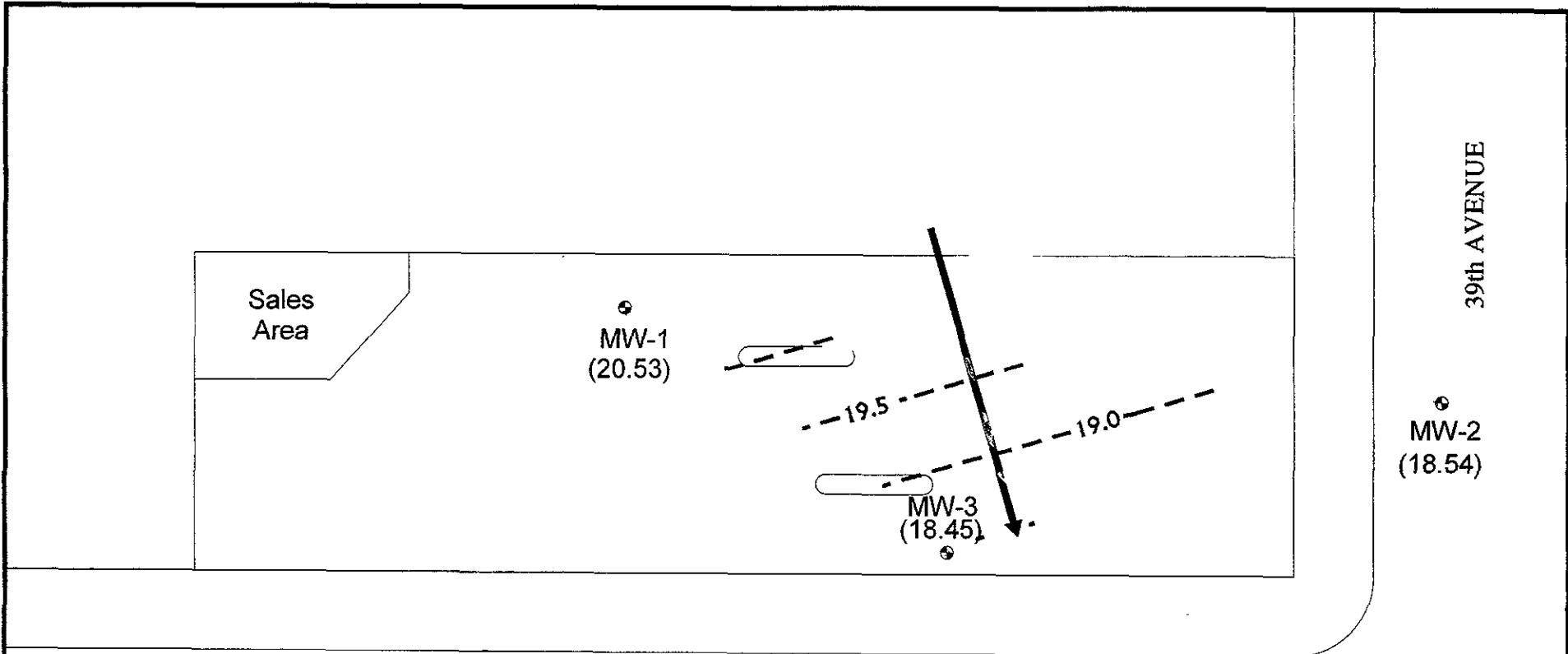

 - Pump Island

Title: Site Plan 3820 San Leandro Street Oakland, California	
Figure Number: 2	Scale: 1" = 20'
Project Number: 6651-01.00	Drawn By: TRB
A·C·C <hr/> ENVIRONMENTAL CONSULTANTS	Date: 5/1/03
	
7977 Capwell Drive, Suite 100 Oakland, California 94621 (510) 638-8400 Fax (510) 638-8404	



SAN LEANDRO STREET

LEGEND

-  MW-3 (18.79) - Groundwater Monitoring Well
-  - Groundwater Elevation Contour
-  - Groundwater Flow Direction
-  - Pump Island

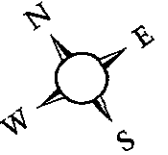
Title: Gradient Map	
3820 San Leandro Street	
Oakland, California	
Figure Number: 3	Scale: 1" = 20'
Project Number: 6651-01.00	Drawn By: TRB
A • C • C ENVIRONMENTAL CONSULTANTS	Date: 5/1/03
	
7977 Capwell Drive, Suite 100 Oakland, California 94621 (510) 638-8400 Fax (510) 638-8404	

JOB NAME: Guy's Gas/Diesel	PURGE METHOD: Manual Bail
SITE ADDRESS: 3820 San Leandro Street	SAMPLED BY: ETG
JOB #: 6051-001.00	LABORATORY: STZ-SF
DATE: 4/17/03	ANALYSIS: TPH _h /BTEX/TPH _g /MTBE
On-site Drum Inventory: SOIL: 1 @ 100%	MONITORING <input checked="" type="checkbox"/> DEVELOPING <input type="checkbox"/>
EMPTY: WATER:	SAMPLING <input checked="" type="checkbox"/>

	PURGE VOL.	PURGE WATER READINGS						OBSERVATIONS	
	(Gal)	pH	Temp.(C)	Cond.	Sal.	Turb.	D.O.	<input type="checkbox"/>	
WELL: MW-1								<input type="checkbox"/>	Froth
DEPTH OF BORING: 20.03	2.1	7.01	20.0	0.745	0.03	114	1.38	<input type="checkbox"/>	Sheen
DEPTH TO WATER: 7.01	4.2	7.00	20.1	0.745	0.03	156	1.41	<input type="checkbox"/>	Odor Type _____
WATER COLUMN: 13.02	6.3	6.85	20.1	0.745	0.03	202	1.43	<input type="checkbox"/>	Free Product
WELL DIAMETER: 2"	8.4	6.80	20.1	0.745	0.03	232	1.43	<input type="checkbox"/>	Amount _____ Type _____
WELL VOLUME:								<input type="checkbox"/>	Other
COMMENTS: Purge: 11:00 Sample: 12:30									
WELL: MW-2								<input type="checkbox"/>	Froth
DEPTH OF BORING: 20.07	2.1	6.87	19.1	0.80	0.03	225	1.20	<input type="checkbox"/>	Sheen
DEPTH TO WATER: 7.43	4.2	6.84	19.1	0.84	0.03	246	1.21	<input type="checkbox"/>	Odor Type _____
WATER COLUMN: 12.64	6.3	6.79	19.2	0.84	0.03	313	1.28	<input type="checkbox"/>	Free Product
WELL DIAMETER: 2"	8.4	6.80	19.2	0.84	0.03	340	1.21	<input type="checkbox"/>	Amount _____ Type _____
WELL VOLUME:								<input type="checkbox"/>	Other
COMMENTS: Purge: 11:30 Sample: 12:45									
WELL: MW-3								<input type="checkbox"/>	Froth
DEPTH OF BORING: 19.49	2.0	6.91	20.1	1.51	0.07	225	1.13	<input type="checkbox"/>	Sheen
DEPTH TO WATER: 8.07	4.0	6.85	20.1	1.56	0.07	308	1.21	<input checked="" type="checkbox"/>	Odor Type <u>Gas/Diesel</u>
WATER COLUMN: 11.42	6.0	6.76	20.1	1.56	0.07	999	1.23	<input type="checkbox"/>	Free Product
WELL DIAMETER: 2"	8.0	6.76	20.1	1.56	0.07	999	1.20	<input type="checkbox"/>	Amount _____ Type _____
WELL VOLUME:								<input type="checkbox"/>	Other
COMMENTS: Purge: 12:00 Sample: 13:00									

ACC Environmental Consultants

April 29, 2003

7977 Capwell Drive, Suite 100
Oakland, CA 94621

Attn.: Ed Giacometti

Project#: 6651-001.00

Project: 3820 San Leandro St.

Dear Mr. Giacometti,

Attached is our report for your samples received on 04/18/2003 13:20

This report has been reviewed and approved for release. Reproduction of this report is permitted only in its entirety.

Please note that any unused portion of the samples will be discarded after 06/02/2003 unless you have requested otherwise.

We appreciate the opportunity to be of service to you. If you have any questions, please call me at (925) 484-1919.

You can also contact me via email. My email address is: vvancil@stl-inc.com

Sincerely,



Vincent Vancil
Project Manager

Severn Trent Laboratories, Inc.

STL San Francisco * 1220 Quarry Lane, Pleasanton, CA 94566

Tel 925 484 1919 Fax 925 484 1096 * www.stl-inc.com * CA DHS ELAP# 2496

Fuel Oxygenates by 8260B

ACC Environmental Consultants

Attn.: Ed Giacometti

7977 Capwell Drive, Suite 100

Oakland, CA 94621

Phone: (510) 638-8400 Fax: (510) 638-8404

Project: 6651-001.00

3820 San Leandro St.

Received: 04/18/2003 13:20

Samples Reported

Sample Name	Date Sampled	Matrix	Lab #
MW-1	04/17/2003 12:30	Water	1
MW-2	04/17/2003 12:45	Water	2
MW-3	04/17/2003 12:50	Water	3

Fuel Oxygenates by 8260B

ACC Environmental Consultants

Attn.: Ed Giacometti

7977 Capwell Drive, Suite 100
Oakland, CA 94621
Phone: (510) 638-8400 Fax: (510) 638-8404

Project: 6651-001.00
3820 San Leandro St.

Received: 04/18/2003 13:20

Prep(s):	5030B	Test(s):	8260B
Sample ID:	MW-1	Lab ID:	2003-04-0482-1
Sampled:	04/17/2003 12:30	Extracted:	4/29/2003 12:47
Matrix:	Water	QC Batch#:	2003/04/29-01.65

Compound	Conc.	RL	Unit	Dilution	Analyzed	Flag
Gasoline	ND	50	ug/L	1.00	04/29/2003 12:47	
Methyl tert-butyl ether (MTBE)	11	0.50	ug/L	1.00	04/29/2003 12:47	
Benzene	ND	0.50	ug/L	1.00	04/29/2003 12:47	
Toluene	ND	0.50	ug/L	1.00	04/29/2003 12:47	
Ethylbenzene	ND	0.50	ug/L	1.00	04/29/2003 12:47	
Total xylenes	ND	1.0	ug/L	1.00	04/29/2003 12:47	
Surrogates(s)						
1,2-Dichloroethane-d4	88.9	76-114	%	1.00	04/29/2003 12:47	
Toluene-d8	92.8	88-110	%	1.00	04/29/2003 12:47	

Fuel Oxygenates by 8260B

ACC Environmental Consultants

Attn.: Ed Giacometti

7977 Capwell Drive, Suite 100

Oakland, CA 94621

Phone: (510) 638-8400 Fax: (510) 638-8404

Project: 6651-001.00

3820 San Leandro St.

Received: 04/18/2003 13:20

Prep(s):	5030B	Test(s):	8260B
Sample ID:	MW-2	Lab ID:	2003-04-0482 - 2
Sampled:	04/17/2003 12:45	Extracted:	4/26/2003 03:36
Matrix:	Water	QC Batch#:	2003/04/25-02.64

Compound	Conc.	RL	Unit	Dilution	Analyzed	Flag
Gasoline	180	50	ug/L	1.00	04/26/2003 03:36	
Methyl tert-butyl ether (MTBE)	8.1	0.50	ug/L	1.00	04/26/2003 03:36	
Benzene	ND	0.50	ug/L	1.00	04/26/2003 03:36	
Toluene	ND	0.50	ug/L	1.00	04/26/2003 03:36	
Ethylbenzene	ND	0.50	ug/L	1.00	04/26/2003 03:36	
Total xylenes	ND	1.0	ug/L	1.00	04/26/2003 03:36	
Surrogates(s)						
1,2-Dichloroethane-d4	109.9	76-114	%	1.00	04/26/2003 03:36	
Toluene-d8	103.8	88-110	%	1.00	04/26/2003 03:36	

Fuel Oxygenates by 8260B

ACC Environmental Consultants

Attn.: Ed Giacometti

7977 Capwell Drive, Suite 100
Oakland, CA 94621
Phone: (510) 638-8400 Fax: (510) 638-8404

Project: 6651-001.00
3820 San Leandro St.

Received: 04/18/2003 13:20

Prep(s):	5030B	Test(s):	8260B
Sample ID:	MW-3	Lab ID:	2003-04-0482 - 3
Sampled:	04/17/2003 12:50	Extracted:	4/26/2003 03:58
Matrix:	Water	QC Batch#:	2003/04/25-02.64

Compound	Conc.	RL	Unit	Dilution	Analyzed	Flag
Gasoline	39000	10000	ug/L	200.00	04/26/2003 03:58	
Methyl tert-butyl ether (MTBE)	34000	100	ug/L	200.00	04/26/2003 03:58	
Benzene	11000	100	ug/L	200.00	04/26/2003 03:58	
Toluene	ND	100	ug/L	200.00	04/26/2003 03:58	
Ethylbenzene	870	100	ug/L	200.00	04/26/2003 03:58	
Total xylenes	ND	200	ug/L	200.00	04/26/2003 03:58	
Surrogates(s)						
1,2-Dichloroethane-d4	111.3	76-114	%	200.00	04/26/2003 03:58	
Toluene-d8	98.3	88-110	%	200.00	04/26/2003 03:58	

Fuel Oxygenates by 8260B

ACC Environmental Consultants

Attn.: Ed Giacometti

7977 Capwell Drive, Suite 100
Oakland, CA 94621
Phone: (510) 638-8400 Fax: (510) 638-8404

Project: 6651-001.00
3820 San Leandro St.

Received: 04/18/2003 13:20

Batch QC Report					
Prep(s): 5030B Method Blank MB: 2003/04/25-02.64-005		Water		Test(s): 8260B QC Batch # 2003/04/25-02.64 Date Extracted: 04/25/2003 22:29	
Compound	Conc.	RL	Unit	Analyzed	Flag
Gasoline	ND	50	ug/L	04/25/2003 22:29	
Methyl tert-butyl ether (MTBE)	ND	0.5	ug/L	04/25/2003 22:29	
Benzene	ND	0.5	ug/L	04/25/2003 22:29	
Toluene	ND	0.5	ug/L	04/25/2003 22:29	
Ethylbenzene	ND	0.5	ug/L	04/25/2003 22:29	
Total xylenes	ND	1.0	ug/L	04/25/2003 22:29	
Surrogates(s)					
1,2-Dichloroethane-d4	107.2	76-114	%	04/25/2003 22:29	
Toluene-d8	99.8	88-110	%	04/25/2003 22:29	

Fuel Oxygenates by 8260B

ACC Environmental Consultants

Attn.: Ed Giacometti

7977 Capwell Drive, Suite 100
Oakland, CA 94621
Phone: (510) 638-8400 Fax: (510) 638-8404

Project: 6651-001.00
3820 San Leandro St.

Received: 04/18/2003 13:20

Batch QC Report			
Prep(s): 5030B			Test(s): 8260B
Method Blank	Water		QC Batch # 2003/04/29-01.65
MB: 2003/04/29-01.65-004			Date Extracted: 04/29/2003 10:35

Compound	Conc.	RL	Unit	Analyzed	Flag
Gasoline	ND	50	ug/L	04/29/2003 10:35	
Methyl tert-butyl ether (MTBE)	ND	0.5	ug/L	04/29/2003 10:35	
Benzene	ND	0.5	ug/L	04/29/2003 10:35	
Toluene	ND	0.5	ug/L	04/29/2003 10:35	
Ethylbenzene	ND	0.5	ug/L	04/29/2003 10:35	
Total xylenes	ND	1.0	ug/L	04/29/2003 10:35	
Surrogates(s)					
1,2-Dichloroethane-d4	88.8	76-114	%	04/29/2003 10:35	
Toluene-d8	92.8	88-110	%	04/29/2003 10:35	

Fuel Oxygenates by 8260B

ACC Environmental Consultants

Attn.: Ed Giacometti

7977 Capwell Drive, Suite 100
Oakland, CA 94621
Phone: (510) 638-8400 Fax: (510) 638-8404

Project: 6651-001.00
3820 San Leandro St.

Received: 04/18/2003 13:20

Batch QC Report			
Prep(s): 5030B			Test(s): 8260FAB
Laboratory Control Spike	Water		QC Batch # 2003/04/25-02.64
LCS 2003/04/25-02.64-003	Extracted: 04/25/2003		Analyzed: 04/25/2003 21:45
LCSD 2003/04/25-02.64-002	Extracted: 04/25/2003		Analyzed: 04/25/2003 22:07

Compound	Conc. ug/L		Exp.Conc.	Recovery		RPD	Ctrl.Limits %		Flags	
	LCS	LCSD		LCS	LCSD		%	Rec.	RPD	LCS
Benzene	24.2	22.4	25.0	96.8	89.6	7.7	69-129	20		
Toluene	24.5	22.6	25.0	98.0	90.4	8.1	70-130	20		
Methyl tert-butyl ether (MTBE)	28.7	28.1	25.0	114.8	112.4	2.1	65-165	20		
Surrogates(s)										
1,2-Dichloroethane-d4	547	546	500	109.4	109.2		76-114	0		
Toluene-d8	493	494	500	98.6	98.8		88-110	0		

Severn Trent Laboratories, Inc.

STL San Francisco * 1220 Quarry Lane, Pleasanton, CA 94566

Tel 925 484 1919 Fax 925 484 1096 * www.stl-inc.com * CA DHS ELAP# 2496

04/29/2003 14:33

Fuel Oxygenates by 8260B

ACC Environmental Consultants

Attn.: Ed Giacometti

7977 Capwell Drive, Suite 100
Oakland, CA 94621
Phone: (510) 638-8400 Fax: (510) 638-8404

Project: 6651-001.00
3820 San Leandro St.

Received: 04/18/2003 13:20

Batch QC Report										
Prep(s): 5030B						Test(s): 8260FAB				
Laboratory Control Spike			Water			QC Batch # 2003/04/29-01.65				
LCS	2003/04/29-01.65-002		Extracted: 04/29/2003			Analyzed: 04/29/2003 09:51				
LCSD	2003/04/29-01.65-001		Extracted: 04/29/2003			Analyzed: 04/29/2003 10:58				
Compound	Conc. ug/L		Exp.Conc.	Recovery		RPD	Ctrl.Limits %		Flags	
	LCS	LCSD		LCS	LCSD		%	Rec.	RPD	LCS
Benzene	24.6	25.1	25.0	98.4	100.4	2.0	69-129	20		
Toluene	24.4	24.4	25.0	97.6	97.6	0.0	70-130	20		
Methyl tert-butyl ether (MTBE)	30.0	30.1	25.0	120.0	120.4	0.3	65-165	20		
Surrogates(s)										
1,2-Dichloroethane-d4	460	443	500	92.0	88.6		76-114	0		
Toluene-d8	480	483	500	96.0	96.6		88-110	0		

Diesel

ACC Environmental Consultants

Attn.: Ed Giacometti

7977 Capwell Drive, Suite 100

Oakland, CA 94621

Phone: (510) 638-8400 Fax: (510) 638-8404

Project: 6651-001.00

3820 San Leandro St.

Received: 04/18/2003 13:20

Samples Reported

Sample Name	Date Sampled	Matrix	Lab #
MW-1	04/17/2003 12:30	Water	1
MW-2	04/17/2003 12:45	Water	2
MW-3	04/17/2003 12:50	Water	3

Severn Trent Laboratories, Inc.

STL San Francisco * 1220 Quarry Lane, Pleasanton, CA 94566

Tel 925 484 1919 Fax 925 484 1096 * www.stl-inc.com * CA DHS ELAP# 2496

04/28/2003 12:10

Diesel

ACC Environmental Consultants

Attn.: Ed Giacometti

7977 Capwell Drive, Suite 100
Oakland, CA 94621
Phone: (510) 638-8400 Fax: (510) 638-8404

Project: 6651-001.00
3820 San Leandro St.

Received: 04/18/2003 13:20

Prep(s):	3510/8015M	Test(s):	8015M
Sample ID:	MW-1	Lab ID:	2003-04-0482 - 1
Sampled:	04/17/2003 12:30	Extracted:	4/21/2003 08:57
Matrix:	Water	QC Batch#:	2003/04/21-01.10

Compound	Conc.	RL	Unit	Dilution	Analyzed	Flag
Diesel	ND	50	ug/L	1.00	04/22/2003 23:40	
Surrogates(s)						
o-Terphenyl	76.8	60-130	%	1.00	04/22/2003 23:40	

Diesel

ACC Environmental Consultants

Attn.: Ed Giacometti

7977 Capwell Drive, Suite 100
Oakland, CA 94621
Phone: (510) 638-8400 Fax: (510) 638-8404

Project: 6651-001.00
3820 San Leandro St.

Received: 04/18/2003 13:20

Prep(s):	3510/8015M	Test(s):	8015M
Sample ID:	MW-2	Lab ID:	2003-04-0482 - 2
Sampled:	04/17/2003 12:45	Extracted:	4/21/2003 08:57
Matrix:	Water	QC Batch#:	2003/04/21-01.10

Compound	Conc.	RL	Unit	Dilution	Analyzed	Flag
Diesel	120	50	ug/L	1.00	04/23/2003 00:21	ndp
Surrogates(s)						
o-Terphenyl	77.6	60-130	%	1.00	04/23/2003 00:21	

Diesel

ACC Environmental Consultants

Attn.: Ed Giacometti

7977 Capwell Drive, Suite 100

Oakland, CA 94621

Phone: (510) 638-8400 Fax: (510) 638-8404

Project: 6651-001.00

3820 San Leandro St.

Received: 04/18/2003 13:20

Prep(s):	3510/8015M	Test(s):	8015M
Sample ID:	MW-3	Lab ID:	2003-04-0482 - 3
Sampled:	04/17/2003 12:50	Extracted:	4/21/2003 08:57
Matrix:	Water	QC Batch#:	2003/04/21-01.10

Compound	Conc.	RL	Unit	Dilution	Analyzed	Flag
Diesel	3200	250	ug/L	5.00	04/25/2003 16:48	ndp
Surrogates(s) o-Terphenyl	NA	60-130	%	5.00	04/25/2003 16:48	sd

Diesel

ACC Environmental Consultants

Attn.: Ed Giacometti

7977 Capwell Drive, Suite 100
Oakland, CA 94621
Phone: (510) 638-8400 Fax: (510) 638-8404

Project: 6651-001.00
3820 San Leandro St.

Received: 04/18/2003 13:20

Batch QC Report		
Prep(s): 3510/8015M Method Blank MB: 2003/04/21-01.10-003	Water	Test(s): 8015M QC Batch # 2003/04/21-01.10 Date Extracted: 04/21/2003 08:57

Compound	Conc.	RL	Unit	Analyzed	Flag
Diesel	ND	50	ug/L	04/22/2003 00:01	
Surrogates(s) o-Terphenyl	105.4	60-130	%	04/22/2003 00:01	

Diesel

ACC Environmental Consultants

Attn.: Ed Giacometti

7977 Capwell Drive, Suite 100
Oakland, CA 94621
Phone: (510) 638-8400 Fax: (510) 638-8404

Project: 6651-001.00
3820 San Leandro St.

Received: 04/18/2003 13:20

Batch QC Report			
Prep(s): 3510/8015M		Test(s): 8015M	
Laboratory Control Spike		Water	QC Batch # 2003/04/21-01.10
LCS	2003/04/21-01.10-001	Extracted: 04/21/2003	Analyzed: 04/21/2003 22:40
LCSD	2003/04/21-01.10-002	Extracted: 04/21/2003	Analyzed: 04/21/2003 23:20

Compound	Conc. ug/L		Exp. Conc.	Recovery		RPD	Ctrl. Limits %		Flags	
	LCS	LCSD		LCS	LCSD		%	Rec.	RPD	LCS
Diesel	1160	1130	1250	92.8	90.4	2.6	60-130	25		
Surrogates(s) o-Terphenyl	24.7	23.3	20.0	123.5	116.4		60-130	0		

Diesel

ACC Environmental Consultants

Attn.: Ed Giacometti

7977 Capwell Drive, Suite 100

Oakland, CA 94621

Phone: (510) 638-8400 Fax: (510) 638-8404

Project: 6651-001.00

3820 San Leandro St.

Received: 04/18/2003 13:20

Legend and Notes

Result Flag

ndp

Hydrocarbon reported does not match the pattern of our Diesel standard

sd

Surrogate recovery not reportable due to required dilution.

2003-04-0482

Report To

Analysis Request

Attn: ED GIACOMETTI
Company: ACC ENVIRONMENTAL CONSULTANTS
Address: 7977 CARWELL DRIVE, OAKLAND, CA
P: (510) 638-8400 x 114 E: egiacometti@accenv.com
Bill To: ACC ENVIRONMENTAL Sampled By: Ed Giacometti
Attn: ED Phone ext. 114

Sample ID	Date	Time	Mat	Pres	TPH EPA	Gas W/	Purgeable Aromatics	Fuel Tests	Purgeable Hydrocarbons	Volatile Organics	Semivolatiles	Oil and Grease	Pesticides	PCBs	PNAs	DAMP Metals	Metals	WET (STLC)	Hexavalent Chromium	Spec Comp	Alkalinity	Anions	Number of Containers
MU-1	4/17/03	12:30	150	14% 100	<input checked="" type="checkbox"/>	<input checked="" type="checkbox"/>	<input checked="" type="checkbox"/>	<input checked="" type="checkbox"/>	<input checked="" type="checkbox"/>	<input checked="" type="checkbox"/>	<input checked="" type="checkbox"/>	<input checked="" type="checkbox"/>	<input checked="" type="checkbox"/>	<input checked="" type="checkbox"/>	<input checked="" type="checkbox"/>	<input checked="" type="checkbox"/>	<input checked="" type="checkbox"/>	<input checked="" type="checkbox"/>	<input checked="" type="checkbox"/>	<input checked="" type="checkbox"/>	<input checked="" type="checkbox"/>	<input checked="" type="checkbox"/>	1
MU-2	4/17/03	12:45	150	14% 100	<input checked="" type="checkbox"/>	<input checked="" type="checkbox"/>	<input checked="" type="checkbox"/>	<input checked="" type="checkbox"/>	<input checked="" type="checkbox"/>	<input checked="" type="checkbox"/>	<input checked="" type="checkbox"/>	<input checked="" type="checkbox"/>	<input checked="" type="checkbox"/>	<input checked="" type="checkbox"/>	<input checked="" type="checkbox"/>	<input checked="" type="checkbox"/>	<input checked="" type="checkbox"/>	<input checked="" type="checkbox"/>	<input checked="" type="checkbox"/>	<input checked="" type="checkbox"/>	<input checked="" type="checkbox"/>	<input checked="" type="checkbox"/>	1
MU-3	4/17/03	12:50	150	14% 100	<input checked="" type="checkbox"/>	<input checked="" type="checkbox"/>	<input checked="" type="checkbox"/>	<input checked="" type="checkbox"/>	<input checked="" type="checkbox"/>	<input checked="" type="checkbox"/>	<input checked="" type="checkbox"/>	<input checked="" type="checkbox"/>	<input checked="" type="checkbox"/>	<input checked="" type="checkbox"/>	<input checked="" type="checkbox"/>	<input checked="" type="checkbox"/>	<input checked="" type="checkbox"/>	<input checked="" type="checkbox"/>	<input checked="" type="checkbox"/>	<input checked="" type="checkbox"/>	<input checked="" type="checkbox"/>	<input checked="" type="checkbox"/>	1

Handwritten notes:
TAX
OIL
150

Project Info.		Sample Receipt		1) Relinquished by:		2) Relinquished by:		3) Relinquished by:	
Project Name: <u>3820 San Leandro St</u>		# of Containers:		Signature: <u>[Signature]</u>		Signature: <u>[Signature]</u>		Signature: _____	
Project#: <u>6651-001.00</u>		Head Space:		Time: <u>11/17/03</u>		Time: <u>13:00</u>		Time: _____	
PO#: _____		Temp: <u>4.0</u>		Printed Name: <u>ED GIACOMETTI</u>		Printed Name: <u>MUSA</u>		Printed Name: _____	
Credit Card#: _____		Conforms to record:		Date: _____		Date: <u>04-18-03</u>		Date: _____	
Company: <u>ACC ENVIRONMENTAL CONSULTANTS</u>		Company: _____		Company: _____		Company: <u>STL S.F</u>		Company: _____	
T A T		Std. 5 Day		1) Received by:		2) Received by:		3) Received by:	
72h		48h		Signature: <u>[Signature]</u>		Signature: _____		Signature: <u>[Signature]</u>	
24h		Other:		Time: _____		Time: _____		Time: <u>13:20</u>	
Report: <input checked="" type="checkbox"/> Routine <input type="checkbox"/> Level 3 <input type="checkbox"/> Level 4 <input type="checkbox"/> EDD <input type="checkbox"/> State Tank Fund EDF		Special Instructions/Comments:		Printed Name: <u>MUSA</u>		Printed Name: _____		Printed Name: <u>Rowley</u>	
				Date: <u>04-18-03</u>		Date: _____		Date: <u>04/18/03</u>	
				Company: <u>STL S.F</u>		Company: _____		Company: _____	