



Aqua Science Engineers, Inc. 55 Oak Court, Suite 220, Danville, CA 94526
(925) 820-9391 - Fax (925) 837-4853 - www.aquascienceengineers.com

RECEIVED

3:45 pm, Oct 22, 2007

Alameda County
Environmental Health

October 19, 2007

Mr. Jerry Wickham
Alameda County Health Care Services Agency
1131 Harbor Bay Parkway
Alameda, CA 94502-6577

SUBJECT: REMEDIAL ACTION PLAN ADDENDUM
Oakland Truck Stop
8255 San Leandro Street
Oakland, California

Dear Mr. Wickham:

This letter presents an addendum to ASE's August 17, 2007 remedial action plan (RAP). This addendum was requested in a letter from the Alameda County Health Care Services Agency (ACHCSA) dated September 11, 2007. Each technical comment is addressed below:

COMMENT 1 – CLEANUP GOALS

The cleanup goals within the RAP will be changed to Environmental Screening Levels (ESLs) for sites where groundwater is a current or potential source of drinking water.

COMMENT 2 – CONFIRMATION SOIL SAMPLES FROM BOTTOM OF EXCAVATION

Soil samples will be collected from the bottom of the excavation at a rate of 1 sample per 500 square feet. These samples will be collected from an excavator bucket in the same manner as the sidewall samples described on page 16 of the RAP.

COMMENT 3 – PROPOSED AREAS FOR OVEREXCAVATION

The excavation areas have been modified slightly from the area shown in the RAP based on conditions observed in a recent site visit (see attached map). However, the excavation cannot be expanded to the south as requested in the September 11, 2007 letter for the following reasons:

- a) The portion to the south is an easement to the property west of the site (currently a truck driving school). This roadway easement is the only access to that property and it is not economically feasible to reroute traffic to that property since there is a bridge access. In addition, that property to the west will be used to stockpile clean overburden soil and will need to be accessed for this project.



Aqua Science Engineers, Inc. 55 Oak Court, Suite 220, Danville, CA 94526
(925) 820-9391 - Fax (925) 837-4853 - www.aquascienceengineers.com

- b) Although borings and monitoring wells to the south of our proposed excavation line do show groundwater contamination, no soil contamination has been identified in these borings/wells. It is ASE's experience that the UST Cleanup Fund will not pay for excavation in areas without soil contamination. If at the conclusion of the remediation, additional remediation is necessary in this area, it could be accomplished more economically in this area using an in-situ remediation such as the injection of Oxygen Releasing Compound (ORC) or an oxidizer such as Fenton's Reagent, RegenOx or other compound.

COMMENT 4 – REUSE OF SOIL FOR BACKFILL

Only soil that contains hydrocarbon concentrations below ESLs for commercial sites where groundwater is a current or potential source of drinking water will be reused for backfill. In addition, the sampling frequency for soil to be reused for backfill will now be 1 sample per 50 yards.

COMMENT 5 – QUARTERLY MONITORING

Quarterly groundwater monitoring will continue at the site until such time that ASE requests a modification in sampling frequency and the request is approved by the ACHCSA.

COMMENT 5 – GEOTRACKER EDF SUBMITTALS

ASE is currently in the process of updating the Geotracker database for this site. The database will be updated within 2 weeks from the date of this letter.

Should you have any questions or if you would like to discuss this data, please feel free to call me at (925) 820-9391.

Respectfully submitted,

AQUA SCIENCE ENGINEERS, INC.



Robert E. Kitay, P.G., R.E.A.
Senior Geologist

cc: Nissan Saidian

DIESEL DISPENSER AREA

IF WE EXCAVATE TO 15' BGS OVER ENTIRE AREA, GENERATE 3250 CU YDS.
 IF WE PUT BACK THE TOP 7', WE WOULD REDUCE OFFHAUL BY 1500 CU YDS.
 OFFHAUL 1720 CU YDS, WHICH EQUALS 2580 TONS.
 IMPORT 600 CU YDS OF DRAIN ROCK (3-FEET)
 IMPORT 1100 CU YDS FILL MATERIAL.

UST AREA

IF WE EXCAVATE TO 15' BGS OVER ENTIRE AREA, GENERATE 2500 CU YDS.
 IF WE PUT BACK THE TOP 6' IN AREA OF OLD USTs, WE WOULD REDUCE OFFHAUL BY 250 CU YDS.
 VOID OF USTs WILL REDUCE OFFHAUL BY 160 CU YDS.
 OFFHAUL 2090 CU YDS, WHICH EQUALS 3135 TONS.
 IMPORT 500 CU YDS OF DRAIN ROCK (3-FEET)
 IMPORT 1200 CU YDS FILL MATERIAL (THE REST IS NEW USTs)

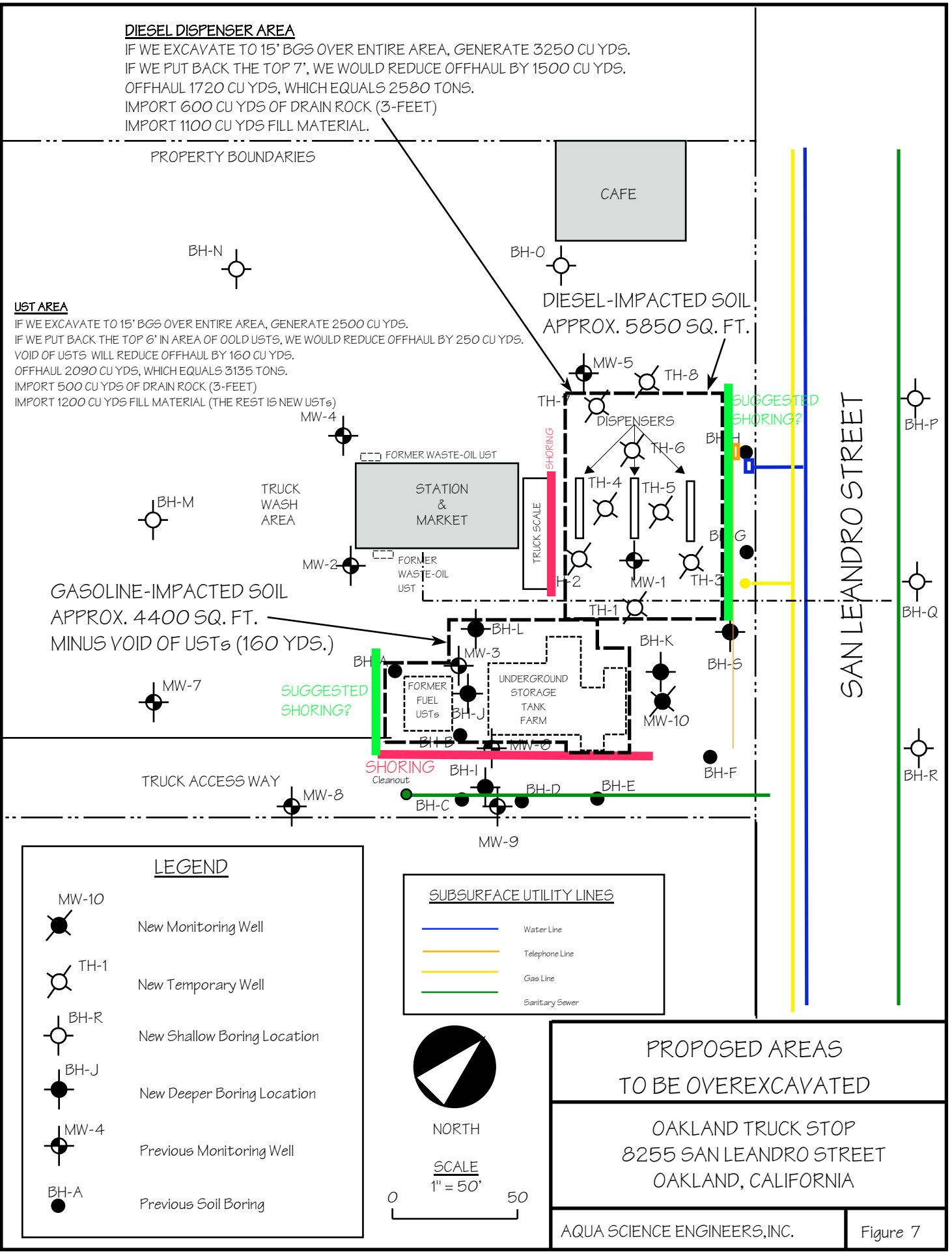

PROPERTY BOUNDARIES

CAFE

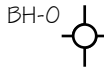
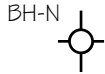

DIESEL-IMPACTED SOIL
 APPROX. 5850 SQ. FT.

UST AREA

IF WE EXCAVATE TO 15' BGS OVER ENTIRE AREA, GENERATE 2500 CU YDS.
 IF WE PUT BACK THE TOP 6' IN AREA OF OLD USTs, WE WOULD REDUCE OFFHAUL BY 250 CU YDS.
 VOID OF USTs WILL REDUCE OFFHAUL BY 160 CU YDS.
 OFFHAUL 2090 CU YDS, WHICH EQUALS 3135 TONS.
 IMPORT 500 CU YDS OF DRAIN ROCK (3-FEET)
 IMPORT 1200 CU YDS FILL MATERIAL (THE REST IS NEW USTs)



SUGGESTED SHORING?



TRUCK WASH AREA

STATION & MARKET



GASOLINE-IMPACTED SOIL
 APPROX. 4400 SQ. FT.
 MINUS VOID OF USTs (160 YDS.)

SUGGESTED SHORING?



TRUCK ACCESS WAY



MW-9

LEGEND

MW-10



New Monitoring Well

TH-1



New Temporary Well

BH-R



New Shallow Boring Location

BH-J



New Deeper Boring Location

MW-4



Previous Monitoring Well

BH-A



Previous Soil Boring

SUBSURFACE UTILITY LINES

- Water Line
- Telephone Line
- Gas Line
- Sanitary Sewer



NORTH

SCALE

1" = 50'

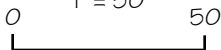

PROPOSED AREAS
 TO BE OVEREXCAVATED

OAKLAND TRUCK STOP
 8255 SAN LEANDRO STREET
 OAKLAND, CALIFORNIA