



**CONESTOGA-ROVERS
& ASSOCIATES**

5900 Hollis Street, Suite A, Emeryville, California 94608
Telephone: 510-420-0700 Facsimile: 510-420-9170
www.CRAworld.com

RECEIVED

1:49 pm, May 04, 2009

Alameda County
Environmental Health

May 1, 2009

Reference No. 521000

Ms. Barbara Jakub
Alameda County Health Care Services Agency
Department of Environmental Health
1131 Harbor Bay Parkway, Suite 250
Alameda, California 94502

Dear Ms. Jakub:

Re: Groundwater Monitoring Report - First Quarter 2009
1137-1167 65th Street
Oakland, California 94608
Agency Case No. RO0000082

On behalf of Mr. John Nady (Nady), Conestoga-Rovers & Associates (CRA) is submitting this *Groundwater Monitoring Report - First Quarter 2009*. Presented in this report is a summary of the field activities and results from the first quarter 2009 groundwater monitoring event. In addition, this report contains recommendations for second quarter 2009 activities.

If you have any questions, please call me at (510) 420-3307.

Yours truly,
CONESTOGA-ROVERS & ASSOCIATES

Mark Jonas, P.G.

MJ/aa/4
Encl. *Groundwater Monitoring Report - First Quarter 2009*

c.c.: Mr. Frederic Schrag

Equal
Employment
Opportunity Employer



GROUNDWATER MONITORING REPORT - FIRST QUARTER 2009

1137-1167 65th STREET
OAKLAND, CALIFORNIA

AGENCY CASE NO. RO0000082

APRIL 27, 2009

REF. NO. 521000 (3)

This report is printed on recycled paper.

**Prepared by:
Conestoga-Rovers
& Associates**

5900 Hollis Street, Suite A
Emeryville, California
U.S.A. 94608

Office: 510-420-0700
Fax: 510-420-9170

web: <http://www.CRAworld.com>

TABLE OF CONTENTS

	<u>Page</u>
1.0 INTRODUCTION	1
1.1 SITE INFORMATION.....	1
2.0 SITE ACTIVITIES AND RESULTS	2
2.1 CURRENT QUARTER'S ACTIVITIES	2
2.1.1 WATER LEVEL MEASUREMENTS.....	2
2.1.2 GROUNDWATER SAMPLING	2
2.1.2 WASTE DISPOSAL	3
2.2 CURRENT QUARTER'S RESULTS	3
2.2.1 GROUNDWATER FLOW DIRECTION AND GRADIENT.....	4
2.2.2 CHEMICALS DETECTED IN A-ZONE GROUNDWATER.....	5
2.2.3 CHEMICALS DETECTED IN B-ZONE GROUNDWATER.....	5
2.2.4 CHEMICALS DETECTED IN C-ZONE GROUNDWATER	6
2.2.5 GEOTRACKER SUBMITTALS.....	6
2.3 PROPOSED ACTIVITIES FOR NEXT QUARTER.....	6
2.3.1 GROUNDWATER MONITORING	6
2.3.2 SITE CHARACTERIZATION.....	7

LIST OF FIGURES
(Following Text)

FIGURE 1	VICINITY MAP
FIGURE 2	GROUNDWATER FLOW AND CHEMICAL CONCENTRATIONS - A ZONE
FIGURE 3	GROUNDWATER FLOW AND CHEMICAL CONCENTRATIONS - B ZONE
FIGURE 4	GROUNDWATER FLOW AND CHEMICAL CONCENTRATIONS - C ZONE

LIST OF TABLES

TABLE 1	WELL CONSTRUCTION DETAILS
TABLE 2	MONITORING WELL GROUNDWATER ANALYTICAL RESULTS: PETROLEUM HYDROCARBONS
TABLE 3	MONITORING WELL GROUNDWATER ANALYTICAL RESULTS: HALOGENATED VOLATILE ORGANIC COMPOUNDS

LIST OF APPENDICES

APPENDIX A	STANDARD FIELD PROCEDURES FOR GROUNDWATER MONITORING AND SAMPLING
APPENDIX B	CERTIFIED ANALYTICAL REPORTS AND CHAIN-OF-CUSTODY DOCUMENTATION
APPENDIX C	FIELD DATA SHEETS

1.0 INTRODUCTION

On behalf of the Mr. John Nady, Trustee of the Nady Trust (Nady), Conestoga-Rovers & Associates (CRA) is submitting this *Groundwater Monitoring Report –First Quarter 2009*. This report describes the first quarter 2009 groundwater monitoring activities performed at 1137-1167 65th Street, Oakland, California (Figure 1).

This groundwater monitoring event was conducted at the direction of the Alameda County Health Care Services Agency, Environmental Health Division (ACEH). This report presents a summary of the monitoring activities and results from the first quarter 2009 monitoring event. In addition, this report contains recommendations for second quarter 2009 activities.

1.1 SITE INFORMATION

Site Address	1137-1167 65 th Street, Oakland, CA
Site Use	Commercial
Client and Contact	John Nady, Trustee of the Nady Trust Contact: Frederic Schrag
Consultant and Contact Person	CRA, Mark Jonas, P.G.
Lead Agency and Contact Person	Alameda County Environmental Health Ms. Barbara Jakub
Fuel Leak Case No.	RO0000082

2.0 SITE ACTIVITIES AND RESULTS

2.1 CURRENT QUARTER'S ACTIVITIES

CRA contracted Muskan Environmental Sampling (MES) to perform quarterly groundwater monitoring activities at the site. On March 30, 2009, MES measured groundwater levels in all 13 monitoring wells and collected groundwater samples from nine of the 13 wells. As recommended in the *Groundwater Monitoring Report – Fourth Quarter 2005* and approved by Mr. Barney Chan of ACEH, the sampling and analysis was as follows:

- Total petroleum hydrocarbons as diesel (TPHd), gasoline (TPHg), motor oil (TPHmo), and stoddard solvent (TPHss); and benzene, toluene, ethylbenzene, and total xylenes (BTEX) are analyzed in groundwater samples collected from monitoring wells MW-1A, MW-2A, MW-3A, MW-4A, MW-6A, MW-7A, and MW-6B.
- Halogenated volatile organic compounds (HVOCs) are analyzed in groundwater samples collected from monitoring wells MW-1A, MW-3A, MW-6A, MW-7A, MW-1B, MW-6B, and MW-6C.
- It is not necessary to analyze groundwater samples for methyl tertiary butyl ether (MTBE).
- Monitoring wells MW-4B, MW-5B, MW-1C, and MW-4C are no longer sampled.

2.1.1 WATER LEVEL MEASUREMENTS

Depth to groundwater measurements were recorded to the nearest 0.01-foot, relative to a previously established reference elevation. Measurements were collected using an electric, conductance-actuated well sounder. Copies of the field data sheets are included as Appendix C. The groundwater level measurement data are summarized in Table 2.

2.1.2 GROUNDWATER SAMPLING

MES collected groundwater samples from wells MW-1A, MW-2A, MW-3A, MW-4A, MW-6A, MW-7A, MW-1B, MW-6B, and MW-6C. Prior to sampling, the wells were purged to remove standing water in the well casing and annulus to promote inflow of representative groundwater from the surrounding formation. Each well was purged using a new disposable bailer, pre-cleaned poly vinyl chloride (PVC) bailer, or

disposable tubing with a check valve. Field measurements of pH, specific conductance, and temperature of purged groundwater were measured after extraction of each successive casing volume. Casing volumes were calculated based on well diameter and height of the water column. Typically, purging continued until at least three casing volumes are extracted and consecutive pH, specific conductance, and temperature measurements appeared to stabilize. Water quality field measurements, purge volumes and sample collection data were recorded on field sampling data forms (Appendix C).

To minimize the potential for cross-contamination, groundwater monitoring equipment was decontaminated prior to being used in the first monitoring well and between successive wells. Groundwater samples were collected from each of the wells using clean disposable bailers or disposable tubing with a check valve. The samples were decanted from the bailers into 1 liter (L) amber glass containers and/or 40 milliliter (mL) glass volatile organic analysis (VOA) vials, both supplied by McCampbell Analytical, Inc. (McCampbell) of Pittsburg, California. Sample containers were labeled and placed in a cooler chilled with water-based ice, for temporary storage and transport. A chain-of-custody record was maintained (Appendix B).

Groundwater samples were analyzed for TPHd, TPHg, TPHmo, and TPHss by modified United States Environmental Protection Agency (EPA) Method SW8015C. BTEX were analyzed by EPA Method SW8021B. Samples were also analyzed for HVOCs by EPA Method SW8260B, but only reported for the EPA Method 8010 basic target list. Samples marked for TPHd and TPHmo analysis were subjected to silica gel cleanup prior to analysis. The laboratory analytical report is included in Appendix B. Analytical results are summarized on Figures 2, 3, and 4 and presented in Tables 2 and 3.

2.1.2 WASTE DISPOSAL

Approximately 83 gallons of purge water were generated during this quarter's monitoring event. This waste water is stored in sealed Department of Transportation (DOT) approved 55-gallon drums and temporarily left on site for eventual transport and disposal.

2.2 CURRENT QUARTER'S RESULTS

A-Zone

Groundwater Flow Direction

West-southwest

Hydraulic Gradient	0.014
Range of Measured Water Depth from Top of Casing in Monitoring Wells	1.96 to 4.20 feet
Were Measureable Separate Phase Hydrocarbons Observed	No
<u>B-Zone</u>	
Groundwater Flow Direction	South-southwest
Hydraulic Gradient	0.016
Range of Measured Water Depth from Top of Casing in Monitoring Wells	4.21 to 7.41 feet
Were Measureable Separate Phase Hydrocarbons Observed	No
<u>C-Zone</u>	
Groundwater Flow Direction	West-northwest
Hydraulic Gradient	0.010
Range of Measured Water Depth from Top of Casing in Monitoring Wells	6.33 to 7.37 feet
Were Measureable Separate Phase Hydrocarbons Observed	No

2.2.1 GROUNDWATER FLOW DIRECTION AND GRADIENT

Depth-to-water measurements collected from 13 wells on March 30, 2009 ranged from 1.96 to 7.41 feet (ft) below top of casing (TOC). Groundwater elevations were calculated by subtracting the depth-to-water measurements from the surveyed TOC elevations. The groundwater elevations for A, B, and C water-bearing zones were each plotted and contoured on Figures 2, 3, and 4, respectively.

The A-zone is defined as the first encountered groundwater bearing zone from approximately 3.5 feet below ground surface (ft bgs) to 12 ft bgs. A-zone monitoring wells are MW-1A, MW-2A, MW-3A, MW-4A, MW-6A, and MW-7A. The groundwater flow direction in the A-zone was west-southwest with a gradient of approximately 0.014 ft/ft (Figure 2). The B-zone is defined as the second encountered groundwater bearing zone from approximately 13 ft bgs to 24 ft bgs. B-zone monitoring wells are MW-1B, MW-4B, MW-5B, and MW-6B. The groundwater flow direction in the B-zone was south-southwest with a gradient of approximately 0.016 ft/ft (Figure 3). The C-zone is defined as the third encountered groundwater bearing zone from approximately 25 ft bgs to 46 ft bgs. C-zone monitoring wells are MW-1C, MW-4C, and MW-6C. The groundwater flow direction in the C-zone was west-northwest with a gradient of approximately 0.010 ft/ft (Figure 4).

Rose diagrams depicting historical groundwater flow directions for the A, B, and C-zones are presented on the figures. The groundwater flow direction and gradient in the A-zone, B-zone, and C-zone are generally consistent with historical results. Depth-to-water and groundwater elevation data are presented in Tables 2 and 3.

2.2.2 CHEMICALS DETECTED IN A-ZONE GROUNDWATER

During this monitoring event, groundwater samples from A-zone monitoring wells MW-1A, MW-2A, MW-3A, MW-4A, MW-6A, and MW-7A were analyzed for petroleum hydrocarbons. Groundwater from A-zone monitoring wells MW-1A, MW-3A, MW-6A, and MW-7A were analyzed for HVOCs.

Petroleum hydrocarbons were detected in all six A-zone monitoring wells sampled. TPHd concentrations ranged from 89 micrograms per liter ($\mu\text{g/L}$) to 110,000 $\mu\text{g/L}$. The highest TPHd concentration was detected in MW-7A. TPHg concentrations ranged from 75 $\mu\text{g/L}$ to 11,000 $\mu\text{g/L}$ with the highest concentration detected in MW-7A. TPHmo was only detected above the laboratory reporting limit in well MW-6A at 430 $\mu\text{g/L}$. TPHss concentrations ranged from 70 $\mu\text{g/L}$ to 16,000 $\mu\text{g/L}$. The highest TPHss was detected in well MW-7A.

Benzene was detected in wells MW-1A and MW-4A at concentrations of 1.7 $\mu\text{g/L}$ and 0.64 $\mu\text{g/L}$, respectively. Toluene was detected in wells MW-2A and MW-4A at concentrations of 3.2 $\mu\text{g/L}$ and 1.4 $\mu\text{g/L}$, respectively. Ethylbenzene was detected in well MW-1A at a concentration of 3.4 $\mu\text{g/L}$. Xylenes were detected in wells MW-1A and MW-4A at concentrations of 5.3 $\mu\text{g/L}$ and 2.4 $\mu\text{g/L}$, respectively.

HVOCs were detected in four of the A-zone monitoring wells sampled. The HVOC detections were as follows:

- MW-1A: 1,1-Dichloroethane (1,1-DCA), cis-1,2-dichloroethene (cis-1,2-DCE), trans-1,2-dichloroethene (trans-1,2-DCE), tetrachloroethene (PCE), trichloroethene (TCE), and vinyl chloride at concentrations of 1.5 µg/L, 9.8 µg/L, 1.1 µg/L, 11 µg/L, 10 µg/L, and 2.5 µg/L, respectively.
- MW-3A: Chlorobenzene at a concentration of 85 µg/L.
- MW-6A: Chloroethane at a concentration of 0.83 µg/L.
- MW-7A: Chlorobenzene at a concentration of 1.4 µg/L.

A-zone groundwater analytical data and water level data are presented in Tables 2 and 3, and summarized on Figure 2.

2.2.3 CHEMICALS DETECTED IN B-ZONE GROUNDWATER

During this monitoring event, groundwater samples from B-zone monitoring well MW-6B were analyzed for petroleum hydrocarbons by EPA Methods SW8015C and SW8021B, and wells MW-1B and MW-6B were analyzed for HVOCs.

- TPHd, TPHg, and TPHss were detected in well MW-6B at concentrations of 34,000 µg/L, 10,000 µg/L, and 13,000 µg/L, respectively.
- No benzene, toluene, ethylbenzene, or xylenes were detected at or above the laboratory detection limits for well MW-6B.
- The following HVOCs were detected in well MW-1B: 1,1-DCA (10 µg/L), 1,2-DCA (5.8 µg/L), and cis-1,2-DCE (10 µg/L).
- The following HVOCs were detected in well MW-6B: Chloroethane (0.96 µg/L) and cis-1,2-DCE (0.80 µg/L).

B-zone groundwater analytical data and water level data are presented in Tables 2 and 3, and summarized on Figure 3.

2.2.4 CHEMICALS DETECTED IN C-ZONE GROUNDWATER

No C-zone wells were sampled for petroleum hydrocarbons. Only C-zone well MW-6C was sampled and analyzed for HVOCs.

- The following HVOCs were detected in well MW-6C: 1,1-DCA (0.57 µg/L), cis-1,2-DCE (22 µg/L), trans-1,2-DCE (0.58 µg/L), PCE (4.6 µg/L), TCE (5.0 µg/L), and vinyl chloride (3.5 µg/L).

C-zone groundwater analytical data and water level data are presented in Tables 2 and 3, and summarized on Figure 4.

2.2.5 GEOTRACKER SUBMITTALS

CRA uploaded first quarter 2009 groundwater depth data, analytical results, and this report to the State's GeoTracker database on behalf of Nady.

2.3 PROPOSED ACTIVITIES FOR NEXT QUARTER

2.3.1 GROUNDWATER MONITORING

A quarterly groundwater monitoring event will occur during the second quarter 2009. As approved by the ACEH in a letter dated September 3, 2008, CRA will modify its groundwater monitoring and sampling program to include additional laboratory analyses and the installation of a data logger in wells MW-1A, MW-1B, and MW-1C, all of which are described more fully in CRA's *Groundwater Monitoring Work Plan*, dated July 1, 2008. These changes will be implemented upon completion of the proposed work detailed in CRA's *Additional Site Characterization Work Plan*, dated July 1, 2008, which includes the installation of additional monitoring wells.

A report will be prepared detailing the activities and findings of the second quarter 2009 event to be submitted to ACEH. Groundwater analytical, well gauging data and groundwater monitoring report will be uploaded to GeoTracker. The second quarter 2009 groundwater monitoring report will be submitted via ACEH's file transfer protocol (ftp) site and notification will be sent to Ms. Jakub by e-mail.

2.3.2 SITE CHARACTERIZATION

As approved by the ACEH in a letter dated September 3, 2008, CRA will implement the proposed soil, groundwater, and soil vapor investigation outlined in CRA's *Additional Site Characterization Work Plan*, dated July 1, 2008, with the provisions contained in the

ACEH approval letter. Implementation of this work is pending permitting with the City of Oakland and property access approval. Due to delays in permitting and access approval, we expect to perform the necessary site characterization in second quarter 2009.

All of Which is Respectfully Submitted,
CONESTOGA-ROVERS & ASSOCIATES



Michael Werner

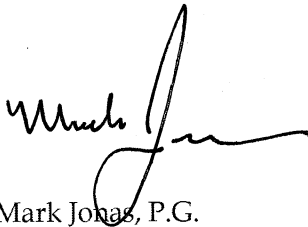
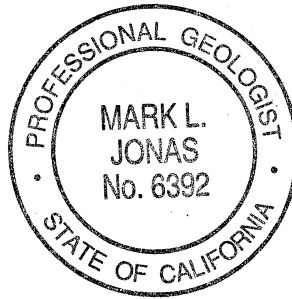

Mark Jonas, P.G.

Conestoga-Rovers & Associates, Inc. (CRA) prepared this document for use by our client and appropriate regulatory agencies. It is based partially on information available to CRA from outside sources and/or in the public domain, and partially on information supplied by CRA and its subcontractors. CRA makes no warranty or guarantee, expressed or implied, included or intended in this document, with respect to the accuracy of information obtained from these outside sources or the public domain, or any conclusions or recommendations based on information that was not independently verified by CRA. This document represents the best professional judgment of CRA. None of the work performed hereunder constitutes or shall be represented as a legal opinion of any kind or nature.

To the best of my knowledge, I have no argument or disagreement with the contents of this report.

Nady Trust U/D/T dated 1/21/1997



John Nady, trustee

FIGURES

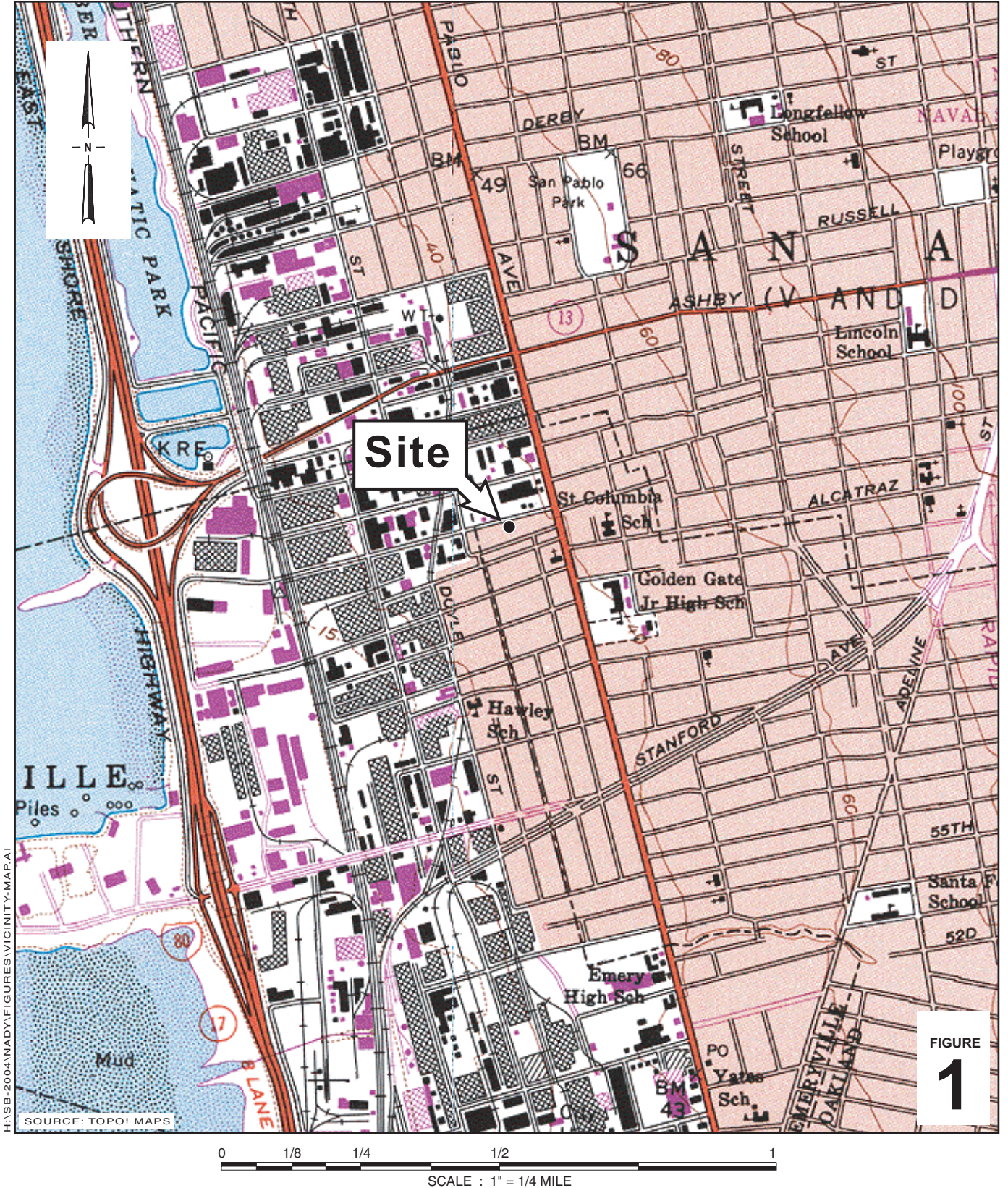
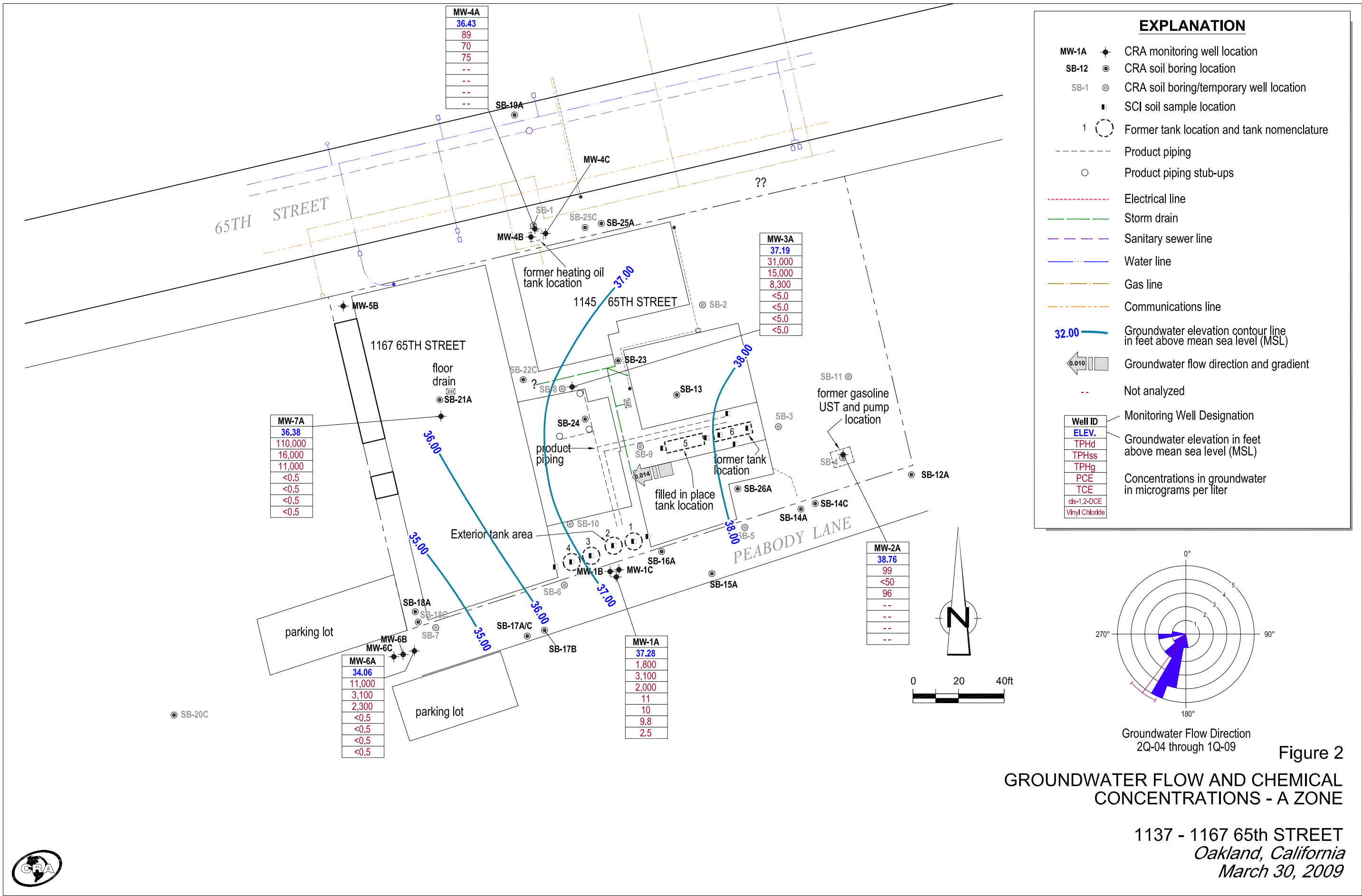

FIGURE
1

1137 - 1167 65th Street
Oakland, California



Vicinity Map



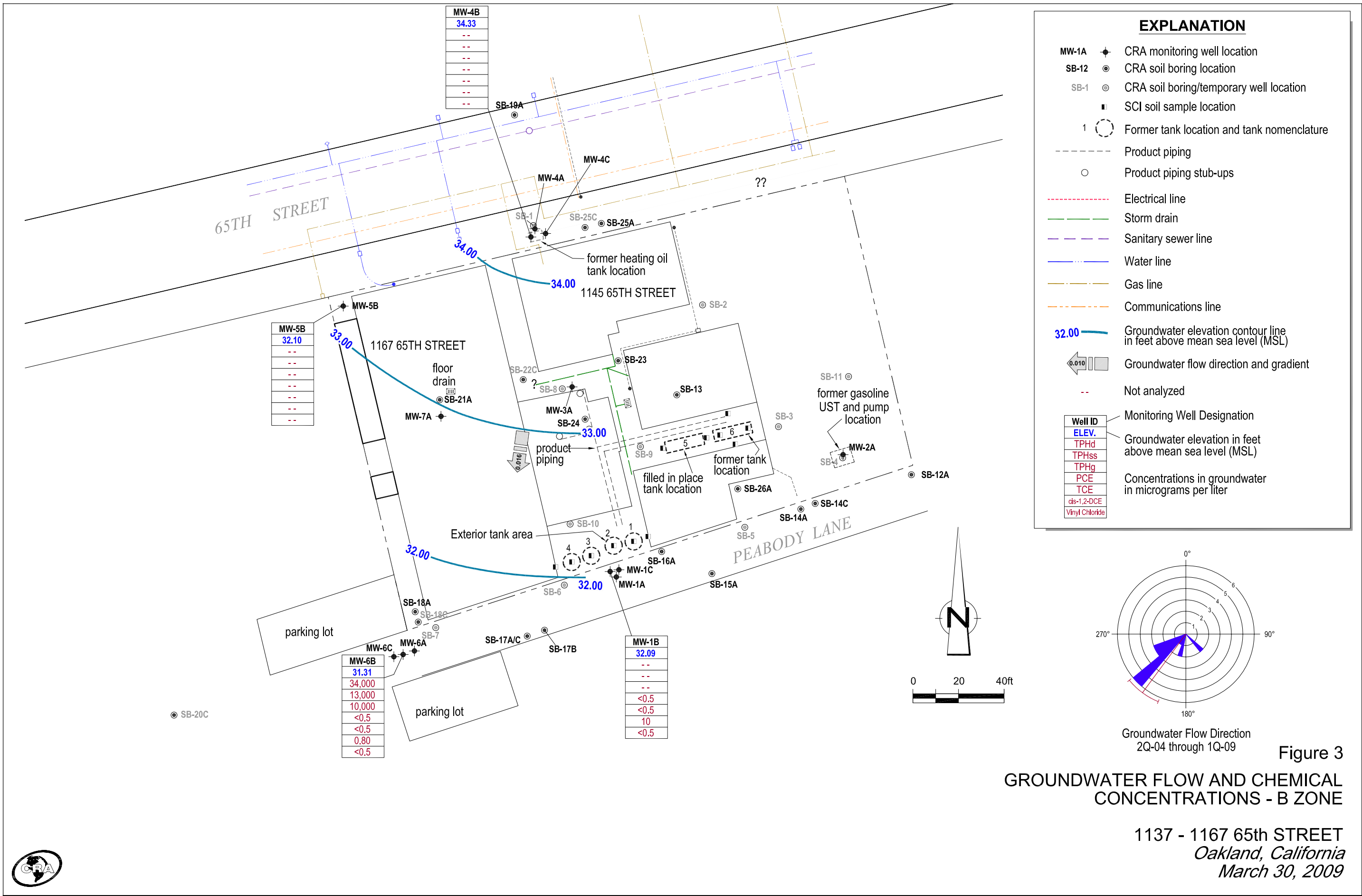
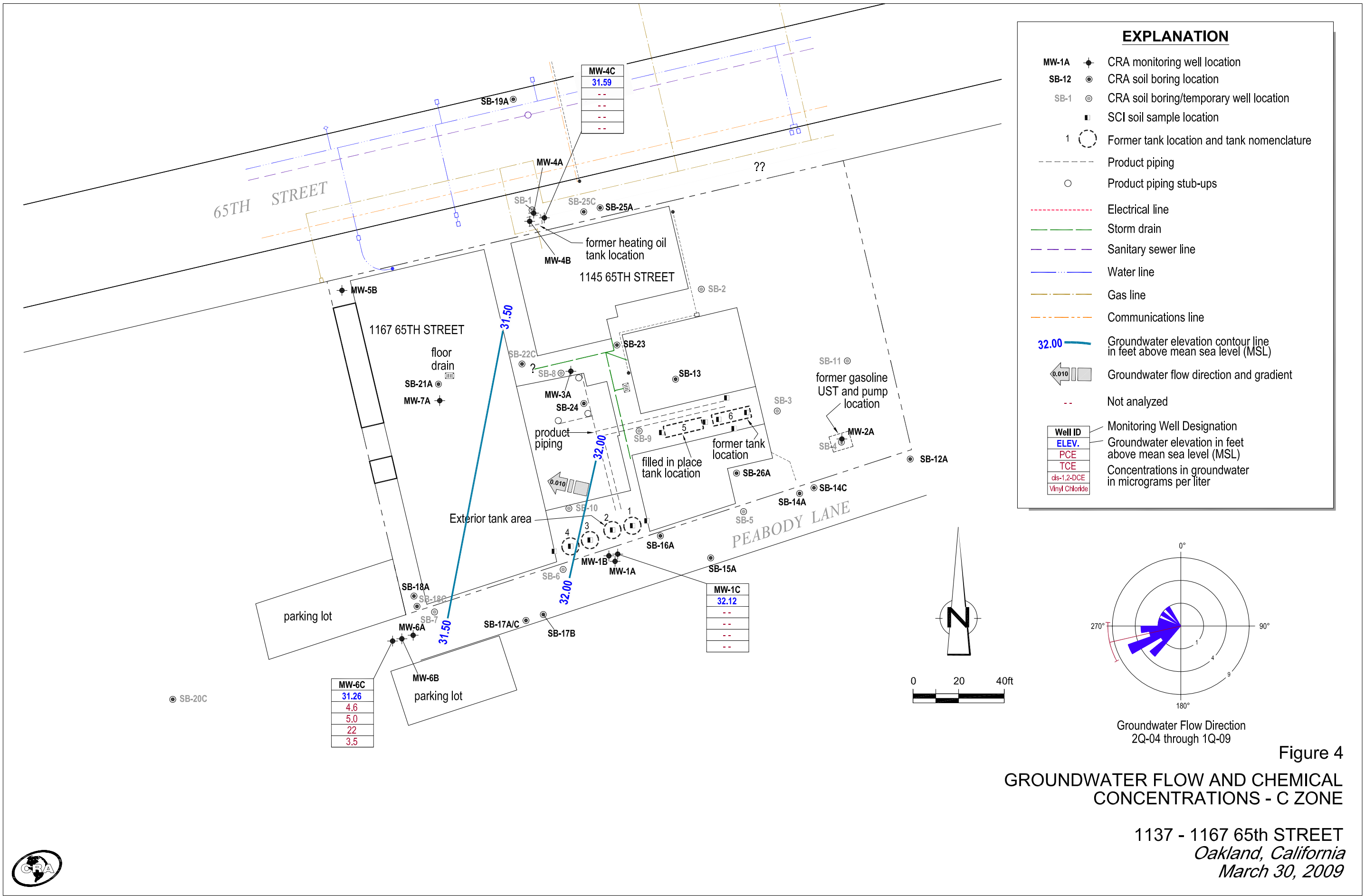

Figure 3
GROUNDWATER FLOW AND CHEMICAL CONCENTRATIONS - B ZONE

1137 - 1167 65th STREET
 Oakland, California
 March 30, 2009





TABLES

TABLE 1

WELL CONSTRUCTION DETAILS
JOHN NADY
1137-1167 65TH STREET, OAKLAND, CALIFORNIA

<i>Well ID</i>	<i>Date Installed</i>	<i>Borehole Depth (ft)</i>	<i>Borehole Diameter (inches)</i>	<i>Casing Diameter (in)</i>	<i>Screen Interval (ft bgs)</i>	<i>Screen Size (in)</i>	<i>Filter Pack (ft bgs)</i>	<i>Bentonite Seal (ft bgs)</i>	<i>Cement Seal (ft bgs)</i>	<i>TOC Elevation (ft msl)</i>	<i>First Water (ft bgs)</i>
<u>A-Zone Monitoring Wells</u>											
MW-1A	5/10/2004	14.5	8	2	4.5 - 14.5	0.010	3.5 - 14.5	2.5 - 3.5	0 - 2.5	39.64	7.0
MW-2A	5/11/2004	12.0	10	4	3.0 - 12.0	0.020	2.5 - 3.0	1.0 - 2.5	0 - 1.0	40.72	4.5
MW-3A	5/7/2004	16.0	8	2	3.5 - 14.0	0.010	3.0 - 3.5	2.0 - 3.0	0 - 2.0	40.88	4.0
MW-4A	5/18/2004	16.0	8	2	3.0 - 13.0	0.010	2.5 - 13.0	1.5 - 2.5	0 - 1.5	38.71	NA
MW-6A	5/11/2004	14.5	8	2	4.5 - 14.5	0.010	3.5 - 14.5	1.5 - 3.5	0 - 1.5	37.98	12.0
MW-7A	5/7/2004	10.0	6.5	1	5.0 - 10.0	0.010	4.0 - 10.0	3.0 - 4.0	0 - 3.0	40.58	6.0
<u>B-Zone Monitoring Wells</u>											
MW-1B	5/12/2004	20.0	8	2	16.5 - 20.0	0.010	15.5 - 20.0	13.0 - 15.5	0 - 13.0	39.50	7.0
MW-4B	5/18/2004	24.0	8	2	17.0 - 21.0	0.010	16.0 - 21.0	12.0 - 14.0 21.0 - 24.0	0 - 12.0	38.54	3.5
MW-5B	5/18/2004	24.0	8	2	15.0 - 24.0	0.010	14.0 - 24.0	12.0 - 14.0	0 - 12.0	38.98	NA
MW-6B	5/12/2004	24.5	8	2	17.0 - 22.0	0.010	16.0 - 22.0	14.0 - 16.0 22.0 - 24.5	0 - 14.0	37.66	15.5
<u>C-Zone Monitoring Wells</u>											
MW-1C	5/10/2004	40.0	8	2	25.0 - 34.0	0.010	24.0 - 34.0	22.0 - 24.0 34.0 - 40.0	0 - 22.0	39.49	7.0
MW-4C	5/17/2004	40.0	8	2	27.0 - 32.0	0.010	26.0 - 27.0	24.0 - 26.0 32.0 - 40.0	0 - 24.0	38.50	12.0
MW-6C	5/11/2004	39.5	8	2	26.5 - 34.0	0.010	25.5 - 34.0	23.0 - 25.0 34.0 - 39.5	0 - 23.0	37.59	15.0

Abbreviations / Notes

ft = feet

in = inches

ft bgs = feet below grade surface

ft msl = feet above mean sea level

TOC = top of casing

TABLE 2

MONITORING WELL GROUNDWATER ANALYTICAL RESULTS: PETROLEUM HYDROCARBONS
JOHN NADY
1137-1167 65TH STREET, OAKLAND, CA

<i>Well ID (TOC)</i>	<i>Date Sampled</i>	<i>Groundwater Zone</i>	<i>Groundwater Elevation (ft msl)</i>	<i>Depth to Water (ft, TOC)</i>	<i>TPHd (µg/L)</i>	<i>TPHg (µg/L)</i>	<i>TPHmo (µg/L)</i>	<i>TPHss (µg/L)</i>	<i>Benzene (µg/L)</i>	<i>Toluene (µg/L)</i>	<i>Ethylbenzene (µg/L)</i>	<i>Xylenes (µg/L)</i>	<i>MTBE (µg/L)</i>	<i>Notes</i>
MW-1A	6/3/2004	Zone A	35.14	4.50	1,300	1,400	260	2,500	ND<0.5	ND<0.5	2.0	11	ND<5.0	
39.64	11/23/2004		36.54	3.10	1,400	2,300	ND<250	2,800	0.64	ND<0.5	2.5	9.7	6.8	a,b,c
	3/14/2005		37.02	2.62	3,200	4,800	ND<250	6,000	0.68	ND<0.5	2.0	6.8	ND<5.0	d,e
	6/15/2005		35.14	4.50	2,500	2,800	ND<250	3,400	ND<2.5	ND<2.5	ND<2.5	5.9	ND<25	a,b,h,i,c
	9/19/2005		33.14	6.50	2,800	4,100	ND<250	6,000	ND<1.0	ND<1.0	3.3	6.2	ND<10	a,b,i,c
	12/12/2005		35.14	4.50	2,500	2,600	ND<250	3,100	ND<1.7	ND<1.7	2.7	6.5	ND<17	a,b,c,h,i
	3/13/2006		37.74	1.90	2,300	2,000	ND<250	2,400	0.51	ND<0.5	1.9	3.5	--	a,b,c,i
	6/19/2006		35.94	3.70	2,600	2,200	ND<250	3,500	0.52	ND<0.5	2.9	6.7	--	m,b,c
	9/20/2006		34.19	5.45	2,400	2,200	ND<250	2,400	ND<2.5	ND<2.5	3.0	9.7	--	a,b,c,i
	12/20/2006		37.02	2.62	1,900	1,300	ND<250	1,400	0.52	ND<0.5	2.9	7.6	--	a,e,h
	3/29/2007		37.04	2.60	1,200	1,800	ND<250	2,100	ND<0.5	ND<0.5	2.2	6.4	ND<5.0	a,b,c
	6/11/2007		35.72	3.92	2,200	3,200	ND<250	2,200	ND<5.0	ND<5.0	ND<5.0	ND<5.0	--	a,b,c
	9/7/2007		33.90	5.74	1,800	2,300	ND<250	1,700	ND<0.5	ND<0.5	2.2	4.6	ND<5.0	a,b,c
	12/12/2007		36.53	3.11	2,500	3,100	ND<250	3,400	ND<5.0	ND<5.0	ND<5.0	12	ND<50	a,c
	3/7/2008		37.23	2.41	1,700	2,200	ND<250	1,600	ND<0.5	ND<0.5	2.3	8.9	--	a,c
	6/9/2008		34.69	4.95	2,000	2,200	ND<250	2,500	ND<2.5	ND<2.5	3.4	8.1	ND<25	a,b,c,i
	9/5/2008		33.58	6.06	1,400	2,300	ND<250	2,600	ND<5.0	ND<5.0	ND<5.0	6.4	ND<50	a,c
	12/18/2008		36.68	2.96	1,800	1,600	ND<250	1,900	ND<0.5	ND<0.5	3.3	ND<0.5	--	a,b,c
	3/30/2009		37.28	2.36	1,800	2,000	ND<250	3,100	1.7	ND<1.0	3.4	5.3	ND<10	b,c,m
MW-2A	6/3/2004	Zone A	36.48	4.24	2,900	1,700	ND<250	3,500	ND<0.5	3.5	4.9	5.1	ND<5.0	
40.72	11/23/2004		37.83	2.89	ND<50	ND<50	ND<250	ND<50	ND<0.5	ND<0.5	ND<0.5	ND<0.5	ND<5.0	
	3/14/2005		39.02	1.70	--	--	--	--	--	--	--	--	--	
	3/15/2005		--	--	560	360	450	260	ND<0.5	2.5	ND<0.5	ND<0.5	ND<5.0	e,d,g,i
	6/15/2005		37.91	2.81	--	--	--	--	--	--	--	--	--	
	6/16/2005		--	--	470	480	330	430	ND<0.5	2.9	ND<0.5	ND<0.5	ND<5.0	a,b,i,g,e
	9/19/2005		35.46	5.26	--	--	--	--	--	--	--	--	--	
	9/20/2005		--	--	2,100	960	870	960	ND<0.5	4.7	2.9	ND<0.5	ND<5.0	e,g,b,i,l
	12/12/2005		37.66	3.06	--	--	--	--	--	--	--	--	--	
	12/13/2005		--	--	700	670	470	510	ND<0.5	5.9	ND<0.5	ND<0.5	ND<5.0	a,b,e,g,i
	3/13/2006		40.33	0.39	--	--	--	--	--	--	--	--	--	
	3/14/2006		--	--	81	100	ND<250	81	ND<0.5	1.5	ND<0.5	ND<0.5	--	a,b,c,i
	6/19/2006		37.31	3.41	--	--	--	--	--	--	--	--	--	

TABLE 2

MONITORING WELL GROUNDWATER ANALYTICAL RESULTS: PETROLEUM HYDROCARBONS
JOHN NADY
1137-1167 65TH STREET, OAKLAND, CA

<i>Well ID (TOC)</i>	<i>Date Sampled</i>	<i>Groundwater Zone</i>	<i>Groundwater Elevation (ft msl)</i>	<i>Depth to Water (ft, TOC)</i>	<i>TPHd (µg/L)</i>	<i>TPHg (µg/L)</i>	<i>TPHmo (µg/L)</i>	<i>TPHss (µg/L)</i>	<i>Benzene (µg/L)</i>	<i>Toluene (µg/L)</i>	<i>Ethylbenzene (µg/L)</i>	<i>Xylenes (µg/L)</i>	<i>MTBE (µg/L)</i>	<i>Notes</i>
MW-2A	6/20/2006		--	--	530	270	420	180	ND<0.5	1.7	ND<0.5	ND<0.5	--	e,g,i,l
cont.	9/20/2006		34.65	6.07	800	1,700	730	1,700	ND<2.5	5.5	ND<2.5	ND<2.5	--	a,b,d,e,g,i
	12/20/2006		38.57	2.15	190	94	300	61	ND<0.5	1.5	ND<0.5	ND<0.5	--	e,g,m,n
	3/29/2007		38.22	2.50	200	260	ND<250	240	ND<0.5	2.7	ND<0.5	ND<0.5	ND<5.0	a,b,c
	6/11/2007		37.14	3.58	200	180	ND<250	94	ND<0.5	1.7	ND<0.5	ND<0.5	--	a,b,c,i
	9/7/2007		35.04	5.68	190	240	ND<250	180	ND<0.5	0.98	ND<0.5	ND<0.5	ND<5.0	a,b,c,i
	12/12/2007		37.82	2.90	220	190	360	140	ND<0.5	2.9	ND<0.5	ND<0.5	ND<5.0	a,b,g,e
	3/7/2008		38.79	1.93	90	100	ND<250	ND<50	ND<0.5	1.2	ND<0.5	ND<0.5	--	e,b
	6/9/2008		36.18	4.54	150	180	ND<250	180	ND<0.5	ND<0.5	ND<0.5	ND<0.5	ND<5.0	a,b,e,i
	9/5/2008		34.46	6.26	180	300	310	220	ND<0.5	1.2	0.59	ND<0.5	ND<5.0	e,g,i,l
	12/18/2008		37.55	3.17	170	140	320	93	ND<0.5	2.7	ND<0.5	ND<0.5	--	a,b,c,d,g,i
	3/30/2009		38.76	1.96	99	96	ND<250	ND<50	ND<0.5	3.2	ND<0.5	ND<0.5	ND<5.0	b,d,e
MW-3A	6/3/2004	Zone A	36.56	4.32	90,000	4,800	6,000	12,000	ND<5.0	ND<5.0	ND<5.0	ND<5.0	ND<50	
40.88	11/23/2004		37.89	2.99	22,000	3,800	ND<2,500	5,700	ND<5.0	ND<5.0	ND<5.0	ND<5.0	ND<50	a,c,d
	3/14/2005		37.28	3.60	--	--	--	--	--	--	--	--	--	
	3/15/2005		--	--	37,000	2,400	ND<2,500	3,500	ND<1.7	ND<1.7	ND<1.7	ND<1.7	ND<17	e,d,i
	6/15/2005		36.78	4.10	--	--	--	--	--	--	--	--	--	
	6/16/2005		--	--	15,000	2,100	ND<1,200	3,300	ND<1.7	ND<1.7	ND<1.7	2.4	ND<17	a,c,d,h,i
	9/19/2005		35.93	4.95	--	--	--	--	--	--	--	--	--	
	9/20/2005		--	--	55,000	4,700	ND<5,000	8,000	ND<1.0	ND<1.0	2.6	6.8	ND<10	a,b,c,d,i
	12/12/2005		36.72	4.16	--	--	--	--	--	--	--	--	--	
	12/13/2005		--	--	34,000	1,100	ND<12,000	1,600	ND<1.7	ND<1.7	ND<1.7	2.3	ND<17	a,b,c,d,h,i
	3/13/2006		37.42	3.46	--	--	--	--	--	--	--	--	--	
	3/14/2006		--	--	21,000	2,200	1,600	3,300	ND<0.5	ND<0.5	1.1	ND<0.5	--	a,c,d,g,h
	6/19/2006		36.48	4.40	--	--	--	--	--	--	--	--	--	
	6/20/2006		--	--	19,000	8,000	1,000	16,000	ND<5.0	ND<5.0	ND<5.0	ND<5.0	--	c,d,g,h,m
	9/20/2006		35.78	5.10	13,000	2,500	1,300	3,300	ND<5.0	ND<5.0	ND<5.0	ND<5.0	--	a,c,d,g,h,i
	12/20/2006		36.78	4.10	15,000	2,600	670	3,500	ND<2.5	ND<2.5	ND<2.5	7.6	--	e,g,h,n
	3/29/2007		36.82	4.06	21,000	2,600	940	3,400	ND<5.0	ND<5.0	ND<5.0	ND<5.0	ND<50	a,c,d,h
	6/11/2007		36.52	4.36	13,000	5,200	730	3,500	ND<10	ND<10	ND<10	ND<10	--	a,d,h
	9/7/2007		35.98	4.90	36,000	11,000	1,600	15,000	ND<10	ND<10	ND<10	ND<10	ND<100	a,c,d,h
	12/12/2007		36.54	4.34	41,000	9,500	ND<2,500	13,000	ND<5.0	7.1	ND<5.0	32	ND<50	a,c,h

TABLE 2

MONITORING WELL GROUNDWATER ANALYTICAL RESULTS: PETROLEUM HYDROCARBONS
JOHN NADY
1137-1167 65TH STREET, OAKLAND, CA

<i>Well ID (TOC)</i>	<i>Date Sampled</i>	<i>Groundwater Zone</i>	<i>Groundwater Elevation (ft msl)</i>	<i>Depth to Water (ft, TOC)</i>	<i>TPHd (µg/L)</i>	<i>TPHg (µg/L)</i>	<i>TPHmo (µg/L)</i>	<i>TPHss (µg/L)</i>	<i>Benzene (µg/L)</i>	<i>Toluene (µg/L)</i>	<i>Ethylbenzene (µg/L)</i>	<i>Xylenes (µg/L)</i>	<i>MTBE (µg/L)</i>	<i>Notes</i>
MW-3A	3/7/2008		36.87	4.01	26,000	3,200	1,200	2,800	ND<2.5	ND<2.5	ND<2.5	2.5	--	a,h,c
cont.	6/9/2008		36.03	4.85	20,000	7,500	ND<1,200	16,000	ND<25	ND<25	ND<25	ND<25	ND<250	a,c,h,i
	9/5/2008		35.78	5.10	17,000	15,000	1,200	19,000	ND<25	ND<25	ND<25	ND<25	ND<250	a,c,h
	12/18/2008		36.65	4.23	25,000	4,700	ND<2,500	6,600	ND<5.0	ND<5.0	ND<5.0	ND<5.0	--	c,m,h
	3/30/2009		37.19	3.69	31,000	8,300	ND<2,500	15,000	ND<5.0	ND<5.0	ND<5.0	ND<5.0	ND<50	c,h,m
MW-4A	6/3/2004	Zone A	36.26	2.45	270	ND<50	440	ND<50	ND<0.5	ND<0.5	ND<0.5	ND<0.5	ND<5.0	
38.71	11/23/2004		37.13	1.58	73	ND<50	ND<250	ND<50	ND<0.5	ND<0.5	ND<0.5	ND<0.5	ND<5.0	d
	3/14/2005		36.66	2.05	--	--	--	--	--	--	--	--	--	
	3/15/2005		--	--	210	ND<50	300	ND<50	0.91	1.7	ND<0.5	1.9	ND<5.0	g,d,f,i
	6/15/2005		36.38	2.33	--	--	--	--	--	--	--	--	--	
	6/16/2005		--	--	99	59	ND<250	75	1.0	1.9	ND<0.5	2.1	ND<5.0	j,d,f
	9/19/2005		35.01	3.70	--	--	--	--	--	--	--	--	--	
	9/20/2005		--	--	87	ND<50	ND<250	ND<50	1.2	2.1	0.51	2.4	ND<5.0	d,f
	12/12/2005		36.39	2.32	--	--	--	--	--	--	--	--	--	
	12/13/2005		--	--	71	ND<50	ND<250	ND<50	0.67	1.4	ND<0.5	1.9	ND<5.0	d,f,i
	3/13/2006		36.75	1.96	--	--	--	--	--	--	--	--	--	
	3/14/2006		--	--	68	ND<50	ND<250	ND<50	0.60	1.3	ND<0.5	1.8	--	d,f
	6/19/2006		36.15	2.56	--	--	--	--	--	--	--	--	--	
	6/20/2006		--	--	72	ND<50	ND<250	ND<50	0.53	1.1	ND<0.5	1.6	--	f
	9/20/2006		35.10	3.61	160	110	ND<250	88	1.2	2.5	0.61	3.9	--	a,d,f,i
	12/20/2006		36.39	2.32	97	ND<50	ND<250	ND<50	0.99	2.1	0.52	2.9	--	f
	3/29/2007		36.46	2.25	ND<50	ND<50	ND<250	ND<50	ND<0.5	0.93	ND<0.5	1.3	ND<5.0	
	6/11/2007		36.14	2.57	66	ND<50	ND<250	ND<50	ND<0.5	0.92	ND<0.5	1.6	--	d,f
	9/7/2007		35.34	3.37	78	ND<50	ND<250	ND<50	0.74	1.3	ND<0.5	1.9	ND<5.0	f
	12/12/2007		36.25	2.46	68	86	ND<250	62	0.62	1.8	ND<0.5	2.4	ND<5.0	j,d,f
	3/7/2008		36.46	2.25	71	ND<50	ND<250	ND<50	ND<0.5	1.0	ND<0.5	1.5	--	l,f
	6/9/2008		35.49	3.22	66	ND<50	ND<250	ND<50	ND<0.5	0.94	ND<0.5	1.5	ND<5.0	d,f
	9/5/2008		34.79	3.92	100	90	ND<250	69	0.61	1.2	ND<0.5	2.0	ND<5.0	d,h,j
	12/18/2008		36.55	2.16	73	ND<50	ND<250	ND<50	0.67	1.4	ND<0.5	2.3	--	d,f
	3/30/2009		36.43	2.28	89	75	ND<250	70	0.64	1.4	ND<0.5	2.4	ND<5.0	d,j

TABLE 2

MONITORING WELL GROUNDWATER ANALYTICAL RESULTS: PETROLEUM HYDROCARBONS
JOHN NADY
1137-1167 65TH STREET, OAKLAND, CA

<i>Well ID (TOC)</i>	<i>Date Sampled</i>	<i>Groundwater Zone</i>	<i>Groundwater Elevation (ft msl)</i>	<i>Depth to Water (ft, TOC)</i>	<i>TPHd (µg/L)</i>	<i>TPHg (µg/L)</i>	<i>TPHmo (µg/L)</i>	<i>TPHss (µg/L)</i>	<i>Benzene (µg/L)</i>	<i>Toluene (µg/L)</i>	<i>Ethylbenzene (µg/L)</i>	<i>Xylenes (µg/L)</i>	<i>MTBE (µg/L)</i>	<i>Notes</i>
MW-6A	6/3/2004	Zone A	31.98	6.00	3,500	970	340	2,400	ND<0.5	ND<0.5	ND<0.5	2.1	ND<5.0	
37.98	11/23/2004		33.13	4.85	1,400	1,900	ND<250	3,000	ND<0.5	ND<0.5	ND<0.5	3.0	ND<5.0	a,c
	3/14/2005		35.03	2.95	5,900	2,900	ND<250	2,600	ND<5.0	ND<5.0	ND<5.0	ND<5.0	ND<5.0	e,d,i
	6/15/2005		33.28	4.70	6,100	2,200	ND<250	3,400	ND<0.5	ND<0.5	0.60	4.4	ND<10	a,i,c,d
	9/19/2005		32.07	5.91	2,600	2,200	ND<250	3,900	ND<1.0	ND<1.0	1.4	7.6	ND<10	a,b,c
	12/12/2005		33.12	4.86	4,600	2,900	ND<250	4,500	ND<0.5	ND<0.5	1.6	8.9	ND<5.0	a,c,h,i
	3/13/2006		36.05	1.93	4,300	1,900	ND<250	3,000	ND<0.5	ND<0.5	ND<0.5	4.3	--	a,c,d,h
	6/19/2006		32.59	5.39	7,800	2,300	260	4,600	ND<1.0	ND<1.0	ND<1.0	ND<1.0	--	c,g,h,m
	9/20/2006		31.96	6.02	2,600	960	ND<250	1,200	ND<2.5	ND<2.5	ND<2.5	ND<2.5	--	a,c,i
	12/20/2006		33.57	4.41	4,100	2,400	ND<250	3,200	ND<5.0	ND<5.0	ND<5.0	8.1	--	e,h,n
	3/29/2007		33.67	4.31	2,900	2,200	ND<250	2,700	ND<5.0	ND<5.0	ND<5.0	ND<5.0	ND<5.0	a,c
	6/11/2007		32.95	5.03	6,400	4,300	ND<250	3,700	ND<0.5	ND<0.5	2.1	9.5	--	a,c
	9/7/2007		32.32	5.66	5,800	1,600	ND<250	1,400	ND<1.0	ND<1.0	ND<1.0	3.1	ND<10	a,b,c,d,h
	12/12/2007		33.50	4.48	9,600	3,300	ND<250	4,400	ND<5.0	ND<5.0	ND<5.0	8.4	ND<5.0	a,c,d
	3/7/2008		34.30	3.68	6,200	4,100	280	3,700	ND<2.5	ND<2.5	ND<2.5	6.9	--	a,h,c
	6/9/2008		32.30	5.68	7,200	7,900	290	16,000	ND<10	ND<10	ND<10	ND<10	ND<100	a,c,h,i
	9/5/2008		32.05	5.93	3,200	8,700	ND<250	11,000	ND<10	ND<10	ND<10	ND<10	ND<100	a,c,h
	12/18/2008		33.98	4.00	11,000	3,000	460	4,300	ND<1.0	ND<1.0	1.2	ND<1.0	--	a,c,d,h
	3/30/2009		34.06	3.92	11,000	2,300	430	3,100	ND<5.0	ND<5.0	ND<5.0	ND<5.0	ND<5.0	a,c,h,j
MW-7A	6/3/2004	Zone A	36.08	4.50	--	3,900	--	9,900	ND<5.0	ND<5.0	ND<5.0	6.6	ND<5.0	
40.58	11/23/2004		--	--	--	--	--	--	--	--	--	--	--	
	3/14/2005		37.03	3.55	14,000	3,900	620	3,700	ND<5.0	ND<5.0	ND<5.0	ND<5.0	ND<5.0	c,d,h
	6/15/2005		36.41	4.17	24,000	2,500	ND<1,200	3,900	ND<5.0	ND<5.0	ND<5.0	ND<5.0	ND<5.0	a,c,d,h,i
	9/19/2005		35.25	5.33	43,000	7,000	ND<5,000	13,000	ND<10	ND<10	ND<10	ND<10	ND<100	a,c,i
	12/12/2005		36.15	4.43	10,000	1,700	ND<1,200	2,500	ND<1.0	ND<1.0	1.4	2.4	ND<10	a,c,d,h,i
	3/13/2006		36.76	3.82	31,000	1,600	1,100	2,300	ND<0.5	ND<0.5	0.93	9.1	--	a,c,d,g,h,i
	6/19/2006		35.78	4.80	36,000	26,000	1,300	44,000	ND<5.0	ND<5.0	10	ND<5.0	--	c,d,g,h,i,m
	9/20/2006		35.03	5.55	36,000	49,000	ND<5,000	69,000	ND<5.0	ND<5.0	ND<5.0	ND<5.0	--	a,c,h,i
	12/20/2006		36.35	4.23	14,000	38,000	ND<1,200	53,000	ND<5.0	ND<5.0	ND<5.0	150	--	e,h,n
	3/29/2007		36.06	4.52	34,000	4,100	890	5,600	ND<5.0	ND<5.0	ND<5.0	ND<5.0	ND<5.0	a,h,c,d
	6/11/2007		36.02	4.56	32,000	3,800	ND<1,200	3,400	ND<5.0	ND<5.0	ND<5.0	ND<5.0	--	a,c,d,h,i
	9/7/2007		35.18	5.40	57,000	21,000	ND<2,500	19,000	ND<10	ND<10	ND<10	54	ND<100	a,b,c,d,h

TABLE 2

MONITORING WELL GROUNDWATER ANALYTICAL RESULTS: PETROLEUM HYDROCARBONS
JOHN NADY
1137-1167 65TH STREET, OAKLAND, CA

<i>Well ID (TOC)</i>	<i>Date Sampled</i>	<i>Groundwater Zone</i>	<i>Groundwater Elevation (ft msl)</i>	<i>Depth to Water (ft, TOC)</i>	<i>TPHd (µg/L)</i>	<i>TPHg (µg/L)</i>	<i>TPHmo (µg/L)</i>	<i>TPHss (µg/L)</i>	<i>Benzene (µg/L)</i>	<i>Toluene (µg/L)</i>	<i>Ethylbenzene (µg/L)</i>	<i>Xylenes (µg/L)</i>	<i>MTBE (µg/L)</i>	<i>Notes</i>
MW-7A	12/12/2007		35.96	4.62	45,000	13,000	1,400	16,000	ND<25	ND<25	ND<25	ND<25	ND<250	a,c,d
cont.	3/7/2008		36.28	4.30	56,000	3,800	1,600	3,500	ND<2.5	ND<2.5	ND<2.5	3.7	--	a,h,i,c
	6/9/2008		35.35	5.23	150,000	35,000	ND<12,000	68,000	ND<25	ND<25	ND<25	ND<25	ND<250	a,c,h,i
	9/5/2008		35.00	5.58	63,000	9,800	2,700	13,000	ND<25	ND<25	ND<25	ND<25	ND<250	a,c,h,i
	12/18/2008		35.95	4.63	28,000	6,200	ND<2,500	9,100	ND<2.5	ND<2.5	2.7	ND<2.5	--	a,c,h
	3/30/2009		36.38	4.20	110,000	11,000	ND<12,000	16,000	ND<25	ND<25	ND<25	ND<25	ND<250	a,c,h
MW-1B	6/3/2004	Zone B	25.10	14.40	ND<50	ND<50	ND<250	ND<50	ND<0.5	ND<0.5	ND<0.5	ND<0.5	ND<5.0	
39.50	11/23/2004		26.24	13.26	ND<50	ND<50	ND<250	ND<50	ND<0.5	ND<0.5	ND<0.5	ND<0.5	ND<5.0	
	3/14/2005		33.97	5.53	52	ND<50	ND<250	ND<50	0.60	ND<0.5	ND<0.5	ND<0.5	ND<5.0	d,i
	6/15/2005		31.87	7.63	ND<50	ND<50	ND<250	ND<50	ND<0.5	ND<0.5	ND<0.5	ND<0.5	ND<5.0	i
	9/19/2005		30.35	9.15	ND<50	ND<50	ND<250	ND<50	ND<0.5	ND<0.5	ND<0.5	ND<0.5	ND<5.0	i
	12/12/2005		30.39	9.11	ND<50	ND<50	ND<250	ND<50	ND<0.5	ND<0.5	ND<0.5	ND<0.5	ND<5.0	i
	3/13/2006		32.15	7.35	--	--	--	--	--	--	--	--	--	
	6/19/2006		22.99	16.51	--	--	--	--	--	--	--	--	--	
	9/20/2006		30.32	9.18	--	--	--	--	--	--	--	--	--	
	12/20/2006		31.60	7.90	--	--	--	--	--	--	--	--	--	
	3/29/2007		24.63	14.87	--	--	--	--	--	--	--	--	--	
	6/11/2007		26.39	13.11	--	--	--	--	--	--	--	--	--	
	9/7/2007		28.42	11.08	--	--	--	--	--	--	--	--	--	
	12/12/2007		30.60	8.90	--	--	--	--	--	--	--	--	--	
	3/7/2008		32.48	7.02	--	--	--	--	--	--	--	--	--	
	6/9/2008		30.50	9.00	--	--	--	--	--	--	--	--	--	
	9/5/2008		30.11	9.39	--	--	--	--	--	--	--	--	--	
	12/18/2008		30.34	9.16	--	--	--	--	--	--	--	--	--	
	3/30/2009		32.09	7.41	--	--	--	--	--	--	--	--	--	
MW-4B	6/3/2004	Zone B	33.52	5.02	ND<50	ND<50	ND<250	ND<50	ND<0.5	ND<0.5	ND<0.5	ND<0.5	ND<5.0	
38.54	11/23/2004		34.65	3.89	ND<50	ND<50	ND<250	ND<50	ND<0.5	ND<0.5	ND<0.5	ND<0.5	ND<5.0	
	3/14/2005		34.78	3.76	--	--	--	--	--	--	--	--	--	
	3/15/2005		--	--	ND<50	ND<50	ND<250	ND<50	ND<0.5	ND<0.5	ND<0.5	ND<0.5	ND<5.0	i
	6/15/2005		33.98	4.56	--	--	--	--	--	--	--	--	--	
	6/16/2005		--	--	ND<50	ND<50	ND<250	ND<50	ND<0.5	ND<0.5	ND<0.5	ND<0.5	ND<5.0	i

TABLE 2

MONITORING WELL GROUNDWATER ANALYTICAL RESULTS: PETROLEUM HYDROCARBONS
JOHN NADY
1137-1167 65TH STREET, OAKLAND, CA

<i>Well ID (TOC)</i>	<i>Date Sampled</i>	<i>Groundwater Zone</i>	<i>Groundwater Elevation (ft msl)</i>	<i>Depth to Water (ft, TOC)</i>	<i>TPHd (µg/L)</i>	<i>TPHg (µg/L)</i>	<i>TPHmo (µg/L)</i>	<i>TPHss (µg/L)</i>	<i>Benzene (µg/L)</i>	<i>Toluene (µg/L)</i>	<i>Ethylbenzene (µg/L)</i>	<i>Xylenes (µg/L)</i>	<i>MTBE (µg/L)</i>	<i>Notes</i>
MW-4B	9/19/2005		32.57	5.97	--	--	--	--	--	--	--	--	--	
cont.	9/20/2005		--	--	ND<50	ND<50	ND<250	ND<50	ND<0.5	ND<0.5	ND<0.5	ND<0.5	ND<5.0	i
	12/12/2005		33.65	4.89	--	--	--	--	--	--	--	--	--	
	12/13/2005		--	--	ND<50	ND<50	ND<250	ND<50	ND<0.5	ND<0.5	ND<0.5	ND<0.5	ND<5.0	i
	3/13/2006		34.61	3.93	--	--	--	--	--	--	--	--	--	
	6/19/2006		33.86	4.68	--	--	--	--	--	--	--	--	--	
	9/20/2006		32.58	5.96	--	--	--	--	--	--	--	--	--	
	12/20/2006		33.92	4.62	--	--	--	--	--	--	--	--	--	
	3/29/2007		33.96	4.58	--	--	--	--	--	--	--	--	--	
	6/11/2007		34.03	4.51	--	--	--	--	--	--	--	--	--	
	9/7/2007		33.22	5.32	--	--	--	--	--	--	--	--	--	
	12/12/2007		33.85	4.69	--	--	--	--	--	--	--	--	--	
	3/7/2008		34.58	3.96	--	--	--	--	--	--	--	--	--	
	6/9/2008		33.45	5.09	--	--	--	--	--	--	--	--	--	
	9/5/2008		32.64	5.90	--	--	--	--	--	--	--	--	--	
	12/18/2008		33.39	5.15	--	--	--	--	--	--	--	--	--	
	3/30/2009		34.33	4.21	--	--	--	--	--	--	--	--	--	
MW-5B	6/3/2004	Zone B	30.16	8.82	ND<50	ND<50	ND<250	ND<50	ND<0.5	ND<0.5	ND<0.5	ND<0.5	ND<5.0	
38.98	11/23/2004		31.32	7.66	ND<50	ND<50	ND<250	ND<50	ND<0.5	ND<0.5	ND<0.5	ND<0.5	ND<5.0	
	3/14/2005		32.71	6.27	--	--	--	--	--	--	--	--	--	
	3/15/2005		--	--	ND<50	ND<50	ND<250	ND<50	ND<0.5	ND<0.5	ND<0.5	ND<0.5	ND<5.0	i
	6/15/2005		31.20	7.78	ND<50	ND<50	ND<250	ND<50	ND<0.5	ND<0.5	ND<0.5	ND<0.5	ND<5.0	i
	9/19/2005		28.68	10.30	--	--	--	--	--	--	--	--	--	
	9/20/2005		--	--	ND<50	ND<50	ND<250	ND<50	ND<0.5	ND<0.5	ND<0.5	ND<0.5	ND<5.0	
	12/12/2005		30.65	8.33	ND<50	ND<50	ND<250	ND<50	ND<0.5	ND<0.5	ND<0.5	ND<0.5	ND<5.0	i
	3/13/2006		32.87	6.11	--	--	--	--	--	--	--	--	--	
	6/19/2006		30.97	8.01	--	--	--	--	--	--	--	--	--	
	9/20/2006		29.68	9.30	--	--	--	--	--	--	--	--	--	
	12/20/2006		31.21	7.77	--	--	--	--	--	--	--	--	--	
	3/29/2007		31.40	7.58	--	--	--	--	--	--	--	--	--	
	6/11/2007		31.02	7.96	--	--	--	--	--	--	--	--	--	
	9/7/2007		30.02	8.96	--	--	--	--	--	--	--	--	--	

TABLE 2

MONITORING WELL GROUNDWATER ANALYTICAL RESULTS: PETROLEUM HYDROCARBONS
JOHN NADY
1137-1167 65TH STREET, OAKLAND, CA

Well ID (TOC)	Date Sampled	Groundwater Zone	Groundwater Elevation (ft msl)	Depth to Water (ft, TOC)	TPHd (µg/L)	TPHg (µg/L)	TPHmo (µg/L)	TPHss (µg/L)	Benzene (µg/L)	Toluene (µg/L)	Ethylbenzene (µg/L)	Xylenes (µg/L)	MTBE (µg/L)	Notes
MW-5B	12/12/2007		30.88	8.10	--	--	--	--	--	--	--	--	--	
cont.	3/7/2008		32.55	6.43	--	--	--	--	--	--	--	--	--	
	6/9/2008		30.34	8.64	--	--	--	--	--	--	--	--	--	
	9/5/2008		29.50	9.48	--	--	--	--	--	--	--	--	--	
	12/18/2008		30.34	8.64	--	--	--	--	--	--	--	--	--	
	3/30/2009		32.10	6.88	--	--	--	--	--	--	--	--	--	
MW-6B	6/3/2004	Zone B	29.36	8.30	2,300	1,100	ND<250	2,900	ND<0.5	ND<0.5	ND<0.5	1.4	ND<5.0	
37.66	11/23/2004		30.53	7.13	280	500	ND<250	700	ND<0.5	ND<0.5	ND<0.5	1.6	ND<5.0	a,c
	3/14/2005		31.86	5.80	5,200	1,300	340	1,200	ND<0.5	ND<0.5	ND<0.5	ND<0.5	ND<5.0	e,d,i
	6/15/2005		30.17	7.49	1,700	900	ND<250	1,300	ND<0.5	ND<0.5	ND<0.5	1.9	ND<5.0	a,c
	9/19/2005		28.83	8.83	2,700	1,200	ND<250	2,000	1.0	1.4	ND<1.0	5.0	ND<20	a,b,c
	12/12/2005		29.85	7.81	4,100	840	ND<250	1,200	ND<0.5	ND<0.5	ND<0.5	3.3	ND<5.0	a,c,h,i
	3/13/2006		32.31	5.35	6,900	1,400	270	2,000	ND<0.5	ND<0.5	ND<0.5	4.7	--	a,c,d,h,i
	6/19/2006		29.88	7.78	7,700	1,700	310	3,300	ND<1.0	ND<1.0	ND<1.0	ND<1.0	--	c,g,h,m
	9/20/2006		28.78	8.88	16,000	3,200	740	4,200	ND<5.0	ND<5.0	ND<5.0	ND<5.0	--	a,c,d,g,h,i
	12/20/2006		30.34	7.32	16,000	55,000	ND<1,200	77,000	ND<50	ND<50	ND<50	130	--	e,g,h,n
	3/29/2007		30.44	7.22	24,000	3,400	650	4,300	ND<5.0	ND<5.0	ND<5.0	ND<5.0	ND<50	a,h,c,d
	6/11/2007		29.93	7.73	29,000	2,600	ND<1,200	2,100	ND<5.0	ND<5.0	ND<5.0	ND<5.0	--	a,c,d,h
	9/7/2007		28.95	8.71	32,000	4,500	ND<1,200	3,800	ND<5.0	ND<5.0	ND<5.0	11	ND<50	a,b,c,d,h
	12/12/2007		30.00	7.66	36,000	12,000	1,000	15,000	ND<25	ND<25	ND<25	ND<25	ND<250	a,h,c,d
	3/7/2008		31.70	5.96	27,000	3,100	1,100	2,700	ND<2.5	ND<2.5	ND<2.5	6.1	--	a,h,k
	6/9/2008		29.36	8.30	81,000	9,500	ND<5,000	20,000	ND<25	ND<25	ND<25	ND<25	ND<250	a,c,h
	9/5/2008		28.66	9.00	40,000	13,000	ND<2500	17,000	ND<10	ND<10	ND<10	ND<10	ND<100	a,c,h
	12/18/2008		29.68	7.98	29,000	5,200	ND<2,500	7,400	ND<5.0	ND<5.0	ND<5.0	ND<5.0	--	a,c,h
	3/30/2009		31.31	6.35	34,000	10,000	ND<2,500	13,000	ND<25	ND<25	ND<25	ND<25	ND<250	c,h,m
MW-1C	6/3/2004	Zone C	30.07	9.42	ND<50	ND<50	ND<250	ND<50	ND<0.5	ND<0.5	ND<0.5	ND<0.5	ND<5.0	
39.49	11/23/2004		31.30	8.19	ND<50	ND<50	ND<250	ND<50	ND<0.5	ND<0.5	ND<0.5	ND<0.5	ND<5.0	
	3/14/2005		32.58	6.91	ND<50	ND<50	ND<250	ND<50	ND<0.5	ND<0.5	ND<0.5	ND<0.5	ND<5.0	f
	6/15/2005		30.89	8.60	ND<50	ND<50	ND<250	ND<50	ND<0.5	ND<0.5	ND<0.5	ND<0.5	ND<5.0	
	9/19/2005		29.19	10.30	ND<50	ND<50	ND<250	ND<50	ND<0.5	ND<0.5	ND<0.5	ND<0.5	ND<5.0	i
	12/12/2005		30.54	8.95	ND<50	ND<50	ND<250	ND<50	ND<0.5	ND<0.5	ND<0.5	ND<0.5	ND<5.0	i

TABLE 2

MONITORING WELL GROUNDWATER ANALYTICAL RESULTS: PETROLEUM HYDROCARBONS
JOHN NADY
1137-1167 65TH STREET, OAKLAND, CA

Well ID (TOC)	Date Sampled	Groundwater Zone	Groundwater Elevation (ft msl)	Depth to Water (ft, TOC)	TPHd (µg/L)	TPHg (µg/L)	TPHmo (µg/L)	TPHss (µg/L)	Benzene (µg/L)	Toluene (µg/L)	Ethylbenzene (µg/L)	Xylenes (µg/L)	MTBE (µg/L)	Notes
MW-1C	3/13/2006		32.99	6.50	--	--	--	--	--	--	--	--	--	
cont.	6/19/2006		30.66	8.83	--	--	--	--	--	--	--	--	--	
	9/20/2006		29.53	9.96	--	--	--	--	--	--	--	--	--	
	12/20/2006		31.13	8.36	--	--	--	--	--	--	--	--	--	
	3/29/2007		31.19	8.30	--	--	--	--	--	--	--	--	--	
	6/11/2007		30.63	8.86	--	--	--	--	--	--	--	--	--	
	9/7/2007		29.60	9.89	--	--	--	--	--	--	--	--	--	
	12/12/2007		30.61	8.88	--	--	--	--	--	--	--	--	--	
	3/7/2008		32.46	7.03	--	--	--	--	--	--	--	--	--	
	6/9/2008		30.07	9.42	--	--	--	--	--	--	--	--	--	
	9/5/2008		29.34	10.15	--	--	--	--	--	--	--	--	--	
	12/18/2008		30.28	9.21	--	--	--	--	--	--	--	--	--	
	3/30/2009		32.12	7.37	--	--	--	--	--	--	--	--	--	
MW-4C	6/3/2004	Zone C	30.10	8.40	ND<50	ND<50	ND<250	ND<50	ND<0.5	ND<0.5	ND<0.5	ND<0.5	ND<5.0	
38.50	11/23/2004		31.31	7.19	ND<50	ND<50	ND<250	ND<50	ND<0.5	ND<0.5	ND<0.5	ND<0.5	ND<5.0	
	3/14/2005		33.15	5.35	--	--	--	--	--	--	--	--	--	
	3/15/2005		--	--	ND<50	ND<50	ND<250	ND<50	ND<0.5	ND<0.5	ND<0.5	ND<0.5	ND<5.0	i
	6/15/2005		30.85	7.65	--	--	--	--	--	--	--	--	--	
	6/16/2005		--	--	ND<50	ND<50	ND<250	ND<50	ND<0.5	ND<0.5	ND<0.5	ND<0.5	ND<5.0	
	9/19/2005		25.97	12.53	--	--	--	--	--	--	--	--	--	
	9/20/2005		--	--	ND<50	ND<50	ND<250	ND<50	ND<0.5	ND<0.5	ND<0.5	ND<0.5	ND<5.0	
	12/12/2005		30.00	8.50	--	--	--	--	--	--	--	--	--	
	12/13/2005		--	--	ND<50	ND<50	ND<250	ND<50	ND<0.5	ND<0.5	ND<0.5	ND<0.5	ND<5.0	i
	3/13/2006		31.18	7.32	--	--	--	--	--	--	--	--	--	
	6/19/2006		30.90	7.60	--	--	--	--	--	--	--	--	--	
	9/20/2006		29.91	8.59	--	--	--	--	--	--	--	--	--	
	12/20/2006		31.21	7.29	--	--	--	--	--	--	--	--	--	
	3/29/2007		31.29	7.21	--	--	--	--	--	--	--	--	--	
	6/11/2007		30.93	7.57	--	--	--	--	--	--	--	--	--	
	9/7/2007		30.20	8.30	--	--	--	--	--	--	--	--	--	
	12/12/2007		31.10	7.40	--	--	--	--	--	--	--	--	--	
	3/7/2008		32.25	6.25	--	--	--	--	--	--	--	--	--	
	6/9/2008		30.35	8.15	--	--	--	--	--	--	--	--	--	

TABLE 2

**MONITORING WELL GROUNDWATER ANALYTICAL RESULTS: PETROLEUM HYDROCARBONS
JOHN NADY
1137-1167 65TH STREET, OAKLAND, CA**

<i>Well ID (TOC)</i>	<i>Date Sampled</i>	<i>Groundwater Zone</i>	<i>Groundwater Elevation (ft msl)</i>	<i>Depth to Water (ft, TOC)</i>	<i>TPHd (µg/L)</i>	<i>TPHg (µg/L)</i>	<i>TPHmo (µg/L)</i>	<i>TPHss (µg/L)</i>	<i>Benzene (µg/L)</i>	<i>Toluene (µg/L)</i>	<i>Ethylbenzene (µg/L)</i>	<i>Xylenes (µg/L)</i>	<i>MTBE (µg/L)</i>	<i>Notes</i>
MW-4C	9/5/2008		29.62	8.88	--	--	--	--	--	--	--	--	--	
cont.	12/18/2008		30.31	8.19	--	--	--	--	--	--	--	--	--	
	3/30/2009		31.59	6.91	--	--	--	--	--	--	--	--	--	
MW-6C	6/3/2004	Zone C	27.89	9.70	240	160	ND<250	340	ND<0.5	ND<0.5	ND<0.5	1.1	ND<5.0	
37.59	11/23/2004		29.21	8.38	ND<50	ND<50	ND<250	ND<50	ND<0.5	ND<0.5	ND<0.5	ND<0.5	ND<5.0	
	3/14/2005		31.79	5.80	60	ND<50	ND<250	ND<50	ND<0.5	ND<0.5	ND<0.5	ND<0.5	ND<5.0	d
	6/15/2005		30.14	7.45	ND<50	ND<50	ND<250	ND<50	ND<0.5	ND<0.5	ND<0.5	ND<0.5	ND<5.0	
	9/19/2005		28.79	8.80	ND<50	ND<50	ND<250	ND<50	ND<0.5	ND<0.5	ND<0.5	ND<0.5	ND<5.0	
	12/12/2005		29.81	7.78	ND<50	ND<50	ND<250	ND<50	ND<0.5	ND<0.5	ND<0.5	ND<0.5	ND<5.0	
	3/13/2006		32.09	5.50	--	--	--	--	--	--	--	--	--	
	6/19/2006		29.84	7.75	--	--	--	--	--	--	--	--	--	
	9/20/2006		28.74	8.85	--	--	--	--	--	--	--	--	--	
	12/20/2006		30.29	7.30	--	--	--	--	--	--	--	--	--	
	3/29/2007		30.39	7.20	--	--	--	--	--	--	--	--	--	
	6/11/2007		29.86	7.73	--	--	--	--	--	--	--	--	--	
	9/7/2007		28.92	8.67	--	--	--	--	--	--	--	--	--	
	12/12/2007		29.94	7.65	--	--	--	--	--	--	--	--	--	
	3/7/2008		31.63	5.96	--	--	--	--	--	--	--	--	--	
	6/9/2008		29.32	8.27	--	--	--	--	--	--	--	--	--	
	9/5/2008		28.60	8.99	--	--	--	--	--	--	--	--	--	
	12/18/2008		29.64	7.95	--	--	--	--	--	--	--	--	--	
	3/30/2009		31.26	6.33	--	--	--	--	--	--	--	--	--	

TABLE 2

**MONITORING WELL GROUNDWATER ANALYTICAL RESULTS: PETROLEUM HYDROCARBONS
JOHN NADY
1137-1167 65TH STREET, OAKLAND, CA**

<i>Well ID (TOC)</i>	<i>Date Sampled</i>	<i>Groundwater Zone</i>	<i>Groundwater Elevation (ft msl)</i>	<i>Depth to Water (ft, TOC)</i>	<i>TPHd (µg/L)</i>	<i>TPHg (µg/L)</i>	<i>TPHmo (µg/L)</i>	<i>TPHss (µg/L)</i>	<i>Benzene (µg/L)</i>	<i>Toluene (µg/L)</i>	<i>Ethylbenzene (µg/L)</i>	<i>Xylenes (µg/L)</i>	<i>MTBE (µg/L)</i>	<i>Notes</i>
--------------------------	-------------------------	-----------------------------	---	---	------------------------	------------------------	-------------------------	-------------------------	---------------------------	---------------------------	--------------------------------	---------------------------	------------------------	--------------

Abbreviations:

µg/L = micrograms per liter - approximately equal to parts per billion = ppb
 (TOC) = Top of casing elevation in feet above mean sea level (msl)
 ft = measured in feet
 TPHd = Total petroleum hydrocarbons as diesel by EPA Method SW8015C with silica gel cleanup.
 TPHg = Total petroleum hydrocarbons as gasoline by EPA Method SW8015C.
 TPHmo = Total petroleum hydrocarbons as motor oil by EPA Method SW8015C with silica gel cleanup.
 TPHss = Total petroleum hydrocarbons as stoddard solvent by EPA Method SW8015C.
 Benzene, toluene, ethylbenzene, and xylenes by EPA Method SW8021B.
 MTBE = Methyl tertiary-butyl ether by EPA Method SW8021B (EPA Method SW8260B).
 -- = Not available, not applicable, not analyzed, not measured

Notes:

a = TPH pattern that does not appear to be derived from gasoline (stoddard solvent/mineral spirit?).
 b = No recognizable pattern.
 c = Stoddard solvent/mineral spirit.
 d = Diesel range compounds are significant; no recognizable pattern.
 e = Gasoline range compounds are significant.
 f = One to a few isolated peaks present
 g = Oil range compounds are significant.
 h = Lighter than water immiscible sheen/product is present.
 i = Liquid sample contains greater than ~1 vol. % sediment.
 j = Unmodified or weakly modified gasoline is significant
 k = TPHg range non-target isolated peaks subtracted out of the TPHg concentration
 l = Heavier gasoline compounds are significant (aged gasoline?)
 m = Strongly aged gasoline or diesel range compounds are significant
 n = Diesel range compounds are significant

TABLE 3

MONITORING WELL GROUNDWATER ANALYTICAL RESULTS: HALOGENATED VOLATILE ORGANIC COMPOUNDS
JOHN NADY
1137-1167 65TH STREET, OAKLAND, CA

Well ID (TOC)	Date Sampled	Groundwater Zone	Groundwater Elevation (ft amsl)	Depth to Water (ft, TOC)	Chloro- benzene (µg/L)	Chloro- ethane (µg/L)	Chloroform (µg/L)	1,1,2,2,-Tetra- chloroethane (µg/L)	(PCE) Tetrachloroethene (µg/L)	(TCE) Trichloroethene (µg/L)	1,2- Dichlorobenzene (µg/L)	cis-1,2- Dichloroethene (µg/L)	trans-1,2- Dichloroethene (µg/L)	1,1- Dichloroethane (µg/L)	(1,2-DCA) 1,2-Dichloroethane (µg/L)	Vinyl Chloride (µg/L)	Notes	
MW-1A 39.64	6/3/2004	Zone A	35.14	4.50	--	ND<2.5	ND<2.5	ND<2.5	55	16	ND<2.5	36	ND<2.5	ND<2.5	ND<2.5	6.3		
	11/23/2004		36.54	3.10	ND<1.0	ND<1.0	ND<1.0	ND<1.0	38	11	ND<1.0	51	2.4	2.8	ND<1.0	9.5		
	3/14/2005		37.02	2.62	ND<1.0	ND<1.0	ND<1.0	ND<1.0	42	12	2.0	32	2.2	2.4	ND<1.0	8.0		
	6/15/2005		35.14	4.50	ND<1.0	ND<1.0	ND<1.0	ND<1.0	62	19	2.6	24	2.4	3.0	ND<1.0	10	h,i	
	9/19/2005		33.14	6.50	ND<1.2	ND<1.2	ND<1.2	ND<1.2	55	18	2.3	28	2.0	2.6	ND<1.2	9.4	i	
	12/12/2005		35.14	4.50	ND<1.0	ND<1.0	ND<1.0	16	60	17	2.0	22	2.3	2.5	ND<1.0	12	h,i	
	3/13/2006		37.74	1.90	ND<1.2	ND<1.2	ND<1.2	14	30	17	ND<1.2	16	1.4	2.0	ND<1.2	4.0	i	
	6/19/2006		35.94	3.70	ND<0.5	ND<0.5	ND<0.5	ND<0.5	33	9.0	ND<0.5	15	1.1	1.8	ND<0.5	3.2		
	9/20/2006		34.19	5.45	ND<0.5	ND<0.5	ND<0.5	ND<0.5	34	15	ND<0.5	21	1.6	2.3	ND<0.5	5.4	i	
	12/20/2006		37.02	2.62	ND<0.5	ND<0.5	ND<0.5	ND<0.5	27	15	ND<0.5	16	1.3	1.7	ND<0.5	5.2		
	3/29/2007		37.04	2.60	ND<0.5	ND<0.5	ND<0.5	ND<0.5	29	16	ND<0.5	13	1.2	1.4	ND<0.5	ND<0.5		
	6/11/2007		35.72	3.92	ND<0.5	ND<0.5	ND<0.5	ND<0.5	26	17	ND<0.5	13	1.6	1.9	ND<0.5	2.3		
	9/7/2007		33.90	5.74	ND<0.5	ND<0.5	ND<0.5	ND<0.5	25	15	ND<0.5	17	1.4	2.0	ND<0.5	2.3		
	12/12/2007		36.53	3.11	ND<0.5	ND<0.5	ND<0.5	ND<0.5	15	10	ND<0.5	14	1.2	2.1	ND<0.5	1.5		
	3/7/2008		37.23	2.41	ND<0.5	ND<0.5	ND<0.5	17	9.0	9.3	1.3	13	1.2	1.7	ND<0.5	1.7		
	6/9/2008		34.69	4.95	ND<0.5	ND<0.5	ND<0.5	ND<0.5	11	9.0	ND<0.5	11	1.1	1.8	ND<0.5	2.4	i	
	9/5/2008		33.58	6.06	ND<0.5	ND<0.5	ND<0.5	ND<0.5	12	13	ND<0.5	13	1.3	1.7	ND<0.5	1.5		
	12/18/2008		36.68	2.96	ND<0.5	ND<0.5	ND<0.5	ND<0.5	8.6	8.6	ND<0.5	13	0.99	1.5	ND<0.5	2.7		
	3/30/2009		37.28	2.36	ND<0.5	ND<0.5	ND<0.5	ND<0.5	11	10	ND<0.5	9.8	1.1	1.5	ND<0.5	2.5		
	MW-2A 40.72		6/3/2004	Zone A	36.48	4.24	--	ND<0.5	ND<0.5	ND<0.5	ND<0.5	ND<0.5	ND<0.5	ND<0.5	ND<0.5	ND<0.5	ND<0.5	ND<0.5
11/23/2004		37.83	2.89		ND<0.5	ND<0.5	ND<0.5	ND<0.5	ND<0.5	ND<0.5	ND<0.5	ND<0.5	ND<0.5	ND<0.5	ND<0.5	ND<0.5	ND<0.5	
3/14/2005		39.02	1.70		--	--	--	--	--	--	--	--	--	--	--	--	--	
3/15/2005		--	--		ND<0.5	ND<0.5	ND<0.5	ND<0.5	ND<0.5	ND<0.5	ND<0.5	ND<0.5	ND<0.5	ND<0.5	ND<0.5	ND<0.5	ND<0.5	i
6/15/2005		37.91	2.81		--	--	--	--	--	--	--	--	--	--	--	--	--	
6/16/2005		--	--		ND<0.5	ND<0.5	ND<0.5	ND<0.5	ND<0.5	ND<0.5	ND<0.5	ND<0.5	ND<0.5	ND<0.5	ND<0.5	ND<0.5	ND<0.5	i
9/19/2005		35.46	5.26		--	--	--	--	--	--	--	--	--	--	--	--	--	
9/20/2005		--	--		ND<0.5	ND<0.5	ND<0.5	ND<0.5	ND<0.5	ND<0.5	ND<0.5	ND<0.5	ND<0.5	ND<0.5	ND<0.5	ND<0.5	ND<0.5	i
12/12/2005		37.66	3.06		--	--	--	--	--	--	--	--	--	--	--	--	--	
12/13/2005		--	--		ND<0.5	ND<0.5	ND<0.5	ND<0.5	ND<0.5	ND<0.5	ND<0.5	ND<0.5	ND<0.5	ND<0.5	ND<0.5	ND<0.5	ND<0.5	i
3/13/2006		40.33	0.39		--	--	--	--	--	--	--	--	--	--	--	--	--	
6/19/2006		37.31	3.41		--	--	--	--	--	--	--	--	--	--	--	--	--	
9/20/2006		34.65	6.07		--	--	--	--	--	--	--	--	--	--	--	--	--	
12/20/2006		38.57	2.15		--	--	--	--	--	--	--	--	--	--	--	--	--	
3/29/2007		38.22	2.50		--	--	--	--	--	--	--	--	--	--	--	--	--	
6/11/2007		37.14	3.58		--	--	--	--	--	--	--	--	--	--	--	--	--	
9/7/2007		35.04	5.68		--	--	--	--	--	--	--	--	--	--	--	--	--	
12/12/2007		37.82	2.90		--	--	--	--	--	--	--	--	--	--	--	--	--	
3/7/2008		38.79	1.93		--	--	--	--	--	--	--	--	--	--	--	--	--	
6/9/2008		36.18	4.54		--	--	--	--	--	--	--	--	--	--	--	--	--	
9/5/2008	34.46	6.26	--	--	--	--	--	--	--	--	--	--	--	--	--			
12/18/2008	37.55	3.17	--	--	--	--	--	--	--	--	--	--	--	--	--			
3/30/2009	38.76	1.96	--	--	--	--	--	--	--	--	--	--	--	--	--			
MW-3A 40.88	6/3/2004	Zone A	36.56	4.32	--	ND<5.0	ND<5.0	ND<5.0	ND<5.0	ND<5.0	ND<5.0	ND<5.0	ND<5.0	ND<5.0	ND<5.0	ND<5.0	a	
	11/23/2004		37.89	2.99	ND<5.0	ND<5.0	ND<5.0	ND<5.0	ND<5.0	ND<5.0	ND<5.0	ND<5.0	ND<5.0	ND<5.0	ND<5.0	ND<5.0		
	3/14/2005		37.28	3.60	--	--	--	--	--	--	--	--	--	--	--	--	--	
	3/15/2005		--	--	ND<1.0	ND<1.0	ND<1.0	ND<1.0	ND<1.0	ND<1.0	43	ND<1.0	ND<1.0	ND<1.0	ND<1.0	ND<1.0	j,i	
	6/15/2005		36.78	4.10	--	--	--	--	--	--	--	--	--	--	--	--	--	
	6/16/2005		--	--	ND<1.0	ND<1.0	ND<1.0	ND<1.0	ND<1.0	ND<1.0	ND<1.0	52	ND<1.0	ND<1.0	ND<1.0	ND<1.0	ND<1.0	h,i

TABLE 3

**MONITORING WELL GROUNDWATER ANALYTICAL RESULTS: HALOGENATED VOLATILE ORGANIC COMPOUNDS
JOHN NADY
1137-1167 65TH STREET, OAKLAND, CA**

Well ID (TOC)	Date Sampled	Groundwater Zone	Groundwater Elevation (ft amsl)	Depth to Water (ft, TOC)	Chloro- benzene (µg/L)	Chloro- ethane (µg/L)	Chloroform (µg/L)	1,1,2,2-Tetra- chloroethane (µg/L)	(PCE) Tetrachloroethene (µg/L)	(TCE) Trichloroethene (µg/L)	1,2- Dichlorobenzene (µg/L)	cis-1,2- Dichloroethene (µg/L)	trans-1,2- Dichloroethene (µg/L)	1,1- Dichloroethane (µg/L)	(1,2-DCA) 1,2-Dichloroethane (µg/L)	Vinyl Chloride (µg/L)	Notes
MW-3A	9/19/2005		35.93	4.95	--	--	--	--	--	--	--	--	--	--	--	--	
cont.	9/20/2005		--	--	ND<1.0	ND<1.0	ND<1.0	ND<1.0	ND<1.0	ND<1.0	51	ND<1.0	ND<1.0	ND<1.0	ND<1.0	ND<1.0	i
	12/12/2005		36.72	4.16	--	--	--	--	--	--	--	--	--	--	--	--	
	12/13/2005		--	--	ND<1.0	ND<1.0	ND<1.0	26	ND<1.0	ND<1.0	43	ND<1.0	ND<1.0	ND<1.0	ND<1.0	ND<1.0	hi,
	3/13/2006		37.42	3.46	--	--	--	--	--	--	--	--	--	--	--	--	
	3/14/2006		--	--	ND<1.0	ND<1.0	ND<1.0	ND<1.0	ND<1.0	ND<1.0	ND<1.0	ND<1.0	ND<1.0	ND<1.0	ND<1.0	ND<1.0	i
	6/19/2006		36.48	4.40	3.7	--	--	--	--	--	--	--	--	--	--	--	
	6/20/2006		--	--	9.8	ND<1.0	ND<1.0	ND<1.0	ND<1.0	ND<1.0	ND<1.0	ND<1.0	ND<1.0	ND<1.0	ND<1.0	ND<1.0	h
	9/20/2006		35.78	5.10	31	ND<1.0	ND<1.0	ND<1.0	ND<1.0	ND<1.0	ND<1.0	ND<1.0	ND<1.0	ND<1.0	ND<1.0	ND<1.0	hi
	12/20/2006		36.78	4.10	31	ND<1.0	ND<1.0	ND<1.0	ND<1.0	ND<1.0	ND<1.0	ND<1.0	ND<1.0	ND<1.0	ND<1.0	ND<1.0	h
	3/29/2007		36.82	4.06	55	ND<1.7	ND<1.7	ND<1.7	ND<1.7	ND<1.7	ND<1.7	ND<1.7	ND<1.7	ND<1.7	ND<1.7	ND<1.7	
	6/11/2007		36.52	4.36	68	ND<1.7	ND<1.7	ND<1.7	ND<1.7	ND<1.7	ND<1.7	ND<1.7	ND<1.7	ND<1.7	ND<1.7	ND<1.7	h
	9/7/2007		35.98	4.90	82	ND<2.5	ND<2.5	ND<2.5	ND<2.5	ND<2.5	ND<2.5	ND<2.5	ND<2.5	ND<2.5	ND<2.5	ND<2.5	h
	12/12/2007		36.54	4.34	72	ND<1.7	ND<1.7	ND<1.7	ND<1.7	ND<1.7	ND<1.7	ND<1.7	ND<1.7	ND<1.7	ND<1.7	ND<1.7	h
	3/7/2008		36.87	4.01	74	ND<1.0	ND<1.0	ND<1.0	ND<1.0	ND<1.0	19	ND<1.0	ND<1.0	ND<1.0	ND<1.0	ND<1.0	h
	6/9/2008		36.03	4.85	98	ND<2.5	ND<2.5	ND<2.5	ND<2.5	ND<2.5	22	ND<2.5	ND<2.5	ND<2.5	ND<2.5	ND<2.5	hi
	9/5/2008		35.78	5.10	92	ND<1.7	ND<1.7	ND<1.7	ND<1.7	ND<1.7	16	ND<1.7	ND<1.7	ND<1.7	ND<1.7	ND<1.7	h
	12/18/2008		36.65	4.23	95	ND<5.0	ND<5.0	ND<5.0	ND<5.0	ND<5.0	ND<5.0	ND<5.0	ND<5.0	ND<5.0	ND<5.0	ND<5.0	h
	3/30/2009		37.19	3.69	85	ND<5.0	ND<5.0	ND<5.0	ND<5.0	ND<5.0	ND<5.0	ND<5.0	ND<5.0	ND<5.0	ND<5.0	ND<5.0	h
MW-4A	6/3/2004	Zone A	36.26	2.45	--	ND<0.5	ND<0.5	ND<0.5	1.7	ND<0.5	ND<0.5	ND<0.5	ND<0.5	ND<0.5	ND<0.5	ND<0.5	
38.71	11/23/2004		37.13	1.58	ND<0.5	ND<0.5	ND<0.5	ND<0.5	1.9	ND<0.5	ND<0.5	ND<0.5	ND<0.5	ND<0.5	ND<0.5	ND<0.5	
	3/14/2005		36.66	2.05	--	--	--	--	--	--	--	--	--	--	--	--	
	3/15/2005		--	--	ND<0.5	ND<0.5	ND<0.5	ND<0.5	1.1	ND<0.5	ND<0.5	ND<0.5	ND<0.5	ND<0.5	ND<0.5	ND<0.5	i
	6/15/2005		36.38	2.33	--	--	--	--	--	--	--	--	--	--	--	--	
	6/16/2005		--	--	ND<0.5	ND<0.5	ND<0.5	ND<0.5	1.4	ND<0.5	ND<0.5	ND<0.5	ND<0.5	ND<0.5	ND<0.5	ND<0.5	
	9/19/2005		35.01	3.70	--	--	--	--	--	--	--	--	--	--	--	--	
	9/20/2005		--	--	ND<0.5	ND<0.5	ND<0.5	ND<0.5	1.3	ND<0.5	ND<0.5	ND<0.5	ND<0.5	ND<0.5	ND<0.5	ND<0.5	
	12/12/2005		36.39	2.32	--	--	--	--	--	--	--	--	--	--	--	--	
	12/13/2005		--	--	ND<0.5	ND<0.5	ND<0.5	ND<0.5	2.0	ND<0.5	ND<0.5	ND<0.5	ND<0.5	ND<0.5	ND<0.5	ND<0.5	i
	3/13/2006		36.75	1.96	--	--	--	--	--	--	--	--	--	--	--	--	
	6/19/2006		36.15	2.56	--	--	--	--	--	--	--	--	--	--	--	--	
	9/20/2006		35.10	3.61	--	--	--	--	--	--	--	--	--	--	--	--	
	12/20/2006		36.39	2.32	--	--	--	--	--	--	--	--	--	--	--	--	
	3/29/2007		36.46	2.25	--	--	--	--	--	--	--	--	--	--	--	--	
	6/11/2007		36.14	2.57	--	--	--	--	--	--	--	--	--	--	--	--	
	9/7/2007		35.34	3.37	--	--	--	--	--	--	--	--	--	--	--	--	
	12/12/2007		36.25	2.46	--	--	--	--	--	--	--	--	--	--	--	--	
	3/7/2008		36.46	2.25	--	--	--	--	--	--	--	--	--	--	--	--	
	6/9/2008		35.49	3.22	--	--	--	--	--	--	--	--	--	--	--	--	
	9/5/2008		34.79	3.92	--	--	--	--	--	--	--	--	--	--	--	--	
	12/18/2008		36.55	2.16	--	--	--	--	--	--	--	--	--	--	--	--	
	3/30/2009		36.43	2.28	--	--	--	--	--	--	--	--	--	--	--	--	
MW-6A	6/3/2004	Zone A	31.98	6.00	--	4.7	0.5	ND<0.5	ND<0.5	ND<0.5	ND<0.5	ND<0.5	1.8	2.1	ND<0.5	6.7	
37.98	11/23/2004		33.13	4.85	ND<0.5	ND<0.5	ND<0.5	ND<0.5	ND<0.5	ND<0.5	ND<0.5	ND<0.5	ND<0.5	ND<0.5	ND<0.5	ND<0.5	
	3/14/2005		35.03	2.95	ND<0.5	0.61	ND<0.5	ND<0.5	ND<0.5	ND<0.5	ND<0.5	ND<0.5	ND<0.5	ND<0.5	ND<0.5	ND<0.5	i
	6/15/2005		33.28	4.70	ND<0.5	6.9	ND<0.5	ND<0.5	ND<0.5	ND<0.5	3.3	ND<0.5	2.5	1.5	ND<0.5	3.2	i
	9/19/2005		32.07	5.91	ND<0.5	21	ND<0.5	ND<0.5	ND<0.5	ND<0.5	2.6	ND<0.5	6.7	4.7	0.59	5.0	
	12/12/2005		33.12	4.86	ND<0.5	13	ND<0.5	8.7	ND<0.5	ND<0.5	ND<0.5	ND<0.5	1.1	0.82	ND<0.5	ND<0.5	hi

TABLE 3

**MONITORING WELL GROUNDWATER ANALYTICAL RESULTS: HALOGENATED VOLATILE ORGANIC COMPOUNDS
JOHN NADY
1137-1167 65TH STREET, OAKLAND, CA**

Well ID (TOC)	Date Sampled	Groundwater Zone	Groundwater Elevation (ft amsl)	Depth to Water (ft, TOC)	Chloro- benzene (µg/L)	Chloro- ethane (µg/L)	Chloroform (µg/L)	1,1,2,2-Tetra- chloroethane (µg/L)	(PCE) Tetrachloroethene (µg/L)	(TCE) Trichloroethene (µg/L)	1,2- Dichlorobenzene (µg/L)	cis-1,2- Dichloroethene (µg/L)	trans-1,2- Dichloroethene (µg/L)	1,1- Dichloroethane (µg/L)	(1,2-DCA) 1,2-Dichloroethane (µg/L)	Vinyl Chloride (µg/L)	Notes	
MW-6A cont.	3/13/2006		36.05	1.93	ND<0.5	1.7	ND<0.5	ND<0.5	ND<0.5	ND<0.5	ND<0.5	ND<0.5	ND<0.5	ND<0.5	ND<0.5	ND<0.5	h	
	6/19/2006		32.59	5.39	ND<0.5	9.4	ND<0.5	ND<0.5	ND<0.5	ND<0.5	ND<0.5	ND<0.5	1.0	1.1	ND<0.5	1.3	h	
	9/20/2006		31.96	6.02	ND<0.5	ND<0.5	ND<0.5	ND<0.5	ND<0.5	ND<0.5	ND<0.5	ND<0.5	1.6	1.9	0.57	ND<0.5	i	
	12/20/2006		33.57	4.41	ND<0.5	12	ND<0.5	ND<0.5	ND<0.5	ND<0.5	ND<0.5	ND<0.5	ND<0.5	ND<0.5	ND<0.5	ND<0.5	h	
	3/29/2007		33.67	4.31	ND<0.5	8.0	ND<0.5	ND<0.5	ND<0.5	ND<0.5	ND<0.5	ND<0.5	0.69	0.71	ND<0.5	ND<0.5		
	6/11/2007		32.95	5.03	ND<5.0	9.8	ND<5.0	ND<5.0	ND<5.0	ND<5.0	ND<5.0	ND<5.0	ND<5.0	ND<5.0	ND<5.0	ND<5.0	ND<5.0	
	9/7/2007		32.32	5.66	ND<0.5	24	ND<0.5	ND<0.5	ND<0.5	ND<0.5	ND<0.5	ND<0.5	ND<0.5	ND<0.5	ND<0.5	ND<0.5	h	
	12/12/2007		33.50	4.48	ND<0.5	4.1	ND<0.5	ND<0.5	ND<0.5	ND<0.5	ND<0.5	ND<0.5	ND<0.5	ND<0.5	ND<0.5	ND<0.5	ND<0.5	
	3/7/2008		34.30	3.68	ND<0.5	1.0	ND<0.5	9.5	ND<0.5	ND<0.5	2.4	ND<0.5	ND<0.5	ND<0.5	ND<0.5	ND<0.5	ND<0.5	h
	6/9/2008		32.30	5.68	0.53	11	ND<0.5	ND<0.5	ND<0.5	ND<0.5	ND<0.5	ND<0.5	ND<0.5	ND<0.5	ND<0.5	ND<0.5	ND<0.5	h,i
	9/5/2008		32.05	5.93	1.0	8.0	ND<0.5	ND<0.5	ND<0.5	ND<0.5	2.5	ND<0.5	ND<0.5	ND<0.5	ND<0.5	ND<0.5	ND<0.5	h
	12/18/2008		33.98	4.00	ND<5.0	ND<5.0	ND<5.0	ND<5.0	ND<5.0	ND<5.0	ND<5.0	ND<5.0	ND<5.0	ND<5.0	ND<5.0	ND<5.0	ND<5.0	b,h
	3/30/2009		34.06	3.92	ND<0.5	0.83	ND<0.5	ND<0.5	ND<0.5	ND<0.5	ND<0.5	ND<0.5	ND<0.5	ND<0.5	ND<0.5	ND<0.5	ND<0.5	h
	MW-7A 40.58	6/3/2004	Zone A	36.08	4.50	--	ND<0.5	ND<0.5	ND<0.5	ND<0.5	ND<0.5	2.0	ND<0.5	ND<0.5	ND<0.5	ND<0.5	ND<0.5	ND<0.5
11/23/2004			--	--	--	--	--	--	--	--	--	--	--	--	--	--	--	
3/14/2005			37.03	3.55	ND<0.5	ND<0.5	ND<0.5	ND<0.5	ND<0.5	ND<0.5	2.6	ND<0.5	ND<0.5	ND<0.5	ND<0.5	ND<0.5	ND<0.5	h
6/15/2005			36.41	4.17	ND<0.5	ND<0.5	ND<0.5	ND<0.5	ND<0.5	ND<0.5	1.8	ND<0.5	ND<0.5	ND<0.5	ND<0.5	ND<0.5	ND<0.5	h,i
9/19/2005			35.25	5.33	ND<0.5	ND<0.5	ND<0.5	ND<0.5	ND<0.5	ND<0.5	1.6	ND<0.5	ND<0.5	ND<0.5	ND<0.5	ND<0.5	ND<0.5	i
12/12/2005			36.15	4.43	ND<0.5	ND<0.5	ND<0.5	21	ND<0.5	ND<0.5	ND<0.5	ND<0.5	ND<0.5	ND<0.5	ND<0.5	ND<0.5	ND<0.5	h,i
3/13/2006			36.76	3.82	ND<0.5	ND<0.5	ND<0.5	ND<0.5	ND<0.5	ND<0.5	ND<0.5	ND<0.5	ND<0.5	ND<0.5	ND<0.5	ND<0.5	ND<0.5	h,i
6/19/2006			35.78	4.80	ND<0.5	ND<0.5	ND<0.5	ND<0.5	ND<0.5	ND<0.5	ND<0.5	ND<0.5	ND<0.5	ND<0.5	ND<0.5	ND<0.5	ND<0.5	h,i
9/20/2006			35.03	5.55	ND<0.5	ND<0.5	ND<0.5	ND<0.5	ND<0.5	ND<0.5	ND<0.5	ND<0.5	ND<0.5	ND<0.5	ND<0.5	ND<0.5	ND<0.5	h,i
12/20/2006			36.35	4.23	ND<0.5	ND<0.5	ND<0.5	ND<0.5	ND<0.5	ND<0.5	ND<0.5	ND<0.5	ND<0.5	ND<0.5	ND<0.5	ND<0.5	ND<0.5	h
3/29/2007			36.06	4.52	ND<1.0	ND<1.0	ND<1.0	ND<1.0	ND<1.0	ND<1.0	ND<1.0	ND<1.0	ND<1.0	ND<1.0	ND<1.0	ND<1.0	ND<1.0	
6/11/2007			36.02	4.56	ND<5.0	ND<5.0	ND<5.0	ND<5.0	ND<5.0	ND<5.0	ND<5.0	ND<5.0	ND<5.0	ND<5.0	ND<5.0	ND<5.0	ND<5.0	j,h,i
9/7/2007			35.18	5.40	ND<0.5	ND<0.5	ND<0.5	ND<0.5	ND<0.5	ND<0.5	ND<0.5	ND<0.5	ND<0.5	ND<0.5	ND<0.5	ND<0.5	ND<0.5	h
12/12/2007			35.96	4.62	0.70	ND<0.5	ND<0.5	ND<0.5	ND<0.5	ND<0.5	ND<0.5	ND<0.5	ND<0.5	ND<0.5	ND<0.5	ND<0.5	ND<0.5	
3/7/2008		36.28	4.30	ND<0.5	ND<0.5	ND<0.5	ND<0.5	ND<0.5	ND<0.5	2.6	ND<0.5	ND<0.5	ND<0.5	ND<0.5	ND<0.5	ND<0.5	h,i	
6/9/2008		35.35	5.23	ND<5.0	ND<5.0	ND<5.0	ND<5.0	ND<5.0	ND<5.0	ND<5.0	ND<5.0	ND<5.0	ND<5.0	ND<5.0	ND<5.0	ND<5.0	j,h,i	
9/5/2008		35.00	5.58	0.71	ND<5.0	ND<5.0	ND<5.0	ND<5.0	ND<5.0	ND<5.0	ND<5.0	ND<5.0	ND<5.0	ND<5.0	ND<5.0	ND<5.0	h,i	
12/18/2008		35.95	4.63	ND<2.5	ND<2.5	ND<2.5	ND<2.5	ND<2.5	ND<2.5	ND<2.5	ND<2.5	ND<2.5	ND<2.5	ND<2.5	ND<2.5	ND<2.5	b	
3/30/2009		36.38	4.20	1.4	ND<0.5	ND<0.5	ND<0.5	ND<0.5	ND<0.5	ND<0.5	ND<0.5	ND<0.5	ND<0.5	ND<0.5	ND<0.5	ND<0.5	h	
MW-1B 39.50	6/3/2004	Zone B	25.10	14.40	--	ND<0.5	8.3	ND<0.5	ND<0.5	ND<0.5	3.9	ND<0.5	ND<0.5	8.1	7.9	ND<0.5		
	11/23/2004		26.24	13.26	ND<0.5	ND<0.5	6.2	ND<0.5	ND<0.5	ND<0.5	2.5	ND<0.5	ND<0.5	8.4	8.8	ND<0.5		
	3/14/2005		33.97	5.53	ND<0.5	1.1	1.9	ND<0.5	ND<0.5	ND<0.5	3.8	ND<0.5	ND<0.5	5.2	12	ND<0.5	i	
	6/15/2005		31.87	7.63	ND<0.5	ND<0.5	1.3	ND<0.5	ND<0.5	ND<0.5	3.3	ND<0.5	ND<0.5	8.8	9.9	ND<0.5	i	
	9/19/2005		30.35	9.15	ND<0.5	0.98	0.87	ND<0.5	ND<0.5	ND<0.5	ND<0.5	3.0	ND<0.5	7.1	11	ND<0.5	i	
	12/12/2005		30.39	9.11	ND<0.5	1.5	0.75	ND<0.5	ND<0.5	ND<0.5	3.7	ND<0.5	ND<0.5	7.0	12	ND<0.5	i	
	3/13/2006		32.15	7.35	ND<0.5	ND<0.5	ND<0.5	ND<0.5	ND<0.5	ND<0.5	6.1	ND<0.5	ND<0.5	6.8	5.2	ND<0.5	i	
	6/19/2006		22.99	16.51	ND<0.5	ND<0.5	ND<0.5	ND<0.5	ND<0.5	ND<0.5	7.0	ND<0.5	ND<0.5	7.8	6.2	ND<0.5		
	9/20/2006		30.32	9.18	ND<0.5	ND<0.5	ND<0.5	ND<0.5	ND<0.5	ND<0.5	9.9	ND<0.5	ND<0.5	11	10	ND<0.5	i	
	12/20/2006		31.60	7.90	ND<0.5	2.5	ND<0.5	ND<0.5	ND<0.5	ND<0.5	9.9	ND<0.5	ND<0.5	7.7	7.8	ND<0.5		
	3/29/2007		24.63	14.87	ND<0.5	1.6	ND<0.5	ND<0.5	ND<0.5	ND<0.5	9.0	ND<0.5	ND<0.5	9.7	8.7	ND<0.5		
	6/11/2007		26.39	13.11	ND<0.5	ND<0.5	ND<0.5	ND<0.5	ND<0.5	ND<0.5	8.5	ND<0.5	ND<0.5	8.0	6.5	ND<0.5	i	
	9/7/2007		28.42	11.08	ND<0.5	ND<0.5	ND<0.5	ND<0.5	ND<0.5	ND<0.5	9.8	ND<0.5	ND<0.5	8.6	7.0	ND<0.5		
	12/12/2007		30.60	8.90	ND<0.5	ND<0.5	ND<0.5	ND<0.5	ND<0.5	ND<0.5	11	ND<0.5	ND<0.5	7.2	7.5	ND<0.5		
3/7/2008		32.48	7.02	ND<0.5	ND<0.5	ND<0.5	ND<0.5	ND<0.5	ND<0.5	7.5	ND<0.5	ND<0.5	8.8	5.6	ND<0.5			
6/9/2008		30.50	9.00	ND<0.5	ND<0.5	ND<0.5	ND<0.5	ND<0.5	ND<0.5	11	ND<0.5	ND<0.5	8.9	5.3	ND<0.5	i		

TABLE 3

**MONITORING WELL GROUNDWATER ANALYTICAL RESULTS: HALOGENATED VOLATILE ORGANIC COMPOUNDS
JOHN NADY
1137-1167 65TH STREET, OAKLAND, CA**

Well ID (TOC)	Date Sampled	Groundwater Zone	Groundwater Elevation (ft amsl)	Depth to Water (ft, TOC)	Chloro- benzene (µg/L)	Chloro- ethane (µg/L)	Chloroform (µg/L)	1,1,2,2,-Tetra- chloroethane (µg/L)	(PCE) Tetrachloroethene (µg/L)	(TCE) Trichloroethene (µg/L)	1,2- Dichlorobenzene (µg/L)	cis-1,2- Dichloroethene (µg/L)	trans-1,2- Dichloroethene (µg/L)	1,1- Dichloroethane (µg/L)	(1,2-DCA) 1,2-Dichloroethane (µg/L)	Vinyl Chloride (µg/L)	Notes		
MW-1B cont.	9/5/2008		30.11	9.39	ND<0.5	ND<0.5	ND<0.5	ND<0.5	ND<0.5	ND<0.5	ND<0.5	13	ND<0.5	8.1	6.7	ND<0.5			
	12/18/2008		30.34	9.16	ND<0.5	1.2	ND<0.5	ND<0.5	ND<0.5	ND<0.5	ND<0.5	16	ND<0.5	8.2	9.3	ND<0.5	i		
	3/30/2009		32.09	7.41	ND<0.5	ND<0.5	ND<0.5	ND<0.5	ND<0.5	ND<0.5	ND<0.5	10	ND<0.5	10	5.8	ND<0.5			
MW-4B 38.54	6/3/2004	Zone B	33.52	5.02	--	ND<0.5	ND<0.5	ND<0.5	ND<0.5	ND<0.5	ND<0.5	ND<0.5	ND<0.5	ND<0.5	ND<0.5	ND<0.5	ND<0.5		
	11/23/2004		34.65	3.89	ND<0.5	ND<0.5	ND<0.5	ND<0.5	ND<0.5	ND<0.5	ND<0.5	ND<0.5	ND<0.5	ND<0.5	ND<0.5	ND<0.5	ND<0.5		
	3/14/2005		34.78	3.76	--	--	--	--	--	--	--	--	--	--	--	--	--	--	
	3/15/2005		--	--	ND<0.5	ND<0.5	ND<0.5	ND<0.5	ND<0.5	ND<0.5	ND<0.5	ND<0.5	ND<0.5	ND<0.5	ND<0.5	ND<0.5	ND<0.5	ND<0.5	i
	6/15/2005		33.98	4.56	--	--	--	--	--	--	--	--	--	--	--	--	--	--	
	6/16/2005		--	--	ND<0.5	ND<0.5	ND<0.5	ND<0.5	ND<0.5	ND<0.5	ND<0.5	ND<0.5	ND<0.5	ND<0.5	ND<0.5	ND<0.5	ND<0.5	ND<0.5	i
	9/19/2005		32.57	5.97	--	--	--	--	--	--	--	--	--	--	--	--	--	--	
	9/20/2005		--	--	ND<0.5	ND<0.5	ND<0.5	ND<0.5	ND<0.5	ND<0.5	ND<0.5	ND<0.5	ND<0.5	ND<0.5	ND<0.5	ND<0.5	ND<0.5	ND<0.5	i
	12/12/2005		33.65	4.89	--	--	--	--	--	--	--	--	--	--	--	--	--	--	
	12/13/2005		--	--	ND<0.5	ND<0.5	ND<0.5	ND<0.5	ND<0.5	ND<0.5	ND<0.5	ND<0.5	ND<0.5	ND<0.5	ND<0.5	ND<0.5	ND<0.5	ND<0.5	i
	3/13/2006		34.61	3.93	--	--	--	--	--	--	--	--	--	--	--	--	--	--	
	6/19/2006		33.86	4.68	--	--	--	--	--	--	--	--	--	--	--	--	--	--	
	9/20/2006		32.58	5.96	--	--	--	--	--	--	--	--	--	--	--	--	--	--	
	12/20/2006		33.92	4.62	--	--	--	--	--	--	--	--	--	--	--	--	--	--	
	3/29/2007		33.96	4.58	--	--	--	--	--	--	--	--	--	--	--	--	--	--	
	6/11/2007		34.03	4.51	--	--	--	--	--	--	--	--	--	--	--	--	--	--	
	9/7/2007		33.22	5.32	--	--	--	--	--	--	--	--	--	--	--	--	--	--	i
	12/12/2007		33.85	4.69	--	--	--	--	--	--	--	--	--	--	--	--	--	--	
	3/7/2008		34.58	3.96	--	--	--	--	--	--	--	--	--	--	--	--	--	--	
	6/9/2008		33.45	5.09	--	--	--	--	--	--	--	--	--	--	--	--	--	--	
9/5/2008	32.64	5.90	--	--	--	--	--	--	--	--	--	--	--	--	--	--			
12/18/2008	33.39	5.15	--	--	--	--	--	--	--	--	--	--	--	--	--	--			
3/30/2009	34.33	4.21	--	--	--	--	--	--	--	--	--	--	--	--	--	--			
MW-5B 38.98	6/3/2004	Zone B	30.16	8.82	--	ND<0.5	ND<0.5	ND<0.5	ND<0.5	ND<0.5	ND<0.5	ND<0.5	ND<0.5	ND<0.5	ND<0.5	ND<0.5	ND<0.5		
	11/23/2004		31.32	7.66	ND<0.5	ND<0.5	ND<0.5	ND<0.5	ND<0.5	ND<0.5	ND<0.5	ND<0.5	ND<0.5	ND<0.5	ND<0.5	ND<0.5	ND<0.5	ND<0.5	
	3/14/2005		32.71	6.27	--	--	--	--	--	--	--	--	--	--	--	--	--	--	
	3/15/2005		--	--	ND<0.5	ND<0.5	ND<0.5	ND<0.5	ND<0.5	ND<0.5	ND<0.5	ND<0.5	ND<0.5	ND<0.5	ND<0.5	ND<0.5	ND<0.5	ND<0.5	i
	6/15/2005		31.20	7.78	ND<0.5	ND<0.5	ND<0.5	ND<0.5	ND<0.5	ND<0.5	ND<0.5	ND<0.5	ND<0.5	ND<0.5	ND<0.5	ND<0.5	ND<0.5	ND<0.5	i
	9/19/2005		28.68	10.30	--	--	--	--	--	--	--	--	--	--	--	--	--	--	
	9/20/2005		--	--	ND<0.5	ND<0.5	ND<0.5	ND<0.5	ND<0.5	ND<0.5	ND<0.5	ND<0.5	ND<0.5	ND<0.5	ND<0.5	ND<0.5	ND<0.5	ND<0.5	
	12/12/2005		30.65	8.33	ND<0.5	ND<0.5	ND<0.5	ND<0.5	ND<0.5	ND<0.5	ND<0.5	ND<0.5	ND<0.5	ND<0.5	ND<0.5	ND<0.5	ND<0.5	ND<0.5	i
	3/13/2006		32.87	6.11	--	--	--	--	--	--	--	--	--	--	--	--	--	--	
	6/19/2006		30.97	8.01	--	--	--	--	--	--	--	--	--	--	--	--	--	--	
	9/20/2006		29.68	9.30	--	--	--	--	--	--	--	--	--	--	--	--	--	--	
	12/20/2006		31.21	7.77	--	--	--	--	--	--	--	--	--	--	--	--	--	--	
	3/29/2007		31.40	7.58	--	--	--	--	--	--	--	--	--	--	--	--	--	--	
	6/11/2007		31.02	7.96	--	--	--	--	--	--	--	--	--	--	--	--	--	--	
	9/7/2007		30.02	8.96	--	--	--	--	--	--	--	--	--	--	--	--	--	--	
	12/12/2007		30.88	8.10	--	--	--	--	--	--	--	--	--	--	--	--	--	--	
	3/7/2008		32.55	6.43	--	--	--	--	--	--	--	--	--	--	--	--	--	--	
	6/9/2008		30.34	8.64	--	--	--	--	--	--	--	--	--	--	--	--	--	--	
	9/5/2008		29.50	9.48	--	--	--	--	--	--	--	--	--	--	--	--	--	--	
	12/18/2008		30.34	8.64	--	--	--	--	--	--	--	--	--	--	--	--	--	--	
3/30/2009	32.10	6.88	--	--	--	--	--	--	--	--	--	--	--	--	--	--			

TABLE 3

MONITORING WELL GROUNDWATER ANALYTICAL RESULTS: HALOGENATED VOLATILE ORGANIC COMPOUNDS
JOHN NADY
1137-1167 65TH STREET, OAKLAND, CA

Well ID (TOC)	Date Sampled	Groundwater Zone	Groundwater Elevation (ft amsl)	Depth to Water (ft, TOC)	Chloro- benzene (µg/L)	Chloro- ethane (µg/L)	Chloroform (µg/L)	1,1,2,2,-Tetra- chloroethane (µg/L)	(PCE) Tetrachloroethene (µg/L)	(TCE) Trichloroethene (µg/L)	1,2- Dichlorobenzene (µg/L)	cis-1,2- Dichloroethene (µg/L)	trans-1,2- Dichloroethene (µg/L)	1,1- Dichloroethane (µg/L)	(1,2-DCA) 1,2-Dichloroethane (µg/L)	Vinyl Chloride (µg/L)	Notes		
MW-6B 37.66	6/3/2004	Zone B	29.36	8.30	--	0.65	ND<0.5	ND<0.5	ND<0.5	ND<0.5	ND<0.5	ND<0.5	ND<0.5	ND<0.5	ND<0.5	ND<0.5			
	11/23/2004		30.53	7.13	ND<0.5	ND<0.5	ND<0.5	ND<0.5	ND<0.5	ND<0.5	ND<0.5	ND<0.5	ND<0.5	ND<0.5	0.89	ND<0.5	ND<0.5		
	3/14/2005		31.86	5.80	ND<0.5	ND<0.5	ND<0.5	ND<0.5	ND<0.5	ND<0.5	ND<0.5	1.1	ND<0.5	ND<0.5	ND<0.5	ND<0.5	3.5	i	
	6/15/2005		30.17	7.49	ND<0.5	ND<0.5	ND<0.5	ND<0.5	ND<0.5	ND<0.5	ND<0.5	1.4	ND<0.5	ND<0.5	0.66	ND<0.5	0.55		
	9/19/2005		28.83	8.83	ND<0.5	1.4	ND<0.5	ND<0.5	ND<0.5	ND<0.5	ND<0.5	1.0	ND<0.5	ND<0.5	1.1	ND<0.5	1.1		
	12/12/2005		29.85	7.81	ND<0.5	2.3	ND<0.5	11	ND<0.5	ND<0.5	ND<0.5	ND<0.5	1.3	ND<0.5	1.3	ND<0.5	ND<0.5	h,i	
	3/13/2006		32.31	5.35	ND<0.5	0.73	ND<0.5	ND<0.5	ND<0.5	ND<0.5	ND<0.5	ND<0.5	ND<0.5	ND<0.5	ND<0.5	ND<0.5	ND<0.5	h	
	6/19/2006		29.88	7.78	ND<0.5	0.91	ND<0.5	ND<0.5	ND<0.5	ND<0.5	ND<0.5	ND<0.5	ND<0.5	ND<0.5	0.52	ND<0.5	ND<0.5	h	
	9/20/2006		28.78	8.88	ND<5.0	ND<5.0	ND<5.0	ND<5.0	ND<5.0	ND<5.0	ND<5.0	ND<5.0	ND<5.0	ND<5.0	ND<5.0	ND<5.0	ND<5.0	ND<5.0	h,i
	12/20/2006		30.34	7.32	ND<0.5	2.5	ND<0.5	ND<0.5	ND<0.5	ND<0.5	ND<0.5	ND<0.5	1.2	ND<0.5	0.69	ND<0.5	ND<0.5	h	
	3/29/2007		30.44	7.22	ND<0.5	1.5	ND<0.5	ND<0.5	ND<0.5	ND<0.5	ND<0.5	ND<0.5	ND<0.5	ND<0.5	0.76	ND<0.5	ND<0.5		
	6/11/2007		29.93	7.73	ND<5.0	ND<5.0	ND<5.0	ND<5.0	ND<5.0	ND<5.0	ND<5.0	ND<5.0	ND<5.0	ND<5.0	ND<5.0	ND<5.0	ND<5.0	ND<5.0	h
	9/7/2007		28.95	8.71	ND<0.5	1.3	ND<0.5	ND<0.5	ND<0.5	ND<0.5	ND<0.5	ND<0.5	1.9	ND<0.5	0.66	ND<0.5	ND<0.5	ND<0.5	h
	12/12/2007		30.00	7.66	ND<0.5	0.77	ND<0.5	ND<0.5	ND<0.5	ND<0.5	ND<0.5	ND<0.5	1.4	ND<0.5	0.62	ND<0.5	ND<0.5	ND<0.5	h
	3/7/2008		31.70	5.96	ND<0.5	1.1	ND<0.5	16	ND<0.5	ND<0.5	ND<0.5	1.2	1.0	ND<0.5	0.58	ND<0.5	ND<0.5	ND<0.5	h
	6/9/2008		29.36	8.30	ND<1.0	1.8	ND<1.0	ND<1.0	ND<1.0	ND<1.0	ND<1.0	ND<1.0	2.5	ND<1.0	ND<1.0	ND<1.0	ND<1.0	ND<1.0	h
	9/5/2008		28.66	9.00	ND<5.0	0.80	ND<0.5	ND<0.5	ND<0.5	ND<0.5	ND<0.5	ND<0.5	2.1	ND<0.5	ND<0.5	ND<0.5	ND<0.5	ND<0.5	h
	12/18/2008		29.68	7.98	ND<5.0	ND<5.0	ND<5.0	ND<5.0	ND<5.0	ND<5.0	ND<5.0	ND<5.0	ND<5.0	ND<5.0	ND<5.0	ND<5.0	ND<5.0	ND<5.0	b,h
3/30/2009	31.31	6.35	ND<0.5	0.96	ND<0.5	ND<0.5	ND<0.5	ND<0.5	ND<0.5	ND<0.5	0.80	ND<0.5	ND<0.5	ND<0.5	ND<0.5	ND<0.5	h		
MW-1C 39.49	6/3/2004	Zone C	30.07	9.42	--	ND<0.5	0.57	ND<0.5	ND<0.5	ND<0.5	ND<0.5	ND<0.5	ND<0.5	ND<0.5	ND<0.5	ND<0.5			
	11/23/2004		31.30	8.19	ND<0.5	ND<0.5	0.56	ND<0.5	ND<0.5	ND<0.5	ND<0.5	ND<0.5	ND<0.5	ND<0.5	ND<0.5	ND<0.5	ND<0.5		
	3/14/2005		32.58	6.91	ND<0.5	ND<0.5	ND<0.5	ND<0.5	ND<0.5	ND<0.5	ND<0.5	ND<0.5	ND<0.5	ND<0.5	ND<0.5	ND<0.5	ND<0.5	i	
	6/15/2005		30.89	8.60	ND<0.5	ND<0.5	ND<0.5	ND<0.5	ND<0.5	ND<0.5	ND<0.5	ND<0.5	ND<0.5	ND<0.5	ND<0.5	ND<0.5	ND<0.5		
	9/19/2005		29.19	10.30	ND<0.5	ND<0.5	ND<0.5	ND<0.5	ND<0.5	ND<0.5	ND<0.5	ND<0.5	ND<0.5	ND<0.5	ND<0.5	ND<0.5	ND<0.5	i	
	12/12/2005		30.54	8.95	ND<0.5	ND<0.5	ND<0.5	ND<0.5	ND<0.5	ND<0.5	ND<0.5	ND<0.5	ND<0.5	ND<0.5	ND<0.5	ND<0.5	ND<0.5	i	
	3/13/2006		32.99	6.50	--	--	--	--	--	--	--	--	--	--	--	--	--		
	6/19/2006		30.66	8.83	--	--	--	--	--	--	--	--	--	--	--	--	--		
	9/20/2006		29.53	9.96	--	--	--	--	--	--	--	--	--	--	--	--	--		
	12/20/2006		31.13	8.36	--	--	--	--	--	--	--	--	--	--	--	--	--		
	3/29/2007		31.19	8.30	--	--	--	--	--	--	--	--	--	--	--	--	--		
	6/11/2007		30.63	8.86	--	--	--	--	--	--	--	--	--	--	--	--	--		
	9/7/2007		29.60	9.89	--	--	--	--	--	--	--	--	--	--	--	--	--		
	12/12/2007		30.61	8.88	--	--	--	--	--	--	--	--	--	--	--	--	--		
	3/7/2008		32.46	7.03	--	--	--	--	--	--	--	--	--	--	--	--	--		
	6/9/2008		30.07	9.42	--	--	--	--	--	--	--	--	--	--	--	--	--		
	9/5/2008		29.34	10.15	--	--	--	--	--	--	--	--	--	--	--	--	--		
	12/18/2008		30.28	9.21	--	--	--	--	--	--	--	--	--	--	--	--	--		
3/30/2009	32.12	7.37	--	--	--	--	--	--	--	--	--	--	--	--	--				
MW-4C 38.50	6/3/2004	Zone C	30.10	8.40	--	ND<0.5	0.84	ND<0.5	ND<0.5	ND<0.5	ND<0.5	ND<0.5	ND<0.5	ND<0.5	ND<0.5	ND<0.5			
	11/23/2004		31.31	7.19	ND<0.5	ND<0.5	ND<0.5	ND<0.5	ND<0.5	ND<0.5	ND<0.5	ND<0.5	ND<0.5	ND<0.5	ND<0.5	ND<0.5	ND<0.5		
	3/14/2005		33.15	5.35	--	--	--	--	--	--	--	--	--	--	--	--	--		
	3/15/2005		--	--	ND<0.5	ND<0.5	ND<0.5	ND<0.5	ND<0.5	ND<0.5	ND<0.5	ND<0.5	ND<0.5	ND<0.5	ND<0.5	ND<0.5	ND<0.5	i	
	6/15/2005		30.85	7.65	--	--	--	--	--	--	--	--	--	--	--	--	--		
	6/16/2005		--	--	ND<0.5	ND<0.5	ND<0.5	ND<0.5	ND<0.5	ND<0.5	ND<0.5	ND<0.5	ND<0.5	ND<0.5	ND<0.5	ND<0.5	ND<0.5		
	9/19/2005		25.97	12.53	--	--	--	--	--	--	--	--	--	--	--	--	--		
	9/20/2005		--	--	ND<0.5	ND<0.5	ND<0.5	ND<0.5	ND<0.5	ND<0.5	ND<0.5	ND<0.5	ND<0.5	ND<0.5	ND<0.5	ND<0.5	ND<0.5		
	12/12/2005		30.00	8.50	--	--	--	--	--	--	--	--	--	--	--	--	--		
	12/13/2005		--	--	ND<0.5	ND<0.5	ND<0.5	ND<0.5	ND<0.5	ND<0.5	ND<0.5	ND<0.5	ND<0.5	ND<0.5	ND<0.5	ND<0.5	ND<0.5	ND<0.5	i

TABLE 3

**MONITORING WELL GROUNDWATER ANALYTICAL RESULTS: HALOGENATED VOLATILE ORGANIC COMPOUNDS
JOHN NADY
1137-1167 65TH STREET, OAKLAND, CA**

Well ID (TOC)	Date Sampled	Groundwater Zone	Groundwater Elevation (ft amsl)	Depth to Water (ft, TOC)	Chloro- benzene (µg/L)	Chloro- ethane (µg/L)	Chloroform (µg/L)	1,1,2,2-Tetra- chloroethane (µg/L)	(PCE) Tetrachloroethene (µg/L)	(TCE) Trichloroethene (µg/L)	1,2- Dichlorobenzene (µg/L)	cis-1,2- Dichloroethene (µg/L)	trans-1,2- Dichloroethene (µg/L)	1,1- Dichloroethane (µg/L)	(1,2-DCA) 1,2-Dichloroethane (µg/L)	Vinyl Chloride (µg/L)	Notes
MW-4C	3/13/2006		31.18	7.32	--	--	--	--	--	--	--	--	--	--	--	--	
cont.	6/19/2006		30.90	7.60	--	--	--	--	--	--	--	--	--	--	--	--	
	9/20/2006		29.91	8.59	--	--	--	--	--	--	--	--	--	--	--	--	
	12/20/2006		31.21	7.29	--	--	--	--	--	--	--	--	--	--	--	--	
	3/29/2007		31.29	7.21	--	--	--	--	--	--	--	--	--	--	--	--	
	6/11/2007		30.93	7.57	--	--	--	--	--	--	--	--	--	--	--	--	
	9/7/2007		30.20	8.30	--	--	--	--	--	--	--	--	--	--	--	--	
	12/12/2007		31.10	7.40	--	--	--	--	--	--	--	--	--	--	--	--	
	3/7/2008		32.25	6.25	--	--	--	--	--	--	--	--	--	--	--	--	
	6/9/2008		30.35	8.15	--	--	--	--	--	--	--	--	--	--	--	--	
	9/5/2008		29.62	8.88	--	--	--	--	--	--	--	--	--	--	--	--	
	12/18/2008		30.31	8.19	--	--	--	--	--	--	--	--	--	--	--	--	
	3/30/2009		31.59	6.91	--	--	--	--	--	--	--	--	--	--	--	--	
MW-6C	6/3/2004	Zone C	27.89	9.70	--	ND<0.5	ND<0.5	ND<0.5	ND<0.5	ND<0.5	ND<0.5	2.8	ND<0.5	0.61	ND<0.5	ND<0.5	
37.59	11/23/2004		29.21	8.38	ND<0.5	ND<0.5	ND<0.5	ND<0.5	ND<0.5	ND<0.5	ND<0.5	ND<0.5	ND<0.5	ND<0.5	ND<0.5	ND<0.5	
	3/14/2005		31.79	5.80	ND<0.5	ND<0.5	ND<0.5	ND<0.5	1.8	1.9	ND<0.5	12	ND<0.5	1.1	ND<0.5	2.3	
	6/15/2005		30.14	7.45	ND<0.5	ND<0.5	ND<0.5	ND<0.5	3.1	3.1	ND<0.5	20	0.64	1.4	ND<0.5	5.7	
	9/19/2005		28.79	8.80	ND<0.5	ND<0.5	ND<0.5	ND<0.5	2.9	3.0	ND<0.5	18	0.57	1.3	ND<0.5	6.8	
	12/12/2005		29.81	7.78	ND<0.5	0.66	ND<0.5	ND<0.5	3.2	3.0	ND<0.5	19	0.61	1.4	ND<0.5	10	
	3/13/2006		32.09	5.50	ND<0.5	ND<0.5	ND<0.5	ND<0.5	3.2	3.9	ND<0.5	26	0.61	0.95	ND<0.5	5.1	
	6/19/2006		29.84	7.75	ND<0.5	ND<0.5	ND<0.5	ND<0.5	4.0	3.4	ND<0.5	32	0.78	0.96	ND<0.5	11	
	9/20/2006		28.74	8.85	ND<0.5	ND<0.5	ND<0.5	ND<0.5	3.7	4.6	ND<0.5	23	0.76	1.0	ND<0.5	9.4	i
	12/20/2006		30.29	7.30	ND<0.5	ND<0.5	ND<0.5	ND<0.5	4.1	4.6	ND<0.5	36	0.88	0.92	ND<0.5	13	
	3/29/2007		30.39	7.20	ND<0.5	ND<0.5	ND<0.5	ND<0.5	6.0	6.4	ND<0.5	35	1.2	1.1	ND<0.5	5.3	
	6/11/2007		29.86	7.73	ND<0.5	ND<0.5	ND<0.5	ND<0.5	6.1	6.4	ND<0.5	26	0.99	0.85	ND<0.5	4.0	
	9/7/2007		28.92	8.67	ND<0.5	ND<0.5	ND<0.5	ND<0.5	7.0	6.9	ND<0.5	32	0.99	0.90	ND<0.5	4.2	
	12/12/2007		29.94	7.65	ND<0.5	ND<0.5	ND<0.5	ND<0.5	5.0	5.2	ND<0.5	29	0.84	0.87	ND<0.5	3.8	
	3/7/2008		31.63	5.96	ND<0.5	ND<0.5	ND<0.5	ND<0.5	5.1	5.5	ND<0.5	28	0.90	0.78	ND<0.5	3.2	
	6/9/2008		29.32	8.27	ND<0.5	ND<0.5	ND<0.5	ND<0.5	4.5	5.5	ND<0.5	23	0.72	0.71	ND<0.5	3.5	
	9/5/2008		28.60	8.99	ND<0.5	ND<0.5	ND<0.5	ND<0.5	3.3	4.2	ND<0.5	ND<0.5	ND<0.5	0.57	ND<0.5	1.2	
	12/18/2008		29.64	7.95	ND<0.5	ND<0.5	ND<0.5	ND<0.5	3.7	4.1	ND<0.5	18	ND<0.5	0.58	ND<0.5	2.8	
	3/30/2009		31.26	6.33	ND<0.5	ND<0.5	ND<0.5	ND<0.5	4.6	5.0	ND<0.5	22	0.58	0.57	ND<0.5	3.5	

Abbreviations:

µg/L = micrograms per liter; equivalent to parts per billion

ft = measured in feet

ft amsl = measured in feet above mean sea level

TOC = Top of casing elevation in feet above mean sea level (msl)

Halogenated Volatile Organic Compounds analyzed by EPA Method SW8260B, reported EPA Method 8010 basic target list.

ND<0.5 = Not Detected above detection limit cited.

-- = Not available, not applicable, not analyzed, not measured

Notes:

b = sample diluted due to high organic content

i = liquid sample that contains greater than ~1 vol. % sediment

h = lighter than water immiscible sheen/product is present

j = sample diluted due to high organic content/matrix interference

APPENDIX A

STANDARD FIELD PROCEDURES FOR
GROUNDWATER MONITORING AND SAMPLING

Conestoga–Rovers & Associates

STANDARD FIELD PROCEDURES FOR GROUNDWATER MONITORING AND SAMPLING

This document presents standard field methods for groundwater monitoring, purging and sampling, and well development. These procedures are designed to comply with Federal, State and local regulatory guidelines. Cambria's specific field procedures are summarized below.

Groundwater Elevation Monitoring

Prior to performing monitoring activities, the historical monitoring and analytical data of each monitoring well shall be reviewed to determine if any of the wells are likely to contain non-aqueous phase liquid (NAPL) and to determine the order in which the wells will be monitored (i.e. cleanest to dirtiest). Groundwater monitoring should not be performed when the potential exists for surface water to enter the well (i.e. flooding during a rainstorm).

Prior to monitoring, each well shall be opened and the well cap removed to allow water levels to stabilize and equilibrate. The condition of the well box and well cap shall be observed and recommended repairs noted. Any surface water that may have entered and flooded the well box should be evacuated prior to removing the well cap. In wells with no history of NAPL, the static water level and total well depth shall be measured to the nearest 0.01 foot with an electronic water level meter. Wells with the highest contaminant concentrations shall be measured last. In wells with a history of NAPL, the NAPL level/thickness and static water level shall be measured to the nearest 0.01 foot using an electronic interface probe. The water level meter and/or interface probe shall be thoroughly cleaned and decontaminated at the beginning of the monitoring event and between each well. Monitoring equipment shall be washed using soapy water consisting of Liqui-nox™ or Alconox™ followed by one rinse of clean tap water and then two rinses of distilled water.

Groundwater Purging and Sampling

Prior to groundwater purging and sampling, the historical analytical data of each monitoring well shall be reviewed to determine the order in which the wells should be purged and sampled (i.e. cleanest to dirtiest). No purging or groundwater sampling shall be performed on wells with a measurable thickness of NAPL or floating NAPL globules. If a sheen is observed, the well should be purged and a groundwater sample collected only if no NAPL is present. Wells shall be purged either by hand using a disposal or PVC bailer or by using an aboveground pump (e.g. peristaltic or Wattera™) or down-hole pump (e.g. Grundfos™ or DC Purger pump).

Groundwater wells shall be purged approximately three to ten well-casing volumes (depending on the regulatory agency requirements) or until groundwater parameters of temperature, pH, and conductivity have stabilized to within 10% for three consecutive readings. Temperature, pH, and conductivity shall be measured and recorded at least once per well casing volume removed. The total volume of groundwater removed shall be recorded along with any other notable physical characteristic such as color and odor. If required, field parameters such as turbidity, dissolved oxygen (DO), and oxidation-reduction potential (ORP) shall also be measured prior to collection of each groundwater sample.

Groundwater samples shall be collected after the well has been purged. If the well is slow to recharge, a sample shall be collected after the water column is allowed to recharge to 80% of the pre-purging static water level. If the well does not recover to 80% in 2 hours, a sample shall be collected once there is enough groundwater in the well. Groundwater samples shall be collected using clean disposable bailers or pumps (if an operating remediation system exists on site and the project manager approves of its use for sampling) and shall be decanted into clean containers supplied by the analytical laboratory. New latex gloves and disposable tubing or bailers shall be

Conestoga–Rovers & Associates

used for sampling each well. If a PVC bailer or down-hole pump is used for groundwater purging, it shall be decontaminated before purging each well by using soapy water consisting of Liqui-nox™ or Alconox™ followed by one rinse of clean tap water and then two rinses of distilled water. If a submersible pump with non-dedicated discharge tubing is used for groundwater purging, both the inside and outside of pump and discharge tubing shall be decontaminated as described above.

Sample Handling

Except for samples that will be tested in the field, or that require special handling or preservation, samples shall be stored in coolers chilled to 4° C for shipment to the analytical laboratory. Samples shall be labeled, placed in protective foam sleeves or bubble wrap as needed, stored on crushed ice at or below 4° C, and submitted under chain-of-custody (COC) to the laboratory. The laboratory shall be notified of the sample shipment schedule and arrival time. Samples shall be shipped to the laboratory within a time frame to allow for extraction and analysis to be performed within the standard sample holding times.

Sample labels shall be filled out using indelible ink and must contain the site name; field identification number; the date, time, and location of sample collection; notation of the type of sample; identification of preservatives used; remarks; and the signature of the sampler. Field identification must be sufficient to allow easy cross-reference with the field datasheet.

All samples submitted to the laboratory shall be accompanied by a COC record to ensure adequate documentation. A copy of the COC shall be retained in the project file. Information on the COC shall consist of the project name and number; project location; sample numbers; sampler/recorder's signature; date and time of collection of each sample; sample type; analyses requested; name of person receiving the sample; and date of receipt of sample.

Laboratory-supplied trip blanks shall accompany the samples and be analyzed to check for cross-contamination, if requested by the project manager.

Waste Handling and Disposal

Groundwater extracted during sampling shall be stored onsite in sealed U.S. DOT H17 55-gallon drums and shall be labeled with the contents, date of generation, generator identification, and consultant contact. Extracted groundwater may be disposed offsite by a licensed waste handler or may be treated and discharged via an operating onsite groundwater extraction/treatment system.

APPENDIX B

CERTIFIED ANALYTICAL REPORTS AND
CHAIN-OF-CUSTODY DOCUMENTATION



McC Campbell Analytical, Inc.

"When Quality Counts"

1534 Willow Pass Road, Pittsburg, CA 94565-1701
Web: www.mcccampbell.com E-mail: main@mcccampbell.com
Telephone: 877-252-9262 Fax: 925-252-9269

Conestoga-Rovers & Associates 5900 Hollis St, Suite A Emeryville, CA 94608	Client Project ID: #521000; John Nady	Date Sampled: 03/30/09
		Date Received: 03/30/09
	Client Contact: Mark Jonas	Date Reported: 04/06/09
	Client P.O.:	Date Completed: 04/06/09

WorkOrder: 0903743

April 06, 2009

Dear Mark:

Enclosed within are:

- 1) The results of the **9** analyzed samples from your project: **#521000; John Nady,**
- 2) A QC report for the above samples,
- 3) A copy of the chain of custody, and
- 4) An invoice for analytical services.

All analyses were completed satisfactorily and all QC samples were found to be within our control limits.

If you have any questions or concerns, please feel free to give me a call. Thank you for choosing

McC Campbell Analytical Laboratories for your analytical needs.

Best regards,

Angela Rydelius
Laboratory Manager
McC Campbell Analytical, Inc.



McCAMPBELL ANALYTICAL, INC.

1534 WILLOW PASS ROAD
PITTSBURG, CA 94565-1701

Website: www.mccampbell.com Email: main@mccampbell.com
Telephone: (877) 252-9262 Fax: (925) 252-9269

0903743

CHAIN OF CUSTODY RECORD

TURN AROUND TIME

RUSH 24 HR 48 HR 72 HR 5 DAY

GeoTracker EDF PDF Excel Write On (DW)
 Check if sample is effluent and "J" flag is required

Report To: Mark Jonas Bill To: Conestoga-Rovers & Associates
Company: Conestoga-Rovers & Associates
5900 Hollis St., Ste A
Emeryville, CA E-Mail: mjonas@crworld.com
mweiner@crworld.com
Tele: (510) 420-3307 Fax: (510) 420-9170
Project #: 521000 Project Name: John Nady
Project Location: 137-1167 65th St. Oakland, CA
Sampler Signature: Muskan Environmental Sampling

Analysis Request

Other

Comments

SAMPLE ID	LOCATION/ Field Point Name	SAMPLING		# Containers	Type Containers	MATRIX					METHOD PRESERVED				BTEX & TPH as Gas (602 / 8021 + 8015) / MTBE TPH as Diesel (8015) / mo with silica selected Total Petroleum Oil & Grease (1664 / 5520 EPA&F) Total Petroleum Hydrocarbons (418.1) EPA 502.2 / 601 / 8010 / 8021 (HVOCs) MTBE / BTEX ONLY (EPA 602 / 8021) EPA 505 / 608 / 8081 (CI Pesticides) EPA 608 / 8082 PCB's ONLY; Arachnols / Congeners EPA 507 / 8141 (NP Pesticides) EPA 515 / 8151 (Acidic CI Herbicides) EPA 524.2 / 624 / 8260 (VOCs) EPA 525.2 / 625 / 8270 (SVOCs) EPA 8270 SIM / 8310 (PAHs / PNAS) CAM 17 Metals (200.7 / 200.8 / 6010 / 6020) LUFT 5 Metals (200.7 / 200.8 / 6010 / 6020) Lead (200.7 / 200.8 / 6010 / 6020)	EPA 505 / 608 / 8081 (CI Pesticides)	EPA 608 / 8082 PCB's ONLY; Arachnols / Congeners	EPA 507 / 8141 (NP Pesticides)	EPA 515 / 8151 (Acidic CI Herbicides)	EPA 524.2 / 624 / 8260 (VOCs)	EPA 525.2 / 625 / 8270 (SVOCs)	EPA 8270 SIM / 8310 (PAHs / PNAS)	CAM 17 Metals (200.7 / 200.8 / 6010 / 6020)	LUFT 5 Metals (200.7 / 200.8 / 6010 / 6020)	Lead (200.7 / 200.8 / 6010 / 6020)	TAP/SS and BTEX 8015/8021 HVOCs by 8010	Filter Samples for Metals analysis: Yes / No
		Date	Time			Water	Soil	Air	Sludge	Other	ICE	HCL	HNO ₃	Other													
+ MW-1A		3-30-09	12:00	2	Geo Pmb													X	X								
+ MW-1B			11:35																X								
+ MW-2A			1:00															X	X								
+ MW-3A			1:25															X	X								
+ MW-4A			12:30															X	X								
+ MW-6A			11:05															X	X								
+ MW-6B			10:35															X	X								
+ MW-6C			10:05															X	X								
+ MW-7A			9:10															X	X								

Relinquished By: [Signature] Date: 3-30-09 Time: 1550 Received By: [Signature]
Relinquished By: _____ Date: _____ Time: _____ Received By: _____
Relinquished By: _____ Date: _____ Time: _____ Received By: _____

ICE/° yes wa of
GOOD CONDITION
HEAD SPACE ABSENT
DECHLORINATED IN LAB
APPROPRIATE CONTAINERS
PRESERVED IN LAB [Signature]
COMMENTS:
VOAS O&G METALS OTHER
PRESERVATION pH<2

McC Campbell Analytical, Inc.



1534 Willow Pass Rd
Pittsburg, CA 94565-1701
(925) 252-9262

CHAIN-OF-CUSTODY RECORD

WorkOrder: 0903743

ClientCode: CETE

WriteOn
 EDF
 Excel
 Fax
 Email
 HardCopy
 ThirdParty
 J-flag

Report to:	Mark Jonas	Email: mjonas@CRAworld.com	Bill to:	Accounts Payable	Requested TAT: 5 days
	Conestoga-Rovers & Associates	cc:		Conestoga-Rovers & Associates	Date Received: 03/30/2009
	5900 Hollis St, Suite A	PO:		5900 Hollis St, Ste. A	Date Printed: 04/01/2009
	Emeryville, CA 94608	ProjectNo: #521000; John Nady		Emeryville, CA 94608	
	(510) 420-3327 FAX (510) 420-9170				

Lab ID	Client ID	Matrix	Collection Date	Hold	Requested Tests (See legend below)											
					1	2	3	4	5	6	7	8	9	10	11	12
0903743-001	MW-1A	Water	3/30/2009 12:00	<input type="checkbox"/>	C	B	A	A								
0903743-002	MW-1B	Water	3/30/2009 11:35	<input type="checkbox"/>	A											
0903743-003	MW-2A	Water	3/30/2009 13:00	<input type="checkbox"/>		B		A								
0903743-004	MW-3A	Water	3/30/2009 13:25	<input type="checkbox"/>	C	B		A								
0903743-005	MW-4A	Water	3/30/2009 12:30	<input type="checkbox"/>		B		A								
0903743-006	MW-6A	Water	3/30/2009 11:05	<input type="checkbox"/>	C	B		A								
0903743-007	MW-6B	Water	3/30/2009 10:35	<input type="checkbox"/>	C	B		A								
0903743-008	MW-6C	Water	3/30/2009 10:05	<input type="checkbox"/>	A											
0903743-009	MW-7A	Water	3/30/2009 9:10	<input type="checkbox"/>	C	B		A								

Test Legend:

1	8010BMS_W	2	G-MBTEX_W	3	PREF REPORT	4	TPH(DMO)WSG_W	5	
6		7		8		9		10	
11		12							

Prepared by: Samantha Arbuckle

Comments:

NOTE: Soil samples are discarded 60 days after results are reported unless other arrangements are made (Water samples are 30 days).
Hazardous samples will be returned to client or disposed of at client expense.



Sample Receipt Checklist

Client Name: **Conestoga-Rovers & Associates**

Date and Time Received: **03/30/09 9:17:44 PM**

Project Name: **#521000; John Nady**

Checklist completed and reviewed by: **Samantha Arbuckle**

WorkOrder N°: **0903743** Matrix Water

Carrier: Client Drop-In

Chain of Custody (COC) Information

- Chain of custody present? Yes No
- Chain of custody signed when relinquished and received? Yes No
- Chain of custody agrees with sample labels? Yes No
- Sample IDs noted by Client on COC? Yes No
- Date and Time of collection noted by Client on COC? Yes No
- Sampler's name noted on COC? Yes No

Sample Receipt Information

- Custody seals intact on shipping container/cooler? Yes No NA
- Shipping container/cooler in good condition? Yes No
- Samples in proper containers/bottles? Yes No
- Sample containers intact? Yes No
- Sufficient sample volume for indicated test? Yes No

Sample Preservation and Hold Time (HT) Information

- All samples received within holding time? Yes No
- Container/Temp Blank temperature Cooler Temp: 6.9°C NA
- Water - VOA vials have zero headspace / no bubbles? Yes No No VOA vials submitted
- Sample labels checked for correct preservation? Yes No
- TTLC Metal - pH acceptable upon receipt (pH<2)? Yes No NA
- Samples Received on Ice? Yes No

(Ice Type: WET ICE)

* NOTE: If the "No" box is checked, see comments below.

Client contacted:

Date contacted:

Contacted by:

Comments:



McC Campbell Analytical, Inc.

"When Quality Counts"

1534 Willow Pass Road, Pittsburg, CA 94565-1701
Web: www.mcccampbell.com E-mail: main@mcccampbell.com
Telephone: 877-252-9262 Fax: 925-252-9269

Conestoga-Rovers & Associates 5900 Hollis St, Suite A Emeryville, CA 94608	Client Project ID: #521000; John Nady	Date Sampled: 03/30/09
		Date Received: 03/30/09
	Client Contact: Mark Jonas	Date Extracted: 04/03/09
	Client P.O.:	Date Analyzed 04/03/09

Halogenated Volatile Organics by P&T and GC-MS (8010 Basic Target List)*

Extraction Method: SW5030B

Analytical Method: SW8260B

Work Order: 0903743

Lab ID	0903743-001C	0903743-002A	0903743-004C	0903743-006C	Reporting Limit for DF =1	
Client ID	MW-1A	MW-1B	MW-3A	MW-6A		
Matrix	W	W	W	W	S	W
DF	1	1	10	1		

Compound	Concentration				µg/kg	µg/L
Bromodichloromethane	ND	ND	ND<5.0	ND	NA	0.5
Bromoform	ND	ND	ND<5.0	ND	NA	0.5
Bromomethane	ND	ND	ND<5.0	ND	NA	0.5
Carbon Tetrachloride	ND	ND	ND<5.0	ND	NA	0.5
Chlorobenzene	ND	ND	85	ND	NA	0.5
Chloroethane	ND	ND	ND<5.0	0.83	NA	0.5
Chloroform	ND	ND	ND<5.0	ND	NA	0.5
Chloromethane	ND	ND	ND<5.0	ND	NA	0.5
Dibromochloromethane	ND	ND	ND<5.0	ND	NA	0.5
1,2-Dibromoethane (EDB)	ND	ND	ND<5.0	ND	NA	0.5
1,2-Dichlorobenzene	ND	ND	ND<5.0	ND	NA	0.5
1,3-Dichlorobenzene	ND	ND	ND<5.0	ND	NA	0.5
1,4-Dichlorobenzene	ND	ND	ND<5.0	ND	NA	0.5
Dichlorodifluoromethane	ND	ND	ND<5.0	ND	NA	0.5
1,1-Dichloroethane	1.5	10	ND<5.0	ND	NA	0.5
1,2-Dichloroethane (1,2-DCA)	ND	5.8	ND<5.0	ND	NA	0.5
1,1-Dichloroethene	ND	ND	ND<5.0	ND	NA	0.5
cis-1,2-Dichloroethene	9.8	10	ND<5.0	ND	NA	0.5
trans-1,2-Dichloroethene	1.1	ND	ND<5.0	ND	NA	0.5
1,2-Dichloropropane	ND	ND	ND<5.0	ND	NA	0.5
cis-1,3-Dichloropropene	ND	ND	ND<5.0	ND	NA	0.5
trans-1,3-Dichloropropene	ND	ND	ND<5.0	ND	NA	0.5
Freon 113	ND	ND	ND<100	ND	NA	10
Methylene chloride	ND	ND	ND<5.0	ND	NA	0.5
1,1,1,2-Tetrachloroethane	ND	ND	ND<5.0	ND	NA	0.5
1,1,1,2,2-Tetrachloroethane	ND	ND	ND<5.0	ND	NA	0.5
Tetrachloroethene	11	ND	ND<5.0	ND	NA	0.5
1,1,1-Trichloroethane	ND	ND	ND<5.0	ND	NA	0.5
1,1,2-Trichloroethane	ND	ND	ND<5.0	ND	NA	0.5
Trichloroethene	10	ND	ND<5.0	ND	NA	0.5
Trichlorofluoromethane	ND	ND	ND<5.0	ND	NA	0.5
Vinyl Chloride	2.5	ND	ND<5.0	ND	NA	0.5

Surrogate Recoveries (%)

%SS1:	84	78	78	76	
%SS2:	97	106	103	100	
%SS3:	89	95	91	87	

Comments

* water and vapor samples are reported in µg/L, soil/sludge/solid samples in mg/kg, product/oil/non-aqueous liquid samples and all TCLP & SPLP extracts are reported in mg/L, wipe samples in µg/wipe.

ND means not detected above the reporting limit; N/A means analyte not applicable to this analysis.

surrogate diluted out of range or surrogate coelutes with another peak.

b6) lighter than water immiscible sheen/product is present



McC Campbell Analytical, Inc.

"When Quality Counts"

1534 Willow Pass Road, Pittsburg, CA 94565-1701
Web: www.mcccampbell.com E-mail: main@mcccampbell.com
Telephone: 877-252-9262 Fax: 925-252-9269

Conestoga-Rovers & Associates 5900 Hollis St, Suite A Emeryville, CA 94608	Client Project ID: #521000; John Nady	Date Sampled: 03/30/09
		Date Received: 03/30/09
	Client Contact: Mark Jonas	Date Extracted: 04/03/09
	Client P.O.:	Date Analyzed 04/03/09

Halogenated Volatile Organics by P&T and GC-MS (8010 Basic Target List)*

Extraction Method: SW5030B

Analytical Method: SW8260B

Work Order: 0903743

Lab ID	0903743-007C	0903743-008A	0903743-009C		Reporting Limit for DF =1	
Client ID	MW-6B	MW-6C	MW-7A			
Matrix	W	W	W		S	W
DF	1	1	1			

Compound	Concentration			µg/kg	µg/L
Bromodichloromethane	ND	ND	ND	NA	0.5
Bromoform	ND	ND	ND	NA	0.5
Bromomethane	ND	ND	ND	NA	0.5
Carbon Tetrachloride	ND	ND	ND	NA	0.5
Chlorobenzene	ND	ND	1.4	NA	0.5
Chloroethane	0.96	ND	ND	NA	0.5
Chloroform	ND	ND	ND	NA	0.5
Chloromethane	ND	ND	ND	NA	0.5
Dibromochloromethane	ND	ND	ND	NA	0.5
1,2-Dibromoethane (EDB)	ND	ND	ND	NA	0.5
1,2-Dichlorobenzene	ND	ND	ND	NA	0.5
1,3-Dichlorobenzene	ND	ND	ND	NA	0.5
1,4-Dichlorobenzene	ND	ND	ND	NA	0.5
Dichlorodifluoromethane	ND	ND	ND	NA	0.5
1,1-Dichloroethane	ND	0.57	ND	NA	0.5
1,2-Dichloroethane (1,2-DCA)	ND	ND	ND	NA	0.5
1,1-Dichloroethene	ND	ND	ND	NA	0.5
cis-1,2-Dichloroethene	0.80	22	ND	NA	0.5
trans-1,2-Dichloroethene	ND	0.58	ND	NA	0.5
1,2-Dichloropropane	ND	ND	ND	NA	0.5
cis-1,3-Dichloropropene	ND	ND	ND	NA	0.5
trans-1,3-Dichloropropene	ND	ND	ND	NA	0.5
Freon 113	ND	ND	ND	NA	10
Methylene chloride	ND	ND	ND	NA	0.5
1,1,1,2-Tetrachloroethane	ND	ND	ND	NA	0.5
1,1,1,2,2-Tetrachloroethane	ND	ND	ND	NA	0.5
Tetrachloroethene	ND	4.6	ND	NA	0.5
1,1,1-Trichloroethane	ND	ND	ND	NA	0.5
1,1,2-Trichloroethane	ND	ND	ND	NA	0.5
Trichloroethene	ND	5.0	ND	NA	0.5
Trichlorofluoromethane	ND	ND	ND	NA	0.5
Vinyl Chloride	ND	3.5	ND	NA	0.5

Surrogate Recoveries (%)

%SS1:	79	80	79	
%SS2:	101	107	96	
%SS3:	101	97	96	

Comments b6 b6

* water and vapor samples are reported in µg/L, soil/sludge/solid samples in mg/kg, product/oil/non-aqueous liquid samples and all TCLP & SPLP extracts are reported in mg/L, wipe samples in µg/wipe.

ND means not detected above the reporting limit; N/A means analyte not applicable to this analysis.

surrogate diluted out of range or surrogate coelutes with another peak.

b6) lighter than water immiscible sheen/product is present



McC Campbell Analytical, Inc.

"When Quality Counts"

1534 Willow Pass Road, Pittsburg, CA 94565-1701
Web: www.mcccampbell.com E-mail: main@mcccampbell.com
Telephone: 877-252-9262 Fax: 925-252-9269

Conestoga-Rovers & Associates 5900 Hollis St, Suite A Emeryville, CA 94608	Client Project ID: #521000; John Nady	Date Sampled: 03/30/09
		Date Received: 03/30/09
	Client Contact: Mark Jonas	Date Extracted: 04/01/09-04/06/09
	Client P.O.:	Date Analyzed 04/01/09-04/06/09

Gasoline (C6-C12) & Stoddard Solvent (C9-C12) Range Volatile Hydrocarbons as Gasoline with BTEX & MTBE*

Extraction Method: SW5030B

Analytical Method: SW8021B/8015Bm

Work Order: 0903743

Lab ID	0903743-001B	0903743-003B	0903743-004B	0903743-005B	Reporting Limit for DF =1	
Client ID	MW-1A	MW-2A	MW-3A	MW-4A		
Matrix	W	W	W	W		
DF	2	1	10	1		

Compound	Concentration				ug/kg	µg/L
TPH(g)	2000	96	8300	75	NA	50
TPH(ss)	3100	ND	15,000	70	NA	50
MTBE	ND<10	ND	ND<50	ND	NA	5.0
Benzene	1.7	ND	ND<5.0	0.64	NA	0.5
Toluene	ND<1.0	3.2	ND<5.0	1.4	NA	0.5
Ethylbenzene	3.4	ND	ND<5.0	ND	NA	0.5
Xylenes	5.3	ND	ND<5.0	2.4	NA	0.5

Surrogate Recoveries (%)

%SS:	100	107	105	95	
------	-----	-----	-----	----	--

Comments	d7,d9	d9	d7,b6	d1	
-----------------	-------	----	-------	----	--

* water and vapor samples and all TCLP & SPLP extracts are reported in ug/L, soil/sludge/solid samples in mg/kg, wipe samples in µg/wipe, product/oil/non-aqueous liquid samples in mg/L.

cluttered chromatogram; sample peak coelutes with surrogate peak.

+The following descriptions of the TPH chromatogram are cursory in nature and McC Campbell Analytical is not responsible for their interpretation:

- b6) lighter than water immiscible sheen/product is present
- d1) weakly modified or unmodified gasoline is significant
- d5) TPH pattern that does not appear to be derived from gasoline (stoddard solvent / mineral spirit?)
- d7) strongly aged gasoline or diesel range compounds are significant in the TPH(g) chromatogram
- d9) no recognizable pattern



McC Campbell Analytical, Inc.

"When Quality Counts"

1534 Willow Pass Road, Pittsburg, CA 94565-1701
Web: www.mcccampbell.com E-mail: main@mcccampbell.com
Telephone: 877-252-9262 Fax: 925-252-9269

Conestoga-Rovers & Associates 5900 Hollis St, Suite A Emeryville, CA 94608	Client Project ID: #521000; John Nady	Date Sampled: 03/30/09
		Date Received: 03/30/09
	Client Contact: Mark Jonas	Date Extracted: 04/01/09-04/06/09
	Client P.O.:	Date Analyzed 04/01/09-04/06/09

Gasoline (C6-C12) & Stoddard Solvent (C9-C12) Range Volatile Hydrocarbons as Gasoline with BTEX & MTBE*

Extraction Method: SW5030B

Analytical Method: SW8021B/8015Bm

Work Order: 0903743

Lab ID	0903743-006B	0903743-007B	0903743-009B		Reporting Limit for DF =1	
Client ID	MW-6A	MW-6B	MW-7A			
Matrix	W	W	W			
DF	10	50	50			

Compound	Concentration			ug/kg	µg/L
TPH(g)	2300	10,000	11,000	NA	50
TPH(ss)	3100	13,000	16,000	NA	50
MTBE	ND<50	ND<250	ND<250	NA	5.0
Benzene	ND<5.0	ND<25	ND<25	NA	0.5
Toluene	ND<5.0	ND<25	ND<25	NA	0.5
Ethylbenzene	ND<5.0	ND<25	ND<25	NA	0.5
Xylenes	ND<5.0	ND<25	ND<25	NA	0.5

Surrogate Recoveries (%)

%SS:	93	93	85		
------	----	----	----	--	--

Comments	d5,b6	d7,b6	d5,b6		
-----------------	-------	-------	-------	--	--

* water and vapor samples and all TCLP & SPLP extracts are reported in ug/L, soil/sludge/solid samples in mg/kg, wipe samples in µg/wipe, product/oil/non-aqueous liquid samples in mg/L.

cluttered chromatogram; sample peak coelutes with surrogate peak.

+The following descriptions of the TPH chromatogram are cursory in nature and McC Campbell Analytical is not responsible for their interpretation:

- b6) lighter than water immiscible sheen/product is present
- d1) weakly modified or unmodified gasoline is significant
- d5) TPH pattern that does not appear to be derived from gasoline (stoddard solvent / mineral spirit?)
- d7) strongly aged gasoline or diesel range compounds are significant in the TPH(g) chromatogram
- d9) no recognizable pattern



McC Campbell Analytical, Inc.

"When Quality Counts"

1534 Willow Pass Road, Pittsburg, CA 94565-1701
Web: www.mccampbell.com E-mail: main@mccampbell.com
Telephone: 877-252-9262 Fax: 925-252-9269

Conestoga-Rovers & Associates 5900 Hollis St, Suite A Emeryville, CA 94608	Client Project ID: #521000; John Nady	Date Sampled: 03/30/09
		Date Received: 03/30/09
	Client Contact: Mark Jonas	Date Extracted: 03/30/09
	Client P.O.:	Date Analyzed: 03/31/09-04/03/09

Total Extractable Petroleum Hydrocarbons with Silica Gel Clean-Up*

Extraction method: SW3510C/3630C

Analytical methods: SW8015B

Work Order: 0903743

Lab ID	Client ID	Matrix	TPH-Diesel (C10-C23)	TPH-Motor Oil (C18-C36)	DF	% SS
0903743-001A	MW-1A	W	1800,e11	ND	1	95
0903743-003A	MW-2A	W	99,e4,e2	ND	1	95
0903743-004A	MW-3A	W	31,000,e11,b6	ND<2500	10	109
0903743-005A	MW-4A	W	89,e2	ND	1	97
0903743-006A	MW-6A	W	11,000,e11,b6	430	1	109
0903743-007A	MW-6B	W	34,000,e11,b6	ND<2500	10	98
0903743-009A	MW-7A	W	110,000,e11,b6	ND<12,000	50	101

Reporting Limit for DF =1; ND means not detected at or above the reporting limit	W	50	250	µg/L
	S	NA	NA	mg/Kg

* water samples are reported in µg/L, wipe samples in µg/wipe, soil/solid/sludge samples in mg/kg, product/oil/non-aqueous liquid samples in mg/L, and all DISTLC / STLC / SPLP / TCLP extracts are reported in µg/L.

#) cluttered chromatogram resulting in coeluted surrogate and sample peaks, or; surrogate peak is on elevated baseline, or; surrogate has been diminished by dilution of original extract; &) low or no surrogate due to matrix interference.

+The following descriptions of the TPH chromatogram are cursory in nature and McC Campbell Analytical is not responsible for their interpretation:

- b6) lighter than water immiscible sheen/product is present
- e2) diesel range compounds are significant; no recognizable pattern
- e4) gasoline range compounds are significant.
- e11) stoddard solvent/mineral spirit (?)



QC SUMMARY REPORT FOR SW8260B

W.O. Sample Matrix: Water

QC Matrix: Water

BatchID: 42361

WorkOrder 0903743

Analyte	Extraction SW5030B			Spiked Sample ID: 0903740-004B								
	Sample µg/L	Spiked µg/L	MS % Rec.	MSD % Rec.	MS-MSD % RPD	LCS % Rec.	LCSD % Rec.	LCS-LCSD % RPD	Acceptance Criteria (%)			
Chlorobenzene	ND	10	108	107	0.901	105	108	2.60	70 - 130	30	70 - 130	30
1,2-Dibromoethane (EDB)	ND	10	122	122	0	108	112	3.36	70 - 130	30	70 - 130	30
1,2-Dichloroethane (1,2-DCA)	ND	10	126	124	1.64	101	104	2.26	70 - 130	30	70 - 130	30
1,1-Dichloroethene	ND	10	99.9	99.6	0.303	87.8	89.4	1.89	70 - 130	30	70 - 130	30
Trichloroethene	ND	10	127	124	2.45	122	125	2.19	70 - 130	30	70 - 130	30
%SS1:	82	25	83	83	0	74	74	0	70 - 130	30	70 - 130	30
%SS2:	100	25	100	101	0.595	91	91	0	70 - 130	30	70 - 130	30
%SS3:	74	2.5	80	80	0	81	80	2.25	70 - 130	30	70 - 130	30

All target compounds in the Method Blank of this extraction batch were ND less than the method RL with the following exceptions:
NONE

BATCH 42361 SUMMARY

Lab ID	Date Sampled	Date Extracted	Date Analyzed	Lab ID	Date Sampled	Date Extracted	Date Analyzed
0903743-001C	03/30/09 12:00 PM	04/03/09	04/03/09 12:30 AM	0903743-002A	03/30/09 11:35 AM	04/03/09	04/03/09 1:07 AM
0903743-004C	03/30/09 1:25 PM	04/03/09	04/03/09 1:45 AM	0903743-006C	03/30/09 11:05 AM	04/03/09	04/03/09 5:12 PM
0903743-007C	03/30/09 10:35 AM	04/03/09	04/03/09 5:51 PM	0903743-008A	03/30/09 10:05 AM	04/03/09	04/03/09 3:38 AM
0903743-009C	03/30/09 9:10 AM	04/03/09	04/03/09 6:30 PM				

MS = Matrix Spike; MSD = Matrix Spike Duplicate; LCS = Laboratory Control Sample; LCSD = Laboratory Control Sample Duplicate; RPD = Relative Percent Deviation.

% Recovery = 100 * (MS-Sample) / (Amount Spiked); RPD = 100 * (MS - MSD) / ((MS + MSD) / 2).

MS / MSD spike recoveries and / or %RPD may fall outside of laboratory acceptance criteria due to one or more of the following reasons: a) the sample is inhomogenous AND contains significant concentrations of analyte relative to the amount spiked, or b) the spiked sample's matrix interferes with the spike recovery.

N/A = not enough sample to perform matrix spike and matrix spike duplicate.

NR = analyte concentration in sample exceeds spike amount for soil matrix or exceeds 2x spike amount for water matrix or sample diluted due to high matrix or analyte content.

Laboratory extraction solvents such as methylene chloride and freon 113 may occasionally appear in the method blank at low levels.



QC SUMMARY REPORT FOR SW8021B/8015Bm

W.O. Sample Matrix: Water

QC Matrix: Water

BatchID: 42345

WorkOrder: 0903743

Analyte	EPA Method SW8021B/8015Bm		Extraction SW5030B						Spiked Sample ID: 0903728-014A			
	Sample	Spiked	MS	MSD	MS-MSD	LCS	LCSD	LCS-LCSD	Acceptance Criteria (%)			
	µg/L	µg/L	% Rec.	% Rec.	% RPD	% Rec.	% Rec.	% RPD	MS / MSD	RPD	LCS/LCSD	RPD
TPH(btex) [£]	ND	60	97.8	96.4	1.43	99.9	99.8	0.116	70 - 130	20	70 - 130	20
MTBE	ND	10	88.7	113	24.1	103	99.9	3.37	70 - 130	30	70 - 130	20
Benzene	ND	10	92.5	93.9	1.49	103	106	3.00	70 - 130	20	70 - 130	20
Toluene	ND	10	91.4	93.5	2.19	92	95.2	3.39	70 - 130	20	70 - 130	20
Ethylbenzene	ND	10	94.9	97.9	3.03	101	106	5.06	70 - 130	20	70 - 130	20
Xylenes	ND	30	106	107	0.955	98.7	104	4.76	70 - 130	20	70 - 130	20
%SS:	99	10	91	94	3.37	100	104	3.71	70 - 130	20	70 - 130	20

All target compounds in the Method Blank of this extraction batch were ND less than the method RL with the following exceptions:
NONE

BATCH 42345 SUMMARY

Lab ID	Date Sampled	Date Extracted	Date Analyzed	Lab ID	Date Sampled	Date Extracted	Date Analyzed
0903743-001B	03/30/09 12:00 PM	04/02/09	04/02/09 3:49 AM	0903743-003B	03/30/09 1:00 PM	04/02/09	04/02/09 4:33 PM
0903743-004B	03/30/09 1:25 PM	04/02/09	04/02/09 2:43 AM	0903743-005B	03/30/09 12:30 PM	04/02/09	04/02/09 8:53 PM
0903743-006B	03/30/09 11:05 AM	04/06/09	04/06/09 3:08 PM				

MS = Matrix Spike; MSD = Matrix Spike Duplicate; LCS = Laboratory Control Sample; LCSD = Laboratory Control Sample Duplicate; RPD = Relative Percent Deviation.

% Recovery = 100 * (MS-Sample) / (Amount Spiked); RPD = 100 * (MS - MSD) / ((MS + MSD) / 2).

MS / MSD spike recoveries and / or %RPD may fall outside of laboratory acceptance criteria due to one or more of the following reasons: a) the sample is inhomogenous AND contains significant concentrations of analyte relative to the amount spiked, or b) the spiked sample's matrix interferes with the spike recovery.

£ TPH(btex) = sum of BTEX areas from the FID.

cluttered chromatogram; sample peak coelutes with surrogate peak.

N/A = not enough sample to perform matrix spike and matrix spike duplicate.

NR = matrix interference and/or analyte concentration in sample exceeds spike amount for soil matrix or exceeds 2x spike amount for water matrix or sample diluted due to high matrix or analyte content, or inconsistency in sample containers.



QC SUMMARY REPORT FOR SW8021B/8015Bm

W.O. Sample Matrix: Water

QC Matrix: Water

BatchID: 42362

WorkOrder: 0903743

EPA Method SW8021B/8015Bm		Extraction SW5030B							Spiked Sample ID: 0903761-001A			
Analyte	Sample	Spiked	MS	MSD	MS-MSD	LCS	LCSD	LCS-LCSD	Acceptance Criteria (%)			
	µg/L	µg/L	% Rec.	% Rec.	% RPD	% Rec.	% Rec.	% RPD	MS / MSD	RPD	LCS/LCSD	RPD
TPH(btex) [£]	ND	60	90.4	86.8	4.14	97.9	109	10.8	70 - 130	20	70 - 130	20
MTBE	ND	10	87.2	80.8	7.57	92.9	96.8	4.18	70 - 130	20	70 - 130	20
Benzene	ND	10	94.8	94.8	0	95.4	94.7	0.716	70 - 130	20	70 - 130	20
Toluene	ND	10	96.3	95.6	0.774	94.4	93.9	0.556	70 - 130	20	70 - 130	20
Ethylbenzene	ND	10	97	94	3.12	98.1	98.7	0.592	70 - 130	20	70 - 130	20
Xylenes	ND	30	108	108	0	109	110	1.10	70 - 130	20	70 - 130	20
%SS:	104	10	103	102	1.19	94	90	4.03	70 - 130	20	70 - 130	20

All target compounds in the Method Blank of this extraction batch were ND less than the method RL with the following exceptions:
NONE

BATCH 42362 SUMMARY

Lab ID	Date Sampled	Date Extracted	Date Analyzed	Lab ID	Date Sampled	Date Extracted	Date Analyzed
0903743-007B	03/30/09 10:35 AM	04/01/09	04/01/09 6:00 PM	0903743-009B	03/30/09 9:10 AM	04/03/09	04/03/09 2:34 PM

MS = Matrix Spike; MSD = Matrix Spike Duplicate; LCS = Laboratory Control Sample; LCSD = Laboratory Control Sample Duplicate; RPD = Relative Percent Deviation.

% Recovery = 100 * (MS-Sample) / (Amount Spiked); RPD = 100 * (MS - MSD) / ((MS + MSD) / 2).

MS / MSD spike recoveries and / or %RPD may fall outside of laboratory acceptance criteria due to one or more of the following reasons: a) the sample is inhomogenous AND contains significant concentrations of analyte relative to the amount spiked, or b) the spiked sample's matrix interferes with the spike recovery.

£ TPH(btex) = sum of BTEX areas from the FID.

cluttered chromatogram; sample peak coelutes with surrogate peak.

N/A = not enough sample to perform matrix spike and matrix spike duplicate.

NR = matrix interference and/or analyte concentration in sample exceeds spike amount for soil matrix or exceeds 2x spike amount for water matrix or sample diluted due to high matrix or analyte content, or inconsistency in sample containers.



QC SUMMARY REPORT FOR SW8015B

W.O. Sample Matrix: Water

QC Matrix: Water

BatchID: 42324

WorkOrder 0903743

EPA Method SW8015B		Extraction SW3510C/3630C							Spiked Sample ID: N/A			
Analyte	Sample	Spiked	MS	MSD	MS-MSD	LCS	LCSD	LCS-LCSD	Acceptance Criteria (%)			
	µg/L	µg/L	% Rec.	% Rec.	% RPD	% Rec.	% Rec.	% RPD	MS / MSD	RPD	LCS/LCSD	RPD
TPH-Diesel (C10-C23)	N/A	1000	N/A	N/A	N/A	92.7	91.7	1.09	N/A	N/A	70 - 130	30
%SS:	N/A	2500	N/A	N/A	N/A	107	106	1.50	N/A	N/A	70 - 130	30

All target compounds in the Method Blank of this extraction batch were ND less than the method RL with the following exceptions:
NONE

BATCH 42324 SUMMARY

Lab ID	Date Sampled	Date Extracted	Date Analyzed	Lab ID	Date Sampled	Date Extracted	Date Analyzed
0903743-001A	03/30/09 12:00 PM	03/30/09	03/31/09 7:37 PM	0903743-003A	03/30/09 1:00 PM	03/30/09	03/31/09 7:37 PM
0903743-004A	03/30/09 1:25 PM	03/30/09	04/01/09 2:31 AM	0903743-005A	03/30/09 12:30 PM	03/30/09	04/01/09 11:03 PM
0903743-006A	03/30/09 11:05 AM	03/30/09	04/01/09 1:23 AM	0903743-007A	03/30/09 10:35 AM	03/30/09	04/01/09 11:03 PM
0903743-009A	03/30/09 9:10 AM	03/30/09	04/03/09 5:51 AM				

MS = Matrix Spike; MSD = Matrix Spike Duplicate; LCS = Laboratory Control Sample; LCSD = Laboratory Control Sample Duplicate; RPD = Relative Percent Deviation.

% Recovery = 100 * (MS-Sample) / (Amount Spiked); RPD = 100 * (MS - MSD) / ((MS + MSD) / 2).

MS / MSD spike recoveries and / or %RPD may fall outside of laboratory acceptance criteria due to one or more of the following reasons: a) the sample is inhomogenous AND contains significant concentrations of analyte relative to the amount spiked, or b) the spiked sample's matrix interferes with the spike recovery.

N/A = not enough sample to perform matrix spike and matrix spike duplicate.

NR = analyte concentration in sample exceeds spike amount for soil matrix or exceeds 2x spike amount for water matrix or sample diluted due to high matrix or analyte content.

APPENDIX C

FIELD DATA SHEETS



WELL GAUGING SHEET

Client: Conestoga-Rovers and Associates

Site

Address: 1137-1167 65th Street, Oakland, CA

Date: 3/30/2009

Signature: 

Well ID	Time	Depth to SPH	Depth to Water	SPH Thickness	Depth to Bottom	Comments
MW-1A	8:10		2.36		14.40	
MW-1B	8:05		7.41		19.70	
MW-1C	8:00		7.37		34.55	
MW-2A	7:50		1.96		11.15	
MW-3A	8:35		3.69		13.85	
MW-4A	7:45		2.28		12.65	
MW-4B	7:40		4.21		20.75	
MW-4C	7:35		6.91		32.00	
MW-5B	7:30		6.88		23.05	
MW-6A	8:25		3.92		14.10	
MW-6B	8:20		6.35		22.00	

