

Atlantic Richfield Company

Shannon Couch
Operations Project Manager

PO Box 1257
San Ramon, CA 94583
Phone: (925) 275-3804
Fax: (925) 275-3815
E-Mail: shannon.couch@bp.com

January 21, 2013

Re: Fourth Quarter 2012 Status Report
Atlantic Richfield Company Station #374
6407 Telegraph Avenue, Oakland, California
ACEH Case #RO0000078

RECEIVED

By Alameda County Environmental Health at 11:09 am, Jan 28, 2013

"I declare, that to the best of my knowledge at the present time, that the information and/or recommendations contained in the attached document are true and correct.

Submitted by,



Shannon Couch
Operations Project Manager

Attachment

January 21, 2013

Project No. 06-88-602

Atlantic Richfield Company
P.O. Box 1257
San Ramon, CA 94583
Submitted via ENFOS

Attn.: Ms. Shannon Couch

Re: Fourth Quarter 2012 Status Report, Atlantic Richfield Company Station #374,
6407 Telegraph Avenue, Oakland, Alameda County, California
ACEH Case #RO0000078

Dear Ms. Couch:

Attached is the *Fourth Quarter 2012 Status Report* for Atlantic Richfield Company Station #374 located at 6407 Telegraph Avenue, Oakland, California (Site). This report presents a summary of current developments at the Site through the Fourth Quarter of 2012. Should you have questions regarding the work performed or results obtained, please do not hesitate to contact us at (707) 455-7290.

Sincerely,
BROADBENT & ASSOCIATES, INC.

James Ramos, EIT
Senior Staff Engineer

Kristene Tidwell, P.G., C.Hg.
Senior Geologist

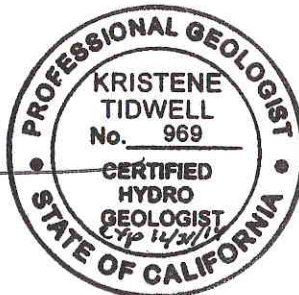

enclosures

cc: Ms. Dilan Roe, Alameda County Environmental Health (submitted via ACEH ftp site)
Electronic copy uploaded to GeoTracker

**FOURTH QUARTER 2012
STATUS REPORT
ATLANTIC RICHFIELD COMPANY STATION #374
OAKLAND, CALIFORNIA**

Broadbent & Associates, Inc. (Broadbent) is pleased to present this *Fourth Quarter 2012 Status Report* on behalf of Atlantic Richfield Company (ARC, a BP affiliated company) for Station #374 located in Oakland, Alameda County, California. Monitoring activities at the site were performed in accordance with the reporting requirements issued by the Alameda County Environmental Health (ACEH). Details of work performed, discussion of results, and recommendations are provided below.

Facility Name / Address:	Station #374 / 6407 Telegraph Avenue, Oakland, California
Client Project Manager / Title:	Ms. Shannon Couch, Remediation Management Project Manager
Broadbent Contact:	Kristene Tidwell, P.G., C.Hg. (707) 455-7290
Broadbent Project No.:	06-88-602
Primary Regulatory Agency / ID No.:	ACEH / Case #RO0000078
Current phase of project:	Monitoring
List of Acronyms / Abbreviations:	See end of report text for list of acronyms/abbreviations used in report.

WORK PERFORMED THIS QUARTER (Fourth Quarter 2012):

1. Submitted *Third Quarter 2012 Monitoring Report* on October 26, 2012 (Q3 GWM Report).
2. Submitted *Soil Vapor Investigation Work Plan* dated November 20, 2012 (Work Plan).
3. No environmental field activities were conducted during the Fourth Quarter 2012.

WORK SCHEDULED FOR NEXT QUARTER (First Quarter 2013):

1. Submit *Fourth Quarter 2012 Status Report* (contained herein).
2. Conduct First Quarter 2013 groundwater monitoring and sampling event.

GROUNDWATER MONITORING PLAN SUMMARY:

Groundwater level gauging:	MW-1 through MW-9	(1Q & 3Q)
Groundwater sample collection:	MW-1, MW-2, MW-4, MW-7, MW-8 and MW-9	(1Q & 3Q)
	MW-3, MW-5 and MW-6	(3Q)
Biodegradation indicator parameter monitoring:	None	

QUARTERLY RESULTS SUMMARY:

LNAPL

LNAPL observed this quarter:	N/A	(yes\no)
LNAPL recovered this quarter:	N/A	(gal)
Cumulative LNAPL recovered:	N/A	(gal)

Groundwater Elevation and Gradient:

Depth to groundwater:	N/A	(ft below TOC)
Gradient direction:	N/A	(compass direction)
Gradient magnitude:	N/A	(ft/ft)
Average change in elevation:	N/A	(ft since last measurement)

Laboratory Analytical Data

Summary:

No environmental field activities were conducted during Fourth Quarter 2012.

DISCUSSION:

No environmental field activities were conducted by Broadbent at the Site during the Fourth Quarter of 2012. The most recent groundwater monitoring and sampling event occurred during the Third Quarter of 2012, the results of which are contained within the Q3 GWM Report. A *Soil Vapor Investigation Work Plan* dated November 20, 2012 was submitted during the fourth quarter and comments from the ACEH are pending. A site location map is presented as Drawing 1 and a groundwater elevation and analytical summary map from the most recent Third Quarter 2012 monitoring and sampling event is presented as Drawing 2.

On July 27, 2011, ARC submitted a *Case Evaluation & Justification For No Further Action* report (Closure Report) prepared by Closure Solutions. This Closure Report presented results that indicated the site appeared to meet low-risk closure criteria due to soil and groundwater investigations that had adequately defined residual and dissolved-phase contaminant, and further investigation and active remediation did not appear to be warranted or necessary to protect human health and ecological receptors. Therefore, ARC recommended No Further Action status for the Site. This closure request was recently redacted due to the age of the request, changing Site conditions, and changes regulatory requirements.

LIMITATIONS:

The findings presented in this report are based upon observations of field personnel, points investigated, results of laboratory tests performed by TestAmerica Laboratories, Inc. (Irvine, California), and our understanding of ACEH requirements. Our services were performed in accordance with the generally accepted standard of practice at the time this report was written. No other warranty, expressed or implied was made. This report has been prepared for the exclusive use of the Atlantic Richfield Company. It is possible that variations in soil or groundwater conditions could exist beyond points explored in this investigation. Also, changes in site conditions could occur in the future due to variations in rainfall, temperature, regional water usage, or other factors.

ATTACHMENTS:

Drawing 1: Site Location Map, Station #374, 6407 Telegraph Avenue, Oakland, California

Drawing 2: Groundwater Elevation Contours and Analytical Summary Map, September 12, 2012, Station #374, 6407 Telegraph Avenue, Oakland, California

LIST OF COMMONLY USED ACCRONYMS/ABBREVIATIONS:

ACEH:	Alameda County Environmental Health	ft/ft:	feet per foot
Broadbent:	Broadbent & Associates, Inc.	gal:	Gallons
BTEX:	Benzene, Toluene, Ethylbenzene, Total Xylenes	GRO:	Gasoline-Range Organics
1,2-DCA:	1,2-Dichloroethane	LNAPL:	Light Non-Aqueous Phase Liquid
DIPE:	Di-Isopropyl Ether	MTBE:	Methyl Tertiary Butyl Ether
DO:	Dissolved Oxygen	NO ₃ :	Nitrate as Nitrogen
DRO:	Diesel-Range Organics	ppb:	parts per billion
EDB:	1,2-Dibromomethane	SO ₄ :	Sulfate
Eh:	Oxidation Reduction Potential	TAME:	Tert-Amyl Methyl Ether
EPA:	Environmental Protection Agency	TBA:	Tertiary Butyl Ether
ETBE:	Ethyl Tertiary Butyl Ether	TOC:	Top of Casing
Fe ²⁺ :	Ferrous Iron	µg/L:	Micrograms per liter

DRAWINGS

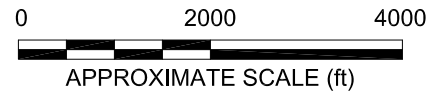
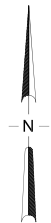
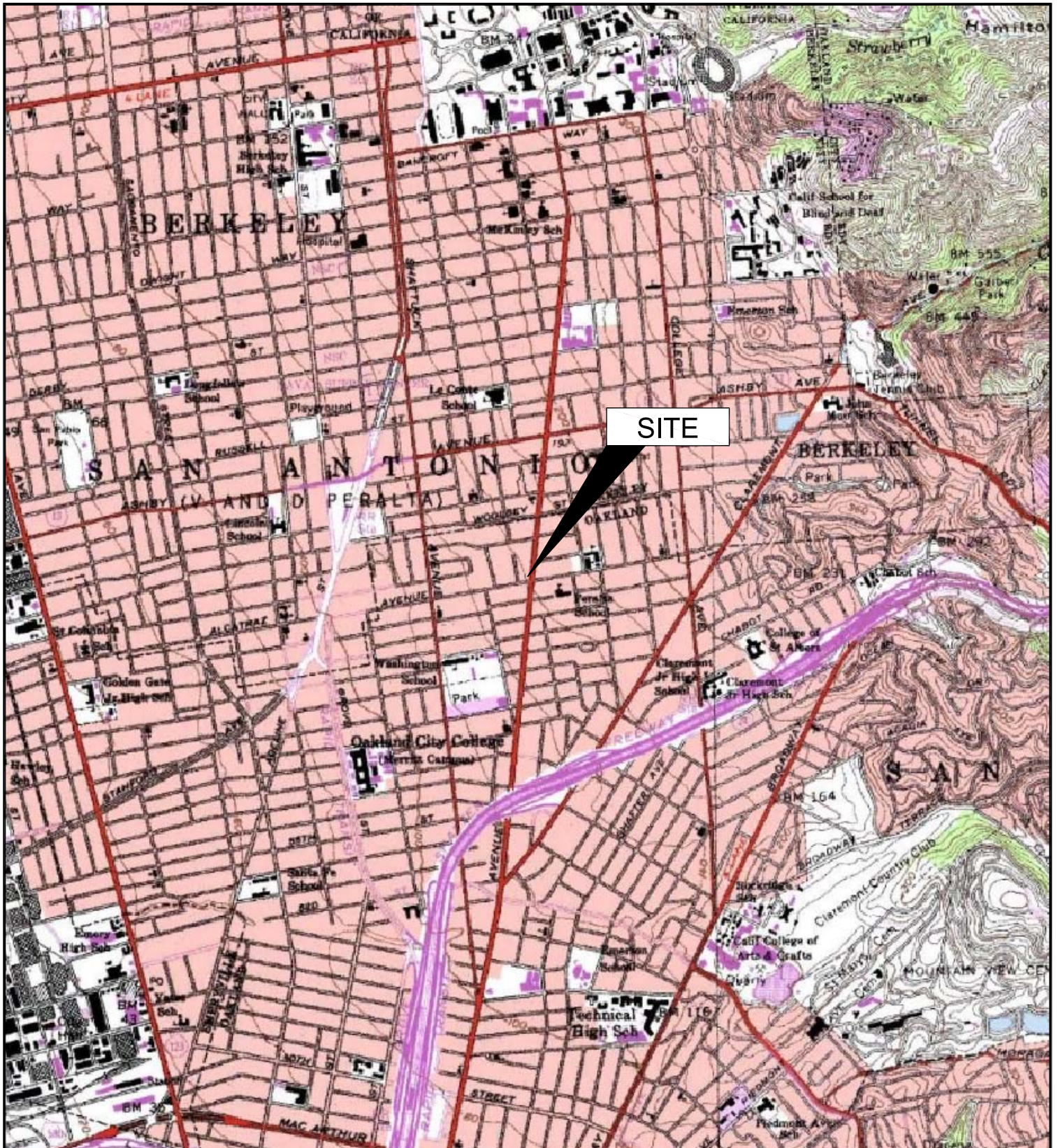

IMAGE SOURCE: USGS



875 Cotting Lane, Suite G
Vacaville, California 95688

Project No.: 06-88-602 Date: 9/10/2012

Station #374
6407 Telegraph Ave.
Oakland, California

Site Location Map

Drawing

1

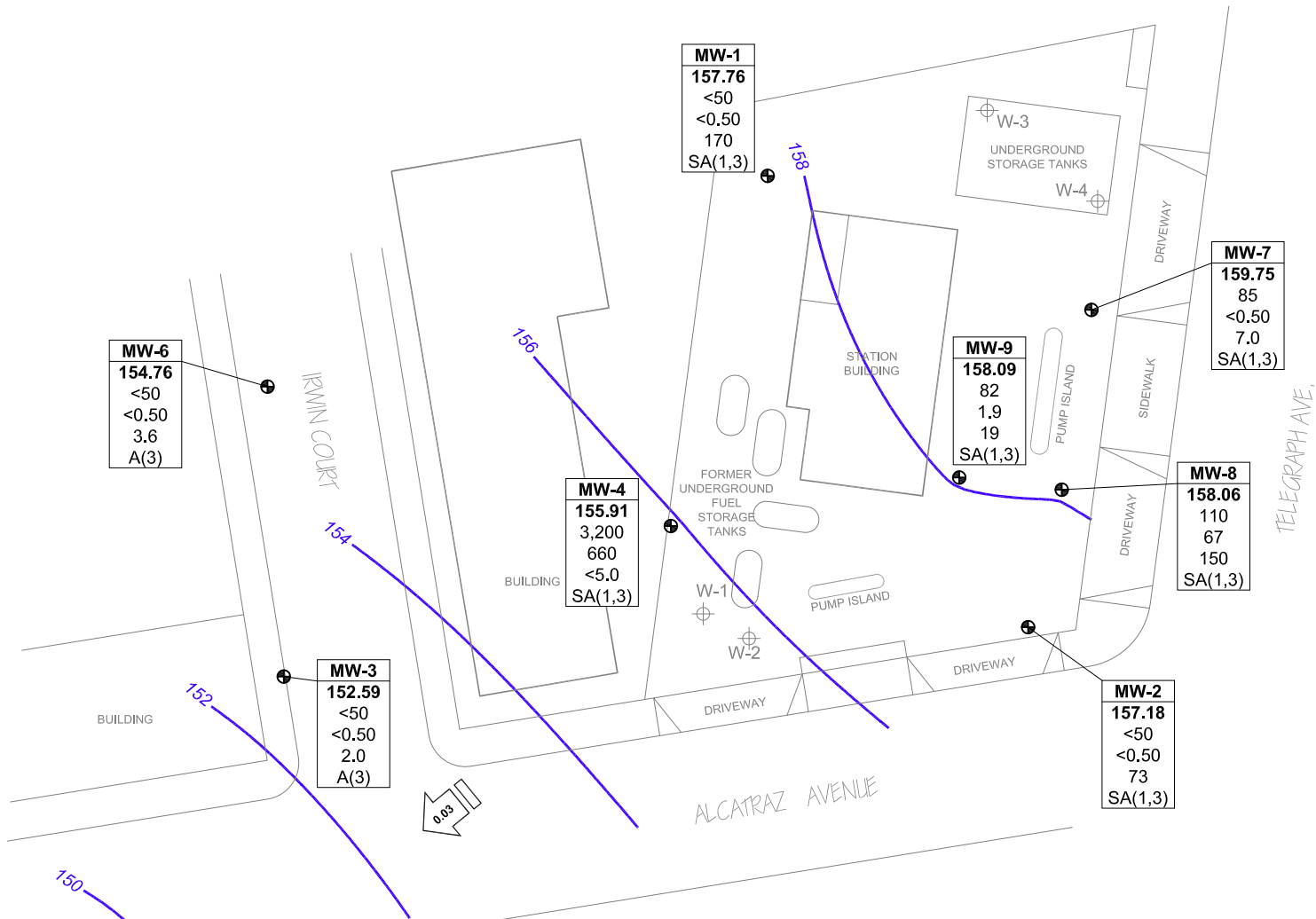

MW-6
154.76
<50
<0.50
3.6
A(3)

MW-3
152.59
<50
<0.50
2.0
A(3)

MW-4
155.91
3,200
660
<5.0
SA(1,3)

MW-1
157.76
<50
<0.50
170
SA(1,3)

MW-9
158.09
82
1.9
19
SA(1,3)

MW-7
159.75
85
<0.50
7.0
SA(1,3)

MW-8
158.06
110
67
150
SA(1,3)

MW-2
157.18
<50
<0.50
73
SA(1,3)

MW-5
148.88
<50
<0.50
<0.50
A(3)

LEGEND

- Monitor Well Location
- Tank Pit Monitor Well Location
- Groundwater Elevation Contour (Feet Above Site Datum)
- Groundwater Gradient (ft/ft)
- A(3) Sampled Annually - Third Quarter
- SA(1,3) Sampled Semi-Annually - First and Third Quarter

WELL	Well Designation
ELEV	Groundwater Elevation (ft)
GRO	GRO, Benzene, and MTBE Concentrations (µg/L)
BZ	
MTBE	
A/SA/Q	Sampling Frequency

* Not Used in Contouring

NOTE: SITE MAP ADAPTED FROM IT CORPORATION FIGURES. SITE DIMENSIONS AND FACILITY LOCATIONS NOT VERIFIED.

