

Atlantic Richfield Company

Shannon Couch
Operations Project Manager

PO Box 1257
San Ramon, CA 94583
Phone: (925) 275-3804
Fax: (925) 275-3815
E-Mail: shannon.couch@bp.com

RECEIVED

5:39 pm, Feb 21, 2012

Alameda County
Environmental Health

January 31, 2012

Re: Fourth Quarter 2011 Status Report
Atlantic Richfield Company Station #374
6407 Telegraph Avenue, Oakland, California
ACEH Case #RO0000078

"I declare, that to the best of my knowledge at the present time, that the information and/or recommendations contained in the attached document are true and correct.

Submitted by,



Shannon Couch
Operations Project Manager

Attachment



875 Cotting Ln., Suite G, Vacaville, CA 95688

[T] 707-455-7290 [F] 707-455-7295

broadbentinc.com

CREATING SOLUTIONS. BUILDING TRUST.

January 31, 2012

Project No. 06-88-602

Atlantic Richfield Company
P.O. Box 1257
San Ramon, CA 94583
Submitted via ENFOS

Attn.: Ms. Shannon Couch

Re: Fourth Quarter 2011 Status Report, Atlantic Richfield Company Station #374,
6407 Telegraph Avenue, Oakland, Alameda County, California
ACEH Case #RO0000078

Dear Ms. Couch:

Attached is the *Fourth Quarter 2011 Status Report* for Atlantic Richfield Company Station #374 located at 6407 Telegraph Avenue, Oakland, California (Site). This report presents a summary of current developments at the Site through the Fourth Quarter of 2011. Should you have questions regarding the work performed or results obtained, please do not hesitate to contact us at (707) 455-7290.

Sincerely,
BROADBENT & ASSOCIATES, INC.

James C. Ramos, E.I.T.
Staff Engineer

For: James
Ramos

Thomas A. Sparrowe, P.G.
Senior Geologist



enclosures

cc: Mr. Paresh Khatri, Alameda County Environmental Health (submitted via ACEH ftp site)
Electronic copy uploaded to GeoTracker

**FOURTH QUARTER 2011
STATUS REPORT
ATLANTIC RICHFIELD COMPANY STATION #374
OAKLAND, CALIFORNIA**

Broadbent & Associates, Inc. (Broadbent) is pleased to present this *Fourth Quarter 2011 Status Report* on behalf of Atlantic Richfield Company (ARC, a BP affiliated company) for Station #374 located in Oakland, Alameda County, California. Monitoring activities at the site were performed in accordance with the reporting requirements issued by the Alameda County Environmental Health (ACEH). Details of work performed, discussion of results, and recommendations are provided below.

Facility Name / Address:	<u>Station #374 / 6407 Telegraph Avenue, Oakland, California</u>
Client Project Manager / Title:	<u>Ms. Shannon Couch, Remediation Management Project Manager</u>
Broadbent Contact:	<u>Tom Sparrowe, P.G., (707) 455-7290</u>
Broadbent Project No.:	<u>06-88-602</u>
Primary Regulatory Agency / ID No.:	<u>ACEH / Case #RO0000078</u>
Current phase of project:	<u>Monitoring</u>
List of Acronyms / Abbreviations:	<u>See end of report text for list of acronyms/abbreviations used in report.</u>

WORK PERFORMED THIS QUARTER (Fourth Quarter 2011):

1. Submitted *Third Quarter 2011 Monitoring Report* on October 31, 2011.
2. No environmental field activities were conducted during the Fourth Quarter 2011.

WORK SCHEDULED FOR NEXT QUARTER (First Quarter 2012):

1. Submit *Fourth Quarter 2011 Status Report* (contained herein).
2. Conduct First Quarter 2012 groundwater monitoring/sampling activities.

GROUNDWATER MONITORING PLAN SUMMARY:

Groundwater level gauging:	<u>MW-1 through MW-9</u>	(1Q & 3Q)
Groundwater sample collection:	<u>MW-1, MW-2, MW-4, MW-7, MW-8 and MW-9</u>	(1Q & 3Q)
	<u>MW-3, MW-5 and MW-6</u>	(3Q)
Biodegradation indicator parameter monitoring:	<u>None</u>	

QUARTERLY RESULTS SUMMARY:

LNAPL

LNAPL observed this quarter:	<u>N/A</u>	(yes/no)
LNAPL recovered this quarter:	<u>N/A</u>	(gal)
Cumulative LNAPL recovered:	<u>N/A</u>	(gal)

Groundwater Elevation and Gradient:

Depth to groundwater:	<u>N/A</u>	(ft below TOC)
Gradient direction:	<u>N/A</u>	(compass direction)
Gradient magnitude:	<u>N/A</u>	(ft/ft)
Average change in elevation:	<u>N/A</u>	(ft since last measurement)

Laboratory Analytical Data

Summary:	<u>No environmental field activities were conducted during Fourth Quarter 2011.</u>
----------	---

DISCUSSION:

No environmental field activities were conducted by Broadbent at the Site during the Fourth Quarter of 2011. The most recent groundwater monitoring/sampling occurred during the Third Quarter of 2011, the results of which are contained within the *Third Quarter 2011 Monitoring Report* (BAI, 10/31/11). For reference, a site location map is provided as Drawing 1 and a groundwater elevation and analytical summary map, dated August 15, 2011, is provided as Drawing 2.

On July 27, 2011, ARC submitted a *Case Evaluation & Justification For No Further Action* report prepared by Closure Solutions indicating that the site appears to meet low-risk closure criteria since soil and groundwater investigations have adequately defined residual and dissolved-phase contaminant, and further investigation and active remediation does not appear to be warranted or necessary to protect human health and ecological receptors. Site data demonstrate that source removal and natural attenuation processes continue to diminish the residual hydrocarbons and fuel additives and Water Quality Objectives will likely be reached in a reasonable timeframe. Therefore, ARC recommended No Further Action status for the Site. To date, there has been no response from ACEH.

LIMITATIONS:

The findings presented in this report are based upon observations of field personnel, points investigated, results of laboratory tests performed by Calscience Environmental Laboratories, Inc. (Garden Grove, California), and our understanding of ACEH requirements. Our services were performed in accordance with the generally accepted standard of practice at the time this report was written. No other warranty, expressed or implied was made. This report has been prepared for the exclusive use of the Atlantic Richfield Company. It is possible that variations in soil or groundwater conditions could exist beyond points explored in this investigation. Also, changes in site conditions could occur in the future due to variations in rainfall, temperature, regional water usage, or other factors.

ATTACHMENTS:

Drawing 1: Site Location Map, Station #374, 6407 Telegraph Avenue, Oakland, California

Drawing 2: Groundwater Elevation Contours and Analytical Summary Map, August 15, 2011, Station #374, 6407 Telegraph Avenue, Oakland, California

LIST OF COMMONLY USED ACCRONYMS/ABBREVIATIONS:

ACEH:	Alameda County Environmental Health	ft/ft:	feet per foot
Broadbent:	Broadbent & Associates, Inc.	gal:	Gallons
BTEX:	Benzene, Toluene, Ethylbenzene, Total Xylenes	GRO:	Gasoline-Range Organics
1,2-DCA:	1,2-Dichloroethane	LNAPL:	Light Non-Aqueous Phase Liquid
DIPE:	Di-Isopropyl Ether	MTBE:	Methyl Tertiary Butyl Ether
DO:	Dissolved Oxygen	NO ₃ :	Nitrate as Nitrogen
DRO:	Diesel-Range Organics	ppb:	parts per billion
EDB:	1,2-Dibromomethane	SO ₄ :	Sulfate
Eh:	Oxidation Reduction Potential	TAME:	Tert-Amyl Methyl Ether
EPA:	Environmental Protection Agency	TBA:	Tertiary Butyl Ether
ETBE:	Ethyl Tertiary Butyl Ether	TOC:	Top of Casing
Fe ²⁺ :	Ferrous Iron	µg/L:	Micrograms per liter

DRAWINGS

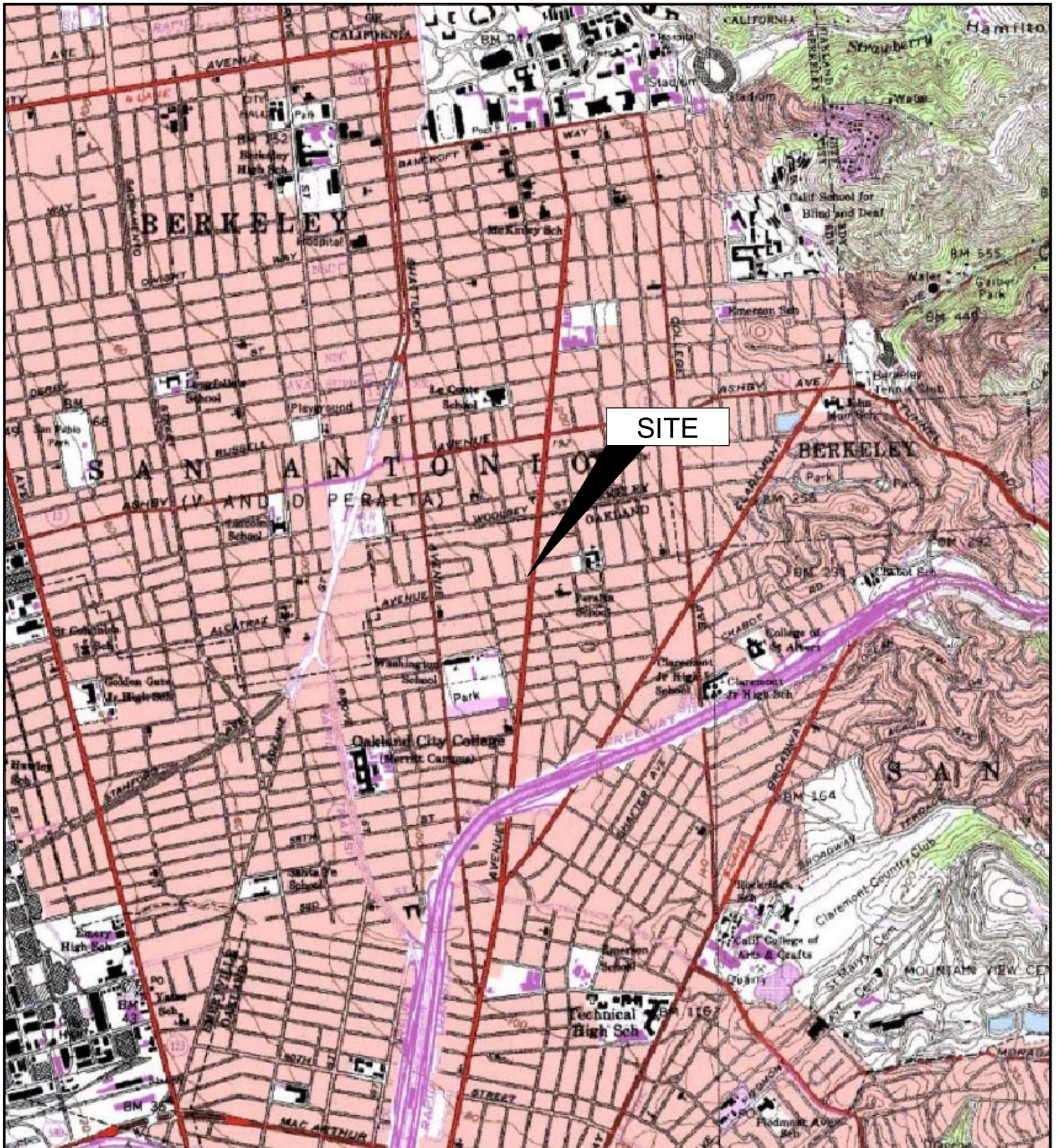

SITE

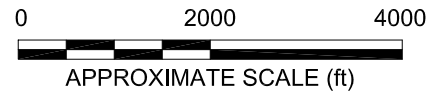
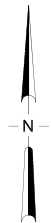

APPROXIMATE SCALE (ft)

IMAGE SOURCE: USGS

BROADBENT & ASSOCIATES, INC
 ENGINEERING, WATER RESOURCES & ENVIRONMENTAL
 1324 Mangrove Ave. Suite 212, Chico, CA 95926
 Project No.: 06-88-602 Date: 10/30/09

Station #374
 6407 Telegraph Ave.
 Oakland, California

Site Location Map

Drawing
1

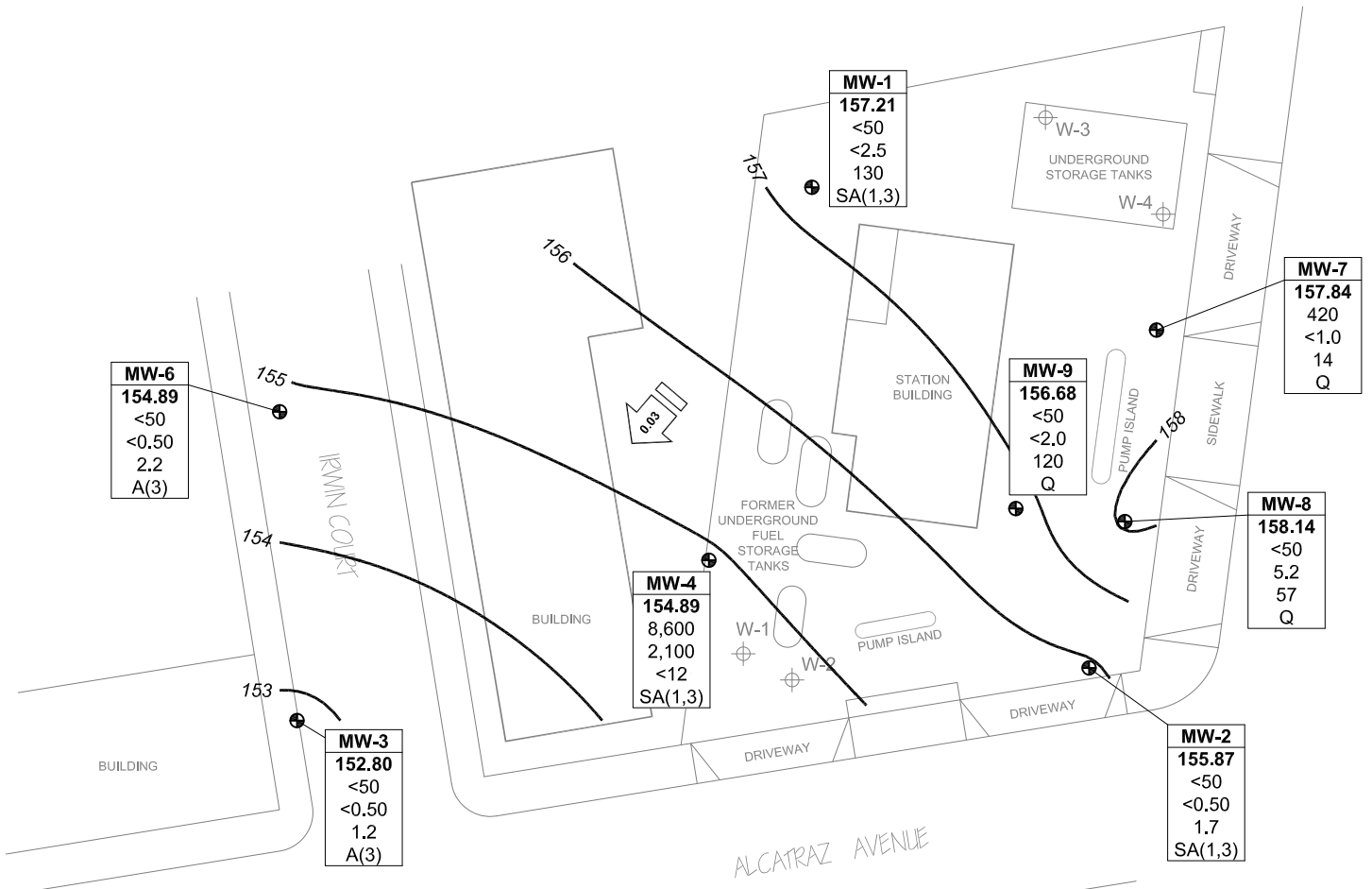

MW-6
154.89
<50
<0.50
2.2
A(3)

MW-3
152.80
<50
<0.50
1.2
A(3)

MW-4
154.89
8,600
2,100
<12
SA(1,3)

MW-1
157.21
<50
<2.5
130
SA(1,3)

MW-9
156.68
<50
<2.0
120
Q

MW-8
158.14
<50
5.2
57
Q

MW-7
157.84
420
<1.0
14
Q

MW-2
155.87
<50
<0.50
1.7
SA(1,3)

MW-5
148.99*
<50
<0.50
<0.50
A(3)

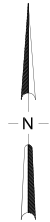

LEGEND	
	Monitor Well Location
	Tank Pit Monitor Well Location
	Groundwater Elevation Contour (Feet Above Site Datum)
	Groundwater Gradient (ft/ft)
WELL	Well Designation
ELEV	Ground-Water Elevation (ft)
GRO	GRO, Benzene and MTBE
BZ	Concentrations (µg/L)
MTBE	
A/SA/Q	Sampling Frequency
	Sampled Annually - Third Quarter
	Sampled Semi-Annually - First and Third Quarter
	Sampled Quarterly
	Not Monitored
	Not Sampled
	Not used in contouring

NOTE: SITE MAP ADAPTED FROM IT CORPORATION FIGURES. SITE DIMENSIONS AND FACILITY LOCATIONS NOT VERIFIED.