

Atlantic Richfield Company

Chuck Carmel
Environmental Business Manager

RECEIVED

9:59 am, Jan 06, 2011

Alameda County
Environmental Health

PO Box 1257
San Ramon, CA 94583
Phone: (925) 275-3803
Fax: (925) 275-3815
E-Mail: charles.carmel@bp.com

January 5, 2011

Re: Fourth Quarter 2010 Status Report
Atlantic Richfield Company Station #374
6407 Telegraph Avenue, Oakland, California
ACEH Case #RO0000078

I declare that to the best of my knowledge at the present time, that the information and/or recommendations contained in the attached document are true and correct.

Submitted by,



Chuck Carmel
Environmental Business Manager

Attachment:

January 5, 2011

Project No. 06-88-602

Atlantic Richfield Company
P.O. Box 1257
San Ramon, CA 94583
Submitted via ENFOS

Attn.: Mr. Chuck Carmel

Re: Fourth Quarter 2010 Status Report, Atlantic Richfield Company Station #374
6407 Telegraph Avenue, Oakland, Alameda County, California
ACEH Case #RO0000078

Dear Mr. Carmel:

Attached is the *Fourth Quarter 2010 Status Report* for Atlantic Richfield Company (a BP affiliated company) Station #374 located at 6407 Telegraph Avenue, Oakland, California (Site). This report presents a summary of current developments at the Site through the Fourth Quarter of 2010.

Should you have questions regarding this submittal, please do not hesitate to contact us at (707) 455-7290.

Sincerely,

BROADBENT & ASSOCIATES, INC.

Thomas A. Sparrowe, P.G.
Senior Geologist



Enclosures

cc: Mr. Paresh Khatri, Alameda County Environmental Health (Submitted via ACEH ftp site)
Electronic copy uploaded to GeoTracker

STATION #374 QUARTERLY STATUS REPORT

Facility: #374	Address:	6407 Telegraph Avenue, Oakland, California
Environmental Business Manager:		Mr. Chuck Carmel
Consulting Co./Contact Person:		Broadbent & Associates, Inc.(BAI)/Mr. Tom Sparrowe, PG (707) 455-7290
Consultant Project No.:		06-88-602
Primary Agency/Regulatory ID No.:		Alameda County Environmental Health (ACEH) ACEH Case #RO0000078
Facility Permits/Permitting Agency:		NA

WORK PERFORMED THIS QUARTER (Fourth Quarter 2010):

1. Prepared and submitted *Third Quarter 2010 Semi-Annual Groundwater Monitoring Report* (BAI, 10/01/2010).
2. Prepare and submit this *Fourth Quarter 2010 Status Report* (contained herein).
3. Drilled and sampled four soil borings and converted three into groundwater monitor wells. Conducted groundwater sampling of all on-site wells as part of the soil and groundwater investigation field work.

WORK PROPOSED FOR NEXT QUARTER (First Quarter 2011):

1. Prepared and submitted this *Fourth Quarter 2010 Status Report* (contained herein).
2. Prepare and submit an *On-Site Soil & Groundwater Investigation Report* to ACEH by January 14, 2011.
3. Conduct First Quarter 2011 semi-annual groundwater monitoring and sampling event.
4. Prepare and submit a *First Quarter 2011 Groundwater Monitoring and Sampling Report*.

QUARTERLY RESULTS SUMMARY:

Current phase of project:	Groundwater monitoring/sampling/characterization
Frequency of Groundwater monitoring:	Semi-Annually (1Q & 3Q): MW-1 through MW-6
Frequency of groundwater sampling:	Semi-Annually (1Q & 3Q): MW-1, MW-2, and MW-4 Annually (3Q): MW-3, MW-5, and MW-6
Is free product (FP) present on-site:	No
Current remediation techniques:	NA
Depth to ground water (below TOC):	NA
General groundwater flow direction:	NA
Approximate hydraulic gradient:	NA

DISCUSSION:

BAI conducted on-site soil and groundwater investigation field activities consisting of drilling and sampling four soil borings (converting three into monitor wells) between November 22 and 24, 2010 and subsequent groundwater sampling of all on-site wells on December 16, 2010. This work was conducted in accordance with BAI's May 11, 2010 *Work Plan for Soil and Groundwater Investigation*, as approved with additional comments by ACEH's August 19, 2010 response letter. The results of this investigation will be presented in an *On-Site Soil and Groundwater Investigation Report* due to ACEH on January 14, 2011.

The previous recent groundwater monitoring/sampling occurred during the Third Quarter of 2010, the results of which are contained within the *Third Quarter 2010 Semi-Annual Groundwater Monitoring Report* (BAI, 10/01/2010). For immediate reference, a site location map is provided as

Drawing 1 and a groundwater elevation and analytical summary map, dated August 10, 2010, is provided as Drawing 2.

ATTACHMENTS:

- Drawing 1. Site Location Map, Station #374, 6407 Telegraph Avenue, Oakland, California
- Drawing 2. Groundwater Elevation Contours and Analytical Summary Map, August 10, 2010, Station #374, 6407 Telegraph Avenue, Oakland, California

DRAWINGS

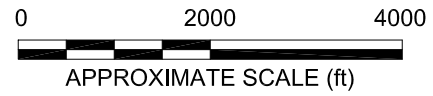
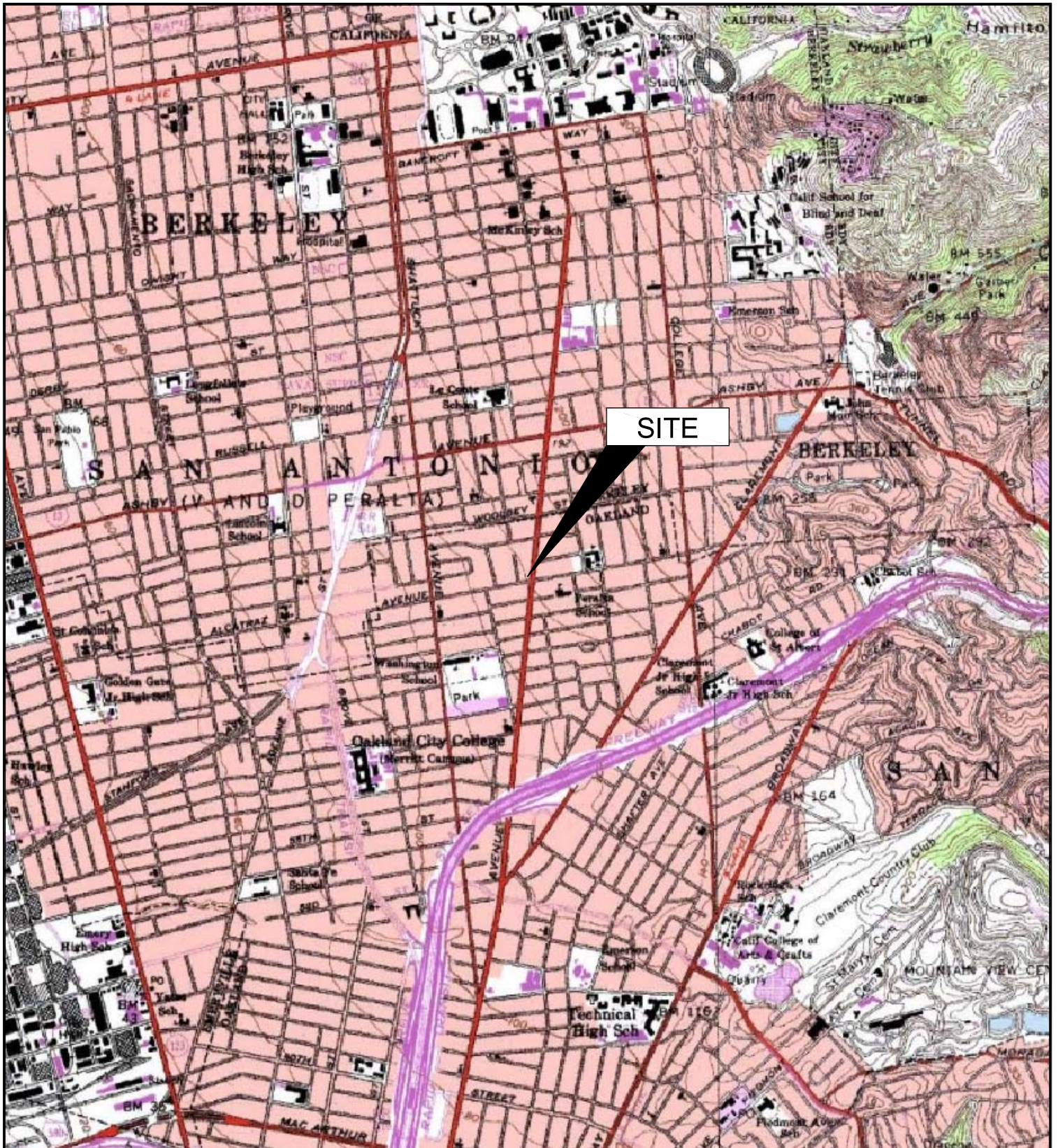
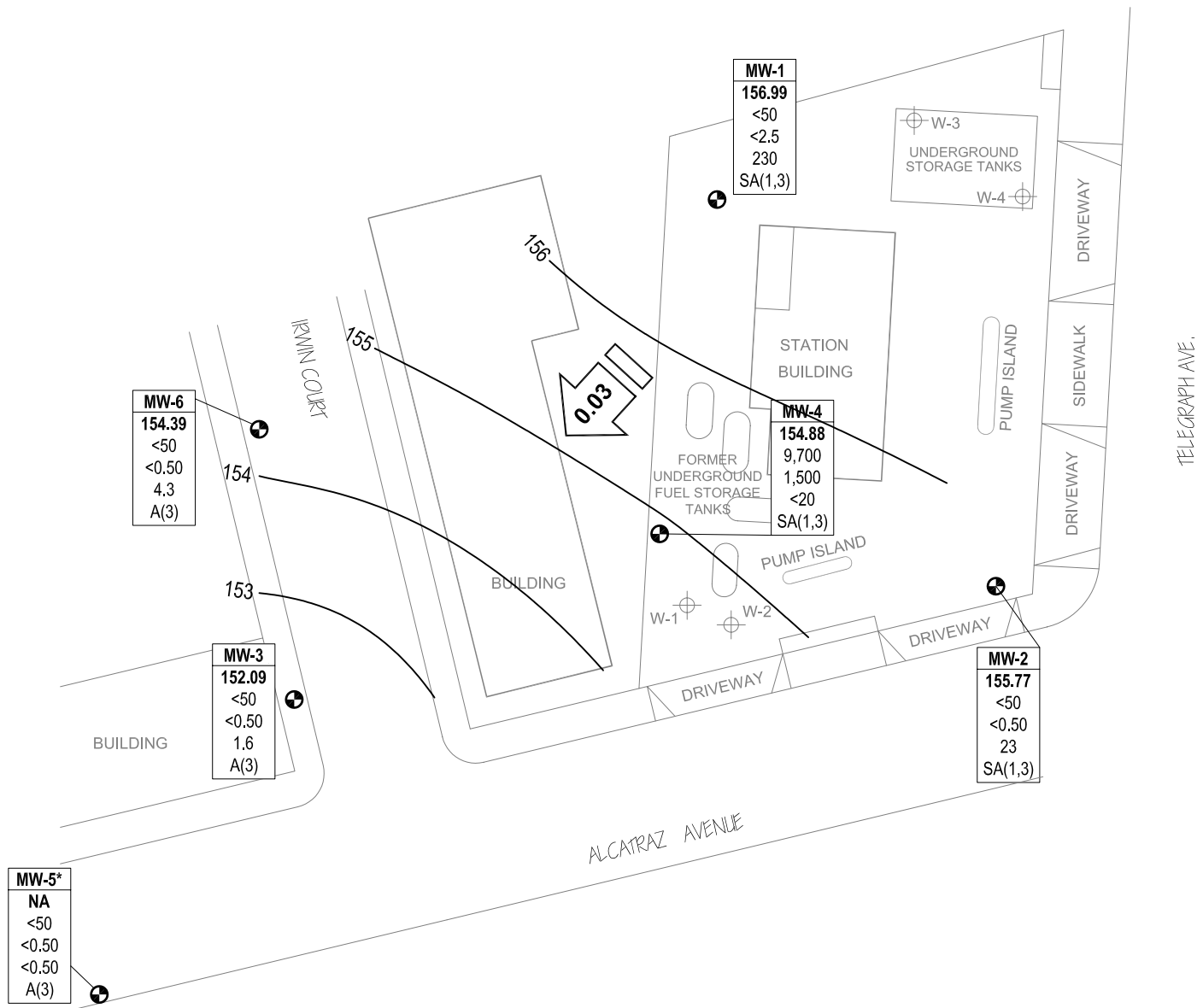
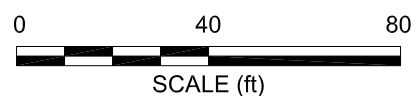
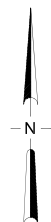

IMAGE SOURCE: USGS



LEGEND

- MONITORING WELL
 - TANK PIT MONITORING WELL
- | | |
|----------------|---|
| Well | WELL DESIGNATION |
| ELEV | GROUND-WATER ELEVATION (FT) |
| GRO | GRO, BENZENE & MTBE CONCENTRATIONS IN GROUND WATER (µg/L) |
| Benzene | |
| MTBE | |
| A/Q/SA | SAMPLING FREQUENCY |
- < NOT DETECTED AT OR ABOVE LABORATORY LIMITS
 - Q SAMPLED QUARTERLY
 - SA(1,3) SAMPLED SEMI-ANNUALLY, 1ST & 3RD QUARTERS
 - A(3) SAMPLED ANNUALLY, 3RD QUARTER
 - NS/NA NOT SAMPLED/ NOT AVAILABLE
 - APPROXIMATE GROUND-WATER FLOW AND DIRECTION (FT/FT)
 - 153 GROUND-WATER ELEVATION CONTOUR (FT)
 - * Elevation not used for contours



NOTE: SITE MAP ADAPTED FROM IT CORPORATION FIGURES.
SITE DIMENSIONS AND FACILITY LOCATIONS NOT VERIFIED.