



Atlantic Richfield Company  
(a BP affiliated company)

P.O. Box 1257  
San Ramon, CA 94583  
Phone: (925) 275-3801  
Fax: (925) 275-3815

20 April 2007

Re: First Quarter 2007 Ground-Water Monitoring Report  
Atlantic Richfield Company Station #374  
6407 Telegraph Avenue  
Oakland, California  
ACEH Case # RO0000078

**RECEIVED**

1:17 pm, May 01, 2007

Alameda County  
Environmental Health



"I declare, that to the best of my knowledge at the present time, that the information and/or recommendations contained in the attached document are true and correct."

Submitted by:

Paul Supple  
Environmental Business Manger



A BP affiliated company

**First Quarter 2007 Ground-Water Monitoring Report**  
Atlantic Richfield Company Station #374  
6407 Telegraph Avenue  
Oakland, California

Prepared for

Mr. Paul Supple  
Environmental Business Manager  
Atlantic Richfield Company  
P.O. Box 1257  
San Ramon, California 94583

Prepared by



1324 Mangrove Avenue, Suite 212  
Chico, California 95926  
(530) 566-1400  
[www.broadbentinc.com](http://www.broadbentinc.com)

20 April 2007

Project No. 06-08-602

Broadbent & Associates, Inc.  
1324 Mangrove Ave., Suite 212  
Chico, CA 95926  
Voice (530) 566-1400  
Fax (530) 566-1401



20 April 2007

Project No. 06-08-602

Atlantic Richfield Company  
P.O. Box 1257  
San Ramon, CA 94583  
Submitted via ENFOS

Attn.: Mr. Paul Supple

Re: First Quarter 2007 Ground-Water Monitoring Report, Atlantic Richfield Company (a BP affiliated company) Station #374, 6407 Telegraph Avenue, Oakland, Alameda County, California. ACEH Case #RO0000078

Dear Mr. Supple:

Attached is the *First Quarter 2007 Ground-Water Monitoring Report* for Atlantic Richfield Company Station #374 (herein referred to as Station #374) located at 6407 Telegraph Avenue, Oakland, California (Property). This report presents results of ground-water monitoring conducted during the First Quarter of 2007.

Should you have questions regarding the work performed or results obtained, please do not hesitate to contact us at (530) 566-1400.

Sincerely,

BROADBENT & ASSOCIATES, INC.

A handwritten signature in black ink, appearing to read 'Thomas A. Venus'.

Thomas A. Venus, P.E.  
Senior Engineer

A handwritten signature in black ink, appearing to read 'Robert H. Miller'.

Robert H. Miller, P.G., C.HG.  
Principal Hydrogeologist

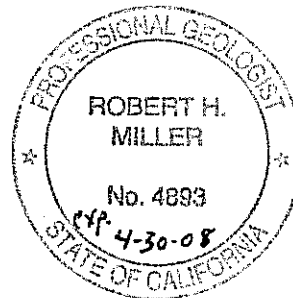

Enclosures

cc: Mr. Steven Plunkett, Alameda County Environmental Health (Submitted via ACEH ftp site)  
Electronic copy uploaded to GeoTracker

## STATION #374 QUARTERLY GROUND-WATER MONITORING REPORT

Facility: #374	Address:	6407 Telegraph Avenue, Oakland, California
Environmental Business Manager:		Mr. Paul Supple
Consulting Co./Contact Persons:		Broadbent & Associates, Inc.(BAI)/Rob Miller & Tom Venus (530) 566-1400
Consultant Project No.:		06-08-602
Primary Agency/Regulatory ID No.:		Alameda County Environmental Health (ACEH) ACEH Case #RO0000078
Facility Permits/Permitting Agency:		NA

### WORK PERFORMED THIS QUARTER (First Quarter 2007):

1. Prepared and submitted Fourth Quarter 2006 Ground-Water Monitoring Report.
2. Conducted ground-water monitoring/sampling for First Quarter 2007. Work performed on 7 February 2007 by Stratus Environmental, Inc (Stratus).

### WORK PROPOSED FOR NEXT QUARTER (Second Quarter 2007):

1. Prepared and submitted this First Quarter 2007 Ground-Water Monitoring Report (contained herein).
2. Conduct quarterly ground-water monitoring/sampling for Second Quarter 2007.
3. Prepare and submit Second Quarter 2007 Ground-Water Monitoring Report.

### QUARTERLY RESULTS SUMMARY:

Current phase of project:	<u>Ground-water monitoring/sampling</u>
Frequency of ground-water monitoring:	<u>Quarterly: MW-1, MW-2, MW-3, MW-4, MW-5, MW-6</u>
Frequency of ground-water sampling:	<u>Quarterly: MW-1</u> <u>Semi-Annually (1Q and 3Q): MW-2 and MW-4</u> <u>Annually (3Q): MW-3, MW-5, and MW-6</u>
Is free product (FP) present on-site:	<u>No</u>
Current remediation techniques:	<u>NA</u>
Depth to ground water (below TOC):	<u>5.00 ft (MW-6) to 8.25 ft (MW-5)</u>
General ground-water flow direction:	<u>Southwest</u>
Approximate hydraulic gradient:	<u>0.03 ft/ft</u>

### DISCUSSION:

First quarter 2007 ground-water monitoring and sampling was conducted at Station #374 on 7 February 2007 by Stratus. Water levels were gauged in the six wells at the Site. No irregularities were noted in the field during this quarter's water level gauging. Depth to water measurements ranged from 5.00 ft at MW-6 to 8.25 ft at MW-5. Resulting ground-water surface elevations ranged from 157.17 ft above mean sea level in well MW-1 to 143.08 ft at well MW-5. Water level elevations were between historic minimum and maximum ranges for each well, as summarized in Table 1. Water level elevations yielded a potentiometric ground-water flow direction and gradient to the southwest at approximately 0.03 ft/ft, consistent with historical data reported in Table 3. Ground-water monitoring field data sheets are provided within Appendix A. Measured depths to ground-water and respective ground-water elevations are summarized in Table 1. Potentiometric ground-water elevation contours are presented in Drawing 1.

Consistent with the current ground-water sampling schedule, water samples were collected from wells MW-1, MW-2, and MW-4 at the Site. No irregularities were reported during sampling. Samples were submitted under chain of custody protocol to Test America Analytical Testing Corporation (Morgan Hill, California), for analysis of Gasoline Range Organics (GRO, C4-12) by the LUFT GCMS Method; for Benzene, Toluene, Ethylbenzene, and Total Xylenes (BTEX) by EPA Method 8260B; and tert-Amyl methyl ether (TAME), tert-Butyl alcohol (TBA), Di-isopropyl ether (DIPE), 1,2-Dibromomethane (EDB), 1,2-Dichloroethane (1,2-DCA), Ethanol, Ethyl tert-butyl ether (ETBE), and Methyl tert-butyl ether (MTBE) by EPA Method 8260B. The GRO concentration for well MW-1 was partly due to individual peak(s) in the quantitative range. No other irregularities were encountered during laboratory analysis of the samples. Ground-water sampling field data sheets and the laboratory analytical report, including chain of custody documentation, are provided in Appendix A.

Gasoline range organics (GRO) were detected above the laboratory reporting limits in two of the three wells sampled at concentrations up to 3,100 micrograms per liter ( $\mu\text{g/L}$ ) in well MW-4. Benzene was detected above the laboratory reporting limit in two of the three wells sampled at concentrations up to 570  $\mu\text{g/L}$  in well MW-4. Toluene was detected above the laboratory reporting limit in one of the three wells sampled at a concentration of 17  $\mu\text{g/L}$  in well MW-4. Ethylbenzene was detected above the laboratory reporting limit in one of the three wells sampled at a concentration of 170  $\mu\text{g/L}$  in well MW-4. Total Xylenes were detected above the laboratory reporting limit in one of the three wells sampled at a concentration of 110  $\mu\text{g/L}$  in well MW-4. MTBE was detected above the laboratory reporting limit in each of the wells sampled at concentrations up to 190  $\mu\text{g/L}$  in well MW-1. The remaining fuel additives and oxygenates were not detected above their laboratory reporting limits in the three wells sampled this quarter. Detected analyte concentrations were within the historic minimum and maximum ranges recorded for each well. Historic laboratory analytical results are summarized in Table 1 and Table 2. The most recent GRO, Benzene, and MTBE concentrations are also presented in Drawing 1. A copy of the Laboratory Analytical Report, including chain-of-custody documentation is provided in Appendix A. Ground-water monitoring data (GEO\_WELL) and laboratory analytical results (EDF) were uploaded to the GeoTracker AB2886 database. Upload confirmation pages are provided in Appendix B.

## **CLOSURE:**

The findings presented in this report are based upon: observations of Stratus field personnel (see Appendix A), the points investigated, and results of laboratory tests performed by Test America (Morgan Hill, California). Our services were performed in accordance with the generally accepted standard of practice at the time this report was written. No other warranty, expressed or implied was made. This report has been prepared for the exclusive use of Atlantic Richfield Company. It is possible that variations in soil or ground-water conditions could exist beyond points explored in this investigation. Also, changes in site conditions could occur in the future due to variations in rainfall, temperature, regional water usage, or other factors.

## **ATTACHMENTS:**

- Drawing 1. Ground-Water Elevation Contours and Analytical Summary Map, 7 February 2007, Station #374, 6407 Telegraph Avenue, Oakland, California
- Table 1. Summary of Ground-Water Monitoring Data: Relative Water Elevations and Laboratory Analyses, Station #374, 6407 Telegraph Ave., Oakland, CA
- Table 2. Summary of Fuel Additives Analytical Data, Station #374, 6407 Telegraph Ave., Oakland, CA

Table 3. Historical Ground-Water Flow Direction and Gradient, Station #374, 6407 Telegraph Ave., Oakland, CA

Appendix A. Stratus Ground-Water Sampling Data Package (Includes Field Data Sheets and Laboratory Analytical Report with Chain-of-Custody Documentation)

Appendix B. GeoTracker Upload Confirmation

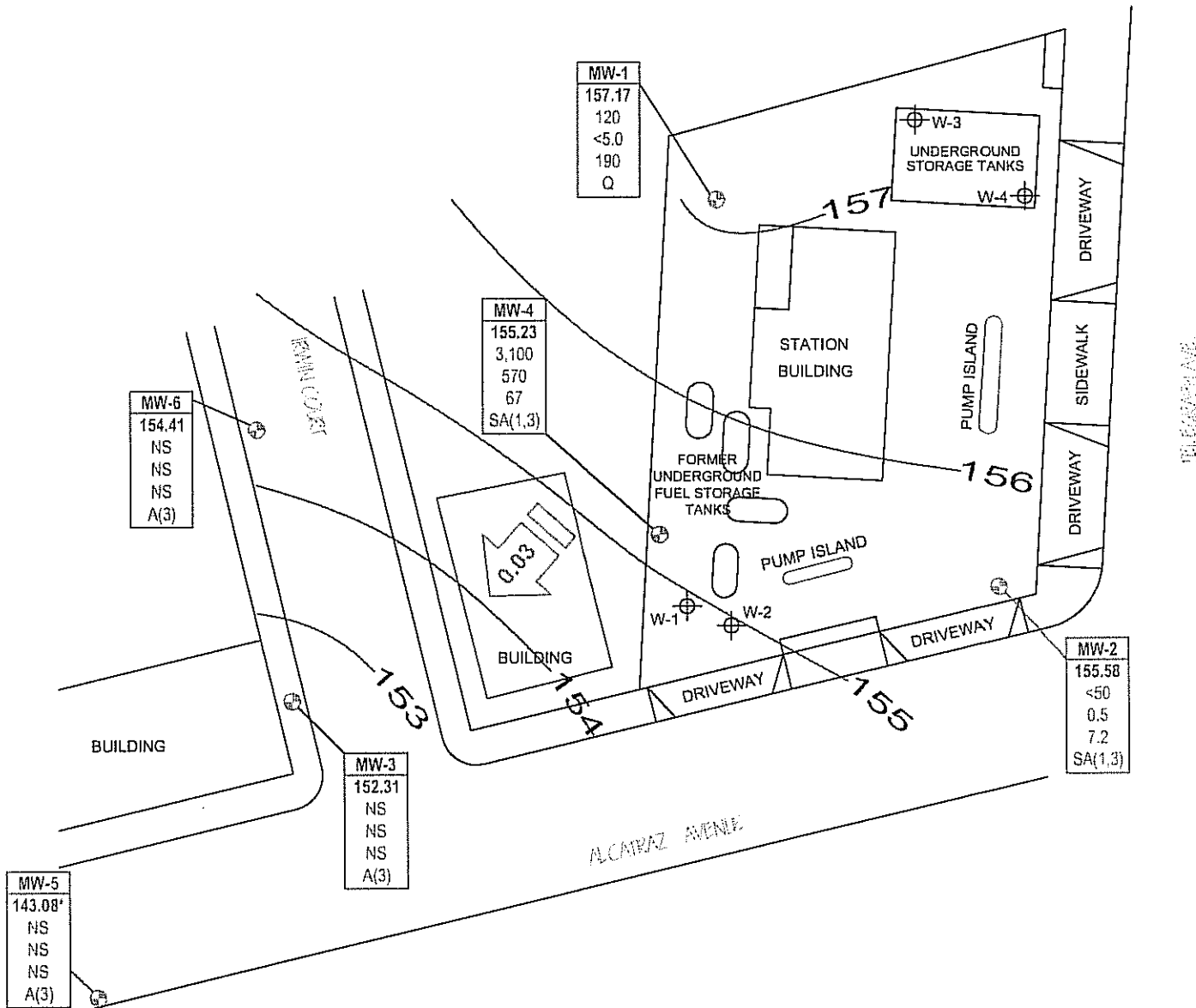

**LEGEND**

- MONITORING WELL
- TANK PIT MONITORING WELL
- |         |   |
|---------|---|
| Well    | WELL DESIGNATION  |
| ELEV    | GROUND-WATER ELEVATION (FT MSL)                           |
| GRO     | GRO, BENZENE & MTBE CONCENTRATIONS IN GROUND WATER (µg/L) |
| Benzene |   |
| MTBE    |   |
| A/Q/SA  | SAMPLING FREQUENCY  |
- < NOT DETECTED AT OR ABOVE LABORATORY LIMITS
- Q SAMPLED QUARTERLY
- SA(1,3) SAMPLED SEMI-ANNUALLY, 1ST & 3RD QUARTERS
- A(3) SAMPLED ANNUALLY, 3RD QUARTER
- NS NOT SAMPLED
- APPROXIMATE GROUND-WATER FLOW AND DIRECTION (FT/FT)
- 155 GROUND-WATER ELEVATION CONTOUR (FT MSL)  
Elevation not used for contours

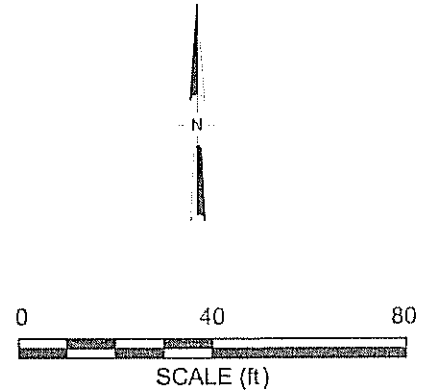

NOTE: SITE MAP ADAPTED FROM IT CORPORATION FIGURES. SITE DIMENSIONS AND FACILITY LOCATIONS NOT VERIFIED.

Table 1. Summary of Ground-Water Monitoring Data: Relative Water Elevations and Laboratory Analyses

Station #374, 6407 Telegraph Ave., Oakland, CA

Well and Sample Date	P/NP	Comments	TOC (feet msl)	Top of Screen (ft bgs)	Bottom of Screen (ft bgs)	DTW (feet bgs)	Water Level Elevation (feet msl)	Concentrations in (µg/L)						DO (mg/L)	pH
								GRO/TPHg	Benzene	Toluene	Ethyl-Benzene	Total Xylenes	MTBE		
<b>MW-1</b>															
6/20/2000	--		158.91	7.00	27.0	6.86	152.05	--	--	--	--	--	--	--	--
9/28/2000	--		158.91	7.00	27.0	7.50	151.41	--	--	--	--	--	--	--	--
12/17/2000	--		158.91	7.00	27.0	7.49	151.42	--	--	--	--	--	--	--	--
3/23/2001	--		158.91	7.00	27.0	5.90	153.01	<50	<0.5	<0.5	<0.5	<0.5	2,710	--	--
6/21/2001	--		158.91	7.00	27.0	7.45	151.46	--	--	--	--	--	--	--	--
9/23/2001	--		158.91	7.00	27.0	8.46	150.45	--	--	--	--	--	--	--	--
12/31/2001	--		158.91	7.00	27.0	5.50	153.41	--	--	--	--	--	--	--	--
3/21/2002	--		158.91	7.00	27.0	4.71	154.20	<5,000	<50	<50	<50	<50	2,000	--	--
4/17/2002	--		158.91	7.00	27.0	5.54	153.37	--	--	--	--	--	--	--	--
8/12/2002	--		158.91	7.00	27.0	7.77	151.14	--	--	--	--	--	--	--	--
12/6/2002	--		158.91	7.00	27.0	7.65	151.26	--	--	--	--	--	--	--	--
1/29/2003	--	b	158.91	7.00	27.0	5.88	153.03	--	--	--	--	--	--	--	--
5/23/2003	--		158.91	7.00	27.0	5.62	153.29	<10,000	<100	<100	<100	<100	1,600	1.3	7.1
9/4/2003	--		158.91	7.00	27.0	7.85	151.06	--	--	--	--	--	--	--	--
11/20/2003	P		158.91	7.00	27.0	8.17	150.74	1,600	<10	<10	<10	<10	1,500	1.7	6.7
02/02/2004	P	f	164.57	7.00	27.0	6.71	157.86	--	--	--	--	--	--	1.0	--
05/14/2004	P		164.57	7.00	27.0	7.08	157.49	<2,500	<25	<25	<25	<25	1,200	1.4	6.6
09/02/2004	P		164.57	7.00	27.0	8.12	156.45	580	<5.0	<5.0	<5.0	<5.0	660	3.8	6.7
11/04/2004	P		164.57	7.00	27.0	7.38	157.19	1,700	<10	<10	<10	<10	580	6.0	6.5
02/08/2005	P		164.57	7.00	27.0	6.60	157.97	<1,000	<10	<10	<10	<10	610	0.71	6.5
05/09/2005	P	e	164.57	7.00	27.0	6.84	157.73	540	<5.0	<5.0	<5.0	5.5	620	3.12	6.6
08/11/2005	P		164.57	7.00	27.0	7.36	157.21	540	<2.5	<2.5	<2.5	4.0	390	0.8	6.6
11/18/2005	P	e	164.57	7.00	27.0	8.02	156.55	350	<2.5	<2.5	<2.5	<2.5	340	2.6	6.7
02/16/2006	P	e	164.57	7.00	27.0	6.44	158.13	350	<2.5	<2.5	<2.5	<2.5	340	1.6	6.7
5/30/2006	P		164.57	7.00	27.0	6.87	157.70	270	<2.5	<2.5	<2.5	<2.5	420	4.73	6.4
8/24/2006	P		164.57	7.00	27.0	7.75	156.82	95	<5.0	<5.0	<5.0	<5.0	180	0.65	6.9
11/1/2006	P		164.57	7.00	27.0	8.28	156.29	120	<5.0	<5.0	<5.0	<5.0	220	1.65	7.07
2/7/2007	NP	e	164.57	7.00	27.0	7.40	157.17	120	<5.0	<5.0	<5.0	<5.0	190	1.88	7.45
<b>MW-2</b>															
6/20/2000	--		157.92	7.00	27.0	7.67	150.25	--	--	--	--	--	--	--	--



Table 1. Summary of Ground-Water Monitoring Data: Relative Water Elevations and Laboratory Analyses

Station #374, 6407 Telegraph Ave., Oakland, CA

Well and Sample Date	P/NP	Comments	TOC (feet msl)	Top of Screen (ft bgs)	Bottom of Screen (ft bgs)	DTW (feet bgs)	Water Level Elevation (feet msl)	Concentrations in (µg/L)					DO (mg/L)	pH	
								GRO/TPHg	Benzene	Toluene	Ethyl-Benzene	Total Xylenes			MTBE
<b>MW-2 Cont.</b>															
9/28/2000	--		157.92	7.00	27.0	8.51	149.41	--	--	--	--	--	--	--	--
12/17/2000	--		157.92	7.00	27.0	8.14	149.78	--	--	--	--	--	--	--	--
3/23/2001	--		157.92	7.00	27.0	7.21	150.71	<50	<0.5	<0.5	<0.5	<0.5	<2.5	--	--
6/21/2001	--		157.92	7.00	27.0	7.99	149.93	--	--	--	--	--	--	--	--
9/23/2001	--		157.92	7.00	27.0	8.52	149.40	--	--	--	--	--	--	--	--
12/31/2001	--		157.92	7.00	27.0	6.01	151.91	--	--	--	--	--	--	--	--
3/21/2002	--		157.92	7.00	27.0	5.95	151.97	<50	<0.5	<0.5	<0.5	<0.5	45	--	--
4/17/2002	--		157.92	7.00	27.0	6.45	151.47	--	--	--	--	--	--	--	--
8/12/2002	--		157.92	7.00	27.0	8.08	149.84	--	--	--	--	--	--	--	--
12/6/2002	--		157.92	7.00	27.0	8.29	149.63	--	--	--	--	--	--	--	--
1/29/2003	--	b	157.92	7.00	27.0	7.22	150.70	--	--	--	--	--	--	--	--
5/23/2003	--		157.92	7.00	27.0	6.85	151.07	<50	<0.50	<0.50	<0.50	<0.50	55	1.4	7.2
9/4/2003	--		157.92	7.00	27.0	7.94	149.98	--	--	--	--	--	--	--	--
11/20/2003	--		157.92	7.00	27.0	8.05	149.87	--	--	--	--	--	--	--	--
02/02/2004	P	f	163.46	7.00	27.0	7.00	156.46	74	<0.50	<0.50	<0.50	<0.50	37	1.1	8.9
05/14/2004	--		163.46	7.00	27.0	7.97	155.49	--	--	--	--	--	--	--	--
09/02/2004	P		163.46	7.00	27.0	8.19	155.27	<250	<2.5	<2.5	<2.5	<2.5	67	2.7	6.9
11/04/2004	--		163.46	7.00	27.0	7.54	155.92	--	--	--	--	--	--	--	--
02/08/2005	P		163.46	7.00	27.0	6.72	156.74	<50	<0.50	<0.50	<0.50	<0.50	30	0.86	6.7
05/09/2005	--		163.46	7.00	27.0	7.16	156.30	--	--	--	--	--	--	--	--
08/11/2005	P		163.46	7.00	27.0	7.85	155.61	<50	<0.50	<0.50	<0.50	<0.50	35	1.0	6.6
11/18/2005	--		163.46	7.00	27.0	8.23	155.23	--	--	--	--	--	--	--	--
02/16/2006	P		163.46	7.00	27.0	6.82	156.64	<50	<0.50	<0.50	<0.50	<0.50	39	1.3	7.0
5/30/2006	--		163.46	7.00	27.0	7.23	156.23	--	--	--	--	--	--	--	--
8/24/2006	P		163.46	7.00	27.0	8.00	155.46	60	<0.50	<0.50	<0.50	<0.50	25	0.90	6.8
11/1/2006	--		163.46	7.00	27.0	8.38	155.08	--	--	--	--	--	--	--	--
2/7/2007	NP		163.46	7.00	27.0	7.88	155.58	<50	0.50	<0.50	<0.50	<0.50	7.2	0.94	7.39
<b>MW-3</b>															
6/20/2000	--		153.64	7.00	27.0	6.42	147.22	<50	<0.5	<0.5	<0.5	<1.0	<10	--	--
9/28/2000	--		153.64	7.00	27.0	7.31	146.33	--	--	--	--	--	--	--	--

Table 1. Summary of Ground-Water Monitoring Data: Relative Water Elevations and Laboratory Analyses

Station #374, 6407 Telegraph Ave., Oakland, CA

Well and Sample Date	P/NP	Comments	TOC (feet msl)	Top of Screen (ft bgs)	Bottom of Screen (ft bgs)	DTW (feet bgs)	Water Level Elevation (feet msl)	Concentrations in (µg/L)						DO (mg/L)	pH
								GRO/TPHg	Benzene	Toluene	Ethyl-Benzene	Total Xylenes	MTBE		
<b>MW-3 Cont.</b>															
12/17/2000	--		153.64	7.00	27.0	6.45	147.19	<50	<0.5	<0.5	<0.5	<0.5	<2.5	--	--
3/23/2001	--		153.64	7.00	27.0	6.01	147.63	--	--	--	--	--	--	--	--
6/21/2001	--		153.64	7.00	27.0	6.80	146.84	110	5.5	<0.5	5.4	4.1	2.5	--	--
9/23/2001	--		153.64	7.00	27.0	7.32	146.32	--	--	--	--	--	--	--	--
12/31/2001	--		153.64	7.00	27.0	4.48	149.16	<50	<0.5	<0.5	<0.5	<0.5	4.9	--	--
3/21/2002	--		153.64	7.00	27.0	4.36	149.28	--	--	--	--	--	--	--	--
4/17/2002	--		153.64	7.00	27.0	5.31	148.33	<50	<0.5	<0.5	<0.5	<0.5	8.7	--	--
8/12/2002	--		153.64	7.00	27.0	7.00	146.64	--	--	--	--	--	--	--	--
12/6/2002	--		153.64	7.00	27.0	7.32	146.32	<50	<0.5	<0.5	<0.5	<0.5	6.2	1.4	6.7
1/29/2003	--	b	153.64	7.00	27.0	6.07	147.57	--	--	--	--	--	--	--	--
5/23/2003	--		153.64	7.00	27.0	6.45	147.19	<50	<0.50	<0.50	<0.50	<0.50	1.6	0.9	7.7
9/4/2003	--	c	153.64	7.00	27.0	6.93	146.71	--	--	--	--	--	--	--	--
11/20/2003	--	c	153.64	7.00	27.0	7.04	146.60	--	--	--	--	--	--	--	--
02/02/2004	--	f	159.21	7.00	27.0	5.92	153.29	--	--	--	--	--	--	--	--
05/14/2004	--		159.21	7.00	27.0	7.52	151.69	--	--	--	--	--	--	--	--
09/02/2004	P		159.21	7.00	27.0	7.19	152.02	<50	<0.50	<0.50	<0.50	<0.50	6.5	9.3	8.9
11/04/2004	--		159.21	7.00	27.0	6.40	152.81	--	--	--	--	--	--	--	--
02/08/2005	--		159.21	7.00	27.0	6.01	153.20	--	--	--	--	--	--	--	--
05/09/2005	--		159.21	7.00	27.0	6.74	152.47	--	--	--	--	--	--	--	--
08/11/2005	P		159.21	7.00	27.0	6.77	152.44	<50	<0.50	<0.50	<0.50	<0.50	11	1.9	6.5
11/18/2005	--		159.21	7.00	27.0	7.83	151.38	--	--	--	--	--	--	--	--
02/16/2006	--		159.21	7.00	27.0	7.26	151.95	--	--	--	--	--	--	--	--
5/30/2006	--		159.21	7.00	27.0	5.82	153.39	--	--	--	--	--	--	--	--
8/24/2006	P		159.21	7.00	27.0	7.00	152.21	<50	<0.50	<0.50	<0.50	<0.50	7.6	1.15	6.4
11/1/2006	--		159.21	7.00	27.0	7.50	151.71	--	--	--	--	--	--	--	--
2/7/2007	--		159.21	7.00	27.0	6.90	152.31	--	--	--	--	--	--	--	--
<b>MW-4</b>															
6/20/2000	--	c	156.53	7.00	27.0	7.50	149.03	20,000	5,100	440	1,000	1,700	<250	--	--
9/28/2000	--		156.53	7.00	27.0	8.20	148.33	--	--	--	--	--	--	--	--
12/17/2000	--		156.53	7.00	27.0	8.11	148.42	4,320	1,240	<20	27.2	249	<100	--	--

Table 1. Summary of Ground-Water Monitoring Data: Relative Water Elevations and Laboratory Analyses

Station #374, 6407 Telegraph Ave., Oakland, CA

Well and Sample Date	P/NP	Comments	TOC (feet msl)	Top of Screen (ft bgs)	Bottom of Screen (ft bgs)	DTW (feet bgs)	Water Level Elevation (feet msl)	Concentrations in (µg/L)						DO (mg/L)	pH
								GRO/TPHg	Benzene	Toluene	Ethyl-Benzene	Total Xylenes	MTBE		
MW-4 Cont.															
3/23/2001	--		156.53	7.00	27.0	6.69	149.84	--	--	--	--	--	--	--	--
6/21/2001	--		156.53	7.00	27.0	8.01	148.52	2,800	470	16	19	160	130	--	--
9/23/2001	--		156.53	7.00	27.0	8.91	147.62	--	--	--	--	--	--	--	--
12/31/2001	--		156.53	7.00	27.0	4.42	152.11	4,600	1,500	100	160	210	160	--	--
3/21/2002	--		156.53	7.00	27.0	4.98	151.55	--	--	--	--	--	--	--	--
4/17/2002	--		156.53	7.00	27.0	6.23	150.30	7,100	2,200	110	290	450	<250	--	--
8/12/2002	--		156.53	7.00	27.0	8.24	148.29	--	--	--	--	--	--	--	--
12/6/2002	--	a	156.53	7.00	27.0	8.42	148.11	1,500	410	6.8	20	29	43	1.1	6.7
1/29/2003	--	b	156.53	7.00	27.0	7.20	149.33	--	--	--	--	--	--	--	--
5/23/2003	--		156.53	7.00	27.0	7.18	149.35	<5,000	1,300	89	210	260	<50	1.4	6.9
9/4/2003	--	c	156.53	7.00	27.0	8.15	148.38	--	--	--	--	--	--	--	--
11/20/2003	--	c	156.53	7.00	27.0	8.73	147.80	--	--	--	--	--	--	--	--
02/02/2004	P	c, f, g	163.25	7.00	27.0	6.25	157.00	980	280	21	29	38	29	1.4	10.6
05/14/2004	--	g	163.25	7.00	27.0	8.38	154.87	--	--	--	--	--	--	--	--
09/02/2004	P	g	163.25	7.00	27.0	8.36	154.89	260	11	<1.0	5.5	14	28	2.4	7.4
11/04/2004	--	c, g	163.25	7.00	27.0	7.71	155.54	--	--	--	--	--	--	--	--
02/08/2005	P	g	163.25	7.00	27.0	6.27	156.98	7,500	1,700	320	480	920	45	0.65	6.5
05/09/2005	--	g	163.25	7.00	27.0	5.90	157.35	--	--	--	--	--	--	--	--
08/11/2005	P	g	163.25	7.00	27.0	7.96	155.29	3,100	1,100	41	160	110	32	0.6	6.5
11/18/2005	--	g	163.25	7.00	27.0	8.57	154.68	--	--	--	--	--	--	--	--
02/16/2006	P	g	163.25	7.00	27.0	6.28	156.97	9,400	1,800	130	600	420	35	0.5	6.8
5/30/2006	--	g	163.25	7.00	27.0	7.02	156.23	--	--	--	--	--	--	--	--
8/24/2006	P	g	162.47	7.00	27.0	8.26	154.21	3,600	1,400	21	110	70	39	1.00	6.8
11/1/2006	--		163.25	7.00	27.0	8.67	154.58	--	--	--	--	--	--	--	--
2/7/2007	NP		163.25	7.00	27.0	8.02	155.23	3,100	570	17	170	110	67	0.95	7.07
MW-5															
6/20/2000	--		151.33	10.00	23.0	7.84	143.49	<50	<0.5	<0.5	<0.5	<1.0	<10	--	--
9/28/2000	--		151.33	10.00	23.0	8.37	142.96	<50	<0.5	<0.5	<0.5	<0.5	<2.5	--	--
12/17/2000	--		151.33	10.00	23.0	8.36	142.97	<50	<0.5	<0.5	<0.5	<0.5	<2.5	--	--
3/23/2001	--		151.33	10.00	23.0	7.55	143.78	<50	<0.5	<0.5	<0.5	<0.5	<2.5	--	--

Table 1. Summary of Ground-Water Monitoring Data: Relative Water Elevations and Laboratory Analyses

Station #374, 6407 Telegraph Ave., Oakland, CA

Well and Sample Date	P/NP	Comments	TOC (feet msl)	Top of Screen (ft bgs)	Bottom of Screen (ft bgs)	DTW (feet bgs)	Water Level Elevation (feet msl)	Concentrations in (µg/L)						DO (mg/L)	pH
								GRO/TPHg	Benzene	Toluene	Ethyl-Benzene	Total Xylenes	MTBE		
MW-5 Cont.															
6/21/2001	--		151.33	10.00	23.0	8.20	143.13	<50	<0.5	<0.5	<0.5	<0.5	<2.5	--	--
9/23/2001	--		151.33	10.00	23.0	8.68	142.65	<50	<0.5	<0.5	<0.5	<0.5	<2.5	--	--
12/31/2001	--		151.33	10.00	23.0	7.57	143.76	<50	<0.5	<0.5	<0.5	<0.5	<2.5	--	--
3/21/2002	--		151.33	10.00	23.0	6.12	145.21	<50	<0.5	<0.5	<0.5	<0.5	3.2	--	--
4/17/2002	--		151.33	10.00	23.0	6.61	144.72	<50	<0.5	<0.5	<0.5	<0.5	<2.5	--	--
8/12/2002	--		151.33	10.00	23.0	8.14	143.19	<50	<0.5	<0.5	<0.5	<0.5	<2.5	4.1	7.6
12/6/2002	--		151.33	10.00	23.0	8.65	142.68	<50	<0.5	<0.5	<0.5	<0.5	<2.5	1.1	6.8
1/29/2003	--	b	151.33	10.00	23.0	7.22	144.11	<50	<0.5	<0.5	<0.5	<0.5	<0.5	1	6.6
5/23/2003	--		151.33	10.00	23.0	7.31	144.02	<50	<0.50	<0.50	<0.50	<0.50	<0.50	1.1	6.6
9/4/2003	--		151.33	10.00	23.0	9.50	141.83	<50	<0.50	<0.50	<0.50	<0.50	<0.50	3.2	6.7
11/20/2003	--		151.33	10.00	23.0	8.31	143.02	--	--	--	--	--	--	--	--
02/02/2004	--	c, f, h	151.33	10.00	23.0	6.92	144.41	--	--	--	--	--	--	--	--
05/14/2004	--	h	151.33	10.00	23.0	8.56	142.77	--	--	--	--	--	--	--	--
09/02/2004	P	h	151.33	10.00	23.0	8.79	142.54	<50	<0.50	<0.50	<0.50	<0.50	<0.50	3.5	6.8
11/04/2004	--	c, h	151.33	10.00	23.0	8.33	143.00	--	--	--	--	--	--	--	--
02/08/2005	--	h	151.33	10.00	23.0	7.28	144.05	--	--	--	--	--	--	--	--
05/09/2005	--	h	151.33	10.00	23.0	8.19	143.14	--	--	--	--	--	--	--	--
08/11/2005	P	h	151.33	10.00	23.0	8.39	142.94	<50	<0.50	<0.50	<0.50	<0.50	<0.50	1.2	6.6
11/18/2005	--	h	151.33	10.00	23.0	11.25	140.08	--	--	--	--	--	--	--	--
02/16/2006	--	h	151.33	10.00	23.0	9.22	142.11	--	--	--	--	--	--	--	--
5/30/2006	--	h	151.33	10.00	23.0	7.52	143.81	--	--	--	--	--	--	--	--
8/24/2006	P	h	--	10.00	23.0	7.95	--	<50	<0.50	<0.50	<0.50	<0.50	<0.50	2.60	6.6
11/1/2006	--		151.33	10.00	23.0	8.32	143.01	--	--	--	--	--	--	--	--
2/7/2007	--		151.33	10.00	23.0	8.25	143.08	--	--	--	--	--	--	--	--
MW-6															
6/20/2000	--		153.84	5.00	15.0	4.79	149.05	--	--	--	--	--	--	--	--
9/28/2000	--		153.84	5.00	15.0	5.39	148.45	--	--	--	--	--	--	--	--
12/17/2000	--		153.84	5.00	15.0	4.71	149.13	--	--	--	--	--	--	--	--
3/23/2001	--		153.84	5.00	15.0	4.69	149.15	<50	<0.5	<0.5	<0.5	<0.5	<2.5	--	--
6/21/2001	--		153.84	5.00	15.0	5.22	148.62	--	--	--	--	--	--	--	--

Table 1. Summary of Ground-Water Monitoring Data: Relative Water Elevations and Laboratory Analyses

Station #374, 6407 Telegraph Ave., Oakland, CA

Well and Sample Date	P/NP	Comments	TOC (feet msl)	Top of Screen (ft bgs)	Bottom of Screen (ft bgs)	DTW (feet bgs)	Water Level Elevation (feet msl)	Concentrations in (µg/L)						DO (mg/L)	pH
								GRO/TPHg	Benzene	Toluene	Ethyl-Benzene	Total Xylenes	MTBE		
MW-6 Cont.															
9/23/2001	--		153.84	5.00	15.0	5.40	148.44	--	--	--	--	--	--	--	--
12/31/2001	--		153.84	5.00	15.0	3.95	149.89	--	--	--	--	--	--	--	--
3/21/2002	--		153.84	5.00	15.0	2.94	150.90	<50	<0.5	<0.5	<0.5	<0.5	5.2	--	--
4/17/2002	--		153.84	5.00	15.0	5.11	148.73	--	--	--	--	--	--	--	--
8/12/2002	--		153.84	5.00	15.0	5.23	148.61	--	--	--	--	--	--	--	--
12/6/2002	--		153.84	5.00	15.0	5.29	148.55	--	--	--	--	--	--	--	--
1/29/2003	--	b	153.84	5.00	15.0	4.79	149.05	--	--	--	--	--	--	--	--
5/23/2003	--		153.84	5.00	15.0	4.31	149.53	<50	<0.50	<0.50	<0.50	<0.50	9.4	1	6.7
09/04/03	--	d	153.84	5.00	15.0	--	--	--	--	--	--	--	--	--	--
11/20/2003	--		153.84	5.00	15.0	6.31	147.53	--	--	--	--	--	--	--	--
02/02/2004	--		159.41	5.00	15.0	4.78	154.63	--	--	--	--	--	--	--	--
05/14/2004	--		159.41	5.00	15.0	6.29	153.12	--	--	--	--	--	--	--	--
09/02/2004	--	d	159.41	5.00	15.0	5.79	153.62	--	--	--	--	--	--	--	--
11/04/2004	--	d	159.41	5.00	15.0	--	--	--	--	--	--	--	--	--	--
02/08/2005	--		159.41	5.00	15.0	5.13	154.28	--	--	--	--	--	--	--	--
05/09/2005	--		159.41	5.00	15.0	4.52	154.89	--	--	--	--	--	--	--	--
08/11/2005	P		159.41	5.00	15.0	5.02	154.59	<50	<0.50	<0.50	<0.50	<0.50	7.9	2.1	6.6
11/18/2005	--		159.41	5.00	15.0	6.31	153.10	--	--	--	--	--	--	--	--
02/16/2006	--		159.41	5.00	15.0	4.24	155.17	--	--	--	--	--	--	--	--
5/30/2006	--		159.41	5.00	15.0	4.45	154.96	--	--	--	--	--	--	--	--
8/24/2006	P		159.41	5.00	15.0	5.18	154.23	<50	<0.50	<0.50	<0.50	<0.50	12	3.4	6.8
11/1/2006	--		159.41	5.00	15.0	6.05	153.36	--	--	--	--	--	--	--	--
2/7/2007	--		159.41	5.00	15.0	5.00	154.41	--	--	--	--	--	--	--	--

SYMBOLS AND ABBREVIATIONS:

-- = Not analyzed/applicable/measured/available  
< = Not detected at or above laboratory reporting limit  
DO = Dissolved oxygen  
DTW = Depth to water in ft bgs  
ft bgs = Feet below ground surface  
ft MSL = Feet above mean sea level  
GRO = Gasoline range organics  
GWE = Groundwater elevation measured in ft MSL  
mg/L = Milligrams per liter  
MTBE = Methyl tert-butyl ether  
NP = Well was not purged prior to sampling  
P = Well was purged prior to sampling  
TOC = Top of casing measured in ft MSL  
TPH-g = Total petroleum hydrocarbons as gasoline  
µg/L = Micrograms per liter  
BTEX = Benzene, toluene, ethylbenzene and xylenes

FOOTNOTES:

a = Chromatogram pattern: Gasoline C6-C10 for GRO/TPH-g.  
b = Beginning this quarter, groundwater samples were analyzed by EPA method 8260B for TPH-g, BTEX, and fuel oxygenates.  
c = Wells gauged with ORC sock in well.  
d = Well inaccessible  
e = The hydrocarbon result for GRO was partly due to individual peaks in the quantitative range.  
f = Well resurveyed on 1/27/2004  
g = Upon review of survey data (1/27/2004), TOC elevation for MW-4 is actually 162.47 ft.  
h = Upon review of survey data (1/27/2004), MW-5 was not surveyed from the TOC. MW-5 was surveyed from the pavement due to inaccessibility to the TOC. Therefore, survey data for MW-5 from the TOC is unavailable.

NOTES:

Beginning in the fourth quarter 2003, the laboratory modified the reported analyte list. TPH-g was changed to GRO. The resulting data may be impacted by the potential of non-TPH-g analytes within the requested fuel range resulting in a higher concentration being reported.

Beginning in the second quarter 2004, the carbon range for GRO was changed from C6-C10 to C4-C12.

Values for DO and pH were obtained through field measurements.

The DTW's and TOC's for wells MW-5 and MW-6 were taken from Delta Environmental sampling sheets because the well logs were not available.

Note: The data within this table collected prior to April 2006 was provided to Broadbent & Associates, Inc. by Atlantic Richfield Company and their previous consultants. Broadbent & Associates, Inc. has not verified the accuracy of this information.

**Table 2. Summary of Fuel Additives Analytical Data**  
**Station #374, 6407 Telegraph Ave., Oakland, CA**

Well and Sample Date	Concentrations in (µg/L)								Comments
	Ethanol	TBA	MTBE	DIPE	ETBE	TAME	1,2-DCA	EDB	
<b>MW-1</b>									
5/23/2003	<20,000	<4,000	1,600	<100	<100	<100	--	--	
11/20/2003	<2,000	<400	1,500	<10	<10	<10	--	--	a
05/14/2004	<5,000	<1,000	1,200	<25	<25	<25	<25	<25	
09/02/2004	<1,000	<200	660	<5.0	<5.0	<5.0	<5.0	<5.0	
11/04/2004	<2,000	<400	580	<10	<10	<10	<10	<10	
02/08/2005	<2,000	<400	610	<10	<10	<10	<10	<10	
05/09/2005	<1,000	<200	620	<5.0	<5.0	<5.0	<5.0	<5.0	a
08/11/2005	<500	250	390	<2.5	<2.5	2.6	<2.5	<2.5	a
11/18/2005	<500	<100	340	<2.5	<2.5	<2.5	<2.5	<2.5	a
02/16/2006	<1,500	<100	340	<2.5	<2.5	<2.5	<2.5	<2.5	
5/30/2006	<1,500	<100	420	<2.5	<2.5	<2.5	<2.5	<2.5	a
8/24/2006	<3,000	<200	180	<5.0	<5.0	<5.0	<5.0	<5.0	
11/1/2006	<3,000	<200	220	<5.0	<5.0	<5.0	<5.0	<5.0	a
2/7/2007	<3,000	<200	190	<5.0	<5.0	<5.0	<5.0	<5.0	
<b>MW-2</b>									
5/23/2003	<100	<20	55	<0.50	<0.50	0.53	--	--	
02/02/2004	<100	<20	37	<0.50	<0.50	<0.50	<0.50	<0.50	
09/02/2004	<500	<100	67	<2.5	<2.5	<2.5	<2.5	<2.5	
02/08/2005	<100	<20	30	<0.50	<0.50	<0.50	<0.50	<0.50	
08/11/2005	<100	<20	35	<0.50	<0.50	<0.50	<0.50	<0.50	a
02/16/2006	<300	<20	39	<0.50	<0.50	<0.50	<0.50	<0.50	
8/24/2006	<300	<20	25	<0.50	<0.50	<0.50	<0.50	<0.50	
2/7/2007	<300	<20	7.2	<0.50	<0.50	<0.50	<0.50	<0.50	
<b>MW-3</b>									
5/23/2003	<100	<20	1.6	<0.50	<0.50	<0.50	--	--	
09/02/2004	<100	<20	6.5	<0.50	<0.50	<0.50	<0.50	<0.50	
08/11/2005	<100	<20	11	<0.50	<0.50	<0.50	<0.50	<0.50	a
8/24/2006	<300	<20	7.6	<0.50	<0.50	<0.50	<0.50	<0.50	
<b>MW-4</b>									
5/23/2003	<10,000	<2,000	<50	<50	<50	<50	--	--	

Table 2. Summary of Fuel Additives Analytical Data  
 Station #374, 6407 Telegraph Ave., Oakland, CA

Well and Sample Date	Concentrations in (µg/L)								Comments
	Ethanol	TBA	MTBE	DIPE	ETBE	TAME	1,2-DCA	EDB	
<b>MW-4 Cont.</b>									
02/02/2004	<500	<100	29	<2.5	<2.5	2.6	<2.5	<2.5	
09/02/2004	<200	<40	28	<1.0	<1.0	<1.0	<1.0	<1.0	
02/08/2005	<5,000	<1,000	45	<25	<25	<25	<25	<25	
08/11/2005	<2,000	<400	32	<10	<10	<10	<10	<10	
02/16/2006	<6,000	<400	35	<10	<10	<10	<10	<10	
8/24/2006	<1,500	<100	39	<2.5	<2.5	<2.5	<2.5	<2.5	
2/7/2007	<6,000	<400	67	<10	<10	<10	<10	<10	
<b>MW-5</b>									
1/29/2003	<40	<20	<0.50	<0.50	<0.50	<0.50	--	--	
5/23/2003	<100	<20	<0.50	<0.50	<0.50	<0.50	--	--	
9/4/2003	<100	<20	<0.50	<0.50	<0.50	<0.50	<0.50	<0.50	
09/02/2004	<100	<20	<0.50	<0.50	<0.50	<0.50	<0.50	<0.50	
08/11/2005	<100	<20	<0.50	<0.50	<0.50	<0.50	<0.50	<0.50	
8/24/2006	<300	<20	<0.50	<0.50	<0.50	<0.50	<0.50	<0.50	
<b>MW-6</b>									
5/23/2003	<100	<20	9.4	<0.50	<0.50	<0.50	--	--	
08/11/2005	<100	<20	7.9	<0.50	<0.50	<0.50	<0.50	<0.50	a
8/24/2006	<300	<20	12	<0.50	<0.50	<0.50	<0.50	<0.50	



SYMBOLS AND ABBREVIATIONS:

-- = Not analyzed/applicable/measured/available

< = Not detected at or above the laboratory reporting limit

1,2-DCA = 1,2-Dichloroethane

DIPE = Di-isopropyl ether

EDB = 1,2-Dibromoethane

ETBE = Ethyl tert-butyl ether

MTBE = Methyl tert-butyl ether

TAME = tert-Amyl methyl ether

TBA = tert-Butyl alcohol

µg/L = Micrograms per Liter

FOOTNOTES:

a = The continuing calibration verification for ethanol was outside of client contractual limits, however, it was within method acceptance limits. The data should still be useful for its intended purpose.

NOTES:

All volatile organic compounds analyzed using EPA Method 8260B.

Note: The data within this table collected prior to April 2006 was provided to Broadbent & Associates, Inc. by Atlantic Richfield Company and their previous consultants. Broadbent & Associates, Inc. has not verified the accuracy of this information.

**Table 3. Historical Ground-Water Flow Direction and Gradient**  
**Station #374, 6407 Telegraph Ave., Oakland, CA**

Date Sampled	Approximate Flow Direction	Approximate Hydraulic Gradient
1/31/1996	Southwest	0.04
4/10/1996	Southwest	0.04
7/16/1996	Southwest	0.03
10/14/1996	Southwest	0.03
3/27/1997	Southwest	0.04
5/27/1997	Southwest	0.03
8/12/1997	Southwest	0.04
11/17/1997	Southwest	0.03
3/16/1998	Southwest	0.03
5/12/1998	Southwest	0.04
7/27/1998	Southwest	0.04
10/15/1998	Southwest	0.02
2/18/1999	Southwest	0.05
5/24/1999	Southwest	0.03
8/27/1999	Southwest	0.03
10/26/1999	Southwest	0.03
2/3/2000	Southwest	0.047
6/20/2000	Southwest	0.035
9/28/2000	Southwest	0.034
12/17/2000	Southwest	0.032
3/23/2001	Southwest	0.034
6/21/2001	Southwest	0.032
9/23/2001	Southwest	0.029
12/31/2001	Southwest	0.043
3/21/2002	Southwest	0.038
4/17/2002	Southwest	0.031
8/12/2002	Southwest	0.032
12/6/2002	Southwest	0.020
1/29/2003	Southwest	0.027
5/23/2003	Southwest	0.039
9/4/2003	Southwest	0.033
11/20/2003	Southwest	0.029
2/2/2004	Southwest	0.043 (a)
5/14/2004	Southwest	0.037 (a)
9/2/2004	Southwest	0.027 (a)
11/4/2004	Southwest	0.034 (a)
2/8/2005	Southwest	0.061 (a)
5/9/2005	Southwest	0.08 (a)
8/11/2005	Southwest	0.06 (n)
11/18/2005	Southwest	0.07 (n)
2/16/2006	Southwest	0.09 (n)
5/30/2006	Southwest	0.06 (n)

**Table 3. Historical Ground-Water Flow Direction and Gradient  
Station #374, 6407 Telegraph Ave., Oakland, CA**

Date Sampled	Approximate Flow Direction	Approximate Hydraulic Gradient
8/24/2006	Southwest	0.03
11/1/2006	Southwest	0.02
2/7/2007	Southwest	0.03

a = Gradients potentially suspect due to error in MW-4 and MW-5 TOC measuring point elevations discovered third quarter 2006.

Note: The data within this table collected prior to April 2006 was provided to Broadbent & Associates, Inc. by Atlantic Richfield Company and their previous consultants. Broadbent & Associates, Inc. has not verified the accuracy of this information.

**APPENDIX A**

**STRATUS GROUND-WATER SAMPLING DATA PACKAGE  
(INCLUDES FIELD DATA SHEETS AND LABORATORY ANALYTICAL REPORT  
WITH CHAIN-OF-CUSTODY DOCUMENTATION)**

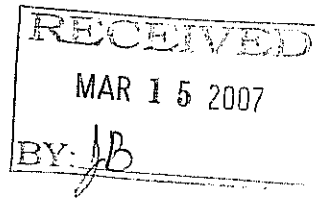

3330 Cameron Park Drive, Ste 550  
Cameron Park, California 95682  
(530) 676-6004 ~ Fax: (530) 676-6005

March 6, 2007

Mr. Rob Miller  
Broadbent & Associates, Inc.  
2000 Kirman Avenue  
Reno, NV 89502

Re: Groundwater Sampling Data Package, BP Service Station No. 374, located at 6407  
Telegraph Avenue, Oakland, California (Quarterly Monitoring performed on  
February 7, 2007)

### **General Information**

*Data Submittal Prepared / Reviewed by:* Sandy Hayes / Jay Johnson

*Phone Number:* (530) 676-6000

*On-Site Supplier Representative:* Jerry Gonzales

*Date:* February 7, 2007

*Arrival:* 13:00                      *Departure:* 14:10

*Weather Conditions:* Clear

*Unusual Field Conditions:* None

*Scope of Work Performed:* Quarterly monitoring and sampling

*Variations from Work Scope:* None noted

This submittal presents the tabulation of data collected in association with routine groundwater monitoring. The attachments include field data sheets, chain of custody documentation, and certified analytical results. The information is being provided to BP-ARCO's Scoping Supplier for use in preparing a report for regulatory submittal. This submittal is limited to presentation of collected data and does not include data interpretation or conclusions or recommendations. Any questions concerning this submittal should be addressed to the Preparer/Reviewer identified above.

Sincerely,

**STRATUS ENVIRONMENTAL, INC.**

Jay R. Johnson, P.G.  
Project Manager



**Attachments:**

- Field Data Sheets
- Chain of Custody Documentation
- Certified Analytical Results

CC: Mr. Paul Supple, BP/ARCO

**BP ALAMEDA PORTFOLIO**  
**HYDROLOGIC DATA SHEET**

Gauge Date: 2/7/07

Project Name: Oakland - 6407 Telegraph Ave.

Field Technician: Jerry

Project Number: 374

TOC = Top of Well Casing Elevation  
DTP = Depth to Free Product (FP or NAPL) Below TOC  
DTW = Depth to Groundwater Below TOC  
DTB = Depth to Bottom of Well Casing Below TOC

DIA = Well Casing Diameter  
ELEV = Groundwater Elevation  
DUP = Duplicate

WELL OR LOCATION	TIME	MEASUREMENT						PURGE & SAMPLE	SHEEN CONFIRMATION (w/bailer)	COMMENTS
		TOC	DTP	DTW	DTB	DIA	ELEV			
MW-1	13:02			7.40	26.55	4"		Yes		
MW-2	12:58			7.88	26.15	4"		Yes		
MW-3	12:45			6.90	26.65	4"				
MW-4	12:54			8.02	26.80	4"		Yes		
MW-5	12:50			8.25	22.95	4"				
MW-6	12:40			5.00	14.45	4"				

# BP ALAMEDA PORTFOLIO

## WATER SAMPLE FIELD DATA SHEET

PROJECT #: 374 PURGED BY: Jo WELL ID.: MW-1  
 CLIENT NAME: \_\_\_\_\_ SAMPLED BY: Jo SAMPLE I.D.: MW-1  
 LOCATION: Oakland - 6407 Telegraph Ave. QA SAMPLES: \_\_\_\_\_

DATE PURGED 2-7-07 START (2400hr) 13:14 END (2400hr) 13:19  
 DATE SAMPLED 2-7-07 SAMPLE TIME (2400hr) 13:15  
 SAMPLE TYPE: Groundwater  Surface Water \_\_\_\_\_ Treatment Effluent \_\_\_\_\_ Other \_\_\_\_\_

CASING DIAMETER: 2" \_\_\_\_\_ 3" \_\_\_\_\_ 4"  5" \_\_\_\_\_ 6" \_\_\_\_\_ 8" \_\_\_\_\_ Other \_\_\_\_\_  
 Casing Volume: (gallons per foot) (0.17) (0.38) (0.67) (1.02) (1.50) (2.60) ( )

DEPTH TO BOTTOM (feet) = 26.55 CASING VOLUME (gal) = \_\_\_\_\_  
 DEPTH TO WATER (feet) = 7.40 CALCULATED PURGE (gal) = 118  
 WATER COLUMN HEIGHT (feet) = 19.1 ACTUAL PURGE (gal) = 118

### FIELD MEASUREMENTS

DATE	TIME (2400hr)	VOLUME (gal)	TEMP. (degrees F)	CONDUCTIVITY (umhos/cm)	pH (units)	COLOR (visual)	TURBIDITY (NTU)
<u>2-7-07</u>	<u>13:16</u>	<u>0</u>	<u>17.2</u>	<u>878</u>	<u>7.45</u>	<u>Clear</u>	_____
_____	_____	_____	_____	_____	_____	_____	_____
_____	_____	_____	_____	_____	_____	_____	_____
_____	_____	_____	_____	_____	_____	_____	_____
_____	_____	_____	_____	_____	_____	_____	_____
_____	_____	_____	_____	_____	_____	_____	_____
_____	_____	_____	_____	_____	_____	_____	_____
_____	_____	_____	_____	_____	_____	_____	_____
_____	_____	_____	_____	_____	_____	_____	_____
_____	_____	_____	_____	_____	_____	_____	_____

SAMPLE INFORMATION

SAMPLE DEPTH TO WATER: 7.40 SAMPLE TURBIDITY: \_\_\_\_\_

80% RECHARGE:  YES  NO ANALYSES: \_\_\_\_\_  
 ODOR: No SAMPLE VESSEL / PRESERVATIVE: 3 Vol. HCL

PURGING EQUIPMENT

Bladder Pump  
 Centrifugal Pump  
 Submersible Pump  
 Peristaltic Pump  
 Other: \_\_\_\_\_  
 Pump Depth: None

Bailer (Teflon)  
 Bailer (PVC)  
 Bailer (Stainless Steel)  
 Dedicated \_\_\_\_\_

SAMPLING EQUIPMENT

Bladder Pump  
 Centrifugal Pump  
 Submersible Pump  
 Peristaltic Pump  
 Other: \_\_\_\_\_

Bailer (Teflon)  
 Bailer ( \_\_\_\_\_ PVC or  disposable)  
 Bailer (Stainless Steel)  
 Dedicated \_\_\_\_\_

WELL INTEGRITY: D.O. - 7.88 LOCK#: Master

REMARKS: \_\_\_\_\_  
 \_\_\_\_\_  
 \_\_\_\_\_

SIGNATURE: [Signature] Page \_\_\_\_\_ of \_\_\_\_\_



**BP ALAMEDA PORTFOLIO**  
**WATER SAMPLE FIELD DATA SHEET**

PROJECT #: 374 PURGED BY: JG WELL I.D.: MW-2  
 CLIENT NAME: \_\_\_\_\_ SAMPLED BY: JG SAMPLE I.D.: MW-2  
 LOCATION: Oakland - 6407 Telegraph Ave. QA SAMPLES: \_\_\_\_\_

DATE PURGED 2/7/07 START (2400hr) 1329 END (2400hr) 1332  
 DATE SAMPLED 2/7/07 SAMPLE TIME (2400hr) 13:30  
 SAMPLE TYPE: Groundwater  Surface Water \_\_\_\_\_ Treatment Effluent \_\_\_\_\_ Other \_\_\_\_\_

CASING DIAMETER: 2" \_\_\_\_\_ 3" \_\_\_\_\_ 4"  5" \_\_\_\_\_ 6" \_\_\_\_\_ 8" \_\_\_\_\_ Other \_\_\_\_\_  
 Casing Volume: (gallons per foot) (0.17) (0.38) (0.67) (1.02) (1.50) (2.60) ( )

DEPTH TO BOTTOM (feet) = 26.15 CASING VOLUME (gal) = \_\_\_\_\_  
 DEPTH TO WATER (feet) = 7.88 CALCULATED PURGE (gal) = AD  
 WATER COLUMN HEIGHT (feet) = 18.2 ACTUAL PURGE (gal) = AD

FIELD MEASUREMENTS

DATE	TIME (2400hr)	VOLUME (gal)	TEMP. (degrees F)	CONDUCTIVITY (umhos/cm)	pH (units)	COLOR (visual)	TURBIDITY (NTU)
<u>2/7/07</u>	<u>13:31</u>	<u>0</u>	<u>18.4</u>	<u>584</u>	<u>7.39</u>	<u>clear</u>	

SAMPLE DEPTH TO WATER: 7.88 SAMPLE INFORMATION SAMPLE TURBIDITY: clear

80% RECHARGE:  YES  NO ANALYSES: see work order  
 ODOR: No SAMPLE VESSEL / PRESERVATIVE: \_\_\_\_\_

**PURGING EQUIPMENT**  
 Bladder Pump  Bailer (Teflon)  
 Centrifugal Pump  Bailer (PVC)  
 Submersible Pump  Bailer (Stainless Steel)  
 Peristaltic Pump  Dedicated \_\_\_\_\_  
 Other: \_\_\_\_\_  
 Pump Depth: none

**SAMPLING EQUIPMENT**  
 Bladder Pump  Bailer (Teflon)  
 Centrifugal Pump  Bailer (  PVC or  disposable)  
 Submersible Pump  Bailer (Stainless Steel)  
 Peristaltic Pump  Dedicated \_\_\_\_\_  
 Other: \_\_\_\_\_

WELL INTEGRITY: good LOCK#: M0579

REMARKS: DO 0.94

SIGNATURE: [Signature] Page \_\_\_ of \_\_\_

**BP ALAMEDA PORTFOLIO**  
**WATER SAMPLE FIELD DATA SHEET**

PROJECT #: 374 PURGED BY: JG WELL I.D.: MW-4  
 CLIENT NAME: \_\_\_\_\_ SAMPLED BY: JG SAMPLE I.D.: MW-4  
 LOCATION: Oakland - 6407 Telegraph Ave. QA SAMPLES: \_\_\_\_\_

DATE PURGED 2/9/07 START (2400hr) 13:44 END (2400hr) 1349  
 DATE SAMPLED 2/7/07 SAMPLE TIME (2400hr) 1345  
 SAMPLE TYPE: Groundwater  Surface Water \_\_\_\_\_ Treatment Effluent \_\_\_\_\_ Other \_\_\_\_\_

CASING DIAMETER: 2" \_\_\_\_\_ 3" \_\_\_\_\_ 4"  5" \_\_\_\_\_ 6" \_\_\_\_\_ 8" \_\_\_\_\_ Other \_\_\_\_\_  
 Casing Volume: (gallons per foot) (0.17) (0.38) (0.67) (1.02) (1.50) (2.60) ( )

DEPTH TO BOTTOM (feet) = 26.80 CASING VOLUME (gal) = \_\_\_\_\_  
 DEPTH TO WATER (feet) = 8.02 CALCULATED PURGE (gal) = \_\_\_\_\_  
 WATER COLUMN HEIGHT (feet) = 18.7 ACTUAL PURGE (gal) = NP

FIELD MEASUREMENTS

DATE	TIME (2400hr)	VOLUME (gal)	TEMP. (degrees F)	CONDUCTIVITY (umhos/cm)	pH (units)	COLOR (visual)	TURBIDITY (NTU)
<u>2/7/07</u>	<u>1346</u>	<u>0</u>	<u>17.1</u>	<u>690</u>	<u>7.07</u>	<u>clear</u>	_____
_____	_____	_____	_____	_____	_____	_____	_____
_____	_____	_____	_____	_____	_____	_____	_____
_____	_____	_____	_____	_____	_____	_____	_____
_____	_____	_____	_____	_____	_____	_____	_____
_____	_____	_____	_____	_____	_____	_____	_____
_____	_____	_____	_____	_____	_____	_____	_____
_____	_____	_____	_____	_____	_____	_____	_____

SAMPLE INFORMATION

SAMPLE DEPTH TO WATER: 8.02 SAMPLE TURBIDITY: clear

80% RECHARGE:  YES  NO ANALYSES: see work order

ODOR: no SAMPLE VESSEL / PRESERVATIVE: 3 VOA-HCL

PURGING EQUIPMENT

\_\_\_\_\_ Bladder Pump \_\_\_\_\_ Bailer (Teflon)  
 \_\_\_\_\_ Centrifugal Pump  Bailer (PVC)  
 \_\_\_\_\_ Submersible Pump \_\_\_\_\_ Bailer (Stainless Steel)  
 \_\_\_\_\_ Peristaltic Pump \_\_\_\_\_ Dedicated \_\_\_\_\_

Other: \_\_\_\_\_

Pump Depth: N/A

SAMPLING EQUIPMENT

\_\_\_\_\_ Bladder Pump \_\_\_\_\_ Bailer (Teflon)  
 \_\_\_\_\_ Centrifugal Pump  Bailer ( \_\_\_\_\_ PVC or  disposable)  
 \_\_\_\_\_ Submersible Pump \_\_\_\_\_ Bailer (Stainless Steel)  
 \_\_\_\_\_ Peristaltic Pump \_\_\_\_\_ Dedicated \_\_\_\_\_

Other: \_\_\_\_\_

WELL INTEGRITY: good LOCK#: MRSTER

REMARKS: D.O. 0.95

SIGNATURE: [Signature]





bp  
A BP affiliated company

### Chain of Custody Record

Project Name: BP 374  
 BP BU/AR Region/Enfos Segment: BP > Americas > West > Retail > CA > Alameda > 374  
 State or Lead Regulatory Agency: \_\_\_\_\_  
 Requested Due Date (mm/dd/yy): \_\_\_\_\_

On-site Time: <u>1300</u>	Temp: <u>COOL</u>
Off-site Time: <u>1410</u>	Temp: <u>COOL</u>
Sky Conditions: <u>clear</u>	
Meteorological Events: <u>None</u>	
Wind Speed: <u>0</u>	Direction: <u>sta</u>

Lab Name: <u>TestAmerica</u>	BP/AR Facility No.: <u>374</u>	Consultant/Contractor: <u>Stratus Environmental, Inc.</u>
Address: <u>885 Jarvis Drive</u>	BP/AR Facility Address: <u>6407 Telegraph Ave., Oakland</u>	Address: <u>3330 Cameron Park Drive, Suite 550</u>
<u>Morgan Hill, CA 95937</u>	Site Lat/Long:	<u>Cameron Park, CA 95682</u>
Lab PM: <u>Lisa Race</u>	California Global ID #: <u>T0600100106</u>	Consultant/Contractor Project No.:
Tele/Fax: <u>408-782-8156 408-782-6308 (fax)</u>	Enfos Project No.: <u>G0C21-0015</u>	Consultant/Contractor PM: <u>Jay Johnson</u>
BP/AR PM Contact: <u>Paul Supple</u>	Provision or RCOP (circle one) <u>Provision</u>	Tele/Fax: <u>(530) 676-6000 / (530) 676-6005</u>
Address: <u>2010 Crow Canyon Place, Suite 150</u>	Phase/WBS: <u>04-Monitoring</u>	Report Type & QC Level: <u>Level 1 with EDF</u>
<u>San Ramon, CA</u>	Sub Phase/Task: <u>03-Analytical</u>	E-mail EDD To: <u>cjewitt@stratusinc.net</u>
Tele/Fax: <u>925-275-3506</u>	Cost Element: <u>01-Contractor labor</u>	Invoice to: <u>Atlantic Richfield Co.</u>

Item No.	Sample Description	Time	Date	Matrix			Laboratory No.	No. of Containers	Preservative					Requested Analysis					Sample Point Lat/Long and Comments *Oxy = MTBD, TAME, ETBE, DIPE, TBA					
				Soil/Solid	Water/Liquid	Air			Unpreserved	H <sub>2</sub> SO <sub>4</sub>	HNO <sub>3</sub>	HCl	Methanol	GRO/BTEX/Oxy*	1,2 DCA	Ethanol	EDB	DRO						
1	MW-1	1315	2/7/07	X				3						X	X	X	X							
2	MW-2	1330		X				3						X	X	X	X							
3	MW-4	1345		X				6						X	X	X	X							
4	TB 374 020707	500		X				2						X	X	X	X							HOLD
5																								
6																								
7																								
8																								
9																								
10																								

Sampler's Name: <u>Jerry Gonzalez</u>	Relinquished By / Affiliation: <u>Jerry Gonzalez</u>	Date: <u>2/9/07</u>	MT Time: <u>2:19 1655</u>	Accepted By / Affiliation: <u>[Signature] / TA-SAE</u>	Date: <u>2/9/07</u>	Time: <u>1655</u>
Sampler's Company: <u>DOWLOS</u>						
Shipment Date:						
Shipment Method:						
Shipment Tracking No:						

Special Instructions: Please cc results to: rmiller@broadbentinc.com

Custody Seals In Place: Yes / No | Temp Blank: Yes / No | Cooler Temp on Receipt: °F/C | Trip Blank: Yes / No | MS/MSD Sample Submitted: Yes / No

26 February, 2007

Jay Johnson  
Stratus Environmental Inc. [Arco]  
3330 Cameron Park Dr., Suite 550  
Cameron Park, CA 95682

RE: ARCO #0374, Oakland, CA  
Work Order: MQB0413

Enclosed are the results of analyses for samples received by the laboratory on 02/13/07 07:55. If you have any questions concerning this report, please feel free to contact me.

Sincerely,



Lisa Race  
Senior Project Manager

CA ELAP Certificate # 1210

The results in this laboratory report pertain only to the samples tested in the laboratory. The analyses contained in this report were performed in accordance with the BPGCLN Technical Specifications, applicable Federal, State, local regulations and certification requirements as well as the methodologies as described in laboratory SOPs reviewed by the BPGCLN. This entire report was reviewed and approved for release.

Stratus Environmental Inc. [Arco] 3330 Cameron Park Dr., Suite 550 Cameron Park CA, 95682	Project: ARCO #0374, Oakland, CA Project Number: G0C21-0015 Project Manager: Jay Johnson	MQB0413 Reported: 02/26/07 15:34
---	--	--

ANALYTICAL REPORT FOR SAMPLES

Sample ID	Laboratory ID	Matrix	Date Sampled	Date Received
MW-1	MQB0413-01	Water	02/07/07 13:15	02/13/07 07:55
MW-2	MQB0413-02	Water	02/07/07 13:30	02/13/07 07:55
MW-4	MQB0413-03	Water	02/07/07 13:45	02/13/07 07:55
TB 374 020707	MQB0413-04	Water	02/07/07 05:00	02/13/07 07:55

The carbon range for the TPH-GRO has been changed from C6-C10 to C4-C12. The carbon range for TPH-DRO has been changed from C10-C28 to C10-C36. EPA 8015B has been modified to better meet the requirements of California regulatory agencies. These samples were received with intact custody seals.

Stratus Environmental Inc. [Arco]  
3330 Cameron Park Dr., Suite 550  
Cameron Park CA, 95682

Project: ARCO #0374, Oakland, CA  
Project Number: G0C21-0015  
Project Manager: Jay Johnson

MQB0413  
Reported:  
02/26/07 15:34

**Total Purgeable Hydrocarbons by GC/MS (CA LUFT)**  
**TestAmerica - Morgan Hill, CA**

Analyte	Result	Reporting Limit	Units	Dilution	Batch	Prepared	Analyzed	Method	Notes
<b>MW-1 (MQB0413-01) Water</b> Sampled: 02/07/07 13:15 Received: 02/13/07 07:55									
Gasoline Range Organics (C4-C12)	120	50	ug/l	1	7B19001	02/19/07	02/19/07	LUFT GCMS	PV
Surrogate: 1,2-Dichloroethane-d4		97 %	60-145		"	"	"	"	
<b>MW-2 (MQB0413-02) Water</b> Sampled: 02/07/07 13:30 Received: 02/13/07 07:55									
Gasoline Range Organics (C4-C12)	ND	50	ug/l	1	7B17001	02/17/07	02/17/07	LUFT GCMS	
Surrogate: 1,2-Dichloroethane-d4		99 %	60-145		"	"	"	"	
<b>MW-4 (MQB0413-03) Water</b> Sampled: 02/07/07 13:45 Received: 02/13/07 07:55									
Gasoline Range Organics (C4-C12)	3100	1000	ug/l	20	7B19004	02/19/07	02/19/07	LUFT GCMS	
Surrogate: 1,2-Dichloroethane-d4		102 %	60-145		"	"	"	"	

Stratus Environmental Inc. [Arco]  
3330 Cameron Park Dr., Suite 550  
Cameron Park CA, 95682

Project: ARCO #0374, Oakland, CA  
Project Number: G0C21-0015  
Project Manager: Jay Johnson

MQB0413  
Reported:  
02/26/07 15:34

**Volatile Organic Compounds by EPA Method 8260B**  
**TestAmerica - Morgan Hill, CA**

Analyte	Result	Reporting Limit	Units	Dilution	Batch	Prepared	Analyzed	Method	Notes
---------	--------	-----------------	-------	----------	-------	----------	----------	--------	-------

**MW-1 (MQB0413-01) Water** Sampled: 02/07/07 13:15 Received: 02/13/07 07:55

tert-Amyl methyl ether	ND	5.0	ug/l	10	7B17001	02/17/07	02/17/07	EPA 8260B	
Benzene	ND	5.0	"	"	"	"	"	"	
tert-Butyl alcohol	ND	200	"	"	"	"	"	"	
Di-isopropyl ether	ND	5.0	"	"	"	"	"	"	
1,2-Dibromoethane (EDB)	ND	5.0	"	"	"	"	"	"	
1,2-Dichloroethane	ND	5.0	"	"	"	"	"	"	
Ethanol	ND	3000	"	"	"	"	"	"	
Ethyl tert-butyl ether	ND	5.0	"	"	"	"	"	"	
Ethylbenzene	ND	5.0	"	"	"	"	"	"	
<b>Methyl tert-butyl ether</b>	<b>190</b>	5.0	"	"	"	"	"	"	
Toluene	ND	5.0	"	"	"	"	"	"	
Xylenes (total)	ND	5.0	"	"	"	"	"	"	

<i>Surrogate: Dibromofluoromethane</i>		105 %	75-130	"	"	"	"	"	
<i>Surrogate: 1,2-Dichloroethane-d4</i>		106 %	60-145	"	"	"	"	"	
<i>Surrogate: Toluene-d8</i>		93 %	70-130	"	"	"	"	"	
<i>Surrogate: 4-Bromofluorobenzene</i>		92 %	60-120	"	"	"	"	"	

**MW-2 (MQB0413-02) Water** Sampled: 02/07/07 13:30 Received: 02/13/07 07:55

tert-Amyl methyl ether	ND	0.50	ug/l	1	7B17001	02/17/07	02/17/07	EPA 8260B	
<b>Benzene</b>	<b>0.50</b>	0.50	"	"	"	"	"	"	
tert-Butyl alcohol	ND	20	"	"	"	"	"	"	
Di-isopropyl ether	ND	0.50	"	"	"	"	"	"	
1,2-Dibromoethane (EDB)	ND	0.50	"	"	"	"	"	"	
1,2-Dichloroethane	ND	0.50	"	"	"	"	"	"	
Ethanol	ND	300	"	"	"	"	"	"	
Ethyl tert-butyl ether	ND	0.50	"	"	"	"	"	"	
Ethylbenzene	ND	0.50	"	"	"	"	"	"	
<b>Methyl tert-butyl ether</b>	<b>7.2</b>	0.50	"	"	"	"	"	"	
Toluene	ND	0.50	"	"	"	"	"	"	
Xylenes (total)	ND	0.50	"	"	"	"	"	"	

<i>Surrogate: Dibromofluoromethane</i>		104 %	75-130	"	"	"	"	"	
<i>Surrogate: 1,2-Dichloroethane-d4</i>		99 %	60-145	"	"	"	"	"	
<i>Surrogate: Toluene-d8</i>		96 %	70-130	"	"	"	"	"	
<i>Surrogate: 4-Bromofluorobenzene</i>		86 %	60-120	"	"	"	"	"	



Stratus Environmental Inc. [Arco]  
3330 Cameron Park Dr., Suite 550  
Cameron Park CA, 95682

Project: ARCO #0374, Oakland, CA  
Project Number: G0C21-0015  
Project Manager: Jay Johnson

MQB0413  
Reported:  
02/26/07 15:34

**Volatile Organic Compounds by EPA Method 8260B**  
**TestAmerica - Morgan Hill, CA**

Analyte	Result	Reporting Limit	Units	Dilution	Batch	Prepared	Analyzed	Method	Notes
---------	--------	-----------------	-------	----------	-------	----------	----------	--------	-------

MW-4 (MQB0413-03) Water Sampled: 02/07/07 13:45 Received: 02/13/07 07:55

tert-Amyl methyl ether	ND	10	ug/l	20	7B19004	02/19/07	02/19/07	EPA 8260B	
<b>Benzene</b>	<b>570</b>	10	"	"	"	"	"	"	
tert-Butyl alcohol	ND	400	"	"	"	"	"	"	
Di-isopropyl ether	ND	10	"	"	"	"	"	"	
1,2-Dibromoethane (EDB)	ND	10	"	"	"	"	"	"	
1,2-Dichloroethane	ND	10	"	"	"	"	"	"	
Ethanol	ND	6000	"	"	"	"	"	"	
Ethyl tert-butyl ether	ND	10	"	"	"	"	"	"	
<b>Ethylbenzene</b>	<b>170</b>	10	"	"	"	"	"	"	
Methyl tert-butyl ether	<b>67</b>	10	"	"	"	"	"	"	
<b>Toluene</b>	<b>17</b>	10	"	"	"	"	"	"	
<b>Xylenes (total)</b>	<b>110</b>	10	"	"	"	"	"	"	
<i>Surrogate: Dibromofluoromethane</i>		98 %		75-130	"	"	"	"	
<i>Surrogate: 1,2-Dichloroethane-d4</i>		102 %		60-145	"	"	"	"	
<i>Surrogate: Toluene-d8</i>		98 %		70-130	"	"	"	"	
<i>Surrogate: 4-Bromofluorobenzene</i>		98 %		60-120	"	"	"	"	

Stratus Environmental Inc. [Arco]  
3330 Cameron Park Dr., Suite 550  
Cameron Park CA, 95682

Project: ARCO #0374, Oakland, CA  
Project Number: G0C21-0015  
Project Manager: Jay Johnson

MQB0413  
Reported:  
02/26/07 15:34

**Total Purgeable Hydrocarbons by GC/MS (CA LUFT) - Quality Control**  
**TestAmerica - Morgan Hill, CA**

Analyte	Result	Reporting Limit	Units	Spike Level	Source Result	%REC	%REC Limits	RPD	RPD Limit	Notes
---------	--------	-----------------	-------	-------------	---------------	------	-------------	-----	-----------	-------

**Batch 7B17001 - EPA 5030B P/T / LUFT GCMS**

<b>Blank (7B17001-BLK1)</b> Prepared & Analyzed: 02/17/07										
Gasoline Range Organics (C4-C12)	ND	50	ug/l							
Surrogate: 1,2-Dichloroethane-d4	2.54		"	2.50		102	60-145			
<b>Laboratory Control Sample (7B17001-BS2)</b> Prepared & Analyzed: 02/17/07										
Gasoline Range Organics (C4-C12)	536	50	ug/l	500		107	75-140			
Surrogate: 1,2-Dichloroethane-d4	2.70		"	2.50		108	60-145			
<b>Laboratory Control Sample Dup (7B17001-BSD2)</b> Prepared & Analyzed: 02/17/07										
Gasoline Range Organics (C4-C12)	503	50	ug/l	500		101	75-140	6	20	
Surrogate: 1,2-Dichloroethane-d4	2.68		"	2.50		107	60-145			

**Batch 7B19001 - EPA 5030B P/T / LUFT GCMS**

<b>Blank (7B19001-BLK1)</b> Prepared & Analyzed: 02/19/07										
Gasoline Range Organics (C4-C12)	ND	50	ug/l							
Surrogate: 1,2-Dichloroethane-d4	2.36		"	2.50		94	60-145			
<b>Laboratory Control Sample (7B19001-BS2)</b> Prepared & Analyzed: 02/19/07										
Gasoline Range Organics (C4-C12)	511	50	ug/l	500		102	75-140			
Surrogate: 1,2-Dichloroethane-d4	2.39		"	2.50		96	60-145			
<b>Laboratory Control Sample Dup (7B19001-BSD2)</b> Prepared & Analyzed: 02/19/07										
Gasoline Range Organics (C4-C12)	517	50	ug/l	500		103	75-140	1	20	
Surrogate: 1,2-Dichloroethane-d4	2.27		"	2.50		91	60-145			

**Batch 7B19004 - EPA 5030B P/T / LUFT GCMS**

<b>Blank (7B19004-BLK1)</b> Prepared & Analyzed: 02/19/07										
Gasoline Range Organics (C4-C12)	ND	50	ug/l							
Surrogate: 1,2-Dichloroethane-d4	2.74		"	2.50		110	60-145			

Stratus Environmental Inc. [Arco]  
3330 Cameron Park Dr., Suite 550  
Cameron Park CA, 95682

Project: ARCO #0374, Oakland, CA  
Project Number: G0C21-0015  
Project Manager: Jay Johnson

MQB0413  
Reported:  
02/26/07 15:34

**Total Purgeable Hydrocarbons by GC/MS (CA LUFT) - Quality Control  
TestAmerica - Morgan Hill, CA**

Analyte	Result	Reporting Limit	Units	Spike Level	Source Result	%REC	%REC Limits	RPD	RPD Limit	Notes
---------	--------	-----------------	-------	-------------	---------------	------	-------------	-----	-----------	-------

**Batch 7B19004 - EPA 5030B P/T / LUFT GCMS**

**Laboratory Control Sample (7B19004-BS2)**

Prepared & Analyzed: 02/19/07

Gasoline Range Organics (C4-C12)	473	50	ug/l	500		95	75-140			
Surrogate: 1,2-Dichloroethane-d4	2.61		"	2.50		104	60-145			

**Laboratory Control Sample Dup (7B19004-BSD2)**

Prepared & Analyzed: 02/19/07

Gasoline Range Organics (C4-C12)	463	50	ug/l	500		93	75-140	2	20	
Surrogate: 1,2-Dichloroethane-d4	2.74		"	2.50		110	60-145			

Stratus Environmental Inc. [Arco]  
3330 Cameron Park Dr., Suite 550  
Cameron Park CA, 95682

Project: ARCO #0374, Oakland, CA  
Project Number: G0C21-0015  
Project Manager: Jay Johnson

MQB0413  
Reported:  
02/26/07 15:34

**Volatile Organic Compounds by EPA Method 8260B - Quality Control**  
**TestAmerica - Morgan Hill, CA**

Analyte	Result	Reporting Limit	Units	Spike Level	Source Result	%REC	%REC Limits	RPD	RPD Limit	Notes
---------	--------	-----------------	-------	-------------	---------------	------	-------------	-----	-----------	-------

**Batch 7B17001 - EPA 5030B P/T / EPA 8260B**

**Blank (7B17001-BLK1)**

Prepared & Analyzed: 02/17/07

tert-Amyl methyl ether	ND	0.50	ug/l							
Benzene	ND	0.50	"							
tert-Butyl alcohol	ND	20	"							
Di-isopropyl ether	ND	0.50	"							
1,2-Dibromoethane (EDB)	ND	0.50	"							
1,2-Dichloroethane	ND	0.50	"							
Ethanol	ND	300	"							
Ethyl tert-butyl ether	ND	0.50	"							
Ethylbenzene	ND	0.50	"							
Methyl tert-butyl ether	ND	0.50	"							
Toluene	ND	0.50	"							
Xylenes (total)	ND	0.50	"							
<i>Surrogate: Dibromofluoromethane</i>	<i>2.50</i>		<i>"</i>	<i>2.50</i>		<i>100</i>	<i>75-130</i>			
<i>Surrogate: 1,2-Dichloroethane-d4</i>	<i>2.54</i>		<i>"</i>	<i>2.50</i>		<i>102</i>	<i>60-145</i>			
<i>Surrogate: Toluene-d8</i>	<i>2.40</i>		<i>"</i>	<i>2.50</i>		<i>96</i>	<i>70-130</i>			
<i>Surrogate: 4-Bromofluorobenzene</i>	<i>2.31</i>		<i>"</i>	<i>2.50</i>		<i>92</i>	<i>60-120</i>			

**Laboratory Control Sample (7B17001-BS1)**

Prepared & Analyzed: 02/17/07

tert-Amyl methyl ether	9.03	0.50	ug/l	10.0		90	65-135			
Benzene	8.99	0.50	"	10.0		90	70-125			
tert-Butyl alcohol	163	20	"	200		82	60-135			
Di-isopropyl ether	7.56	0.50	"	10.0		76	70-130			
1,2-Dibromoethane (EDB)	9.43	0.50	"	10.0		94	80-125			
1,2-Dichloroethane	9.36	0.50	"	10.0		94	75-125			
Ethanol	176	300	"	200		88	15-150			
Ethyl tert-butyl ether	8.23	0.50	"	10.0		82	65-130			
Ethylbenzene	9.07	0.50	"	10.0		91	70-130			
Methyl tert-butyl ether	8.19	0.50	"	10.0		82	50-140			
Toluene	8.51	0.50	"	10.0		85	70-120			
Xylenes (total)	26.3	0.50	"	30.0		88	80-125			
<i>Surrogate: Dibromofluoromethane</i>	<i>2.58</i>		<i>"</i>	<i>2.50</i>		<i>103</i>	<i>75-130</i>			
<i>Surrogate: 1,2-Dichloroethane-d4</i>	<i>2.52</i>		<i>"</i>	<i>2.50</i>		<i>101</i>	<i>60-145</i>			
<i>Surrogate: Toluene-d8</i>	<i>2.48</i>		<i>"</i>	<i>2.50</i>		<i>99</i>	<i>70-130</i>			
<i>Surrogate: 4-Bromofluorobenzene</i>	<i>2.49</i>		<i>"</i>	<i>2.50</i>		<i>100</i>	<i>60-120</i>			

Stratus Environmental Inc. [Arco]  
3330 Cameron Park Dr., Suite 550  
Cameron Park CA, 95682

Project: ARCO #0374, Oakland, CA  
Project Number: G0C21-0015  
Project Manager: Jay Johnson

MQB0413  
Reported:  
02/26/07 15:34

**Volatile Organic Compounds by EPA Method 8260B - Quality Control**  
**TestAmerica - Morgan Hill, CA**

Analyte	Result	Reporting Limit	Units	Spike Level	Source Result	%REC	%REC Limits	RPD	RPD Limit	Notes
---------	--------	-----------------	-------	-------------	---------------	------	-------------	-----	-----------	-------

**Batch 7B17001 - EPA 5030B P/T / EPA 8260B**

<b>Matrix Spike (7B17001-MS1)</b>	<b>Source: MQB0412-01</b>			<b>Prepared &amp; Analyzed: 02/17/07</b>						
tert-Amyl methyl ether	19.8	1.0	ug/l	20.0	ND	99	65-135			
Benzene	19.8	1.0	"	20.0	0.28	98	70-125			
tert-Butyl alcohol	392	40	"	400	45	87	60-135			
Di-isopropyl ether	15.7	1.0	"	20.0	ND	78	70-130			
1,2-Dibromoethane (EDB)	22.8	1.0	"	20.0	ND	114	80-125			
1,2-Dichloroethane	18.5	1.0	"	20.0	ND	92	75-125			
Ethanol	329	600	"	400	ND	82	15-150			
Ethyl tert-butyl ether	17.2	1.0	"	20.0	ND	86	65-130			
Ethylbenzene	24.0	1.0	"	20.0	5.2	94	70-130			
Methyl tert-butyl ether	29.4	1.0	"	20.0	13	82	50-140			
Toluene	19.9	1.0	"	20.0	0.88	95	70-120			
Xylenes (total)	59.0	1.0	"	60.0	1.3	96	80-125			
<i>Surrogate: Dibromofluoromethane</i>	<i>2.48</i>		<i>"</i>	<i>2.50</i>		<i>99</i>	<i>75-130</i>			
<i>Surrogate: 1,2-Dichloroethane-d4</i>	<i>2.35</i>		<i>"</i>	<i>2.50</i>		<i>94</i>	<i>60-145</i>			
<i>Surrogate: Toluene-d8</i>	<i>2.52</i>		<i>"</i>	<i>2.50</i>		<i>101</i>	<i>70-130</i>			
<i>Surrogate: 4-Bromofluorobenzene</i>	<i>2.61</i>		<i>"</i>	<i>2.50</i>		<i>104</i>	<i>60-120</i>			

<b>Matrix Spike Dup (7B17001-MSD1)</b>	<b>Source: MQB0412-01</b>			<b>Prepared &amp; Analyzed: 02/17/07</b>						
tert-Amyl methyl ether	20.1	1.0	ug/l	20.0	ND	100	65-135	2	25	
Benzene	20.3	1.0	"	20.0	0.28	100	70-125	2	15	
tert-Butyl alcohol	396	40	"	400	45	88	60-135	1	35	
Di-isopropyl ether	16.0	1.0	"	20.0	ND	80	70-130	2	35	
1,2-Dibromoethane (EDB)	22.8	1.0	"	20.0	ND	114	80-125	0	15	
1,2-Dichloroethane	18.6	1.0	"	20.0	ND	93	75-125	0.5	10	
Ethanol	342	600	"	400	ND	86	15-150	4	35	
Ethyl tert-butyl ether	18.3	1.0	"	20.0	ND	92	65-130	6	35	
Ethylbenzene	24.1	1.0	"	20.0	5.2	94	70-130	0.4	15	
Methyl tert-butyl ether	29.6	1.0	"	20.0	13	83	50-140	0.7	25	
Toluene	20.5	1.0	"	20.0	0.88	98	70-120	3	15	
Xylenes (total)	59.7	1.0	"	60.0	1.3	97	80-125	1	15	
<i>Surrogate: Dibromofluoromethane</i>	<i>2.47</i>		<i>"</i>	<i>2.50</i>		<i>99</i>	<i>75-130</i>			
<i>Surrogate: 1,2-Dichloroethane-d4</i>	<i>2.31</i>		<i>"</i>	<i>2.50</i>		<i>92</i>	<i>60-145</i>			
<i>Surrogate: Toluene-d8</i>	<i>2.54</i>		<i>"</i>	<i>2.50</i>		<i>102</i>	<i>70-130</i>			
<i>Surrogate: 4-Bromofluorobenzene</i>	<i>2.58</i>		<i>"</i>	<i>2.50</i>		<i>103</i>	<i>60-120</i>			

Stratus Environmental Inc. [Arco]  
3330 Cameron Park Dr., Suite 550  
Cameron Park CA, 95682

Project: ARCO #0374, Oakland, CA  
Project Number: G0C21-0015  
Project Manager: Jay Johnson

MQB0413  
Reported:  
02/26/07 15:34

**Volatile Organic Compounds by EPA Method 8260B - Quality Control**  
**TestAmerica - Morgan Hill, CA**

Analyte	Result	Reporting Limit	Units	Spike Level	Source Result	%REC	%REC Limits	RPD	RPD Limit	Notes
---------	--------	-----------------	-------	-------------	---------------	------	-------------	-----	-----------	-------

**Batch 7B19004 - EPA 5030B P/T / EPA 8260B**

**Blank (7B19004-BLK1)**

Prepared & Analyzed: 02/19/07

tert-Amyl methyl ether	ND	0.50	ug/l							
Benzene	ND	0.50	"							
tert-Butyl alcohol	ND	20	"							
Di-isopropyl ether	ND	0.50	"							
1,2-Dibromoethane (EDB)	ND	0.50	"							
1,2-Dichloroethane	ND	0.50	"							
Ethanol	ND	300	"							
Ethyl tert-butyl ether	ND	0.50	"							
Ethylbenzene	ND	0.50	"							
Methyl tert-butyl ether	ND	0.50	"							
Toluene	ND	0.50	"							
Xylenes (total)	ND	0.50	"							
<i>Surrogate: Dibromofluoromethane</i>	<i>2.46</i>		<i>"</i>	<i>2.50</i>		<i>98</i>	<i>75-130</i>			
<i>Surrogate: 1,2-Dichloroethane-d4</i>	<i>2.74</i>		<i>"</i>	<i>2.50</i>		<i>110</i>	<i>60-145</i>			
<i>Surrogate: Toluene-d8</i>	<i>2.44</i>		<i>"</i>	<i>2.50</i>		<i>98</i>	<i>70-130</i>			
<i>Surrogate: 4-Bromofluorobenzene</i>	<i>2.43</i>		<i>"</i>	<i>2.50</i>		<i>97</i>	<i>60-120</i>			

**Laboratory Control Sample (7B19004-BS1)**

Prepared & Analyzed: 02/19/07

tert-Amyl methyl ether	12.0	0.50	ug/l	10.0		120	65-135			
Benzene	11.3	0.50	"	10.0		113	70-125			
tert-Butyl alcohol	203	20	"	200		102	60-135			
Di-isopropyl ether	11.2	0.50	"	10.0		112	70-130			
1,2-Dibromoethane (EDB)	12.0	0.50	"	10.0		120	80-125			
1,2-Dichloroethane	12.0	0.50	"	10.0		120	75-125			
Ethanol	173	300	"	200		86	15-150			
Ethyl tert-butyl ether	11.3	0.50	"	10.0		113	65-130			
Ethylbenzene	11.3	0.50	"	10.0		113	70-130			
Methyl tert-butyl ether	11.4	0.50	"	10.0		114	50-140			
Toluene	11.2	0.50	"	10.0		112	70-120			
Xylenes (total)	34.6	0.50	"	30.0		115	80-125			
<i>Surrogate: Dibromofluoromethane</i>	<i>2.67</i>		<i>"</i>	<i>2.50</i>		<i>107</i>	<i>75-130</i>			
<i>Surrogate: 1,2-Dichloroethane-d4</i>	<i>2.80</i>		<i>"</i>	<i>2.50</i>		<i>112</i>	<i>60-145</i>			
<i>Surrogate: Toluene-d8</i>	<i>2.55</i>		<i>"</i>	<i>2.50</i>		<i>102</i>	<i>70-130</i>			
<i>Surrogate: 4-Bromofluorobenzene</i>	<i>2.70</i>		<i>"</i>	<i>2.50</i>		<i>108</i>	<i>60-120</i>			

Stratus Environmental Inc. [Arco]  
3330 Cameron Park Dr., Suite 550  
Cameron Park CA, 95682

Project: ARCO #0374, Oakland, CA  
Project Number: G0C21-0015  
Project Manager: Jay Johnson

MQB0413  
Reported:  
02/26/07 15:34

**Volatile Organic Compounds by EPA Method 8260B - Quality Control**  
**TestAmerica - Morgan Hill, CA**

Analyte	Result	Reporting Limit	Units	Spike Level	Source Result	%REC	%REC Limits	RPD	RPD Limit	Notes
---------	--------	-----------------	-------	-------------	---------------	------	-------------	-----	-----------	-------

**Batch 7B19004 - EPA 5030B P/T / EPA 8260B**

<b>Matrix Spike (7B19004-MS1)</b>		<b>Source: MQB0418-05</b>			<b>Prepared &amp; Analyzed: 02/19/07</b>					
tert-Amyl methyl ether	14.2	0.50	ug/l	10.0	ND	142	65-135			LM
Benzene	13.2	0.50	"	10.0	ND	132	70-125			LM
tert-Butyl alcohol	243	20	"	200	ND	122	60-135			
Di-isopropyl ether	13.9	0.50	"	10.0	ND	139	70-130			LM
1,2-Dibromoethane (EDB)	14.6	0.50	"	10.0	ND	146	80-125			LM
1,2-Dichloroethane	14.4	0.50	"	10.0	ND	144	75-125			LM
Ethanol	247	300	"	200	ND	124	15-150			
Ethyl tert-butyl ether	13.8	0.50	"	10.0	ND	138	65-130			LM
Ethylbenzene	12.3	0.50	"	10.0	ND	123	70-130			
Methyl tert-butyl ether	14.4	0.50	"	10.0	ND	144	50-140			LM
Toluene	12.5	0.50	"	10.0	ND	125	70-120			LM
Xylenes (total)	37.3	0.50	"	30.0	ND	124	80-125			
<i>Surrogate: Dibromofluoromethane</i>	2.66		"	2.50		106	75-130			
<i>Surrogate: 1,2-Dichloroethane-d4</i>	2.82		"	2.50		113	60-145			
<i>Surrogate: Toluene-d8</i>	2.43		"	2.50		97	70-130			
<i>Surrogate: 4-Bromofluorobenzene</i>	2.47		"	2.50		99	60-120			

<b>Matrix Spike Dup (7B19004-MSD1)</b>		<b>Source: MQB0418-05</b>			<b>Prepared &amp; Analyzed: 02/19/07</b>					
tert-Amyl methyl ether	12.8	0.50	ug/l	10.0	ND	128	65-135	10	25	
Benzene	12.3	0.50	"	10.0	ND	123	70-125	7	15	
tert-Butyl alcohol	226	20	"	200	ND	113	60-135	7	35	
Di-isopropyl ether	12.6	0.50	"	10.0	ND	126	70-130	10	35	
1,2-Dibromoethane (EDB)	13.0	0.50	"	10.0	ND	130	80-125	12	15	LM
1,2-Dichloroethane	12.9	0.50	"	10.0	ND	129	75-125	11	10	LM, BA
Ethanol	242	300	"	200	ND	121	15-150	2	35	
Ethyl tert-butyl ether	12.4	0.50	"	10.0	ND	124	65-130	11	35	
Ethylbenzene	11.7	0.50	"	10.0	ND	117	70-130	5	15	
Methyl tert-butyl ether	12.9	0.50	"	10.0	ND	129	50-140	11	25	
Toluene	11.8	0.50	"	10.0	ND	118	70-120	6	15	
Xylenes (total)	35.3	0.50	"	30.0	ND	118	80-125	6	15	
<i>Surrogate: Dibromofluoromethane</i>	2.64		"	2.50		106	75-130			
<i>Surrogate: 1,2-Dichloroethane-d4</i>	2.67		"	2.50		107	60-145			
<i>Surrogate: Toluene-d8</i>	2.53		"	2.50		101	70-130			
<i>Surrogate: 4-Bromofluorobenzene</i>	2.49		"	2.50		100	60-120			

TestAmerica - Morgan Hill, CA

The results in this report apply to the samples analyzed in accordance with the chain of custody document. Unless otherwise stated, results are reported on a wet weight basis. This analytical report must be reproduced in its entirety.

Stratus Environmental Inc. [Arco]  
3330 Cameron Park Dr., Suite 550  
Cameron Park CA, 95682

Project: ARCO #0374, Oakland, CA  
Project Number: G0C21-0015  
Project Manager: Jay Johnson

MQB0413  
Reported:  
02/26/07 15:34

**Notes and Definitions**

PV Hydrocarbon result partly due to individ. peak(s) in quant. range  
LM MS and/or MSD above acceptance limits. See Blank Spike(LCS).  
BA Relative percent difference out of control  
DET Analyte DETECTED  
ND Analyte NOT DETECTED at or above the reporting limit or MDL, if MDL is specified  
NR Not Reported  
dry Sample results reported on a dry weight basis  
RPD Relative Percent Difference





bp  
A BP affiliated company

### Chain of Custody Record

Project Name: BP 374  
 BP BU/AR Region/Enfos Segment: BP > Americas > West > Retail > CA > Alameda > 374  
 State or Lead Regulatory Agency: \_\_\_\_\_  
 Requested Due Date (mm/dd/yy): \_\_\_\_\_

On-site Time: <u>1300</u>	Temp: <u>cool</u>
Off-site Time: <u>1410</u>	Temp: <u>cool</u>
Sky Conditions: <u>clear</u>	
Meteorological Events: <u>None</u>	
Wind Speed: <u>0</u>	Direction: <u>ata</u>

Lab Name: <u>TestAmerica</u>	BP/AR Facility No.: <u>374</u>	Consultant/Contractor: <u>Stratus Environmental, Inc.</u>
Address: <u>885 Jarvis Drive</u> <u>Morgan Hill, CA 95937</u>	BP/AR Facility Address: <u>6407 Telegraph Ave., Oakland</u>	Address: <u>3330 Cameron Park Drive, Suite 550</u> <u>Cameron Park, CA 95682</u>
Lab PM: <u>Lisa Race</u>	Site Lat/Long:	Consultant/Contractor Project No.:
Tele/Fax: <u>408-782-8156 408-782-6308 (fax)</u>	California Global ID #: <u>T0600100106</u>	Consultant/Contractor PM: <u>Jay Johnson</u>
BP/AR PM Contact: <u>Paul Supple</u>	Enfos Project No.: <u>GOC21-0015</u>	Tele/Fax: <u>(530) 676-6000 / (530) 676-6005</u>
Address: <u>2010 Crow Canyon Place, Suite 150</u> <u>San Ramon, CA</u>	Provision or RCOP (circle one) <u>Provision</u>	Report Type & QC Level: <u>Level 1 with EDF</u>
Tele/Fax: <u>925-275-3506</u>	Phase/WBS: <u>04-Monitoring</u>	E-mail EDD To: <u>cjewitt@stratusinc.net</u>
	Sub Phase/Task: <u>03-Analytical</u>	Invoice to: <u>Atlantic Richfield Co.</u>
	Cost Element: <u>01-Contractor labor</u>	

Item No.	Sample Description	Time	Date	Matrix			Laboratory No.	No. of Containers	Preservative					Requested Analysis					Sample Point Lat/Long and Comments *Oxy = MTBD, TAME, ETBE, DIPE, TBA							
				Soil/Solid	Water/Liquid	Air			Unpreserved	H <sub>2</sub> SO <sub>4</sub>	HNO <sub>3</sub>	HCl	Methanol	GROVTEX/Oxy*	1,2 DCA	Ethanol	EDB	DRO								
1	MW-1	1315	2/1/07	X			MQB0413	3				X			X	X	X	X								
2	MW-2	1330	1	X			02	3				X			X	X	X	X								
3	MW-4	1345	1	X			03	6				X			X	X	X	X								
4	TB 374 020707	500	1	X			04	2				X			X	X	X	X							HOLD	
5																										
6																										
7																										
8																										
9																										
10																										

Sampler's Name: <u>Jerry Gonzalez</u>	Relinquished By / Affiliation: _____	Date: <u>2/19/07</u>	Time: <u>1655</u>	Accepted By / Affiliation: _____	Date: <u>2/1/07</u>	Time: <u>1655</u>
Sampler's Company: <u>Doulos</u>	Signature: _____	Date: <u>2/12</u>	Time: <u>1550</u>	Signature: _____	Date: <u>2-13-07</u>	Time: <u>1755</u>
Shipment Date:						
Shipment Method:						
Shipment Tracking No:						

Special Instructions: Please cc results to: rmiller@broadbentinc.com

Custody Seals In Place: (Yes) / No | Temp Blank: (Yes) / No | Cooler Temp on Receipt: 62 °F/C | Trip Blank: (Yes) / No | MS/MSD Sample Submitted: (Yes) / No

## TEST AMERICA SAMPLE RECEIPT LOG

**CLIENT NAME:** BP  
**REC. BY (PRINT)** A.M.  
**WORKORDER:** MQB0413

**DATE REC'D AT LAB:** 2-13-07  
**TIME REC'D AT LAB:** 7:55  
**DATE LOGGED IN:** 2/13/07

**For Regulatory Purposes?**  
**DRINKING WATER** YES /  NO  
**WASTE WATER** YES /  NO

CIRCLE THE APPROPRIATE RESPONSE	LAB SAMPLE #	CLIENT ID	CONTAINER DESCRIPTION	PRESERVATIVE	pH	SAMPLE MATRIX	DATE SAMPLED	REMARKS: CONDITION (ETC.)
1. Custody Seal(s) <input checked="" type="radio"/> Present / Absent <input checked="" type="radio"/> Intact / Broken*								<div style="font-size: 2em; transform: rotate(-45deg); opacity: 0.5;">                     2-13-07 A.M. See COC                 </div>
2. Chain-of-Custody <input checked="" type="radio"/> Present / Absent*								
3. Traffic Reports or Packing List: <input checked="" type="radio"/> Present / Absent								
4. Airbill: <input checked="" type="radio"/> Airbill / Sticker <input checked="" type="radio"/> Present / Absent								
5. Airbill #: <u>See Attached</u>								
6. Sample Labels: <input checked="" type="radio"/> Present / Absent								
7. Sample IDs: <input checked="" type="radio"/> Listed / Not Listed on Chain-of-Custody								
8. Sample Condition: <input checked="" type="radio"/> Intact / Broken* / Leaking*								
9. Does information on chain-of-custody, traffic reports and sample labels agree? <input checked="" type="radio"/> Yes / No*								
10. Sample received within hold time? <input checked="" type="radio"/> Yes / No*								
11. Adequate sample volume received? <input checked="" type="radio"/> Yes / No*								
12. Proper preservatives used? <input checked="" type="radio"/> Yes / No*								
13. <input checked="" type="radio"/> Trip Blank / <input checked="" type="radio"/> Temp Blank Received? (circle which, if yes) <input checked="" type="radio"/> Yes / No*								
14. Read Temp: <u>19°C</u> Corrected Temp: <u>16°C</u> Is corrected temp 4 +/-2°C? <input checked="" type="radio"/> Yes / No**								

(Acceptance range for samples requiring thermal pres.)  
 \*\*Exception (if any): METALS / DFF ON ICE  
 or Problem COC

**\*IF CIRCLED, CONTACT PROJECT MANAGER AND ATTACH RECORD OF RESOLUTION.**

California Overnight Shipping Label



D10010120563667

Date Printed 2/12/2007

Tracking#D10010120563667

*Shipped From:*

TEST AMERICA - SACRAMENTO  
819 STRIKER AVENUE 8  
SACRAMENTO, CA 95834

*Sent By:* TIM ALBRIGHT

*Phone#:* (916)921-9600

*wgt(lbs):* 60

*Reference:*

*Decl. Value:* \$0.00

*Ship To Company:*  
TESTAMERICA - MORGAN HILL  
885 JARVIS DR  
MORGAN HILL, CA 95037  
SAMPLE CONTROL (408)776-9600

*Service:* **S**  
*Sort Code:* **SJC**

*Special Services:*

**APPENDIX B**

**GEOTRACKER UPLOAD CONFIRMATION**

## Electronic Submittal Information

[Main Menu](#) | [View/Add Facilities](#) | [Upload EDD](#) | [Check EDD](#)

### UPLOADING A GEO\_WELL FILE

Processing is complete. No errors were found!  
Your file has been successfully submitted!

**Submittal Title:** 1Q07 GEO\_WELL 374

**Submittal Date/Time:** 4/4/2007 2:13:04 PM

**Confirmation Number:** 7836842417

[Back to Main Menu](#)

Logged in as BROADBENT-C  
(CONTRACTOR)

[CONTACT SITE ADMINISTRATOR.](#)

# Electronic Submittal Information

[Main Menu](#) | [View/Add Facilities](#) | [Upload EDD](#) | [Check EDD](#)

Your EDF file has been successfully uploaded!

**Confirmation Number:** 1566884875

**Date/Time of Submittal:** 4/4/2007 2:15:11 PM

**Facility Global ID:** T0600100106

**Facility Name:** ARCO #0374

**Submittal Title:** 1Q07 GW Monitoring

**Submittal Type:** GW Monitoring Report

Click [here](#) to view the detections report for this upload.

<b>ARCO #0374</b> 6407 TELEGRAPH OAKLAND, CA 94609	<b>Regional Board - Case #: 01-0114</b> SAN FRANCISCO BAY RWQCB (REGION 2) - (CM) <b>Local Agency (lead agency) - Case #: RO0000078</b> ALAMEDA COUNTY LOP - (SP)
--	--

<u>CONF #</u>	<u>TITLE</u>	<u>QUARTER</u>
1566884875	1Q07 GW Monitoring	Q1 2007
<u>SUBMITTED BY</u>	<u>SUBMIT DATE</u>	<u>STATUS</u>
Broadbent & Associates, Inc.	4/4/2007	PENDING REVIEW

## SAMPLE DETECTIONS REPORT

# FIELD POINTS SAMPLED	3
# FIELD POINTS WITH DETECTIONS	3
# FIELD POINTS WITH WATER SAMPLE DETECTIONS ABOVE MCL	2
SAMPLE MATRIX TYPES	WATER

## METHOD QA/QC REPORT

METHODS USED	8260FA,8260TPH
TESTED FOR REQUIRED ANALYTES?	Y
LAB NOTE DATA QUALIFIERS	Y

## QA/QC FOR 8021/8260 SERIES SAMPLES

TECHNICAL HOLDING TIME VIOLATIONS	0
METHOD HOLDING TIME VIOLATIONS	0
LAB BLANK DETECTIONS ABOVE REPORTING DETECTION LIMIT	0
LAB BLANK DETECTIONS	0
DO ALL BATCHES WITH THE 8021/8260 SERIES INCLUDE THE FOLLOWING?	
- LAB METHOD BLANK	Y
- MATRIX SPIKE	N
- MATRIX SPIKE DUPLICATE	N
- BLANK SPIKE	Y
- SURROGATE SPIKE	Y

## WATER SAMPLES FOR 8021/8260 SERIES

MATRIX SPIKE / MATRIX SPIKE DUPLICATE(S) % RECOVERY BETWEEN 65-135%	N
MATRIX SPIKE / MATRIX SPIKE DUPLICATE(S) RPD LESS THAN 30%	Y
SURROGATE SPIKES % RECOVERY BETWEEN 85-115%	Y
BLANK SPIKE / BLANK SPIKE DUPLICATES % RECOVERY BETWEEN 70-130%	Y

**SOIL SAMPLES FOR 8021/8260 SERIES**

MATRIX SPIKE / MATRIX SPIKE DUPLICATE(S) % RECOVERY BETWEEN 65-135% n/a  
MATRIX SPIKE / MATRIX SPIKE DUPLICATE(S) RPD LESS THAN 30% n/a  
SURROGATE SPIKES % RECOVERY BETWEEN 70-125% n/a  
BLANK SPIKE / BLANK SPIKE DUPLICATES % RECOVERY BETWEEN 70-130% n/a

**FIELD QC SAMPLES**

<u>SAMPLE</u>	<u>COLLECTED</u>	<u>DETECTIONS &gt; REPD</u>
QCTB SAMPLES	N	0
QCEB SAMPLES	N	0
QCAB SAMPLES	N	0

Logged in as BROADBENT-C (CONTRACTOR)

CONTACT SITE ADMINISTRATOR.