

Atlantic Richfield Company

Chuck Carmel
Environmental Business Manager

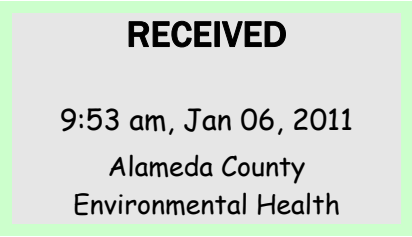

PO Box 1257
San Ramon, CA 94583
Phone: (925) 275-3803
Fax: (925) 275-3815
E-Mail: charles.carmel@bp.com

January 5, 2011

Re: Fourth Quarter 2010 Status Report
Atlantic Richfield Company Service Station #6148
5131 Shattuck Avenue, Oakland, California
ACEH Case #RO0000077

I declare that to the best of my knowledge at the present time, that the information and/or recommendations contained in the attached document are true and correct.

Submitted by,

A handwritten signature in black ink, appearing to be "Chuck Carmel", enclosed within a hand-drawn oval.

Chuck Carmel
Environmental Business Manager

Attachment

January 5, 2010

Project No. 06-88-638

Atlantic Richfield Company
P.O. Box 1257
San Ramon, California 94583
Submitted via ENFOS

Attn.: Mr. Chuck Carmel

Re: Fourth Quarter 2010 Status Report, Atlantic Richfield Company Station #6148
5131 Shattuck Ave, Oakland, California; ACEH Case #RO0000077

Dear Mr. Carmel:

Provided herein is the *Fourth Quarter 2010 Status Report* for Atlantic Richfield Company (a BP affiliated company) Station #6148 located at 5131 Shattuck Ave., Oakland, Alameda County, California (Site). This report presents a summary of current developments at the Site through the Fourth Quarter 2010.

Should you have questions regarding this submission, please do not hesitate to contact me at (707) 455-7290.

Sincerely,

BROADBENT & ASSOCIATES, INC.



Thomas A. Sparrowe, P.G.
Senior Geologist



Enclosures

cc: Mr. Paresh Khatri, ACEH (Submitted via ACEH ftp Site)
Electronic copy uploaded to GeoTracker

STATION #6148 QUARTERLY STATUS REPORT

Facility: #6148	Address:	5131 Shattuck Avenue, Oakland, California
Environmental Business Manager:		Mr. Chuck Carmel
Consulting Company/Contact Person:		Broadbent & Associates, Inc. (BAI)/Mr. Tom Sparrowe, PG (707) 455-7290
Primary Agency/Regulatory ID No.:		Alameda County Environmental Health (ACEH) ACEH Case #RO0000077
Consultant Project No.:		06-88-638

WORK PERFORMED THIS QUARTER (Fourth Quarter 2010):

1. ARCO received a *Monitoring Well Destruction* letter from ACEH dated August 12, 2010 requesting that the Site monitor wells be destroyed as a condition of case closure approval.
2. Completed the *Fourth Quarter 2010 Status Report* (contained herein).
3. BAI initiated on-site monitor and remediation well abandonment activities.
4. Well destruction drilling permits were issued by Alameda County Public Works Agency (ACPWA) on November 1, 2010.

WORK PROPOSED FOR NEXT QUARTER (First Quarter 2011):

1. Continue with on-site monitor and remediation well abandonment activities and complete site closure activities.
2. Prepare and submit a *Monitoring Well Destruction Report* to ACEH by February 15, 2010.

DISCUSSION:

No groundwater monitoring and sampling work activities took place at the Site during Fourth Quarter 2010. ARCO received a August 12, 2010 *Monitoring Well Destruction* letter from ACEH requesting that the Site monitor and remediation wells be destroyed as part of the case closure approval process. This letter also requested that a *Well Destruction Report* be submitted to ACEH by December 15, 2010. An extension to the December 15, 2010 completion date was requested by BAI via email on October 21, 2010 for a December 28, 2010 completion date. This deadline extension request was approved by ACEH on November 4, 2010 (see attached email correspondence).

Well destruction drilling permits were issued by ACPWA on November 1, 2010. On December 1 and 2, 2010, BAI oversaw Woodward Drilling, Inc. of Rio Vista, California pressure grout seven monitor wells (MW-1 through MW-7), four air-sparge wells (AS-2 through AS-4), and ten vapor extraction wells (VW-1 through VW-5 and VW-7 through VW-10). Ms. Vicky Hamlin of ACPWA was on site to observe the well destructions. While setting up to overdrill air-sparge well (AS-1) an incident occurred that required BP to order a safety stand-down to review and correct work procedures. Unfortunately, the safety stand-down order is still in effect and has prevented the completion of destroying the remaining two wells (AS-1 and VW-6). Once the safety stand-down order is lifted, BAI will complete the well abandonment operations at the site followed with a *Well Destruction Report*.

For reference, a Site Location Map is provided as Drawing 1. Provided as Drawing 2 is the Groundwater Elevation Contours and Analytical Summary Map from the *First Quarter 2010 Groundwater Monitoring Report* (BAI, 4/05/2010) for groundwater monitoring/sampling conducted on November 5, 2009.

ATTACHMENTS:

- Drawing 1 Site Location Map, Station #6148, 5131 Shattuck Avenue, Oakland, California
- Drawing 2 Ground-Water Elevation Contour and Analytical Summary Map, 5 November 2009,
Station #6148, 5131 Shattuck Avenue, Oakland, California

DRAWINGS

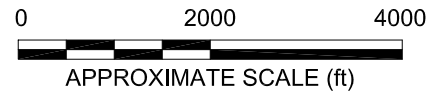
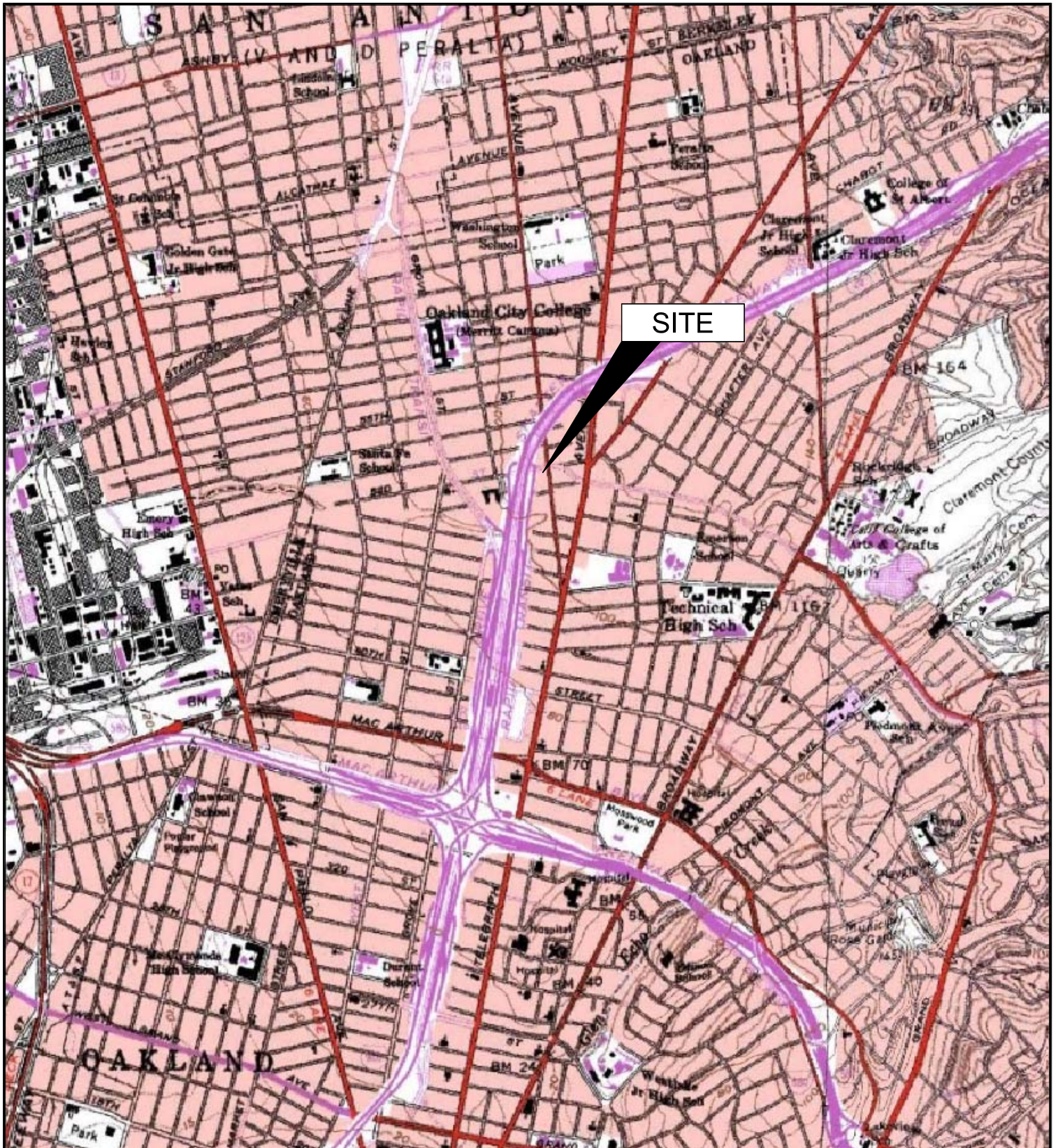

IMAGE SOURCE: USGS

BROADBENT & ASSOCIATES, INC
 ENGINEERING, WATER RESOURCES & ENVIRONMENTAL
 1324 Mangrove Ave. Suite 212, Chico, CA 95926
 Project No.: 06-88-638 Date: 9/4/09

ARCO Service Station #6148
 5131 Shattuck Avenue
 Oakland, California

Site Location Map

Drawing

1

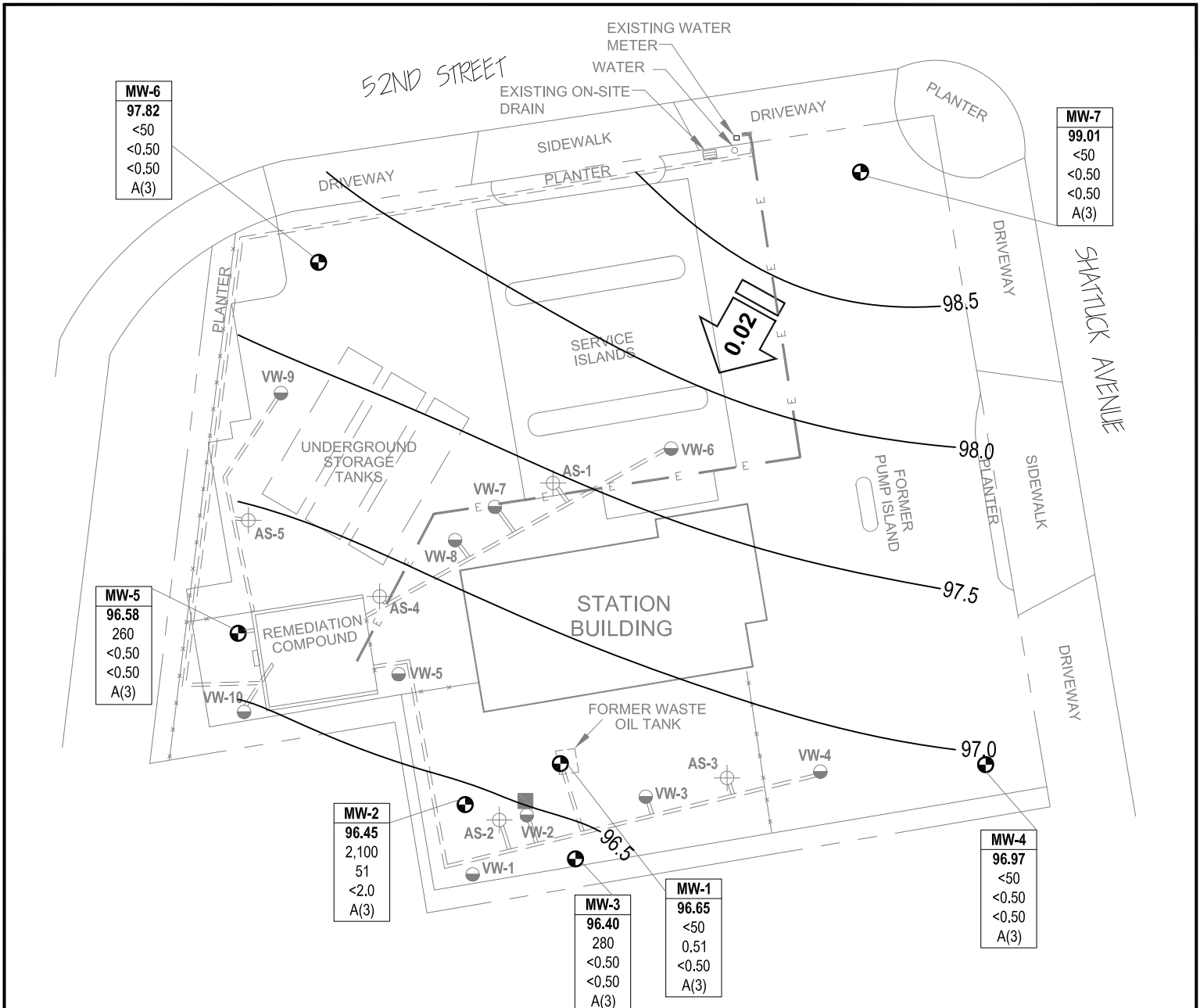

MW-6
97.82
<50
<0.50
<0.50
A(3)

MW-7
99.01
<50
<0.50
<0.50
A(3)

MW-5
96.58
260
<0.50
<0.50
A(3)

MW-2
96.45
2,100
51
<2.0
A(3)

MW-3
96.40
280
<0.50
<0.50
A(3)

MW-1
96.65
<50
0.51
<0.50
A(3)

MW-4
96.97
<50
<0.50
<0.50
A(3)

LEGEND

- MONITORING WELL
 - AIR SPARGING WELL
 - SOIL VAPOR EXTRACTION WELL
 - DESTROYED WELL
 - ELECTRICAL LINE
 - FENCING
 - REMEDIATION PIPING
 - GROUND-WATER FLOW DIRECTION AND GRADIENT (FT/FT)
 - GROUND-WATER ELEVATION CONTOUR (FT/NAVD88)
- | | |
|-------------|---|
| Well | WELL DESIGNATION |
| ELEV | GROUND-WATER ELEVATION (FT ABOVE NAVD88) |
| GRO | CONCENTRATION OF GRO, BENZENE AND MTBE IN GROUND WATER (µg/L) |
| A | SAMPLING FREQUENCY |
- A(3) SAMPLED ANNUALLY, 3RD QUARTER
 - < NOT DETECTED AT OR ABOVE LABORATORY REPORTING LIMITS
 - NS NOT SAMPLED
 - ORC OXYGEN RELEASING COMPOUND SOCK

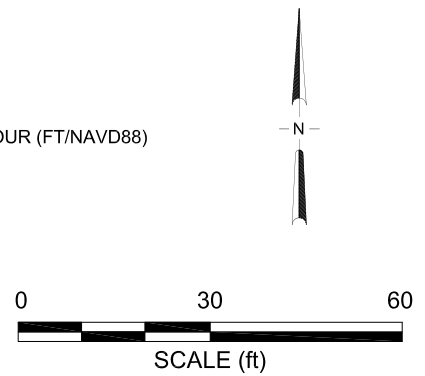

NOTE: SITE MAP ADAPTED FROM IT CORPORATION FIGURES. SITE DIMENSIONS AND FACILITY LOCATIONS NOT VERIFIED.