

# Atlantic Richfield Company

**Chuck Carmel**  
Environmental Business Manager

**RECEIVED**

10:43 am, Oct 07, 2010

Alameda County  
Environmental Health

PO Box 1257  
San Ramon, CA 94583  
Phone: (925) 275-3803  
Fax: (925) 275-3815  
E-Mail: charles.carmel@bp.com

October 6, 2010

Re: Third Quarter 2010 Status Report  
Atlantic Richfield Company Service Station #6148  
5131 Shattuck Avenue, Oakland, California  
ACEH Case #RO0000077

I declare that to the best of my knowledge at the present time, that the information and/or recommendations contained in the attached document are true and correct.

Submitted by,



Chuck Carmel  
Environmental Business Manager

Attachment

Broadbent & Associates, Inc.  
875 Cotting Ln., Suite G  
Vacaville, CA 95688  
(707) 455-7290 Tel  
(707) 455-7295 Fax



October 6, 2010

Project No. 06-88-638

Atlantic Richfield Company  
P.O. Box 1257  
San Ramon, California 94583  
Submitted via ENFOS

Attn.: Mr. Chuck Carmel

Re: Third Quarter 2010 Status Report, Atlantic Richfield Company Station #6148  
5131 Shattuck Ave, Oakland, California; ACEH Case #RO0000077

Dear Mr. Carmel:

Provided herein is the *Third Quarter 2010 Status Report* for Atlantic Richfield Company (a BP affiliated company) Station #6148 located at 5131 Shattuck Ave., Oakland, Alameda County, California (Site). This report presents a summary of current developments at the Site through the Third Quarter 2010.

Should you have questions regarding this submission, please do not hesitate to contact me at (707) 455-7290.

Sincerely,

BROADBENT & ASSOCIATES, INC.

A handwritten signature in blue ink that reads 'Thomas A. Sparrowe'.

Thomas A. Sparrowe, P.G.  
Senior Geologist



Enclosures

cc: Mr. Paresh Khatri, ACEH (Submitted via ACEH ftp Site)  
Electronic copy uploaded to GeoTracker

## STATION #6148 QUARTERLY STATUS REPORT

|                                    |          |   |
|------------------------------------|----------|---|
| Facility: #6148                    | Address: | 5131 Shattuck Avenue, Oakland, California                                 |
| Environmental Business Manager:    |          | Mr. Chuck Carmel  |
| Consulting Company/Contact Person: |          | Broadbent & Associates, Inc. (BAI)/Mr. Tom Sparrowe, PG<br>(707) 455-7290 |
| Primary Agency/Regulatory ID No.:  |          | Alameda County Environmental Health (ACEH)<br>ACEH Case #RO0000077        |
| Consultant Project No.:            |          | 06-88-638   |

### WORK PERFORMED THIS QUARTER (Third Quarter 2010):

1. ARCO received a *Monitoring Well Destruction* letter from ACEH dated August 12, 2010 requesting that the Site monitor wells be destroyed as a condition of case closure approval.
2. BAI initiated on-site monitor and remediation well abandonment activities.
3. Completed the *Third Quarter 2010 Quarterly Status Report* (contained herein).

### WORK PROPOSED FOR NEXT QUARTER (Fourth Quarter 2010):

1. Continue with on-site monitor and remediation well abandonment activities and complete site closure activities.

### DISCUSSION:

No groundwater monitoring and sampling work activities took place at the Site during Third Quarter 2010. ARCO received a August 12, 2010 *Monitoring Well Destruction* letter from ACEH requesting that the Site monitor and remediation wells be destroyed as part of the case closure approval process. For reference, a Site Location Map is provided as Drawing 1. Provided as Drawing 2 is the Groundwater Elevation Contours and Analytical Summary Map from the *First Quarter 2010 Ground-Water Monitoring Report* (BAI, 4/05/2010) for groundwater monitoring/sampling conducted on November 5, 2009.

### REFERENCES

- BAI, 2010. *First Quarter 2010 Ground-Water Monitoring Report, Atlantic Richfield Company Station #6148, 5131 Shattuck Ave, Oakland, California; ACEH Case #RO0000077*. April 5.
- ACEH, 2010. Written Correspondence from P. Khatri (ACEH) to C. Carmel (ARC), *Monitoring Well Destruction and Landowner Notification for Fuel Leak Case No. RO0000077 and GeoTracker Global ID T0600100103, ARCO #6148, 5131 Shattuck Avenue, Oakland CA 94609*. August 12.

### ATTACHMENTS:

- Drawing 1 Site Location Map, Station #6148, 5131 Shattuck Avenue, Oakland, California
- Drawing 2 Groundwater Elevation Contour and Analytical Summary Map, November 5, 2009, Station #6148, 5131 Shattuck Avenue, Oakland, California



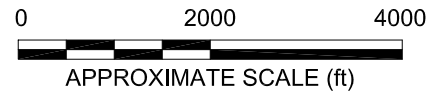
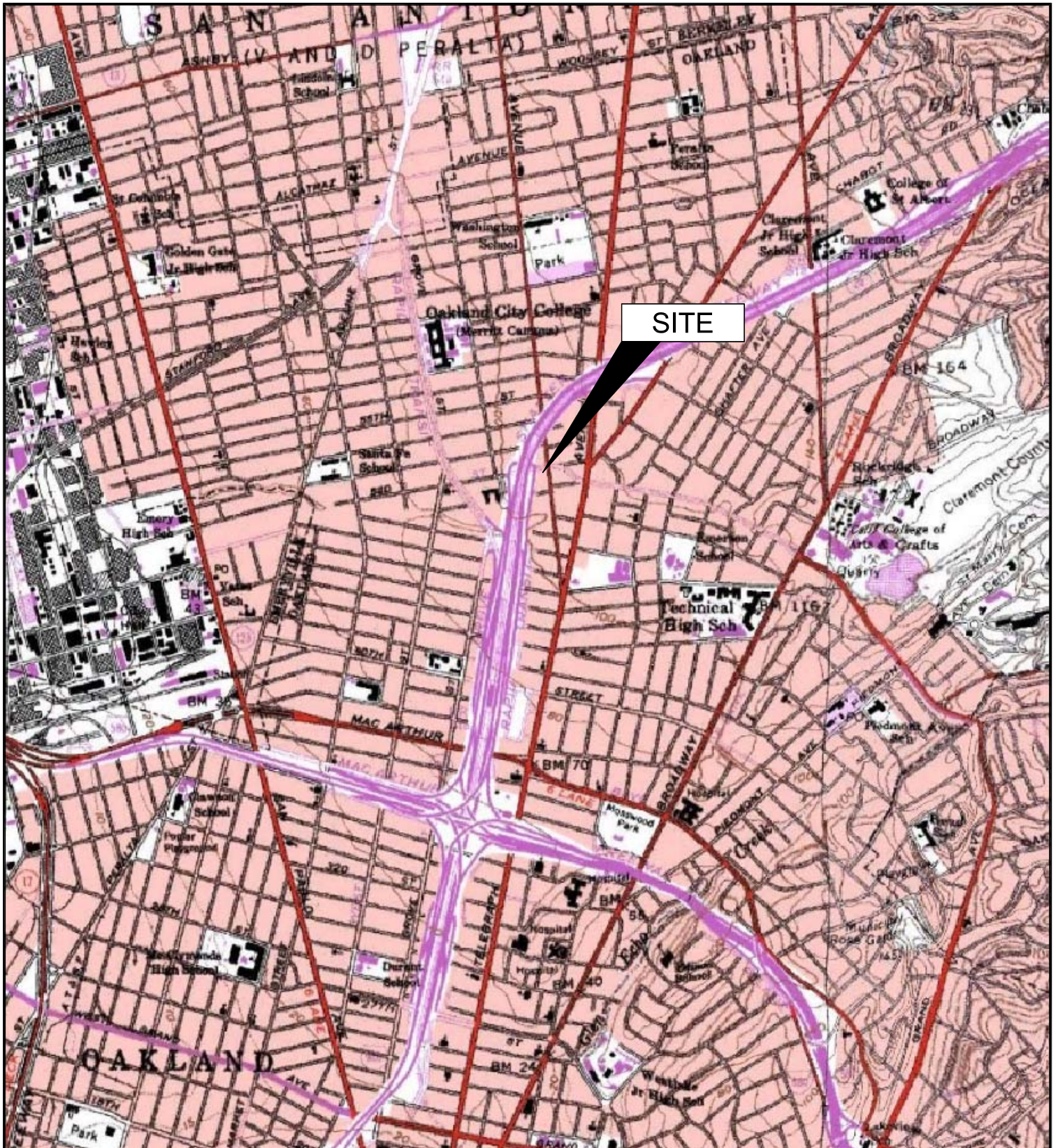
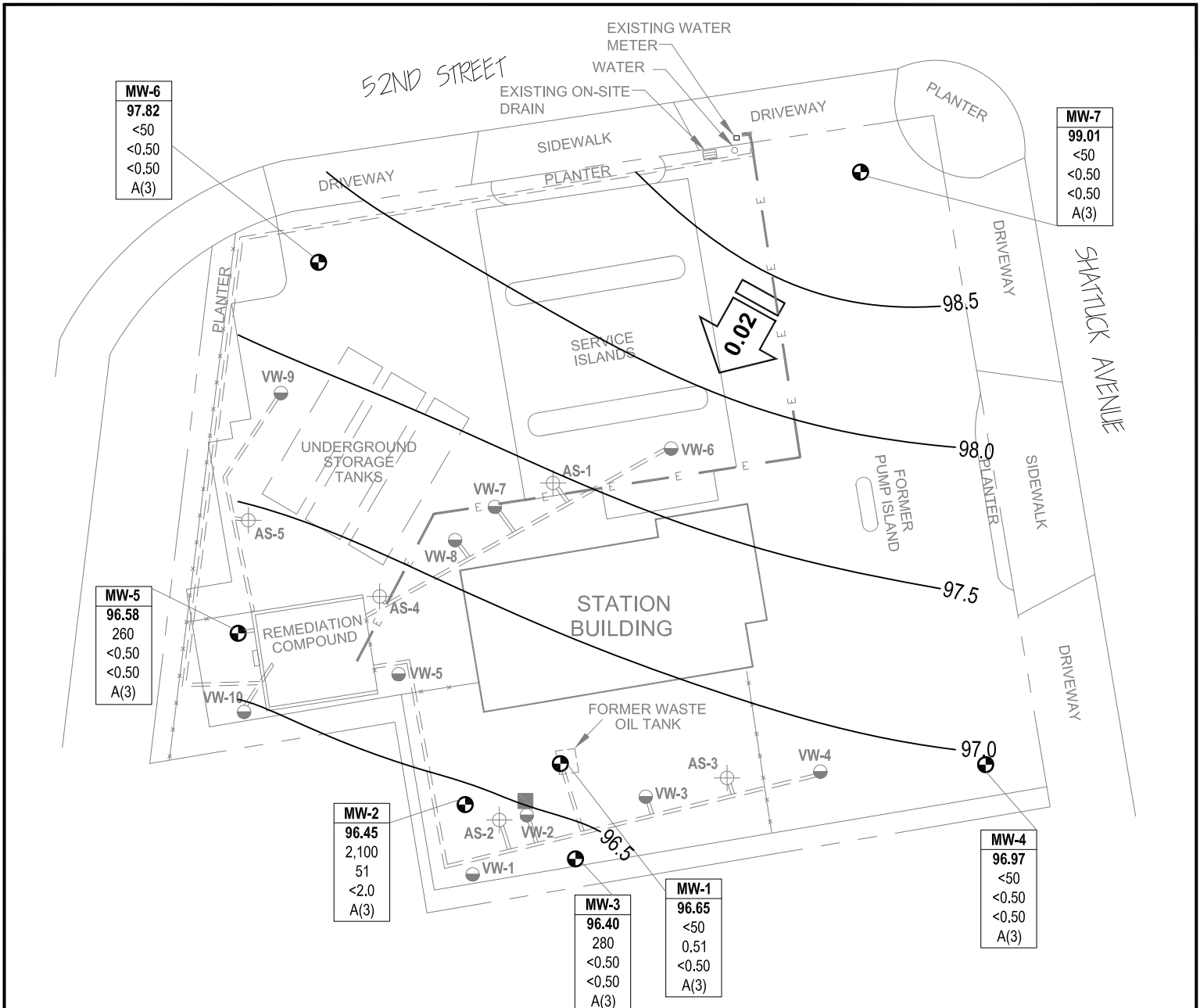

IMAGE SOURCE: USGS





|             |
|-------------|
| <b>MW-6</b> |
| 97.82       |
| <50         |
| <0.50       |
| <0.50       |
| A(3)        |

|             |
|-------------|
| <b>MW-7</b> |
| 99.01       |
| <50         |
| <0.50       |
| <0.50       |
| A(3)        |

|             |
|-------------|
| <b>MW-5</b> |
| 96.58       |
| 260         |
| <0.50       |
| <0.50       |
| A(3)        |

|             |
|-------------|
| <b>MW-2</b> |
| 96.45       |
| 2,100       |
| 51          |
| <2.0        |
| A(3)        |

|             |
|-------------|
| <b>MW-3</b> |
| 96.40       |
| 280         |
| <0.50       |
| <0.50       |
| A(3)        |

|             |
|-------------|
| <b>MW-1</b> |
| 96.65       |
| <50         |
| 0.51        |
| <0.50       |
| A(3)        |

|             |
|-------------|
| <b>MW-4</b> |
| 96.97       |
| <50         |
| <0.50       |
| <0.50       |
| A(3)        |

**LEGEND**

- MONITORING WELL
  - AIR SPARGING WELL
  - SOIL VAPOR EXTRACTION WELL
  - DESTROYED WELL
  - ELECTRICAL LINE
  - FENCING
  - REMEDIATION PIPING
  - GROUND-WATER FLOW DIRECTION AND GRADIENT (FT/FT)
  - GROUND-WATER ELEVATION CONTOUR (FT/NAVD88)
- |                |   |
|----------------|---|
| <b>Well</b>    | WELL DESIGNATION  |
| <b>ELEV</b>    | GROUND-WATER ELEVATION (FT ABOVE NAVD88)                      |
| <b>GRO</b>     | CONCENTRATION OF GRO, BENZENE AND MTBE IN GROUND WATER (µg/L) |
| <b>Benzene</b> |   |
| <b>MTBE</b>    |   |
| <b>A</b>       | SAMPLING FREQUENCY  |
- A(3) SAMPLED ANNUALLY, 3RD QUARTER
  - < NOT DETECTED AT OR ABOVE LABORATORY REPORTING LIMITS
  - NS NOT SAMPLED
  - ORC OXYGEN RELEASING COMPOUND SOCK

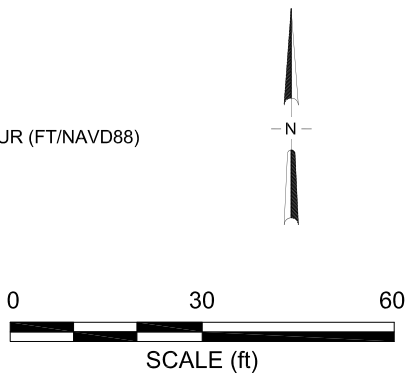

NOTE: SITE MAP ADAPTED FROM IT CORPORATION FIGURES. SITE DIMENSIONS AND FACILITY LOCATIONS NOT VERIFIED.