

Atlantic Richfield Company

Chuck Carmel
Environmental Business Manager

RECEIVED

1:12 pm, Aug 02, 2010

Alameda County
Environmental Health

PO Box 1257
San Ramon, CA 94583
Phone: (925) 275-3803
Fax: (925) 275-3815
E-Mail: charles.carmel@bp.com

July 19, 2010

Re: Second Quarter 2010 Status Report
Atlantic Richfield Company Service Station #6148
5131 Shattuck Avenue, Oakland, California
ACEH Case #RO0000077

I declare that to the best of my knowledge at the present time, that the information and/or recommendations contained in the attached document are true and correct.

Submitted by,



Chuck Carmel
Environmental Business Manager

Attachment

Broadbent & Associates, Inc.
875 Cotting Ln., Suite G
Vacaville, CA 95688
(707) 455-7290 Tel
(707) 455-7295 Fax



July 19, 2010

Project No. 06-88-638

Atlantic Richfield Company
P.O. Box 1257
San Ramon, California 94583
Submitted via ENFOS

Attn.: Mr. Chuck Carmel

Re: Second Quarter 2010 Status Report, Atlantic Richfield Company Station #6148
5131 Shattuck Ave, Oakland, California; ACEH Case #RO0000077

Dear Mr. Carmel:

Provided herein is the *Second Quarter 2010 Status Report* for Atlantic Richfield Company (a BP affiliated company) Station #6148 located at 5131 Shattuck Ave., Oakland, Alameda County, California (Site). This report presents a summary of current developments at the Site through the Second Quarter 2010.

Should you have questions regarding this submission, please do not hesitate to contact me at (707) 455-7290.

Sincerely,

BROADBENT & ASSOCIATES, INC

Thomas A. Sparrowe, P.G.
Senior Geologist

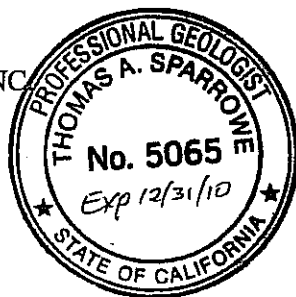

Enclosures

cc: Mr. Paresh Khatri, ACEH (Submitted via ACEH fip Site)
Electronic copy uploaded to GeoTracker

STATION #6148 QUARTERLY STATUS REPORT

Facility: #6148	Address:	5131 Shattuck Avenue, Oakland, California
Environmental Business Manager:		Mr. Chuck Carmel
Consulting Company/Contact Person:		Broadbent & Associates, Inc. (BAI)/Mr. Tom Sparrowe, PG (707) 455-7290
Primary Agency/Regulatory ID No.:		Alameda County Environmental Health (ACEH) ACEH Case #RO0000077
Consultant Project No.:		06-88-638

WORK PERFORMED THIS QUARTER (Second Quarter 2010):

1. Prepared and submitted the *Second Quarter 2010 Status Report* (BAI, 5/05/2010).
2. No environmental field work was conducted at the Site during the Second Quarter of 2010.

WORK PROPOSED FOR NEXT QUARTER (Third Quarter 2010):

1. Prepared and submitted this *Second Quarter 2010 Status Report* (contained herein).
2. No environmental work activities are scheduled to be conducted at the Site during the Third Quarter of 2010.

DISCUSSION:

No groundwater monitoring and sampling work activities took place at the Site during Second Quarter 2010. Case closure was requested by BP on April 13, 2004 from ACEH. On November 15, 2007, BAI provided ACEH with a completed Case Closure Summary document to assist the ACEH with its review. BP is currently awaiting a response from the ACEH to the case closure request and case closure summary. For reference, a Site Location Map is provided as Drawing 1. Provided as Drawing 2 is the Groundwater Elevation Contours and Analytical Summary Map from the *First Quarter 2010 Ground-Water Monitoring Report* (BAI, 4/05/2010) for groundwater monitoring/sampling conducted on November 5, 2009.

ATTACHMENTS:

- | | |
|-----------|--|
| Drawing 1 | Site Location Map, Station #6148, 5131 Shattuck Avenue, Oakland, California |
| Drawing 2 | Groundwater Elevation Contour and Analytical Summary Map, November 5, 2009, Station #6148, 5131 Shattuck Avenue, Oakland, California |

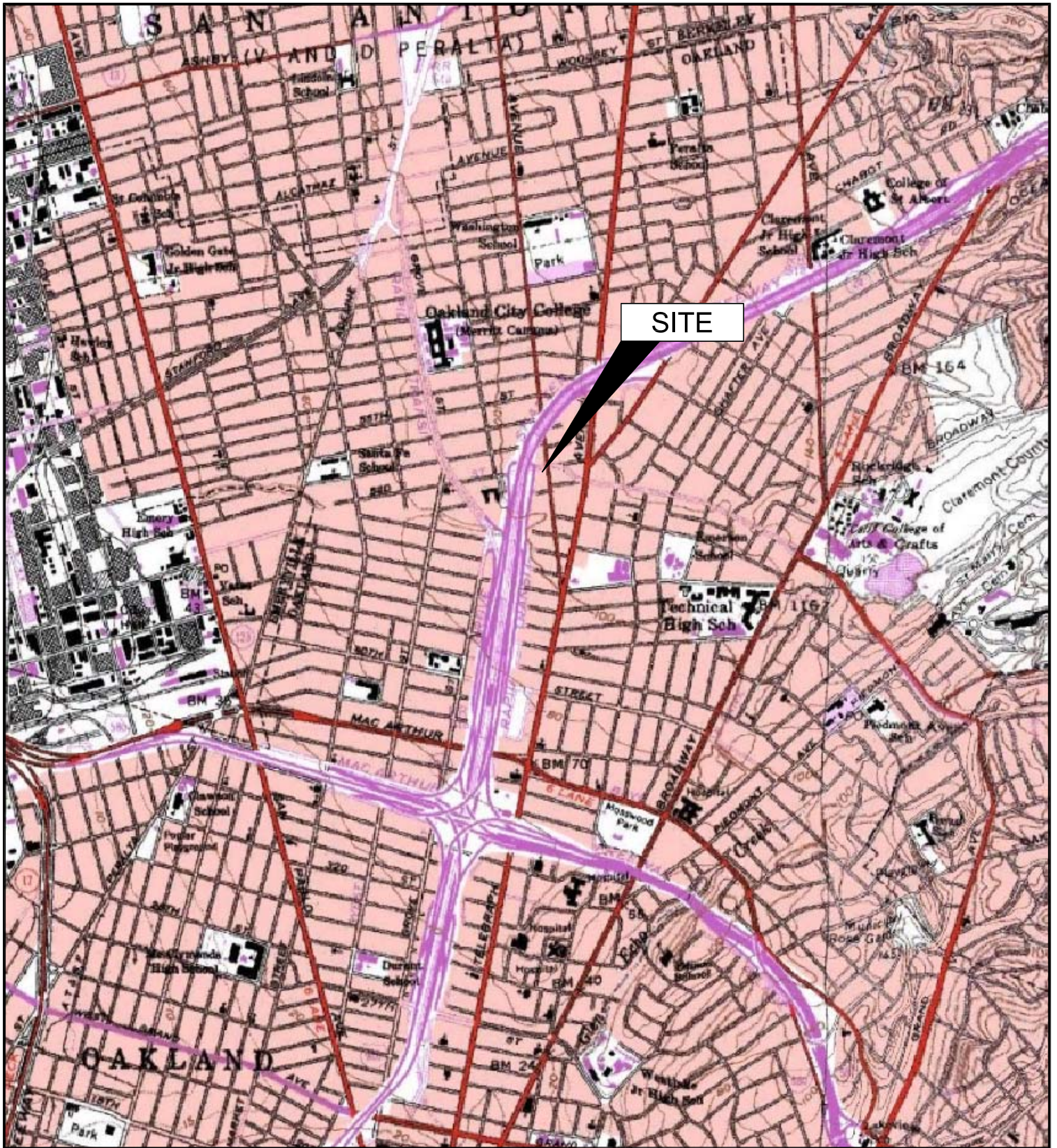
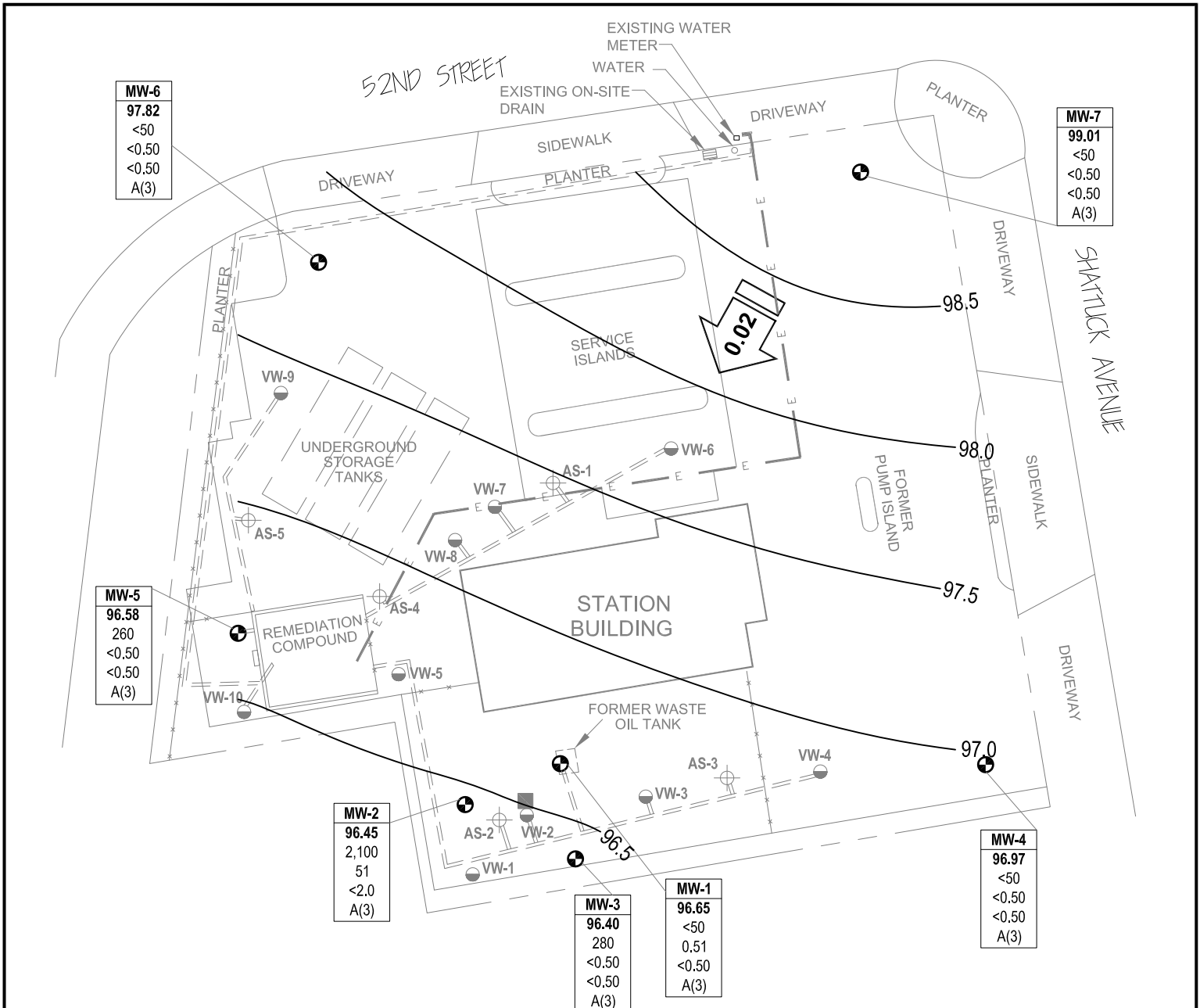

IMAGE SOURCE: USGS



MW-6
97.82
<50
<0.50
<0.50
A(3)

MW-7
99.01
<50
<0.50
<0.50
A(3)

MW-5
96.58
260
<0.50
<0.50
A(3)

MW-2
96.45
2,100
51
<2.0
A(3)

MW-3
96.40
280
<0.50
<0.50
A(3)

MW-1
96.65
<50
0.51
<0.50
A(3)

MW-4
96.97
<50
<0.50
<0.50
A(3)

LEGEND

- MONITORING WELL
 - AIR SPARGING WELL
 - SOIL VAPOR EXTRACTION WELL
 - DESTROYED WELL
 - ELECTRICAL LINE
 - FENCING
 - REMEDIATION PIPING
 - GROUND-WATER FLOW DIRECTION AND GRADIENT (FT/FT)
 - GROUND-WATER ELEVATION CONTOUR (FT/NAVD88)
- | Well | WELL DESIGNATION |
|------|---|
| ELEV | GROUND-WATER ELEVATION (FT ABOVE NAVD88) |
| GRO | CONCENTRATION OF GRO, BENZENE AND MTBE IN GROUND WATER (µg/L) |
| A | SAMPLING FREQUENCY |
- A(3) SAMPLED ANNUALLY, 3RD QUARTER
 - < NOT DETECTED AT OR ABOVE LABORATORY REPORTING LIMITS
 - NS NOT SAMPLED
 - ORC OXYGEN RELEASING COMPOUND SOCK

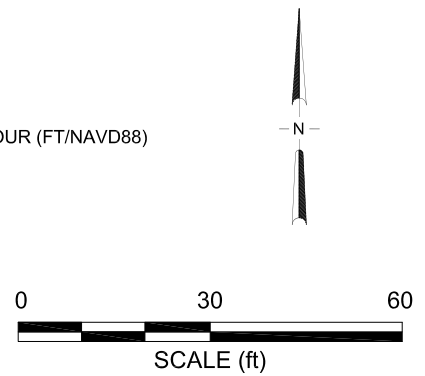

NOTE: SITE MAP ADAPTED FROM IT CORPORATION FIGURES. SITE DIMENSIONS AND FACILITY LOCATIONS NOT VERIFIED.