

Atlantic Richfield Company

Chuck Carmel
Environmental Business Manager

RECEIVED

8:51 am, Apr 01, 2010

Alameda County
Environmental Health

PO Box 1257
San Ramon, CA 94583
Phone: (925) 275-3803
Fax: (925) 275-3815
E-Mail: charles.carmel@bp.com

5 April 2010

Re: First Quarter 2010 Status Report
Atlantic Richfield Company Service Station #6148
5131 Shattuck Avenue, Oakland, California
ACEH Case #RO0000077

"I declare, that to the best of my knowledge at the present time, that the information and/or recommendations contained in the attached document are true and correct.

Submitted by,



Chuck Carmel
Environmental Business Manager

Attachment

5 April 2010

Project No. 06-88-638

Atlantic Richfield Company
P.O. Box 1257
San Ramon, California 94583
Submitted via ENFOS

Attn.: Mr. Chuck Carmel

Re: First Quarter 2010 Status Report, Atlantic Richfield Company Station #6148
5131 Shattuck Ave, Oakland, California; ACEH Case #RO0000077

Dear Mr. Carmel:

Provided herein is the *First Quarter 2010 Status Report* for Atlantic Richfield Company (a BP affiliated company) Station #6148 located at 5131 Shattuck Ave., Oakland, Alameda County, California (Site). This report presents a summary of current developments at the Site through the First Quarter 2010.

Should you have questions regarding this submission, please do not hesitate to contact me at (530) 566-1400.

Sincerely,

BROADBENT & ASSOCIATES, INC.



Thomas A. Venus, P.E.
Senior Engineer



Enclosures

cc: Mr. Paresh Khatri, ACEH (Submitted via ACEH ftp Site)
Electronic copy uploaded to GeoTracker

STATION #6148 QUARTERLY STATUS REPORT

Facility: #6148	Address:	5131 Shattuck Avenue, Oakland, California
Environmental Business Manager:		Mr. Chuck Carmel
Consulting Company/Contact Person:		Broadbent & Associates, Inc. (BAI)/Mr. Tom Venus, PE (530)566-1400
Primary Agency/Regulatory ID No.:		Alameda County Environmental Health (ACEH) ACEH Case #RO0000077
Consultant Project No.:		06-88-638

WORK PERFORMED THIS QUARTER (First Quarter 2010):

1. Prepared and submitted the *Fourth Quarter 2009 Ground-Water Monitoring Report* (BAI, 1/05/2010).
2. No environmental field work was conducted at the Site during the First Quarter of 2010.

WORK PROPOSED FOR NEXT QUARTER (Second Quarter 2010):

1. Prepared and submitted this *First Quarter 2010 Status Report* (contained herein).
2. No environmental work activities are scheduled to be conducted at the Site during the Second Quarter of 2010.

DISCUSSION:

No ground-water monitoring and sampling work activities took place at the Site during First Quarter 2010. Case closure was requested by BP on 13 April 2004 from ACEH. On 15 November 2007, BAI provided ACEH with a completed Case Closure Summary document to assist the ACEH with its review. BP is currently awaiting a response from the ACEH to the case closure request and case closure summary. For reference, a Site Location Map is provided as Drawing 1. Provided as Drawing 2 is the Ground-Water Elevation Contours and Analytical Summary Map from the *Fourth Quarter 2009 Ground-Water Monitoring Report* (BAI, 1/05/2010) for ground-water monitoring/sampling conducted on 5 November 2009.

ATTACHMENTS:

- Drawing 1 Site Location Map, Station #6148, 5131 Shattuck Avenue, Oakland, California
- Drawing 2. Ground-Water Elevation Contour and Analytical Summary Map, 5 November 2009,
Station #6148, 5131 Shattuck Avenue, Oakland, California

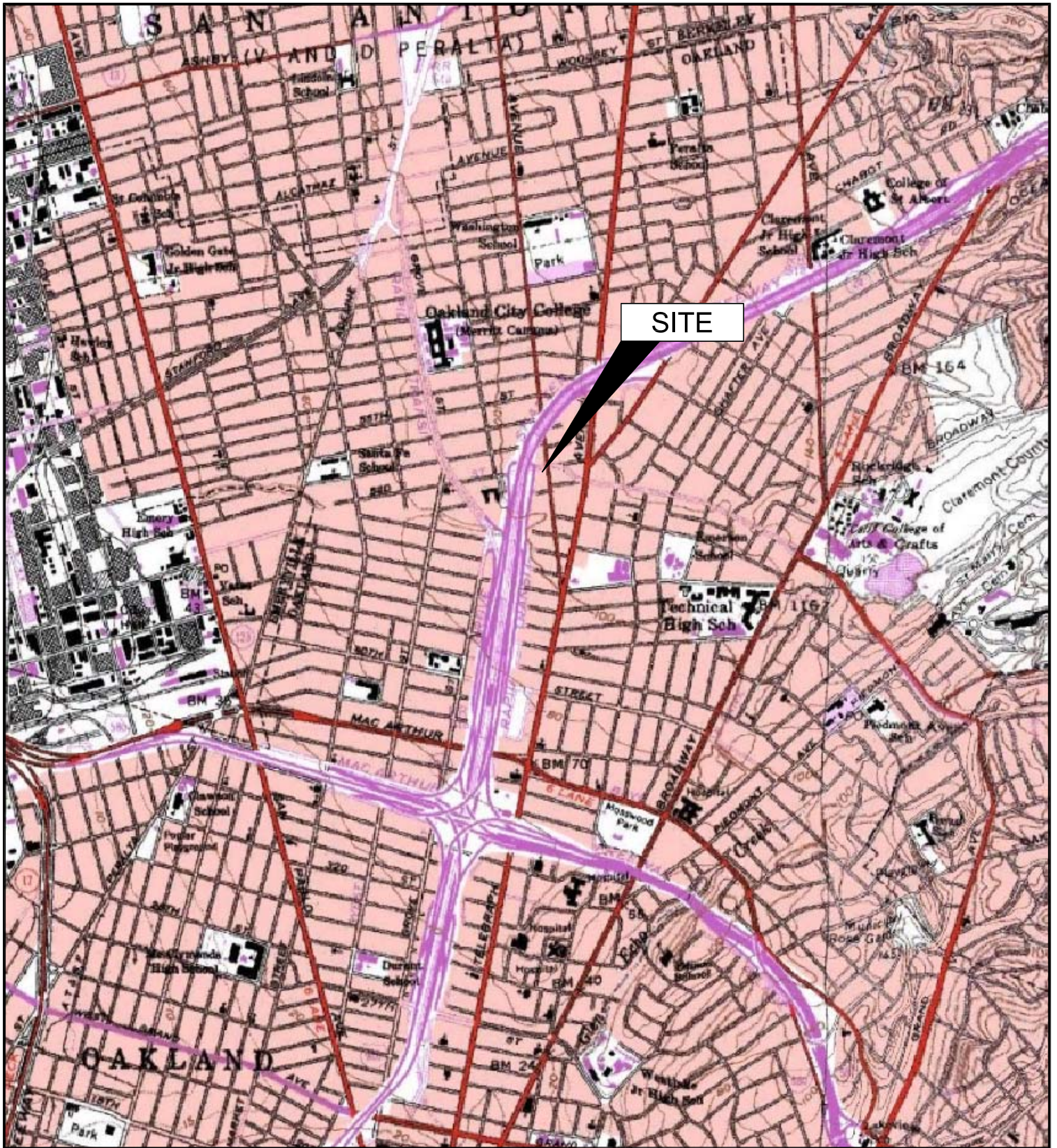
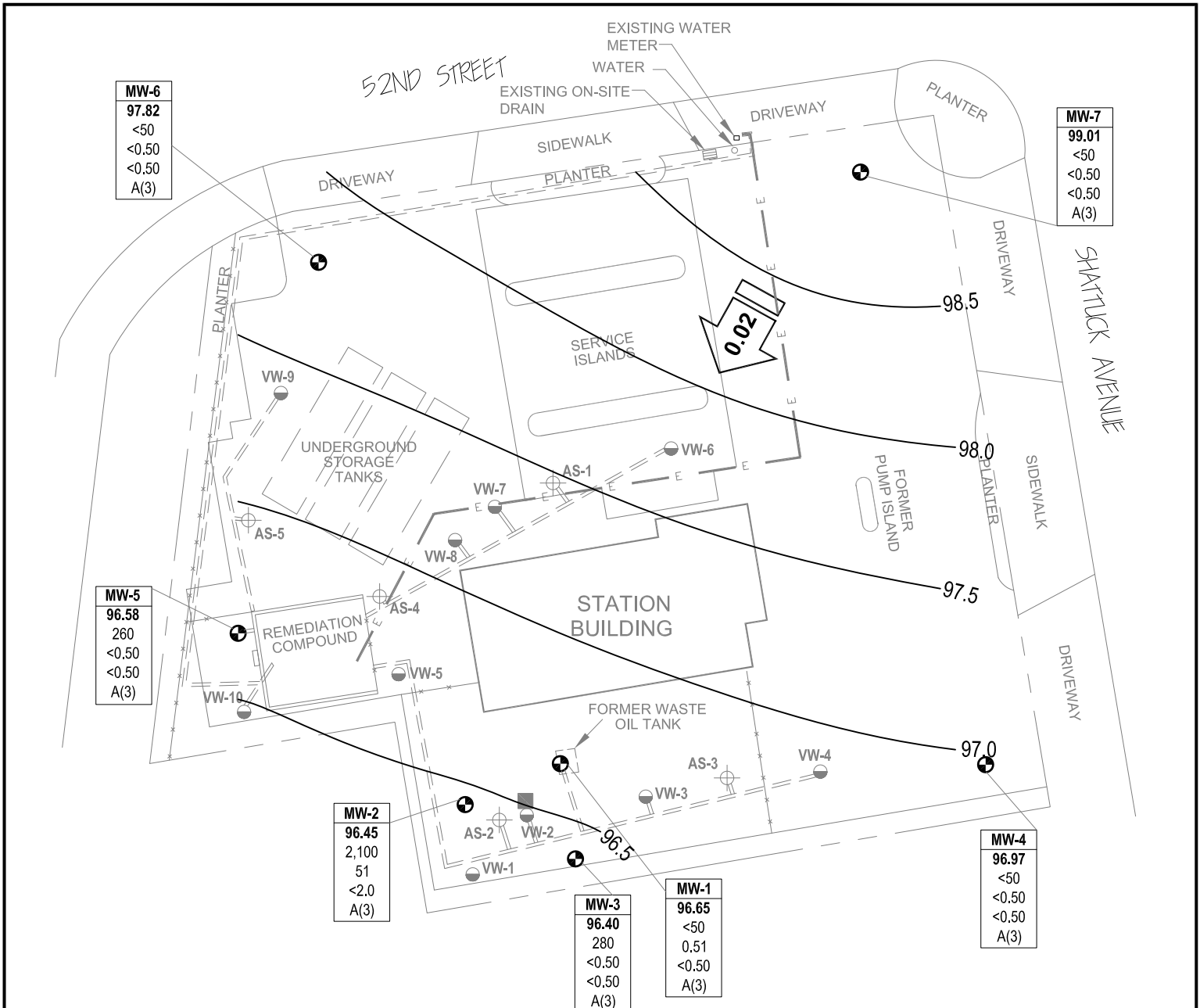

IMAGE SOURCE: USGS



MW-6
97.82
<50
<0.50
<0.50
A(3)

MW-7
99.01
<50
<0.50
<0.50
A(3)

MW-5
96.58
260
<0.50
<0.50
A(3)

MW-2
96.45
2,100
51
<2.0
A(3)

MW-3
96.40
280
<0.50
<0.50
A(3)

MW-1
96.65
<50
0.51
<0.50
A(3)

MW-4
96.97
<50
<0.50
<0.50
A(3)

LEGEND

- MONITORING WELL
 - AIR SPARGING WELL
 - SOIL VAPOR EXTRACTION WELL
 - DESTROYED WELL
 - ELECTRICAL LINE
 - FENCING
 - REMEDIATION PIPING
 - GROUND-WATER FLOW DIRECTION AND GRADIENT (FT/FT)
 - GROUND-WATER ELEVATION CONTOUR (FT/NAVD88)
- | | |
|----------------|---|
| Well | WELL DESIGNATION |
| ELEV | GROUND-WATER ELEVATION (FT ABOVE NAVD88) |
| GRO | CONCENTRATION OF GRO, BENZENE AND MTBE IN GROUND WATER (µg/L) |
| Benzene | |
| MTBE | |
| A | SAMPLING FREQUENCY |
- A(3) SAMPLED ANNUALLY, 3RD QUARTER
 - < NOT DETECTED AT OR ABOVE LABORATORY REPORTING LIMITS
 - NS NOT SAMPLED
 - ORC OXYGEN RELEASING COMPOUND SOCK



NOTE: SITE MAP ADAPTED FROM IT CORPORATION FIGURES. SITE DIMENSIONS AND FACILITY LOCATIONS NOT VERIFIED.