



Atlantic Richfield Company  
(a BP affiliated company)

P.O. Box 1257  
San Ramon, CA 94583  
Phone: (925) 275-3801  
Fax: (925) 275-3815

7 July 2009

Re: Second Quarter 2009 Status Report  
Atlantic Richfield Company Station #6148  
5131 Shattuck Avenue  
Oakland, California  
ACEH Case #RO0000077

**RECEIVED**

9:34 am, Jul 29, 2009

Alameda County  
Environmental Health



“I declare, that to the best of my knowledge at the present time, that the information and/or recommendations contained in the attached document are true and correct.”

Submitted by:

Paul Supple  
Environmental Business Manger

7 July 2009

Project No. 06-88-638

Atlantic Richfield Company  
P.O. Box 1257  
San Ramon, California 94583  
Submitted via ENFOS

Attn.: Mr. Paul Supple

Re: Second Quarter 2009 Status Report, Atlantic Richfield Company (a BP affiliated company) Station #6148, 5131 Shattuck Avenue, Oakland, Alameda County, California; ACEH Case #RO000077

Dear Mr. Supple:

Provided herein is the *Second Quarter 2009 Status Report* for Atlantic Richfield Company Station #6148 located at 5131 Shattuck Avenue, Oakland, Alameda County, California. Case closure was requested by BP from Alameda County Environmental Health (ACEH) on 13 April 2004. BP is currently awaiting a response from ACEH. This report presents a summary of current developments at the Site through the Second Quarter of 2009.

Should you have questions regarding this submission, please do not hesitate to contact us at (530) 566-1400.

Sincerely,

BROADBENT & ASSOCIATES, INC.



Thomas A. Venus, P.E.  
Senior Engineer



Robert H. Miller, P.G., C.HG.  
Principal Hydrogeologist

Enclosures

cc: Mr. Paresh Khatri, ACEH (Submitted via ACEH ftp Site)  
Electronic copy uploaded to GeoTracker

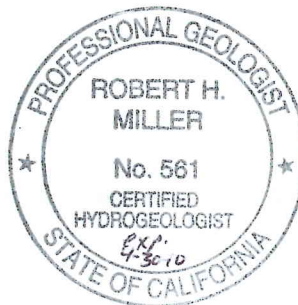

## STATION #6148 QUARTERLY GROUND-WATER STATUS REPORT

Facility: #6148	Address:	5131 Shattuck Avenue, Oakland, California
Environmental Business Manager:		Mr. Paul Supple
Consulting Company/Contact Person:		Broadbent & Associates, Inc.(BAI)/Rob Miller & Tom Venus (530)566-1400
Primary Agency/Regulatory ID No.:		Alameda County Environmental Health (ACEH) ACEH Case #RO0000077
Consultant Project No.:		06-08-638

### WORK PERFORMED THIS QUARTER (Second Quarter 2009):

1. Prepared and submitted First Quarter 2009 Status Report.
2. No environmental work was conducted at the site during the Second Quarter of 2009.

### WORK PROPOSED FOR NEXT QUARTER (Third Quarter 2009):

1. Prepared and submitted this Second Quarter 2009 Status Report (contained herein).
2. Perform annual ground-water monitoring at the Site during the Third Quarter of 2009.

### DISCUSSION:

Case closure was requested by BP on 13 April 2004 from ACEH. BP is currently awaiting a response from the ACEH. For reference, a Ground-Water Elevation Contour and Analytical Summary Map from the Third Quarter 2008 Annual Ground-Water Monitoring Report is provided as Drawing 1.

### ATTACHMENTS:

Drawing 1      Ground-Water Elevation Contour and Analytical Summary Map, 20 August 2008, Station #6148, 5131 Shattuck Avenue, Oakland, California

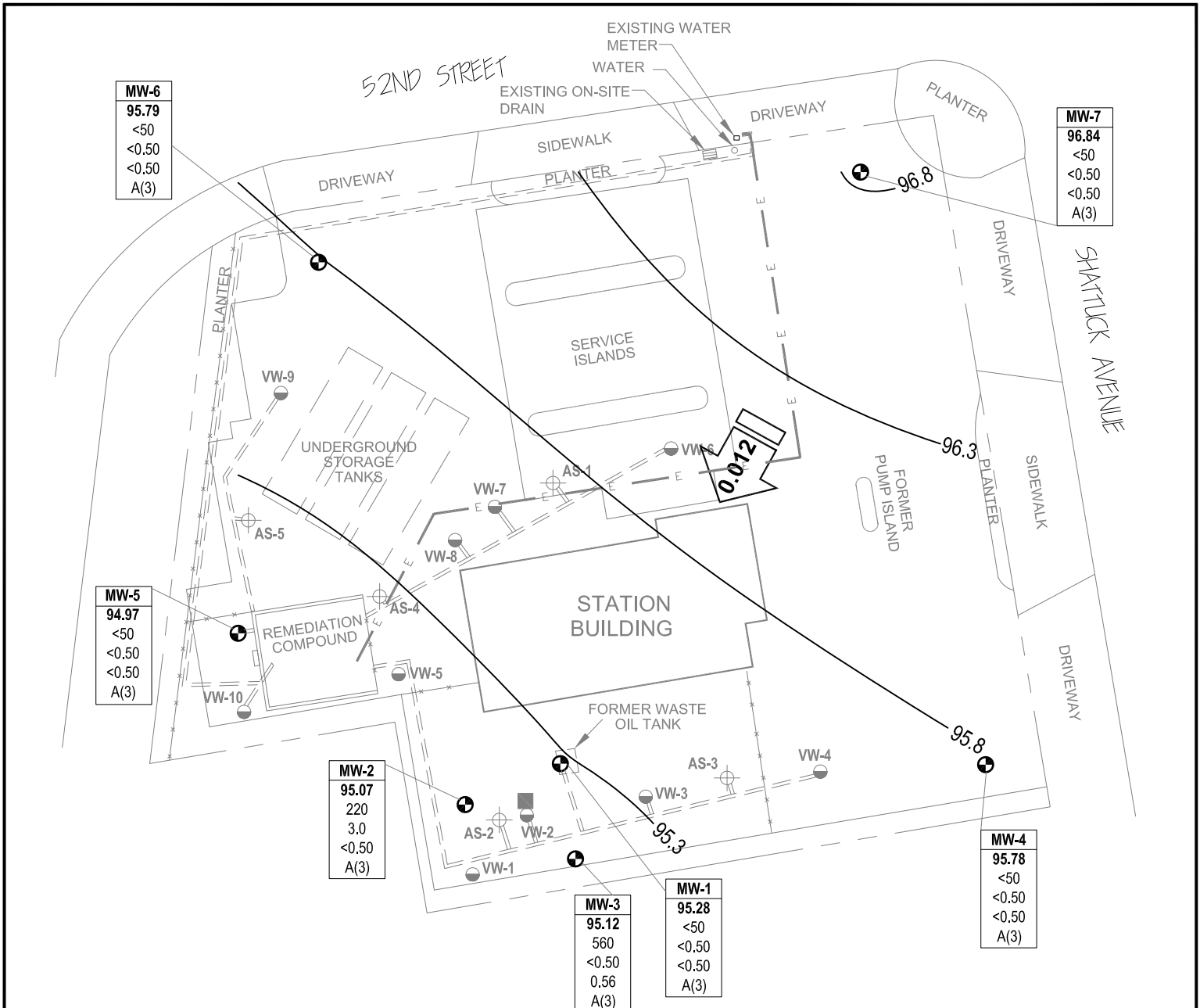

<b>MW-6</b>
95.79
<50
<0.50
<0.50
A(3)

<b>MW-7</b>
96.84
<50
<0.50
<0.50
A(3)

<b>MW-5</b>
94.97
<50
<0.50
<0.50
A(3)

<b>MW-2</b>
95.07
220
3.0
<0.50
A(3)

<b>MW-3</b>
95.12
560
<0.50
0.56
A(3)

<b>MW-1</b>
95.28
<50
<0.50
<0.50
A(3)

<b>MW-4</b>
95.78
<50
<0.50
<0.50
A(3)

**LEGEND**

- MONITORING WELL
  - AIR SPARGING WELL
  - SOIL VAPOR EXTRACTION WELL
  - DESTROYED WELL
  - ELECTRICAL LINE
  - FENCING
  - REMEDIATION PIPING
  - GROUND-WATER FLOW DIRECTION AND GRADIENT (FT/FT)
  - GROUND-WATER ELEVATION CONTOUR (FT/MSL)
- |                |   |
|----------------|---|
| <b>Well</b>    | WELL DESIGNATION  |
| <b>ELEV</b>    | GROUND-WATER ELEVATION (FT ABOVE MSL)                         |
| <b>GRO</b>     | CONCENTRATION OF GRO, BENZENE AND MTBE IN GROUND WATER (µg/L) |
| <b>Benzene</b> |   |
| <b>MTBE</b>    |   |
| <b>A</b>       | SAMPLING FREQUENCY  |
| A(3)           | SAMPLED ANNUALLY, 3RD QUARTER                                 |
| <              | NOT DETECTED AT OR ABOVE LABORATORY REPORTING LIMITS          |
| NS             | NOT SAMPLED   |
| ORC            | OXYGEN RELEASING COMPOUND SOCK                                |

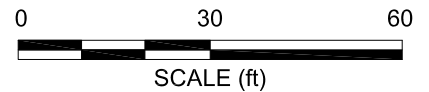

NOTE: SITE MAP ADAPTED FROM IT CORPORATION FIGURES. SITE DIMENSIONS AND FACILITY LOCATIONS NOT VERIFIED.