



Atlantic Richfield Company
(a BP affiliated company)

P.O. Box 1257
San Ramon, CA 94583
Phone: (925) 275-3801
Fax: (925) 275-3815

8 April 2008

Re: First Quarter 2008 Status Report
Atlantic Richfield Company Station #6148
5131 Shattuck Avenue
Oakland, California
ACEH Case #RO0000077

RECEIVED

3:05 pm, Apr 30, 2008

Alameda County
Environmental Health



“I declare, that to the best of my knowledge at the present time, that the information and/or recommendations contained in the attached document are true and correct.”

Submitted by:

Paul Supple
Environmental Business Manger

8 April 2008

Project No. 06-08-638

Atlantic Richfield Company
P.O. Box 1257
San Ramon, California 94583
Submitted via ENFOS

Attn.: Mr. Paul Supple

Re: First Quarter 2008 Status Report, Atlantic Richfield Company (a BP affiliated company)
Station #6148, 5131 Shattuck Avenue, Oakland, Alameda County, California;
ACEH Case #RO000077

Dear Mr. Supple:

Provided herein is the *First Quarter 2008 Status Report* for Atlantic Richfield Company Station #6148 located at 5131 Shattuck Avenue, Oakland, Alameda County, California. Case closure was requested by BP from Alameda County Environmental Health (ACEH) on 13 April 2004. BP is currently awaiting a response from ACEH.

Should you have questions regarding this submission, please do not hesitate to contact us at (530) 566-1400.

Sincerely,

BROADBENT & ASSOCIATES, INC.



Thomas A. Venus, P.E.
Senior Engineer



Robert H. Miller, P.G., C.HG.
Principal Hydrogeologist

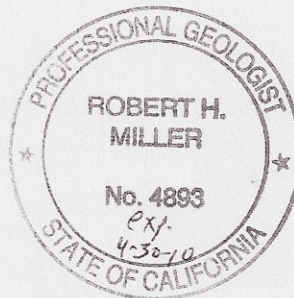

Enclosures

cc: Mr. Paresh Khatri, ACEH (Submitted via ACEH ftp Site)
Electronic copy uploaded to GeoTracker

STATION #6148 QUARTERLY GROUND-WATER STATUS REPORT

Facility: #6148	Address:	5131 Shattuck Avenue, Oakland, California
Environmental Business Manager:		Mr. Paul Supple
Consulting Company/Contact Person:		Broadbent & Associates, Inc.(BAI)/Rob Miller & Tom Venus (530)566-1400
Primary Agency/Regulatory ID No.:		Alameda County Environmental Health (ACEH) ACEH Case #RO0000077
Consultant Project No.:		06-08-638

WORK PERFORMED THIS QUARTER (First Quarter 2008):

1. Prepared and submitted Fourth Quarter 2007 Status Report.
2. No environmental work was conducted at the site during the First Quarter of 2008.

WORK PROPOSED FOR NEXT QUARTER (Second Quarter 2008):

1. Prepared and submitted this First Quarter 2008 Status Report (contained herein).
2. No environmental work is scheduled for the Site during the Second Quarter of 2008.

DISCUSSION:

Case closure was requested by BP on 13 April 2004 from ACEH. BP is currently awaiting a response from the ACEH. For reference, a Ground-Water Elevation Contour and Analytical Summary Map from Third Quarter 2007 is provided as Drawing 1.

ATTACHMENTS:

Drawing 1 Ground-Water Elevation Contour and Analytical Summary Map, 15 August 2007, Station #6148, 5131 Shattuck Avenue, Oakland, California

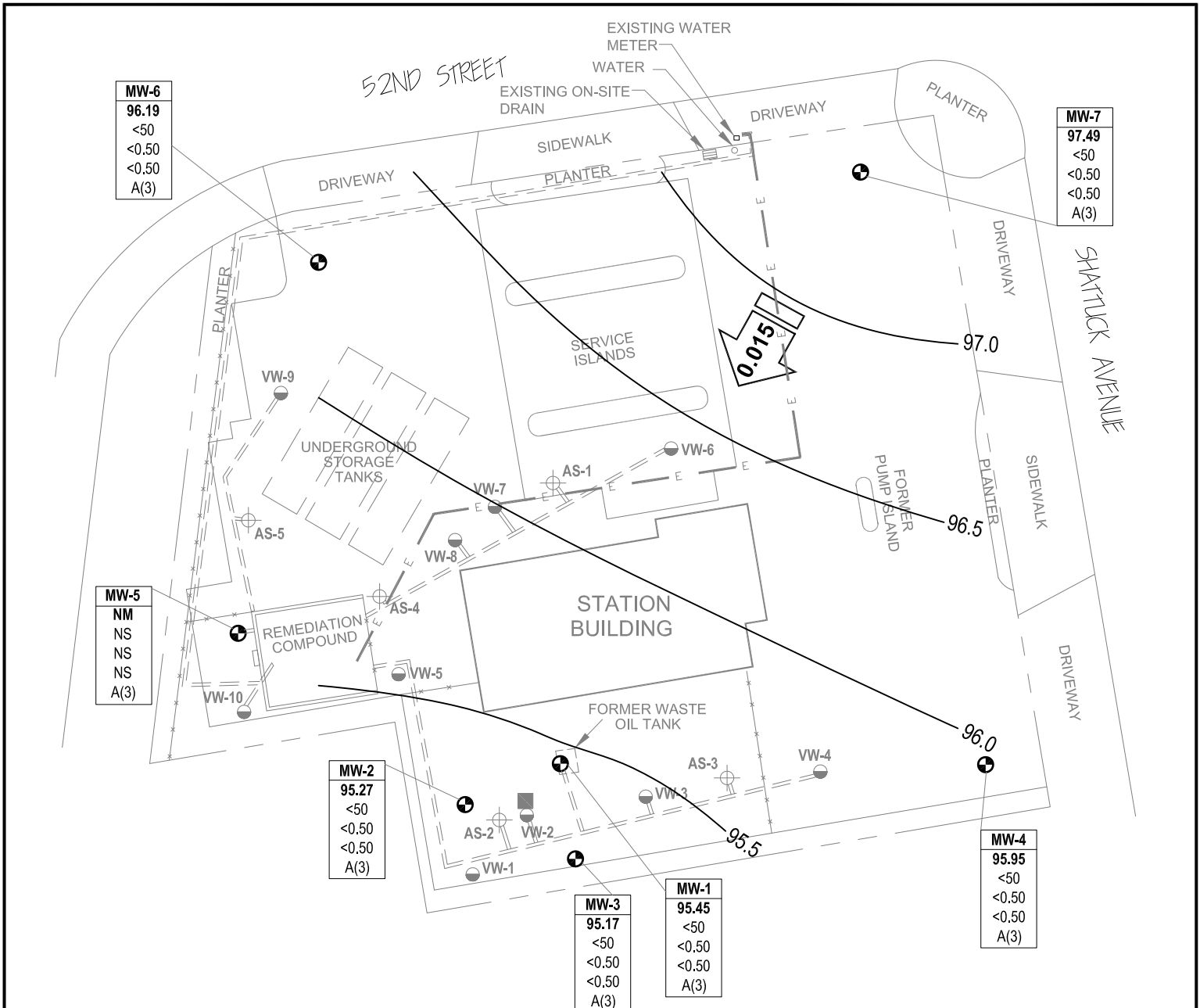

MW-6
96.19
<50
<0.50
<0.50
A(3)

MW-7
97.49
<50
<0.50
<0.50
A(3)

MW-5
NM
NS
NS
NS
NS
A(3)

MW-2
95.27
<50
<0.50
<0.50
A(3)

MW-3
95.17
<50
<0.50
<0.50
A(3)

MW-1
95.45
<50
<0.50
<0.50
A(3)

MW-4
95.95
<50
<0.50
<0.50
A(3)

LEGEND

- MONITORING WELL
- AIR SPARGING WELL
- SOIL VAPOR EXTRACTION WELL
- DESTROYED WELL
- WELL DESIGNATION
- GROUND-WATER ELEVATION (FT ABOVE MSL)
- CONCENTRATION OF GRO, BENZENE AND MTBE IN GROUND WATER (µg/L)
- SAMPLING FREQUENCY
- SAMPLED ANNUALLY, 3RD QUARTER
- NOT DETECTED AT OR ABOVE LABORATORY REPORTING LIMITS
- NOT SAMPLED
- OXYGEN RELEASING COMPOUND SOCK
- ELECTRICAL LINE
- FENCING
- REMEDIATION PIPING
- GROUND-WATER FLOW DIRECTION AND GRADIENT (FT/FT)
- GROUND-WATER ELEVATION CONTOUR (FT/MSL)

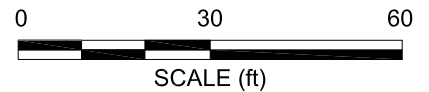

NOTE: SITE MAP ADAPTED FROM IT CORPORATION FIGURES. SITE DIMENSIONS AND FACILITY LOCATIONS NOT VERIFIED.