



Atlantic Richfield Company
(a BP affiliated company)

P.O. Box 1257
San Ramon, CA 94583
Phone: (925) 275-3801
Fax: (925) 275-3815

18 January 2008

Re: Fourth Quarter 2007 Status Report
Atlantic Richfield Company Station #6148
5131 Shattuck Avenue
Oakland, California
ACEH Case #RO0000077

RECEIVED

2:41 pm, Jan 25, 2008

Alameda County
Environmental Health



“I declare, that to the best of my knowledge at the present time, that the information and/or recommendations contained in the attached document are true and correct.”

Submitted by:

Paul Supple
Environmental Business Manger

Broadbent & Associates, Inc.
1324 Mangrove Ave., Suite 212
Chico, CA 95926
Voice (530) 566-1400
Fax (530) 566-1401



18 January 2008

Project No. 06-08-638

Atlantic Richfield Company
P.O. Box 1257
San Ramon, California 94583
Submitted via ENFOS

Attn.: Mr. Paul Supple

Re: Fourth Quarter 2007 Report, Atlantic Richfield Company (a BP affiliated company)
Station #6148, 5131 Shattuck Avenue, Oakland, Alameda County, California;
ACEH Case #RO000077

Dear Mr. Supple:

Provided herein is the *Fourth Quarter 2007 Status Report* for Atlantic Richfield Company Station #6148 located at 5131 Shattuck Avenue, Oakland, Alameda County, California. Case closure was requested by BP from Alameda County Environmental Health (ACEH) on 13 April 2004. BP is currently awaiting a response from ACEH.

Should you have questions regarding this submission, please do not hesitate to contact us at (530) 566-1400.

Sincerely,

BROADBENT & ASSOCIATES, INC.

Thomas A. Venus, P.E.
Senior Engineer

Robert H. Miller, P.G., C.HG.
Principal Hydrogeologist

Enclosures

cc: Mr. Steven Plunkett, ACEH (Submitted via ACEH ftp Site)
Electronic copy uploaded to GeoTracker

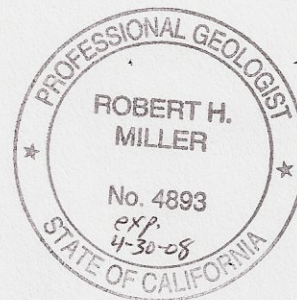

STATION #6148 QUARTERLY GROUND-WATER STATUS REPORT

Facility: #6148	Address:	5131 Shattuck Avenue, Oakland, California
Environmental Business Manager:		Mr. Paul Supple
Consulting Company/Contact Person:		Broadbent & Associates, Inc.(BAI)/Rob Miller & Tom Venus (530)566-1400
Primary Agency/Regulatory ID No.:		Alameda County Environmental Health (ACEH) ACEH Case #RO0000077
Consultant Project No.:		06-08-638

WORK PERFORMED THIS QUARTER (Fourth Quarter 2007):

1. Prepared and submitted Third Quarter 2007 Annual Ground-Water Monitoring Report.
2. No environmental work was conducted at the site during the Fourth Quarter of 2007.

WORK PROPOSED FOR NEXT QUARTER (First Quarter 2008):

1. Prepared and submitted this Fourth Quarter 2007 Status Report (contained herein).
2. No environmental work is scheduled for the Site during the First Quarter of 2008.

DISCUSSION:

Case closure was requested by BP on 13 April 2004 from ACEH. BP is currently awaiting a response from the ACEH. For reference, a Ground-Water Elevation Contour and Analytical Summary Map from Third Quarter 2007 is provided as Drawing 1.

ATTACHMENTS:

Drawing 1 Ground-Water Elevation Contour and Analytical Summary Map, 15 August 2007, Station #6148, 5131 Shattuck Avenue, Oakland, California

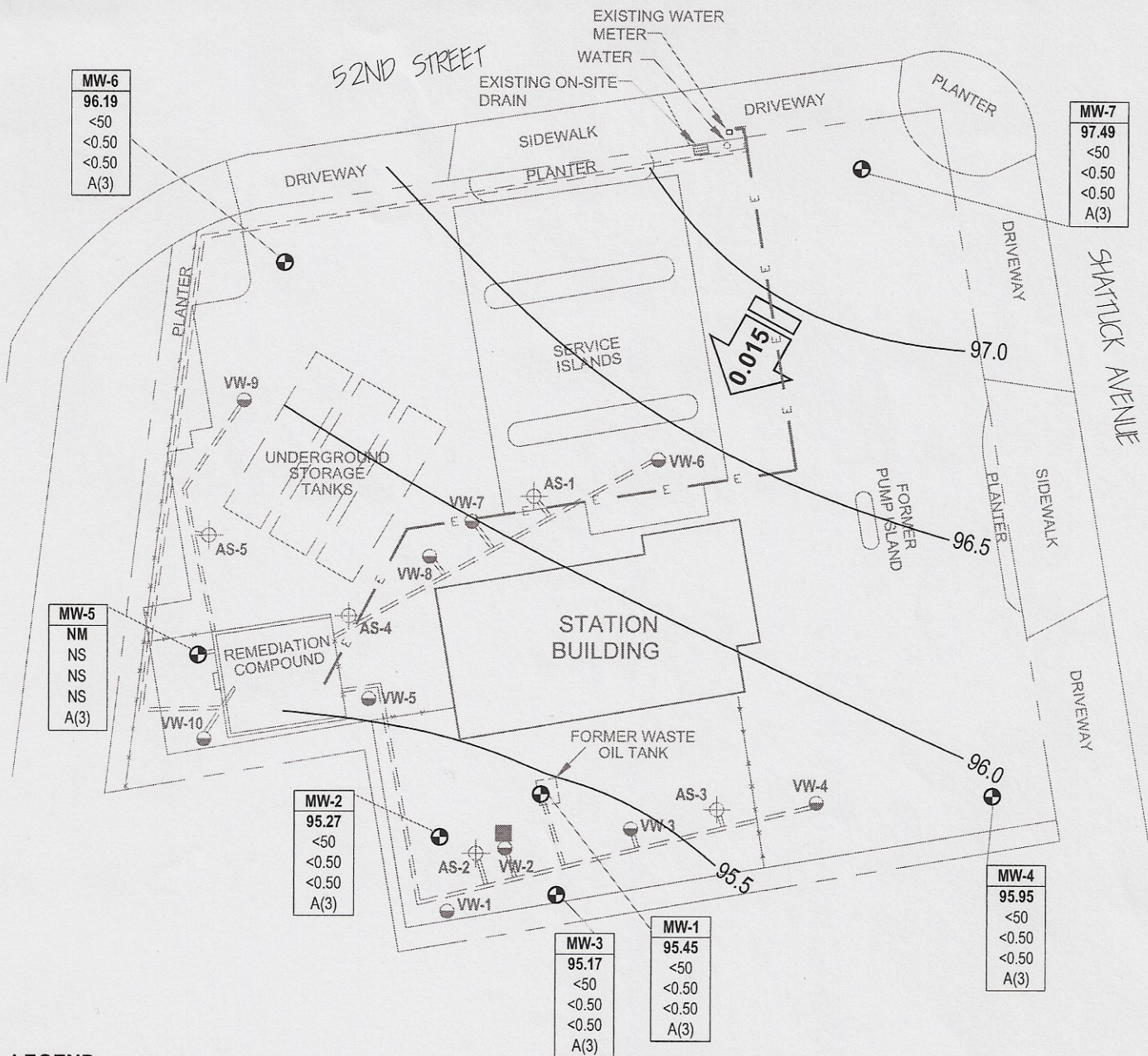

MW-6
96.19
<50
<0.50
<0.50
A(3)

MW-7
97.49
<50
<0.50
<0.50
A(3)

MW-5
NM
NS
NS
NS
A(3)

MW-2
95.27
<50
<0.50
<0.50
A(3)

MW-3
95.17
<50
<0.50
<0.50
A(3)

MW-1
95.45
<50
<0.50
<0.50
A(3)

MW-4
95.95
<50
<0.50
<0.50
A(3)

LEGEND

- MONITORING WELL
- AIR SPARGING WELL
- SOIL VAPOR EXTRACTION WELL
- DESTROYED WELL

- ELECTRICAL LINE
- FENCING
- REMEDIATION PIPING
- GROUND-WATER FLOW DIRECTION AND GRADIENT (FT/FT)
- GROUND-WATER ELEVATION CONTOUR (FT/MSL)

Well	WELL DESIGNATION
ELEV	GROUND-WATER ELEVATION (FT ABOVE MSL)
GRO	CONCENTRATION OF GRO, BENZENE AND MTBE IN GROUND WATER (µg/L)
Benzene	
MTBE	
A	SAMPLING FREQUENCY
A(3)	SAMPLED ANNUALLY, 3RD QUARTER
<	NOT DETECTED AT OR ABOVE LABORATORY REPORTING LIMITS
NS	NOT SAMPLED
ORC	OXYGEN RELEASING COMPOUND SOCK

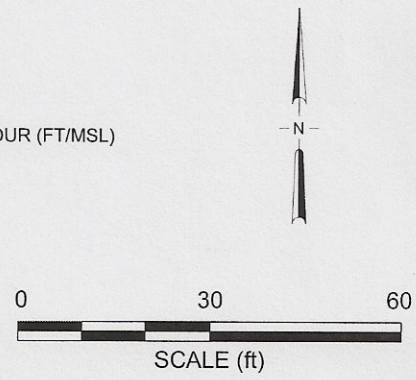

NOTE: SITE MAP ADAPTED FROM IT CORPORATION FIGURES. SITE DIMENSIONS AND FACILITY LOCATIONS NOT VERIFIED.