



RECEIVED

9:05 am, Jan 28, 2010

Alameda County
Environmental Health

ARCADIS U.S., Inc.
100 Montgomery Street, Suite 300
San Francisco, California 94105
Tel 415.374.2744
Fax 415.374.2745
www.arcadis-us.com

Re: Fourth Quarter 2009 Status Report
Former BP Station #4931
731 West MacArthur Blvd.
Oakland, California
ACEH Case #RO0000076

ENVIRONMENTAL

"I declare that to the best of my knowledge at the present time, that the information and/or recommendations contained in the attached document are true and correct."

Date:
01/25/2010

Submitted by:
ARCADIS U.S., Inc.

Contact:
Hollis E. Phillips

Phone:
415.374.2744 ext 13

Hollis E. Phillips, PG
Project Manager

Email:
Hollis.phillips@arcadis-us.com

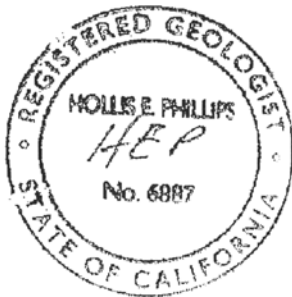

Our ref:
GP09BPNA.C110

25 January 2010

Project No. 09-88-624

ARCADIS-US, Inc.
100 Montgomery Street, Ste. 300
San Francisco, California 94104

Attn.: Ms. Hollis Phillips, PG

Re: Fourth Quarter 2009 Status Report, Former BP Station #4931, 731 West MacArthur Blvd, Oakland, CA; ACEH Case #RO0000076.

Dear Ms. Phillips:

Provided herein is the *Fourth Quarter 2009 Status Report* for Former BP Station #4931 (herein referred to as Station #4931) located at 731 West MacArthur Blvd, Oakland, CA (Site). This report presents a summary of current developments at the Site during the Fourth Quarter of 2009.

Should you have questions regarding the work performed or results obtained, please do not hesitate to contact us at (530) 566-1400.

Sincerely,

BROADBENT & ASSOCIATES, INC.



Jason Duda
Project Scientist



Thomas A. Venus, P.E.
Senior Engineer



Enclosures

cc: Mr. Paresh Khatri, Alameda County Environmental Health (Submitted via ACEH FTP site)
Mr. Nick Goyal, Owner, electronic copy e-mailed (nick@vintnerdist.com)
Electronic copy uploaded to GeoTracker

STATION #4931 QUARTERLY STATUS REPORT

Facility: #4931	Address: 731 MacArthur Blvd, Oakland
ARCADIS Project Manager:	Ms. Hollis Phillips, PG
Consulting Co./Contact Persons:	Broadbent & Associates, Inc.(BAI)/Jason Duda & Tom Venus (530) 566-1400
Primary Agency/Regulatory ID No.:	Alameda County Environmental Health (ACEH) ACEH Case #RO0000076
Consultant Project No.:	09-88-624
Facility Permits/Permitting Agency:	NA

WORK PERFORMED THIS QUARTER (Fourth Quarter 2009):

1. Submitted *Third Quarter 2009 Ground-Water Monitoring Report* (BAI, 10/30/2009).
2. No environmental work was conducted at the Site during the Fourth Quarter of 2009.

WORK PROPOSED FOR NEXT QUARTER (First Quarter 2010):

1. Prepared and submitted this *Fourth Quarter 2009 Status Report* (contained herein).
2. Conduct semi-annual ground-water monitoring/sampling for First Quarter 2010.

QUARTERLY RESULTS SUMMARY:

Current phase of project:	Ground-water monitoring/sampling
Frequency of ground-water monitoring:	Semi-Annually (1Q & 3Q) = A-3, A-4, A-5 and A-8 Annually (3Q) = A-2, A-7, A-9, A-10, A-11, and A-12
Frequency of ground-water sampling:	Semi-Annually (1Q & 3Q) = A-3, A-4, A-5 and A-8 Annually (3Q) = A-2, A-7, A-9, A-10, A-11, and A-12
Is free product (FP) present on-site:	NA
Current remediation techniques:	NA
Depth to ground water (below TOC):	NA
General ground-water flow direction:	NA
Approximate hydraulic gradient:	NA

DISCUSSION:

No environmental work was conducted at the Site during the Fourth Quarter of 2009. Semi-annual ground-water monitoring/sampling occurred during the Third Quarter of 2009. A Site Location Map is provided as Drawing 1. For reference, a ground-water elevation and analytical summary map depicting data from the Third Quarter 2009 sampling event is provided as Drawing 2. Semi-annual ground-water monitoring/sampling is scheduled to be conducted at the Site during the First Quarter of 2010.

ATTACHMENTS:

- Drawing 1. Site Location Map, Station #4931, 731 West MacArthur Blvd, Oakland, CA
- Drawing 2. Ground-Water Elevation Contour and Analytical Summary Map, 3 September 2009, Station #4931, 731 West MacArthur Blvd, Oakland, CA

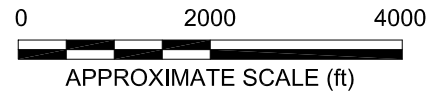
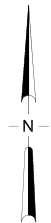
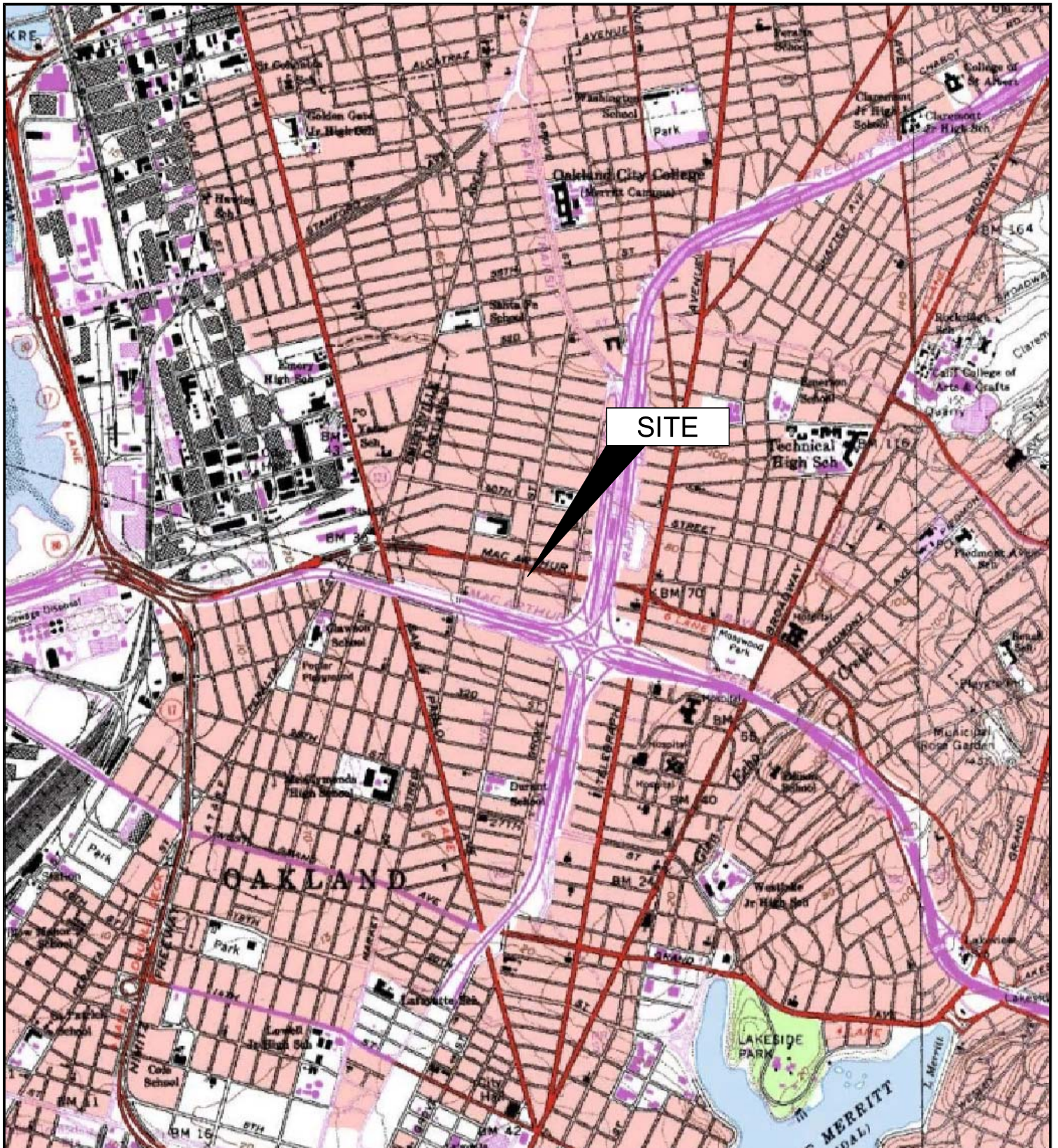
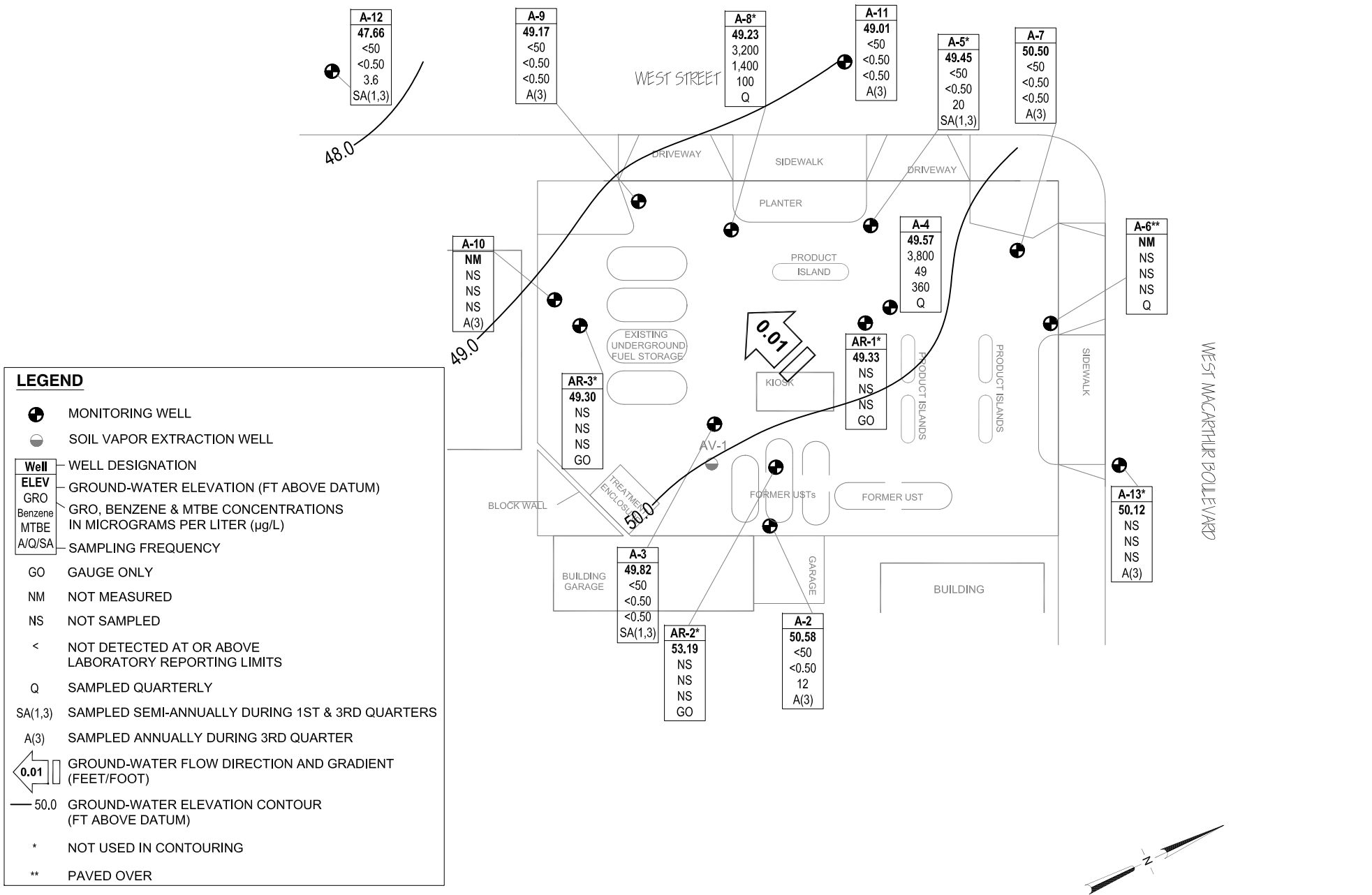

IMAGE SOURCE: USGS



LEGEND

- ⊕ MONITORING WELL
- ⊙ SOIL VAPOR EXTRACTION WELL

Well	WELL DESIGNATION
ELEV	GROUND-WATER ELEVATION (FT ABOVE DATUM)
GRO	GRO, BENZENE & MTBE CONCENTRATIONS IN MICROGRAMS PER LITER (µg/L)
Benzene	
MTBE	
A/Q/SA	SAMPLING FREQUENCY

- GO GAUGE ONLY
- NM NOT MEASURED
- NS NOT SAMPLED
- < NOT DETECTED AT OR ABOVE LABORATORY REPORTING LIMITS
- Q SAMPLED QUARTERLY
- SA(1,3) SAMPLED SEMI-ANNUALLY DURING 1ST & 3RD QUARTERS
- A(3) SAMPLED ANNUALLY DURING 3RD QUARTER

← 0.01 GROUND-WATER FLOW DIRECTION AND GRADIENT (FEET/FOOT)

— 50.0 GROUND-WATER ELEVATION CONTOUR (FT ABOVE DATUM)

- * NOT USED IN CONTOURING
- ** PAVED OVER

NOTE: SITE MAP ADAPTED FROM URS FIGURES.
SITE DIMENSIONS AND FACILITY LOCATIONS NOT VERIFIED.

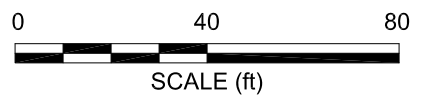

BROADBENT & ASSOCIATES, INC.
ENGINEERING, WATER RESOURCES & ENVIRONMENTAL
1324 Mangrove Ave. Suite 212, Chico, California 95926
Project No.: 06-88-624 Date: 10/1/09

Station #4931
731 West MacArthur Boulevard
Oakland, California

Ground-Water Elevation Contour
and Analytical Summary Map
3 September 2009