



June 22, 2005

Ms. Donna Drogas
Alameda County Environmental Health (ACEH)
1131 Harbor Bay Parkway, Suite 250
Alameda, CA 94502-6577

Alameda County
JUL 08 2005
Environmental Health

**Re: Second Quarter 2005 Groundwater Monitoring Report
ARCO Service Station #4931
731 West MacArthur Boulevard
Oakland, California
ACEH Case #3874**

Dear Ms. Drogas:

On behalf of Atlantic Richfield Company, a BP affiliated company, URS Corporation (URS) is submitting the *Second Quarter 2005 Groundwater Monitoring Report* for ARCO Service Station #4931, located at 731 West MacArthur Boulevard, Oakland, California.

If you have any questions regarding this submission, please call (510) 874-3280.

Sincerely,

URS CORPORATION



Scott Robinson, P.G.
Project Manager



Enclosure: Second Quarter 2005 Groundwater Monitoring Report

cc: Mr. Paul Supple, Atlantic Richfield Company (RM), electronic copy uploaded to ENFOS
Mr. Chuck Headlee, Regional Water Quality Control Board - San Francisco Bay Region, 1515
Clay Street, Suite 1400, Oakland, CA 94612 and uploaded to RWQCB ftp site.
Mr. Nick Goyal, Owner, electronic copy e-mailed (nick@vintersdist.com)

URS Corporation
1333 Broadway, Suite 800
Oakland, CA 94612-1924
Tel: 510.893.3600
Fax: 510.874.3268



Atlantic Richfield Company
(a BP affiliated company)

P.O. Box 6549
Moraga, California 94570
Phone: (925) 299-8891
Fax: (925) 299-8872

June 22, 2005

Re: Second Quarter 2005 Groundwater Monitoring Report
ARCO Service Station #4931
731 West MacArthur Boulevard
Oakland, California
ACEH Case #3874



Alameda County
JUL 08 2005
Environmental Health

I declare, that to the best of my knowledge at the present time, that the information and/or recommendations contained in the attached document are true and correct.

Submitted by:

Paul Supple
Environmental Business Manager

R E P O R T

**SECOND QUARTER 2005
GROUNDWATER MONITORING
REPORT**

**ARCO SERVICE STATION #4931
731 WEST MACARTHUR BOULEVARD
OAKLAND, CALIFORNIA**

Prepared for
RM

June 22, 2005

URS

URS Corporation
1333 Broadway, Suite 800
Oakland, California 94612

Date: June 22, 2005
Quarter: 2Q 05

RM QUARTERLY GROUNDWATER MONITORING REPORT

Facility No.: 4931 Address: 731 West MacArthur Boulevard, Oakland, California
RM Environmental Business Manager: Paul Supple
Consulting Co./Contact Person: URS Corporation / Scott Robinson
Primary Agency: Alameda County Environmental Health (ACEH)
ACEH Case #: 3874

WORK PERFORMED THIS QUARTER (Second – 2005):

1. Performed second quarter 2005 groundwater monitoring event on May 9, 2005.
2. Prepared and submitted this Second Quarter 2005 Groundwater Monitoring Report.

WORK PROPOSED FOR NEXT QUARTER (Third – 2005):

1. Perform third quarter 2005 groundwater monitoring event.
2. Prepare and submit Third Quarter 2005 Groundwater Monitoring Report.
3. Uncover well A-6.

SITE SUMMARY:

Current Phase of Project: Remediation/Groundwater monitoring/sampling
Frequency of Groundwater Sampling: Quarterly: A-4, A-6, A-8
Semi-Annual (1st/3rd Quarter): A-3, A-5
Annual (3rd Quarter): A-2, A-7, A-9, A-10, A-11, A-12
Frequency of Groundwater Monitoring: Quarterly: All wells including AR-1, AR-2, AR-3
Free Product (FP) Present On-Site: No
Current Remediation Techniques: None
Approximate Depth to Groundwater: 2.84 (AR-2) to 8.21 (A-10) feet
Groundwater Gradient (direction): Northwest-Southwest
Groundwater Gradient (magnitude): 0.04 feet per foot

DISCUSSION:

Gasoline range organics were detected at or above the laboratory reporting limit in one of the two wells sampled this quarter at a concentration of 69 micrograms per liter ($\mu\text{g/L}$) (A-8). Benzene was detected at or above the laboratory reporting limit in both wells at concentrations of 0.90 $\mu\text{g/L}$ (A-8) and 140 $\mu\text{g/L}$ (A-4). Ethylbenzene was detected at or above the laboratory reporting limit in one well at a concentration of 62 $\mu\text{g/L}$ (A-4). Methyl tert-butyl ether was detected at or above the laboratory reporting limit in both wells at concentrations of 66 $\mu\text{g/L}$ (A-8) and 1,800 $\mu\text{g/L}$ (A-4). Tert-butyl alcohol was detected at or above laboratory reporting limits in one well at a concentration of 2,000 $\mu\text{g/L}$ (A-4). Tert-amyl methyl ether was detected at or above the laboratory reporting limit in both wells at concentrations of 2.9 $\mu\text{g/L}$ (A-8) to 460 $\mu\text{g/L}$ (A-4). No other fuel components were detected at or above their respective laboratory reporting limits. During sampling, well A-4 dewatered after purging 10 gallons. Well A-6 was not sampled because it has been paved over.

ATTACHMENTS:

- Figure 1 – Groundwater Elevation Contour and Analytical Summary Map – May 9, 2005
- Table 1 – Groundwater Elevation and Analytical Data
- Table 2 – Fuel Additives Analytical Data
- Table 3 – Groundwater Flow Direction and Gradient
- Attachment A – Field Procedures and Field Data Sheets
- Attachment B – Laboratory Procedures, Certified Analytical Reports and Chain-of-Custody Records
- Attachment C – Historical Groundwater Data
- Attachment D – Error Check Reports and EDF/Geowell Submittal Confirmations

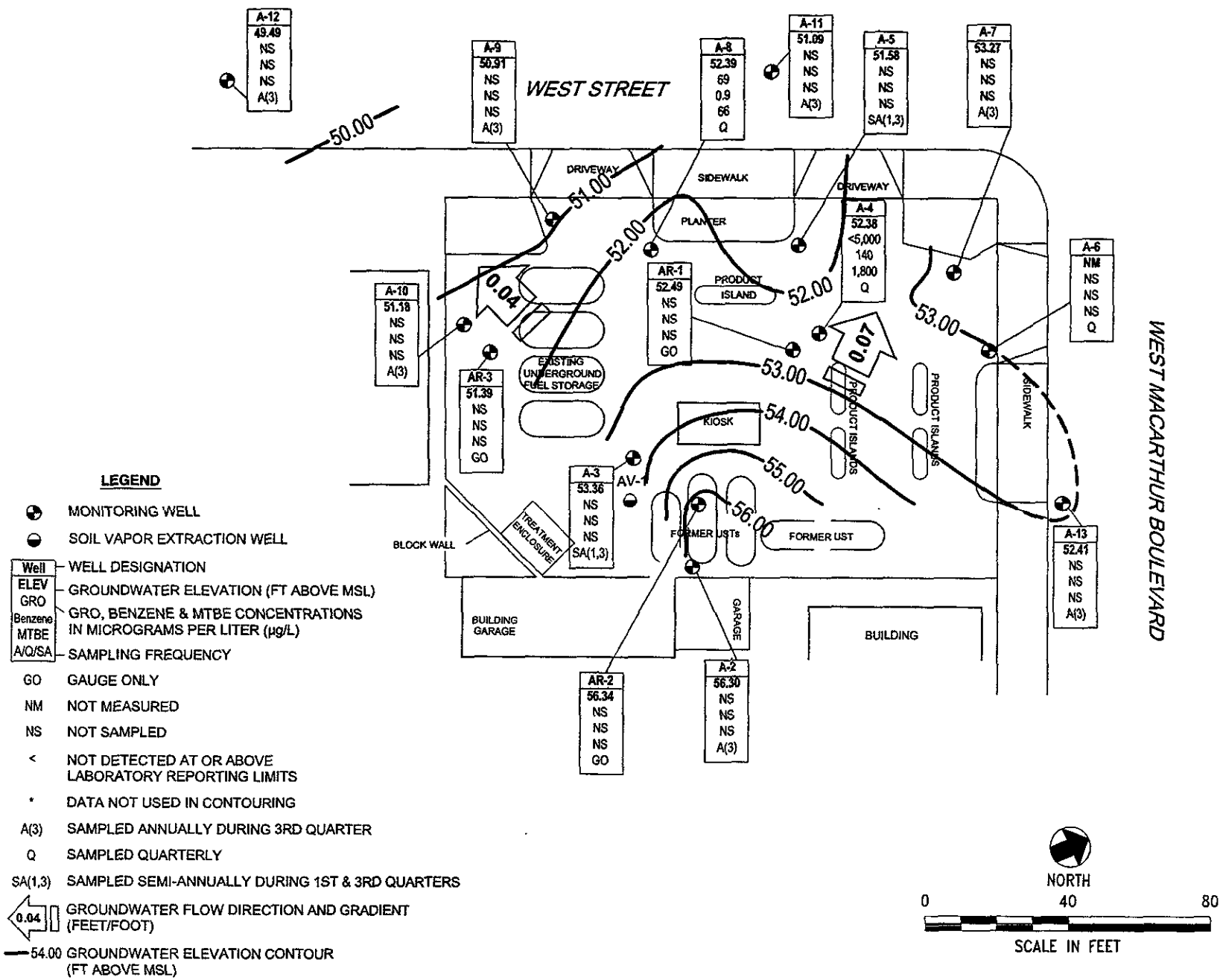

URS	Project No. 38487182	GROUNDWATER ELEVATION CONTOUR AND ANALYTICAL SUMMARY MAP Second Quarter 2005 (May 9, 2005)	FIGURE 1
	ARCO Service Station #4931 731 West MacArthur Boulevard Oakland, California		

Table 1

Groundwater Elevation and Analytical Data

ARCO Service Station #4931

731 West MacArthur Blvd., Oakland, CA

Well No.	Date	P/ NP	Footnotes/ Comments	TOC (ft MSL)	Top of Screen (ft bgs)	Bottom of Screen (ft bgs)	DTW (ft bgs)	GWE (ft MSL)	GRO/ TPH-g (µg/L)	Benzene (µg/L)	Toluene (µg/L)	Ethyl-benzene (µg/L)	Total Xylenes (µg/L)	MTBE (µg/L)	DO (mg/L)	pH
A-2	6/21/2000	--		55.48	5.00	20.00	6.85	48.63	<50	<0.5	<0.5	<0.5	<1.0	<3.0	--	--
	9/20/2000	--		55.48	5.00	20.00	10.45	45.03	<50	<0.5	<0.5	<0.5	<0.5	<2.5	--	--
	12/26/2000	--		55.48	5.00	20.00	6.27	49.21	<50	<0.5	<0.5	<0.5	<0.5	<2.5	--	--
	3/20/2001	--		55.48	5.00	20.00	4.57	50.91	<50	<0.5	<0.5	<0.5	<0.5	<2.5	--	--
	6/12/2001	--		55.48	5.00	20.00	9.27	46.21	<50	<0.5	<0.5	<0.5	<0.5	<2.5	--	--
	9/23/2001	--		55.48	5.00	20.00	10.75	44.73	<50	<0.5	<0.5	<0.5	<0.5	<2.5	--	--
	12/31/2001	--		55.48	5.00	20.00	4.13	51.35	<50	<0.5	<0.5	1	3.2	<2.5	--	--
	3/21/2002	--		55.48	5.00	20.00	3.26	52.22	<50	<0.5	<0.5	<0.5	<0.5	<2.5	--	--
	4/17/2002	--		55.48	5.00	20.00	3.72	51.76	<50	<0.5	<0.5	<0.5	<0.5	3.1	--	--
	8/12/2002	NP		55.48	5.00	20.00	9.95	45.53	<10	<0.10	<0.10	<0.10	<0.10	<0.50	3.1	7.7
	12/6/2002	NP		55.48	5.00	20.00	10.01	45.47	<50	<0.50	<0.50	<0.50	<0.50	6	3.1	6.1
	1/30/2003	NP		55.48	5.00	20.00	5.08	50.40	<50	<0.50	<0.50	<0.50	<0.50	<0.50	2.6	6.7
	5/28/2003	--		55.48	5.00	20.00	4.82	50.66	<50	<0.50	<0.50	<0.50	<0.50	1.1	5.7	6.8
	8/6/2003	--		55.48	5.00	20.00	9.73	45.75	<50	<0.50	<0.50	<0.50	<0.50	<0.50	2.3	7.7
	11/14/2003	--		55.48	5.00	20.00	9.36	46.12	--	--	--	--	--	--	--	--
	02/02/2004	--	g	60.65	5.00	20.00	4.45	56.20	--	--	--	--	--	--	--	--
	05/04/2004	--		60.65	5.00	20.00	6.79	53.86	--	--	--	--	--	--	--	--
	09/02/2004	NP		60.65	5.00	20.00	10.51	50.14	<50	<0.50	<0.50	<0.50	<0.50	<0.50	3.1	--
	11/10/2004	--		60.65	5.00	20.00	6.10	54.55	--	--	--	--	--	--	--	--
	02/02/2005	--		60.65	5.00	20.00	4.00	56.65	--	--	--	--	--	--	--	--
	05/09/2005	--		60.65	5.00	20.00	4.35	56.30	--	--	--	--	--	--	--	--
A-3	6/21/2000	--		54.66	5.00	20.00	9.48	45.18	<50	<0.5	<0.5	<0.5	<1.0	46	--	--
	9/20/2000	--		54.66	5.00	20.00	10.24	44.42	<50	<0.5	<0.5	<0.5	<0.5	89.6	--	--
	12/26/2000	--		54.66	5.00	20.00	9.58	45.08	<50	<0.5	<0.5	<0.5	<0.5	7.11	--	--
	3/20/2001	--		54.66	5.00	20.00	6.34	48.32	--	--	--	--	--	--	--	--
	6/12/2001	--		54.66	5.00	20.00	9.76	44.90	<50	<0.5	<0.5	<0.5	<0.5	86	--	--
	9/23/2001	--		54.66	5.00	20.00	10.55	44.11	--	--	--	--	--	--	--	--
	12/31/2001	--		54.66	5.00	20.00	3.70	50.96	<50	<0.5	<0.5	<0.5	1	60	--	--
	3/21/2002	--		54.66	5.00	20.00	5.75	48.91	--	--	--	--	--	--	--	--
	4/17/2002	--		54.66	5.00	20.00	7.27	47.39	<50	<0.5	<0.5	<0.5	<0.5	45	--	--
	8/12/2002	--		54.66	5.00	20.00	9.71	44.95	--	--	--	--	--	--	--	--
	12/6/2002	P		54.66	5.00	20.00	9.55	45.11	<500	<5.0	<5.0	<5.0	<5.0	150	2.4	6.6
	1/30/2003	--		54.66	5.00	20.00	6.05	48.61	--	--	--	--	--	--	--	--

Table 1

Groundwater Elevation and Analytical Data

ARCO Service Station #4931

731 West MacArthur Blvd., Oakland, CA

Well No.	Date	P/ NP	Footnotes/ Comments	TOC (ft MSL)	Top of Screen (ft bgs)	Bottom of Screen (ft bgs)	DTW (ft bgs)	GWE (ft MSL)	GRO/ TPH-g (µg/L)	Benzene (µg/L)	Toluene (µg/L)	Ethyl-benzene (µg/L)	Total Xylenes (µg/L)	MTBE (µg/L)	DO (mg/L)	pH
A-3	5/28/2003	--		54.66	5.00	20.00	8.06	46.60	74	<0.50	<0.50	<0.50	<0.50	43	1.5	6.9
	8/6/2003	--		54.66	5.00	20.00	9.91	44.75	--	--	--	--	--	--	--	--
	11/14/2003	--		54.66	5.00	20.00	9.52	45.14	--	--	--	--	--	--	--	--
	02/02/2004	P	g	59.32	5.00	20.00	5.63	53.69	<50	<0.50	<0.50	<0.50	<0.50	13	1.2	7.1
	05/04/2004	--		59.32	5.00	20.00	8.14	51.18	--	--	--	--	--	--	--	--
	09/02/2004	P		59.32	5.00	20.00	10.10	49.22	<250	<2.5	<2.5	<2.5	<2.5	62	1.3	6.6
	11/10/2004	--		59.32	5.00	20.00	7.89	51.43	--	--	--	--	--	--	--	--
	02/02/2005	P		59.32	5.00	20.00	5.00	54.32	<50	<0.50	<0.50	<0.50	<0.50	6.8	1.9	6.9
	05/09/2005	--		59.32	5.00	20.00	5.96	53.36	--	--	--	--	--	--	--	--
A-4	6/21/2000	--		54.73	5.00	20.00	9.49	45.24	2,100	110	2.1	11	5.9	2,000	--	--
	9/20/2000	--		54.73	5.00	20.00	10.33	44.40	1,540	127	<5.0	9.07	7.42	1,940	--	--
	12/26/2000	--		54.73	5.00	20.00	9.34	45.39	1,550	42.7	<5.0	11	10.9	1,210	--	--
	3/20/2001	--		54.73	5.00	20.00	7.56	47.17	913	40.9	<5.0	15.5	14.6	<25	--	--
	6/12/2001	--		54.73	5.00	20.00	9.83	44.90	2,000	230	<20	21	<20	4,700	--	--
	9/23/2001	--		54.73	5.00	20.00	10.54	44.19	1,600	35	<10	<10	<10	3,000	--	--
	12/31/2001	--		54.73	5.00	20.00	5.42	49.31	<500	<5.0	<5.0	<5.0	<5.0	880	--	--
	3/21/2002	--		54.73	5.00	20.00	6.18	48.55	<5,000	<50	<50	<50	<50	1,400	--	--
	4/17/2002	--		54.73	5.00	20.00	7.34	47.39	1,300	79	31	17	55	2,200	--	--
	8/12/2002	P	a	54.73	5.00	20.00	9.56	45.17	2,400	120	<5.0	<5.0	<5.0	2,100	2	7.2
	12/6/2002	P		54.73	5.00	20.00	10.02	44.71	2,200	110	10	42	56	2,000	--	6.7
	1/30/2003	P		54.73	5.00	20.00	7.55	47.18	6,000	180	<50	85	<50	2,100	1.8	6.8
	5/28/2003	--		54.73	5.00	20.00	8.94	45.79	6,000	120	<50	<50	<50	2,500	1.5	6.7
	8/6/2003	--		54.73	5.00	20.00	10.03	44.70	5,800	100	<25	<25	33	2,500	1.5	6.7
	11/14/2003	P	d, f	54.73	5.00	20.00	10.37	44.36	1,000	17	<5.0	<5.0	<5.0	310	1.6	6.8
	02/02/2004	P	d, g	59.59	5.00	20.00	6.70	52.89	3,600	46	<25	<25	<25	1,500	1.0	7.1
	05/04/2004	P	d	59.59	5.00	20.00	9.12	50.47	<5,000	<50	<50	<50	<50	2,300	6.4	6.8
09/02/2004	P		59.59	5.00	20.00	9.95	49.64	3,000	<25	<25	<25	<25	1,200	9.1	6.8	
11/10/2004	P		59.59	5.00	20.00	8.68	50.91	1,800	16	<10	<10	<10	1,100	2.0	7.2	
02/02/2005	P		59.59	5.00	20.00	6.92	52.67	3,300	120	<10	66	11	1,700	1.5	6.5	
05/09/2005	P		59.59	5.00	20.00	7.21	52.38	<5,000	140	<50	62	<50	1,800	1.64	6.6	
A-5	6/21/2000	--		54.17	3.00	24.00	9.29	44.88	980	<0.5	<0.5	<0.5	<1.0	2,000	--	--
	9/20/2000	--		54.17	3.00	24.00	10.23	43.94	--	--	--	--	--	--	--	--
	12/26/2000	--		54.17	3.00	24.00	9.65	44.52	525	<0.5	<0.5	<0.5	<0.5	1,200	--	--

Table 1

Groundwater Elevation and Analytical Data

ARCO Service Station #4931

731 West MacArthur Blvd., Oakland, CA

Well No.	Date	P/ NP	Footnotes/ Comments	TOC (ft MSL)	Top of Screen (ft bgs)	Bottom of Screen (ft bgs)	DTW (ft bgs)	GWE (ft MSL)	GRO/ TPH-g (µg/L)	Benzene (µg/L)	Toluene (µg/L)	Ethylbenzene (µg/L)	Total Xylenes (µg/L)	MTBE (µg/L)	DO (mg/L)	pH
A-5	3/20/2001	--		54.17	3.00	24.00	8.05	46.12	--	--	--	--	--	--	--	--
	6/12/2001	--		54.17	3.00	24.00	9.81	44.36	830	<5.0	<5.0	<5.0	<5.0	3,200	--	--
	9/23/2001	--		54.17	3.00	24.00	10.42	43.75	--	--	--	--	--	--	--	--
	12/31/2001	--		54.17	3.00	24.00	6.03	48.14	320	<0.5	<0.5	<0.5	<0.5	60	--	--
	3/21/2002	--		54.17	3.00	24.00	6.71	47.46	--	--	--	--	--	--	--	--
	4/17/2002	--		54.17	3.00	24.00	8.01	46.16	1,600	<10	<10	<10	<10	3,200	--	--
	8/12/2002	--		54.17	3.00	24.00	9.87	44.30	--	--	--	--	--	--	--	--
	12/6/2002	P		54.17	3.00	24.00	9.66	44.51	310	<0.50	<0.50	<0.50	<0.50	330	1.9	6.6
	1/30/2003	--		54.17	3.00	24.00	7.67	46.50	--	--	--	--	--	--	--	--
	5/28/2003	--		54.17	3.00	24.00	8.56	45.61	<5,000	<50	<50	<50	<50	1,500	1.6	6.6
	8/6/2003	--		54.17	3.00	24.00	9.58	44.59	--	--	--	--	--	--	--	--
	11/14/2003	--		54.17	3.00	24.00	9.81	44.36	--	--	--	--	--	--	--	--
	02/02/2004	P	g	58.78	3.00	24.00	7.43	51.35	390	<2.5	9.2	<2.5	2.6	140	1.0	6.8
	05/04/2004	--		58.78	3.00	24.00	9.98	48.80	--	--	--	--	--	--	--	--
	09/02/2004	P		58.78	3.00	24.00	9.65	49.13	<250	<2.5	<2.5	<2.5	<2.5	66	1.1	6.4
	11/10/2004	--		58.78	3.00	24.00	8.48	50.30	--	--	--	--	--	--	--	--
	02/02/2005	P		58.78	3.00	24.00	7.10	51.68	68	<0.50	<0.50	<0.50	<0.50	17	1.0	7.2
	05/09/2005	--		58.78	3.00	24.00	7.20	51.58	--	--	--	--	--	--	--	--
A-6	6/21/2000	--		55.17	3.00	25.00	8.67	46.50	<50	<0.5	<0.5	<0.5	<1.0	<3.0	--	--
	9/20/2000	--		55.17	3.00	25.00	9.34	45.83	<50	<0.5	<0.5	<0.5	<0.5	<2.5	--	--
	12/26/2000	--		55.17	3.00	25.00	8.65	46.52	<50	<0.5	<0.5	<0.5	<0.5	<2.5	--	--
	3/20/2001	--		55.17	3.00	25.00	6.84	48.33	<50	<0.5	<0.5	<0.5	<0.5	<2.5	--	--
	6/12/2001	--		55.17	3.00	25.00	8.93	46.24	<50	<0.5	<0.5	<0.5	<0.5	7	--	--
	9/23/2001	--		55.17	3.00	25.00	9.74	45.43	<50	<0.5	<0.5	<0.5	<0.5	<2.5	--	--
	12/31/2001	--		55.17	3.00	25.00	4.81	50.36	<50	<0.5	<0.5	<0.5	<0.5	3.2	--	--
	3/21/2002	--		55.17	3.00	25.00	5.44	49.73	<50	<0.5	<0.5	<0.5	<0.5	<2.5	--	--
	4/17/2002	--		55.17	3.00	25.00	6.95	48.22	<50	<0.5	<0.5	<0.5	<0.5	3.1	--	--
	8/12/2002	NP		55.17	3.00	25.00	8.90	46.27	<50	<0.5	<0.5	<0.5	<0.5	<2.5	4.3	7.9
	12/6/2002	--	e	55.17	3.00	25.00	--	--	--	--	--	--	--	--	--	--
	1/30/2003	--	e	55.17	3.00	25.00	--	--	--	--	--	--	--	--	--	--
	5/28/2003	--	e	55.17	3.00	25.00	--	--	--	--	--	--	--	--	--	--
	8/6/2003	--	e	55.17	3.00	25.00	--	--	--	--	--	--	--	--	--	--
	11/14/2003	--	e	55.17	3.00	25.00	--	--	--	--	--	--	--	--	--	--

Table 1

Groundwater Elevation and Analytical Data

ARCO Service Station #4931

731 West MacArthur Blvd., Oakland, CA

Well No.	Date	P/ NP	Footnotes/ Comments	TOC (ft MSL)	Top of Screen (ft bgs)	Bottom of Screen (ft bgs)	DTW (ft bgs)	GWE (ft MSL)	GRO/ TPH-g (µg/L)	Benzene (µg/L)	Toluene (µg/L)	Ethyl-benzene (µg/L)	Total Xylenes (µg/L)	MTBE (µg/L)	DO (mg/L)	pH
A-6	02/02/2004	--	e	55.17	3.00	25.00	--	--	--	--	--	--	--	--	--	--
	05/04/2004	--	e	55.17	3.00	25.00	--	--	--	--	--	--	--	--	--	--
	09/02/2004	--	e	55.17	3.00	25.00	--	--	--	--	--	--	--	--	--	--
	11/10/2004	--	e	55.17	3.00	25.00	--	--	--	--	--	--	--	--	--	--
	02/02/2005	--	e	55.17	3.00	25.00	--	--	--	--	--	--	--	--	--	--
	05/09/2005	--	e	55.17	3.00	25.00	--	--	--	--	--	--	--	--	--	--
A-7	6/21/2000	--		54.71	3.00	22.00	8.58	46.13	<50	<0.5	<0.5	<0.5	<1.0	<3.0	--	--
	9/20/2000	--		54.71	3.00	22.00	9.19	45.52	--	--	--	--	--	--	--	--
	12/26/2000	--		54.71	3.00	22.00	8.50	46.21	--	--	--	--	--	--	--	--
	3/20/2001	--		54.71	3.00	22.00	6.75	47.96	--	--	--	--	--	--	--	--
	6/12/2001	--		54.71	3.00	22.00	8.80	45.91	< 50	< 0.5	< 0.5	< 0.5	<0.5	<2.5	--	--
	9/23/2001	--		54.71	3.00	22.00	9.59	45.12	--	--	--	--	--	--	--	--
	12/31/2001	--		54.71	3.00	22.00	4.78	49.93	--	--	--	--	--	--	--	--
	3/21/2002	--		54.71	3.00	22.00	5.35	49.36	--	--	--	--	--	--	--	--
	4/17/2002	--		54.71	3.00	22.00	6.88	47.83	<50	<0.5	<0.5	<0.5	<0.5	2.5	--	--
	8/12/2002	--		54.71	3.00	22.00	8.77	45.94	--	--	--	--	--	--	--	--
	12/6/2002	--		54.71	3.00	22.00	9.07	45.64	--	--	--	--	--	--	--	--
	1/30/2003	--		54.71	3.00	22.00	6.65	48.06	--	--	--	--	--	--	--	--
	5/28/2003	--		54.71	3.00	22.00	7.63	47.08	<50	<0.50	<0.50	<0.50	<0.50	3.8	2.3	6.7
	8/6/2003	--		54.71	3.00	22.00	8.90	45.81	--	--	--	--	--	--	--	--
	11/14/2003	--		54.71	3.00	22.00	9.08	45.63	--	--	--	--	--	--	--	--
	02/02/2004	--	g	59.75	3.00	22.00	5.96	53.79	--	--	--	--	--	--	--	--
	05/04/2004	--		59.75	3.00	22.00	8.21	51.54	--	--	--	--	--	--	--	--
	09/02/2004	P		59.75	3.00	22.00	9.02	50.73	<50	<0.50	<0.50	<0.50	<0.50	8.9	3.0	6.7
11/10/2004	--		59.75	3.00	22.00	7.50	52.25	--	--	--	--	--	--	--	--	
02/02/2005	--		59.75	3.00	22.00	6.10	53.65	--	--	--	--	--	--	--	--	
05/09/2005	--		59.75	3.00	22.00	6.48	53.27	--	--	--	--	--	--	--	--	
A-8	6/21/2000	--		53.77	3.00	25.00	9.07	44.70	810	<0.5	<0.5	<0.5	810	1,500	--	--
	9/20/2000	--		53.77	3.00	25.00	9.72	44.05	10,800	2,680	46	439	370	4,410	--	--
	12/26/2000	--		53.77	3.00	25.00	9.20	44.57	7,700	1,440	<50	202	106	2,230	--	--
	3/20/2001	--		53.77	3.00	25.00	7.51	46.26	<5,000	1,280	<50	53.9	<50	2,880	--	--
	6/12/2001	--		53.77	3.00	25.00	9.53	44.24	5,600	1,700	<50	61	54	2,900	--	--
	9/23/2001	--		53.77	3.00	25.00	10.08	43.69	10,000	3,500	<50	110	64	6,500	--	--

Table 1

Groundwater Elevation and Analytical Data

ARCO Service Station #4931

731 West MacArthur Blvd., Oakland, CA

Well No.	Date	P/ NP	Footnotes/ Comments	TOC (ft MSL)	Top of Screen (ft bgs)	Bottom of Screen (ft bgs)	DTW (ft bgs)	GWE (ft MSL)	GRO/ TPH-g (µg/L)	Benzene (µg/L)	Toluene (µg/L)	Ethyl-benzene (µg/L)	Total Xylenes (µg/L)	MTBE (µg/L)	DO (mg/L)	pH
A-8	12/31/2001	--		53.77	3.00	25.00	4.34	49.43	4,300	610	<10	60	24	520	--	--
	3/21/2002	--		53.77	3.00	25.00	6.67	47.10	6,600	1,400	<50	130	<50	2,700	--	--
	4/17/2002	--		53.77	3.00	25.00	7.72	46.05	3,800	540	<10	<10	12	3,100	--	--
	8/12/2002	NP		53.77	3.00	25.00	9.64	44.13	9,400	1,800	<20	35	28	4,200	1	6.7
	12/6/2002	NP	b	53.77	3.00	25.00	9.62	44.15	5,300	1,100	11	11	<10	2,200	1.4	6.7
	1/30/2003	NP		53.77	3.00	25.00	7.49	46.28	<10,000	1,100	<100	<100	<100	2,200	1.5	6.9
	5/28/2003	--		53.77	3.00	25.00	9.17	44.60	7,700	1,700	<50	<50	<50	2,100	1	6.8
	8/6/2003	--		53.77	3.00	25.00	9.67	44.10	13,000	2,400	<50	<50	<50	3,000	0.9	6.5
	11/14/2003	NP	d	53.77	3.00	25.00	9.80	43.97	3,100	570	<5.0	<5.0	<5.0	850	2.3	6.2
	02/02/2004	NP	d, g	58.70	3.00	25.00	7.10	51.60	3,900	300	<25	<25	<25	1,100	1.1	6.8
	05/04/2004	NP		58.70	3.00	25.00	9.44	49.26	<5,000	490	<50	<50	<50	1,600	1.0	6.9
	09/02/2004	NP		58.70	3.00	25.00	9.67	49.03	<2,500	30	<25	<25	<25	680	1.0	6.2
	11/10/2004	NP		58.70	3.00	25.00	8.15	50.55	580	61	<2.5	<2.5	<2.5	290	1.5	6.4
	02/02/2005	NP		58.70	3.00	25.00	6.53	52.17	5,000	890	<25	<25	<25	1,900	1.0	7.4
	05/09/2005	NP		58.70	3.00	25.00	6.31	52.39	69	0.90	<0.50	<0.50	<0.50	66	4.1	7.2
A-9	6/21/2000	--		53.04	5.00	40.00	8.56	44.48	<50	<0.5	<0.5	<0.5	<1.0	5	--	--
	9/20/2000	--		53.04	5.00	40.00	9.05	43.99	<50	<0.5	<0.5	<0.5	<0.5	<2.5	--	--
	12/26/2000	--		53.04	5.00	40.00	8.49	44.55	<50	<0.5	<0.5	<0.5	<0.5	<2.5	--	--
	3/20/2001	--		53.04	5.00	40.00	6.95	46.09	<50	<0.5	<0.5	<0.5	<0.5	<2.5	--	--
	6/12/2001	--		53.04	5.00	40.00	8.67	44.37	<50	<0.5	<0.5	<0.5	<0.5	4.8	--	--
	9/23/2001	--		53.04	5.00	40.00	9.21	43.83	<50	<0.5	<0.5	<0.5	<0.5	<2.5	--	--
	12/31/2001	--		53.04	5.00	40.00	4.57	48.47	<50	<0.5	<0.5	<0.5	<0.5	<2.5	--	--
	3/21/2002	--		53.04	5.00	40.00	5.60	47.44	<50	<0.5	<0.5	<0.5	<0.5	<2.5	--	--
	4/17/2002	--		53.04	5.00	40.00	6.89	46.15	<50	<0.5	<0.5	<0.5	<0.5	<2.5	--	--
	8/12/2002	P		53.04	5.00	40.00	8.71	44.33	<50	<0.50	<0.50	<0.50	<0.50	<2.5	4	7.6
	12/6/2002	P		53.04	5.00	40.00	8.77	44.27	<50	<0.50	<0.50	<0.50	<0.50	<2.0	1.1	6.7
	1/30/2003	P		53.04	5.00	40.00	6.88	46.16	<50	<0.50	<0.50	<0.50	<0.50	1.1	0.9	6.8
	5/28/2003	--		53.04	5.00	40.00	9.75	43.29	<50	<0.50	<0.50	<0.50	<0.50	0.74	1.9	6.8
	8/6/2003	--		53.04	5.00	40.00	9.00	44.04	<50	<0.50	<0.50	<0.50	<0.50	1.8	2.2	6.7
	11/14/2003	--	d	53.04	5.00	40.00	8.82	44.22	--	--	--	--	--	--	--	--
	02/02/2004	--	d, g	57.73	5.00	40.00	7.10	50.63	--	--	--	--	--	--	--	--
	05/04/2004	--		57.73	5.00	40.00	8.12	49.61	--	--	--	--	--	--	--	--
	09/02/2004	P		57.73	5.00	40.00	8.78	48.95	<50	<0.50	<0.50	<0.50	<0.50	<0.50	6.6	6.5

Table 1

Groundwater Elevation and Analytical Data

ARCO Service Station #4931

731 West MacArthur Blvd., Oakland, CA

Well No.	Date	P/ NP	Footnotes/ Comments	TOC (ft MSL)	Top of Screen (ft bgs)	Bottom of Screen (ft bgs)	DTW (ft bgs)	GWE (ft MSL)	GRO/ TPH-g (µg/L)	Benzene (µg/L)	Toluene (µg/L)	Ethylbenzene (µg/L)	Total Xylenes (µg/L)	MTBE (µg/L)	DO (mg/L)	pH
A-9	11/10/2004	--		57.73	5.00	40.00	7.88	49.85	--	--	--	--	--	--	--	--
	02/02/2005	--		57.73	5.00	40.00	6.40	51.33	--	--	--	--	--	--	--	--
	05/09/2005	--		57.73	5.00	40.00	6.82	50.91	--	--	--	--	--	--	--	--
A-10	6/21/2000	--		54.26	5.00	30.00	10.47	43.79	--	--	--	--	--	--	--	--
	9/20/2000	--		54.26	5.00	30.00	10.76	43.50	--	--	--	--	--	--	--	--
	12/26/2000	--		54.26	5.00	30.00	--	--	--	--	--	--	--	--	--	--
	3/20/2001	--		54.26	5.00	30.00	--	--	--	--	--	--	--	--	--	--
	9/23/2001	--		54.26	5.00	30.00	--	--	--	--	--	--	--	--	--	--
	12/31/2001	--		54.26	5.00	30.00	--	--	--	--	--	--	--	--	--	--
	3/21/2002	--		54.26	5.00	30.00	--	--	--	--	--	--	--	--	--	--
	4/17/2002	--		54.26	5.00	30.00	--	--	--	--	--	--	--	--	--	--
	8/12/2002	--		54.26	5.00	30.00	--	--	--	--	--	--	--	--	--	--
	12/6/2002	--		54.26	5.00	30.00	--	--	--	--	--	--	--	--	--	--
	1/30/2003	--		54.26	5.00	30.00	--	--	--	--	--	--	--	--	--	--
	5/28/2003	--		54.26	5.00	30.00	--	--	--	--	--	--	--	--	--	--
	8/6/2003	--		54.26	5.00	30.00	--	--	--	--	--	--	--	--	--	--
	11/14/2003	--		54.26	5.00	30.00	10.37	43.89	--	--	--	--	--	--	--	--
	02/02/2004	--	g	59.39	5.00	30.00	7.97	51.42	--	--	--	--	--	--	--	--
	05/04/2004	--		59.39	5.00	30.00	8.69	50.70	--	--	--	--	--	--	--	--
	09/02/2004	P		59.39	5.00	30.00	10.55	48.84	<500	<5.0	<5.0	<5.0	<5.0	270	0.8	6.6
11/10/2004	--		59.39	5.00	30.00	9.16	50.23	--	--	--	--	--	--	--	--	
02/02/2005	--		59.39	5.00	30.00	7.90	51.49	--	--	--	--	--	--	--	--	
05/09/2005	--		59.39	5.00	30.00	8.21	51.18	--	--	--	--	--	--	--	--	
A-11	6/21/2000	--		53.74	5.00	30.00	9.54	44.20	<50	<0.5	<0.5	<0.5	<1.0	4	--	--
	9/20/2000	--		53.74	5.00	30.00	10.62	43.12	--	--	--	--	--	--	--	--
	12/26/2000	--		53.74	5.00	30.00	10.03	43.71	<50	<0.5	<0.5	<0.5	<0.5	<2.5	--	--
	3/20/2001	--		53.74	5.00	30.00	8.49	45.25	--	--	--	--	--	--	--	--
	6/12/2001	--		53.74	5.00	30.00	10.21	43.53	<50	<0.5	<0.5	<0.5	<0.5	<2.5	--	--
	9/23/2001	--		53.74	5.00	30.00	10.77	42.97	--	--	--	--	--	--	--	--
	12/31/2001	--		53.74	5.00	30.00	6.06	47.68	<50	<0.5	<0.5	<0.5	<0.5	<2.5	--	--
	3/21/2002	--		53.74	5.00	30.00	7.14	46.60	--	--	--	--	--	--	--	--
	4/17/2002	--		53.74	5.00	30.00	8.41	45.33	<50	<0.5	<0.5	<0.5	<0.5	<2.5	--	--
8/12/2002	--		53.74	5.00	30.00	10.25	43.49	--	--	--	--	--	--	--	--	

Table 1

Groundwater Elevation and Analytical Data

ARCO Service Station #4931

731 West MacArthur Blvd., Oakland, CA

Well No.	Date	P/ NP	Footnotes/ Comments	TOC (ft MSL)	Top of Screen (ft bgs)	Bottom of Screen (ft bgs)	DTW (ft bgs)	GWE (ft MSL)	GRO/ TPH-g (µg/L)	Benzene (µg/L)	Toluene (µg/L)	Ethyl-benzene (µg/L)	Total Xylenes (µg/L)	MTBE (µg/L)	DO (mg/L)	pH
A-11	12/6/2002	P		53.74	5.00	30.00	10.43	43.31	<50	<0.50	<0.50	<0.50	<0.50	<2.0	2.4	6.7
	1/30/2003	--		53.74	5.00	30.00	8.42	45.32	--	--	--	--	--	--	--	--
	5/28/2003	--		53.74	5.00	30.00	9.30	44.44	<50	<0.50	<0.50	<0.50	<0.50	0.53	1.8	7
	8/6/2003	--		53.74	5.00	30.00	10.28	43.46	--	--	--	--	--	--	--	--
	11/14/2003	--		53.74	5.00	30.00	10.40	43.34	--	--	--	--	--	--	--	--
	02/02/2004	--	g	59.16	5.00	30.00	7.95	51.21	--	--	--	--	--	--	--	--
	05/04/2004	--		59.16	5.00	30.00	8.72	50.44	--	--	--	--	--	--	--	--
	09/02/2004	P		59.16	5.00	30.00	10.44	48.72	<50	<0.50	<0.50	<0.50	<0.50	<0.50	2.6	6.6
	11/10/2004	--		59.16	5.00	30.00	9.20	49.96	--	--	--	--	--	--	--	--
	02/02/2005	--		59.16	5.00	30.00	7.95	51.21	--	--	--	--	--	--	--	--
	05/09/2005	--		59.16	5.00	30.00	8.07	51.09	--	--	--	--	--	--	--	--
A-12	6/21/2000	--		52.05	5.00	30.00	9.28	42.77	<50	<0.5	<0.5	<0.5	<1.0	18	--	--
	9/20/2000	--		52.05	5.00	30.00	9.55	42.50	--	--	--	--	--	--	--	--
	12/26/2000	--		52.05	5.00	30.00	9.05	43.00	< 50	< 0.5	< 0.5	< 0.5	<0.5	17.3	--	--
	3/20/2001	--		52.05	5.00	30.00	7.92	44.13	--	--	--	--	--	--	--	--
	6/12/2001	--		52.05	5.00	30.00	9.26	42.79	< 50	< 0.5	< 0.5	< 0.5	<0.5	25	--	--
	9/23/2001	--		52.05	5.00	30.00	9.68	42.37	--	--	--	--	--	--	--	--
	12/31/2001	--		52.05	5.00	30.00	5.74	46.31	< 50	< 0.5	< 0.5	< 0.5	<0.5	9.5	--	--
	3/21/2002	--		52.05	5.00	30.00	6.64	45.41	--	--	--	--	--	--	--	--
	4/17/2002	--		52.05	5.00	30.00	7.68	44.37	<50	<0.5	<0.5	<0.5	<0.5	29	--	--
	8/12/2002	--		52.05	5.00	30.00	9.30	42.75	--	--	--	--	--	--	--	--
	12/06/02	P	c	52.05	5.00	30.00	9.38	42.67	<50	<0.50	<0.50	<0.50	<0.50	13	2.3	6.5
	1/30/2003	--		52.05	5.00	30.00	7.87	44.18	--	--	--	--	--	--	--	--
	5/28/2003	--		52.05	5.00	30.00	8.51	43.54	50	<0.50	<0.50	<0.50	<0.50	10	1.4	7
	8/6/2003	--		52.05	5.00	30.00	9.28	42.77	--	--	--	--	--	--	--	--
	11/14/2003	--		52.05	5.00	30.00	9.37	42.68	--	--	--	--	--	--	--	--
	02/02/2004	P	g	57.06	5.00	30.00	7.90	49.16	<50	<0.50	<0.50	<0.50	<0.50	0.91	1.0	6.9
	05/04/2004	--		57.06	5.00	30.00	8.74	48.32	--	--	--	--	--	--	--	--
	09/02/2004	P		57.06	5.00	30.00	9.41	47.65	<50	<0.50	<0.50	<0.50	<0.50	6.2	1.1	6.5
	11/10/2004	--		57.06	5.00	30.00	8.32	48.74	--	--	--	--	--	--	--	--
	02/02/2005	P		57.06	5.00	30.00	7.45	49.61	<50	<0.50	<0.50	<0.50	<0.50	8.3	1.4	7.1
	05/09/2005	--		57.06	5.00	30.00	7.57	49.49	--	--	--	--	--	--	--	--
A-13	6/21/2000	--		55.11	10.00	10.00	--	--	--	--	--	--	--	--	--	--

Table 1

Groundwater Elevation and Analytical Data

ARCO Service Station #4931

731 West MacArthur Blvd., Oakland, CA

Well No.	Date	P/ NP	Footnotes/ Comments	TOC (ft MSL)	Top of Screen (ft bgs)	Bottom of Screen (ft bgs)	DTW (ft bgs)	GWE (ft MSL)	GRO/ TPH-g (µg/L)	Benzene (µg/L)	Toluene (µg/L)	Ethyl-benzene (µg/L)	Total Xylenes (µg/L)	MTBE (µg/L)	DO (mg/L)	pH
A-13	9/20/2000	--		55.11	10.00	10.00	--	--	--	--	--	--	--	--	--	--
	12/26/2000	--		55.11	10.00	10.00	--	--	--	--	--	--	--	--	--	--
	3/20/2001	--		55.11	10.00	10.00	--	--	--	--	--	--	--	--	--	--
	6/12/2001	--		55.11	10.00	10.00	--	--	--	--	--	--	--	--	--	--
	9/23/2001	--		55.11	10.00	10.00	--	--	--	--	--	--	--	--	--	--
	12/31/2001	--		55.11	10.00	10.00	--	--	--	--	--	--	--	--	--	--
	3/21/2002	--		55.11	10.00	10.00	6.70	48.41	--	--	--	--	--	--	--	--
	4/17/2002	--		55.11	10.00	10.00	7.95	47.16	<50	<0.5	<0.5	<0.5	<0.5	<2.5	--	--
	8/12/2002	--		55.11	10.00	10.00	10.11	45.00	--	--	--	--	--	--	--	--
	12/6/2002	--		55.11	10.00	10.00	10.26	44.85	--	--	--	--	--	--	--	--
	1/30/2003	--		55.11	10.00	10.00	7.81	47.30	--	--	--	--	--	--	--	--
	5/28/2003	--		55.11	10.00	10.00	9.06	46.05	<50	<0.50	<0.50	<0.50	<0.50	<0.50	1.9	6.5
	8/6/2003	--		55.11	10.00	10.00	10.22	44.89	--	--	--	--	--	--	--	--
	11/14/2003	--		55.11	10.00	10.00	10.27	44.84	--	--	--	--	--	--	--	--
	02/02/2004	--	g	60.26	10.00	10.00	7.92	52.34	--	--	--	--	--	--	--	--
	05/04/2004	--		60.26	10.00	10.00	10.06	50.20	--	--	--	--	--	--	--	--
	09/02/2004	P		60.26	10.00	10.00	10.34	49.92	<50	<0.50	<0.50	<0.50	<0.50	<0.50	2.0	6.6
	11/10/2004	--		60.26	10.00	10.00	8.95	51.31	--	--	--	--	--	--	--	--
	02/02/2005	--		60.26	10.00	10.00	7.28	52.98	--	--	--	--	--	--	--	--
	05/09/2005	--		60.26	10.00	10.00	7.85	52.41	--	--	--	--	--	--	--	--
AR-1	6/21/2000	--		54.72	10.00	30.00	--	--	--	--	--	--	--	--	--	--
	9/20/2000	--		54.72	10.00	30.00	--	--	--	--	--	--	--	--	--	--
	12/26/2000	--		54.72	10.00	30.00	9.95	44.77	--	--	--	--	--	--	--	--
	3/20/2001	--		54.72	10.00	30.00	8.34	46.38	--	--	--	--	--	--	--	--
	6/12/2001	--		54.72	10.00	30.00	10.17	44.55	--	--	--	--	--	--	--	--
	9/23/2001	--		54.72	10.00	30.00	10.72	44.00	--	--	--	--	--	--	--	--
	12/31/2001	--		54.72	10.00	30.00	5.91	48.81	--	--	--	--	--	--	--	--
	3/21/2002	--		54.72	10.00	30.00	7.00	47.72	--	--	--	--	--	--	--	--
	4/17/2002	--		54.72	10.00	30.00	8.33	46.39	--	--	--	--	--	--	--	--
	8/12/2002	--		54.72	10.00	30.00	10.18	44.54	--	--	--	--	--	--	--	--
	12/6/2002	--		54.72	10.00	30.00	10.21	44.51	--	--	--	--	--	--	--	--
	1/30/2003	--		54.72	10.00	30.00	8.22	46.50	--	--	--	--	--	--	--	--
	5/28/2003	--		54.72	10.00	30.00	9.62	45.10	--	--	--	--	--	--	--	--

Table 1

Groundwater Elevation and Analytical Data

ARCO Service Station #4931

731 West MacArthur Blvd., Oakland, CA

Well No.	Date	P/ NP	Footnotes/ Comments	TOC (ft MSL)	Top of Screen (ft bgs)	Bottom of Screen (ft bgs)	DTW (ft bgs)	GWE (ft MSL)	GRO/ TPH-g (µg/L)	Benzene (µg/L)	Toluene (µg/L)	Ethyl-benzene (µg/L)	Total Xylenes (µg/L)	MTBE (µg/L)	DO (mg/L)	pH
AR-1	8/6/2003	--		54.72	10.00	30.00	10.47	44.25	--	--	--	--	--	--	--	--
	11/14/2003	--	d	54.72	10.00	30.00	10.40	44.32	--	--	--	--	--	--	--	--
	02/02/2004	--	d, g	59.52	10.00	30.00	7.96	51.56	--	--	--	--	--	--	--	--
	05/04/2004	--	d	59.52	10.00	30.00	10.17	49.35	--	--	--	--	--	--	--	--
	09/02/2004	--		59.52	10.00	30.00	10.28	49.24	--	--	--	--	--	--	--	--
	11/10/2004	--		59.52	10.00	30.00	9.15	50.37	--	--	--	--	--	--	--	--
	02/02/2005	--		59.52	10.00	30.00	7.80	51.72	--	--	--	--	--	--	--	--
	05/09/2005	--		59.52	10.00	30.00	7.03	52.49	--	--	--	--	--	--	--	--
AR-2	6/21/2000	--		54.77	8.00	28.00	--	--	--	--	--	--	--	--	--	--
	9/20/2000	--		54.77	8.00	28.00	--	--	--	--	--	--	--	--	--	--
	12/26/2000	--		54.77	8.00	28.00	--	--	--	--	--	--	--	--	--	--
	3/20/2001	--		54.77	8.00	28.00	3.13	51.64	--	--	--	--	--	--	--	--
	6/12/2001	--		54.77	8.00	28.00	4.51	50.26	--	--	--	--	--	--	--	--
	9/23/2001	--		54.77	8.00	28.00	6.05	48.72	--	--	--	--	--	--	--	--
	12/31/2001	--		54.77	8.00	28.00	2.79	51.98	--	--	--	--	--	--	--	--
	3/21/2002	--		54.77	8.00	28.00	7.75	47.02	--	--	--	--	--	--	--	--
	4/17/2002	--		54.77	8.00	28.00	2.24	52.53	--	--	--	--	--	--	--	--
	8/12/2002	--		54.77	8.00	28.00	4.93	49.84	--	--	--	--	--	--	--	--
	12/6/2002	--		54.77	8.00	28.00	6.09	48.68	--	--	--	--	--	--	--	--
	1/30/2003	--		54.77	8.00	28.00	3.89	50.88	--	--	--	--	--	--	--	--
	5/28/2003	--		54.77	8.00	28.00	3.33	51.44	--	--	--	--	--	--	--	--
	8/6/2003	--		54.77	8.00	28.00	5.05	49.72	--	--	--	--	--	--	--	--
	11/14/2003	--		54.77	8.00	28.00	6.01	48.76	--	--	--	--	--	--	--	--
	02/02/2004	--	g	59.18	8.00	28.00	3.88	55.30	--	--	--	--	--	--	--	--
	05/04/2004	--		59.18	8.00	28.00	6.01	53.17	--	--	--	--	--	--	--	--
	09/02/2004	--		59.18	8.00	28.00	5.65	53.53	--	--	--	--	--	--	--	--
	11/10/2004	--		59.18	8.00	28.00	5.48	53.70	--	--	--	--	--	--	--	--
	02/02/2005	--		59.18	8.00	28.00	2.62	56.56	--	--	--	--	--	--	--	--
	05/09/2005	--		59.18	8.00	28.00	2.84	56.34	--	--	--	--	--	--	--	--
AR-3	6/21/2000	--		54.19	10.00	30.00	--	--	--	--	--	--	--	--	--	--
	9/20/2000	--		54.19	10.00	30.00	--	--	--	--	--	--	--	--	--	--
	12/26/2000	--		54.19	10.00	30.00	9.70	44.49	--	--	--	--	--	--	--	--
	3/20/2001	--		54.19	10.00	30.00	--	--	--	--	--	--	--	--	--	--

Table 1

Groundwater Elevation and Analytical Data

ARCO Service Station #4931

731 West MacArthur Blvd., Oakland, CA

Well No.	Date	P/ NP	Footnotes/ Comments	TOC (ft MSL)	Top of Screen (ft bgs)	Bottom of Screen (ft bgs)	DTW (ft bgs)	GWE (ft MSL)	GRO/ TPH-g (µg/L)	Benzene (µg/L)	Toluene (µg/L)	Ethyl-benzene (µg/L)	Total Xylenes (µg/L)	MTBE (µg/L)	DO (mg/L)	pH
AR-3	6/12/2001	--		54.19	10.00	30.00	--	--	--	--	--	--	--	--	--	--
	9/23/2001	--		54.19	10.00	30.00	10.43	43.76	--	--	--	--	--	--	--	--
	12/31/2001	--		54.19	10.00	30.00	5.18	49.01	--	--	--	--	--	--	--	--
	3/21/2002	--		54.19	10.00	30.00	6.78	47.41	--	--	--	--	--	--	--	--
	4/17/2002	--		54.19	10.00	30.00	8.06	46.13	--	--	--	--	--	--	--	--
	8/12/2002	--		54.19	10.00	30.00	9.94	44.25	--	--	--	--	--	--	--	--
	12/6/2002	--		54.19	10.00	30.00	9.99	44.20	--	--	--	--	--	--	--	--
	1/30/2003	--		54.19	10.00	30.00	7.96	46.23	--	--	--	--	--	--	--	--
	5/28/2003	--		54.19	10.00	30.00	8.94	45.25	--	--	--	--	--	--	--	--
	8/6/2003	--		54.19	10.00	30.00	9.94	44.25	--	--	--	--	--	--	--	--
	11/14/2003	--		54.19	10.00	30.00	10.03	44.16	--	--	--	--	--	--	--	--
	02/02/2004	--	g	59.10	10.00	30.00	6.90	52.20	--	--	--	--	--	--	--	--
	05/04/2004	--		59.10	10.00	30.00	9.12	49.98	--	--	--	--	--	--	--	--
	09/02/2004	--		59.10	10.00	30.00	10.15	48.95	--	--	--	--	--	--	--	--
	11/10/2004	--		59.10	10.00	30.00	8.79	50.31	--	--	--	--	--	--	--	--
	02/02/2005	--		59.10	10.00	30.00	7.30	51.80	--	--	--	--	--	--	--	--
	05/09/2005	--		59.10	10.00	30.00	7.71	51.39	--	--	--	--	--	--	--	--

Table 1

**Groundwater Elevation and Analytical Data
ARCO Service Station #4931
731 West MacArthur Blvd., Oakland, CA**

SYMBOLS AND ABBREVIATIONS:

- = Not analyzed/applicable/measured/available
< = Not detected at or above laboratory reporting limit
DO = Dissolved oxygen
DTW = Depth to water in feet below ground surface
ft bgs = feet below ground surface
ft MSL = feet above mean sea level
GRO = Gasoline Range Organics, range C4-C12
GWE = Groundwater elevation measured in feet above mean sea level
mg/L = Milligrams per liter
MTBE = Methyl tert butyl ether
NP = Not Purged
P = Purge
TOC = Top of casing measured in feet above mean sea level
TPH-g = Total petroleum hydrocarbons as gasoline
ug/L = Micrograms per liter

FOOTNOTES:

a = Hydrocarbon pattern is present in the requested fuel quantitation range but does not resemble the pattern of the requested fuel for GRO/TPH-g.
b = The concentration indicated for this analyte (MTBE) is an estimated value above the calibration range of the instrument.
c = This sample was analyzed beyond the EPA recommended holding time. The results may still be useful for their intended purpose.
d = ORC sock in well.
e = Well inaccessible; well paved over.
f = Sheen in well.
g = Well surveyed to NAVD '88 datum on January 28, 2004.

NOTES:

Top and bottom of screen measurements for wells A-2 through A-5 were estimated from the EMCON sampling sheet.

Beginning in the first quarter 2003 (1/30/2003), groundwater samples were analyzed by EPA method 8260B for TPH-g, BTEX, and fuel oxygenates. Prior to 1/30/03, TPH-g was analyzed using EPA Method 8015B modified and MTBE by 8021B unless otherwise noted.

Beginning in the fourth quarter 2003, the laboratory modified the reported analyte list. TPH-g has been changed to GRO. The resulting data may be impacted by the potential of non-TPHg analytes within the requested fuel range resulting in a higher concentration being reported.

Beginning in the second quarter 2004, the carbon range for GRO was changed from C6-C10 to C4-C12

Values for DO and pH were obtained through field measurements.

The data within this table collected prior to August 2002 was provided to URS by RM and their previous consultants. URS has not verified the accuracy of this information.

Table 2

Fuel Additives Analytical Data
ARCO Service Station #4931
731 West MacArthur Blvd., Oakland, CA

Well Number	Date Sampled	Ethanol (µg/L)	TBA (µg/L)	MTBE (µg/L)	DIPE (µg/L)	ETBE (µg/L)	TAME (µg/L)	1,2-DCA (µg/L)	EDB (µg/L)	Footnotes/ Comments
A-2	1/30/2003	<40	<20	--	<0.50	<0.50	<0.50	--	--	a
	5/28/2003	<100	<20	1.1	<0.50	<0.50	<0.50	--	--	
	8/6/2003	<100	<20	<0.50	<0.50	<0.50	<0.50	<0.50	<0.50	
	09/02/2004	<100	<20	<0.50	<0.50	<0.50	<0.50	<0.50	<0.50	
A-3	1/30/2003	--	--	--	--	--	--	--	--	b
	5/28/2003	<100	<20	43	<0.50	<0.50	24	--	--	
	8/6/2003	--	--	--	--	--	--	--	--	
	02/02/2004	<100	<20	13	<0.50	<0.50	4.6	<0.50	<0.50	
	09/02/2004	<500	<100	62	<2.5	<2.5	15	<2.5	<2.5	
	02/02/2005	<100	<20	6.8	<0.50	<0.50	2.4	<0.50	<0.50	
A-4	1/30/2003	<4,000	<2,000	2,100	<50	<50	530	--	--	a
	5/28/2003	<10,000	<2,000	2,500	<50	<50	590	--	--	
	8/6/2003	<5,000	<1,000	2,500	<25	<25	560	<25	<25	
	11/14/2003	<1,000	320	310	<5.0	<5.0	76	--	--	
	02/02/2004	<5,000	<1,000	1,500	<25	<25	350	<25	<25	
	05/04/2004	<10,000	<2,000	2,300	<50	<50	510	<50	<50	
	09/02/2004	<5,000	1,200	1,200	<25	<25	280	<25	<25	
	11/10/2004	<2,000	910	1,100	<10	<10	270	<10	<10	
	02/02/2005	<2,000	2,100	1,700	<10	<10	430	<10	<10	
	05/09/2005	<10,000	2,000	1,800	<50	<50	460	<50	<50	
A-5	1/30/2003	--	--	--	--	--	--	--	--	b
	5/28/2003	<10,000	<2,000	1,500	<50	<50	620	--	--	
	8/6/2003	--	--	--	--	--	--	--	--	
	02/02/2004	<500	170	140	<2.5	<2.5	54	<2.5	<2.5	
	09/02/2004	<500	150	66	<2.5	<2.5	29	<2.5	<2.5	
	02/02/2005	<100	840	17	<0.50	<0.50	7.6	<0.50	<0.50	
A-7	1/30/2003	--	--	--	--	--	--	--	--	a
	5/28/2003	<100	<20	3.8	<0.50	<0.50	0.94	--	--	
	8/6/2003	--	--	--	--	--	--	--	--	
	09/02/2004	<100	<20	8.9	<0.50	<0.50	3.0	<0.50	<0.50	
A-8	1/30/2003	<8,000	<4,000	2,200	<100	<100	900	--	--	a
	5/28/2003	<10,000	<2,000	2,100	<50	<50	1,100	--	--	

Table 2

Fuel Additives Analytical Data
ARCO Service Station #4931
731 West MacArthur Blvd., Oakland, CA

Well Number	Date Sampled	Ethanol (µg/L)	TBA (µg/L)	MTBE (µg/L)	DIPE (µg/L)	ETBE (µg/L)	TAME (µg/L)	1,2-DCA (µg/L)	EDB (µg/L)	Footnotes/Comments
A-8	8/6/2003	<10,000	<2,000	3,000	<50	<50	1,200	<50	<50	
	11/14/2003	<1,000	<200	850	<5.0	<5.0	320	--	--	
	02/02/2004	<5,000	<1,000	1,100	<25	<25	380	<25	<25	
	05/04/2004	<10,000	<2,000	1,600	<50	<50	440	<50	<50	
	09/02/2004	<5,000	<1,000	680	<25	<25	170	<25	<25	
	11/10/2004	<500	<100	290	<2.5	<2.5	66	<2.5	<2.5	
	02/02/2005	<5,000	<1,000	1,900	<25	<25	510	<25	<25	b
	05/09/2005	<100	<20	66	<0.50	<0.50	2.9	<0.50	<0.50	
A-9	1/30/2003	<40	<20	1.1	<0.50	<0.50	<0.50	--	--	
	5/28/2003	<100	<20	0.74	<0.50	<0.50	<0.50	--	--	
	8/6/2003	<100	<20	1.8	<0.50	<0.50	<0.50	<0.50	<0.50	
	09/02/2004	<100	<20	<0.50	<0.50	<0.50	<0.50	<0.50	<0.50	
A-10	09/02/2004	<1,000	<200	270	<5.0	<5.0	44	<5.0	<5.0	
A-11	1/30/2003	--	--	--	--	--	--	--	--	
	5/28/2003	<100	<20	0.53	<0.50	<0.50	<0.50	--	--	
	8/6/2003	--	--	--	--	--	--	--	--	
	09/02/2004	<100	<20	<0.50	<0.50	<0.50	<0.50	<0.50	<0.50	
A-12	1/30/2003	--	--	--	--	--	--	--	--	
	5/28/2003	<100	<20	10	<0.50	<0.50	2.5	--	--	
	8/6/2003	--	--	--	--	--	--	--	--	
	02/02/2004	<100	<20	0.91	<0.50	<0.50	<0.50	<0.50	<0.50	
	09/02/2004	<100	<20	6.2	<0.50	<0.50	1.7	<0.50	<0.50	
	02/02/2005	<100	<20	8.3	<0.50	<0.50	2.2	<0.50	<0.50	b
A-13	1/30/2003	--	--	--	--	--	--	--	--	
	5/28/2003	<100	<20	<0.50	<0.50	<0.50	<0.50	--	--	
	8/6/2003	--	--	--	--	--	--	--	--	
	09/02/2004	<100	<20	<0.50	<0.50	<0.50	<0.50	<0.50	<0.50	

Table 2

Fuel Additives Analytical Data ARCO Service Station #4931 731 West MacArthur Blvd., Oakland, CA

ABBREVIATIONS:

-- = Not analyzed/applicable/measured/available
< = Not detected at or above the laboratory reporting limit.
1,2-DCA = 1,2-Dichloroethane
DIPE = Di-isopropyl ether
EDB = 1,2-Dibromoethane
ETBE = Ethyl tert-butyl ether
MTBE = Methyl tert-butyl ether
TAME = tert-Amyl methyl ether
TBA = tert-Butyl alcohol
ug/L = Micrograms per Liter

FOOTNOTES:

a = The result for TBA was reported with a possible high bias due to the continuing calibration verification falling outside acceptance criteria.
b = The calibration verification for ethanol was within the method limits but outside the contract limits.

NOTES:

All volatile organic compounds analyzed using EPA Method 8260B.

The data within this table collected prior to August 2002 was provided to URS by RM and their previous consultants. URS has not verified the accuracy of this information.

Table 3

Groundwater Gradient Data
ARCO Service Station #4931
731 West MacArthur Blvd., Oakland, CA

Date Sampled	Approximate Flow Direction	Approximate Hydraulic Gradient
6/21/2000	West-Southwest	0.031
9/20/2000	Southwest	0.013
12/26/2000	West	0.028
3/20/2001	West	0.046
6/12/2001	West	0.014
9/23/2001	West	0.012
12/31/2001	West	0.024
3/21/2002	West	0.047
4/17/2002	West	0.03
8/12/2002	West	0.016
12/6/2002	West	0.015
1/30/2003	West	Variable
5/26/2003	West	0.022 a
8/6/2003	West-Southwest	0.018
11/14/2003	West	0.02
2/2/2004	West	0.04
5/4/2004	West to North	0.025 to 0.033
9/2/2004	West	0.033
11/10/2004	West	0.031
2/2/2005	West-Southwest	0.04
5/9/2005	Northwest-Southwest	0.04

FOOTNOTES:

a = using wells AR-1 and A-9

NOTES:

Source : The data within this table collected prior to August 2002 was provided to URS by RM and their previous consultants. URS has not verified the accuracy of this information.

ATTACHMENT A
FIELD PROCEDURES AND FIELD DATA SHEETS

FIELD PROCEDURES

Sampling Procedures

The sampling procedure for each well consists first of measuring the water level and depth to bottom, and checking for the presence of free phase petroleum product (free product), using either an electronic indicator and a clear Teflon™ bailer or an oil-water interface probe. Wells not containing free product are purged approximately three casing volumes of water (or until dewatered) using a centrifugal pump, gas displacement pump, or bailer. Equipment and purging method used for the current sampling event is noted on the attached field data sheets. During purging, temperature, pH, and electrical conductivity are monitored to document that these parameters are stable prior to collecting samples. After purging, water levels are allowed to partially (approximately 80%) recover. Groundwater samples (both purge and no purge) are collected using a Teflon bailer, placed into appropriate Environmental Protection Agency- (EPA) approved containers, labeled, logged onto chain-of-custody records, and transported on ice to a California State-certified laboratory. Wells with free product are not sampled and free product is removed according to California Code of Regulation, Title 23, Div. 3, Chap. 16, Section 2655, UST Regulations.

WELL GAUGING DATA

Project # 050509-PC Date 5/9/05 Client Arco 4931

Site 731 W. MacArthur Blvd., Oakland

Well ID	Well Size (in.)	Sheen / Odor	Depth to Immiscible Liquid (ft.)	Thickness of Immiscible Liquid (ft.)	Volume of Immiscibles Removed (ml)	Depth to water (ft.)	Depth to well bottom (ft.)	Survey Point: TOB or TOP	
A-2	4					4.35 2.84	19.47	TOB	G.O.
A-3	4					5.96	16.29		G.O.
A-4	4		No SPH Detected			7.21	19.36		√SPH
A-5	3					7.20	24.50		G.O.
A-7	3					6.48	22.24		G.O.
A-8	3					6.31	16.84		NPE ²
A-9	6					6.82	38.02		G.O.
A-10	3					8.21	29.68		G.O.
A-11	3					8.07	29.72		G.O. Tr.
A-12	3					7.57	16.29		G.O. Tr.
A-13	3		Gauged w/ tubing in well			7.85	29.05		G.O.
AR-1	6					7.03	28.95		G.O.
AR-2	6					2.84	26.28		G.O.
AR-3	4					7.71	28.98	↓	G.O.

ARCO / BP WELL MONITORING DATA SHEET

BTS #: 050509-AC-1	Station # 4931
Sampler: WE/PC	Date: 5/9/05
Well I.D.: A-4	Well Diameter: 2 3 <input checked="" type="checkbox"/> 4 6 8
Total Well Depth: 19.36	Depth to Water: 7.21
Depth to Free Product:	Thickness of Free Product (feet):
Referenced to: <u>PVC</u> Grade	D.O. Meter (if req'd): <input checked="" type="checkbox"/> YES HACH

Well Diameter	Multiplier	Well Diameter	Multiplier
1"	0.04	4"	0.65
2"	0.16	6"	1.47
3"	0.37	Other	radius ² * 0.163

Purge Method: <input type="checkbox"/> Bailer <input type="checkbox"/> Disposable Bailer <input type="checkbox"/> Positive Air Displacement <input checked="" type="checkbox"/> Electric Submersible <input type="checkbox"/> Extraction Pump Other: _____	Sampling Method: <input type="checkbox"/> Bailer <input checked="" type="checkbox"/> Disposable Bailer <input type="checkbox"/> Extraction Port Other: _____
---	---

Top of Screen: _____ If well is listed as a no-purge, confirm that water level is below the top of screen. Otherwise, the well must be purged.

<u>7.9</u>	x	<u>3</u>	=	<u>23.7</u>	Gals.
1 Case Volume (Gals.)		Specified Volumes		Calculated Volume	

Time	Temp (°F)	pH	Conductivity (mS or μ S)	Gals. Removed	Observations
0931	64.4	6.4	1202	8	adeq / clear
0932	well	dewatered	@	10 gallons	
0944	65.1	6.6	1333	—	DTW = 16.32 @ departure

Did well dewater? <input checked="" type="checkbox"/> Yes <input type="checkbox"/> No	Gallons actually evacuated: 10	
Sampling Time: 950	Sampling Date: 5/9/05	
Sample I.D.: A-4	Laboratory: Pace <input checked="" type="checkbox"/> Sequoia <input type="checkbox"/> Other _____	
Analyzed for: GRO BTEX MTBE DRO	Other: see cot	
D.O. (if req'd):	Pre-purge: _____ mg/L	Post-purge: 1.64 mg/L
O.R.P. (if req'd):	Pre-purge: _____ mV	Post-purge: _____ mV

ARCO / BP WELL MONITORING DATA SHEET

BTS #: <u>050509-004</u>	Station # <u>Arco 4931</u>
Sampler: <u>PC</u>	Date: <u>5/9/05</u>
Well I.D.: <u>A-8</u>	Well Diameter: 2 <u>2</u> 4 6 8 _____
Total Well Depth: <u>16.84</u>	Depth to Water: <u>6.31</u>
Depth to Free Product:	Thickness of Free Product (feet):
Referenced to: <u>(V)</u> Grade	D.O. Meter (if req'd): YSI <u>(HACH)</u>

Well Diameter	Multiplier	Well Diameter	Multiplier
1"	0.04	4"	0.65
2"	0.16	6"	1.47
3"	0.37	Other	radius ² * 0.163

Purge Method: <u>Bailer</u> <input type="checkbox"/> Disposable Bailer <input checked="" type="checkbox"/> Positive Air Displacement <input checked="" type="checkbox"/> Electric Submersible <input type="checkbox"/> Extraction Pump Other: _____	Sampling Method: <u>Bailer</u> <input checked="" type="checkbox"/> Disposable Bailer <input type="checkbox"/> Extraction Port Other: _____
--	---

Top of Screen: 2' If well is listed as a no-purge, confirm that water level is below the top of screen. Otherwise, the well must be purged.

_____	X	_____	=	_____ Gals.
I Case Volume (Gals.)		Specified Volumes		Calculated Volume

Time	Temp (°F)	pH	Conductivity (mS or μ S)	Gals. Removed	Observations
935	64.2	7.2	1143		

Did well dewater? Yes <input type="checkbox"/> No <input type="checkbox"/>	Gallons actually evacuated: _____	
Sampling Time: <u>935</u>	Sampling Date: <u>5/9/05</u>	
Sample I.D.: <u>A-8</u>	Laboratory: Pace <u>Sequa</u> Other _____	
Analyzed for: <u>(GRO BTEX)</u> MTBE DRO	Other: <u>see 106</u>	
D.O. (if req'd):	Pre-purge: _____ mg/L	Post-purge: <u>4.1</u> mg/L
O.R.P. (if req'd):	Pre-purge: _____ mV	Post-purge: _____ mV

BP GEM OIL COMPANY TYPE A BILL OF LADING

SOURCE RECORD BILL OF LADING FOR NON-HAZARDOUS PURGEWATER RECOVERED FROM GROUNDWATER WELLS AT BP GEM OIL COMPANY FACILITIES IN THE STATE OF CALIFORNIA. THE NON-HAZARDOUS PURGE- WATER WHICH HAS BEEN RECOVERED FROM GROUND- WATER WELLS IS COLLECTED BY THE CONTRACTOR, MADE UP INTO LOADS OF APPROPRIATE SIZE AND HAULED BY DILLARD ENVIRONMENTAL TO THE ALTAMONT LANDFILL AND RESOURCE RECOVERY FACILITY IN LIVERMORE, CALIFORNIA.

The contractor performing this work is PLAINE TECH SERVICES, INC. (BTS), 1680 Rogers Avenue, San Jose, CA 95112 (phone [408] 573-0555). Blaine Tech Services, Inc. is authorized by BP GEM OIL COMPANY to recover, collect, apportion into loads the Non-Hazardous Well Purgewater that is drawn from wells at the BP GEM Oil Company facility indicated below and deliver that purgewater to BTS. Transport routing of the Non-Hazardous Well Purgewater may be direct from one BP GEM facility to the designated destination point; from one BP GEM facility to the designated destination point via another BP GEM facility; from a BP GEM facility to the designated destination point via the contractor's facility, or any combination thereof. The Non-Hazardous Well Purgewater is and remains the property of BP GEM Oil Company.

This Source Record BILL OF LADING was initiated to cover the recovery of Non-Hazardous Well Purgewater from wells at the BP GEM Oil Company facility described below:

4931
Station #

731 W. MacArthur
Station Address

Total Gallons Collected From Groundwater Monitoring Wells:
10

added equip. rinse water 8

any other adjustments _____

TOTAL GALS. RECOVERED 18

loaded onto BTS vehicle # 48

BTS event # 050509-PC1

time date 1000 5/9/08

signature [Signature]

REC'D AT

time date

BTS
unloaded by signature [Signature]

5/9/08

ATTACHMENT B

**LABORATORY PROCEDURES,
CERTIFIED ANALYTICAL REPORTS,
AND CHAIN-OF-CUSTODY RECORDS**

LABORATORY PROCEDURES

Laboratory Procedures

The groundwater samples were analyzed for the presence of the chemicals mentioned in the chain of custody using standard EPA methods. The methods of analysis for the groundwater samples are documented in the certified analytical report. The certified analytical reports and chain-of-custody record are presented in this attachment. The analytical data provided by the laboratory approved by RM have been reviewed and verified by that laboratory.



25 May, 2005

Scott Robinson
URS Corporation [Arco]
1333 Broadway, Suite 800
Oakland, CA 94612

RE: ARCO #4931, Oakland, CA
Work Order: MOE0430

Enclosed are the results of analyses for samples received by the laboratory on 05/10/05 15:13. If you have any questions concerning this report, please feel free to contact me.

Sincerely,

Tim Costello For Lisa Race
Senior Project Manager

CA ELAP Certificate #1210

URS Corporation [Arco] 1333 Broadway, Suite 800 Oakland CA, 94612	Project: ARCO #4931, Oakland, CA Project Number: G0C8C-0004 Project Manager: Scott Robinson	MOE0430 Reported: 05/25/05 15:24
---	---	--

ANALYTICAL REPORT FOR SAMPLES

Sample ID	Laboratory ID	Matrix	Date Sampled	Date Received
A-4	MOE0430-01	Water	05/09/05 09:50	05/10/05 15:13
A-8	MOE0430-02	Water	05/09/05 09:35	05/10/05 15:13
TB493105092005	MOE0430-03	Water	05/09/05 00:00	05/10/05 15:13

The carbon range for the TPH-GRO has been changed from C6-C10 to C4-C12. The carbon range for TPH-DRO has been changed from C10-C28 to C10-C36. EPA 8015B has been modified to better meet the requirements of California regulatory agencies. These samples were received with no custody seals.

URS Corporation [Arco]
 1333 Broadway, Suite 800
 Oakland CA, 94612

 Project: ARCO #4931, Oakland, CA
 Project Number: G0C8C-0004
 Project Manager: Scott Robinson

 MOE0430
 Reported:
 05/25/05 15:24

Volatile Organic Compounds by EPA Method 8260B
Sequoia Analytical - Morgan Hill

Analyte	Result	Reporting Limit	Units	Dilution	Batch	Prepared	Analyzed	Method	Notes
A-4 (MOE0430-01) Water Sampled: 05/09/05 09:50 Received: 05/10/05 15:13									
tert-Amyl methyl ether	460	50	ug/l	100	5E17003	05/17/05	05/18/05	EPA 8260B	
Benzene	140	50	"	"	"	"	"	"	
tert-Butyl alcohol	2000	2000	"	"	"	"	"	"	
Di-isopropyl ether	ND	50	"	"	"	"	"	"	
1,2-Dibromoethane (EDB)	ND	50	"	"	"	"	"	"	
1,2-Dichloroethane	ND	50	"	"	"	"	"	"	
Ethanol	ND	10000	"	"	"	"	"	"	
Ethyl tert-butyl ether	ND	50	"	"	"	"	"	"	
Ethylbenzene	62	50	"	"	"	"	"	"	
Methyl tert-butyl ether	1800	50	"	"	"	"	"	"	
Toluene	ND	50	"	"	"	"	"	"	
Xylenes (total)	ND	50	"	"	"	"	"	"	
Gasoline Range Organics (C4-C12)	ND	5000	"	"	"	"	"	"	
<i>Surrogate: 1,2-Dichloroethane-d4</i>		100 %	60-135	"	"	"	"	"	
A-8 (MOE0430-02) Water Sampled: 05/09/05 09:35 Received: 05/10/05 15:13									
tert-Amyl methyl ether	2.9	0.50	ug/l	1	5E17003	05/17/05	05/18/05	EPA 8260B	
Benzene	0.90	0.50	"	"	"	"	"	"	
tert-Butyl alcohol	ND	20	"	"	"	"	"	"	
Di-isopropyl ether	ND	0.50	"	"	"	"	"	"	
1,2-Dibromoethane (EDB)	ND	0.50	"	"	"	"	"	"	
1,2-Dichloroethane	ND	0.50	"	"	"	"	"	"	
Ethanol	ND	100	"	"	"	"	"	"	
Ethyl tert-butyl ether	ND	0.50	"	"	"	"	"	"	
Ethylbenzene	ND	0.50	"	"	"	"	"	"	
Methyl tert-butyl ether	66	0.50	"	"	"	"	"	"	
Toluene	ND	0.50	"	"	"	"	"	"	
Xylenes (total)	ND	0.50	"	"	"	"	"	"	
Gasoline Range Organics (C4-C12)	69	50	"	"	"	"	"	"	
<i>Surrogate: 1,2-Dichloroethane-d4</i>		92 %	60-135	"	"	"	"	"	

URS Corporation [Arco]
 1333 Broadway, Suite 800
 Oakland CA, 94612

 Project: ARCO #4931, Oakland, CA
 Project Number: G0C8C-0004
 Project Manager: Scott Robinson

 MOE0430
 Reported:
 05/25/05 15:24

Volatile Organic Compounds by EPA Method 8260B - Quality Control
Sequoia Analytical - Morgan Hill

Analyte	Result	Reporting Limit	Units	Spike Level	Source Result	%REC Limits	RPD	RPD Limit	Notes
---------	--------	--------------------	-------	----------------	------------------	----------------	-----	--------------	-------

Batch 5E17003 - EPA 5030B P/T / EPA 8260B
Blank (5E17003-BLK1)

Prepared & Analyzed: 05/17/05

tert-Amyl methyl ether	ND	0.50	ug/l						
Benzene	ND	0.50	"						
tert-Butyl alcohol	ND	20	"						
Di-isopropyl ether	ND	0.50	"						
1,2-Dibromoethane (EDB)	ND	0.50	"						
1,2-Dichloroethane	ND	0.50	"						
Ethanol	ND	100	"						
Ethyl tert-butyl ether	ND	0.50	"						
Ethylbenzene	ND	0.50	"						
Methyl tert-butyl ether	ND	0.50	"						
Toluene	ND	0.50	"						
Xylenes (total)	ND	0.50	"						
Gasoline Range Organics (C4-C12)	ND	50	"						
<i>Surrogate: 1,2-Dichloroethane-d4</i>	<i>5.02</i>		<i>"</i>	<i>5.00</i>		<i>100</i>	<i>60-135</i>		

Laboratory Control Sample (5E17003-BS1)

Prepared & Analyzed: 05/17/05

tert-Amyl methyl ether	9.65	0.50	ug/l	10.0		96	80-115		
Benzene	8.66	0.50	"	10.0		87	65-115		
tert-Butyl alcohol	49.2	20	"	50.0		98	75-150		
Di-isopropyl ether	8.93	0.50	"	10.0		89	75-125		
1,2-Dibromoethane (EDB)	9.38	0.50	"	10.0		94	85-120		
1,2-Dichloroethane	9.91	0.50	"	10.0		99	85-130		
Ethanol	143	100	"	200		72	70-135		
Ethyl tert-butyl ether	9.67	0.50	"	10.0		97	75-130		
Ethylbenzene	9.02	0.50	"	10.0		90	75-135		
Methyl tert-butyl ether	9.94	0.50	"	10.0		99	65-125		
Toluene	9.38	0.50	"	10.0		94	85-120		
Xylenes (total)	27.2	0.50	"	30.0		91	85-125		
<i>Surrogate: 1,2-Dichloroethane-d4</i>	<i>4.87</i>		<i>"</i>	<i>5.00</i>		<i>97</i>	<i>60-135</i>		

URS Corporation [Arco]
 1333 Broadway, Suite 800
 Oakland CA, 94612

 Project: ARCO #4931, Oakland, CA
 Project Number: G0C8C-0004
 Project Manager: Scott Robinson

 MOE0430
 Reported:
 05/25/05 15:24

Volatile Organic Compounds by EPA Method 8260B - Quality Control
Sequoia Analytical - Morgan Hill

Analyte	Result	Reporting Limit	Units	Spike Level	Source Result	%REC	%REC Limits	RPD	RPD Limit	Notes
---------	--------	-----------------	-------	-------------	---------------	------	-------------	-----	-----------	-------

Batch 5E17003 - EPA 5030B P/T / EPA 8260B
Laboratory Control Sample (5E17003-BS2)

Prepared & Analyzed: 05/17/05

Benzene	4.93	0.50	ug/l	6.08		81	65-115			
Ethylbenzene	8.11	0.50	"	7.84		103	75-135			
Methyl tert-butyl ether	8.41	0.50	"	9.60		88	65-125			
Toluene	36.8	0.50	"	32.9		112	85-120			
Xylenes (total)	41.9	0.50	"	38.5		109	85-125			
Gasoline Range Organics (C4-C12)	420	50	"	440		95	70-124			
Surrogate: 1,2-Dichloroethane-d4	4.35		"	5.00		87	60-135			

Laboratory Control Sample Dup (5E17003-BSD1)

Prepared & Analyzed: 05/17/05

tert-Amyl methyl ether	9.18	0.50	ug/l	10.0		92	80-115	5	15	
Benzene	9.22	0.50	"	10.0		92	65-115	6	20	
tert-Butyl alcohol	49.7	20	"	50.0		99	75-150	1	25	
Di-isopropyl ether	9.48	0.50	"	10.0		95	75-125	6	15	
1,2-Dibromoethane (EDB)	9.35	0.50	"	10.0		94	85-120	0.3	15	
1,2-Dichloroethane	9.56	0.50	"	10.0		96	85-130	4	20	
Ethanol	137	100	"	200		68	70-135	4	35	HM
Ethyl tert-butyl ether	9.28	0.50	"	10.0		93	75-130	4	25	
Ethylbenzene	9.85	0.50	"	10.0		98	75-135	9	15	
Methyl tert-butyl ether	9.66	0.50	"	10.0		97	65-125	3	20	
Toluene	10.2	0.50	"	10.0		102	85-120	8	20	
Xylenes (total)	29.5	0.50	"	30.0		98	85-125	8	20	
Surrogate: 1,2-Dichloroethane-d4	4.41		"	5.00		88	60-135			

Matrix Spike (5E17003-MS1)

Source: MOE0430-01

Prepared & Analyzed: 05/17/05

Benzene	637	50	ug/l	608	140	82	65-115			
Ethylbenzene	860	50	"	784	62	102	75-135			
Methyl tert-butyl ether	2610	50	"	960	1800	84	65-125			
Toluene	3720	50	"	3290	16	113	85-120			
Xylenes (total)	4170	50	"	3850	ND	108	85-125			
Gasoline Range Organics (C4-C12)	43900	5000	"	44000	3100	93	70-124			
Surrogate: 1,2-Dichloroethane-d4	4.56		"	5.00		91	60-135			

URS Corporation [Arco]
1333 Broadway, Suite 800
Oakland CA, 94612

Project: ARCO #4931, Oakland, CA
Project Number: G0C8C-0004
Project Manager: Scott Robinson

MOE0430
Reported:
05/25/05 15:24

**Volatile Organic Compounds by EPA Method 8260B - Quality Control
Sequoia Analytical - Morgan Hill**

Analyte	Result	Reporting Limit	Units	Spike Level	Source Result	%REC	%REC Limits	RPD	RPD Limit	Notes
---------	--------	--------------------	-------	----------------	------------------	------	----------------	-----	--------------	-------

Batch 5E17003 - EPA 5030B P/T / EPA 8260B

Matrix Spike Dup (5E17003-MSD1)	Source: MOE0430-01			Prepared & Analyzed: 05/17/05						
Benzene	602	50	ug/l	608	140	76	65-115	6	20	
Ethylbenzene	819	50	"	784	62	97	75-135	5	15	
Methyl tert-butyl ether	2620	50	"	960	1800	85	65-125	0.4	20	
Toluene	3500	50	"	3290	16	106	85-120	6	20	
Xylenes (total)	3940	50	"	3850	ND	102	85-125	6	20	
Gasoline Range Organics (C4-C12)	41500	5000	"	44000	3100	87	70-124	6	20	
Surrogate: 1,2-Dichloroethane-d4	4.25		"	5.00		85	60-135			

URS Corporation [Arco]
1333 Broadway, Suite 800
Oakland CA, 94612

Project: ARCO #4931, Oakland, CA
Project Number: G0C8C-0004
Project Manager: Scott Robinson

MOE0430
Reported:
05/25/05 15:24

Notes and Definitions

HM Analyte recovery below established limit
DET Analyte DETECTED
ND Analyte NOT DETECTED at or above the reporting limit or MDL, if MDL is specified
NR Not Reported
dry Sample results reported on a dry weight basis
RPD Relative Percent Difference



Chain of Custody Record

Project Name: Analytical for QMR sampling
 BP BU/AR Region/Enfos Segment: BP > Americas > West Coast > Retail > WCBU > CA > Central > 4931 > Historical
 State or Lead Regulatory Agency: California Regional Water Quality Control Board - San Francisco
 Requested Due Date (mm/dd/yy): 10 Day TAT

On-site Time: <u>820</u>	Temp: <u>65° F</u>
Off-site Time: <u>610</u>	Temp: <u>65° F</u>
Sky Conditions: <u>clear</u>	
Meteorological Events: <u>none</u>	
Wind Speed:	Direction:

Lab Name: <u>Sequoia</u>	BP/AR Facility No.: <u>4931</u>	Consultant/Contractor: <u>URS</u>
Address: <u>885 Jarvis Drive</u> <u>Morgan Hill, CA 95037</u>	BP/AR Facility Address: <u>731 West MacArthur Blvd., Oakland, CA 94609</u>	Address: <u>1333 Broadway, Suite 800</u> <u>Oakland, CA 94612</u>
Lab PM: <u>Lisa Race</u>	Site Lat/Long: <u>37.80773 / -122.2413</u>	Consultant/Contractor Project No.: <u>38487032</u>
Tele/Fax: <u>408.782.8156 / 408.782.6308</u>	California Global ID No.: <u>T0600100110</u>	Consultant/Contractor PM: <u>Scott Robinson</u>
BP/AR PM Contact: <u>Paul Supple</u>	Enfos Project No.: <u>G0C8C-0004</u>	Tele/Fax: <u>510.874.3280 / 510.874.3268</u>
Address: <u>P.O. Box 6549</u> <u>Moraga, CA 94570</u>	Provision or RCOP: <u>Provision</u>	Report Type & QC Level: <u>Level 1 with EDF</u>
Tele/Fax: <u>925.299.8891 / 925.299.8872</u>	Phase/WBS: <u>04 - Mon/Remed by Natural Attenuation</u>	E-mail EDD To: <u>Rachel.Lindvall@urscorp.com</u>
	Sub Phase/Task: <u>03 - Analytical</u>	Invoice to: <u>Atlantic Richfield Company</u>
	Cost Element: <u>05 - Subcontracted Costs</u>	

Item No.	Sample Description	Time	Date	Matrix			Laboratory No.	No. of Containers	Preservative					Requested Analysis					Sample Point Lat/Long and Comments
				Soil/Solid	Water/Liquid	Air			Unpreserved	H ₂ SO ₄	HNO ₃	HCl	Methanol	GC/MS (260)	MTBE, ETBE, DIBP, TAME, TBA (260)	EDB, 1,2-DCA (260)	ETHANOL (260)		
1	A-4	950	5/10/05	R			01	3											110E6430 on hole
2	AB	935		R			02	3											
3	TB493105092005			R			03	2											
4																			
5																			
6																			
7																			
8																			
9																			
10																			

Sampler's Name:	Relinquished By / Affiliation	Date	Time	Accepted By / Affiliation	Date	Time
<u>P. Corwin / W. Crown</u>	<u>Rachel Lindvall</u>	<u>5/10/05</u>	<u>1412</u>	<u>[Signature]</u>	<u>5/10/05</u>	<u>1412</u>
Sampler's Company: <u>BTS</u>		<u>5/10/05</u>	<u>1456</u>	<u>[Signature]</u>	<u>5/10/05</u>	<u>1513</u>
Shipment Date:						
Shipment Method:						
Shipment Tracking No:						

Special Instructions:

Custody Seals In Place Yes R No
 Temp Blank Yes R No
 Cooler Temperature on Receipt F/C
 Trip Blank Yes A No

SEQUOIA ANALYTICAL SAMPLE RECEIPT LOG

CLIENT NAME: Acc #4931
 REC. BY (PRINT) JAY
 WORKORDER: MOE 6470

DATE REC'D AT LAB: 5/10/05
 TIME REC'D AT LAB: 5:13
 DATE LOGGED IN: 5-11-05

For Regulatory Purposes?
 DRINKING WATER YES/NO NO
 WASTE WATER YES/NO NO

(For clients requiring preservation checks at receipt, document here ↓)

CIRCLE THE APPROPRIATE RESPONSE		LAB SAMPLE #	DASH #	CLIENT ID	CONTAINER DESCRIPTION	PRESERVATIVE	pH	SAMPLE MATRIX	DATE SAMPLED	REMARKS: CONDITION (ETC.)
1. Custody Seal(s)	Present / Absent Intact / Broken*	01		A-4	(3) JWA	HCL	—	LV	5/9/05	
2. Chain-of-Custody	Present / Absent*	02		A-8	↓	↓	↓	↓	↓	
3. Traffic Reports or Packing List:	Present / Absent	03		FB493105092005	(3) JWA	↓	↓	↓	↓	
4. Airbill:	Airbill / Sticker Present / Absent									
5. Airbill #:										
6. Sample Labels:	Present / Absent									
7. Sample IDs:	Listed / Not Listed on Chain-of-Custody									
8. Sample Condition:	Intact / Broken* / Leaking*									
9. Does information on chain-of-custody, traffic reports and sample labels agree?	Yes / No*									
10. Sample received within hold time?	Yes / No*									
11. Adequate sample volume received?	Yes / No*									
12. Proper Preservatives used?	Yes / No*									
13. Trip Blank / Temp Blank Received? (circle which, if yes)	Yes / No*									
14. Temp Rec. at Lab: Is temp 4 +/- 2°C?	<u>6.0°C</u> Yes / No**									

*IF CIRCLED, CONTACT PROJECT MANAGER AND ATTACH RECORD OF RESOLUTION.

ATTACHMENT C

HISTORICAL GROUNDWATER DATA

Table 1
Groundwater Elevation and Analytical Data
Total Purgeable Petroleum Hydrocarbons
(TPPH as Gasoline, BTEX Compounds, and MTBE)

ARCO Service Station 4931
731 West MacArthur Boulevard, Oakland, California

Well Number	Date Ganged/ Sampled	Well Elevation (feet, MSL)	Depth to Water (feet, TOB)	Groundwater Elevation (feet, MSL)	TPH Gasoline (ppb)	Benzene (ppb)	Toluene (ppb)	Ethyl- benzene (ppb)	Total Xylenes (ppb)	MTBE 8021B* (ppb)	MTBE 8260 (ppb)	Dissolved Oxygen (ppm)	Purged/ Not Purged (P/NP)
A-2	03/26/96	55.48	5.37	50.11	<50	<0.5	<0.5	<0.5	<0.5	NA	NA	NM	
A-2	05/22/96	55.48	5.25	50.23	<50	<0.5	<0.5	<0.5	<0.5	NA	NA	NM	
A-2	08/22/96	55.48	10.45	45.03	<50	<0.5	<0.5	<0.5	<0.5	NA	NA	NM	
A-2	12/19/96	55.48	5.53	49.95	<50	1.1	1.8	<0.5	1.3	<2.5	NA	NM	
A-2	04/01/97	55.48	8.77	46.71	<50	<0.5	<0.5	<0.5	<0.5	2.7	NA	NM	
A-2	05/27/97	55.48	9.87	45.61	<50	<0.5	<0.5	<0.5	<0.5	<2.5	NA	NM	
A-2	08/12/97	55.48	11.11	44.37	<50	<0.5	<0.5	<0.5	<0.5	4.6	NA	NM	
A-2	11/14/97	55.48	10.63	44.85	<50	<0.5	<0.5	<0.5	<0.5	5.6	NA	NM	
A-2	03/18/98	55.48	3.58	51.90	<50	<0.5	<0.5	<0.5	2.4	27	NA	2.6	
A-2	05/19/98	55.48	4.82	50.66	<50	<0.5	<0.5	<0.5	<0.5	<3	NA	NM	
A-2	07/29/98	55.48	8.94	46.54	<50	<0.5	<0.5	<0.5	<0.5	<3	NA	1.30	P
A-2	10/09/98	55.48	10.82	44.66	<50	<0.5	<0.5	<0.5	<0.5	<3	NA	1.2	NP
A-2	02/19/99	55.48	4.46	51.02	<50	<0.5	<0.5	<0.5	<0.5	<3	NA	0.5	NP
A-2	06/02/99	55.48	5.59	49.89	<50	<0.5	<0.5	<0.5	<0.5	<3	NA	3.0	P
A-2	08/26/99	55.48	10.67	44.81	<50	<0.5	0.6	<0.5	<0.5	<3	NA	5.35	NP
A-2	10/26/99	55.48	4.61	50.87	<50	<0.5	<0.5	<0.5	<0.5	<3	NA	0.79	NP
A-2	02/25/00	55.48	3.10	52.38	<50	<0.5	<0.5	<0.5	<0.5	<3	NA	2.14	P
A-3	03/26/96	54.66	7.20	47.46	Not Sampled: Well Sampled Semiannually							4.21	NP
A-3	05/22/96	54.66	7.70	46.96	<50	1.2	1.9	0.7					
A-3	08/22/96	54.66	10.88	43.78	Not Sampled: Well Sampled Semiannually				1.3	NA	NA	NM	
A-3	12/19/96	54.66	7.70	46.96	5,900	<25	<25	<25	<25	NA	5,300	NM	
A-3	04/01/97	54.66	9.78	44.88	Not Sampled: Well Sampled Semiannually								
A-3	05/27/97	54.66	10.55	44.11	2,300	<20	<20	<20	<20	3,800	NA	NM	
A-3	08/12/97	54.66	11.12	43.54	Not Sampled: Well Sampled Semiannually								
A-3	11/14/97	54.66	8.24	46.42	<1,000	<10	<10	<10	<10	1,500	NA	3.8	
A-3	03/18/98	54.66	5.05	49.61	Not Sampled: Well Sampled Semiannually								
A-3	05/19/98	54.66	9.00	45.66	<250	<2.5	<2.5	<2.5	<2.5	220	NA	4.60	P
A-3	07/29/98	54.66	9.86	44.80	Not Sampled: Well Sampled Semiannually								
A-3	10/09/98	54.66	11.36	43.30	<250	<2.5	<2.5	<2.5	<2.5	260	NA	1.0	NP
A-3	02/19/99	54.66	6.19	48.47	<50	<0.5	<0.5	<0.5	<0.5	<3	NA	2.5	NP
A-3	06/02/99	54.66	10.82	43.84	120	<1	<1	<1	<1	160	NA	2.78	NP

OAKS:\ARCO\4931\QTRLY\4931g100.xls:1
 Recreated from electronic data provided by IT Corporation.

IT CORPORATION

Table 1
Groundwater Elevation and Analytical Data
Total Purgeable Petroleum Hydrocarbons
(TPPH as Gasoline, BTEX Compounds, and MTBE)

ARCO Service Station 4931
731 West MacArthur Boulevard, Oakland, California

Well Number	Date Gauged/ Sampled	Well Elevation (feet, MSL)	Depth to Water (feet, TOB)	Groundwater Elevation (feet, MSL)	TPH Gasoline (ppb)	Benzene (ppb)	Toluene (ppb)	Ethyl- benzene (ppb)	Total Xylenes (ppb)	MTBE 8021B* (ppb)	MTBE 8260 (ppb)	Dissolved Oxygen (ppm)	Purged/ Not Purged (P/NP)
A-3	08/26/99	54.66	10.73	43.93	Not Sampled: Well Sampled Semiannually								
A-3	10/26/99	54.66	6.58	48.08	<50	<0.5	<0.5	<0.5	<1	32	NA	0.95	
A-3	02/25/00	54.66	5.41	49.25	Not Sampled: Well Sampled Semiannually								
A-4	03/26/96	54.73	7.95	46.78	8,900	1,200	21	200	220	NA	NA	NM	
A-4	05/22/96	54.73	8.35	46.38	5,300	700	<10	170	130	NA	NA	NM	
A-4	08/22/96	54.73	11.03	43.70	3,000	480	<5.0	75	26	150	NA	NM	
A-4	12/19/96	54.73	8.67	46.06	<2,000	<20	<20	<20	<20	NA	15,000	NM	
A-4	04/01/97	54.73	11.95	42.78	8,900	1,700	22	310	260	6,900	NA	NM	
A-4	05/27/97	54.73	10.80	43.93	7,100	960	<20	150	74	7,900	NA	NM	
A-4	08/12/97	54.73	11.38	43.35	4,300	670	12	51	27	2,800	NA	NM	
A-4	11/14/97	54.73	7.74	46.99	<20,000	300	500	<200	<200	27,000	NA	NM	
A-4	03/18/98	54.73	6.80	47.93	4,700	600	<20	99	94	1,200	NA	2.2	
A-4	05/19/98	54.73	9.06	45.67	<2000	<20	<20	<20	720	2,000	NA	1.0	
A-4	07/29/98	54.73	10.05	44.68	8,400	1,300	<20	290	130	1,800	NA	1.28	P
A-4	10/09/98	54.73	11.20	43.53	3,500	400	<20	54	<20	1,700	NA	0.7	NP
A-4	02/19/99	54.73	6.85	47.88	<1,000	<10	<10	<10	12	650	NA	1.0	NP
A-4	06/02/99	54.73	11.00	43.73	6,100	760	16	260	89	2,300	NA	0.1	NP
A-4	08/26/99	54.73	10.80	43.93	1,100	63	5	8	4	1,400	NA	1.12	NP
A-4	10/26/99	54.73	10.11	44.62	1,500	39	2.3	9.0	5	1,700	NA	1.15	NP
A-4	02/25/00	54.73	5.90	48.83	870	53	1.1	4.6	20	600	NA	10.12	NP
A-5	03/26/96	54.17	7.93	46.24	Not Sampled: Well Sampled Semiannually								
A-5	05/22/96	54.17	8.20	45.97	<50	<0.5	<0.5	<0.5	<0.5	NA	NA	NM	
A-5	08/22/96	54.17	10.70	43.47	Not Sampled: Well Sampled Semiannually								
A-5	12/19/96	54.17	8.39	45.78	9,900	1,100	330	230	700	NA	24	NM	
A-5	04/01/97	54.17	10.83	43.34	Not Sampled: Well Sampled Semiannually								
A-5	05/27/97	54.17	10.65	43.52	100	<0.5	<0.5	<0.5	<0.5	120	NA	NM	
A-5	08/12/97	54.17	11.05	43.12	Not Sampled: Well Sampled Semiannually								
A-5	11/14/97	54.17	10.51	43.66	<50	<0.5	<0.5	<0.5	<0.5	41	NA	4.8	
A-5	03/18/98	54.17	8.10	46.07	Not Sampled: Well Sampled Semiannually								
A-5	05/19/98	54.17	9.31	44.86	590	<5	<5	<5	<5	710	NA	2.48	P

OAK:\ARCO\4931\QTRLY\4931q100.xls\sh:1
 Recreated from electronic data provided by IT Corporation.

IT CORPORATION

Table 1
Groundwater Elevation and Analytical Data
Total Purgeable Petroleum Hydrocarbons
(TPPH as Gasoline, BTEX Compounds, and MTBE)

ARCO Service Station 4931
731 West MacArthur Boulevard, Oakland, California

Well Number	Date Gauged/ Sampled	Well Elevation (feet, MSL)	Depth to Water (feet, TOB)	Groundwater Elevation (feet, MSL)	TPH Gasoline (ppb)	Benzene (ppb)	Toluene (ppb)	Ethyl- benzene (ppb)	Total Xylenes (ppb)	MTBE 8021B* (ppb)	MTBE 8260 (ppb)	Dissolved Oxygen (ppm)	Purged/ Not Purged (P/NP)	
A-5	07/29/98	54.17	9.89	44.28	Not Sampled: Well Sampled Semiannually									
A-5	10/09/98	54.17	11.02	43.15	690	<5	<5	<5	<5	710	NA	1.0	NP	
A-5	02/19/99	54.17	6.82	47.35	<2,000	<20	<20	<20	<20	2,300	NA	0.6	NP	
A-5	06/02/99	54.17	10.82	43.35	1,500	<0.5	2.3	<0.5	<0.5	2,400	NA	2.91	NP	
A-5	08/26/99	54.17	10.65	43.52	Not Sampled: Well Sampled Semiannually									
A-5	10/26/99	54.17	10.35	43.82	380	<0.5	<0.5	<0.5	<1	440	NA	0.49	NP	
A-5	02/25/00	54.17	6.89	47.28	Not Sampled: Well Sampled Semiannually									
A-6	03/26/96	55.17	7.15	48.02	52	2.7	<0.5	1.1	2.0	NA	NA	NM		
A-6	05/22/96	55.17	7.35	47.82	<50	2.4	<0.5	0.88	1.7	NA	NA	NM		
A-6	08/22/96	55.17	10.12	45.05	<50	<0.5	<0.5	<0.5	<0.5	<2.5	NA	NM		
A-6	12/19/96	55.17	7.43	47.74	<50	1.7	<0.5	0.78	1.5	<2.5	NA	NM		
A-6	04/01/97	55.17	9.97	45.20	<50	4.7	<0.5	1.9	3.2	<2.5	NA	NM		
A-6	05/27/97	55.17	9.66	45.51	<50	0.69	<0.5	<0.5	<0.5	<2.5	NA	NM		
A-6	08/12/97	55.17	10.43	44.74	<50	<0.5	<0.5	<0.5	<0.5	<2.5	NA	NM		
A-6	11/14/97	55.17	9.76	45.41	<50	<0.5	<0.5	<0.5	<0.5	<2.5	NA	NM		
A-6	03/18/98	55.17	7.00	48.17	<50	<0.5	<0.5	<0.5	<0.5	<3	NA	<1.0		
A-6	05/19/98	55.17	8.27	46.90	<50	6.2	0.5	2.3	2.6	<3	NA	3.0		
A-6	07/29/98	55.17	8.96	46.21	<50	<0.5	<0.5	1.3	4.7	<3	NA	2.16	P	
A-6	10/09/98	55.17	10.23	44.94	<50	<0.5	<0.5	<0.5	<0.5	<3	NA	0.8	NP	
A-6	02/19/99	55.17	5.79	49.38	<50	<0.5	<0.5	<0.5	<0.5	<3	NA	1.0	NP	
A-6	06/02/99	55.17	9.71	45.46	<50	<0.5	<0.5	<0.5	<0.5	5	NA	0.4	NP	
A-6	08/26/99	55.17	9.79	45.38	<50	<0.5	<0.5	<0.5	<0.5	<3	NA	2.00	NP	
A-6	10/26/99	55.17	9.70	45.47	<50	<0.5	<0.5	<0.5	0.7	<3	NA	0.66	NP	
A-6	02/25/00	55.17	5.68	49.49	<50	<0.5	<0.5	<0.5	<1	<3	NA	1.66	NP	
A-7	03/26/96	54.71	6.90	47.81	Not Sampled: Well Sampled Semiannually									
A-7	05/22/96	54.71	8.27	46.44	<50	<0.5	<0.5	<0.5	<0.5	NA	NA	NM		
A-7	08/22/96	54.71	9.80	44.91	Not Sampled: Well Sampled Semiannually									
A-7	12/19/96	54.71	7.19	47.52	Not Sampled: Well Sampled Annually									
A-7	04/01/97	54.71	9.63	45.08	Not Sampled: Well Sampled Annually									
A-7	05/27/97	54.71	9.34	45.37	<50	<0.5	<0.5	<0.5	<0.5	<2.5	NA	NM		

OAKC:\ARCO\4931\QTRLYM93\q:00.xls\shh:1
 Recreated from electronic data provided by IT Corporation.

IT CORPORATION

Table 1
Groundwater Elevation and Analytical Data
Total Purgeable Petroleum Hydrocarbons
(TPPH as Gasoline, BTEX Compounds, and MTBE)
ARCO Service Station 4931
731 West MacArthur Boulevard, Oakland, California

Well Number	Date Gauged/ Sampled	Well Elevation (feet, MSL)	Depth to Water (feet, TOB)	Groundwater Elevation (feet, MSL)	TPH Gasoline (ppb)	Benzene (ppb)	Toluene (ppb)	Ethyl- benzene (ppb)	Total Xylenes (ppb)	MTBE 8021B* (ppb)	MTBE 8260 (ppb)	Dissolved Oxygen (ppm)	Purged/ Not Purged (P/NP)	
A-7	08/12/97	54.71	10.10	44.61	Not Sampled: Well Sampled Annually									
A-7	11/14/97	54.71	9.35	45.36	Not Sampled: Well Sampled Annually									
A-7	03/18/98	54.71	6.75	47.96	Not Sampled: Well Sampled Annually									
A-7	05/19/98	54.71	8.85	45.86	<50	<0.5	<0.5	<0.5	<0.5	<3	NA	1.82	P	
A-7	07/29/98	54.71	8.84	45.87	Not Sampled: Well Sampled Annually									
A-7	10/09/98	54.71	10.05	44.66	Not Sampled: Well Sampled Annually									
A-7	02/19/99	54.71	5.57	49.14	<50	<0.5	<0.5	<0.5	<0.5	<3	NA	4.7	NP	
A-7	06/02/99	54.71	9.56	45.15	<50	<0.5	<0.5	<0.5	<0.5	<3	NA	2.17	NP	
A-7	08/26/99	54.71	9.66	45.05	Not Sampled: Well Sampled Annually									
A-7	10/26/99	54.71	9.54	45.17	Not Sampled: Well Sampled Annually									
A-7	02/25/00	54.71	5.60	49.11	Not Sampled: Well Sampled Annually									
A-8	03/26/96	53.77	7.10	46.67	48,000	2,600	<100	650	1,100	NA	NA	NM		
A-8	05/22/96	53.77	7.20	46.57	14,000	2,800	160	320	190	NA	NA	NM		
A-8	08/22/96	53.77	11.57	42.20	8,000	1,000	76	150	96	4,300	NA	NM		
A-8	12/19/96	53.77	8.04	45.73	12,000	450	110	210	230	<500	NA	NM		
A-8	04/01/97	53.77	9.98	43.79	Not Sampled: Well Sampled Semiannually									
A-8	05/27/97	53.77	11.45	42.32	11,000	1,600	100	220	210	2,300	NA	NM		
A-8	08/12/97	53.77	11.59	42.18	Not Sampled: Well Sampled Semiannually									
A-8	11/14/97	53.77	9.85	43.92	26,000	2,300	<200	400	400	4,100	NA	2.2		
A-8	03/18/98	53.77	7.80	45.97	Not Sampled: Well Sampled Semiannually									
A-8	05/19/98	53.77	8.78	44.99	88,000	4,200	150	640	600	6,700	NA	1.36	P	
A-8	07/29/98	53.77	9.59	44.18	46,000	4,900	160	620	580	13,000	NA	0.5	NP	
A-8	10/09/98	53.77	11.23	42.54	130,000	3,700	110	500	770	7,300	NA	1.0	NP	
A-8	02/19/99	53.77	6.51	47.26	<1,000	39	<10	<10	<10	840	NA	0.2	NP	
A-8	06/02/99	53.77	10.68	43.09	8,500	1,300	32	180	110	6,700	NA	1.31	NP	
A-8	08/26/99	53.77	10.43	43.34	6,200	870	17	64	60	3,700	NA	0.69	NP	
A-8	10/26/99	53.77	10.23	43.54	15,000	2,800	140	370	360	480	NA	0.62	NP	
A-8	02/25/00	53.77	5.93	47.84	2,600	330	6.6	18	26	1,100	NA	1.43	NP	
A-9	03/26/96	53.04	7.05	45.99	<50	<0.5	<0.5	<0.5	<0.5	NA	NA	NM		
A-9	05/22/96	53.04	7.20	45.84	<50	<0.5	<0.5	<0.5	<0.5	NA	NA	NM		

OAKC:\ARCO\4931\Q7RL\Y\931q100.xls:wh:1
 Recreated from electronic data provided by IT Corporation.

Table 1
Groundwater Elevation and Analytical Data
Total Purgeable Petroleum Hydrocarbons
(TPPH as Gasoline, BTEX Compounds, and MTBE)

ARCO Service Station 4931
731 West MacArthur Boulevard, Oakland, California

Well Number	Date Gauged/ Sampled	Well Elevation (feet, MSL)	Depth to Water (feet, TOB)	Groundwater Elevation (feet, MSL)	TPH				Total Xylenes (ppb)	MTBE 8021B* (ppb)	MTBE 8260 (ppb)	Dissolved Oxygen (ppm)	Purged/ Not Purged (P/NP)
					Gasoline (ppb)	Benzene (ppb)	Toluene (ppb)	Ethyl- benzene (ppb)					
A-9	08/22/96	53.04	9.68	43.36	<50	<0.5	<0.5	<0.5	<0.5	8.5	NA	NM	
A-9	12/19/96	53.04	7.43	45.61	<50	<0.5	<0.5	<0.5	<0.5	2.6	NA	NM	
A-9	04/01/97	53.04	9.95	43.09	Not Sampled: Well Sampled Semiannually				<0.5	45	NA	NM	
A-9	05/27/97	53.04	9.56	43.48	<50	2.3	<0.5	<0.5	<0.5				
A-9	08/12/97	53.04	10.15	42.89	Not Sampled: Well Sampled Semiannually				<0.5	45	NA	NM	
A-9	11/14/97	53.04	8.64	44.40	<200	<2.0	<2.0	<2.0	<2.0	190	NA	9.6	
A-9	03/18/98	53.04	6.45	46.59	Not Sampled: Well Sampled Semiannually				<0.5	7	NA	1.27	P
A-9	05/19/98	53.04	8.35	44.69	<50	<0.5	<0.5	<0.5	<0.5				
A-9	07/29/98	53.04	8.74	44.30	<50	<0.5	<0.5	<0.5	<0.5				
A-9	10/09/98	53.04	10.05	42.99	<50	<0.5	<0.5	<0.5	<0.5			0.99	NP
A-9	02/19/99	53.04	6.91	46.13	<50	<0.5	<0.5	<0.5	<0.5			1.0	NP
A-9	06/02/99	53.04	9.72	43.32	<50	<0.5	<0.5	<0.5	<0.5			2.0	NP
A-9	08/26/99	53.04	9.48	43.56	<50	<0.5	<0.5	<0.5	<0.5	16	NA	2.32	NP
A-9	10/26/99	53.04	9.17	43.87	<50	<0.5	<0.5	<0.5	<0.5			0.71	NP
A-9	02/25/00	53.04	5.84	47.20	1,500	6.2	0.7	78	11	91	NA	2.15	NP
A-10	03/26/96	54.26	8.28	45.98	<50	<0.5	<0.5	<0.5	<1			1.55	NP
A-10	05/22/96	54.26	8.60	45.66	Not Sampled: Well Removed from Sampling Program								
A-10	08/22/96	54.26	10.98	43.28	Not Sampled: Well Removed from Sampling Program								
A-10	12/19/96	54.26	8.80	45.46	Not Sampled: Well Removed from Sampling Program								
A-10	04/01/97	54.26	11.15	43.11	Not Sampled: Well Removed from Sampling Program								
A-10	05/27/97	54.26	10.90	43.36	Not Sampled: Well Removed from Sampling Program								
A-10	08/12/97	54.26	11.30	42.96	Not Sampled: Well Removed from Sampling Program								
A-10	11/14/97	54.26	10.80	43.46	Not Sampled: Well Removed from Sampling Program								
A-10	03/18/98				Well Removed from Survey Program								
A-11	03/26/96	53.74	8.10	45.64	Not Sampled: Well Sampled Semiannually								
A-11	05/22/96	53.74	8.25	45.49	<50	<0.5	<0.5	<0.5	<0.5	NA	NA	NM	
A-11	08/22/96	53.74	10.58	43.16	Not Sampled: Well Sampled Semiannually								
A-11	12/19/96	53.74	8.37	45.37	<50	<0.5	<0.5	<0.5	<0.5	<2.5	NA	NM	
A-11	04/01/97	53.74	10.95	42.79	Not Sampled: Well Sampled Semiannually								
A-11	05/27/97	53.74	10.60	43.14	<50	<0.5	<0.5	<0.5	<0.5	3.1	NA	NM	

OAKVC:ARCOM4931\QTRLY4931q100.xls:uh:1
 Recreated from electronic data provided by IT Corporation.

IT CORPORATION

Table 1
Groundwater Elevation and Analytical Data
Total Purgeable Petroleum Hydrocarbons
(TPPH as Gasoline, BTEX Compounds, and MTBE)

ARCO Service Station 4931
731 West MacArthur Boulevard, Oakland, California

Well Number	Date Gauged/ Sampled	Well Elevation (feet, MSL)	Depth to Water (feet, TOB)	Groundwater Elevation (feet, MSL)	TPH Gasoline (ppb)	Benzene (ppb)	Toluene (ppb)	Ethyl- benzene (ppb)	Total Xylenes (ppb)	MTBE 8021B* (ppb)	MTBE 8260 (ppb)	Dissolved Oxygen (ppm)	Purged/ Not Purged (P/NP)	
A-11	08/12/97	53.74	11.07	42.67	Not Sampled: Well Sampled Semiannually									
A-11	11/14/97	53.74	10.58	43.16	<50	<0.5	<0.5	<0.5	<0.5	<3	NA	1.6		
A-11	03/18/98	53.74	8.14	45.60	Not Sampled: Well Sampled Semiannually									
A-11	05/19/98	53.74	9.40	44.34	<50	<0.5	<0.5	<0.5	<0.5	<3	NA	1.13	P	
A-11	07/29/98	53.74	10.32	43.42	Not Sampled: Well Sampled Semiannually									
A-11	10/09/98	53.74	10.91	42.83	<50	<0.5	<0.5	<0.5	<0.5	<3	NA	2.0	NP	
A-11	02/19/99	53.74	6.77	46.97	<50	<0.5	<0.5	<0.5	<0.5	<3	NA	1.8	NP	
A-11	06/02/99	53.74	10.95	42.79	<50	<0.5	<0.5	<0.5	<0.5	<3	NA	1.38	NP	
A-11	08/26/99	53.74	11.05	42.69	Not Sampled: Well Sampled Semiannually									
A-11	10/26/99	53.74	10.81	42.93	<50	<0.5	<0.5	<0.5	<0.5	6	NA	0.49	NP	
A-11	02/25/00	53.74	6.70	47.04	Not Sampled: Well Sampled Semiannually									
A-12	03/26/96	52.05	7.83	44.22	Not Sampled: Well Sampled Semiannually									
A-12	05/22/96	52.05	7.80	44.25	<50	<0.5	<0.5	<0.5	<0.5	NA	NA	NM		
A-12	08/22/96	52.05	9.97	42.08	Not Sampled: Well Sampled Semiannually									
A-12	12/19/96	52.05	8.18	43.87	85	<0.5	<0.5	<0.5	<0.5	170	NA	NM		
A-12	04/01/97	52.05	10.30	41.75	Not Sampled: Well Sampled Semiannually									
A-12	05/27/97	52.05	10.05	42.00	50	12	<0.5	<0.5	<0.5	96	NA	NM		
A-12	08/12/97	52.05	10.46	41.59	Not Sampled: Well Sampled Semiannually									
A-12	11/14/97	52.05	9.70	42.35	<50	<0.5	<0.5	<0.5	<0.5	75	NA	7.0		
A-12	03/18/98	52.05	8.15	43.90	Not Sampled: Well Sampled Semiannually									
A-12	05/19/98	52.05	9.15	42.90	<50	<0.5	<0.5	<0.5	<0.5	29	NA	1.47	P	
A-12	07/29/98	52.05	9.38	42.67	Not Sampled: Well Sampled Semiannually									
A-12	10/09/98	52.05	10.21	41.84	<50	<0.5	<0.5	<0.5	<0.5	7	NA	2.0	NP	
A-12	02/19/99	52.05	6.96	45.09	<50	<0.5	<0.5	<0.5	<0.5	<3	NA	5.2	NP	
A-12	06/02/99	52.05	10.25	41.80	<50	<0.5	<0.5	<0.5	<0.5	7	NA	1.38	NP	
A-12	08/26/99	52.05	9.91	42.14	Not Sampled: Well Sampled Semiannually									
A-12	10/26/99	52.05	9.73	42.32	<50	<0.5	<0.5	<0.5	<0.5	<1	12	NA	0.51	NP
A-12	02/25/00	52.05	6.97	45.08	Not Sampled: Well Sampled Semiannually									
A-13	03/26/96	55.11			Well Inaccessible									
A-13	05/22/96	55.11			Well Inaccessible									

0AKC:VRCOW4931VQTRLY4931q102.xls:uh:1
 Recreated from electronic data provided by IT Corporation.

IT CORPORATION

**Table 1
Groundwater Elevation and Analytical Data
Total Purgeable Petroleum Hydrocarbons
(TPH as Gasoline, BTEX Compounds, and MTBE)**

**ARCO Service Station 4931
731 West MacArthur Boulevard, Oakland, California**

Well Number	Date Gauged/ Sampled	Well Elevation (feet, MSL)	Depth to Water (feet, TOB)	Groundwater Elevation (feet, MSL)	TPH Gasoline (ppb)	Benzene (ppb)	Toluene (ppb)	Ethyl- benzene (ppb)	Total Xylenes (ppb)	MTBE 8021B* (ppb)	MTBE 8260 (ppb)	Dissolved Oxygen (ppm)	Purged/ Not Purged (P/NP)
A-13	08/22/96	55.11											
A-13	12/19/96	55.11						Well Inaccessible					
A-13	04/01/97	55.11						Well Inaccessible					
A-13	05/27/97	55.11						Well Inaccessible					
A-13	08/12/97	55.11						Well Inaccessible					
A-13	11/14/97	55.11						Well Inaccessible					
A-13	03/18/98	55.11						Well Inaccessible					
A-13	05/19/98	55.11						Well Inaccessible					
A-13	07/29/98	55.11						Well Inaccessible					
A-13	10/09/98	55.11						Well Inaccessible					
A-13	02/19/99	55.11						Well Inaccessible					
A-13	06/02/99	55.11						Well Inaccessible					
A-13	08/26/99	55.11						Well Inaccessible					
A-13	10/26/99	55.11						Well Inaccessible					
A-13	02/25/00	55.11						Well Inaccessible					
AR-1	03/26/96	54.72	8.13	46.59	6,200	110	64	38	520	NA	NA	NM	
AR-1	05/22/96	54.72	8.57	46.15	NS	NS	NS	NS	NS	NS	NS	NM	
AR-1	08/22/96	54.72	10.97	43.75	5,600	100	28	29	310	960	NA	NM	
AR-1	12/19/96	54.72	8.93	45.79	Not Sampled: Well Removed from Sampling Program								
AR-1	04/01/97	54.72	11.78	42.94	Not Sampled: Well Removed from Sampling Program								
AR-1	05/27/97	54.72	10.76	43.96	Not Sampled: Well Removed from Sampling Program								
AR-1	08/12/97	54.72	11.40	43.32	Not Sampled: Well Removed from Sampling Program								
AR-1	11/14/97	54.72	10.80	43.92	Not Sampled: Well Removed from Sampling Program								
AR-1	03/18/98	54.72	NM	NM	Not Sampled: Well Removed from Sampling Program								
AR-1	05/19/98	54.72	NM	NM	Not Sampled: Well Removed from Sampling Program								
AR-1	07/29/98	54.72	10.17	44.55	Not Sampled: Well Removed from Sampling Program								
AR-1	10/09/98	54.72	11.25	43.47	Not Sampled: Well Removed from Sampling Program								
AR-1	02/19/99	54.72	7.02	47.70	Not Sampled: Well Removed from Sampling Program								
AR-1	06/02/99	54.72	11.00	43.72	Not Sampled: Well Removed from Sampling Program								
AR-1	08/26/99	54.72	10.96	43.76	Not Sampled: Well Removed from Sampling Program								
AR-1	10/26/99	54.72	10.68	44.04	Not Sampled: Well Removed from Sampling Program								0.39 1.39

OAKC:\ARCOM931\QTRLY\4931q100.xls\sh:1
Recreated from electronic data provided by IT Corporation.

Table 1
Groundwater Elevation and Analytical Data
Total Purgeable Petroleum Hydrocarbons
(TPPH as Gasoline, BTEX Compounds, and MTBE)

ARCO Service Station 4931
731 West MacArthur Boulevard, Oakland, California

Well Number	Date Gauged/ Sampled	Well Elevation (feet, MSL)	Depth to Water (feet, TOB)	Groundwater Elevation (feet, MSL)	TPH Gasoline (ppb)	Benzene (ppb)	Toluene (ppb)	Ethyl- benzene (ppb)	Total Xylenes (ppb)	MTBB 8021B* (ppb)	MTBE 8260 (ppb)	Dissolved Oxygen (ppm)	Purged/ Not Purged (P/NP)
AR-1	02/25/00	54.72	7.15	47.57	Not Sampled: Well Removed from Sampling Program								
AR-2	03/26/96	54.77	4.93	49.84	<50	<0.5	<0.5	<0.5	<0.5	NA	NA	NM	
AR-2	05/22/96	54.77	5.65	49.12	NS	NS	NS	NS	NS	NS	NS	NM	
AR-2	08/22/96	54.77	7.27	47.50	<50	<0.5	<0.5	<0.5	<0.5	200	NA	NM	
AR-2	12/19/96	54.77	7.78	46.99	Not Sampled: Well Removed from Sampling Program								
AR-2	04/01/97	54.77	6.80	47.97	Not Sampled: Well Removed from Sampling Program								
AR-2	05/27/97	54.77	6.32	48.45	Not Sampled: Well Removed from Sampling Program								
AR-2	08/12/97	54.77	7.43	47.34	Not Sampled: Well Removed from Sampling Program								
AR-2	11/14/97	54.77	8.95	45.82	Not Sampled: Well Removed from Sampling Program								
AR-2	03/18/98	54.77	NM	NM	Not Sampled: Well Removed from Sampling Program								
AR-2	05/19/98	54.77	NM	NM	Not Sampled: Well Removed from Sampling Program								
AR-2	07/29/98	54.77	4.47	50.30	Not Sampled: Well Removed from Sampling Program								
AR-2	10/09/98	54.77	6.90	47.87	Not Sampled: Well Removed from Sampling Program								
AR-2	02/19/99	54.77	3.80	50.97	Not Sampled: Well Removed from Sampling Program								
AR-2	06/02/99	54.77	4.61	50.16	Not Sampled: Well Removed from Sampling Program								
AR-2	08/26/99	54.77	5.22	49.55	Not Sampled: Well Removed from Sampling Program								
AR-2	10/26/99	54.77	3.20	51.57	Not Sampled: Well Removed from Sampling Program								
AR-2	02/25/00	54.77	2.33	52.44	Not Sampled: Well Removed from Sampling Program								
AR-3	03/26/96	54.19	7.95	46.24	<50	<0.5	<0.5	<0.5	<0.5	NA	NA	NM	
AR-3	05/22/96	54.19	8.30	45.89	NS	NS	NS	NS	NS	NS	NS	NM	
AR-3	08/22/96	54.19	10.84	43.35	Not Sampled: Well Removed from Sampling Program								
AR-3	12/19/96	54.19	8.56	45.63	Not Sampled: Well Removed from Sampling Program								
AR-3	04/01/97	54.19	11.24	42.95	Not Sampled: Well Removed from Sampling Program								
AR-3	05/27/97	54.19	10.67	43.52	Not Sampled: Well Removed from Sampling Program								
AR-3	08/12/97	54.19	11.10	43.09	Not Sampled: Well Removed from Sampling Program								
AR-3	11/14/97	54.19	10.60	43.59	Not Sampled: Well Removed from Sampling Program								
AR-3	03/18/98	54.19	NM	NM	Not Sampled: Well Removed from Sampling Program								
AR-3	05/19/98	54.19	NM	NM	Not Sampled: Well Removed from Sampling Program								
AR-3	07/29/98	54.19	9.95	44.24	Not Sampled: Well Removed from Sampling Program								
AR-3	10/09/98	54.19	11.20	42.99	Not Sampled: Well Removed from Sampling Program								

OAK:\ARCO\931\QTRLY\4931\g190.xls\shr:1
 Recasted from electronic data provided by IT Corporation.

IT CORPORATION

Table 1
Groundwater Elevation and Analytical Data
Total Purgeable Petroleum Hydrocarbons
(TPPH as Gasoline, BTEX Compounds, and MTBE)

ARCO Service Station 4931
731 West MacArthur Boulevard, Oakland, California

Well Number	Date Gaged/ Sampled	Well Elevation (feet, MSL)	Depth to Water (feet, TOB)	Groundwater Elevation (feet, MSL)	TPH Gasoline	Benzene (ppb)	Toluene (ppb)	Ethyl- benzene (ppb)	Total Xylenes (ppb)	MTBE 8021B* (ppb)	MTBE 8260 (ppb)	Dissolved Oxygen (ppm)	Purged/ Not Purged (P/NP)	
AR-3	02/19/99	54.19	6.98	47.21	Not Sampled: Well Removed from Sampling Program									
AR-3	06/02/99	54.19	10.80	43.39	Not Sampled: Well Removed from Sampling Program									
AR-3	08/26/99	54.19	10.69	43.50	Not Sampled: Well Removed from Sampling Program									
AR-3	10/26/99	54.19	NM	NM	Not Sampled: Well Removed from Sampling Program								0.40	
AR-3	02/25/00	54.19	7.21	46.98	Not Sampled: Well Removed from Sampling Program									

TPH	= Total petroleum hydrocarbons by modified EPA method 8015
BTEX	= Benzene, toluene, ethylbenzene, total xylenes by EPA method 8021B. (EPA method 8020 prior to 10/26/99).
MTBE	= Methyl tert-butyl ether
*	= EPA method 8020 prior to 10/26/99
MSL	= Mean sea level
TOB	= Top of box
ppb	= Parts per billion
ppm	= Parts per million
<	= Less than laboratory detection limit stated to the right
NA	= Not analyzed
NM	= Not measured
NS	= Not sampled

**Table 2
Groundwater Flow Direction and Gradient**

**ARCO Service Station 4931
731 West MacArthur Boulevard, Oakland, California**

Date Measured	Average Flow Direction	Average Hydraulic Gradient
03/26/96	Southwest	0.03
05/22/96	Southwest	0.04
08/22/96	Southwest	0.02
12/19/96	Southwest	0.03
04/01/97	Southwest	0.03
05/27/97	Southwest	0.04
08/12/97	Southwest	0.02
11/14/97	Southwest	0.02
03/18/98	West	0.03
05/19/98	West-Southwest	0.02
07/29/98	West-Southwest	0.02
10/09/98	Southwest	0.007
02/19/99	Southwest	0.04
06/02/99	West	0.04
08/26/99	West-Southwest	0.02
10/26/99	West-Northwest	0.13
02/25/00	West-Southwest	0.05

ATTACHMENT D

**ERROR CHECK REPORTS AND EDF/GEOWELL SUBMITTAL
CONFIRMATIONS**

Electronic Submittal Information

[Main Menu](#) | [View/Add Facilities](#) | [Upload EDD](#) | [Check EDD](#)

SUCCESSFUL GEO_WELL CHECK - NO ERRORS

<u>ORGANIZATION NAME:</u>	URS Corporation-Oakland Office
<u>USER NAME:</u>	URSCORP-OAKLAND
<u>DATE CHECKED:</u>	5/27/2005 11:33:28 AM

Processing is complete. No errors were found!
You may now proceed to the [upload](#) page.

[Back to Main Menu](#)

Logged in as URSCORP-OAKLAND (CONTRACTOR)

CONTACT SITE [ADMINISTRATOR](#).

Electronic Submittal Information

[Main Menu](#) | [View/Add Facilities](#) | [Upload EDD](#) | [Check EDD](#)

UPLOADING A GEO_WELL FILE

**Processing is complete. No errors were found!
Your file has been successfully submitted!**

Submittal Title: 2Q 2005 QMR Geo_Well Site
4931

Submittal Date/Time: 5/27/2005 11:35:34 AM

**Confirmation
Number:** 5023925602

[Back to Main Menu](#)

Logged in as URSCORP-OAKLAND
(CONTRACTOR)

[CONTACT SITE ADMINISTRATOR.](#)

Electronic Submittal Information

[Main Menu](#) |
 [View/Add Facilities](#) |
 [Upload EDD](#) |
 [Check EDD](#)

SUCCESSFUL EDF CHECK - NO ERRORS

<u>ORGANIZATION NAME:</u>	URS Corporation-Oakland Office
<u>USER NAME:</u>	URSCORP-OAKLAND
<u>DATE CHECKED:</u>	5/27/2005 11:34:38 AM
<u>GLOBAL ID:</u>	T0600100110
<u>FILE UPLOADED:</u>	Arco#4931-EDF-MOE0430.zip

No errors were found in your EDF upload file.

If you want to submit this file to the SWRCB, choose the "Upload EDD" option in the above menu and follow the instructions.

When you complete the submittal process, you will be given a confirmation number for your submittal.

Click [here](#) to view the detections report for this upload.

ARCO # 04931	<u>Regional Board - Case #: 01-0118</u>
731 MACARTHUR BLVD	SAN FRANCISCO BAY RWQCB (REGION
W	2) - (BG)
OAKLAND, CA 94609	<u>Local Agency (lead agency) - Case #: 3874</u>
	ALAMEDA COUNTY LOP - (AG)

SAMPLE DETECTIONS REPORT

# FIELD POINTS SAMPLED	2
# FIELD POINTS WITH DETECTIONS	2
# FIELD POINTS WITH WATER SAMPLE DETECTIONS ABOVE MCL	1
SAMPLE MATRIX TYPES	WATER

METHOD QA/QC REPORT

METHODS USED	8260FA
TESTED FOR REQUIRED ANALYTES?	N
MISSING PARAMETERS NOT TESTED:	
- 8260FA REQUIRES DBFM TO BE TESTED	
- 8260FA REQUIRES BR4FBZ TO BE TESTED	
- 8260FA REQUIRES BZMED8 TO BE TESTED	
LAB NOTE DATA QUALIFIERS	Y

QA/QC FOR 8021/8260 SERIES SAMPLES

TECHNICAL HOLDING TIME VIOLATIONS	0
METHOD HOLDING TIME VIOLATIONS	0
LAB BLANK DETECTIONS ABOVE REPORTING DETECTION LIMIT	0
LAB BLANK DETECTIONS	0
DO ALL BATCHES WITH THE 8021/8260 SERIES INCLUDE THE FOLLOWING?	
- LAB METHOD BLANK	Y
- MATRIX SPIKE	Y
- MATRIX SPIKE DUPLICATE	Y

- BLANK SPIKE Y
 - SURROGATE SPIKE Y

WATER SAMPLES FOR 8021/8260 SERIES

MATRIX SPIKE / MATRIX SPIKE DUPLICATE(S) % RECOVERY BETWEEN 65-135% Y
 MATRIX SPIKE / MATRIX SPIKE DUPLICATE(S) RPD LESS THAN 30% Y
 SURROGATE SPIKES % RECOVERY BETWEEN 85-115% Y
 BLANK SPIKE / BLANK SPIKE DUPLICATES % RECOVERY BETWEEN 70-130% Y

SOIL SAMPLES FOR 8021/8260 SERIES

MATRIX SPIKE / MATRIX SPIKE DUPLICATE(S) % RECOVERY BETWEEN 65-135% n/a
 MATRIX SPIKE / MATRIX SPIKE DUPLICATE(S) RPD LESS THAN 30% n/a
 SURROGATE SPIKES % RECOVERY BETWEEN 70-125% n/a
 BLANK SPIKE / BLANK SPIKE DUPLICATES % RECOVERY BETWEEN 70-130% n/a

FIELD QC SAMPLES

<u>SAMPLE</u>	<u>COLLECTED</u>	<u>DETECTIONS > REPD.</u>
QCTB SAMPLES	N	0
QCEB SAMPLES	N	0
QCAB SAMPLES	N	0

Logged in as URSCORP-OAKLAND (CONTRACTOR)

CONTACT SITE ADMINISTRATOR.

Electronic Submittal Information

[Main Menu](#) |
 [View/Add Facilities](#) |
 [Upload EDD](#) |
 [Check EDD](#)

Your EDF file has been successfully uploaded!

Confirmation Number: 7510508775
Date/Time of Submittal: 5/27/2005 11:37:21 AM
Facility Global ID: T0600100110
Facility Name: ARCO # 04931
Submittal Title: 2Q 2005 QMR EDF Site 4931
Submittal Type: GW Monitoring Report

Click [here](#) to view the detections report for this upload.

ARCO # 04931 731 MACARTHUR BLVD W OAKLAND, CA 94609	Regional Board - Case #: 01-0118 SAN FRANCISCO BAY RWQCB (REGION 2) - (BG) Local Agency (lead agency) - Case #: 3874 ALAMEDA COUNTY LOP - (AG)
--	---

CONF #	TITLE	QUARTER
7510508775	2Q 2005 QMR EDF Site 4931	Q2 2005
SUBMITTED BY	SUBMIT DATE	STATUS
Srijesh Thapa	5/27/2005	PENDING REVIEW

SAMPLE DETECTIONS REPORT

# FIELD POINTS SAMPLED	2
# FIELD POINTS WITH DETECTIONS	2
# FIELD POINTS WITH WATER SAMPLE DETECTIONS ABOVE MCL	1
SAMPLE MATRIX TYPES	WATER

METHOD QA/QC REPORT

METHODS USED	8260FA
TESTED FOR REQUIRED ANALYTES?	N
MISSING PARAMETERS NOT TESTED:	
- 8260FA REQUIRES DBFM TO BE TESTED	
- 8260FA REQUIRES BR4FBZ TO BE TESTED	
- 8260FA REQUIRES BZMED8 TO BE TESTED	
LAB NOTE DATA QUALIFIERS	Y

QA/QC FOR 8021/8260 SERIES SAMPLES

TECHNICAL HOLDING TIME VIOLATIONS	0
METHOD HOLDING TIME VIOLATIONS	0
LAB BLANK DETECTIONS ABOVE REPORTING DETECTION LIMIT	0
LAB BLANK DETECTIONS	0
DO ALL BATCHES WITH THE 8021/8260 SERIES INCLUDE THE FOLLOWING?	
- LAB METHOD BLANK	Y
- MATRIX SPIKE	Y
- MATRIX SPIKE DUPLICATE	Y
- BLANK SPIKE	Y
- SURROGATE SPIKE	Y

WATER SAMPLES FOR 8021/8260 SERIES

MATRIX SPIKE / MATRIX SPIKE DUPLICATE(S) % RECOVERY BETWEEN 65-135%	Y
---	---

MATRIX SPIKE / MATRIX SPIKE DUPLICATE(S) RPD LESS THAN 30%	Y	
SURROGATE SPIKES % RECOVERY BETWEEN 85-115%	Y	
BLANK SPIKE / BLANK SPIKE DUPLICATES % RECOVERY BETWEEN 70-130%	Y	
<u>SOIL SAMPLES FOR 8021/8260 SERIES</u>		
MATRIX SPIKE / MATRIX SPIKE DUPLICATE(S) % RECOVERY BETWEEN 65-135%	n/a	
MATRIX SPIKE / MATRIX SPIKE DUPLICATE(S) RPD LESS THAN 30%	n/a	
SURROGATE SPIKES % RECOVERY BETWEEN 70-125%	n/a	
BLANK SPIKE / BLANK SPIKE DUPLICATES % RECOVERY BETWEEN 70-130%	n/a	
<u>FIELD QC SAMPLES</u>		
<u>SAMPLE</u>	<u>COLLECTED</u>	<u>DETECTIONS > REPDL</u>
QCTB SAMPLES	N	0
QCEB SAMPLES	N	0
QCAB SAMPLES	N	0

Logged in as URSCORP-OAKLAND (CONTRACTOR)

CONTACT SITE ADMINISTRATOR.