

January 27, 2003

Alameda County
JAN 31 2003
Environmental Health

Ms. Susan Hugo
Alameda County Health Care Services Agency
1131 Harbor Bay Parkway, Suite 250
Alameda, CA 94502-6577

Re: Second Quarter 2002 Groundwater Monitoring Report
ARCO Service Station #4931
731 West MacArthur Boulevard
Oakland, California
URS Project #38465952

Dear Ms. Hugo:

On behalf of Atlantic Richfield Company (ARCO-an affiliated company of the Group Environmental Management Company), URS Corporation (URS) is submitting the *Second Quarter 2002 Groundwater Monitoring Report* for the ARCO Service Station #4931, located at 731 MacArthur Boulevard, Oakland, California.

If you have any questions regarding this submission, please call us at (510) 893-3600.

Sincerely,

URS CORPORATION

Scott Robinson

Scott Robinson
Project Manager

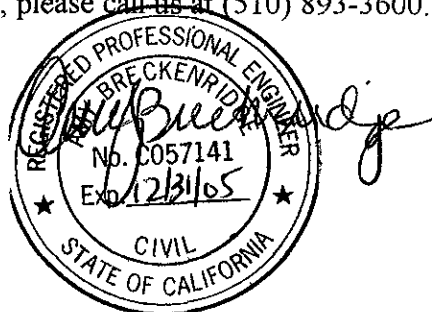

Amy P. Breckenridge, P.E.
Portfolio Manager

Enclosure: Second Quarter 2002 Quarterly Groundwater Monitoring Report

cc: Mr. Paul Supple, ARCO, P.O. Box 6549, Moraga, CA 94570
Mr. John Kaiser, California Regional Water Quality Control Board – San Francisco Bay Region

R E P O R T

**SECOND QUARTER 2002
GROUNDWATER MONITORING**

ARCO SERVICE STATION #4931
731 WEST MACARTHUR BOULEVARD
OAKLAND, CALIFORNIA

Prepared for
Atlantic Richfield Company

January 27, 2003

URS

URS Corporation
500 12th Street, Suite 200
Oakland, California 94607

38465952



Date: January 27, 2003
 Quarter: 2Q 02

ATLANTIC RICHFIELD COMPANY QUARTERLY GROUNDWATER MONITORING REPORT

Facility No.: 4931 Address: 731 West MacArthur Boulevard, Oakland, CA
 Atlantic Richfield Co. Environmental Engineer: Paul Supple/ (925) 299-8891
 Consulting Co./Contact Person: URS Corporation/Scott Robinson
 Consultant Project No.: 38465952
 Primary Agency/Regulatory ID No.: Alameda County Health Care Services Agency

WORK PERFORMED THIS QUARTER (Second – 2002):

1. Site transferred from Delta Environmental Consultants, Inc. (Delta) to URS Corporation.
2. Delta performed second quarter 2002 groundwater monitoring event.
3. Delta prepared and submitted first quarter 2002 groundwater monitoring report.

WORK PROPOSED FOR NEXT QUARTER (Third – 2002):

1. Perform third quarter 2002 groundwater monitoring event.
2. Prepare and submit second quarter 2002 groundwater monitoring report.

Current Phase of Project	Monitoring/Remediation
Frequency of Groundwater Sampling:	Annual (2 nd Quarter): A-7, A-13 Semi-Annual (2 nd /4 th Quarter): A-3, A-5, A-11, A-12 Quarterly: A-2, A-4, A-6, A-8, A-9
Frequency of Groundwater Monitoring:	Quarterly
Is Free Product (FP) Present On-Site:	No
FP Recovered this Quarter:	N/A
Cumulative FP Recovered to Date:	Unknown
Bulk Soil Removed This Quarter:	None
Bulk Soil Removed to Date:	Unknown
Current Remediation Techniques:	Intrinsic Bioremediation Enhancement using ORC
Approximate Depth to Groundwater:	6.96 feet
Groundwater Gradient:	0.03 feet per foot West – Southwest
Cumulative TPH-g/Benzene Removed:	0.45/0.06 gallons

DISCUSSION:

Bioremediation enhancement is ongoing using oxygen release compound (ORC) in wells A-4, A-8, A-9 and AR-1. Benzene was detected in wells A-4 and A-8 at concentrations of 79 micrograms per liter (µg/L) and 540 µg/L, respectively. Total petroleum hydrocarbons as gasoline were detected in wells A-4, A-5, A-8 at concentrations of 1300 µg/L, 1600 µg/L and 3800 µg/L, respectively. Methyl tertiary butyl ether was detected in samples collected from monitoring wells A-2 through A-6, A-8 and A-12 at 3.1 µg/L, 45 µg/L, 2200 µg/L, 3200 µg/L, 3.1 µg/L, 3100 µg/L and 29 µg/L, respectively.

ATTACHMENTS:

- Table 1 – Groundwater Elevation and Analytical Data
- Table 2 – Groundwater Flow Direction and Gradient
- Figure 1 – Groundwater Analytical Summary Map – April 17, 2002
- Figure 2 – Groundwater Elevation Contour Summary Map – April 17, 2002
- Attachment A – Field Procedures and Field Data Sheets
- Attachment B – Laboratory Procedures, Certified Analytical Reports, and Chain-of-Custody Records
- Attachment C – Historic Groundwater Data (Source: IT Corporation)
- Attachment D - EDCC Report and EDF/Geowell Submittal Confirmation

TABLE 1

SUMMARY OF GROUNDWATER ELEVATION AND ANALYTICAL DATA

ARCO Service Station No. 4931
731 West Macarthur Boulevard
Oakland, California

Well Number	Date Sampled	Top of Riser Elevation (ft)	Depth to Groundwater (ft)	Groundwater Elevation (ft)	TPH as Gasoline (µg/L)	Benzene (µg/L)	Toluene (µg/L)	Ethylbenzene (µg/L)	Total Xylenes (µg/L)	MTBE (µg/L)
A-2	06/21/00	55.48	6.85	48.63	<50	<0.5	<0.5	<0.5	<1.0	<3.0
	09/20/00		10.45	45.03	<50	<0.5	<0.5	<0.5	<0.5	<2.5
	12/26/00		6.27	49.21	<50	<0.5	<0.5	<0.5	<0.5	<2.5
	03/20/01		4.57	50.91	<50	<0.5	<0.5	<0.5	<0.5	<2.5
	06/12/01		9.27	46.21	<50	<0.5	<0.5	<0.5	<0.5	<2.5
	09/23/01		10.75	44.73	<50	<0.5	<0.5	<0.5	<0.5	<2.5
	12/31/01		4.13	51.35	<50	<0.5	<0.5	1	3.2	<2.5
	03/21/02		3.26	52.22	<50	<0.5	<0.5	<0.5	<0.5	<2.5
	04/17/02		3.72	51.76	<50	<0.5	<0.5	<0.5	<0.5	<0.5
A-3	06/21/00	54.66	9.48	45.18	<50	<0.5	<0.5	<0.5	<1.0	46
	09/20/00		10.24	44.42	<50	<0.5	<0.5	<0.5	<0.5	89.6
	12/26/00		9.58	45.08	<50	<0.5	<0.5	<0.5	<0.5	7.11
	03/20/01		6.34	48.32	NS	NS	NS	NS	NS	NS
	06/12/01		9.76	44.90	<50	<0.5	<0.5	<0.5	<0.5	86
	09/23/01		10.55	44.11	NS	NS	NS	NS	NS	NS
	12/31/01		3.70	50.96	<50	<0.5	<0.5	<0.5	1	60
	03/21/02		5.75	48.91	NS	NS	NS	NS	NS	NS
	04/17/02		7.27	47.39	<50	<0.5	<0.5	<0.5	<0.5	<0.5
A-4	06/21/00	54.73	9.49	45.24	2,100	110	2.1	11	5.9	2,000
	09/20/00		10.33	44.40	1,540	127	<5.0	9.07	7.42	1,940
	12/26/00		9.34	45.39	1,550	42.7	<5.0	11	10.9	1,210
	03/20/01		7.56	47.17	913	40.9	<5.0	15.5	14.6	<25
	06/12/01		9.83	44.90	2,000	230	<20	21	<20	4,700
	09/23/01		10.54	44.19	1,600	35	<10	<10	<10	3,000
	12/31/01		5.42	49.31	<500	<5.0	<5.0	<5.0	<5.0	880
	03/21/02		6.18	48.55	<5,000	<50	<50	<50	<50	1,400
	04/17/02		7.34	47.39	1300	79	31	17	55	2,200

TABLE 1

SUMMARY OF GROUNDWATER ELEVATION AND ANALYTICAL DATA

ARCO Service Station No. 4931
731 West Macarthur Boulevard
Oakland, California

Well Number	Date Sampled	Top of Riser Elevation (ft)	Depth to Groundwater (ft)	Groundwater Elevation (ft)	TPH					
					as Gasoline (µg/L)	Benzene (µg/L)	Toluene (µg/L)	Ethyl-benzene (µg/L)	Total Xylenes (µg/L)	MTBE (µg/L)
A-5	06/21/00	54.17	9.29	44.88	980	<0.5	<0.5	<0.5	<1.0	2,000
	09/20/00		10.23	43.94	NS	NS	NS	NS	NS	NS
	12/26/00		9.65	44.52	525	<0.5	<0.5	<0.5	<0.5	1,200
	03/20/01		8.05	46.12	NS	NS	NS	NS	NS	NS
	06/12/01		9.81	44.36	830	<5.0	<5.0	<5.0	<5.0	3,200
	09/23/01		10.42	43.75	NS	NS	NS	NS	NS	NS
	12/31/01		6.03	48.14	320	<0.5	<0.5	<0.5	<0.5	60
	03/21/02		6.71	47.46	NS	NS	NS	NS	NS	NS
	04/17/02		8.01	46.16	1600	<10	<10	<10	<10	<10
A-6	06/21/00	55.17	8.67	46.50	<50	<0.5	<0.5	<0.5	<1.0	<3.0
	09/20/00		9.34	45.83	<50	<0.5	<0.5	<0.5	<0.5	<2.5
	12/26/00		8.65	46.52	<50	<0.5	<0.5	<0.5	<0.5	<2.5
	03/20/01		6.84	48.33	<50	<0.5	<0.5	<0.5	<0.5	<2.5
	06/12/01		8.93	46.24	<50	<0.5	<0.5	<0.5	<0.5	7
	09/23/01		9.74	45.43	<50	<0.5	<0.5	<0.5	<0.5	<2.5
	12/31/01		4.81	50.36	<50	<0.5	<0.5	<0.5	<0.5	3.2
	03/21/02		5.44	49.73	<50	<0.5	<0.5	<0.5	<0.5	<2.5
	04/17/02		6.95	48.22	<50	<0.5	<0.5	<0.5	<0.5	<0.5
A-7	06/21/00	54.71	8.58	46.13	<50	<0.5	<0.5	<0.5	<1.0	<3.0
	09/20/00		9.19	45.52	NS	NS	NS	NS	NS	NS
	12/26/00		8.50	46.21	NS	NS	NS	NS	NS	NS
	03/20/01		6.75	47.96	NS	NS	NS	NS	NS	NS
	06/12/01		8.80	45.91	<50	<0.5	<0.5	<0.5	<0.5	<2.5
	09/23/01		9.59	45.12	NS	NS	NS	NS	NS	NS
	12/31/01		4.78	49.93	NS	NS	NS	NS	NS	NS
	03/21/02		5.35	49.36	NS	NS	NS	NS	NS	NS
	04/17/02		6.88	47.83	<50	<0.5	<0.5	<0.5	<0.5	<0.5

TABLE 1

SUMMARY OF GROUNDWATER ELEVATION AND ANALYTICAL DATA

ARCO Service Station No. 4931
731 West Macarthur Boulevard
Oakland, California

Well Number	Date Sampled	Top of Riser Elevation (ft)	Depth to Groundwater (ft)	Groundwater Elevation (ft)	TPH as Gasoline (µg/L)	Benzene (µg/L)	Toluene (µg/L)	Ethylbenzene (µg/L)	Total Xylenes (µg/L)	MTBE (µg/L)
A-8	06/21/00	53.77	9.07	44.70	810	<0.5	<0.5	<0.5	810	1,500
	09/20/00		9.72	44.05	10,800	2,680	46	439	370	4,410
	12/26/00		9.20	44.57	7,700	1,440	<50	202	106	2,230
	03/20/01		7.51	46.26	<5,000	1,280	<50	53.9	<50	2,880
	06/12/01		9.53	44.24	5,600	1,700	<50	61	54	2,900
	09/23/01		10.08	43.69	10,000	3,500	<50	110	64	6,500
	12/31/01		4.34	49.43	4,300	610	<10	60	24	520
	03/21/02		6.67	47.10	6,600	1400	<50	130	<50	2,700
	04/17/02			7.72	46.05	3,800	540	<10	<10	12
A-9	06/21/00	53.04	8.56	44.48	<50	<0.5	<0.5	<0.5	<1.0	5.0
	09/20/00		9.05	43.99	<50	<0.5	<0.5	<0.5	<0.5	<2.5
	12/26/00		8.49	44.55	<50	<0.5	<0.5	<0.5	<0.5	<2.5
	03/20/01		6.95	46.09	<50	<0.5	<0.5	<0.5	<0.5	<2.5
	06/12/01		8.67	44.37	<50	<0.5	<0.5	<0.5	<0.5	4.8
	09/23/01		9.21	43.83	<50	<0.5	<0.5	<0.5	<0.5	<2.5
	12/31/01		4.57	48.47	<50	<0.5	<0.5	<0.5	<0.5	<2.5
	03/21/02		5.60	47.44	<50	<0.5	<0.5	<0.5	<0.5	<2.5
	04/17/02			6.89	46.15	<50	<0.5	<0.5	<0.5	<0.5
A-10	06/21/00	54.26	10.47	43.79	NS	NS	NS	NS	NS	NS
	09/20/00		10.76	43.50	NS	NS	NS	NS	NS	NS
	12/26/00		NM	NC	NS	NS	NS	NS	NS	NS
	03/20/01		NM	NC	NS	NS	NS	NS	NS	NS
	09/23/01		NM	NC	NS	NS	NS	NS	NS	NS
	12/31/01		NM	NC	NS	NS	NS	NS	NS	NS
	03/21/02		NM	NC	NS	NS	NS	NS	NS	NS
	04/17/02			NM	NC	NS	NS	NS	NS	NS

TABLE 1

SUMMARY OF GROUNDWATER ELEVATION AND ANALYTICAL DATA

ARCO Service Station No. 4931
731 West Macarthur Boulevard
Oakland, California

Well Number	Date Sampled	Top of Riser Elevation (ft)	Depth to Groundwater (ft)	Groundwater Elevation (ft)	TPH as Gasoline (µg/L)	Benzene (µg/L)	Toluene (µg/L)	Ethylbenzene (µg/L)	Total Xylenes (µg/L)	MTBE (µg/L)
A-11	06/21/00	53.74	9.54	44.20	<50	<0.5	<0.5	<0.5	<1.0	4.0
	09/20/00		10.62	43.12	NS	NS	NS	NS	NS	NS
	12/26/00		10.03	43.71	< 50	< 0.5	< 0.5	< 0.5	<0.5	<2.5
	03/20/01		8.49	45.25	NS	NS	NS	NS	NS	NS
	06/12/01		10.21	43.53	< 50	< 0.5	< 0.5	< 0.5	<0.5	<2.5
	09/23/01		10.77	42.97	NS	NS	NS	NS	NS	NS
	12/31/01		6.06	47.68	< 50	< 0.5	< 0.5	< 0.5	<0.5	<2.5
	03/21/02		7.14	46.60	NS	NS	NS	NS	NS	NS
	04/17/02		8.41	45.33	<50	<0.5	<0.5	<0.5	<0.5	<0.5
A-12	06/21/00	52.05	9.28	42.77	<50	<0.5	<0.5	<0.5	<1.0	18
	09/20/00		9.55	42.50	NS	NS	NS	NS	NS	NS
	12/26/00		9.05	43.00	< 50	< 0.5	< 0.5	< 0.5	<0.5	17.3
	03/20/01		7.92	44.13	NS	NS	NS	NS	NS	NS
	06/12/01		9.26	42.79	< 50	< 0.5	< 0.5	< 0.5	<0.5	25
	09/23/01		9.68	42.37	NS	NS	NS	NS	NS	NS
	12/31/01		5.74	46.31	< 50	< 0.5	< 0.5	< 0.5	<0.5	9.5
	03/21/02		6.64	45.41	NS	NS	NS	NS	NS	NS
	04/17/02		7.68	44.37	<50	<0.5	<0.5	<0.5	<0.5	<0.5
A-13	06/21/00	55.11	NM	NC	NS	NS	NS	NS	NS	NS
	09/20/00		NM	NC	NS	NS	NS	NS	NS	NS
	12/26/00		NM	NC	NS	NS	NS	NS	NS	NS
	03/20/01		NM	NC	NS	NS	NS	NS	NS	NS
	06/12/01		NM	NC	NS	NS	NS	NS	NS	NS
	09/23/01		NM	NC	NS	NS	NS	NS	NS	NS
	12/31/01		NM	NC	NS	NS	NS	NS	NS	NS
	03/21/02		6.70	48.41	NS	NS	NS	NS	NS	NS
	04/17/02		7.95	47.16	<50	<0.5	<0.5	<0.5	<0.5	<0.5

TABLE 1

SUMMARY OF GROUNDWATER ELEVATION AND ANALYTICAL DATA

ARCO Service Station No. 4931
731 West Macarthur Boulevard
Oakland, California

Well Number	Date Sampled	Top of Riser Elevation (ft)	Depth to Groundwater (ft)	Groundwater Elevation (ft)	TPH as Gasoline (µg/L)	Benzene (µg/L)	Toluene (µg/L)	Ethylbenzene (µg/L)	Total Xylenes (µg/L)	MTBE (µg/L)
AR-1	06/21/00	54.72	NM	NC	NS	NS	NS	NS	NS	NS
	09/20/00		NM	NC	NS	NS	NS	NS	NS	NS
	12/26/00		9.95	44.77	NS	NS	NS	NS	NS	NS
	03/20/01		8.34	46.38	NS	NS	NS	NS	NS	NS
	06/12/01		10.17	44.55	NS	NS	NS	NS	NS	NS
	09/23/01		10.72	44.00	NS	NS	NS	NS	NS	NS
	12/31/01		5.91	48.81	NS	NS	NS	NS	NS	NS
	03/21/02		7.00	47.72	NS	NS	NS	NS	NS	NS
	04/17/02		8.33	46.39	NS	NS	NS	NS	NS	NS
AR-2	06/21/00	54.77	NM	NC	NS	NS	NS	NS	NS	NS
	09/20/00		NM	NC	NS	NS	NS	NS	NS	NS
	12/26/00		NM	NC	NS	NS	NS	NS	NS	NS
	03/20/01		3.13	51.64	NS	NS	NS	NS	NS	NS
	06/12/01		4.51	50.26	NS	NS	NS	NS	NS	NS
	09/23/01		6.05	48.72	NS	NS	NS	NS	NS	NS
	12/31/01		2.79	51.98	NS	NS	NS	NS	NS	NS
	03/21/02		7.75	47.02	NS	NS	NS	NS	NS	NS
	04/17/02		2.24	52.53	NS	NS	NS	NS	NS	NS

TABLE 1

SUMMARY OF GROUNDWATER ELEVATION AND ANALYTICAL DATA

ARCO Service Station No 4931
731 West Macarthur Boulevard
Oakland, California

Well Number	Date Sampled	Top of Riser Elevation (ft)	Depth to Groundwater (ft)	Groundwater Elevation (ft)	TPH as Gasoline ($\mu\text{g/L}$)	Benzene ($\mu\text{g/L}$)	Toluene ($\mu\text{g/L}$)	Ethyl-benzene ($\mu\text{g/L}$)	Total Xylenes ($\mu\text{g/L}$)	MTBE ($\mu\text{g/L}$)
AR-3	06/21/00	54.19	NM	NC	NS	NS	NS	NS	NS	NS
	09/20/00		NM	NC	NS	NS	NS	NS	NS	NS
	12/26/00		9.70	44.49	NS	NS	NS	NS	NS	NS
	03/20/01		NM	NC	NS	NS	NS	NS	NS	NS
	06/12/01		NM	NC	NS	NS	NS	NS	NS	NS
	09/23/01		10.43	43.76	NS	NS	NS	NS	NS	NS
	12/31/01		5.18	49.01	NS	NS	NS	NS	NS	NS
	03/21/02		6.78	47.41	NS	NS	NS	NS	NS	NS
	04/17/02		8.06	46.13	NS	NS	NS	NS	NS	NS

^a Well appears to have been paved over

$\mu\text{g/L}$ = Micrograms per liter

TPH = Total Petroleum Hydrocarbons

NM = Not measured

MTBE = Methyl tertiary butyl ether analyzed by EPA Method 8021B unless otherwise noted

NC = Not calculated

NS = Not sampled

Note: Please refer to Attachment C for Historical Groundwater Elevation and Analytical Data Tables developed by IT Corporation

Note: URS Corporation took over reporting from Delta Environmental Consultants Inc during the second quarter 2002

TABLE 2

FLOW DIRECTION AND GRADIENT

ARCO Service Station No. 4931
 731 West Macarthur Boulevard
 Oakland, California

Date Measured	Average Flow Direction	Average Hydraulic Gradient
06/21/00	West-Southwest	0.031
09/20/00	Southwest	0.013
12/26/00	West	0.028
03/20/01	West	0.046
06/12/01	West	0.014
09/23/01	West	0.012
12/31/01	West	0.024
03/21/02	West	0.047
04/17/02	West	0.03*

* URS Corporation took over reporting from Delta Environmental Consultants Inc. during the second quarter 2002

Note: Please refer to Attachment C for Historical Groundwater Elevation and Analytical Data Tables developed by IT Corporation

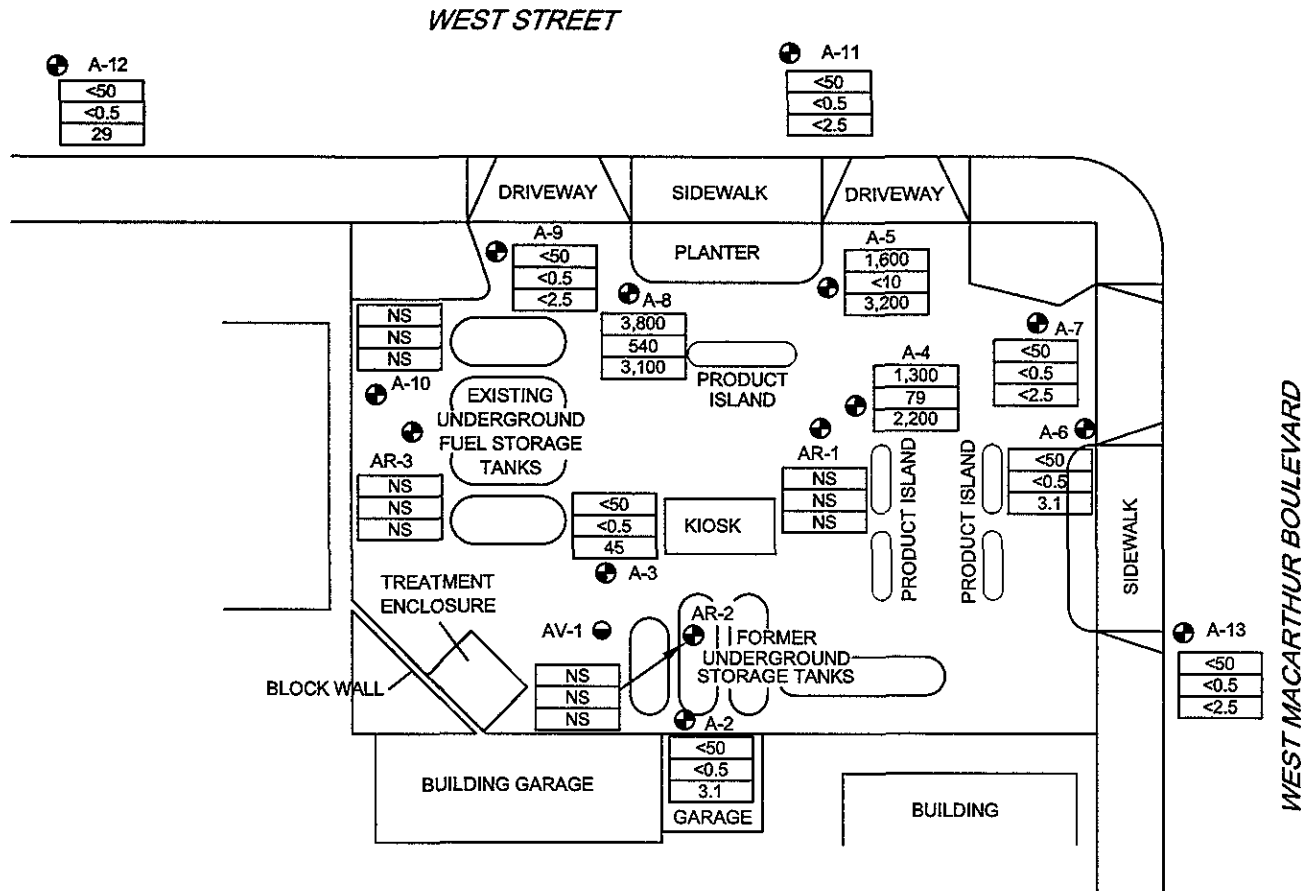

NORTH



SCALE IN FEET

URS	Project No. 38465952	GROUNDWATER ANALYTICAL SUMMARY Second Quarter 2002 (April 17, 2002)	FIGURE 1
	Arco Service Station 4931 731 West MacArthur Boulevard Oakland, California		

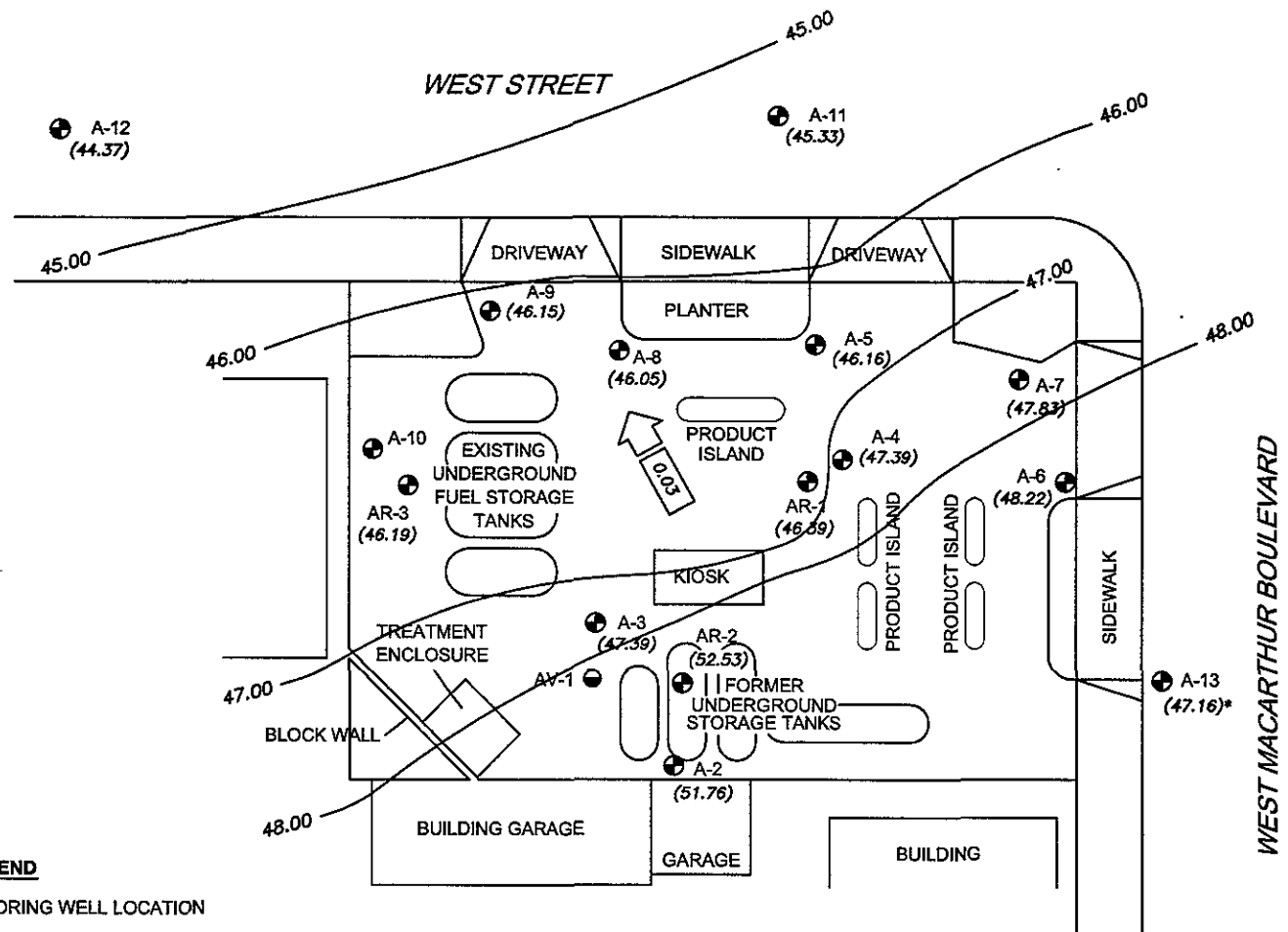

LEGEND

- A-2 MONITORING WELL LOCATION
- AV-1 SOIL VAPOR EXTRACTION WELL LOCATION
- (46.19) GROUNDWATER ELEVATION IN FEET ABOVE MSL
- 46.00 — WATER TABLE CONTOUR IN FEET ABOVE MSL
- ← 0.03 APPROXIMATE GROUNDWATER FLOW GRADIENT
- * ELEVATION NOT USED IN CONTOURING

NOTE: SITE MAP ADAPTED FROM IT CORPORATION FIGURES. SITE DIMENSIONS AND FACILITY LOCATIONS NOT VERIFIED.



NORTH

0 40 80



SCALE IN FEET

URS	Project No. 38465952	GROUNDWATER ELEVATION CONTOUR MAP Second Quarter 2002 (April 17, 2002)	FIGURE 2
	Arco Service Station 4931 731 West MacArthur Boulevard Oakland, California		

ATTACHMENT A

FIELD PROCEDURES AND FIELD DATA SHEETS

FIELD PROCEDURES

Sampling Procedures

The sampling procedure for each well consists first of measuring the water level and depth to bottom, and checking for the presence of free phase petroleum product (free product), using either an electronic indicator and a clear Teflon™ bailer or an oil-water interface probe. Wells not containing free product are purged approximately three casing volumes of water (or until dewatered) using a centrifugal pump, gas displacement pump, or bailer. Equipment and purging method used for the current sampling event is noted on the attached field data sheets. During purging, temperature, pH, and electrical conductivity are monitored to document that these parameters are stable prior to collecting samples. After purging, water levels are allowed to partially (approximately 80%) recover. Groundwater samples (both purge and no purge) are collected using a Teflon bailer, placed into appropriate Environmental Protection Agency- (EPA) approved containers, labeled, logged onto chain-of-custody records, and transported on ice to a California State-certified laboratory. Wells with free product are not sampled and free product is removed according to California Code of Regulation, Title 23, Div. 3, Chap. 16, Section 2655, UST Regulations.



3164 Gold Camp Drive Suite 200
 Rancho Cordova California 95670
 Direct (916) 638-2085
 Fax (916) 638-8385

Arco Site Address 731 West MacArthur Blvd Arco Site Number Arco 4931

Oakland, California

Delta Project No D000-313

Arco Project Manager: Paul Supple

Delta Project PM Steve Meeks

Site Sampled By ~~Paul Supple~~ Doolos

Date Sampled 4-17-02

Site Contact & Phone Number _____

Water Level Data						Purge Volume Calculations					Sampling Analytes				Sample Record			
Well ID	Time	Depth to Water (feet)	Top of Screen Interval (feet)	Total Depth of Well (feet)	Check if Purge Not Required	Casing Water Column (A)	Well Diameter (inches)	Multiplier Value (B)	Three Casing Volumes (gallons)	Actual Water Purged (gallons)	BTEX (8020) VOA	TPH-g (8015M) VOA	MTBE (8020) VOA	Other	Dissolved Oxygen (mg/L)	Sample Frequency (A, S, Q)	Sample ID	Sample Time
A-2	11:50	3.72	5.0	19.0	<input type="checkbox"/>		4 inch	2.0		30.5	<input checked="" type="checkbox"/>	<input checked="" type="checkbox"/>	<input checked="" type="checkbox"/>	<input type="checkbox"/>	3.10	Q/2,5,8,11	A-2	14:12
A-3	12:13	7.27	5.0	19.3	<input checked="" type="checkbox"/>		4 inch	2.0			<input type="checkbox"/>	<input type="checkbox"/>	<input type="checkbox"/>	<input type="checkbox"/>	0.92	S/5,11	A-3	14:17
A-4	12:00	7.34	5.0	19.6	<input checked="" type="checkbox"/>		4 inch	2.0			<input checked="" type="checkbox"/>	<input checked="" type="checkbox"/>	<input checked="" type="checkbox"/>	<input type="checkbox"/>	0.75	Q/2,5,8,11	A-4	13:35
A-5	12:02	8.01	3.0	24.0	<input checked="" type="checkbox"/>		3 inch	1.1			<input type="checkbox"/>	<input type="checkbox"/>	<input type="checkbox"/>	<input type="checkbox"/>	0.59	S/5,11	A-5	13:20
A-6	11:55	6.95	2.0	25.0	<input checked="" type="checkbox"/>		3 inch	1.1			<input checked="" type="checkbox"/>	<input checked="" type="checkbox"/>	<input checked="" type="checkbox"/>	<input type="checkbox"/>	0.99	Q/2,5,8,11	A-6	13:27
A-7	11:53	6.88	3.0	22.6	<input checked="" type="checkbox"/>		3 inch	1.1			<input type="checkbox"/>	<input type="checkbox"/>	<input type="checkbox"/>	<input type="checkbox"/>	0.83	A/5	A-7	13:15
A-8	12:20	7.72	2.0	20.0	<input checked="" type="checkbox"/>		3 inch	1.1			<input checked="" type="checkbox"/>	<input checked="" type="checkbox"/>	<input checked="" type="checkbox"/>	<input type="checkbox"/>	0.40	Q/2,5,8,11	A-8	13:03
A-9	12:17	6.89	5.0	38.0	<input checked="" type="checkbox"/>		6 inch	4.4			<input checked="" type="checkbox"/>	<input checked="" type="checkbox"/>	<input checked="" type="checkbox"/>	<input type="checkbox"/>	0.78	Q/2,5,8,11	A-9	12:57
A-11	12:29	8.41	5.0	28.0	<input checked="" type="checkbox"/>		3 inch	1.1			<input type="checkbox"/>	<input type="checkbox"/>	<input type="checkbox"/>	<input type="checkbox"/>	0.96	S/5,11	A-11	12:56
A-12	12:25	7.68	5.0	30.0	<input checked="" type="checkbox"/>		3 inch	1.1			<input type="checkbox"/>	<input type="checkbox"/>	<input type="checkbox"/>	<input type="checkbox"/>	0.80	S/5,11	A-12	12:45
A-13	11:58	7.95	10.0	29.5	<input type="checkbox"/>		3 inch	1.1		23.7	<input type="checkbox"/>	<input type="checkbox"/>	<input type="checkbox"/>	<input type="checkbox"/>	1.48	A/5	A-13	13:55
AR-1	12:05	8.33	10.0	31.5	<input type="checkbox"/>		6 inch	4.4			<input type="checkbox"/>	<input type="checkbox"/>	<input type="checkbox"/>	<input type="checkbox"/>		NS		
AR-2	12:31	2.24	10.0	27.5	<input type="checkbox"/>		6 inch	4.4			<input type="checkbox"/>	<input type="checkbox"/>	<input type="checkbox"/>	<input type="checkbox"/>		NS		
AR-3	12:09	8.06	10.0	27.0	<input type="checkbox"/>		6 inch	4.4			<input type="checkbox"/>	<input type="checkbox"/>	<input type="checkbox"/>	<input type="checkbox"/>		NS		
					<input type="checkbox"/>						<input type="checkbox"/>	<input type="checkbox"/>	<input type="checkbox"/>	<input type="checkbox"/>				
					<input type="checkbox"/>						<input type="checkbox"/>	<input type="checkbox"/>	<input type="checkbox"/>	<input type="checkbox"/>				
					<input type="checkbox"/>						<input type="checkbox"/>	<input type="checkbox"/>	<input type="checkbox"/>	<input type="checkbox"/>				
					<input type="checkbox"/>						<input type="checkbox"/>	<input type="checkbox"/>	<input type="checkbox"/>	<input type="checkbox"/>				
					<input type="checkbox"/>						<input type="checkbox"/>	<input type="checkbox"/>	<input type="checkbox"/>	<input type="checkbox"/>				
					<input type="checkbox"/>						<input type="checkbox"/>	<input type="checkbox"/>	<input type="checkbox"/>	<input type="checkbox"/>				

(A)-Casing Water Column Depth to Bottom - Depth to Water (B)-Multiplier Values. (2" Well 0.5) (4" Well 2.0) (6" Well 4.4)

Sampling Sequence

Annual: A-7 A-13; Semi-Annual: A-3 A-5 A-11 A-12
 Quarterly A-6, A-8 A-9, A-2 A-4

Sampling Notes List depth of Sample on C.O.C. [i.e. MW-1(30)]. Make Sure to Note on C.O.C. Provide Lowest Reporting Limit Available

Original Copies of Field Sampling Sheets are Located in Project File

If the water level is below the top of the screen, take a grab sample and check box for NO PURGE (NP). If the water level is above the screen, purge as normal.

ATTACHMENT B

**LABORATORY PROCEDURES,
CERTIFIED ANALYTICAL REPORTS,
AND CHAIN-OF-CUSTODY RECORDS**

LABORATORY PROCEDURES

Laboratory Procedures

The groundwater samples were analyzed for the presence of the chemicals noted on the chain-of-custody using standard EPA Methods. The methods of analysis for the groundwater samples are documented in the certified analytical report. The certified analytical reports and chain-of-custody record are presented in this attachment. The analytical data provided by the laboratory approved by Group Environmental Management Company have been reviewed and verified by that laboratory.



1 May, 2002

Steven Meeks
Delta Environmental Consultants (Rancho Cordova)
3164 Gold Camp Drive Ste. 200
Rancho Cordova, CA 95670

RE: ARCO 4931, Oakland, CA
Sequoia Report: S204358

Enclosed are the results of analyses for samples received by the laboratory on 04/19/02 15:20. If you have any questions concerning this report, please feel free to contact me.

Sincerely,

Lito Diaz
Laboratory Director

CA ELAP Certificate #1624

Delta Environmental Consultants (Rancho Cordova)
3164 Gold Camp Drive Ste. 200
Rancho Cordova CA, 95670

Project: ARCO 4931, Oakland, CA
Project Number 4931, Oakland, CA
Project Manager: Steven Meeks

Reported:
05/01/02 13:13

ANALYTICAL REPORT FOR SAMPLES

Sample ID	Laboratory ID	Matrix	Date Sampled	Date Received
A-2	S204358-01	Water	04/17/02 14:12	04/19/02 15:20
A-3	S204358-02	Water	04/17/02 14:17	04/19/02 15:20
A-4	S204358-03	Water	04/17/02 13:35	04/19/02 15:20
A-5	S204358-04	Water	04/17/02 13:20	04/19/02 15:20
A-6	S204358-05	Water	04/17/02 13:27	04/19/02 15:20
A-7	S204358-06	Water	04/17/02 13:15	04/19/02 15:20
A-8	S204358-07	Water	04/17/02 13:03	04/19/02 15:20
A-9	S204358-08	Water	04/17/02 12:57	04/19/02 15:20
A-11	S204358-09	Water	04/17/02 12:50	04/19/02 15:20
A-12	S204358-10	Water	04/17/02 12:45	04/19/02 15:20
A-13	S204358-11	Water	04/17/02 13:55	04/19/02 15:20
TB	S204358-12	Water	04/17/02 06:00	04/19/02 15:20

Sequoia Analytical - Sacramento

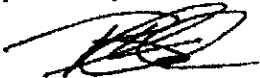

Ron Chew, Client Services Representative

The results in this report apply to the samples analyzed in accordance with the chain of custody document. This analytical report must be reproduced in its entirety.

Delta Environmental Consultants (Rancho Cordova)
 3164 Gold Camp Drive Ste. 200
 Rancho Cordova CA, 95670

 Project: ARCO 4931, Oakland, CA
 Project Number: 4931, Oakland, CA
 Project Manager: Steven Meeks

 Reported:
 05/01/02 13:13

Total Purgeable Hydrocarbon, BTEX and MTBE by DHS LUFT
Sequoia Analytical - Sacramento

Analyte	Result	Reporting Limit	Units	Dilution	Batch	Prepared	Analyzed	Method	Notes
A-2 (S204358-01) Water Sampled: 04/17/02 14:12 Received: 04/19/02 15:20									
Purgeable Hydrocarbons	ND	50	ug/l	1	2040341	04/26/02	04/26/02	DHS LUFT	
Benzene	ND	0.50	"	"	"	"	"	"	
Toluene	ND	0.50	"	"	"	"	"	"	
Ethylbenzene	ND	0.50	"	"	"	"	"	"	
Xylenes (total)	ND	0.50	"	"	"	"	"	"	
Methyl tert-butyl ether	3.1	2.5	"	"	"	"	"	"	
<i>Surrogate: a,a,a-Trifluorotoluene</i>		102 %	60-140	"	"	"	"	"	
A-3 (S204358-02) Water Sampled: 04/17/02 14:17 Received: 04/19/02 15:20									
Purgeable Hydrocarbons	ND	50	ug/l	1	2040341	04/26/02	04/26/02	DHS LUFT	
Benzene	ND	0.50	"	"	"	"	"	"	
Toluene	ND	0.50	"	"	"	"	"	"	
Ethylbenzene	ND	0.50	"	"	"	"	"	"	
Xylenes (total)	ND	0.50	"	"	"	"	"	"	
Methyl tert-butyl ether	45	2.5	"	"	"	"	"	"	C-07
<i>Surrogate: a,a,a-Trifluorotoluene</i>		101 %	60-140	"	"	"	"	"	
A-4 (S204358-03) Water Sampled: 04/17/02 13:35 Received: 04/19/02 15:20									
Purgeable Hydrocarbons	1300	1000	ug/l	20	2050003	04/30/02	04/30/02	DHS LUFT	HC-12
Benzene	79	10	"	"	"	"	"	"	
Toluene	31	10	"	"	"	"	"	"	
Ethylbenzene	17	10	"	"	"	"	"	"	
Xylenes (total)	55	10	"	"	"	"	"	"	
Methyl tert-butyl ether	2200	50	"	"	"	"	"	"	
<i>Surrogate: a,a,a-Trifluorotoluene</i>		107 %	60-140	"	"	"	"	"	

Delta Environmental Consultants (Rancho Cordova)
 3164 Gold Camp Drive Ste. 200
 Rancho Cordova CA, 95670

 Project: ARCO 4931, Oakland, CA
 Project Number: 4931, Oakland, CA
 Project Manager: Steven Meeks

 Reported:
 05/01/02 13:13

Total Purgeable Hydrocarbon, BTEX and MTBE by DHS LUFT Sequoia Analytical - Sacramento

Analyte	Result	Reporting Limit	Units	Dilution	Batch	Prepared	Analyzed	Method	Notes
A-5 (S204358-04) Water Sampled: 04/17/02 13:20 Received: 04/19/02 15:20									
Purgeable Hydrocarbons	1600	1000	ug/l	20	2050003	04/30/02	04/30/02	DHS LUFT	HC-12
Benzene	ND	10	"	"	"	"	"	"	
Toluene	ND	10	"	"	"	"	"	"	
Ethylbenzene	ND	10	"	"	"	"	"	"	
Xylenes (total)	ND	10	"	"	"	"	"	"	
Methyl tert-butyl ether	3200	50	"	"	"	"	"	"	
<i>Surrogate: a,a,a-Trifluorotoluene</i>		110 %	60-140	"	"	"	"	"	
A-6 (S204358-05) Water Sampled: 04/17/02 13:27 Received: 04/19/02 15:20									
Purgeable Hydrocarbons	ND	50	ug/l	1	2040344	04/26/02	04/26/02	DHS LUFT	
Benzene	ND	0.50	"	"	"	"	"	"	
Toluene	ND	0.50	"	"	"	"	"	"	
Ethylbenzene	ND	0.50	"	"	"	"	"	"	
Xylenes (total)	ND	0.50	"	"	"	"	"	"	
Methyl tert-butyl ether	3.1	2.5	"	"	"	"	"	"	C-07
<i>Surrogate: a,a,a-Trifluorotoluene</i>		94.4 %	60-140	"	"	"	"	"	
A-7 (S204358-06) Water Sampled: 04/17/02 13:15 Received: 04/19/02 15:20									
Purgeable Hydrocarbons	ND	50	ug/l	1	2040344	04/26/02	04/26/02	DHS LUFT	
Benzene	ND	0.50	"	"	"	"	"	"	
Toluene	ND	0.50	"	"	"	"	"	"	
Ethylbenzene	ND	0.50	"	"	"	"	"	"	
Xylenes (total)	ND	0.50	"	"	"	"	"	"	
Methyl tert-butyl ether	ND	2.5	"	"	"	"	"	"	
<i>Surrogate: a,a,a-Trifluorotoluene</i>		93.4 %	60-140	"	"	"	"	"	



Delta Environmental Consultants (Rancho Cordova)
3164 Gold Camp Drive Ste. 200
Rancho Cordova CA, 95670

Project: ARCO 4931, Oakland, CA
Project Number: 4931, Oakland, CA
Project Manager: Steven Meeks

Reported:
05/01/02 13:13

**Total Purgeable Hydrocarbon, BTEX and MTBE by DHS LUFT
Sequoia Analytical - Sacramento**

Analyte	Result	Reporting Limit	Units	Dilution	Batch	Prepared	Analyzed	Method	Notes
A-8 (S204358-07) Water Sampled: 04/17/02 13:03 Received: 04/19/02 15:20									
Purgeable Hydrocarbons	3800	1000	ug/l	20	2040362	04/29/02	04/29/02	DHS LUFT	HC-12
Benzene	540	10	"	"	"	"	"	"	"
Toluene	ND	10	"	"	"	"	"	"	"
Ethylbenzene	ND	10	"	"	"	"	"	"	"
Xylenes (total)	12	10	"	"	"	"	"	"	"
Methyl tert-butyl ether	3100	50	"	"	"	"	"	"	"
<i>Surrogate: a,a,a-Trifluorotoluene</i>		98.4 %	60-140	"	"	"	"	"	"
A-9 (S204358-08) Water Sampled: 04/17/02 12:57 Received: 04/19/02 15:20									
Purgeable Hydrocarbons	ND	50	ug/l	1	2040344	04/26/02	04/26/02	DHS LUFT	
Benzene	ND	0.50	"	"	"	"	"	"	"
Toluene	ND	0.50	"	"	"	"	"	"	"
Ethylbenzene	ND	0.50	"	"	"	"	"	"	"
Xylenes (total)	ND	0.50	"	"	"	"	"	"	"
Methyl tert-butyl ether	ND	2.5	"	"	"	"	"	"	"
<i>Surrogate: a,a,a-Trifluorotoluene</i>		82.6 %	60-140	"	"	"	"	"	"
A-11 (S204358-09) Water Sampled: 04/17/02 12:50 Received: 04/19/02 15:20									
Purgeable Hydrocarbons	ND	50	ug/l	1	2040344	04/26/02	04/26/02	DHS LUFT	
Benzene	ND	0.50	"	"	"	"	"	"	"
Toluene	ND	0.50	"	"	"	"	"	"	"
Ethylbenzene	ND	0.50	"	"	"	"	"	"	"
Xylenes (total)	ND	0.50	"	"	"	"	"	"	"
Methyl tert-butyl ether	ND	2.5	"	"	"	"	"	"	"
<i>Surrogate: a,a,a-Trifluorotoluene</i>		77.3 %	60-140	"	"	"	"	"	"



Delta Environmental Consultants (Rancho Cordova)
3164 Gold Camp Drive Ste. 200
Rancho Cordova CA, 95670

Project: ARCO 4931, Oakland, CA
Project Number: 4931, Oakland, CA
Project Manager: Steven Meeks

Reported:
05/01/02 13:13

**Total Purgeable Hydrocarbon, BTEX and MTBE by DHS LUFT
Sequoia Analytical - Sacramento**

Analyte	Result	Reporting Limit	Units	Dilution	Batch	Prepared	Analyzed	Method	Notes
A-12 (S204358-10) Water Sampled: 04/17/02 12:45 Received: 04/19/02 15:20									
Purgeable Hydrocarbons	ND	50	ug/l	1	2040344	04/26/02	04/27/02	DHS LUFT	
Benzene	ND	0.50	"	"	"	"	"	"	
Toluene	ND	0.50	"	"	"	"	"	"	
Ethylbenzene	ND	0.50	"	"	"	"	"	"	
Xylenes (total)	ND	0.50	"	"	"	"	"	"	
Methyl tert-butyl ether	29	2.5	"	"	"	"	"	"	C-07
<i>Surrogate: a,a,a-Trifluorotoluene</i>		82.4 %	60-140		"	"	"	"	
A-13 (S204358-11) Water Sampled: 04/17/02 13:55 Received: 04/19/02 15:20									
Purgeable Hydrocarbons	ND	50	ug/l	1	2040344	04/26/02	04/27/02	DHS LUFT	
Benzene	ND	0.50	"	"	"	"	"	"	
Toluene	ND	0.50	"	"	"	"	"	"	
Ethylbenzene	ND	0.50	"	"	"	"	"	"	
Xylenes (total)	ND	0.50	"	"	"	"	"	"	
Methyl tert-butyl ether	ND	2.5	"	"	"	"	"	"	
<i>Surrogate: a,a,a-Trifluorotoluene</i>		82.3 %	60-140		"	"	"	"	
TB (S204358-12) Water Sampled: 04/17/02 06:00 Received: 04/19/02 15:20									
Purgeable Hydrocarbons	ND	50	ug/l	1	2040362	04/29/02	04/29/02	DHS LUFT	
Benzene	ND	0.50	"	"	"	"	"	"	
Toluene	1.7	0.50	"	"	"	"	"	"	
Ethylbenzene	ND	0.50	"	"	"	"	"	"	
Xylenes (total)	0.75	0.50	"	"	"	"	"	"	
Methyl tert-butyl ether	ND	2.5	"	"	"	"	"	"	
<i>Surrogate: a,a,a-Trifluorotoluene</i>		106 %	60-140		"	"	"	"	



Delta Environmental Consultants (Rancho Cordova)
3164 Gold Camp Drive Ste. 200
Rancho Cordova CA, 95670

Project: ARCO 4931, Oakland, CA
Project Number: 4931, Oakland, CA
Project Manager: Steven Meeks

Reported:
05/01/02 13:13

**Total Purgeable Hydrocarbon, BTEX and MTBE by DHS LUFT - Quality Control
Sequoia Analytical - Sacramento**

Analyte	Result	Reporting Limit	Units	Spike Level	Source Result	%REC	%REC Limits	RPD	RPD Limit	Notes
---------	--------	-----------------	-------	-------------	---------------	------	-------------	-----	-----------	-------

Batch 2040341 - EPA 5030B (P/T)

Blank (2040341-BLK1)

Prepared & Analyzed: 04/26/02

Purgeable Hydrocarbons	ND	50	ug/l							
Benzene	ND	0.50	"							
Toluene	ND	0.50	"							
Ethylbenzene	ND	0.50	"							
Xylenes (total)	ND	0.50	"							
Methyl tert-butyl ether	ND	2.5	"							
<i>Surrogate: a,a,a-Trifluorotoluene</i>	10.0		"	10.0		100	60-140			

LCS (2040341-BS1)

Prepared & Analyzed: 04/26/02

Benzene	10.9	0.50	ug/l	10.0		109	70-130			
Toluene	10.9	0.50	"	10.0		109	70-130			
Ethylbenzene	10.5	0.50	"	10.0		105	70-130			
Xylenes (total)	32.5	0.50	"	30.0		108	70-130			
Methyl tert-butyl ether	10.2	2.5	"	10.0		102	70-130			
<i>Surrogate: a,a,a-Trifluorotoluene</i>	10.6		"	10.0		106	60-140			

Matrix Spike (2040341-MS1)

Source: S204356-08

Prepared & Analyzed: 04/26/02

Benzene	10.6	0.50	ug/l	10.0	ND	106	60-140			
Toluene	10.5	0.50	"	10.0	ND	105	60-140			
Ethylbenzene	10.2	0.50	"	10.0	ND	102	60-140			
Xylenes (total)	31.3	0.50	"	30.0	ND	104	60-140			
Methyl tert-butyl ether	15.7	2.5	"	10.0	3.5	122	60-140			
<i>Surrogate: a,a,a-Trifluorotoluene</i>	10.2		"	10.0		102	60-140			

Matrix Spike Dup (2040341-MSD1)

Source: S204356-08

Prepared & Analyzed: 04/26/02

Benzene	11.0	0.50	ug/l	10.0	ND	110	60-140	3.70	25	
Toluene	10.8	0.50	"	10.0	ND	108	60-140	2.82	25	
Ethylbenzene	10.5	0.50	"	10.0	ND	105	60-140	2.90	25	
Xylenes (total)	32.1	0.50	"	30.0	ND	107	60-140	2.52	25	
Methyl tert-butyl ether	16.5	2.5	"	10.0	3.5	130	60-140	4.97	25	
<i>Surrogate: a,a,a-Trifluorotoluene</i>	10.1		"	10.0		101	60-140			



Delta Environmental Consultants (Rancho Cordova)
3164 Gold Camp Drive Ste. 200
Rancho Cordova CA, 95670

Project: ARCO 4931, Oakland, CA
Project Number: 4931, Oakland, CA
Project Manager: Steven Meeks

Reported:
05/01/02 13:13

Total Purgeable Hydrocarbon, BTEX and MTBE by DHS LUFT - Quality Control
Sequoia Analytical - Sacramento

Analyte	Result	Reporting Limit	Units	Spike Level	Source Result	%REC	%REC Limits	RPD	RPD Limit	Notes
---------	--------	-----------------	-------	-------------	---------------	------	-------------	-----	-----------	-------

Batch 2040344 - EPA 5030B (P/T)

Blank (2040344-BLK1)

Prepared & Analyzed: 04/26/02

Purgeable Hydrocarbons	ND	50	ug/l							
Benzene	ND	0.50	"							
Toluene	ND	0.50	"							
Ethylbenzene	ND	0.50	"							
Xylenes (total)	ND	0.50	"							
Methyl tert-butyl ether	ND	2.5	"							

Surrogate: a,a,a-Trifluorotoluene

10.3 " 10.0 103 60-140

LCS (2040344-BS1)

Prepared & Analyzed: 04/26/02

Benzene	11.2	0.50	ug/l	10.0		112	70-130			
Toluene	10.1	0.50	"	10.0		101	70-130			
Ethylbenzene	10.3	0.50	"	10.0		103	70-130			
Xylenes (total)	32.4	0.50	"	30.0		108	70-130			
Methyl tert-butyl ether	12.4	2.5	"	10.0		124	70-130			

Surrogate: a,a,a-Trifluorotoluene

11.2 " 10.0 112 60-140

Matrix Spike (2040344-MS1)

Source: S204354-05

Prepared & Analyzed: 04/26/02

Benzene	10.3	0.50	ug/l	10.0	ND	103	60-140			
Toluene	9.68	0.50	"	10.0	ND	96.8	60-140			
Ethylbenzene	10.1	0.50	"	10.0	ND	101	60-140			
Xylenes (total)	31.8	0.50	"	30.0	ND	106	60-140			
Methyl tert-butyl ether	10.3	2.5	"	10.0	ND	103	60-140			

Surrogate: a,a,a-Trifluorotoluene

10.2 " 10.0 102 60-140

Matrix Spike Dup (2040344-MSD1)

Source: S204354-05

Prepared & Analyzed: 04/26/02

Benzene	9.99	0.50	ug/l	10.0	ND	99.9	60-140	3.06	25	
Toluene	9.40	0.50	"	10.0	ND	94.0	60-140	2.94	25	
Ethylbenzene	9.75	0.50	"	10.0	ND	97.5	60-140	3.53	25	
Xylenes (total)	31.0	0.50	"	30.0	ND	103	60-140	2.55	25	
Methyl tert-butyl ether	14.7	2.5	"	10.0	ND	147	60-140	35.2	25	QM-07

Surrogate: a,a,a-Trifluorotoluene

10.6 " 10.0 106 60-140

Delta Environmental Consultants (Rancho Cordova)
 3164 Gold Camp Drive Ste. 200
 Rancho Cordova CA, 95670

 Project: ARCO 4931, Oakland, CA
 Project Number: 4931, Oakland, CA
 Project Manager: Steven Meeks

 Reported:
 05/01/02 13:13

**Total Purgeable Hydrocarbon, BTEX and MTBE by DHS LUFT - Quality Control
Sequoia Analytical - Sacramento**

Analyte	Result	Reporting Limit	Units	Spike Level	Source Result	%REC	%REC Limits	RPD	RPD Limit	Notes
---------	--------	-----------------	-------	-------------	---------------	------	-------------	-----	-----------	-------

Batch 2040362 - EPA 5030B (P/T)
Blank (2040362-BLK1)

Prepared & Analyzed: 04/29/02

Purgeable Hydrocarbons	ND	50	ug/l							
Benzene	ND	0.50	"							
Toluene	ND	0.50	"							
Ethylbenzene	ND	0.50	"							
Xylenes (total)	ND	0.50	"							
Methyl tert-butyl ether	ND	2.5	"							
<i>Surrogate: a,a,a-Trifluorotoluene</i>	9.89		"	10.0		98.9	60-140			

LCS (2040362-BS1)

Prepared & Analyzed: 04/29/02

Benzene	10.9	0.50	ug/l	10.0		109	70-130			
Toluene	10.8	0.50	"	10.0		108	70-130			
Ethylbenzene	10.6	0.50	"	10.0		106	70-130			
Xylenes (total)	32.3	0.50	"	30.0		108	70-130			
Methyl tert-butyl ether	12.3	2.5	"	10.0		123	70-130			
<i>Surrogate: a,a,a-Trifluorotoluene</i>	10.5		"	10.0		105	60-140			

Matrix Spike (2040362-MS1)

Source: S204366-03

Prepared & Analyzed: 04/29/02

Benzene	38.6	0.50	ug/l	10.0	29	96.0	60-140			
Toluene	12.6	0.50	"	10.0	1.1	115	60-140			
Ethylbenzene	49.1	0.50	"	10.0	43	61.0	60-140			
Xylenes (total)	99.2	0.50	"	30.0	62	124	60-140			
Methyl tert-butyl ether	965	2.5	"	10.0	1200	-2350	60-140			QM-07
<i>Surrogate: a,a,a-Trifluorotoluene</i>	11.0		"	10.0		110	60-140			

Matrix Spike Dup (2040362-MSD1)

Source: S204366-03

Prepared & Analyzed: 04/29/02

Benzene	39.9	0.50	ug/l	10.0	29	109	60-140	3.31	25	
Toluene	13.1	0.50	"	10.0	1.1	120	60-140	3.89	25	
Ethylbenzene	48.8	0.50	"	10.0	43	58.0	60-140	0.613	25	QM-07
Xylenes (total)	99.2	0.50	"	30.0	62	124	60-140	0.00	25	
Methyl tert-butyl ether	1100	2.5	"	10.0	1200	-1000	60-140	13.1	25	QM-07
<i>Surrogate: a,a,a-Trifluorotoluene</i>	10.5		"	10.0		105	60-140			

Delta Environmental Consultants (Rancho Cordova)
3164 Gold Camp Drive Ste. 200
Rancho Cordova CA, 95670

Project: ARCO 4931, Oakland, CA
Project Number: 4931, Oakland, CA
Project Manager: Steven Meeks

Reported:
05/01/02 13:13

Total Purgeable Hydrocarbon, BTEX and MTBE by DHS LUFT - Quality Control
Sequoia Analytical - Sacramento

Analyte	Result	Reporting Limit	Units	Spike Level	Source Result	%REC	%REC Limits	RPD	RPD Limit	Notes
---------	--------	-----------------	-------	-------------	---------------	------	-------------	-----	-----------	-------

Batch 2050003 - EPA 5030B (P/T)
Blank (2050003-BLK1)

Prepared & Analyzed: 04/30/02

Purgeable Hydrocarbons	ND	50	ug/l							
Benzene	ND	0.50	"							
Toluene	ND	0.50	"							
Ethylbenzene	ND	0.50	"							
Xylenes (total)	ND	0.50	"							
Methyl tert-butyl ether	ND	2.5	"							
<i>Surrogate: a,a,a-Trifluorotoluene</i>	<i>10.8</i>		<i>"</i>	<i>10.0</i>		<i>108</i>	<i>60-140</i>			

LCS (2050003-BS1)

Prepared & Analyzed: 04/30/02

Benzene	11.7	0.50	ug/l	10.0		117	70-130			
Toluene	10.8	0.50	"	10.0		108	70-130			
Ethylbenzene	11.2	0.50	"	10.0		112	70-130			
Xylenes (total)	32.3	0.50	"	30.0		108	70-130			
Methyl tert-butyl ether	11.8	2.5	"	10.0		118	70-130			
<i>Surrogate: a,a,a-Trifluorotoluene</i>	<i>11.8</i>		<i>"</i>	<i>10.0</i>		<i>118</i>	<i>60-140</i>			

Matrix Spike (2050003-MS1)

Source: S204377-10

Prepared & Analyzed: 04/30/02

Benzene	12.2	0.50	ug/l	10.0	1.2	110	60-140			
Toluene	10.3	0.50	"	10.0	ND	101	60-140			
Ethylbenzene	10.7	0.50	"	10.0	ND	107	60-140			
Xylenes (total)	30.9	0.50	"	30.0	ND	102	60-140			
Methyl tert-butyl ether	52.5	2.5	"	10.0	41	115	60-140			
<i>Surrogate: a,a,a-Trifluorotoluene</i>	<i>10.6</i>		<i>"</i>	<i>10.0</i>		<i>106</i>	<i>60-140</i>			

Matrix Spike Dup (2050003-MSD1)

Source: S204377-10

Prepared & Analyzed: 04/30/02

Benzene	13.1	0.50	ug/l	10.0	1.2	119	60-140	7.11	25	
Toluene	11.1	0.50	"	10.0	ND	109	60-140	7.48	25	
Ethylbenzene	11.5	0.50	"	10.0	ND	115	60-140	7.21	25	
Xylenes (total)	33.5	0.50	"	30.0	ND	110	60-140	8.07	25	
Methyl tert-butyl ether	53.2	2.5	"	10.0	41	122	60-140	1.32	25	
<i>Surrogate: a,a,a-Trifluorotoluene</i>	<i>10.5</i>		<i>"</i>	<i>10.0</i>		<i>105</i>	<i>60-140</i>			



Delta Environmental Consultants (Rancho Cordova)
3164 Gold Camp Drive Ste. 200
Rancho Cordova CA, 95670

Project: ARCO 4931, Oakland, CA
Project Number: 4931, Oakland, CA
Project Manager: Steven Meeks

Reported:
05/01/02 13:13

Notes and Definitions

- C-07 The reported compound(s) have been confirmed by a second (dissimilar) column or detector.
- HC-12 Hydrocarbon pattern is present in the requested fuel quantitation range but does not resemble the pattern of the requested fuel.
- QM-07 The spike recovery was outside control limits for the MS and/or MSD. The batch was accepted based on acceptable LCS recovery.
- DET Analyte DETECTED
- ND Analyte NOT DETECTED at or above the reporting limit
- NR Not Reported
- dry Sample results reported on a dry weight basis
- RPD Relative Percent Difference

ARCO Products Company 
Division of AtlanticRichfieldCompany

Task Order No.

Chain of Custody

ARCO Facility no. 4931	City (Facility) OAKLAND CA	Project manager (Consultant) STEVEN MEERS	Laboratory name
ARCO engineer Paul Supple	Telephone no. (ARCO)	Telephone no. (Consultant) 638 2085	Contract number
Consultant name Delta ENV	Address (Consultant)		
			Method of shipment

Sample I.D.	Lab no.	Container no.	Matrix			Preservation		Sampling date	Sampling time	BTEX 601EPA 9030	BITUMEN EPA 16310/201015	TPH Modified 8015 Gas <input type="checkbox"/> Direct <input type="checkbox"/>	Oil and Grease 413.1 <input type="checkbox"/> 413.2 <input type="checkbox"/>	TPH EPA 418.1/15ME03E	EPA 801/8010	EPA 824/8240	EPA 826/8270	TCAP Meas <input type="checkbox"/> VOA <input type="checkbox"/> VOA <input type="checkbox"/> Semi <input type="checkbox"/>	CAM Metals EPA 8010/7000 TLC <input type="checkbox"/> STLC <input type="checkbox"/>	Lead Crystals Lead EPA 7220/7251 <input type="checkbox"/>	Special detection Limit/reporting	
			Soil	Water	Other	Ice	Acid															
A-2		8		X		X	X	4-17-02	14:12		X											5204358-01
A-3									14:17													-02
A-4									13:35													-03
A-5									13:20													-04
A-6									13:27													-05
A-7									13:15													-06
A-8									13:03													-07
A-9									12:57													-08
A-11									12:50													-09
A-12									12:45													-10
A-13									13:55													-11
T 13									6:00													-12

Condition of sample:		Temperature received:		Priority Rush 1 Business Day <input type="checkbox"/>	
Relinquished by sampler	Date	Time	Received by	Rush 2 Business Days <input type="checkbox"/>	
<i>Paul Supple</i>	4-19-02		<i>Mexica Grogan</i>	4/19/02 1500	
Relinquished by	Date	Time	Received by	Expedited 5 Business Days <input type="checkbox"/>	
Relinquished by	Date	Time	Received by laboratory	Date	Time
				Standard 10 Business Days <input checked="" type="checkbox"/>	

SEQUOIA ANALYTICAL SAMPLE RECEIPT LOG

CLIENT NAME: Delta Env.
 REC. BY (PRINT) Monica
 WORKORDER: S204358

DATE Received at Lab: 4/17/02
 TIME Received at Lab: 1530
 LOG IN DATE: 4/22/02

(Drinking water) for regulatory purposes: YES/NO NO
 (Wastewater) for regulatory purposes: YES/NO NO

CIRCLE THE APPROPRIATE RESPONSE		LAB SAMPLE #	#	CLIENT ID	DESCRIPTION	SAMPLE MATRIX	DATE SAMPLED	CONDITION (ETC.)
1. Custody Seal(s)	Present / Absent Intact / Broken*	S204358	01	A-2	WOB	W	4/17/02	
2. Chain-of-Custody	Present / Absent*		02	-3				
3. Traffic Reports or Packing List:	Present / Absent		03	-4				
4. Airbill:	Airbill / Sticker Present / Absent		04	-5				
5. Airbill #:			05	-6				
6. Sample Labels:	Present / Absent		06	-7				
7. Sample IDs:	Listed / Not Listed on Chain-of-Custody		07	-8				
8. Sample Condition:	Intact / Broken* / leaking*		08	-9				
			09	-10				
			10	-11				
			11	-12				
			12	-13				
9. Does information on custody reports, traffic reports and sample labels agree?	Yes / No*							
10. Sample received within hold time:	Yes / No*							
11. Proper Preservatives used:	Yes / No*							
12. Temp Rec. at Lab:								
(Acceptance range for samples requiring thermal pres. +/-2°C)	Yes / No*							

***If Circled, contact Project Manager and attach record of resolution.**

ATTACHMENT C
HISTORIC GROUNDWATER DATA

Table 1
Groundwater Elevation and Analytical Data
Total Purgeable Petroleum Hydrocarbons
(TPPH as Gasoline, BTEX Compounds, and MTBE)

ARCO Service Station 4931
731 West MacArthur Boulevard, Oakland, California

Well Number	Date Gauged/ Sampled	Well Elevation (feet, MSL)	Depth to Water (feet, TOB)	Groundwater Elevation (feet, MSL)	TPH Gasoline (ppb)	Benzene (ppb)	Toluene (ppb)	Ethyl- benzene (ppb)	Total Xylenes (ppb)	MTBE 8021B* (ppb)	MTBE 8260 (ppb)	Dissolved Oxygen (ppm)	Purged/ Not Purged (P/NP)
A-2	03/26/96	55.48	5.37	50.11	<50	<0.5	<0.5	<0.5	<0.5	NA	NA	NM	
A-2	05/22/96	55.48	5.25	50.23	<50	<0.5	<0.5	<0.5	<0.5	NA	NA	NM	
A-2	08/22/96	55.48	10.45	45.03	<50	1.1	1.8	<0.5	1.3	<2.5	NA	NM	
A-2	12/19/96	55.48	5.53	49.95	<50	<0.5	<0.5	<0.5	<0.5	2.7	NA	NM	
A-2	04/01/97	55.48	8.77	46.71	<50	<0.5	<0.5	<0.5	<0.5	<2.5	NA	NM	
A-2	05/27/97	55.48	9.87	45.61	<50	<0.5	<0.5	<0.5	<0.5	4.6	NA	NM	
A-2	08/12/97	55.48	11.11	44.37	<50	<0.5	<0.5	<0.5	<0.5	5.6	NA	NM	
A-2	11/14/97	55.48	10.63	44.85	<50	0.9	2.8	<0.5	2.4	27	NA	2.6	
A-2	03/18/98	55.48	3.58	51.90	<50	<0.5	<0.5	<0.5	<0.5	<3	NA	NM	
A-2	05/19/98	55.48	4.82	50.66	<50	<0.5	<0.5	<0.5	<0.5	<3	NA	1.30	P
A-2	07/29/98	55.48	8.94	46.54	<50	<0.5	<0.5	<0.5	<0.5	<3	NA	1.2	NP
A-2	10/09/98	55.48	10.82	44.66	<50	<0.5	<0.5	<0.5	<0.5	<3	NA	0.5	NP
A-2	02/19/99	55.48	4.46	51.02	<50	<0.5	<0.5	<0.5	<0.5	<3	NA	3.0	P
A-2	06/02/99	55.48	5.59	49.89	<50	<0.5	0.6	<0.5	<0.5	<3	NA	5.35	NP
A-2	08/26/99	55.48	10.67	44.81	<50	<0.5	<0.5	<0.5	<0.5	<3	NA	0.79	NP
A-2	10/26/99	55.48	4.61	50.87	<50	<0.5	<0.5	<0.5	<1	<3	NA	2.14	P
A-2	02/25/00	55.48	3.10	52.38	<50	<0.5	<0.5	<0.5	<1	<3	NA	4.21	NP
A-3	03/26/96	54.66	7.20	47.46	Not Sampled: Well Sampled Semiannually								
A-3	05/22/96	54.66	7.70	46.96	<50	1.2	1.9	0.7	1.3	NA	NA	NM	
A-3	08/22/96	54.66	10.88	43.78	Not Sampled: Well Sampled Semiannually								
A-3	12/19/96	54.66	7.70	46.96	5,900	<25	<25	<25	<25	NA	5,300	NM	
A-3	04/01/97	54.66	9.78	44.88	Not Sampled: Well Sampled Semiannually								
A-3	05/27/97	54.66	10.55	44.11	2,300	<20	<20	<20	<20	3,800	NA	NM	
A-3	08/12/97	54.66	11.12	43.54	Not Sampled: Well Sampled Semiannually								
A-3	11/14/97	54.66	8.24	46.42	<1,000	<10	<10	<10	<10	1,500	NA	3.8	
A-3	03/18/98	54.66	5.05	49.61	Not Sampled: Well Sampled Semiannually								
A-3	05/19/98	54.66	9.00	45.66	<250	<2.5	<2.5	<2.5	<2.5	220	NA	4.60	P
A-3	07/29/98	54.66	9.86	44.80	Not Sampled: Well Sampled Semiannually								
A-3	10/09/98	54.66	11.36	43.30	<250	<2.5	<2.5	<2.5	<2.5	260	NA	1.0	NP
A-3	02/19/99	54.66	6.19	48.47	<50	<0.5	<0.5	<0.5	<0.5	<3	NA	2.5	NP
A-3	06/02/99	54.66	10.82	43.84	120	<1	<1	<1	<1	160	NA	2.78	NP

Table 1
Groundwater Elevation and Analytical Data
Total Purgeable Petroleum Hydrocarbons
(TPPH as Gasoline, BTEX Compounds, and MTBE)

ARCO Service Station 4931
731 West MacArthur Boulevard, Oakland, California

Well Number	Date Gauged/ Sampled	Well Elevation (feet, MSL)	Depth to Water (feet, TOB)	Groundwater Elevation (feet, MSL)	TPH Gasoline (ppb)	Benzene (ppb)	Toluene (ppb)	Ethyl- benzene (ppb)	Total Xylenes (ppb)	MTBE 8021B* (ppb)	MTBE 8260 (ppb)	Dissolved Oxygen (ppm)	Purged/ Not Purged (P/NP)
A-3	08/26/99	54.66	10.73	43.93	Not Sampled: Well Sampled Semiannually							0.95	
A-3	10/26/99	54.66	6.58	48.08	<50	<0.5	<0.5	<0.5	<1	32	NA	2.06	NP
A-3	02/25/00	54.66	5.41	49.25	Not Sampled: Well Sampled Semiannually								
A-4	03/26/96	54.73	7.95	46.78	8,900	1,200	21	200	220	NA	NA	NM	
A-4	05/22/96	54.73	8.35	46.38	5,300	700	<10	170	130	NA	NA	NM	
A-4	08/22/96	54.73	11.03	43.70	3,000	480	<5.0	75	26	150	NA	NM	
A-4	12/19/96	54.73	8.67	46.06	<2,000	<20	<20	<20	<20	NA	15,000	NM	
A-4	04/01/97	54.73	11.95	42.78	8,900	1,700	22	310	260	6,900	NA	NM	
A-4	05/27/97	54.73	10.80	43.93	7,100	960	<20	150	74	7,900	NA	NM	
A-4	08/12/97	54.73	11.38	43.35	4,300	670	12	51	27	2,800	NA	NM	
A-4	11/14/97	54.73	7.74	46.99	<20,000	300	500	<200	<200	27,000	NA	2.2	
A-4	03/18/98	54.73	6.80	47.93	4,700	600	<20	99	94	1,200	NA	1.0	
A-4	05/19/98	54.73	9.06	45.67	<2000	<20	<20	<20	720	2,000	NA	1.28	P
A-4	07/29/98	54.73	10.05	44.68	8,400	1,300	<20	290	130	1,800	NA	0.7	NP
A-4	10/09/98	54.73	11.20	43.53	3,500	400	<20	54	<20	1,700	NA	1.0	NP
A-4	02/19/99	54.73	6.85	47.88	<1,000	<10	<10	<10	12	650	NA	0.1	NP
A-4	06/02/99	54.73	11.00	43.73	6,100	760	16	260	89	2,300	NA	1.12	NP
A-4	08/26/99	54.73	10.80	43.93	1,100	68	5	8	4	1,400	NA	1.15	NP
A-4	10/26/99	54.73	10.11	44.62	1,500	39	2.3	9.0	5	1,700	NA	10.12	NP
A-4	02/25/00	54.73	5.90	48.83	870	53	1.1	4.6	20	600	NA	1.72	NP
A-5	03/26/96	54.17	7.93	46.24	Not Sampled: Well Sampled Semiannually								
A-5	05/22/96	54.17	8.20	45.97	<50	<0.5	<0.5	<0.5	<0.5	NA	NA	NM	
A-5	08/22/96	54.17	10.70	43.47	Not Sampled: Well Sampled Semiannually								
A-5	12/19/96	54.17	8.39	45.78	9,900	1,100	330	230	700	NA	24	NM	
A-5	04/01/97	54.17	10.83	43.34	Not Sampled: Well Sampled Semiannually								
A-5	05/27/97	54.17	10.65	43.52	100	<0.5	<0.5	<0.5	<0.5	120	NA	NM	
A-5	08/12/97	54.17	11.05	43.12	Not Sampled: Well Sampled Semiannually								
A-5	11/14/97	54.17	10.51	43.66	<50	<0.5	<0.5	<0.5	<0.5	41	NA	4.8	
A-5	03/18/98	54.17	8.10	46.07	Not Sampled: Well Sampled Semiannually								
A-5	05/19/98	54.17	9.31	44.86	590	<5	<5	<5	<5	710	NA	2.48	P

Table 1
Groundwater Elevation and Analytical Data
Total Purgeable Petroleum Hydrocarbons
(TPPH as Gasoline, BTEX Compounds, and MTBE)

ARCO Service Station 4931
731 West MacArthur Boulevard, Oakland, California

Well Number	Date Gauged/ Sampled	Well Elevation (feet, MSL)	Depth to Water (feet, TOB)	Groundwater Elevation (feet, MSL)	TPH Gasoline (ppb)	Benzene (ppb)	Toluene (ppb)	Ethyl- benzene (ppb)	Total Xylenes (ppb)	MTBE 8021B* (ppb)	MTBE 8260 (ppb)	Dissolved Oxygen (ppm)	Purged/ Not Purged (P/NP)	
A-5	07/29/98	54.17	9.89	44.28	Not Sampled: Well Sampled Semiannually									
A-5	10/09/98	54.17	11.02	43.15	690	<5	<5	<5	<5	710	NA	1.0	NP	
A-5	02/19/99	54.17	6.82	47.35	<2,000	<20	<20	<20	<20	2,300	NA	0.6	NP	
A-5	06/02/99	54.17	10.82	43.35	1,500	<0.5	2.3	<0.5	<0.5	2,400	NA	2.81	NP	
A-5	08/26/99	54.17	10.65	43.52	Not Sampled: Well Sampled Semiannually								0.49	
A-5	10/26/99	54.17	10.35	43.82	380	<0.5	<0.5	<0.5	<1	440	NA	1.55	NP	
A-5	02/25/00	54.17	6.89	47.28	Not Sampled: Well Sampled Semiannually									
A-6	03/26/96	55.17	7.15	48.02	52	2.7	<0.5	1.1	2.0	NA	NA	NM		
A-6	05/22/96	55.17	7.35	47.82	<50	2.4	<0.5	0.88	1.7	NA	NA	NM		
A-6	08/22/96	55.17	10.12	45.05	<50	<0.5	<0.5	<0.5	<0.5	<2.5	NA	NM		
A-6	12/19/96	55.17	7.43	47.74	<50	1.7	<0.5	0.78	1.5	<2.5	NA	NM		
A-6	04/01/97	55.17	9.97	45.20	<50	4.7	<0.5	1.9	3.2	<2.5	NA	NM		
A-6	05/27/97	55.17	9.66	45.51	<50	0.69	<0.5	<0.5	<0.5	<2.5	NA	NM		
A-6	08/12/97	55.17	10.43	44.74	<50	<0.5	<0.5	<0.5	<0.5	<2.5	NA	NM		
A-6	11/14/97	55.17	9.76	45.41	<50	<0.5	<0.5	<0.5	<0.5	<3	NA	<1.0		
A-6	03/18/98	55.17	7.00	48.17	<50	6.2	0.5	2.3	2.6	<3	NA	3.0		
A-6	05/19/98	55.17	8.27	46.90	<50	<0.5	<0.5	1.3	4.7	<3	NA	2.16	P	
A-6	07/29/98	55.17	8.96	46.21	<50	<0.5	<0.5	<0.5	<0.5	<3	NA	0.8	NP	
A-6	10/09/98	55.17	10.23	44.94	<50	<0.5	<0.5	<0.5	<0.5	<3	NA	1.0	NP	
A-6	02/19/99	55.17	5.79	49.38	<50	<0.5	<0.5	<0.5	<0.5	5	NA	0.4	NP	
A-6	06/02/99	55.17	9.71	45.46	<50	<0.5	<0.5	<0.5	<0.5	<3	NA	2.00	NP	
A-6	08/26/99	55.17	9.79	45.38	<50	<0.5	<0.5	<0.5	0.7	<3	NA	0.66	NP	
A-6	10/26/99	55.17	9.70	45.47	<50	<0.5	<0.5	<0.5	<1	<3	NA	1.66	NP	
A-6	02/25/00	55.17	5.68	49.49	<50	<0.5	<0.5	<0.5	<1	<3	NA	1.22	NP	
A-7	03/26/96	54.71	6.90	47.81	Not Sampled: Well Sampled Semiannually									
A-7	05/22/96	54.71	8.27	46.44	<50	<0.5	<0.5	<0.5	<0.5	NA	NA	NM		
A-7	08/22/96	54.71	9.80	44.91	Not Sampled: Well Sampled Semiannually									
A-7	12/19/96	54.71	7.19	47.52	Not Sampled: Well Sampled Annually									
A-7	04/01/97	54.71	9.63	45.08	Not Sampled: Well Sampled Annually									
A-7	05/27/97	54.71	9.34	45.37	<50	<0.5	<0.5	<0.5	<0.5	<2.5	NA	NM		

Table 1
Groundwater Elevation and Analytical Data
Total Purgeable Petroleum Hydrocarbons
(TPPH as Gasoline, BTEX Compounds, and MTBE)

ARCO Service Station 4931
731 West MacArthur Boulevard, Oakland, California

Well Number	Date Gauged/ Sampled	Well Elevation (feet, MSL)	Depth to Water (feet, TOB)	Groundwater Elevation (feet, MSL)	TPH				Total Xylenes (ppb)	MTBE 8021B* (ppb)	MTBE 8260 (ppb)	Dissolved Oxygen (ppm)	Purged/ Not Purged (P/NP)
					Gasoline (ppb)	Benzene (ppb)	Toluene (ppb)	Ethyl- benzene (ppb)					
A-7	08/12/97	54.71	10.10	44.61	Not Sampled: Well Sampled Annually								
A-7	11/14/97	54.71	9.35	45.36	Not Sampled: Well Sampled Annually								
A-7	03/18/98	54.71	6.75	47.96	Not Sampled: Well Sampled Annually								
A-7	05/19/98	54.71	8.85	45.86	<50	<0.5	<0.5	<0.5	<0.5	<3	NA	1.82	P
A-7	07/29/98	54.71	8.84	45.87	Not Sampled: Well Sampled Annually								
A-7	10/09/98	54.71	10.05	44.66	Not Sampled: Well Sampled Annually								
A-7	02/19/99	54.71	5.57	49.14	<50	<0.5	<0.5	<0.5	<0.5	<3	NA	4.7	NP
A-7	06/02/99	54.71	9.56	45.15	<50	<0.5	<0.5	<0.5	<0.5	<3	NA	2.17	NP
A-7	08/26/99	54.71	9.66	45.05	Not Sampled: Well Sampled Annually								0.49
A-7	10/26/99	54.71	9.54	45.17	Not Sampled: Well Sampled Annually								1.26
A-7	02/25/00	54.71	5.60	49.11	Not Sampled: Well Sampled Annually								
A-8	03/26/96	53.77	7.10	46.67	48,000	2,600	<100	650	1,100	NA	NA	NM	
A-8	05/22/96	53.77	7.20	46.57	14,000	2,800	160	320	190	NA	NA	NM	
A-8	08/22/96	53.77	11.57	42.20	8,000	1,000	76	150	96	4,300	NA	NM	
A-8	12/19/96	53.77	8.04	45.73	12,000	450	110	210	230	<500	NA	NM	
A-8	04/01/97	53.77	9.98	43.79	Not Sampled: Well Sampled Semiannually								
A-8	05/27/97	53.77	11.45	42.32	11,000	1,600	100	220	210	2,300	NA	NM	
A-8	08/12/97	53.77	11.59	42.18	Not Sampled: Well Sampled Semiannually								
A-8	11/14/97	53.77	9.85	43.92	26,000	2,300	<200	400	400	4,100	NA	2.2	
A-8	03/18/98	53.77	7.80	45.97	Not Sampled: Well Sampled Semiannually								
A-8	05/19/98	53.77	8.78	44.99	88,000	4,200	150	640	600	6,700	NA	1.36	P
A-8	07/29/98	53.77	9.59	44.18	46,000	4,900	160	620	580	13,000	NA	0.5	NP
A-8	10/09/98	53.77	11.23	42.54	130,000	3,700	110	500	770	7,300	NA	1.0	NP
A-8	02/19/99	53.77	6.51	47.26	<1,000	39	<10	<10	<10	840	NA	0.2	NP
A-8	06/02/99	53.77	10.68	43.09	8,500	1,300	32	180	110	6,700	NA	1.31	NP
A-8	08/26/99	53.77	10.43	43.34	6,200	870	17	64	60	3,700	NA	0.69	NP
A-8	10/26/99	53.77	10.23	43.54	15,000	2,800	140	370	360	480	NA	0.62	NP
A-8	02/25/00	53.77	5.93	47.84	2,600	330	6.6	18	26	1,100	NA	1.43	NP
A-9	03/26/96	53.04	7.05	45.99	<50	<0.5	<0.5	<0.5	<0.5	NA	NA	NM	
A-9	05/22/96	53.04	7.20	45.84	<50	<0.5	<0.5	<0.5	<0.5	NA	NA	NM	

Table 1
Groundwater Elevation and Analytical Data
Total Purgeable Petroleum Hydrocarbons
(TPPH as Gasoline, BTEX Compounds, and MTBE)

ARCO Service Station 4931
731 West MacArthur Boulevard, Oakland, California

Well Number	Date Gauged/ Sampled	Well Elevation (feet, MSL)	Depth to Water (feet, TOB)	Groundwater Elevation (feet, MSL)	TPH Gasoline (ppb)	Benzene (ppb)	Toluene (ppb)	Ethyl- benzene (ppb)	Total Xylenes (ppb)	MTBE 8021B* (ppb)	MTBE 8260 (ppb)	Dissolved Oxygen (ppm)	Purged/ Not Purged (P/NP)	
A-9	08/22/96	53.04	9.68	43.36	<50	<0.5	<0.5	<0.5	<0.5	8.5	NA	NM		
A-9	12/19/96	53.04	7.43	45.61	<50	<0.5	<0.5	<0.5	<0.5	2.6	NA	NM		
A-9	04/01/97	53.04	9.95	43.09	Not Sampled: Well Sampled Semiannually									
A-9	05/27/97	53.04	9.56	43.48	<50	2.3	<0.5	<0.5	<0.5	45	NA	NM		
A-9	08/12/97	53.04	10.15	42.89	Not Sampled: Well Sampled Semiannually									
A-9	11/14/97	53.04	8.64	44.40	<200	<2.0	<2.0	<2.0	<2.0	190	NA	9.6		
A-9	03/18/98	53.04	6.45	46.59	Not Sampled: Well Sampled Semiannually									
A-9	05/19/98	53.04	8.35	44.69	<50	<0.5	<0.5	<0.5	<0.5	7	NA	1.27	P	
A-9	07/29/98	53.04	8.74	44.30	<50	<0.5	<0.5	<0.5	<0.5	<3	NA	0.99	NP	
A-9	10/09/98	53.04	10.05	42.99	<50	<0.5	<0.5	<0.5	<0.5	<3	NA	1.0	NP	
A-9	02/19/99	53.04	6.91	46.13	<50	<0.5	<0.5	<0.5	<0.5	<3	NA	2.0	NP	
A-9	06/02/99	53.04	9.72	43.32	<50	<0.5	<0.5	<0.5	<0.5	16	NA	2.32	NP	
A-9	08/26/99	53.04	9.48	43.56	<50	<0.5	<0.5	<0.5	<0.5	<3	NA	0.71	NP	
A-9	10/26/99	53.04	9.17	43.87	1,500	6.2	0.7	78	11	91	NA	2.15	NP	
A-9	02/25/00	53.04	5.84	47.20	<50	<0.5	<0.5	<0.5	<1	<3	NA	1.55	NP	
A-10	03/26/96	54.26	8.28	45.98	Not Sampled: Well Removed from Sampling Program									
A-10	05/22/96	54.26	8.60	45.66	Not Sampled: Well Removed from Sampling Program									
A-10	08/22/96	54.26	10.98	43.28	Not Sampled: Well Removed from Sampling Program									
A-10	12/19/96	54.26	8.80	45.46	Not Sampled: Well Removed from Sampling Program									
A-10	04/01/97	54.26	11.15	43.11	Not Sampled: Well Removed from Sampling Program									
A-10	05/27/97	54.26	10.90	43.36	Not Sampled: Well Removed from Sampling Program									
A-10	08/12/97	54.26	11.30	42.96	Not Sampled: Well Removed from Sampling Program									
A-10	11/14/97	54.26	10.80	43.46	Not Sampled: Well Removed from Sampling Program									
A-10	03/18/98				----- Well Removed from Survey Program -----									
A-11	03/26/96	53.74	8.10	45.64	Not Sampled: Well Sampled Semiannually									
A-11	05/22/96	53.74	8.25	45.49	<50	<0.5	<0.5	<0.5	<0.5	NA	NA	NM		
A-11	08/22/96	53.74	10.58	43.16	Not Sampled: Well Sampled Semiannually									
A-11	12/19/96	53.74	8.37	45.37	<50	<0.5	<0.5	<0.5	<0.5	<2.5	NA	NM		
A-11	04/01/97	53.74	10.95	42.79	Not Sampled: Well Sampled Semiannually									
A-11	05/27/97	53.74	10.60	43.14	<50	<0.5	<0.5	<0.5	<0.5	3.1	NA	NM		

Table 1
Groundwater Elevation and Analytical Data
Total Purgeable Petroleum Hydrocarbons
(TPPH as Gasoline, BTEX Compounds, and MTBE)

ARCO Service Station 4931
731 West MacArthur Boulevard, Oakland, California

Well Number	Date Gauged/ Sampled	Well Elevation (feet, MSL)	Depth to Water (feet, TOB)	Groundwater Elevation (feet, MSL)	TPH				Total Xylenes (ppb)	MTBE 8021B* (ppb)	MTBE 8260 (ppb)	Dissolved Oxygen (ppm)	Purged/ Not Purged (P/NP)
					Gasoline (ppb)	Benzene (ppb)	Toluene (ppb)	Ethyl- benzene (ppb)					
A-11	08/12/97	53.74	11.07	42.67	Not Sampled: Well Sampled Semiannually								
A-11	11/14/97	53.74	10.58	43.16	<50	<0.5	<0.5	<0.5	<0.5	<3	NA	1.6	
A-11	03/18/98	53.74	8.14	45.60	Not Sampled: Well Sampled Semiannually								
A-11	05/19/98	53.74	9.40	44.34	<50	<0.5	<0.5	<0.5	<0.5	<3	NA	1.13	P
A-11	07/29/98	53.74	10.32	43.42	Not Sampled: Well Sampled Semiannually								
A-11	10/09/98	53.74	10.91	42.83	<50	<0.5	<0.5	<0.5	<0.5	<3	NA	2.0	NP
A-11	02/19/99	53.74	6.77	46.97	<50	<0.5	<0.5	<0.5	<0.5	<3	NA	1.8	NP
A-11	06/02/99	53.74	10.95	42.79	<50	<0.5	<0.5	<0.5	<0.5	6	NA	1.38	NP
A-11	08/26/99	53.74	11.05	42.69	Not Sampled: Well Sampled Semiannually							0.49	
A-11	10/26/99	53.74	10.81	42.93	<50	<0.5	<0.5	<0.5	<1	4	NA	1.27	NP
A-11	02/25/00	53.74	6.70	47.04	Not Sampled: Well Sampled Semiannually								
A-12	03/26/96	52.05	7.83	44.22	Not Sampled: Well Sampled Semiannually								
A-12	05/22/96	52.05	7.80	44.25	<50	<0.5	<0.5	<0.5	<0.5	NA	NA	NM	
A-12	08/22/96	52.05	9.97	42.08	Not Sampled: Well Sampled Semiannually								
A-12	12/19/96	52.05	8.18	43.87	85	<0.5	<0.5	<0.5	<0.5	170	NA	NM	
A-12	04/01/97	52.05	10.30	41.75	Not Sampled: Well Sampled Semiannually								
A-12	05/27/97	52.05	10.05	42.00	50	12	<0.5	<0.5	<0.5	96	NA	NM	
A-12	08/12/97	52.05	10.46	41.59	Not Sampled: Well Sampled Semiannually								
A-12	11/14/97	52.05	9.70	42.35	<50	<0.5	<0.5	<0.5	<0.5	75	NA	7.0	
A-12	03/18/98	52.05	8.15	43.90	Not Sampled: Well Sampled Semiannually								
A-12	05/19/98	52.05	9.15	42.90	<50	<0.5	<0.5	<0.5	<0.5	29	NA	1.47	P
A-12	07/29/98	52.05	9.38	42.67	Not Sampled: Well Sampled Semiannually								
A-12	10/09/98	52.05	10.21	41.84	<50	<0.5	<0.5	<0.5	<0.5	7	NA	2.0	NP
A-12	02/19/99	52.05	6.96	45.09	<50	<0.5	<0.5	<0.5	<0.5	<3	NA	5.2	NP
A-12	06/02/99	52.05	10.25	41.80	<50	<0.5	<0.5	<0.5	<0.5	7	NA	1.38	NP
A-12	08/26/99	52.05	9.91	42.14	Not Sampled: Well Sampled Semiannually							0.51	
A-12	10/26/99	52.05	9.73	42.32	<50	<0.5	<0.5	<0.5	<1	12	NA	1.09	NP
A-12	02/25/00	52.05	6.97	45.08	Not Sampled: Well Sampled Semiannually								
A-13	03/26/96	55.11			----- Well Inaccessible -----								
A-13	05/22/96	55.11			----- Well Inaccessible -----								

Table 1
Groundwater Elevation and Analytical Data
Total Purgeable Petroleum Hydrocarbons
(TPPH as Gasoline, BTEX Compounds, and MTBE)

ARCO Service Station 4931
731 West MacArthur Boulevard, Oakland, California

Well Number	Date Gauged/ Sampled	Well Elevation (feet, MSL)	Depth to Water (feet, TOB)	Groundwater Elevation (feet, MSL)	TPH Gasoline (ppb)	Benzene (ppb)	Toluene (ppb)	Ethyl- benzene (ppb)	Total Xylenes (ppb)	MTBE 8021B* (ppb)	MTBE 8260 (ppb)	Dissolved Oxygen (ppm)	Purged/ Not Purged (P/NP)
A-13	08/22/96	55.11		-----	-----	-----	-----	-----	-----	-----	-----	-----	-----
A-13	12/19/96	55.11		-----	-----	-----	-----	-----	-----	-----	-----	-----	-----
A-13	04/01/97	55.11		-----	-----	-----	-----	-----	-----	-----	-----	-----	-----
A-13	05/27/97	55.11		-----	-----	-----	-----	-----	-----	-----	-----	-----	-----
A-13	08/12/97	55.11		-----	-----	-----	-----	-----	-----	-----	-----	-----	-----
A-13	11/14/97	55.11		-----	-----	-----	-----	-----	-----	-----	-----	-----	-----
A-13	03/18/98	55.11		-----	-----	-----	-----	-----	-----	-----	-----	-----	-----
A-13	05/19/98	55.11		-----	-----	-----	-----	-----	-----	-----	-----	-----	-----
A-13	07/29/98	55.11		-----	-----	-----	-----	-----	-----	-----	-----	-----	-----
A-13	10/09/98	55.11		-----	-----	-----	-----	-----	-----	-----	-----	-----	-----
A-13	02/19/99	55.11		-----	-----	-----	-----	-----	-----	-----	-----	-----	-----
A-13	06/02/99	55.11		-----	-----	-----	-----	-----	-----	-----	-----	-----	-----
A-13	08/26/99	55.11		-----	-----	-----	-----	-----	-----	-----	-----	-----	-----
A-13	10/26/99	55.11		-----	-----	-----	-----	-----	-----	-----	-----	-----	-----
A-13	02/25/00	55.11		-----	-----	-----	-----	-----	-----	-----	-----	-----	-----
AR-1	03/26/96	54.72	8.13	46.59	6,200	110	64	38	520	NA	NA		NM
AR-1	05/22/96	54.72	8.57	46.15	NS	NS	NS	NS	NS	NS	NS		NM
AR-1	08/22/96	54.72	10.97	43.75	5,600	100	28	29	310	960	NA		NM
AR-1	12/19/96	54.72	8.93	45.79	Not Sampled: Well Removed from Sampling Program								
AR-1	04/01/97	54.72	11.78	42.94	Not Sampled: Well Removed from Sampling Program								
AR-1	05/27/97	54.72	10.76	43.96	Not Sampled: Well Removed from Sampling Program								
AR-1	08/12/97	54.72	11.40	43.32	Not Sampled: Well Removed from Sampling Program								
AR-1	11/14/97	54.72	10.80	43.92	Not Sampled: Well Removed from Sampling Program								
AR-1	03/18/98	54.72	NM	NM	Not Sampled: Well Removed from Sampling Program								
AR-1	05/19/98	54.72	NM	NM	Not Sampled: Well Removed from Sampling Program								
AR-1	07/29/98	54.72	10.17	44.55	Not Sampled: Well Removed from Sampling Program								
AR-1	10/09/98	54.72	11.25	43.47	Not Sampled: Well Removed from Sampling Program								
AR-1	02/19/99	54.72	7.02	47.70	Not Sampled: Well Removed from Sampling Program								
AR-1	06/02/99	54.72	11.00	43.72	Not Sampled: Well Removed from Sampling Program								
AR-1	08/26/99	54.72	10.96	43.76	Not Sampled: Well Removed from Sampling Program								0.39
AR-1	10/26/99	54.72	10.68	44.04	Not Sampled: Well Removed from Sampling Program								1.39

Table 1
Groundwater Elevation and Analytical Data
Total Purgeable Petroleum Hydrocarbons
(TPPH as Gasoline, BTEX Compounds, and MTBE)

ARCO Service Station 4931
731 West MacArthur Boulevard, Oakland, California

Well Number	Date Gauged/ Sampled	Well Elevation (feet, MSL)	Depth to Water (feet, TOB)	Groundwater Elevation (feet, MSL)	TPH Gasoline (ppb)	Benzene (ppb)	Toluene (ppb)	Ethyl- benzene (ppb)	Total Xylenes (ppb)	MTBE 8021B* (ppb)	MTBE 8260 (ppb)	Dissolved Oxygen (ppm)	Purged/ Not Purged (P/NP)
AR-1	02/25/00	54.72	7.15	47.57	Not Sampled: Well Removed from Sampling Program								
AR-2	03/26/96	54.77	4.93	49.84	<50	<0.5	<0.5	<0.5	<0.5	NA	NA	NM	
AR-2	05/22/96	54.77	5.65	49.12	NS	NS	NS	NS	NS	NS	NS	NM	
AR-2	08/22/96	54.77	7.27	47.50	<50	<0.5	<0.5	<0.5	<0.5	200	NA	NM	
AR-2	12/19/96	54.77	7.78	46.99	Not Sampled: Well Removed from Sampling Program								
AR-2	04/01/97	54.77	6.80	47.97	Not Sampled: Well Removed from Sampling Program								
AR-2	05/27/97	54.77	6.32	48.45	Not Sampled: Well Removed from Sampling Program								
AR-2	08/12/97	54.77	7.43	47.34	Not Sampled: Well Removed from Sampling Program								
AR-2	11/14/97	54.77	8.95	45.82	Not Sampled: Well Removed from Sampling Program								
AR-2	03/18/98	54.77	NM	NM	Not Sampled: Well Removed from Sampling Program								
AR-2	05/19/98	54.77	NM	NM	Not Sampled: Well Removed from Sampling Program								
AR-2	07/29/98	54.77	4.47	50.30	Not Sampled: Well Removed from Sampling Program								
AR-2	10/09/98	54.77	6.90	47.87	Not Sampled: Well Removed from Sampling Program								
AR-2	02/19/99	54.77	3.80	50.97	Not Sampled: Well Removed from Sampling Program								
AR-2	06/02/99	54.77	4.61	50.16	Not Sampled: Well Removed from Sampling Program								
AR-2	08/26/99	54.77	5.22	49.55	Not Sampled: Well Removed from Sampling Program								
AR-2	10/26/99	54.77	3.20	51.57	Not Sampled: Well Removed from Sampling Program								
AR-2	02/25/00	54.77	2.33	52.44	Not Sampled: Well Removed from Sampling Program								
AR-3	03/26/96	54.19	7.95	46.24	<50	<0.5	<0.5	<0.5	<0.5	NA	NA	NM	
AR-3	05/22/96	54.19	8.30	45.89	NS	NS	NS	NS	NS	NS	NS	NM	
AR-3	08/22/96	54.19	10.84	43.35	Not Sampled: Well Removed from Sampling Program								
AR-3	12/19/96	54.19	8.56	45.63	Not Sampled: Well Removed from Sampling Program								
AR-3	04/01/97	54.19	11.24	42.95	Not Sampled: Well Removed from Sampling Program								
AR-3	05/27/97	54.19	10.67	43.52	Not Sampled: Well Removed from Sampling Program								
AR-3	08/12/97	54.19	11.10	43.09	Not Sampled: Well Removed from Sampling Program								
AR-3	11/14/97	54.19	10.60	43.59	Not Sampled: Well Removed from Sampling Program								
AR-3	03/18/98	54.19	NM	NM	Not Sampled: Well Removed from Sampling Program								
AR-3	05/19/98	54.19	NM	NM	Not Sampled: Well Removed from Sampling Program								
AR-3	07/29/98	54.19	9.95	44.24	Not Sampled: Well Removed from Sampling Program								
AR-3	10/09/98	54.19	11.20	42.99	Not Sampled: Well Removed from Sampling Program								

Table 1
Groundwater Elevation and Analytical Data
Total Purgeable Petroleum Hydrocarbons
(TPPH as Gasoline, BTEX Compounds, and MTBE)

ARCO Service Station 4931
731 West MacArthur Boulevard, Oakland, California

Well Number	Date Gauged/ Sampled	Well Elevation (feet, MSL)	Depth to Water (feet, TOB)	Groundwater Elevation (feet, MSL)	TPH Gasoline (ppb)	Benzene (ppb)	Toluene (ppb)	Ethyl- benzene (ppb)	Total Xylenes (ppb)	MTBE 8021B* (ppb)	MTBE 8260 (ppb)	Dissolved Oxygen (ppm)	Purged/ Not Purged (P/NP)
AR-3	02/19/99	54.19	6.98	47.21	Not Sampled: Well Removed from Sampling Program								
AR-3	06/02/99	54.19	10.80	43.39	Not Sampled: Well Removed from Sampling Program								
AR-3	08/26/99	54.19	10.69	43.50	Not Sampled: Well Removed from Sampling Program								0.40
AR-3	10/26/99	54.19	NM	NM	Not Sampled: Well Removed from Sampling Program								
AR-3	02/25/00	54.19	7.21	46.98	Not Sampled: Well Removed from Sampling Program								

TPH = Total petroleum hydrocarbons by modified EPA method 8015
 BTEX = Benzene, toluene, ethylbenzene, total xylenes by EPA method 8021B. (EPA method 8020 prior to 10/26/99).
 MTBE = Methyl tert-butyl ether
 * = EPA method 8020 prior to 10/26/99
 MSL = Mean sea level
 TOB = Top of box
 ppb = Parts per billion
 ppm = Parts per million
 < = Less than laboratory detection limit stated to the right
 NA = Not analyzed
 NM = Not measured
 NS = Not sampled

**Table 2
Groundwater Flow Direction and Gradient**

**ARCO Service Station 4931
731 West MacArthur Boulevard, Oakland, California**

Date Measured	Average Flow Direction	Average Hydraulic Gradient
03/26/96	Southwest	0.03
05/22/96	Southwest	0.04
08/22/96	Southwest	0.02
12/19/96	Southwest	0.03
04/01/97	Southwest	0.03
05/27/97	Southwest	0.04
08/12/97	Southwest	0.02
11/14/97	Southwest	0.02
03/18/98	West	0.03
05/19/98	West-Southwest	0.02
07/29/98	West-Southwest	0.02
10/09/98	Southwest	0.007
02/19/99	Southwest	0.04
06/02/99	West	0.04
08/26/99	West-Southwest	0.02
10/26/99	West-Northwest	0.13
02/25/00	West-Southwest	0.05

ATTACHMENT D

EDCC REPORT AND EDF/GEOWELL SUBMITTAL CONFIRMATION

Error Summary Log

10/29/02

EDF 1.2i All files present in deliverable.

Laboratory:	Sequoia Analytical Laboratories, Inc., Sacramento, CA
Project Name:	ARCO 4931, Oakland, CA
Work Order Number:	S204358
Global ID:	T0600100110
Lab Report Number:	S204358102820021509

Report Summary

Labreport	Sampid	Labsampid	Mtrx	QC	Anmcode	Exmcode	Logdate	Extdate	Anadate	Labiocfl	Run	Sub
S20435810282002	A-11 1509	S20435809	W	CS	SW8021B	SW5030B	04/17/02	04/26/02	04/26/02	2040344	1	
S20435810282002	A-12 1509	S20435810	W	CS	SW8021B	SW5030B	04/17/02	04/26/02	04/27/02	2040344	1	
S20435810282002	A-13 1509	S20435811	W	CS	SW8021B	SW5030B	04/17/02	04/26/02	04/27/02	2040344	1	
S20435810282002	A-2 1509	S20435801	W	CS	SW8021B	SW5030B	04/17/02	04/26/02	04/26/02	2040341	1	
S20435810282002	A-3 1509	S20435802	W	CS	SW8021B	SW5030B	04/17/02	04/26/02	04/26/02	2040341	1	
S20435810282002	A-4 1509	S20435803	W	CS	SW8021B	SW5030B	04/17/02	04/30/02	04/30/02	2050003	1	
S20435810282002	A-5 1509	S20435804	W	CS	SW8021B	SW5030B	04/17/02	04/30/02	04/30/02	2050003	1	
S20435810282002	A-6 1509	S20435805	W	CS	SW8021B	SW5030B	04/17/02	04/26/02	04/26/02	2040344	1	
S20435810282002	A-7 1509	S20435806	W	CS	SW8021B	SW5030B	04/17/02	04/26/02	04/26/02	2040344	1	
S20435810282002	A-8 1509	S20435807	W	CS	SW8021B	SW5030B	04/17/02	04/29/02	04/29/02	2040362	1	
S20435810282002	A-9 1509	S20435808	W	CS	SW8021B	SW5030B	04/17/02	04/26/02	04/26/02	2040344	1	
S20435810282002	TB 1509	S20435812	W	CS	SW8021B	SW5030B	04/17/02	04/29/02	04/29/02	2040362	1	
		S20435405	W	NC	SW8021B	SW5030B	//	04/26/02	04/26/02	2040344	1	
		S20435608	W	NC	SW8021B	SW5030B	//	04/26/02	04/26/02	2040341	1	
		S20436603	W	NC	SW8021B	SW5030B	//	04/29/02	04/29/02	2040362	1	
		S20437710	W	NC	SW8021B	SW5030B	//	04/30/02	04/30/02	2050003	1	
		2040341BS1	WQ	BS1	SW8021B	SW5030B	//	04/26/02	04/26/02	2040341	1	
		2040341BLK1	WQ	LB1	SW8021B	SW5030B	//	04/26/02	04/26/02	2040341	1	
		2040341MS1	W	MS1	SW8021B	SW5030B	//	04/26/02	04/26/02	2040341	1	
		2040341MSD1	W	SD1	SW8021B	SW5030B	//	04/26/02	04/26/02	2040341	1	
		2040344BS1	WQ	BS1	SW8021B	SW5030B	//	04/26/02	04/26/02	2040344	1	
		2040344BLK1	WQ	LB1	SW8021B	SW5030B	//	04/26/02	04/26/02	2040344	1	
		2040344MS1	W	MS1	SW8021B	SW5030B	//	04/26/02	04/26/02	2040344	1	
		2040344MSD1	W	SD1	SW8021B	SW5030B	//	04/26/02	04/26/02	2040344	1	
		2040362BS1	WQ	BS1	SW8021B	SW5030B	//	04/29/02	04/29/02	2040362	1	
		2040362BLK1	WQ	LB1	SW8021B	SW5030B	//	04/29/02	04/29/02	2040362	1	

Report Summary

Labreport	Sampid	Labsampid	Mtrx	QC	Anmcode	Exmcode	Logdate	Extdate	Anadate	Lablotctl	Run Sub
		2040362MS1	W	MS1	SW8021B	SW5030B	//	04/29/02	04/29/02	2040362	1
		2040362MSD1	W	SD1	SW8021B	SW5030B	//	04/29/02	04/29/02	2040362	1
		2050003BS1	WQ	BS1	SW8021B	SW5030B	//	04/30/02	04/30/02	2050003	1
		2050003BLK1	WQ	LB1	SW8021B	SW5030B	//	04/30/02	04/30/02	2050003	1
		2050003MS1	W	MS1	SW8021B	SW5030B	//	04/30/02	04/30/02	2050003	1
		2050003MSD1	W	SD1	SW8021B	SW5030B	//	04/30/02	04/30/02	2050003	1

EDFSAMP: Error Summary Log

10/29/02

Error type	Logcode	Projname	Npdlwo	Sampid	Matrix
There are no errors in this data file					

EDFTEST: Error Summary Log

10/29/02

Error type	Labsampid	Qccode	Anmcode	Exmcode	Anadate	Run number
There are no errors in this data file					//	0

EDFRES: Error Summary Log

10/29/02

Error type	Labsampid	Qcocode	Matrix	Anmcode	Pvccode	Anadate	Run number	Parlabel
Warning: extra parameter	2040341MS1	MS1	W	SW8021B	PR	04/26/02	1	AAATFBZME
Warning: extra parameter	2040341MS1	MS1	W	SW8021B	PR	04/26/02	1	MTBE
Warning: extra parameter	2040341MS1	MS1	W	SW8021B	PR	04/26/02	1	XYLENES
Warning: extra parameter	2040341MSD1	SD1	W	SW8021B	PR	04/26/02	1	AAATFBZME
Warning: extra parameter	2040341MSD1	SD1	W	SW8021B	PR	04/26/02	1	MTBE
Warning: extra parameter	2040341MSD1	SD1	W	SW8021B	PR	04/26/02	1	XYLENES
Warning: extra parameter	2040344MS1	MS1	W	SW8021B	PR	04/26/02	1	AAATFBZME
Warning: extra parameter	2040344MS1	MS1	W	SW8021B	PR	04/26/02	1	MTBE
Warning: extra parameter	2040344MS1	MS1	W	SW8021B	PR	04/26/02	1	XYLENES
Warning: extra parameter	2040344MSD1	SD1	W	SW8021B	PR	04/26/02	1	AAATFBZME
Warning: extra parameter	2040344MSD1	SD1	W	SW8021B	PR	04/26/02	1	MTBE
Warning: extra parameter	2040344MSD1	SD1	W	SW8021B	PR	04/26/02	1	XYLENES
Warning: extra parameter	2040362MS1	MS1	W	SW8021B	PR	04/29/02	1	AAATFBZME
Warning: extra parameter	2040362MS1	MS1	W	SW8021B	PR	04/29/02	1	MTBE
Warning: extra parameter	2040362MS1	MS1	W	SW8021B	PR	04/29/02	1	XYLENES
Warning: extra parameter	2040362MSD1	SD1	W	SW8021B	PR	04/29/02	1	AAATFBZME
Warning: extra parameter	2040362MSD1	SD1	W	SW8021B	PR	04/29/02	1	MTBE
Warning: extra parameter	2040362MSD1	SD1	W	SW8021B	PR	04/29/02	1	XYLENES
Warning: extra parameter	2050003MS1	MS1	W	SW8021B	PR	04/30/02	1	AAATFBZME
Warning: extra parameter	2050003MS1	MS1	W	SW8021B	PR	04/30/02	1	MTBE
Warning: extra parameter	2050003MS1	MS1	W	SW8021B	PR	04/30/02	1	XYLENES
Warning: extra parameter	2050003MSD1	SD1	W	SW8021B	PR	04/30/02	1	AAATFBZME
Warning: extra parameter	2050003MSD1	SD1	W	SW8021B	PR	04/30/02	1	MTBE
Warning: extra parameter	2050003MSD1	SD1	W	SW8021B	PR	04/30/02	1	XYLENES
Warning: extra parameter	S20435405	NC	W	SW8021B	PR	04/26/02	1	AAATFBZME

Error type	Labsampid	Qccode	Matrix	Anmcode	Pvccode	Anadate	Run number	Parlabel
Warning: extra parameter	S20435405	NC	W	SW8021B	PR	04/26/02	1	MTBE
Warning: extra parameter	S20435405	NC	W	SW8021B	PR	04/26/02	1	XYLENES
Warning: extra parameter	S20435608	NC	W	SW8021B	PR	04/26/02	1	AAATFBZME
Warning: extra parameter	S20435608	NC	W	SW8021B	PR	04/26/02	1	MTBE
Warning: extra parameter	S20435608	NC	W	SW8021B	PR	04/26/02	1	XYLENES
Warning: extra parameter	S20435801	CS	W	SW8021B	PR	04/26/02	1	AAATFBZME
Warning: extra parameter	S20435801	CS	W	SW8021B	PR	04/26/02	1	MTBE
Warning: extra parameter	S20435801	CS	W	SW8021B	PR	04/26/02	1	PHCG
Warning: extra parameter	S20435801	CS	W	SW8021B	PR	04/26/02	1	XYLENES
Warning: extra parameter	S20435802	CS	W	SW8021B	PR	04/26/02	1	AAATFBZME
Warning: extra parameter	S20435802	CS	W	SW8021B	PR	04/26/02	1	MTBE
Warning: extra parameter	S20435802	CS	W	SW8021B	PR	04/26/02	1	PHCG
Warning: extra parameter	S20435802	CS	W	SW8021B	PR	04/26/02	1	XYLENES
Warning: extra parameter	S20435803	CS	W	SW8021B	PR	04/30/02	1	AAATFBZME
Warning: extra parameter	S20435803	CS	W	SW8021B	PR	04/30/02	1	MTBE
Warning: extra parameter	S20435803	CS	W	SW8021B	PR	04/30/02	1	PHCG
Warning: extra parameter	S20435803	CS	W	SW8021B	PR	04/30/02	1	XYLENES
Warning: extra parameter	S20435804	CS	W	SW8021B	PR	04/30/02	1	AAATFBZME
Warning: extra parameter	S20435804	CS	W	SW8021B	PR	04/30/02	1	MTBE
Warning: extra parameter	S20435804	CS	W	SW8021B	PR	04/30/02	1	PHCG
Warning: extra parameter	S20435804	CS	W	SW8021B	PR	04/30/02	1	XYLENES
Warning: extra parameter	S20435805	CS	W	SW8021B	PR	04/26/02	1	AAATFBZME
Warning: extra parameter	S20435805	CS	W	SW8021B	PR	04/26/02	1	MTBE
Warning: extra parameter	S20435805	CS	W	SW8021B	PR	04/26/02	1	PHCG
Warning: extra parameter	S20435805	CS	W	SW8021B	PR	04/26/02	1	XYLENES
Warning: extra parameter	S20435806	CS	W	SW8021B	PR	04/26/02	1	AAATFBZME
Warning: extra parameter	S20435806	CS	W	SW8021B	PR	04/26/02	1	MTBE
Warning: extra parameter	S20435806	CS	W	SW8021B	PR	04/26/02	1	PHCG
Warning: extra parameter	S20435806	CS	W	SW8021B	PR	04/26/02	1	XYLENES

Error type	Labsampid	Qccode	Matrix	Anmcode	Pvccode	Anadate	Run number	Parlabel
Warning: extra parameter	S20435807	CS	W	SW8021B	PR	04/29/02	1	AAATFBZME
Warning: extra parameter	S20435807	CS	W	SW8021B	PR	04/29/02	1	MTBE
Warning: extra parameter	S20435807	CS	W	SW8021B	PR	04/29/02	1	PHCG
Warning: extra parameter	S20435807	CS	W	SW8021B	PR	04/29/02	1	XYLENES
Warning: extra parameter	S20435808	CS	W	SW8021B	PR	04/26/02	1	AAATFBZME
Warning: extra parameter	S20435808	CS	W	SW8021B	PR	04/26/02	1	MTBE
Warning: extra parameter	S20435808	CS	W	SW8021B	PR	04/26/02	1	PHCG
Warning: extra parameter	S20435808	CS	W	SW8021B	PR	04/26/02	1	XYLENES
Warning: extra parameter	S20435809	CS	W	SW8021B	PR	04/26/02	1	AAATFBZME
Warning: extra parameter	S20435809	CS	W	SW8021B	PR	04/26/02	1	MTBE
Warning: extra parameter	S20435809	CS	W	SW8021B	PR	04/26/02	1	PHCG
Warning: extra parameter	S20435809	CS	W	SW8021B	PR	04/26/02	1	XYLENES
Warning: extra parameter	S20435810	CS	W	SW8021B	PR	04/27/02	1	AAATFBZME
Warning: extra parameter	S20435810	CS	W	SW8021B	PR	04/27/02	1	MTBE
Warning: extra parameter	S20435810	CS	W	SW8021B	PR	04/27/02	1	PHCG
Warning: extra parameter	S20435810	CS	W	SW8021B	PR	04/27/02	1	XYLENES
Warning: extra parameter	S20435811	CS	W	SW8021B	PR	04/27/02	1	AAATFBZME
Warning: extra parameter	S20435811	CS	W	SW8021B	PR	04/27/02	1	MTBE
Warning: extra parameter	S20435811	CS	W	SW8021B	PR	04/27/02	1	PHCG
Warning: extra parameter	S20435811	CS	W	SW8021B	PR	04/27/02	1	XYLENES
Warning: extra parameter	S20435812	CS	W	SW8021B	PR	04/29/02	1	AAATFBZME
Warning: extra parameter	S20435812	CS	W	SW8021B	PR	04/29/02	1	MTBE
Warning: extra parameter	S20435812	CS	W	SW8021B	PR	04/29/02	1	PHCG
Warning: extra parameter	S20435812	CS	W	SW8021B	PR	04/29/02	1	XYLENES
Warning: extra parameter	S20436603	NC	W	SW8021B	PR	04/29/02	1	AAATFBZME
Warning: extra parameter	S20436603	NC	W	SW8021B	PR	04/29/02	1	MTBE
Warning: extra parameter	S20436603	NC	W	SW8021B	PR	04/29/02	1	XYLENES
Warning: extra parameter	S20437710	NC	W	SW8021B	PR	04/30/02	1	AAATFBZME
Warning: extra parameter	S20437710	NC	W	SW8021B	PR	04/30/02	1	MTBE

Error type	Labsampid	Qccode	Matrix	Anmcode	Pvccode	Anadate	Run number	Parlabel
Warning: extra parameter	S20437710	NC	W	SW8021B	PR	04/30/02	1	XYLENES
Warning: extra parameter	2040341BLK1	LB1	WQ	SW8021B	PR	04/26/02	1	AAATFBZME
Warning: extra parameter	2040341BLK1	LB1	WQ	SW8021B	PR	04/26/02	1	MTBE
Warning: extra parameter	2040341BLK1	LB1	WQ	SW8021B	PR	04/26/02	1	PHCG
Warning: extra parameter	2040341BLK1	LB1	WQ	SW8021B	PR	04/26/02	1	XYLENES
Warning: extra parameter	2040341BS1	BS1	WQ	SW8021B	PR	04/26/02	1	AAATFBZME
Warning: extra parameter	2040341BS1	BS1	WQ	SW8021B	PR	04/26/02	1	MTBE
Warning: extra parameter	2040341BS1	BS1	WQ	SW8021B	PR	04/26/02	1	XYLENES
Warning: extra parameter	2040344BLK1	LB1	WQ	SW8021B	PR	04/26/02	1	AAATFBZME
Warning: extra parameter	2040344BLK1	LB1	WQ	SW8021B	PR	04/26/02	1	MTBE
Warning: extra parameter	2040344BLK1	LB1	WQ	SW8021B	PR	04/26/02	1	PHCG
Warning: extra parameter	2040344BLK1	LB1	WQ	SW8021B	PR	04/26/02	1	XYLENES
Warning: extra parameter	2040344BS1	BS1	WQ	SW8021B	PR	04/26/02	1	AAATFBZME
Warning: extra parameter	2040344BS1	BS1	WQ	SW8021B	PR	04/26/02	1	MTBE
Warning: extra parameter	2040344BS1	BS1	WQ	SW8021B	PR	04/26/02	1	XYLENES
Warning: extra parameter	2040362BLK1	LB1	WQ	SW8021B	PR	04/29/02	1	AAATFBZME
Warning: extra parameter	2040362BLK1	LB1	WQ	SW8021B	PR	04/29/02	1	MTBE
Warning: extra parameter	2040362BLK1	LB1	WQ	SW8021B	PR	04/29/02	1	PHCG
Warning: extra parameter	2040362BLK1	LB1	WQ	SW8021B	PR	04/29/02	1	XYLENES
Warning: extra parameter	2040362BS1	BS1	WQ	SW8021B	PR	04/29/02	1	AAATFBZME
Warning: extra parameter	2040362BS1	BS1	WQ	SW8021B	PR	04/29/02	1	MTBE
Warning: extra parameter	2040362BS1	BS1	WQ	SW8021B	PR	04/29/02	1	XYLENES
Warning: extra parameter	2050003BLK1	LB1	WQ	SW8021B	PR	04/30/02	1	AAATFBZME
Warning: extra parameter	2050003BLK1	LB1	WQ	SW8021B	PR	04/30/02	1	MTBE
Warning: extra parameter	2050003BLK1	LB1	WQ	SW8021B	PR	04/30/02	1	PHCG
Warning: extra parameter	2050003BLK1	LB1	WQ	SW8021B	PR	04/30/02	1	XYLENES
Warning: extra parameter	2050003BS1	BS1	WQ	SW8021B	PR	04/30/02	1	AAATFBZME
Warning: extra parameter	2050003BS1	BS1	WQ	SW8021B	PR	04/30/02	1	MTBE
Warning: extra parameter	2050003BS1	BS1	WQ	SW8021B	PR	04/30/02	1	XYLENES

EDFQC: Error Summary Log

10/29/02

Error type	Lablotctf	Anmcode	Parlabel	Qccode	Labqcid
There are no errors in this data files					

EDFCL: Error Summary Log

10/29/02

Error type	Clevdate	Anmcode	Exmcode	Parlabel	Cicode
There are no errors in this data file	//				

AB2886 Electronic Delivery

[Main Menu](#) | [View/Add Facilities](#) | [Upload EDD](#) | [Check EDD](#)

Your EDF file has been successfully uploaded!

Confirmation Number: 2926976740

Date/Time of Submittal: 10/30/2002 11:49:57 AM

Facility Global ID: T060010Q110

Facility Name: ARCO

Submittal Title: Second Quarter Groundwater Monitoring Report

Submittal Type: GW Monitoring Report

Logged in as URSCORP-OAKLAND (CONTRACTOR)

CONTACT SITE [ADMINISTRATOR](#)

AB2886 Electronic Delivery

[Main Menu](#) | [View/Add Facilities](#) | [Upload EDD](#) | [Check EDD](#)

UPLOADING A GEO_WELL FILE

Processing is complete. No errors were found!
Your file has been successfully submitted!

Submittal Title: Second Quarter Groundwater Monitoring Report for Site
#4931

Submittal Date/Time: 10/30/2002 11:58:42 AM

Confirmation
Number: 7684696793

[Back to Main Menu](#)

Logged in as URSCORP-OAKLAND (CONTRACTOR)

CONTACT SITE [ADMINISTRATOR](#).