

ENGINEERING-SCIENCE, INC.

290 Elwood Davis Road, Suite 312 • Liverpool, New York 13088 • (315) 451-9560 • Fax: (315) 451-9570

ALCO
HAZMAT

March 18, 1994

94 MAR 24 PM 1:35

Ms. Susan Hugo
Alameda County Department
of Environmental Health
80 Swan Way, Room 200
Oakland, California 94621

Re: Greyhound Terminal
Location 8934
Oakland, California

Dear Ms. Hugo:

On behalf of Greyhound Lines, Inc., Engineering-Science, Inc. (ES) is pleased to submit the February 1994 monthly monitoring report for the Greyhound Terminal in Oakland. Table 1 (attached) lists the measured water levels and free-product thicknesses from on-site wells monitored during our site visit. Figure 1 shows the locations of the monitoring wells.

During our site visit on February 2, residual free phase hydrocarbons were observed in recovery wells BC-1, ES-2 and ES-5. A hydrocarbon sheen was present in recovery well ES-1. A total of 780 gallons of diesel fuel and contaminated groundwater have been recovered to date. In addition to our regular monitoring, monitoring well MW-3 was resampled for TPH-D to complete the January groundwater sampling event. TPH-D was detected in MW-3 at a concentration of 0.54 mg/L. A copy of the analytical laboratory report is presented in Attachment A.

Our next site visit is scheduled for April 6, 1994. Greyhound awaits any comments that the Alameda County Department of Environmental Health may have regarding the previously submitted Supplemental Site Assessment and Preliminary Risk Evaluation reports. If you have any questions or require additional information, please feel free to contact us at (315) 451-9560.

Sincerely,

ENGINEERING-SCIENCE, INC.

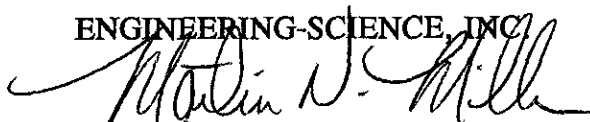

Martin N. Miller
Environmental Technician

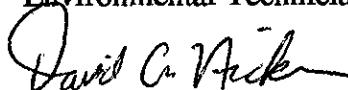

David A. Nickerson
Project Manager



David L. Chaffin, R.G.
California Registered Geologist (No. 4885)

cc: Mr. Richard Hiatt, RWQCB
Tom Portele, GLI, Dallas, TX

TABLE 1
MONITORING SUMMARY
GREYHOUND LINES, INC.
OAKLAND, CA

FEBRUARY 2, 1994



Location	Depth to Liquid (feet)	Depth to Water (feet)	Product Thickness (feet)	Remarks
ES-1*	18.92	18.92	0	Sheen
ES-2*	19.20	19.25	.05	Free Product
ES-3	19.30	19.30	0	Clear
ES-4	18.42	18.42	0	Clear
ES-5*	18.18	19.98	1.80	Free Product
ES-6	21.74	21.74	0	Clear
ES-7	19.79	19.79	0	Clear
ES-8	19.08	19.08	0	Clear
ES-9	17.02	17.02	0	Clear
ES-10	17.25	17.25	0	Clear
ES-11	18.74	18.74	0	Clear
BC-1*	19.30	19.50	.20	Free Product
BC-2**	16.42	16.42	0	Clear
BC-3**	16.40	16.40	0	Clear

* Recovery Well

** Well casings deviated from vertical.

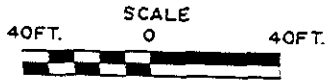
FIGURE 1



- LEGEND**
-  FORMER TANK PIT AREA
 -  GROUNDWATER MONITORING WELL

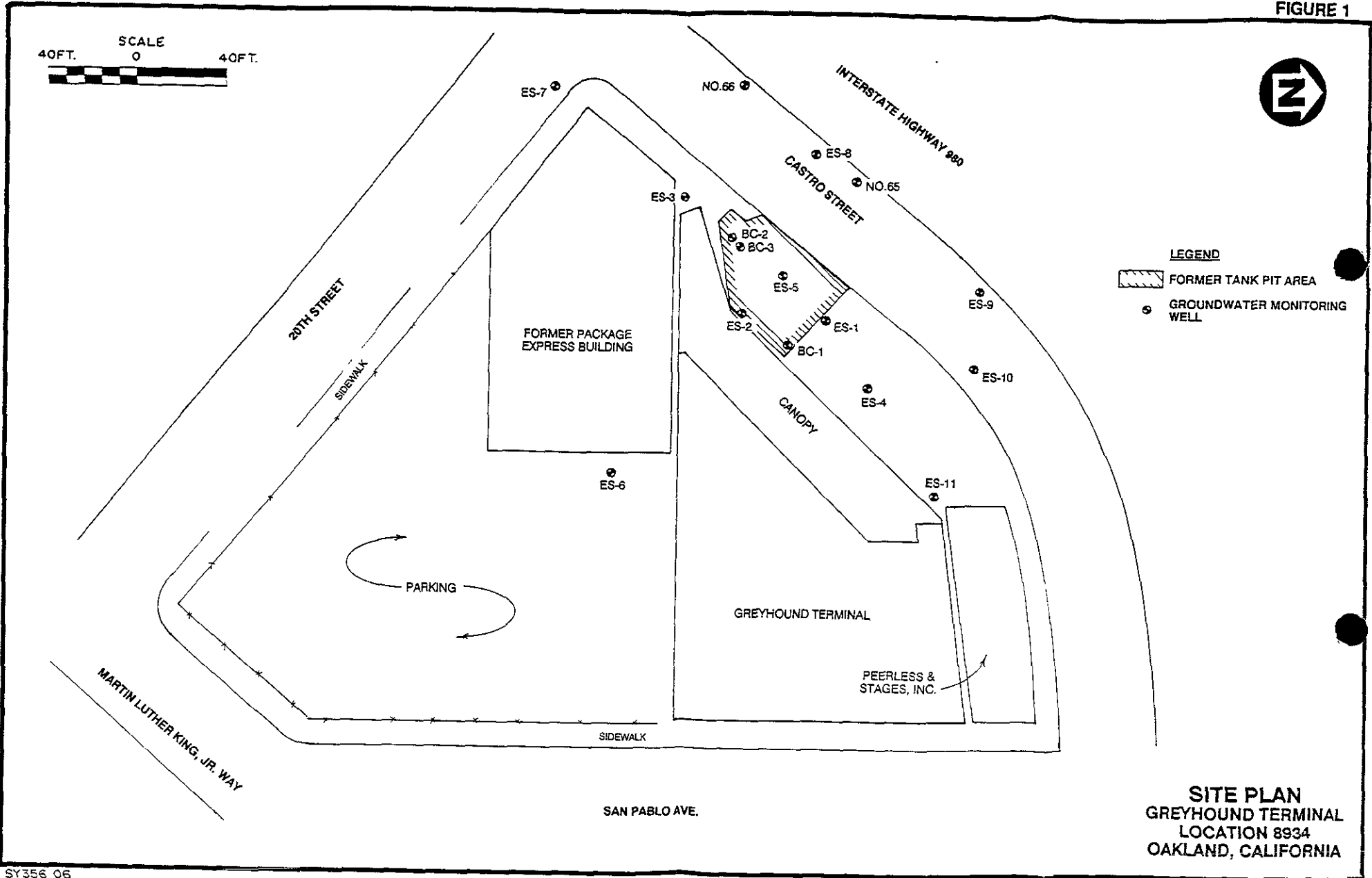

SITE PLAN
GREYHOUND TERMINAL
LOCATION 8934
OAKLAND, CALIFORNIA

ATTACHMENT A



Certificate of Analysis No. 9402110-04

Engineering Science, Inc.
290 Elwood Davis Rd
Liverpool, NY 13088
ATTN: Martin Miller

DATE: 02/14/94

PROJECT: Greyhound Lines, Inc.
SITE: Oakland, California
SAMPLED BY: Engineering Science, Inc.
SAMPLE ID: MW-3

PROJECT NO: 723823.18
MATRIX: LIQUID
DATE SAMPLED: 02/02/94 16:00:00
DATE RECEIVED: 02/03/94

ANALYTICAL DATA

PARAMETER	RESULTS	DETECTION LIMIT	UNITS
Petroleum Hydrocarbons-Diesel Mod. California DHS Analyzed by: SG Date: 02/07/94 23:21:00	0.54	0.5	mg/L

Notes: *Ref: Methods for Chemical Analysis of Water and Wastes, 1983, EPA
**Ref: Standard Methods for Examination of Water & Wastewater, 17th ed.
***Ref: Test Methods for Evaluating Solid Waste, EPA SW846, 3rd Ed.

QUALITY ASSURANCE: These analyses are performed in accordance with EPA guidelines for quality assurance.
SPL California License # 1903

SPL, Inc., - Shari L. Grice



Environmental Laboratory
 8880 Interchange Drive
 Houston, Texas 77054
 713/660-0901

Analysis Request and Chain of Custody Record

Project No. 723823.18	Client/Project Name Greyhound LINES, INC.	Project Location OAKLAND, California
---------------------------------	---	--

Field Sample No./ Identification	Date and Time	Grab	Comp	Sample Container (Size/Mat'l)	Sample Type (Liquid, Sludge, Etc.)	Preservative	ANALYSIS REQUESTED	LABORATORY REMARKS
A	2/2/94 1545	✓		3-40ml	LIQUID	HCL	624	After Carbon
B	2/2/94 1545	✓		↓	↓	↓		Between "
C	2/2/94 1545	✓		↓	↓	↓		Before "
MW-3	2/2/94 1600	X		1-ll	↓	↓	TPH-D	Re-sample.

Samplers (Signature) ES Affiliation	Relinquished by (Signature) 	Date: 2/2/94 Time: 1600	Received by (Signature) _____	Date: Time:	Intact
	Relinquished by (Signature) _____	Date: Time:	Received by (Signature) _____	Date: Time:	Intact
	Relinquished by (Signature) _____	Date: Time:	Received by (Signature) _____	Date: Time:	Intact 3c

SAMPLER REMARKS:	Received for laboratory (Signature) STEPEN	Date: 2/2/94 Time: 1600	Laboratory No.
	Data Results to		
Seal #			