

92 DEC 17 PM 1:01

December 15, 1992

Ms. Susan Hugo
Alameda County Department of Environmental Health
80 Swan Way, Room 200
Oakland, California 94621

STD 3809

Re: Greyhound Terminal
Location 8934
Monthly Monitoring

Dear Ms. Hugo:

On behalf of Greyhound Lines, Inc., Engineering-Science, Inc. (ES) is pleased to submit the November 1992 monthly monitoring report for the Greyhound Terminal in Oakland. Attached you will find Table 1 which lists the measured water levels and free-product thicknesses from on-site wells monitored during our site visit. Figure 1 shows the locations of the monitoring wells.

During our site visit on November 6, free-phase hydrocarbons were observed in ES-1, ES-2, ES-5, and BC-1. All other wells were found to be clear.

During the week of November 9 through 13, Greyhound installed the hydrocarbon recovery system to address the free product plume at the facility. The recovery system utilizes monitoring wells ES-1, ES-2, ES-5 and BC-1 to recover free product and groundwater at the site. An installation report is currently being prepared and will be submitted to your office.

If you have any questions or require additional information, please feel free to contact us at (315) 451-9560.

Sincerely,

ENGINEERING-SCIENCE, INC.

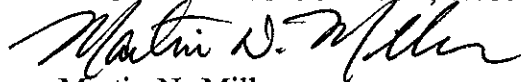

Martin N. Miller
Environmental Technician

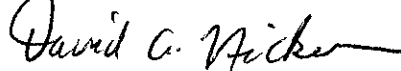

David A. Nickerson, P.G.
Project Manager



David L. Chaffin, R.G.
California Registered Geologist (No. 4885)

MNM/DAN/DLC/slr

cc: Mr. Richard Hiatt, RWQCB
Tom Portele, GLI, Dallas, TX

TABLE 1
GREYHOUND LINES, INC.
OAKLAND, CA
MONITORING SUMMARY
NOVEMBER 6, 1992

Location	Depth to Liquid (feet)	Depth to Water (feet)	Product Thickness (feet)	Remarks
ES-1	18.52	18.53	.01	Free Product
ES-2	18.84	19.44	.60	Free Product
ES-3	19.84	19.84	0	Clear
ES-4	18.94	18.94	0	Clear
ES-5	17.60	20.92	3.32	Free Product
BC-1	18.24	20.69	2.45	Free Product
BC-2	15.98	15.98	0	Clear
BC-3	16.81	16.81	0	Clear

FIGURE 1

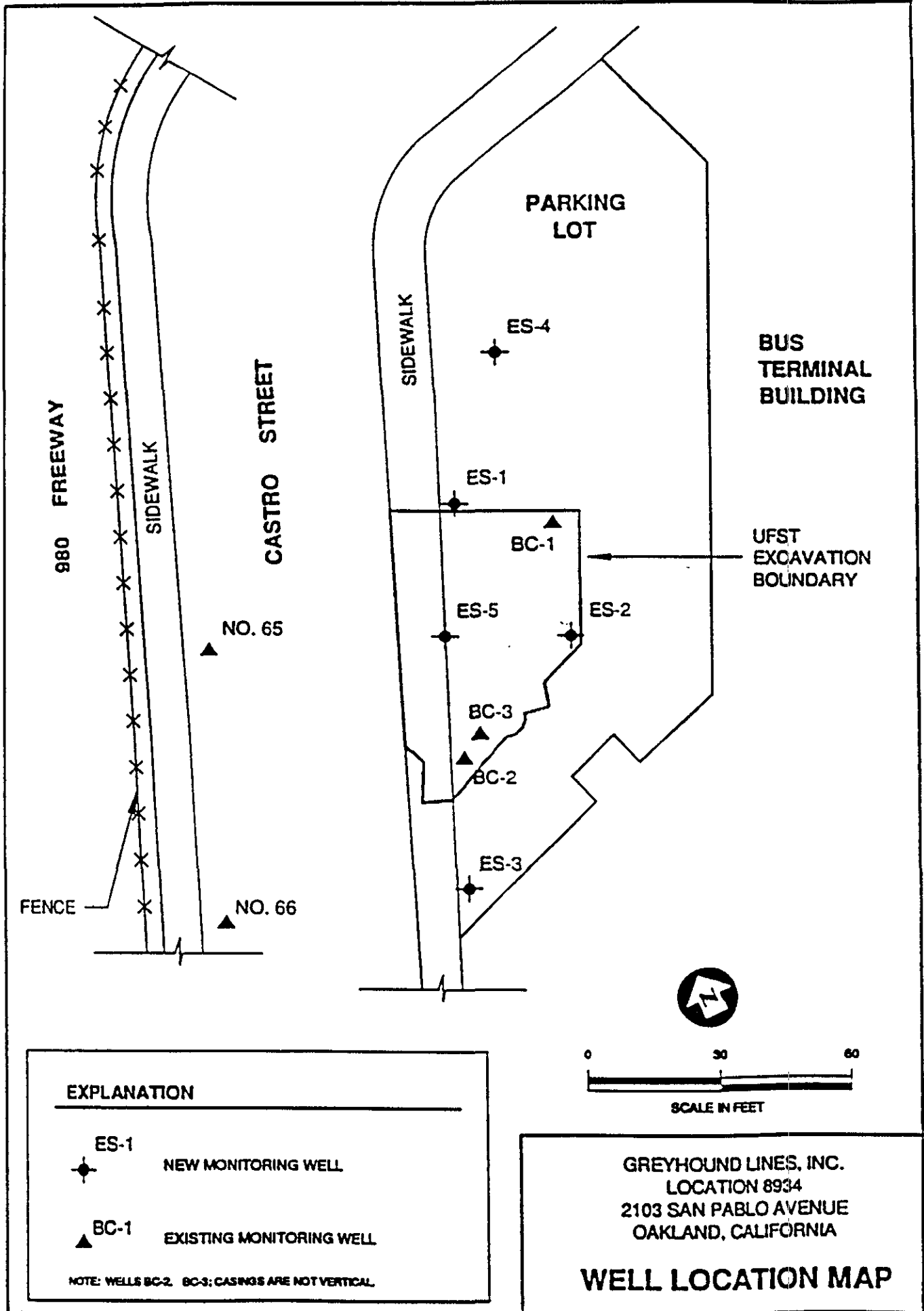

EXPLANATION

- ES-1**
◆ NEW MONITORING WELL
- BC-1**
▲ EXISTING MONITORING WELL

NOTE: WELLS BC-2, BC-3; CASINGS ARE NOT VERTICAL.



GREYHOUND LINES, INC.
LOCATION 8934
2103 SAN PABLO AVENUE
OAKLAND, CALIFORNIA

WELL LOCATION MAP