

Atlantic Richfield Company

Chuck Carmel
Environmental Business Manager

RECEIVED

8:51 am, Oct 06, 2010

Alameda County
Environmental Health

PO Box 1257
San Ramon, CA 94583
Phone: (925) 275-3803
Fax: (925) 275-3815
E-Mail: charles.carmel@bp.com

5 October 2010

Re: Third Quarter 2010 Status Report
Atlantic Richfield Company Station #2169
889 West Grand Avenue, Oakland, California
ACEH Case #RO0000072

"I declare, that to the best of my knowledge at the present time, that the information and/or recommendations contained in the attached document are true and correct.

Submitted by,



Chuck Carmel
Environmental Business Manager

Attachment

5 October 2010

Project No. 06-88-621

Atlantic Richfield Company
P.O. Box 1257
San Ramon, California 94583
Submitted via ENFOS

Attn.: Mr. Chuck Carmel

Re: Third Quarter 2010 Status Report, Atlantic Richfield Company Station #2169
889 West Grand Avenue, Oakland, Alameda County, California;
ACEH Case #RO0000072

Dear Mr. Carmel:

Provided herein is the *Third Quarter 2010 Status Report* for Atlantic Richfield Company (a BP affiliated company) Station #2169 located at 889 West Grand Avenue, Oakland, Alameda County, California (Site). This report presents a summary of current developments at the Site through the Second Quarter of 2010.

Should you have questions regarding this submittal, please do not hesitate to contact me at (530) 566-1400.

Sincerely,

BROADBENT & ASSOCIATES, INC.



Thomas A. Venus, PE
Senior Engineer



Enclosures

cc: Mr. Paresh Khatri, Alameda County Environmental Health (Submitted via ACEH ftp Site)
Electronic copy uploaded to GeoTracker

STATION #2169 QUARTERLY STATUS REPORT

Facility: #2169	Address: 889 West Grand Avenue, Oakland
Environmental Business Manager:	Mr. Chuck Carmel
Consulting Co./Contact Person:	Broadbent & Associates, Inc. (BAI)/Mr. Tom Venus, PE (530) 566-1400
Primary Agency/Regulatory ID No.:	Alameda County Environmental Health (ACEH) ACEH Case #RO0000072
Consultant Project No.:	06-88-621
Facility Permits/Permitting Agency:	NA

WORK PERFORMED THIS QUARTER (Third Quarter 2010):

1. Prepared and submitted *Second Quarter 2010 Status Report* (BAI, 7/6/2010).
2. Significant raze and rebuild station renovation construction activities performed by Fillner Construction, prime contractor to new station owner Chuck Kim. Compliance soil sampling activities for City of Oakland Fire Department CUPA performed by Apex Envirotech.
3. Attempted to perform scheduled Third Quarter 2010 semi-annual ground-water monitoring from wells remaining following start of raze and rebuild station renovation activities.
4. Prepared and submitted *Soil & Ground-Water Investigation with Well Abandonment Report* (BAI, 9/24/2010).
5. Attempted to acquire off-site property access in order to complete the soil and ground-water investigation as proposed in the *Preferential Pathway Evaluation and Soil and Ground-Water Investigation Work Plan* (BAI, 4/6/2009). Mailings in July 2010 and September 2010 were confirmed deliveries by the US Postal Service.

WORK PROPOSED FOR NEXT QUARTER (Fourth Quarter 2010):

1. Prepared and submitted *Third Quarter 2010 Status Report* (contained herein).
2. Conduct ground-water monitoring/sampling event from remaining monitoring wells if safe to access during raze and rebuild construction activities (delayed from Third Quarter 2010 Semi-Annual effort).
3. Continue attempts to obtain off-site property access to begin implementation of the soil and water investigation. Assistance of ACEH desired with private property owners.
4. Initiate off-site soil and ground-water investigation work activities once signed property access agreements are received.

DISCUSSION:

On 16 June 2010, BAI observed Cascade Drilling decommission the following 15 on-site monitoring and former remediation wells in advance of raze and rebuild renovation activities at Station #2169: A-3, A-4, AR-1, AS-1, AS-2, AS-3, AS-4, AS-5, AV-1, AV-2, AV-3, AV-4, AV-5, AV-6, and AV-7. Observations and results were written up in the *Soil & Ground-Water Investigation with Well Abandonment Report* (BAI, 9/24/2010). During the Third Quarter of 2010, several attempts were made to sample the remaining on-site wells that were requested to be preserved for future use (A-1, A-2, AR-2, ADR-1, and ADR-2), however active station demolition and reconstruction activities prevented access to the wells during that time. It was decided against sampling just the two offsite wells during the Third Quarter 2010. Instead, attempts will be made to inspect and sample the five remaining onsite wells and the two existing offsite wells during the Fourth Quarter of 2010.

During station demolition and renovation activities, Fillner Construction, the contractor for the new station owner, informed BAI of the discovery of a 550-gallon single-walled steel underground

storage tank still containing waste oil. The UST was formerly located near the southeast corner of the recently razed station building. This vicinity was identified as the approximate location of a former waste oil tank shown on historic drawings of the Site. According to Apex Envirotech, the environmental consultant brought in by Fillner Construction and the new station owner for compliance sampling, the UST was intact when removed. Apex Envirotech is supposed to prepare and submit a compliance soil sampling report to satisfy the requirements of the City of Oakland Fire Department CUPA. On behalf of Atlantic Richfield Company, BAI has requested copies of the compliance sampling reports from Apex Envirotech when completed. It is presumed that the City of Oakland Fire Department will forward copies of these reports to the ACEH.

Requests for off-site property access required to implement the remaining scope of work within the *Preferential Pathway Evaluation and Soil and Ground-Water Investigation Work Plan* have continued. Proposed access agreements have been sent to the owners of record of the properties at 885 22nd Street and 949 West Grand Avenue. According to the Alameda County Assessor's Office, Mr. Harold Williams, Sr. (given contact address of 866 54th Street, Oakland, CA 94608) is the owner of record for 885 22nd Street, also known as Alameda County Assessor's Parcel Number (APN) 3-29-15. Also according to the Alameda County Assessor's Office, Mr. Myung S. Kim (given contact address of 2601 Telegraph Avenue, Oakland, CA 94612) is the owner of record for the city block across Market Street from the Site with the address of 949 West Grand Avenue, also known as Alameda County APN 5-411-1-4. The two most recent access request letters (sent 2 July 2010 and 7 September 2010) to each of the offsite property owners were confirmed deliveries by the US Postal Service. In mid-September 2010, Mr. Myung S. "George" Kim contacted BAI and Atlantic Richfield Company and has opened a dialogue regarding property access. No replies have been received from Mr. Williams. In light of the continued offsite property access stalemate, BAI suggests that the ACEH be enlisted to assist with acquiring the necessary offsite property access from Mr. Harold Williams Sr. Furthermore, it may be necessary to enlist the assistance of ACEH in obtaining offsite access from Mr. George Kim should negotiations be nonproductive.

The most recent monitoring/sampling data for the Site can be reviewed in the *First Quarter 2010 Semi-Annual Ground-Water Monitoring Report* (BAI, 4/30/2010). For immediate reference, a Site Location Map is provided as Drawing 1 and a Ground-Water Elevation Contour and Analytical Summary Map from First Quarter 2010 is provided as Drawing 2. The former Site layout plan with the locations of existing and recently abandoned wells, and recently completed and still proposed soil borings are shown in Drawing 3.

ATTACHMENTS:

- Drawing 1. Site Location Map, ARCO Service Station #2169, 889 West Grand Avenue, Oakland, California
- Drawing 2. Ground-Water Elevation Contour and Analytical Summary Map, 3 March 2010, ARCO Service Station #2169, 889 West Grand Avenue, Oakland, California
- Drawing 3. Former Site Layout Plan with Well and Soil Boring Locations, ARCO Service Station #2169, 889 West Grand Avenue, Oakland, California

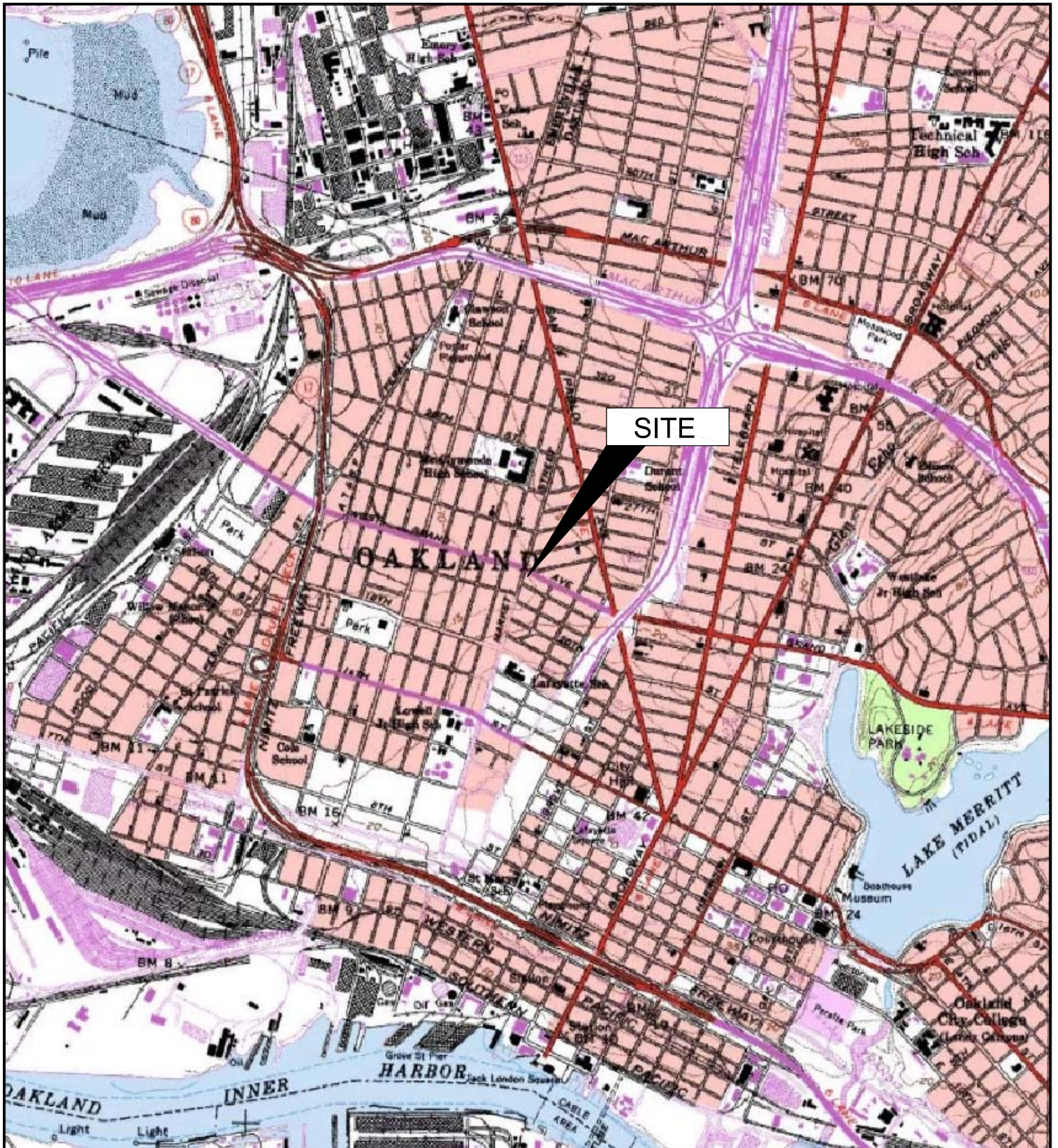

SITE

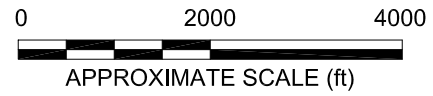
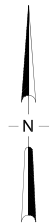
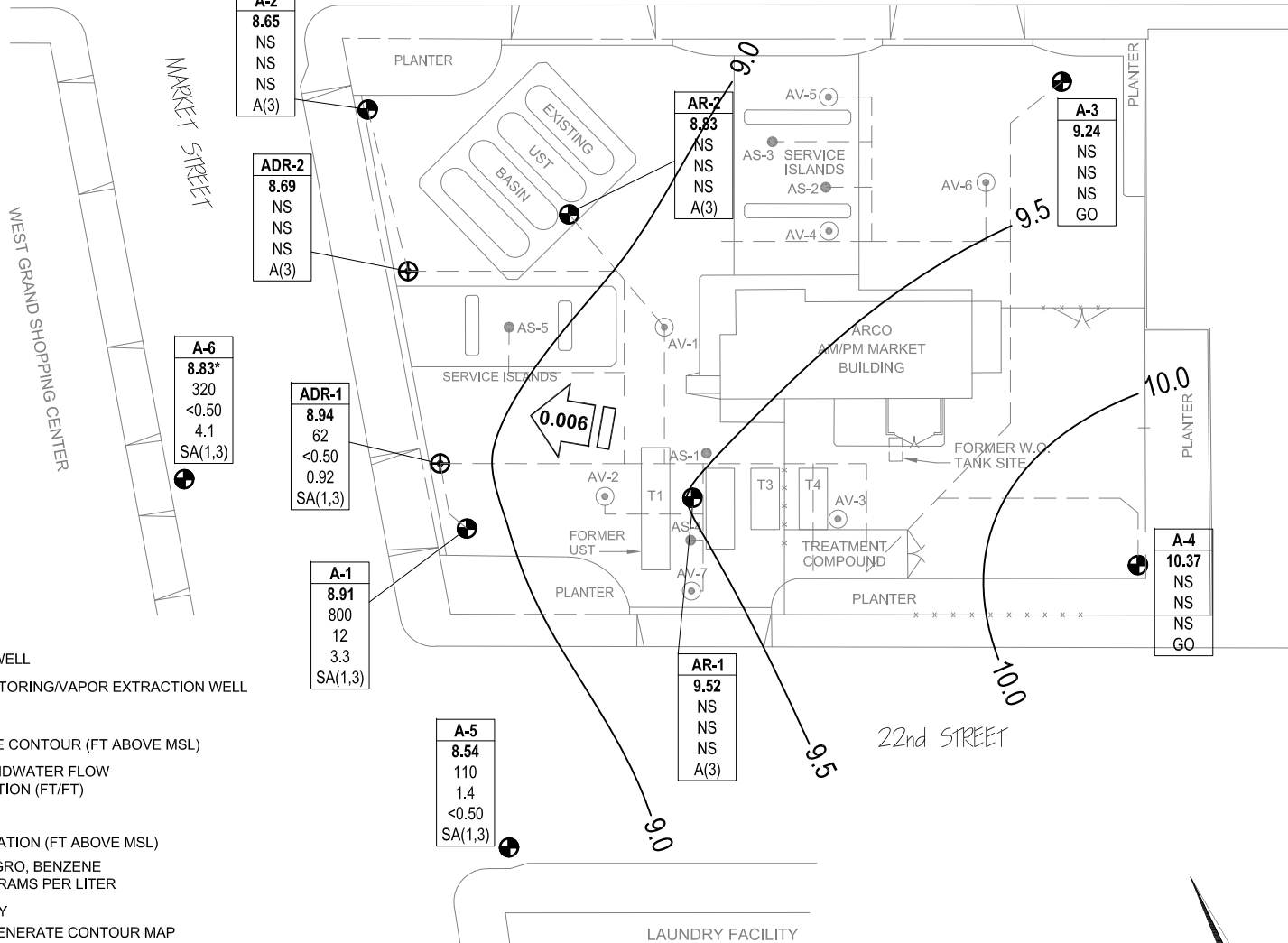

IMAGE SOURCE: USGS

WEST GRAND AVENUE



LEGEND

- MONITORING WELL
 - VAPOR EXTRACTION WELL
 - GROUNDWATER MONITORING/VAPOR EXTRACTION WELL
 - AIR SPARGING WELL
 - 9.0 GROUNDWATER TABLE CONTOUR (FT ABOVE MSL)
 - 0.006 APPROXIMATE GROUNDWATER FLOW GRADIENT AND DIRECTION (FT/FT)
- | Well | WELL DESIGNATION |
|---------|--|
| ELEV | GROUNDWATER ELEVATION (FT ABOVE MSL) |
| GRO | CONCENTRATION OF GRO, BENZENE AND MTBE IN MICROGRAMS PER LITER |
| Benzene | |
| MTBE | |
| A/Q | SAMPLING FREQUENCY |
- * WELL NOT USED TO GENERATE CONTOUR MAP
 - < NOT DETECTED AT OR ABOVE LABORATORY REPORTING LIMIT
 - NS NOT SAMPLED
 - A(3) SAMPLED ANNUALLY, 3RD QUARTER
 - SA SAMPLED SEMI-ANNUALLY, 1ST & 3RD QUARTERS
 - GO GAUGE ONLY
 - — REMEDIATION PIPING

NOTE: SITE MAP ADAPTED FROM IT CORPORATION FIGURES.
SITE DIMENSIONS AND FACILITY LOCATIONS NOT VERIFIED.

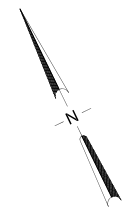

BROADBENT & ASSOCIATES, INC.
ENGINEERING, WATER RESOURCES & ENVIRONMENTAL
1324 Mangrove Ave. Suite 212, Chico, California 95926
Project No.: 06-88-621 Date: 3/23/2010

ARCO Service Station #2169
889 West Grand Avenue
Oakland, California

Ground-Water Elevation Contour
and Analytical Summary Map
3 March 2010

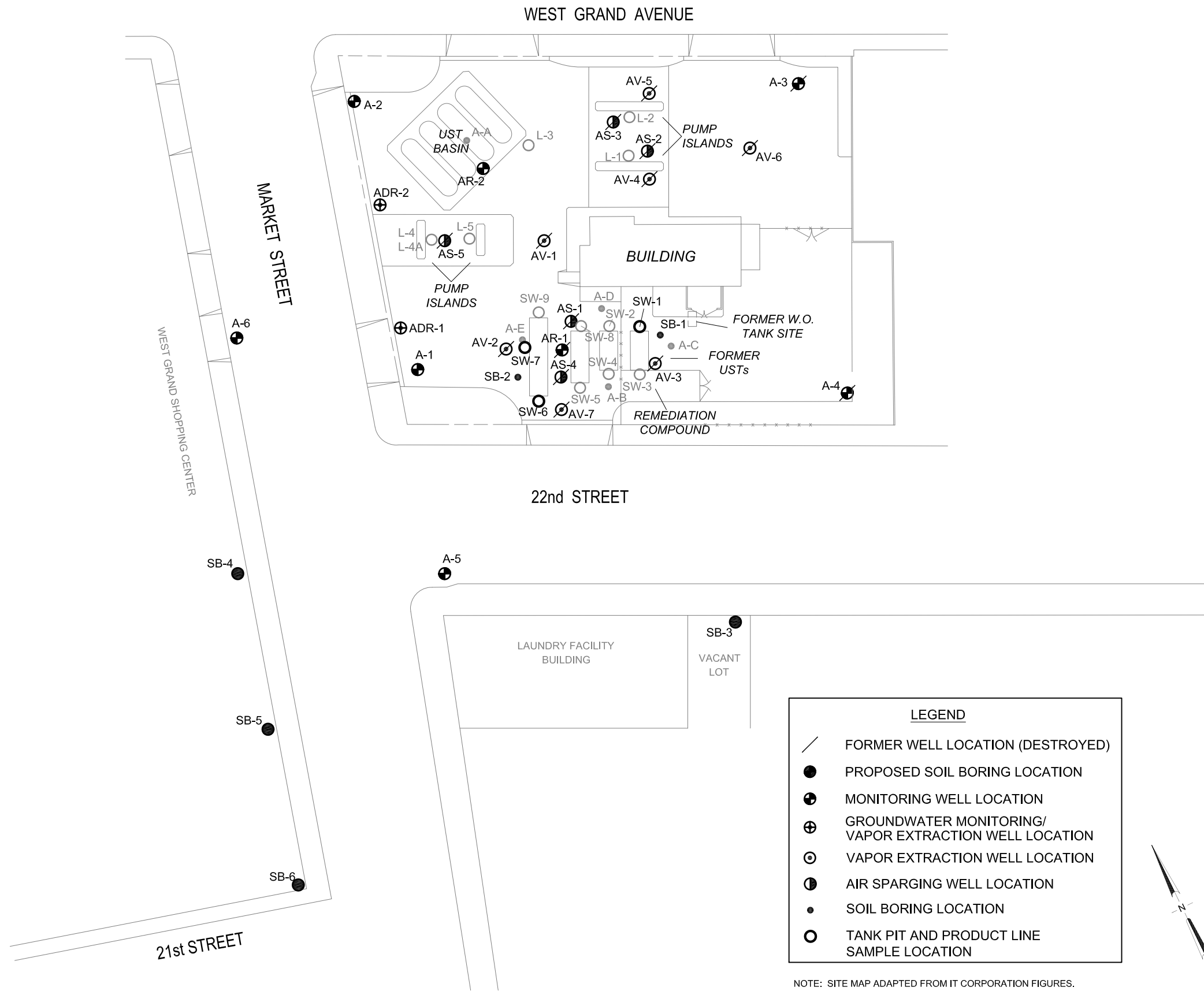

LEGEND	
	FORMER WELL LOCATION (DESTROYED)
	PROPOSED SOIL BORING LOCATION
	MONITORING WELL LOCATION
	GROUNDWATER MONITORING/ VAPOR EXTRACTION WELL LOCATION
	VAPOR EXTRACTION WELL LOCATION
	AIR SPARGING WELL LOCATION
	SOIL BORING LOCATION
	TANK PIT AND PRODUCT LINE SAMPLE LOCATION

NOTE: SITE MAP ADAPTED FROM IT CORPORATION FIGURES.

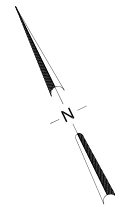

SCALE (ft)