

Atlantic Richfield Company

Chuck Carmel
Environmental Business Manager

RECEIVED

10:27 am, Jul 07, 2010

Alameda County
Environmental Health

PO Box 1257
San Ramon, CA 94583
Phone: (925) 275-3803
Fax: (925) 275-3815
E-Mail: charles.carmel@bp.com

6 July 2010

Re: Second Quarter 2010 Status Report
Atlantic Richfield Company Station #2169
889 West Grand Avenue, Oakland, California
ACEH Case #RO0000072

"I declare, that to the best of my knowledge at the present time, that the information and/or recommendations contained in the attached document are true and correct.

Submitted by,



Chuck Carmel
Environmental Business Manager

Attachment

6 July 2010

Project No. 06-88-621

Atlantic Richfield Company
P.O. Box 1257
San Ramon, California 94583
Submitted via ENFOS

Attn.: Mr. Chuck Carmel

Re: Second Quarter 2010 Status Report, Atlantic Richfield Company Station #2169
889 West Grand Avenue, Oakland, Alameda County, California;
ACEH Case #RO0000072

Dear Mr. Carmel:

Provided herein is the *Second Quarter 2010 Status Report* for Atlantic Richfield Company (a BP affiliated company) Station #2169 located at 889 West Grand Avenue, Oakland, Alameda County, California (Site). This report presents a summary of current developments at the Site through the Second Quarter of 2010.

Should you have questions regarding this submittal, please do not hesitate to contact me at (530) 566-1400.

Sincerely,

BROADBENT & ASSOCIATES, INC.



Thomas A. Venus, PE
Senior Engineer



Enclosures

cc: Mr. Paresh Khatri, Alameda County Environmental Health (Submitted via ACEH ftp Site)
Electronic copy uploaded to GeoTracker

STATION #2169 QUARTERLY STATUS REPORT

Facility: #2169	Address: 889 West Grand Avenue, Oakland
Environmental Business Manager:	Mr. Chuck Carmel
Consulting Co./Contact Person:	Broadbent & Associates, Inc. (BAI)/Mr. Tom Venus, PE (530) 566-1400
Primary Agency/Regulatory ID No.:	Alameda County Environmental Health (ACEH) ACEH Case #RO0000072
Consultant Project No.:	06-88-621
Facility Permits/Permitting Agency:	NA

WORK PERFORMED THIS QUARTER (Second Quarter 2010):

1. Prepared and submitted *First Quarter 2010 Semi-Annual Ground-Water Monitoring Report* (BAI, 4/30/2010).
2. Decommissioned 15 on-site monitoring and former remediation wells in advance of demolition of existing station and construction of new station and facilities (raze & rebuild).
3. Advanced two on-site soil borings as proposed in the *Preferential Pathway Evaluation and Soil and Ground-Water Investigation Work Plan* submitted on 6 April 2009 and approved by ACEH in their letter dated 1 May 2009.
4. Attempted to acquire off-site property access in order to complete the soil and ground-water investigation as proposed in the *Preferential Pathway Evaluation and Soil and Ground-Water Investigation Work Plan* (BAI, 4/6/2009).

WORK PROPOSED FOR NEXT QUARTER (Third Quarter 2010):

1. Prepared and submitted this *Second Quarter 2010 Status Report* (contained herein).
2. Prepare Monitoring Well Decommissioning and On-Site Soil & Ground-Water Investigation Report for on-site wells that had to be destroyed prior to raze and rebuild construction, and concurrent soil sampling from two on-site investigation borings.
3. Conduct Third Quarter 2010 semi-annual ground-water monitoring/sampling event from remaining monitoring wells if safe to access during raze and rebuild construction activities.
4. Continue attempts to obtain off-site property access to begin implementation of the soil and water investigation. Assistance of ACEH desired with private property owners.
5. Provide ACEH with documentation and/or summary timeline of correspondence with property owners who are not favorably responsive to requests for off-site access.
6. Initiate off-site soil and ground-water investigation work activities once signed property access agreements are received.

DISCUSSION:

On 7 May 2010, BAI was notified by BP Retail Operations that the operator of Station #2169, was going to purchase the property from BP then demolish the existing station and construct a new station and facilities (raze and rebuild). After review of the proposed development plans, it was determined that 15 of the 20 monitoring and former remediation wells present on the Site would have to be properly decommissioned before the 'raze and rebuild' could commence. On 14 May 2010, BAI notified ACEH on the necessity of the well decommissioning activities and provided plans showing which wells were to be preserved and which wells were to be abandoned and by what means. On 24 May 2010, BAI applied for the well destruction permits from the Alameda County Public Works Agency. On 16 June 2010, BAI observed Cascade Drilling decommission the following 15 on-site monitoring and former remediation wells: A-3, A-4, AR-1, AS-1, AS-2, AS-3, AS-4, AS-5, AV-1, AV-2, AV-3, AV-4, AV-5, AV-6, and AV-7 (The following on-site wells were preserved for future use: A-1, A-2, AR-2, ADR-1, and ADR-2).

Since a drilling rig had been mobilized to the Site, on 17 June 2010 BAI observed Cascade Drilling advance two on-site soil borings as proposed in the *Preferential Pathway Evaluation and Soil and Ground-Water Investigation Work Plan* (BAI, 4/6/2009). As proposed in the work-plan, the objective of drilling on-site soil borings SB-1 and SB-2 were to collect soil samples to characterize residual hydrocarbons in the subsurface in the former source area following shutdown of the former air-sparg/soil-vapor extraction remediation system that previously operated at the Site. Six soil samples were collected from each boring. The observations and results for these field activities will be prepared into a combined Monitoring Well Decommissioning and Soil & Ground-Water Investigation Report, to be provided under separate cover in the near future.

Requests for off-site property access required to implement the remaining scope of work within the *Preferential Pathway Evaluation and Soil and Ground-Water Investigation Work Plan* has been initiated. However, the two off-site property owners have so far been unresponsive to phone calls and letters sent via mail. In light of the continued offsite property access stalemate, BAI suggests that the ACEH be enlisted to assist with acquiring the necessary offsite property access.

The most recent monitoring/sampling data for the Site can be reviewed in the *First Quarter 2010 Semi-Annual Ground-Water Monitoring Report* (BAI, 4/30/2010). For immediate reference, a Site Location Map is provided as Drawing 1 and a Ground-Water Elevation Contour and Analytical Summary Map from First Quarter 2010 is provided as Drawing 2.

ATTACHMENTS:

- Drawing 1. Site Location Map, ARCO Service Station #2169, 889 West Grand Avenue, Oakland, California
- Drawing 2. Ground-Water Elevation Contour and Analytical Summary Map, 3 March 2010, ARCO Service Station #2169, 889 West Grand Avenue, Oakland, California

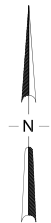

APPROXIMATE SCALE (mi)

IMAGE SOURCE: DELORME

BROADBENT & ASSOCIATES, INC.
 ENGINEERING, WATER RESOURCES & ENVIRONMENTAL
 1324 Mangrove Ave. Suite 212, Chico, CA 95926
 Project No.: 06-88-621 Date: 3/23/2010

ARCO Service Station #2169
 889 West Grand Avenue
 Oakland, California

Site Location Map

Drawing

1

WEST GRAND AVENUE

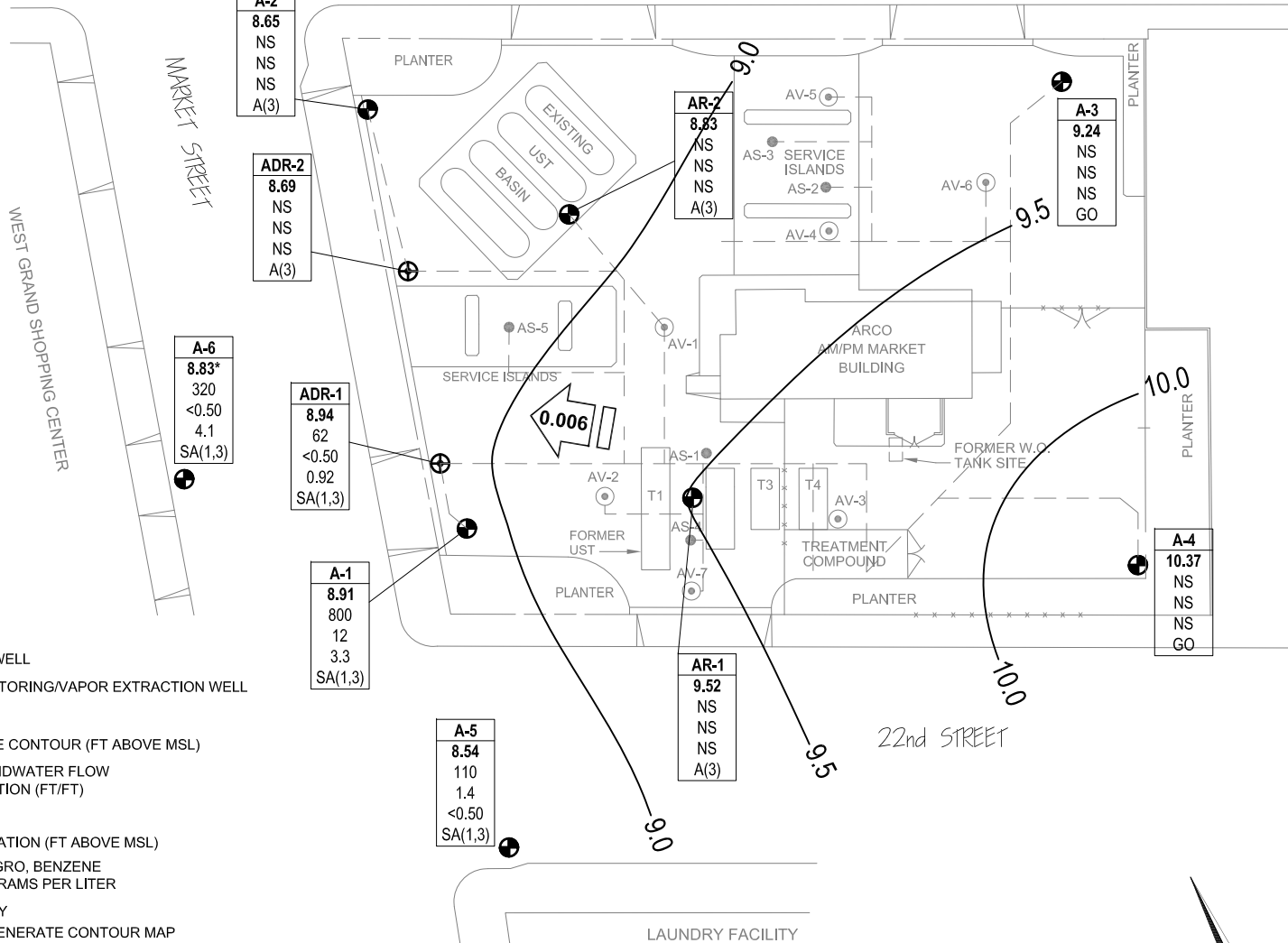

LEGEND

- MONITORING WELL
 - VAPOR EXTRACTION WELL
 - GROUNDWATER MONITORING/VAPOR EXTRACTION WELL
 - AIR SPARGING WELL
 - 9.0 GROUNDWATER TABLE CONTOUR (FT ABOVE MSL)
 - 0.006 APPROXIMATE GROUNDWATER FLOW GRADIENT AND DIRECTION (FT/FT)
- | Well | WELL DESIGNATION |
|---------|--|
| ELEV | GROUNDWATER ELEVATION (FT ABOVE MSL) |
| GRO | CONCENTRATION OF GRO, BENZENE AND MTBE IN MICROGRAMS PER LITER |
| Benzene | |
| MTBE | |
| A/Q | SAMPLING FREQUENCY |
- * WELL NOT USED TO GENERATE CONTOUR MAP
 - < NOT DETECTED AT OR ABOVE LABORATORY REPORTING LIMIT
 - NS NOT SAMPLED
 - A(3) SAMPLED ANNUALLY, 3RD QUARTER
 - SA SAMPLED SEMI-ANNUALLY, 1ST & 3RD QUARTERS
 - GO GAUGE ONLY
 - — REMEDIATION PIPING

NOTE: SITE MAP ADAPTED FROM IT CORPORATION FIGURES.
SITE DIMENSIONS AND FACILITY LOCATIONS NOT VERIFIED.

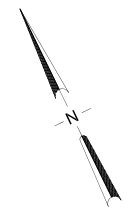

BROADBENT & ASSOCIATES, INC.
ENGINEERING, WATER RESOURCES & ENVIRONMENTAL
1324 Mangrove Ave. Suite 212, Chico, California 95926
Project No.: 06-88-621 Date: 3/23/2010

ARCO Service Station #2169
889 West Grand Avenue
Oakland, California

Ground-Water Elevation Contour
and Analytical Summary Map
3 March 2010

Drawing
2