

Atlantic Richfield Company

Chuck Carmel
Environmental Business Manager

RECEIVED

9:11 am, Feb 01, 2010

Alameda County
Environmental Health

PO Box 1257
San Ramon, CA 94583
Phone: (925) 275-3803
Fax: (925) 275-3815
E-Mail: charles.carmel@bp.com

22 January 2010

Re: Fourth Quarter 2009 Status Report
Atlantic Richfield Company Station #2169
889 West Grand Avenue, Oakland, California
ACEH Case #RO0000072

"I declare, that to the best of my knowledge at the present time, that the information and/or recommendations contained in the attached document are true and correct.

Submitted by,



Chuck Carmel
Environmental Business Manager

Attachment

22 January 2010

Project No. 06-88-621

Atlantic Richfield Company
P.O. Box 1257
San Ramon, California 94583
Submitted via ENFOS

Attn.: Mr. Chuck Carmel

Re: Fourth Quarter 2009 Status Report, Atlantic Richfield Company Station #2169
889 West Grand Avenue, Oakland, Alameda County, California;
ACEH Case #RO0000072

Dear Mr. Carmel:

Provided herein is the *Fourth Quarter 2009 Status Report* for Atlantic Richfield Company (a BP affiliated company) Station #2169 located at 889 West Grand Avenue, Oakland, Alameda County, California (Site). This report presents a summary of current developments at the Site through the Fourth Quarter of 2009.

Should you have questions regarding this submittal, please do not hesitate to contact me at (530) 566-1400.

Sincerely,

BROADBENT & ASSOCIATES, INC.



Thomas A. Venus, PE
Senior Engineer



Enclosures

cc: Mr. Paresh Khatri, Alameda County Environmental Health (Submitted via ACEH ftp Site)
Electronic copy uploaded to GeoTracker

STATION #2169 QUARTERLY STATUS REPORT

Facility: #2169	Address: 889 West Grand Avenue, Oakland
Environmental Business Manager:	Mr. Chuck Carmel
Consulting Co./Contact Person:	Broadbent & Associates, Inc. (BAI)/Mr. Tom Venus, PE (530) 566-1400
Primary Agency/Regulatory ID No.:	Alameda County Environmental Health (ACEH) ACEH Case #RO0000072
Consultant Project No.:	06-88-621
Facility Permits/Permitting Agency:	NA

WORK PERFORMED THIS QUARTER (Fourth Quarter 2009):

1. Prepared and submitted *Third Quarter 2009 Semi-Annual Ground-Water Monitoring Report* (BAI, 10/30/2009).
2. Attempted to acquire off-site property access in order to complete soil and ground-water investigation as proposed in the *Preferential Pathway Evaluation and Soil and Ground-Water Investigation Work Plan* submitted on 6 April 2009 and approved by ACEH in their letter dated 1 May 2009.
3. No environmental field work was conducted at the Site during the Fourth Quarter of 2009.

WORK PROPOSED FOR NEXT QUARTER (First Quarter 2010):

1. Prepared and submitted this *Fourth Quarter 2009 Status Report* (contained herein).
2. Conduct First Quarter 2010 semi-annual ground-water monitoring/sampling event.
3. Continue attempts to obtain off-site property access to begin implementation of the soil and water investigation. Assistance of ACEH desired with private property owners. Provide ACEH with documentation and/or summary timeline of correspondence with property owner who is not favorably responsive to requests for off-site access.
4. Initiate soil and ground-water investigation work activities once signed property access agreements are received.

QUARTERLY RESULTS SUMMARY:

Current phase of project:	Ground-Water Monitoring/Sampling
Frequency of ground-water monitoring:	Semi-Annually (1Q & 3Q): A-1 through A-6, AR-1, AR-2, ADR-1, ADR-2
Frequency of ground-water sampling:	Semi-Annually (1Q & 3Q): Wells A-1, A-5, A-6, ADR-1 Annually (3Q): Wells A-2, AR-1, AR-2, ADR-2
Is free product (FP) present on-site:	No
FP recovered this quarter:	None
Cumulative FP recovered:	4.8 gallons: Wells ADR-1 and ADR-2
Current remediation techniques:	Soil Vapor Extraction System shut down in December 2001
Depth to ground water (below TOC):	NA
General ground-water flow direction:	NA
Approximate hydraulic gradient:	NA

DISCUSSION:

No environmental field work took place at the Site during the Fourth Quarter of 2009. The most recent monitoring/sampling data for the Site can be reviewed in the *Third Quarter 2009 Semi-Annual Ground-Water Monitoring Report* (BAI, 10/30/2009). For immediate reference, a Site Location Map is

provided as Drawing 1 and a Ground-Water Elevation Contour and Analytical Summary Map from Third Quarter 2009 is provided as Drawing 2.

The *Preferential Pathway Evaluation and Soil and Ground-Water Investigation Work Plan* submitted on 6 April 2009 was approved by the ACEH in their letter dated 1 May 2009. Off-site property access required for the implementation of the work plan has been initiated. However, the two off-site property owners have so far been unresponsive to phone calls and letters sent via mail. An email was sent to Mr. Pares Khatri of ACEH on 21 July 2009 requesting a deadline extension for the submittal of a soil and ground-water investigation report. It was requested that the 30 July 2009 deadline for submittal of the report be amended to 90 days following receipt of signed property access agreements. In light of the present offsite property access stalemate, BAI suggests that the ACEH be enlisted to assist with acquiring offsite property access.

ATTACHMENTS:

- Drawing 1. Site Location Map, ARCO Service Station #2169, 889 West Grand Avenue, Oakland, California

- Drawing 2. Ground-Water Elevation Contour and Analytical Summary Map, 4 September 2009, ARCO Service Station #2169, 889 West Grand Avenue, Oakland, California

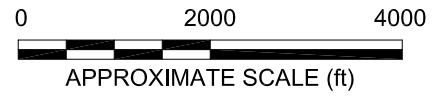
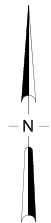
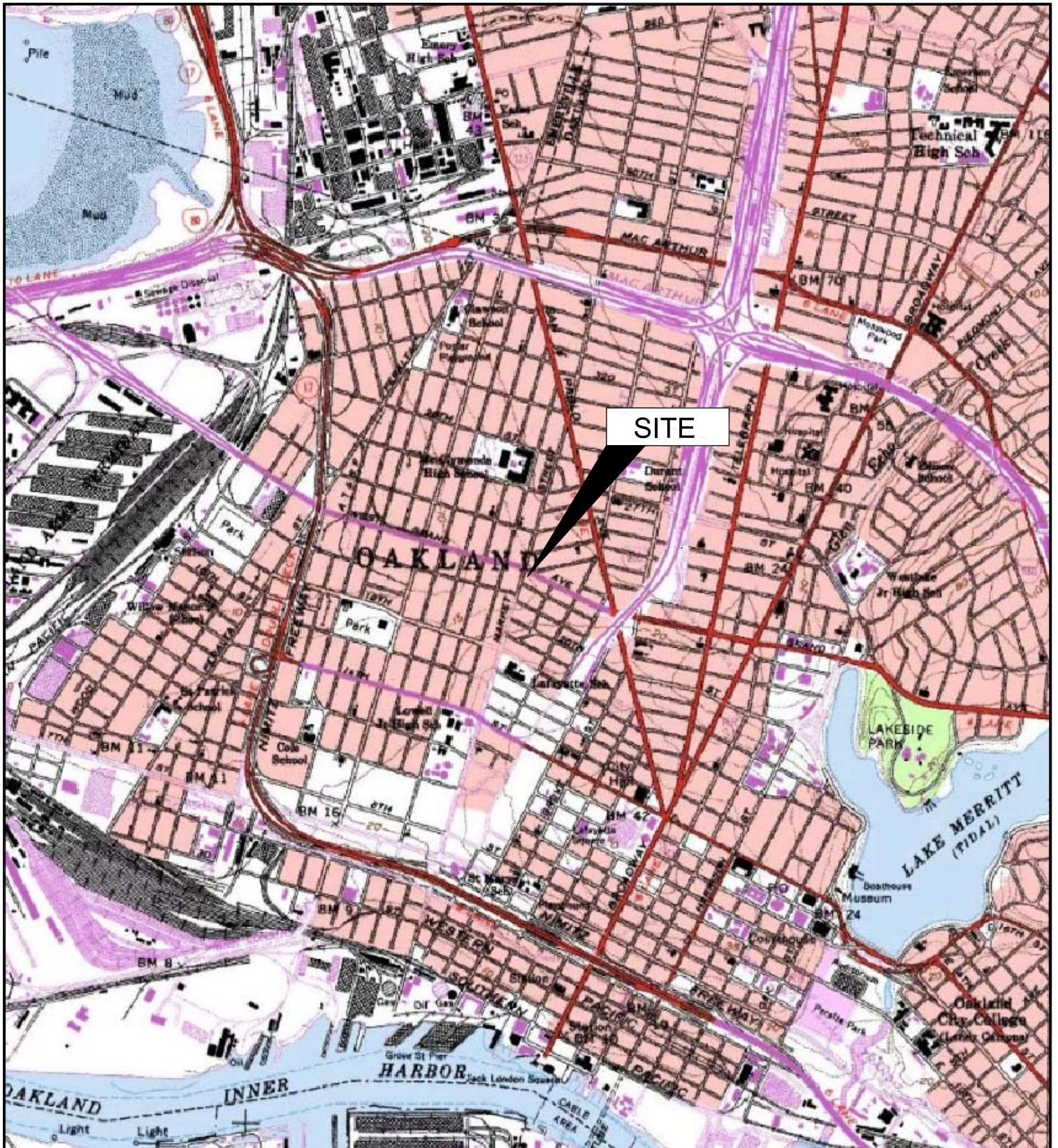
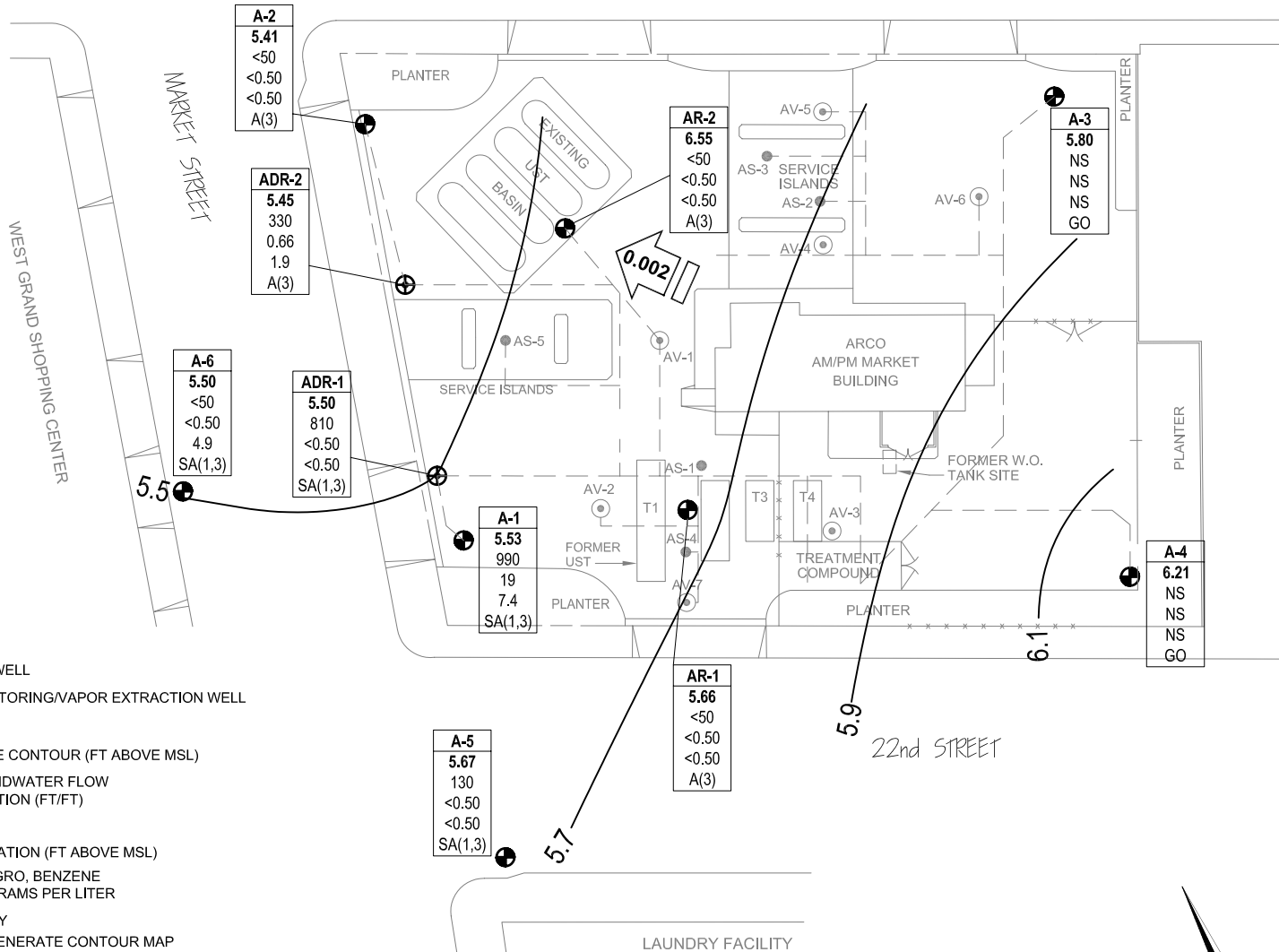

IMAGE SOURCE: USGS

WEST GRAND AVENUE



LEGEND

- MONITORING WELL
 - VAPOR EXTRACTION WELL
 - GROUNDWATER MONITORING/VAPOR EXTRACTION WELL
 - AIR SPARGING WELL
 - 5.5 GROUNDWATER TABLE CONTOUR (FT ABOVE MSL)
 - APPROXIMATE GROUNDWATER FLOW GRADIENT AND DIRECTION (FT/FT)
- | Well | WELL DESIGNATION |
|---------|--|
| ELEV | GROUNDWATER ELEVATION (FT ABOVE MSL) |
| GRO | CONCENTRATION OF GRO, BENZENE AND MTBE IN MICROGRAMS PER LITER |
| Benzene | |
| MTBE | |
| A/Q | SAMPLING FREQUENCY |
- * WELL NOT USED TO GENERATE CONTOUR MAP
 - < NOT DETECTED AT OR ABOVE LABORATORY REPORTING LIMIT
 - NS NOT SAMPLED
 - A(3) SAMPLED ANNUALLY, 3RD QUARTER
 - SA SAMPLED SEMI-ANNUALLY, 1ST & 3RD QUARTERS
 - GO GAUGE ONLY
 - — REMEDIATION PIPING

NOTE: SITE MAP ADAPTED FROM IT CORPORATION FIGURES. SITE DIMENSIONS AND FACILITY LOCATIONS NOT VERIFIED.

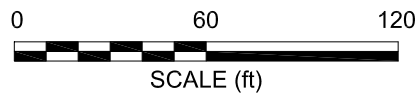
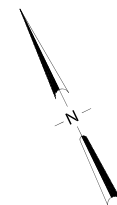

BROADBENT & ASSOCIATES, INC.
 ENGINEERING, WATER RESOURCES & ENVIRONMENTAL
 1324 Mangrove Ave. Suite 212, Chico, California 95926
 Project No.: 06-88-621 Date: 10/13/09

ARCO Service Station #2169
 889 West Grand Avenue
 Oakland, California

Ground-Water Elevation Contour
 and Analytical Summary Map
 4 September 2009

Drawing

2