



Atlantic Richfield Company
(a BP affiliated company)

P.O. Box 1257
San Ramon, California 94583
Phone: (925) 275-3801
Fax: (925) 275-3815

18 July 2008

Re: Second Quarter 2008 Status Report
Atlantic Richfield Company Station #2169
889 West Grand Avenue, Oakland, California
ACEH Case #RO000072

RECEIVED

2:23 pm, Jul 29, 2008

Alameda County
Environmental Health



"I declare, that to the best of my knowledge at the present time, that the information and/or recommendations contained in the attached document are true and correct."

Submitted by:

Paul Supple
Environmental Business Manager

18 July 2008

Project No. 06-08-621

Atlantic Richfield Company
P.O. Box 1257
San Ramon, California 94583
Submitted via ENFOS

Attn.: Mr. Paul Supple

Re: Second Quarter 2008 Status Report, Atlantic Richfield Company (a BP affiliated company) Station #2169, 889 West Grand Avenue, Oakland, Alameda County, California; ACEH Case #RO0000072

Dear Mr. Supple:

Provided herein is the *Second Quarter 2008 Status Report* for Atlantic Richfield Company Station #2169 (herein referred to as Station #2169) located at 889 West Grand Avenue, Oakland, Alameda County, California (Site). This report presents a summary of current developments at the Site through the Second Quarter of 2008.

Should you have questions regarding the work performed or results obtained, please do not hesitate to contact us at (530) 566-1400.

Sincerely,

BROADBENT & ASSOCIATES, INC.

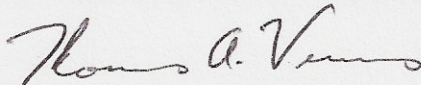

Thomas A. Venus, P.E.
Senior Engineer



Robert H. Miller, P.G., C.HG.
Principal Hydrogeologist

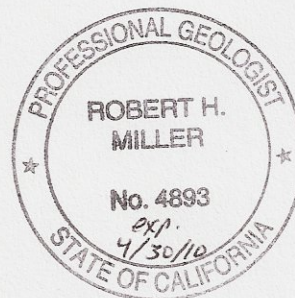

Enclosures

cc: Mr. Paresh Khatri, Alameda County Environmental Health (Submitted via ACEH ftp Site)
Electronic copy uploaded to GeoTracker

STATION #2169 QUARTERLY STATUS REPORT

Facility: #2169	Address:	889 West Grand Avenue, Oakland
Environmental Business Manager:		Mr. Paul Supple
Consulting Co./Contact Persons:		Broadbent & Associates, Inc. (BAI)/Rob Miller & Tom Venus (530) 566-1400
Primary Agency/Regulatory ID No.:		Alameda County Environmental Health (ACEH) ACEH Case #RO0000072
Consultant Project No.:		06-08-621
Facility Permits/Permitting Agency:		NA

WORK PERFORMED THIS QUARTER (Second Quarter 2008):

1. Prepared and submitted First Quarter 2008 Semi-Annual Ground-Water Monitoring Report.
2. No environmental work was conducted at the Site during the Second Quarter of 2008.

WORK PROPOSED FOR NEXT QUARTER (Third Quarter 2008):

1. Prepared and submitted this Second Quarter 2008 Status Report (contained herein).
2. Conduct Third Quarter 2008 semi-annual ground-water monitoring/sampling event.

QUARTERLY RESULTS SUMMARY:

Current phase of project:	Ground-Water Monitoring/Sampling
Frequency of ground-water monitoring:	Semi-Annually (1Q & 3Q): A-1, A-2, A-3, A-4, A-5, A-6, AR-1, AR-2, ADR-1, ADR-2
Frequency of ground-water sampling:	Semi-Annually (1Q & 3Q): Wells A-1, A-5, A-6, ADR-1 Annually (3Q): Wells A-2, AR-1, AR-2, ADR-2
Is free product (FP) present on-site:	No
FP recovered this quarter:	None
Cumulative FP recovered:	4.8 gallons: Wells ADR-1 and ADR-2
Current remediation techniques:	Soil Vapor Extraction System shut down in December 2001
Depth to ground water (below TOC):	NA
General ground-water flow direction:	NA
Approximate hydraulic gradient:	NA

DISCUSSION:

No environmental activities took place at the Site during this quarter. The most recent data can be referenced in the First Quarter 2008 Semi-Annual Ground-Water Monitoring Report for the Site. A Ground-Water Elevation Contour and Analytical Summary Map from First Quarter 2008 is provided as Drawing 1.

ATTACHMENTS:

Drawing 1. Ground-Water Elevation Contour and Analytical Summary Map, 22 February 2008, ARCO Service Station #2169, 889 West Grand Avenue, Oakland, California

WEST GRAND AVENUE

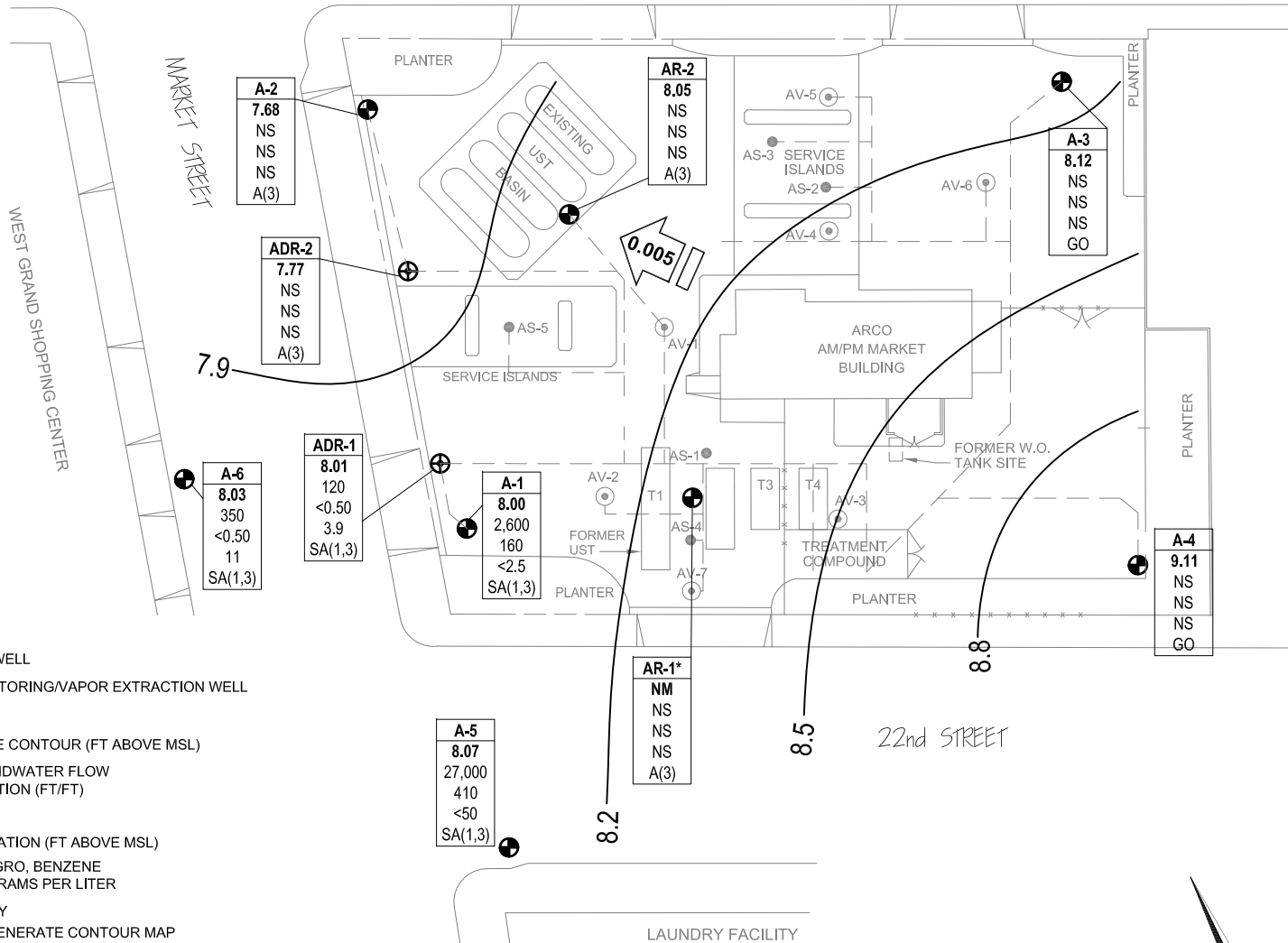

LEGEND

- ⊕ MONITORING WELL
 - ⊙ VAPOR EXTRACTION WELL
 - ⊕⊙ GROUNDWATER MONITORING/VAPOR EXTRACTION WELL
 - AIR SPARGING WELL
 - 8.8 GROUNDWATER TABLE CONTOUR (FT ABOVE MSL)
 - ← 0.005 APPROXIMATE GROUNDWATER FLOW GRADIENT AND DIRECTION (FT/FT)
- | Well | WELL DESIGNATION |
|---------|--|
| ELEV | GROUNDWATER ELEVATION (FT ABOVE MSL) |
| GRO | CONCENTRATION OF GRO, BENZENE AND MTBE IN MICROGRAMS PER LITER |
| Benzene | |
| MTBE | |
- A/Q — SAMPLING FREQUENCY
 - * WELL NOT USED TO GENERATE CONTOUR MAP
 - < NOT DETECTED AT OR ABOVE LABORATORY REPORTING LIMIT
 - NS NOT SAMPLED
 - A(3) SAMPLED ANNUALLY, 3RD QUARTER
 - SA SAMPLED SEMI-ANNUALLY, 1ST & 3RD QUARTERS
 - GO GAUGE ONLY
 - — REMEDIATION PIPING

NOTE: SITE MAP ADAPTED FROM IT CORPORATION FIGURES. SITE DIMENSIONS AND FACILITY LOCATIONS NOT VERIFIED.

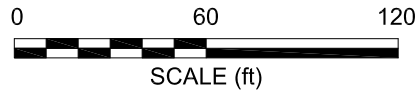
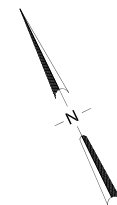

BROADBENT & ASSOCIATES, INC.
 ENGINEERING, WATER RESOURCES & ENVIRONMENTAL
 1324 Mangrove Ave. Suite 212, Chico, California 95926
 Project No.: 06-08-621 Date: 4/23/08

ARCO Service Station #2169
 889 West Grand Avenue
 Oakland, California

Ground-Water Elevation Contour
 and Analytical Summary Map
 22 February 2008

Drawing

1