

RECEIVED

By Alameda County Environmental Health at 3:33 pm, Feb 03, 2014

Atlantic Richfield Company

Chuck Carmel
Project Manager

PO Box 1257
San Ramon, CA 94583
Phone: (925) 275-3803
Fax: (925) 275-3815
E-Mail: charles.carmel@bp.com

January 27, 2014

Re: Fourth Quarter 2013 Status Report
Atlantic Richfield Company Station #2169
889 West Grand Avenue, Oakland, California
ACEH Case #RO0000072

"I declare, that to the best of my knowledge at the present time, that the information and/or recommendations contained in the attached document are true and correct.

Submitted by,



Chuck Carmel
Project Manager

Attachment



BROADBENT

1370 Ridgewood Drive, Suite 5, Chico, CA 95973

[T] 530-566-1400 [F] 530-566-1401

broadbentinc.com

CREATING SOLUTIONS. BUILDING TRUST.

January 27, 2014

Project No. 06-88-621

Atlantic Richfield Company
P.O. Box 1257
San Ramon, CA 94583
Submitted via ENFOS

Attn.: Mr. Chuck Carmel

Re: Fourth Quarter 2013 Status Report, Atlantic Richfield Company Station #2169,
889 West Grand Avenue, Oakland, California; ACEH Case #RO0000072

Dear Mr. Carmel:

Attached is the Fourth Quarter 2013 Status Report for Atlantic Richfield Company Station #2169 located at 889 West Grand Avenue, Oakland, California. This report presents a summary of current developments at the Site through the Fourth Quarter of 2013.

Should you have questions regarding this submittal, please do not hesitate to contact us at (530) 566-1400.

Sincerely,

BROADBENT & ASSOCIATES, INC.

Jason Duda
Project Scientist

Robert H. Miller, P.G., C.HG
Principal Hydrogeologist

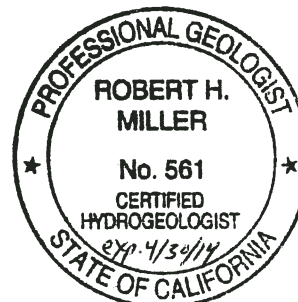

Enclosures

cc: Mr. Keith Nowell, Alameda County Environmental Health (submitted via ACEH ftp site)
Electronic copy uploaded to GeoTracker

**FOURTH QUARTER 2013
STATUS REPORT
ARCO STATION #2169, OAKLAND, CALIFORNIA**

Broadbent & Associates, Inc. (Broadbent) is pleased to present this *Fourth Quarter 2013 Status Report* on behalf of Atlantic Richfield Company (a BP affiliated company) for ARCO Station #2169 located in Oakland, Alameda County, California. Quarterly reporting is being submitted to the Alameda County Environmental Health Services Agency (ACEH) consistent with their requirements under the legal authority of the California Regional Water Quality Control Board as codified by California Code of Regulations Title 23, Section 2652(d). A summary description of current developments regarding the Site is provided below.

Facility Name / Address:	ARCO Station #2169 / 889 West Grand Avenue, Oakland
Client Project Manager / Title:	Mr. Chuck Carmel / RM Project Manager
Broadbent Contact:	Jason Duda / (530) 566-1400
Broadbent Project No.:	06-88-621
Primary Regulatory Agency / ID No.:	ACEH, Case #RO0000072
Current phase of project:	Monitoring, Site Evaluation
List of Acronyms / Abbreviations:	See end of report text for list of acronyms/abbreviations used in report.

WORK PERFORMED THIS QUARTER (Fourth Quarter 2013):

1. Submitted *Third Quarter 2013 Monitoring Report* (Broadbent, 10/24/2013).
2. No environmental field work was conducted at Station #2169 during the Fourth Quarter of 2013.

WORK SCHEDULED FOR NEXT QUARTER (First Quarter 2014):

1. Submit *Fourth Quarter 2013 Status Report* (contained herein).
2. Conduct groundwater monitoring/sampling for First Quarter 2014.
3. Prepare and submit Conceptual Site Model report.

DISCUSSION:

No environmental field activities took place at the Site during Fourth Quarter 2013. For reference, a Site Location Map is provided as Drawing 1. Provided as Drawing 2 is the Groundwater Elevation Contour and Analytical Summary Map from the *Third Quarter 2013 Monitoring Report* (Broadbent, 10/24/2013). The next groundwater monitoring and sampling event is scheduled to be conducted during the First Quarter 2014. A Conceptual Site Model is anticipated to be completed during the First Quarter 2014.

ATTACHMENTS:

- Drawing 1: Site Location Map
Drawing 2: Groundwater Elevation Contour and Analytical Summary Map, August 8, 2013

LIST OF COMMONLY USED ACCRONYMS/ABBREVIATIONS:

ACEH:	Alameda County Environmental Health	ft/ft:	feet per foot
ACPWA:	Alameda County Public Works Agency	gal:	Gallons
APN:	Assessor's Parcel Number	GRO:	Gasoline-Range Organics
BTEX:	Benzene, Toluene, Ethylbenzene, Total Xylenes	LNAPL:	Light Non-Aqueous Phase Liquid
1,2-DCA:	1,2-Dichloroethane	MTBE:	Methyl Tertiary Butyl Ether
DIPE:	Di-Isopropyl Ether	NO ₃ :	Nitrate as Nitrogen
DO:	Dissolved Oxygen	ppb:	parts per billion
DRO:	Diesel-Range Organics	SO ₄ :	Sulfate
EDB:	1,2-Dibromomethane	TAME:	Tert-Amyl Methyl Ether
Eh:	Oxidation Reduction Potential	TBA:	Tertiary Butyl Ether
EPA:	Environmental Protection Agency	TOC:	Top of Casing
ETBE:	Ethyl Tertiary Butyl Ether	ROW:	Right of way
Fe ²⁺ :	Ferrous Iron	µg/L:	micrograms per liter

DRAWINGS

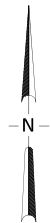

APPROXIMATE SCALE (mi)

IMAGE SOURCE: DELORME



BROADBENT
1370 Ridgewood Drive, Suite 5
Chico, California 95973

Project No.: 06-88-621 Date: 4/17/2013

ARCO Station #2169
889 West Grand Avenue
Oakland, California

Site Location Map

Drawing

1

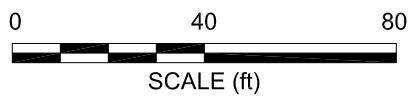
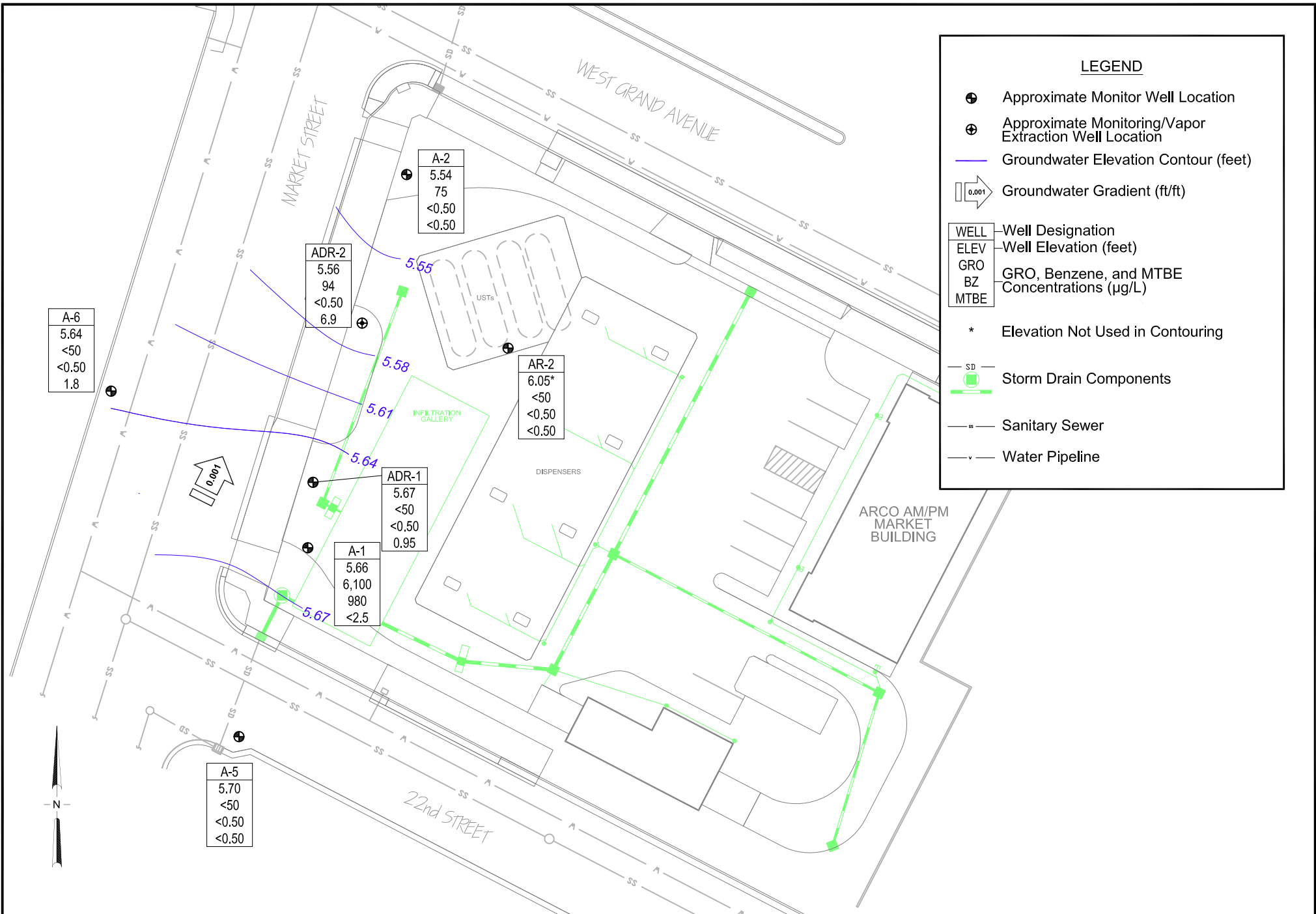

BROADBENT
 1370 Ridgewood Dr., Suite 5
 Chico, California 95973
 Project No.: 06-88-621 Date: 9/02/2013

ARCO Station #2169
 889 West Grand Avenue
 Oakland, California

Groundwater Elevation Contours and
 Analytical Summary Map
 August 8, 2013