

Detterman, Mark, Env. Health

From: cuadrado, claudia [ccuadrado@EKICONCONSULT.COM]
Sent: Thursday, May 12, 2011 2:15 PM
To: 'Thomas Price'
Cc: Detterman, Mark, Env. Health; james, earl
Subject: RE: Site A figures
Attachments: SiteA_RMP_July2000_Figure12.pdf; SiteA_RMP_July2000_Figure4.pdf;
SiteA_RMP_July2000_Figure5.pdf; SiteA_RMP_July2000_Figure6.pdf;
SiteA_RMP_July2000_Figure7.pdf; SiteA_RMP_July2000_Figure8.pdf;
SiteA_RMP_July2000_Figure9.pdf

Hi Tom,

Attached are the requested figures in pdf format. Please note that Figure 12 corresponds to Figure 10 in the text. Please let me know if you have any questions.

Thanks,

Claudia

-----Original Message-----

From: Thomas Price [<mailto:TPrice@dtsc.ca.gov>]
Sent: Thursday, May 12, 2011 1:37 PM
To: cuadrado, claudia
Cc: Mark Env. Health Detterman; james, earl
Subject: Re: Site A figures

The report is entitled "Environmental Risk Management Plan" dated 7/26/2000, Figures 4-10. Are those available in electronic format? I need those for uploading to DTSC's Envirostor database. These are oversized drawings and DTSC's scanning capability is quite limited so if you can provide that is would be very helpful. Also please cc Mark Detterman, P.G. of Alameda County Environmental Health.

Thank you,

Tom Price - Project Manager
Brownfields and Environmental Restoration Program Dep't Toxic Substances Control 700 Heinz Avenue Berkeley, CA 94710
phone: (510) 540-3811
fax: (510) 540-3819
email: tprice@dtsc.ca.gov

>>> "cuadrado, claudia" <ccuadrado@EKICONCONSULT.COM> 5/12/2011 1:18 PM >>>

Hi Tom,

Earl told me that you are interested in getting some Site A figures from a report dated 30 July 2000. Could you please let me know the title of the report and which figures you would like to get?

Thanks,

Claudia

Claudia Cuadrado, P.E.
Erlar & Kalinowski, Inc.
1870 Ogden Drive
Burlingame, CA 94010
ph. 650.292.9100

fax 650.552.9012

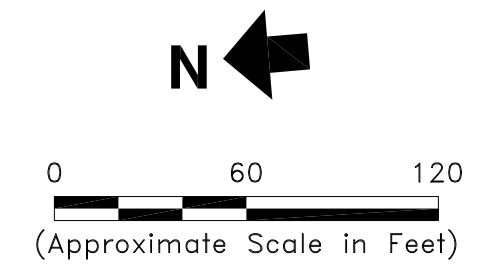

High pH Area
pH Values of 13 Observed in Soil and Groundwater in this Area

South Temescal Creek Area
FORMER WARBURTON PROPERTY

Myers Drum Site

North Temescal Creek Area
Northern Area of the Shellmound Properties

Southern Area of the Shellmound Properties

ELEMENTIS PROPERTY

SEPULVEDA PROPERTY

OLD SHELLMOUND STREET RIGHT-OF-WAY

Former Shellmound Parcel I

Former Shellmound Parcel II

Former Shellmound Parcel III

LEGEND

- ⊕ Monitoring Well Location by Others
- ▲ EKI CPT/PIPP Groundwater Sample Location (June/July 1997)
- EKI Soil Sample Location (June 1997)
- ⊕ EKI Grab Groundwater Sample Location (September 1997)
- ◆ LFR Monitoring Well Location (December 1997)
- △ Temescal Creek Sample Location (October 1998)
- ⊗ EKI Grab Groundwater and or Soil Sample Location (September/October 1998)
- EKI Surface Soil Sample Location (June 1997)
- ⊗ Storm Drain Manhole
- LFR Soil Boring Location (December 1997)
- ◆ LFR Soil Boring w/Hydropunch Location (December 1997)
- ⊕ LFR Monitoring Well Location (June 1998)
- ▲ LFR Soil Boring Location (June 1998)
- Soil Sample Location by Others
- ⊕ Hydropunch Grab Groundwater Location by TRC Environmental (May 1993)
- TRC Soil Sampling Location (1991 - 1993)
- ⊕ TRC Monitoring Well Location (1991 - 1993)
- Barbary Coast Steel Soil and Groundwater Sampling Location (AGI, 1995)
- Limit of Excavation
- ▲ Soil and Groundwater Sampling Locations by AGI Technologies (April 1994)
- ⊕ Soil Sampling Locations by Earth Metrics
- Soil Sample Collected During or After Demolition Activities
- ⊕ B74 Soil Boring Locations by EKI (June and July 1999)
- ⊕ URS-41 Soil Boring Locations by URS Greiner Woodward Clyde (June 1999)
- Sanitary Sewer
- 60-Inch Storm Drain
- South Bayfront Project Area
- Former Property Boundaries
- Remediation Trench
- ▭ Areas of Completed Environmental Excavations
- ▭ High pH Area

Future Use Areas

- ▭ Proposed Ground-Level Commercial Use/Air-Rights Urban Residential
- ▭ Proposed Ground-Level Commercial Use
- ▭ Proposed Ground-Level Parking or Roadway
- ▭ Blank Areas within Project Area Denote Proposed Landscaping, Sidewalks or Plaza Area

Notes:

1. All locations are approximate.
2. Base map from Mark Thomas & Co. (September 1998).
3. EKI sampling locations from Kister, Savio & Rei, Inc. and Mark Thomas & Co. surveys. Coordinates are based on California Coordinate System Zone III, of 1972.
4. LFR sampling locations provided electronically by LFR in July 1998.
5. Myers site sampling locations from TRC (1996).

Erler & Kalinowski, Inc.

High pH Area
Earl D. James
Express Witness Reports
Emeryville, CA
November 2000
EKI 990093.00
Figure 12

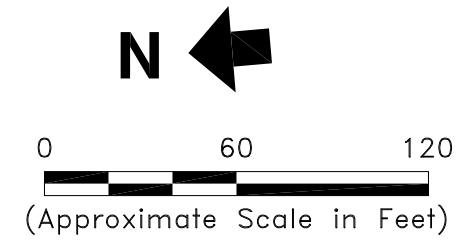

Estimated Area of Potential Hydrogen Sulfide Gas Generation in Subsurface Soils

LEGEND

- ⊕ Abandoned Monitoring Well Location by Others
- ▲ EKI CPT/PIPP Groundwater Sample Location (June/July 1997)
- EKI Soil Sample Location (June 1997)
- ⊕ EKI Grab Groundwater Sample Location (September 1997)
- ⊕ Abandoned LFR Monitoring Well Location (December 1997)
- △ Temescal Creek Sample Location (October 1998)
- ⊗ EKI Grab Groundwater and/or Soil Sample Location (September/October 1998)
- EKI Surface Soil Sample Location (June 1997)
- ⊙ Storm Drain Manhole
- ⊕ LFR Soil Boring Location (December 1997)
- ◆ LFR Soil Boring w/Hydropunch Location (December 1997)
- ⊕ Abandoned LFR Monitoring Well Location (June 1998)
- ▲ LFR Soil Boring Location (June 1998)
- ⊕ Soil Sample Location by Others
- ⊕ Hydropunch Grab Groundwater Location by TRC Environmental (May 1993)
- TRC Soil Sampling Location (1991 - 1993)
- TRC Soil Sampling Location (1998)
- ⊕ Abandoned TRC Monitoring Well Location
- ⊕ TRC Monitoring Well Location (1991 - 1993) (Soil Samples Collected from Some Boreholes)
- Barbary Coast Steel Soil and Groundwater Sampling Location (AGI, 1995)
- ▲ Soil and Groundwater Sampling Locations by AGI Technologies (April 1995)
- ⊕ Soil Sampling Locations by Earth Metrics (1987 - 1988)
- ⊕ B74 Soil Boring Locations by EKI (June and July 1999)
- ⊕ URS-41 Soil Boring Locations by URS Greiner Woodward Clyde (June 1999)
- ⊕ Soil/Groundwater Locations by EKI (January and March 1999)
- EDJ1 Test Pit Location (November 4, 1999)
- Sanitary Sewer
- 60-Inch Storm Drain
- South Bayfront Project Area
- Former Property Boundaries

- NA — Not Analyzed
- (4,100) — Hydrogen Sulfide Generally Detected in Pre-Excavation Bag Sample in Parts Per Million (ppmv). See Note 7.
- 6 (0.11) — Depth in Feet of Initial Hydrogen Sulfide Vapor Occurrence in Parts Per Million (ppmv) (Peak Concentration Measured with Hand Held Jerome Meter). See Note 8.
- 460 360 6.78 — Total Sulfide Measured in Unfiltered Sample (mg/L)
- Dissolved Sulfide Measured in 0.45 Filtered Sample (mg/L)

- Future Use Areas**
- Proposed Ground—Level Commercial Use/Air-Rights Urban Residential
 - Proposed Ground—Level Commercial Use
 - Proposed Ground—Level Parking or Roadway
 - Blank Areas within Project Area Denote Proposed Landscaping, Sidewalks or Plaza Area

Notes:

1. All locations are approximate.
2. Base map from Mark Thomas & Co. (September 1998).
3. EKI sampling locations from Kister, Savio & Rei, Inc., Mark Thomas & Co. and URS Greiner Woodward Clyde surveys. Coordinates are based on California Coordinate System Zone III, of 1927.
4. LFR sampling locations provided electronically by LFR in July 1998.
5. Myers site sampling locations from TRC (1996).
6. Most recent groundwater data utilized at each location, see data base in Appendix A of South Bayfront Project Risk Management Plan.
7. Hydrogen sulfide concentrations detected in pre-excitation bag samples collected from 6.0 to 12.0 feet below ground surface, reported in Appendix C of the South Bayfront Project Risk Management Plan.
8. Hydrogen sulfide concentrations detected in post-excitation test pits, reported in Appendix C of the South Bayfront Project Risk Management Plan.

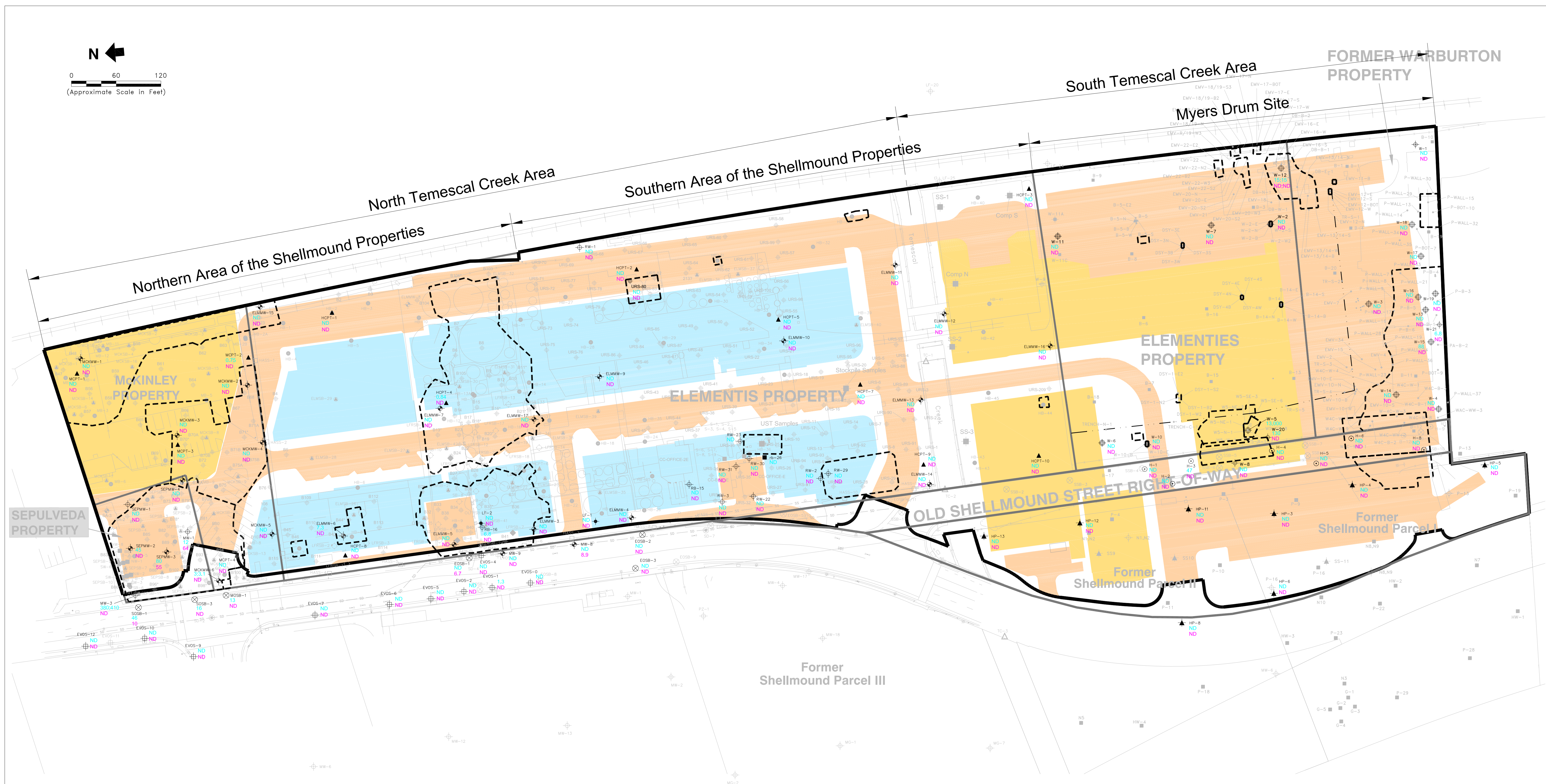
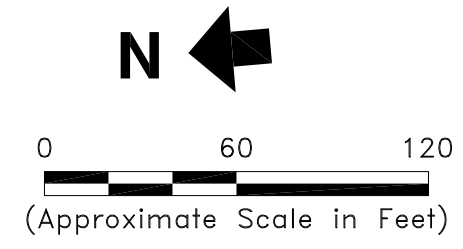

LEGEND

- ⊕ Abandoned Monitoring Well Location by Others
- ▲ EKI CPT/PIPP Groundwater Sample Location (June/July 1997)
- EKI Soil Sample Location (June 1997)
- ⊕ EKI Grab Groundwater Sample Location (September 1997)
- ⊕ Abandoned LFR Monitoring Well Location (December 1997)
- △ Temescal Creek Sample Location (October 1998)
- ⊗ EKI Grab Groundwater and/or Soil Sample Location (September/October 1998)
- EKI Surface Soil Sample Location (June 1997)
- ⊙ Storm Drain Manhole
- ⊕ LFR Soil Boring Location (December 1997)
- ◆ LFR Soil Boring w/Hydropunch Location (December 1997)
- ⊕ Abandoned LFR Monitoring Well Location (June 1998)
- ▲ LFR Soil Boring Location (June 1998)
- Soil Sample Location by Others
- ⊕ Hydropunch Grab Groundwater Location by TRC Environmental (May 1993)
- TRC Soil Sampling Location (1991 - 1993)
- TRC Soil Sampling Location (1998)
- ⊕ Abandoned TRC Monitoring Well Location
- ⊕ TRC Monitoring Well Location (1991 - 1993) (Soil Samples Collected from Some Boreholes)
- Barbary Coast Steel Soil and Groundwater Sampling Location (AGI, 1995)
- ▲ Soil and Groundwater Sampling Locations by AGI Technologies (April 1995)
- ⊕ Soil Sampling Locations by Earth Metrics (1987 - 1988)
- ⊕ B74 Soil Boring Locations by EKI (June and July 1999)
- ⊕ URS-41 Soil Boring Locations by URS Greiner Woodward Clyde (June 1999)
- ⊕ Soil/Groundwater Locations by EKI (January and March 1999)
- Sanitary Sewer
- 60-Inch Storm Drain
- South Bayfront Project Area
- Former Property Boundaries
- Remediation Trench
- - - Areas of Completed Environmental Excavations

- ND — Benzene Concentration in ug/L (Cyan Color)
- ND — Vinyl Chloride Concentration in ug/L (Magenta Color)
- 380.440 — Original Sample Concentration; Duplicate Sample Concentration in ug/L
- ND — Not Detected
- Future Use Areas**
- Light Blue — Proposed Ground-Level Commercial Use/Air-Rights Urban Residential
- Yellow — Proposed Ground-Level Commercial Use
- Orange — Proposed Ground-Level Parking or Roadway
- White — Blank Areas within Project Area Denote Proposed Landscaping, Sidewalks or Plaza Area

Notes:

1. All locations are approximate.
2. Base map from Mark Thomas & Co. (September 1998).
3. EKI sampling locations from Kister, Savio & Rei, Inc., Mark Thomas & Co. and URS Greiner Woodward Clyde surveys. Coordinates are based on California Coordinate System Zone III, of 1927.
4. LFR sampling locations provided electronically by LFR in July 1998.
5. Myers site sampling locations from TRC (1996).
6. Analysis of chemicals of concern in groundwater samples included on this figure were included in calculation of Site wide 95% UCL (See text Section 5).
7. If more than one sample taken, the most recent sampling result was used.

Erler & Kalinowski, Inc.
 Benzene and Vinyl Chloride in Groundwater (ug/L)
 Environmental Risk Management Plan
 South Bayfront Properties
 Emeryville, CA
 June 2000
 EKI 970003.27
 Figure 8

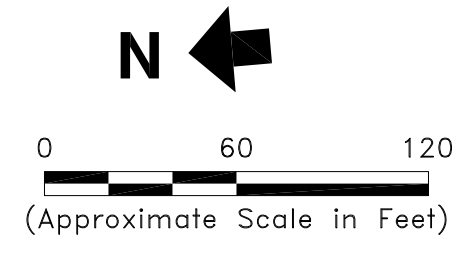

LEGEND

- | | | |
|--|--|---|
| <ul style="list-style-type: none"> ⊕ Monitoring Well Location by Others ▲ EKI CPT/PIPP Groundwater Sample Location (June/July 1997) ● EKI Soil Sample Location (June 1997) ⊕ EKI Grab Groundwater Sample Location (September 1997) ⊕ LFR Monitoring Well Location (December 1997) △ Temescal Creek Sample Location (October 1998) ⊗ EKI Grab Groundwater and/or Soil Sample Location (September/October 1998) □ EKI Surface Soil Sample Location (June 1997) ⊗ Storm Drain Manhole ⊕ LFR Soil Boring Location (December 1997) ◆ LFR Soil Boring w/Hydropunch Location (December 1997) | <ul style="list-style-type: none"> ⊕ LFR Monitoring Well Location (June 1998) ▲ LFR Soil Boring Location (June 1998) ● Soil Sample Location by Others ⊕ Hydropunch Grab Groundwater Location by TRC Environmental (May 1993) ■ TRC Soil Sampling Location (1991 - 1993) ● TRC Soil Sampling Location (1998) ⊕ TRC Monitoring Well Location (1991 - 1993) (Soil Samples Collected from Some Boreholes) ● Barbary Coast Steel Soil and Groundwater Sampling Location (AGI, 1995) ▲ Soil and Groundwater Sampling Locations by AGI Technologies (April 1995) ⊕ Soil Sampling Locations by Earth Metrics (1987 - 1988) ● Confirmation Sample Location | <ul style="list-style-type: none"> ⊕ B74 Soil Boring Locations by EKI (June and July 1999) ⊕ URS-41 Soil Boring Locations by URS Greiner Woodward Clyde (June 1999) ⊕ Soil/Groundwater Locations by EKI (January and March 1999) — Sanitary Sewer — 60-Inch Storm Drain — South Bayfront Project Area — Former Property Boundaries — Remediation Trench — Areas of Completed Environmental Excavations — Compositing Scheme for Borings by URS Greiner Woodward Clyde (June 1999) |
|--|--|---|

- 1,800 — Benzene Concentration in ug/kg
- 24/10 — Original Sample Result; Duplicate Sample Result
- (ND) — Composite Sample Result in ug/kg
- ND — Not Detected (Detection Limit Below 670 ug/kg)
- ND* — Not Detected (Detection Limit Above the PRG e.g. 670 ug/kg)

- Future Use Areas**
- Light Blue: Proposed Ground-Level Commercial Use/Air-Rights Urban Residential
 - Yellow: Proposed Ground-Level Commercial Use
 - Orange: Proposed Ground-Level Parking or Roadway
 - White: Blank Areas within Project Area Denote Proposed Landscaping, Sidewalks or Plaza Area

Notes:

1. All locations are approximate.
2. Base map from Mark Thomas & Co. (September 1998).
3. EKI sampling locations from Kister, Savio & Rei, Inc., Mark Thomas & Co. and URS Greiner Woodward Clyde surveys. Coordinates are based on California Coordinate System Zone III, of 1927.
4. LFR sampling locations provided electronically by LFR in July 1998.
5. Myers site sampling locations from TRC (1996).
6. Analysis of chemicals of concern in soil samples collected from boreholes included on this figure were included in calculation of Site wide 95% UCL (See text Section 5).
7. If more than one sample taken, the highest detected sampling result was used.

Erler & Kalinowski, Inc.

Residual Benzene in Soil (ug/kg)
0-6.5 Feet
Environmental Risk Management Plan
South Bayfront Properties
Emeryville, CA
June 2000
EKI 970003.27
Figure 7

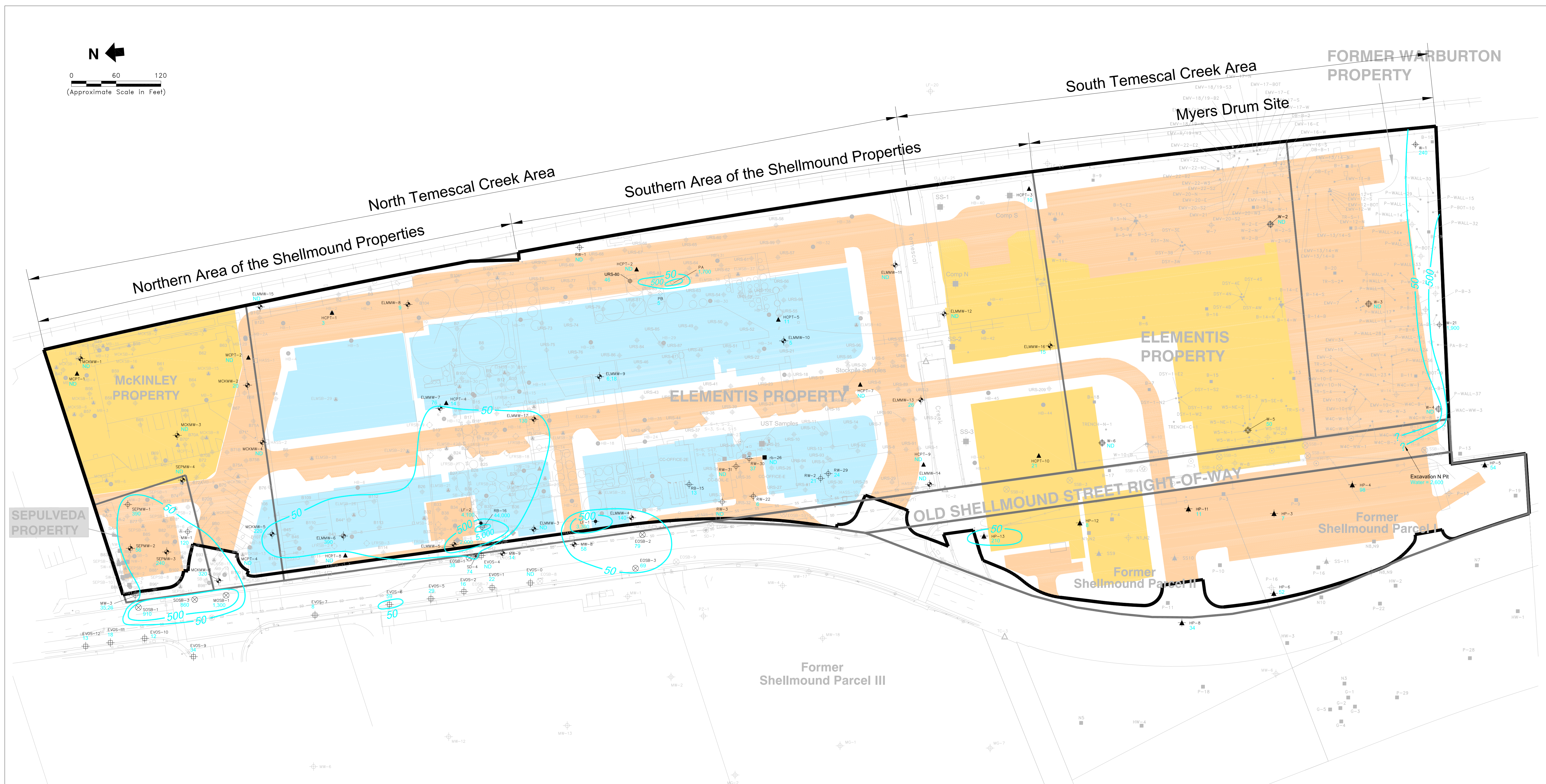
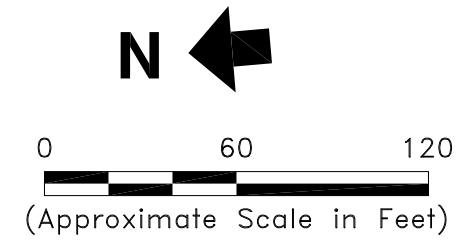

LEGEND

- | | | |
|--|--|---|
| <ul style="list-style-type: none"> ⊕ Abandoned Monitoring Well Location by Others ▲ EKI CPT/PIPP Groundwater Sample Location (June/July 1997) ● EKI Soil Sample Location (June 1997) ⊕ EKI Grab Groundwater Sample Location (September 1997) ⊕ Abandoned LFR Monitoring Well Location (December 1997) △ Temescal Creek Sample Location (October 1998) ⊗ EKI Grab Groundwater and/or Soil Sample Location (September/October 1998) □ EKI Surface Soil Sample Location (June 1997) ⊙ Storm Drain Manhole ⊕ LFR Soil Boring Location (December 1997) ◆ LFR Soil Boring w/Hydropunch Location (December 1997) | <ul style="list-style-type: none"> ⊕ Abandoned LFR Monitoring Well Location (June 1998) ▲ LFR Soil Boring Location (June 1998) ● Soil Sample Location by Others ⊕ Hydropunch Grab Groundwater Location by TRC Environmental (May 1993) ■ TRC Soil Sampling Location (1991 - 1993) ● TRC Soil Sampling Location (1998) ⊕ Abandoned TRC Monitoring Well Location ⊕ TRC Monitoring Well Location (1991 - 1993) (Soil Samples Collected from Some Boreholes) ● Barbary Coast Steel Soil and Groundwater Sampling Location (AGI, 1995) ▲ Soil and Groundwater Sampling Locations by AGI Technologies (April 1995) ⊕ Soil Sampling Locations by Earth Metrics (1987 - 1988) | <ul style="list-style-type: none"> ⊕ B74 Soil Boring Locations by EKI (June and July 1999) ⊕ URS-41 Soil Boring Locations by URS Greiner Woodward Clyde (June 1999) ⊕ Soil/Groundwater Locations by EKI (January and March 1999) — Sanitary Sewer — 60-Inch Storm Drain — South Bayfront Project Area — Former Property Boundaries |
|--|--|---|

- 4,100 — Arsenic Concentration in ug/L
 - 6,18 — Original Arsenic Concentration; Duplicate Arsenic Concentration in ug/L
 - ND — Not Detected
 - 500 — 500 ug/L Arsenic Concentration Contour for Upper-Most Shallow Zone
- Future Use Areas**
- Proposed Ground-Level Commercial Use/Air-Rights Urban Residential
 - Proposed Ground-Level Commercial Use
 - Proposed Ground-Level Parking or Roadway
 - Blank Areas within Project Areas Denote Proposed Landscaping, Sidewalks or Plaza Area

Notes:

1. All locations are approximate.
2. Base map from Mark Thomas & Co. (September 1998).
3. EKI sampling locations from Kister, Savio & Rei, Inc., Mark Thomas & Co. and URS Greiner Woodward Clyde surveys. Coordinates are based on California Coordinate System Zone III, of 1927.
4. LFR sampling locations provided electronically by LFR in July 1998.
5. Myers site sampling locations from TRC (1996).
6. Most recent data utilized at each location, see data base in Appendix A of South Bayfront Project Risk Management Plan.
7. If more than one sample taken, the most recent sampling data was used.

Erler & Kalinowski, Inc.
 Arsenic in Groundwater (ug/L)
 Isoconcentration Contour
 Environmental Risk Management Plan
 South Bayfront Properties
 Emeryville, CA
 June 2000
 EKI 970003.27
 Figure 6

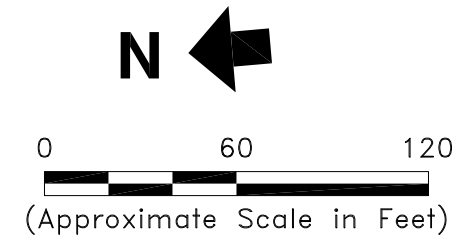

LEGEND

- ⊕ Monitoring Well Location by Others
- ▲ EKI CPT/PIPP Groundwater Sample Location (June/July 1997)
- EKI Soil Sample Location (June 1997)
- ⊕ EKI Grab Groundwater Sample Location (September 1997)
- ⊕ LFR Monitoring Well Location (December 1997)
- △ Temescal Creek Sample Location (October 1998)
- ⊗ EKI Grab Groundwater and/or Soil Sample Location (September/October 1998)
- EKI Surface Soil Sample Location (June 1997)
- ⊗ Storm Drain Manhole
- ⊕ LFR Soil Boring Location (December 1997)
- ◆ LFR Soil Boring w/Hydropunch Location (December 1997)
- ⊕ LFR Monitoring Well Location (June 1998)
- ▲ LFR Soil Boring Location (June 1998)
- Soil Sample Location by Others
- ⊕ Hydropunch Grab Groundwater Location by TRC Environmental (May 1993)
- TRC Soil Sampling Location (1991 - 1993)
- TRC Soil Sampling Location (1998)
- ⊕ TRC Monitoring Well Location (1991 - 1993) (Soil Samples Collected from Some Boreholes)
- Barbary Coast Steel Soil and Groundwater Sampling Location (AGI, 1995)
- ▲ Soil and Groundwater Sampling Locations by AGI Technologies (April 1995)
- ⊕ Soil Sampling Locations by Earth Metrics (1987 - 1988)
- Confirmation Soil Sample
- ⊕ B74 Soil Boring Locations by EKI (June and July 1999)
- ⊕ URS-41 Soil Boring Locations by URS Greiner Woodward Clyde (June 1999)
- ⊕ Soil/Groundwater Locations by EKI (January and March 1999)
- SS — Sanitary Sewer
- SD — 60-Inch Storm Drain
- SBP — South Bayfront Project Area
- F — Former Property Boundaries
- R — Remediation Trench
- E — Areas of Completed Environmental Excavations
- M — Compositing Scheme for Borings by URS Greiner Woodward Clyde (June 1999)

- 15 — Arsenic Concentration in mg/kg
- (9) — Composite Sample Result in mg/kg
- ND — Not Detected

Future Use Areas

- Proposed Ground-Level Commercial Use/Air-Rights Urban Residential
- Proposed Ground-Level Commercial Use
- Proposed Ground-Level Parking or Roadway
- Blank Areas within Project Area Denote Proposed Landscaping, Sidewalks or Plaza Area

Notes:

1. All locations are approximate.
2. Base map from Mark Thomas & Co. (September 1998).
3. EKI sampling locations from Kister, Savio & Rei, Inc., Mark Thomas & Co. and URS Greiner Woodward Clyde surveys. Coordinates are based on California Coordinate System Zone III, of 1927.
4. LFR sampling locations provided electronically by LFR in July 1998.
5. Myers site sampling locations from TRC (1996).
6. Analysis of chemicals of concern in soil samples collected from boreholes included on this figure were included in calculation of Site wide 95% UCL (See text Section 5).
7. If samples were taken at multiple depths from the same location, the highest detected sampling result was used.

Erler & Kalinowski, Inc.
 Residual Arsenic in Soil (mg/kg)
 0-6.5 Feet
 Environmental Risk Management Plan
 South Bayfront Properties
 Emeryville, CA
 June 2000
 EKI 970003.27
 Figure 5

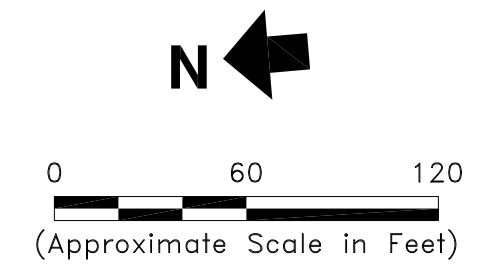

LEGEND

- ⊕ Monitoring Well Location by Others
- ▲ EKI CPT/PIPP Groundwater Sample Location (June/July 1997)
- EKI Soil Sample Location (June 1997)
- ⊕ EKI Grab Groundwater Sample Location (September 1997)
- ◆ LFR Monitoring Well Location (December 1997)
- △ Temescal Creek Sample Location (October 1998)
- ⊗ EKI Grab Groundwater and or Soil Sample Location (September/October 1998)
- EKI Surface Soil Sample Location (June 1997)
- ⊗ Storm Drain Manhole
- LFR Soil Boring Location (December 1997)
- ◆ LFR Soil Boring w/Hydropunch Location (December 1997)
- ⊕ LFR Monitoring Well Location (June 1998)
- ▲ LFR Soil Boring Location (June 1998)
- Soil Sample Location by Others
- ⊕ Hydropunch Grab Groundwater Location by TRC Environmental (May 1993)
- TRC Soil Sampling Location (1991 - 1993)
- ⊕ TRC Monitoring Well Location (1991 - 1993)
- Barbary Coast Steel Soil and Groundwater Sampling Location (AGI, 1995)
- Limit of Excavation
- ▲ Soil and Groundwater Sampling Locations by AGI Technologies (April 1994)
- ⊕ Soil Sampling Locations by Earth Metrics
- Soil Sample Collected During or After Demolition Activities
- ⊕ B74 Soil Boring Locations by EKI (June and July 1999)
- ⊕ URS-41 Soil Boring Locations by URS Greiner Woodward Clyde (June 1999)
- Sanitary Sewer
- 60-Inch Storm Drain
- South Bayfront Project Area
- Former Property Boundaries
- Remediation Trench
- Areas of Completed Environmental Excavations
- ▨ Areas of 2000 Soil Excavations (See Appendices H, I and J)

Future Use Areas

- Proposed Ground-Level Commercial Use/Air-Rights Urban Residential
- Proposed Ground-Level Commercial Use
- Proposed Ground-Level Parking or Roadway
- Blank Areas within Project Area Denote Proposed Landscaping, Sidewalks or Plaza Area

Notes:

1. All locations are approximate.
2. Base map from Mark Thomas & Co. (September 1998).
3. EKI sampling locations from Kister, Savio & Rei, Inc. and Mark Thomas & Co. surveys. Coordinates are based on California Coordinate System Zone III, of 1927.
4. LFR sampling locations provided electronically by LFR in July 1998.
5. Myers site sampling locations from TRC (1996).

FORMER WARBURTON PROPERTY

South Temescal Creek Area

Myers Drum Site

North Temescal Creek Area

Northern Area of the Shellmound Properties

Southern Area of the Shellmound Properties

ELEMENTIS PROPERTY

SEPULVEDA PROPERTY

Former Shellmound Parcel III

OLD SHELLMOUND STREET RIGHT-OF-WAY

Former Shellmound Parcel II

Former Shellmound Parcel I

Erler & Kalinowski, Inc.

Soil, Groundwater, and Surface Water Sampling Locations
Environmental Risk Management Plan
South Bayfront Properties
Emeryville, CA
June 2000
EKI 970003.27
Figure 4