

Attachment 3
6.4.01



#1
1/2

August 5, 1986

Emery 07148

Mr. Thomas J. Gram
East Bay Park Company
5901 Christie Avenue
Suite 403
Emeryville, CA 94608

RE: 5500 Eastshore Highway
Emeryville, CA

Dear Tom:

Please consider this notice of removal of the underground tanks from the referenced property. Enclosed are the results of the initial soil tests made at the time of removal. Per our engineer, the results of additional testing will be received on August 6 and I have requested that the additional test results and his recommendations be hand delivered to your office by Thursday, August 7. I am hopeful this will enable you to waive the soil conditions and proceed with the contract by Friday, August 8.

f. s. 16

TANK REMOVAL PRS

As outlined in Blymyer's letter, we have committed a total expenditure of \$59,496. Depending upon your election to proceed or withdraw, we will forward the appropriate invoices upon their receipt.

Sincerely,

Robert W. Weaver
Director of Properties
and Real Estate

RWW:rd

Encls.

cc: John Mangu

← NORTH

Key

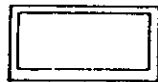

TANK EXCAVATION

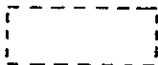

REMOVED TANK (LABELED)



INITIAL SOIL SAMPLE



ADDITIONAL SOIL, WATER, SAMPLE

OGT-1

OGT-2

OGT-3

OGT-4

#1
2/2

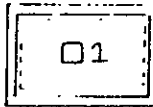

WASTE OIL

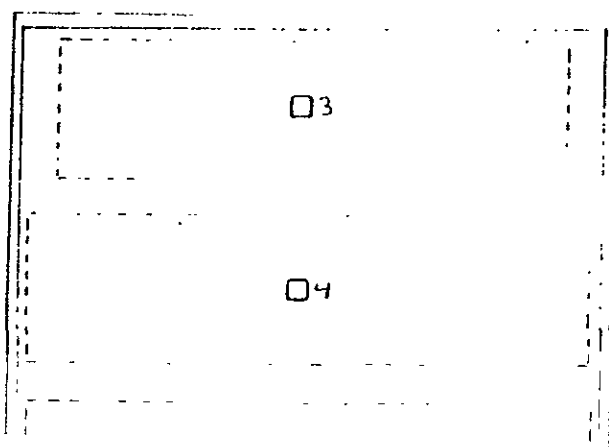
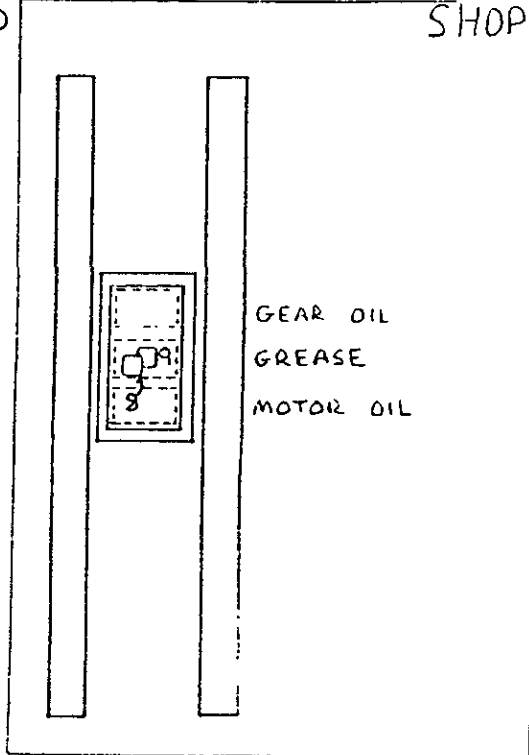

MOTOR OIL

GASOLINE

OGT-5

NO. 707	PIE NATIONAL
DATE 8/17/82	TANK EXCAVATIONS
	SAMPLING LOCATIONS
9527	SC-2

Soil & Water

#2 091

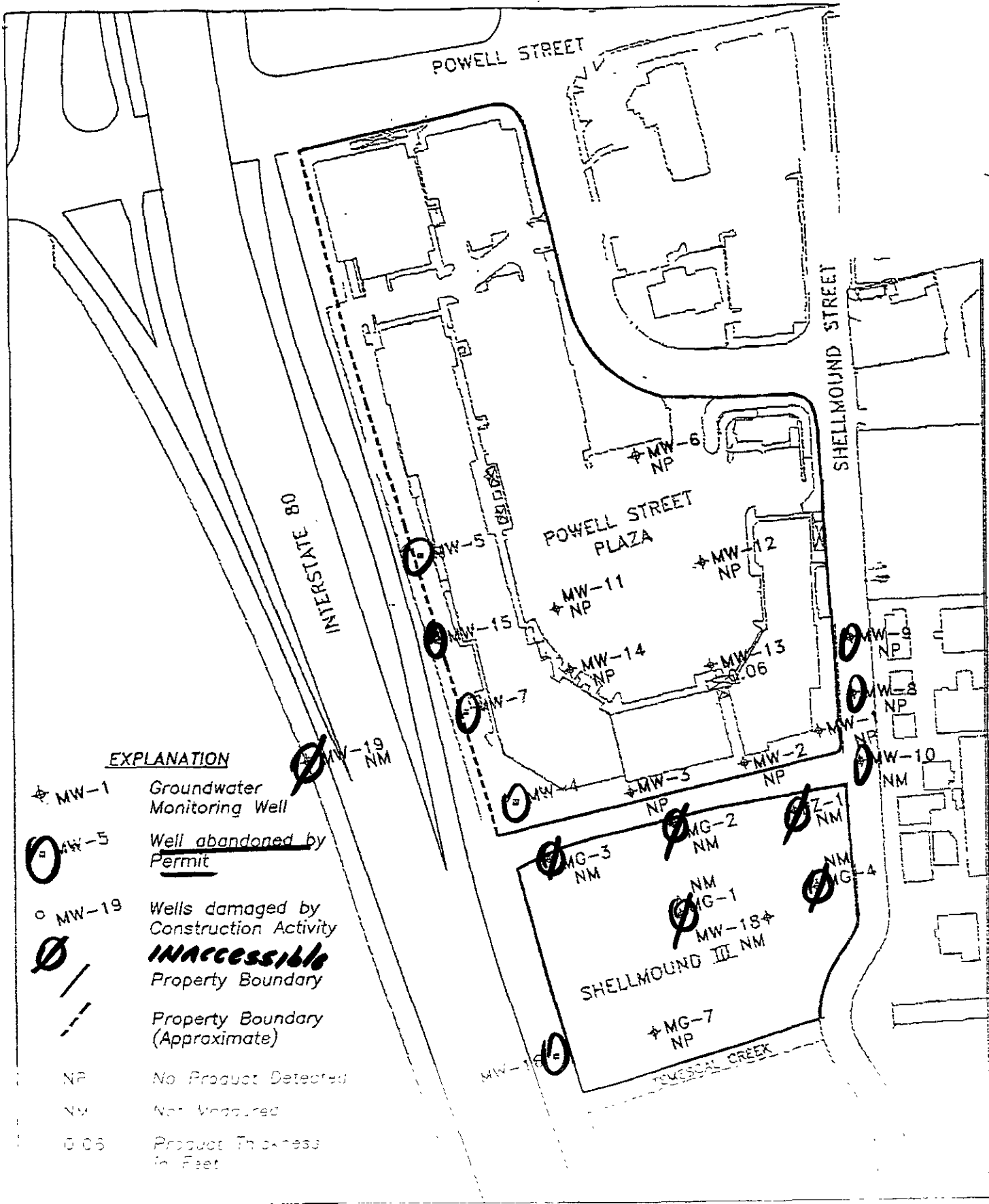

EXPLANATION

- ★ MW-1 Groundwater Monitoring Well
- MW-5 Well abandoned by Permit
- MW-19 Wells damaged by Construction Activity
- ⊗ **INACCESSIBLE**
- Property Boundary
- - - Property Boundary (Approximate)
- NP No Product Detected
- NM Not Measured
- 0.06 Product Thickness in Feet



PES Environmental, Inc.
Engineering & Environmental Services

Free-Phase Product Thickness on May 23, 1997
Powell Street Plaza and
Shellmound III Sites
Emeryville, California

3

TABLE 1
 Summary of Wells Sampled
 May 23, 1997
 Powell Street Plaza and Shellmound III Sites
 Emeryville, California

#2 192

Well ID	Semi-Annual Sampling Required	Sample Number	Status of Wells Not Sampled
MW-1	X	97210001	
MW-2	X	97210002	
MW-3		NS	Eliminated from sampling schedule.
MW-4		NS	Abandoned by permit.
MW-5		NS	Abandoned by permit.
MW-6		NS	Eliminated from sampling schedule.
MW-7		NS	Abandoned by permit.
MW-8		NS	Eliminated from sampling schedule.
MW-9		NS	Eliminated from sampling schedule.
MW-10		NS	Eliminated from sampling schedule.
MW-11	X	97210011	
MW-12	X	97210012	
MW-13		NS	Free-product present.
MW-14		NS	Eliminated from sampling schedule.
MW-15		NS	Abandoned by permit.
MW-16		NS	Abandoned by permit.
MW-18		NS	Eliminated from sampling schedule.
MW-19	X	NS	Inaccessible.
MG-1		NS	Inaccessible.
MG-2	X	NS	Inaccessible.
MG-3		NS	Inaccessible.
MG-4	X	NS	Inaccessible.
MG-7	X	97210107	
FZ-1	X	NS	Inaccessible.
Trip Blank		97210000	

Note:

NS = Not sampled

TABLE 3
Groundwater Elevations and Product Thickness Measurements
May 23, 1997
Powell Street Plaza and Shellmound III Sites
Emeryville, California

Well Number	Top of Casing Elevation* (feet MSL)	5/23/97 Depth to Product (feet)	5/23/97 Depth to Water (feet)	5/23/97 Product Thickness (feet)	3/5/97 Product Thickness (feet)	Change in Product Thickness (feet)	5/23/97 Groundwater Elevation (feet MSL)	5/23/97 Corrected GW Elevation (feet MSL)	3/5/97 Groundwater Elevation (feet MSL)	Change in Elevation 3/5/97 - 5/23/97 (feet MSL)
MW-1	8.72	NP	5.55				3.17		3.55	-0.38
MW-2	9.83	NP	6.85				2.98		NM	NM
MW-3	10.86	NP	8.15				2.71		NM	NM
MW-4 ⁽¹⁾	---	---	---				---		---	
MW-5 ⁽¹⁾	---	---	---				---		---	
MW-6	11.42	NP	7.98				3.44		3.50	-0.06
MW-7 ⁽¹⁾	---	---	---				---		---	
MW-8	7.48	NP	NM				NM		NM	NM
MW-9	7.50	NP	NM				NM		NM	NM
MW-10	7.38	NM	NM				NM		NM	NM
MW-11	11.89	NP	11.33				0.56		-0.07	0.63
MW-12	9.42	NP	6.68				2.74		2.55	0.19
MW-13	10.83	6.07	6.13	0.06	0.10	-0.04	4.70	4.75	4.75	0.00
MW-14	11.74	NP	7.08				4.66		4.90	-0.24
MW-15 ⁽¹⁾	---	---	---				---		---	
MW-16 ⁽¹⁾	---	---	---				---		---	
MW-18	6.21	NM	NM				NM		NM	NM
MW-19	9.94	NM	NM				NM		NM	NM
MG-1	11.82	NM	NM				NM		NM	NM
MG-2	10.83	NM	NM				NM		NM	NM
MG-3	9.76	NM	NM				NM		NM	NM
MG-4	7.38	NM	NM				NM		NM	NM
MG-7	13.10	NP	11.92				1.18		1.10	0.08
PZ-1	7.99	NM	NM				NM		NM	NM

Notes:

* = Top of casing elevations based on December 27, 1994 and January 4, 1995 Kier & Wright surveys. GW = Groundwater
 NP = No free product observed (1) = Well has been abandoned.

NM = Not measured

Groundwater Elevations were calculated as follows:

$$\text{Water-Level Elevation} = \text{Top of Casing} - \text{Depth to Water} + (0.85 \times \text{Product Thickness})$$