



HAGEMAN-AGUIAR, INC.

Underground Contamination Investigations, Groundwater Consultants, Environmental Engineering

February 7, 1995

Ms. Susan Hugo
Alameda County Health Services Agency
Department of Environmental Health
Hazardous Materials Division
1131 Harbor Bay Parkway
Alameda, CA 94502

Re: Tank Closure Report
Rix Industries
6460 Hollis Street
Emeryville, CA

Dear Susan:

Please find enclosed a copy of the **Tank Closure Report** for your review and approval.

Should you have any questions, please give me a call and I will be happy to discuss them with you.

Best Regards,
HAGEMAN-AGUIAR, INC.

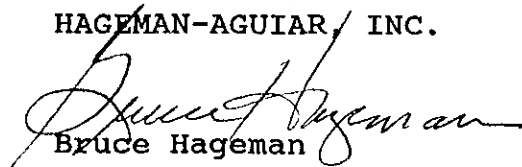
Bruce Hageman

encl.



HAGEMAN-AGUIAR, INC.

Underground Contamination Investigations, Groundwater Consultants, Environmental Engineering

Ms. Susan Hugo
Alameda County Health Services Agency
Department of Environmental Health
Hazardous Materials Division
1131 Harbor Bay Parkway
Alameda, CA 94502

**TANK CLOSURE REPORT
(January 27, 1995)**

**RIX INDUSTRIES
6460 HOLLIS STREET
EMERYVILLE, CA**

Dear Ms. Hugo:

Please consider this a complete report and documentation of the tank removal project at Rix Industries, 6460 Hollis Street, Emeryville, CA.

On October 22, 1994, The five underground storage tanks located in the rear yard of Rix industries, 6460 Hollis Street, Emeryville, CA, were triple rinsed and the rinsate was transported for disposal. Nine hundred fifty two gallons of rinsate was pumped and sent for disposal under manifest # 935758841, by Romic Environmental Technologies. The triple washing event was witnessed by Ms. Susan Hugo, of The Alameda County Health Services Agency.

On December 23, 1994, the concrete covering the underground tanks was broken up in preparation for the excavation and removal of the five underground storage tanks.

RECEIVED
HAGUIAR
JAN 27 1995

On December 26, 1994, the area over the top and sides of the tanks was excavated in preparation for the tank removal.

On December 27, 1994, the tanks were rendered inert by placing a specified amount of dry ice in each tank, about two hours prior to the tanks being removed. GASTECH readings were taken to verify safe levels of chemical vapors and oxygen. The tanks were pronounced safe for transportation, the tanks were then loaded on trucks and transported for disposal. Prior to loading, the tanks were inspected for corrosion/holes, the results of the inspection were as follows: **Tank A:** 1000 gallon steel tank, holes were noted at top of tank, tank was badly rusted. **Tank B:** 1000 gallon steel tank, holes were noted on the sides and ends of tank, severely corroded. **Tank C:** 1000 gallon steel tank, no holes were noted, tank was severely rusted. **Tank D:** 2000 gallon steel tank, rusty, no holes were observed. **Tank E:** 1000 gallon steel tank, holes were observed on the sides and ends of tank. All piping that was unable to be removed was permanently capped. The tanks and associated piping were transported for disposal under manifest # 93618129, dated

12/27/94. The spoils pile of soil (approximately 120 cu yards) was sampled 12/27/94, a four point composite was sampled and transported to a certified laboratory for pre-disposal analyses. 12\27\94, 1,100 gallons of groundwater pumped from the tank excavation prior to taking soil samples, the water was transported and disposed of under manifest # 93730185.

12/28/94, An additional 600 gallons of groundwater was pumped from the tank excavation in advance of taking soil samples from the tank pit. The water was transported and disposed of under manifest # 92740296. Ten (10) soil samples were taken from the sidewalls of the tank excavation at a depth of four feet (just above the water table). The soil sample locations are identified on the soil sample site plan in

the **EXHIBIT SECTION** of this report. the soil samples were taken with the use of 2" x 6" brass sample tubes covered at each end with a Teflon material, plastic caps were then placed over the teflon material at each end of the sample tube. The plastic caps were then taped to the brass sample tube to seal the sample. The soil samples were then placed on ice prior to delivery under Chain of Custody to a State of California Certified Laboratory for Analyses. The soil samples were analyzed for Total Petroleum Hydrocarbons, as Gasoline, Diesel, Kerosene, Stoddard Solvent, Motor Oil. Benzene, Toluene, Total Xylenes and Ethyl Benzene. The soil Samples were also analyzed for Acetone, Isopropanol, MEK, MIBK and Sec Butanol and Halogenated Volatile Organics, using EPA Method 8010. The Laboratory Analyses Report on the results of the sampling can be found in the **EXHIBITS SECTION** of this report. It should noted that the soil sampling event took place in the presence of Ms. Susan Hugo, Alameda County Health Services Agency, Department of Environmental Health, Hazardous Materials Division.

12/28/94, Upon completion of the soil sampling, the tank excavation was backfilled with engineered imported backfill material.

12/30/94, The surface of the tank excavation was restored with a six inch concrete pad.

1\19\95, 161.54 tons of contaminated soil was transported for disposal was transported under non-hazardous waste manifests to the McKittrick Waste Treatment Facility (**see documentation in EXHIBIT SECTION**). The project was completed.

it should be noted that the five tanks that were removed in December 1994, under permit from Alameda County Health Services Agency, and The Emeryville Fire Department. The tanks were removed in accordance with all the State, County

and local regulations, the project was supervised and witnessed by personnel of the local governmental agencies involved. **This site has now met all tank closure requirements issued by The Alameda County Health Services Agency.**

Should you have any questions concerning this project please contact me at (510) 284-1661.

HAGEMAN-AGUIAR, INC.

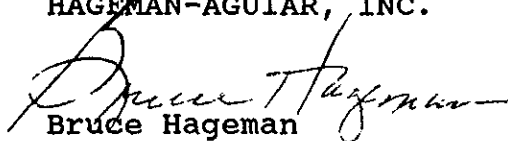
Bruce Hageman

cc: Mr. Frank Dewolf

Mr. Miles Benedict. MRE Commercial Real Estate

PERMITS

EXHIBITS SECTION

CITY OF EMERYVILLE
FIRE DEPARTMENT
6303 HOLLIS STREET
EMERYVILLE, CA., 94608
(510) 596-3750

FIRE DEPARTMENT
USE ONLY

94-1222:2431
(PERMIT NUMBER)

APPLICATION AND PERMIT

THIS APPLICATION IS YOUR PERMIT WHEN PROPERLY FILLED OUT,
SIGNED, VALIDATED AND FEES PAID.

ADDRESS: 6460 Hollis St.

BUSINESS NAME: Riv Industries

CONTACT PERSON: Bruce Hageman (contractor)

TELEPHONE NUMBER: 284-1661

DESCRIPTION OF OPERATION: Removal of 5 UGSt
(exterior) at 6460 Hollis St. (Tanks
A-E, fig. 3 site map)

APPLICANT READ AND SIGN BELOW:

I CERTIFY THAT I HAVE READ THIS APPLICATION AND STATE THAT
THE INFORMATION GIVEN IS TRUE AND CORRECT. I AGREE TO
COMPLY WITH ALL LOCAL ORDINANCES AND STATE LAWS THAT
RELATE TO THIS PERMIT. I HEREBY AUTHORIZE REPRESENTATIVES
OF THE CITY TO ENTER UPON THE ABOVE MENTIONED PROPERTY TO
VERIFY COMPLIANCE WITH THE CONDITIONS OF THIS PERMIT, AT
ANY REASONABLE TIME.

- Building Owner
 Business Operator
Date of Application: 12/22/94

Bruce Hageman (contractor)

Application Received:

Date: 12/22/94 Signed: *JW*

Permit Issued:

Date: 12/22/94 Signed: *JW*

EFD Permit Type(s):
(see reverse)

Expiration Date:

6 mos. FRM ISSUE DATE

TOTAL FEES DUE: \$125.00/tank

MAKE CHECK PAYABLE TO THE CITY
OF EMERYVILLE.

FEES ARE ESTABLISHED THRU THE
CITY OF EMERYVILLE MASTER FEE
SCHEDULE ADOPTED JUNE 1, 1993.
COPY AVAILABLE ON REQUEST.

Occupancy Group/Division:
(per UBC Table 5A)

OCCUPANCY TYPE:

- Commercial Assembly
Industrial Educational
Residential H-class
Other Specify: _____

THIS PERMIT MUST BE AVAILABLE FOR INSPECTION AT ALL TIMES

REVOCACTION OF PERMIT

THE CHIEF IS AUTHORIZED TO SUSPEND/REVOKE A PERMIT WHEN THE CHIEF HAS
DETERMINED THAT SECTION 4.107, 1991 UFC HAS BEEN VIOLATED.

POSTING OF PERMIT

PERMIT(S) SHALL BE KEPT ON THE PREMISES DESIGNATED AT ALL TIMES AND
SHALL BE AVAILABLE FOR INSPECTION AT ANY TIME BY ANY PERSON(S) WHO
ARE AUTHORIZED BY THE CHIEF OF THE EMERYVILLE FIRE DEPARTMENT.

DATE

INSPECTION NOTES/COMMENTS

INSPECTOR

12/22/94	EPA ID # 982038754; County permit signed by Susan Hugo, 5/24/94. Check # 3440, dated 12/21/94.	KA
	EFD requires 24-hour notice prior to removal; LEL and O ₂ levels must both be below 10%; County Health and/or EFD representatives <u>must be on-site</u> prior to removal.	

White: Applicant

Yellow: EFD

Pink: Finance

SUSAN L HUGO

ALAMEDA COUNTY HEALTH CARE SERVICES AGENCY
DEPARTMENT OF ENVIRONMENTAL HEALTH
HAZARDOUS MATERIALS DIVISION
80 SWAN WAY, ROOM 200
OAKLAND, CA 94621
PHONE NO. 510/271-4320

STID 376

ALCO
HAZMAT

94 APR -4 PM 12:44

ACCEPTED

Underground Storage Tank Closure Permit Application
Alameda County Division of Hazardous Materials
80 Swan Way, Suite 200,
Oakland, CA 94621
Telephone: (510) 271-4320

These closure/removal plans have been reviewed and found to be acceptable and in compliance with the requirements of State and Local Health Department regulations and plans indicated by this Department. The permit is issued in accordance with State and local laws. The permit is valid for one year from the date of issuance of any required permits for removal or destruction.

One copy of the permit and all applicable laws and regulations shall be available to the public upon request for the removal. All operations must be conducted in accordance with the Building and Fire Code and other applicable laws and regulations. All changes meet the requirements of the permit or to the following:

- Removal of Tank(s) and Piping
- Sampling
- Final Inspection

Issuance of a permit to operate, b) permanent site closure, is dependent on compliance with accepted plans and all applicable laws and regulations.

*THERE IS A FINANCIAL PENALTY FOR NOT OBTAINING THESE INSPECTIONS

Contact Specialist:

Please note change made on page 5.
Susan L. Hugo
5/24/94

UNDERGROUND TANK CLOSURE PLAN

*** Complete according to attached instructions ***

1. Business Name Rix Industries
Business Owner B.E. Otterson
 2. Site Address 6460 Hollis Street
city Emeryville, CA zip 94608 Phone (510) 658-5275
 3. Mailing Address 6460 Hollis Street
city Emeryville, CA zip 94608 Phone (510) 658-5275
 4. Land Owner Gloria and Frank DeWolf
Address Casa De Emdeko city, state Kailua-Kona Hawaii zip 96740
75-5082 Alii Drive
 5. Generator name under which tank will be manifested Gloria and Frank DeWolf
- EPA I.D. No. under which tank will be manifested 98 2038 754

6. Contractor MINTER AND FAHY CONSTRUCTION COMPANY
Address 411 NORTH BUCHANAN CIRCLE, #2
City PACHECO, CA Phone (510) 674-8800
License Type* "A" ID# 477315

*Effective January 1, 1992, Business and Professional Code Section 7058.7 requires prime contractors to also hold Hazardous Waste Certification issued by the State Contractors License Board. Indicate that the certificate has been received, in addition, to holding the appropriate contractors license type.

7. Consultant HAGEMAN - AGUIAR, INC.
Address 3732 MT. DIABLO BLVD., STE 372
City LAFAYETTE, CA Phone (510) 284-1661

8. Contact Person for Investigation
Name GARY AGUIAR, BRUCE HAGEMAN Title PRINCIPAL ENGINEER, PRESIDENT
Phone (510) 284-1661

9. Number of tanks being closed under this plan 10
Length of piping being removed under this plan 150'
Total number of tanks at facility 10

10. State Registered Hazardous Waste Transporters/Facilities (see instructions).

** Underground tanks are hazardous waste and must be handled **
as hazardous waste

a) Product/Residual Sludge/Rinsate Transporter

Name H & H ENVIRONMENTAL EPA I.D. No. CAD000477168
Hauler License No. 0334 License Exp. Date _____
Address 220 CHINA BASIN
City SAN FRANCISCO State CA Zip 94107

b) Product/Residual Sludge/Rinsate Disposal Site

Name PRC PATTERSON, INC. EPA I.D. No. CAD083166728
Address H & H ENVIRONMENTAL
City 220 CHINA BASIN
City SAN FRANCISCO State CA Zip 94107

c) Tank and Piping Transporter

Name H & H ENVIRONMENTAL EPA I.D. No. CAD000477168
Hauler License No. 0334 License Exp. Date _____
Address 220 CHINA BASIN
City SAN FRANCISCO State CA Zip 94107

d) Tank and Piping Disposal Site

Name H & H ENVIRONMENTAL EPA I.D. No. CAD000477168
Address 220 CHINA BASIN
City SAN FRANCISCO State CA Zip 94107

11. Experienced Sample Collector

Name JEFF ROTH
Company HAGEMAN - AGUIAR, INC.
Address 3732 MT. DIABLO BLVD., STE 372
City LAFAYETTE State CA Zip 94549 Phone (510) 284-1661

12. Laboratory

Name PRIORITY ENVIRONMENTAL LAB, INC.
Address 1764 HOURET COURT
City FREMONT State CA Zip 95035
State Certification No. #1708

13. Have tanks or pipes leaked in the past? Yes No

If yes, describe. DATA RETRIEVED FROM GROUNDWATER SAMPLES INDICATE MATERIAL FROM THE TANKS MIGRATED TO GROUNDWATER.

14. Describe methods to be used for rendering tank inert

DRY ICE (SOLID CARBON DIOXIDE)

5LBS PER 100 GALLONS OF TANK CAPACITY

Before tanks are pumped out and inerted, all associated piping must be flushed out into the tanks. All accessible associated piping must then be removed. Inaccessible piping must be plugged.

The Bay Area Air Quality Management District (771-6000), along with local Fire and Building Departments, must also be contacted for tank removal permits. Fire departments typically require the use of explosion proof combustible gas meters to verify tank inertness. It is the contractor's responsibility to bring a working combustible gas meter on site to verify tank inertness.

15. Tank History and Sampling Information

Tank		Material to be sampled (tank contents, soil, ground-water, etc.)	Location and Depth of Samples	
Capacity GALLONS	Use History (see instructions)			
TANK A-1000 TANK B-1000 TANK C-1000 TANK D-1000 TANK E-1000 TANK F-1000 TANK H-1000 TANK J-1000 TANK L-1000	UNKNOWN; BELIEVED TO BE CHLORINATED SOLVENTS DIESEL, SEC BUTANOL DIESEL MINERAL SPIRITS MINERAL SPIRITS METHYL ISOBUTYL KETONE (MIBK) TETRACHLOROETHENE SEC BUTANOL	TOTAL PETROLEUM HYDROCARBONS AS, DIESEL TPH AS KEROSENE TPH AS MINERAL SPIRITS TPH AS GASOLINE BTEX HALOGENATED VOLATILE ORGANICS ETHYL SILICATE PURGABLE HALOCARBONS	FIVE TO SIX FEET FROM SIDEWALLS OF TANK PITS JUST ABOVE THE SATURATED ZONE	
TANK K-5000				UNKNOWN; BELIEVED TO BE MINTERAL SPIRITS

One soil sample must be collected for every 20 feet of piping that is removed. A ground water sample must be collected should any ground water be present in the excavation.

Excavated/Stockpiled Soil	
Stockpiled Soil Volume (Estimated)	Sampling Plan
500 CU YDS	COMPOSITE SOIL SAMPLE PER EVERY 50 CU YDS PER SPOILS PILE

Stockpiled soil must be placed on bermed plastic and must be completely covered by plastic sheeting.

16. Chemical methods and associated detection limits to be used for analyzing samples

The Tri-Regional Board recommended minimum verification analyses and practical quantitation reporting limits should be followed. See attached Table 2.

Contaminant Sought	EPA, DHS, or Other Sample Preparation Method Number	EPA, DHS, or Other Analysis Method Number	Method Detection Limit
TOTAL PETRO-LEUM FUEL WITH BTEX DISTINCTION	5030	8015/8020	1.0/.0050
MINERAL SPIRITS	3550	8015	1.0 mg/kg
HALOGENATED VOLATILE ORGANICS	5030	8010 <i>28240</i>	5.0
INDUSTRIAL SOLVENTS SCAN <i>TPH gasoline</i> <i>TPH diesel</i> <i>THL gasoline</i>	3810	8015 MODIFIED	0.020

17. Submit Site Health and Safety Plan (See Instructions)

18. Submit Worker's Compensation Certificate copy

Name of Insurer STATE FUND

19. Submit Plot Plan (See Instructions)

20. Enclose Deposit (See Instructions)

21. Report any leaks or contamination to this office within 5 days of discovery. The report shall be made on an Underground Storage Tank Unauthorized Leak/Contamination Site Report form. (see Instructions)

22. Submit a closure report to this office within 60 days of the tank removal. This report must contain all the information listed in item 22 of the instructions.

I declare that to the best of my knowledge and belief the statements and information provided above are correct and true.

I understand that information in addition to that provided above may be needed in order to obtain an approval from the Department of Environmental Health and that no work is to begin on this project until this plan is approved.

I understand that any changes in design, materials or equipment will void this plan if prior approval is not obtained.

I understand that all work performed during this project will be done in compliance with all applicable OSHA (Occupational Safety and Health Administration) requirements concerning personnel health and safety. I understand that site and worker safety are solely the responsibility of the property owner or his agent and that this responsibility is not shared nor assumed by the County of Alameda.

Once I have received my stamped, accepted closure plan, I will contact the project Hazardous Materials Specialist at least three working days in advance of site work to schedule the required inspections.

Signature of Contractor

Name (please type) _____

Signature _____

Date _____

Signature of Site Owner or Operator

Name (please type) MILES BENEDICT FOR FRANK DeWOLF

Signature *Miles Benedict*

Date 4/4/94

INSTRUCTIONS

General Instructions

- * Three (3) copies of this plan plus attachments and deposit must be submitted to this Department.
- * Any cutting into tanks requires local fire department approval.
- * One complete copy of your approved plan must be at the construction site at all times; a copy of your approved plan must also be sent to the landowner.

Item Specific Instructions

2. SITE ADDRESS
Address at which closure is taking place.
5. EPA I.D. NO. under which the tanks will be manifested
EPA I.D. numbers may be obtained from the State Department of Health Services, 916/324-1781.
6. CONTRACTOR
Prime contractor for the project.
10. STATE REGISTERED HAZARDOUS WASTE TRANSPORTERS/FACILITIES
 - a) All residual liquids and sludges are to be removed from tanks before tanks are inerted.
 - c) Tanks must be hauled as hazardous waste.
 - d) This is the place where tanks will be taken for cleaning.
15. TANK HISTORY AND SAMPLING INFORMATION
Use History - This information is essential and must be accurate. Include tank installation date, products stored in the tank, and the date when the tank was last used.

Material to be sampled - e.g. water, oil, sludge, soil, etc.

Location and depth of samples - e.g. beneath the tank a maximum of two feet below the native soil/backfill interface, side wall at the high water mark, etc.

16. CHEMICAL METHODS AND ASSOCIATED DETECTION LIMITS
See attached Table 2.

17. SITE HEALTH AND SAFETY PLAN

A site specific Health and Safety plan must be submitted. We advocate the site health and safety plan include the following items, at a minimum:

- a) The name and responsibilities of the site health and safety officer;
- b) An outline of briefings to be held before work each day to appraise employees of site health and safety hazards;
- c) Identification of health and safety hazards of each work task. Include potential fire, explosion, physical, and chemical hazards;
- d) For each hazard, identify the action levels (contaminant concentrations in air) or physical conditions which will trigger changes in work habits to ensure workers are not exposed to unsafe chemical levels or physical conditions;
- e) Description of the work habit changes triggered by the above action levels or physical conditions;
- f) Frequency and types of air and personnel monitoring - along with the environmental sampling techniques and instrumentation - to be used to detect the above action levels. Include instrumentation maintenance and calibration methods and frequencies;
- g) Confined space entry procedures (if applicable);
- h) Decontamination procedures;
- i) Measures to be taken to secure the site, excavation and stockpiled soil during and after work hours (e.g. barricades, caution tape, fencing, trench plates, plastic sheeting, security guards, etc.);
- j) Spill containment/emergency/contingency plan. Be sure to include emergency phone numbers, the location of the phone nearest the site, and directions to the hospital nearest the site;
- k) Documentation that all site workers have received the appropriate OSHA approved trainings and participate in appropriate medical surveillance per 29 CFR 1910.120; and
- l) Page for employees to sign indicating they have read and will comply with the site health and safety plan.

The safety plan must be distributed to all employees and contractors working in hazardous waste operations on site. A complete copy of the site health and safety plan along with any standard operating procedures shall be on site and accessible at all times.

NOTE: These requirements are excerpts from 29 CFR Part 1910.120(b)(4), Hazardous Waste Operations and Emergency Response; Final Rule, March 6, 1989. Safety plans of certain underground tank sites may need to meet the complete requirements of this Rule.

19. PLOT PLAN

The plan should consist of a scaled view of the facility at which the tank(s) are located and should include the following information:

- a) Scale;
- b) North Arrow;
- c) Property Lines;
- d) Location of all Structures;
- e) Location of all relevant existing equipment including tanks and piping to be removed and dispensers;
- f) Streets;
- g) Underground conduits, sewers, water lines, utilities;
- h) Existing wells (drinking, monitoring, etc.);
- i) Depth to ground water; and
- j) All existing tanks and piping in addition to the ones being pulled.

20. DEPOSIT

A deposit, payable to Alameda County for the amount indicated on the Alameda County Underground Storage Tank Fee Schedule, must accompany the plans.

21. Blank Unauthorized Leak/Contamination Site Report forms may be obtained in limited quantities from our office and from the San Francisco Bay Regional Water Quality Control Board (415/464-1255). Larger quantities may be obtained directly from the State Water Resources Control Board at (916) 739-2421.

22. TANK CLOSURE REPORT

The tank closure report should contain the following information:

- a) General description of the closure activities;
- b) Description of tank, fittings and piping conditions. Indicate tank size and former contents; note any corrosion, pitting, holes, etc.;

- c) Description of the excavation itself. Include the tank and excavation depth, a log of the stratigraphic units encountered within the excavation, a description of root holes or other potential contaminant pathways, the depth to any observed ground water, descriptions and locations of stained or odor-bearing soil, and descriptions of any observed free product or sheen;
- d) Description of sampling methods;
- e) Description of any remedial measures conducted at the time of tank removal;
- f) To-scale figures showing the excavation size and depth, nearby buildings, sample locations and depths, and tank and piping locations. Include a copy of the plot plan prepared for the Tank Closure Plan under item 19;
- g) Chain of custody records;
- h) Copies of signed laboratory reports;
- i) Copies of "TSDF to Generator" Manifests for all hazardous wastes hauled offsite (sludge, rinsate, tanks and piping, contaminated soil, etc.); and
- j) Tabulation of the volume and final destination of all non-manifested contaminated soil hauled offsite.

TABLE #2
RECOMMENDED MINIMUM VERIFICATION ANALYSES FOR
UNDERGROUND TANK LEAKS

<u>HYDROCARBON LEAK</u>	<u>SOIL ANALYSIS</u>		<u>WATER ANALYSIS</u>	
Unknown Fuel	TPH G	GCFID(5030)	TPH G	GCFID(5030)
	TPH D	GCFID(3550)	TPH D	GCFID(3510)
	BTX&E	8020 or 8240	BTX&E	602, 624 or 8260
	TPH AND BTX&E 8260			
Leaded Gas	TPH G	GCFID(5030)	TPH G	GCFID(5030)
	BTX&E	8020 OR 8240	BTX&E	602 or 624
	TPH AND BTX&E 8260		TOTAL LEAD AA	
	-----Optional-----			
	TEL	DHS-LUFT	TEL	DHS-LUFT
	EDB	DHS-AB1803	EDB	DHS-AB1803
Unleaded Gas	TPH G	GCFID(5030)	TPH G	GCFID(5030)
	BTX&E	8020 or 8240	BTX&E	602, 624 or 8260
	TPH AND BTX&E 8260			
Diesel, Jet Fuel and Kerosene	TPH D	GCFID(3550)	TPH D	GCFID(3510)
	BTX&E	8020 or 8240	BTX&E	602, 624 or 8260
	TPH AND BTX&E 8260			
Fuel/Heating Oil	TPH D	GCFID(3550)	TPH D	GCFID(3510)
	BTX&E	8020 or 8240	BTX&E	602, 624 or 8260
	TPH AND BTX&E 8260			
Chlorinated Solvents	CL HC	8010 or 8240	CL HC	601 or 624
	BTX&E	8020 or 8240	BTX&E	602 or 624
	CL HC AND BTX&E 8260		CL HC AND BTX&E 8260	
Non-chlorinated Solvents	TPH D	GCFID(3550)	TPH D	GCFID(3510)
	BTX&E	8020 or 8240	BTX&E	602 or 624
	TPH AND BTX&E 8260		TPH and BTX&E 8260	
Waste and Used Oil or Unknown (All analyses must be completed and submitted)	TPH G	GCFID(5030)	TPH G	GCFID(5030)
	TPH D	GCFID(3550)	TPH D	GCFID(3510)
	TPH AND BTX&E 8260			
	O & G	5520 D & F	O & G	5520 C & F
	BTX&E	8020 or 8240	BTX&E	602, 624 or 8260
	CL HC	8010 or 8240	CL HC	601 or 624

ICAP or AA TO DETECT METALS: Cd, Cr, Pb, Zn, Ni
 METHOD 8270 FOR SOIL OR WATER TO DETECT:
 PCB*
 PCP*
 PNA
 CREOSOTE

* If found, analyze for dibenzofurans (PCBs) or dioxins (PCP)

Reference: Tri-Regional Board Staff Recommendations for Preliminary Evaluation and Investigation of Underground Tank Sites, 10 August 1990

EXPLANATION FOR TABLE #2: MINIMUM VERIFICATION ANALYSIS

1. OTHER METHODOLOGIES are continually being developed and as methods are accepted by EPA or DHS, they also can be used.
2. For DRINKING WATER SOURCES, EPA recommends that the 500 series for volatile organics be used in preference to the 600 series because the detection limits are lower and the QA/QC is better.
3. APPROPRIATE STANDARDS for the materials stored in the tank are to be used for all analyses on Table #2. For instance, seasonally, there may be five different jet fuel mixtures to be considered.
4. To AVOID FALSE POSITIVE detection of benzene, benzene-free solvents are to be used.
5. TOTAL PETROLEUM HYDROCARBONS (TPH) as gasoline (G) and diesel (D) ranges (volatile and extractible, respectively) are to be analyzed and characterized by GCFID with a fused capillary column and prepared by EPA method 5030 (purge and trap) for volatile hydrocarbons, or extracted by sonication using 3550 methodology for extractable hydrocarbons. Fused capillary columns are preferred to packed columns; a packed column may be used as a "first cut" with "dirty" samples or once the hydrocarbons have been characterized and proper QA/QC is followed.
6. TETRAETHYL LEAD (TEL) analysis may be required if total lead is detected unless the determination is made that the total lead concentration is geogenic (naturally occurring).
7. CHLORINATED HYDROCARBONS (CL HC) AND BENZENE, TOLUENE, XYLENE AND ETHYLBENZENE (BTX&E) are analyzed in soil by EPA methods 8010 and 8020 respectively, (or 8240) and in water, 601 and 602, respectively (or 624).
8. OIL AND GREASE (O & G) may be used when heavy, straight chain hydrocarbons may be present. Infrared analysis by method 418.1 may also be acceptable for O & G if proper standards are used. Standard Methods" 17th Edition, 1989, has changed the 503 series to 5520.
9. PRACTICAL QUANTITATION REPORTING LIMITS are influenced by matrix problems and laboratory QA/QC procedures. Following are the Practical Quantitation Reporting Limits:

	<u>SOIL PPM</u>	<u>WATER PPB</u>
TPH G	1.0	50.0
TPH D	1.0	50.0
BTX&E	0.005	0.5
O & G	50.0	5,000.0

Based upon a Regional Board survey of Department of Health Services Certified Laboratories, the Practical Quantitation Reporting Limits are attainable by a majority of laboratories with the exception of diesel fuel in soils. The Diesel Practical Quantitation Reporting Limits, shown by the survey, are:

ROUTINE	MODIFIED PROTOCOL
≤ 10 ppm (42%)	≤ 10 ppm (10%)
≤ 5 ppm (19%)	≤ 5 ppm (21%)
≤ 1 ppm (35%)	≤ 1 ppm (60%)

When the Practical Quantitation Reporting Limits are not achievable, an explanation of the problem is to be submitted on the laboratory data sheets.

- LABORATORY DATA SHEETS are to be signed and submitted and include the laboratory's assessment of the condition of the samples on receipt including temperature, suitable container type, air bubbles present/absent in VOA bottles, proper preservation, etc. The sheets are to include the dates sampled, submitted, prepared for analysis, and analyzed.
- IF PEAKS ARE FOUND, when running samples, that do not conform to the standard, laboratories are to report the peaks, including any unknown complex mixtures that elute at times varying from the standards. Recognizing that these mixtures may be contrary to the standard, they may not be readily identified; however, they are to be reported. At the discretion of the LIA or Regional Board the following information is to be contained in the laboratory report:

The relative retention time for the unknown peak(s) relative to the reference peak in the standard, copies of the chromatogram(s), the type of column used, initial temperature, temperature program is C/minute, and the final temperature.

- REPORTING LIMITS FOR TPH are: gasoline standard ≤ 20 carbon atoms, diesel and jet fuel (kerosene) standard ≤ 50 carbon atoms. It is not necessary to continue the chromatography beyond the limit, standard, or EPA/DHS method protocol (whichever time is greater).

EPILOGUE

ADDITIVES: Major oil companies are being encouraged or required by the federal government to reformulate gasoline as cleaner burning fuels to reduce air emissions. MTBE (Methyl-tertiary butyl ether), ETHANOL (ethyl alcohol), and other chemicals may be added to reformulate gasolines to increase the oxygen content in the fuel and thereby decrease undesirable emissions (about four percent with MTBE). MTBE and ethanol are, for practical purposes, soluble in water. The removal from the water column will be difficult. Other compounds are being added by the oil companies for various purposes. The refinements for detection and analysis for all of these additives are still being worked out. If you have any questions about the methodology, please call your Regional Board representative.

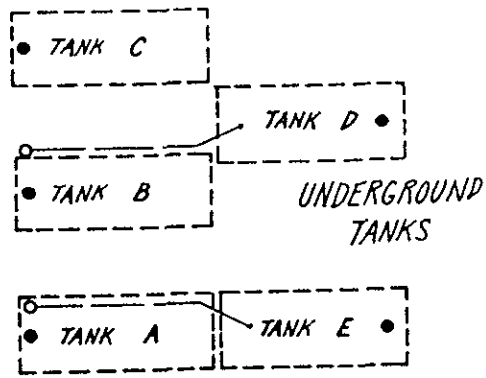

STORAGE
YARD

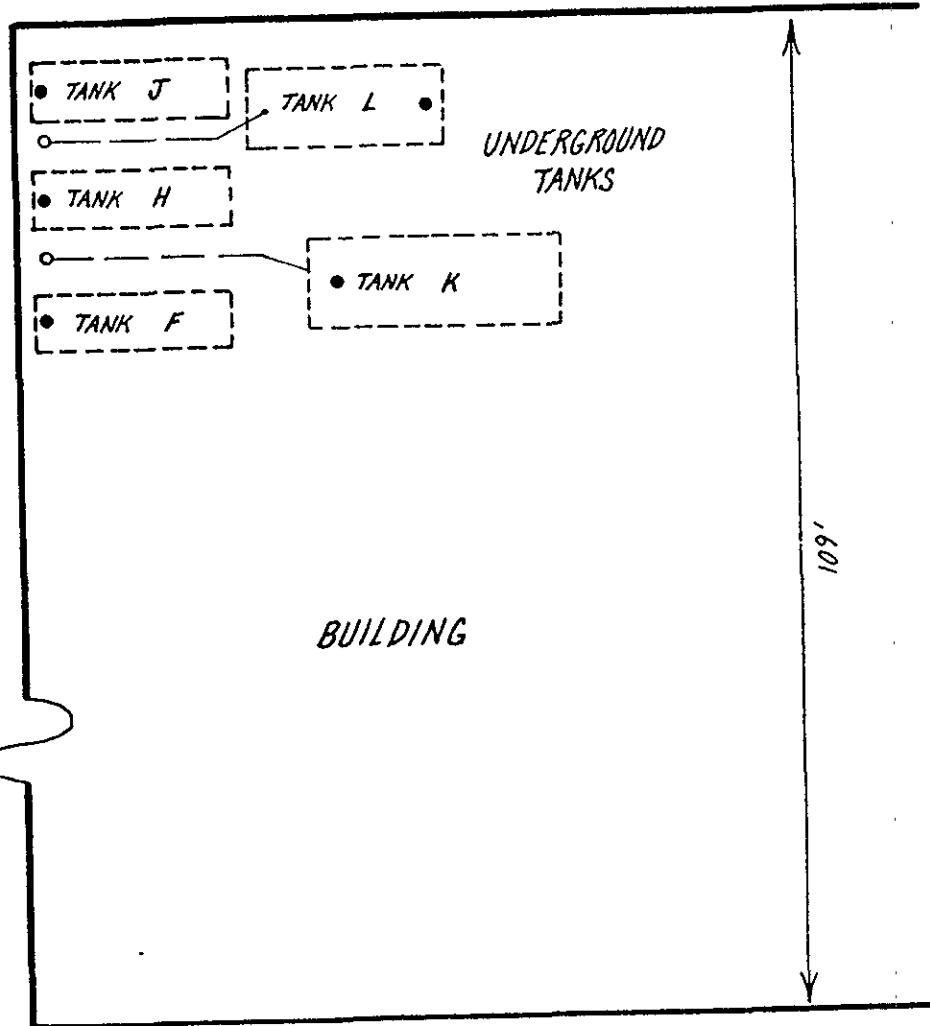

DRIVEWAY

UNDERGROUND
TANKS

BUILDING

109'

HOLLIS STREET

FIGURE 3.
Site Map.

18. Submit Worker's Compensation Certificate copy

Name of Insurer STATE FUND

19. Submit Plot Plan (See Instructions)

20. Enclose Deposit (See Instructions)

21. Report any leaks or contamination to this office within 5 days of discovery. The report shall be made on an Underground Storage Tank Unauthorized Leak/Contamination Site Report form. (see Instructions)

22. Submit a closure report to this office within 60 days of the tank removal. This report must contain all the information listed in item 22 of the instructions.

I declare that to the best of my knowledge and belief the statements and information provided above are correct and true.

I understand that information in addition to that provided above may be needed in order to obtain an approval from the Department of Environmental Health and that no work is to begin on this project until this plan is approved.

I understand that any changes in design, materials or equipment will void this plan if prior approval is not obtained.

I understand that all work performed during this project will be done in compliance with all applicable OSHA (Occupational Safety and Health Administration) requirements concerning personnel health and safety. I understand that site and worker safety are solely the responsibility of the property owner or his agent and that this responsibility is not shared nor assumed by the County of Alameda.

Once I have received my stamped, accepted closure plan, I will contact the project Hazardous Materials Specialist at least three working days in advance of site work to schedule the required inspections.

Signature of Contractor X

Name (please type) Minter & Fahy Construction Company, Inc.

Signature [Signature] John F. Fahy, Jr.

Date April 29, 1994

Signature of Site Owner or Operator X

Name (please type) Miles K. Benedict representing C. Frank Dewolf

Signature [Signature]

Date May 10, 1994

MANIFESTS

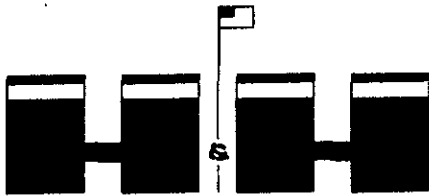

ENVIRONMENTAL SERVICES
 (DIVISION OF H&H SHIP SERVICE CO., INC.)

220 CHINA BASIN, SAN FRANCISCO, CA 94107 . DAY AND NIGHT: (415) 543-4835 FAX (415) 543-8265

CERTIFICATE OF DISPOSAL

DECEMBER 30, 1994

H & H Ship Service Company hereby certifies to HAGEMAN & AGUIAR, INC.
 that:

1. The storage tank(s), size(s) 1 - 2,000 GALS. AND 4 - 1,000 GALS.

removed from the

FRANK DEWOLF

facility at

6460 HOLLIS STREET

EMERYVILLE, CALIFORNIA

were transported to H & H Ship Service Company, 220 China Basin St. San Francisco, California 94107.

2. The following tank(s), H & H Job Number 15271

have been steam cleaned, cut with approximately 2' x 2' holes, rendered harmless and disposed of as scrap metal.

3. Disposal site: SCHNITZER STEEL, OAKLAND, CALIFORNIA

4. The foregoing method of destruction/disposal is suitable for the materials involved, and fully complies with all applicable regulatory and permit requirements.

5. Should you require further information, please call (415) 543-4835 or (415) 905-5510.

Very truly yours,

Lourdes B. Lopez
 Lourdes B. Lopez
 Operations Coordinator



UNIFORM HAZARDOUS WASTE MANIFEST		1. Generator's US EPA ID No. C A D 9 8 2 0 3 8 7 5 4		Manifest Document No. 1 8 1 2 9		2. Page 1 of 1		Information in the shaded areas is not required by Federal law.		
3. Generator's Name and Mailing Address FRANK DEWOLF 76-6287 Leone Street, Kailua-Kona, HI. 96740					A. State Manifest Document Number 93618129					
4. Generator's Phone (808 329-9796					B. State Generator's ID					
5. Transporter 1 Company Name H & H SHIP SERVICE COMPANY			6. US EPA ID Number C A D 0 0 4 7 7 1 1 6 8		C. State Transporter's ID 428039			D. Transporter's Phone (415) 543-4835		
7. Transporter 2 Company Name					8. US EPA ID Number					
9. Designated Facility Name and Site Address H & H SHIP SERVICE COMPANY 220 TERRY FRANCOIS/CHINA BASIN SAN FRANCISCO, CA. 94107					10. US EPA ID Number C A D 0 0 4 7 7 1 1 6 8		G. State Facility's ID C A D 0 0 4 7 7 1 1 6 8			
					H. Facility's Phone (415) 543-4835					
11. US DOT Description (including Proper Shipping Name, Hazard Class, and ID Number)					12. Containers		13. Total Quantity		14. Unit Wt/Vol	
					No. Type		Quantity		Waste Number	
WASTE EMPTY STORAGE TANKS NON-RCRA HAZARDOUS WASTE SOLID					0 0 4 T P		0 4 0 0 0		P State 512 EPA/Other	
WASTE EMPTY STORAGE TANK NON-RCRA HAZARDOUS WASTE SOLID					0 0 1 T P		0 2 0 0 0		P State 512 EPA/Other	
c.									State EPA/Other	
d.									State EPA/Other	
15. Special Handling Instructions and Additional Information JOB #15271 24 Hr. Emergency Contact: H & H #(415) 543-4835 APPROPRIATE PROTECTIVE CLOTHING AND RESPIRATOR					K. Handling Codes for Wastes Listed Above a. 01 b. 01 c. d.					
16. GENERATOR'S CERTIFICATION: I hereby declare that the contents of this consignment are fully and accurately described above by proper shipping name and are classified, packed, marked, and labeled, and are in all respects in proper condition for transport by highway according to applicable international and national government regulations. If I am a large quantity generator, I certify that I have a program in place to reduce the volume and toxicity of waste generated to the degree I have determined to be economically practicable and that I have selected the practicable method of treatment, storage, or disposal currently available to me which minimizes the present and future threat to human health and the environment; OR, if I am a small quantity generator, I have made a good faith effort to minimize my waste generation and select the best waste management method that is available to me and that I can afford.					15. Special Handling Instructions and Additional Information JOB SITE: FRANK DEWOLF 6460 Hollis Street Emeryville, California					
Printed/Typed Name BRUCE HAGEMAN			Signature <i>Bruce Hageman</i>		Month 1 2		Day 2 7		Year 9 4	
17. Transporter 1 Acknowledgement of Receipt of Materials Printed/Typed Name JIMMIE H. REESE			Signature <i>Jimmie H. Reese</i>		Month 1 2		Day 2 7		Year 9 4	
18. Transporter 2 Acknowledgement of Receipt of Materials Printed/Typed Name			Signature		Month		Day		Year	
19. Discrepancy Indication Space										
Printed/Typed Name LOURDES B LOPEZ			Signature <i>Loures B Lopez</i>		Month 1 2		Day 2 7		Year 9 4	

DO NOT WRITE BELOW THIS LINE.

IN CASE OF EMERGENCY OR SPILL, CALL THE NATIONAL RESPONSE CENTER 800-424-9300
 2: WASH DC CENTER 202-556-8800
 3: WASH DC CENTER 202-556-8800
 4: WASH DC CENTER 202-556-8800
 5: WASH DC CENTER 202-556-8800
 6: WASH DC CENTER 202-556-8800
 7: WASH DC CENTER 202-556-8800
 8: WASH DC CENTER 202-556-8800
 9: WASH DC CENTER 202-556-8800
 10: WASH DC CENTER 202-556-8800
 11: WASH DC CENTER 202-556-8800
 12: WASH DC CENTER 202-556-8800
 13: WASH DC CENTER 202-556-8800
 14: WASH DC CENTER 202-556-8800
 15: WASH DC CENTER 202-556-8800
 16: WASH DC CENTER 202-556-8800
 17: WASH DC CENTER 202-556-8800
 18: WASH DC CENTER 202-556-8800
 19: WASH DC CENTER 202-556-8800
 20: WASH DC CENTER 202-556-8800
 21: WASH DC CENTER 202-556-8800
 22: WASH DC CENTER 202-556-8800
 23: WASH DC CENTER 202-556-8800
 24: WASH DC CENTER 202-556-8800
 25: WASH DC CENTER 202-556-8800
 26: WASH DC CENTER 202-556-8800
 27: WASH DC CENTER 202-556-8800
 28: WASH DC CENTER 202-556-8800
 29: WASH DC CENTER 202-556-8800
 30: WASH DC CENTER 202-556-8800
 31: WASH DC CENTER 202-556-8800
 32: WASH DC CENTER 202-556-8800
 33: WASH DC CENTER 202-556-8800
 34: WASH DC CENTER 202-556-8800
 35: WASH DC CENTER 202-556-8800
 36: WASH DC CENTER 202-556-8800
 37: WASH DC CENTER 202-556-8800
 38: WASH DC CENTER 202-556-8800
 39: WASH DC CENTER 202-556-8800
 40: WASH DC CENTER 202-556-8800
 41: WASH DC CENTER 202-556-8800
 42: WASH DC CENTER 202-556-8800
 43: WASH DC CENTER 202-556-8800
 44: WASH DC CENTER 202-556-8800
 45: WASH DC CENTER 202-556-8800
 46: WASH DC CENTER 202-556-8800
 47: WASH DC CENTER 202-556-8800
 48: WASH DC CENTER 202-556-8800
 49: WASH DC CENTER 202-556-8800
 50: WASH DC CENTER 202-556-8800
 51: WASH DC CENTER 202-556-8800
 52: WASH DC CENTER 202-556-8800
 53: WASH DC CENTER 202-556-8800
 54: WASH DC CENTER 202-556-8800
 55: WASH DC CENTER 202-556-8800
 56: WASH DC CENTER 202-556-8800
 57: WASH DC CENTER 202-556-8800
 58: WASH DC CENTER 202-556-8800
 59: WASH DC CENTER 202-556-8800
 60: WASH DC CENTER 202-556-8800
 61: WASH DC CENTER 202-556-8800
 62: WASH DC CENTER 202-556-8800
 63: WASH DC CENTER 202-556-8800
 64: WASH DC CENTER 202-556-8800
 65: WASH DC CENTER 202-556-8800
 66: WASH DC CENTER 202-556-8800
 67: WASH DC CENTER 202-556-8800
 68: WASH DC CENTER 202-556-8800
 69: WASH DC CENTER 202-556-8800
 70: WASH DC CENTER 202-556-8800
 71: WASH DC CENTER 202-556-8800
 72: WASH DC CENTER 202-556-8800
 73: WASH DC CENTER 202-556-8800
 74: WASH DC CENTER 202-556-8800
 75: WASH DC CENTER 202-556-8800
 76: WASH DC CENTER 202-556-8800
 77: WASH DC CENTER 202-556-8800
 78: WASH DC CENTER 202-556-8800
 79: WASH DC CENTER 202-556-8800
 80: WASH DC CENTER 202-556-8800
 81: WASH DC CENTER 202-556-8800
 82: WASH DC CENTER 202-556-8800
 83: WASH DC CENTER 202-556-8800
 84: WASH DC CENTER 202-556-8800
 85: WASH DC CENTER 202-556-8800
 86: WASH DC CENTER 202-556-8800
 87: WASH DC CENTER 202-556-8800
 88: WASH DC CENTER 202-556-8800
 89: WASH DC CENTER 202-556-8800
 90: WASH DC CENTER 202-556-8800
 91: WASH DC CENTER 202-556-8800
 92: WASH DC CENTER 202-556-8800
 93: WASH DC CENTER 202-556-8800
 94: WASH DC CENTER 202-556-8800
 95: WASH DC CENTER 202-556-8800
 96: WASH DC CENTER 202-556-8800
 97: WASH DC CENTER 202-556-8800
 98: WASH DC CENTER 202-556-8800
 99: WASH DC CENTER 202-556-8800
 100: WASH DC CENTER 202-556-8800

UNIFORM HAZARDOUS WASTE MANIFEST

1. Generator's US EPA ID No. Manifest Document No. 2. Page 1 of 1
 C A D 0 0 9 4 5 2 6 5 7 4 7 5 8 4 1

Information in the shaded areas is not required by Federal law.

3. Generator's Name and Mailing Address
 RLY INDUSTRIES
 6460 HOLLYB STREET
 EMERYVILLE, CA 94608 1035

4. Generator's Phone (510/784 1661) Contact: BRICK BAGMAN

5. Transporter 1 Company Name 6. US EPA ID Number
 RONIC ENVIRONMENTAL TRCB C A D 0 0 9 4 5 2 6 5 7

7. Transporter 2 Company Name 8. US EPA ID Number

9. Designated Facility Name and Site Address 10. US EPA ID Number
 RONIC ENVIRONMENTAL TRCB
 7001 Bay Road
 East Palo Alto, CA 94303-1316 C A D 0 0 9 4 5 2 6 5 7

11. US DOT Description (including Proper Shipping Name, Hazard Class, and ID Number) 12. Containers 13. Total Quantity 14. Unit

Waste PLANNABLE LIQUIDS, H.O.S.
 3 UN1993 PG11
 (ISOPROPYL ALCOHOL, METHYL ETHYL KETONE) 2011 TIT 0109152 6

b.

c.

d.

A. Additional Descriptions for Materials Listed Above
 36"

K. Handling Codes for Wastes Listed Above

15. Special Handling Instructions and Additional Information
 Line 1 1) A 305117 77 EPA/Other Waste Code(s) D035 D039 D040 P001 P004

24 HR. EMERGENCY RESPONSE NUMBER:
 (510) 284-1661

16. GENERATOR'S CERTIFICATION: I hereby declare that the contents of this consignment are fully and accurately described above by proper shipping name and are classified, packed, marked, and labeled, and are in all respects in proper condition for transport by highway according to applicable international and national government regulations.

If I am a large quantity generator, I certify that I have a program in place to reduce the volume and toxicity of waste generated to the degree I have determined to be economically practicable and that I have selected the practicable method of treatment, storage, or disposal currently available to me which minimizes the present and future threat to human health and the environment; OR, if I am a small quantity generator, I have made a good faith effort to minimize my waste generation and select the best waste management method that is available to me and that I can afford.

Printed/Typed Name Signature Month Day Year
 [Signature] 11 02 12 19 14

17. Transporter 1 Acknowledgement of Receipt of Materials
 Printed/Typed Name Signature Month Day Year
 [Signature] 11 02 12 19 14

18. Transporter 2 Acknowledgement of Receipt of Materials
 Printed/Typed Name Signature Month Day Year

19. Discrepancy Indication Space

20. Facility Owner or Operator Certification of receipt of hazardous materials covered by this manifest except as noted in Item 19.
 Printed/Typed Name Signature Month Day Year

IN CASE OF EMERGENCY OR SPILL, CALL THE NATIONAL RESPONSE CENTER 1-800-424-8802; WITHIN CALIFORNIA, CALL 1-800-852-7650
 GENERATOR
 TRANSPORTER
 FACILITY

DO NOT WRITE BELOW THIS LINE.

IN CALIFORNIA, CALL 1-800-852-7555

HAZARDOUS WASTE MANIFEST

See Instructions on back of page 6.

Department of Toxic Substances
Sacramento, California
Information in the shaded areas
is not required by Federal law.

1. Generator's Name and Mailing Address
RIX INDUSTRIES
6460 HOLLISS STREET
EMERVILLE CA 94608

1. Generator's US EPA ID No.
CAD9820B8754/3101185

Manifest Document No.
2. Page 1 of 1

4. Generator's Phone
(510) 58-5275

6. US EPA ID Number
CAD10010626515

5. Transporter 1 Company Name
WASTE OIL RECOVERY

8. US EPA ID Number
CAD10010626515

9. Designated Facility Name and Site Address
ALVISO INDEPENDENT OIL P.O. BOX 184
5002 ARCHER STREET
ALVISO, CA 95002

10. US EPA ID Number
CAL100010485711

11. US DOT Description (including Proper Shipping Name, Hazard Class, and ID Number)
a. **USED OILS, NON RCRA HAZARDOUS**
b. **WASTE, LIQUID**

12. Containers	13. Total Quantity	14. Unit Wt/Vol	15. Waste Number
No.	Type		
1	DRUM	267.7715	221
			NON RCRA

Additional Descriptions for Materials Listed Above
WASTE FUEL AND WATER

Handling Instructions and Additional Information
PERSONAL PROTECTIVE EQUIPMENT
EMERGENCY 510 5330750

K. Handling Codes for Wastes Listed Above
a. **OIR**

CERTIFICATION: I hereby declare that the contents of this consignment are fully and accurately described above by proper shipping name and are classified, labeled, and are in all respects in proper condition for transport by highway according to applicable international and national government regulations.

I, **James Hagan**, certify that I have a program in place to reduce the volume and toxicity of waste generated to the degree I have determined to be feasible and that I have selected the practicable method of treatment, storage, or disposal currently available to me which minimizes the present and future risks to the environment; OR, if I am a small quantity generator, I have made a good faith effort to minimize my waste generation and select the best method that is available to me and that I can afford.

Signature of Generator: **James Hagan** Date: **12/27/94**

Signature of Transporter: **[Signature]** Date: **12/27/94**

Signature of Receiver: **[Signature]** Date: **12/27/94**

DO NOT WRITE BELOW THIS LINE.

IN CASE OF EMERGENCY OR SPILL, CALL THE NATIONAL RESPONSE CENTER 1-800-424-8802; WITHIN CALIFORNIA, CALL 1-800-852-7550

UNIFORM HAZARDOUS WASTE MANIFEST		1. Generator's US EPA ID No. C A D 9 8 2 0 3 8 7 5 4		Manifest Document No. 1 8 1 2 9		2. Page 1 of 1		Information in the shaded areas is not required by Federal law.		
3. Generator's Name and Mailing Address FRANK DEWOLF 76-6287 Leone Street, Kailua-Kona, HI. 96740					State Manifest Document Number 93618129					
4. Generator's Phone (808) 329-9796					State Generator's ID					
5. Transporter 1 Company Name H & H SHIP SERVICE COMPANY					6. US EPA ID Number C A D 0 0 4 7 7 1 1 6 8					
7. Transporter 2 Company Name					8. US EPA ID Number					
9. Designated Facility Name and Site Address H & H SHIP SERVICE COMPANY 220 TERRY FRANCOIS/CHINA BASIN SAN FRANCISCO, CA. 94107					10. US EPA ID Number C A D 0 0 4 7 7 1 1 6 8					
11. US DOT Description (including Proper Shipping Name, Hazard Class, and ID Number)					12. Containers		13. Total Quantity		14. Unit Wt/Vol	
a. WASTE EMPTY STORAGE TANKS NON-RCRA HAZARDOUS WASTE SOLID					No. Type		Quantity		State	
					0 0 4 T P		0 4 0 0 0		512	
b. WASTE EMPTY STORAGE TANK NON-RCRA HAZARDOUS WASTE SOLID					0 0 1 T P		0 2 0 0 0		512	
c.										
d.										
J. Additional Descriptions for Materials Listed Above FOUR EMPTY 1,000 gallon and ONE EMPTY 2,000 gallon storage tanks last containing fuel oil. Tanks inerted with dry ice for safe transport. PROFILE #A4638					K. Handling Codes for Wastes Listed Above					
					a. 01		b. 01			
15. Special Handling Instructions and Additional Information JOB #15271 24 Hr. Emergency Contact: H & H #(415) 543-4835 APPROPRIATE PROTECTIVE CLOTHING AND RESPIRATOR					JOB SITE: FRANK DEWOLF 6460 Hollis Street Emeryville, California					
16. GENERATOR'S CERTIFICATION: I hereby declare that the contents of this consignment are fully and accurately described above by proper shipping name and are classified, packed, marked, and labeled, and are in all respects in proper condition for transport by highway according to applicable international and national government regulations. If I am a large quantity generator, I certify that I have a program in place to reduce the volume and toxicity of waste generated to the degree I have determined to be economically practicable and that I have selected the practicable method of treatment, storage, or disposal currently available to me which minimizes the present and future threat to human health and the environment; OR, if I am a small quantity generator, I have made a good faith effort to minimize my waste generation and select the best waste management method that is available to me and that I can afford.										
Printed/Typed Name <i>Frank Dewolf</i>				Signature <i>Frank Dewolf</i>				Month Day Year 1 2 2 7 9 4		
17. Transporter 1 Acknowledgement of Receipt of Materials Printed/Typed Name JIMMIE H. REESE				Signature <i>Jimmie H. Reese</i>				Month Day Year 1 2 2 7 9 4		
18. Transporter 2 Acknowledgement of Receipt of Materials Printed/Typed Name				Signature				Month Day Year		
19. Discrepancy Indication Space										
20. Facility Owner or Operator Certification of receipt of hazardous materials covered by this manifest except as noted in Item 19. Printed/Typed Name										
				Signature				Month Day Year		

DO NOT WRITE BELOW THIS LINE.

IN CASE OF EMERGENCY OR SPILL, CALL THE NATIONAL RESPONSE CENTER 1-800-424-8802; WITHIN CALIFORNIA, CALL 1-800-852-7350

UNIFORM HAZARDOUS WASTE MANIFEST		1. Generator's US EPA ID No. CAD98203875H40296		Manifest Document No. 1 of 1		2. Page 1 of 1		Information in the shaded areas is not required by Federal law.					
3. Generator's Name and Mailing Address RIX INDUSTRIES 6460 HOLLIS STREET													
4. Generator's Phone 916585275 EMERYVILLE, CA 94608													
5. Transporter 1 Company Name WASTE OIL RECOVERY		6. US EPA ID Number CAD000626515											
7. Transporter 2 Company Name		8. US EPA ID Number											
9. Designated Facility Name and Site Address ALVISO INDEPENDENT OIL 5002 ARCHER STREET P.O. BOX 124 ALVISO, CA 95002		10. US EPA ID Number CAL000048571											
11. US DOT Description (including Proper Shipping Name, Hazard Class, and ID Number) USED OIL, NON RCRA HAZARDOUS WASTE, LIQUID		12. Containers		13. Total Quantity		14. Unit Wt/Vol.							
		No.		Type									
		001		TT		00600 G							
		b.											
		c.											
d.													
15. Special Handling Instructions and Additional Information WEAR PERSONAL PROTECTIVE EQUIPMENT 24 HOUR EMERGENCY 510533 0750 EIRC # 27													
16. GENERATOR'S CERTIFICATION: I hereby declare that the contents of the consignment are fully and accurately described above by proper shipping name and are classified, packed, marked, and labeled, and are in all respects in proper condition for transport by highway according to applicable federal, state and international laws. If I am a large quantity generator, I certify that I have a program in place to reduce the volume and toxicity of waste generated to the degree I have determined to be economically practicable and that I have selected the practicable method of treatment, storage, or disposal currently available to me which minimizes the present and future threat to human health and the environment; OR, if I am a small quantity generator, I have made a good faith effort to minimize my waste generation and select the best waste management method that is available to me and that I can afford.													
Printed/Typed Name [Signature]				Signature [Signature]				Month 12		Day 26		Year 1991	
17. Transporter 1 Acknowledgement of Receipt of Materials													
Printed/Typed Name MICHELLE HALLON				Signature [Signature]				Month 12		Day 26		Year 1991	
18. Transporter 2 Acknowledgement of Receipt of Materials													
Printed/Typed Name				Signature				Month		Day		Year	
19. Discrepancy Indication Space													
20. Facility Owner or Operator Certification of receipt of hazardous materials covered by this manifest except as noted in Item 19.													
Printed/Typed Name				Signature				Month		Day		Year	

DO NOT WRITE BELOW THIS LINE.

McKittrick Waste Treatment Site

January 23, 1995

Hageman-Aguiar, Inc.
3732 Mt. Diablo Blvd.
Lafayette, Ca. 94549
Attn: Bruce Hageman

RE: Rix Industries
UST Regulated Soil

Dear Customer,

We at McKittrick Waste Treatment Site (MWTS) would like to take this time to thank you for your interest in our services. After reviewing the information provided during profiling, we have determined the waste stream identified above meets the acceptance criteria as outlined in our facility permits.

Please reference the following profile number: 195-44BC, on each non-hazardous manifest. The price for bio-remediation/ reuse/ recycle will be \$25.00 per ton.

In the event that the waste weighs less than 1800 lbs. per cubic yard the price for disposal will be \$32.00 per cubic yard. MWTS has \$200.00 minimum charge per waste stream.

This price will remain firm for 30 days from the above date. All payments due within 30 days.

If you have any questions regarding this agreement, please feel free to contact me

Thank you,

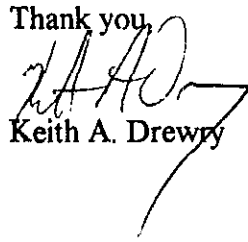
Keith A. Drewry

NON-HAZARDOUS WASTE DATA FORM

APPROVAL /PROFILE NUMBER 195-44-BC

Generator Information

Name Rix Industries

Address 6460 Hollis Street

City, State, Zip Emeryville, CA 94710

Signature of Authorized Agent *Diane Ferguson*

Phone (510) 284-1661 Date 01/11/94

The above signed generator certifies that the waste, as described, is 100% Non-Hazardous.

Waste To Be Disposed

Type Soil

Generating Location 6460 Hollis Street, Emeryville, CA

Quantity BBLs./GLs. 120 YARDS TONS

Transporter Information

Name Trident Trucking Company

Address 23422 Clawiter Road

City, State, Zip Hayward, CA 94545

Phone (510) 783-2881

Signature *Jim Martini* Date 1-18-95

Disposal Facility Information

McKittrick Waste Treatment Site

56533 Highway 58 West

McKittrick, Ca. 93251

(805) 762-7366

Signature *Kim Remy* Date 1-19-95

Ph 7

Tons 22.24

EPA # CAD 9806 36831

WEIGHMASTER CERTIFICATE

This is to certify that the following described commodity was weighed, measured, or counted by a weighmaster, whose signature is on this certificate, who is a recognized authority of accuracy, as prescribed by Chapter 7 (commencing with section 12700) of Division 5 of the California Business and Professions Code, administered by the Division of Measurement Standards of the California Department of Food and Agriculture.

BILLING INFORMATION

WEIGHMASTER • McKITTRICK WASTE TREATMENT SITE — A subsidiary of Sanifill, Inc.
 56533 HWY. 58 WEST • McKittrick, CA 93251
 (805) 762-7366

"CLASS II SITE"

No 038828

ACCEPTANCE NO. 115-4-10

INVOICE: HAULER GENERATOR
 110893A

WASH OUT: _____ @ \$ _____ EACH

COST PER TON: \$ _____

TOTAL COST: \$ _____

WEIGHING LOCATION:

**HIGHWAY 58, 1/4 MILE WEST OF HIGHWAY 33
 McKITTRICK, CALIFORNIA**

If Waste Is Weighed it is 100% Nonhazardous

GROSS BY _____
 TARE BY _____ DEPUTY _____
 DEPUTY (IF DIFFERENT FROM GROSS ABOVE) _____

DATE	TIME	WEIGHT IN LBS.
01/19/95	03:05 PM	73800 lb
01/19/95	03:36 PM	29320 lb (44420)
		<u>22.24</u>

GROSS 13914
 WEIGHED FOR / SELLER _____
 TARE _____
 NET _____
 DELIVERED TO / BUYER _____
 TONS _____
 DRIVER Gene Atant

VEHICLE LIC. NOS.	TRAILER LIC.	TRAILER LIC.	COMMODITY	UNITS	B/L NO.
<u>1W31986</u>	<u>6U4059</u>			<u>2009</u>	<u>NIP</u>
CARRIER				FEE: <input type="checkbox"/> PD <input type="checkbox"/> CHG \$ _____	

SAMPLE SCREENING INFORMATION

COLOR 1 SULFIDES _____
 CYANIDES 1
 pH 7 LAYERS 1
 FREE LIQUID _____
 FLASH PT. _____
 OTHER _____

DATE: 01/19/95
TIME: 15:16:58

TICKET NO.: 12919

PLANT: ~~XXXXXXXXXXXXXXXXXXXXXXXXXXXX~~

56533 Highway 50 West
McKittrick, CA 93251

LANDFILL PHONE: (805)762-7366 BUS PHONE: (805)762-7366

GENERATOR:	RLX INDUSTRIES	COLOR :	DEF	PI :	7.00
SOURCE:		SULFIDES :	NEG	LAYERS :	1.00
HAULER:	38828	CYANIDES :	NEG	RAPPELS :	0
MANIFEST#:	NA	UREA :			
		FLASH PT :			
COMMODITY:	BIO S/DESL				

P.O.#:
CELL. LOC: IA
VIN# : H0023A

ACCT#:	5030823	*-----*	CUSTOMER	*-----*
			HARGREAVE-AGULLAR INC.	
VEN. TYPE:	ENDDUMP		3732 RT DIABLO BLVD	
PNT. TYPE:	CHARGE		LAFAYETTE CA 94549-	
		-----		*-----*

12/1/95

CK#:
DL#:
SLSP#:

GROSS SCALE: 79800
TARE: 29320
NET POUNDS: 44480
NET TONS: 22.2400

PREPARED BY: KP

SIGNATURE: James McKittrick

WEIGHMASTER: Bill Berry

This is to certify that the following described commodity was measured, or counted by a weighmaster, whose signature is on this certificate, who is a recognized authority of accuracy, as prescribed by Chapter 7 (commencing with section 12700) of division 5 of the California Business and Professions Code, administered by the Division of Measurement Standards of the California Department of Food and Agriculture.

NON-HAZARDOUS WASTE DATA FORM

APPROVAL /PROFILE NUMBER 195-44-BC

Generator Information

Name Rix Industries

Address 6460 Hollis Street

City, State, Zip Emeryville, CA 94710

Signature of Authorized Agent *[Signature]*

Phone (510) 284-1661 Date 01/11/94

The above signed generator certifies that the waste, as described, is 100% Non-Hazardous.

Waste To Be Disposed

Type Soil

Generating Location 6460 Hollis Street, Emeryville, CA

Quantity BBLs./GLS. 120 YARDS TONS

Transporter Information

Name Trident Trucking Company

Address 23422 Clawiter Road

City, State, Zip Hayward, CA 94545

Phone (510) 783-2881

Signature *[Signature]* Date 1-19-95

TOMMY ALKINGTON

Disposal Facility Information

McKittrick Waste Treatment Site
56533 Highway 58 West
McKittrick, Ca. 93251
(805) 762-7366

Ph 7

Tons 25.39

Signature *[Signature]* Date 01/19/95

EPA # CAD 9806 36831

WEIGHMASTER CERTIFICATE

This is to certify that the following described commodity was weighed, measured, or counted by a weighmaster, whose signature is on this certificate, who is a recognized authority of accuracy, as prescribed by Chapter 7 (commencing with section 12700) of Division 5 of the California Business and Professions Code, administered by the Division of Measurement Standards of the California Department of Food and Agriculture.

BILLING INFORMATION

WEIGHMASTER • McKITTRICK WASTE TREATMENT SITE — A subsidiary of Sanifill, Inc.
 56533 HWY. 58 WEST • McKittrick, CA 93251
 (805) 762-7366

"CLASS II SITE"

No 038827

WEIGHING LOCATION:

**HIGHWAY 58, 1/4 MILE WEST OF HIGHWAY 33
 McKITTRICK, CALIFORNIA**

If Waste Is Weighed it is 100% Nonhazardous

DATE	TIME	WEIGHT IN LBS.
01/19/95	02:48 PM	80020 lb
01/19/95	03:32 PM	29240 lb
		50780
		25.39

GROSS BY	DEPUTY
TARE BY	DEPUTY
DEPUTY (IF DIFFERENT FROM GROSS ABOVE)	
GROSS 12913	
WEIGHED FOR / SELLER	
DELIVERED TO / BUYER	
DRIVER <i>Tommy [Signature]</i>	

VEHICLE LIC. NOS.	TRAILER LIC.	TRAILER LIC.	COMMODITY	UNITS	B/L NO.
OP 74515	OT 83515			25.39	A.F
CARRIER			FEE: <input type="checkbox"/> PD <input type="checkbox"/> CHG \$		

ACCEPTANCE NO. 115-4112
 INVOICE: HAULER GENERATOR
 H. 13A
 WASH OUT: _____ @ \$ _____ EACH
 COST PER TON: \$ _____
 TOTAL COST: \$ _____

SAMPLE SCREENING INFORMATION

COLOR White SULFIDES _____
 CYANIDES 1
 pH 7 LAYERS 1
 FREE LIQUID _____
 FLASH PT. _____
 OTHER _____

DATE: 01/15/95
TIME: 15:12:29

TICKET NO.: 12913

56533 Highway 58 West
McKittrick, CA 93251

LANDFILL PHONE: (805)762-7366 BUS PHONE: (805)762-7366

GENERATOR: RIX INDUSTRIES COLOR: BRN PH: 2.00
SOURCE: SULFIDES: NEG LAYERS: 1.00
HAULER: 38827 CYLINDERS: NEG BARRELS: 0
MANIFEST#: NA FREE LTO:
COMMODITY: RIO S/DESL FLASH PT:

P.O.#:
CELL LOC: 1A
VIN#: H0823A

ACCT#: 5030823
VEH TYPE: ENDDUMP
PMT TYPE: CHARGE

***** CUSTOMER *****
| HADGEMAN-AQUILAR INC |
| |
| 3732 MT DIABLO BLVD |
| |
| LAFAYETTE CA 94549- |

CK#:
DL#:
SLSP:

GROSS SCALE: 80020
TAKE: 29240
NET POUNDS: 50780
NET TONS: 25.3900

PREPARED BY: KP

SIGNATURE: *Tommy Pildington*

WEIGHMASTER: *Kyle Perry*

This is to certify that the following described commodity was measured, or counted by a weighmaster, whose signature is on this certificate, who is a recognized authority of accuracy, as prescribed by Chapter 7 (commencing with section 12700) of division 5 of the California Business and Professions Code, administered by the Division of Measurement Standards of the California Department of Food and Agriculture.

#12923

NON-HAZARDOUS WASTE DATA FORM

APPROVAL /PROFILE NUMBER 195-44-BC

Generator Information

Name Rix Industries

Address 6460 Hollis Street

City, State, Zip Emeryville, CA 94710

Signature of Authorized Agent *[Signature]*

Phone (510) 284-1661 Date 01/11/94

The above signed generator certifies that the waste, as described, is 100% Non-Hazardous.

Waste To Be Disposed

Type Soil

Generating Location 6460 Hollis Street, Emeryville, CA

Quantity BBLs./GLs. 120 YARDS TONS

Transporter Information

Name Trident Trucking Company

Address 23422 Clawiter Road

City, State, Zip Hayward, CA 94545

Phone (510) 783-2881

Signature *[Signature]* Date 1-19-95

Disposal Facility Information

McKittrick Waste Treatment Site
56533 Highway 58 West
McKittrick, Ca. 93251
(805) 762-7366

Ph 7

Tons 20.69

Signature *[Signature]* Date 1/19/95

EPA # CAD 9806 36831

DATE: 01/19/95
TIME: 18:18:58

TICKEY NO.: 12923

Price of commodity as of 1/19/95 10:00 AM PST

56533 Highway 53 West

McKittrick, CA 93251

LANDFILL PHONE: (805)762-7366 BUS PHONE: (805)762-7366

GENERATOR: RIX INDUSTRIES COLOR: RED PH: 2.00
SOURCE: SULFIDES: NEG LAYERS: 1.00
HAULER: 38837 CYANIDES: NEG BARRELS: 0
MPTLESTN: NA FREE LIO:
FLASH PT:

COMMODITY: BIO S/DESL

PLC#:
CELL LOC: IA
VIN#: H0823A

ACCT#: 5030823

VEH TYPE: ENDDUMP

PMT TYPE: CHARGE

CUSTOMER	
HAULMAN-AQUILAR INC	
3732 RT Diablo Blvd	
LAFAYETTE CA 94542	

1811ds

CK#:
DL#:
SLSP:

GROSS SCALE: 72640
TARE: 31260
NET POUNDS: 41380
NET TONS: 20.6900

PREPARED BY: KF

SIGNATURE: *Mark S. Nelson*

WEIGHMASTER: *Kevin Reilly*

This is to certify that the following described commodity was measured, or counted by a weighmaster, whose signature is on this certificate, who is a recognized authority of accuracy, as prescribed by Chapter 7 (commencing with section 12700) of division 5 of the California Business and Professions Code, administered by the Division of Measurement Standards of the California Department of Food and Agriculture.

WEIGHMASTER CERTIFICATE

This is to certify that the following described commodity was weighed, measured, or counted by a weighmaster, whose signature is on this certificate, who is a recognized authority of accuracy, as prescribed by Chapter 7 (commencing with section 12700) of Division 5 of the California Business and Professions Code, administered by the Division of Measurement Standards of the California Department of Food and Agriculture.

WEIGHMASTER • McKITTRICK WASTE TREATMENT SITE — A subsidiary of Sanifill, Inc.
 56533 HWY. 58 WEST • McKittrick, CA 93251
 (805) 762-7366

"CLASS II SITE"

No 038837

WEIGHING LOCATION:

**HIGHWAY 58, 1/4 MILE WEST OF HIGHWAY 33
 McKITTRICK, CALIFORNIA**

If Waste Is Weighed it is 100% Nonhazardous

DATE	TIME	WEIGHT IN LBS.
01.19.95	05:52 PM	72640 lb
01.19.95	06:38 PM	31250 lb
		<u>41380</u>
		<u>20.09</u>

GROSS BY Tom R. Sizer

TARE BY Kim R. Evans DEPUTY

12933 DEPUTY (IF DIFFERENT FROM GROSS ABOVE)

WEIGHED FOR / SELLER Mark E. Feldman

DELIVERED TO / BUYER McKittrick Waste Treatment Site

DRIVER Mark E. Feldman

VEHICLE LIC. NOS.	TRAILER LIC.	TRAILER LIC.	COMMODITY	UNITS	B/LY NO.
<u>9A20642</u>	<u>H71VH41416</u>		<u>Soil</u>	<u>20</u>	<u>N/A</u>

FEE: PD CHG \$

BILLING INFORMATION

ACCEPTANCE NO. 15-44130

INVOICE: HAULER GENERATOR
 HAR23A

WASH OUT: _____ @ \$ _____ EACH

COST PER TON: \$ _____

TOTAL COST: \$ _____

SAMPLE SCREENING INFORMATION

COLOR DM SULFIDES IRX

CYANIDES 16g

pH 7 LAYERS 1

FREE LIQUID _____

FLASH PT. _____

OTHER _____

CARRIER Justus #25

#12924

NON-HAZARDOUS WASTE DATA FORM

APPROVAL /PROFILE NUMBER 195-44-BC

Generator Information

Name Rix Industries

Address 6460 Hollis Street

City, State, Zip Emeryville, CA 94710

Signature of Authorized Agent [Signature]

Phone (510) 284-1661 Date 01/11/94

The above signed generator certifies that the waste, as described, is 100% Non-Hazardous.

Waste To Be Disposed

Type Soil

Generating Location 6460 Hollis Street, Emeryville, CA

Quantity BBLs./GLs. 120 YARDS TONS

Transporter Information

Name Trident Trucking Company

Address 23422 Clawiter Road

City, State, Zip Hayward, CA 94545

Phone (510) 783-2881

Signature [Signature] Date 1-19-95

Disposal Facility Information

McKittrick Waste Treatment Site
56533 Highway 58 West
McKittrick, Ca. 93251
(805) 762-7366

Signature [Signature] Date Jan 19, 95

Ph 7

Tons 22.58

EPA # CAD 980636831

WEIGHMASTER CERTIFICATE

This is to certify that the following described commodity was weighed, measured, or counted by a weighmaster, whose signature is on this certificate, who is a recognized authority of accuracy, as prescribed by Chapter 7 (commencing with section 12700) of Division 5 of the California Business and Professions Code, administered by the Division of Measurement Standards of the California Department of Food and Agriculture.

WEIGHMASTER • McKITTRICK WASTE TREATMENT SITE — A subsidiary of Sanifill, Inc.
 56533 HWY. 58 WEST • McKittrick, CA 93251
 (805) 762-7366

"CLASS II SITE"

No 038838

WEIGHING LOCATION:

**HIGHWAY 58, 1/4 MILE WEST OF HIGHWAY 33
 McKITTRICK, CALIFORNIA**

If Waste Is Weighed it is 100% Nonhazardous

DATE	TIME	WEIGHT IN LBS.
01/19/95	05:55 PM	71760 lb
01/19/95	06:54 PM	26600 lb
		<u>45160</u>
		<u>22.58</u>

GROSS BY: [Signature]

TARE BY: [Signature] DEPUTY

DEPUTY (IF DIFFERENT FROM GROSS ABOVE): [Signature]

WEIGHED FOR / SELLER: [Signature]

DELIVERED TO / BUYER: [Signature]

DRIVER: [Signature]

VEHICLE LIC. NOS.	TRAILER LIC.	TRAILER LIC.	COMMODITY	UNITS	BL/ NO.
9A53972	IVN4307		Sulfides	22.58	

CARRIER: Orident #33

FEE: PD CHG \$

BILLING INFORMATION

ACCEPTANCE NO. 195 44150

INVOICE: HAULER GENERATOR
 110723A

WASH OUT: _____ @ \$ _____ EACH

COST PER TON: \$ _____

TOTAL COST: \$ _____

SAMPLE SCREENING INFORMATION

COLOR DM SULFIDES 105

CYANIDES 105

pH 7 LAYERS 1

FREE LIQUID _____

FLASH PT. _____

OTHER _____

DATE: 01/19/95
TIME: 18:34:41

TICKET NO.: 12924

Price of commodity shown in Release of Storage Fee and Receipts for the Commodity

56533 Highway 58 West

Hickitrick, CA 93251

LANDFILL PHONE: (805)762-7366 BUS PHONE: (805)762-7366

GENERATOR:	RTX INDUSTRIES	COLOR:	BRN	PH:	7.00
SOURCE:		SUFFICES:	NEO	LAYERS:	1.00
HAULER:	38030	CYANIDES:	NRG	SOUFFLES:	0
MANIFEST#:	NA	FREE LIQ:			
		FLASH PT:			
COMMODITY:	BTD S/DESL				

PLU#:
CELL LOC: IA
URN: H08230

ACC#: 5030873

VEH TYPE: ENDDUMP

PMT TYPE: CHARGE

***** CUSTOMER *****
 | HAUGEMAN GOUTHER MIL
 | 3732 RT DUBLIN BLVD
 | LOFAYETTE CA 94569

184 yds

CK#:
DL#:
SLSP:

GROSS SCALE:	71760	
TARE:	26600	
NET POUNDS:	45160	
NET TONS:	22.5800	

PREPARED BY: KP

SIGNATURE: *Laurie* #3350#5

WEIGHMASTER: *[Signature]*

This is to certify that the following described commodity was measured, or counted by a weighmaster, whose signature is on this certificate, who is a recognized authority of accuracy, as prescribed by Chapter 7 (commencing with section 12700) of division 5 of the California Business and Professions Code, administered by the Division of Measurement Standards of the California Department of Food and Agriculture.

12917

NON-HAZARDOUS WASTE DATA FORM

APPROVAL /PROFILE NUMBER 195-44-BC

Generator Information

Name Rix Industries

Address 6460 Hollis Street

City, State, Zip Emeryville, CA 94710

Signature of Authorized Agent [Signature]

Phone (510) 284-1661 Date 01/11/94

The above signed generator certifies that the waste, as described, is 100% Non-Hazardous.

Waste To Be Disposed

Type Soil

Generating Location 6460 Hollis Street, Emeryville, CA

Quantity BBLs./GLS. 120 YARDS TONS

Transporter Information

Name Trident Trucking Company

Address 23422 Clawiter Road

City, State, Zip Hayward, CA 94545

Phone (510) 783-2881

Signature [Signature] Date 1-19-95

Disposal Facility Information

McKittrick Waste Treatment Site

56533 Highway 58 West

McKittrick, Ca. 93251

(805) 762-7366

Signature [Signature]

Date Jan 19, 95

Ph 7

Tons 21.02

EPA # CAD 9806 36831

DATE: 01/19/95
TIME: 17:40:00

TICKET NO.: 12917

PACKER: [illegible]

56533 Highway 58 West

McKittrick, CA 93251

LANDFILL PHONE: (805) 762-7366 BUS PHONE: (805) 762-7366

GENERATOR:	RIX INDUSTRIES	COLOR:	BRN	FE:	7.00
SOURCE:		SULFIDES:	PLG	LAYERS:	1.00
HEATER:	38829	CYNIDES:	DEA	DRUMS:	0
MANIFEST#:	NA	FREE TQ:			
		FLASH P1:			
COMMODITY:	BIO S/DEGL				

P.O.#:
CELL LOC: 1A
UTN#: H08230

DATE: 5030823

VEH TYPE: ENDDUMP

PHI TYPE: CHARGE

1	HAGGEMID ROLLERS 100	
1	3232 FT DOUBLE BLVD	
1	LABYRETT	CA 9454

18 yds

CK#:
GL#:
SLST#:

GROSS SCALE#	70920
TARE#	28080
NET POUNDS#	42040
NET TONS#	21.0200

PREPARED BY: KP

SIGNATURE: *Thomas E. Perry*

WEIGHMASTER: *Tom Perry*

This is to certify that the following described commodity was measured, or counted by a weighmaster, whose signature is on this certificate, who is a recognized authority of accuracy, as prescribed by Chapter 7 (commencing with section 12700) of division 5 of the California Business and Professions Code, administered by the Division of Measurement Standards of the California Department of Food and Agriculture.

WEIGHMASTER CERTIFICATE

This is to certify that the following described commodity was weighed, measured, or counted by a weighmaster, whose signature is on this certificate, who is a recognized authority of accuracy, as prescribed by Chapter 7 (commencing with section 12700) of Division 5 of the California Business and Professions Code, administered by the Division of Measurement Standards of the California Department of Food and Agriculture.

WEIGHMASTER • McKITTRICK WASTE TREATMENT SITE — A subsidiary of Sanfill, Inc.
 56533 HWY. 58 WEST • McKittrick, CA 93251
 (805) 762-7366 **"CLASS II SITE"**

No 038829

BILLING INFORMATION

ACCEPTANCE NO. 195-441BC
 INVOICE: HAULER GENERATOR
 HWY 23A
 WASH OUT: _____ @ \$ _____ EACH
 COST PER TON: \$ _____
 TOTAL COST: \$ _____

WEIGHING LOCATION:

**HIGHWAY 58, 1/4 MILE WEST OF HIGHWAY 33
 McKITTRICK, CALIFORNIA**

If Waste Is Weighed it is 100% Nonhazardous

DATE	TIME	WEIGHT IN LBS.
01.19.95	08:00 PM	28880 lb Tare
		2930 gross
		42040
		21.02

GROSS BY [Signature]
 TARE BY [Signature] DEPUTY
 DEPUTY (IF DIFFERENT FROM GROSS ABOVE)
 WEIGHED FOR / SELLER ROY INDUST.
 DELIVERED TO / BUYER McKittrick Waste Treatment Site
 DRIVER [Signature]

SAMPLE SCREENING INFORMATION

COLOR Brown SULFIDES neg
 CYANIDES neg
 pH 7 LAYERS 1
 FREE LIQUID _____
 FLASH PT. _____
 OTHER _____

VEHICLE LIC. NOS.	TRAILER LIC.	TRAILER LIC.	COMMODITY	UNITS	B/L NO.
<u>4R13942</u>	<u>1VN4289</u>		<u>DMW 010/11PSC</u>	<u>21.02</u>	<u>N/A</u>
CARRIER			FEE: <input type="checkbox"/> PD <input type="checkbox"/> CHG \$ _____		

Incident # 208

#12920

NON-HAZARDOUS WASTE DATA FORM

APPROVAL /PROFILE NUMBER 195-44-BC

Generator Information

Name Rix Industries

Address 6460 Hollis Street

City, State, Zip Emeryville, CA 94710

Signature of Authorized Agent [Signature]

Phone (510) 284-1661 Date 01/11/94

The above signed generator certifies that the waste, as described, is 100% Non-Hazardous.

Waste To Be Disposed

Type Soil

Generating Location 6460 Hollis Street, Emeryville, CA

Quantity BBLs./GLS. 120 YARDS TONS

Transporter Information

Name Trident Trucking Company

Address 23422 Clawiter Road

City, State, Zip Hayward, CA 94545

Phone (510) 783-2881

Signature [Signature] Date 1-19-95

Disposal Facility Information

McKittrick Waste Treatment Site
56533 Highway 58 West
McKittrick, Ca. 93251
(805) 762-7366

Ph 7

Tons 24.05

Signature [Signature] Date Jan 19, 95

EPA # CAD 9806 36831

WEIGHMASTER CERTIFICATE

This is to certify that the following described commodity was weighed, measured, or counted by a weighmaster, whose signature is on this certificate, who is a recognized authority of accuracy, as prescribed by Chapter 7 (commencing with section 12700) of Division 5 of the California Business and Professions Code, administered by the Division of Measurement Standards of the California Department of Food and Agriculture.

WEIGHMASTER • MCKITTRICK WASTE TREATMENT SITE — A subsidiary of Sanfill, Inc.
 56533 HWY. 58 WEST • McKittrick, CA 93251
 (805) 762-7366

"CLASS II SITE"

No 038836

WEIGHING LOCATION:

**HIGHWAY 58, 1/4 MILE WEST OF HIGHWAY 33
 MCKITTRICK, CALIFORNIA**

If Waste Is Weighed it is 100% Nonhazardous

DATE	TIME	WEIGHT IN LBS.
01/19/95	05:48 PM	73600 lb
01/19/95	05:32 PM	30500 lb
		<u>48100</u>
		<u>24.05</u>

GROSS BY: [Signature]

TARE BY: [Signature] DEPUTY

DEPUTY (IF DIFFERENT FROM GROSS ABOVE): [Signature]

WEIGHED FOR / SELLER: DIV

DELIVERED TO / BUYER: McKittrick Waste Treatment Site

DRIVER: Frank Loria

VEHICLE LIC. NOS.	TRAILER LIC.	TRAILER LIC.	COMMODITY	UNITS	B/L NO.
<u>9E11758</u>	<u>1161107</u>		<u>DE/SOIL/BSL</u>	<u>24.05</u>	
CARRIER: <u>Induct</u>				FEE: <input type="checkbox"/> PD <input type="checkbox"/> CHG \$	

BILLING INFORMATION

ACCEPTANCE NO. 1015-11130

INVOICE: HAULER GENERATOR
 40823A

WASH OUT: _____ @ \$ _____ EACH

COST PER TON: \$ _____

TOTAL COST: \$ _____

SAMPLE SCREENING INFORMATION

COLOR: DLN SULFIDES: 1118

CYANIDES: 1118

pH: 7 LAYERS: 1

FREE LIQUID: _____

FLASH PT. _____

OTHER: _____

DATE: 01/19/95
TIME: 18:13:01

TICKET NO.: 12922

INDUSTRIAL ELECTRIC SUPPLY CO. INC.

56533 Highway 50 West

Red Bluff, CA 93251

LANDLINE PHONE: (805) 762-7366 BUS PHONE: (805) 762-7366

GENERATOR:	RIX INDUSTRIES	COLOR :	BRN	PH :	7.00
SOURCE:		SUFTES :	NEG	LAYERS :	1.00
HAULER:	30036	CYANDES :	0.0	BUFFELS :	0
MANIFEST#:	NA	FREE LTO :			
		FLASH PT :			

COMMODITY: BIO S/DESL

P.O.#:
CELL LOC: 1A
V.I.N.#: H08231

TACT#: 5030823

VEH TYPE: ENDDUMP

PNT TYPE: CHARGE

***** CUSTOMER *****
HADJENAN-AGUILAR INC
3732 RT DIABLO BLVD
LAFAYETTE CA 94549

18110's

CR#:
DL#:
SLSP:

GROSS SCALE:	70600	
TARE:	30500	
NET POUNDS:	40100	
NET TONS:	24.0500	

PREPARED BY: KF

SIGNATURE: Floyd Dina

WEIGHMASTER: C. Kim Perry

This is to certify that the following described commodity was measured, or counted by a weighmaster, whose signature is on this certificate, who is a recognized authority of accuracy, as prescribed by Chapter 7 (commencing with section 12700) of division 5 of the California Business and Professions Code, administered by the Division of Measurement Standards of the California Department of Food and Agriculture.

LABORATORY DATA



PRIORITY ENVIRONMENTAL LABS

Precision Environmental Analytical Laboratory

December 31, 1994

PEL # 9412087

HAGEMAN - AGUIAR, INC.

Attn: Jeffrey Roth

Re: Ten soil samples for Gasoline/BTEX and TEPH analyses.

Project name: Rix Industries

Project location: 6460 Hollis St., - Emeryville, CA.

Date sampled: Dec 28, 1994

Date submitted: Dec 29, 1994

Date extracted: Dec 29-31, 1994

Date analyzed: Dec 29-31, 1994

RESULTS:

SAMPLE I.D.	Kerosene (mg/Kg)	Gasoline (mg/Kg)	Diesel (mg/Kg)	Benzene (ug/Kg)	Toluene (ug/Kg)	Ethyl Benzene (ug/Kg)	Total Xylenes (ug/Kg)	Motor Oil (mg/Kg)	Stoddard Solvent (mg/Kg)
SW 1	N.D.	N.D.	N.D.	N.D.	N.D.	N.D.	N.D.	N.D.	N.D.
SW 2	N.D.	N.D.	N.D.	N.D.	N.D.	N.D.	N.D.	N.D.	N.D.
SW 3	N.D.	N.D.	N.D.	N.D.	N.D.	N.D.	N.D.	N.D.	N.D.
SW 4	N.D.	N.D.	N.D.	N.D.	N.D.	N.D.	N.D.	N.D.	N.D.
SW 5	N.D.	N.D.	N.D.	N.D.	N.D.	N.D.	N.D.	N.D.	3.9
SW 6	N.D.	N.D.	N.D.	N.D.	N.D.	N.D.	N.D.	N.D.	4.2
SW 7	N.D.	N.D.	N.D.	N.D.	N.D.	N.D.	N.D.	N.D.	N.D.
SW 8	N.D.	N.D.	N.D.	N.D.	N.D.	N.D.	N.D.	N.D.	N.D.
SW 9	N.D.	N.D.	N.D.	N.D.	N.D.	N.D.	N.D.	N.D.	N.D.
SW 10	N.D.	N.D.	N.D.	N.D.	N.D.	N.D.	N.D.	N.D.	N.D.
Blank	N.D.	N.D.	N.D.	N.D.	N.D.	N.D.	N.D.	N.D.	N.D.
Spiked Recovery	---	88.6%	101.2%	88.3%	90.2%	91.0%	100.5%	---	---
Detection limit	1.0	1.0	1.0	5.0	5.0	5.0	5.0	10	1.0
Method of Analysis	3550/ 8015	5030 / 8015	3550 / 8015	8020	8020	8020	8020	3550/ 8015	3550/ 8015

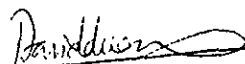
 David Duong
 Laboratory Director



PRIORITY ENVIRONMENTAL LABS

Precision Environmental Analytical Laboratory

December 31, 1994

PEL # 9412087

HAGEMAN - AGUIAR, INC.

Attn: Jeffrey Roth

Re: Ten soil samples for Acetone, Isopropanol, MEK, MIBK, and Sec-Butanol analyses.

Project name: Rix Industries

Project location: 6460 Hollis St., - Emeryville, CA.

Date sampled: Dec 28, 1994

Date submitted: Dec 29, 1994

Date extracted: Dec 29-31, 1994

Date analyzed: Dec 29-31, 1994

RESULTS:

SAMPLE I.D.	Acetone (mg/Kg)	Isopropanol (mg/Kg)	MEK (mg/Kg)	MIBK (mg/Kg)	Sec-Butanol (mg/Kg)
SW 1	2.2	30	N.D.	N.D.	N.D.
SW 2	2.0	65	N.D.	N.D.	N.D.
SW 3	N.D.	29	N.D.	N.D.	N.D.
SW 4	2.6	170	1.1	0.6	N.D.
SW 5	3.0	860	3.1	5.6	N.D.
SW 6	6.9	330	1.7	1.4	N.D.
SW 7	4.8	500	0.9	2.5	N.D.
SW 8	6.2	530	1.2	2.6	N.D.
SW 9	3.1	180	31	0.8	N.D.
SW 10	N.D.	35	12	N.D.	N.D.
Blank	N.D.	N.D.	N.D.	N.D.	N.D.
Detection limit	0.5	0.5	0.5	0.5	0.5
Method of Analysis	8015	8015	8015	8015	8015

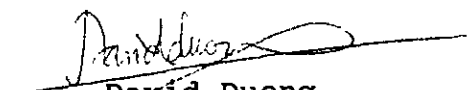
David Duong
Laboratory Director



PRIORITY ENVIRONMENTAL LABS

Precision Environmental Analytical Laboratory

December 31, 1994

PEL # 9412087

HAGEMAN - AGUIAR, INC.

Attn: Jeffrey Roth

Project name: Rix Industries

Project location: 6460 Hollis St. Emeryville, CA

Sample I.D.: SW 1

Date Sampled: Dec 28, 1994

Date Submitted: Dec 29, 1994

Date Analyzed: Dec 29-31, 1994

Method of Analysis: EPA 8010

Detection limit: 5.0 ug/Kg

COMPOUND NAME	CONCENTRATION (ug/Kg)	SPIKE RECOVERY (%)
---------------	----------------------------	-------------------------

Chloromethane	N.D.	-----
Vinyl Chloride	N.D.	-----
Bromomethane	N.D.	-----
Chloroethane	N.D.	-----
Trichlorofluoromethane	N.D.	-----
1,1-Dichloroethene	N.D.	-----
Methylene Chloride	N.D.	-----
1,2-Dichloroethene (TOTAL)	N.D.	-----
1,1-Dichloroethane	N.D.	-----
Chloroform	N.D.	-----
1,1,1-Trichloroethane	N.D.	-----
Carbon Tetrachloride	N.D.	-----
1,2-Dichloroethane	N.D.	-----
Trichloroethene	N.D.	-----
1,2-Dichloropropane	N.D.	-----
Bromodichloromethane	N.D.	-----
2-Chloroethylvinylether	N.D.	-----
Trans-1,3-Dichloropropene	N.D.	-----
Cis-1,3-Dichloropropene	N.D.	-----
1,1,2-Trichloroethane	N.D.	-----
Tetrachloroethene	N.D.	-----
Dibromochloromethane	N.D.	-----
Chlorobenzene	N.D.	-----
Bromoform	N.D.	-----
1,1,2,2-Tetrachloroethane	N.D.	-----
1,3-Dichlorobenzene	N.D.	-----
1,4-Dichlorobenzene	N.D.	-----
1,2-Dichlorobenzene	N.D.	-----

David Duong
Laboratory Director



PRIORITY ENVIRONMENTAL LABS

Precision Environmental Analytical Laboratory

December 31, 1994

PEL # 9412087

HAGEMAN - AGUIAR, INC.

Attn: Jeffrey Roth

Project name: Rix Industries

Project location: 6460 Hollis St. Emeryville, CA

Sample I.D.: SW 2

Date Sampled: Dec 28, 1994

Date Submitted: Dec 29, 1994

Date Analyzed: Dec 29-31, 1994

Method of Analysis: EPA 8010

Detection limit: 5.0 ug/Kg

COMPOUND NAME	CONCENTRATION (ug/Kg)	SPIKE RECOVERY (%)
Chloromethane	N.D.	-----
Vinyl Chloride	N.D.	-----
Bromomethane	N.D.	-----
Chloroethane	N.D.	-----
Trichlorofluoromethane	N.D.	-----
1,1-Dichloroethene	N.D.	-----
Methylene Chloride	N.D.	-----
1,2-Dichloroethene (TOTAL)	N.D.	-----
1,1-Dichloroethane	N.D.	-----
Chloroform	N.D.	-----
1,1,1-Trichloroethane	N.D.	-----
Carbon Tetrachloride	N.D.	-----
1,2-Dichloroethane	N.D.	-----
Trichloroethene	N.D.	-----
1,2-Dichloropropane	N.D.	-----
Bromodichloromethane	N.D.	-----
2-Chloroethylvinylether	N.D.	-----
Trans-1,3-Dichloropropene	N.D.	-----
Cis-1,3-Dichloropropene	N.D.	-----
1,1,2-Trichloroethane	N.D.	-----
Tetrachloroethene	N.D.	-----
Dibromochloromethane	N.D.	-----
Chlorobenzene	N.D.	-----
Bromoform	N.D.	-----
1,1,2,2-Tetrachloroethane	N.D.	-----
1,3-Dichlorobenzene	N.D.	-----
1,4-Dichlorobenzene	N.D.	-----
1,2-Dichlorobenzene	N.D.	-----

David Duong
Laboratory Director



PRIORITY ENVIRONMENTAL LABS

Precision Environmental Analytical Laboratory

December 31, 1994

PEL # 9412087

HAGEMAN - AGUIAR, INC.

Attn: Jeffrey Roth

Project name: Rix Industries

Project location: 6460 Hollis St. Emeryville, CA

Sample I.D.: SW 3

Date Sampled: Dec 28, 1994

Date Submitted: Dec 29, 1994

Date Analyzed: Dec 29-31, 1994

Method of Analysis: EPA 8010

Detection limit: 5.0 ug/Kg

COMPOUND NAME	CONCENTRATION (ug/Kg)	SPIKE RECOVERY (%)
---------------	----------------------------	-------------------------

Chloromethane	N.D.	-----
Vinyl Chloride	N.D.	-----
Bromomethane	N.D.	-----
Chloroethane	N.D.	-----
Trichlorofluoromethane	N.D.	-----
1,1-Dichloroethene	N.D.	-----
Methylene Chloride	N.D.	-----
1,2-Dichloroethene (TOTAL)	N.D.	-----
1,1-Dichloroethane	N.D.	-----
Chloroform	N.D.	-----
1,1,1-Trichloroethane	N.D.	-----
Carbon Tetrachloride	N.D.	-----
1,2-Dichloroethane	N.D.	-----
Trichloroethene	N.D.	-----
1,2-Dichloropropane	N.D.	-----
Bromodichloromethane	N.D.	-----
2-Chloroethylvinylether	N.D.	-----
Trans-1,3-Dichloropropene	N.D.	-----
Cis-1,3-Dichloropropene	N.D.	-----
1,1,2-Trichloroethane	N.D.	-----
Tetrachloroethene	N.D.	-----
Dibromochloromethane	N.D.	-----
Chlorobenzene	N.D.	-----
Bromoform	N.D.	-----
1,1,2,2-Tetrachloroethane	N.D.	-----
1,3-Dichlorobenzene	N.D.	-----
1,4-Dichlorobenzene	N.D.	-----
1,2-Dichlorobenzene	N.D.	-----

David Duong
Laboratory Director



PRIORITY ENVIRONMENTAL LABS

Precision Environmental Analytical Laboratory

December 31, 1994

PEL # 9412087

HAGEMAN - AGUIAR, INC.

Attn: Jeffrey Roth

Project name: Rix Industries

Project location: 6460 Hollis St. Emeryville, CA

Sample I.D.: SW 4

Date Sampled: Dec 28, 1994

Date Submitted: Dec 29, 1994

Date Analyzed: Dec 29-31, 1994

Method of Analysis: EPA 8010

Detection limit: 5.0 ug/Kg

COMPOUND NAME	CONCENTRATION (ug/Kg)	SPIKE RECOVERY (%)
---------------	----------------------------	-----------------------

Chloromethane	N.D.	-----
Vinyl Chloride	N.D.	-----
Bromomethane	N.D.	-----
Chloroethane	N.D.	-----
Trichlorofluoromethane	N.D.	-----
1,1-Dichloroethene	N.D.	-----
Methylene Chloride	N.D.	-----
1,2-Dichloroethene (TOTAL)	N.D.	-----
1,1-Dichloroethane	N.D.	-----
Chloroform	N.D.	-----
1,1,1-Trichloroethane	N.D.	-----
Carbon Tetrachloride	N.D.	-----
1,2-Dichloroethane	N.D.	-----
Trichloroethene	N.D.	-----
1,2-Dichloropropane	N.D.	-----
Bromodichloromethane	N.D.	-----
2-Chloroethylvinylether	N.D.	-----
Trans-1,3-Dichloropropene	N.D.	-----
Cis-1,3-Dichloropropene	N.D.	-----
1,1,2-Trichloroethane	N.D.	-----
Tetrachloroethene	N.D.	-----
Dibromochloromethane	N.D.	-----
Chlorobenzene	N.D.	-----
Bromoform	N.D.	-----
1,1,2,2-Tetrachloroethane	N.D.	-----
1,3-Dichlorobenzene	N.D.	-----
1,4-Dichlorobenzene	N.D.	-----
1,2-Dichlorobenzene	N.D.	-----

David Duong
Laboratory Director



PRIORITY ENVIRONMENTAL LABS

Precision Environmental Analytical Laboratory

December 31, 1994

PEL # 9412087

HAGEMAN - AGUIAR, INC.

Attn: Jeffrey Roth

Project name: Rix Industries

Project location: 6460 Hollis St. Emeryville, CA

Sample I.D.: SW 5

Date Sampled: Dec 28, 1994

Date Submitted: Dec 29, 1994

Date Analyzed: Dec 29-31, 1994

Method of Analysis: EPA 8010

Detection limit: 5.0 ug/Kg

COMPOUND NAME	CONCENTRATION (ug/Kg)	SPIKE RECOVERY (%)
Chloromethane	N.D.	-----
Vinyl Chloride	N.D.	-----
Bromomethane	N.D.	-----
Chloroethane	N.D.	-----
Trichlorofluoromethane	N.D.	-----
1,1-Dichloroethene	N.D.	-----
Methylene Chloride	N.D.	-----
1,2-Dichloroethene (TOTAL)	N.D.	-----
1,1-Dichloroethane	N.D.	-----
Chloroform	N.D.	-----
1,1,1-Trichloroethane	N.D.	-----
Carbon Tetrachloride	N.D.	-----
1,2-Dichloroethane	N.D.	-----
Trichloroethene	N.D.	-----
1,2-Dichloropropane	N.D.	-----
Bromodichloromethane	N.D.	-----
2-Chloroethylvinylether	N.D.	-----
Trans-1,3-Dichloropropene	N.D.	-----
Cis-1,3-Dichloropropene	N.D.	-----
1,1,2-Trichloroethane	N.D.	-----
Tetrachloroethene	N.D.	-----
Dibromochloromethane	N.D.	-----
Chlorobenzene	N.D.	-----
Bromoform	N.D.	-----
1,1,2,2-Tetrachloroethane	N.D.	-----
1,3-Dichlorobenzene	N.D.	-----
1,4-Dichlorobenzene	N.D.	-----
1,2-Dichlorobenzene	N.D.	-----

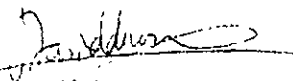
David Duong
Laboratory Director



PRIORITY ENVIRONMENTAL LABS

Precision Environmental Analytical Laboratory

December 31, 1994

PEL # 9412087

HAGEMAN - AGUIAR, INC.

Attn: Jeffrey Roth

Project name: Rix Industries

Project location: 6460 Hollis St. Emeryville, CA

Sample I.D.: SW 6

Date Sampled: Dec 28, 1994

Date Submitted: Dec 29, 1994

Date Analyzed: Dec 29-31, 1994

Method of Analysis: EPA 8010

Detection limit: 5.0 ug/Kg

COMPOUND NAME	CONCENTRATION (ug/Kg)	SPIKE RECOVERY (%)
Chloromethane	N.D.	-----
Vinyl Chloride	N.D.	-----
Bromomethane	N.D.	-----
Chloroethane	N.D.	-----
Trichlorofluoromethane	N.D.	-----
1,1-Dichloroethene	N.D.	-----
Methylene Chloride	N.D.	-----
1,2-Dichloroethene (TOTAL)	N.D.	-----
1,1-Dichloroethane	N.D.	-----
Chloroform	N.D.	-----
1,1,1-Trichloroethane	N.D.	-----
Carbon Tetrachloride	N.D.	-----
1,2-Dichloroethane	N.D.	-----
Trichloroethene	N.D.	-----
1,2-Dichloropropane	N.D.	-----
Bromodichloromethane	N.D.	-----
2-Chloroethylvinylether	N.D.	-----
Trans-1,3-Dichloropropene	N.D.	-----
Cis-1,3-Dichloropropene	N.D.	-----
1,1,2-Trichloroethane	N.D.	-----
Tetrachloroethene	N.D.	-----
Dibromochloromethane	N.D.	-----
Chlorobenzene	N.D.	-----
Bromoform	N.D.	-----
1,1,2,2-Tetrachloroethane	N.D.	-----
1,3-Dichlorobenzene	N.D.	-----
1,4-Dichlorobenzene	N.D.	-----
1,2-Dichlorobenzene	N.D.	-----

David Duong
Laboratory Director



PRIORITY ENVIRONMENTAL LABS

Precision Environmental Analytical Laboratory

December 31, 1994

PEL # 9412087

HAGEMAN - AGUIAR, INC.

Attn: Jeffrey Roth

Project name: Rix Industries

Project location: 6460 Hollis St. Emeryville, CA

Sample I.D.: SW 7

Date Sampled: Dec 28, 1994

Date Submitted: Dec 29, 1994

Date Analyzed: Dec 29-31, 1994

Method of Analysis: EPA 8010

Detection limit: 5.0 ug/Kg

COMPOUND NAME	CONCENTRATION (ug/Kg)	SPIKE RECOVERY (%)
Chloromethane	N.D.	-----
Vinyl Chloride	N.D.	-----
Bromomethane	N.D.	-----
Chloroethane	N.D.	-----
Trichlorofluoromethane	N.D.	-----
1,1-Dichloroethene	N.D.	-----
Methylene Chloride	N.D.	-----
1,2-Dichloroethene (TOTAL)	N.D.	-----
1,1-Dichloroethane	N.D.	-----
Chloroform	N.D.	-----
1,1,1-Trichloroethane	N.D.	-----
Carbon Tetrachloride	N.D.	-----
1,2-Dichloroethane	N.D.	-----
Trichloroethene	N.D.	-----
1,2-Dichloropropane	N.D.	-----
Bromodichloromethane	N.D.	-----
2-Chloroethylvinylether	N.D.	-----
Trans-1,3-Dichloropropene	N.D.	-----
Cis-1,3-Dichloropropene	N.D.	-----
1,1,2-Trichloroethane	N.D.	-----
Tetrachloroethene	N.D.	-----
Dibromochloromethane	N.D.	-----
Chlorobenzene	N.D.	-----
Bromoform	N.D.	-----
1,1,2,2-Tetrachloroethane	N.D.	-----
1,3-Dichlorobenzene	N.D.	-----
1,4-Dichlorobenzene	N.D.	-----
1,2-Dichlorobenzene	N.D.	-----

David Duong
Laboratory Director



PRIORITY ENVIRONMENTAL LABS

Precision Environmental Analytical Laboratory

December 31, 1994

PEL # 9412087

HAGEMAN - AGUIAR, INC.

Attn: Jeffrey Roth

Project name: Rix Industries Project location: 6460 Hollis St. Emeryville, CA

Sample I.D.: SW 8

Date Sampled: Dec 28, 1994
Date Analyzed: Dec 29-31, 1994

Date Submitted: Dec 29, 1994

Method of Analysis: EPA 8010

Detection limit: 5.0 ug/Kg

COMPOUND NAME	CONCENTRATION (ug/Kg)	SPIKE RECOVERY (%)
Chloromethane	N.D.	-----
Vinyl Chloride	N.D.	-----
Bromomethane	N.D.	-----
Chloroethane	N.D.	-----
Trichlorofluoromethane	N.D.	-----
1,1-Dichloroethene	N.D.	-----
Methylene Chloride	N.D.	-----
1,2-Dichloroethene (TOTAL)	N.D.	-----
1,1-Dichloroethane	N.D.	-----
Chloroform	N.D.	-----
1,1,1-Trichloroethane	N.D.	-----
Carbon Tetrachloride	N.D.	-----
1,2-Dichloroethane	N.D.	-----
Trichloroethene	N.D.	-----
1,2-Dichloropropane	N.D.	-----
Bromodichloromethane	N.D.	-----
2-Chloroethylvinylether	N.D.	-----
Trans-1,3-Dichloropropene	N.D.	-----
Cis-1,3-Dichloropropene	N.D.	-----
1,1,2-Trichloroethane	N.D.	-----
Tetrachloroethene	N.D.	-----
Dibromochloromethane	N.D.	-----
Chlorobenzene	N.D.	-----
Bromoform	N.D.	-----
1,1,2,2-Tetrachloroethane	N.D.	-----
1,3-Dichlorobenzene	N.D.	-----
1,4-Dichlorobenzene	N.D.	-----
1,2-Dichlorobenzene	N.D.	-----

David Duong
Laboratory Director



PRIORITY ENVIRONMENTAL LABS

Precision Environmental Analytical Laboratory

December 31, 1994

PEL # 9412087

HAGEMAN - AGUIAR, INC.

Attn: Jeffrey Roth

Project name: Rix Industries

Project location: 6460 Hollis St. Emeryville, CA

Sample I.D.: SW 9

Date Sampled: Dec 28, 1994

Date Submitted: Dec 29, 1994

Date Analyzed: Dec 29-31, 1994

Method of Analysis: EPA 8010

Detection limit: 5.0 ug/Kg

COMPOUND NAME	CONCENTRATION (ug/Kg)	SPIKE RECOVERY (%)
---------------	----------------------------	-------------------------

Chloromethane	N.D.	-----
Vinyl Chloride	N.D.	-----
Bromomethane	N.D.	-----
Chloroethane	N.D.	-----
Trichlorofluoromethane	N.D.	-----
1,1-Dichloroethene	N.D.	-----
Methylene Chloride	N.D.	-----
1,2-Dichloroethene (TOTAL)	N.D.	-----
1,1-Dichloroethane	N.D.	-----
Chloroform	N.D.	-----
1,1,1-Trichloroethane	N.D.	-----
Carbon Tetrachloride	N.D.	-----
1,2-Dichloroethane	N.D.	-----
Trichloroethene	21	-----
1,2-Dichloropropane	N.D.	-----
Bromodichloromethane	N.D.	-----
2-Chloroethylvinylether	N.D.	-----
Trans-1,3-Dichloropropene	N.D.	-----
Cis-1,3-Dichloropropene	N.D.	-----
1,1,2-Trichloroethane	N.D.	-----
Tetrachloroethene	17	-----
Dibromochloromethane	N.D.	-----
Chlorobenzene	N.D.	-----
Bromoform	N.D.	-----
1,1,2,2-Tetrachloroethane	N.D.	-----
1,3-Dichlorobenzene	N.D.	-----
1,4-Dichlorobenzene	N.D.	-----
1,2-Dichlorobenzene	N.D.	-----

David Duong
Laboratory Director



PRIORITY ENVIRONMENTAL LABS

Precision Environmental Analytical Laboratory

December 31, 1994

PEL # 9412087

HAGEMAN - AGUIAR, INC.

Attn: Jeffrey Roth

Project name: Rix Industries

Project location: 6460 Hollis St. Emeryville, CA

Sample I.D.: SW 10

Date Sampled: Dec 28, 1994

Date Submitted: Dec 29, 1994

Date Analyzed: Dec 29-31, 1994

Method of Analysis: EPA 8010

Detection limit: 5.0 ug/Kg

COMPOUND NAME	CONCENTRATION (ug/Kg)	SPIKE RECOVERY (%)
---------------	----------------------------	-------------------------



Chloromethane	N.D.	-----
Vinyl Chloride	N.D.	-----
Bromomethane	N.D.	-----
Chloroethane	N.D.	-----
Trichlorofluoromethane	N.D.	-----
1,1-Dichloroethene	N.D.	-----
Methylene Chloride	N.D.	-----
1,2-Dichloroethene (TOTAL)	N.D.	-----
1,1-Dichloroethane	N.D.	-----
Chloroform	N.D.	-----
1,1,1-Trichloroethane	N.D.	-----
Carbon Tetrachloride	N.D.	-----
1,2-Dichloroethane	N.D.	-----
Trichloroethene	10	-----
1,2-Dichloropropane	N.D.	-----
Bromodichloromethane	N.D.	-----
2-Chloroethylvinylether	N.D.	-----
Trans-1,3-Dichloropropene	N.D.	-----
Cis-1,3-Dichloropropene	N.D.	-----
1,1,2-Trichloroethane	N.D.	-----
Tetrachloroethene	11	-----
Dibromochloromethane	N.D.	-----
Chlorobenzene	N.D.	-----
Bromoform	N.D.	-----
1,1,2,2-Tetrachloroethane	N.D.	-----
1,3-Dichlorobenzene	N.D.	-----
1,4-Dichlorobenzene	N.D.	-----
1,2-Dichlorobenzene	N.D.	-----

David Duong
Laboratory Director

PEL # 9412087

INV # 25561

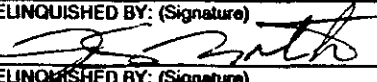
CHAIN OF CUSTODY FORM

PROJECT NAME AND ADDRESS: <u>Rix Industries</u> <u>6460 Hollis St.</u> <u>EMERYVILLE, CA</u>					SAMPLER: (Signature) 		ANALYSIS REQUESTED <i>TPH GAs / BTX TPH DIESEL, KEROSENE MEK, MIBK, MINERAL SPIRITS ACETONE, ISO PROPANOL SEC - BUTANOL EPA 9010</i>					
					HAGEMAN - AGUIAR, INC. 3732 Mt. Diablo Blvd., Suite 372 Lafayette, CA 94549 (415)284-1661 (415)284-1664 (FAX)							
CROSS REFERENCE NUMBER	DATE	TIME	SOIL	WATER	STATION LOCATION							REMARKS
SW 1	12-28-94	1030	X		NORTH, SIDEWALL - 4' DEPTH	X	X	X	X	X	X	NORM TAT
SW 2	12-28-94	1130	X		NORTH, SIDEWALL - 4'	X	X	X	X	X	X	
SW 3	12-28-94	1135	X		EAST, SIDEWALL - 4'	X	X	X	X	X	X	
SW 4	12-28-94	1140	X		EAST, SIDEWALL - 4'	X	X	X	X	X	X	
SW 5	12-28-94	1145	X		EAST, SIDEWALL - 4'	X	X	X	X	X	X	
SW 6	12-28-94	1150	X		SOUTH, SIDEWALL - 4'	X	X	X	X	X	X	
SW 7	12-28-94	1155	X		SOUTH, SIDEWALL - 4'	X	X	X	X	X	X	
SW 8	12-28-94	1200	X		WEST, SIDEWALL - 4'	X	X	X	X	X	X	
SW 9	12-28-94	1205	X		WEST, SIDEWALL - 4'	X	X	X	X	X	X	
SW 10	12-28-94	1030	X		WEST, SIDEWALL - 4'	X	X	X	X	X	X	
RELINQUISHED BY: (Signature) 					DATE 12-29-94	RECEIVED BY: (Signature)					DATE	
					TIME 0800						TIME	
RELINQUISHED BY: (Signature)					DATE	RECEIVED BY: (Signature)					DATE	
					TIME						TIME	
RELINQUISHED BY: (Signature)					DATE	RECEIVED BY: (Signature)					DATE	
					TIME						TIME	
RELINQUISHED BY: (Signature)					DATE	RECEIVED FOR LABORATORY BY: (Signature) 					DATE 12/29/94	
					TIME						TIME 5:10 AM	



PRIORITY ENVIRONMENTAL LABS

Precision Environmental Analytical Laboratory

December 28, 1994

PEL # 9412085

HAGEMAN - AGUIAR, INC.

Attn: Gary Aguiar

Re: Two composited soil samples for Gasoline/BTEX and TEPH analyses.

Project name: RIX Industries
Project location: 6460 Hollis St., - Emeryville, CA.

Date sampled: Dec 27, 1994
Date extracted: Dec 28, 1994

Date submitted: Dec 28, 1994
Date analyzed: Dec 28, 1994

RESULTS:

SAMPLE I.D.	Kerosene (mg/Kg)	Gasoline (mg/Kg)	Diesel (ug/Kg)	Benzene (ug/Kg)	Toluene (ug/Kg)	Ethyl Benzene (ug/Kg)	Total Xylene (ug/Kg)	Mineral Spirits (mg/Kg)
SP1-SP4	N.D.	N.D.	24	N.D.	N.D.	N.D.	N.D.	12
SP5-SP8	N.D.	N.D.	17	N.D.	N.D.	N.D.	N.D.	6.3
Blank	N.D.	N.D.	N.D.	N.D.	N.D.	N.D.	N.D.	N.D.
Spiked Recovery	---	86.6%	101.2%	88.3%	90.2%	91.0%	100.5%	---
Detection limit	1.0	1.0	1.0	5.0	5.0	5.0	5.0	1.0
Method of Analysis	3550 / 8015	5030 / 8015	3550 / 8015	8020	8020	8020	8020	3550 / 8015

David Duong
Laboratory Director



PRIORITY ENVIRONMENTAL LABS

Precision Environmental Analytical Laboratory

December 29, 1994

PEL # 9412085

HAGEMAN - AGUIAR, INC.

Attn: Jeffrey Roth

Re: Two composited soil samples for Acetone, Isopropanol, MEK, MIBK, and Sec-Butanol analyses.

Project name: Rix Industries
Project location: 6460 Hollis St., - Emeryville, CA.

Date sampled: Dec 27, 1994
Date extracted: Dec 28-29, 1994

Date submitted: Dec 28, 1994
Date analyzed: Dec 28-29, 1994

RESULTS:

SAMPLE I.D.	Acetone (mg/Kg)	Isopropanol (mg/Kg)	MEK (mg/Kg)	MIBK (mg/Kg)	Sec-Butanol (mg/Kg)
SP1-SP4	5.1	33	N.D.	N.D.	N.D.
SP5-SP8	0.6	N.D.	N.D.	N.D.	N.D.
Blank	N.D.	N.D.	N.D.	N.D.	N.D.
Detection limit	0.5	0.5	0.5	0.5	0.5
Method of Analysis	8015	8015	8015	8015	8015

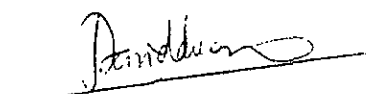
David Duong
Laboratory Director



PRIORITY ENVIRONMENTAL LABS

Precision Environmental Analytical Laboratory

December 28, 1994

PEL # 9412085

HAGEMAN - AGUIAR, INC.

Attn: Gary Aguiar

Project name: Rix Industries Project location: 6460 Hollis St. Emeryville, CA

Sample I.D.: SP1-SP4

Date Sampled: Dec 27, 1994
Date Analyzed: Dec 28, 1994

Date Submitted: Dec 28, 1994

Method of Analysis: EPA 8010

Detection limit: 5.0 ug/Kg

COMPOUND NAME	CONCENTRATION (ug/Kg)	SPIKE RECOVERY (%)
---------------	----------------------------	-------------------------

Chloromethane	N.D.	-----
Vinyl Chloride	N.D.	-----
Bromomethane	N.D.	-----
Chloroethane	N.D.	-----
Trichlorofluoromethane	N.D.	-----
1,1-Dichloroethene	N.D.	-----
Methylene Chloride	N.D.	-----
1,2-Dichloroethene (TOTAL)	N.D.	-----
1,1-Dichloroethane	N.D.	-----
Chloroform	6.0	-----
1,1,1-Trichloroethane	N.D.	-----
Carbon Tetrachloride	N.D.	-----
1,2-Dichloroethane	N.D.	-----
Trichloroethene	5.0	-----
1,2-Dichloropropane	N.D.	-----
Bromodichloromethane	N.D.	-----
2-Chloroethylvinylether	N.D.	-----
Trans-1,3-Dichloropropene	N.D.	-----
Cis-1,3-Dichloropropene	N.D.	-----
1,1,2-Trichloroethane	N.D.	-----
Tetrachloroethene	39	-----
Dibromochloromethane	N.D.	-----
Chlorobenzene	N.D.	-----
Bromoform	N.D.	-----
1,1,2,2-Tetrachloroethane	N.D.	-----
1,3-Dichlorobenzene	N.D.	-----
1,4-Dichlorobenzene	N.D.	-----
1,2-Dichlorobenzene	N.D.	-----

David Duong
Laboratory Director



PRIORITY ENVIRONMENTAL LABS

Precision Environmental Analytical Laboratory

December 28, 1994

PEL # 9412085

HAGEMAN - AGUIAR, INC.

Attn: Gary Aguiar

Project name: Rix Industries Project location: 6460 Hollis St. Emeryville, CA

Sample I.D.: SP5-SP8

Date Sampled: Dec 27, 1994
Date Analyzed: Dec 28, 1994

Date Submitted: Dec 28, 1994

Method of Analysis: EPA 8010

Detection limit: 5.0 ug/Kg

COMPOUND NAME	CONCENTRATION (ug/Kg)	SPIKE RECOVERY (%)
Chloromethane	N.D.	-----
Vinyl Chloride	N.D.	-----
Bromomethane	N.D.	-----
Chloroethane	N.D.	-----
Trichlorofluoromethane	N.D.	-----
1,1-Dichloroethene	N.D.	-----
Methylene Chloride	N.D.	-----
1,2-Dichloroethene (TOTAL)	N.D.	-----
1,1-Dichloroethane	N.D.	-----
Chloroform	N.D.	-----
1,1,1-Trichloroethane	N.D.	-----
Carbon Tetrachloride	N.D.	-----
1,2-Dichloroethane	N.D.	-----
Trichloroethene	N.D.	-----
1,2-Dichloropropane	N.D.	-----
Bromodichloromethane	N.D.	-----
2-Chloroethylvinylether	N.D.	-----
Trans-1,3-Dichloropropene	N.D.	-----
Cis-1,3-Dichloropropene	N.D.	-----
1,1,2-Trichloroethane	N.D.	-----
Tetrachloroethene	21	-----
Dibromochloromethane	N.D.	-----
Chlorobenzene	N.D.	-----
Bromoform	N.D.	-----
1,1,2,2-Tetrachloroethane	N.D.	-----
1,3-Dichlorobenzene	N.D.	-----
1,4-Dichlorobenzene	N.D.	-----
1,2-Dichlorobenzene	N.D.	-----

David Duong
Laboratory Director



PRIORITY ENVIRONMENTAL LABS

Precision Environmental Analytical Laboratory

December 28, 1994

PEL # 9412085

HAGEMAN-AGUIAR, INC.

Attn: Jeffrey Roth
Re: Two composited soil samples for RCI analysis.

Project name: Rix Industries
Project location: 6460 Hollis Street - Emeryville, CA

Date sampled: Dec 27, 1994
Date extracted: Dec 28, 1994

Date submitted: Dec 28, 1994
Date analyzed: Dec 28, 1994

RESULTS:

SAMPLE I.D.	REACTIVITY	CORROSIVITY	IGNITABILITY
SP1-SP4	NO	pH 7.4	NO
SP5-SP8	NO	pH 7.3	NO
Blank	NO	pH 7.0	NO
Method of Analysis	Title 22, CCR 66261.23	Title 22, CCR 66261.22	Title 22, CCR 66261.21

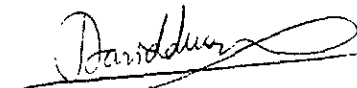
David Duong
Laboratory Director



PRIORITY ENVIRONMENTAL LABS

Precision Environmental Analytical Laboratory

December 30, 1994

PEL # 9412085

HAGEMAN - AGUIAR, INC.

Attn: Jeffrey Roth

Re: Two composited soil samples for STLC Lead analysis.

Project name: Rix Industries
Project location: 6460 Hollis St., - Emeryville, CA.

Date sampled: Dec 27, 1994
Date extracted: Dec 28-30, 1994

Date submitted: Dec 28, 1994
Date analyzed: Dec 28-30, 1994

RESULTS:

SAMPLE I.D.	STLC Lead (mg/L)
SP1-SP4	N.D.
SP5-SP8	N.D.
Blank	N.D.
Detection limit	0.1
Method of Analysis	1310 / 7420

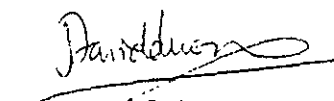
David Duong
Laboratory Director

PEL # 9412085

CHAIN OF CUST INV # 25559

PROJECT NAME AND ADDRESS: <i>RIX INDUSTRIES</i> <i>6460 HOLIS ST.</i> <i>EMERYVILLE, CA</i>			SAMPLER: (Signature) <i>[Signature]</i>		ANALYSIS REQUESTED	
HAGEMAN - AGUIAR, INC. 3732 Mt. Diablo Blvd., Suite 372 Lafayette, CA 94549 (415)284-1661 (415)284-1664 (FAX)						
CROSS REFERENCE NUMBER	DATE	TIME	SOIL	WATER	STATION LOCATION	REMARKS
<i>SP1-SP4</i>	<i>12-27-94</i>	<i>1130</i>	<i>X</i>		<i>4pt. COMPOSITE - SPOILS</i>	<i>As soon</i>
<i>SP5-SP8</i>	<i>12-27-94</i>	<i>1140</i>	<i>X</i>		<i>4pt. COMPOSITE - SPOILS.</i>	<i>As you can</i>
						<i>110 RUSH 11</i>
RELINQUISHED BY: (Signature) <i>[Signature]</i>			DATE <i>12-28-94</i>	TIME <i>0000</i>	RECEIVED BY: (Signature)	DATE
RELINQUISHED BY: (Signature)			DATE	TIME	RECEIVED BY: (Signature)	DATE
RELINQUISHED BY: (Signature)			DATE	TIME	RECEIVED BY: (Signature)	DATE
RELINQUISHED BY: (Signature)			DATE	TIME	RECEIVED FOR LABORATORY BY: (Signature) <i>[Signature]</i>	DATE <i>12/28/94</i> TIME <i>10:00 AM</i>

TPH GAS / BTX
 TPH DIESEL / MINERAL SPIRITS
 MEK / MIBK / ACETONE
 STC BUTANOL
 BOILO EPA
 KEROSENE
 ISOPROPANE

SYBASE FACILITY

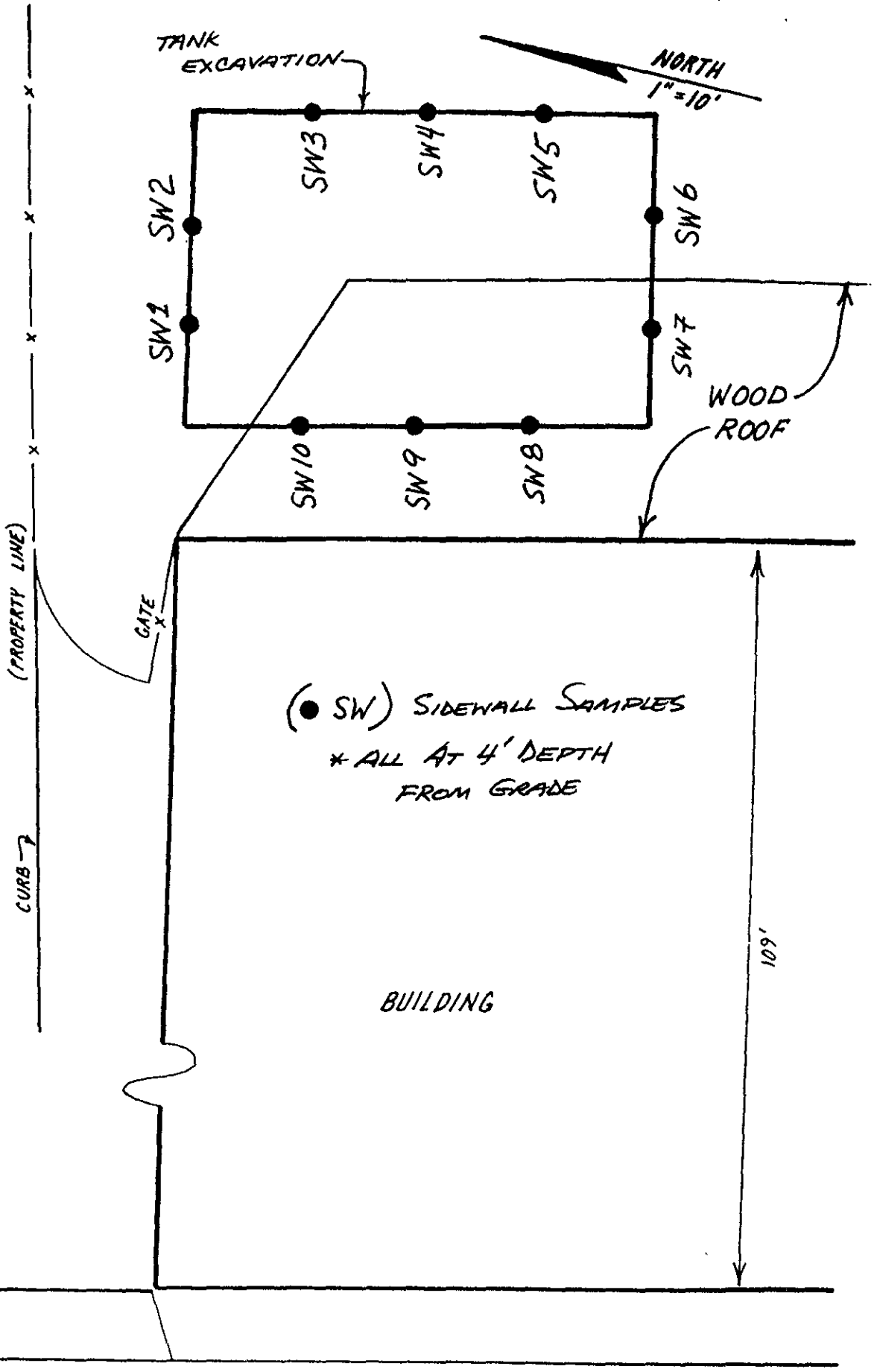

(● SW) SIDEWALL SAMPLES
* ALL AT 4' DEPTH
FROM GRADE

BUILDING

HOLLIS STREET

SITE PLANS

SYBASE FACILITY

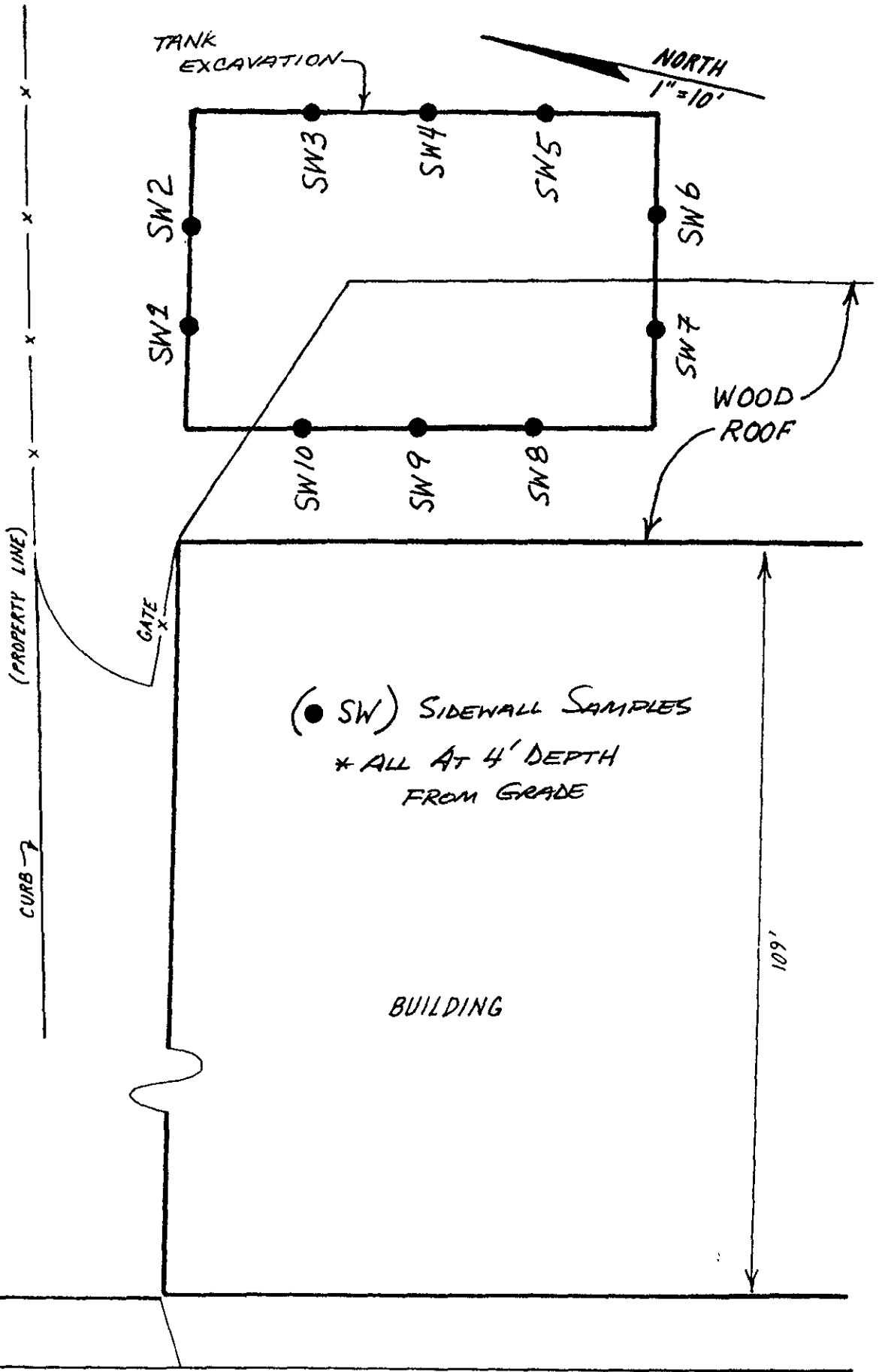

TANK EXCAVATION

NORTH
1"=10'

SW2
SW2

SW3

SW4

SW5

SW6

SW7

SW10

SW9

SW8

WOOD ROOF

GATE

(PROPERTY LINE)

CURB

(● SW) SIDEWALL SAMPLES
* ALL AT 4' DEPTH FROM GRADE

BUILDING

109'

HOLLIS STREET

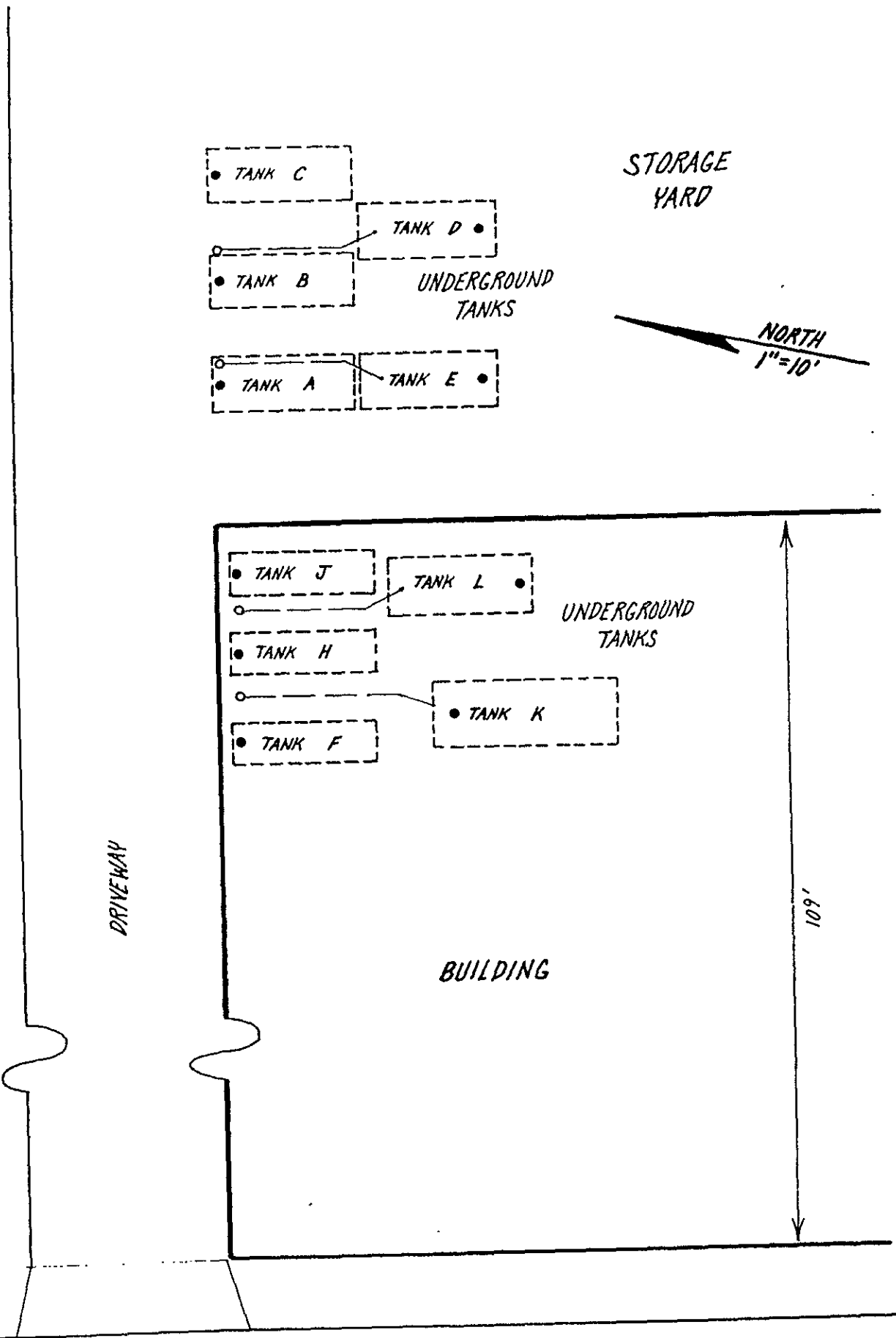

HOLLIS STREET

FIGURE 3.
Site Map.

II. SITE DESCRIPTION

Site Description and Tank Contents

A map of the site is shown in Figure 3. This map shows the layout of the facility, along with the apparent locations of ten underground storage tanks. As shown in Figure 3, five of the tanks are located within the existing facility building. Based upon a field reconnaissance conducted by Hageman-Aguiar, Inc., personnel on January 30, 1992, the previous tanks were found to be labeled as containing the following:

- TANK A - Chlorinated Solvents
- TANK B - Tank Empty (no label)
- TANK C - Tank Empty (no label)
- TANK D - Tank Empty (no label)
- TANK E - Mostly Water (no label)
- TANK F - sec-Butyl Alcohol
- TANK H - Isopropyl Alcohol
- TANK J - Methyl Ethyl Ketone (MEK)
- TANK K - Ethyl Silicate
- TANK L - sec-Butyl Alcohol

Hydrogeologic Setting

The soils beneath the site consist of Quaternary Alluvium overlying Franciscan bedrock (Geologic Map of California, San Francisco Sheet, State of California Division of Mines and Geology, 1980). Bedrock is likely to occur at a depth of greater than 50 feet beneath the site. On this portion of the low-lying Bay Plain in close proximity to San Francisco

NORTH
1"=10'

STORAGE
YARD

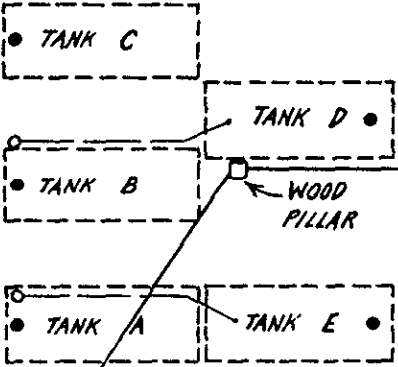

MW-3

WOOD
ROOF

GATE

UNDERGROUND
TANKS

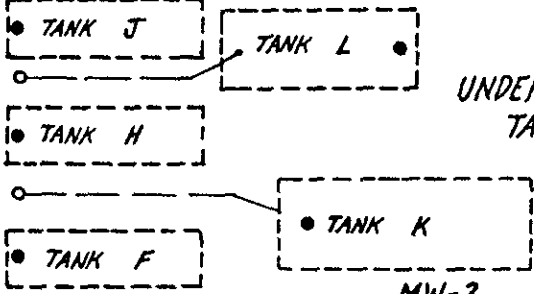

MW-1

MW-2

BUILDING

109'

(PROPERTY LINE)

CURB

SYBASE FACILITY

HOLLIS STREET

INSPECTION REPORTS

white -env.health
 yellow -facility
 pink -files

ALAMEDA COUNTY, DEPARTMENT OF ENVIRONMENTAL HEALTH
 Hazardous Materials Inspection Form

80 Swan Way, #200
 Oakland, CA 94621
 (415) 271-4320

COPY, III

Site ID # 376 Site Name RIX INDUSTRIES INC. Today's Date 8/4/94

Site Address 6460 HOLLIS STREET

City EMERYVILLE Zip 94608 Phone _____

MAX AMT stored > 500 lbs, 55 gal., 200 cft.?

Inspection Categories:

- I. Haz. Mat/Waste GENERATOR/TRANSPORTER
- II. Business Plans, Acute Hazardous Materials
- III. Underground Tanks

* Calif. Administration Code (CAC) or the Health & Safety Code (HS&C)

Comments:

5 UGTs closed in place, located inside the building & 5 UGTs to be removed in the backyard. This department will allow your request of removing the 5 tanks during the scheduled shut down of plant operations in December 24, 1994 thru January 1, 1995 with the following conditions -

- 1) All tanks should be emptied of its contents & tripled rinse.
- 2) The integrity of the tanks must be determined.
- 3) After emptying & rinsing the tanks, any liquid (water) accumulation inside the tanks must be monitored.
- 4) The groundwater monitoring program must start immediately.
- 5) Contaminant plume delineation must be completed.
- 6) A letter of commitment from the property owner / tanks' owner that

II.A BUSINESS PLANS (Title 19)

- 1. Immediate Reporting 2703
- 2. Bus. Plan Stds. 25503(b)
- 3. RR Cars > 30 days 25503.7
- 4. Inventory Information 25504(a)
- 5. Inventory Complete 2730
- 6. Emergency Response 25504(b)
- 7. Training 25504(c)
- 8. Deficiency 25505(a)
- 9. Modification 25505(b)

II.B ACUTELY HAZ. MATLS

- 10. Registration Form Filed 25533(a)
- 11. Form Complete 25533(b)
- 12. RMPP Contents 25534(c)
- 13. Implement Sch. Req'd? (Y/N) _____
- 14. OffSite Conseq. Assess 25524(c)
- 15. Probable Risk Assessment 25534(d)
- 16. Persons Responsible 25534(g)
- 17. Certification 25534(f)
- 18. Exemption Request? (Y/N) 25536(b)
- 19. Trade Secret Requested? 25536

III. UNDERGROUND TANKS (Title 23)

- General**
- 1. Permit Application 25284 (H&S)
- 2. Pipeline Leak Detection 25292 (H&S)
- 3. Records Maintenance 2712
- 4. Release Report 2651
- 5. Closure Plans 2670
- 6. Method
 - 1) Monthly Test
 - 2) Daily Vadose
Semi-annual gndwater
One time soils
 - 3) Daily Vadose
One time soils
Annual tank test
 - 4) Monthly Gndwater
One time soils
 - 5) Daily Inventory
Annual tank testing
Cont pipe leak det
Vadose/gndwater mon.
 - 6) Daily Inventory
Annual tank testing
Cont pipe leak det
 - 7) Weekly Tank Gauge
Annual tank testing
 - 8) Annual Tank Testing
Daily Inventory
 - 9) Other _____
- 7. Precs Tank Test 2643
Date: _____
- 8. Inventory Rec. 2644
- 9. Soil Testing 2646
- 10. Ground Water 2647
- Monitoring for Existing Tanks**
- 11. Monitor Plan 2632
- 12. Access, Secure 2634
- 13. Plans Submit 2711
Date: _____
- 14. As Built 2635
Date: _____
- New Tanks**

Rev 6/88

Contact: K. Franklinski the 5 tanks will be removed no later than January 1, 1995 no II, III
 Title: owner Inspector: SUSAN L. HUGO
 Signature: K. Franklinski Signature: Susan L. Hugo

white -env.health
 yellow -facility
 pink -files

ALAMEDA COUNTY, DEPARTMENT OF ENVIRONMENTAL HEALTH
 Hazardous Materials Inspection Form

80 Swan Way, #200
 Oakland, CA 94621
 (415) 271-4320

II, III

Site ID # 376 Site Name Rix Industries Today's Date 12/27/94

Site Address 6460 Hollis Street

City Emeryville Zip 94608 Phone _____

MAX AMT stored > 500 lbs, 55 gal., 200 cft.?

Inspection Categories:

- I. Haz. Mat/Waste GENERATOR/TRANSPORTER
- II. Business Plans, Acute Hazardous Materials
- III. Underground Tanks

8:30AM - 10:30AM
 12:45PM -

HP 1/95 #42839
 HE, H - tanks hauler

Calif. Administration Code (CAC) or the Health & Safety Code (HS&C)

Comments:

Tanks manifest - # 93618 R29 (including piping)
 5- UGIs Removal (UGIs outside the bldg.)

4- 1000 gal UGIs
 1- 2000 gal UGI

Emeryville Fire (including Anthony present at the site)
 Tank #E - (1000gal) steel tank; Corroded, holes present at the ends & sides & top of the tank; LEL = 1%; O2 = 1.9%

Tank A = (1000gal) steel tank; rusty & corroded. Holes present at top. LEL = 8% O2 = 1.2%

Tank #B (1000gal) steel tank; rusty & corroded LEL = 2% O2 = 1% holes present on the side & ends

Tank C (1000gal) steel tank; rusty & corroded. LEL = 1.0% O2 = 0.2% rusty & corroded

Tank D (2000gal) steel tank; rusty & corroded LEL = 3% O2 = 0.2%

II.A BUSINESS PLANS (Title 19)

- ___ 1. Immediate Reporting 2703
- ___ 2. Bus. Plan Std. 25503(b)
- ___ 3. RR Cars > 30 days 25503.7
- ___ 4. Inventory Information 25504(a)
- ___ 5. Inventory Complete 2730
- ___ 6. Emergency Response 25504(b)
- ___ 7. Training 25504(c)
- ___ 8. Deficiency 25505(a)
- ___ 9. Modification 25505(b)

II.B ACUTELY HAZ. MATLS

- ___ 10. Registration Form Filed 25533(a)
- ___ 11. Form Complete 25533(b)
- ___ 12. RMPP Contents 25533(c)
- ___ 13. Implement Sch. Req'd? (Y/N) _____
- ___ 14. OffSite Conseq. Assess. 25524(c)
- ___ 15. Probable Risk Assessment 25534(d)
- ___ 16. Persons Responsible 25534(g)
- ___ 17. Certification 25534(b)
- ___ 18. Exemption Request? (Y/N) 25536(b)
- ___ 19. Trade Secret Requested? 25538

III. UNDERGROUND TANKS (Title 23)

- General
- ___ 1. Permit Application 25284 (H&S)
 - ___ 2. Pipeline Leak Detection 25292 (H&S)
 - ___ 3. Records Maintenance 2712
 - ___ 4. Release Report 2651
 - ___ 5. Closure Plans 2670

- Monitoring for Existing Tanks
- ___ 6. Method
 - 1) Monthly Test
 - 2) Daily Vadose Semi-annual groundwater One time sols
 - 3) Daily Vadose One time sols Annual tank test
 - 4) Monthly Gndwater One time sols
 - 5) Daily Inventory Annual tank testing Cont pipe leak det Vadose/gndwater mon.
 - 6) Daily Inventory Annual tank testing Cont pipe leak det
 - 7) Weekly Tank Gauge Annual tank testing
 - 8) Annual Tank Testing Daily Inventory
 - 9) Other _____

- ___ 7. Precis Tank Test 2643 Date: _____
- ___ 8. Inventory Rec. 2644
- ___ 9. Soil Testing 2646
- ___ 10. Ground Water. 2647

- New Tanks
- ___ 11. Monitor Plan 2632
 - ___ 12. Access. Secure 2634
 - ___ 13. Plans Submit 2711 Date: _____
 - ___ 14. As Built 2635 Date: _____

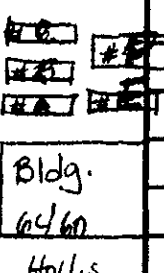

* Stockpiled soil must be covered w/visqueen properly characterized for disposal

Title: _____

Signature: _____

Inspector: _____

Signature: Susan L. Hugo

* Piping associated w/the tanks which can't be removed must be permanently capped.

12215117976-8



A&E.

12/27/94 12215117976-8
Tank e- 6460 Hollis St.
Emeryville, CA 94608



12/27/94

12215117976-8

Jack B.

6460 Hollis St
Emeryville

9 2008



12/27/94

12215117976-8

Tank D - 2000 gal.

Rix Industries 6460 Hollis St.
Emeryville



12/27/94 12215117976-8 Piping type
Capped.
Rix Industries
6460 Hollis St Emeryville 94608



0 - piping

12/27/94 12215117976-8
Tank C - 6460 Hollis,
Emeryville 94608



C

12/27/90 12215117976-8
Lark E- 6460 Hollis St.
Emeryville 94608.



8

12/27/90 12215117976-8
Trunks B, C & D
6460 Hollis St Emeryville



12/27/94 12215117976-B St.
Tank B - 6460 Hollis 94608
Emeryville



O - Hollis B