



KAPREALIAN ENGINEERING, INC.

Consulting Engineers

P O BOX 913

BENICIA, CA 94510

(707) 746-6015 (707) 746-9918

FAX: (707) 746-3581

TRANSMITTAL PAGE

DATE: 9-15-89

Alameda County Health Agency

TO: Larry Silo

FROM: David Prochaska

Number of Pages
(including cover): 2

ATTENTION: General - Doublet (35th Ave & Rowland)
attached in note. Please indicate any principle of
location. This is approximately same as train
which previously had. etc. after no action

If any problems occur in receiving, please
call the number listed above.

9-13-89

NORTH

CRUISEWAY

15' WALK

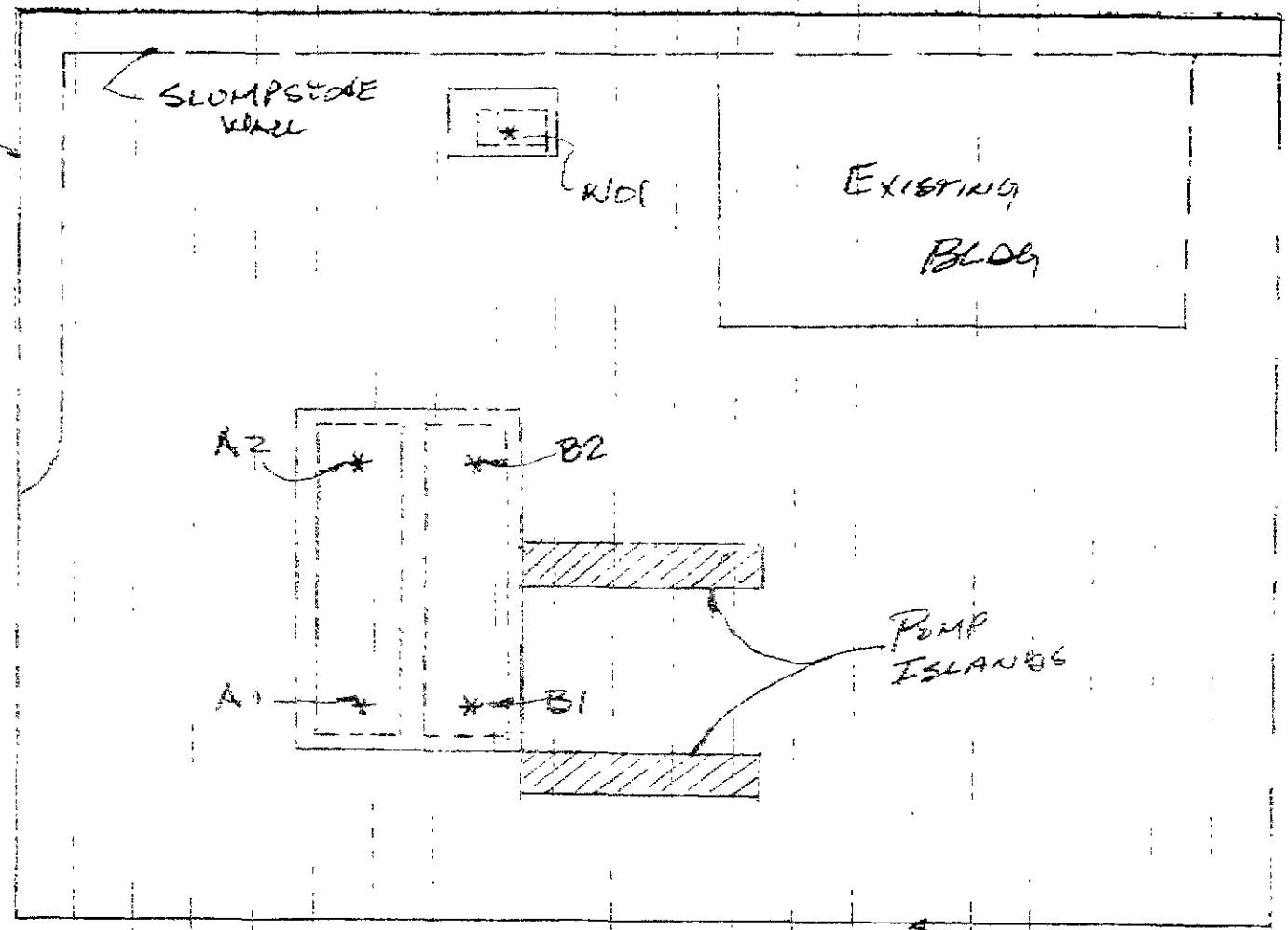

* SAMPLE POINT LOCATION

35TH AVE

UNOCAL - OAKLAND
35TH AVE
OAKLAND

KAPREALIAN ENGINEERING, INC.

Consulting Engineers

P O BOX 913

BENICIA, CA 94510

(707) 746-6815 (707) 746-6916

FAX: (707) 746-5581

TRANSMITTAL PAGE

 DATE: 9-13-89

Alameda County Health Agency

 TO: Larry Seto

 FROM: Dick Bradner

 Number of Pages
 (including cover): 9

 SUBJECT: Unocal - Oakland (35th Ave & Quigley)

Please find attached Site plan showing sample point locations, lab results, and Chain of Custody documentation for 5 tank bottom sample collected Monday 9/11/89 @ above referenced location.

Contractor has been directed to excavate tank pits to sample depth (ie 14 ft for the 10 tank pit & 9.5 ft for the 10 tank pit)

If any problems occur in receiving, please call the number listed above.

10 tank pit & 9.5 ft for the 10 tank pit)

On this basis, may we have your approval of tank pit preparation. Please call me when you've had an opportunity to review the attached.



SEQUOIA ANALYTICAL

680 Chesapeake Drive • Redwood City, CA 94063
 (415) 364-9600 • FAX (415) 364-9233

Kaprealian Engineering, Inc.

P.O. Box 913

Benicia, CA 94810

Attention: Mardo Kaprealian, P.E.

Client Project ID: Unocal, Oakland, 35th Ave/Quigley

Matrix Descript: Soil

Analysis Method: EPA 8030/8015/8020

First Sample #: 909-1121

Sampled: Sep 11, 1989

Received: Sep 12, 1989

Analyzed: Sep 12, 1989

Reported: Sep 13, 1989

TOTAL PETROLEUM FUEL HYDROCARBONS with BTEX DISTINCTION (EPA 8015/8020)

Sample Number	Sample Description	Low/Medium B.P. Hydrocarbons mg/kg (ppm)	Benzene mg/kg (ppm)	Toluene mg/kg (ppm)	Ethyl Benzene mg/kg (ppm)	Xylenes mg/kg (ppm)
909-1121	A1	10	N.D.	N.D.	N.D.	0.11
909-1122	A2	5.0	N.D.	N.D.	N.D.	N.D.
909-1123	B1	3.0	N.D.	N.D.	N.D.	N.D.
909-1124	B2	1.0	N.D.	N.D.	N.D.	N.D.

Detection Limits:

1.0

0.05

0.1

0.1

0.1

Low to Medium Boiling Point Hydrocarbons are quantitated against a gasoline standard.

Analytes reported as N.D. were not present above the stated limit of detection.

SEQUOIA ANALYTICAL

Arthur G. Burton
 Laboratory Director

9091121.KEI <1>

SEP 13 '89 16:53

707 746 5581

PAGE.002



KAPREALIAN ENGINEERING, INC.

Consulting Engineers

P.O. BOX 813

BENICIA, CA 94510

(415) 676-8100 (707) 746-6915

CHAIN OF CUSTODY

R.M. Bradish
SAMPLER: _____
(Signature)

DATE/TIME OF COLLECTION: 9-11-89

TURN AROUND TIME: 24 Hr

SAMPLE DESCRIPTION AND PROJECT NUMBER:

Unocal - Oakland
35th Ave. & Grand

SAMPLE #	ANALYSES	GRAB OR COMP.	NUMBER OF CONTAINERS	SOIL/WATER	
91121	A1	TPH-G & BTX&E	G	1	S
91122	A2	" "	G	1	S
091123	B1	" "	G	1	S
7091124	B2	" "	G	1	S

RELINQUISHED BY*	TIME/DATE	RECEIVED BY*	TIME/DATE
1. <i>R.M. Bradish</i>	8:12 9/11/89	<i>Tam Baker</i>	8:12 9-12-89
2. <i>Tam Baker</i>	9-12 9:05	<i>B.C. Oliver</i>	9-12-89 10:00 a.m.
3. _____	_____	_____	_____

* STATE AFFILIATION NEXT TO SIGNATURE

REMARKS: _____

NOTE: IF REGULAR TURNAROUND, SOIL ANALYSES MUST BE COMPLETED WITHIN 14 CALENDAR DAYS OF SAMPLE COLLECTION. WATER ANALYSES MUST BE COMPLETED WITHIN 7 CALENDAR DAYS FOR BTX&E (UNLESS SAMPLE HAS BEEN PRESERVED), AND 14 CALENDAR DAYS FOR TPH AS GASOLINE; EXTRACT TPH AS DIESEL WITHIN 14 CALENDAR DAYS.



SEQUOIA ANALYTICAL

680 Chesapeake Drive • Redwood City, CA 94063
(415) 364-9600 • FAX (415) 364-9233

Kaprealian Engineering, Inc.	Client Project ID: Unocal, Oakland, 35th Ave/Quigley	Sampled: Sep 11, 1989
P.O. Box 913	Matrix Descript: Soil, WO1	Received: Sep 12, 1989
Sanicla, CA 94510	Analysis Method: SM 503 D&E (Gravimetric)	Extracted: Sep 13, 1989
Attention: Mardo Kaprealian, P.E.	First Sample #: 909-1125	Analyzed: Sep 13, 1989
		Reported: Sep 13, 1989

TOTAL RECOVERABLE OIL & GREASE

Sample Number	Sample Description	Oil & Grease mg/kg (ppm)
909-1125	WO1	50

Detection Limits:	30.0
-------------------	------

Analyses reported as N.D. were not present above the stated limit of detection.

SEQUOIA ANALYTICAL

Arthur G. Burton
 Arthur G. Burton
 Laboratory Director

9091125.XEB (1)



SEQUOIA ANALYTICAL

680 Chesapeake Drive - Redwood City, CA 94063
(415) 364-9600 • FAX (415) 364-9233

Kaprealian Engineering, Inc.	Client Project ID: Unocal, Oakland, 35th Ave/Culley	Sampled: Sep 11, 1989
P.O. Box 913	Matrix Descript: Soil, W01	Received: Sep 12, 1989
Sanicla, CA 94510	Analysis Method: EPA 3550/8015	Extracted: Sep 12, 1989
Attention: Mardo Kaprealian, P.E.	First Sample #: 909-1125	Analyzed: Sep 12, 1989
		Reported: Sep 13, 1989

TOTAL PETROLEUM FUEL HYDROCARBONS (EPA 8015)

Sample Number	Sample Description	High B.P. Hydrocarbons mg/kg (ppm)
909-1125	W01	3.3

Detection Limits:	1.0
-------------------	-----

High Boiling Point Hydrocarbons are quantitated against a diesel fuel standard.
Analytes reported as N.D. were not present above the stated limit of detection

SEQUOIA ANALYTICAL

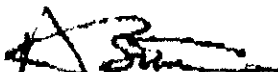
Arthur G. Burton
Laboratory Director

9091125.KE1 <8>



SEQUOIA ANALYTICAL

680 Chesapeake Drive • Redwood City, CA 94063
(415) 364-9600 • FAX (415) 364-9233

Kaprealian Engineering, Inc.	Client Project ID: Unocal, Oakland, 35th Ave/Quigley	Sampled: Sep 11, 1989
P.O. Box 913	Sample Descript.: Sol, WOI	Received: Sep 12, 1989
Benicia, CA 94510	Analysis Method: EPA 8030/8015/8020	Analyzed: Sep 13, 1989
Attention: Mardo Kaprealian, P.E.	Lab Number: 909-1125	Reported: Sep 13, 1989

TOTAL PETROLEUM FUEL HYDROCARBONS WITH BTEX DISTINCTION (EPA 8015/8020)

Analyte	Detection Limit mg/kg (ppm)	Sample Results mg/kg (ppm)
Low to Medium Boiling Point Hydrocarbons.....	1.0	N.D.
Benzene.....	0.05	N.D.
Toluene.....	0.1	N.D.
Ethyl Benzene.....	0.1	N.D.
Xylenes.....	0.1	N.D.

Low to Medium Boiling Point Hydrocarbons are quantitated against a gasoline standard.
Analytes reported as N.D. were not present above the stated limit of detection.

SEQUOIA ANALYTICAL

Arthur G. Burton
Laboratory Director

9091125.K01 <3>



SEQUOIA ANALYTICAL

660 Chesapeake Drive • Redwood City, CA 94063
(415) 364-9600 • FAX (415) 364-9233

Kaprealian Engineering, Inc. P.O. Box 913 Berkeley, CA 94510 Attention: Mardo Kaprealian, P.E.	Client Project ID: Unocal, Oakland, 35th Ave/Quigley Sample Descript: Soil, WO1 Analysis Method: EPA 5030/8010 Lab Number: 009-1125	Sampled: Sep 11, 1989 Received: Sep 12, 1989 Analyzed: Sep 12, 1989 Reported: Sep 19, 1989
---	--	---

HALOGENATED VOLATILE ORGANICS (EPA 8010)

Analyte	Detection Limit µg/kg	Sample Results µg/kg
Bromodichloromethane	5.0	N.D.
Bromoforn	5.0	N.D.
Bromomethane	5.0	N.D.
Carbon tetrachloride	5.0	N.D.
Chlorobenzene	5.0	N.D.
Chloroethane	25.0	N.D.
2-Chloroethylvinyl ether	5.0	N.D.
Chloroform	5.0	N.D.
Chloromethane	5.0	N.D.
Dibromochloromethane	5.0	N.D.
1,2-Dichlorobenzene	10.0	N.D.
1,3-Dichlorobenzene	10.0	N.D.
1,4-Dichlorobenzene	10.0	N.D.
1,1-Dichloroethane	5.0	N.D.
1,2-Dichloroethane	5.0	N.D.
1,1-Dichloroethene	5.0	N.D.
Total 1,2-Dichloroethene	5.0	N.D.
1,2-Dichloropropane	5.0	N.D.
cis-1,3-Dichloropropene	5.0	N.D.
trans-1,3-Dichloropropene	5.0	N.D.
Methylene chloride	10.0	N.D.
1,1,2,2-Tetrachloroethane	5.0	N.D.
Tetrachloroethene	5.0	N.D.
1,1,1-Trichloroethane	5.0	N.D.
1,1,2-Trichloroethane	5.0	N.D.
Trichloroethene	5.0	N.D.
Trichlorofluoromethane	5.0	N.D.
Vinyl chloride	10.0	N.D.

Analytes reported as N.D. were not present above the stated limit of detection.

SEQUOIA ANALYTICAL

Arthur G. Burton
Laboratory Director

0091125.K21 c4>



KAPREALIAN ENGINEERING, INC.

Consulting Engineers

P.O. BOX 513

BENICIA CA 94810

(415) 876-8100 (707) 746-6015

CHAIN OF CUSTODY

R.M. Bradish
SAMPLER: _____
(Signature)

DATE/TIME OF
COLLECTION: 9-11-89

TURN AROUND
TIME: 24 Hr

SAMPLE DESCRIPTION
AND PROJECT NUMBER:

Unusual - Oakland
35th Ave & Quigley

SAMPLE #	ANALYSES	GRAB OR COMP.	NUMBER OF CONTAINERS	SOIL/ WATER
91125 - W01	TPH-G; BTX&E; TPH-D; TOG (SOIL & E); SOIL	G	1	S

RELINQUISHED BY* TIME/DATE

1. *R.M. Bradish* 8:12 9/12/89

2. *Tom Baker* 9:12 9/12

3. _____

RECEIVED BY* TIME/DATE

Tom Baker 9:12 9-12-89

B.L. Olwin 9/12/89 10:00 a.m.

* STATE AFFILIATION NEXT TO SIGNATURE

REMARKS: _____

NOTE: IF REGULAR TURNAROUND, SOIL ANALYSES MUST BE COMPLETED WITHIN 14 CALENDAR DAYS OF SAMPLE COLLECTION. WATER ANALYSES MUST BE COMPLETED WITHIN 7 CALENDAR DAYS FOR BTX&E (UNLESS SAMPLE HAS BEEN PRESERVED), AND 14 CALENDAR DAYS FOR TPH AS GASOLINE; EXTRACT TPH AS DIESEL WITHIN 14 CALENDAR DAYS.