



GETTLER-RYAN INC.

TRANSMITTAL

RECEIVED

2:55 pm, Apr 24, 2008

Alameda County
Environmental Health

April 22, 2008

G-R #386956

TO: Ms. Charlotte Evans
Conestoga-Rovers & Associates
5900 Hollis Street, Suite A
Emeryville, California 94608

CC: Mr. Ian Robb
Chevron Environmental
Management Company
P.O. Box 6012, Room K2196
San Ramon, California 94583

FROM: Deanna L. Harding
Project Coordinator
Gettler-Ryan Inc.
6747 Sierra Court, Suite J
Dublin, California 94568

RE: **Former Texaco Service Station**
3810 Broadway
Oakland, California
(Site #211283)
RO 0000056

WE HAVE ENCLOSED THE FOLLOWING:

COPIES	DATED	DESCRIPTION
1	April 17, 2008	Groundwater Monitoring and Sampling Report First Quarter Event of March 11, 2008

COMMENTS:

Pursuant to your request, we are providing you with a copy of the above referenced report for your use and distribution to the following (via PDF):

Mr. Steven Plunkett, Alameda County Health Care Services, Dept. of Environmental Health, 1131 Harbor Bay Parkway, Suite 250, Alameda, CA 94502-6577 **(Distributed by CRA via PDF)**

Please provide any comments/changes and propose any groundwater monitoring modifications for the next event prior to **May 6, 2008**, at which time this final report will be distributed to the following:

cc: Mr. Joe Zadik, 8255 San Leandro Street, Oakland, CA 94621

Enclosures

Trans/211283-IR

6747 Sierra Court, Suite J • Dublin, CA 94568 • (925) 551-7555 • Fax (925) 551-7888
3140 Gold Camp Drive, Suite 170 • Rancho Cordova, CA 95670 • (916) 631-1300 • Fax (916) 631-1317
1364 N. McDowell Blvd., Suite B2 • Petaluma, CA 94954 • (707) 789-3255 • Fax (707) 789-3218



Ian Robb
Project Manager
Marketing Business Unit

**Chevron Environmental
Management Company**
6001 Bollinger Canyon Road
San Ramon, CA 94583
Tel (925) 842-9496
Fax (925) 842-8370
ianrobb@chevron.com

April 22, 2008

Alameda County Health Care Services
1131 Harbor Bay Parkway, Suite 250
Alameda, CA 94502-6577

RE: Chevron Service Station # 211283

Address 3810 Broadway, Oakland, California

I have reviewed the attached routine groundwater monitoring report dated April 22, 2008.

I agree with the conclusions and recommendations presented in the referenced report. The information in this report is accurate to the best of my knowledge and all local Agency/Regional Board guidelines have been followed. This report was prepared by Gettler-Ryan Inc., upon whose assistance and advice I have relied.

This letter is submitted pursuant to the requirements of California Water Code section 13267(b) (1) and the regulating implementation entitled Appendix A pertaining thereto.

I declare under penalty of perjury that the foregoing is true and correct.

Sincerely,

A handwritten signature in black ink, appearing to read "Ian Robb", written in a cursive style.

Ian Robb

Attachment: Report

WELL CONDITION STATUS SHEET

Client/Facility #: Chevron #211283
 Site Address: 3810 Broadway
 City: Oakland, CA

Job # 386956
 Event Date: 3/11/08
 Sampler: SH

WELL ID	Vault Frame Condition	Gasket/O-Ring (M)missing	BOLTS (M) Missing (R) Replaced	Bolt Flanges B= Broken S= Stripped R=Retap	APRON Condition C=Cracked B=Broken G=Gone	Grout Seal (Deficient) inches from TOC	Casing (Condition prevents tight cap seal)	REPLACE LOCK Y/N	REPLACE CAP Y/N	WELL VAULT Manufacture/Size/ # of Bolts	Pictures Taken Yes / No
MW-1	OK	→	2R (7/8")	2R (7/8")	OK	→	Bent 5' down	N	N	?/8" / 2	N
MW-4	OK	→								Emco/12"/2	N
MW-5B	OK	→								BL/8"/3	N
MW-6	OK	→	2R (1/2")	OK						Pemco/12"/2	N
MW-7	OK	→	2R (3/8")	2R (3/8")	OK					?/8" / 2	N
MW-9	OK	→	2R (3/8")	2R (3/8")	OK					?/8" / 2	N
MW-10	OK	→		2R 25FK	OK			Yes	Yes	Emco/12"/2	N
MW-11	OK	→	1M	1B, 1S	OK					Emco/12"/2	N
MW-12	OK	→	3R (3/8")	OK						BL/8"/3	N

Comments MW-10 - Flanges retapped, good thread at lower part of flanges, out of reach ~~to~~ of bolt
bring longer 1/2" bolts next event

MW-11 flange too stripped to retap



GETTLER-RYAN INC.



April 17, 2008
G-R Job #386956

Mr. Ian Robb
Chevron Environmental Management Company
P.O. Box 6012, Room K2196
San Ramon, CA 94583

RE: First Quarter Event of March 11, 2008
Groundwater Monitoring & Sampling Report
Former Texaco Service Station
3810 Broadway
Oakland, California
(Site #211283)

Dear Mr. Robb:

This report documents the most recent groundwater monitoring and sampling event performed by Gettler-Ryan Inc. (G-R) at the referenced site. All field work was conducted in accordance with G-R Standard Operating Procedure - Groundwater Sampling (attached).

Static groundwater levels were measured and the wells were checked for the presence of separate-phase hydrocarbons. Static water level data, groundwater elevations, and separate-phase hydrocarbon thickness (if any) are presented in the attached Table 1. A Potentiometric Map is included as Figure 1.

Groundwater samples were collected from the monitoring wells and submitted to a state certified laboratory for analyses. The field data sheets for this event are attached. Analytical results are presented in the table(s) listed below. The chain of custody document and laboratory analytical report are also attached.

Please call if you have any questions or comments regarding this report. Thank you.

Sincerely,



Deanna L. Harding
Project Coordinator



Hagop Kevork
P.E. No. C55734

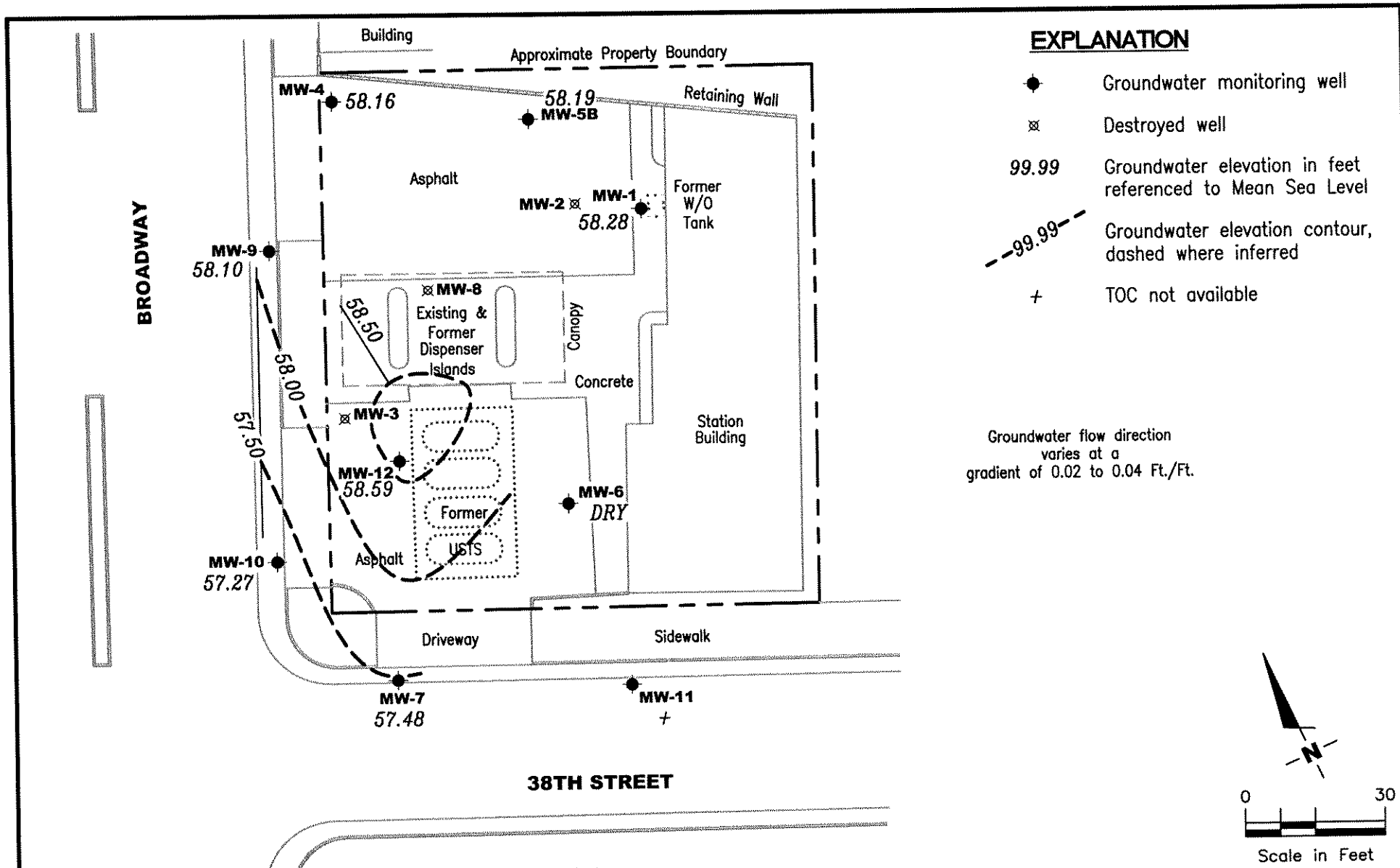

Figure 1: Potentiometric Map
Table 1: Groundwater Monitoring Data and Analytical Results
Table 2: Field Measurements
Attachments: Standard Operating Procedure - Groundwater Sampling
Field Data Sheets
Chain of Custody Document and Laboratory Analytical Reports



Source: Figure modified from drawing provided by Delta Environmental and Morrow Surveying dated 06/24/02

FIGURE

GETTLER - RYAN INC.
 6747 Sierra Court, Suite J
 Dublin, CA 94568 (925) 551-7555

POTENTIOMETRIC MAP
 Former Texaco Service Station
 3810 Broadway
 Oakland, California (Site #211283)

1

PROJECT NUMBER
 386956

REVIEWED BY

DATE
 March 11, 2008

REVISED DATE

Table 1
Groundwater Monitoring Data and Analytical Results
Former Texaco Service Station (Site #211283)
3810 Broadway
Oakland, California

WELL ID/ DATE	TOC* (ft.)	DTW (ft.)	GWE (msl)	SPHT (ft.)	TPH-D (ppb)	TPH-G (ppb)	B (ppb)	T (ppb)	E (ppb)	X (ppb)	MTBE by	MTBE by	ETHANOL (ppb)
											8021◆ (ppb)	8260 (ppb)	
MW-1													
06/28/96	86.69	21.77	64.92	--	<50	<100	<0.5	<1.0	<1.0	<2.0	--	--	--
10/10/96	86.69	23.26	63.43	--	<400	520	9.2	53	17	70	22	16 ¹	--
11/07/96	86.69	23.27	63.42	--	--	--	--	--	--	--	--	--	--
12/18/97	86.69	19.70	66.99	--	<50	2,200	<3.0	<3.0	<3.0	<3.0	<200	--	--
04/06/98	86.69	16.88	69.81	--	<50	1,600	16.4	0.8	<0.5	<0.5	38.3	--	--
06/18/98	86.69	19.78	66.91	--	280	330	7.8	<0.5	<0.5	<0.5	<0.5	--	--
08/31/98	86.69	21.71	64.98	--	150	<50	1.5	<0.5	<0.5	<0.5	<2.5	--	--
12/21/98	86.69	22.15	64.54	--	130	130	2.3	0.90	<0.5	<0.5	110	13	--
03/24/99	86.69	19.55	67.14	--	305	1,520	11.7	<2.50	<2.50	<2.50	21.6	<25.0	--
06/25/99	86.69	21.60	65.09	--	207	231	5.29	<0.500	<0.500	<0.500	3.94	1.01	--
09/24/99	86.69	22.58	64.11	--	71.7	58.6	6.03	<0.500	<0.500	<0.500	3.70	--	--
12/29/99	86.69	22.81	63.88	--	345	117	4.26	<0.500	<0.500	1.97	26.2	<0.500	--
03/21/00	86.69	19.00	67.69	--	319	834	<0.500	<0.500	<0.500	<0.500	21.5	--	--
07/26/00	86.69	21.50	65.19	--	125	<50.0	<0.500	<0.500	<0.500	<0.500	<2.50	--	--
09/06/00	86.69	21.90	64.79	--	192	88.1	15.60	<0.500	<0.500	<0.500	--	--	--
11/29/00	86.92	22.05	64.87	--	331	<50.0	3.52	<0.500	<0.500	<0.500	--	--	--
03/06/01	86.92	19.79	67.13	--	--	--	--	--	--	--	--	--	--
03/23/01	86.92	20.15	66.77	--	-- ⁵	204	10.7	<0.500	<0.500	<0.500	--	--	--
06/19/01 ⁶	86.92	21.78	65.14	--	330	<50	<0.50	<0.50	<0.50	<0.50	--	0.87	--
09/05/01 ⁶	86.92	24.37	62.55	--	400	74	<0.50	0.63	<0.50	2.7	--	<5.0	--
12/20/01 ⁶	86.92	20.25	66.67	--	530	59	1.7	<0.50	<0.50	<0.50	--	<5.0	--
06/25/02	86.69	21.64	65.05	0.00	490 ⁹	<50	<0.50	<0.50	<0.50	<1.5	<2.5	--	--
09/18/02	86.69	22.44	64.25	0.00	180	<50	<0.50	<0.50	<0.50	<1.5	<2.5	--	--
12/19/02	86.69	21.49	65.20	0.00	320	<50	<0.50	<0.50	<0.50	<1.5	<2.5	--	--
03/20/03	86.69	20.92	65.77	0.00	UNABLE TO SAMPLE - BEND IN WELL				--	--	--	--	--
06/23/03 ¹⁰	86.69	21.34	65.35	0.00	310	<50	<0.5	<0.5	<0.5	<0.5	--	<0.5	--
09/22/03 ¹⁰	86.69	22.46	64.23	0.00	150	<50	<0.5	<0.5	<0.5	<0.5	--	<0.5	<50
12/22/03 ¹⁰	86.69	22.10	64.59	0.00	350	<50	<0.5	<0.5	<0.5	<0.5	--	<0.5	<50
03/22/04 ¹⁰	86.69	20.42	66.27	0.00	270	<50	<0.5	<0.5	<0.5	<0.5	--	2	<50
06/21/04 ¹⁰	86.69	21.93	64.76	0.00	130	<50	<0.5	<0.5	<0.5	<0.5	--	<0.5	<50
09/20/04 ¹⁰	86.69	22.99	63.70	0.00	240	<50	<0.5	<0.5	<0.5	<0.5	--	<0.5	<50
12/20/04 ¹⁰	86.69	21.78	64.91	0.00	320 ⁹	<50	<0.5	<0.5	<0.5	<0.5	--	<0.5	<50
03/28/05 ¹⁰	86.69	19.28	67.41	0.00	400 ⁹	<50	<0.5	<0.5	<0.5	<0.5	--	0.6	<50
06/27/05 ¹⁰	86.69	20.82	65.87	0.00	200 ¹²	<50	<0.5	<0.5	<0.5	<0.5	--	<0.5	<50

Table 1
Groundwater Monitoring Data and Analytical Results
Former Texaco Service Station (Site #211283)
3810 Broadway
Oakland, California

WELL ID/ DATE	TOC* (ft.)	DFW (ft.)	GWE (msl)	SPHT (ft.)	TPH-D (ppb)	TPH-G (ppb)	B (ppb)	T (ppb)	E (ppb)	X (ppb)	MTBE by 8021♦ (ppb)	MTBE by 8260 (ppb)	ETHANOL (ppb)	
MW-1 (cont)														
09/19/05 ¹⁰	86.69	22.17	64.52	0.00	62	<50	<0.5	<0.5	<0.5	<0.5	--	<0.5	<50	
12/19/05 ¹⁰	86.69	22.06	64.63	0.00	360 ¹⁶	<50	<0.5	0.8	<0.5	<0.5	--	<0.5	<50	
03/27/06 ¹⁰	86.69	18.27	68.42	0.00	320	77	<0.5	0.5	2	4	--	0.7	<50	
06/26/06 ¹⁰	86.69	20.20	66.49	0.00	290	<50	<0.5	<0.5	<0.5	<0.5	--	<0.5	<50	
09/25/06 ¹⁰	86.69	21.86	64.83	0.00	270	<50	<0.5	<0.5	<0.5	<0.5	--	<0.5	<50	
12/18/06	86.69	21.60	65.09	UNABLE TO SAMPLE - DUE TO BENT WELL CASING						--	--	--	--	--
03/19/07 ¹⁰	NP ¹⁸	86.69	20.82	65.87	0.00	630	<50	<0.5	<0.5	<0.5	--	<0.5	<50	
06/25/07 ¹⁰	NP ¹⁸	86.69	28.62	58.07	0.00	4,100 ¹⁹	<50	<0.5	<0.5	<0.5	--	<0.5	<50	
09/24/07	86.69	DRY	--	--	--	--	--	--	--	--	--	--	--	
12/18/07	86.69	29.35	57.34	UNABLE TO SAMPLE - DUE TO INSUFFICIENT WATER						--	--	--	--	
03/11/08	86.69	28.41	58.28	UNABLE TO SAMPLE - DUE TO BENT WELL CASING						--	--	--	--	
MW-4														
06/28/96	83.31	18.83	64.48	--	<50	<100	<0.5	<1.0	<1.0	<2.0	--	--	--	
10/10/96	83.31	19.84	63.47	--	<50	650	3.9	65	22	120	<5.0	--	--	
11/07/96	83.31	19.84	63.47	--	--	--	--	--	--	--	--	--	--	
12/18/97	83.31	17.77	65.54	--	2,000	<50	<0.5	<0.5	<0.5	<0.5	<30	--	--	
04/06/98	83.31	15.45	67.86	--	<50	<50	<0.5	<0.5	<0.5	<0.5	<30	--	--	
06/18/98	83.31	16.89	66.42	--	53	<50	<0.5	<0.5	<0.5	<0.5	<0.5	--	--	
08/31/98	83.31	18.48	64.83	--	60	<50	<0.5	<0.5	<0.5	<0.5	<2.5	--	--	
12/21/98	83.31	18.80	64.51	--	<50	<50	<0.5	<0.5	<0.5	<0.5	<2.5	--	--	
03/24/99	83.31	16.70	66.61	--	<50.0	<50.0	<0.500	<0.500	<0.500	<0.500	<2.00	--	--	
06/25/99	83.31	18.16	65.15	--	128	<50.0	<0.500	<0.500	<0.500	<0.500	<2.00	--	--	
09/24/99	83.31	19.12	64.19	--	<50.0	<50.0	<0.500	<0.500	<0.500	<0.500	<2.50	--	--	
12/29/99	83.31	19.08	64.23	--	169	<50.0	<0.500	<0.500	<0.500	<0.500	<5.00	--	--	
03/21/00	83.31	16.10	67.21	--	<50.0	<50.0	<0.500	<0.500	<0.500	<0.500	<2.50	--	--	
07/26/00	83.31	OBSTRUCTION IN WELL			--	--	--	--	--	--	--	--	--	
09/06/00	83.31	18.52	64.79	--	-- ⁵	<50.0	<0.500	<0.500	<0.500	<0.500	--	--	--	
11/29/00	83.63	18.75	64.88	--	183	<50.0	<0.500	<0.500	<0.500	<0.500	--	--	--	
03/06/01	83.63	17.81	65.82	--	50.9	<50.0	<0.500	<0.500	<0.500	<0.500	--	--	--	
06/19/01 ⁶	83.63	18.55	65.08	--	<50	<50	<0.50	<0.50	<0.50	<0.50	--	<0.50	--	
09/05/01 ⁶	83.63	19.10	64.53	--	710	<50	<0.50	<0.50	<0.50	<0.50	--	<5.0	--	
12/20/01 ⁶	83.63	17.55	66.08	--	460	<50	<0.50	<0.50	<0.50	<0.50	--	<5.0	--	

Table 1
Groundwater Monitoring Data and Analytical Results
Former Texaco Service Station (Site #211283)
3810 Broadway
Oakland, California

WELL ID/ DATE	TOC* (ft.)	DTW (ft.)	GWE (msl)	SPHT (ft.)	TPH-D (ppb)	TPH-G (ppb)	B (ppb)	T (ppb)	E (ppb)	X (ppb)	MTBE by	MTBE by	ETHANOL (ppb)
											8021♦ (ppb)	8260 (ppb)	
MW-4 (cont)													
06/25/02	83.31	18.39	64.92	0.00	250	<50	<0.50	<0.50	<0.50	<1.5	<2.5	--	--
09/18/02	83.31	19.16	64.15	0.00	160	<50	<0.50	<0.50	<0.50	<1.5	<2.5	--	--
12/19/02	83.31	18.14	65.17	0.00	56	<50	<0.50	<0.50	<0.50	<1.5	<2.5	--	--
03/20/03	83.31	17.76	65.55	0.00	180	<50	<0.50	<0.50	<0.50	<1.5	<2.5	--	--
06/23/03 ¹⁰	83.31	18.13	65.18	0.00	<50	<50	<0.5	<0.5	<0.5	<0.5	--	<0.5	--
09/22/03 ¹⁰	83.31	19.08	64.23	0.00	110	<50	<0.5	<0.5	<0.5	<0.5	--	<0.5	<50
12/22/03 ¹⁰	83.31	18.78	64.53	0.00	<50	<50	<0.5	<0.5	<0.5	<0.5	--	<0.5	<50
03/22/04 ¹⁰	83.31	17.31	66.00	0.00	130	<50	<0.5	<0.5	<0.5	<0.5	--	<0.5	<50
06/21/04 ¹⁰	83.31	18.67	64.64	0.00	87	<50	<0.5	<0.5	<0.5	<0.5	--	<0.5	<50
09/20/04 ¹⁰	83.31	19.58	63.73	0.00	120	<50	<0.5	<0.5	<0.5	<0.5	--	<0.5	<50
12/20/04 ¹⁰	83.31	18.59	64.72	0.00	66 ⁹	<50	<0.5	<0.5	<0.5	<0.5	--	<0.5	<50
03/28/05 ¹⁰	83.31	16.82	66.49	0.00	71 ⁹	<50	<0.5	<0.5	<0.5	<0.5	--	<0.5	<50
06/27/05 ¹⁰	83.31	17.61	65.70	0.00	120 ¹²	<50	<0.5	<0.5	<0.5	<0.5	--	<0.5	<50
09/19/05 ¹⁰	83.31	19.00	64.31	0.00	<50	<50	<0.5	<0.5	<0.5	<0.5	--	<0.5	<50
12/19/05 ¹⁰	83.31	18.69	64.62	0.00	<50	<50	<0.5	<0.5	<0.5	<0.5	--	<0.5	<50
03/27/06 ¹⁰	83.31	15.05	68.26	0.00	160	<50	<0.5	<0.5	<0.5	<0.5	--	<0.5	<50
06/26/06 ¹⁰	83.31	16.81	66.50	0.00	110	<50	<0.5	<0.5	<0.5	<0.5	--	<0.5	<50
09/25/06 ¹⁰	83.31	18.59	64.72	0.00	120	<50	<0.5	<0.5	<0.5	<0.5	--	<0.5	<50
12/18/06 ¹⁰	83.31	18.26	65.05	0.00	250	<50	<0.5	<0.5	<0.5	<0.5	--	<0.5	<50
03/19/07 ¹⁰	83.31	17.62	65.69	0.00	93	<50	<0.5	<0.5	<0.5	<0.5	--	<0.5	<50
06/25/07 ¹⁰	83.31	24.82	58.49	0.00	4,600 ¹⁹	<50	<0.5	<0.5	<0.5	<0.5	--	<0.5	<50
09/24/07 ¹⁰	83.31	26.76	56.55	0.00	4,300	94	<0.5	<0.5	<0.5	<0.5	--	0.6	<50
12/18/07 ¹⁰	83.31	25.91	57.40	0.00	3,700	<50	<0.5	<0.5	<0.5	<0.5	--	0.6	<50
03/11/08¹⁰	83.31	25.15	58.16	0.00	430	54	<0.5	<0.5	<0.5	<0.5	--	0.6	<50
MW-5B													
06/25/02 ⁷	85.36	20.48	64.88	0.00	320	660	89	1.9	39	11	130	--	--
09/18/02	85.36	21.18	64.18	0.00	480	1,100	220	1.2	19	<1.5	35	--	--
12/19/02	85.36	20.36	65.00	0.00	330	<50	<0.50	<0.50	<0.50	<1.5	190	--	--
03/20/03	85.36	INACCESSIBLE - VEHICLE OVER WELL				--	--	--	--	--	--	--	--
06/23/03 ¹⁰	85.36	20.18	65.18	0.00	300	<50	<0.5	<0.5	<0.5	<0.5	--	290	--
09/22/03 ¹⁰	85.36	21.19	64.17	0.00	200	91	19	<0.5	3	<0.5	--	260	<50
12/22/03 ¹⁰	85.36	20.85	64.51	0.00	410	99	18	<0.5	<0.5	<0.5	--	52	<50

Table 1
Groundwater Monitoring Data and Analytical Results
Former Texaco Service Station (Site #211283)
3810 Broadway
Oakland, California

WELL ID/ DATE	TOC* (ft.)	DTW (ft.)	GWE (msl)	SPHT (ft.)	TPH-D (ppb)	TPH-G (ppb)	B (ppb)	T (ppb)	E (ppb)	X (ppb)	MTBE by	MTBE by	ETHANOL (ppb)
											8021♦ (ppb)	8260 (ppb)	
MW-5B (cont)													
03/22/04 ¹⁰	85.36	19.26	66.10	0.00	400	<50	<0.5	<0.5	<0.5	<0.5	--	210	<50
06/21/04 ¹⁰	85.36	20.70	64.66	0.00	270	<50	<0.5	<0.5	<0.5	<0.5	--	100	<50
09/20/04 ¹⁰	85.36	21.69	63.67	0.00	430	<50	<0.5	<0.5	<0.5	<0.5	--	9	<50
12/20/04 ¹⁰	85.36	20.56	64.80	0.00	400 ⁹	<50	<0.5	<0.5	<0.5	<0.5	--	48	<50
03/28/05 ¹⁰	85.36	18.12	67.24	0.00	480 ⁹	<50	<0.5	<0.5	<0.5	<0.5	--	67	<50
06/27/05 ¹⁰	85.36	19.61	65.75	0.00	350 ¹³	<50	<0.5	<0.5	<0.5	<0.5	--	57	<50
09/19/05 ¹⁰	85.36	20.88	64.48	0.00	220	<50	<0.5	<0.5	<0.5	<0.5	--	32	<50
12/19/05 ¹⁰	85.36	20.74	64.62	0.00	330 ¹⁶	<50	<0.5	<0.5	<0.5	<0.5	--	21	<50
03/27/06 ¹⁰	85.36	17.10	68.26	0.00	550	<50	<0.5	<0.5	<0.5	<0.5	--	31	<50
06/26/06 ¹⁰	85.36	19.05	66.31	0.00	410	<50	<0.5	<0.5	<0.5	<0.5	--	30	<50
09/25/06 ¹⁰	85.36	20.61	64.75	0.00	320	<50	<0.5	<0.5	<0.5	<0.5	--	25	<50
12/18/06 ¹⁰	85.36	20.35	65.01	0.00	580	<50	<0.5	<0.5	<0.5	<0.5	--	14	<50
03/19/07 ¹⁰	85.36	19.62	65.74	0.00	170	<50	<0.5	<0.5	<0.5	<0.5	--	24	<50
06/25/07 ¹⁰	85.36	26.94	58.42	0.00	950 ¹⁹	250 ¹⁹	2	<0.5	0.6	1	--	15	<50
09/24/07 ¹⁰	85.36	28.78	56.58	0.00	1,300	1,900	5	0.6	3	5	--	25	<50
12/18/07 ¹⁰	85.36	27.98	57.38	0.00	560	2,100	19	<0.5	2	4	--	28	<50
03/11/08¹⁰	85.36	27.17	58.19	0.00	290	640	16	<0.5	4	0.5	--	38	<50
MW-6													
10/10/96	86.09	22.44	63.65	--	500	45,000	8,300	2,900	810	3,100	190	40 ¹	--
11/07/96	86.09	22.60	63.49	--	--	--	--	--	--	--	--	--	--
12/18/97	86.09	22.28	63.81	--	1,900	60,000	12,000	9,800	1,800	8,600	<2,000	--	--
04/06/98	86.09	19.90	66.19	--	<50	30,500	5,950	3,720	952	3,750	<1,000	--	--
06/18/98	86.09	20.49	65.60	--	1,100	23,000	2,600	540	410	1,300	<250	--	--
08/31/98	86.09	21.05	65.04	--	1,800	17,000	3,400	460	530	1,800	<250	--	--
12/21/98	86.09	21.74	64.35	--	930	7,900	1,900	510	280	730	150	2.6	--
03/24/99	86.09	21.18	64.91	--	763	12,200	1,970	327	338	794	<40.0	<50.0	--
06/25/99	86.09	21.34	64.75	--	1,050	14,800	2,040	1,080	406	1,430	<40.0	--	--
09/24/99	86.09	22.28	63.81	--	1,720	17,200	2,810	1,330	489	2,340	<50.0	--	--
12/29/99	86.09	24.96	61.13	--	1,480	14,700	2,790	974	469	1,720	<500	--	--
03/21/00	86.09	18.70	67.39	--	1,120	20,000	4,160	962	719	2,330	<250	--	--
07/26/00	86.09	INACCESSIBLE		--	--	--	--	--	--	--	--	--	--
09/06/00	86.09	INACCESSIBLE		--	--	--	--	--	--	--	--	--	--

Table 1
Groundwater Monitoring Data and Analytical Results
Former Texaco Service Station (Site #211283)
3810 Broadway
Oakland, California

WELL ID/ DATE	TOC* (ft.)	DTW (ft.)	GWE (msl)	SPHT (ft.)	TPH-D (ppb)	TPH-G (ppb)	B (ppb)	T (ppb)	E (ppb)	X (ppb)	MTBE by	MTBE by	ETHANOL (ppb)
											8021◆ (ppb)	8260 (ppb)	
MW-6 (cont)													
11/29/00	86.48	21.30	65.18	--	2,060	22,800	4,120	2,010	872	3,180	--	--	--
03/06/01	86.48	19.05	67.43	--	2,220	32,100	3,760	4,590	1,160	5,360	--	--	--
06/19/01 ⁶	86.48	21.11	65.37	--	<1,500	40,000	2,800	6,000	1,200	5,300	--	<25	--
09/05/01 ⁶	86.48	21.37	65.11	--	<1,000	18,000	3,800	800	730	1,400	--	<200	--
12/20/01 ⁶	86.48	19.80	66.68	--	<1,300	29,000	2,600	3,700	1,100	4,100	--	<100	--
06/25/02	86.09	21.13	64.96	0.00	2,500	21,000	2,200	1,800	850	2,100	<100	--	--
09/18/02	86.09	22.00	64.09	0.00	1,300	13,000	1,700	480	610	970	110	--	--
12/19/02	86.09	20.98	65.11	0.00	2,700	20,000	2,900	620	770	2,100	<20	--	--
03/20/03	86.09	20.23	65.86	0.00	2,600	23,000	1,500	2,200	920	3,400	<100	--	--
06/23/03 ¹⁰	86.09	20.96	65.13	0.00	2,400	21,000	2,000	1,400	890	2,500	--	6	--
09/22/03 ¹⁰	86.09	21.95	64.14	0.00	1,800	7,400	920	220	360	580	--	5	<50
12/22/03 ¹⁰	86.09	21.63	64.46	0.00	2,300	9,700	1,700	240	450	1,000	--	6	<100 ¹¹
03/22/04 ¹⁰	86.09	20.31	65.78	0.00	2,700	23,000	1,500	1,400	830	2,800	--	4	<250
06/21/04 ¹⁰	86.09	20.64	65.45	0.00	2,800	20,000	2,000	2,300	1,100	3,800	--	4	<130
09/20/04 ¹⁰	86.09	22.29	63.80	0.00	1,300	4,600	480	65	200	260	--	4	<100
12/20/04 ¹⁰	86.09	21.33	64.76	0.00	1,500	9,500	1,500	220	450	840	--	5	<250
03/28/05 ¹⁰	86.09	19.65	66.44	0.00	2,400 ⁹	13,000	1,100	550	600	1,600	--	3	<250
06/27/05 ¹⁰	86.09	19.86	66.23	0.00	2,100 ¹⁴	15,000	1,100	1,300	790	2,600	--	3	<100
09/19/05 ¹⁰	86.09	20.49	65.60	0.00	2,300	18,000	1,300	1,200	800	2,500	--	3	<100
12/19/05 ¹⁰	86.09	21.49	64.60	0.00	1,900 ¹⁴	13,000	1,900	190	620	890	--	5	110
03/27/06 ¹⁰	86.09	18.28	67.81	0.00	1,300	14,000	740	420	600	1,400	--	2	<50
06/26/06 ¹⁰	86.09	19.08	67.01	0.00	2,300	23,000	660	1,700	870	3,000	--	<3	<250
09/25/06 ¹⁰	86.09	20.02	66.07	0.00	2,100	18,000	580	1,200	760	2,600	--	1	<100
12/18/06 ¹⁰	86.09	20.57	65.52	0.00	2,700	14,000	1,200	370	680	1,300	--	4	<50
03/19/07 ¹⁰	86.09	20.56	65.53	0.00	2,700	17,000	990	560	840	2,100	--	3	<100
06/25/07	86.09	DRY	--	--	--	--	--	--	--	--	--	--	--
09/24/07	86.09	DRY	--	--	--	--	--	--	--	--	--	--	--
12/18/07	86.09	DRY	--	--	--	--	--	--	--	--	--	--	--
03/11/08	86.09	DRY	--	--	--	--	--	--	--	--	--	--	--
MW-7													
10/10/96	84.11	20.78	63.33	--	<50	<50	0.6	<0.5	<0.5	<0.5	<5.0	--	--
11/07/96	84.11	20.80	63.31	--	--	--	--	--	--	--	--	--	--

Table 1
Groundwater Monitoring Data and Analytical Results
Former Texaco Service Station (Site #211283)
3810 Broadway
Oakland, California

WELL ID/ DATE	TOC* (ft.)	DTW (ft.)	GWE (msl)	SPHT (ft.)	TPH-D (ppb)	TPH-G (ppb)	B (ppb)	T (ppb)	E (ppb)	X (ppb)	MTBE by	MTBE by	ETHANOL (ppb)
											8021♦ (ppb)	8260 (ppb)	
MW-7 (cont)													
12/18/97	84.11	17.27	66.84	--	<50	<50	<0.5	<0.5	<0.5	<0.5	<30	--	--
04/06/98	84.11	15.91	68.20	--	<50	<50	<0.5	<0.5	<0.5	<0.5	<30	--	--
06/18/98	84.11	17.95	66.16	--	<50	<50	<0.5	<0.5	<0.5	<0.5	<0.5	--	--
08/31/98	84.11	19.40	64.71	--	<50	<50	<0.5	<0.5	<0.5	<0.5	<2.5	--	--
12/21/98	84.11	19.75	64.36	--	<50	<50	<0.5	<0.5	<0.5	<0.5	<2.5	--	--
03/24/99	84.11	17.54	66.57	--	51.3	<50.0	<0.500	<0.500	<0.500	<0.500	<2.00	--	--
06/25/99	84.11	19.22	64.89	--	<50.0	<50.0	<0.500	<0.500	<0.500	<0.500	<2.00	--	--
09/24/99	84.11	20.18	63.93	--	<50.0	<50.0	<0.500	<0.500	<0.500	<0.500	<2.50	--	--
12/29/99	84.11	20.15	63.96	--	99.0	<50.0	<0.500	<0.500	<0.500	<0.500	<5.00	--	--
03/21/00	84.11	16.35	67.76	--	<50.0	<50.0	<0.500	<0.500	<0.500	<0.500	<2.50	--	--
07/26/00	84.11	18.99	65.12	--	<50.0	<50.0	<0.500	<0.500	<0.500	<0.500	<2.50	--	--
09/06/00	84.11	19.49	64.62	--	-- ⁵	<50.0	<0.500	<0.500	<0.500	<0.500	--	--	--
11/29/00	84.44	19.52	64.92	--	<50.0	<50.0	<0.500	<0.500	<0.500	<0.500	--	--	--
03/06/01	84.44	17.15	67.29	--	<50.0	<50.0	<0.500	<0.500	<0.500	<0.500	--	--	--
06/19/01 ⁶	84.44	19.30	65.14	--	<50	<50	<0.50	<0.50	<0.50	<0.50	--	<0.50	--
09/05/01 ⁶	84.44	20.22	64.22	--	<50	<50	0.64	0.84	0.94	5.2	--	<5.0	--
12/20/01 ⁶	84.44	17.85	66.59	--	<50	<50	<0.50	<0.50	<0.50	<0.50	--	<5.0	--
06/25/02	84.11	19.30	64.81	0.00	<50	<50	<0.50	<0.50	<0.50	<1.5	<2.5	--	--
09/18/02	84.11	20.10	64.01	0.00	170	<50	<0.50	<0.50	<0.50	<1.5	<2.5	--	--
12/19/02	84.11	18.73	65.38	0.00	<50	<50	<0.50	<0.50	<0.50	<1.5	<2.5	--	--
03/20/03	84.11	18.86	65.25	0.00	<50	<50	<0.50	<0.50	<0.50	<1.5	<2.5	--	--
06/23/03 ¹⁰	84.11	19.00	65.11	0.00	<50	<50	<0.5	<0.5	<0.5	<0.5	--	<0.5	--
09/22/03 ¹⁰	84.11	20.05	64.06	0.00	<50	<50	<0.5	<0.5	<0.5	<0.5	--	<0.5	<50
12/22/03 ¹⁰	84.11	19.72	64.39	0.00	72	<50	<0.5	<0.5	<0.5	<0.5	--	<0.5	<50
03/22/04 ¹⁰	84.11	17.94	66.17	0.00	<50	<50	<0.5	<0.5	<0.5	<0.5	--	<0.5	<50
06/21/04 ¹⁰	84.11	19.53	64.58	0.00	73	<50	<0.5	<0.5	<0.5	<0.5	--	<0.5	<50
09/20/04 ¹⁰	84.11	20.59	63.52	0.00	69	<50	<0.5	<0.5	<0.5	<0.5	--	<0.5	<50
12/20/04 ¹⁰	84.11	19.43	64.68	0.00	67 ⁹	<50	<0.5	<0.5	<0.5	<0.5	--	<0.5	<50
03/28/05 ¹⁰	84.11	16.68	67.43	0.00	69 ⁹	<50	<0.5	<0.5	<0.5	<0.5	--	<0.5	<50
06/27/05 ¹⁰	84.11	18.43	65.68	0.00	<50	<50	<0.5	<0.5	<0.5	<0.5	--	<0.5	<50
09/19/05 ¹⁰	84.11	19.77	64.34	0.00	<50	<50	<0.5	<0.5	<0.5	<0.5	--	<0.5	<50
12/19/05 ¹⁰	84.11	19.38	64.73	0.00	<50	<50	<0.5	<0.5	<0.5	<0.5	--	<0.5	<50
03/27/06 ¹⁰	84.11	15.51	68.60	0.00	<50	<50	<0.5	<0.5	<0.5	<0.5	--	<0.5	<50
06/26/06 ¹⁰	84.11	17.85	66.26	0.00	70	<50	<0.5	<0.5	<0.5	<0.5	--	<0.5	<50

Table 1
Groundwater Monitoring Data and Analytical Results
Former Texaco Service Station (Site #211283)
3810 Broadway
Oakland, California

WELL ID/ DATE	TOC* (ft.)	DTW (ft.)	GWE (msl)	SPHT (ft.)	TPH-D (ppb)	TPH-G (ppb)	B (ppb)	T (ppb)	E (ppb)	X (ppb)	MTBE by 8021♦ (ppb)	MTBE by 8260 (ppb)	ETHANOL (ppb)
MW-7 (cont)													
09/25/06 ¹⁰	84.11	19.53	64.58	0.00	<50	<50	<0.5	<0.5	<0.5	<0.5	--	<0.5	<50
12/18/06 ¹⁰	84.11	19.28	64.83	0.00	270	<50	<0.5	<0.5	<0.5	<0.5	--	<0.5	<50
03/19/07 ¹⁰	84.11	18.32	65.79	0.00	81	<50	<0.5	<0.5	<0.5	<0.5	--	<0.5	<50
06/25/07 ¹⁰	84.11	26.92	57.19	0.00	65	<50	<0.5	<0.5	<0.5	<0.5	--	1	<50
09/24/07 ¹⁰	84.11	28.32	55.79	0.00	<150	<50	<0.5	<0.5	<0.5	<0.5	--	0.7	<50
12/18/07 ¹⁰	84.11	27.61	56.50	0.00	130	<50	<0.5	<0.5	<0.5	<0.5	--	1	<50
03/11/08¹⁰	84.11	26.63	57.48	0.00	<50	<50	<0.5	<0.5	<0.5	<0.5	--	<0.5	<50
MW-9													
10/10/96	82.17	18.62	63.55	--	520	80	2.5	13	2.2	13	<5.0	--	--
11/07/96	82.17	63.53	18.64	--	--	--	--	--	--	--	--	--	--
12/18/97	82.17	16.42	65.75	--	<50	<50	<0.5	<0.5	<0.5	<0.5	<30	--	--
04/06/98	82.17	14.00	68.17	--	<50	<50	<0.5	<0.5	<0.5	<0.5	<30	--	--
06/18/98	82.17	15.33	66.84	--	100	<50	<0.5	<0.5	<0.5	<0.5	<0.5	--	--
08/31/98	82.17	17.14	65.03	--	57	<50	<0.5	<0.5	<0.5	<0.5	<2.5	--	--
12/21/98	82.17	17.40	64.77	--	71	<50	<0.5	<0.5	<0.5	<0.5	<2.5	--	--
03/24/99	82.17	16.22	65.95	--	84.0	<50.0	<0.500	<0.500	<0.500	<0.500	<2.00	--	--
06/25/99	82.17	16.90	65.27	--	92.0	<50.0	<0.500	<0.500	<0.500	<0.500	<2.00	--	--
09/24/99	82.17	17.89	64.28	--	<50.0	<50.0	<0.500	<0.500	<0.500	<0.500	<2.50	--	--
12/29/99	82.17	18.01	64.16	--	52.8	<50.0	<0.500	<0.500	<0.500	<0.500	<5.00	--	--
03/21/00	82.17	14.80	67.37	--	72.4	<50.0	<0.500	<0.500	<0.500	<0.500	<2.50	--	--
07/26/00	82.17	17.17	65.00	--	83.6	<50.0	<0.500	<0.500	<0.500	<0.500	<2.50	--	--
09/06/00	82.17	17.95	64.22	--	74.3	<50.0	<0.500	<0.500	<0.500	<0.500	--	--	--
11/29/00	82.52	18.10	64.42	--	96.2	<50.0	<0.500	<0.500	<0.500	<0.500	--	--	--
03/06/01	82.52	16.75	65.77	--	94.2	<50.0	<0.500	<0.500	<0.500	<0.500	--	--	--
06/19/01 ⁶	82.52	17.83	64.69	--	<50	<50	<0.50	<0.50	<0.50	<0.50	--	<0.50	--
09/05/01 ⁶	82.52	17.98	64.54	--	<50	<50	<0.50	<0.50	<0.50	1.6	--	<5.0	--
12/20/01 ⁶	82.52	16.85	65.67	--	84	<50	<0.50	<0.50	<0.50	<0.50	--	<5.0	--
06/25/02	82.17	17.12	65.05	0.00	100	<50	<0.50	<0.50	<0.50	<1.5	<2.5	--	--
09/18/02	82.17	17.76	64.41	0.00	170	<50	<0.50	<0.50	<0.50	<1.5	<2.5	--	--
12/19/02	82.17	16.83	65.34	0.00	73	<50	<0.50	<0.50	<0.50	<1.5	<2.5	--	--
03/20/03	82.17	16.61	65.56	0.00	87	<50	<0.50	<0.50	<0.50	<1.5	<2.5	--	--
06/23/03 ¹⁰	82.17	17.14	65.03	0.00	<50	<50	<0.5	<0.5	<0.5	<0.5	--	0.7	--

Table 1
Groundwater Monitoring Data and Analytical Results
Former Texaco Service Station (Site #211283)
3810 Broadway
Oakland, California

WELL ID/ DATE	TOC* (ft.)	DTW (ft.)	GWE (msl)	SPHT (ft.)	TPH-D (ppb)	TPH-G (ppb)	B (ppb)	T (ppb)	E (ppb)	X (ppb)	MTBE by 8021◆ (ppb)	MTBE by 8260 (ppb)	ETHANOL (ppb)
MW-9 (cont)													
09/22/03 ¹⁰	82.17	17.72	64.45	0.00	66	<50	<0.5	<0.5	<0.5	<0.5	--	0.7	<50
12/22/03 ¹⁰	82.17	17.44	64.73	0.00	94	<50	<0.5	<0.5	<0.5	<0.5	--	0.7	<50
03/22/04 ¹⁰	82.17	16.07	66.10	0.00	<50	<50	<0.5	<0.5	<0.5	<0.5	--	0.7	<50
06/21/04 ¹⁰	82.17	17.38	64.79	0.00	80	<50	<0.5	<0.5	<0.5	<0.5	--	1	<50
09/20/04 ¹⁰	82.17	18.14	64.03	0.00	120	<50	<0.5	<0.5	<0.5	<0.5	--	1	<50
12/20/04 ¹⁰	82.17	17.15	65.02	0.00	74 ⁹	<50	<0.5	<0.5	<0.5	<0.5	--	2	<50
03/28/05 ¹⁰	82.17	15.47	66.70	0.00	84 ⁹	<50	<0.5	<0.5	<0.5	<0.5	--	3	<50
06/27/05 ¹⁰	82.17	16.41	65.76	0.00	140 ¹²	<50	<0.5	<0.5	<0.5	<0.5	--	3	<50
09/19/05 ¹⁰	82.17	17.42	64.75	0.00	<50	<50	<0.5	<0.5	<0.5	<0.5	--	5	<50
12/19/05 ¹⁰	82.17	17.93	64.24	0.00	52 ¹⁷	<50	<0.5	<0.5	<0.5	<0.5	--	5	<50
03/27/06 ¹⁰	82.17	13.75	68.42	0.00	<50	<50	<0.5	<0.5	<0.5	<0.5	--	7	<50
06/26/06 ¹⁰	82.17	15.90	66.27	0.00	110	<50	<0.5	<0.5	<0.5	<0.5	--	9	<50
09/25/06 ¹⁰	82.17	17.27	64.90	0.00	57	<50	<0.5	<0.5	<0.5	<0.5	--	8	<50
12/18/06 ¹⁰	82.17	16.67	65.50	0.00	220	<50	<0.5	<0.5	<0.5	<0.5	--	7	<50
03/19/07 ¹⁰	82.17	16.16	66.01	0.00	210	<50	<0.5	<0.5	<0.5	<0.5	--	9	<50
06/25/07 ¹⁰	82.17	23.84	58.33	0.00	74	<50	<0.5	<0.5	<0.5	<0.5	--	6	<50
09/24/07 ¹⁰	82.17	25.68	56.49	0.00	280	<50	<0.5	<0.5	<0.5	<0.5	--	2	<50
12/18/07	82.17	INACCESSIBLE - WELL UNDER WATER				--	--	--	--	--	--	--	--
03/11/08 ¹⁰	82.17	24.07	58.10	0.00	<50	<50	<0.5	<0.5	<0.5	<0.5	--	<0.5	<50
MW-10													
10/10/96	81.83	18.40	63.43	--	<50	<50	<0.5	<0.5	<0.5	<0.5	<5.0	--	--
11/07/96	81.83	18.43	63.40	--	--	--	--	--	--	--	--	--	--
12/18/97	81.83	16.18	65.65	--	<50	350	6.9	0.87	0.88	0.77	<30	--	--
04/06/98	81.83	14.39	67.44	--	<50	2,300	224	168	81.4	253	<30	--	--
06/18/98	81.83	15.11	66.72	--	320	7,200	310	210	83	280	<0.5	--	--
08/31/98	81.83	17.03	64.80	--	120	460	51	8.2	5.1	10	<5.0	--	--
12/21/98	81.83	17.32	64.51	--	79	120	5.5	<1.0	<1.0	<1.0	8.7	<2.0	--
03/24/99	81.83	15.25	66.58	--	923	1,330	85.9	42.9	29.7	95.2	20.4	<25.0	--
06/25/99	81.83	16.82	65.01	--	167	1,130	115	32.6	17.2	36.3	<4.00	--	--
09/24/99	81.83	17.75	64.08	--	76.7	382	20.0	<1.00	2.21	1.37	8.83	--	--
12/29/99	81.83	18.13	63.70	--	107	114	9.03	<0.500	0.531	<0.500	<5.00	--	--
03/21/00	81.83	14.22	67.61	--	194	1,270	86.3	52.3	38.1	102	19.5	--	--

Table 1
Groundwater Monitoring Data and Analytical Results
Former Texaco Service Station (Site #211283)
3810 Broadway
Oakland, California

WELL ID/ DATE	TOC* (ft.)	DTW (ft.)	GWE (msl)	SPHT (ft.)	TPH-D (ppb)	TPH-G (ppb)	B (ppb)	T (ppb)	E (ppb)	X (ppb)	MTBE by 8021♦ (ppb)	MTBE by 8260 (ppb)	ETHANOL (ppb)	
MW-10 (cont)														
07/26/00	81.83	16.61	65.22	--	192	562	74.8	7.51	24.3	14.8	13.3	<1.00 ^d	--	
09/06/00	81.83	17.08	64.75	--	205	606	93.4	5.36	16.7	38.9	--	--	--	
11/29/00	82.16	16.90	65.26	--	258	583	40.0	1.46	4.69	15.8	--	--	--	
03/06/01	82.16	14.80	67.36	--	199	837	34.2	26.4	20.8	27.5	--	--	--	
06/19/01 ⁶	82.16	16.85	65.31	--	<50	400	47	2.6	8.8	17	--	0.60	--	
09/05/01 ⁶	82.16	17.87	64.29	--	<100	230	20	<0.50	1.2	5.3	--	<5.0	--	
12/20/01 ⁶	82.16	15.54	66.62	--	110	300	13	2.5	1.7	4.6	--	<5.0	--	
06/25/02	81.83	16.93	64.90	0.00	180	810	180	3.2	17	8.0	<2.5	--	--	
09/18/02	81.83	17.68	64.15	0.00	200	260	24	<2.0	2.5	5.0	2.9	--	--	
12/19/02	81.83	16.36	65.47	0.00	86	360	25	0.60	<0.50	1.5	<5.0	--	--	
03/20/03	81.83	16.32	65.51	0.00	200	620	21	5.3	6.0	13	<10	--	--	
06/23/03 ¹⁰	81.83	16.57	65.26	0.00	290	1,500	170	23	40	93	--	0.7	--	
09/22/03 ¹⁰	81.83	17.60	64.23	0.00	180	480	48	3	7	17	--	0.8	<50	
12/22/03 ¹⁰	81.83	17.31	64.52	0.00	120	230	7	<0.5	<0.5	1	--	0.9	<50	
03/22/04 ¹⁰	81.83	15.58	66.25	0.00	230	1,500	72	26	30	82	--	0.7	<50	
06/21/04 ¹⁰	81.83	17.12	64.71	0.00	220	1,000	120	29	47	73	--	2	<50	
09/20/04 ¹⁰	81.83	18.12	63.71	0.00	230	470	36	5	6	20	--	2	<50	
12/20/04 ¹⁰	81.83	17.01	64.82	0.00	170 ⁹	480	13	2	1	7	--	2	<50	
03/28/05 ¹⁰	81.83	14.64	67.19	0.00	450 ⁹	1,900	64	46	55	140	--	1	<50	
06/27/05 ¹⁰	81.83	15.99	65.84	0.00	400 ¹⁵	1,700	140	61	33	180	--	3	<50	
09/19/05 ¹⁰	81.83	17.35	64.48	0.00	170	1,200	98	35	58	110	--	5	<50	
12/19/05 ¹⁰	81.83	17.12	64.71	0.00	160 ¹⁴	1,000	61	23	20	47	--	5	<50	
03/27/06 ¹⁰	81.83	13.35	68.48	0.00	180	670	6	4	8	11	--	5	<50	
06/26/06 ¹⁰	81.83	15.10	66.73	0.00	580	4,700	220	110	150	390	--	0.8	<50	
09/25/06 ¹⁰	81.83	17.10	64.73	0.00	480	4,400	290	180	200	350	--	4	<50	
12/18/06 ¹⁰	81.83	16.75	65.08	0.00	2,900	2,500	270	97	97	170	--	1	<50	
03/19/07 ¹⁰	81.83	15.91	65.92	0.00	650	2,000	150	43	52	88	--	1	<50	
06/25/07 ¹⁰	81.83	24.41	57.42	0.00	7,600 ¹⁰	<50 ¹⁹	<0.5	<0.5	<0.5	<0.5	--	4	<50	
09/24/07 ¹⁰	81.83	25.96	55.87	0.00	8,400	88	<0.5	<0.5	<0.5	<0.5	--	2	<50	
12/18/07	81.83	INACCESSIBLE - WELL UNDER WATER					--	--	--	--	--	--	--	--
03/11/08¹⁰	81.83	24.56	57.27	0.00	1,200	190	1	<0.5	<0.5	<0.5	--	2	<50	

Table 1
Groundwater Monitoring Data and Analytical Results
Former Texaco Service Station (Site #211283)
3810 Broadway
Oakland, California

WELL ID/ DATE	TOC* (ft.)	DTW (ft.)	GWE (msl)	SPHT (ft.)	TPH-D (ppb)	TPH-G (ppb)	B (ppb)	T (ppb)	E (ppb)	X (ppb)	MTBE by	MTBE by	ETHANOL (ppb)
											8021♦ (ppb)	8260 (ppb)	
MW-11													
08/08/00	--	25.61	--	--	--	--	--	--	--	--	--	--	--
08/16/00	--	25.50	--	--	56.80	<50.0	<0.500	<0.500	<0.500	<0.500	--	--	--
09/06/00	--	25.90	--	--	-- ⁵	<50.0	<0.500	<0.500	<0.500	<0.500	--	--	--
11/29/00	90.63	25.80	64.83	--	63.8	<50.0	<0.500	<0.500	<0.500	<0.500	--	--	--
03/06/01	90.63	23.32	67.31	--	<50.0	<50.0	<0.500	<0.500	<0.500	<0.500	--	--	--
06/19/01 ⁶	90.63	25.57	65.06	--	<50	<50	<0.50	<0.50	<0.50	<0.50	--	<0.50	--
09/05/01 ⁶	90.63	26.42	64.21	--	<50	<50	<0.50	<0.50	<0.50	0.68	--	<5.0	--
12/20/01 ⁶	90.63	24.27	66.36	--	<50	<50	<0.50	<0.50	<0.50	<0.50	--	<5.0	--
06/25/02	-- ⁸	25.51	-- ⁸	0.00	<50	<50	<0.50	<0.50	<0.50	<1.5	<2.5	--	--
09/18/02	-- ⁸	26.31	-- ⁸	0.00	80	<50	<0.50	<0.50	<0.50	<1.5	<2.5	--	--
12/19/02	-- ⁸	25.08	-- ⁸	0.00	<50	<50	<0.50	<0.50	<0.50	<1.5	<2.5	--	--
03/20/03	-- ⁸	24.87	-- ⁸	0.00	<50	<50	<0.50	0.51	<0.50	<1.5	<2.5	--	--
06/23/03 ¹⁰	-- ⁸	25.21	-- ⁸	0.00	140	<50	<0.5	<0.5	<0.5	<0.5	--	<0.5	--
09/22/03 ¹⁰	-- ⁸	26.26	-- ⁸	0.00	52	<50	<0.5	<0.5	<0.5	<0.5	--	1	<50
12/22/03 ¹⁰	-- ⁸	25.97	-- ⁸	0.00	69	<50	<0.5	<0.5	<0.5	<0.5	--	2	<50
03/22/04 ¹⁰	-- ⁸	24.13	-- ⁸	0.00	<50	<50	<0.5	<0.5	<0.5	<0.5	--	<0.5	<50
06/21/04 ¹⁰	-- ⁸	25.74	-- ⁸	0.00	79	<50	<0.5	<0.5	<0.5	<0.5	--	<0.5	<50
09/20/04 ¹⁰	-- ⁸	26.83	-- ⁸	0.00	140	<50	<0.5	<0.5	<0.5	<0.5	--	4	<50
12/20/04 ¹⁰	-- ⁸	25.67	-- ⁸	0.00	54 ⁹	<50	<0.5	<0.5	<0.5	<0.5	--	3	<50
03/28/05 ¹⁰	-- ⁸	23.03	-- ⁸	0.00	58 ⁹	<50	<0.5	<0.5	<0.5	<0.5	--	<0.5	<50
06/27/05 ¹⁰	-- ⁸	24.61	-- ⁸	0.00	<50	<50	<0.5	<0.5	<0.5	<0.5	--	0.6	<50
09/19/05 ¹⁰	-- ⁸	25.98	-- ⁸	0.00	<50	<50	<0.5	<0.5	<0.5	<0.5	--	2	<50
12/19/05 ¹⁰	-- ⁸	25.93	-- ⁸	0.00	<50	<50	<0.5	<0.5	<0.5	<0.5	--	2	<50
03/27/06 ¹⁰	-- ⁸	21.81	-- ⁸	0.00	<50	<50	<0.5	<0.5	<0.5	<0.5	--	<0.5	<50
06/26/06 ¹⁰	-- ⁸	24.00	-- ⁸	0.00	64	<50	<0.5	<0.5	<0.5	<0.5	--	<0.5	<50
09/25/06 ¹⁰	-- ⁸	25.75	-- ⁸	0.00	<50	<50	<0.5	<0.5	<0.5	<0.5	--	<0.5	<50
12/18/06 ¹⁰	-- ⁸	25.55	-- ⁸	0.00	140	<50	<0.5	<0.5	<0.5	<0.5	--	<0.5	<50
03/19/07 ¹⁰	-- ⁸	24.58	-- ⁸	0.00	63	<50	<0.5	<0.5	<0.5	<0.5	--	<0.5	<50
06/25/07 ¹⁰	-- ⁸	32.81	-- ⁸	0.00	130	<50	<0.5	<0.5	<0.5	<0.5	--	1	<50
09/24/07 ¹⁰	-- ⁸	34.24	-- ⁸	0.00	110	<50	<0.5	<0.5	<0.5	<0.5	--	2	<50
12/18/07 ¹⁰	-- ⁸	33.52	-- ⁸	0.00	90	<50	<0.5	<0.5	<0.5	<0.5	--	2	<50
03/11/08 ^{fn}	-- ⁸	32.55	-- ⁸	0.00	52	<50	<0.5	<0.5	<0.5	<0.5	--	<0.5	<50

Table 1
Groundwater Monitoring Data and Analytical Results
Former Texaco Service Station (Site #211283)
3810 Broadway
Oakland, California

WELL ID/ DATE	TOC* (ft.)	DTW (ft.)	GWE (msl)	SPHT (ft.)	TPH-D (ppb)	TPH-G (ppb)	B (ppb)	T (ppb)	E (ppb)	X (ppb)	MTBE by 8021♦ (ppb)	MTBE by 8260 (ppb)	ETHANOL (ppb)
MW-12													
06/25/02 ⁷	84.19	18.65	65.54	0.00	410	1,000	340	8.2	16	8.3	11	--	--
09/18/02	84.19	19.67	64.52	0.00	230	130	52	<0.50	<0.50	<1.5	9.8	--	--
12/19/02	84.19	18.67	65.52	0.00	450	<50	11	<0.50	<0.50	<1.5	<2.5	--	--
03/20/03	84.19	17.97	66.22	0.00	300	280	120	1.9	11	<1.5	2.6	--	--
06/23/03 ¹⁰	84.19	18.27	65.92	0.00	400	400	130	4	1	0.7	--	14	--
09/22/03 ¹⁰	84.19	19.52	64.67	0.00	270	<50	9	<0.5	<0.5	<0.5	--	9	<50
12/22/03 ¹⁰	84.19	19.75	64.44	0.00	130	720	130	29	10	46	--	2	<50
03/22/04 ¹⁰	84.19	17.06	67.13	0.00	240	<50	3	<0.5	<0.5	1	--	0.5	<50
06/21/04 ¹⁰	84.19	18.82	65.37	0.00	350	140	43	<0.5	<0.5	<0.5	--	8	<50
09/20/04 ¹⁰	84.19	19.99	64.20	0.00	340	<50	<0.5	<0.5	<0.5	<0.5	--	2	<50
12/20/04 ¹⁰	84.19	19.46	64.73	0.00	160 ⁹	1,300	400	28	31	31	--	1	<50
03/28/05 ¹⁰	84.19	16.42	67.77	0.00	440 ⁹	90	24	<0.5	<0.5	<0.5	--	1	<50
06/27/05 ¹⁰	84.19	17.53	66.66	0.00	170 ¹³	<50	<0.5	<0.5	<0.5	<0.5	--	1	<50
09/19/05 ¹⁰	84.19	19.04	65.15	0.00	190	<50	<0.5	<0.5	<0.5	<0.5	--	3	<50
12/19/05 ¹⁰	84.19	19.41	64.78	0.00	340 ¹³	330	94	5	1	3	--	2	<50
03/27/06 ¹⁰	84.19	15.45	68.74	0.00	140	130	33	0.7	1	4	--	0.8	<50
06/26/06 ¹⁰	84.19	16.70	67.49	0.00	220	<50	<0.5	<0.5	<0.5	<0.5	--	<0.5	<50
09/25/06 ¹⁰	84.19	18.81	65.38	0.00	200	<50	<0.5	<0.5	<0.5	<0.5	--	<0.5	<50
12/18/06 ¹⁰	84.19	18.94	65.25	0.00	410	240	68	5	1	1	--	1	<50
03/19/07 ¹⁰	84.19	17.83	66.36	0.00	200	55	7	<0.5	<0.5	<0.5	--	2	<50
06/25/07 ¹⁰	84.19	25.80	58.39	0.00	1,600 ¹⁰	5,500 ¹⁰	1,000 ¹⁰	190 ¹⁰	170 ¹⁰	320 ¹⁰	--	2	<100
09/24/07 ¹⁰	84.19	27.88	56.31	0.00	2,300	<50	0.7	<0.5	<0.5	<0.5	--	1	<50
12/18/07 ¹⁰	84.19	27.06	57.13	0.00	550	230	17	<0.5	<0.5	<0.5	--	<0.5	<50
03/11/08¹⁰	84.19	25.60	58.59	0.00	1,100	7,000	960	330	410	860	--	<1	<100
MW-2													
06/28/96	85.83	22.10	63.73	1.35	--	--	--	--	--	--	--	--	--
10/10/96	85.83	22.36	63.47	--	1,800	99,000	4,100	9,400	2,300	9,900	390	<25 ¹	--
11/07/96	85.83	22.39	63.45**	0.01	--	--	--	--	--	--	--	--	--
12/18/97	85.83	20.19	65.64	--	4,700	24,000	600	1,800	750	2,400	<2,000	--	--
04/06/98	85.83	18.00	67.83	--	9.5	20,100	252	448	430	1,410	<200	--	--
06/18/98	85.83	19.63	66.20	--	5,200	20,000	240	370	270	790	<50	--	--
08/31/98	85.83	21.01	64.82	--	19,000	72,000	270	990	630	1,700	<125	--	--

Table 1
Groundwater Monitoring Data and Analytical Results
Former Texaco Service Station (Site #211283)
3810 Broadway
Oakland, California

WELL ID/ DATE	TOC* (ft.)	DTW (ft.)	GWE (msl)	SPHT (ft.)	TPH-D (ppb)	TPH-G (ppb)	B (ppb)	T (ppb)	E (ppb)	X (ppb)	MTBE by	MTBE by	ETHANOL (ppb)
											8021♦ (ppb)	8260 (ppb)	
MW-2 (cont)													
12/21/98	85.83	21.31	64.52	--	13,000	290	8.7	18	9.7	38	10	29	--
03/24/99	85.83	19.18	66.65	--	5,590	80,400	651	1,860	1,120	3,730	<40.0	<100	--
06/25/99	85.83	20.78	65.05	--	12,100	34,700	504	1,300	716	2,160	<40.0	--	--
09/24/99	85.83	21.82	64.01	--	108	6,510	1,030	350	183	680	<50.0	--	--
12/29/99	85.83	22.17	63.90**	0.30	--	--	--	--	--	--	--	--	--
01/07/00	85.83	22.84	63.30**	0.39	--	--	--	--	--	--	--	--	--
03/21/00	-- ³	18.19	--	--	41,100	54,100	1,260	3,320	2,180	8,200	<1,250	--	--
DESTROYED													
MW-3													
06/28/96	83.18	19.04	64.14	--	--	--	--	--	--	--	--	--	--
10/10/96	83.18	19.51	63.67	--	1,200	110,000	6,600	16,000	2,200	12,000	<250	--	--
11/07/96	83.18	19.40	63.78	--	--	--	--	--	--	--	--	--	--
12/18/97	83.18	18.79	64.39	--	6,100,000	180,000	1,500	16,000	4,600	23,000	<3,000	--	--
04/06/98	83.18	16.58	66.64	0.05	--	--	--	--	--	--	--	--	--
06/18/98	83.18	--	--	>2.0 ²	--	--	--	--	--	--	--	--	--
08/31/98	83.18	19.56	63.68	0.07	--	--	--	--	--	--	--	--	--
12/21/98	83.18	20.23	65.13	2.73	--	--	--	--	--	--	--	--	--
03/24/99	83.18	16.76	67.11	0.86	--	--	--	--	--	--	--	--	--
06/25/99	83.18	18.47	64.95	0.30	--	--	--	--	--	--	--	--	--
09/24/99	83.18	19.43	63.81	0.08	--	--	--	--	--	--	--	--	--
12/29/99	83.18	19.25	63.96	0.04	--	--	--	--	--	--	--	--	--
01/07/00	83.18	19.87	63.37	0.07	--	--	--	--	--	--	--	--	--
DESTROYED													
MW-5													
10/10/96	85.41	21.93	63.48	--	<50	1,800	34	4.7	11	44	21	5.0 ¹	--
11/07/96	85.41	21.96	63.45	--	--	--	--	--	--	--	--	--	--
12/18/97	85.41	19.81	65.60	--	<50	1,200	15	<1.0	15	<1.0	72	--	--
04/06/98	85.41	17.43	67.98	--	<50	1,000	126	0.5	0.8	1.5	<30	--	--
06/18/98	85.41	19.15	66.26	--	100	110	6.9	<0.5	<0.5	<0.5	<0.5	--	--
08/31/98	85.41	20.46	64.95	--	120	480	5.3	<2.5	<2.5	<2.5	<12	--	--

Table 1
Groundwater Monitoring Data and Analytical Results
Former Texaco Service Station (Site #211283)
3810 Broadway
Oakland, California

WELL ID/ DATE	TOC* (ft.)	DTW (ft.)	GWE (msl)	SPHT (ft.)	TPH-D (ppb)	TPH-G (ppb)	B (ppb)	T (ppb)	E (ppb)	X (ppb)	MTBE by 8021♦ (ppb)	MTBE by 8260 (ppb)	ETHANOL (ppb)
MW-5 (cont)													
12/21/98	85.41	20.91	64.50	--	100	270	16	2.9	1.3	<1.0	34	<2.0	--
03/24/99	85.41	18.74	66.67	--	93.3	143	2.80	<0.500	0.749	<0.500	<2.00	<5.00	--
06/25/99	85.41	20.31	65.10	--	125	847	6.61	<0.500	0.611	<0.500	2.69	<2.00	--
09/24/99	85.41	21.36	64.05	--	94.0	563	6.00	<2.50	<2.50	<2.50	25.1	--	--
12/29/99	85.41	21.41	64.00	--	173	896	16.6	1.48	8.92	2.67	61.1	<0.500	--
03/21/00	85.41	18.13	67.28	--	158	858	53.7	<1.00	21.4	8.00	11.6	--	--
07/26/00	85.41	OBSTRUCTION IN WELL		--	--	--	--	--	--	--	--	--	--
09/06/00	85.41	20.33	65.08	--	231	670	153	<2.50	7.87	<2.50	--	--	--
11/29/00	85.13	OBSTRUCTION IN WELL		--	--	--	--	--	--	--	--	--	--
03/06/01	85.13	OBSTRUCTION IN WELL		--	--	--	--	--	--	--	--	--	--
06/19/01	85.13	OBSTRUCTION IN WELL		--	--	--	--	--	--	--	--	--	--
09/05/01	85.13	OBSTRUCTION IN WELL		--	--	--	--	--	--	--	--	--	--
12/02/01	85.13	OBSTRUCTION IN WELL		--	--	--	--	--	--	--	--	--	--
DESTROYED													
MW-8													
10/10/96	84.01	20.82	63.19	--	110	17,000	1,300	1,200	64	1,300	110	<5.0 ^l	--
11/07/96	84.01	20.44	63.57	--	--	--	--	--	--	--	--	--	--
12/18/97	84.01	19.36	64.65	--	630	15,000	3,600	1,800	410	930	<600	--	--
04/06/98	84.01	16.19	67.82	--	<50	32,300	8,230	5,900	718	2,120	<1,000	--	--
06/18/98	84.01	17.75	66.26	--	<50	74,000	5,400	4,500	700	2,200	2,400	--	--
08/31/98	84.01	INACCESSIBLE		--	--	--	--	--	--	--	--	--	--
12/21/98	84.01	19.48	64.53	--	1,200	9,600	2,600	410	220	300	700	<2.0	--
03/24/99	84.01	17.44	66.57	--	2,890	86,100	9,890	11,700	1,650	7,130	<200	<250	--
06/25/99	84.01	20.69	63.40**	0.10	--	--	--	--	--	--	--	--	--
07/01/99	84.01	20.45	65.07**	1.89	--	--	--	--	--	--	--	--	--
09/24/99	84.01	20.98	64.25**	1.53	--	--	--	--	--	--	--	--	--
12/29/99	84.01	20.25	63.97**	0.26	--	--	--	--	--	--	--	--	--
01/07/00	84.01	21.00	63.33**	0.40	--	--	--	--	--	--	--	--	--
DESTROYED													

Table 1
Groundwater Monitoring Data and Analytical Results
Former Texaco Service Station (Site #211283)
3810 Broadway
Oakland, California

WELL ID/ DATE	TOC* (ft.)	DTW (ft.)	GWE (msl)	SPHT (ft.)	TPH-D (ppb)	TPH-G (ppb)	B (ppb)	T (ppb)	E (ppb)	X (ppb)	MTBE by 8021♦ (ppb)	MTBE by 8260 (ppb)	ETHANOL (ppb)
TRIP BLANK													
QA													
06/25/02	--	--	--	--	--	<50	<0.50	<0.50	<0.50	<1.5	<2.5	--	--
09/18/02	--	--	--	--	--	<50	<0.50	<0.50	<0.50	<1.5	<2.5	--	--
12/19/02	--	--	--	--	--	<50	<0.50	<0.50	<0.50	<1.5	<2.5	--	--
03/20/03	--	--	--	--	--	<50	<0.50	<0.50	<0.50	<1.5	<2.5	--	--
06/23/03 ¹⁰	--	--	--	--	--	<50	<0.5	<0.5	<0.5	<0.5	--	<0.5	--
09/22/03 ¹⁰	--	--	--	--	--	<50	<0.5	<0.5	<0.5	<0.5	--	<0.5	--
12/22/03 ¹⁰	--	--	--	--	--	<50	<0.5	<0.5	<0.5	<0.5	--	<0.5	--
03/22/04 ¹⁰	--	--	--	--	--	<50	<0.5	<0.5	<0.5	<0.5	--	<0.5	--
06/21/04 ¹⁰	--	--	--	--	--	<50	<0.5	<0.5	<0.5	<0.5	--	<0.5	--
09/20/04 ¹⁰	--	--	--	--	--	<50	<0.5	<0.5	<0.5	<0.5	--	<0.5	--
12/20/04 ¹⁰	--	--	--	--	--	<50	<0.5	<0.5	<0.5	<0.5	--	<0.5	--
03/28/05 ¹⁰	--	--	--	--	--	<50	<0.5	<0.5	<0.5	<0.5	--	<0.5	--
06/27/05 ¹⁰	--	--	--	--	--	<50	<0.5	<0.5	<0.5	<0.5	--	<0.5	--
09/19/05 ¹⁰	--	--	--	--	--	<50	<0.5	<0.5	<0.5	<0.5	--	<0.5	--
12/19/05 ¹⁰	--	--	--	--	--	<50	<0.5	<0.5	<0.5	<0.5	--	<0.5	--
03/27/06 ¹⁰	--	--	--	--	--	<50	<0.5	<0.5	<0.5	<0.5	--	<0.5	--
06/26/06 ¹⁰	--	--	--	--	--	<50	<0.5	<0.5	<0.5	<0.5	--	<0.5	--
09/25/06 ¹⁰	--	--	--	--	--	<50	<0.5	<0.5	<0.5	<0.5	--	<0.5	--
12/18/06 ¹⁰	--	--	--	--	--	<50	<0.5	<0.5	<0.5	<0.5	--	<0.5	--
03/19/07 ¹⁰	--	--	--	--	--	<50	<0.5	<0.5	<0.5	<0.5	--	<0.5	--
06/25/07 ¹⁰	--	--	--	--	--	<50	<0.5	<0.5	<0.5	<0.5	--	<0.5	--
09/24/07 ¹⁰	--	--	--	--	--	<50	<0.5	<0.5	<0.5	<0.5	--	<0.5	--
12/18/07 ¹⁰	--	--	--	--	--	<50	<0.5	<0.5	<0.5	<0.5	--	<0.5	--
03/11/08 ¹⁰	--	--	--	--	--	<50	<0.5	<0.5	<0.5	<0.5	--	<0.5	--

Table 1
Groundwater Monitoring Data and Analytical Results
Former Texaco Service Station (Site #211283)
3810 Broadway
Oakland, California

EXPLANATIONS:

Groundwater monitoring data and laboratory analytical results prior to June 25, 2002, were compiled from reports prepared by Toxicchem Management Systems, Inc.

TOC = Top of Casing	SPHT = Separate-phase hydrocarbon thickness	X = Xylenes
(ft.) = Feet	TPH-D = Total Petroleum Hydrocarbons as Diesel	MTBE = Methyl tertiary butyl ether
DTW = Depth to Water	TPH-G = Total Petroleum Hydrocarbons as Gasoline	(ppb) = Parts per billion
GWE = Groundwater Elevation	B = Benzene	-- = Not Measured/Not Analyzed
(msl) = Mean Sea Level	T = Toluene	QA = Quality Assurance/Trip Blank
SPH = Separate-phase hydrocarbons	E = Ethylbenzene	NP= No Purge

* TOC elevations were surveyed June 24, 2002, by Morrow Surveying, and are based on City of Oakland Benchmark.

** GWE corrected for the presence of SPH; correction factor = [(TOC - DTW)+(0.80 x SPHT)].

◆ Prior to June 25, 2002, MTBE was analyzed by EPA Method 8020.

¹ MTBE confirmed by EPA Method 8240.

² Free product could not be accurately measured.

³ TOC altered.

⁴ Analyzed outside EPA recommended hold time.

⁵ Sample containers broken during transport to laboratory.

⁶ TPH-G and BTEX analyzed by EPA Method 8260.

⁷ Well development performed.

⁸ MW-11 was inaccessible during the re-surveying. TOC was not measured.

⁹ Laboratory report indicates the observed sample pattern is not typical of diesel/#2 fuel oil.

¹⁰ BTEX analyzed by EPA Method 8260.

¹¹ Ethanol was previously reported as <50 ppb.

¹² Laboratory report indicates the observed sample pattern is not typical of #2 fuel/diesel. It elutes in the DRO range later than #2 fuel.

¹³ Laboratory report indicates the observed sample pattern includes #2fuel/diesel and an additional pattern which elutes later in the DRO range.

¹⁴ Laboratory report indicates the observed sample pattern is not typical of #2fuel/diesel. It elutes in the DRO range earlier than #2 fuel.

¹⁵ Laboratory report indicates the observed sample patterns are not typical of #2fuel/diesel. They elute in the DRO range earlier and later than #2 fuel.

¹⁶ Laboratory report indicates the observed sample pattern is not typical of #2 fuel/diesel. It elutes in the DRO range later than #2 fuel and contains individual peaks eluting in the DRO range.

¹⁷ Laboratory report indicates the observed sample pattern is not typical of #2 fuel/diesel. The reported result is due to an individual peak (s) eluting in the DRO range.

¹⁸ No purge due to bent casing.

¹⁹ Laboratory confirmed analytical result.

Table 2
Field Measurements
Former Texaco Service Station (Site #211283)
3810 Broadway
Oakland, California

WELL ID	DATE	D.O.	ORP	D.O.	ORP	D.O.	ORP
		Before Purging (mg/L)	Before Purging (mV)	Mid-Purging (mg/L)	Mid-Purging (mV)	After Purging (mg/L)	After Purging (mV)
MW-6	09/24/99	1.00	--	--	--	1.20	--
	12/29/99	1.30	--	--	--	1.50	--
	03/21/00	3.00	--	--	--	4.30	--
	11/29/00	2.00	--	--	--	1.80	--
	03/06/01	3.70	--	--	--	4.00	--
	06/19/01	3.00	--	--	--	3.40	--
	09/05/01	10.40	--	--	--	10.80	--
	12/20/01	1.30	--	--	--	1.50	--
	06/25/02	1.00	--	0.60	--	0.40	--
	09/18/02	0.60	58	0.90	69	1.00	72
	12/19/02	1.20	71	--	--	1.10	79
	03/20/03	0.40	-93	--	--	1.60	-87
	06/23/03	0.90	64	--	--	1.20	78
	09/22/03	1.10	70	--	--	1.30	76
	12/22/03	0.90	68	--	--	1.00	70
	03/22/04	1.00	74	--	--	1.20	82
	06/21/04	1.10	72	--	--	1.10	86
	09/20/04	1.20	68	--	--	1.30	76
	12/20/04	1.00	71	--	--	1.10	80
	03/28/05	1.10	75	--	--	1.10	86
	06/27/05	1.10	78	--	--	1.20	90
	09/19/05	2.90	-- ¹	--	--	1.20	-- ¹
	12/19/05	1.00	69	--	--	1.00	74
	03/27/06	1.60	89	--	--	1.20	75
	06/26/06	1.40	105	--	--	1.20	82
	09/25/06	1.20	103	--	--	1.30	91
	12/18/06	1.20	87	--	--	-- ²	-- ²
	03/19/07	1.9	-57	--	--	1.6	-63
	06/25/07	DRY	--	--	--	--	--
	09/24/07	DRY	--	--	--	--	--
12/18/07	DRY	--	--	--	--	--	
03/11/08	DRY	--	--	--	--	--	
MW-7	09/24/99	1.40	--	--	--	1.60	--
	12/29/99	2.30	--	--	--	1.80	--
	03/21/00	5.80	--	--	--	9.00	--
	07/26/00	6.00	--	--	--	6.60	--
	09/06/00	4.30	--	--	--	5.00	--
	11/29/00	4.00	--	--	--	3.70	--
	03/06/01	4.70	--	--	--	5.10	--
	06/19/01	3.80	--	--	--	4.20	--
	09/05/01	6.70	--	--	--	7.10	--
	12/20/01	4.90	--	--	--	5.00	--
	06/25/02	1.00	--	1.40	--	1.30	--
	09/18/02	1.80	112	1.90	98	2.10	102
	12/19/02	1.30	121	--	--	1.60	110
	03/20/03	2.60	129	--	--	2.70	152
	06/23/03	1.70	122	--	--	1.90	140
09/22/03	1.40	92	--	--	1.70	124	
12/22/03	1.50	98	--	--	1.60	114	

Table 2
Field Measurements
Former Texaco Service Station (Site #211283)
3810 Broadway
Oakland, California

WELL ID	DATE	D.O.	ORP	D.O.	ORP	D.O.	ORP
		Before Purging (mg/L)	Before Purging (mV)	Mid-Purging (mg/L)	Mid-Purging (mV)	After Purging (mg/L)	After Purging (mV)
MW-7 (cont)	03/22/04	1.30	90	--	--	1.50	96
	06/21/04	1.50	106	--	--	1.70	126
	09/20/04	1.40	115	--	--	0.96	110
	12/20/04	1.30	88	--	--	1.40	95
	03/28/05	1.40	92	--	--	1.40	88
	06/27/05	1.50	106	--	--	1.40	94
	09/19/05	3.70	17	--	--	3.10	29
	12/19/05	1.40	85	--	--	1.30	90
	03/27/06	1.80	126	--	--	2.10	132
	06/26/06	1.60	119	--	--	1.80	121
	09/25/06	1.70	125	--	--	1.60	124
	12/18/06	1.40	130	--	--	-- ²	-- ²
	03/19/07	2.8	-10	--	--	2.3	-13
	06/25/07	1.8	119	--	--	1.5	98
	09/24/07	1.7	1.3	--	--	94	76
	12/18/07	2.1	68	--	--	1.8	73
	03/11/08	1.8	93	--	--	1.7	104
	MW-9	09/24/99	1.00	--	--	--	1.20
12/29/99		3.30	--	--	--	2.70	--
03/21/00		3.20	--	--	--	7.30	--
07/26/00		3.60	--	--	--	1.80	--
09/06/00		3.80	--	--	--	4.00	--
11/29/00		2.00	--	--	--	2.00	--
03/06/01		4.00	--	--	--	4.90	--
06/19/01		3.40	--	--	--	4.00	--
09/05/01		2.70	--	--	--	2.00	--
12/20/01		2.20	--	--	--	2.20	--
06/25/02		0.90	--	1.00	--	1.20	--
09/18/02		1.40	138	1.00	110	0.90	95
12/19/02		1.80	126	--	--	1.10	98
03/20/03		0.10	206	--	--	1.10	193
06/23/03		1.20	146	--	--	1.00	138
09/22/03		1.10	126	--	--	1.00	130
12/22/03		1.30	134	--	--	1.20	142
03/22/04		3.70	120	--	--	1.40	126
06/21/04		3.50	108	--	--	1.20	116
09/20/04		2.70	54	--	--	1.10	62
12/20/04		2.50	72	--	--	1.40	80
03/28/05		2.80	92	--	--	1.70	68
06/27/05		2.60	82	--	--	1.50	62
09/19/05		1.00	-38	--	--	0.60	-30
12/19/05		2.10	76	--	--	2.20	68
03/27/06		2.20	136	--	--	1.90	125
06/26/06		2.40	122	--	--	2.00	115
09/25/06	2.10	116	--	--	1.90	120	
12/18/06	1.80	131	--	--	-- ²	-- ²	

Table 2
Field Measurements
Former Texaco Service Station (Site #211283)
3810 Broadway
Oakland, California

WELL ID	DATE	D.O.	ORP	D.O.	ORP	D.O.	ORP	
		Before Purging (mg/L)	Before Purging (mV)	Mid-Purging (mg/L)	Mid-Purging (mV)	After Purging (mg/L)	After Purging (mV)	
MW-9	03/19/07	1.7	-03	--	--	2.1	-11	
(cont)	06/25/07	2.2	11	--	--	2.0	73	
	09/24/07	2.4	2.2	--	--	93	75	
	12/18/07	INACCESSIBLE - WELL UNDER WATER				--	--	--
	03/11/08	2.2	76	--	--	1.9	63	
MW-10	09/19/05	1.40	-97	--	--	0.80	-98	
MW-2	09/24/99	1.00	--	--	--	0.80	--	
	12/29/99	2.60	--	--	--	--	--	
	03/21/00	3.30	--	--	--	3.60	--	
	DESTROYED							

Table 2
Field Measurements
Former Texaco Service Station (Site #211283)
3810 Broadway
Oakland, California

EXPLANATIONS:

Dissolved oxygen concentrations prior to June 25, 2002, were compiled from reports prepared by Toxichem Management Systems, Inc.

D.O. = Dissolved Oxygen

mg/L = milligrams per liter

ORP = Oxidation Reduction Potential

(mV) = Millivolts

-- = Not Measured

¹ ORP reading under range.

² Field technician inadvertently missed readings.

STANDARD OPERATING PROCEDURE - GROUNDWATER SAMPLING

Gettler-Ryan Inc. field personnel adhere to the following procedures for the collection and handling of groundwater samples prior to analysis by the analytical laboratory. Prior to sample collection, the type of analysis to be performed is determined. Loss prevention of volatile compounds is controlled and sample preservation for subsequent analysis is maintained.

Prior to well development, each well is monitored for the presence of free-phase hydrocarbons and the depth to water is recorded. Wells are then developed by alternately surging the well with the bailer, then purging the well with a pump to remove accumulated sediments and draw groundwater into the well. Development continues until the groundwater parameters (temperature, pH, and conductivity) have stabilized.

Prior to sampling, the presence or absence of free-phase hydrocarbons is determined using an interface probe. Product thickness, if present, is measured to the nearest 0.01 foot and is noted in the field notes. In addition, all depth to water level measurements are collected with a static water level indicator and are also recorded in the field notes, prior to purging and sampling any wells.

After water levels are collected and prior to sampling, if purging is to occur, each well is purged a minimum of three well casing volumes of water using pre-cleaned pumps (stack, suction, Grundfos), or disposable bailers. Temperature, pH and electrical conductivity are measured a minimum of three times during the purging. Purging continues until these parameters stabilize.

Groundwater samples are collected using disposable bailers. The water samples are transferred from the bailer into appropriate containers. Pre-preserved containers, supplied by analytical laboratories, are used when possible. When pre-preserved containers are not available, the laboratory is instructed to preserve the sample as appropriate. Duplicate samples are collected for the laboratory to use in maintaining quality assurance/quality control standards. The samples are labeled to include the job number, sample identification, collection date and time, analysis, preservation (if any), and the sample collector's initials. The water samples are placed in a cooler, maintained at 4°C for transport to the laboratory. Once collected in the field, all samples are maintained under chain of custody until delivered to the laboratory.

The chain of custody document includes the job number, type of preservation, if any, analysis requested, sample identification, date and time collected, and the sample collector's name. The chain of custody is signed and dated (including time of transfer) by each person who receives or surrenders the samples, beginning with the field personnel and ending with the laboratory personnel.

A laboratory supplied trip blank accompanies each sampling set. For sampling sets greater than 20 samples, 5% trip blanks are included. The trip blank is analyzed for some or all of the same compounds as the groundwater samples.

As requested by Chevron Environmental Management Company, the purge water and decontamination water generated during sampling activities is transported by IWM to Chemical Waste Management located in Kettleman Hill, California.



GETTLER-RYAN INC.

WELL MONITORING/SAMPLING FIELD DATA SHEET

Client/Facility#: Chevron #211283
 Site Address: 3810 Broadway
 City: Oakland, CA

Job Number: 386956
 Event Date: 3-11-08 (inclusive)
 Sampler: SH

Well ID: MW-1
 Well Diameter: 2 in.
 Total Depth: 29.89 ft.
 Depth to Water: 28.41 ft.
1.48 xVF = .17 = 0.25 x3 case volume = Estimated Purge Volume: 0.75 gal.

Date Monitored: 3-11-08

Volume	3/4"= 0.02	1"= 0.04	2"= 0.17	3"= 0.38
Factor (VF)	4"= 0.66	5"= 1.02	6"= 1.50	12"= 5.80

Check if water column is less than 0.50 ft.

Depth to Water w/ 80% Recharge [(Height of Water Column x 0.20) + DTW]: _____

- Purge Equipment:**
- Disposable Bailer _____
 - Stainless Steel Bailer _____
 - Stack Pump _____
 - Suction Pump _____
 - Grundfos _____
 - Peristaltic Pump _____
 - QED Bladder Pump _____
 - Other: _____

- Sampling Equipment:**
- Disposable Bailer _____
 - Pressure Bailer _____
 - Discrete Bailer _____
 - Peristaltic Pump _____
 - QED Bladder Pump _____
 - Other: _____

Time Started:	_____ (2400 hrs)
Time Completed:	_____ (2400 hrs)
Depth to Product:	_____ ft
Depth to Water:	_____ ft
Hydrocarbon Thickness:	_____ ft
Visual Confirmation/Description:	_____
Skimmer / Absorbant Sock (circle one)	
Amt Removed from Skimmer:	_____ gal
Amt Removed from Well:	_____ gal
Water Removed:	_____ gal
Product Transferred to:	_____

Start Time (purge): _____
 Sample Time/Date: 3-11-08
 Approx. Flow Rate: _____ gpm.
 Did well de-water? _____ If yes, Time: _____ Volume: _____ gal. DTW @ Sampling: _____

Weather Conditions: _____
 Water Color: _____ Odor: Y / N

Sediment Description: _____

Time (2400 hr.)	Volume (gal)	pH	Conductivity (umhos/cm - μS)	Temperature (C / F)	D.O. (mg/L)	ORP (mV)
_____	_____	_____	_____	_____	PRE: _____	PRE: _____
_____	_____	_____	_____	_____	POST: _____	POST: _____

LABORATORY INFORMATION

SAMPLE ID	(#) CONTAINER	REFRIG.	PRESERV. TYPE	LABORATORY	ANALYSES
MW-	x vov vial	YES	HCL	LANCASTER	TPH-G(8015)/BTEX+MTBE(8260)/ETHANOL (8260)
	x 500ml ambers	YES	NR	LANCASTER	TPH-D (8015)

COMMENTS: IW to sample. Casing bent ~ 5' down, unable to fit bailer in well. Attempted to collect sample with pin bailer. Unable to get water with pin due to silt

Add/Replaced Lock: _____ Add/Replaced Plug: _____ Add/Replaced Bolt: 2 (3/8")



GETTLER-RYAN INC.

WELL MONITORING/SAMPLING FIELD DATA SHEET

Client/Facility#: Chevron #211283
 Site Address: 3810 Broadway
 City: Oakland, CA

Job Number: 386956
 Event Date: 3-11-08 (inclusive)
 Sampler: SH

Well ID: MW-4
 Well Diameter: 2 in.
 Total Depth: 28.82 ft.
 Depth to Water: 25.15 ft.
3.67 xVF 1.17 = 0.62

Date Monitored: 3-11-08

Volume	3/4"= 0.02	1"= 0.04	2"= 0.17	3"= 0.38
Factor (VF)	4"= 0.66	5"= 1.02	6"= 1.50	12"= 5.80

Check if water column is less than 0.50 ft.

Depth to Water w/ 80% Recharge ((Height of Water Column x 0.20) + DTW): 25.89
 x3 case volume = Estimated Purge Volume: 2 gal.

Purge Equipment:
 Disposable Bailer X
 Stainless Steel Bailer _____
 Stack Pump _____
 Suction Pump _____
 Grundfos _____
 Peristaltic Pump _____
 QED Bladder Pump _____
 Other: _____

Sampling Equipment:
 Disposable Bailer X
 Pressure Bailer _____
 Discrete Bailer _____
 Peristaltic Pump _____
 QED Bladder Pump _____
 Other: _____

Time Started: _____ (2400 hrs)
 Time Completed: _____ (2400 hrs)
 Depth to Product: _____ ft
 Depth to Water: _____ ft
 Hydrocarbon Thickness: _____ ft
 Visual Confirmation/Description: _____
 Skimmer / Absorbent Sock (circle one)
 Amt Removed from Skimmer: _____ gal
 Amt Removed from Well: _____ gal
 Water Removed: _____
 Product Transferred to: _____

Start Time (purge): 1226 Weather Conditions: Clear
 Sample Time/Date: 1300 / 3-11-08 Water Color: Tan Odor: Y / N
 Approx. Flow Rate: _____ gpm. Sediment Description: heavy
 Did well de-water? no If yes, Time: _____ Volume: _____ gal. DTW @ Sampling: 25.62

Time (2400 hr.)	Volume (gal.)	pH	Conductivity (µmhos/cm - µS)	Temperature (C / F)	D.O. (mg/L)	ORP (mV)
<u>1230</u>	<u>1.0</u>	<u>7.18</u>	<u>336</u>	<u>18.4</u>	PRE: _____	PRE: _____
<u>1235</u>	<u>1.5</u>	<u>7.11</u>	<u>329</u>	<u>17.9</u>	_____	_____
<u>1241</u>	<u>2.0</u>	<u>7.09</u>	<u>317</u>	<u>17.8</u>	POST: _____	POST: _____

LABORATORY INFORMATION

SAMPLE ID	(#) CONTAINER	REFRIG.	PRESERV. TYPE	LABORATORY	ANALYSES
MW-4	6 x vov vial	YES	HCL	LANCASTER	TPH-G(8015)/BTEX+MTBE(8260)/ETHANOL (8260)
	2 500ml ambers	YES	NP	LANCASTER	TPH-D (8015)

COMMENTS: _____

Add/Replaced Lock: _____ Add/Replaced Plug: _____ Add/Replaced Bolt: _____



GETTLER-RYAN INC.

WELL MONITORING/SAMPLING FIELD DATA SHEET

Client/Facility#: Chevron #211283
 Site Address: 3810 Broadway
 City: Oakland, CA

Job Number: 386956
 Event Date: 3-11-08 (inclusive)
 Sampler: SH

Well ID: MW-513
 Well Diameter: 2 in.
 Total Depth: 36.30 ft.
 Depth to Water: 27.17

Date Monitored: 3-11-08

Volume	3/4" = 0.02	1" = 0.04	2" = 0.17	3" = 0.38
Factor (VF)	4" = 0.66	5" = 1.02	6" = 1.50	12" = 5.80

Depth to Water 3.13 xVF .17 = 0.53 x3 case volume = Estimated Purge Volume: 2 gal.
 Depth to Water w/ 80% Recharge [(Height of Water Column x 0.20) + DTW]: 27.80

Purge Equipment:
 Disposable Bailer X
 Stainless Steel Bailer _____
 Stack Pump _____
 Suction Pump _____
 Grundfos _____
 Peristaltic Pump _____
 QED Bladder Pump _____
 Other: _____

Sampling Equipment:
 Disposable Bailer X
 Pressure Bailer _____
 Discrete Bailer _____
 Peristaltic Pump _____
 QED Bladder Pump _____
 Other: _____

Time Started: _____ (2400 hrs)
 Time Completed: _____ (2400 hrs)
 Depth to Product: _____ ft
 Depth to Water: _____ ft
 Hydrocarbon Thickness: _____ ft
 Visual Confirmation/Description: _____
 Skimmer / Absorbent Sock (circle one)
 Amt Removed from Skimmer: _____ gal
 Amt Removed from Well: _____ gal
 Water Removed: _____
 Product Transferred to: _____

Start Time (purge): 1423 Weather Conditions: Clear
 Sample Time/Date: 1515 3-11-08 Water Color: Light Grey Odor: Y (N)
 Approx. Flow Rate: _____ gpm. Sediment Description: light
 Did well de-water? NO If yes, Time: _____ Volume: _____ gal. DTW @ Sampling: 27.42

Time (2400 hr.)	Volume (gal.)	pH	Conductivity (µmhos/cm - AS)	Temperature (°F)	D.O. (mg/L)	ORP (mV)
<u>1430</u>	<u>1.0</u>	<u>6.93</u>	<u>293</u>	<u>17.3</u>	PRE: _____	PRE: _____
<u>1435</u>	<u>1.5</u>	<u>6.95</u>	<u>271</u>	<u>17.5</u>	POST: _____	POST: _____
<u>1541</u>	<u>2.0</u>	<u>6.91</u>	<u>254</u>	<u>17.6</u>		

LABORATORY INFORMATION

SAMPLE ID	(#) CONTAINER	REFRIG.	PRESERV. TYPE	LABORATORY	ANALYSES
<u>MW-513</u>	<u>6</u> x vial	YES	HCL	LANCASTER	TPH-G(8015)/BTEX+MTBE(8260)/ETHANOL (8260)
	<u>2</u> 500ml ambers	YES	NP	LANCASTER	TPH-D (8015)

COMMENTS: _____

Add/Replaced Lock: _____ Add/Replaced Plug: _____ Add/Replaced Bolt: _____



GETTLER - RYAN INC.

WELL MONITORING/SAMPLING FIELD DATA SHEET

Client/Facility#: Chevron #211283 Job Number: 386956
 Site Address: 3810 Broadway Event Date: 3-11-08 (inclusive)
 City: Oakland, CA Sampler: SH

Well ID: MW-6
 Well Diameter: 2 in.
 Total Depth: 27-78 ft.
 Depth to Water: Dry ft.

Date Monitored: 3-11-08

Volume	3/4"= 0.02	1"= 0.04	2"= 0.17	3"= 0.38
Factor (VF)	4"= 0.66	5"= 1.02	6"= 1.50	12"= 5.80

Check if water column is less than 0.50 ft.
 xVF = _____ x3 case volume = Estimated Purge Volume: _____ gal.

Depth to Water w/ 80% Recharge [(Height of Water Column x 0.20) + DTW]: _____

Purge Equipment:

- Disposable Bailer _____
- Stainless Steel Bailer _____
- Stack Pump _____
- Suction Pump _____
- Grundfos _____
- Peristaltic Pump _____
- OED Bladder Pump _____
- Other: _____

Sampling Equipment:

- Disposable Bailer _____
- Pressure Bailer _____
- Discrete Bailer _____
- Peristaltic Pump _____
- OED Bladder Pump _____
- Other: _____

Time Started: _____ (2400 hrs)
 Time Completed: _____ (2400 hrs)
 Depth to Product: _____ ft
 Depth to Water: _____ ft
 Hydrocarbon Thickness: _____ ft
 Visual Confirmation/Description: _____
 Skimmer / Absorbant Sock (circle one)
 Amt Removed from Skimmer: _____ gal
 Amt Removed from Well: _____ gal
 Water Removed: _____
 Product Transferred to: _____

Start Time (purge): _____ Weather Conditions: _____
 Sample Time/Date: / Water Color: _____ Odor: Y / N
 Approx. Flow Rate: _____ gpm. Sediment Description: _____
 Did well de-water? _____ If yes, Time: _____ Volume: _____ gal. DTW @ Sampling: _____

Time (2400 hr.)	Volume (gal.)	pH	Conductivity (µmhos/cm - µS)	Temperature (C / F)	D.O. (mg/L)	ORP (mV)
_____	_____	_____	_____	_____	PRE: _____	PRE: _____
_____	_____	_____	_____	_____	POST: _____	POST: _____

LABORATORY INFORMATION

SAMPLE ID	(#) CONTAINER	REFRIG.	PRESERV. TYPE	LABORATORY	ANALYSES
MW-	x voc vial	YES	HCL	LANCASTER	TPH-G(8015)/BTEX+MTBE(8260)/ETHANOL (8260)
	x 500ml ambers	YES	NP	LANCASTER	TPH-D (8015)

COMMENTS: well Dry

Add/Replaced Lock: _____ Add/Replaced Plug: _____ Add/Replaced Bolt: 2 (1/2)



GETTLER-RYAN INC.

WELL MONITORING/SAMPLING FIELD DATA SHEET

Client/Facility#: Chevron #211283 Job Number: 386956
 Site Address: 3810 Broadway Event Date: 3-11-08 (inclusive)
 City: Oakland, CA Sampler: SH

Well ID: MW-7 Date Monitored: 3-11-08
 Well Diameter: 2 in.
 Total Depth: 33.45 ft.
 Depth to Water: 26.63 ft.
 Depth to Water w/ 80% Recharge [(Height of Water Column x 0.20) + DTW]: 27.99

Volume	3/4"= 0.02	1"= 0.04	2"= 0.17	3"= 0.38
Factor (VF)	4"= 0.66	5"= 1.02	6"= 1.50	12"= 5.80

Check if water column is less than 0.50 ft.
 $6.82 \times VF - 1.7 = 1.16$ x3 case volume = Estimated Purge Volume: 3.5 gal.

Purge Equipment:
 Disposable Bailer X
 Stainless Steel Bailer _____
 Stack Pump _____
 Suction Pump _____
 Grundfos _____
 Peristaltic Pump _____
 QED Bladder Pump _____
 Other: _____

Sampling Equipment:
 Disposable Bailer X
 Pressure Bailer _____
 Discrete Bailer _____
 Peristaltic Pump _____
 QED Bladder Pump _____
 Other: _____

Time Started: _____ (2400 hrs)
 Time Completed: _____ (2400 hrs)
 Depth to Product: _____ ft
 Depth to Water: _____ ft
 Hydrocarbon Thickness: _____ ft
 Visual Confirmation/Description: _____
 Skimmer / Absorbant Sock (circle one)
 Amt Removed from Skimmer: _____ gal
 Amt Removed from Well: _____ gal
 Water Removed: _____
 Product Transferred to: _____

Start Time (purge): 1007 Weather Conditions: Clear
 Sample Time/Date: 1050 / 3-11-08 Water Color: Tan Odor: Y 1 (N)
 Approx. Flow Rate: _____ gpm. Sediment Description: Moderate
 Did well de-water? NO If yes, Time: _____ Volume: _____ gal. DTW @ Sampling: 27.54

Time (2400 hr.)	Volume (gal.)	pH	Conductivity (µmhos/cm - US)	Temperature (° F)	D.O. (mg/L)	ORP (mV)
<u>1013</u>	<u>1.5</u>	<u>7.04</u>	<u>363</u>	<u>17.7</u>	PRE: <u>1.8</u>	PRE: <u>93</u>
<u>1019</u>	<u>3.5</u>	<u>6.94</u>	<u>347</u>	<u>17.8</u>		
<u>1028</u>	<u>3.5</u>	<u>6.91</u>	<u>341</u>	<u>18.0</u>	POST: <u>1.7</u>	POST: <u>104</u>

LABORATORY INFORMATION

SAMPLE ID	(#) CONTAINER	REFRIG.	PRESERV. TYPE	LABORATORY	ANALYSES
<u>MW-7</u>	<u>6</u> x vov vial	YES	HCL	LANCASTER	TPH-G(8015)/BTEX+MTBE(8260)/ETHANOL (8260)
	<u>2</u> 500ml ambers	YES	NP	LANCASTER	TPH-D (8015)

COMMENTS: retapped 2 flanges to 3/8"

Add/Replaced Lock: _____ Add/Replaced Plug: _____ Add/Replaced Bolt: 2 (3/8")



GETTLER-RYAN INC.

WELL MONITORING/SAMPLING FIELD DATA SHEET

Client/Facility#: Chevron #211283
 Site Address: 3810 Broadway
 City: Oakland, CA

Job Number: 386956
 Event Date: 3-11-08 (inclusive)
 Sampler: SH

Well ID: MW-9
 Well Diameter: 2 in.
 Total Depth: 33.92 ft.
 Depth to Water: 24.07 ft.
9.85 xVF

Date Monitored: 3-11-08

Volume	3/4" = 0.02	1" = 0.04	2" = 0.17	3" = 0.38
Factor (VF)	4" = 0.66	5" = 1.02	6" = 1.50	12" = 5.80

Check if water column is less than 0.50 ft.

Depth to Water w/ 80% Recharge [(Height of Water Column x 0.20) + DTW]: 26.04
 $0.17 = 1.67 \times 3 \text{ case volume} = \text{Estimated Purge Volume: } 5.5 \text{ gal.}$

Purge Equipment:
 Disposable Bailer X
 Stainless Steel Bailer _____
 Stack Pump _____
 Suction Pump _____
 Grundfos _____
 Peristaltic Pump _____
 QED Bladder Pump _____
 Other: _____

Sampling Equipment:
 Disposable Bailer X
 Pressure Bailer _____
 Discrete Bailer _____
 Peristaltic Pump _____
 QED Bladder Pump _____
 Other: _____

Time Started: _____ (2400 hrs)
 Time Completed: _____ (2400 hrs)
 Depth to Product: _____ ft
 Depth to Water: _____ ft
 Hydrocarbon Thickness: _____ ft
 Visual Confirmation/Description: _____
 Skimmer / Absorbent Sock (circle one)
 Amt Removed from Skimmer: _____ gal
 Amt Removed from Well: _____ gal
 Water Removed: _____
 Product Transferred to: _____

Start Time (purge): 1142 Weather Conditions: Clear
 Sample Time/Date: 1200 / 3-11-08 Water Color: Tan Odor: Y 1 (W)
 Approx. Flow Rate: _____ gpm. Sediment Description: Moderate
 Did well de-water? NO If yes, Time: _____ Volume: _____ gal. DTW @ Sampling: 24.08

Time (2400 hr.)	Volume (gal.)	pH	Conductivity (µmhos/cm - (US))	Temperature (C F)	D.O. (mg/L)	ORP (mV)
<u>1146</u>	<u>2</u>	<u>7.34</u>	<u>221</u>	<u>18.4</u>	PRE: <u>2.2</u>	PRE: <u>76</u>
<u>1150</u>	<u>4</u>	<u>7.21</u>	<u>217</u>	<u>18.3</u>		
<u>1155</u>	<u>5.5</u>	<u>7.11</u>	<u>210</u>	<u>18.0</u>	POST: <u>1.9</u>	POST: <u>63</u>

LABORATORY INFORMATION

SAMPLE ID	(#) CONTAINER	REFRIG.	PRESERV. TYPE	LABORATORY	ANALYSES
MW-9	2 x vov vial	YES	HCL	LANCASTER	TPH-G(8015)/BTX+MTBE(8260)/ETHANOL (8260)
	2 500ml ambers	YES	NP	LANCASTER	TPH-D (8015)

COMMENTS: Flanges re-tapped to 3/8"

Add/Replaced Lock: _____ Add/Replaced Plug: _____ Add/Replaced Bolt: 2 (3/8")



GETTLER-RYAN INC.

WELL MONITORING/SAMPLING FIELD DATA SHEET

Client/Facility#: Chevron #211283
 Site Address: 3810 Broadway
 City: Oakland, CA

Job Number: 386956
 Event Date: 3-11-08 (inclusive)
 Sampler: SH

Well ID: MW-10
 Well Diameter: 2 in.
 Total Depth: 33.17 ft.
 Depth to Water: 24.56 ft.
8.61 xVF 0.17 = 1.46
 Depth to Water w/ 80% Recharge [(Height of Water Column x 0.20) + DTW]: 26.28

Date Monitored: 3-11-08

Volume	3/4" = 0.02	1" = 0.04	2" = 0.17	3" = 0.38
Factor (VF)	4" = 0.66	5" = 1.02	6" = 1.50	12" = 5.80

Check if water column is less than 0.50 ft.
 x3 case volume = Estimated Purge Volume: 4.5 gal.

Purge Equipment:
 Disposable Bailer X
 Stainless Steel Bailer _____
 Stack Pump _____
 Suction Pump _____
 Grundfos _____
 Peristaltic Pump _____
 QED Bladder Pump _____
 Other: _____

Sampling Equipment:
 Disposable Bailer X
 Pressure Bailer _____
 Discrete Bailer _____
 Peristaltic Pump _____
 QED Bladder Pump _____
 Other: _____

Time Started: _____ (2400 hrs)
 Time Completed: _____ (2400 hrs)
 Depth to Product: _____ ft
 Depth to Water: _____ ft
 Hydrocarbon Thickness: _____ ft
 Visual Confirmation/Description: _____
 Skimmer / Absorbent Sock (circle one)
 Amt Removed from Skimmer: _____ gal
 Amt Removed from Well: _____ gal
 Water Removed: _____
 Product Transferred to: _____

Start Time (purge): 1106 Weather Conditions: Clear
 Sample Time/Date: 1130 / 3-11-08 Water Color: Grey Odor: (Y) N
 Approx. Flow Rate: _____ gpm. Sediment Description: light
 Did well de-water? no If yes, Time: _____ Volume: _____ gal. DTW @ Sampling: 24.93

Time (2400 hr.)	Volume (gal.)	pH	Conductivity (µmhos/cm - µS)	Temperature (C / F)	D.O. (mg/L)	ORP (mV)
<u>1110</u>	<u>1.5</u>	<u>7.21</u>	<u>203</u>	<u>17.9</u>	PRE: _____	PRE: _____
<u>1114</u>	<u>3.0</u>	<u>7.13</u>	<u>217</u>	<u>17.5</u>	POST: _____	POST: _____
<u>1117</u>	<u>4.5</u>	<u>7.09</u>	<u>221</u>	<u>17.2</u>		

LABORATORY INFORMATION

SAMPLE ID	(#) CONTAINER	REFRIG.	PRESERV. TYPE	LABORATORY	ANALYSES
MW-10	6 x vov vial	YES	HCL	LANCASTER	TPH-G(8015)/BTEX+MTBE(8260)/ETHANOL (8260)
	2x 500ml ambers	YES	NP	LANCASTER	TPH-D (8015)

COMMENTS: Bring longer 1/2" bolts. Flanges retapped, threads out of
each of current bolts

Add/Replaced Lock: _____ Add/Replaced Plug: ✓ Add/Replaced Bolt: _____



GETTLER-RYAN INC.

WELL MONITORING/SAMPLING FIELD DATA SHEET

Client/Facility#: Chevron #211283
 Site Address: 3810 Broadway
 City: Oakland, CA

Job Number: 386956
 Event Date: 3-11-08 (inclusive)
 Sampler: SH

Well ID: MW-11
 Well Diameter: 2 in.
 Total Depth: 39.41 ft.
 Depth to Water: 32.55 ft.

Date Monitored: 3-11-08

Volume	3/4"= 0.02	1"= 0.04	2"= 0.17	3"= 0.38
Factor (VF)	4"= 0.66	5"= 1.02	6"= 1.50	12"= 5.80

Check if water column is less than 0.50 ft.
 Depth to Water w/ 80% Recharge [(Height of Water Column x 0.20) + DTW]: 33.92

Purge Equipment:
 Disposable Bailer X
 Stainless Steel Bailer _____
 Stack Pump _____
 Suction Pump _____
 Grundfos _____
 Peristaltic Pump _____
 QED Bladder Pump _____
 Other: _____

Sampling Equipment:
 Disposable Bailer X
 Pressure Bailer _____
 Discrete Bailer _____
 Peristaltic Pump _____
 QED Bladder Pump _____
 Other: _____

Time Started: _____ (2400 hrs)
 Time Completed: _____ (2400 hrs)
 Depth to Product: _____ ft
 Depth to Water: _____ ft
 Hydrocarbon Thickness: _____ ft
 Visual Confirmation/Description: _____
 Skimmer / Absorbant Sock (circle one)
 Amt Removed from Skimmer: _____ gal
 Amt Removed from Well: _____ gal
 Water Removed: _____
 Product Transferred to: _____

Start Time (purge): 0915
 Sample Time/Date: 09501 3-11-08
 Approx. Flow Rate: _____ gpm.
 Did well de-water? NO If yes, Time: _____

Weather Conditions: Clear
 Water Color: Cloudy Odor: YIN
 Sediment Description: light
 Volume: _____ gal. DTW @ Sampling: 32.93

Time (2400 hr.)	Volume (gal.)	pH	Conductivity (µmhos/cm - DS)	Temperature (C / F)	D.O. (mg/L)	ORP (mV)
<u>0920</u>	<u>1.5</u>	<u>7.34</u>	<u>475</u>	<u>16.8</u>	PRE: _____	PRE: _____
<u>0924</u>	<u>2.5</u>	<u>7.29</u>	<u>461</u>	<u>17.1</u>	POST: _____	POST: _____
<u>0929</u>	<u>3.5</u>	<u>7.26</u>	<u>452</u>	<u>17.2</u>		

LABORATORY INFORMATION

SAMPLE ID	(#) CONTAINER	REFRIG.	PRESERV. TYPE	LABORATORY	ANALYSES
<u>MW-11</u>	<u>2 x vov vial</u>	<u>YES</u>	<u>HCL</u>	<u>LANCASTER</u>	<u>TPH-G(8015)/BTEX+MTBE(8260)/ETHANOL (8260)</u>
	<u>2 500ml ambers</u>	<u>YES</u>	<u>NP</u>	<u>LANCASTER</u>	<u>TPH-D (8015)</u>

COMMENTS: Traffic Control

Add/Replaced Lock: _____ Add/Replaced Plug: _____ Add/Replaced Bolt: _____



GETTLER-RYAN INC.

WELL MONITORING/SAMPLING FIELD DATA SHEET

MW-12

Client/Facility#: Chevron #211283
Site Address: 3810 Broadway
City: Oakland, CA

Job Number: 386956
Event Date: 3-11-08 (inclusive)
Sampler: SH

Well ID: MW-~~12~~ 12
Well Diameter: 2 in.
Total Depth: 29.61 ft.
Depth to Water: 25.60 ft.

Date Monitored: 3-11-08

Volume	3/4"= 0.02	1"= 0.04	2"= 0.17	3"= 0.38
Factor (VF)	4"= 0.66	5"= 1.02	6"= 1.50	12"= 5.80

Depth to Water w/ 80% Recharge [(Height of Water Column x 0.20) + DTW]: 26.40
 Check if water column is less then 0.50 ft.
4.01 xVF .17 = 0.68 x3 case volume = Estimated Purge Volume: 2.5 gal.

Purge Equipment:
Disposable Bailer X
Stainless Steel Bailer _____
Stack Pump _____
Suction Pump _____
Grundfos _____
Peristaltic Pump _____
OED Bladder Pump _____
Other: _____

Sampling Equipment:
Disposable Bailer X
Pressure Bailer _____
Discrete Bailer _____
Peristaltic Pump _____
OED Bladder Pump _____
Other: _____

Time Started: _____ (2400 hrs)
Time Completed: _____ (2400 hrs)
Depth to Product: _____ ft
Depth to Water: _____ ft
Hydrocarbon Thickness: _____ ft
Visual Confirmation/Description: _____
Skimmer / Absorbant Sock (circle one)
Amt Removed from Skimmer: _____ gal
Amt Removed from Well: _____ gal
Water Removed: _____
Product Transferred to: _____

Start Time (purge): 1315 Weather Conditions: Clear
Sample Time/Date: 14001 3-11-08 Water Color: Clear Odor: Y KN
Approx. Flow Rate: _____ gpm. Sediment Description: light
Did well de-water? no If yes, Time: _____ Volume: _____ gal. DTW @ Sampling: 26.75

Time (2400 hr.)	Volume (gal.)	pH	Conductivity (µmhos/cm) (µS)	Temperature (°C) (°F)	D.O. (mg/L)	ORP (mV)
<u>1321</u>	<u>1.0</u>	<u>7.24</u>	<u>898</u>	<u>18.7</u>	PRE: _____	PRE: _____
<u>1327</u>	<u>2.0+5</u>	<u>7.19</u>	<u>873</u>	<u>18.5</u>	_____	_____
<u>1336</u>	<u>2.5</u>	<u>7.17</u>	<u>864</u>	<u>18.9</u>	POST: _____	POST: _____

LABORATORY INFORMATION

SAMPLE ID	(#) CONTAINER	REFRIG.	PRESERV. TYPE	LABORATORY	ANALYSES
MW- <u>D</u>	<u>6</u> x vial	YES	HCL	LANCASTER	TPH-G(8015)/BTEX+MTBE(8260)/ETHANOL (8260)
	<u>2</u> x 500ml ambers	YES	NP	LANCASTER	TPH-D (8015)

COMMENTS: _____

Add/Replaced Lock: _____ Add/Replaced Plug: _____ Add/Replaced Bolt: 3 (9/16")

Chevron California Region Analysis Request/Chain of Custody



031208-02

For Lancaster Laboratories use only

Acct. #: 10904

Sample # 5302364-371

Group #: 004482

Group 1081382

Facility #: SS#211283-OML G-R#386956 Global ID#T0600101108 Site Address: 3810 BROADWAY, OAKLAND, CA Chevron PM: IR Lead Consultant: CRACE Consultant/Office: G-R, Inc., 6747 Sierra Court, Suite J, Dublin, Ca. 94568 Consultant Prj. Mgr.: Deanna L. Harding (deanna@grinc.com) Consultant Phone #: 925-551-7555 Fax #: 925-551-7899 Sampler: Steve Hunter				Matrix <input type="checkbox"/> Potable <input type="checkbox"/> NPDES <input type="checkbox"/> Soil <input type="checkbox"/> Water <input type="checkbox"/> Oil <input type="checkbox"/> Air		Analyses Requested <table border="1" style="width: 100%; border-collapse: collapse;"> <tr> <th colspan="10">Preservation Codes</th> </tr> <tr> <td>H</td><td>H</td><td></td><td></td><td></td><td></td><td></td><td></td><td></td><td>H</td> </tr> <tr> <td>BTEX + MTBE 8260</td><td>8021</td><td></td><td></td><td></td><td></td><td></td><td></td><td></td><td></td> </tr> <tr> <td>TPH 8015 MOD GRO</td><td></td><td></td><td></td><td></td><td></td><td></td><td></td><td></td><td></td> </tr> <tr> <td>TPH 8015 MOD DRO</td><td></td><td></td><td></td><td></td><td></td><td></td><td></td><td></td><td></td> </tr> <tr> <td>8260 full scan</td><td></td><td></td><td></td><td></td><td></td><td></td><td></td><td></td><td></td> </tr> <tr> <td>Oxygenates</td><td></td><td></td><td></td><td></td><td></td><td></td><td></td><td></td><td></td> </tr> <tr> <td>Total Lead</td><td></td><td></td><td></td><td></td><td></td><td></td><td></td><td></td><td></td> </tr> <tr> <td>Dissolved Lead</td><td></td><td></td><td></td><td></td><td></td><td></td><td></td><td></td><td></td> </tr> <tr> <td colspan="10" style="text-align: center;">Method: ETHANOL (8260)</td> </tr> </table>										Preservation Codes										H	H								H	BTEX + MTBE 8260	8021									TPH 8015 MOD GRO										TPH 8015 MOD DRO										8260 full scan										Oxygenates										Total Lead										Dissolved Lead										Method: ETHANOL (8260)										Preservative Codes H = HCl T = Thiosulfate N = HNO ₃ B = NaOH S = H ₂ SO ₄ O = Other <input type="checkbox"/> J value reporting needed <input checked="" type="checkbox"/> Must meet lowest detection limits possible for 8260 compounds 8021 MTBE Confirmation <input type="checkbox"/> Confirm highest hit by 8260 <input type="checkbox"/> Confirm all hits by 8260 <input type="checkbox"/> Run ___ oxy's on highest hit <input type="checkbox"/> Run ___ oxy's on all hits	
Preservation Codes																																																																																																																					
H	H								H																																																																																																												
BTEX + MTBE 8260	8021																																																																																																																				
TPH 8015 MOD GRO																																																																																																																					
TPH 8015 MOD DRO																																																																																																																					
8260 full scan																																																																																																																					
Oxygenates																																																																																																																					
Total Lead																																																																																																																					
Dissolved Lead																																																																																																																					
Method: ETHANOL (8260)																																																																																																																					
Sample Identification		Date Collected	Time Collected	Grab	Composite	Soil	Water	Oil	Air	Total Number of Containers	BTEX + MTBE 8260	8021	TPH 8015 MOD GRO	TPH 8015 MOD DRO	8260 full scan	Oxygenates	Total Lead	Dissolved Lead	Method																																																																																																		
QA		3-11-08		X			X			2	X	X																																																																																																									
MW-4			1300	X			X			8	X	X	X							X																																																																																																	
MW-5B			1515	X			X			8	X	X	X							X																																																																																																	
MW-7			1050	X			X			8	X	X	X							X																																																																																																	
MW-9			1200	X			X			8	X	X	X							X																																																																																																	
MW-10			1130	X			X			8	X	X	X							X																																																																																																	
MW-11			0950	X			X			8	X	X	X							X																																																																																																	
MW-12			1400	X			X			8	X	X	X							X																																																																																																	
Comments / Remarks																																																																																																																					
Turnaround Time Requested (TAT) (please circle) (STD. TAT) 24 hour 72 hour 48 hour 4 day 5 day						Relinquished by: Steve Hunter Date: 3-11-08 Time: 1730				Received by: [Signature] Date: 03-12-08 Time: 1045				Date: 03-12-08 Time: 1045																																																																																																							
Data Package Options (please circle if required) QC Summary Type I - Full Type VI (Raw Data) <input type="checkbox"/> Coeff Deliverable not needed EDF/EDD WIP (RWQCB) Disk						Relinquished by: [Signature] Date: 12 MAR 08 Time: 1634				Received by: [Signature] Date: 3/13/08 Time: 1036				Date: 3/13/08 Time: 1036																																																																																																							
UPS FedEx Other: [Signature]						Temperature Upon Receipt: 016.2 °C				Custody Seals Intact? Yes <input checked="" type="checkbox"/>																																																																																																											



Analysis Report

2425 New Holland Pike, PO Box 12425, Lancaster, PA 17605-2425 • 717-656-2300 Fax: 717-656-2681 • www.lancasterlabs.com

ANALYTICAL RESULTS

Prepared for:

Chevron
6001 Bollinger Canyon Rd L4310
San Ramon CA 94583

925-842-8582

Prepared by:

Lancaster Laboratories
2425 New Holland Pike
Lancaster, PA 17605-2425

STAMP: GETTLER-RYAN, INC. GENERAL CONTRACTORS

SAMPLE GROUP

The sample group for this submittal is 1081382. Samples arrived at the laboratory on Thursday, March 13, 2008. The PO# for this group is 0015024486 and the release number is ROBB.

<u>Client Description</u>	<u>Lancaster Labs Number</u>
QA-T-080311 NA Water	5302364
MW-4-W-080311 Grab Water	5302365
MW-5B-W-080311 Grab Water	5302366
MW-7-W-080311 Grab Water	5302367
MW-9-W-080311 Grab Water	5302368
MW-10-W-080311 Grab Water	5302369
MW-11-W-080311 Grab Water	5302370
MW-12-W-080311 Grab Water	5302371

ELECTRONIC COPY TO CRA c/o Gettler-Ryan

Attn: Cheryl Hansen



Analysis Report

2425 New Holland Pike, PO Box 12425, Lancaster, PA 17605-2425 • 717-656-2300 Fax: 717-656-2681 • www.lancasterlabs.com

Questions? Contact your Client Services Representative
Angela M Miller at (717) 656-2300

Respectfully Submitted,

A handwritten signature in cursive script, appearing to read "Christine Dulaney".

Christine Dulaney
Senior Specialist



Analysis Report

2425 New Holland Pike, PO Box 12425, Lancaster, PA 17605-2425 • 717-656-2300 Fax: 717-656-2681 • www.lancasterlabs.com

Lancaster Laboratories Sample No. WW5302364

Group No. 1081382

QA-T-080311 NA Water
Facility# 211283 Job# 386956 GRD
3810 Broadway-Oakland T0600101108 QA
Collected: 03/11/2008

Account Number: 10904

Submitted: 03/13/2008 10:10
Reported: 03/24/2008 at 16:58
Discard: 04/24/2008

Chevron
6001 Bollinger Canyon Rd L4310
San Ramon CA 94583

1283Q

CAT No.	Analysis Name	CAS Number	As Received Result	As Received Method Detection Limit	Units	Dilution Factor
01728	TPH-GRO - Waters	n.a.	N.D.	50.	ug/l	1
The reported concentration of TPH-GRO does not include MTBE or other gasoline constituents eluting prior to the C6 (n-hexane) TPH-GRO range start time.						
06054	BTEX+MTBE by 8260B					
02010	Methyl Tertiary Butyl Ether	1634-04-4	N.D.	0.5	ug/l	1
05401	Benzene	71-43-2	N.D.	0.5	ug/l	1
05407	Toluene	108-88-3	N.D.	0.5	ug/l	1
05415	Ethylbenzene	100-41-4	N.D.	0.5	ug/l	1
06310	Xylene (Total)	1330-20-7	N.D.	0.5	ug/l	1

State of California Lab Certification No. 2116

All QC is compliant unless otherwise noted. Please refer to the Quality Control Summary for overall QC performance data and associated samples.

Laboratory Chronicle

CAT No.	Analysis Name	Method	Trial#	Analysis Date and Time	Analyst	Dilution Factor
01728	TPH-GRO - Waters	SW-846 8015E modified	1	03/17/2008 12:30	Patrick N Evans	1
06054	BTEX+MTBE by 8260B	SW-846 8260E	1	03/21/2008 17:35	Ginelle L Feister	1
01146	GC VOA Water Prep	SW-846 5030E	1	03/17/2008 12:30	Patrick N Evans	1
01163	GC/MS VOA Water Prep	SW-846 5030E	1	03/21/2008 17:35	Ginelle L Feister	1



Analysis Report

2425 New Holland Pike, PO Box 12425, Lancaster, PA 17605-2425 • 717-656-2300 Fax: 717-656-2681 • www.lancasterlabs.com

Lancaster Laboratories Sample No. WW5302365

Group No. 1081382

MW-4-W-080311 Grab Water
Facility# 211283 Job# 386956 GRD
3810 Broadway-Oakland T0600101108 MW-4
Collected: 03/11/2008 13:00 by SH

Account Number: 10904

Submitted: 03/13/2008 10:10
Reported: 03/24/2008 at 16:58
Discard: 04/24/2008

Chevron
6001 Bollinger Canyon Rd L4310
San Ramon CA 94583

12834

CAT No.	Analysis Name	CAS Number	As Received	As Received	Units	Dilution Factor
			Result	Method Detection Limit		
01728	TPH-GRO - Waters	n.a.	54.	50.	ug/l	1
	The reported concentration of TPH-GRO does not include MTBE or other gasoline constituents eluting prior to the C6 (n-hexane) TPH-GRO range start time.					
06609	TPH-DRO (Waters)	n.a.	430.	50.	ug/l	1
06067	ETEX, MTBE, ETOH					
01587	Ethanol	64-17-5	N.D.	50.	ug/l	1
02010	Methyl Tertiary Butyl Ether	1634-04-4	0.6	0.5	ug/l	1
05401	Benzene	71-43-2	N.D.	0.5	ug/l	1
05407	Toluene	108-88-3	N.D.	0.5	ug/l	1
05415	Ethylbenzene	100-41-4	N.D.	0.5	ug/l	1
06310	Xylene (Total)	1330-20-7	N.D.	0.5	ug/l	1

State of California Lab Certification No. 2116

All QC is compliant unless otherwise noted. Please refer to the Quality Control Summary for overall QC performance data and associated samples.

Laboratory Chronicle

CAT No.	Analysis Name	Method	Trial#	Analysis	Analyst	Dilution Factor
				Date and Time		
01728	TPH-GRO - Waters	SW-846 8015B modified	1	03/17/2008 19:38	Patrick N Evans	1
06609	TPH-DRO (Waters)	SW-846 8015B	1	03/19/2008 13:39	Heather E Williams	1
06067	ETEX, MTBE, ETOH	SW-846 8260B	1	03/20/2008 16:08	Ginelle L Feister	1
01146	GC VOA Water Prep	SW-846 5030B	1	03/17/2008 19:38	Patrick N Evans	1
01163	GC/MS VOA Water Prep	SW-846 5030B	1	03/20/2008 16:08	Ginelle L Feister	1
02376	Extraction - Fuel/TPH (Waters)	SW-846 3510C	1	03/17/2008 10:45	Jessica Agosto	1

Lancaster Laboratories Sample No. WW5302366

Group No. 1081382

MW-5B-W-080311 Grab Water
 Facility# 211283 Job# 386956 GRD
 3810 Broadway-Oakland T0600101108 MW-5B
 Collected: 03/11/2008 15:15 by SH

Account Number: 10904

Submitted: 03/13/2008 10:10
 Reported: 03/24/2008 at 16:58
 Discard: 04/24/2008

Chevron
 6001 Bollinger Canyon Rd L4310
 San Ramon CA 94583

12835

CAT No.	Analysis Name	CAS Number	As Received Result	As Received		Units	Dilution Factor
				Method	Detection Limit		
01728	TPH-GRO - Waters	n.a.	640.		50.	ug/l	1
	The reported concentration of TPH-GRO does not include MTBE or other gasoline constituents eluting prior to the C6 (n-hexane) TPH-GRO range start time.						
06609	TPH-DRO (Waters)	n.a.	290.		50.	ug/l	1
06067	BTEX, MTBE, ETOH						
01587	Ethanol	64-17-5	N.D.		50.	ug/l	1
02010	Methyl Tertiary Butyl Ether	1634-04-4	38.		0.5	ug/l	1
05401	Benzene	71-43-2	16.		0.5	ug/l	1
05407	Toluene	108-88-3	N.D.		0.5	ug/l	1
05415	Ethylbenzene	100-41-4	4.		0.5	ug/l	1
06310	Xylene (Total)	1330-20-7	0.5		0.5	ug/l	1

State of California Lab Certification No. 2116

All QC is compliant unless otherwise noted. Please refer to the Quality Control Summary for overall QC performance data and associated samples.

Laboratory Chronicle

CAT No.	Analysis Name	Method	Trial#	Analysis		Analyst	Dilution Factor
				Date	Time		
01728	TPH-GRO - Waters	SW-846 8015B modified	1	03/17/2008	20:11	Patrick N Evans	1
06609	TPH-DRO (Waters)	SW-846 8015B	1	03/18/2008	23:30	Heather E Williams	1
06067	BTEX, MTBE, ETOH	SW-846 8260E	1	03/20/2008	16:32	Ginelle L Feister	1
01146	GC VOA Water Prep	SW-846 5030E	1	03/17/2008	20:11	Patrick N Evans	1
01163	GC/MS VOA Water Prep	SW-846 5030E	1	03/20/2008	16:32	Ginelle L Feister	1
02376	Extraction - Fuel/TPH (Waters)	SW-846 3510C	1	03/17/2008	10:45	Jessica Agosto	1

Lancaster Laboratories Sample No. WW5302367

Group No. 1081382

MW-7-W-080311 Grab Water
 Facility# 211283 Job# 386956 GRD
 3810 Broadway-Oakland T0600101108 MW-7
 Collected: 03/11/2008 10:50 by SH

Account Number: 10904

Submitted: 03/13/2008 10:10
 Reported: 03/24/2008 at 16:58
 Discard: 04/24/2008

Chevron
 6001 Bollinger Canyon Rd L4310
 San Ramon CA 94583

12837

CAT No.	Analysis Name	CAS Number	As Received	As Received	Units	Dilution Factor
			Result	Method Detection Limit		
01728	TPH-GRO - Waters	n.a.	N.D.	50.	ug/l	1
	The reported concentration of TPH-GRO does not include MTBE or other gasoline constituents eluting prior to the C6 (n-hexane) TPH-GRO range start time.					
06609	TPH-DRO (Waters)	n.a.	N.D.	50.	ug/l	1
06067	BTEX, MTBE, ETOH					
01587	Ethanol	64-17-5	N.D.	50.	ug/l	1
02010	Methyl Tertiary Butyl Ether	1634-04-4	N.D.	0.5	ug/l	1
05401	Benzene	71-43-2	N.D.	0.5	ug/l	1
05407	Toluene	108-88-3	N.D.	0.5	ug/l	1
05415	Ethylbenzene	100-41-4	N.D.	0.5	ug/l	1
06310	Xylene (Total)	1330-20-7	N.D.	0.5	ug/l	1

State of California Lab Certification No. 2116

All QC is compliant unless otherwise noted. Please refer to the Quality Control Summary for overall QC performance data and associated samples.

Laboratory Chronicle

CAT No.	Analysis Name	Method	Trial#	Analysis	Analyst	Dilution Factor
				Date and Time		
01728	TPH-GRO - Waters	SW-846 8015E modified	1	03/17/2008 20:44	Patrick N Evans	1
06609	TPH-DRO (Waters)	SW-846 8015B	1	03/18/2008 23:49	Heather E Williams	1
06067	ETEX, MTBE, ETOH	SW-846 8260E	1	03/20/2008 16:56	Ginelle L Feister	1
01146	GC VOA Water Prep	SW-846 5030B	1	03/17/2008 20:44	Patrick N Evans	1
01163	GC/MS VOA Water Prep	SW-846 5030E	1	03/20/2008 16:56	Ginelle L Feister	1
02376	Extraction - Fuel/TPH (Waters)	SW-846 3510C	1	03/17/2008 10:45	Jessica Agosto	1



Analysis Report

2425 New Holland Pike, PO Box 12425, Lancaster, PA 17605-2425 • 717-656-2300 Fax: 717-656-2681 • www.lancasterlabs.com

Page 1 of 1

Lancaster Laboratories Sample No. WW5302368

Group No. 1081382

MW-9-W-080311 Grab Water
 Facility# 211283 Job# 386956 GRD
 3810 Broadway-Oakland T0600101108 MW-9
 Collected: 03/11/2008 12:00 by SH

Account Number: 10904

Submitted: 03/13/2008 10:10
 Reported: 03/24/2008 at 16:58
 Discard: 04/24/2008

Chevron
 6001 Bollinger Canyon Rd L4310
 San Ramon CA 94583

12839

CAT No.	Analysis Name	CAS Number	As Received Result	As Received		Units	Dilution Factor
				Method	Detection Limit		
01728	TPH-GRO - Waters	n.a.	N.D.	50.		ug/l	1
	The reported concentration of TPH-GRO does not include MTBE or other gasoline constituents eluting prior to the C6 (n-hexane) TPH-GRO range start time.						
06609	TPH-DRO (Waters)	n.a.	N.D.	50.		ug/l	1
06067	ETEX, MTBE, ETOH						
01587	Ethanol	64-17-5	N.D.	50.		ug/l	1
02010	Methyl Tertiary Butyl Ether	1634-04-4	N.D.	0.5		ug/l	1
05401	Benzene	71-43-2	N.D.	0.5		ug/l	1
05407	Toluene	108-88-3	N.D.	0.5		ug/l	1
05415	Ethylbenzene	100-41-4	N.D.	0.5		ug/l	1
06310	Xylene (Total)	1330-20-7	N.D.	0.5		ug/l	1

State of California Lab Certification No. 2116

All QC[®] is compliant unless otherwise noted. Please refer to the Quality Control Summary for overall QC performance data and associated samples.

Laboratory Chronicle

CAT No.	Analysis Name	Method	Trial#	Analysis		Analyst	Dilution Factor
				Date	Time		
01728	TPH-GRO - Waters	SW-846 8015B modified	1	03/17/2008	21:17	Patrick N Evans	1
06609	TPH-DRO (Waters)	SW-846 8015B	1	03/19/2008	00:09	Heather E Williams	1
06067	ETEX, MTBE, ETOH	SW-846 8260B	1	03/20/2008	17:21	Ginelle L Feister	1
01146	GC VOA Water Prep	SW-846 5030B	1	03/17/2008	21:17	Patrick N Evans	1
01163	GC/MS VOA Water Prep	SW-846 5030B	1	03/20/2008	17:21	Ginelle L Feister	1
02376	Extraction - Fuel/TPH (Waters)	SW-846 3510C	1	03/17/2008	10:45	Jessica Agosto	1



Analysis Report

2425 New Holland Pike, PO Box 12425, Lancaster, PA 17605-2425 • 717-656-2300 Fax: 717-656-2681 • www.lancasterlabs.com

Lancaster Laboratories Sample No. WW5302369

Group No. 1081382

MW-10-W-080311 Grab Water
 Facility# 211283 Job# 386956 GRD
 3810 Broadway-Oakland T0600101108 MW-10
 Collected: 03/11/2008 11:30 by SH

Account Number: 10904

Submitted: 03/13/2008 10:10
 Reported: 03/24/2008 at 16:58
 Discard: 04/24/2008

Chevron
 6001 Bollinger Canyon Rd L4310
 San Ramon CA 94583

28310

CAT No.	Analysis Name	CAS Number	As Received	As Received	Units	Dilution Factor
			Result	Method Detection Limit		
01728	TPH-GRO - Waters	n.a.	190.	50.	ug/l	1
	The reported concentration of TPH-GRO does not include MTBE or other gasoline constituents eluting prior to the C6 (n-hexane) TPH-GRO range start time.					
06609	TPH-DRO (Waters)	n.a.	1,200.	50.	ug/l	1
06067	BTEX, MTBE, ETOH					
01587	Ethanol	64-17-5	N.D.	50.	ug/l	1
02010	Methyl Tertiary Butyl Ether	1634-04-4	2.	0.5	ug/l	1
05401	Benzene	71-43-2	1.	0.5	ug/l	1
05407	Toluene	108-88-3	N.D.	0.5	ug/l	1
05415	Ethylbenzene	100-41-4	N.D.	0.5	ug/l	1
06310	Xylene (Total)	1330-20-7	N.D.	0.5	ug/l	1

State of California Lab Certification No. 2116

All QC is compliant unless otherwise noted. Please refer to the Quality Control Summary for overall QC performance data and associated samples.

Laboratory Chronicle

CAT No.	Analysis Name	Method	Trial#	Analysis	Analyst	Dilution Factor
				Date and Time		
01728	TPH-GRO - Waters	SW-846 8015B modified	1	03/18/2008 17:09	Patrick N Evans	1
06609	TPH-DRO (Waters)	SW-846 8015B	1	03/19/2008 00:28	Heather E Williams	1
06067	BTEX, MTBE, ETOH	SW-846 8260B	1	03/20/2008 17:45	Ginelle L Feister	1
01146	GC VOA Water Prep	SW-846 5030B	1	03/18/2008 17:09	Patrick N Evans	1
01163	GC/MS VOA Water Prep	SW-846 5030B	1	03/20/2008 17:45	Ginelle L Feister	1
02376	Extraction - Fuel/TPH (Waters)	SW-846 3510C	1	03/17/2008 10:45	Jessica Agosto	1

Lancaster Laboratories Sample No. WW5302370

Group No. 1081382

MW-11-W-080311 Grab Water
 Facility# 211283 Job# 386956 GRD
 3810 Broadway-Oakland T0600101108 MW-11
 Collected: 03/11/2008 09:50 by SH

Account Number: 10904

Submitted: 03/13/2008 10:10
 Reported: 03/24/2008 at 16:58
 Discard: 04/24/2008

Chevron
 6001 Bollinger Canyon Rd L4310
 San Ramon CA 94583

28311

CAT No.	Analysis Name	CAS Number	As Received	As Received	Units	Dilution Factor
			Result	Method Detection Limit		
01728	TPH-GRO - Waters	n.a.	N.D.	50.	ug/l	1
	The reported concentration of TPH-GRO does not include MTBE or other gasoline constituents eluting prior to the C6 (n-hexane) TPH-GRO range start time.					
06609	TPH-DRO (Waters)	n.a.	52.	50.	ug/l	1
06067	BTEX, MTBE, ETOH					
01587	Ethanol	64-17-5	N.D.	50.	ug/l	1
02010	Methyl Tertiary Butyl Ether	1634-04-4	N.D.	0.5	ug/l	1
05401	Benzene	71-43-2	N.D.	0.5	ug/l	1
05407	Toluene	108-88-3	N.D.	0.5	ug/l	1
05415	Ethylbenzene	100-41-4	N.D.	0.5	ug/l	1
06310	Xylene (Total)	1330-20-7	N.D.	0.5	ug/l	1

State of California Lab Certification No. 2116

All QC is compliant unless otherwise noted. Please refer to the Quality Control Summary for overall QC performance data and associated samples.

Laboratory Chronicle

CAT No.	Analysis Name	Method	Trial#	Analysis		Analyst	Dilution Factor
				Date and Time			
01728	TPH-GRO - Waters	SW-846 8015B modified	1	03/17/2008 08:54		Carrie E Youtzy	1
06609	TPH-DRO (Waters)	SW-846 8015B	1	03/19/2008 00:48		Heather E Williams	1
06067	BTEX, MTBE, ETOH	SW-846 8260B	1	03/20/2008 18:09		Ginelle L Feister	1
01146	GC VOA Water Prep	SW-846 5030B	1	03/17/2008 08:54		Carrie E Youtzy	1
01163	GC/MS VOA Water Prep	SW-846 5030B	1	03/20/2008 18:09		Ginelle L Feister	1
02376	Extraction - Fuel/TPH (Waters)	SW-846 3510C	1	03/17/2008 10:45		Jessica Agosto	1



Analysis Report

2425 New Holland Pike, PO Box 12425, Lancaster, PA 17605-2425 • 717-656-2300 Fax: 717-656-2681 • www.lancasterlabs.com

Page 1 of 1

Lancaster Laboratories Sample No. WW5302371

Group No. 1081382

MW-12-W-080311 Grab Water
 Facility# 211283 Job# 386956 GRD
 3810 Broadway-Oakland T0600101108 MW-12
 Collected: 03/11/2008 14:00 by SH

Account Number: 10904

Submitted: 03/13/2008 10:10
 Reported: 03/24/2008 at 16:58
 Discard: 04/24/2008

Chevron
 6001 Bollinger Canyon Rd L4310
 San Ramon CA 94583

28312

CAT No.	Analysis Name	CAS Number	As Received	As Received	Units	Dilution Factor
			Result	Method Detection Limit		
01728	TPH-GRO - Waters	n.a.	7,000.	250.	ug/l	5
	The reported concentration of TPH-GRO does not include MTBE or other gasoline constituents eluting prior to the C6 (n-hexane) TPH-GRO range start time.					
06609	TPH-DRO (Waters)	n.a.	1,100.	50.	ug/l	1
06067	BTEX, MTBE, ETOH					
01587	Ethanol	64-17-5	N.D.	100.	ug/l	2
02010	Methyl Tertiary Butyl Ether	1634-04-4	N.D.	1.	ug/l	2
05401	Benzene	71-43-2	960.	5.	ug/l	10
05407	Toluene	108-88-3	330.	1.	ug/l	2
05415	Ethylbenzene	100-41-4	410.	5.	ug/l	10
06310	Xylene (Total)	1330-20-7	860.	1.	ug/l	2

State of California Lab Certification No. 2116

All QC is compliant unless otherwise noted. Please refer to the Quality Control Summary for overall QC performance data and associated samples.

Laboratory Chronicle

CAT No.	Analysis Name	Method	Analysis		Analyst	Dilution Factor
			Trial#	Date and Time		
01728	TPH-GRO - Waters	SW-846 8015B modified	1	03/17/2008 11:39	Carrie E Youtzy	5
06609	TPH-DRO (Waters)	SW-846 8015B	1	03/19/2008 01:07	Heather E Williams	1
06067	BTEX, MTBE, ETOH	SW-846 8260B	1	03/20/2008 18:34	Ginelle L Feister	2
06067	BTEX, MTBE, ETOH	SW-846 8260B	1	03/20/2008 18:56	Ginelle L Feister	10
01146	GC VOA Water Prep	SW-846 5030B	1	03/17/2008 11:39	Carrie E Youtzy	5
01163	GC/MS VOA Water Prep	SW-846 5030B	1	03/20/2008 18:34	Ginelle L Feister	2
01163	GC/MS VOA Water Prep	SW-846 5030B	2	03/20/2008 18:58	Ginelle L Feister	10
02376	Extraction - Fuel/TPH (Waters)	SW-846 3510C	1	03/17/2008 10:45	Jessica Agosto	1

Quality Control Summary

 Client Name: Chevron
 Reported: 03/24/08 at 04:58 PM

Group Number: 1081382

Matrix QC may not be reported if site-specific QC samples were not submitted. In these situations, to demonstrate precision and accuracy at a batch level, a LCS/LCSD was performed, unless otherwise specified in the method.

Laboratory Compliance Quality Control

Analysis Name	Blank Result	Blank MDL	Report Units	LCS %REC	LCSD %REC	LCS/LCSD Limits	RPD	RPD Max
Batch number: 080750024A TPH-DRO (Waters)	N.D.	29.	5302365-5302371 ug/l	74	75	63-119	2	20
Batch number: 08076A08A TPH-GRO - Waters	N.D.	50.	5302370-5302371 ug/l	109	118	75-135	8	30
Batch number: 08077A51A TPH-GRO - Waters	N.D.	50.	5302364-5302368 ug/l	111	115	75-135	4	30
Batch number: 08078A51A TPH-GRO - Waters	N.D.	50.	5302369 ug/l	112	109	75-135	3	30
Batch number: Z080801AA Ethanol	N.D.	50.	5302365-5302371 ug/l	105		31-166		
Methyl Tertiary Butyl Ether	N.D.	0.5	ug/l	99		73-119		
Benzene	N.D.	0.5	ug/l	99		78-119		
Toluene	N.D.	0.5	ug/l	105		85-115		
Ethylbenzene	N.D.	0.5	ug/l	104		82-119		
Xylene (Total)	N.D.	0.5	ug/l	102		83-113		
Batch number: Z080812AA Methyl Tertiary Butyl Ether	N.D.	0.5	5302364 ug/l	99		73-119		
Benzene	N.D.	0.5	ug/l	96		78-119		
Toluene	N.D.	0.5	ug/l	102		85-115		
Ethylbenzene	N.D.	0.5	ug/l	102		82-119		
Xylene (Total)	N.D.	0.5	ug/l	101		83-113		

Sample Matrix Quality Control

Unspiked (UNSPK) = the sample used in conjunction with the matrix spike
 Background (BKG) = the sample used in conjunction with the duplicate

Analysis Name	MS %REC	MSD %REC	MS/MSD Limits	RPD	RPD MAX	BKG Conc	DUP Conc	DUP RPD	Dup RPD Max
Batch number: 08076A08A TPH-GRO - Waters			5302370-5302371 63-154			UNSPK: P301479			
Batch number: 08077A51A TPH-GRO - Waters			5302364-5302368 63-154			UNSPK: P302355			
Batch number: 08078A51A TPH-GRO - Waters			5302369 63-154			UNSPK: P299845			
Batch number: Z080801AA Ethanol	92	105	5302365-5302371 32-164	13	30	UNSPK: P301427			

*- Outside of specification

- (1) The result for one or both determinations was less than five times the LOQ.
- (2) The unspiked result was more than four times the spike added.

Quality Control Summary

Client Name: Chevron
Reported: 03/24/08 at 04:58 PM

Group Number: 1081382

Sample Matrix Quality Control

Unspiked (UNSPK) = the sample used in conjunction with the matrix spike
Background (BKG) = the sample used in conjunction with the duplicate

Analysis Name	MS %REC	MSD %REC	MS/MSD Limits	RPD RPD	RPD MAX	BKG Conc	DUP Conc	DUP RPD	Dup RPD Max
Methyl Tertiary Butyl Ether	99	103	69-127	4	30				
Benzene	102	106	83-128	4	30				
Toluene	108	113	83-127	4	30				
Ethylbenzene	106	110	82-129	3	30				
Xylene (Total)	103	108	82-130	5	30				

Batch number: Z080812AA	Sample number(s): 5302364	UNSPK: P302359
Methyl Tertiary Butyl Ether	103	105
Benzene	102	104
Toluene	109	111
Ethylbenzene	108	111
Xylene (Total)	107	108

Surrogate Quality Control

Surrogate recoveries which are outside of the QC window are confirmed unless attributed to dilution or otherwise noted on the Analysis Report.

Analysis Name: TPH-DRO (Waters)
Batch number: 080750024A
Orthoterphenyl

5302365	67
5302366	80
5302367	74
5302368	70
5302369	70
5302370	81
5302371	86
Blank	82
LCS	102
LCSD	104

Limits: 59-131

Analysis Name: TPH-GRO - Waters
Batch number: 08076A08A
Trifluorotoluene-F

5302370	86
5302371	94
Blank	82
LCS	90
LCSD	83
MS	90

Limits: 63-135

Analysis Name: TPH-GRO - Waters
Batch number: 08077A51A

*- Outside of specification

- (1) The result for one or both determinations was less than five times the LOQ.
- (2) The unspiked result was more than four times the spike added.

Quality Control Summary

Client Name: Chevron
Reported: 03/24/08 at 04:58 PM

Group Number: 1081382

Surrogate Quality Control

Trifluorotoluene-F

5302364	110
5302365	106
5302366	114
5302367	105
5302368	105
Blank	110
LCS	104
LCS D	108
MS	103

Limits: 63-135

Analysis Name: TPH-GRO - Waters
Batch number: 08078A51A
Trifluorotoluene-F

5302369	111
Blank	107
LCS	105
LCS D	111
MS	108

Limits: 63-135

Analysis Name: BTEX, MTBE, ETOH
Batch number: Z080801AA
Dibromofluoromethane

	Dibromofluoromethane	1,2-Dichloroethane-d4	Toluene-d8	4-Bromofluorobenzene
5302365	92	96	98	92
5302366	91	95	100	94
5302367	94	96	98	92
5302368	94	97	100	91
5302369	92	95	99	93
5302370	94	97	98	91
5302371	92	95	105	96
Blank	92	96	101	92
LCS	92	95	101	97
MS	92	96	101	97
MSD	92	96	102	97

Limits: 80-116

77-113

80-113

78-113

Analysis Name: BTEX+MTBE by 8260B
Batch number: Z080812AA
Dibromofluoromethane

	Dibromofluoromethane	1,2-Dichloroethane-d4	Toluene-d8	4-Bromofluorobenzene
5302364	98	105	107	97
Blank	97	106	106	98
LCS	97	107	107	101
MS	98	106	106	100
MSD	98	108	106	100

Limits: 80-116

77-113

80-113

78-113

*- Outside of specification

- (1) The result for one or both determinations was less than five times the LOQ.
- (2) The unspiked result was more than four times the spike added.

Quality Control Summary

Client Name: Chevron
Reported: 03/24/08 at 04:58 PM

Group Number: 1081382

*- Outside of specification

- (1) The result for one or both determinations was less than five times the LOQ.
- (2) The unspiked result was more than four times the spike added.

Lancaster Laboratories Explanation of Symbols and Abbreviations

The following defines common symbols and abbreviations used in reporting technical data:

N.D.	none detected	BMQL	Below Minimum Quantitation Level
TNTC	Too Numerous To Count	MPN	Most Probable Number
IU	International Units	CP Units	cobalt-chloroplatinate units
umhos/cm	micromhos/cm	NTU	nephelometric turbidity units
C	degrees Celsius	F	degrees Fahrenheit
Cal	(diet) calories	lb.	pound(s)
meq	milliequivalents	kg	kilogram(s)
g	gram(s)	mg	milligram(s)
ug	microgram(s)	l	liter(s)
ml	milliliter(s)	ul	microliter(s)
m3	cubic meter(s)	fib >5 um/ml	fibers greater than 5 microns in length per ml
<	less than – The number following the sign is the <u>limit of quantitation</u> , the smallest amount of analyte which can be reliably determined using this specific test.		
>	greater than		
ppm	parts per million – One ppm is equivalent to one milligram per kilogram (mg/kg), or one gram per million grams. For aqueous liquids, ppm is usually taken to be equivalent to milligrams per liter (mg/l), because one liter of water has a weight very close to a kilogram. For gases or vapors, one ppm is equivalent to one microliter of gas per liter of gas.		
ppb	parts per billion		
Dry weight basis	Results printed under this heading have been adjusted for moisture content. This increases the analyte weight concentration to approximate the value present in a similar sample without moisture.		

U.S. EPA data qualifiers:

Organic Qualifiers

A	TIC is a possible aldol-condensation product
B	Analyte was also detected in the blank
C	Pesticide result confirmed by GC/MS
D	Compound quantitated on a diluted sample
E	Concentration exceeds the calibration range of the instrument
J	Estimated value
N	Presumptive evidence of a compound (TICs only)
P	Concentration difference between primary and confirmation columns >25%
U	Compound was not detected
X,Y,Z	Defined in case narrative

Inorganic Qualifiers

B	Value is <CRDL, but ≥IDL
E	Estimated due to interference
M	Duplicate injection precision not met
N	Spike amount not within control limits
S	Method of standard additions (MSA) used for calculation
U	Compound was not detected
W	Post digestion spike out of control limits
*	Duplicate analysis not within control limits
+	Correlation coefficient for MSA <0.995

Analytical test results for methods listed on the laboratories' accreditation scope meet all requirements of NELAC unless otherwise noted under the individual analysis.

Tests results relate only to the sample tested. Clients should be aware that a critical step in a chemical or microbiological analysis is the collection of the sample. Unless the sample analyzed is truly representative of the bulk of material involved, the test results will be meaningless. If you have questions regarding the proper techniques of collecting samples, please contact us. We cannot be held responsible for sample integrity, however, unless sampling has been performed by a member of our staff. This report shall not be reproduced except in full, without the written approval of the laboratory.

WARRANTY AND LIMITS OF LIABILITY – In accepting analytical work, we warrant the accuracy of test results for the sample as submitted. THE FOREGOING EXPRESS WARRANTY IS EXCLUSIVE AND IS GIVEN IN LIEU OF ALL OTHER WARRANTIES, EXPRESSED OR IMPLIED. WE DISCLAIM ANY OTHER WARRANTIES, EXPRESSED OR IMPLIED, INCLUDING A WARRANTY OF FITNESS FOR PARTICULAR PURPOSE AND WARRANTY OF MERCHANTABILITY. IN NO EVENT SHALL LANCASTER LABORATORIES BE LIABLE FOR INDIRECT, SPECIAL, CONSEQUENTIAL, OR INCIDENTAL DAMAGES INCLUDING, BUT NOT LIMITED TO, DAMAGES FOR LOSS OF PROFIT OR GOODWILL REGARDLESS OF (A) THE NEGLIGENCE (EITHER SOLE OR CONCURRENT) OF LANCASTER LABORATORIES AND (B) WHETHER LANCASTER LABORATORIES HAS BEEN INFORMED OF THE POSSIBILITY OF SUCH DAMAGES. We accept no legal responsibility for the purposes for which the client uses the test results. No purchase order or other order for work shall be accepted by Lancaster Laboratories which includes any conditions that vary from the Standard Terms and Conditions of Lancaster Laboratories and we hereby object to any conflicting terms contained in any acceptance or order submitted by client.