



GETTLER-RYAN INC.

RECEIVED

2:24 pm, Jan 22, 2008

Alameda County
Environmental Health

TRANSMITTAL

January 18, 2008

G-R #386956

TO: Ms. Charlotte Evans
Conestoga-Rovers & Associates
5900 Hollis Street, Suite A
Emeryville, California 94608

CC: Mr. Ian Robb
Chevron Environmental
Management Company
P.O. Box 6012, Room K2196
San Ramon, California 94583

FROM: Deanna L. Harding
Project Coordinator
Gettler-Ryan Inc.
6747 Sierra Court, Suite J
Dublin, California 94568

RE: **Former Texaco Service Station**
3810 Broadway
Oakland, California
(Site #211283)
RO 0000056

WE HAVE ENCLOSED THE FOLLOWING:

COPIES	DATED	DESCRIPTION
1	January 16, 2008	Groundwater Monitoring and Sampling Report Fourth Quarter Event of December 18, 2007

COMMENTS:

Pursuant to your request, we are providing you with a copy of the above referenced report for **your use and distribution to the following (via PDF):**

Mr. Barney Chan, Alameda County Health Care Services, Dept. of Environmental Health, 1131 Harbor Bay Parkway, Suite 250, Alameda, CA 94502-6577 (**Distributed by Conestoga-Rovers via PDF**)

Please provide any comments/changes and propose any groundwater monitoring modifications for the next event prior to **February 1, 2008**, at which time this final report will be distributed to the following:

cc: Mr. Joe Zadik, 8255 San Leandro Street, Oakland, CA 94621

Enclosures



Ian Robb
Project Manager
Marketing Business Unit

**Chevron Environmental
Management Company**
6001 Bollinger Canyon Road
San Ramon, CA 94583
Tel (925) 842-9496
Fax (925) 842-8370
ianrobb@chevron.com

January 18, 2008

Alameda County Health Care Services
1131 Harbor Bay Parkway, Suite 250
Alameda, CA 94502-6577

RE: Chevron Service Station # - 211283

Address 3810 Broadway, Oakland, California

I have reviewed the attached routine groundwater monitoring report dated January 18, 2008.

I agree with the conclusions and recommendations presented in the referenced report. The information in this report is accurate to the best of my knowledge and all local Agency/Regional Board guidelines have been followed. This report was prepared by Gettler-Ryan Inc., upon whose assistance and advice I have relied.

This letter is submitted pursuant to the requirements of California Water Code section 13267(b) (1) and the regulating implementation entitled Appendix A pertaining thereto.

I declare under penalty of perjury that the foregoing is true and correct.

Sincerely,

A handwritten signature in black ink, appearing to read "I. Robb", written in a cursive style.

Ian Robb

Attachment: Report

WELL CONDITION STATUS SHEET

Client/Facility #: Chevron #211283
 Site Address: 3810 Broadway
 City: Oakland, CA

Job # 386956
 Event Date: 12/18/05
 Sampler: S 41

WELL ID	Vault Frame Condition	Gasket/O-Ring (M)missing	BOLTS (M) Missing (R) Replaced	Bolt Flanges B= Broken S= Stripped R=Retap	APRON Condition C=Cracked B=Broken G=Gone	Grout Seal (Deficient) inches from TOC	Casing (Condition prevents tight cap seal)	REPLACE LOCK Y/N	REPLACE CAP Y/N	WELL VAULT Manufacture/Size/ # of Bolts	Pictures Taken Yes / No
MW-1	OK		→	2S	OK				→	Emco 3/6" / 2	
MW-4	OK								→	Emco / 12" / 2	
MW-5B	OK								→	BL / 3" / 3	
MW-6	OK								→	Emco / 12" / 2	
MW-7	OK		→	2S	OK				→	3/8" / 2	
MW-9	OK								→	3/8" / 2	
MW-10	(Under water)									Emco / 12" / 2	
MW-12	(Under water)									3/8" / 2 Emco / 12" / 2	
MW-11	OK		1M	1B	OK				→	Emco / 12" / 2	

Comments _____



GETTLER-RYAN Inc.

January 16, 2008
G-R Job #386956

Mr. Ian Robb
Chevron Environmental Management Company
P.O. Box 6012, Room K2196
San Ramon, CA 94583

RE: Fourth Quarter Event of December 18, 2007
Groundwater Monitoring & Sampling Report
Former Texaco Service Station
3810 Broadway
Oakland, California
(Site #211283)

Dear Mr. Robb:

This report documents the most recent groundwater monitoring and sampling event performed by Gettler-Ryan Inc. (G-R) at the referenced site. All field work was conducted in accordance with G-R Standard Operating Procedure - Groundwater Sampling (attached).

Static groundwater levels were measured and the wells were checked for the presence of separate-phase hydrocarbons. Static water level data, groundwater elevations, and separate-phase hydrocarbon thickness (if any) are presented in the attached Table 1. A Potentiometric Map is included as Figure 1.

Groundwater samples were collected from the monitoring wells and submitted to a state certified laboratory for analyses. The field data sheets for this event are attached. Analytical results are presented in the table(s) listed below. The chain of custody document and laboratory analytical report are also attached.

Please call if you have any questions or comments regarding this report. Thank you.

Sincerely,

Deanna L. Harding
Project Coordinator

Douglas J. Lee
Senior Geologist, P.G. No. 6882

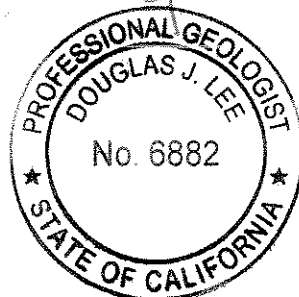

- Figure 1: Potentiometric Map
- Table 1: Groundwater Monitoring Data and Analytical Results
- Table 2: Field Measurements
- Attachments: Standard Operating Procedure - Groundwater Sampling
Field Data Sheets
Chain of Custody Document and Laboratory Analytical Reports

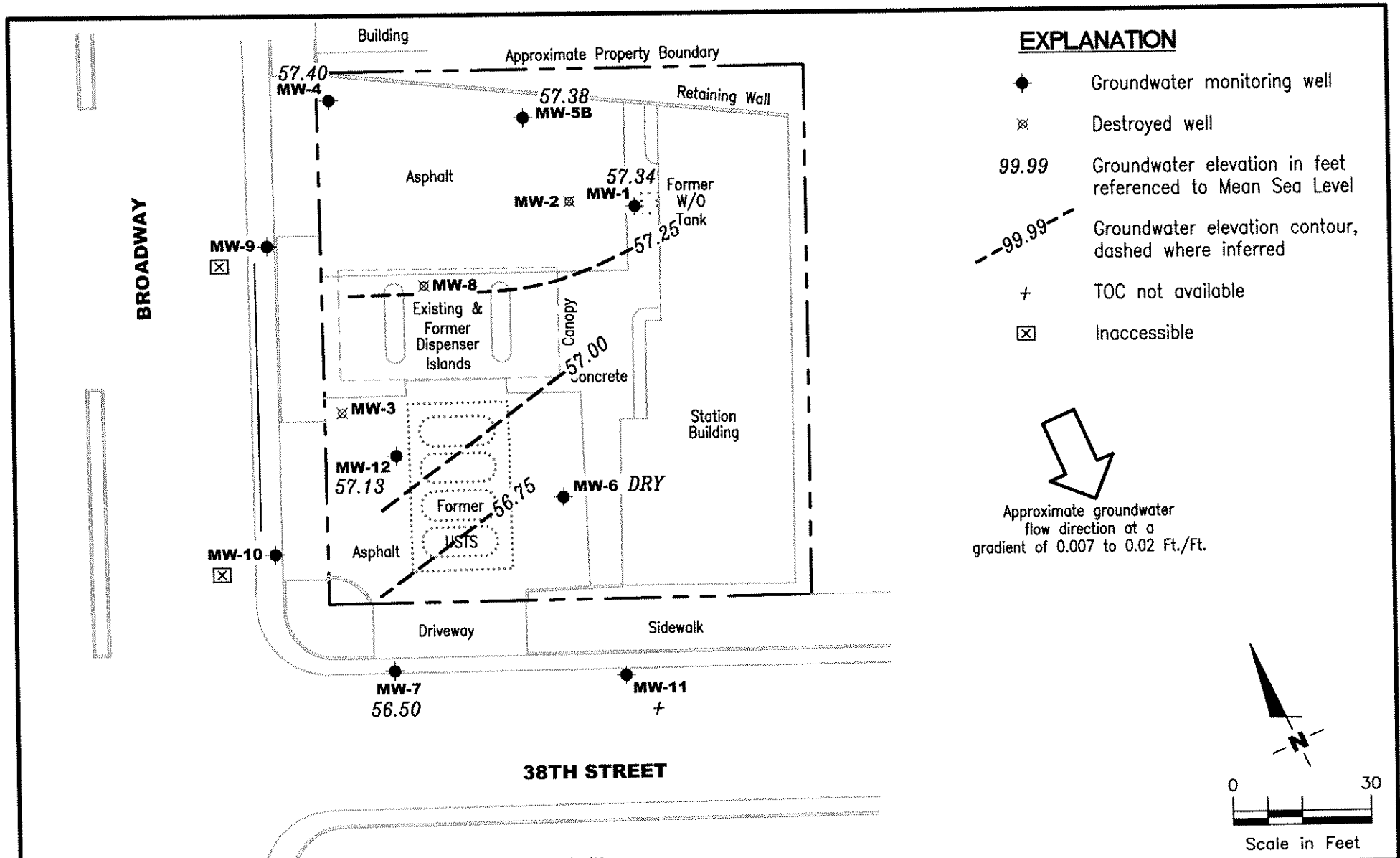

Source: Figure modified from drawing provided by Delta Environmental and Morrow Surveying dated 06/24/02

FIGURE

GETTLER - RYAN INC.
 6747 Sierra Court, Suite J
 Dublin, CA 94568 (925) 551-7555

POTENTIOMETRIC MAP
 Former Texaco Service Station
 3810 Broadway
 Oakland, California (Site #211283)

1

PROJECT NUMBER
 386956

REVIEWED BY

DATE
 December 18, 2007

REVISED DATE

Table 1
Groundwater Monitoring Data and Analytical Results
Former Texaco Service Station (Site #211283)
3810 Broadway
Oakland, California

WELL ID/ DATE	TOC* (ft.)	DTW (ft.)	GWE (msl)	SPHT (ft.)	TPH-D (ppb)	TPH-G (ppb)	B (ppb)	T (ppb)	E (ppb)	X (ppb)	MTBE by	MTBE by	ETHANOL (ppb)
											8021◆ (ppb)	8260 (ppb)	
MW-1													
06/28/96	86.69	21.77	64.92	--	<50	<100	<0.5	<1.0	<1.0	<2.0	--	--	--
10/10/96	86.69	23.26	63.43	--	<400	520	9.2	53	17	70	22	16 ¹	--
11/07/96	86.69	23.27	63.42	--	--	--	--	--	--	--	--	--	--
12/18/97	86.69	19.70	66.99	--	<50	2,200	<3.0	<3.0	<3.0	<3.0	<200	--	--
04/06/98	86.69	16.88	69.81	--	<50	1,600	16.4	0.8	<0.5	<0.5	38.3	--	--
06/18/98	86.69	19.78	66.91	--	280	330	7.8	<0.5	<0.5	<0.5	<0.5	--	--
08/31/98	86.69	21.71	64.98	--	150	<50	1.5	<0.5	<0.5	<0.5	<2.5	--	--
12/21/98	86.69	22.15	64.54	--	130	130	2.3	0.90	<0.5	<0.5	110	13	--
03/24/99	86.69	19.55	67.14	--	305	1,520	11.7	<2.50	<2.50	<2.50	21.6	<25.0	--
06/25/99	86.69	21.60	65.09	--	207	231	5.29	<0.500	<0.500	<0.500	3.94	1.01	--
09/24/99	86.69	22.58	64.11	--	71.7	58.6	6.03	<0.500	<0.500	<0.500	3.70	--	--
12/29/99	86.69	22.81	63.88	--	345	117	4.26	<0.500	<0.500	1.97	26.2	<0.500	--
03/21/00	86.69	19.00	67.69	--	319	834	<0.500	<0.500	<0.500	<0.500	21.5	--	--
07/26/00	86.69	21.50	65.19	--	125	<50.0	<0.500	<0.500	<0.500	<0.500	<2.50	--	--
09/06/00	86.69	21.90	64.79	--	192	88.1	15.60	<0.500	<0.500	<0.500	--	--	--
11/29/00	86.92	22.05	64.87	--	331	<50.0	3.52	<0.500	<0.500	<0.500	--	--	--
03/06/01	86.92	19.79	67.13	--	--	--	--	--	--	--	--	--	--
03/23/01	86.92	20.15	66.77	--	-- ⁵	204	10.7	<0.500	<0.500	<0.500	--	--	--
06/19/01 ⁶	86.92	21.78	65.14	--	330	<50	<0.50	<0.50	<0.50	<0.50	--	0.87	--
09/05/01 ⁶	86.92	24.37	62.55	--	400	74	<0.50	0.63	<0.50	2.7	--	<5.0	--
12/20/01 ⁶	86.92	20.25	66.67	--	530	59	1.7	<0.50	<0.50	<0.50	--	<5.0	--
06/25/02	86.69	21.64	65.05	0.00	490 ⁹	<50	<0.50	<0.50	<0.50	<1.5	<2.5	--	--
09/18/02	86.69	22.44	64.25	0.00	180	<50	<0.50	<0.50	<0.50	<1.5	<2.5	--	--
12/19/02	86.69	21.49	65.20	0.00	320	<50	<0.50	<0.50	<0.50	<1.5	<2.5	--	--
03/20/03	86.69	20.92	65.77	0.00	UNABLE TO SAMPLE - BEND IN WELL					--	--	--	--
06/23/03 ¹⁰	86.69	21.34	65.35	0.00	310	<50	<0.5	<0.5	<0.5	<0.5	--	<0.5	--
09/22/03 ¹⁰	86.69	22.46	64.23	0.00	150	<50	<0.5	<0.5	<0.5	<0.5	--	<0.5	<50
12/22/03 ¹⁰	86.69	22.10	64.59	0.00	350	<50	<0.5	<0.5	<0.5	<0.5	--	<0.5	<50
03/22/04 ¹⁰	86.69	20.42	66.27	0.00	270	<50	<0.5	<0.5	<0.5	<0.5	--	2	<50
06/21/04 ¹⁰	86.69	21.93	64.76	0.00	130	<50	<0.5	<0.5	<0.5	<0.5	--	<0.5	<50
09/20/04 ¹⁰	86.69	22.99	63.70	0.00	240	<50	<0.5	<0.5	<0.5	<0.5	--	<0.5	<50
12/20/04 ¹⁰	86.69	21.78	64.91	0.00	320 ⁹	<50	<0.5	<0.5	<0.5	<0.5	--	<0.5	<50
03/28/05 ¹⁰	86.69	19.28	67.41	0.00	400 ⁹	<50	<0.5	<0.5	<0.5	<0.5	--	0.6	<50
06/27/05 ¹⁰	86.69	20.82	65.87	0.00	200 ¹²	<50	<0.5	<0.5	<0.5	<0.5	--	<0.5	<50

Table 1
Groundwater Monitoring Data and Analytical Results
Former Texaco Service Station (Site #211283)
3810 Broadway
Oakland, California

WELL ID/ DATE	TOC* (ft.)	DTW (ft.)	GWE (msl)	SPHT (ft.)	TPH-D (ppb)	TPH-G (ppb)	B (ppb)	T (ppb)	E (ppb)	X (ppb)	MTBE by	MTBE by	ETHANOL (ppb)	
											8021♦ (ppb)	8260 (ppb)		
MW-1 (cont)														
09/19/05 ¹⁰	86.69	22.17	64.52	0.00	62	<50	<0.5	<0.5	<0.5	<0.5	--	<0.5	<50	
12/19/05 ¹⁰	86.69	22.06	64.63	0.00	360 ¹⁶	<50	<0.5	0.8	<0.5	<0.5	--	<0.5	<50	
03/27/06 ¹⁰	86.69	18.27	68.42	0.00	320	77	<0.5	0.5	2	4	--	0.7	<50	
06/26/06 ¹⁰	86.69	20.20	66.49	0.00	290	<50	<0.5	<0.5	<0.5	<0.5	--	<0.5	<50	
09/25/06 ¹⁰	86.69	21.86	64.83	0.00	270	<50	<0.5	<0.5	<0.5	<0.5	--	<0.5	<50	
12/18/06	86.69	21.60	65.09	UNABLE TO SAMPLE - DUE TO BENT WELL CASING						--	--	--	--	--
03/19/07 ¹⁰	NP ¹⁸	86.69	20.82	65.87	0.00	630	<50	<0.5	<0.5	<0.5	<0.5	--	<0.5	<50
06/25/07 ¹⁰	NP ¹⁸	86.69	28.62	58.07	0.00	4,100 ¹⁹	<50	<0.5	<0.5	<0.5	<0.5	--	<0.5	<50
09/24/07	86.69	DRY	--	--	--	--	--	--	--	--	--	--	--	
12/18/07	86.69	29.35	57.34	UNABLE TO SAMPLE - DUE TO INSUFFICIENT WATER						--	--	--	--	
MW-4														
06/28/96	83.31	18.83	64.48	--	<50	<100	<0.5	<1.0	<1.0	<2.0	--	--	--	
10/10/96	83.31	19.84	63.47	--	<50	650	3.9	65	22	120	<5.0	--	--	
11/07/96	83.31	19.84	63.47	--	--	--	--	--	--	--	--	--	--	
12/18/97	83.31	17.77	65.54	--	2,000	<50	<0.5	<0.5	<0.5	<0.5	<30	--	--	
04/06/98	83.31	15.45	67.86	--	<50	<50	<0.5	<0.5	<0.5	<0.5	<0.5	--	--	
06/18/98	83.31	16.89	66.42	--	53	<50	<0.5	<0.5	<0.5	<0.5	<2.5	--	--	
08/31/98	83.31	18.48	64.83	--	60	<50	<0.5	<0.5	<0.5	<0.5	<2.5	--	--	
12/21/98	83.31	18.80	64.51	--	<50	<50	<0.5	<0.5	<0.5	<0.5	<2.5	--	--	
03/24/99	83.31	16.70	66.61	--	<50.0	<50.0	<0.500	<0.500	<0.500	<0.500	<2.00	--	--	
06/25/99	83.31	18.16	65.15	--	128	<50.0	<0.500	<0.500	<0.500	<0.500	<2.00	--	--	
09/24/99	83.31	19.12	64.19	--	<50.0	<50.0	<0.500	<0.500	<0.500	<0.500	<2.50	--	--	
12/29/99	83.31	19.08	64.23	--	169	<50.0	<0.500	<0.500	<0.500	<0.500	<5.00	--	--	
03/21/00	83.31	16.10	67.21	--	<50.0	<50.0	<0.500	<0.500	<0.500	<0.500	<2.50	--	--	
07/26/00	83.31	OBSTRUCTION IN WELL			--	--	--	--	--	--	--	--	--	
09/06/00	83.31	18.52	64.79	--	-- ⁵	<50.0	<0.500	<0.500	<0.500	<0.500	--	--	--	
11/29/00	83.63	18.75	64.88	--	183	<50.0	<0.500	<0.500	<0.500	<0.500	--	--	--	
03/06/01	83.63	17.81	65.82	--	50.9	<50.0	<0.500	<0.500	<0.500	<0.500	--	<0.50	--	
06/19/01 ⁶	83.63	18.55	65.08	--	<50	<50	<0.50	<0.50	<0.50	<0.50	--	<5.0	--	
09/05/01 ⁶	83.63	19.10	64.53	--	710	<50	<0.50	<0.50	<0.50	<0.50	--	<5.0	--	
12/20/01 ⁶	83.63	17.55	66.08	--	460	<50	<0.50	<0.50	<0.50	<0.50	--	<5.0	--	
06/25/02	83.31	18.39	64.92	0.00	250	<50	<0.50	<0.50	<0.50	<1.5	<2.5	--	--	

Table 1
Groundwater Monitoring Data and Analytical Results
Former Texaco Service Station (Site #211283)
3810 Broadway
Oakland, California

WELL ID/ DATE	TOC* (ft.)	DTW (ft.)	GWE (msl)	SPHT (ft.)	TPH-D (ppb)	TPH-G (ppb)	B (ppb)	T (ppb)	E (ppb)	X (ppb)	MTBE by 8021♦ (ppb)	MTBE by 8260 (ppb)	ETHANOL (ppb)
MW-4 (cont)													
09/18/02	83.31	19.16	64.15	0.00	160	<50	<0.50	<0.50	<0.50	<1.5	<2.5	--	--
12/19/02	83.31	18.14	65.17	0.00	56	<50	<0.50	<0.50	<0.50	<1.5	<2.5	--	--
03/20/03	83.31	17.76	65.55	0.00	180	<50	<0.50	<0.50	<0.50	<1.5	<2.5	--	--
06/23/03 ¹⁰	83.31	18.13	65.18	0.00	<50	<50	<0.5	<0.5	<0.5	<0.5	--	<0.5	--
09/22/03 ¹⁰	83.31	19.08	64.23	0.00	110	<50	<0.5	<0.5	<0.5	<0.5	--	<0.5	<50
12/22/03 ¹⁰	83.31	18.78	64.53	0.00	<50	<50	<0.5	<0.5	<0.5	<0.5	--	<0.5	<50
03/22/04 ¹⁰	83.31	17.31	66.00	0.00	130	<50	<0.5	<0.5	<0.5	<0.5	--	<0.5	<50
06/21/04 ¹⁰	83.31	18.67	64.64	0.00	87	<50	<0.5	<0.5	<0.5	<0.5	--	<0.5	<50
09/20/04 ¹⁰	83.31	19.58	63.73	0.00	120	<50	<0.5	<0.5	<0.5	<0.5	--	<0.5	<50
12/20/04 ¹⁰	83.31	18.59	64.72	0.00	66 ⁹	<50	<0.5	<0.5	<0.5	<0.5	--	<0.5	<50
03/28/05 ¹⁰	83.31	16.82	66.49	0.00	71 ⁹	<50	<0.5	<0.5	<0.5	<0.5	--	<0.5	<50
06/27/05 ¹⁰	83.31	17.61	65.70	0.00	120 ¹²	<50	<0.5	<0.5	<0.5	<0.5	--	<0.5	<50
09/19/05 ¹⁰	83.31	19.00	64.31	0.00	<50	<50	<0.5	<0.5	<0.5	<0.5	--	<0.5	<50
12/19/05 ¹⁰	83.31	18.69	64.62	0.00	<50	<50	<0.5	<0.5	<0.5	<0.5	--	<0.5	<50
03/27/06 ¹⁰	83.31	15.05	68.26	0.00	160	<50	<0.5	<0.5	<0.5	<0.5	--	<0.5	<50
06/26/06 ¹⁰	83.31	16.81	66.50	0.00	110	<50	<0.5	<0.5	<0.5	<0.5	--	<0.5	<50
09/25/06 ¹⁰	83.31	18.59	64.72	0.00	120	<50	<0.5	<0.5	<0.5	<0.5	--	<0.5	<50
12/18/06 ¹⁰	83.31	18.26	65.05	0.00	250	<50	<0.5	<0.5	<0.5	<0.5	--	<0.5	<50
03/19/07 ¹⁰	83.31	17.62	65.69	0.00	93	<50	<0.5	<0.5	<0.5	<0.5	--	<0.5	<50
06/25/07 ¹⁰	83.31	24.82	58.49	0.00	4,600 ¹⁹	<50	<0.5	<0.5	<0.5	<0.5	--	<0.5	<50
09/24/07 ¹⁰	83.31	26.76	56.55	0.00	4,300	94	<0.5	<0.5	<0.5	<0.5	--	0.6	<50
12/18/07 ¹⁰	83.31	25.91	57.40	0.00	3,700	<50	<0.5	<0.5	<0.5	<0.5	--	0.6	<50
MW-5B													
06/25/02 ⁷	85.36	20.48	64.88	0.00	320	660	89	1.9	39	11	130	--	--
09/18/02	85.36	21.18	64.18	0.00	480	1,100	220	1.2	19	<1.5	35	--	--
12/19/02	85.36	20.36	65.00	0.00	330	<50	<0.50	<0.50	<0.50	<1.5	190	--	--
03/20/03	85.36	INACCESSIBLE - VEHICLE OVER WELL				--	--	--	--	--	--	--	--
06/23/03 ¹⁰	85.36	20.18	65.18	0.00	300	<50	<0.5	<0.5	<0.5	<0.5	--	290	--
09/22/03 ¹⁰	85.36	21.19	64.17	0.00	200	91	19	<0.5	3	<0.5	--	260	<50
12/22/03 ¹⁰	85.36	20.85	64.51	0.00	410	99	18	<0.5	<0.5	<0.5	--	52	<50
03/22/04 ¹⁰	85.36	19.26	66.10	0.00	400	<50	<0.5	<0.5	<0.5	<0.5	--	210	<50
06/21/04 ¹⁰	85.36	20.70	64.66	0.00	270	<50	<0.5	<0.5	<0.5	<0.5	--	100	<50

Table 1
Groundwater Monitoring Data and Analytical Results
Former Texaco Service Station (Site #211283)
3810 Broadway
Oakland, California

WELL ID/ DATE	TOC* (ft.)	DTW (ft.)	GWE (msl)	SPHT (ft.)	TPH-D (ppb)	TPH-G (ppb)	B (ppb)	T (ppb)	E (ppb)	X (ppb)	MTBE by 8021♦ (ppb)	MTBE by 8260 (ppb)	ETHANOL (ppb)
MW-5B (cont)													
09/20/04 ¹⁰	85.36	21.69	63.67	0.00	430	<50	<0.5	<0.5	<0.5	<0.5	--	9	<50
12/20/04 ¹⁰	85.36	20.56	64.80	0.00	400 ⁹	<50	<0.5	<0.5	<0.5	<0.5	--	48	<50
03/28/05 ¹⁰	85.36	18.12	67.24	0.00	480 ⁹	<50	<0.5	<0.5	<0.5	<0.5	--	67	<50
06/27/05 ¹⁰	85.36	19.61	65.75	0.00	350 ¹³	<50	<0.5	<0.5	<0.5	<0.5	--	57	<50
09/19/05 ¹⁰	85.36	20.88	64.48	0.00	220	<50	<0.5	<0.5	<0.5	<0.5	--	32	<50
12/19/05 ¹⁰	85.36	20.74	64.62	0.00	330 ¹⁶	<50	<0.5	<0.5	<0.5	<0.5	--	21	<50
03/27/06 ¹⁰	85.36	17.10	68.26	0.00	550	<50	<0.5	<0.5	<0.5	<0.5	--	31	<50
06/26/06 ¹⁰	85.36	19.05	66.31	0.00	410	<50	<0.5	<0.5	<0.5	<0.5	--	30	<50
09/25/06 ¹⁰	85.36	20.61	64.75	0.00	320	<50	<0.5	<0.5	<0.5	<0.5	--	25	<50
12/18/06 ¹⁰	85.36	20.35	65.01	0.00	580	<50	<0.5	<0.5	<0.5	<0.5	--	14	<50
03/19/07 ¹⁰	85.36	19.62	65.74	0.00	170	<50	<0.5	<0.5	<0.5	<0.5	--	24	<50
06/25/07 ¹⁰	85.36	26.94	58.42	0.00	950 ¹⁹	250 ¹⁹	2	<0.5	0.6	1	--	15	<50
09/24/07 ¹⁰	85.36	28.78	56.58	0.00	1,300	1,900	5	0.6	3	5	--	25	<50
12/18/07 ¹⁰	85.36	27.98	57.38	0.00	560	2,100	19	<0.5	2	4	--	28	<50
MW-6													
10/10/96	86.09	22.44	63.65	--	500	45,000	8,300	2,900	810	3,100	190	40 ¹	--
11/07/96	86.09	22.60	63.49	--	--	--	--	--	--	--	--	--	--
12/18/97	86.09	22.28	63.81	--	1,900	60,000	12,000	9,800	1,800	8,600	<2,000	--	--
04/06/98	86.09	19.90	66.19	--	<50	30,500	5,950	3,720	952	3,750	<1,000	--	--
06/18/98	86.09	20.49	65.60	--	1,100	23,000	2,600	540	410	1,300	<250	--	--
08/31/98	86.09	21.05	65.04	--	1,800	17,000	3,400	460	530	1,800	<250	--	--
12/21/98	86.09	21.74	64.35	--	930	7,900	1,900	510	280	730	150	2.6	--
03/24/99	86.09	21.18	64.91	--	763	12,200	1,970	327	338	794	<40.0	<50.0	--
06/25/99	86.09	21.34	64.75	--	1,050	14,800	2,040	1,080	406	1,430	<40.0	--	--
09/24/99	86.09	22.28	63.81	--	1,720	17,200	2,810	1,330	489	2,340	<50.0	--	--
12/29/99	86.09	24.96	61.13	--	1,480	14,700	2,790	974	469	1,720	<500	--	--
03/21/00	86.09	18.70	67.39	--	1,120	20,000	4,160	962	719	2,330	<250	--	--
07/26/00	86.09	INACCESSIBLE	--	--	--	--	--	--	--	--	--	--	--
09/06/00	86.09	INACCESSIBLE	--	--	--	--	--	--	--	--	--	--	--
11/29/00	86.48	21.30	65.18	--	2,060	22,800	4,120	2,010	872	3,180	--	--	--
03/06/01	86.48	19.05	67.43	--	2,220	32,100	3,760	4,590	1,160	5,360	--	--	--
06/19/01 ⁶	86.48	21.11	65.37	--	<1,500	40,000	2,800	6,000	1,200	5,300	--	<25	--

Table 1
Groundwater Monitoring Data and Analytical Results
Former Texaco Service Station (Site #211283)
3810 Broadway
Oakland, California

WELL ID/ DATE	TOC* (ft.)	DTW (ft.)	GWE (msl)	SPHT (ft.)	TPH-D (ppb)	TPH-G (ppb)	B (ppb)	T (ppb)	E (ppb)	X (ppb)	MTBE by	MTBE by	ETHANOL (ppb)
											8021♦ (ppb)	8260 (ppb)	
MW-6 (cont)													
09/05/01 ⁶	86.48	21.37	65.11	--	<1,000	18,000	3,800	800	730	1,400	--	<200	--
12/20/01 ⁶	86.48	19.80	66.68	--	<1,300	29,000	2,600	3,700	1,100	4,100	--	<100	--
06/25/02	86.09	21.13	64.96	0.00	2,500	21,000	2,200	1,800	850	2,100	<100	--	--
09/18/02	86.09	22.00	64.09	0.00	1,300	13,000	1,700	480	610	970	110	--	--
12/19/02	86.09	20.98	65.11	0.00	2,700	20,000	2,900	620	770	2,100	<20	--	--
03/20/03	86.09	20.23	65.86	0.00	2,600	23,000	1,500	2,200	920	3,400	<100	--	--
06/23/03 ¹⁰	86.09	20.96	65.13	0.00	2,400	21,000	2,000	1,400	890	2,500	--	6	--
09/22/03 ¹⁰	86.09	21.95	64.14	0.00	1,800	7,400	920	220	360	580	--	5	<50
12/22/03 ¹⁰	86.09	21.63	64.46	0.00	2,300	9,700	1,700	240	450	1,000	--	6	<100 ¹¹
03/22/04 ¹⁰	86.09	20.31	65.78	0.00	2,700	23,000	1,500	1,400	830	2,800	--	4	<250
06/21/04 ¹⁰	86.09	20.64	65.45	0.00	2,800	20,000	2,000	2,300	1,100	3,800	--	4	<130
09/20/04 ¹⁰	86.09	22.29	63.80	0.00	1,300	4,600	480	65	200	260	--	4	<100
12/20/04 ¹⁰	86.09	21.33	64.76	0.00	1,500	9,500	1,500	220	450	840	--	5	<250
03/28/05 ¹⁰	86.09	19.65	66.44	0.00	2,400 ⁹	13,000	1,100	550	600	1,600	--	3	<250
06/27/05 ¹⁰	86.09	19.86	66.23	0.00	2,100 ¹⁴	15,000	1,100	1,300	790	2,600	--	3	<100
09/19/05 ¹⁰	86.09	20.49	65.60	0.00	2,300	18,000	1,300	1,200	800	2,500	--	3	<100
12/19/05 ¹⁰	86.09	21.49	64.60	0.00	1,900 ¹⁴	13,000	1,900	190	620	890	--	5	110
03/27/06 ¹⁰	86.09	18.28	67.81	0.00	1,300	14,000	740	420	600	1,400	--	2	<50
06/26/06 ¹⁰	86.09	19.08	67.01	0.00	2,300	23,000	660	1,700	870	3,000	--	<3	<250
09/25/06 ¹⁰	86.09	20.02	66.07	0.00	2,100	18,000	580	1,200	760	2,600	--	1	<100
12/18/06 ¹⁰	86.09	20.57	65.52	0.00	2,700	14,000	1,200	370	680	1,300	--	4	<50
03/19/07 ¹⁰	86.09	20.56	65.53	0.00	2,700	17,000	990	560	840	2,100	--	3	<100
06/25/07	86.09	DRY	--	--	--	--	--	--	--	--	--	--	--
09/24/07	86.09	DRY	--	--	--	--	--	--	--	--	--	--	--
12/18/07	86.09	DRY	--	--	--	--	--	--	--	--	--	--	--
MW-7													
10/10/96	84.11	20.78	63.33	--	<50	<50	0.6	<0.5	<0.5	<0.5	<5.0	--	--
11/07/96	84.11	20.80	63.31	--	--	--	--	--	--	--	--	--	--
12/18/97	84.11	17.27	66.84	--	<50	<50	<0.5	<0.5	<0.5	<0.5	<30	--	--
04/06/98	84.11	15.91	68.20	--	<50	<50	<0.5	<0.5	<0.5	<0.5	<30	--	--
06/18/98	84.11	17.95	66.16	--	<50	<50	<0.5	<0.5	<0.5	<0.5	<0.5	--	--
08/31/98	84.11	19.40	64.71	--	<50	<50	<0.5	<0.5	<0.5	<0.5	<2.5	--	--

Table 1
Groundwater Monitoring Data and Analytical Results
Former Texaco Service Station (Site #211283)
3810 Broadway
Oakland, California

WELL ID/ DATE	TOC* (ft.)	DTW (ft.)	GWE (msl)	SPHT (ft.)	TPH-D (ppb)	TPH-G (ppb)	B (ppb)	T (ppb)	E (ppb)	X (ppb)	MTBE by	MTBE by	ETHANOL (ppb)
											8021♦ (ppb)	8260 (ppb)	
MW-7 (cont)													
12/21/98	84.11	19.75	64.36	--	<50	<50	<0.5	<0.5	<0.5	<0.5	<2.5	--	--
03/24/99	84.11	17.54	66.57	--	51.3	<50.0	<0.500	<0.500	<0.500	<0.500	<2.00	--	--
06/25/99	84.11	19.22	64.89	--	<50.0	<50.0	<0.500	<0.500	<0.500	<0.500	<2.00	--	--
09/24/99	84.11	20.18	63.93	--	<50.0	<50.0	<0.500	<0.500	<0.500	<0.500	<2.50	--	--
12/29/99	84.11	20.15	63.96	--	99.0	<50.0	<0.500	<0.500	<0.500	<0.500	<5.00	--	--
03/21/00	84.11	16.35	67.76	--	<50.0	<50.0	<0.500	<0.500	<0.500	<0.500	<2.50	--	--
07/26/00	84.11	18.99	65.12	--	<50.0	<50.0	<0.500	<0.500	<0.500	<0.500	<2.50	--	--
09/06/00	84.11	19.49	64.62	--	-- ⁵	<50.0	<0.500	<0.500	<0.500	<0.500	--	--	--
11/29/00	84.44	19.52	64.92	--	<50.0	<50.0	<0.500	<0.500	<0.500	<0.500	--	--	--
03/06/01	84.44	17.15	67.29	--	<50.0	<50.0	<0.500	<0.500	<0.500	<0.500	--	--	--
06/19/01 ⁶	84.44	19.30	65.14	--	<50	<50	<0.50	<0.50	<0.50	<0.50	--	<0.50	--
09/05/01 ⁶	84.44	20.22	64.22	--	<50	<50	0.64	0.84	0.94	5.2	--	<5.0	--
12/20/01 ⁶	84.44	17.85	66.59	--	<50	<50	<0.50	<0.50	<0.50	<0.50	--	<5.0	--
06/25/02	84.11	19.30	64.81	0.00	<50	<50	<0.50	<0.50	<0.50	<1.5	<2.5	--	--
09/18/02	84.11	20.10	64.01	0.00	170	<50	<0.50	<0.50	<0.50	<1.5	<2.5	--	--
12/19/02	84.11	18.73	65.38	0.00	<50	<50	<0.50	<0.50	<0.50	<1.5	<2.5	--	--
03/20/03	84.11	18.86	65.25	0.00	<50	<50	<0.50	<0.50	<0.50	<1.5	<2.5	--	--
06/23/03 ¹⁰	84.11	19.00	65.11	0.00	<50	<50	<0.5	<0.5	<0.5	<0.5	--	<0.5	--
09/22/03 ¹⁰	84.11	20.05	64.06	0.00	<50	<50	<0.5	<0.5	<0.5	<0.5	--	<0.5	<50
12/22/03 ¹⁰	84.11	19.72	64.39	0.00	72	<50	<0.5	<0.5	<0.5	<0.5	--	<0.5	<50
03/22/04 ¹⁰	84.11	17.94	66.17	0.00	<50	<50	<0.5	<0.5	<0.5	<0.5	--	<0.5	<50
06/21/04 ¹⁰	84.11	19.53	64.58	0.00	73	<50	<0.5	<0.5	<0.5	<0.5	--	<0.5	<50
09/20/04 ¹⁰	84.11	20.59	63.52	0.00	69	<50	<0.5	<0.5	<0.5	<0.5	--	<0.5	<50
12/20/04 ¹⁰	84.11	19.43	64.68	0.00	67 ⁹	<50	<0.5	<0.5	<0.5	<0.5	--	<0.5	<50
03/28/05 ¹⁰	84.11	16.68	67.43	0.00	69 ⁹	<50	<0.5	<0.5	<0.5	<0.5	--	<0.5	<50
06/27/05 ¹⁰	84.11	18.43	65.68	0.00	<50	<50	<0.5	<0.5	<0.5	<0.5	--	<0.5	<50
09/19/05 ¹⁰	84.11	19.77	64.34	0.00	<50	<50	<0.5	<0.5	<0.5	<0.5	--	<0.5	<50
12/19/05 ¹⁰	84.11	19.38	64.73	0.00	<50	<50	<0.5	<0.5	<0.5	<0.5	--	<0.5	<50
03/27/06 ¹⁰	84.11	15.51	68.60	0.00	<50	<50	<0.5	<0.5	<0.5	<0.5	--	<0.5	<50
06/26/06 ¹⁰	84.11	17.85	66.26	0.00	70	<50	<0.5	<0.5	<0.5	<0.5	--	<0.5	<50
09/25/06 ¹⁰	84.11	19.53	64.58	0.00	<50	<50	<0.5	<0.5	<0.5	<0.5	--	<0.5	<50
12/18/06 ¹⁰	84.11	19.28	64.83	0.00	270	<50	<0.5	<0.5	<0.5	<0.5	--	<0.5	<50
03/19/07 ¹⁰	84.11	18.32	65.79	0.00	81	<50	<0.5	<0.5	<0.5	<0.5	--	<0.5	<50

Table 1
Groundwater Monitoring Data and Analytical Results
Former Texaco Service Station (Site #211283)
3810 Broadway
Oakland, California

WELL ID/ DATE	TOC* (ft.)	DTW (ft.)	GWE (msl)	SPHT (ft.)	TPH-D (ppb)	TPH-G (ppb)	B (ppb)	T (ppb)	E (ppb)	X (ppb)	MTBE by 8021♦ (ppb)	MTBE by 8260 (ppb)	ETHANOL (ppb)
MW-7 (cont)													
06/25/07 ¹⁰	84.11	26.92	57.19	0.00	65	<50	<0.5	<0.5	<0.5	<0.5	--	1	<50
09/24/07 ¹⁰	84.11	28.32	55.79	0.00	<150	<50	<0.5	<0.5	<0.5	<0.5	--	0.7	<50
12/18/07 ¹⁰	84.11	27.61	56.50	0.00	130	<50	<0.5	<0.5	<0.5	<0.5	--	1	<50
MW-9													
10/10/96	82.17	18.62	63.55	--	520	80	2.5	13	2.2	13	<5.0	--	--
11/07/96	82.17	63.53	18.64	--	--	--	--	--	--	--	--	--	--
12/18/97	82.17	16.42	65.75	--	<50	<50	<0.5	<0.5	<0.5	<0.5	<30	--	--
04/06/98	82.17	14.00	68.17	--	<50	<50	<0.5	<0.5	<0.5	<0.5	<30	--	--
06/18/98	82.17	15.33	66.84	--	100	<50	<0.5	<0.5	<0.5	<0.5	<0.5	--	--
08/31/98	82.17	17.14	65.03	--	57	<50	<0.5	<0.5	<0.5	<0.5	<2.5	--	--
12/21/98	82.17	17.40	64.77	--	71	<50	<0.5	<0.5	<0.5	<0.5	<2.5	--	--
03/24/99	82.17	16.22	65.95	--	84.0	<50.0	<0.500	<0.500	<0.500	<0.500	<2.00	--	--
06/25/99	82.17	16.90	65.27	--	92.0	<50.0	<0.500	<0.500	<0.500	<0.500	<2.00	--	--
09/24/99	82.17	17.89	64.28	--	<50.0	<50.0	<0.500	<0.500	<0.500	<0.500	<2.50	--	--
12/29/99	82.17	18.01	64.16	--	52.8	<50.0	<0.500	<0.500	<0.500	<0.500	<5.00	--	--
03/21/00	82.17	14.80	67.37	--	72.4	<50.0	<0.500	<0.500	<0.500	<0.500	<2.50	--	--
07/26/00	82.17	17.17	65.00	--	83.6	<50.0	<0.500	<0.500	<0.500	<0.500	--	--	--
09/06/00	82.17	17.95	64.22	--	74.3	<50.0	<0.500	<0.500	<0.500	<0.500	--	--	--
11/29/00	82.52	18.10	64.42	--	96.2	<50.0	<0.500	<0.500	<0.500	<0.500	--	--	--
03/06/01	82.52	16.75	65.77	--	94.2	<50.0	<0.500	<0.500	<0.500	<0.500	--	--	--
06/19/01 ⁶	82.52	17.83	64.69	--	<50	<50	<0.50	<0.50	<0.50	<0.50	--	<0.50	--
09/05/01 ⁶	82.52	17.98	64.54	--	<50	<50	<0.50	<0.50	<0.50	1.6	--	<5.0	--
12/20/01 ⁶	82.52	16.85	65.67	--	84	<50	<0.50	<0.50	<0.50	<0.50	--	<5.0	--
06/25/02	82.17	17.12	65.05	0.00	100	<50	<0.50	<0.50	<0.50	<1.5	<2.5	--	--
09/18/02	82.17	17.76	64.41	0.00	170	<50	<0.50	<0.50	<0.50	<1.5	<2.5	--	--
12/19/02	82.17	16.83	65.34	0.00	73	<50	<0.50	<0.50	<0.50	<1.5	<2.5	--	--
03/20/03	82.17	16.61	65.56	0.00	87	<50	<0.50	<0.50	<0.50	<1.5	<2.5	--	--
06/23/03 ¹⁰	82.17	17.14	65.03	0.00	<50	<50	<0.5	<0.5	<0.5	<0.5	--	0.7	--
09/22/03 ¹⁰	82.17	17.72	64.45	0.00	66	<50	<0.5	<0.5	<0.5	<0.5	--	0.7	<50
12/22/03 ¹⁰	82.17	17.44	64.73	0.00	94	<50	<0.5	<0.5	<0.5	<0.5	--	0.7	<50
03/22/04 ¹⁰	82.17	16.07	66.10	0.00	<50	<50	<0.5	<0.5	<0.5	<0.5	--	0.7	<50
06/21/04 ¹⁰	82.17	17.38	64.79	0.00	80	<50	<0.5	<0.5	<0.5	<0.5	--	1	<50

Table 1
Groundwater Monitoring Data and Analytical Results
Former Texaco Service Station (Site #211283)
3810 Broadway
Oakland, California

WELL ID/ DATE	TOC* (ft.)	DTW (ft.)	GWE (msl)	SPHT (ft.)	TPH-D (ppb)	TPH-G (ppb)	B (ppb)	T (ppb)	E (ppb)	X (ppb)	MTBE by 8021♦ (ppb)	MTBE by 8260 (ppb)	ETHANOL (ppb)
MW-9 (cont)													
09/20/04 ¹⁰	82.17	18.14	64.03	0.00	120	<50	<0.5	<0.5	<0.5	<0.5	--	1	<50
12/20/04 ¹⁰	82.17	17.15	65.02	0.00	74 ⁹	<50	<0.5	<0.5	<0.5	<0.5	--	2	<50
03/28/05 ¹⁰	82.17	15.47	66.70	0.00	84 ⁹	<50	<0.5	<0.5	<0.5	<0.5	--	3	<50
06/27/05 ¹⁰	82.17	16.41	65.76	0.00	140 ¹²	<50	<0.5	<0.5	<0.5	<0.5	--	3	<50
09/19/05 ¹⁰	82.17	17.42	64.75	0.00	<50	<50	<0.5	<0.5	<0.5	<0.5	--	5	<50
12/19/05 ¹⁰	82.17	17.93	64.24	0.00	52 ¹⁷	<50	<0.5	<0.5	<0.5	<0.5	--	5	<50
03/27/06 ¹⁰	82.17	13.75	68.42	0.00	<50	<50	<0.5	<0.5	<0.5	<0.5	--	7	<50
06/26/06 ¹⁰	82.17	15.90	66.27	0.00	110	<50	<0.5	<0.5	<0.5	<0.5	--	9	<50
09/25/06 ¹⁰	82.17	17.27	64.90	0.00	57	<50	<0.5	<0.5	<0.5	<0.5	--	8	<50
12/18/06 ¹⁰	82.17	16.67	65.50	0.00	220	<50	<0.5	<0.5	<0.5	<0.5	--	7	<50
03/19/07 ¹⁰	82.17	16.16	66.01	0.00	210	<50	<0.5	<0.5	<0.5	<0.5	--	9	<50
06/25/07 ¹⁰	82.17	23.84	58.33	0.00	74	<50	<0.5	<0.5	<0.5	<0.5	--	6	<50
09/24/07 ¹⁰	82.17	25.68	56.49	0.00	280	<50	<0.5	<0.5	<0.5	<0.5	--	2	<50
12/18/07	82.17	INACCESSIBLE - WELL UNDER WATER				--	--	--	--	--	--	--	--
MW-10													
10/10/96	81.83	18.40	63.43	--	<50	<50	<0.5	<0.5	<0.5	<0.5	<5.0	--	--
11/07/96	81.83	18.43	63.40	--	--	--	--	--	--	--	--	--	--
12/18/97	81.83	16.18	65.65	--	<50	350	6.9	0.87	0.88	0.77	<30	--	--
04/06/98	81.83	14.39	67.44	--	<50	2,300	224	168	81.4	253	<30	--	--
06/18/98	81.83	15.11	66.72	--	320	7,200	310	210	83	280	<0.5	--	--
08/31/98	81.83	17.03	64.80	--	120	460	51	8.2	5.1	10	<5.0	--	--
12/21/98	81.83	17.32	64.51	--	79	120	5.5	<1.0	<1.0	<1.0	8.7	<2.0	--
03/24/99	81.83	15.25	66.58	--	923	1,330	85.9	42.9	29.7	95.2	20.4	<25.0	--
06/25/99	81.83	16.82	65.01	--	167	1,130	115	32.6	17.2	36.3	<4.00	--	--
09/24/99	81.83	17.75	64.08	--	76.7	382	20.0	<1.00	2.21	1.37	8.83	--	--
12/29/99	81.83	18.13	63.70	--	107	114	9.03	<0.500	0.531	<0.500	<5.00	--	--
03/21/00	81.83	14.22	67.61	--	194	1,270	86.3	52.3	38.1	102	19.5	--	--
07/26/00	81.83	16.61	65.22	--	192	562	74.8	7.51	24.3	14.8	13.3	<1.00 ⁴	--
09/06/00	81.83	17.08	64.75	--	205	606	93.4	5.36	16.7	38.9	--	--	--
11/29/00	82.16	16.90	65.26	--	258	583	40.0	1.46	4.69	15.8	--	--	--
03/06/01	82.16	14.80	67.36	--	199	837	34.2	26.4	20.8	27.5	--	--	--
06/19/01 ⁶	82.16	16.85	65.31	--	<50	400	47	2.6	8.8	17	--	0.60	--

Table 1
Groundwater Monitoring Data and Analytical Results
Former Texaco Service Station (Site #211283)
3810 Broadway
Oakland, California

WELL ID/ DATE	TOC* (ft.)	DTW (ft.)	GWE (msl)	SPHT (ft.)	TPH-D (ppb)	TPH-G (ppb)	B (ppb)	T (ppb)	E (ppb)	X (ppb)	MTBE by	MTBE by	ETHANOL (ppb)	
											8021♦ (ppb)	8260 (ppb)		
MW-10 (cont)														
09/05/01 ⁶	82.16	17.87	64.29	--	<100	230	20	<0.50	1.2	5.3	--	<5.0	--	
12/20/01 ⁶	82.16	15.54	66.62	--	110	300	13	2.5	1.7	4.6	--	<5.0	--	
06/25/02	81.83	16.93	64.90	0.00	180	810	180	3.2	17	8.0	<2.5	--	--	
09/18/02	81.83	17.68	64.15	0.00	200	260	24	<2.0	2.5	5.0	2.9	--	--	
12/19/02	81.83	16.36	65.47	0.00	86	360	25	0.60	<0.50	1.5	<5.0	--	--	
03/20/03	81.83	16.32	65.51	0.00	200	620	21	5.3	6.0	13	<10	--	--	
06/23/03 ¹⁰	81.83	16.57	65.26	0.00	290	1,500	170	23	40	93	--	0.7	--	
09/22/03 ¹⁰	81.83	17.60	64.23	0.00	180	480	48	3	7	17	--	0.8	<50	
12/22/03 ¹⁰	81.83	17.31	64.52	0.00	120	230	7	<0.5	<0.5	1	--	0.9	<50	
03/22/04 ¹⁰	81.83	15.58	66.25	0.00	230	1,500	72	26	30	82	--	0.7	<50	
06/21/04 ¹⁰	81.83	17.12	64.71	0.00	220	1,000	120	29	47	73	--	2	<50	
09/20/04 ¹⁰	81.83	18.12	63.71	0.00	230	470	36	5	6	20	--	2	<50	
12/20/04 ¹⁰	81.83	17.01	64.82	0.00	170 ⁹	480	13	2	1	7	--	2	<50	
03/28/05 ¹⁰	81.83	14.64	67.19	0.00	450 ⁹	1,900	64	46	55	140	--	1	<50	
06/27/05 ¹⁰	81.83	15.99	65.84	0.00	400 ¹⁵	1,700	140	61	33	180	--	3	<50	
09/19/05 ¹⁰	81.83	17.35	64.48	0.00	170	1,200	98	35	58	110	--	5	<50	
12/19/05 ¹⁰	81.83	17.12	64.71	0.00	160 ¹⁴	1,000	61	23	20	47	--	5	<50	
03/27/06 ¹⁰	81.83	13.35	68.48	0.00	180	670	6	4	8	11	--	5	<50	
06/26/06 ¹⁰	81.83	15.10	66.73	0.00	580	4,700	220	110	150	390	--	0.8	<50	
09/25/06 ¹⁰	81.83	17.10	64.73	0.00	480	4,400	290	180	200	350	--	4	<50	
12/18/06 ¹⁰	81.83	16.75	65.08	0.00	2,900	2,500	270	97	97	170	--	1	<50	
03/19/07 ¹⁰	81.83	15.91	65.92	0.00	650	2,000	150	43	52	88	--	1	<50	
06/25/07 ¹⁰	81.83	24.41	57.42	0.00	7,600 ¹⁹	<50 ¹⁹	<0.5	<0.5	<0.5	<0.5	--	4	<50	
09/24/07 ¹⁰	81.83	25.96	55.87	0.00	8,400	88	<0.5	<0.5	<0.5	<0.5	--	2	<50	
12/18/07	81.83	INACCESSIBLE - WELL UNDER WATER				--	--	--	--	--	--	--	--	--
MW-11														
08/08/00	--	25.61	--	--	--	--	--	--	--	--	--	--	--	
08/16/00	--	25.50	--	--	56.80	<50.0	<0.500	<0.500	<0.500	<0.500	--	--	--	
09/06/00	--	25.90	--	--	-- ⁵	<50.0	<0.500	<0.500	<0.500	<0.500	--	--	--	
11/29/00	90.63	25.80	64.83	--	63.8	<50.0	<0.500	<0.500	<0.500	<0.500	--	--	--	
03/06/01	90.63	23.32	67.31	--	<50.0	<50.0	<0.500	<0.500	<0.500	<0.500	--	--	--	
06/19/01 ⁶	90.63	25.57	65.06	--	<50	<50	<0.50	<0.50	<0.50	<0.50	--	<0.50	--	

Table 1
Groundwater Monitoring Data and Analytical Results
Former Texaco Service Station (Site #211283)
3810 Broadway
Oakland, California

WELL ID/ DATE	TOC* (ft.)	DTW (ft.)	GWE (msl)	SPHT (ft.)	TPH-D (ppb)	TPH-G (ppb)	B (ppb)	T (ppb)	E (ppb)	X (ppb)	MTBE by 8021♦ (ppb)	MTBE by 8260 (ppb)	ETHANOL (ppb)
MW-11 (cont)													
09/05/01 ⁶	90.63	26.42	64.21	--	<50	<50	<0.50	<0.50	<0.50	0.68	--	<5.0	--
12/20/01 ⁶	90.63	24.27	66.36	--	<50	<50	<0.50	<0.50	<0.50	<0.50	--	<5.0	--
06/25/02	-- ⁸	25.51	-- ⁸	0.00	<50	<50	<0.50	<0.50	<0.50	<1.5	<2.5	--	--
09/18/02	-- ⁸	26.31	-- ⁸	0.00	80	<50	<0.50	<0.50	<0.50	<1.5	<2.5	--	--
12/19/02	-- ⁸	25.08	-- ⁸	0.00	<50	<50	<0.50	<0.50	<0.50	<1.5	<2.5	--	--
03/20/03	-- ⁸	24.87	-- ⁸	0.00	<50	<50	<0.50	0.51	<0.50	<1.5	<2.5	--	--
06/23/03 ¹⁰	-- ⁸	25.21	-- ⁸	0.00	140	<50	<0.5	<0.5	<0.5	<0.5	--	<0.5	--
09/22/03 ¹⁰	-- ⁸	26.26	-- ⁸	0.00	52	<50	<0.5	<0.5	<0.5	<0.5	--	1	<50
12/22/03 ¹⁰	-- ⁸	25.97	-- ⁸	0.00	69	<50	<0.5	<0.5	<0.5	<0.5	--	2	<50
03/22/04 ¹⁰	-- ⁸	24.13	-- ⁸	0.00	<50	<50	<0.5	<0.5	<0.5	<0.5	--	<0.5	<50
06/21/04 ¹⁰	-- ⁸	25.74	-- ⁸	0.00	79	<50	<0.5	<0.5	<0.5	<0.5	--	<0.5	<50
09/20/04 ¹⁰	-- ⁸	26.83	-- ⁸	0.00	140	<50	<0.5	<0.5	<0.5	<0.5	--	4	<50
12/20/04 ¹⁰	-- ⁸	25.67	-- ⁸	0.00	54 ⁹	<50	<0.5	<0.5	<0.5	<0.5	--	3	<50
03/28/05 ¹⁰	-- ⁸	23.03	-- ⁸	0.00	58 ⁹	<50	<0.5	<0.5	<0.5	<0.5	--	<0.5	<50
06/27/05 ¹⁰	-- ⁸	24.61	-- ⁸	0.00	<50	<50	<0.5	<0.5	<0.5	<0.5	--	<0.5	<50
09/19/05 ¹⁰	-- ⁸	25.98	-- ⁸	0.00	<50	<50	<0.5	<0.5	<0.5	<0.5	--	0.6	<50
12/19/05 ¹⁰	-- ⁸	25.93	-- ⁸	0.00	<50	<50	<0.5	<0.5	<0.5	<0.5	--	2	<50
03/27/06 ¹⁰	-- ⁸	21.81	-- ⁸	0.00	<50	<50	<0.5	<0.5	<0.5	<0.5	--	<0.5	<50
06/26/06 ¹⁰	-- ⁸	24.00	-- ⁸	0.00	64	<50	<0.5	<0.5	<0.5	<0.5	--	<0.5	<50
09/25/06 ¹⁰	-- ⁸	25.75	-- ⁸	0.00	<50	<50	<0.5	<0.5	<0.5	<0.5	--	<0.5	<50
12/18/06 ¹⁰	-- ⁸	25.55	-- ⁸	0.00	140	<50	<0.5	<0.5	<0.5	<0.5	--	<0.5	<50
03/19/07 ¹⁰	-- ⁸	24.58	-- ⁸	0.00	63	<50	<0.5	<0.5	<0.5	<0.5	--	1	<50
06/25/07 ¹⁰	-- ⁸	32.81	-- ⁸	0.00	130	<50	<0.5	<0.5	<0.5	<0.5	--	2	<50
09/24/07 ¹⁰	-- ⁸	34.24	-- ⁸	0.00	110	<50	<0.5	<0.5	<0.5	<0.5	--	2	<50
12/18/07 ¹⁰	-- ⁸	33.52	-- ⁸	0.00	90	<50	<0.5	<0.5	<0.5	<0.5	--	2	<50
MW-12													
06/25/02 ⁷	84.19	18.65	65.54	0.00	410	1,000	340	8.2	16	8.3	11	--	--
09/18/02	84.19	19.67	64.52	0.00	230	130	52	<0.50	<0.50	<1.5	9.8	--	--
12/19/02	84.19	18.67	65.52	0.00	450	<50	11	<0.50	<0.50	<1.5	<2.5	--	--
03/20/03	84.19	17.97	66.22	0.00	300	280	120	1.9	11	<1.5	2.6	--	--
06/23/03 ¹⁰	84.19	18.27	65.92	0.00	400	400	130	4	1	0.7	--	14	--
09/22/03 ¹⁰	84.19	19.52	64.67	0.00	270	<50	9	<0.5	<0.5	<0.5	--	9	<50

Table 1
Groundwater Monitoring Data and Analytical Results
Former Texaco Service Station (Site #211283)
3810 Broadway
Oakland, California

WELL ID/ DATE	TOC* (ft.)	DTW (ft.)	GWE (msl)	SPHT (ft.)	TPH-D (ppb)	TPH-G (ppb)	B (ppb)	T (ppb)	E (ppb)	X (ppb)	MTBE by	MTBE by	ETHANOL (ppb)
											8021♦ (ppb)	8260 (ppb)	
MW-12 (cont)													
12/22/03 ¹⁰	84.19	19.75	64.44	0.00	130	720	130	29	10	46	--	2	<50
03/22/04 ¹⁰	84.19	17.06	67.13	0.00	240	<50	3	<0.5	<0.5	1	--	0.5	<50
06/21/04 ¹⁰	84.19	18.82	65.37	0.00	350	140	43	<0.5	<0.5	<0.5	--	8	<50
09/20/04 ¹⁰	84.19	19.99	64.20	0.00	340	<50	<0.5	<0.5	<0.5	<0.5	--	2	<50
12/20/04 ¹⁰	84.19	19.46	64.73	0.00	160 ⁹	1,300	400	28	31	31	--	1	<50
03/28/05 ¹⁰	84.19	16.42	67.77	0.00	440 ⁹	90	24	<0.5	<0.5	<0.5	--	1	<50
06/27/05 ¹⁰	84.19	17.53	66.66	0.00	170 ¹³	<50	<0.5	<0.5	<0.5	<0.5	--	3	<50
09/19/05 ¹⁰	84.19	19.04	65.15	0.00	190	<50	<0.5	<0.5	<0.5	<0.5	--	2	<50
12/19/05 ¹⁰	84.19	19.41	64.78	0.00	340 ¹³	330	94	5	1	3	--	2	<50
03/27/06 ¹⁰	84.19	15.45	68.74	0.00	140	130	33	0.7	1	4	--	0.8	<50
06/26/06 ¹⁰	84.19	16.70	67.49	0.00	220	<50	<0.5	<0.5	<0.5	<0.5	--	<0.5	<50
09/25/06 ¹⁰	84.19	18.81	65.38	0.00	200	<50	<0.5	<0.5	<0.5	<0.5	--	<0.5	<50
12/18/06 ¹⁰	84.19	18.94	65.25	0.00	410	240	68	5	1	1	--	1	<50
03/19/07 ¹⁰	84.19	17.83	66.36	0.00	200	55	7	<0.5	<0.5	<0.5	--	2	<50
06/25/07 ¹⁰	84.19	25.80	58.39	0.00	1,600 ¹⁹	5,500 ¹⁹	1,000 ¹⁹	190 ¹⁹	170 ¹⁹	320 ¹⁹	--	2	<100
09/24/07 ¹⁰	84.19	27.88	56.31	0.00	2,300	<50	0.7	<0.5	<0.5	<0.5	--	1	<50
12/18/07 ¹⁰	84.19	27.06	57.13	0.00	550	230	17	<0.5	<0.5	<0.5	--	<0.5	<50
MW-2													
06/28/96	85.83	22.10	63.73	1.35	--	--	--	--	--	--	--	--	--
10/10/96	85.83	22.36	63.47	--	1,800	99,000	4,100	9,400	2,300	9,900	390	<25 ¹	--
11/07/96	85.83	22.39	63.45**	0.01	--	--	--	--	--	--	--	--	--
12/18/97	85.83	20.19	65.64	--	4,700	24,000	600	1,800	750	2,400	<2,000	--	--
04/06/98	85.83	18.00	67.83	--	9.5	20,100	252	448	430	1,410	<200	--	--
06/18/98	85.83	19.63	66.20	--	5,200	20,000	240	370	270	790	<50	--	--
08/31/98	85.83	21.01	64.82	--	19,000	72,000	270	990	630	1,700	<125	--	--
12/21/98	85.83	21.31	64.52	--	13,000	290	8.7	18	9.7	38	10	29	--
03/24/99	85.83	19.18	66.65	--	5,590	80,400	651	1,860	1,120	3,730	<40.0	<100	--
06/25/99	85.83	20.78	65.05	--	12,100	34,700	504	1,300	716	2,160	<40.0	--	--
09/24/99	85.83	21.82	64.01	--	108	6,510	1,030	350	183	680	<50.0	--	--
12/29/99	85.83	22.17	63.90**	0.30	--	--	--	--	--	--	--	--	--

Table 1
Groundwater Monitoring Data and Analytical Results
Former Texaco Service Station (Site #211283)
3810 Broadway
Oakland, California

WELL ID/ DATE	TOC* (ft.)	DTW (ft.)	GWE (msl)	SPHT (ft.)	TPH-D (ppb)	TPH-G (ppb)	B (ppb)	T (ppb)	E (ppb)	X (ppb)	MTBE by 8021♦ (ppb)	MTBE by 8260 (ppb)	ETHANOL (ppb)
MW-2 (cont)													
01/07/00	85.83	22.84	63.30**	0.39	--	--	--	--	--	--	--	--	--
03/21/00	-- ³	18.19	--	--	41,100	54,100	1,260	3,320	2,180	8,200	<1,250	--	--
DESTROYED													
MW-3													
06/28/96	83.18	19.04	64.14	--	--	--	--	--	--	--	--	--	--
10/10/96	83.18	19.51	63.67	--	1,200	110,000	6,600	16,000	2,200	12,000	<250	--	--
11/07/96	83.18	19.40	63.78	--	--	--	--	--	--	--	--	--	--
12/18/97	83.18	18.79	64.39	--	6,100,000	180,000	1,500	16,000	4,600	23,000	<3,000	--	--
04/06/98	83.18	16.58	66.64	0.05	--	--	--	--	--	--	--	--	--
06/18/98	83.18	--	--	>2.0 ²	--	--	--	--	--	--	--	--	--
08/31/98	83.18	19.56	63.68	0.07	--	--	--	--	--	--	--	--	--
12/21/98	83.18	20.23	65.13	2.73	--	--	--	--	--	--	--	--	--
03/24/99	83.18	16.76	67.11	0.86	--	--	--	--	--	--	--	--	--
06/25/99	83.18	18.47	64.95	0.30	--	--	--	--	--	--	--	--	--
09/24/99	83.18	19.43	63.81	0.08	--	--	--	--	--	--	--	--	--
12/29/99	83.18	19.25	63.96	0.04	--	--	--	--	--	--	--	--	--
01/07/00	83.18	19.87	63.37	0.07	--	--	--	--	--	--	--	--	--
DESTROYED													
MW-5													
10/10/96	85.41	21.93	63.48	--	<50	1,800	34	4.7	11	44	21	5.0 ¹	--
11/07/96	85.41	21.96	63.45	--	--	--	--	--	--	--	--	--	--
12/18/97	85.41	19.81	65.60	--	<50	1,200	15	<1.0	15	<1.0	72	--	--
04/06/98	85.41	17.43	67.98	--	<50	1,000	126	0.5	0.8	1.5	<30	--	--
06/18/98	85.41	19.15	66.26	--	100	110	6.9	<0.5	<0.5	<0.5	<0.5	--	--
08/31/98	85.41	20.46	64.95	--	120	480	5.3	<2.5	<2.5	<2.5	<12	--	--
12/21/98	85.41	20.91	64.50	--	100	270	16	2.9	1.3	<1.0	34	<2.0	--
03/24/99	85.41	18.74	66.67	--	93.3	143	2.80	<0.500	0.749	<0.500	<2.00	<5.00	--
06/25/99	85.41	20.31	65.10	--	125	847	6.61	<0.500	0.611	<0.500	2.69	<2.00	--
09/24/99	85.41	21.36	64.05	--	94.0	563	6.00	<2.50	<2.50	<2.50	25.1	--	--
12/29/99	85.41	21.41	64.00	--	173	896	16.6	1.48	8.92	2.67	61.1	<0.500	--

Table 1
Groundwater Monitoring Data and Analytical Results
Former Texaco Service Station (Site #211283)
3810 Broadway
Oakland, California

WELL ID/ DATE	TOC* (ft.)	DTW (ft.)	GWE (msl)	SPHT (ft.)	TPH-D (ppb)	TPH-G (ppb)	B (ppb)	T (ppb)	E (ppb)	X (ppb)	MTBE by	MTBE by	ETHANOL (ppb)
											8021♦ (ppb)	8260 (ppb)	
MW-5 (cont)													
03/21/00	85.41	18.13	67.28	--	158	858	53.7	<1.00	21.4	8.00	11.6	--	--
07/26/00	85.41	OBSTRUCTION IN WELL		--	--	--	--	--	--	--	--	--	--
09/06/00	85.41	20.33	65.08	--	231	670	153	<2.50	7.87	<2.50	--	--	--
11/29/00	85.13	OBSTRUCTION IN WELL		--	--	--	--	--	--	--	--	--	--
03/06/01	85.13	OBSTRUCTION IN WELL		--	--	--	--	--	--	--	--	--	--
06/19/01	85.13	OBSTRUCTION IN WELL		--	--	--	--	--	--	--	--	--	--
09/05/01	85.13	OBSTRUCTION IN WELL		--	--	--	--	--	--	--	--	--	--
12/02/01	85.13	OBSTRUCTION IN WELL		--	--	--	--	--	--	--	--	--	--
DESTROYED													
MW-8													
10/10/96	84.01	20.82	63.19	--	110	17,000	1,300	1,200	64	1,300	110	<5.0 ¹	--
11/07/96	84.01	20.44	63.57	--	--	--	--	--	--	--	--	--	--
12/18/97	84.01	19.36	64.65	--	630	15,000	3,600	1,800	410	930	<600	--	--
04/06/98	84.01	16.19	67.82	--	<50	32,300	8,230	5,900	718	2,120	<1,000	--	--
06/18/98	84.01	17.75	66.26	--	<50	74,000	5,400	4,500	700	2,200	2,400	--	--
08/31/98	84.01	INACCESSIBLE		--	--	--	--	--	--	--	--	--	--
12/21/98	84.01	19.48	64.53	--	1,200	9,600	2,600	410	220	300	700	<2.0	--
03/24/99	84.01	17.44	66.57	--	2,890	86,100	9,890	11,700	1,650	7,130	<200	<250	--
06/25/99	84.01	20.69	63.40**	0.10	--	--	--	--	--	--	--	--	--
07/01/99	84.01	20.45	65.07**	1.89	--	--	--	--	--	--	--	--	--
09/24/99	84.01	20.98	64.25**	1.53	--	--	--	--	--	--	--	--	--
12/29/99	84.01	20.25	63.97**	0.26	--	--	--	--	--	--	--	--	--
01/07/00	84.01	21.00	63.33**	0.40	--	--	--	--	--	--	--	--	--
DESTROYED													
TRIP BLANK													
QA													
06/25/02	--	--	--	--	--	<50	<0.50	<0.50	<0.50	<1.5	<2.5	--	--
09/18/02	--	--	--	--	--	<50	<0.50	<0.50	<0.50	<1.5	<2.5	--	--
12/19/02	--	--	--	--	--	<50	<0.50	<0.50	<0.50	<1.5	<2.5	--	--
03/20/03	--	--	--	--	--	<50	<0.50	<0.50	<0.50	<1.5	<2.5	--	--

Table 1
Groundwater Monitoring Data and Analytical Results
Former Texaco Service Station (Site #211283)
3810 Broadway
Oakland, California

WELL ID/ DATE	TOC* (ft.)	DTW (ft.)	GWE (msl)	SPHT (ft.)	TPH-D (ppb)	TPH-G (ppb)	B (ppb)	T (ppb)	E (ppb)	X (ppb)	MTBE by 8021♦ (ppb)	MTBE by 8260 (ppb)	ETHANOL (ppb)
QA (cont)													
06/23/03 ¹⁰	--	--	--	--	--	<50	<0.5	<0.5	<0.5	<0.5	--	<0.5	--
09/22/03 ¹⁰	--	--	--	--	--	<50	<0.5	<0.5	<0.5	<0.5	--	<0.5	--
12/22/03 ¹⁰	--	--	--	--	--	<50	<0.5	<0.5	<0.5	<0.5	--	<0.5	--
03/22/04 ¹⁰	--	--	--	--	--	<50	<0.5	<0.5	<0.5	<0.5	--	<0.5	--
06/21/04 ¹⁰	--	--	--	--	--	<50	<0.5	<0.5	<0.5	<0.5	--	<0.5	--
09/20/04 ¹⁰	--	--	--	--	--	<50	<0.5	<0.5	<0.5	<0.5	--	<0.5	--
12/20/04 ¹⁰	--	--	--	--	--	<50	<0.5	<0.5	<0.5	<0.5	--	<0.5	--
03/28/05 ¹⁰	--	--	--	--	--	<50	<0.5	<0.5	<0.5	<0.5	--	<0.5	--
06/27/05 ¹⁰	--	--	--	--	--	<50	<0.5	<0.5	<0.5	<0.5	--	<0.5	--
09/19/05 ¹⁰	--	--	--	--	--	<50	<0.5	<0.5	<0.5	<0.5	--	<0.5	--
12/19/05 ¹⁰	--	--	--	--	--	<50	<0.5	<0.5	<0.5	<0.5	--	<0.5	--
03/27/06 ¹⁰	--	--	--	--	--	<50	<0.5	<0.5	<0.5	<0.5	--	<0.5	--
06/26/06 ¹⁰	--	--	--	--	--	<50	<0.5	<0.5	<0.5	<0.5	--	<0.5	--
09/25/06 ¹⁰	--	--	--	--	--	<50	<0.5	<0.5	<0.5	<0.5	--	<0.5	--
12/18/06 ¹⁰	--	--	--	--	--	<50	<0.5	<0.5	<0.5	<0.5	--	<0.5	--
03/19/07 ¹⁰	--	--	--	--	--	<50	<0.5	<0.5	<0.5	<0.5	--	<0.5	--
06/25/07 ¹⁰	--	--	--	--	--	<50	<0.5	<0.5	<0.5	<0.5	--	<0.5	--
09/24/07 ¹⁰	--	--	--	--	--	<50	<0.5	<0.5	<0.5	<0.5	--	<0.5	--
12/18/07 ¹⁰	--	--	--	--	--	<50	<0.5	<0.5	<0.5	<0.5	--	<0.5	--

Table 1
Groundwater Monitoring Data and Analytical Results
Former Texaco Service Station (Site #211283)
3810 Broadway
Oakland, California

EXPLANATIONS:

Groundwater monitoring data and laboratory analytical results prior to June 25, 2002, were compiled from reports prepared by Toxichem Management Systems, Inc.

TOC = Top of Casing	SPHT = Separate-phase hydrocarbon thickness	X = Xylenes
(ft.) = Feet	TPH-D = Total Petroleum Hydrocarbons as Diesel	MTBE = Methyl tertiary butyl ether
DTW = Depth to Water	TPH-G = Total Petroleum Hydrocarbons as Gasoline	(ppb) = Parts per billion
GWE = Groundwater Elevation	B = Benzene	-- = Not Measured/Not Analyzed
(msl) = Mean Sea Level	T = Toluene	QA = Quality Assurance/Trip Blank
SPH = Separate-phase hydrocarbons	E = Ethylbenzene	NP= No Purge

* TOC elevations were surveyed June 24, 2002, by Morrow Surveying, and are based on City of Oakland Benchmark.

** GWE corrected for the presence of SPH; correction factor = [(TOC - DTW)+(0.80 x SPHT)].

◆ Prior to June 25, 2002, MTBE was analyzed by EPA Method 8020.

¹ MTBE confirmed by EPA Method 8240.

² Free product could not be accurately measured.

³ TOC altered.

⁴ Analyzed outside EPA recommended hold time.

⁵ Sample containers broken during transport to laboratory.

⁶ TPH-G and BTEX analyzed by EPA Method 8260.

⁷ Well development performed.

⁸ MW-11 was inaccessible during the re-surveying. TOC was not measured.

⁹ Laboratory report indicates the observed sample pattern is not typical of diesel/#2 fuel oil.

¹⁰ BTEX analyzed by EPA Method 8260.

¹¹ Ethanol was previously reported as <50 ppb.

¹² Laboratory report indicates the observed sample pattern is not typical of #2 fuel/diesel. It elutes in the DRO range later than #2 fuel.

¹³ Laboratory report indicates the observed sample pattern includes #2fuel/diesel and an additional pattern which elutes later in the DRO range.

¹⁴ Laboratory report indicates the observed sample pattern is not typical of #2fuel/diesel. It elutes in the DRO range earlier than #2 fuel.

¹⁵ Laboratory report indicates the observed sample patterns are not typical of #2fuel/diesel. They elute in the DRO range earlier and later than #2 fuel.

¹⁶ Laboratory report indicates the observed sample pattern is not typical of #2 fuel/diesel. It elutes in the DRO range later than #2 fuel and contains individual peaks eluting in the DRO range.

¹⁷ Laboratory report indicates the observed sample pattern is not typical of #2 fuel/diesel. The reported result is due to an individual peak (s) eluting in the DRO range.

¹⁸ No purge due to bent casing.

¹⁹ Laboratory confirmed analytical result.

Table 2
Field Measurements
Former Texaco Service Station (Site #211283)
3810 Broadway
Oakland, California

WELL ID	DATE	D.O.	ORP	D.O.	ORP	D.O.	ORP
		Before Purging (mg/L)	Before Purging (mV)	Mid-Purging (mg/L)	Mid-Purging (mV)	After Purging (mg/L)	After Purging (mV)
MW-2	09/24/99	1.00	--	--	--	0.80	--
	12/29/99	2.60	--	--	--	--	--
	03/21/00	3.30	--	--	--	3.60	--
MW-6	09/24/99	1.00	--	--	--	1.20	--
	12/29/99	1.30	--	--	--	1.50	--
	03/21/00	3.00	--	--	--	4.30	--
	11/29/00	2.00	--	--	--	1.80	--
	03/06/01	3.70	--	--	--	4.00	--
	06/19/01	3.00	--	--	--	3.40	--
	09/05/01	10.40	--	--	--	10.80	--
	12/20/01	1.30	--	--	--	1.50	--
	06/25/02	1.00	--	0.60	--	0.40	--
	09/18/02	0.60	58	0.90	69	1.00	72
	12/19/02	1.20	71	--	--	1.10	79
	03/20/03	0.40	-93	--	--	1.60	-87
	06/23/03	0.90	64	--	--	1.20	78
	09/22/03	1.10	70	--	--	1.30	76
	12/22/03	0.90	68	--	--	1.00	70
	03/22/04	1.00	74	--	--	1.20	82
	06/21/04	1.10	72	--	--	1.10	86
	09/20/04	1.20	68	--	--	1.30	76
	12/20/04	1.00	71	--	--	1.10	80
	03/28/05	1.10	75	--	--	1.10	86
	06/27/05	1.10	78	--	--	1.20	90
	09/19/05	2.90	-- ¹	--	--	1.20	-- ¹
	12/19/05	1.00	69	--	--	1.00	74
	03/27/06	1.60	89	--	--	1.20	75
	06/26/06	1.40	105	--	--	1.20	82
09/25/06	1.20	103	--	--	1.30	91	
12/18/06	1.20	87	--	--	-- ²	-- ²	
03/19/07	1.9	-57	--	--	1.6	-63	
06/25/07	DRY	--	--	--	--	--	
09/24/07	DRY	--	--	--	--	--	
12/18/07	DRY	--	--	--	--	--	
MW-7	09/24/99	1.40	--	--	--	1.60	--
	12/29/99	2.30	--	--	--	1.80	--
	03/21/00	5.80	--	--	--	9.00	--
	07/26/00	6.00	--	--	--	6.60	--
	09/06/00	4.30	--	--	--	5.00	--
	11/29/00	4.00	--	--	--	3.70	--
	03/06/01	4.70	--	--	--	5.10	--
	06/19/01	3.80	--	--	--	4.20	--
	09/05/01	6.70	--	--	--	7.10	--
	12/20/01	4.90	--	--	--	5.00	--
	06/25/02	1.00	--	1.40	--	1.30	--
	09/18/02	1.80	112	1.90	98	2.10	102
	12/19/02	1.30	121	--	--	1.60	110

Table 2
Field Measurements
Former Texaco Service Station (Site #211283)
3810 Broadway
Oakland, California

WELL ID	DATE	D.O.	ORP	D.O.	ORP	D.O.	ORP
		Before Purging (mg/L)	Before Purging (mV)	Mid-Purging (mg/L)	Mid-Purging (mV)	After Purging (mg/L)	After Purging (mV)
MW-7 (cont)	03/20/03	2.60	129	--	--	2.70	152
	06/23/03	1.70	122	--	--	1.90	140
	09/22/03	1.40	92	--	--	1.70	124
	12/22/03	1.50	98	--	--	1.60	114
	03/22/04	1.30	90	--	--	1.50	96
	06/21/04	1.50	106	--	--	1.70	126
	09/20/04	1.40	115	--	--	0.96	110
	12/20/04	1.30	88	--	--	1.40	95
	03/28/05	1.40	92	--	--	1.40	88
	06/27/05	1.50	106	--	--	1.40	94
	09/19/05	3.70	17	--	--	3.10	29
	12/19/05	1.40	85	--	--	1.30	90
	03/27/06	1.80	126	--	--	2.10	132
	06/26/06	1.60	119	--	--	1.80	121
	09/25/06	1.70	125	--	--	1.60	124
	12/18/06	1.40	130	--	--	-- ²	-- ²
	03/19/07	2.8	-10	--	--	2.3	-13
	06/25/07	1.8	119	--	--	1.5	98
09/24/07	1.7	1.3	--	--	94	76	
12/18/07	2.1	68	--	--	1.8	73	
MW-9	09/24/99	1.00	--	--	--	1.20	--
	12/29/99	3.30	--	--	--	2.70	--
	03/21/00	3.20	--	--	--	7.30	--
	07/26/00	3.60	--	--	--	1.80	--
	09/06/00	3.80	--	--	--	4.00	--
	11/29/00	2.00	--	--	--	2.00	--
	03/06/01	4.00	--	--	--	4.90	--
	06/19/01	3.40	--	--	--	4.00	--
	09/05/01	2.70	--	--	--	2.00	--
	12/20/01	2.20	--	--	--	2.20	--
	06/25/02	0.90	--	1.00	--	1.20	--
	09/18/02	1.40	138	1.00	110	0.90	95
	12/19/02	1.80	126	--	--	1.10	98
	03/20/03	0.10	206	--	--	1.10	193
	06/23/03	1.20	146	--	--	1.00	138
	09/22/03	1.10	126	--	--	1.00	130
	12/22/03	1.30	134	--	--	1.20	142
	03/22/04	3.70	120	--	--	1.40	126
	06/21/04	3.50	108	--	--	1.20	116
	09/20/04	2.70	54	--	--	1.10	62
	12/20/04	2.50	72	--	--	1.40	80
	03/28/05	2.80	92	--	--	1.70	68
	06/27/05	2.60	82	--	--	1.50	62
	09/19/05	1.00	-38	--	--	0.60	-30
	12/19/05	2.10	76	--	--	2.20	68
	03/27/06	2.20	136	--	--	1.90	125
06/26/06	2.40	122	--	--	2.00	115	
09/25/06	2.10	116	--	--	1.90	120	
12/18/06	1.80	131	--	--	-- ²	-- ²	

Table 2
Field Measurements
Former Texaco Service Station (Site #211283)
3810 Broadway
Oakland, California

WELL ID	DATE	D.O.	ORP	D.O.	ORP	D.O.	ORP	
		Before Purging (mg/L)	Before Purging (mV)	Mid-Purging (mg/L)	Mid-Purging (mV)	After Purging (mg/L)	After Purging (mV)	
MW-9	03/19/07	1.7	-03	--	--	2.1	-11	
(cont)	06/25/07	2.2	11	--	--	2.0	73	
	09/24/07	2.4	2.2	--	--	93	75	
	12/18/07	INACCESSIBLE - WELL UNDER WATER				--	--	--
MW-10	09/19/05	1.40	-97	--	--	0.80	-98	

Table 2
Field Measurements
Former Texaco Service Station (Site #211283)
3810 Broadway
Oakland, California

EXPLANATIONS:

Dissolved oxygen concentrations prior to June 25, 2002, were compiled from reports prepared by Toxichem Management Systems, Inc.

D.O. = Dissolved Oxygen

mg/L = milligrams per liter

ORP = Oxidation Reduction Potential

(mV) = Millivolts

-- = Not Measured

¹ ORP reading under range.

² Field technician inadvertently missed readings.

STANDARD OPERATING PROCEDURE - GROUNDWATER SAMPLING

Gettler-Ryan Inc. field personnel adhere to the following procedures for the collection and handling of groundwater samples prior to analysis by the analytical laboratory. Prior to sample collection, the type of analysis to be performed is determined. Loss prevention of volatile compounds is controlled and sample preservation for subsequent analysis is maintained.

Prior to sampling, the presence or absence of free-phase hydrocarbons is determined using an interface probe. Product thickness, if present, is measured to the nearest 0.01 foot and is noted in the field notes. In addition, all depth to water level measurements are collected with a static water level indicator and are also recorded in the field notes, prior to purging and sampling any wells.

After water levels are collected and prior to sampling, if purging is to occur, each well is purged a minimum of three well casing volumes of water using pre-cleaned pumps (stack, suction, Grundfos), or disposable bailers. Temperature, pH and electrical conductivity are measured a minimum of three times during the purging. Purging continues until these parameters stabilize.

Groundwater samples are collected using disposable bailers. The water samples are transferred from the bailer into appropriate containers. Pre-preserved containers, supplied by analytical laboratories, are used when possible. When pre-preserved containers are not available, the laboratory is instructed to preserve the sample as appropriate. Duplicate samples are collected for the laboratory to use in maintaining quality assurance/quality control standards. The samples are labeled to include the job number, sample identification, collection date and time, analysis, preservation (if any), and the sample collector's initials. The water samples are placed in a cooler, maintained at 4°C for transport to the laboratory. Once collected in the field, all samples are maintained under chain of custody until delivered to the laboratory.

The chain of custody document includes the job number, type of preservation, if any, analysis requested, sample identification, date and time collected, and the sample collector's name. The chain of custody is signed and dated (including time of transfer) by each person who receives or surrenders the samples, beginning with the field personnel and ending with the laboratory personnel.

A laboratory supplied trip blank accompanies each sampling set. For sampling sets greater than 20 samples, 5% trip blanks are included. The trip blank is analyzed for some or all of the same compounds as the groundwater samples.

As requested by Chevron Environmental Management Company, the purge water and decontamination water generated during sampling activities is transported by IWM to Chemical Waste Management located in Kettleman Hill, California.



GETTLER-RYAN INC.

WELL MONITORING/SAMPLING FIELD DATA SHEET

Client/Facility #: Chevron #211283 Job Number: 386956
 Site Address: 3810 Broadway Event Date: 12/12/07 (inclusive)
 City: Oakland, CA Sampler: RH SH

Well ID: MW-1 Date Monitored: 12/12/07 Well Condition: see wlogs
 Well Diameter: 2 in.
 Total Depth: 30.58 ft 30.06
 Depth to Water: 29.35 ft
0.71 xVF = _____ x3 case volume= Estimated Purge Volume: _____ gal.

Volume	3/4"= 0.02	1"= 0.04	2"= 0.17	3"= 0.38
Factor (VF)	4"= 0.66	5"= 1.02	6"= 1.50	12"= 5.80

Check if water column is less than 0.50 ft.

Purge Equipment:
 Disposable Bailer _____
 Stainless Steel Bailer _____
 Stack Pump _____
 Suction Pump _____
 Grundfos _____
 Other: _____

I.W.

Sampling Equipment:
 Disposable Bailer _____
 Pressure Bailer _____
 Discrete Bailer _____
 Other: _____

Time Started: _____ (2400 hrs)
 Time Completed: _____ (2400 hrs)
 Depth to Product: _____ ft
 Depth to Water: _____ ft
 Hydrocarbon Thickness: _____ ft
 Visual Confirmation/Description: _____
 Skimmer / Absorbent Sock (circle one)
 Amt Removed from Skimmer: _____ gal
 Amt Removed from Well: _____ gal
 Water Removed: _____
 Product Transferred to: _____

Start Time (purge): _____ Weather Conditions: _____
 Sample Time/Date: 1 Water Color: _____ Odor: _____
 Purging Flow Rate: _____ gpm. Sediment Description: _____
 Did well de-water? _____ If yes, Time: _____ Volume: _____ gal.

Time (2400 hr.)	Volume (gal.)	pH	Conductivity (µmhos/cm)	Temperature (C / F)	D.O. (mg/L)	ORP (mV)
_____	_____	_____	_____	_____	PRE: _____	PRE: _____
_____	_____	_____	_____	_____	POST: _____	POST: _____

LABORATORY INFORMATION

SAMPLE ID	(#) CONTAINER	REFRIG.	PRESERV. TYPE	LABORATORY	ANALYSES
MW-	x voa vial	YES	HCL	LANCASTER	TPH-G(8015)/BTEX+MTBE(8260)/ETHANOL (8260)
	x 500ml ambers	YES	NP	LANCASTER	TPH-D (8015)

COMMENTS: Well casing bent, attempted to sample w/ pin bailer, unable to get sample due to heavy silt. TWD rechecked and found to be 30.06.
 Add/Replaced Lock: _____ Add/Replaced Plug: _____ Size: _____



GETTLER-RYAN INC.

WELL MONITORING/SAMPLING FIELD DATA SHEET

Client/Facility #: Chevron #211283 Job Number: 386956
 Site Address: 3810 Broadway Event Date: 12/12/07 (inclusive)
 City: Oakland, CA Sampler: SL

Well ID: MW-4 Date Monitored: 12/12/07 Well Condition: see wcss
 Well Diameter: 2 in.
 Total Depth: 28.82 ft.
 Depth to Water: 25.91 ft.
 $2.91 \times VF = 0.17 = 0.5 \times 3 \text{ case volume} = \text{Estimated Purge Volume: } 1.5 \text{ gal.}$

Volume	3/4"= 0.02	1"= 0.04	2"= 0.17	3"= 0.38
Factor (VF)	4"= 0.66	5"= 1.02	6"= 1.50	12"= 5.80

Check if water column is less than 0.50 ft.

Purge Equipment:

Disposable Bailer α
 Stainless Steel Bailer _____
 Stack Pump _____
 Suction Pump _____
 Grundfos _____
 Other: _____

Sampling Equipment:

Disposable Bailer α
 Pressure Bailer _____
 Discrete Bailer _____
 Other: _____

Time Started: _____ (2400 hrs)
 Time Completed: _____ (2400 hrs)
 Depth to Product: _____ ft
 Depth to Water: _____ ft
 Hydrocarbon Thickness: _____ ft
 Visual Confirmation/Description: _____
 Skimmer / Absorbent Sock (circle one)
 Amt Removed from Skimmer: _____ gal
 Amt Removed from Well: _____ gal
 Water Removed: _____
 Product Transferred to: _____

Start Time (purge): 1207 Weather Conditions: Rain
 Sample Time/Date: 1235 12/12/07 Water Color: Grey Odor: NO
 Purging Flow Rate: _____ gpm. Sediment Description: None
 Did well de-water? NO If yes, Time: _____ Volume: _____ gal.

Time (2400 hr.)	Volume (gal.)	pH	Conductivity (u mhos/cm)	Temperature (°F)	D.O. (mg/L)	ORP (mV)
<u>1212</u>	<u>0.5</u>	<u>8.14</u>	<u>673</u>	<u>15.8</u>	PRE: _____	PRE: _____
<u>1218</u>	<u>1.0</u>	<u>7.99</u>	<u>659</u>	<u>16.7</u>	_____	_____
<u>1224</u>	<u>1.5</u>	<u>7.84</u>	<u>647</u>	<u>16.7</u>	POST: _____	POST: _____

LABORATORY INFORMATION

SAMPLE ID	(#) CONTAINER	REFRIG.	PRESERV. TYPE	LABORATORY	ANALYSES
MW-4	6 vial	YES	HCL	LANCASTER	TPH-G(8015)/BTEX+MTBE(8260)/ETHANOL (8260)
	2 500ml ambers	YES	NP	LANCASTER	TPH-D (8015)

COMMENTS:

Add/Replaced Lock: _____ Add/Replaced Plug: _____ Size: _____



GETTLER-RYAN INC.

WELL MONITORING/SAMPLING FIELD DATA SHEET

Client/Facility #: Chevron #211283 Job Number: 386956
 Site Address: 3810 Broadway Event Date: 12/18/07 (inclusive)
 City: Oakland, CA Sampler: SH

Well ID: MW-5B Date Monitored: 12/18/07 Well Condition: see wcss
 Well Diameter: 2 in.
 Total Depth: 30.22 ft.
 Depth to Water: 27.98 ft.
 Volume Factor (VF): 2.24 x VF 0.17 = 0.38 x3 case volume = Estimated Purge Volume: 1.5 gal.

Volume	3/4"= 0.02	1"= 0.04	2"= 0.17	3"= 0.38
Factor (VF)	4"= 0.66	5"= 1.02	6"= 1.50	12"= 5.80

Check if water column is less than 0.50 ft.

Purge Equipment:
 Disposable Bailer X
 Stainless Steel Bailer _____
 Stack Pump _____
 Suction Pump _____
 Grundfos _____
 Other: _____

Sampling Equipment:
 Disposable Bailer X
 Pressure Bailer _____
 Discrete Bailer _____
 Other: _____

Time Started: _____ (2400 hrs)
 Time Completed: _____ (2400 hrs)
 Depth to Product: _____ ft
 Depth to Water: _____ ft
 Hydrocarbon Thickness: _____ ft
 Visual Confirmation/Description: _____
 Skimmer / Absorbant Sock (circle one)
 Amt Removed from Skimmer: _____ gal
 Amt Removed from Well: _____ gal
 Water Removed: _____
 Product Transferred to: _____

Start Time (purge): 1053 Weather Conditions: Rain
 Sample Time/Date: 1120 12/18/07 Water Color: tan/grey Odor: yes (gas)
 Purging Flow Rate: _____ gpm. Sediment Description: moderat
 Did well de-water? _____ If yes, Time: _____ Volume: _____ gal.

Time (2400 hr.)	Volume (gal.)	pH	Conductivity (umhos/cm)	Temperature (C, F)	D.O. (mg/L)	ORP (mV)
<u>1057</u>	<u>0.5</u>	<u>6.99</u>	<u>694</u>	<u>17.0</u>	PRE: _____	PRE: _____
<u>1100</u>	<u>1.0</u>	<u>7.03</u>	<u>731</u>	<u>16.0</u>	_____	_____
<u>1104</u>	<u>1.5</u>	<u>7.12</u>	<u>742</u>	<u>16.4</u>	POST: _____	POST: _____

LABORATORY INFORMATION

SAMPLE ID	(#) CONTAINER	REFRIG.	PRESERV. TYPE	LABORATORY	ANALYSES
<u>MW-5B</u>	<u>6</u> x vov vial	YES	HCL	LANCASTER	TPH-G(8015)/BTEX+MTBE(8260)/ETHANOL (8260)
	<u>2</u> x 500ml ambers	YES	NP	LANCASTER	TPH-D (8015)

COMMENTS: _____

Add/Replaced Lock: _____ Add/Replaced Plug: _____ Size: _____



GETTLER-RYAN INC.

WELL MONITORING/SAMPLING FIELD DATA SHEET

Client/Facility #: Chevron #211283
 Site Address: 3810 Broadway
 City: Oakland, CA

Job Number: 386956
 Event Date: 12/12/07 (inclusive)
 Sampler: ST

Well ID: MW-6
 Well Diameter: 2 in.
 Total Depth: 22.21 ft.
 Depth to Water: Dry ft.

Date Monitored: 12/12/07 Well Condition: see well log

Volume	3/4"= 0.02	1"= 0.04	2"= 0.17	3"= 0.38
Factor (VF)	4"= 0.66	5"= 1.02	6"= 1.50	12"= 5.80

xVF _____ = _____ x3 case volume= Estimated Purge Volume: _____ gal.

Check if water column is less than 0.50 ft.

Purge Equipment:

Disposable Bailer _____
 Stainless Steel Bailer _____
 Stack Pump _____
 Suction Pump _____
 Grundfos _____
 Other: _____

Sampling Equipment:

Disposable Bailer _____
 Pressure Bailer _____
 Discrete Bailer _____
 Other: _____

Time Started: _____ (2400 hrs)
 Time Completed: _____ (2400 hrs)
 Depth to Product: _____ ft
 Depth to Water: _____ ft
 Hydrocarbon Thickness: _____ ft
 Visual Confirmation/Description: _____
 Skimmer / Absorbant Sock (circle one)
 Amt Removed from Skimmer: _____ gal
 Amt Removed from Well: _____ gal
 Water Removed: _____
 Product Transferred to: _____

Start Time (purge): _____ Weather Conditions: _____
 Sample Time/Date: 1 Water Color: _____ Odor: _____
 Purging Flow Rate: _____ gpm. Sediment Description: _____
 Did well de-water? _____ If yes, Time: _____ Volume: _____ gal.

Time (2400 hr.)	Volume (gal.)	pH	Conductivity (umhos/cm)	Temperature (C / F)	D.O. (mg/L)		ORP (mV)	
					PRE:	POST:	PRE:	POST:

LABORATORY INFORMATION

SAMPLE ID	(#) CONTAINER	REFRIG.	PRESERV. TYPE	LABORATORY	ANALYSES
MW-	x vov vial	YES	HCL	LANCASTER	TPH-G(8015)/BTEX+MTBE(8260)/ ETHANOL (8260)
	x 500ml ambers	YES	NP	LANCASTER	TPH-D (8015)

COMMENTS: Well Dry

Add/Replaced Lock: _____ Add/Replaced Plug: _____ Size: _____



GETTLER-RYAN INC.

WELL MONITORING/SAMPLING FIELD DATA SHEET

Client/Facility #: Chevron #211283
 Site Address: 3810 Broadway
 City: Oakland, CA

Job Number: 386956
 Event Date: 12/18/07 (inclusive)
 Sampler: SH

Well ID: MW-7
 Well Diameter: 2 in.
 Total Depth: 33.43 ft.
 Depth to Water: 27.61 ft.

Date Monitored: 12/18/07 Well Condition: see well log

Volume	3/4"= 0.02	1"= 0.04	2"= 0.17	3"= 0.38
Factor (VF)	4"= 0.66	5"= 1.02	6"= 1.50	12"= 5.80

5.82 x VF 0.17 = 1 x3 case volume= Estimated Purge Volume: 3 gal.
 Check if water column is less than 0.50 ft.

Purge Equipment:

Disposable Bailer X
 Stainless Steel Bailer _____
 Stack Pump _____
 Suction Pump _____
 Grundfos _____
 Other: _____

Sampling Equipment:

Disposable Bailer K
 Pressure Bailer _____
 Discrete Bailer _____
 Other: _____

Time Started: _____ (2400 hrs)
 Time Completed: _____ (2400 hrs)
 Depth to Product: _____ ft
 Depth to Water: _____ ft
 Hydrocarbon Thickness: _____ ft
 Visual Confirmation/Description: _____
 Skimmer / Absorbant Sock (circle one)
 Amt Removed from Skimmer: _____ gal
 Amt Removed from Well: _____ gal
 Water Removed: _____
 Product Transferred to: _____

Start Time (purge): 1022 Weather Conditions: Rain
 Sample Time/Date: 1040 / 12/18/07 Water Color: Tan Odor: NO
 Purging Flow Rate: _____ gpm. Sediment Description: light
 Did well de-water? NO If yes, Time: _____ Volume: _____ gal.

Time (2400 hr.)	Volume (gal.)	pH	Conductivity (umhos/cm)	Temperature (C F)	D.O. (mg/L)	ORP (mV)
<u>1025</u>	<u>1</u>	<u>8.17</u>	<u>654</u>	<u>15.8</u>	PRE: <u>2.1</u>	PRE: <u>68</u>
<u>1028</u>	<u>2</u>	<u>7.92</u>	<u>663</u>	<u>16.4</u>		
<u>1030</u>	<u>3</u>	<u>7.91</u>	<u>660</u>	<u>16.9</u>	POST: <u>1.0</u>	POST: <u>177</u>

LABORATORY INFORMATION

SAMPLE ID	(#) CONTAINER	REFRIG.	PRESERV. TYPE	LABORATORY	ANALYSES
MW-7	6 x vov vial	YES	HCL	LANCASTER	TPH-G(8015)/BTEX+MTBE(8260)/ETHANOL (8260)
	2 x 500ml ambers	YES	NP	LANCASTER	TPH-D (8015)

COMMENTS: _____

Add/Replaced Lock: _____

Add/Replaced Plug: _____ Size: _____



GETTLER-RYAN INC.

WELL MONITORING/SAMPLING FIELD DATA SHEET

Client/Facility #: Chevron #211283 Job Number: 386956
 Site Address: 3810 Broadway Event Date: 12/12/07 (inclusive)
 City: Oakland, CA Sampler: SH

Well ID: MW-9 Date Monitored: _____ Well Condition: _____
 Well Diameter: 2 in.
 Total Depth: _____ ft.
 Depth to Water: _____ ft.

Volume	3/4"= 0.02	1"= 0.04	2"= 0.17	3"= 0.38
Factor (VF)	4"= 0.66	5"= 1.02	6"= 1.50	12"= 5.80

$xVF = \text{_____} \times 3 \text{ case volume} = \text{Estimated Purge Volume: _____ gal.}$
 Check if water column is less than 0.50 ft.

Purge Equipment:

Disposable Bailer _____
 Stainless Steel Bailer _____
 Stack Pump _____
 Suction Pump _____
 Grundfos _____
 Other: _____

Sampling Equipment:

Disposable Bailer _____
 Pressure-Bailer _____
 Discrete Bailer _____
 Other: _____

Time Started: _____ (2400 hrs)
 Time Completed: _____ (2400 hrs)
 Depth to Product: _____ ft
 Depth to Water: _____ ft
 Hydrocarbon Thickness: _____ ft
 Visual Confirmation/Description: _____
 Skimmer / Absorbent Sock (circle one)
 Amt Removed from Skimmer: _____ gal
 Amt Removed from Well: _____ gal
 Water Removed: _____
 Product Transferred to: _____

Start Time (purge): _____ Weather Conditions: _____
 Sample Time/Date: / Water Color: _____ Odor: _____
 Purging Flow Rate: _____ gpm. Sediment Description: _____
 Did well de-water? _____ If yes, Time: _____ Volume: _____ gal.

Time (2400 hr.)	Volume (gal.)	pH	Conductivity (μ mhos/cm)	Temperature (C / F)	D.O. (mg/L)	ORP (mV)
_____	_____	_____	_____	_____	PRE: _____	PRE: _____
_____	_____	_____	_____	_____	POST: _____	POST: _____

LABORATORY INFORMATION

SAMPLE ID	(#) CONTAINER	REFRIG.	PRESERV. TYPE	LABORATORY	ANALYSES
MW-	x vva vial	YES	HCL	LANCASTER	TPH-G(8015)/BTEX+MTBE(8260)/ETHANOL (8260)
	x 500ml ambers	YES	NP	LANCASTER	TPH-D (8015)

COMMENTS: well Under Water

Add/Replaced Lock: _____ Add/Replaced Plug: _____ Size: _____



GETTLER-RYAN INC.

WELL MONITORING/SAMPLING FIELD DATA SHEET

Client/Facility #: Chevron #211283 Job Number: 386956
 Site Address: 3810 Broadway Event Date: 12/18/07 (inclusive)
 City: Oakland, CA Sampler: SIT

Well ID: MW-10 Date Monitored: _____ Well Condition: _____
 Well Diameter: 2 in. Volume Factor (VF) table:
 Total Depth: _____ ft. 3/4"= 0.02 1"= 0.04 2"= 0.17 3"= 0.38
 Depth to Water: _____ ft. 4"= 0.66 5"= 1.02 6"= 1.50 12"= 5.80

Volume	3/4"= 0.02	1"= 0.04	2"= 0.17	3"= 0.38
Factor (VF)	4"= 0.66	5"= 1.02	6"= 1.50	12"= 5.80

_____ xVF _____ = _____ x3 case volume= Estimated Purge Volume: _____ gal.
 Check if water column is less than 0.50 ft.

Purge Equipment:
 Disposable Bailer _____
 Stainless Steel Bailer _____
 Stack Pump _____
 Suction Pump _____
 Grundfos _____
 Other: _____

Sampling Equipment:
 Disposable Bailer _____
 Pressure Bailer _____
 Discrete Bailer _____
 Other: _____

Time Started: _____ (2400 hrs)
 Time Completed: _____ (2400 hrs)
 Depth to Product: _____ ft
 Depth to Water: _____ ft
 Hydrocarbon Thickness: _____ ft
 Visual Confirmation/Description: _____
 Skimmer / Absorbant Sock (circle one)
 Amt Removed from Skimmer: _____ gal
 Amt Removed from Well: _____ gal
 Water Removed: _____
 Product Transferred to: _____

Start Time (purge): _____ Weather Conditions: _____
 Sample Time/Date: _____ / _____ Water Color: _____ Odor: _____
 Purging Flow Rate: _____ gpm. Sediment Description: _____
 Did well de-water? _____ If yes, Time: _____ Volume: _____ gal.

Time (2400 hr.)	Volume (gal.)	pH	Conductivity (u mhos/cm)	Temperature (C / F)	D.O. (mg/L)	ORP (mV)
_____	_____	_____	_____	_____	PRE: _____	PRE: _____
_____	_____	_____	_____	_____	POST: _____	POST: _____

LABORATORY INFORMATION

SAMPLE ID	(#) CONTAINER	REFRIG.	PRESERV. TYPE	LABORATORY	ANALYSES
MW-	x voa vial	YES	HCL	LANCASTER	TPH-G(8015)/BTEX+MTBE(8260)/ETHANOL (8260)
	x 500ml ambers	YES	NP	LANCASTER	TPH-D (8015)

COMMENTS: well under water

Add/Replaced Lock: _____ Add/Replaced Plug: _____ Size: _____



GETTLER-RYAN INC.

WELL MONITORING/SAMPLING FIELD DATA SHEET

Client/Facility #: Chevron #211283 Job Number: 386956
 Site Address: 3810 Broadway Event Date: 12/18/07 (inclusive)
 City: Oakland, CA Sampler: STH

Well ID: MW-11 Date Monitored: 12/18/07 Well Condition: see wcss
 Well Diameter: 2 in.
 Total Depth: 39.47 ft.
 Depth to Water: 33.52 ft.
 $5.95 \times VF = .17 = 1.01 \times \text{case volume} = \text{Estimated Purge Volume: } 3.5 \text{ gal.}$

Volume	3/4"= 0.02	1"= 0.04	2"= 0.17	3"= 0.38
Factor (VF)	4"= 0.66	5"= 1.02	6"= 1.50	12"= 5.80

Check if water column is less than 0.50 ft.

Purge Equipment:

Disposable Bailer X
 Stainless Steel Bailer _____
 Stack Pump _____
 Suction Pump _____
 Grundfos _____
 Other: _____

Sampling Equipment:

Disposable Bailer X
 Pressure Bailer _____
 Discrete Bailer _____
 Other: _____

Time Started: _____ (2400 hrs)
 Time Completed: _____ (2400 hrs)
 Depth to Product: _____ ft
 Depth to Water: _____ ft
 Hydrocarbon Thickness: _____ ft
 Visual Confirmation/Description: _____
 Skimmer / Absorbant Sock (circle one)
 Amt Removed from Skimmer: _____ gal
 Amt Removed from Well: _____ gal
 Water Removed: _____
 Product Transferred to: _____

Start Time (purge): 0936 Weather Conditions: Rain
 Sample Time/Date: 1005 12/18/07 Water Color: Tan Odor: no
 Purging Flow Rate: - gpm. Sediment Description: moderate
 Did well de-water? no If yes, Time: _____ Volume: _____ gal.

Time (2400 hr.)	Volume (gal.)	pH	Conductivity (umhos/cm)	Temperature (C F)	D.O. (mg/L)	ORP (mV)
<u>0940</u>	<u>1</u>	<u>7.04</u>	<u>677</u>	<u>16.3</u>	PRE: _____	PRE: _____
<u>0946</u>	<u>2</u>	<u>7.01</u>	<u>654</u>	<u>16.1</u>	_____	_____
<u>0950</u>	<u>3.5</u>	<u>6.86</u>	<u>642</u>	<u>16.0</u>	POST: _____	POST: _____

LABORATORY INFORMATION

SAMPLE ID	(#) CONTAINER	REFRIG.	PRESERV. TYPE	LABORATORY	ANALYSES
<u>MW-11</u>	<u>6</u> x vva vial	YES	HCL	LANCASTER	TPH-G(8015)/BTEX+MTBE(8260)/ETHANOL (8260)
	<u>2</u> 500ml ambers	YES	NP	LANCASTER	TPH-D (8015)

COMMENTS: _____

Add/Replaced Lock: _____ Add/Replaced Plug: _____ Size: _____



GETTLER-RYAN INC.

WELL MONITORING/SAMPLING FIELD DATA SHEET

Client/Facility #: Chevron #211283
 Site Address: 3810 Broadway
 City: Oakland, CA

Job Number: 386956
 Event Date: 12/18/07 (inclusive)
 Sampler: SH

Well ID: MW-R
 Well Diameter: 2 in.
 Total Depth: 294.2 ft.
 Depth to Water: 27.06 ft.

Date Monitored: 12/12/07 Well Condition: see well log

Volume	3/4"= 0.02	1"= 0.04	2"= 0.17	3"= 0.38
Factor (VF)	4"= 0.66	5"= 1.02	6"= 1.50	12"= 5.80

$2.36 \times VF .17 = 0.4$ x3 case volume= Estimated Purge Volume: 1.5 gal.
 Check if water column is less than 0.50 ft.

Purge Equipment:

Disposable Bailer X
 Stainless Steel Bailer _____
 Stack Pump _____
 Suction Pump _____
 Grundfos _____
 Other: _____

Sampling Equipment:

Disposable Bailer X
 Pressure Bailer _____
 Discrete Bailer _____
 Other: _____

Time Started: _____ (2400 hrs)
 Time Completed: _____ (2400 hrs)
 Depth to Product: _____ ft
 Depth to Water: _____ ft
 Hydrocarbon Thickness: _____ ft
 Visual Confirmation/Description: _____
 Skimmer / Absorbant Sock (circle one)
 Amt Removed from Skimmer: _____ gal
 Amt Removed from Well: _____ gal
 Water Removed: _____
 Product Transferred to: _____

Start Time (purge): 1247 Weather Conditions: Clear
 Sample Time/Date: 1320 12/18/07 Water Color: Tur Odor: NO
 Purging Flow Rate: -- gpm. Sediment Description: None
 Did well de-water? NO If yes, Time: _____ Volume: _____ gal.

Time (2400 hr.)	Volume (gal.)	pH	Conductivity (u mhos/cm)	Temperature (C F)	D.O. (mg/L)	ORP (mV)
<u>1253</u>	<u>0.5</u>	<u>6.93</u>	<u>MEASURING</u>	<u>16.3</u>	PRE: _____	PRE: _____
<u>1300</u>	<u>1.0</u>	<u>6.81</u>	<u>11</u>	<u>16.1</u>	_____	_____
<u>1305</u>	<u>1.5</u>	<u>6.76</u>	<u>11</u>	<u>16.0</u>	POST: _____	POST: _____

LABORATORY INFORMATION

SAMPLE ID	(#) CONTAINER	REFRIG.	PRESERV. TYPE	LABORATORY	ANALYSES
MW-	x voa vial	YES	HCL	LANCASTER	TPH-G(8015)/BTEX+MTBE(8260)/ETHANOL (8260)
	x 500ml ambers	YES	NP	LANCASTER	TPH-D (8015)

COMMENTS: _____

Add/Replaced Lock: _____ Add/Replaced Plug: _____ Size: _____

Chevron California Region Analysis Request/Chain of Custody



121807-01

For Lancaster Laboratories use only

Acct. #: 10904 Sample # 5240970-75 Group #: 000462

1070408

Facility #: SS#211283-OML G-R#386956 Global ID#10600101108
 Site Address: 3810 BROADWAY, OAKLAND, CA
 Chevron PM: SS CRACE
Lead Consultant:
G-R, Inc., 8747 Sierra Court, Suite J, Dublin, Ca. 94568
 Consultant/Office: Deanna L. Harding (deanna@grinc.com)
 Consultant Prj. Mgr.:
 Consultant Phone #: 925-551-7555 Fax #: 925-551-7899
 Sampler: Steve Hunter

Analyses Requested

		Preservation Codes									
		H	H							H	
BTEX + MTBE	<input type="checkbox"/> 8021										
TPH 8015 MOD GRO	<input checked="" type="checkbox"/> 8021										
TPH 8015 MOD DRO	<input type="checkbox"/> Silica Gel Cleanup										
8260 full scan											
Oxygenates											
Total Lead	Method										
Dissolved Lead	Method										
	<u>ETHANOL (8260)</u>										

Preservative Codes
 H = HCl T = Thiosulfate
 N = HNO₃ B = NaOH
 S = H₂SO₄ O = Other

- J value reporting needed
- Must meet lowest detection limits possible for 8260 compounds
- 8021 MTBE Confirmation
- Confirm highest hit by 8260
- Confirm all hits by 8260
- Run ___ oxy's on highest hit
- Run ___ oxy's on all hits

Sample Identification	Date Collected	Time Collected	Grab	Composite	Matrix			Total Number of Containers	Analyses Requested												Comments / Remarks				
					Soil	Water	Oil		BTEX + MTBE	TPH 8015 MOD GRO	TPH 8015 MOD DRO	8260 full scan	Oxygenates	Total Lead	Dissolved Lead	ETHANOL (8260)									
<u>QA</u>	<u>12-18-07</u>		<input checked="" type="checkbox"/>			<input checked="" type="checkbox"/>		<u>2</u>	<input checked="" type="checkbox"/>	<input checked="" type="checkbox"/>															
<u>MW-4</u>		<u>1235</u>	<input checked="" type="checkbox"/>			<input checked="" type="checkbox"/>		<u>8</u>	<input checked="" type="checkbox"/>	<input checked="" type="checkbox"/>	<input checked="" type="checkbox"/>														
<u>MW-8B</u>		<u>1120</u>	<input checked="" type="checkbox"/>			<input checked="" type="checkbox"/>		<u>8</u>	<input checked="" type="checkbox"/>	<input checked="" type="checkbox"/>	<input checked="" type="checkbox"/>														
<u>MW-7</u>		<u>1040</u>	<input checked="" type="checkbox"/>			<input checked="" type="checkbox"/>		<u>8</u>	<input checked="" type="checkbox"/>	<input checked="" type="checkbox"/>	<input checked="" type="checkbox"/>														
<u>MW-11</u>		<u>1005</u>	<input checked="" type="checkbox"/>			<input checked="" type="checkbox"/>		<u>8</u>	<input checked="" type="checkbox"/>	<input checked="" type="checkbox"/>	<input checked="" type="checkbox"/>														
<u>MW-12</u>		<u>1320</u>	<input checked="" type="checkbox"/>			<input checked="" type="checkbox"/>		<u>8</u>	<input checked="" type="checkbox"/>	<input checked="" type="checkbox"/>	<input checked="" type="checkbox"/>														

Turnaround Time Requested (TAT) (please circle) STD. TAT 24 hour 4 day 5 day 72 hour 48 hour	Relinquished by: <u>[Signature]</u>	Date: <u>12/18/07</u>	Time: <u>1430</u>	Received by: <u>[Signature]</u>	Date: <u>18 DEC 07</u>	Time: <u>1430</u>
	Relinquished by: <u>[Signature]</u>	Date: <u>18 DEC 07</u>	Time: <u>1630</u>	Received by: <u>DHL</u>	Date:	Time:
	Relinquished by:	Date:	Time:	Received by:	Date:	Time:
Data Package Options (please circle if required) QC Summary Type I - Full Type VI (Raw Data) <input type="checkbox"/> Coelt Deliverable not needed WIP (RWQCB) Disk	Relinquished by Commercial Carrier: <u>DHL</u>	UPS FedEx Other	Temperature Upon Receipt: <u>1.6°</u> C°	Received by: <u>Robby Binkley</u>	Date: <u>12-19-07</u>	Time: <u>1045</u>
	Custody Seals Intact? <input checked="" type="checkbox"/> Yes <input type="checkbox"/> No					

ANALYTICAL RESULTS

Prepared for:

Chevron
6001 Bollinger Canyon Rd. L4310
San Ramon CA 94583

925-842-8582

Prepared by:

Lancaster Laboratories
2425 New Holland Pike
Lancaster, PA 17605-2425SAMPLE GROUP

The sample group for this submittal is 1070408. Samples arrived at the laboratory on Wednesday, December 19, 2007. The PO# for this group is 0015014975 and the release number is SINHA.

Client DescriptionQA-T-071218 NA Water
MW-4-W-071218 Grab Water
MW-5B-W-071218 Grab Water
MW-7-W-071218 Grab Water
MW-11-W-071218 Grab Water
MW-12-W-071218 Grab WaterLancaster Labs Number5240970
5240971
5240972
5240973
5240974
5240975

ELECTRONIC COPY TO CRA c/o Gettler-Ryan

Attn: Cheryl Hansen

Questions? Contact your Client Services Representative
Angela M Miller at (717) 656-2300

Respectfully Submitted,



Valerie L. Tomayko
Group Leader



Analysis Report

2425 New Holland Pike, PO Box 12425, Lancaster, PA 17605-2425 • 717-656-2300 Fax: 717-656-2681 • www.lancasterlabs.com

Lancaster Laboratories Sample No. WW 5240970

QA-T-071218 NA Water
Facility# 211283 Job# 386956 GRD
3810 Broadway Terrace-Oakland T0600101108 QA
Collected:12/18/2007

Account Number: 10904

Submitted: 12/19/2007 10:45
Reported: 01/02/2008 at 09:47
Discard: 02/02/2008

Chevron
6001 Bollinger Canyon Rd L4310
San Ramon CA 94583

OK-TB
I 5E w

CAT No.	Analysis Name	CAS Number	As Received Result	As Received Method Detection Limit	Units	Dilution Factor
01728	TPH-GRO - Waters The reported concentration of TPH-GRO does not include MTBE or other gasoline constituents eluting prior to the C6 (n-hexane) TPH-GRO range start time.	n.a.	N.D.	50.	ug/l	1
06054	BTEX+MTBE by 8260B					
02010	Methyl Tertiary Butyl Ether	1634-04-4	N.D.	0.5	ug/l	1
05401	Benzene	71-43-2	N.D.	0.5	ug/l	1
05407	Toluene	108-88-3	N.D.	0.5	ug/l	1
05415	Ethylbenzene	100-41-4	N.D.	0.5	ug/l	1
06310	Xylene (Total)	1330-20-7	N.D.	0.5	ug/l	1

State of California Lab Certification No. 2116

All QC is compliant unless otherwise noted. Please refer to the Quality Control Summary for overall QC performance data and associated samples.

Laboratory Chronicle

CAT No.	Analysis Name	Method	Analysis		Analyst	Dilution Factor
			Trial#	Date and Time		
01728	TPH-GRO - Waters	SW-846 8015B modified	1	12/21/2007 12:06	K. Robert Caulfeild-James	1
06054	BTEX+MTBE by 8260B	SW-846 8260B	1	12/27/2007 16:57	Ginelle L Feister	1
01146	GC VOA Water Prep	SW-846 5030B	1	12/21/2007 12:06	K. Robert Caulfeild-James	1
01163	GC/MS VOA Water Prep	SW-846 5030B	1	12/27/2007 16:57	Ginelle L Feister	1



Analysis Report

2425 New Holland Pike, PO Box 12425, Lancaster, PA 17605-2425 • 717-656-2300 Fax: 717-656-2681 • www.lancasterlabs.com

Lancaster Laboratories Sample No. WW 5240971

MW-4-W-071218 Grab Water
 Facility# 211283 Job# 386956 GRD
 3810 Broadway Terrace-Oakland T0600101108 MW-4
 Collected: 12/18/2007 12:35 by SH

Account Number: 10904

Submitted: 12/19/2007 10:45
 Reported: 01/02/2008 at 09:47
 Discard: 02/02/2008

Chevron
 6001 Bollinger Canyon Rd L4310
 San Ramon CA 94583

OK-M4
 I 5E w

CAT No.	Analysis Name	CAS Number	As Received Result	As Received Method Detection Limit	Units	Dilution Factor
01728	TPH-GRO - Waters	n.a.	N.D.	50.	ug/l	1
	The reported concentration of TPH-GRO does not include MTBE or other gasoline constituents eluting prior to the C6 (n-hexane) TPH-GRO range start time.					
06609	TPH-DRO (Waters)	n.a.	3,700.	150.	ug/l	5
06067	BTEX, MTBE, ETOH					
01587	Ethanol	64-17-5	N.D.	50.	ug/l	1
02010	Methyl Tertiary Butyl Ether	1634-04-4	0.6	0.5	ug/l	1
05401	Benzene	71-43-2	N.D.	0.5	ug/l	1
05407	Toluene	108-88-3	N.D.	0.5	ug/l	1
05415	Ethylbenzene	100-41-4	N.D.	0.5	ug/l	1
06310	Xylene (Total)	1330-20-7	N.D.	0.5	ug/l	1

State of California Lab Certification No. 2116

All QC is compliant unless otherwise noted. Please refer to the Quality Control Summary for overall QC performance data and associated samples.

Laboratory Chronicle

CAT No.	Analysis Name	Method	Trial#	Analysis		Analyst	Dilution Factor
				Date	Time		
01728	TPH-GRO - Waters	SW-846 8015B modified	1	12/21/2007	14:17	K. Robert Caulfeild-James	1
06609	TPH-DRO (Waters)	SW-846 8015B	1	12/26/2007	18:50	Diane V Do	5
06067	BTEX, MTBE, ETOH	SW-846 8260B	1	12/27/2007	22:55	Michael A Ziegler	1
01146	GC VOA Water Prep	SW-846 5030B	1	12/21/2007	14:17	K. Robert Caulfeild-James	1
01163	GC/MS VOA Water Prep	SW-846 5030B	1	12/27/2007	22:55	Michael A Ziegler	1
02376	Extraction - Fuel/TPH (Waters)	SW-846 3510C	1	12/20/2007	06:00	Tracy L Schickel	1



Analysis Report

2425 New Holland Pike, PO Box 12425, Lancaster, PA 17605-2425 • 717-656-2300 Fax: 717-656-2681 • www.lancasterlabs.com

Page 1 of 1

Lancaster Laboratories Sample No. WW 5240972

MW-5B-W-071218 Grab Water
Facility# 211283 Job# 386956 GRD
3810 Broadway Terrace-Oakland T0600101108 MW-5B
Collected: 12/18/2007 11:20 by SH

Account Number: 10904

Submitted: 12/19/2007 10:45
Reported: 01/02/2008 at 09:47
Discard: 02/02/2008

Chevron
6001 Bollinger Canyon Rd L4310
San Ramon CA 94583

OKM5B
I 5E w

CAT No.	Analysis Name	CAS Number	As Received Result	As Received Method Detection Limit	Units	Dilution Factor
01728	TPH-GRO - Waters The reported concentration of TPH-GRO does not include MTBE or other gasoline constituents eluting prior to the C6 (n-hexane) TPH-GRO range start time.	n.a.	2,100.	250.	ug/l	5
06609	TPH-DRO (Waters)	n.a.	560.	50.	ug/l	1
06067	BTEX, MTBE, ETOH					
01587	Ethanol	64-17-5	N.D.	50.	ug/l	1
02010	Methyl Tertiary Butyl Ether	1634-04-4	28.	0.5	ug/l	1
05401	Benzene	71-43-2	19.	0.5	ug/l	1
05407	Toluene	108-88-3	N.D.	0.5	ug/l	1
05415	Ethylbenzene	100-41-4	2.	0.5	ug/l	1
06310	Xylene (Total)	1330-20-7	4.	0.5	ug/l	1

State of California Lab Certification No. 2116

All QC is compliant unless otherwise noted. Please refer to the Quality Control Summary for overall QC performance data and associated samples.

Laboratory Chronicle

CAT No.	Analysis Name	Method	Trial#	Analysis		Analyst	Dilution Factor
				Date	Time		
01728	TPH-GRO - Waters	SW-846 8015B modified	1	12/21/2007	14:39	K. Robert Caulfeild-James	5
06609	TPH-DRO (Waters)	SW-846 8015B	1	12/23/2007	01:37	Diane V Do	1
06067	BTEX, MTBE, ETOH	SW-846 8260B	1	12/27/2007	23:18	Michael A Ziegler	1
01146	GC VOA Water Prep	SW-846 5030B	1	12/21/2007	14:39	K. Robert Caulfeild-James	5
01163	GC/MS VOA Water Prep	SW-846 5030B	1	12/27/2007	23:18	Michael A Ziegler	1
02376	Extraction - Fuel/TPH (Waters)	SW-846 3510C	1	12/20/2007	06:00	Tracy L Schickel	1

Lancaster Laboratories Sample No. WW 5240973

MW-7-W-071218 Grab Water
 Facility# 211283 Job# 386956 GRD
 3810 Broadway Terrace-Oakland T0600101108 MW-7
 Collected: 12/18/2007 10:40 by SH

Account Number: 10904

Submitted: 12/19/2007 10:45
 Reported: 01/02/2008 at 09:47
 Discard: 02/02/2008

Chevron
 6001 Bollinger Canyon Rd L4310
 San Ramon CA 94583

OK-M7
 I 5E w

CAT No.	Analysis Name	CAS Number	As Received	As Received	Units	Dilution Factor
			Result	Method Detection Limit		
01728	TPH-GRO - Waters The reported concentration of TPH-GRO does not include MTBE or other gasoline constituents eluting prior to the C6 (n-hexane) TPH-GRO range start time.	n.a.	N.D.	50.	ug/l	1
06609	TPH-DRO (Waters)	n.a.	130.	50.	ug/l	1
06067	BTEX, MTBE, ETOH					
01587	Ethanol	64-17-5	N.D.	50.	ug/l	1
02010	Methyl Tertiary Butyl Ether	1634-04-4	1.	0.5	ug/l	1
05401	Benzene	71-43-2	N.D.	0.5	ug/l	1
05407	Toluene	108-88-3	N.D.	0.5	ug/l	1
05415	Ethylbenzene	100-41-4	N.D.	0.5	ug/l	1
06310	Xylene (Total)	1330-20-7	N.D.	0.5	ug/l	1

State of California Lab Certification No. 2116

All QC is compliant unless otherwise noted. Please refer to the Quality Control Summary for overall QC performance data and associated samples.

Laboratory Chronicle

CAT No.	Analysis Name	Method	Trial#	Analysis	Analyst	Dilution Factor
				Date and Time		
01728	TPH-GRO - Waters	SW-846 8015B modified	1	12/21/2007 15:00	K. Robert Caulfeild-James	1
06609	TPH-DRO (Waters)	SW-846 8015B	1	12/23/2007 02:00	Diane V Do	1
06067	BTEX, MTBE, ETOH	SW-846 8260B	1	12/28/2007 00:04	Michael A Ziegler	1
01146	GC VOA Water Prep	SW-846 5030B	1	12/21/2007 15:00	K. Robert Caulfeild-James	1
01163	GC/MS VOA Water Prep	SW-846 5030B	1	12/28/2007 00:04	Michael A Ziegler	1
02376	Extraction - Fuel/TPH (Waters)	SW-846 3510C	1	12/20/2007 06:00	Tracy L Schickel	1



Analysis Report

2425 New Holland Pike, PO Box 12425, Lancaster, PA 17605-2425 • 717-656-2300 Fax: 717-656-2681 • www.lancasterlabs.com

Page 1 of 1

Lancaster Laboratories Sample No. WW 5240974

MW-11-W-071218 Grab Water
Facility# 211283 Job# 386956 GRD
3810 Broadway Terrace-Oakland T0600101108 MW-11
Collected: 12/18/2007 10:05 by SH

Account Number: 10904

Submitted: 12/19/2007 10:45
Reported: 01/02/2008 at 09:47
Discard: 02/02/2008

Chevron
6001 Bollinger Canyon Rd L4310
San Ramon CA 94583

OKM11
I 5E w

CAT No.	Analysis Name	CAS Number	As Received Result	As Received Method Detection Limit	Units	Dilution Factor
01728	TPH-GRO - Waters	n.a.	N.D.	50.	ug/l	1
	The reported concentration of TPH-GRO does not include MTBE or other gasoline constituents eluting prior to the C6 (n-hexane) TPH-GRO range start time.					
06609	TPH-DRO (Waters)	n.a.	90.	50.	ug/l	1
06067	BTEX, MTBE, ETOH					
01587	Ethanol	64-17-5	N.D.	50.	ug/l	1
02010	Methyl Tertiary Butyl Ether	1634-04-4	2.	0.5	ug/l	1
05401	Benzene	71-43-2	N.D.	0.5	ug/l	1
05407	Toluene	108-88-3	N.D.	0.5	ug/l	1
05415	Ethylbenzene	100-41-4	N.D.	0.5	ug/l	1
06310	Xylene (Total)	1330-20-7	N.D.	0.5	ug/l	1

State of California Lab Certification No. 2116

All QC is compliant unless otherwise noted. Please refer to the Quality Control Summary for overall QC performance data and associated samples.

Laboratory Chronicle

CAT No.	Analysis Name	Method	Trial#	Analysis		Analyst	Dilution Factor
				Date	Time		
01728	TPH-GRO - Waters	SW-846 8015B modified	1	12/21/2007	15:22	K. Robert Caulfeild-James	1
06609	TPH-DRO (Waters)	SW-846 8015B	1	12/23/2007	02:24	Diane V Do	1
06067	BTEX, MTBE, ETOH	SW-846 8260E	1	12/28/2007	01:13	Michael A Ziegler	1
01146	GC VOA Water Prep	SW-846 5030E	1	12/21/2007	15:22	K. Robert Caulfeild-James	1
01163	GC/MS VOA Water Prep	SW-846 5030E	1	12/28/2007	01:13	Michael A Ziegler	1
02376	Extraction - Fuel/TPH (Waters)	SW-846 3510C	1	12/20/2007	06:00	Tracy L Schickel	1

Lancaster Laboratories Sample No. **WW 5240975**

MW-12-W-071218 Grab Water
 Facility# 211283 Job# 386956 GRD
 3810 Broadway Terrace-Oakland T0600101108 MW-12
 Collected: 12/18/2007 13:20 by SH

Account Number: 10904

Submitted: 12/19/2007 10:45
 Reported: 01/02/2008 at 09:47
 Discard: 02/02/2008

Chevron
 6001 Bollinger Canyon Rd L4310
 San Ramon CA 94583

OKM12
 I 5E w

CAT No.	Analysis Name	CAS Number	As Received Result	As Received Method Detection Limit	Units	Dilution Factor
01728	TPH-GRO - Waters	n.a.	230.	50.	ug/l	1
	The reported concentration of TPH-GRO does not include MTBE or other gasoline constituents eluting prior to the C6 (n-hexane) TPH-GRO range start time.					
06609	TPH-DRO (Waters)	n.a.	550.	150.	ug/l	1
	Due to the nature of the sample matrix, a reduced aliquot was used for analysis. The reporting limits were raised accordingly.					
06067	BTEX, MTBE, ETOH					
01587	Ethanol	64-17-5	N.D.	50.	ug/l	1
02010	Methyl Tertiary Butyl Ether	1634-04-4	N.D.	0.5	ug/l	1
05401	Benzene	71-43-2	17.	0.5	ug/l	1
05407	Toluene	108-88-3	N.D.	0.5	ug/l	1
05415	Ethylbenzene	100-41-4	N.D.	0.5	ug/l	1
06310	Xylene (Total)	1330-20-7	N.D.	0.5	ug/l	1
	Preservation requirements were not met. The vial submitted for volatile analysis did not have a pH < 2 at the time of analysis. Due to the volatile nature of the analytes, it is not appropriate for the laboratory to adjust the pH at the time of sample receipt. The pH of this sample was pH = 4.					

State of California Lab Certification No. 2116

All QC is compliant unless otherwise noted. Please refer to the Quality Control Summary for overall QC performance data and associated samples.

Laboratory Chronicle

CAT No.	Analysis Name	Method	Trial#	Analysis Date and Time	Analyst	Dilution Factor
01728	TPH-GRO - Waters	SW-846 8015B modified	1	12/21/2007 15:44	K. Robert Caulfeild-James	1
06609	TPH-DRO (Waters)	SW-846 8015B	1	12/23/2007 02:48	Diane V Do	1
06067	BTEX, MTBE, ETOH	SW-846 8260B	1	12/28/2007 01:36	Michael A Ziegler	1
01146	GC VOA Water Prep	SW-846 5030B	1	12/21/2007 15:44	K. Robert Caulfeild-James	1
01163	GC/MS VOA Water Prep	SW-846 5030B	1	12/28/2007 01:36	Michael A Ziegler	1
02376	Extraction - Fuel/TPH (Waters)	SW-846 3510C	1	12/20/2007 06:00	Tracy L Schickel	1



Analysis Report

2425 New Holland Pike, PO Box 12425, Lancaster, PA 17605-2425 • 717-656-2300 Fax: 717-656-2681 • www.lancasterlabs.com

Page 2 of 2

Lancaster Laboratories Sample No. WW 5240975

MW-12-W-071218 Grab Water
Facility# 211283 Job# 386956 GRD
3810 Broadway Terrace-Oakland T0600101108 MW-12
Collected:12/18/2007 13:20 by SH

Submitted: 12/19/2007 10:45
Reported: 01/02/2008 at 09:47
Discard: 02/02/2008

Account Number: 10904

Chevron
6001 Bollinger Canyon Rd L4310
San Ramon CA 94583

OKM12

Quality Control Summary

 Client Name: Chevron
 Reported: 01/02/08 at 09:47 AM

Group Number: 1070408

Matrix QC may not be reported if site-specific QC samples were not submitted. In these situations, to demonstrate precision and accuracy at a batch level, a LCS/LCSD was performed, unless otherwise specified in the method.

Laboratory Compliance Quality Control

Analysis Name	Blank Result	Blank MDL	Report Units	LCS %REC	LCSD %REC	LCS/LCSD Limits	RPD	RPD Max
Batch number: 073530022A TPH-DRO (Waters)	N.D.	29.	ug/l	94	96	63-119	3	20
Batch number: 07355B20A TPH-GRO - Waters	N.D.	50.	ug/l	90	87	75-135	4	30
Batch number: D073613AA Ethanol	N.D.	50.	ug/l	106		31-166		
Methyl Tertiary Butyl Ether	N.D.	0.5	ug/l	95		73-119		
Benzene	N.D.	0.5	ug/l	100		78-119		
Toluene	N.D.	0.5	ug/l	105		85-115		
Ethylbenzene	N.D.	0.5	ug/l	96		82-119		
Xylene (Total)	N.D.	0.5	ug/l	102		83-113		
Batch number: Z073612AA Methyl Tertiary Butyl Ether	N.D.	0.5	ug/l	97	103	73-119	6	30
Benzene	N.D.	0.5	ug/l	94	96	78-119	2	30
Toluene	N.D.	0.5	ug/l	92	91	85-115	1	30
Ethylbenzene	N.D.	0.5	ug/l	90	91	82-119	1	30
Xylene (Total)	N.D.	0.5	ug/l	92	92	83-113	0	30

Sample Matrix Quality Control

Unspiked (UNSPK) = the sample used in conjunction with the matrix spike
 Background (BKG) = the sample used in conjunction with the duplicate

Analysis Name	MS %REC	MSD %REC	MS/MSD Limits	RPD	RPD MAX	BKG Conc	DUP Conc	DUP RPD	Dup RPD Max
Batch number: 07355B20A TPH-GRO - Waters									
Batch number: D073613AA Ethanol	131	128	32-164	2	30				
Methyl Tertiary Butyl Ether	92	91	69-127	1	30				
Benzene	101	101	83-128	0	30				
Toluene	103	102	83-127	1	30				
Ethylbenzene	97	96	82-129	1	30				
Xylene (Total)	101	102	82-130	0	30				
Batch number: Z073612AA Methyl Tertiary Butyl Ether	98		69-127						
Benzene	97		83-128						
Toluene	95		83-127						
Ethylbenzene	92		82-129						
Xylene (Total)	93		82-130						

*- Outside of specification

- (1) The result for one or both determinations was less than five times the LOQ.
- (2) The unspiked result was more than four times the spike added.

Quality Control Summary

Client Name: Chevron
Reported: 01/02/08 at 09:47 AM

Group Number: 1070408

Sample Matrix Quality Control

Unspiked (UNSPK) = the sample used in conjunction with the matrix spike
Background (BKG) = the sample used in conjunction with the duplicate

Analysis Name	MS %REC	MSD %REC	MS/MSD Limits	RPD	RPD MAX	BKG Conc	DUP Conc	DUP RPD	Dup RPD Max
---------------	------------	-------------	------------------	-----	------------	-------------	-------------	------------	----------------

Surrogate Quality Control

Surrogate recoveries which are outside of the QC window are confirmed unless attributed to dilution or otherwise noted on the Analysis Report.

Analysis Name: TPH-DRO (Waters)
Batch number: 073530022A
Orthoterphenyl

5240971	71
5240972	89
5240973	84
5240974	87
5240975	76
Blank	91
LCS	106
LCSD	107

Limits: 59-131

Analysis Name: TPH-GRO - Waters
Batch number: 07355B20A
Trifluorotoluene-F

5240970	77
5240971	79
5240972	97
5240973	78
5240974	75
5240975	90
Blank	74
LCS	106
LCSD	104
MS	105

Limits: 63-135

Analysis Name: BTEX, MTBE, ETOH
Batch number: D073613AA
Dibromofluoromethane

		1,2-Dichloroethane-d4	Toluene-d8	4-Bromofluorobenzene
5240971	86	91	93	91
5240972	82	86	90	94
5240973	85	89	89	89
5240974	83	87	85	86
5240975	82	87	90	91
Blank	83	89	87	88
LCS	85	91	91	99
MS	83	89	89	97

*- Outside of specification

- (1) The result for one or both determinations was less than five times the LOQ.
- (2) The unspiked result was more than four times the spike added.

Quality Control Summary

Client Name: Chevron
Reported: 01/02/08 at 09:47 AM

Group Number: 1070408

Surrogate Quality Control

MSD	87	92	93	100
Limits:	80-116	77-113	80-113	78-113
Analysis Name: BTEX+MTBE by 8260B				
Batch number: Z073612AA				
	Dibromofluoromethane	1,2-Dichloroethane-d4	Toluene-d8	4-Bromofluorobenzene
5240970	104	108	95	86
Blank	105	109	93	87
LCS	102	105	94	88
LCSD	105	111	93	88
MS	105	109	95	88
Limits:	80-116	77-113	80-113	78-113

*- Outside of specification

- (1) The result for one or both determinations was less than five times the LOQ.
- (2) The unspiked result was more than four times the spike added.

Lancaster Laboratories Explanation of Symbols and Abbreviations

The following defines common symbols and abbreviations used in reporting technical data:

N.D.	none detected	BMQL	Below Minimum Quantitation Level
TNTC	Too Numerous To Count	MPN	Most Probable Number
IU	International Units	CP Units	cobalt-chloroplatinate units
umhos/cm	micromhos/cm	NTU	nephelometric turbidity units
C	degrees Celsius	F	degrees Fahrenheit
Cal	(diet) calories	lb.	pound(s)
meq	milliequivalents	kg	kilogram(s)
g	gram(s)	mg	milligram(s)
ug	microgram(s)	l	liter(s)
ml	milliliter(s)	ul	microliter(s)
m3	cubic meter(s)	fib >5 um/ml	fibers greater than 5 microns in length per ml
<	less than – The number following the sign is the <u>limit of quantitation</u> , the smallest amount of analyte which can be reliably determined using this specific test.		
>	greater than		
ppm	parts per million – One ppm is equivalent to one milligram per kilogram (mg/kg), or one gram per million grams. For aqueous liquids, ppm is usually taken to be equivalent to milligrams per liter (mg/l), because one liter of water has a weight very close to a kilogram. For gases or vapors, one ppm is equivalent to one microliter of gas per liter of gas.		
ppb	parts per billion		
Dry weight basis	Results printed under this heading have been adjusted for moisture content. This increases the analyte weight concentration to approximate the value present in a similar sample without moisture.		

U.S. EPA data qualifiers:

Organic Qualifiers	Inorganic Qualifiers
A TIC is a possible aldol-condensation product	B Value is <CRDL, but ≥IDL
B Analyte was also detected in the blank	E Estimated due to interference
C Pesticide result confirmed by GC/MS	M Duplicate injection precision not met
D Compound quantitated on a diluted sample	N Spike amount not within control limits
E Concentration exceeds the calibration range of the instrument	S Method of standard additions (MSA) used for calculation
J Estimated value	U Compound was not detected
N Presumptive evidence of a compound (TICs only)	W Post digestion spike out of control limits
P Concentration difference between primary and confirmation columns >25%	* Duplicate analysis not within control limits
U Compound was not detected	+ Correlation coefficient for MSA <0.995
X,Y,Z Defined in case narrative	

Analytical test results for methods listed on the laboratories' accreditation scope meet all requirements of NELAC unless otherwise noted under the individual analysis.

Tests results relate only to the sample tested. Clients should be aware that a critical step in a chemical or microbiological analysis is the collection of the sample. Unless the sample analyzed is truly representative of the bulk of material involved, the test results will be meaningless. If you have questions regarding the proper techniques of collecting samples, please contact us. We cannot be held responsible for sample integrity, however, unless sampling has been performed by a member of our staff. This report shall not be reproduced except in full, without the written approval of the laboratory.

WARRANTY AND LIMITS OF LIABILITY – In accepting analytical work, we warrant the accuracy of test results for the sample as submitted. THE FOREGOING EXPRESS WARRANTY IS EXCLUSIVE AND IS GIVEN IN LIEU OF ALL OTHER WARRANTIES, EXPRESSED OR IMPLIED. WE DISCLAIM ANY OTHER WARRANTIES, EXPRESSED OR IMPLIED, INCLUDING A WARRANTY OF FITNESS FOR PARTICULAR PURPOSE AND WARRANTY OF MERCHANTABILITY. IN NO EVENT SHALL LANCASTER LABORATORIES BE LIABLE FOR INDIRECT, SPECIAL, CONSEQUENTIAL, OR INCIDENTAL DAMAGES INCLUDING, BUT NOT LIMITED TO, DAMAGES FOR LOSS OF PROFIT OR GOODWILL REGARDLESS OF (A) THE NEGLIGENCE (EITHER SOLE OR CONCURRENT) OF LANCASTER LABORATORIES AND (B) WHETHER LANCASTER LABORATORIES HAS BEEN INFORMED OF THE POSSIBILITY OF SUCH DAMAGES. We accept no legal responsibility for the purposes for which the client uses the test results. No purchase order or other order for work shall be accepted by Lancaster Laboratories which includes any conditions that vary from the Standard Terms and Conditions of Lancaster Laboratories and we hereby object to any conflicting terms contained in any acceptance or order submitted by client.